



UNITED STATES ENVIRONMENTAL PROTECTION AGENCY
WASHINGTON, DC 20460

OFFICE OF CHEMICAL SAFETY
AND POLLUTION PREVENTION

March 20, 2024

Mandy Slack
Sr. Analyst, Regulatory Affairs
Swiss Farms Products, Inc.
3993 Howard Hughes Parkway, Suite 250
Las Vegas, NV 89169-6754

Subject: Notification per PRN 98-10 – updating label with additional refillable text to the Storage & Disposal Statement as well as optional text to the Ortho Guarantee Statement

Product Name: SF 1345
EPA Registration Number: 73327-19
Application Date: 12/15/2023
Case Number: 494576

Dear Ms. Slack,

The Agency is in receipt of your Application for Pesticide Notification under Pesticide Registration Notice (PRN) 98-10 for the above referenced product. The Registration Division (RD) has conducted a review of this request for its applicability under PRN 98-10 and finds that the action requested falls within the scope of PRN 98-10.

The label submitted with the application has been stamped “Notification” and will be placed in our records.

Should you wish to add/retain a reference to the company’s website on your label, then please be aware that the website becomes labeling under the Federal Insecticide Fungicide and Rodenticide Act and is subject to review by the Agency. If the website is false or misleading, the product would be misbranded and unlawful to sell or distribute under FIFRA section 12(a)(1)(E). 40 CFR 156.10(a)(5) list examples of statements EPA may consider false or misleading. In addition, regardless of whether a website is referenced on your product’s label, claims made on the website may not substantially differ from those claims approved through the registration process. Therefore, should the Agency find or if it is brought to our attention that a website contains false or misleading statements or claims substantially differing from the EPA approved registration, the website will be referred to the EPA’s Office of Enforcement and Compliance.

If you have any questions, you may contact please contact Sayed Islam at 202-566-2796 or by email at islam.sayed@epa.gov.

Page 2 of 2
EPA Reg. No. 73327-19
Case No. 494576

A handwritten signature in black ink, appearing to read "Sacholska", written over a horizontal line.

For

Heather McFarley, Product Manager 24
Fungicide and Herbicide Branch
Registration Division (7505P)
Office of Pesticide Programs

Note to PM:

EPA Reg. No. 73327-19

Bold, italicized text is information for the reader and is not part of the label.

[Bracketed information is optional.] Text separated by / denotes and/or options. **Highlighted** text is new.

[Herbicide]
[Weed and Grass Killer]

SF 1345

ACTIVE INGREDIENTS

Diquat dibromide0.20%

Fluazifop-P-Butyl.....0.07%

Dicamba, Dimethylamine salt0.05%

OTHER INGREDIENTS.....99.68%

Total 100.00%

NOTIFICATION

73327-19

The applicant has certified that no changes, other than those reported to the Agency have been made to the labeling. The Agency acknowledges this notification by letter dated:

3/20/2024

KEEP OUT OF REACH OF CHILDREN

CAUTION

See additional precautionary statements and directions for use in booklet.

EPA Reg. No. 73327-19

EPA Est. No. XXX-XX-X (*insert EPA Registered Establishment Number(s)*)

[Superscript is first letter of lot number]

Net Contents

Bold, italicized text is information for the reader and is not part of the label.

[Bracketed information is optional.] Text separated by / denotes and/or options. **Highlighted** text is new.

FIRST AID
If in eyes: IMMEDIATELY hold eye open and rinse thoroughly and gently with water for 15 to 20 minutes. Remove contact lenses, if present, after the first 5 minutes, then continue rinsing eye. Call a poison control center or doctor for treatment advice.
NOTE TO PHYSICIAN If in eyes, treat symptomatically. Symptoms may develop gradually. Severe damage may be caused by apparently trivial contact and healing may be delayed. Medical supervision should be continued until healing is complete Have the product container or label with you when calling a poison control center or doctor, or going for treatment advice. You may also contact 1-877-465-5161 for emergency medical treatment.

PRECAUTIONARY STATEMENTS

HAZARDS TO HUMANS AND DOMESTIC ANIMALS

CAUTION

May cause eye irritation. Avoid contact with eyes. Protective eyewear is strongly recommended when applying this product. Wash thoroughly with soap and water after handling and before eating, drinking, chewing gum, using tobacco, or using the toilet. Prolonged or frequently repeated skin contact may cause allergic reactions in some individuals.

ENVIRONMENTAL HAZARDS

This pesticide is toxic to fish and aquatic invertebrates. To protect the environment, do not allow pesticide to enter or run off into storm drains, drainage ditches, gutters or surface waters. Applying this product in calm weather when rain is not predicted for the next 24 hours will help to ensure that wind or rain does not blow or wash pesticide off the treatment area.

GROUND WATER ADVISORY: This chemical has properties and characteristics associated with chemicals detected in groundwater. This chemical may leach into groundwater if used in areas where soils are permeable, particularly where the water table is shallow.

SURFACE WATER ADVISORY: This product may impact surface water quality due to runoff of rain water. This is especially true for poorly draining soils and soils with shallow ground water. This product is classified as having a high potential for reaching surface water via runoff.

A level, well-maintained vegetative buffer strip between areas to which this product is applied and surface water features such as ponds, streams, and springs will reduce the potential loading of fluazifop-P-butyl from runoff water and sediment. Runoff of this product will be reduced by avoiding applications when rainfall or irrigation is expected to occur within 48 hours

NON-TARGET ORGANISM ADVISORY: This product is toxic to plants and may adversely impact the forage and habitat of non-target organisms, including pollinators, in areas adjacent to the treated site. Protect the forage and habitat of non-target organisms by following label directions intended to minimize spray drift.

[WARRANTY INFORMATION]

NOTICE: To the extent consistent with applicable law, buyer assumes all risks of use, storage or handling of this product not in accordance with directions.

Bold, italicized text is information for the reader and is not part of the label.



[Bracketed information is optional.] Text separated by / denotes and/or options. **Highlighted** text is new.

DIRECTIONS FOR USE

It is violation of Federal law to use this product in a manner inconsistent with its labeling.

-  People and pets may re-enter after the treated area has been allowed to dry.

USE RESTRICTIONS

- **DO NOT** apply this product in a way that will contact any person or pet either directly or through drift.
- Only persons applying this product may be in the area during application.
- Keep people and pets out of the area during application. 
-  **DO NOT** allow people or pets to enter the treated area until sprays have dried.
- **DO NOT** mow, cut, or disturb treated vegetation for at least 7 days following application.
- **DO NOT** use on or around food or feed crops.
- **DO NOT** apply more than 1 gallon of product per 350 sq ft in a single application. 1 gallon of product contains 0.0166 lb diquat dibromide, 0.0056 lb fluazifop-p-butyl, 0.0044 lb dicamba.
- **DO NOT** apply more than 2 gallons of product per 350 sq ft per year (2 applications of 1 gallon). 2 gallons of product contain 0.0332 lb diquat dibromide, 0.0112 lb fluazifop-p-butyl, 0.0088 lb dicamba.
- If retreatment is necessary, wait 28 days before making a second application.
- **DO NOT** make more than 2 broadcast applications per year.

SPRAY DRIFT ADVISORIES

THE APPLICATOR IS RESPONSIBLE FOR AVOIDING OFF-SITE SPRAY DRIFT. BE AWARE OF NEARBY NON-TARGET SITES AND ENVIRONMENTAL CONDITIONS.

IMPORTANCE OF DROPLET SIZE

An effective way to reduce spray drift is to apply large droplets. Use the largest droplets that provide target pest control. While applying larger droplets will reduce spray drift, the potential for drift will be greater if applications are made improperly or under unfavorable environmental conditions.

HAND HELD TECHNOLOGY APPLICATIONS

Take precautions to minimize spray drift

Rate Conversion Chart

Fl oz product	lb diquat dibromide	lb fluazifop-p-butyl	lb dicamba
24	0.0031	0.0011	0.0008
32	0.0042	0.0014	0.0011
128 (1 gallon)	0.0166	0.0056	0.0044
170 (1.33 gallon)	0.0221	0.0074	0.0059
256 (2 gallons)	0.0332	0.0112	0.0088

Bold, italicized text is information for the reader and is not part of the label.

[Bracketed information is optional.] Text separated by / denotes and/or options. **Highlighted** text is new.

HOW IT WORKS

The dual action of SF 1345/this product kills all types of weeds and grasses. One ingredient works on contact with visible results within hours. The other two ingredients are absorbed and move within the plant, penetrating deep to kill down to the root.

WHERE TO USE

- Around perennial landscape plants, shrubs, or trees
- Patios, walkways, driveways
- Gravel or mulch beds
- Along fences, around buildings
- Preparing landscaped areas
- Lawn renovation

SPRAYER APPLICATOR LANGUAGE SECTION

NOTE TO PM: Spray Pattern Descriptor is any word used to describe the pattern including flat, fan, coarse, or fine.

NOTE TO PM: Quotes around Directions are optional (i.e. "ON", "OFF")

Option 1 – Bottle attached trigger sprayer

[Conventional Trigger RTU/Applicator Device/Applicator Name Directions/Instructions]

[If Applicator is not attached:][Remove cap [and seal], then insert applicator/sprayer in/into the bottle. Tighten applicator/sprayer to bottle/container/pouch]

[HOW TO USE:]

[Spray]

1. Turn sprayer nozzle to desired spray/spray pattern/foam/ setting/perimeter setting/ "On"/spray pattern descriptor.
2. Squeeze trigger [repeatedly] [to spray.]

[Finish]

1. [Turn sprayer nozzle to "OFF"/X.]

Option 2- Hose attached trigger sprayer

[Conventional Trigger Large RTU/Quick Connect Trigger Sprayer/Applicator/Applicator Name Directions/Instructions]

[HOW TO USE:]

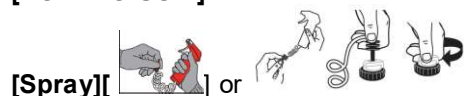

[Spray][

1. Remove sprayer/Applicator Name from bottle/holster/holder/box/container/package [by sliding/pulling/pushing sprayer up/down/in/out].
2. [Remove cap/seal/cover on pouch/container/bottle spout/knob/fitment]
3. Unwrap/Uncoil hose and insert [[color] hose connector] into [color] spout/knob/opening/lid [on][bottle/pouch/container] [cap] [until it clicks].
4. [Flip up [color] spout until fully upright / Twist spout/knob to "ON" / Pull spout up Rotate hose connector [to lock/engage/open/secure].]
5. Turn sprayer nozzle to desired spray/spray pattern/foam/ setting/perimeter setting/ "On"/spray pattern descriptor.
6. Squeeze trigger [repeatedly] [to spray.]

Bold, italicized text is information for the reader and is not part of the label.

[Bracketed information is optional.] Text separated by / denotes and/or options. **Highlighted** text is new.

[Finish]

1. [Turn sprayer nozzle to “OFF” / X.]
2. **[DO NOT DISCONNECT HOSE CONNECTOR [FROM SPOUT/CAP/KNOB/OPENING].]**
3. [Place sprayer back into holster/holder.]

Option 3 – Pull ‘N Spray

[Pull ‘N Spray/Applicator/Applicator Device/Applicator Name Directions/Instructions]

[HOW TO USE:]

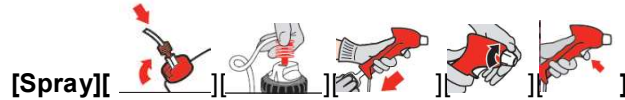

1. Remove sprayer/Applicator Name from bottle/holster/holder/box/container/package [by sliding/pulling/pushing sprayer up/down/in/out]
2. [Remove cap/seal/cover on pouch/container/bottle spout/knob/fitment]
3. Unwrap/Uncoil hose and insert [[color] hose connector] into [color] spout/knob/opening/lid [on][bottle/pouch/container] [cap] [until it clicks].
4. [Flip up [color] spout until fully upright / Twist spout/knob to “ON” / Pull spout up Rotate hose connector [to lock/engage/open/secure].]
5. Turn sprayer nozzle to desired spray/spray pattern/foam/ setting/perimeter setting/ “On”/spray pattern descriptor.
6. Point sprayer away from body. Slowly pull ring at bottom of sprayer until it stops, and hold for two [2] seconds to fill sprayer.
7. Press trigger to spray.

[Finish]

1. [Turn sprayer nozzle to “OFF” / X.]
2. **[DO NOT DISCONNECT HOSE CONNECTOR [FROM SPOUT/CAP/KNOB/OPENING].]**
3. [Place sprayer back into holster/holder.]

Option 4 – Battery Hose Attached Sprayer

[Battery Powered Wand/Comfort Wand/Comfort Shot Wand/Applicator/Wand/Applicator Name Directions/Instructions]

[HOW TO USE:]

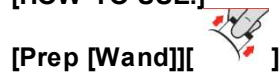

1. Remove sprayer/Applicator Name from bottle/holster/holder/box/container/package [by sliding/pulling/pushing sprayer up/down/in/out].
2. [Remove [color] pull strip to activate batteries].
3. [Unfold / Flip Open [Applicator Name/applicator/wand] until it clicks/locks into position.]
4. [Extend wand/applicator/nozzle] [fully].



1. [Remove cap/seal/cover on pouch/container/bottle spout/knob/fitment]
2. Unwrap/Uncoil hose and insert [[color] hose connector] into [color] spout/knob/opening/lid [on][bottle/pouch/container] [cap] [until it clicks].
3. [Flip up [color] spout until fully upright / Twist spout/knob to “ON” / Pull spout up / Rotate hose connector [to lock/engage/open/secure].]



1. Turn sprayer nozzle to desired spray/spray pattern/foam/ setting/perimeter setting/ “On”/spray pattern descriptor.
2. [Slide [color] switch on trigger to “Unlock”].

Bold, italicized text is information for the reader and is not part of the label.

[Bracketed information is optional.] Text separated by / denotes and/or options. **Highlighted** text is new.

3. Press trigger to spray.



[Finish]

1. [Turn nozzle to "OFF"/X].
2. [Slide [color] switch on trigger to "Lock"].
3. [Fold [Applicator Name/wand/applicator] closed [and place sprayer/wand back in holster/holder].]



Important Use Information: DO NOT submerge in water. When storing sprayer for long periods, remove batteries.

[To replace batteries: See marked diagram inside battery compartment.]

Option 5 – Pump Container with Applicator

[Pump 'n Go/EZ Sprayer/Applicator/Applicator Device/Applicator Name Directions/Instructions]

Instructions for Printing on the Wand and Handle:

Wand: [Insert Arrow Graphic]  SPRAY POSITION **Handle:** [Insert Arrow Graphic]  RELEASE PRESSURE AFTER USE Push handle to cap & turn. RETIGHTEN.

[HOW TO USE:][HOW TO ASSEMBLE AND USE INSTRUCTIONS][FOR][Pump 'n Go/Applicator Name]



[CUT]

1. [Carefully cut the [two] [color] zip tie[s] securing hose and pump handle with scissors, using caution not to cut [color] hose.]



[CONNECT]

2. [Unwind hose.][Firmly push the [hose] connector at the end of the hose onto the [color] spout/cap/knob/opening on the pump [, until it locks into place].]



[PREP [WAND/SPRAYER]][Extend Wand]

Lift sprayer [wand] off bottle. Push [color] button while pulling out on the sprayer/wand nozzle tip. Fully extend wand/sprayer until [color] button snaps into SPRAY POSITION. NOTE: [Color] Trigger will not function until wand is fully extended and [color] button is visible in the SPRAY POSITION.



[PUMP]

Make sure handle is screwed on tightly [, or the bottle will not pressurize]. Pump container 25-30 [X-X] times to pressurize bottle. A full bottle requires fewer pumps than an empty bottle. Pumping to the higher range will provide longer spray duration. After pumping, push pump down and turn handle clockwise/counterclockwise to lock into carrying position.

NOTE: This bottle is designed to expand under pressure and cannot be over-pressurized.

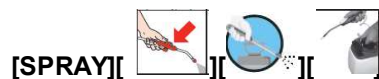

[SPRAY]

Aim wand/sprayer. Spray by pushing down [color] trigger with thumb. Adjust spray pattern by rotating [color] nozzle tip up to one-half rotation.

Bold, italicized text is information for the reader and is not part of the label.

[Bracketed information is optional.] Text separated by / denotes and/or options. **Highlighted** text is new.

[FINISH][STORE]  ]

[When finished spraying,] push the [color] button and retract/fold the wand/sprayer until the [color] button snaps back into the original storage position. Place wand/sprayer back onto the top of the bottle [in the integrated holster with nozzle tip extended through the eyelet opening].

[DEPRESSURIZE]   ]

Push pump handle all the way down and turn pump handle and cap counter-clockwise/clockwise to relieve pressure, then retighten to store.

Option 6 - Squeeze

[Applicator Name/Applicator Directions/Instructions]

[HOW TO USE/APPLY] *Alternative Text:* [HOW TO ASSEMBLE AND USE INSTRUCTIONS]:

[Open:]

1. [Twist off cap and remove foil liner.]
2. [Replace cap.]
3. Flip/Twist/Open Cap

[Spray:]

1. To BEGIN spraying, invert the bottle and point/aim/direct [at the insect/or area of application]
2. Squeeze the bottle [to initiate the flow of product.]
3. Spray only until the surface is wet. / Spray evenly

[Finish:]

1. [To STOP spraying, release pressure / turn bottle upright]
2. [Flip/twist/close the cap [until you hear an audible snap / until secure].]

Option 7 – Flairosol

[Applicator Name/Applicator Directions/Instructions]

[HOW TO USE:]

[Prep]

1. [Before first use prime the trigger by pumping/squeezing it [several/a few times]]
2. [Slide/Press [color] switch/button [on trigger] to “Unlock”].

[Spray/Apply]

1. Squeeze/pump/pull/press trigger/button to release spray/mist
2. Spray [directly] onto/at insects/bugs or onto surfaces

[Finish]

1. [When empty purchase refill bottle & reuse [trigger] sprayer]

Option 8 – Integrated Primo Wand

[Battery Powered/Comfort/Ergo [Shot] Wand/Applicator/Applicator Name Directions/Instructions]

[HOW TO USE:]

[Prep [Wand]]

1. [Unsnap/Unsecure/Unlock wand/applicator and Extend wand/applicator [upward/fully][until it clicks into place]]
2. [Remove [color] pull strip to activate batteries].

Bold, italicized text is information for the reader and is not part of the label.

[Bracketed information is optional.] Text separated by / denotes and/or options. **Highlighted** text is new.

[Spray]

1. Turn sprayer nozzle to desired spray/spray pattern/foam/ setting/perimeter setting/ "On"/spray pattern descriptor.
2. [Slide [color] switch on trigger to "Unlock"].
3. Press trigger to spray.

[Finish]

1. [Turn nozzle to "OFF"/X].
2. [Slide [color] switch on trigger to "Lock"].
3. [Fold [Applicator Name/wand/applicator] closed]

Important Use Information: When storing sprayer for long periods, remove batteries.

[To replace/change batteries: Remove sprayer head/applicator from bottle by rotating clockwise/counterclockwise to access battery compartment. See marked diagram inside battery compartment.]

Optional Troubleshooting Section for Options 4 and 8

Troubleshooting Tips:

Problem: Sprayer does not spray [function].

Possible Cause: Batteries not installed properly.

Solution: See instructions for correct battery placement.

Problem: Sprayer makes a straining noise [Sprayer runs but nothing [no product] comes out].

Possible Cause: Sprayer nozzle is turned off.

Solution: Turn sprayer nozzle to [desired] spray setting [position].

Possible Cause: [Red] [color] hose connector is not flipped up.

Solution: Insert [color] hose connector into [color] spout/knob/opening on bottle cap until it clicks and flip up spout until fully upright.

Possible Cause: Sprayer is not primed.

Solution: Press and hold button on sprayer for about X **(10 / 15 / 20 / 30)** seconds to prime sprayer.

Problem: Spray pattern is weak [or uneven] [product flow is uneven or dribbles out of nozzle].

Possible Cause: Weak batteries.

Solution: Install fresh set of batteries.

Possible Cause: [Red] [color] hose connector is not flipped up.

Solution: Insert [color] hose connector into [color] spout/knob/opening on bottle cap until it clicks. [Attach coupler to the cap] and flip up spout until fully upright.

Possible Cause: Sprayer nozzle not fully open.

Solution: Turn sprayer nozzle to [desired] spray setting [position].

End of Optional Troubleshooting Section for Options 4 and 8

Refill/Applicator Reuse Options

Option 1 – Applicator Reuse

[Applicator Name/Wand] REFILL/REUSE DIRECTIONS

How to attach applicator name/wand to SF 1345/Product Name/refill/recharge/renew/fill-up/reload/bottle/container:

Removing [color] hose/Comfort Wand/Applicator Name from original bottle/container:

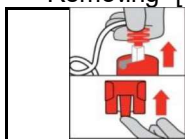

Remove the [color] hose connector from the original bottle/container/pouch by pulling the [color] plug from the [color] spout [on cap].

[To remove the side holster/holder from original bottle/container/pouch, pull/lift the bottom tab underneath and slide the holster/holder up.]

Adding [color] hose/Comfort Wand/Applicator Name to SF 1345/Product Name/refill/recharge/renew/fill-up/reload/bottle/container:

Bold, italicized text is information for the reader and is not part of the label.

[Bracketed information is optional.] Text separated by / denotes and/or options. **Highlighted** text is new.

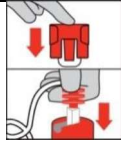
	<p>[Attach the sprayer holster/holder to Ortho Home Defense and Outdoor Insect Killer2/Product Name/refill/recharge/renew/fill-up/reload/bottle/container by sliding the holster/holder down onto the knob.]</p>
<p>Insert [color] hose connector into [color] spout [on cap] [until it clicks].</p>	

OR

[Applicator Name/Flairosol] REFILL: This bottle/container may be refilled with SF 1345/Product Name. To refill twist/snap SF 1345/Product Name into/onto spray/applicator nozzle/top.

OR

[Applicator Name/Flairosol] REFILL/REUSE DIRECTIONS

How to attach Applicator Name/Flairosol to SF 1345/Product Name/refill/recharge/renew/fill-up/reload/bottle/container:

Remove sprayer/applicator/top from the empty container/bottle by rotating it clockwise/counter clockwise. Place sprayer/applicator/top on the refill container and rotate it clockwise/counter clockwise [until it is secure].

OR

Remove sprayer/applicator/top from the empty container by pulling the bottle/container down/out. Place sprayer/applicator/top on the refill container/bottle and push up on the bottle/container [until it is secure].

OR

Refill Container

Use this product to refill the empty [insert brand name for SF 1345] container by pouring product carefully and directly into the container. **DO NOT** add water.

HOW TO REFILL For [Ready-To-Use] Containers with Applicators Intended to be Reused/Refilled To refill this empty container, pour product carefully and directly from the [insert brand name] container designated as the ready-to-use refill container. **DO NOT** add water

Option 2 – Integrated Primo Wand Applicator Reuse

REFILL/REUSE DIRECTIONS / How to Reuse/Refill

How to attach Applicator Name/integrated wand to SF 1345/Product Name/refill/recharge/renew/fill-up/reload/bottle/container:

1. Remove sprayer head/applicator from botte by rotating clockwise/counterclockwise and remove from empty bottle/container/pouch.
2. Remove cap/lid from SF 1345/Product Name/refill/recharge/renew/fill-up/reload/bottle/container/pouch.
3. [Remove Seal.]
4. Insert tube/straw into SF 1345/Product Name/refill/recharge/renew/fill-up/reload/bottle/container/pouch.
5. Secure the sprayer head/applicator from botte/container/pouch by rotating clockwise/counterclockwise

Option 3 – Refill by pouring same RTU formula from Liquaflex refill package

[REFILL DIRECTIONS/INSTRUCTIONS]

1. **DO NOT** reuse or refill this container/pouch. Use this product to refill the empty [Product name] container/bottle/pouch.
2. For best pouring experience place bag and refill bottle next to each other at waist height

Bold, italicized text is information for the reader and is not part of the label.

[Bracketed information is optional.] Text separated by / denotes and/or options. **Highlighted** text is new.

3. Remove cap
4. Grasp [handle] with dominant hand
5. Place the other hand on the front side of the bag/pouch/container for stability
6. Carefully pour liquid into target container/bottle/pouch

Option 4 – Refill by pouring same RTU formula into Pump Container with Applicator

How to refill [Quick Pump/Pump 'N Go/Applicator Name] [using/with] [1.33 Gallon Ready-To-Use Refill/SF 1345/Product Name/refill/recharge/renew/fill-up/reload/bottle/container]:

1. Remove pump handle on Quick Pump/Pump N Go/Applicator Name by twisting it counterclockwise.
2. Remove cap from SF 1345/Product Name/refill/recharge/renew/fill-up/reload/bottle/container/pouch.
3. Pour product carefully and directly into [Quick Pump/Pump 'N Go/Applicator Name] container/bottle. **DO NOT** fill above 2”/3”/4” from top of container/bottle. **DO NOT** add water.

Secure pump handle back on container by twisting it clockwise until tight.

Note to PM: The illustrations may or may not appear on the final printed label. The use of illustrations is dependent upon the size of the packaging.

HOW TO APPLY

- Shake gently before using.
- Spray only the weeds you want to kill. Thoroughly wet the foliage to cover but **DO NOT** spray to runoff.
- For best results, apply when weeds are actively growing and when the air temperature is above 60°F.
- **DO NOT** spray plants you desire to keep. You may use a cardboard or plastic shield to protect desirable plants from spray.
- Apply when air is calm to prevent drift to desirable plants.
- If desirable plants are accidentally sprayed, rinse them off immediately with plenty of water.

WHAT TO EXPECT

- Sprayed weeds begin to [wilt] [die] within hours after application, with complete kill within [days to] 1-2 weeks.
- A single application controls most [listed] weeds.
- Rainproof: rainfall or watering [15/30] minutes after application will not reduce weed control.
- Perennial landscape plants, trees, and shrubs may be planted 1 day after application.

LAWN RENOVATION/REPLACEMENT

Use SF 1345/this product to kill grass and weeds before planting new lawn.

- Determine the size of the area to be treated. [One gallon treats 350 sq. ft.] [One quart treats 88 sq. ft.]
- **DO NOT** mow within [1 week] [7 days] before spraying or [1 week] [7 days] after spraying.
- If soil is dry, water every other day for a week before application.
- Wait 7 days after last application to rake, till, or replant with seed or sod.

Note to PM:

Bold, italicized text is information for the reader and is not part of the label.

[Bracketed information is optional.] Text separated by / denotes and/or options. **Highlighted** text is new.

Weeds Controlled [Optional]

Alder	Cupgrass, Southwestern	Mallow, Common	Pusley, Florida
Aspen, Quaking	Cupgrass, Woolly	Lantana	Quackgrass
Bahiagrass	Cudweed, Purple	Lettuce, Prickly	Rabbitfootgrass
Barley, Wild	Dallisgrass	Little Bitter Cress	Ragweed
Bedsraw	Dandelion	London Rocket	Ragweed, Common
Beggarweed	Dandelion, False	Lovegrass, Diffuse	Ragweed, Giant (Buffaloweed)
Beggarweed, Creeping	Dewberry	Mallow, Venice	Ragwort, Tansy
Beggarweed, Florida	Dock, Curly	Marestail (Horseweed)	Red Rice
Bermudagrass	Dog fennel (Cypressweed)	Mayweed	Ryegrass, Annual
Bentgrass	Eveningprimrose	Medic, Black	Ryegrass, Italian
Bindweed, Field	Eveningprimrose, Common	Medic, Blue	Ryegrass, Perennial
Blackberry, Wild	Eveningprimrose, Cutleaf	Milkweed	Sandbur, Field
Bluegrass	Fennel	Morningglory, Ivyleaf	Sandbur, Southern
Bluegrass, Annual	Fescue species	Morningglory, Tall	Sandspur
Bluegrass, Kentucky	Fescue, Tall	Morningglory, Wild	Sesbania, Hemp
Brassbuttons	Fiddleneck	Mullein, Common	Shattercane
Broadleaf Signalgrass	Filaree	Mustard, Blue	Shepherdspurse
Bromegrass	Foxtail	Mustard, Tansy	Sida, Prickly (Teaweed)
Bromegrass, Smooth	Foxtail, Giant	Mustard, Tumble	Smartweed
Brownseed	Foxtail, Green	Mustard, Wild	Smartweed, Green
Brome, Downy	Foxtail, Yellow	Nimblewill	Smartweed, Pennsylvania
Bur clover	Geranium, Wild	Nutsedge (Nutgrass)	Smartweed, Swamp
Buttercup	Goosegrass	Nutsedge, yellow	Smooth Cat's Ear
Buttercup, Roughseed	Groundsel, Common	Nutsedge, purple	Sorghum alnum
Buttercup, Tall	Guineagrass, Seedling	Oats, wild	Sourdock
Carrot, Wild (Queen Anne's Lace)	Henbit	Oldenlandia	Sowthistle
Catchfly, Nightflowering	Horsenettle	Orchardgrass	Sowthistle, Annual
Cattail	Horseradish	Oxalis	Sowthistle, Spiny
Ceanothus	Ironweed	Oxalis, yellow	Sprangletop
Centipedegrass	Iceplant	Pampasgrass	Spurge
Chamomile, Corn	Ironweed	Panicum, Fall	Spurge, Garden
Cheeseweed	Itchgrass	Panicum, Texas	Spurge, Leafy
Chickweed	Johnsongrass	Paspalum	Spurge, Prostrate
Chickweed, Common	Johnsongrass, Rhizome	Pennycress, Field (Fanweed, Frenchweed, Stinkweed)	Spurge, Spotted
Chickweed, Mouseear	Johnsongrass, Seedling	Pennywort	Starthistle, Yellow
Clover	Junglerice	Pigweed	St. Augustine grass
Clovers (Annual)	Kikuyugrass	Pigweed, Prostrate	Thistle, Artichoke
Clover, Red	Knapweed	Pigweed, Redroot (Carelessweed)	Thistle, Bull
Clover, Sweet	Knapweed, Black	Pigweed, Rough	Thistle, Canada
Clover, White	Knapweed, Diffuse	Pigweed, Smooth	Timothy
Cockle, White	Knapweed, Russian	Pigweed, Tumble	Toadflax, Blue
Cocklebur	Knapweed, Spotted	Plantain	Torpedograss
Cogongrass	Knawel	Plantain, Broadleaf	Trumpet creeper (Buckvine)
Coral bead	Knotweed	Plantain, Buckhorn	Vaseygrass
Crabgrass	Kochia	Plantain, common	Velvetleaf
Crabgrass, Hairy	Ladysthumb	Puncturevine	Virginia Creeper
Crabgrass, Large	Lambsquarters	Purslane	Whiteweed
Crabgrass, Smooth	Lambsquarters, Common	Purslane, Common	Wild Oats
Crabgrass, Southern	Maiden Cane		Wild Proso Millet
Crabgrass, Tropical	Mallow		Wirestem Muhly
Creeping Charlie			Witchgrass
Cupgrass, Prairie			Yarrow
			Yarrow, Common

Bold, italicized text is information for the reader and is not part of the label.

[Bracketed information is optional.] Text separated by / denotes and/or options. **Highlighted** text is new.

STORAGE AND/& DISPOSAL

STORAGE AND/& DISPOSAL

PESTICIDE STORAGE: Keep from freezing. Keep pesticide in original container. Do not put concentrate or dilute into food or drink containers. Store in a cool, dry place, preferable in a locked storage area. To prevent accidental poisoning, never store this product in food, drink, or unlabeled containers.

Note to PM reviewer: Below is For Non-Refillable containers

PESTICIDE DISPOSAL AND CONTAINER HANDLING: **If empty:** Nonrefillable container. Do not reuse or refill this container. Place in trash or offer for recycling if available. **If partly filled:** Call your local solid waste agency for disposal instructions. Never place unused product down any indoor or outdoor drain.

Note to PM: Below is For Refillable Containers

PESTICIDE DISPOSAL AND CONTAINER HANDLING: Refillable container. [Refill this container with /product name only. Do not reuse this container for any other purpose.] **AND/OR** [Applicator Name] can be reused with [Product Name refill bottle/container]. [Follow instructions in the Reuse/Refill Directions [when reusing [applicator name]]. **If empty:** Place in trash or offer for recycling if available. **If partly filled:** Do not pour or dispose down-the-drain or sewer. Call your local solid waste agency for local disposal options. Never place unused product down any indoor or outdoor drain.

Bold, italicized text is information for the reader and is not part of the label.

[Bracketed information is optional.] Text separated by / denotes and/or options. **Highlighted** text is new.

Comprehensive List of Marketing Claims [Optional]

The following claims may or may not appear on any label panel or in advertising. Appropriate formula and company specific information will be inserted on Final Printed Label to replace "X".

1. Absorbed into both broadleaf and grass weeds
2. Experience the [SF 1345] Advantage ([peel back this panel for details] [see details inside/underneath this booklet] [see details on back panel])
3. Peel/Open Here
4. [Open] Resealable Label for Directions and Precautions
5. Press to Reseal
6. Kills [annual and perennial] weeds, grasses and other unwanted plants
7. Multipurpose grass and [broadleaf] weed control [with residual weed control]
8. For weed control - kills weeds and grasses in [1-2 weeks] [2-4 weeks] - roots and all
9. Eliminates most common weeds, grasses and unwanted vegetation
10. [Proven] [Trusted] performance
11. Guaranteed effective: Kills [200] [over 150] [over 175] types of weeds and grasses, roots and all, with just one application
12. One application kills [200] [over 150] [over 175] types of weeds and grasses, roots and all
13. Kills [200] [over 150] [over 175] weeds
14. Kills [to] the root [guaranteed]
15. Kills [the toughest weeds and grasses to] the root so [weeds] [they] don't come back
16. Kills the root so weeds don't come back
17. Kills the roots of [both] broadleaf and grassy weeds
18. Kills weeds and grasses down to the root
19. Kills [all types of] [most/many/common] weeds [and grasses]
20. Spray the leaves to kill the roots
21. [A] single application controls most/many/common [listed] weeds
22. Individual results may vary
23. For outdoor residential use
24. No root. No weed. No Problem.
25. Speeds absorption to the root for complete kill
26. Begins [absorbing] [working] on contact
27. Dead [weeds] in a day
28. For weeds that are dead in [a] [one] day
29. [Next day] [This weekend] results: [Begins] [Starts] killing on contact, visible results in/as fast as [1 hour] [2 hours] [3 hours] [4 hours] [24 hours] [hours]
30. [See] [Visible] results in/as fast as [1] [2] [3] [4] hours
31. Works in hours
32. Starts [to kill] [working] immediately
33. Absorbs on contact, starts working immediately
34. Begins to kill on contact
35. Works when absorbed by the foliage of weeds
36. Overnight results
37. Ideal for killing unwanted weeds and grasses throughout your yard.
38. Use along fences; in cracks of walks, drives and patios; and around perennial beds, trees and shrubs
39. Kills weeds around perennial beds, around trees, shrubs and fences, and on patios, paths, sidewalks, sidewalk cracks, walkways, [and] driveways.
40. Can be used many places weeds and grasses grow, including patios, walkways, and driveways; along fences; in landscaping beds; or around perennials, shrubs and trees

Bold, italicized text is information for the reader and is not part of the label.

[Bracketed information is optional.] Text separated by / denotes and/or options. **Highlighted** text is new.

41. Kills grasses and [broadleaf] weeds in - Patios - Driveways - Sidewalks - Ornamental Gardens
42. [Spray weeds] [Use] in perennial beds, around trees, shrubs and around fences, and on patios, paths, sidewalks, sidewalk cracks, walkways, [and] driveways
43. [Use] For Weed Control: Use along fences, paths, patios, sidewalks and driveways, around trees, shrubs, ornamental plantings, perennial beds and buildings, and in brick and gravel walkways
44. Use to trim and edge landscape areas
45. [Use] For Spot Spraying: Use in and around perennial beds, ornamental trees, shrubs, fences, driveways and walkways
46. For control that [doesn't] [won't] wash away
47. Guaranteed effective results even if it rains within hours
48. Won't be washed away by rain or watering [15 minutes] [30 minutes] after treatment
49. Rainfast/rainproof in [15 minutes] [30 minutes].
50. Rain and waterproof in [15 minutes] [30 minutes or less]
51. Once it enters the plant, it won't wash off
52. Rainfast/rainproof in [15/30] minutes - enters the plant on contact
53. Won't wash off
54. Won't wash away
55. Waterproof
56. Weatherproof
57. Triple-Action [formula]
58. [This product/formula] [combines] [3/three] [actives/active ingredients] [combined] [to] deliver both visible results within hours and deep penetration to kill the roots
59. [3/three/triple] actives/active ingredients [combination]*
60. [Combines] 3/three/triple actives/active ingredients [combination]
61. Dual Activity
62. Economical
63. Value [size/sized]
64. Ready To Use
65. Fast-acting [formula]
66. Fast-acting formula moves to the root [more] quickly
67. Quick kill formula
68. Completely kills even the toughest weeds and grasses
69. Kills to the root so weeds don't come back
70. Water-based formula
71. Low odor
72. Battery operated sprayer
73. Batteries included
74. Refill [included]
75. [Insert packaging type] refill
76. [Insert applicator name] Up to X minutes of continuous spray
77. Continuous spray
78. [Insert applicator name] [with] extended reach/continuous spray [illustration]



79. 2X extended reach*

Note to PM:

Bold, italicized text is information for the reader and is not part of the label.

[Bracketed information is optional.] Text separated by / denotes and/or options. **Highlighted** text is new.

80. Always lock after use [illustration]



81. Extended reach/continuous spray [insert applicator name]

82. [Insert applicator name]/[wand] extends 2 feet [continuous spray] [illustration]



81.

82. [Container] treats/covers [up to] xxxx sq. ft. [Note to reviewer: 24 oz treats up to 65 sq ft, 1 gallon treats up to 350 sq ft]

83. Coverage may vary based on the number, type or size of weeds treated in a given area

84. Spot treat or spray evenly over 350 sq ft

85. Guaranteed [We Guarantee It] [or Your Money Back]

86. Dead Weeds Guaranteed [or Your Money Back]

87. Satisfaction guaranteed or we will gladly refund purchase price

88. Satisfaction guaranteed or your money back with proof of purchase

89. Insert company Promise - satisfaction guaranteed

90. ACE Quality since 1924

*vs previous design [illustration]

Illustrations:

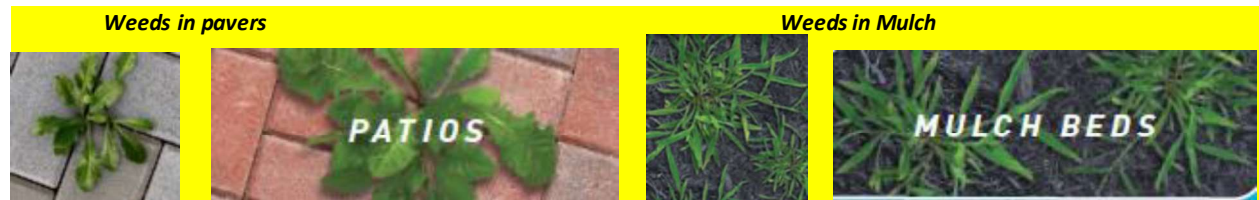

Lawn Renovation



Note to PM:

EPA Reg. No. 73327-19

Bold, italicized text is information for the reader and is not part of the label.

[Bracketed information is optional.] Text separated by / denotes and/or options. **Highlighted** text is new.

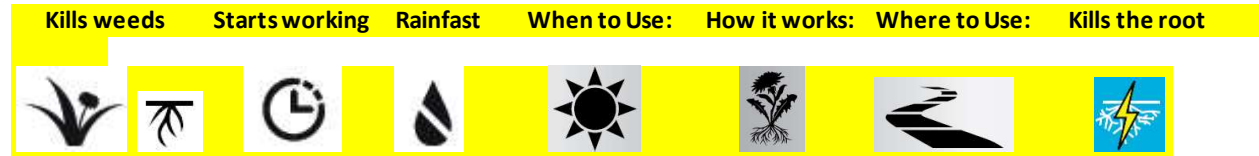

The **[insert company or brand name]** Guarantee: **[When purchased from an authorized seller]** If for any reason you, the consumer are not satisfied with this product, mail us your original proof of purchase to obtain a full refund of your purchase price.

Consumer Guarantee: If for any reason you are not satisfied after using this product, simply send us original proof of purchase and we will refund the purchase price.

The **[insert company/brand]** Promise: If this [company/brand] product when used for its intended purpose fails to give you complete satisfaction return the item to the [company] store where purchased for free replacement of the same or similar item.

Money Back Guarantee. See back panel for details*



*Great quality. Great Price. Guaranteed. Our guarantee is a promise that you'll be fully satisfied with the quality of every (**insert Product Brand Name**) product. If for any reason you aren't happy, we'll replace it or return your money – whichever you prefer. All you need to do is return the empty packaging. It's that simple. Guaranteed. Guaranteed within 1 year of the date of purchase. Questions or comments? Call (855-481-2977).

[OUR PRODUCT GUARANTEE] [Scotts Miracle-Gro] [No-Quibble Money Back Guarantee™] **[insert company/brand]** If for any reason you, the end-user consumer, are not satisfied with the performance of this product, simply submit your proof of purchase and we will happily either refund the purchase price or provide a replacement product (in our sole discretion). Visit ortho.com/refunds for more details.

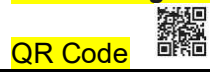
Note to PM: Label text may also appear all or in part in [a foreign language] [insert one or more foreign language] in addition to English.



Questions or Comments?

[Call] [800 number] [icon phone]  [or visit [our website at]] [www._____.com] [icon computer] 

©20XX **Insert Company Name**. [World rights reserved.]

Manufactured for/Sold by/Made for/Produced for:
Swiss Farms Products, Inc.
3993 Howard Hughes Pkwy, Suite 250
Las Vegas, NV 89109

Insert trademark statement

[Assembled in/ Made in/Product of] [USA/ Insert Country]