

72956-1

6/24/2009

1/14



UNITED STATES ENVIRONMENTAL PROTECTION AGENCY  
WASHINGTON, D.C. 20460

JUN 24 2009

OFFICE OF  
PREVENTION, PESTICIDES AND  
TOXIC SUBSTANCES

Ms Cristina Griffin  
Regulatory Agent for,  
Nice-Pak Products, Inc.  
c/o Delta Analytical Corp.  
12510 Prosperity Drive, Suite 160  
Silver Spring, MD 20904

Subject: Sani-Towel  
EPA Registration Number 72956-1  
Your Notification Dated May 27<sup>th</sup>, 2009  
EPA Received Date May 27<sup>th</sup>, 2009

The notification referred to above, submitted in connection with registration under the Federal Insecticide, Fungicide, and Rodenticide Act, FIFRA, as amended, to add two additional brand names, "Sani Professional Brand No-Rinse Cart Wipes" and "Sani Professional Brand No-Rinse Surface Sanitizing Wipe(s)", is acceptable.

Please note: The following additional brand name, "Sani Professional Brand Sani Cart Wipe", is being deleted from the product labeling.

The notification has been part of the permanent record of this file.

If you have any questions concerning this letter, please contact Karen M. Leavy-Munk at (703)-308-6237.

Sincerely,

Marshall Swindell  
Product Manager 33  
Regulatory Management Branch I  
Antimicrobial Division(7510C)

2/14

 <b>EPA</b>	United States <b>Environmental Protection Agency</b> Washington, DC 20460	<input type="checkbox"/> Registration <input type="checkbox"/> Amendment <input checked="" type="checkbox"/> Other	OPP Identifier Number  <b>NOTIF</b>
--	---	--	---

**Application for Pesticide - Section I**

1. Company/Product Number <b>72956-1</b>	2. EPA Product Manager <b>Marshall Swindell</b>	3. Proposed Classification <input type="checkbox"/> None <input type="checkbox"/> Restricted
4. Company/Product (Name) <b>Nice-Pak Products, Inc. / Sani-Towel</b>	PM# <b>33</b>	

5. Name and Address of Applicant (Include ZIP Code) <b>Nice-Pak Products, Inc.</b> <b>c/o Delta Analytical Corp.</b> <b>12510 Prosperity Drive, Suite 160</b> <b>Silver Spring, MD 20904</b> <input type="checkbox"/> Check if this is a new address	6. Expedited Review. In accordance with FIFRA Section 3(c)(3)(b)(i), my product is similar or identical in composition and labeling to:  EPA Reg. No. _____ Product Name _____
---	---

**Section - II**

<input type="checkbox"/> Amendment - Explain below <input type="checkbox"/> Resubmission in response to Agency letter dated _____ <input checked="" type="checkbox"/> Notification - Explain below.	<input type="checkbox"/> Final printed labels in response to Agency letter dated _____ <input type="checkbox"/> "Me Too" Application. <input type="checkbox"/> Other - explain below.
---	---

Explanation: Use additional page(s) if necessary. (For section I and Section II.)

**Notification per PR Notice 98-10 to add 2 alternate brand names, withdraw one previously approved alternate brand name, and add minor changes to page 1.**

This notification is consistent with the provisions of PR Notice 98-10 and EPA regulations at 40 CFR 152.46, and no other changes have been made to the labeling or the confidential statement of formula of this product. I understand that it is a violation of 18 U.S.C. Sec. 1001 to willfully make any false statement to EPA. I further understand that if this notification is not consistent with the terms of PR Notice 98-10 and 40 CFR 152.46, this product may be in violation of FIFRA and I may be subject to enforcement action and penalties under sections 12 and 14 of FIFRA.

**Section - III**

1. Material this Product will be Packaged In:			
Child-Resistant Packaging <input type="checkbox"/> Yes* <input type="checkbox"/> No	Unit Packaging <input type="checkbox"/> Yes <input type="checkbox"/> No  If "Yes," Unit Package wgt.    No. per container	Water Soluble Packaging <input type="checkbox"/> Yes <input type="checkbox"/> No  If "Yes," Unit Package wgt.    No. per container	2. Type of Container <input type="checkbox"/> Metal <input type="checkbox"/> Plastic <input type="checkbox"/> Glass <input type="checkbox"/> Paper <input type="checkbox"/> Other (Specify) _____
* Certification must be submitted.			
3. Location of Net Contents Information <input type="checkbox"/> Label <input type="checkbox"/> Container	4. Size(s) of Retail Container	5. Location of Label Direction <input type="checkbox"/> On Label <input type="checkbox"/> On Labeling accompanying product	
6. Manner In Which Label Is Affixed to Product <input type="checkbox"/> Lithograph <input type="checkbox"/> Paper glued <input type="checkbox"/> Other _____ <input type="checkbox"/> Stenciled			

**Section - IV**

1. Contact Point (Complete items directly below for identification of individual to be contacted, if necessary, to process this application.)		
Name <b>Cristina Griffin</b>	Title <b>Agent for Nice-Pak Products, Inc.</b>	Telephone No. (Include Area Code) <b>301-680-7971</b>

**Certification**

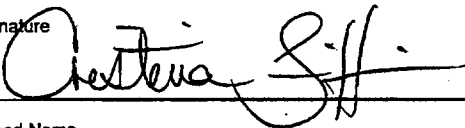
I certify that the statements I have made on this form and all attachments thereto are true, accurate and complete. I acknowledge that any kind of knowingly false or misleading statement may be punishable by fine or imprisonment or both under applicable law.		6. Date Application Received  <b>(Stamped)</b>
2. Signature 	3. Title <b>Agent for Nice-Pak Products, Inc.</b>	
4. Typed Name <b>Cristina Griffin</b>	5. Date <b>May 27, 2009</b>	



May 27, 2009

Document Processing Desk (NOTIF)  
Office of Pesticide Programs (7504P)  
Environmental Protection Agency  
One Potomac Yard  
2777 South Crystal Drive, Room S-4900  
Arlington VA 22202

Attn: Marshall Swindell, PM 33

**RE: Notification per PR Notice 98-10 to add 2 new alternate brand names, withdraw 1 previously approved alternate brand name, and add minor changes**  
**Product: Sani-Towel, EPA Reg. No. 72956-1**  
**Company: Nice-Pak Products, Inc.**

Dear Marshall:

On behalf of Nice-Pak Products, Inc., I am submitting a notification per PR Notice 98-10 to add 2 new alternate brand names, withdraw 1 previously approved alternate brand name, and add minor changes to the labeling for the product Sani-Towel, EPA Reg. No. 72956-1. All changes are to the first page of the label and are highlighted.

The new names are:

**Sani Professional Brand No-Rinse Sani Cart Wipe[s]**  
**Sani Professional Brand No-Rinse Surface Sanitizing Wipe[s]**

Note the previous EPA approved alternate names are listed (but not highlighted because they already were approved). Nice-Pak may wish to make "Wipe" in the names plural, so we have added an optional "s" to each name.

We are withdrawing the following name from this product as this name will be used for another product:

~~**Sani Professional Brand Sani Cart Wipe**~~

The minor label changes are all on page 1 and highlighted:

- Under the ingredient statement we are adding "[Does not include the weight of the [cloth][towelette][or][wipe]]" to clarify the ingredient statement.
- Revising establishment numbers.
- To the "Manufactured by" statement adding "for" as optional when appropriate.
- Added optional [Made in USA]

Enclosures

- EPA form 8570-1
- Revised label highlighted to show additions

If there are any questions or comments regarding this submission, please contact me at 301-680-7971 or [cgriffin@delta-ac.com](mailto:cgriffin@delta-ac.com).

Sincerely,

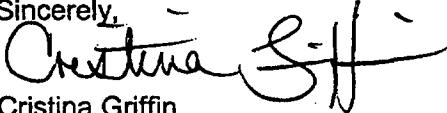

Cristina Griffin  
Agent for Nice-Pak Products, Inc.

Enclosures

cc: David Jones, Nice-Pak Products, Inc

5/14

# SANI-TOWEL®

- [Alternate brand name: No Rinse Sani-Surface Sanitizing and Cleaning Wipe[s]]
- [Alternate brand name: No Rinse Sani-Surface Shopping Cart Sanitizing Wipe[s]]
- [Alternate brand name: Sani Professional Brand Table Turners Sanitizing Wipe[s]]
- [Alternate brand name: Sani Professional Brand Sani Cart Wipe]
- [Alternate brand name: Professional Sani Brand Table Turners Sanitizing Wipe[s]]
- [Alternate brand name: Professional Sani Brand Sani Cart Wipe[s]]
- [Alternate brand name: Sani Brand Kids Zone Sanitizing Wipe[s]]
- [Alternate brand name: Sani Brand Kids Places 'n Spaces Sanitizing Wipe[s]]
- [Alternate brand name: Sani Professional Brand No-Rinse Sani Cart Wipe[s]]
- [Alternate brand name: Sani Professional Brand No-Rinse Surface Sanitizing Wipe[s]]

[NO RINSE HARD, NON-POROUS SURFACE SANITIZING TOWEL]  
 [FOR RESIDENTIAL USE] [FOR HOME USE]

### ACTIVE INGREDIENTS

n-Alkyl(C <sub>12</sub> 67%, C <sub>14</sub> 25%, C <sub>16</sub> 7%, C <sub>8</sub> , C <sub>10</sub> , C <sub>18</sub> 1%) Dimethyl Benzyl	
Ammonium Chloride .....	0.0175%
OTHER INGREDIENTS .....	99.9825%
TOTAL .....	100.0000%

[Does not include the weight of the [cloth] [towelette] [or] [wipe]]

### KEEP OUT OF REACH OF CHILDREN

NET CONTENTS [and/or Net Wt.] \_\_\_\_\_ oz (g) [or lbs. (kg)]  
 \_\_\_ # OF CLOTHS [WIPES] [SIZE of each cloth or wipe]

EPA Reg. No. 72956-1  
 EPA Est. No. 9480-NY-1 [or EPA Est. No. A=9480-NY-1, B=72956-WI-1, C=72956-AR-1 Alpha character will precede batch number on product container]  
 [Made in USA]

[Manufactured [by:] [for:]  
 Nice-Pak Products, Inc.  
 Two Nice-Pak Park  
 Orangeburg, NY 10962-1376  
 [For information call: [phone number to be inserted]]

Statements in brackets [ ] are optional or instructional. The terms "wipe(s)", "towel(s)", "towelette(s)", and "cloth(s)" can be used interchangeably throughout except for the product primary brand name which can be changed only by notification or amendment.

F:\shared\labels\PD\72956-1\ABN notif 052709.doc Page 1 of 10 05/27/09

[Use one of the following as applicable to type of container.]

**[To Dispense TOWELETTES] [or WIPES] [or TOWELS] [or CLOTHS]:**

Remove lid [and discard inner seal] [from container or canister.] Find center of wipe roll, remove first wipe for use, twist corner of next wipe into a point and thread through the hole in the [container or] canister lid. Pull through about one inch. Replace lid. Dispense remaining wipes as necessary by pulling out at an angle. When not in use keep [center cap of] lid closed to prevent moisture loss.

**TRAVEL PACK:**

Peel back label slowly. Pull out wipes as needed and reseal label. Unfold wipe.

**PACKET/PACKAGE:**

Tear open packet [package]. Unfold wipe.

**To Dispense [or To use] [SOLO® PAK] [or soft pack] [or product]:**

Open package lid. Completely remove inner seal. Pull out wipe [at an angle][towards you]. [The next wipe pops up automatically.] Snap lid closed after use to retain moisture.

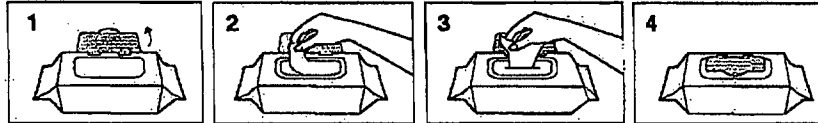

DO NOT FLUSH • STORE AT ROOM TEMPERATURE  
 DISPOSE OF USED WIPES IN TRASH RECEPTACLE • KEEP SOLO®  
 LID CLOSED WHEN NOT IN USE  
 SOLO® is a registered trademark of Nice Pak Products Inc.

**REFILL PACKET:**

This refill package is made for use only in a [product name] container; do not use this product in a container for another product. Do not use the refill wipes in a container that is cracked or broken. Discard the cracked or broken container in accordance with the container disposal instructions on the label.

**[Option 1]**

Remove [entire] lid from container. Tear open refill [package] at [notch] [mark] [arrow] and place [wipe] roll in empty container. Follow information on container to dispense wipes.

**[Option 2]**

Remove [entire] lid from container. Tear open refill [package] at [notch] [mark] [arrow]. Place [entire] refill package of wipes in empty container. Follow information on container to dispense wipes.

**GENERIC:**

Open lid. Pull out wipe. Close lid tightly.

Statements in brackets [ ] are optional or instructional. The terms "wipe(s)", "towel(s)", "towelette(s)", and "cloth(s)" can be used interchangeably throughout except for the product primary brand name which can be changed only by notification or amendment.

F:\shared\labels\PD\172956-1\ABN notif 052709.doc Page 2 of 10 05/27/09

Bucket [or pail or container]

1. Remove the lid from the [pail or bucket or container.]
2. Press open the dispenser at center of the lid.
3. Open the refill pack.
4. Locate the first wipe at the center of the roll.
5. Feed the first wipe though the dispensing orifice.
6. Reapply the lid to the [pail or bucket or container.]
7. Dispense the wipe.

For the refills:

1. Remove the lid from the [pail or bucket or container.]
2. Remove the empty refill pack material from the [pail or bucket or container.]
3. Press open the dispenser at center of the lid.
4. Open the refill pack.
5. Locate the first wipe at the center of the roll.
6. Feed the first wipe though the dispensing orifice.
7. Reapply the lid to the pail.
8. Dispense the wipe.

**GENERIC:**

Open lid. Pull out wipe. Close lid tightly.

[Product is ready for use, no mixing or measuring required.]

**DIRECTIONS FOR USE:**

It is violation of Federal law to use this product in a manner inconsistent with its labeling.

**[CLEANING] [AND] [DEODORIZING]:** Wipe surface with towelette until clean. Let air dry.

**FOOD CONTACT SURFACES**

For use on pre-cleaned hard, non-porous food preparation surfaces. Surfaces include: [Use one or more of the following:] tables, food preparation tables, counter tops, cabinets, sinks, microwaves, ranges, refrigerators and freezers, [the following uses must be preceded by the words: "outside surface[s] of " or "exterior surface[s] of ":] food mixers, bread machines, coffee machines, griddles, toasters, toaster ovens, chargrills, broilers, cooking surfaces and backsplashes, ovens, juicers, [add the following after the list of surfaces:] and other similar hard, non-porous food contact surfaces except for those excluded by this label.†

**Sanitizing food contact surfaces:** Use first towel to pre-clean and remove heavy soil. Use second towel to sanitize. Wipe enough for treated area to remain visibly wet for a minimum of 60 seconds. Let air dry. No rinsing required.

† Do not use to sanitize glassware, cookware, and eating utensils.

<p>Statements in brackets [ ] are optional or instructional. The terms "wipe(s)", "towel(s)", "towelette(s)", and "cloth(s)" can be used interchangeably throughout except for the product primary brand name which can be changed only by notification or amendment.</p> <p>Fishared\labelst\PDI\72956-1\ABN notif 052709.doc</p>	<p>Page 3 of 10</p>	<p>05/27/09</p>
--	---------------------	-----------------

**NON-FOOD CONTACT SURFACES**

[Thoroughly pre-clean if surface is visibly soiled.]

For use on pre-cleaned hard non-porous surfaces. Surfaces include: [Use one or more of the following:] Dining tables, chairs; display cabinets, garbage cans, infant high chairs, booster seats, floors, sinks, drain boards, faucets, toilet seats and rims, vanities, towel dispensers, railings, infant-changing tables, bath tubs, showers, hampers, glazed tiled walls, telephones, playpens, cribs, diaper pails, doorknobs, shopping carts [add the following after the list of surfaces:] and other similar hard, non-porous food contact surfaces except for those excluded by this label.

[Cleaning and] **Sanitizing non-food contact surfaces:** For heavily soiled items, clean prior to sanitizing. Use towel to sanitize surface. Wipe enough for treated surfaces to remain visibly wet for 5 minutes. Use additional towels as needed to keep entire surface area wet for a full 5 minutes. Let air dry. No rinsing required.

99.9% effective in 5 minutes against Staphylococcus aureus (ATCC #6538), Salmonella enterica (ATCC #10708), and Klebsiella pneumoniae (ATCC #4352) [in the presence of organic soil (5% blood serum)].

[Use storage/disposal statement A for hard canisters/dispensers. Use storage/disposal statement B for travel pack or SOLO or [refill] packet/package.]

**STORAGE AND DISPOSAL**

[Statement A:] For containers [canisters] and refill dispensers:

**Storage:** Do not store near heat or open flame. When not in use keep center cap of lid closed to prevent moisture loss. **Towelette Disposal:** Do not reuse towelette. Dispose of used towelette in trash. Do not flush in toilet. **Dispenser Disposal:** Do not reuse empty container. Triple rinse and offer for recycling. If recycling is not available, put in trash collection.

[If refillable container is being used, substitute the following: Refill Dispenser Disposal: Triple rinse cracked or broken containers and offer for recycling. If recycling is not available, discard in trash.]

[Statement B:] For packets, SOLO® Pak, travel packs, and [refill] packets [or package]:

**Storage:** Do not store near heat or open flame.

**Towelette Disposal:** Do not reuse towelette. Dispose of used towelette in trash. Do not flush in toilet.

**Travel Pack [or Solo® Pak or Refill Packet [or [bulk] package]] Disposal:** Put empty travel pack [or Solo® Pak or refill packet [or packaging]] in trash collection.

Statements in brackets [ ] are optional or instructional. The terms "wipe(s)", "towel(s)", "towelette(s)", and "cloth(s)" can be used interchangeably throughout except for the product primary brand name which can be changed only by notification or amendment.



[All below are optional label claims (placement optional), literature and promotional statements]

99.9% effective against [in killing] common household bacteria  
99.999% effective in 60 seconds against Staphylococcus aureus, Escherichia coli and Shigella boydii  
on cleaned, hard, non-porous food contact surfaces

- Always ready to use
- Built-in scrubbing fibers
- Clean and sanitize any room, any time
- Clean and sanitize hard non-porous surfaces all over the house [throughout your home ] [easily]
- Clean and sanitize non-porous surfaces around the house
- Clean and sanitize surfaces your family touches
- Cleans grocery carts and shopping carts
- Cleaner and sanitizing towel [or cloth]
- Cleaning and sanitizing wipes for food preparation surfaces
- Cleans and sanitizes hard non-porous surfaces after food preparation
- Cleans hard to remove stains
- Cleans, deodorizes and kills common household bacteria
- Cloth
- Decorative, stay moist package
- Easily clean and sanitize hard non-porous surfaces around the house
- Easy and effective kitchen sanitizing
- Easy flip top lid
- Effective [effectively] [in] sanitizing [sanitizes ] non-porous kitchen surfaces
- Effective daily cleaner
- Effective on non-porous food prep surfaces
- [Effectively] neutralizes 99.9% of common household bacteria
- Effectively neutralizes 99.9% of common household bacteria that live in your house
- Eliminates odors
- Eradicates 99.9% of common household bacteria
- Everyday, every room sanitizer
- Fast and easy way to clean and sanitize around the house
- Food preparation surfaces
- Food-contact surface wipes
- Food-contact surfaces
- Food-preparation surface sanitizer(s) [wipes]
- For use in supermarkets, grocery stores, retail stores and mass merchants
- For use on hard non-porous surfaces in kitchens [and /or bathrooms]
- For use on pre-cleaned hard, non-porous food contact surfaces
- For use to sanitize shopping carts
- For your toughest kitchen and bathroom messes
- Great for on-the-go cleaning
- Great on-the-go sanitizer
- Hard non-porous surface cleaning and sanitizing [kitchen sanitizing ] made easy
- Heavy duty cleaner [cleaning]
- Ideal for cleaning and sanitizing family spaces
- Ideal for sanitizing family surfaces: highchairs, booster seats, strollers, car seats, cribs, dining tables, kitchen surfaces
- Ideal for sanitizing food [prep] or [contact] surfaces
- Ideal for sanitizing hard non-porous food contact surfaces (tabletops, countertops, sinks, kitchen appliance exteriors, glazed tilework)
- Ideal for shopping cart handles, baby seats, high chairs
- Kills 99.999% of Staphylococcus aureus (ATCC #6538), Escherichia coli (ATCC #11229) and Shigella boydii (ATCC #9207) in 60 seconds on pre-cleaned [hard, non-porous] food contact surfaces
- Kitchen sanitizer(s) that need no rinsing

Statements in brackets [ ] are optional or instructional. The terms "wipe(s)", "towel(s)", "towelette(s)", and "cloth(s)" can be used interchangeably throughout except for the product primary brand name which can be changed only by notification or amendment.

F:\shared\labels\PD1\72956-1\ABN notif 052709.doc Page 5 of 10 05/27/09

Kitchen sanitizing wipes  
 Kitchen surface [sanitizing] wipes [towels]  
 Kitchen surface sanitizer(s)  
 Kitchen surfaces  
 Large, thick, and quilted for everyday cleaning  
 Leaves a shine every time  
 Leaves no streaks  
 Multi-room sanitizer [sanitizing] cleaner  
 No mixing or measuring required  
 No streaking  
 No rinse food contact surface sanitizer  
 No-rinse kitchen [surface] sanitizer(s)  
 No-rinse kitchen sanitizing wipes  
 No-rinse sanitizer(s) for food contact [food prep] [kitchen] surfaces  
 No-rinse sanitizing for kitchen surfaces  
 No-rinse sanitizing wipes  
 Not for sale in [insert state]  
 One-step no rinse sanitizer for hard, non-porous non-food contact surfaces  
 On-the-go sanitizer  
 Pre-measured, pre-moistened sanitizing towels for use on [cleaned] hard, non-porous [food contact] surfaces  
 Pre-moistened [cleaner and] sanitizing towel [or cloth]  
 Pre-soaked [sturdy] cloth [or towel]  
 Pre-sprayed [sturdy] cloth [or towel]  
 Pre-sprayed scrubbing towels  
 Pre-wetted [towel or cloth]  
 Quilted pre-sprayed towels  
 Ready to use. Just pull, wipe and discard  
 For use on cleaned hard, non-porous food contact surfaces in kitchens  
 For use on hard, non-porous non-food contact surfaces as a one step sanitizer  
 Removes tough stains  
 Sanitizer [sanitizing] home [house] [household] [surface] cleaner  
 Sanitizes as it cleans food prep surfaces  
 Sanitizes hard non-porous food prep [kitchen] surfaces [easily]  
 Sanitizes surfaces that come in contact with food without requiring a rinse  
 Sanitizing clean-ups for family areas [spaces]  
 Sanitizing hard non-porous food prep [kitchen] surfaces is easy  
 Sanitizing wipes for family areas  
 Sanitizing wipes for family contact [food contact] [food-preparation] surfaces  
 Sanitizing wipes for hard non-porous surfaces  
 Sanitizing wipes for surfaces families touch  
 Scrubbing house [household] [surface] cleaner  
 The fast, easy and effective way to sanitize cleaned, hard non-porous surfaces  
 The sanitizing wipes that make cleanups easy  
 Towel  
 Use in the kitchen  
 Versatile sanitizer [sanitizing] cleaner  
 Wipes for food-contact surfaces  
 Wipes out 99.9% of common household bacteria  
 Wipes out 99.9% of bacteria

Statements in brackets [ ] are optional or instructional. The terms "wipe(s)", "towel(s)", "towelette(s)", and "cloth(s)" can be used interchangeably throughout except for the product primary brand name which can be changed only by notification or amendment.

Fishared\labels\PDI\72956-1\ABN notif 052709.doc Page 6 of 10 05/27/09

Specifically designed for sanitizing cleaned hard, non-porous surfaces throughout the household. [99.9%] effective in 5 minutes against common household bacteria: Staphylococcus aureus, Salmonella enterica, and Klebsiella pneumoniae. Common uses include: doorknobs, chairs, toilet seats and rims, railings, infant high chairs, infant – changing tables, diaper pails, playpens, booster seats, strollers, cribs, and toy chests.

Specifically designed for sanitizing cleaned hard, non-porous surface areas where food is normally prepared. 99.999% effective in 60 seconds against common Kitchen bacteria: Staphylococcus aureus, Escherichia coli (E coli), Salmonella enterica, Shigella boydii, and Klebsiella pneumoniae in the presence of organic soil (heavy soil must be pre-cleaned first). Common uses include: kitchen counters, tables, cooking surfaces, sinks, shopping cart handles, baby seats, and high chairs.

Statements in brackets [ ] are optional or instructional. The terms "wipe(s)", "towel(s)", "towelette(s)", and "cloth(s)" can be used interchangeably throughout except for the product primary brand name which can be changed only by notification or amendment.

**OPTIONAL GRAPHICS**

[The following graphics and statements are optional.  
They may be placed anywhere on label/container.]

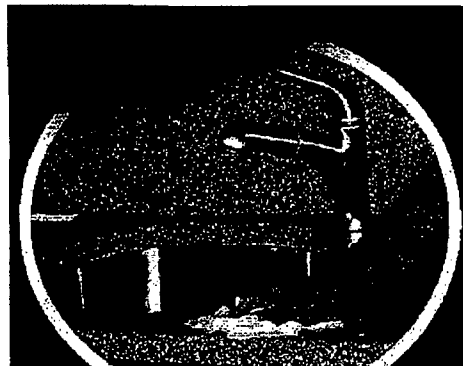

Kitchen Surfaces



Telephones



Toilet Seats



Highchairs/Cribs  
Toy Chests



Changing Tables

Statements in brackets [ ] are optional or instructional. The terms "wipe(s)", "towel(s)", "towelette(s)", and "cloth(s)" can be used interchangeably throughout except for the product primary brand name which can be changed only by notification or amendment.

OPTIONAL GRAPHICS

[The following graphics and statements are optional.  
They may be placed anywhere on label/container.]

**NOT A BABY WIPE  
NOT FOR USE ON SKIN**

[This graphic shows use of the towel dispenser.]



Statements in brackets [ ] are optional or instructional. The terms "wipe(s)", "towel(s)", "towelette(s)", and "cloth(s)" can be used interchangeably throughout except for the product primary brand name which can be changed only by notification or amendment.

**OPTIONAL GRAPHICS**

[The following graphics and statements are optional.  
They may be placed anywhere on label/container.]

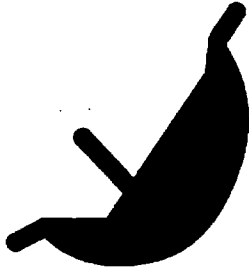

**Car seat**

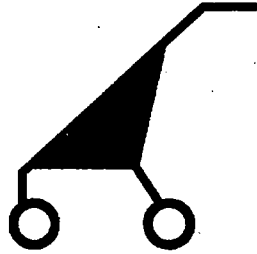

**Stroller**

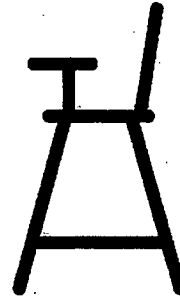

**Highchair**



**Crib**

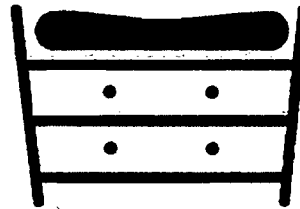

**Changing table**

Statements in brackets [ ] are optional or instructional. The terms "wipe(s)", "towel(s)", "towelette(s)", and "cloth(s)" can be used interchangeably throughout except for the product primary brand name which can be changed only by notification or amendment.