

72956-1

02/14/2006

1/10

UNITED STATES ENVIRONMENTAL PROTECTION AGENCY

Nice-Pak Products, Inc.
c/o Delta Analytical Corp.
7910 Woodmont Avenue, Suite 1000
Bethesda, MD 20814

FEB 14 2006

Attention: Cristina Griffin

Sani Towel
EPA Registration No. 72956-1
Amendment Application Date: January 18, 2006
EPA Received Date: January 19, 2006

This will acknowledge receipt of your notification, "for alternate brand names" submitted under the provisions of FIFRA section 3 (c) 9. Based on a review of the material, the following comment apply.

Additional Brand Names:

No Rinse Sani-Surface Sanitizing and Cleaning Wipes
No Rinse Sani-Surface Shopping Cart Sanitizing Wipes

The alternate brand names are acceptable and has been made a part of the records for this file.

Please note any additional labeling changes must be submitted as a label amendment for the basic label.

If you have any question concerning this letter, please contact me at 703-308-6341 or Portia Jenkins at (703) 308-6230.

Sincerely yours,

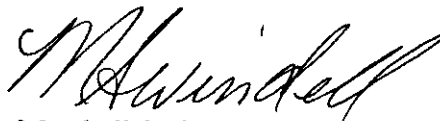

Marshall Swindell
Product Manager 33
Regulatory Management Branch I
Antimicrobials Division (7510C)

CONCURRENCES

SYMBOL								
SURNAME								
DATE								



United States
Environmental Protection Agency
Washington, DC 20460

Registration
 Amendment
 Other

OPP Identifier Number
306999

Application for Pesticide - Section I

1. Company/Product Number 72956-1	2. EPA Product Manager Marshall Swindell	3. Proposed Classification <input type="checkbox"/> None <input type="checkbox"/> Restricted
4. Company/Product (Name) Nice-Pak Products, Inc./ Sani-Towel	PM# 33	
5. Name and Address of Applicant (Include ZIP Code) Nice-Pak Products, Inc. c/o Delta Analytical Corp. 7910 Woodmont Ave. Suite 1000 Bethesda MD 20814 <input type="checkbox"/> Check if this is a new address	6. Expedited Review. In accordance with FIFRA Section 3(c)(3)(b)(i), my product is similar or identical in composition and labeling to: EPA Reg. No. _____ Product Name _____	

Section - II

Amendment - Explain below
 Resubmission in response to Agency letter dated _____
 Notification - Explain below.

Final printed labels in response to Agency letter dated _____
 "Me Too" Application.
 Other - explain below.

Explanation: Use additional page(s) if necessary. (For section I and Section II.)
Notification per PR Notice 98-10 to add 2 alternate brand names, minor claims and graphics.

This notification is consistent with the provisions of PR Notice 98-10 and EPA regulations at 40 CFR 152.46, and no other changes have been made to the labeling or the confidential statement of formula of this product. I understand that it is a violation of 18 U.S.C. Sec. 1001 to willfully make any false statement to EPA. I further understand that if this notification is not consistent with the terms of PR Notice 98-10 and 40 CFR 152.46, this product may be in violation of FIFRA and I may be subject to enforcement action and penalties under sections 12 and 14 of FIFRA.

Section - III

1. Material this Product will be Packaged in:

Child-Resistant Packaging <input type="checkbox"/> Yes* <input type="checkbox"/> No	Unit Packaging <input type="checkbox"/> Yes <input type="checkbox"/> No	Water Soluble Packaging <input type="checkbox"/> Yes <input type="checkbox"/> No	2. Type of Container <input type="checkbox"/> Metal <input type="checkbox"/> Plastic <input type="checkbox"/> Glass <input type="checkbox"/> Paper <input type="checkbox"/> Other (Specify) _____
* Certification must be submitted.		If "Yes," Unit Package wgt. No. per container	If "Yes," Unit Package wgt. No. per container

3. Location of Net Contents Information
 Label Container

4. Size(s) of Retail Container

5. Location of Label Direction
 On Label
 On Labeling accompanying product

6. Manner In Which Label Is Affixed to Product
 Lithograph Other _____
 Paper glued
 Stenciled

Section - IV

1. Contact Point (Complete items directly below for identification of individual to be contacted, if necessary, to process this application.)

Name Cristina Griffin	Title Agent for Nice-Pak Products, Inc	Telephone No. (include Area Code) 301-652-5405
---------------------------------	--	--

Certification

I certify that the statements I have made on this form and all attachments thereto are true, accurate and complete. I acknowledge that any kind of knowingly false or misleading statement may be punishable by fine or imprisonment or both under applicable law.

2. Signature 	3. Title Agent for Nice-Pak Products, Inc	6. Date Application Received (Stamped)
4. Typed Name Cristina Griffin	5. Date January 18, 2006	

SANI-TOWEL®

[Alternate brand name: No Rinse Sani-Surface Sanitizing and Cleaning Wipes]
[Alternate brand name: No Rinse Sani-Surface Shopping Cart Sanitizing Wipes]
[NO RINSE HARD, NON-POROUS SURFACE SANITIZING TOWEL]
[FOR RESIDENTIAL USE] [FOR HOME USE]

ACTIVE INGREDIENTS

n-Alkyl(C ₁₂ 67%, C ₁₄ 25%, C ₁₆ 7%, C ₈ , C ₁₀ , C ₁₈ 1%) Dimethyl Benzyl	
Ammonium Chloride.....	0.0175%
Isopropyl Alcohol.....	5.4800%
OTHER INGREDIENTS	<u>94.5025%</u>
TOTAL	<u>100.0000%</u>

KEEP OUT OF REACH OF CHILDREN

CAUTION

See back [side] panel for additional precautionary statements

NET CONTENTS [or Net Wt.] _____oz (g) [or lbs. (kg)]
____# OF CLOTHS [WIPES] [SIZE of each cloth or wipe]

EPA Reg. No. 72956-1
EPA Est. No.9480-NY-1
[EPA Est. No. A=9480-NY-1, B=9480-IN-1 Alpha character will precede batch number on product container]

[Manufactured by:]
Nice-Pak Products, Inc.
Two Nice-Pak Park
Orangeburg, NY 10962-1376
[For information call: [phone number to be inserted]] [website address]

PRECAUTIONARY STATEMENTS HAZARDS TO HUMANS AND DOMESTIC ANIMALS

CAUTION: Avoid contact with eyes.
Do not use for cleansing or sanitizing human skin.

FIRST AID

If in eyes: Hold eye open and rinse slowly and gently with water for 15 – 20 minutes. Remove contact lenses, if present, after the first five minutes, then continue rinsing eye. Call a poison control center or doctor for treatment advice. Have the product container or label with you when calling a poison control center or doctor, or going for treatment.

Statements in brackets [] are optional or instructional. The terms "wipe(s)", "towel(s)", "towelette(s)", and "cloth(s)" can be used interchangeably throughout except for the product primary brand name which can be changed only by notification or amendment.

DIRECTIONS FOR USE:

It is violation of Federal law to use this product in a manner inconsistent with its labeling.
[Product is ready for use, no mixing or measuring required.]

[Use one of the following as applicable to type of container.]

TOWELETTE [or WIPE] [or TOWEL] [or CLOTH]**CANISTER DIRECTIONS:**

To start feed: Remove lid and discard inner seal from canister. Find center of wipe roll, remove first wipe for use, twist corner of next wipe into a point and thread through the hole in the canister lid. Pull through about one inch. Replace lid. Dispense remaining wipes as necessary by pulling out at an angle. When not in use keep center cap of lid closed to prevent moisture loss.

TRAVEL PACK:

Peel back label slowly. Pull out wipes as needed and reseal label. Unfold wipe.

PACKET:

Tear open packet. Unfold wipe.

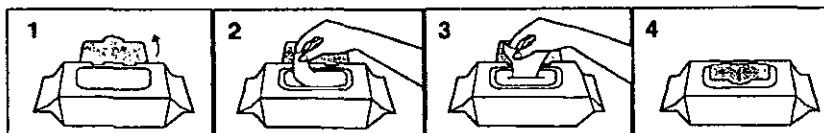
SOLO® PAK:

DO NOT FLUSH • STORE AT ROOM TEMPERATURE
DISPOSE OF USED WIPES IN TRASH RECEPTACLE • KEEP SOLO®
LID CLOSED WHEN NOT IN USE

GENERIC:

Open lid. Pull out wipe. Close lid tightly.

CLEANING: Wipe surface with towelette until clean. Let air dry.

FOOD CONTACT SURFACES

For use on pre-cleaned hard, non-porous food preparation surfaces. Surfaces may include: [Use one or more of the following:] tables, food preparation tables, counter tops, cabinets, sinks, microwaves, ranges, refrigerators and freezers, [the following uses must be preceded by the words: "outside surface[s] of " or "exterior surface[s] of ":] food mixers, bread machines, coffee machines, griddles, toasters, toaster ovens, chargrills, broilers, cooking surfaces and backsplashes, ovens, juicers, [add the following after the list of surfaces:] and other similar hard, non-porous food contact surfaces except for those excluded by this label. †

Sanitizing food contact surfaces: Use first towel to pre-clean and remove heavy soil. Use second towel to sanitize. Wipe enough for treated area to remain visibly wet for a minimum of 60 seconds. Let air dry. No rinsing required.

† Do not use to sanitize glassware, cookware, and eating utensils.

Statements in brackets [] are optional or instructional. The terms "wipe(s)", "towel(s)", "towelette(s)", and "cloth(s)" can be used interchangeably throughout except for the product primary brand name which can be changed only by notification or amendment.

NON-FOOD CONTACT SURFACES

[Thoroughly pre-clean if surface is visibly soiled.]

For use on pre-cleaned hard non-porous surfaces. Surfaces may include: [Use one or more of the following:] Dining tables, chairs, display cabinets, garbage cans, infant high chairs, booster seats, floors, sinks, drain boards, faucets, toilet seats and rims, vanities, towel dispensers, railings, infant-changing tables, bath tubs, showers, hampers, tiled walls, telephones, playpens, cribs, diaper pails, doorknobs, shopping carts [add the following after the list of surfaces:] and other similar hard, non-porous food contact surfaces except for those excluded by this label.

[Cleaning and] **Sanitizing non-food contact surfaces:** For heavily soiled items, clean prior to sanitizing. Use towel to sanitize surface. Wipe enough for treated surfaces to remain visibly wet for 5 minutes. Use additional towels as needed to keep entire surface area wet for a full 5 minutes. Let air dry. No rinsing required.

99.9% effective in 5 minutes against Staphylococcus aureus (ATCC #6538), Salmonella choleraesuis (ATCC #10708), and Klebsiella pneumoniae (ATCC #4352) [in the presence of organic soil (5% blood serum)].

STORAGE AND DISPOSAL

[Use canister or packet/travel pack storage/disposal statements below depending on type of container]

[For canisters]:

Storage: Do not store near heat or open flame. When not in use keep center cap of lid closed to prevent moisture loss.

Towelette Disposal: Do not reuse towelette. Dispose of used towelette in trash. Do not flush in toilet.

Dispenser Disposal: Do not reuse empty container. Wrap container and put in trash collection.

[For packets and travel packs]:

Storage: Do not store near heat or open flame.

Towelette Disposal: Do not reuse towelette. Dispose of used towelette in trash. Do not flush in toilet.

Travel Pack [or Solo® Pak or Packet] Disposal: Put empty travel pack [or Solo® Pak or packet] in trash collection.

Statements in brackets [] are optional or instructional. The terms "wipe(s)", "towel(s)", "towelette(s)", and "cloth(s)" can be used interchangeably throughout except for the product primary brand name which can be changed only by notification or amendment.

[All below are optional label claims (placement optional), literature and promotional statements]

99.9% effective against [in killing] common household bacteria

99.999% effective in 60 seconds against Staphylococcus aureus, Escherichia coli and Shigella boydii
on cleaned, hard, non-porous food contact surfaces

Always ready to use

Built-in scrubbing fibers

Clean and sanitize any room, any time

Clean and sanitize hard non-porous surfaces all over the house [throughout your home] [easily]

Clean and sanitize non-porous surfaces around the house

Clean and sanitize surfaces your family touches

Cleans grocery carts and shopping carts

Cleaner and sanitizing towel [or cloth]

Cleaning and sanitizing wipes for food preparation surfaces

Cleans and sanitizes hard non-porous surfaces after food preparation

Cleans hard to remove stains

Cleans, deodorizes and kills common household bacteria

Cloth

Decorative, stay moist package

Easily clean and sanitize hard non-porous surfaces around the house

Easy and effective kitchen sanitizing

Easy flip top lid

Effective [effectively] [in] sanitizing [sanitizes] non-porous kitchen surfaces

Effective daily cleaner

Effective on non-porous food prep surfaces

[Effectively] neutralizes 99.9% of common household bacteria

Effectively neutralizes 99.9% of common household bacteria that live in your house

Eliminates odors

Eradicates 99.9% of common household bacteria

Everyday, every room sanitizer

Fast and easy way to clean and sanitize around the house

Food preparation surfaces

Food-contact surface wipes

Food-contact surfaces

Food-preparation surface sanitizer(s) [wipes]

For use in supermarkets, grocery stores, retail stores and mass merchants

For use on hard non-porous surfaces in kitchens [and /or bathrooms]

For use on pre-cleaned hard, non-porous food contact surfaces

For use to sanitize shopping carts

For your toughest kitchen and bathroom messes

Great for on-the-go cleaning

Great on-the-go sanitizer

Hard non-porous surface cleaning and sanitizing [kitchen sanitizing] made easy

Heavy duty cleaner [cleaning]

Ideal for cleaning and sanitizing family spaces

Ideal for sanitizing family surfaces: highchairs, booster seats, strollers, car seats, cribs, dining tables,
kitchen surfaces

Ideal for sanitizing food [prep] or [contact] surfaces

Ideal for sanitizing hard non-porous food contact surfaces (tabletops, countertops, sinks, kitchen
appliance exteriors, tilework)

Ideal for shopping cart handles, baby seats, high chairs

Kills 99.999% of Staphylococcus aureus (ATCC #6538), Escherichia coli (ATCC #11229) and Shigella
boydii (ATCC #9207) in 60 seconds on pre-cleaned [hard, non-porous] food contact surfaces

Kitchen sanitizer(s) that need no rinsing

Kitchen sanitizing wipes

Statements in brackets [] are optional or instructional. The terms "wipe(s)", "towel(s)", "towelette(s)",
and "cloth(s)" can be used interchangeably throughout except for the product primary brand name
which can be changed only by notification or amendment.

Kitchen surface [sanitizing] wipes [towels]
 Kitchen surface sanitizer(s)
 Kitchen surfaces
 Large, thick, and quilted for everyday cleaning
 Leaves a shine every time
 Leaves no streaks
 Multi-room sanitizer [sanitizing] cleaner
 No mixing or measuring required
 No streaking
 No rinse food contact surface sanitizer
 No-rinse kitchen [surface] sanitizer(s)
 No-rinse kitchen sanitizing wipes
 No-rinse sanitizer(s) for food contact [food prep] [kitchen] surfaces
 No-rinse sanitizing for kitchen surfaces
 No-rinse sanitizing wipes
 One-step no rinse sanitizer for hard, non-porous non-food contact surfaces
 On-the-go sanitizer
 Pre-measured, pre-moistened sanitizing towels for use on [cleaned] hard, non-porous [food contact] surfaces
 Pre-moistened [cleaner and] sanitizing towel [or cloth]
 Pre-soaked [sturdy] cloth [or towel]
 Pre-sprayed [sturdy] cloth [or towel]
 Pre-sprayed scrubbing towels
 Pre-wetted [towel or cloth]
 Quilted pre-sprayed towels
 Ready to use. Just pull, wipe and discard
 Recommended for use on cleaned hard, non-porous food contact surfaces in kitchens
 Recommended for use on hard, non-porous non-food contact surfaces as a one step sanitizer
 Removes tough stains
 Sanitizer [sanitizing] home [house] [household] [surface] cleaner
 Sanitizes as it cleans food prep surfaces
 Sanitizes hard non-porous food prep [kitchen] surfaces [easily]
 Sanitizes surfaces that come in contact with food without requiring a rinse
 Sanitizing clean-ups for family areas [spaces]
 Sanitizing hard non-porous food prep [kitchen] surfaces is easy
 Sanitizing wipes for family areas
 Sanitizing wipes for family contact [food contact] [food-preparation] surfaces
 Sanitizing wipes for hard non-porous surfaces
 Sanitizing wipes for surfaces families touch
 Scrubbing house [household] [surface] cleaner
 The fast, easy and effective way to sanitize cleaned, hard non-porous surfaces
 The sanitizing wipes that make cleanups easy
 Towel
 Use in the kitchen
 Versatile sanitizer [sanitizing] cleaner
 Wipes for food-contact surfaces
 Wipes out 99.9% of common household bacteria
 Wipes out 99.9% of bacteria that commonly infect your home

Statements in brackets [] are optional or instructional. The terms "wipe(s)", "towel(s)", "towelette(s)", and "cloth(s)" can be used interchangeably throughout except for the product primary brand name which can be changed only by notification or amendment.

Specifically designed for sanitizing cleaned hard, non-porous surfaces throughout the household. [99.9%] effective in 5 minutes against common household bacteria: *Staphylococcus aureus*, *Salmonella choleraesuis*, and *Klebsiella pneumoniae*. Common uses include: doorknobs, chairs, toilet seats and rims, railings, infant high chairs, infant – changing tables, diaper pails, playpens, booster seats, strollers, cribs, and toy chests.

Specifically designed for sanitizing cleaned hard, non-porous surface areas where food is normally prepared. 99.9% effective in 60 seconds against common Kitchen bacteria: *Staphylococcus aureus*, *Escherichia coli* (E coli), *Salmonella choleraesuis*, *Shigella boydii*, and *Klebsiella pneumoniae* in the presence of organic soil (heavy soil must be pre-cleaned first). Common uses include: kitchen counters, tables, cooking surfaces, sinks, shopping cart handles, baby seats, and high chairs.

Statements in brackets [] are optional or instructional. The terms “wipe(s)”, “towel(s)”, “towelette(s)”, and “cloth(s)” can be used interchangeably throughout except for the product primary brand name which can be changed only by notification or amendment.

OPTIONAL GRAPHICS

[The following graphics and statements are optional. They may be placed anywhere on label/container.]

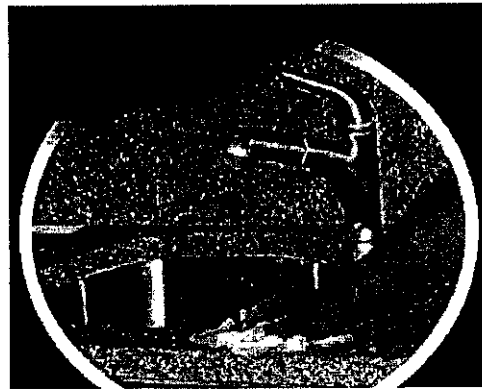

Kitchen Surfaces



Telephones

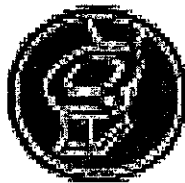

Toilet Seats

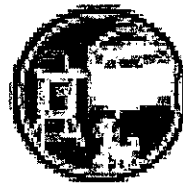

High Chairs/Cribs
Toy Chests



Changing Tables

Statements in brackets [] are optional or instructional. The terms "wipe(s)", "towel(s)", "towelette(s)", and "cloth(s)" can be used interchangeably throughout except for the product primary brand name which can be changed only by notification or amendment.

OPTIONAL GRAPHICS

[The following graphics and statements are optional. They may be placed anywhere on label/container.]



[This graphic shows use of the towel dispenser.]

NOT A BABY WIPE

NOT FOR USE ON SKIN

Statements in brackets [] are optional or instructional. The terms "wipe(s)", "towel(s)", "toweletie(s)" and "cloth(s)" can be used interchangeably throughout except for the product primary brand name which can be changed only by notification or amendment.

fishared\labels\pdil sani-towel\011706 Sani-towel notif .doc Page 8 of 8 1/17/06