



U.S. ENVIRONMENTAL PROTECTION AGENCY  
Office of Pesticide Programs  
Registration Division (H7505C)  
401 "M" St., S.W.  
Washington, D.C. 20460

EPA Reg. Number:  
72956-1

Date of Issuance:  
OCT 28 2005

NOTICE OF PESTICIDE:  
 Registration  
 Reregistration

Term of Issuance:  
Unconditional

(under FIFRA, as amended)

Name of Pesticide Product:  
Sani-Towel

Name and Address of Registrant (include ZIP Code):

Nice Pak Products, Inc.  
2 Nice Pak Park  
Orangeburg, NY 10962

**Note:** Changes in labeling differing in substance from that accepted in connection with this registration must be submitted to and accepted by the Registration Division prior to use of the label in commerce. In any correspondence on this product always refer to the above EPA registration number.

On the basis of information furnished by the registrant, the above named pesticide is hereby registered/reregistration under the Federal Insecticide, Fungicide and Rodenticide Act.

Registration is in no way to be construed as an endorsement or recommendation of this product by the Agency. In order to protect health and the environment, the Administrator, on his motion, may at any time suspend or cancel the registration of a pesticide in accordance with the Act. The acceptance of any name in connection with the registration of a product under this Act is not to be construed as giving the registrant a right to exclusive use of the name or to its use if it has been covered by others.

This product is conditionally registered in accordance with FIFRA sec. 3(c)(7)(A) provided that you:

1. Submit and/or cite all data or other material required for registration/reregistration of your product under FIFRA sec. 3(c)(5) or FIFRA sec. 4 when the Agency requires all registrants of similar products to submit such data.

2. Make the following labeling changes:

a) Add the phrase EPA Registration No. "72956-1"

Signature of Approving Official:

Marshall Swindell, Product Manager (33)  
Regulatory Management Branch I  
Antimicrobials Division (7510C)

Date:

OCT 28 2005

- b) Delete the statements "Germ Killing, Destroys common household germs, and any Germicidal claims" from the label.
  - c) Delete the statement "Eradicate 99.9% bacteria" and revise the claim for bacteria to read: "odor causing bacteria "
  - d) Delete the statement "Destroys common microbes"
3. Submit five (2) copies of your final printed labeling before you release the product for shipment. Refer to the A-79 enclosure for a further description of final printed labeling.

If these conditions are not complied with, the registration will be subject to cancellation in accordance with FIFRA sec. 6(e). Your release for shipment of the product constitutes acceptance of these conditions.

A stamped copy of the label is enclosed for your records.

Sincerely,

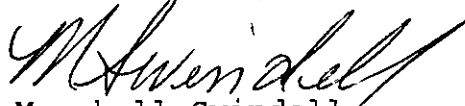

Marshall Swindell  
Product Manager 33  
Regulatory Management Branch I  
Antimicrobials Division (7501C)

Enclosure

379

# SANI-TOWEL®

[NO RINSE HARD, NON-POROUS SURFACE SANITIZING TOWEL]  
[FOR RESIDENTIAL USE] [FOR HOME USE]

### ACTIVE INGREDIENTS

n-Alkyl(C <sub>12</sub> 67%, C <sub>14</sub> 25%, C <sub>16</sub> 7%, C <sub>8</sub> , C <sub>10</sub> , C <sub>18</sub> 1%) Dimethyl Benzyl	
Ammonium Chloride.....	0.0175%
Isopropyl Alcohol.....	5.4800%
OTHER INGREDIENTS .....	94.5025%
TOTAL .....	100.0000%

KEEP OUT OF REACH OF CHILDREN

### CAUTION

See back [side] panel for additional precautionary statements

NET CONTENTS [or Net Wt.] \_\_\_\_\_oz (g) [or lbs. (kg)]  
\_\_\_\_# OF CLOTHS [SIZE of each cloth]

**ACCEPTED**  
with **COMMENTS**  
EPA Letter Dated:

OCT 28 2005

Under the Federal Insecticide,  
Fungicide, and Rodenticide Act as  
amended, for the pesticide,  
registered under EPA Reg. No.

72956-1

EPA Reg. No. 72956-  
EPA Est. No.9480-NY-1  
[EPA Est. No. A=9480-NY-1, B=9480-IN-1 Alpha character will precede batch number on product  
container]

[Manufactured by:]  
Nice-Pak Products, Inc.  
Two Nice-Pak Park  
Orangeburg, NY 10962-1376  
[For information call: [phone number to be inserted]] [website address]

### PRECAUTIONARY STATEMENTS HAZARDS TO HUMANS AND DOMESTIC ANIMALS

**CAUTION:** Avoid contact with eyes.  
**Do not use for cleansing or sanitizing human skin.**

### FIRST AID

**If in eyes:** Hold eye open and rinse slowly and gently with water for 15 – 20 minutes. Remove contact lenses, if present, after the first five minutes, then continue rinsing eye. Call a poison control center or doctor for treatment advice. Have the product container or label with you when calling a poison control center or doctor, or going for treatment.

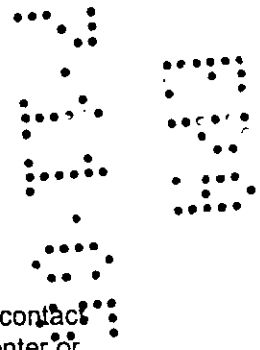

Statements in brackets [ ] are optional or instructional. The terms "wipe(s)", "towel(s)", "towelette(s)", and "cloth(s)" can be used interchangeably throughout except for the product primary brand name which can be changed only by notification or amendment.

4 8 9

**DIRECTIONS FOR USE:**

It is violation of Federal law to use this product in a manner inconsistent with its labeling. [Product is ready for use, no mixing or measuring required.]

[Use one of the following as applicable to type of container:]

**TOWELETTE [or WIPE] [or TOWEL] [or CLOTH]**

**CANISTER DIRECTIONS:**

To start feed: Remove lid and discard inner seal from canister. Find center of wipe roll, remove first wipe for use, twist corner of next wipe into a point and thread through the hole in the canister lid. Pull through about one inch. Replace lid. Dispense remaining wipes as necessary by pulling out at an angle. When not in use keep center cap of lid closed to prevent moisture loss.

**TRAVEL PACK:**

Peel back label slowly. Pull out wipes as needed and reseal label. Unfold wipe.

**PACKET:**

Tear open packet. Unfold wipe.

**SOLO® PAK:**

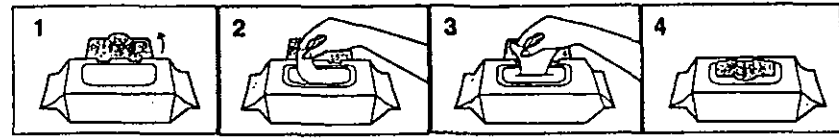

DO NOT FLUSH • STORE AT ROOM TEMPERATURE  
DISPOSE OF USED WIPES IN TRASH RECEPTACLE • KEEP SOLO®  
LID CLOSED WHEN NOT IN USE

ACCEPTED  
with COMMENTS  
EPA Letter Dated:

OCT 28 2005  
Under the Federal Insecticide,  
Fungicide, and Rodenticide Act as  
amended, for the pesticide,  
registered under EPA Reg. No.

72956-1

**GENERIC:**

Open lid. Pull out wipe. Close lid tightly.

**CLEANING:** Wipe surface with towelette until clean. Let air dry.

**FOOD CONTACT SURFACES**

For use on pre-cleaned hard, non-porous food preparation surfaces. Surfaces may include: [Use one or more of the following:] tables, food preparation tables, counter tops, cabinets, sinks, microwaves, ranges, refrigerators and freezers, [the following uses must be preceded by the words: "outside surface[s] of " or "exterior surface[s] of ":] food mixers, bread machines, coffee machines, griddles, toasters, toaster ovens, chargrills, broilers, cooking surfaces and backsplashes, ovens, juicers, [add the following after the list of surfaces:] and other similar hard, non-porous food contact surfaces except for those excluded by this label, †

**Sanitizing food contact surfaces:** Use first towel to pre-clean and remove heavy soil. Use second towel to sanitize. Wipe enough for treated area to remain visibly wet for a minimum of 60 seconds. Let air dry. No rinsing required.

† Do not use to sanitize glassware, cookware, and eating utensils.

Statements in brackets [ ] are optional or instructional. The terms "wipe(s)", "towel(s)", "towelette(s)", and "cloth(s)" can be used interchangeably throughout except for the product primary brand name which can be changed only by notification or amendment.

**[NON-FOOD CONTACT SURFACES]**

[Thoroughly pre-clean if surface is visibly soiled.]

For use on pre-cleaned hard non-porous surfaces. Surfaces may include: [Use one or more of the following:] Dining tables, chairs, display cabinets, garbage cans, infant high chairs, booster seats, floors, sinks, drain boards, faucets, toilet seats and rims, vanities, towel dispensers, railings, infant-changing tables, bath tubs, showers, hampers, tiled walls, telephones, playpens, cribs, diaper pails, doorknobs, [add the following after the list of surfaces:] and other similar hard, non-porous food contact surfaces except for those excluded by this label.

[Cleaning and] **Sanitizing non-food contact surfaces:** For heavily soiled items, clean prior to sanitizing. Use towel to sanitize surface. Wipe enough for treated surfaces to remain visibly wet for 5 minutes. Use additional towels as needed to keep entire surface area wet for a full 5 minutes. Let air dry. No rinsing required.

99.9% effective in 5 minutes against *Staphylococcus aureus* (ATCC #6538), *Salmonella choleraesuis* (ATCC #10708), and *Klebsiella pneumoniae* (ATCC #4352) [in the presence of organic soil (5% blood serum)].

**STORAGE AND DISPOSAL**

[Use canister or packet/travel pack storage/disposal statements below depending on type of container]

[For canisters]:

Storage: Do not store near heat or open flame. When not in use keep center cap of lid closed to prevent moisture loss.

Towelette Disposal: Do not reuse towelette. Dispose of used towelette in trash. Do not flush in toilet.

Dispenser Disposal: Do not reuse empty container. Wrap container and put in trash collection.

[For packets and travel packs]:

Storage: Do not store near heat or open flame.

Towelette Disposal: Do not reuse towelette. Dispose of used towelette in trash. Do not flush in toilet.

Travel Pack [or Solo® Pak or Packet] Disposal: Put empty travel pack [or Solo® Pak or packet] in trash collection.

**ACCEPTED  
with COMMENTS  
EPA Letter Dated:**

OCT 28 2005

Under the Federal Insecticide,  
Fungicide, and Rodenticide Act as  
amended, for the pesticide,  
registered under EPA Reg. No.

72956-1

Statements in brackets [ ] are optional or instructional. The terms "wipe(s)", "towel(s)", "towelette(s)", and "cloth(s)" can be used interchangeably throughout except for the product primary brand name which can be changed only by notification or amendment.

6 8 9

[All below are optional label claims (placement optional), literature and promotional statements]

99.9% effective against [in killing] common household bacteria  
99.999% effective in 60 seconds against Staphylococcus aureus, Escherichia coli and Shigella boydii  
on cleaned, hard, non-porous food contact surfaces

Always ready to use

Antibacterial

Antibacterial [house] [household] [surface] cleaner

Antimicrobial

Antimicrobial cleaner

Built-in scrubbing fibers

Clean and sanitize any room, any time

Clean and sanitize hard non-porous surfaces all over the house [throughout your home ] [easily]

Clean and sanitize non-porous surfaces around the house

Clean and sanitize surfaces your family touches

Cleaner and sanitizing towel [or cloth]

Cleaning and sanitizing wipes for food preparation surfaces

Cleans and sanitizes hard non-porous surfaces after food preparation

Cleans hard to remove stains

Cleans, deodorizes and kills common household bacteria

Cloth

Cuts grease

Cuts the toughest grime and grease without scratching your surfaces

Cuts through the toughest grime

Decorative, stay moist package

~~Destroys common household germs~~

~~Destroys common microbes in your [or the] home~~

Easily clean and sanitize hard non-porous surfaces around the house

Easy and effective kitchen sanitizing

Easy flip top lid

Effective [effectively] [in] sanitizing [sanitizes ] non-porous kitchen surfaces

Effective daily cleaner

Effective on non-porous food prep surfaces

[Effectively] neutralizes 99.9% of common household bacteria

Effectively neutralizes 99.9% of common household bacteria that live in your house

Eliminates odors

Eradicates 99.9% of common household bacteria

Everyday, every room sanitizer

Fast and easy way to clean and sanitize around the house

Food preparation surfaces

Food-contact surface wipes

Food-contact surfaces

Food-preparation surface sanitizer(s) [wipes]

For use on hard non-porous surfaces in kitchens [and /or bathrooms]

For use on pre-cleaned hard, non-porous food contact surfaces

For your toughest kitchen and bathroom messes

~~Germ-killing [house] [household] [surface] cleaner~~

~~Germ-killing household cleaner~~

Grease cutting formula [power]

Great for grease cutting

Great for on-the-go cleaning

Great on-the-go sanitizer

Hard non-porous surface cleaning and sanitizing [kitchen sanitizing ] made easy

Heavy duty cleaner [cleaning]

ACCEPTED  
with COMMENTS  
EPA Letter Dated:

OCT 28 2005

Under the Federal Insecticide,  
Fungicide, and Rodenticide Act as  
amended, for the pesticide,  
registered under EPA Reg. No.

72956-1

Statements in brackets [ ] are optional or instructional. The terms "wipe(s)", "towel(s)", "towelette(s)", and "cloth(s)" can be used interchangeably throughout except for the product primary brand name which can be changed only by notification or amendment.

Ideal for cleaning and sanitizing family spaces  
 Ideal for sanitizing family surfaces: highchairs, booster seats, strollers, car seats, cribs, dining tables  
 Ideal for sanitizing food prep surfaces  
 Ideal for sanitizing hard non-porous food contact surfaces (tabletops, countertops, sinks, kitchen appliance exteriors, tilework)  
 Kills 99.999% of Staphylococcus aureus, Escherichia coli and Shigella boydii in 60 seconds on pre-cleaned hard, non-porous food contact surfaces  
 Kills bacteria on [hard] non-porous food prep [kitchen] surfaces  
 Kills common household bacteria [including Staphylococcus aureus (Staph)]  
 Kills common kitchen bacteria in minutes  
~~Kills common household germs on non-porous surfaces~~  
 Kitchen sanitizer(s) that need no rinsing  
 Kitchen sanitizing wipes  
 Kitchen surface [sanitizing] wipes [towels]  
 Kitchen surface sanitizer(s)  
 Kitchen surfaces  
 Large, thick, and quilted for everyday cleaning  
 Leaves a shine every time  
 Leaves no streaks  
 Multi-room sanitizer [sanitizing] cleaner  
 No mixing or measuring required  
 No streaking  
 No-rinse kitchen [surface] sanitizer(s)  
 No-rinse kitchen sanitizing wipes  
 No-rinse sanitizer(s) for food contact [food prep] [kitchen] surfaces  
 No-rinse sanitizing for kitchen surfaces  
 No-rinse sanitizing wipes  
 One-step no rinse sanitizer for hard, non-porous non-food contact surfaces  
 On-the-go sanitizer  
 Pre-measured, pre-moistened sanitizing towels for use on [cleaned] hard, non-porous [food contact] surfaces  
 Pre-moistened [cleaner and] sanitizing towel [or cloth]  
 Pre-soaked [sturdy] cloth [or towel]  
 Pre-sprayed [sturdy] cloth [or towel]  
 Pre-sprayed scrubbing towels  
 Pre-wetted [towel or cloth]  
 Quilted pre-sprayed towels  
 Recommended for use on cleaned hard, non-porous food contact surfaces in kitchens  
 Recommended for use on hard, non-porous non-food contact surfaces as a one step sanitizer  
 Removes tough stains  
 Sanitizer [sanitizing] home [house] [household] [surface] cleaner  
 Sanitizes as it cleans food prep surfaces  
 Sanitizes hard non-porous food prep [kitchen] surfaces [easily]  
 Sanitizing clean-ups for family areas [spaces]  
 Sanitizing hard non-porous food prep [kitchen] surfaces is easy  
 Sanitizing wipes for family areas  
 Sanitizing wipes for family contact [food contact] [food-preparation] surfaces  
 Sanitizing wipes for hard non-porous surfaces  
 Sanitizing wipes for surfaces families touch  
 Scrubbing house [household] [surface] cleaner  
~~The bacteria are killed in 60 seconds by contact with the liquid in the towel. The product is effective when the surface is completely contacted with the towel.~~  
 The fast, easy and effective way to sanitize cleaned, hard non-porous surfaces  
 The sanitizing wipes that make cleanups easy

**ACCEPTED**  
**with COMMENTS**  
**EPA Letter Dated:**

OCT 28 2005

Under the Federal Insecticide, Fungicide, and Rodenticide Act as amended, for the pesticide, registered under EPA Reg. No.

72956-1

Statements in brackets [ ] are optional or instructional. The terms "wipe(s)", "towel(s)", "towelette(s)", and "cloth(s)" can be used interchangeably throughout except for the product primary brand name which can be changed only by notification or amendment.

\\shared\labels\pdf\ sani-towel(residential)\070505 Sani-towel draft.doc Page 5 of 7 7/5/05

879

Towel  
Use in the kitchen  
Versatile sanitizer [sanitizing] cleaner  
Wipes for food-contact surfaces  
Wipes out 99.9% of common household bacteria  
Wipes out 99.9% of bacteria that commonly infect your home

Specifically designed for sanitizing cleaned hard, non-porous surfaces throughout the household. [99.9%] effective in 5 minutes against common household bacteria: Staphylococcus aureus, Salmonella choleraesuis, and Klebsiella pneumoniae. Common uses include: doorknobs, chairs, toilet seats and rims, railings, infant high chairs, infant – changing tables, diaper pails, playpens, booster seats, strollers, cribs, and toy chests.

Specifically designed for sanitizing cleaned hard, non-porous surface areas where food is normally prepared. 99.9% effective in 60 seconds against common Kitchen bacteria: Staphylococcus aureus, Escherichia coli (E coli), Salmonella choleraesuis, Shigella boydii, and Klebsiella pneumoniae in the presence of organic soil (heavy soil must be pre-cleaned first). Common uses include: kitchen counters, tables, cooking surfaces, and sinks.

**ACCEPTED  
with COMMENTS  
EPA Letter Dated:**

OCT 28 2005

Under the Federal Insecticide,  
Fungicide, and Rodenticide Act as  
amended, for the pesticide,  
registered under EPA Reg. No.

72956-1

Statements in brackets [ ] are optional or instructional. The terms "wipe(s)", "towel(s)", "towelette(s)", and "cloth(s)" can be used interchangeably throughout except for the product primary brand name which can be changed only by notification or amendment.



OPTIONAL GRAPHICS  
[The following graphics and statements are optional.  
They may be placed anywhere on label/container.]



[This graphic shows use of the towel dispenser.]

**NOT A BABY WIPE**

**NOT FOR USE ON SKIN**

Statements in brackets [ ] are optional or instructional. The terms "wipe(s)", "towel(s)", "towelette(s)", and "cloth(s)" can be used interchangeably throughout except for the product primary brand name which can be changed only by notification or amendment.