

71995-23

2/28/2001

Please read instructions on reverse before completing form.

Form Approved, OMB No. 2070-0060, Approval expires 2-28-95



United States
Environmental Protection Agency
Washington, DC 20460

Registration
 Amendment
 Other

OPP Identifier Number

Application for Pesticide - Section I

1. Company/Product Number 71995-23	2. EPA Product Manager Mr. Jim Tompkins	3. Proposed Classification <input checked="" type="checkbox"/> None <input type="checkbox"/> Restricted
4. Company/Product (Name) Roundup Weed & Grass Killer1 Ready-To-Use	PM# 25	
5. Name and Address of Applicant (Include ZIP Code) Monsanto Company 600 13th Street N.W., Suite 660 Washington, DC 20005 <input type="checkbox"/> Check if this is a new address	6. Expedited Review. In accordance with FIFRA Section 3(c)(3) (b)(i), my product is similar or identical in composition and labeling to: EPA Reg. No. _____ Product Name _____	

Section - II

Amendment - Explain below. Final printed labels in response to Agency letter dated _____

Resubmission in response to Agency letter dated _____ "Me Too" Application.

Notification - Explain below. Other - Explain below.

NOTIFICATION

FEB 28 2001

Explanation: Use additional page(s) if necessary. (For section I and Section II.)

Submission of final printed labels for Pull N' Spray Product

This notification is consistent with the provisions of PR Notice 98-10 and EPA regulations at 40 CFR 152.46, and no other changes have been made to the labeling or the confidential statement of formula of this product. I understand that it is a violation of 18 U.S.C Sec. 1001 to wilfully make any false statement to EPA. I further understand that if this notification is not consistent with the terms of PR Notice 98-10 and 40 CFR 152.46, this product may be in violation of FIFRA and I may be subject to enforcement action and penalties under sections 12 and 14 of FIFRA.

Section - III

1. Material This Product Will Be Packaged In:

Child-Resistant Packaging <input type="checkbox"/> Yes <input type="checkbox"/> No	Unit Packaging <input type="checkbox"/> Yes <input type="checkbox"/> No	Water Soluble Packaging <input type="checkbox"/> Yes <input type="checkbox"/> No	2. Type of Container <input type="checkbox"/> Metal <input type="checkbox"/> Plastic <input type="checkbox"/> Glass <input type="checkbox"/> Paper <input type="checkbox"/> Other (Specify) _____
* Certification must be submitted		If "Yes" Unit Packaging wgt. No. per container	If "Yes" Package wgt No. per container

3. Location of Net Contents Information
 Label Container

4. Size(s) Retail Container

5. Location of Label Directions

6. Manner in Which Label is Affixed to Product
 Lithograph Paper glued Stenciled Other _____

Section - IV

1. Contact Point (Complete items directly below for identification of individual to be contacted, if necessary, to process this application.)

Name Dr. Marsha Gray	Title Registration Manager	Telephone No. (Include Area Code) (202) 783-2463
-------------------------	-------------------------------	---

Certification
I certify that the statements I have made on this form and all attachments thereto are true, accurate and complete. I acknowledge that any knowingly false or misleading statement may be punishable by fine or imprisonment or both under applicable law.

2. Signature
Rhonda M Mannion

3. Title
Registration Manager

4. Typed Name
Rhonda M. Mannion

5. Date
26 February 2001

6. Date Application Received
(Stamped)

Reg No. 71995-23

2/3

Pull N' Spray

NOTIFICATION

FEB 28 2001

NEW
TWICE AS STRONG!
AS FAST-ACTING
FORMULA!

Roundup

WEED & GRASS KILLER,
 READY-TO-USE

**NO ROOT.
 NO WEED.
 NO PROBLEM.™**

21178Y3-20 (004200)
 Active Ingredient
 Glyphosate, isopropylamine salt 1.92%
 Other Ingredients 98.08%

**KEEP OUT OF
 REACH OF CHILDREN**
 See back panel for additional precautionary statements. **CAUTION**
 NET 1.33 GAL (170 FL OZ)

FRONT

PPN 21178Y3-20

**Do not unscrew cap.
Do not refill container.**

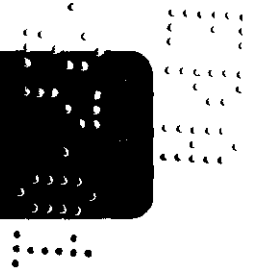
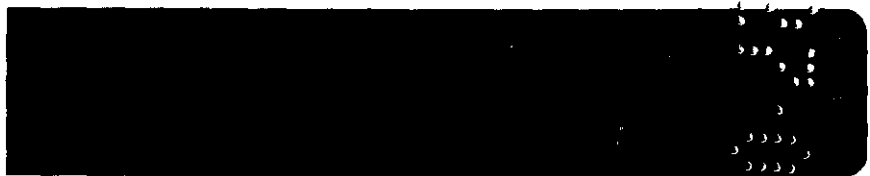

BACK

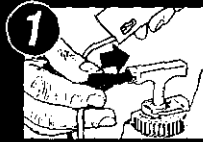

1 Detach green wand and pull plug and tubing from bottom of wand. Insert plug firmly into "T-handle" until it clicks. ONCE CONNECTED, PLUG CANNOT BE REMOVED WITHOUT DAMAGING "T-HANDLE."



2 Slide white strip on cap. Then grab "T-handle" and pull all the way up. JUST PULL UP - NO NEED TO PUMP.



3 Point wand at unwanted weeds/grasses and push button to begin spraying. Twist nozzle at end of wand to adjust spray pattern.

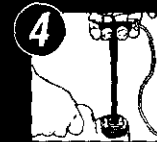

4 Pull "T-handle" again as needed to continue spraying. JUST PULL UP - NO NEED TO PUMP. When finished, push "T-handle" gently down to cap and follow storage instructions.



DIRECTIONS FOR USE

It is a violation of Federal law to use this product in a manner inconsistent with its labeling.

HOW TO APPLY

- Follow illustrations and instructions above. Point wand at unwanted weeds/grasses and push button to begin spraying. Twist nozzle at end of wand to adjust spray pattern. Pull "T-handle" again as needed to continue spraying. **JUST PULL UP - NO NEED TO PUMP.**
- Spray the weeds or grasses you want to kill until thoroughly wet.
- When spot treating weeds in a flower or vegetable garden, shield desirable plants from drift with a sheet of cardboard or plastic. If desirable plant is accidentally sprayed, rinse off immediately with water.

IMPORTANT: Do not spray plants or grasses you like - they may die too. Not recommended for spot weed control in lawns since Roundup kills lawn grasses.

WHEN TO APPLY

- Apply when weeds are actively growing.
- For best results, apply during warm, sunny weather (above 60°F).
- Spray when air is calm to prevent drift to desirable plants.
- RAIN-PROOF - Rain or watering 2 hours after application will not wash away effectiveness.
- All ornamental flowers, trees & shrubs may be planted 1 day after application.

HOW IT WORKS

Roundup enters plants through foliage and moves systemically to the roots, killing weeds by stopping the production of a substance found only in plants. Any product not absorbed by plants breaks down into natural materials without moving in or on the soil to untreated plants. Weeds yellow and wilt within hours with complete kill in 1 to 2 weeks.

STORAGE AND DISPOSAL: Push "T-handle" gently down to cap. Slide white strip on cap back to closed position. LEAVE WAND PLUG CONNECTED TO "T-HANDLE". Snap wand back into place on side of container. Store product in original container in a secure place. Keep from freezing. **DISPOSAL: DO NOT RE-USE EMPTY CONTAINER.** Securely wrap partially filled or empty container in newspaper and put in trash. Never pour product down any drain.

PRECAUTIONARY STATEMENTS

HAZARDS TO HUMANS & DOMESTIC ANIMALS

CAUTION: Causes eye irritation. Avoid contact with eyes or clothing. Wash thoroughly with soap and water after handling.

People and pets may enter treated areas after spray has dried.

FIRST AID: IF IN EYES: Flush eyes with plenty of water. Call a physician if irritation persists. In case of an emergency involving this product, call 1-888-768-6387.

ENVIRONMENTAL HAZARDS: Do not apply directly to water. Do not contaminate water when disposing of equipment washwaters.

NOTICE: Buyer assumes all responsibility for safety and use not in accordance with directions.

This product is protected by U.S. Patent No. 5,196,044. Other patents pending. No license granted under any non-U.S. patent(s).



PRODUCT FACTS
Container treats more than 1,400 weeds

KILLS WEEDS

ALL TYPES OF WEEDS & GRASSES

WHERE TO USE

- ✓ On patios, walkways & driveways
- ✓ In flower beds & vegetable gardens
- ✓ Around shrubs & trees
- ✓ Along fences
- ✓ In large areas
 - for lawn replacement
 - for garden plot preparation

Questions, Comments or Medical Information call 1-888-ROUNDUP

www.roundup.com

IMPORTANT!

Follow directions and illustrations on back to assemble and use Pull 'N Spray correctly.

21178Y4-35

© 2001 MONSANTO COMPANY
Roundup is a trademark of Monsanto Company
Manufactured for Monsanto Company.
Lawn & Garden Products
P.O. Box 1750, Columbus, OH 43216-1750
PPN 21178Y3-21 (004400)
EPA Reg. No. 71995-23
EPA Est. 239-1A-3; 58996-MO-1*
Superscript is first letter of lot number
Made in USA



0 70183 58064 4 1020

PPN 21178Y3-21

