



United States  
**Environmental Protection Agency**  
 Washington, DC 20460

Registration  
 Amendment  
 Other

OPP Identifier Number  
**307434**

**Application for Pesticide - Section I**

1. Company/Product Number EPA Reg. No. 71995-21	2. EPA Product Manager Jim Tompkins	3. Proposed Classification <input checked="" type="checkbox"/> None <input type="checkbox"/> Restricted
4. Company/Product (Name) Roundup Ready-To-Use Weed & Grass Killer Plus WeedPrevent	PM # 25	
5. Name and Address of Applicant (Include ZIP Code) Monsanto Company 1300 I (Eye) Street, N.W., Suite 450 East Washington, DC 20005 <input type="checkbox"/> Check if this is a new address	6. Expedited Review. In accordance with FIFRA Section 3(c)(3) (b)(i), my product is similar or identical in composition and labeling to: EPA Reg. No. _____ Product Name _____	

**Section - II**

<input type="checkbox"/> Amendment - Explain below.	<input type="checkbox"/> Final printed labels in response to Agency letter dated	<b>NOTIFICATION</b> SEP 10 2004
<input type="checkbox"/> Resubmission in response to Agency letter dated	<input type="checkbox"/> "Me Too" Application.	
<input checked="" type="checkbox"/> Notification - Explain below.	<input type="checkbox"/> Other - Explain below.	

**Explanation:** Use additional page(s) if necessary. (For section I and Section II.)  
 Submission of final printed label and notification label text changes.

This notification is consistent with the provisions of PR Notice 98-10 and EPA regulations at 40 CFR 152.46, and no other changes have been made to the labeling or the confidential statement of formula of this product. I understand that it is a violation of 18 U.S.C Sec. 1001 to willfully make any false statement to EPA. I further understand that if this notification is not consistent with the terms of PR Notice 98-10 and 40 CFR 152.46, this product may be in violation of FIFRA and I may be subject to enforcement action and penalties under sections 12 and 14 of FIFRA.

**Section - III**

1. Material This Product Will Be Packaged In:				2. Type of Container	
Child-Resistant Packaging <input type="checkbox"/> Yes* <input type="checkbox"/> No	Unit Packaging <input type="checkbox"/> Yes <input type="checkbox"/> No	Water Soluble Packaging <input type="checkbox"/> Yes <input type="checkbox"/> No	<input type="checkbox"/> Metal <input type="checkbox"/> Plastic <input type="checkbox"/> Glass <input type="checkbox"/> Paper <input type="checkbox"/> Other (Specify) Plant Cells		
* Certification must be submitted		If "Yes" Unit Packaging wgt. No. per Container	If "Yes" Package wgt. No. per Container		
3. Location of Net Contents Information <input type="checkbox"/> Label <input type="checkbox"/> Container		4. Size(s) Retail Container Various		5. Location of Label Directions <input type="checkbox"/> On Label <input type="checkbox"/> On Labeling accompanying product	
6. Manner in Which Label is Affixed to Product <input type="checkbox"/> Lithograph <input type="checkbox"/> Other _____ <input type="checkbox"/> Paper glued <input type="checkbox"/> Stenciled					

**Section - IV**

1. Contact Point (Complete items directly below for identification of individual to be contacted, if necessary, to process this application.)		
Name Dr. Russ Schneider	Title Director, Regulatory Affairs	Telephone No. (Include Area Code) (202) 383-2866
<b>Certification</b> I certify that the statements I have made on this form and all attachments thereto are true, accurate and complete. I acknowledge that any knowingly false or misleading statement may be punishable by fine or imprisonment or both under applicable law.		6. Date Application Received <b>(Stamped)</b>
2. Signature <i>Rhonda M. Mannion</i>	3. Title Registration Manager	
4. Typed Name Rhonda M. Mannion 314/ 694-8785	5. Date 30 August 2004	

4/9

NOTIFICATION

SEP 10 2004

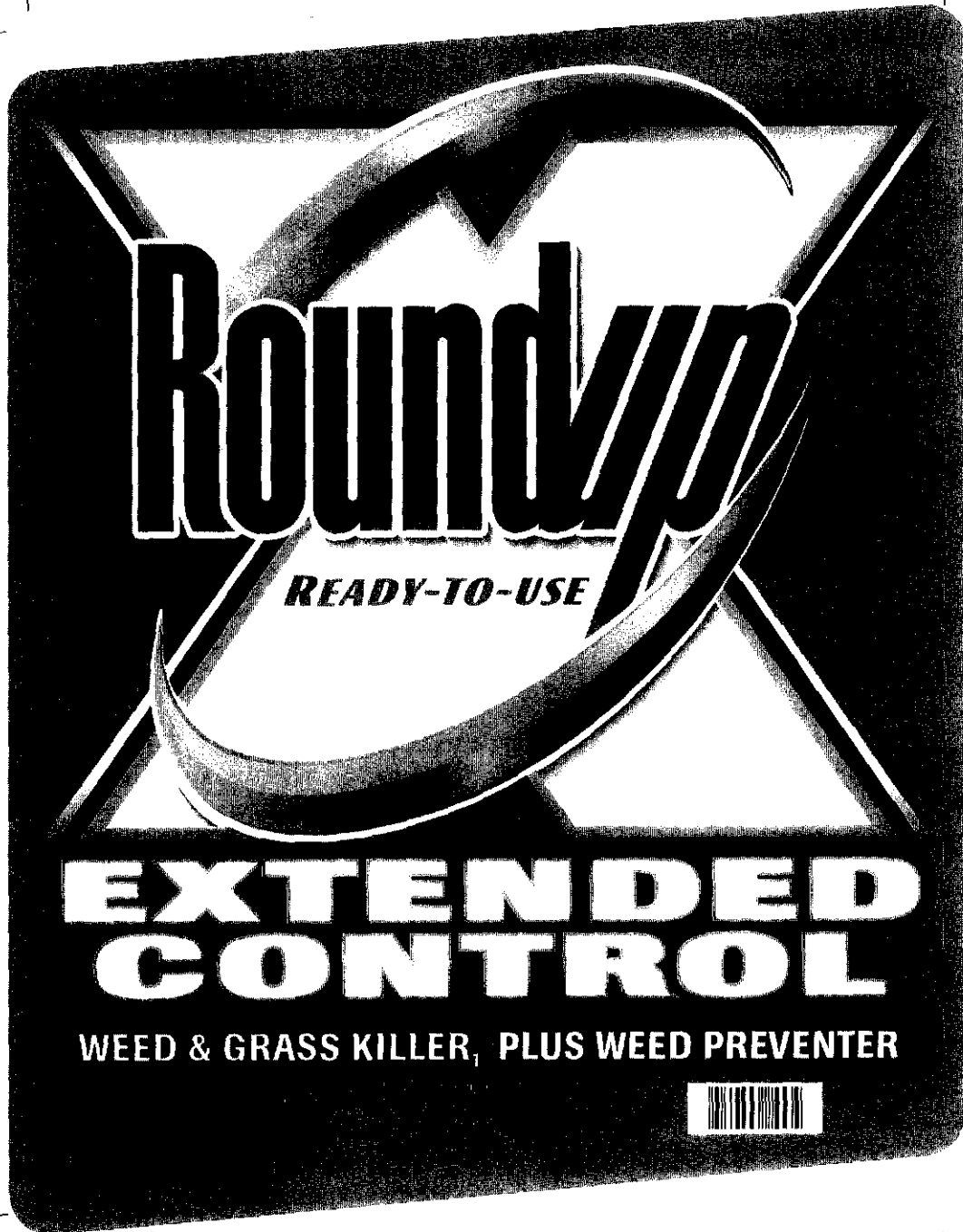

file: 42545\_label\_art created by customer  
folder: 42545\_Monsanto\_170oz\_X alt: 8-11-04 bm  
colors: Roto White / Black / 430 / 362 / 485 / 129 / 131  
ITF\_25%\_-58micron  
size: 5.5x7.125



### Delivers Maximum Performance!

- ✓ Visual results in 24 hours!
- ✓ RAINPROOF™ Protection in 30 minutes!
- ✓ Great value—covers up to 400 sq. ft.!

WEEDS KILLS, KILLS PLUS WEED PREVENTION

#### HOW IT WORKS:



##### IMPORTANT!

To prevent new weeds and grasses from growing, YOU MUST SPRAY THE ENTIRE AREA you want to control NOT JUST the existing weeds.

#### Dual-Action Formula Works Two Ways:



1

Kills existing weeds and grasses, roots and all.

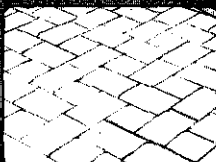

2

Prevents new weeds from growing for up to 3 months by creating an invisible barrier.

#### WHERE AND HOW TO USE:

Yellow color represents area to be sprayed in order to receive 3 month weed-free control.

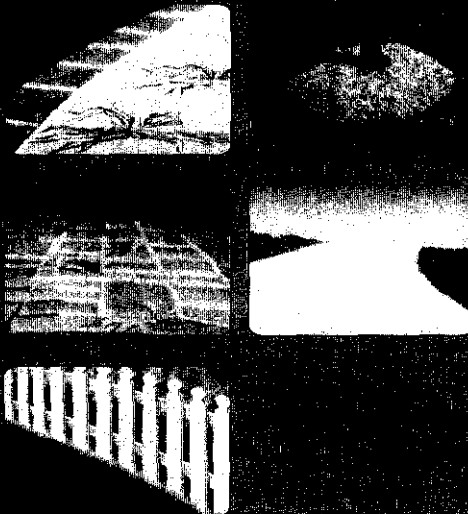

Questions, Comments or Medical Information call 1-800-246-7219 [www.roundup.com](http://www.roundup.com)

Where NOT to Use:



**PRODUCT FACTS**

**WHAT IT DOES** Kills and prevents all types of weeds and grasses.

**HOW IT WORKS** **IMPORTANT:** To prevent new weeds and grasses from growing YOU MUST SPRAY THE ENTIRE AREA you want to control, NOT JUST the emerged weeds.

Roundup Extended Control works two ways:  
1. One ingredient enters plants through foliage and moves systemically to the roots, killing weeds by stopping the production of a substance found in plants. Weeds begin to yellow and within 24 hours with complete kill in 1 to 2 weeks.  
2. The other ingredient provides an invisible barrier in the soil that prevents growth of sprouting weeds and grasses for up to 3 months!

**WHERE TO USE** Apply Roundup Extended Control to BOTH existing weeds and weed-prone areas where weeds have not yet appeared.

- On cracks and crevices in driveways, sidewalks, walkways, and patios.
- Along fences, foundations, curbs, retaining walls, and edge of lawns.
- Around the base or in mulched beds of well-established (at least 6 months old) plants, shrubs or trees.
- On gravel areas.

**WHERE NOT TO USE** DO NOT SPRAY plants or grasses you like - they may die too.

- DO NOT USE in lawns or for lawn renovation as Roundup Extended Control prevents desirable grasses from growing too.
- DO NOT USE for vegetable garden preparation or in and around fruits and vegetables.
- DO NOT SPRAY around young plants or in an area that will be planted or seeded within 4 months.

Note: For weed control in these areas use Roundup Weed & Grass Killer Ready-To-Use Plus.

People and pets may enter treated area after spray has dried.



**DIRECTIONS FOR USE**

It is a violation of Federal law to use this product in a manner inconsistent with its labeling.

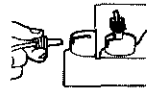

- Remove sprayer from side carrier and unwrap hose completely.
- Insert plug at end of hose into spout on cap until it clicks.
- Flip up spout.

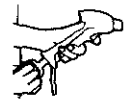

- Point sprayer away from body.
- Grasp sprayer by the handle.
- SLOWLY pull ring at bottom of sprayer handle out until it stops and hold for 2 seconds to prime the sprayer.



- Twist nozzle at end of sprayer to adjust spray pattern.
- Press and hold trigger button on sprayer to begin spraying.
- Pull ring at sprayer bottom again as needed to prime sprayer and continue spraying.

**HOW TO APPLY**

- Point sprayer at unwanted weeds, grasses, and weed-prone areas where weeds typically emerge and press sprayer trigger, hold for continuous spray.
- Spray the existing weeds AND the entire surrounding weed-prone area you want to keep free of weeds for up to 3 months. Spray the area until **THOROUGHLY WET**.
- When spraying around the base of well-established (at least 6 months old) ornamental plants, shrubs or trees, shield desirable plants from drift with a sheet of cardboard or plastic. If desirable plant is accidentally sprayed, rinse off immediately with water.

**WHEN TO APPLY**

- Spray when air is calm to prevent drift to desirable plants.
- For fastest visual results, apply during warm, sunny weather (above 60° F).
- RAINPROOF™ Protection: Rain or watering within 30 minutes of application will NOT wash away effectiveness.

**WHEN TO REPLANT**

- All ornamental bedding plants, trees, shrubs, sod, and seed (flowers and grasses) may be planted 4 months after application.

5/9



Ready-To-Use Extended Control  
Weed & Grass Killer, Plus Weed Preventer

**STORAGE & DISPOSAL**

**STORAGE:** Completely dispense product in sprayer prior to storage. Rotate nozzle to the OFF position. Flip down spout on cap. **NO NEED TO DISCONNECT SPRAYER HOSE FROM CAP.** Place sprayer back inside carrier on bottle with nozzle facing down. Store product in original container in a safe place away from direct sunlight. Keep from freezing. **DISPOSAL: Do not reuse container. Empty Container:** Put in trash (recycle where available). **Partially Full Container:** Call your local waste disposal service or 1-800-CLEANUP. Never pour product down any drain.

**HAZARDS TO HUMANS & DOMESTIC ANIMALS**

**CAUTION:** Causes moderate eye irritation. Avoid contact with eyes or clothing. Wash thoroughly with soap and water after handling.

**If In Eyes**

- Hold eye open and rinse slowly and gently for 15-20 minutes.
- Remove contact lenses, if present, after first 5 minutes, then continue rinsing eyes.
- Call a poison control center, 1-800-246-7219, or doctor for treatment advice.

**EMERGENCY MEDICAL INFORMATION**

- Have the product container or label with you when calling a poison control center or doctor, or going for treatment.
- You may contact 1-800-246-7219 for emergency medical treatment information.
- This product is identified as **Roundup Ready-to-Use Extended Control Weed & Grass Killer, Plus Weed Preventer, EPA Reg. No. 71995-21.**

**ENVIRONMENTAL HAZARDS:** Do not apply directly to water. Do not contaminate water when disposing of equipment washwaters.

**NOTICE:** Buyer assumes all responsibility for safety and use not in accordance with directions.

**ROUNDUP FAMILY OF PRODUCTS**

- Visit the Roundup website to learn more about the Roundup family of products for the best solution to your toughest weed problems.

**QUESTIONS, COMMENTS, INFORMATION**

 **Call 1-800-246-7219** [www.roundup.com](http://www.roundup.com)

Roundup is a trademark of Monsanto Technology LLC.  
©2004 MONSANTO COMPANY  
Manufactured for Monsanto Company, Lawn & Garden Products  
P.O. Box 418, Marysville, OH 43041  
EPA Reg. No. 71995-21  
EPA Est. 239-IA-3<sup>1</sup> 58996-MO-1<sup>A</sup>  
Superscript is first letter of lot number  
PPN 2013 Made in USA

80% Size  
12-digit UPC  
(For Position Only)  
0 70183 50024 6



file: 42546\_label\_art  
folder: 42546\_Monsanto\_170oz\_X  
Colors: white / black / 485 red  
size: 2.0625x2.0625

created by customer  
alt: 7-21-04 jw

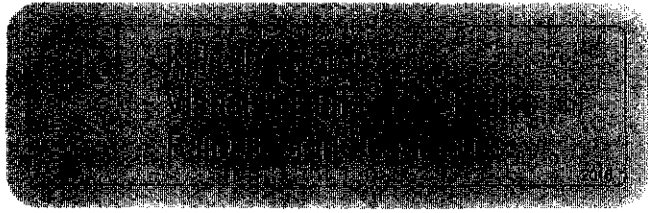

MONSANTO



NOTIFICATION

SEP 16 2004

8/19

MONSANTO COMPANY  
1300 I (EYE) STREET, NW  
SUITE 450 EAST  
WASHINGTON, D.C. 20005  
PHONE (202) 383-2866  
FAX (202) 789-1748  
<http://www.monsanto.com>

30 August 2004

**Hand Delivered**

Document Processing Center (NOTIF)  
Office of Pesticide Programs  
U.S. Environmental Protection Agency  
Room 266A, Crystal Mall 2,  
1801 South Bell Street  
Arlington, VA 22202-4501

Attention: Mr. Jim Tompkins (7505C)  
Product Manager (Team 25)

**Subject: EPA Reg. No. 71995-21. Submission of Revised Final Printed Label.**

Dear Mr. Tompkins:

As a result of consumer focus group testing, Monsanto Company, Lawn & Garden Products has revised the final printed label for *Roundup® Ready-To-Use Extended Control Weed & Grass Killer<sub>1</sub> Plus Weed Preventer* (Reg. No. 71995-21) to better communicate to the consumer how to effectively use this product to receive its full residual benefit.

Enclosed you will find the revised final printed label (print plate nos. 10022C1-1, 10022C1-2, 10022C1-3, 2013, and 2016) which is consistent with the EPA stamped Master Label dated 6 February 2003 and the subsequent label notification dated 14 July 2004 with the following exceptions:

- An additional page was added to the back label (front page of the back panel booklet) to highlight important product usage information. The text is duplicative of existing back label text and consistent with the Master Label with the following exceptions:
  - The advisory statement "*IMPORTANT: To prevent new weeds .... NOT JUST the emerged weeds*" was moved to the **How It Works** section (change was also made inside the back panel booklet).
  - The **Where To Use** section heading was changed to **Where and How To Use**.
  - The statement "*Yellow color represents area to be sprayed in order to receive 3 month weed-free control*" was added to the **Where and How To Use** section.
  - Used an abbreviated version of the **Where To Use** section located inside the back panel booklet. "Tree Rings and Mulched Areas" was substituted for "Around the base or in mulched beds of well-established plants, shrubs or trees"



9/9

- Added walkway cracks to the **Where To Use** section inside the back panel booklet. Walkway cracks are a subset of the approved use “on walkways”.
- Added a definition for well-established plants, shrubs or trees.  
“Around the base of well-established (at least 6 months old) plants, shrubs or trees.”
- The **When To Apply** section now follows the **How To Apply** section.
- Extended the replanting interval for bedding plants, trees, shrubs and sod from 3 to 4 months.
- Chose not to repeat the Re-entry statement in the **Precautionary Statements** section. It was already printed in the **Product Facts Box**.

The following documents are enclosed with this letter:

- Application for Pesticide (8750-1) – OPP ID No. 307434
- Three (3) copies of the revised final printed label for *Roundup Ready-To-Use Extended Control Weed & Grass Killer, Plus Weed Preventer*

Should you have any questions, please contact Dr. Russ Schneider at our Washington office (202) 383-2866, or me directly at (314) 694-8785 or by email at [rhonda.m.mannion@monsanto.com](mailto:rhonda.m.mannion@monsanto.com).

Sincerely,



Rhonda M. Mannion  
Registration Manager

cc: R. Schneider / DC Office  
M. Brown / A2ND  
D. Hinton / A2ND  
T. Schafer / A2ND  
File copy