

71995-21

2-12-2003

1/5

**FEB 12 2003**

Ms. Rhonda M. Mannion  
Registration Manager  
MONSANTO COMPANY Lawn & Garden Products  
600 13<sup>th</sup> Street NW Suite 660  
Washington, D.C. 20005

Dear Ms. Mannion:

This is in response to your request dated January 7, 2003 to change the primary brand name for **EPA Registration 71995-21** from GroundClear SuperEdger Grass & Weed Control I to:

**ROUNDUP READY-TO-USE WEED & GRASS KILLER  
PLUS WEEDPREVENT**

Your request for the name change is **accepted** and the change will be made to the Agency's records. All future correspondence on this product should reference the new name.

Sincerely yours,



Sherada D. Hobgood  
Notifications Review Coordinator  
Registration Division (7505C)



United States  
**Environmental Protection Agency**  
 Washington, DC 20460

Registration  
 Amendment  
 Other

OPP Identifier Number

**Application for Pesticide – Section I**

1. Company/Product Number EPA Reg. No. 71995-21	2. EPA Product Manager Jim Tompkins	3. Proposed Classification <input checked="" type="checkbox"/> None <input type="checkbox"/> Restricted
4. Company/Product (Name) GroundClear SuperEdger Grass & Weed Control I	PM # 25	
5. Name and Address of Applicant (Include ZIP Code) Monsanto Company, Lawn & Garden Products 600 13 <sup>th</sup> St., N.W., Suite 660 Washington, DC 20005 <input type="checkbox"/> Check if this is a new address	6. <b>Expedited Review.</b> In accordance with FIFRA Section 3(c)(3) (b)(i), my product is similar or identical in composition and labeling to: EPA Reg. No. _____ Product Name <b>NOTIFICATION</b>	

**Section – II**

FEB 12 2003

Amendment – Explain below.  Final printed labels in response to Agency letter dated 16 July 1997  
 Resubmission in response to Agency letter dated  "Me Too" Application.  
 Notification – Explain below.  Other – Explain below.

**Explanation:** Use additional page(s) if necessary. (For section I and Section II.)

Notification of new primary brand name, submission of final printed labeling, and notification of new disposal statements per PR Notice 2001-6.

Notification of label change relative to PR Notice 2001-6. This notification is consistent with the guidance in PR Notices 2001-6 and 98-10 and the requirements of 40 CFR 156.10 and 40 CFR 152.46, and no other changes have been made to the labeling or the confidential statement of formula of this product. I understand that it is a violation of 18 U.S.C Sec. 1001 to willfully make any false statement to EPA. I further understand that if this notification is not consistent with the guidance of PR Notices 2001-6 and 98-10 and the requirements of 40 CFR 156.10 and 40 CFR 152.46, this product may be in violation of FIFRA and I may be subject to enforcement action and penalties under sections 12 and 14 of FIFRA.

**Section – III**

1. Material This Product Will Be Packaged In:

Child-Resistant Packaging <input type="checkbox"/> Yes* <input type="checkbox"/> No	Unit Packaging <input type="checkbox"/> Yes <input type="checkbox"/> No	Water Soluble Packaging <input type="checkbox"/> Yes <input type="checkbox"/> No	2. Type of Container <input type="checkbox"/> Metal <input type="checkbox"/> Plastic <input type="checkbox"/> Glass <input type="checkbox"/> Paper <input type="checkbox"/> Other (Specify) <u>Plant Cells</u>
<b>Certification must be submitted</b>		If "Yes" Unit Packaging wgt. No. per Container	If "Yes" Package wgt. No. per Container

3. Location of Net Contents Information  
 Label  Container

4. Size(s) Retail Container  
Various

5. Location of Label Directions  
 On Label  
 On Labeling accompanying product

6. Manner in Which Label is Affixed to Product  
 Lithograph  Other \_\_\_\_\_  
 Paper glued  
 Stenciled

**Section – IV**

1. Contact Point (Complete items directly below for identification of individual to be contacted, if necessary, to process this application.)

Name Dr. Marsha C. Gray	Title Registration Manager	Telephone No. (Include Area Code) (202) 783-2460
----------------------------	-------------------------------	---

**Certification**  
 I certify that the statements I have made on this form and all attachments thereto are true, accurate and complete. I acknowledge that any knowingly false or misleading statement may be punishable by fine or imprisonment or both under applicable law.

2. Signature  
*Rhonda M. Mannion*

3. Title  
Registration Manager

4. Typed Name  
Rhonda M. Mannion 314/ 694-8785

5. Date  
7 January 2003

6. Date Application Received (Stamped)

3/5

NOTIFICATION  
FEB 12 2003

# Roundup

READY-TO-USE WEED & GRASS KILLER

## PLUS WEED PREVENT

**Dual-Action Formula**

**Kills Existing Weeds To The Root PLUS  
Prevents New Weeds For Up To 3 MONTHS**

ppn 21177A1-5



Active Ingredient	
Glyphosate, isopropylamine salt .....	1.00%
Dithiopyr .....	0.03%
Other Ingredients .....	98.97%

**KEEP OUT OF  
REACH OF CHILDREN**  
See back panel for  
additional precautionary statements. **CAUTION**  
**NET 128 FL OZ (1 GAL)**

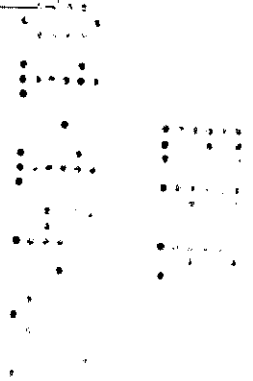

4/5

# QUICK CONNECT SPRAYER

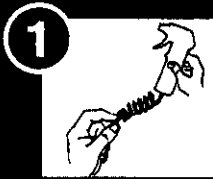

Remove sprayer. Pull card tubing ALL THE WAY OUT.

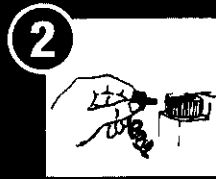

Insert green plug into spout (on cap) until it clicks.

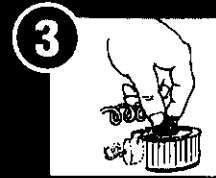

Flip up spout. Open nozzle at end of sprayer.



Ready-To-Use  
Weed & Grass Killer  
Plus WeedPrevent

## PRODUCT FACTS

Container treats up to 300 sq ft

### Dual (2 way) Action:

1. Kills existing weeds & grasses, roots & all
2. Creates an invisible barrier in the soil to prevent new weeds from appearing for up to 3 months

### KILLS & PREVENTS ALL TYPES OF WEEDS & GRASSES



To prevent new weeds from appearing for up to 3 months, spray the existing weeds AND the entire surrounding area you wish to keep weed free.

### WHERE TO USE

Apply only where you want to kill existing weeds AND prevent future weed growth for up to 3 months, such as:

- ✓ Walkways, driveways, gravel pathways, parking areas, and brick patios
- ✓ Along fences, foundations, and curbs
- ✓ Areas around the base of well established plants, shrubs or trees
- ✓ Decorative rock, mulch, or bark landscapes
- ✓ Along the edge of lawns, tree rings, and retaining walls

**IMPORTANT:** Do not use on your lawn or in and around fruits and vegetables. Do not use to prepare vegetable garden plots. For weed control in vegetable gardens use Roundup Weed & Grass Killer Ready-To-Use.



Questions, Comments or Medical Information  
call 1-800-246-7219 [www.roundup.com](http://www.roundup.com)

This product is protected by U.S. Patent No. 5,196,044 and 4,692,184. Other patents pending. No license granted under any non-U.S. patent(s).

© 2002 MONSANTO COMPANY

### DIRECTIONS FOR USE

It is a violation of Federal law to use this product in a manner inconsistent with its labeling.

### HOW TO APPLY

- Adjust nozzle to coarse spray.
- After weeds have emerged spray the weeds AND the entire surrounding area you want to keep free of weeds for up to 3 months. Spray the area until THOROUGHLY WET.
- When spraying around the base of well-established ornamental plants, shrubs or trees, shield desirable plants from drift with a sheet of cardboard or plastic. If desirable plant is accidentally sprayed, rinse off immediately with water.
- For best results, apply during warm, sunny weather (above 60 F).
- Spray when air is calm to prevent drift to desirable plants.

**IMPORTANT:** Do not spray plants or grasses you like – they may die too. When making applications around desirable trees or ornamental plants, wait until desirable plants have become well established and deeply rooted. DO NOT use for weed control in lawns or vegetable gardens since Roundup Plus WeedPrevent kills lawn grasses and prevents new plants from sprouting for up to 3 months.

### HOW IT WORKS

Roundup Plus WeedPrevent has two-way action. One ingredient enters plants through foliage and moves systemically to the roots killing weeds by stopping the production of a substance found in plants. The other ingredient provides an invisible barrier in the soil that prevents growth of sprouting weeds. Weeds begin to yellow and wilt within 24 hours with complete kill in 1 to 2 weeks.

**STORAGE AND DISPOSAL** STORAGE: Store product in original container in a safe place. Protect from freezing. DISPOSAL: If Empty: Do not reuse this container. Place in trash or offer for recycling if available. If Partly Filled: Call your local solid waste agency or 1-800-CLEANUP for disposal instructions. Never place unused product down any indoor or outdoor drain.



### PRECAUTIONARY STATEMENTS HAZARDS TO HUMANS & DOMESTIC ANIMALS

**CAUTION:** Causes moderate eye irritation. Avoid contact with eyes or clothing. Wash thoroughly with soap and water after handling.

People and pets may enter treated area after spray has dried.

#### FIRST AID

If in eyes: Flush eyes with plenty of water. Call a physician if irritation persists.

#### NOTE TO PHYSICIAN

- For emergency information call 1-800-246-7219.
- This product is identified as Roundup Ready-To-Use Plus WeedPrevent, EPA Reg. No. 71995-21.

**ENVIRONMENTAL HAZARDS:** Do not apply directly to water. Do not contaminate water when disposing of equipment washwaters.

**NOTICE:** Buyer assumes all responsibility for safety and use not in accordance with directions.

Roundup is a registered trademark of Monsanto Technology LLC.  
Manufactured for Monsanto Company, Lawn & Garden Products  
P.O. Box 418, Marysville, OH 43041  
21177A1-4 (017201)  
EPA Reg. No. 71995-21  
EPA Est. 239-1A-3, 58996-MO-1A  
Superscript is first letter of lot number. Made in USA.



file: 30971/back label/art  
folder: 30971/Monsanto/21177A1-4  
colors: pms 3425 green, pantone yellow, black  
codes: upca: -58m, 80% / ift: -58m, 25%

created: 12-5-02 es  
alt: lmk 1/7/03

**[New] RESULTS IN 24 HOURS**  
**PREVENTS NEW NEEDS**  
**FOR UP TO 3 MONTHS!**

