



UNITED STATES ENVIRONMENTAL PROTECTION AGENCY
WASHINGTON, DC 20460

OFFICE OF CHEMICAL SAFETY
AND POLLUTION PREVENTION

July 5, 2017

Timothy H. Dickens, Ph.D.
Thermacell Repellents, Inc. c/o Scientific Coordination, Inc.
4629 Cherry Valley Drive
Rockville, MD 20853

Subject: Label Amendment – Various revisions including Directions for Use
Product Name: Thermacell Mosquito Repellent with Earth Scent
EPA Registration Number: 71910-3
Application Date: 01/27/2017
Decision Number: 526012

Dear Dr. Dickens:

The amended label referred to above, submitted in connection with registration under the Federal Insecticide, Fungicide and Rodenticide Act, as amended, is acceptable. This approval does not affect any conditions that were previously imposed on this registration. You continue to be subject to existing conditions on your registration and any deadlines connected with them.

A stamped copy of your labeling is enclosed for your records. This labeling supersedes all previously accepted labeling. You must submit one copy of the final printed labeling before you release the product for shipment with the new labeling. In accordance with 40 CFR 152.130(c), you may distribute or sell this product under the previously approved labeling for 18 months from the date of this letter. After 18 months, you may only distribute or sell this product if it bears this new revised labeling or subsequently approved labeling. "To distribute or sell" is defined under FIFRA section 2(gg) and its implementing regulation at 40 CFR 152.3.

Should you wish to add/retain a reference to the company's website on your label, then please be aware that the website becomes labeling under the Federal Insecticide Fungicide and Rodenticide Act and is subject to review by the Agency. If the website is false or misleading, the product would be misbranded and unlawful to sell or distribute under FIFRA section 12(a)(1)(E). 40 CFR 156.10(a)(5) list examples of statements EPA may consider false or misleading. In addition, regardless of whether a website is referenced on your product's label, claims made on the website may not substantially differ from those claims approved through the registration process. Therefore, should the Agency find or if it is brought to our attention that a website contains false or misleading statements or claims substantially differing from the EPA approved registration, the website will be referred to the EPA's Office of Enforcement and Compliance.

Your release for shipment of the product constitutes acceptance of these conditions. If these conditions are not complied with, the registration will be subject to cancellation in accordance

Page 2 of 2
EPA Reg. No. 71910-3
Decision No. 526012

with FIFRA section 6. If you have any questions, you may contact Julie Breeden-Alemi, DVM at 703-347-0511 or via email at Breeden-Alemi.Julie@epa.gov.

Sincerely,

A handwritten signature in black ink, appearing to read "Elizabeth Fertich". The signature is cursive and somewhat stylized, with the first letters of the first and last names being capitalized and prominent.

Elizabeth Fertich
Acting Product Manager 03
Invertebrate & Vertebrate Branch 1
Registration Division (7505P)
Office of Pesticide Programs

Enclosure

{FRONT PANEL AND INSERT WHEN APPLICABLE }

{ [] Denotes alternate/optional verbiage; { } Denotes verbiage not printed on market labeling; # = Number }

Thermacell® Mosquito Repellent with Earth Scent



{Select appropriate marketing verbiage from "Marketing Text" section}

Active Ingredient:

d-cis/trans allethrin	21.97%
Other Ingredients	<u>78.03%</u>
Total	100.00%

Keep Out of Reach of Children
CAUTION
 See [back] [side] [bottom] [panel] [and insert] for additional First Aid and [Precautions]
 [precautionary statements]¹.

[This Package] Contains

1 [Reusable] Appliance

[#] Mosquito Repellent Mat(s)
 Net Wt ____ oz (____ g) [each]
 [Total Net Wt ____ oz (____ g)]

[#] Butane [Thermacell] Cartridge(s)
 Net Wt ____ oz (____ g) [each]
 [Total Net Wt ____ oz (____ g)]

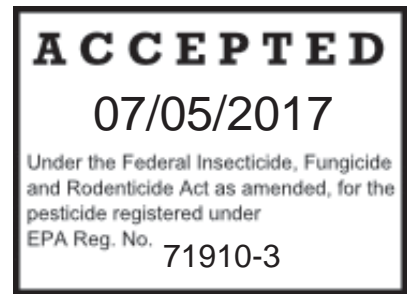

{non-insecticidal items included in the box}

[# belt clip] [# multi-use clamp] [# tree hanger] [# water resistant carry pouch] [# holster] [# holster with clip]
 [[#] [size] Batteries [for light] [sold separately]]

EPA Reg. No. 71910-3

EPA Est. {Determined at time of order}

©Thermacell Repellents, Inc.
 26 Crosby Drive
 Bedford, MA 01730
 Service@Thermacell.com

[Mats Made in {Determined at time of order}]
 [Manufactured in {Determined at time of order}]

¹ {NOTE TO REVIEWER: Most of the Thermacell devices use an insert. All outer boxes carry all Precautionary Statements, First Aid and Disposal. When used, inserts also carry all Precautionary Statements, First Aid and Disposal along with the Front Panel and Directions For Use. }

[Manufactured for the USA {Determined at time of order}]
 [Protected by one or more [of the following] U.S. Patents: 5,700,430; 7,835,631; 6,033,212, patent(s)
 pending]

{NOTES TO THE REVIEWER}

- {Numbering items are for document clarity only. Numbered items may appear in a different order on marketing label.}
- {statements may be combined into small paragraphs or remain as bullets on marketing label}
- {"Appliance" is interchangeable throughout with device, appliance, lantern, torch, backpacker, mosquito repeller, {marketing product name}}
- {Mat is interchangeable throughout with "{marketing name} mat". (ie: Thermacell mat, or t-mat, or mosquito mat... see Marketing Statements (Refills) for options)}
- {The fuel source may come in different containers. Cartridge is interchangeable throughout with {marketing name} cartridge, tank, canister, fuel source (ie: cartridge, or T-cartridge or fuel cartridge) see Marketing Statements (Refills) for options)}

{SIDE OR BOTTOM PANEL AND INSERT WHEN APPLICABLE}

PRECAUTIONARY STATEMENTS

Hazards to Humans & Domestic Animals

CAUTION: Harmful if swallowed or absorbed through skin. Causes moderate eye irritation. Avoid contact with skin, eyes or clothing. Wash hands thoroughly with soap and water after handling and before eating, drinking, chewing gum, using tobacco or using the toilet. Remove and wash contaminated clothing before reuse.

First Aid

If Swallowed:	<ul style="list-style-type: none"> • Call a poison control center or doctor immediately for treatment advice. Have a person sip a glass of water if able to swallow. Do not induce vomiting unless told to do so by a poison control center or doctor. Do not give anything by mouth to an unconscious person.
If On Skin or Clothing:	<ul style="list-style-type: none"> • Take off contaminated clothing. Rinse skin immediately with plenty of water for 15-20 minutes. Call a poison control center or doctor for treatment advice.
If In Eyes:	<ul style="list-style-type: none"> • Hold eye open and rinse slowly and gently with water for 15-20 minutes. Remove contact lenses, if present, after the first 5 minutes, then continue rinsing eyes. Call a poison control center or doctor for treatment advice.
<p>Have the product container or label with you when calling a poison control center or doctor, or going for treatment. For additional information on this pesticide product (including health concerns, medical emergencies or pesticide incidents), you may call 1-866-753-3837, Monday through Friday, 8:30 a.m. to 4:30 p.m. EST. After 4:30 p.m., call your poison control center.</p>	

{Note: The first aid statements' grid format will be used if market label space permits; otherwise a paragraph format will be used.}

Physical and Chemical Hazards

[Butane Cartridge] Hazard: Extremely flammable. Contents under pressure. Vapors may cause flash fire. Use only in a well ventilated area. Do not use, store, or dispose near heat, sparks, or flames. Do not puncture or incinerate. Containers exposed to direct sunlight or otherwise heated above 120°F (49°C) may burst. Store in cool, dry area. Intentional misuse by deliberately concentrating and inhaling the contents may be harmful or fatal. If vapors are inhaled, remove person to fresh air.

{If product uses batteries} [Batteries] [Use only with [provided] [rechargeable] [product name] [lithium ion] [alkaline] battery. Do not pry battery with any instrument or tool or put in a fire. Battery may burst or release toxic materials.]

Environmental Hazards

This product is toxic to fish and aquatic invertebrates. Do not apply directly to water. Do not contaminate water when cleaning equipment or disposing of equipment washwater or rinsate. Drift may be hazardous to aquatic organisms in water adjacent to treated areas.

{SIDE / BACK PANEL OR INSERT WHEN APPLICABLE}

{NOTES TO REVIEWER: When a box insert is used the device specific directions, useful tips, use restrictions and troubleshooting are printed on the insert only. The box and insert both will carry, "DIRECTIONS FOR USE - It is a violation of Federal law to use this product in a manner inconsistent with its labeling."}

The added section below (highlighted) is a direct lift from the SAL EPA Reg No 71910-2 01-DEC 2016}

DIRECTIONS FOR USE

It is a violation of Federal law to use this product in a manner inconsistent with its labeling.

[See leaflet inside box for usage directions.]

{FOR ALL DEVICES: Many of the Useful Tips and Troubleshooting are common for all devices since the mosquito repellency works the same in all devices. The differences occur in the added functions. Only the applicable bullets for each device will appear on the marketing label, in any order, bulleted or numbered.}

[Useful Tips:]

- Allow 10 to 30 minutes, depending upon the size of the area, for product to take effect [and repel mosquitoes].
- This product works [well] [best] in outdoor areas where there is minimal air movement, such as [decks], [unenclosed porches], [patios] [yards] and [outdoor campsites].
- [Product may be used for camping.]
- Use one appliance for [225 square feet] [or 15 feet in diameter] [15 ft]. [Use additional devices to cover a larger area.]
- Each [Thermacell] mat lasts a maximum of [4] hours [and each Thermacell[®] butane cartridge lasts a maximum of 12 hours].
- Provides a maximum of [4] hours mosquito repellency per mat.
- [Original, [Earth Scent] and [Max Life] [All] Thermacell refill mats [work in] [are effective in] Thermacell mosquito repellent appliances.
- [Original] [Mats provide [a maximum of] [up to] [4] hours mosquito repellency per mat [and turn from pale blue to white when mosquito repellent [active ingredient] [is] has been [exhausted] [used up] [depleted].]
- Mats turn from pale blue to white when [mosquito repellent] [it] [active ingredient] [is] [has been] [exhausted] [used up] [depleted] [and needs to be replaced].
- [If your device [appliance] fails to heat, it may be out of fuel. Check the fuel level by holding the cartridge vertically and looking at the fuel level. You can see the amount of butane in the cartridge. Replace if empty.]
- [Some visible vapor will appear during use; this is normal]
- [Use additional appliances to cover a larger area.]
- Altitudes [above [#] ft] [can] [may] effect product performance
- [Butane [cartridge]] [canister(s)] works best in [at] altitudes under [#] ft. High altitudes may affect performance.
- Position multiple devices [as needed] [every 15 ft] to protect a larger [patio][area].
- [Zone] [Indicator] Light requires [#] [type] batteries
- The mosquito repellent and light features operate [separately] [independently].

Use Restrictions: *{for all devices}*

Only for outdoor use as a mosquito repellent. Do not use indoors, in tents or in any enclosed area. Do not insert anything other than Thermacell[®] mats into the appliance. Cover or remove all exposed food. Do not leave appliance

unattended or use in windy conditions. Do not expose appliance(s) or mats to rain. [Do not attach appliance to your body or clothing.] [When using appliance stand,] Place appliance on a flat, stable surface with the grill facing upward. [Press the on-off button to the 'OFF' [out] position when not in use.] Do not touch the grill; [the top of the lantern;] it will be hot after a couple of minutes. Clean with a damp cloth only when the appliance is cool and inactive. Butane cartridges other than Thermacell® cartridges will not work in this appliance. [Only Thermacell® mats and cartridges will work in this appliance.]

Troubleshooting *{this section will appear, as appropriate, at the end of directions for use for the individual device}*

1. If you do not see an orange glow [through view window]
 1. Repeat directions "To Turn ON"
 2. If there is still no orange light visible [in the view window], make sure the [fuel][source][canister][cartridge] is completely screwed into place. Repeat "Turn On" directions. Confirm the orange glow is visible.
 3. Check the amount of fuel in the cartridge. If cartridge is empty or near empty, remove cartridge and replace with a new [Thermacell®] [cartridge]. [Then] Repeat "Turn On" directions. Confirm the orange glow is visible.
 4. [Canister] [cartridge] [may not work] [is less effective] at elevations over [#] ft.
 5. The bottom [cover] [door] must be in place and properly closed to allow the fuel to flow.
2. Not sure product is working?
 1. Place product upwind for maximum mosquito repellency. Windy conditions can reduce [product name] [mosquito repellent] effectiveness [against mosquitoes].
 2. Check the [mosquito repellent] mat. Mats turn from pale blue to white when it has been [exhausted][used up][depleted][need to be replaced]. See directions to replace [change] [Thermacell][mosquito repellent] mat
 3. Check the amount of fuel in the cartridge. If cartridge is empty or near empty, remove cartridge and replace with a new [Thermacell][cartridge]. [Then] Repeat "Turn On" directions. Confirm the orange glow is visible [through view window]
3. Still have questions? Call customer service at 1-866-753-3837 or email Service@Thermacell.com



{1. The following directions will be used when mats are sold with or used in the appliance (Thermacell® Mosquito Repellent) Stock Keeping Unit (SKUs) include but not exclusive to MR-GJ, MR-LJ, MR-RJ, MR-XJ, MR3, MR450}

1. Remove one Thermacell® Mosquito Repellent mat from wrapper.
2. Make sure the 'ON/OFF' switch on the appliance is in the 'OFF' position. Insert the mat under the appliance's black grill. To change mats, slide [turn] the 'ON/OFF' switch to 'OFF' and allow the appliance to cool completely. Push the used mat out by inserting a fresh one.
3. Remove the appliance [cover] [cap]. Remove the cap from the cartridge.
4. Screw the cartridge into the opening of the appliance. Make sure the cartridge is fully inserted by turning it clockwise until it stops. Replace the appliance cover. [If your appliance fails to heat, it may be out of fuel. To check the fuel level, hold the appliance vertically and look through the slot on the back of the appliance. You can see the amount of butane left in the cartridge. Replace if empty.]
5. Slide [Turn] the 'ON/OFF' switch to the 'ON' position; the butane gas will begin to flow.
6. Wait approximately 5 to 10 seconds then depress the start button three to five times in rapid succession.

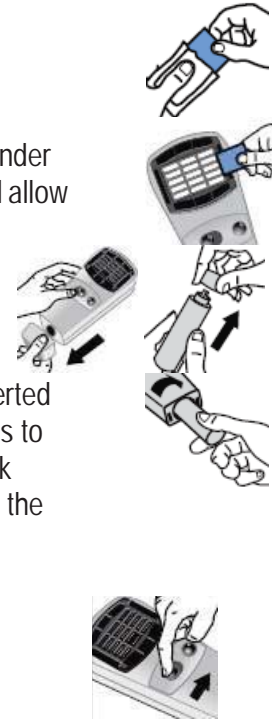

To use the [LED] [blue] [green] [Zone] indicator light:] *{used when appliance has an on/off indicator light feature}*

1. [To install [replace] battery,] Remove [side] [rear] battery compartment cover. Insert [#] [size] [supplied] [not] [included] battery into compartment. Replace battery compartment cover.]
2. [The [LED] [blue] [green] [Zone] indicator light will automatically illuminate once the mosquito repeller begins to [heat the mat] [create the Zone of Mosquito Protection]. It [will] [may] take [#] to [#] minutes for the zone to completely form. Light will turn off when the mat is no longer being heated [indicating appliance may require restarting] [or] [butane replacement] [or] [battery needs replacement]



3. The appliance can be used without the indicator light feature.

When finished using the appliance, slide [turn] the 'ON/OFF' switch to the 'OFF' position, and allow the appliance to cool completely. Appliance is now ready for storage.

{SIDE / BOTTOM PANEL AND INSERT WHEN APPLICABLE}

Storage and Disposal

Do not contaminate water, food or feed by storage or disposal.

Pesticide Storage: Store unused mats in original box in a cool, dry place inaccessible to children and pets.

Store appliance and butane cartridges in original box in a cool, dry place away from sources of heat. [Store

[alkaline] [lithium] batteries in cool, dry place away from heat or open flame.] **Pesticide Disposal and**

Container Handling: Non-refillable container; do not refill or reuse this container. **If cartridge is empty or for**

used mats: Do not reuse empty packaging, envelopes [wrappers] or cartridges. Do not puncture or incinerate

empty cartridges. Place in trash or offer for recycling if available. **If cartridge is partly filled or for unused**

mats: Call your local solid waste agency for disposal instructions. Never place unused mats down any indoor

or outdoor drain. **For unwanted appliance:** [Place in trash or offer for recycling if available.] [Thermacell

products contain recyclable materials and should not be put into the municipal waste stream. Contact your local

municipality for recycling directions.]

Batch Code: _____

[Guarantee:]

{Appears on side or bottom of Box}

100 % Satisfaction Guaranteed *{may appear as text or graphically enhanced text}*

At Thermacell, we stand behind our products and our quality. If you are not completely satisfied with your Thermacell purchase, you may return it to us for repair, replacement, or refund. [*Please see Guarantee [section] [inside] on [bottom] [side] [of] [box][package][bag] for details.]

{Entire Guarantee}

[At Thermacell, we stand behind our products and our quality]. If you are not completely satisfied with your Thermacell purchase, you may return it to us for repair, replacement, or refund. [We will repair or replace product up to [#] years from date of purchase]

[For refunds, requests must be received within [#] days from date of purchase with the original store receipt. Any product received later than [#] days from the date of purchase will be replaced or repaired by Thermacell at the company's option. Please call customer service at 866-753-3837 for a return authorization number. Ship only the Thermacell device [no repellent mats, no butane cartridge] back to us.]

[Warranty and Disclaimers: To the extent consistent with applicable by law, seller will not be held responsible for damage, injury or poor performance caused by use of other butane cartridges or repellent mats. To the extent consistent with applicable law, seller is not responsible for damage caused by using this butane cartridge in other butane products.]

Thermacell® is a Registered Trademark of Thermacell Repellents, Inc.

{Mat Label}

Thermacell® Mosquito Repellent with Earth Scent Mat

Active Ingredient:
d-cis/trans allethrin 21.97%
Other Ingredients 78.03%
Total 100.00%

Keep Out of Reach of Children
CAUTION
See outer carton for additional First Aid, Precautionary Statements
and Directions for Use.

Net Weight: ____ oz.
EPA Reg. No. 71910-3 EPA Est. No. {Determined at time of order}
©Thermacell Repellents, Inc.
[26 Crosby Drive] Bedford, MA 01730
Made [and Printed] in {Determined at time of order}

{Thermacell® Butane Cartridge Labeling}

Thermacell® Butane Cartridge
Keep Out of Reach of Children
DANGER²

Extremely flammable. Contents under pressure. [See box for additional precautions.] [Contains Butane/Isobutane blend. Vapors may cause flash fire. Use only in a well ventilated area. Do not use, store, or dispose near heat, sparks, or flames. Do not puncture or incinerate. Containers exposed to direct sunlight or otherwise heated above 120°F (49°C) may burst. Store in cool, dry area. Intentional misuse by deliberately concentrating and inhaling the contents may be harmful or fatal. If vapors are inhaled, remove person to fresh air. Use only with Thermacell® products.]

Net Wt ____ oz
©Thermacell Repellents, Inc.
[26 Crosby Drive]
Bedford, MA 01730-1402
[Thermacell® is a Registered Trademark of Thermacell Repellents, Inc.]

² {NOTE TO REVIEWER: This use of DANGER and the text for the butane cartridge are in accordance with CPSC and Federal Hazardous Substances Act (FHSA) Requirements.

{Appliance Labeling}

{Promotional Item Language (when appliance is used as a promotional item):}

NWTF Logo National Wild Turkey Federation
Team Realtree Logo [America's Most Versatile Camo Pattern]
Realtree Hardwoods Green HD Logo

Thermacell® Mosquito Repellent [Appliance]

{Labeling for device top}

ATTENTION - HOT SURFACE [Insert mat under grill]

{Labeling for device base or lid or other integral part of the device}

Keep Out of Reach of Children

CAUTION

Read *Directions for Use, First Aid* and *Precautionary Statements* on box prior to use.

Only for outdoor use as a mosquito repellent. Do not use indoors, in a tent or any enclosed area. Do not touch the [black] grill while the appliance is in use. Grill is hot while in use. Place on a flat, stable surface [with the [black] grill facing upward]. Do not cover with any material while in use. Do not expose appliance to rain. [Only Thermacell Butane cartridges and mats work in this appliance.]

EPA Reg. No. 71910-3 EPA Est. No. *{determined at time of order}*

©Thermacell Repellents, Inc.

[26 Crosby Drive], Bedford, MA 10730

781-541-6900

U.S. Patent Nos. 5,700,430; D423,071

[Thermacell® is a Registered Trademark of Thermacell Repellents, Inc.]

{FRONT PANEL AND INSERT WHEN APPLICABLE }

Thermacell® Mosquito Repellent with Earth Scent

REFILLS

{Select appropriate marketing verbiage from "Marketing Text" section may be added to the front panel}

Active Ingredient:

d-cis/trans allethrin	21.97%
Other Ingredients	78.03%
Total	100.00%

Keep Out of Reach of Children
CAUTION
 See [back] [side] [bottom] panel [and insert] for additional First Aid and Precautions³ .

[This Package] Contains

[#] Mosquito Repellent Mat(s)
Net Weight [Wt.] ____ oz (____g) each

[#] Butane [Thermacell] Cartridge(s)
Net Wt ____ oz. (____ g) [each]
Total Net Wt. ____oz (____g)

EPA Reg. No. 71910-3 EPA Est. No. {determined a time of order}

©Thermacell Repellents, Inc.
 26 Crosby Drive
 Bedford, MA 01730
 1-866-753-3837 Service@Thermacell.com

[Made and Printed {Determined at time of order}]
 [Mats Made in {Determined at time of order}]
 [Manufactured in {Determined at time of order}]

[Protected by one or more of the following U.S. Patents: 5,700,430; D300,606; 6,033,212 C1, patent(s) pending]

³ {NOTE TO REVIEWER: All outer boxes carry all Precautionary Statements, First Aid and Disposal. When used, inserts also carry all Precautionary Statements, First Aid and Disposal along with the Front Panel and Directions For Use. }

{SIDE / BOTTOM PANEL AND INSERT WHEN APPLICABLE}

PRECAUTIONARY STATEMENTS**Hazards to Humans & Domestic Animals**

CAUTION: Harmful if swallowed or absorbed through skin. Causes moderate eye irritation. Avoid contact with skin, eyes or clothing. Wash hands thoroughly with soap and water after handling and before eating, drinking, chewing gum, using tobacco or using the toilet. Remove and wash contaminated clothing before reuse.

First Aid

If Swallowed:	<ul style="list-style-type: none"> Call a poison control center or doctor immediately for treatment advice. Have a person sip a glass of water if able to swallow. Do not induce vomiting unless told to do so by a poison control center or doctor. Do not give anything by mouth to an unconscious person.
If On Skin or Clothing:	<ul style="list-style-type: none"> Take off contaminated clothing. Rinse skin immediately with plenty of water for 15-20 minutes. Call a poison control center or doctor for treatment advice.
If In Eyes:	<ul style="list-style-type: none"> Hold eye open and rinse slowly and gently with water for 15-20 minutes. Remove contact lenses, if present, after the first 5 minutes, then continue rinsing eyes. Call a poison control center or doctor for treatment advice.
<p>Have the product container or label with you when calling a poison control center or doctor, or going for treatment. For additional information on this pesticide product (including health concerns, medical emergencies or pesticide incidents), you may call 1-866-753-3837, Monday through Friday, 8:30 a.m. to 4:30 p.m. EST. After 4:30 p.m., call your poison control center.</p>	

{Note: The first aid statements' grid format will be used if market label space permits; otherwise a paragraph format will be used.}

Physical and Chemical Hazards

{If Butane is included:} [Butane Cartridge] Hazard: Extremely flammable. Contents under pressure. Vapors may cause flash fire. Use only in a well ventilated area. Do not use, store, or dispose near heat, sparks, or flames. Do not puncture or incinerate. Containers exposed to direct sunlight or otherwise heated above 120°F (49°C) may burst. Store in cool, dry area. Intentional misuse by deliberately concentrating and inhaling the contents may be harmful or fatal. If vapors are inhaled, remove person to fresh air.

Environmental Hazards

This product is toxic to fish and aquatic invertebrates. Do not apply directly to water. Do not contaminate water when cleaning equipment or disposing of equipment washwater or rinsate. Drift may be hazardous to aquatic organisms in water adjacent to treated areas.

{SIDE / BACK PANEL OR INSERT WHEN APPLICABLE}

DIRECTIONS FOR USE

It is a violation of Federal law to use this product in a manner inconsistent with its labeling.
[See leaflet inside box for usage directions.]

Use Restrictions: *{for all devices}*

Only for outdoor use as a mosquito repellent. Do not use indoors, in tents or in any enclosed area. Do not insert anything other than Thermacell[®] mats into the appliance. Cover or remove all exposed food. Do not leave appliance unattended or use in windy conditions. Do not expose appliance(s) or mats to rain. [Do not attach appliance to your body or clothing.] [When using appliance stand,] Place appliance on a flat, stable surface with the grill facing upward. [Press the on-off button to the 'OFF' [out] position when not in use.] Do not touch the grill; [the top of the lantern;] it will be hot after a couple of minutes. Clean with a damp cloth only when the appliance is cool and inactive. Butane cartridges other than Thermacell[®] cartridges will not work in this appliance. [Only Thermacell[®] mats and cartridges will work in this appliance.]

[Please refer to the instruction booklet that came with your device for specific features and directions.]

To Use Mosquito Repellent

1. Remove one mat from wrapper.
2. With Thermacell device off and completely cool, insert and center mat under grill.
3. Attach Thermacell device to the power source specified on the device directions.
4. Follow your device directions to activate mosquito repellent.

{If Butane is included}

To Insert Butane Cartridge

1. Remove the appliance cover. Remove the cap from the butane cartridge.
2. Screw the cartridge into the opening of the Thermacell appliance. Make sure canister is fully inserted by turning it until it stops. Do not over tighten.
3. Replace the appliance cover.

To Turn On/ Off

Refer to the appliance's packaging.

To Replace Mosquito Repellent Mat

Make sure device is off and cool; push used mat out by inserting a fresh one.

{SIDE / BOTTOM PANEL AND INSERT WHEN APPLICABLE}

Storage and Disposal

Do not contaminate water, food or feed by storage or disposal.

Pesticide Storage: Store unused mats in original box in a cool, dry place inaccessible to children and pets.

Store appliance and butane cartridges in original box in a cool, dry place away from sources of heat. **Pesticide**

Disposal and Container Handling: Non-refillable container; do not refill or reuse this container. **If cartridge**

is empty or for used mats: Do not reuse empty packaging, envelopes [wrappers] or cartridges. Do not

puncture or incinerate empty cartridges. Place in trash or offer for recycling if available. **If cartridge is partly**

filled or for unused mats: Call your local solid waste agency for disposal instructions. Never place unused

mats down any indoor or outdoor drain. **For unwanted appliance:** [Place in trash or offer for recycling if

available.] [Thermacell products contain recyclable materials and should not be put into the municipal waste

stream. Contact your local municipality for recycling directions.]

Batch Code [Lot Number]: _____

[Warranty and Disclaimers: To the extent consistent with applicable by law, seller will not be held responsible for damage, injury or poor performance caused by use of other butane cartridges or repellent mats. To the extent consistent with applicable law, seller is not responsible for damage caused by using this butane cartridge in other butane products.]

{Marketing Text for use on boxes:}

1. Buy one get one free
2. Convenient [and] Silent
3. Coupon [{\$} {number} Rebate[s]] inside
4. Easy to use
5. Effective
6. Portable
7. Refills [are] available
8. Lightweight and Silent [and Portable]
9. Clean, simple, easy to use.
10. No open flame
11. Value Pack: {number}[dollar savings] [off regular price]
12. Lightweight [only] [#] ounces
13. Mosquito [Repellent] [Defense] [Zone]
14. [This package] [Package] contains
15. [#] hour pack includes [#] butane cartridges and [#] mats

{Repellency}

16. Provides 15 ft x 15 ft area of mosquito repellency
17. Repels mosquitoes
18. [Provides] 15 x 15 ft [Zone [of] Mosquito Protection] [Mosquito Protection Zone]

{REFILL Statements}

19. Can be used in any Thermacell Mosquito Repellent product[s]
20. Refills Available
21. Thermacell® refills may be used in [other] [all] [any] [these] [Thermacell® Mosquito Repellent products]
22. [#] mosquito repellent mats [provide] [=] [work for a total of] [#] hours
23. [#] [Each] [butane] cartridge(s) [lasts] [lasting] [up to] 12 hours each
24. Each mat lasts a maximum of 4 hours
25. [#] hours mosquito protection. [#] mosquito repellent mats [lasting] 4 hours each *{ie 48 hours mosquito protection. 12 mosquito repellent mats lasting 4 hours each}*
26. [#] mosquito repellent mats [lasting] [#] hours each [#] hours total mosquito protection. *{ie: 12 mosquito repellent mats lasting 4 hours each, 48 hours mosquito protection.}* *{this claim is the same math equation as #26, but reversed. We need both versions of this statement because a hanging box with header card (see image) would not allow the statement to be clearly read as written on #26. If we write it reversed, the message it works}*

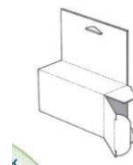
***How it [Thermacell® Mosquito Repellents] Works]***

27. Provides 15ft x 15ft Zone [of] Mosquito Protection [mosquito protection zone] [, the size of an average deck.]
28. Heat activated mat releases repellent into the air creating a 15ft x 15ft Mosquito Protection Zone [Zone [of] Mosquito Protection]

{Where Product is Used}

29. For hunting
30. Hunting Series

31. *{brand name}* Ideal for *{areas product can be used, not all products will list the same items from this list}* Backyard Camping Hunting Basecamp DIY Fishing Patio Deck Spectator Sports Swimming Beaches Parties Gardening Outdoor Entertaining Campsites Docks

{Scent}

32. Earth Scent {or other appropriate description}
33. Earth Cover Scent
34. Earth [Cover] Scent [to mask] [masks] human odor
35. For hunters
36. Mosquito repellent for hunters
37. Masks human odor
38. No game-spooking odors
39. Place product upwind for maximum mosquito repellency.
40. [Mosquito repellent does not] [Won't] spook game
41. Mosquito Repellent mats with Earth Scent
42. Repels mosquitoes and [simultaneously] masks human odor
43. Smells like dirt
44. Thermacell® has added an earth cover scent to mosquito repellent so hunters can mask their own scent and keep the mosquitoes away.
45. Thermacell® Mosquito Repellent with Earth Scent

{Other}

46. Refills available wherever Thermacell [Mosquito repellent] [products are] [is] sold
47. Mosquitoes can spoil just about any hunting trip. Thermacell Mosquito Repellent efficiently repels and reduces the annoyance of mosquitoes in an area 15ft by 15ft. [It's portable.] [It's silent.] [[It is] [it's] effective and easy to use.]

{Promotional item language (when appliance is used as a promotional item)}

NWTF Logo National Wild Turkey Federation
 Team Realtree logo [America's Most Versatile Camo Pattern]
 Realtree Hardwoods Green HD logo