



UNITED STATES ENVIRONMENTAL PROTECTION AGENCY
WASHINGTON, D.C. 20460

SEP 17 2013

OFFICE OF CHEMICAL SAFETY
AND POLLUTION PREVENTION

Abigail Downs
Consultant for Medtrol, Inc.
Technology Sciences Group, Inc.
1150 18th Street, Suite 1000
Washington, DC 20036

Subject: Super-Chlor
EPA Registration No.: 69687-1
Application Date: 8/19/2013
Receipt Date: 8/20/2013

Dear Ms. Downs:

This acknowledges the receipt of your notification, submitted under the provision of PR Notice 98-10 and FIFRA section 3(c)9.

Proposed Notification

- Label update to administrative note to include interchangeable words for “glucometer”
- Addition of “+” sign to the directions for use to direct user to the PPE language
- Addition of optional “Not for use on skin” logo

General Comments

Based on a review of the submitted materials, your notification for the update and additions stated above is acceptable and is made a part of the records on file.

Should you have any questions or comments concerning this letter, you may contact Jaclyn Pyne by telephone at (703) 347-0213 or by e-mail at pyne.jaclyn@epa.gov. When submitting information or data in response to this letter, a copy of this letter should accompany the submission to facilitate processing.

Sincerely,

Demson Fuller
Acting Product Manager (32)
Regulatory Management Branch II
Antimicrobials Division (7510P)



United States
Environmental Protection Agency
Washington, DC 20460

<input type="checkbox"/>	Registration
<input type="checkbox"/>	Amendment
<input checked="" type="checkbox"/>	Other

OPP Identifier Number

Application for Pesticide - Section I

1. Company/Product Number 69687-1	2. EPA Product Manager Demson Fuller	3. Proposed Classification <input type="checkbox"/> None <input type="checkbox"/> Restricted
4. Company/Product (Name) Medtrol, Inc. / Super-Chlor	PM# 32	
5. Name and Address of Applicant (Include ZIP Code) Medtrol, Inc. 7157 North Austin Avenue Niles, IL 60714 <input type="checkbox"/> Check if this is a new address	6. Expedited Review. In accordance with FIFRA Section 3(c)(3)(b)(i), my product is similar or identical in composition and labeling to: EPA Reg. No. _____ Product Name _____	

Section - II

<input type="checkbox"/> Amendment - Explain below.	<input type="checkbox"/> Final printed labels in response to Agency letter dated _____
<input type="checkbox"/> Resubmission in response to Agency letter dated _____	<input type="checkbox"/> "Me Too" Application.
<input checked="" type="checkbox"/> Notification - Explain below.	<input type="checkbox"/> Other - Explain below.

Explanation: Use additional page(s) if necessary. (For section I and Section II.)

Notification to update product label per PR Notice 98-10. This notification is consistent with the provisions of PR Notice 98-10 and EPA regulations at 40 CFR 152.46, and no other changes have been made to the labeling or the confidential statement of formula of this product. I understand that it is a violation of 18 U.S.C. Sec. 1001 to willfully make any false statement to EPA. I further understand that if this notification is not consistent with the terms of PR Notice 98-10 and 40 CFR 152.46, this product may be in violation of FIFRA and I may be subject to enforcement action and penalties under sections 12 and 14 of FIFRA. Please confirm receipt with Abigail Downs: adowns@tsgusa.com or via phone (202) 828-8992.

Section - III

1. Material This Product Will Be Packaged In:				2. Type of Container	
Child-Resistant Packaging <input type="checkbox"/> Yes <input type="checkbox"/> No	Unit Packaging <input type="checkbox"/> Yes <input type="checkbox"/> No	Water Soluble Packaging <input type="checkbox"/> Yes <input type="checkbox"/> No		<input type="checkbox"/> Metal	<input type="checkbox"/> Plastic
* Certification must be submitted		If "Yes" Unit Packaging wgt. No. per container	If "Yes" Package wgt. No. per container	<input type="checkbox"/> Glass	<input type="checkbox"/> Paper
				<input type="checkbox"/> Other (Specify) _____	
3. Location of Net Contents Information <input type="checkbox"/> Label <input type="checkbox"/> Container		4. Size(s) Retail Container		5. Location of Label Directions <input type="checkbox"/> On label	
6. Manner in Which Label is Affixed to Product		<input type="checkbox"/> Lithograph <input type="checkbox"/> Paper glued <input type="checkbox"/> Stenciled		<input type="checkbox"/> Other _____	

Section - IV

1. Contact Point (Complete items directly below for identification of individual to be contacted, if necessary, to process this application.)		
Name Abigail Downs	Title Regulatory Consultant	Telephone No. (Include Area Code) 202-828-8992
Certification I certify that the statements I have made on this form and all attachments thereto are true, accurate and complete. I acknowledge that any knowingly false or misleading statement may be punishable by fine or imprisonment or both under applicable law.		6. Date Application Received (Stamped)
2. Signature 	3. Title Regulatory Agent to Medtrol, Inc.	
4. Typed Name Abigail T. Downs	5. Date August 19, 2013	

3/18

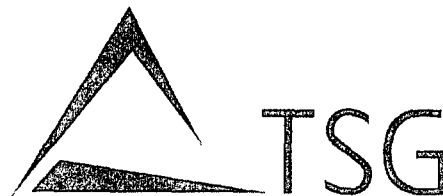

Technology Sciences Group Inc.

1150 18th Street, NW, Suite 1000
Washington, D.C. 20036
Direct: (202) 828-8992
Fax: (202) 872-0745
E-Mail: adowns@tsgusa.com

Abigail T. Downs
Regulatory Consultant

Demson Fuller

August 19, 2013

Attn: Jaclyn Pyne
Antimicrobial Division (7504P)
Office of Pesticide Products
U.S. Environmental Protection Agency
Room S-4900, One Potomac Yard
2777 South Crystal Drive
Arlington, VA 22202-4501

Re: Notification to Update Product Label per PR Notice 98-10
Company Name: Medtrol, Inc.
Product Name: Super-Chlor
EPA Registration Number: 69687-1

Dear Mrs. Pyne,

Technology Sciences Group, Inc., on behalf of Medtrol, Inc., is submitting the enclosed notification to update the aforementioned product label. This notification updates the administrative note to include interchangeable words for the term "glucometer," adds a "+" sign to the directions for use personal protective equipment phrase to direct users to the PPE language under the HIV section, and adds an additional, "Not for use on skin" logo to the optional marketing claims section of the label.

Please see the following enclosed in support of this time extension:

1. EPA Form 8570-1;
2. Revised redline version of the label with the requested changes in red;
3. Three clean revised copies of the proposed label dated August 19, 2013.

Please do not hesitate to contact me with any questions via phone (202) 828-8992 or e-mail at adowns@tsgusa.com.

Sincerely,

Regulatory Consultant to
Medtrol, Inc.

{Administrative Note: Bracketed text [] is optional version of text for different packaging.}

{Administrative Note: The terms "towelette(s)", "towel(s)", "wipe(s)", "wiper(s)" and "cloth(s)", and the terms "Premoistened", "Premeasured", "Convenient", "Disposable" and "Pre-saturated", and the terms "Glucometers", "Glucose Meters", and "Blood Glucose Meter" may be used interchangeably throughout.}

Premoistened [3" x 3"] [3" x 4"] [5" x 9"] [6" x 6"] [6" x 7"] [6" x 8"] [6" x 9"] [7" x 8"] [7" x 9"] [8" x 7"] [8" x 9"] [8" x 10"] [9" x 6"] [9" x 9"] [12" x 12"] [14" x 14"] Towelette [CAT#SC110]

SUPER-CHLOR® [Product Name]

[For wiping] [Disinfecting wipe for] hard [,] non-porous [surfaces] [environmental surfaces] [healthcare surfaces][.]

[Effective against] [Kills] [Sporicidal] [for] [*Clostridium difficile*] [*C. difficile*] [*C. diff*] [*C DIFF*] spores] [ATCC 43598][,] [+Virucidal] [for] [+Hepatitis B Virus][,] [+HBV][,][+Human][+Hepatitis C Virus] [+Human Hepatitis C Virus][,][+HCV][,] [+Human Immunodeficiency Virus Type 1][,] [+HIV-1][,] [Fungicidal] [for] [*Trichophyton mentagrophytes*] [ATCC 9533][,][Bactericidal] [for] [*Staphylococcus aureus*-MRSA(MRSA)], [*Methicillin Resistant Staphylococcus aureus* (MRSA)], [*Staphylococcus aureus* (MRSA)], [MRSA] [ATCC 33592] [,] [*Enterococcus faecalis*-VRE (VRE)], [*Vancomycin Resistant Enterococcus faecalis* (VRE)], [*Enterococcus faecalis* (VRE)], [VRE] [ATCC 51575][,] [*Staphylococcus aureus*] [ATCC 6538][,] [*Salmonella enterica*] [ATCC 10708][,] [and] [*Pseudomonas aeruginosa*] [ATCC 15442] [.]

Active Ingredient: Sodium hypochlorite.....	0.65%
Other Ingredients*:	99.35%
Total.....	100.00%

*Other ingredients do not include the weight of towelette.

SUGGESTED AREAS OF USAGE:

[On] [Medical] [,] [and] [Dental] [and] [Laboratory] [Counters] [,] [Exam Tables] [,] [Carts] [,] [Patient Care Equipment] [,] [and][Point-of-Care Equipment] [,] [Telephones] [,] [Sink Tops] [,] [Toilet Seats][,][Digital screens] [,][on] [Plastics][,] [Glazed Porcelain] [,] [Glazed [ceramic] tiles][,] [Stainless Steel] [,][Formica] [,] [Vinyl] [,] [Rubber Surfaces] [,] [Hard] [Plastic Surfaces] [,] [Laminated [Plastic] Countertops] [,] [Glass] [,] [Plexiglas] [,] [Suitable For Use on Equipment Requiring Bleach Based Products] [,] [Bed Rails] [,] [IV Poles] [,] [Dialysis Machines] [,] [&] [and] [[Blood] Glucose Meters†] [Glucometers†] [.]

KEEP OUT OF REACH OF CHILDREN

CAUTION

FIRST AID: If in eyes: Hold eye open and rinse slowly and gently with water for 15 – 20 minutes. Remove contact lenses, if present, after the first 5 minutes, then continue rinsing eye. Call a poison control center or doctor for treatment advice.

Have the product container with you when calling a poison control center or doctor, or going for treatment.

(See [side] [back] panel[s] [on reverse] [of] [outer box] for directions for use and additional precautionary statements.)

OR

(See side panel of outer box for [suggested areas of usage][,] [first aid statement][,] [special instructions for cleaning and decontamination against +HIV-1, +HBV and +HCV][,] [precautionary statements][,] [storage and disposal].)

{Administrative Note: Bracketed text [] is optional version of text for different packaging.}

{Administrative Note: The terms "towelette(s)", "towel(s)", "wipe(s)", "wiper(s)" and "cloth(s)" and the terms "Premoistened", "Premeasured", "Convenient", "Disposable" and "Pre-saturated", and the terms "Glucometers", "Glucose Meters", and "Blood Glucose Meter" may be used interchangeably throughout.}

EPA Reg. No. 69687-1
EPA Est. No. 69687-IL-001
[MEDTROL logo]
[©XXXX Medtrol, Inc.]

Net Contents [0.1][0.15][0.2][0.25][0.3]
[0.4][0.5][0.6][0.7][0.8][0.9][1.0] [xx.xx]oz.
[DIN: {insert # as applicable}]

DIRECTIONS FOR USE

It is a violation of Federal Law to use this product in a manner inconsistent with its labeling.

[Hospital Disinfection] [Healthcare Facility Disinfection] [General Disinfection] [Disinfection]

1. Always use personal protective equipment.±
2. Open [Super-Chlor®][Product name] [packet] [canister].
3. Remove premoistened [3" x 3"] [3" x 4"] [5" x 9"] [6" x 6"] [6" x 7"] [6" x 8"] [6" x 9"] ["7 x 8"] [7" x 9"] ["8 x 7"] ["8 x 9"] [8" X 10"] [9" x 6"] [9" x 9"] [12" x 12"] [14" x 14"] [9"x12"] [12"x9"] towelette.
4. Apply towelette and wipe desired surface to be [decontaminated][disinfected].
5. {Note: one of the two statements will be on the label.} A 30 second contact time is required to kill HBV and HCV. A 3 minutes contact time is required [for efficacy against][to kill] [[Clostridium difficile] [C. difficile] [C. diff] [C DIFF] spores]. A 5 minute contact time is required [for effectiveness against][to kill] HIV and other organisms listed on the label. Reapply as necessary to ensure that the surface remains wet for the entire contact time.

OR

Allow treated surfaces to remain thoroughly wet for 5 minutes. Reapply as necessary to ensure that the surface remains wet for the entire contact time.

6. Allow surface to air dry and discard [used] towelette and [empty] [packet][canister] (see storage and disposal).

{Optional text for use with canister offerings}

[To open canister:

1. Always use personal protective equipment.±
2. Remove lid from canister
3. [Remove [foil] seal] [from mouth of canister] [if present][and discard]
4. Lift flap [in] [on] canister lid
5. Pull up corner of center towelette/wipe and snap off, twist to a point and thread through dispenser hole in lid.
6. DO NOT PUSH FINGER THROUGH OPENING
7. Replace lid. Pull out exposed towelette/wipe and snap off. The next towelette/wipe pops up automatically.
8. Snap center flap down when finished to retain moisture.
9. Do not flush towelette/wipe into toilet.]

{Optional text for use with canister}

DIRECTIONS FOR DISPENSING:

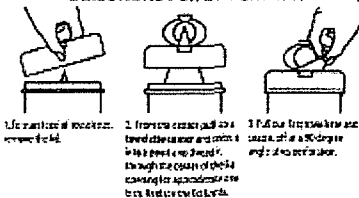

{Optional text for refills sold separately}

{Administrative Note: Bracketed text [] is optional version of text for different packaging.}

{Administrative Note: The terms "towelette(s)", "towel(s)", "wipe(s)", "wiper(s)" and "cloth(s)", and the terms "Premoistened", "Premeasured", "Convenient", "Disposable" and "Pre-saturated", and the terms "Glucometers", "Glucose Meters", and "Blood Glucose Meter" may be used interchangeably throughout.}

1. Always use personal protective equipment.
2. To refill the wipes [towelette] cut open sealed pouch and place [the roll of wipes] into the canister.
3. Pull up corner of center towelette/wipe and snap off, twist to a point and thread through dispenser hole in lid.
4. DO NOT PUSH FINGER THROUGH OPENING
5. Replace lid. Pull out exposed towelette/wipe and snap off. The next towelette/wipe pops up automatically.
6. Snap center flap down when finished to retain moisture.
7. Do not flush towelette/wipe into toilet.

{Optional text for single use packet}

[TO OPEN PACKAGE: Always use personal protective equipment. Tear open [along dotted line] [At tear notch] [along the top edge of pouch]. [Pull out] [Remove] towelette. [Unfold towelette before use.] Dispose used wipes/towelette in trash. Do not flush wipes/towelette into toilet. Discard used wipes [towelette] and empty packet in designated infectious waste container for disposal according to Federal, State and Local regulations.

{Administrative Note: If a virucidal and/or HIV claim is made the following paragraph and special instructions are required}

+KILLS HIV-1, HBV, AND HCV ON PRECLEANED ENVIRONMENTAL SURFACES/OBJECTS PREVIOUSLY SOILED WITH BLOOD/BODY FLUIDS in health care settings or other settings in which there is an expected likelihood of soiling of inanimate surfaces/objects with blood/body fluids and in which the surfaces/objects likely to be soiled with blood/body fluids can be associated with the potential for transmission of HIV-1 (associated with AIDS), HBV, and HCV.

SPECIAL INSTRUCTIONS FOR CLEANING AND DECONTAMINATION AGAINST HIV-1, HBV, AND HCV ON SURFACES/OBJECTS SOILED WITH BLOOD/BODY FLUIDS.

PERSONAL PROTECTION: When handling items soiled with blood or body fluids, use disposable [protective] [latex] gloves, gown, masks [,] and eye protection.

CLEANING PROCEDURES: Blood/body fluids must be thoroughly cleaned from surfaces/objects before application of [Super-Chlor][Product Name].

CONTACT TIME: Allow surface(s) to remain wet for 30 seconds to kill HBV and HCV[.] [.] [for 3 minutes to kill [*Clostridium difficile*] [*C. difficile*] [*C. diff*][*C DIFF*] spores]] [.] [and] [5 minutes to kill HIV and the other organisms listed on the label][.]

DISPOSAL OF INFECTIOUS MATERIAL: Blood/body fluids must be autoclaved and disposed of according to local regulations for infectious waste disposal.

PRECAUTIONARY STATEMENTS

Hazards to humans and domestic animals

CAUTION: Causes moderate eye irritation. Avoid contact with eyes and clothing. Wash thoroughly with soap and water after handling and before eating, drinking, chewing gum, using tobacco, or using the toilet. Remove and wash contaminated clothing before reuse.

This product is not to be used as a terminal sterilant/high level disinfectant on any surface or instrument that (1) is introduced directly into the human body, either into or in contact with the bloodstream or normally sterile areas of the body, or (2) contacts intact mucous membranes but which does not ordinarily penetrate the blood barriers or otherwise enter normally sterile areas of the body. This product may be used to pre-clean or decontaminate critical or semi-critical medical devices prior to sterilization or high level disinfection.

{Administrative Note: Bracketed text [] is optional version of text for different packaging.}

{Administrative Note: The terms "towelette(s)", "towel(s)", "wipe(s)", "wiper(s)" and "cloth(s)" and the terms "Premoistened", "Premeasured", "Convenient", "Disposable" and "Pre-saturated", and the terms "Glucometers", "Glucose Meters", and "Blood Glucose Meter" may be used interchangeably throughout.}

†This product is for the exterior surfaces of Glucometers and is not for use on the needle and/or the monitors.

STORAGE AND DISPOSAL

Do not contaminate water, food or feed by storage or disposal

Pesticide Storage: [For product sold in canisters] Keep this product (wipe/towelette) in a tightly closed container/canister, when not in use. Store canister in cool, dry, and well-ventilated area away from heat, open flame, direct sunlight and inaccessible to children. [For product sold in individual packets] Store in a cool, dry, and well-ventilated area away from heat, open flame, direct sunlight and inaccessible to children.

Pesticide (towelette/wipe) Disposal: Wastes resulting from the use of this product must be disposed of on site or at an approved waste disposal facility.

Container/Canister Handling and Disposal:

A. [For Household/Residential Products]

[For rigid nonrefillable container/canister less than 5 gallons]

Container Handling: Nonrefillable rigid container/canister. Do not re-use or refill this container/canister. Triple rinse (or equivalent), promptly after emptying. Offer for recycling, if available, or throw in trash.

B. [For Commercial/Industrial/Institutional Products]

[For rigid nonrefillable container/canister less than 5 gallons]

Container Handling: Nonrefillable rigid container/canister. Do not re-use or refill this container. Triple rinse (or equivalent), promptly after emptying. Offer for recycling or reconditioning, or puncture and dispose of in a sanitary landfill, or incineration, or, if allowed by state and local authorities, by burning. If burned, stay out of smoke.

C. [For Refillable Containers]

Container Handling: Refillable container. Refill this container with pesticide only. Do not reuse this container for any other purpose. To clean the container before final disposal; Triple rinse (or equivalent), promptly after emptying. Offer for recycling or reconditioning, or puncture and dispose of in a sanitary landfill, or incineration, or, if allowed by state and local authorities, by burning. If burned, stay out of smoke.

D. [For individual packed wipes [towelettes]]

Container Handling: Wipes: Dispose of [wipe] [towelette] in trash after use. Do not flush. Offer empty packet for recycling if available or discard in trash.

Complete product line information available by calling:

7157 North Austin Avenue [MEDTROL, INC. logo]
Niles, Illinois 60714
Ph: 800-647-7180 Fx: 800-255-3027

e-mail: sales@medtrol.com
Website: www.medtrol.com
[BARCODE LABEL]

{Administrative Note: Bracketed text [] is optional version of text for different packaging. }

{Administrative Note: The terms "towelette(s)", "towel(s)", "wipe(s)", "wiper(s)" and "cloth(s)" ~~and the terms "Premoistened", "Premeasured", "Convenient", "Disposable" and "Pre-saturated", and the terms "Glucometers", "Glucose Meters", and "Blood Glucose Meter"~~ may be used interchangeably throughout. }

{OPTIONAL ADDITIONAL TEXT FOR USE ON PRODUCT LABEL OR COLLATERAL LABELING}

[1:10 [dilution of] [stabilized] bleach [sodium hypochlorite] [dilution] [solution]]
 [1:10 dilution of [stabilized] [bleach] [sodium hypochlorite] [household bleach]
 [1:10][dilution of] [solution of] [Sodium hypochlorite] [NaOCl] [bleach] [household bleach]
 [[3] [three] [minutes] [mins.] [contact time] [is effective] [is required] [efficacy] [against] [to kill]
 [[*Clostridium difficile*] [*C. difficile*] [*C. diff*] [*C DIFF*] spores] [in one-step]]
 [[5] [Five] [minutes] [mins.] [contact time] [is effective] [is required] [efficacy] [against] [to kill]
 [+HIV and other organisms listed on the label]]
 [[30] [Thirty] [seconds] [secs.] [contact time] [is effective] [is required] [efficacy] [against] [to kill]
 +HBC and +HCV]]
 [[1] [one] [-] step]]
 [1:10 [(6500 ppm)] [dilution of][sodium hypochlorite][NaOCl][bleach][equivalent to household
 bleach].
 [A one step cleaning and disinfecting sporicidal bleach wipe that meets CDC, CMS Tag F441, SHEA
 IDSA, APIC and Joint Commission guidelines for killing *Clostridium difficile* spores.]
 [A potable water rinse is required for food contact surfaces]
 An effective way to [clean] [,] [and] [deodorize] [and] [disinfect] [against odor-causing organism]
 [on] hard, nonporous surfaces listed on this label]
 [Active] [sodium hypochlorite][0.65%][6500 ppm][[active][sodium hypochlorite]
 [Aids [in reducing] [in the reduction of] cross contamination between treated surfaces]
 [All of the [raw materials] [components] of [the] [this] [these] [packets] [,] [and] [liquid[s]] [,] [and]
 [canister[s]] [product[s] are made in the [U.S.A.][USA][.]]
 [All in one] [one-step] [cleaner and disinfectant][cleaner] [disinfectant]
 [Antibacterial]
 [An effective method to [clean] [and] [,] [deodorize] [and] disinfect hard, non-porous environmental
 [and] [healthcare] surfaces]
 [An effective way to clean and deodorize against odor-causing organisms and disinfect hard, non-
 porous surfaces]
 [Assembled for] [and] [distributed by] [:]
 [Available exclusively from] [:]
 [Avoid excessive heat]
 [Avoid prolonged freezing]
 [Avoid direct sunlight]
 [Available chlorine 0.65%, 6500 ppm]
 [Attached and kills] [Destroys] [Deactivates] [helps] [eliminate] [tough to kill] [*Clostridium*
difficile][spores] in one-step on hard, nonporous healthcare surfaces]
 [Bathroom [disinfectant] wipes for hard, non-porous environmental surfaces]
 [Bleach [sodium hypochlorite] [disinfectant] wipe[s][.]
 [Bleach wipe[s]]
 [Bleach disinfectants] [1:10 dilution] [hospital use]
 [[Blood] glucose meter[s]†]
 [Can be used to][Clean][s] [,] [deodorize][s] and disinfect][s] [in one step] [hard, non-porous]
 [healthcare] [and] [environmental] [surfaces] [in one step][.]
 [Can be used on] [Use on] hard [,] non-porous surfaces only.
 [This product] [Product name] [cleans and disinfects] [kills] [[*Clostridium difficile*] [*C. difficile*], [*C.*
diff] [*C DIFF*] spores] in one-step

{Administrative Note: Bracketed text [] is optional version of text for different packaging. }

{Administrative Note: The terms "towelette(s)", "towel(s)", "wipe(s)", "wiper(s)" and "cloth(s)" and the terms "Premoistened", "Premeasured", "Convenient", "Disposable" and "Pre-saturated", and the terms "Glucometers", "Glucose Meters", and "Blood Glucose Meter" may be used interchangeably throughout. }

[Can be used] [For use] on hard [,] non-porous surfaces of [Can be used on] [Can be] [Used to [clean and] disinfect] [[blood] glucose meters[†]][[blood] glucose monitors[†]] [glucometer[s][†]] [,] [and] [blood pressure cuff[s]] [and] [,] [stethoscopes][in [blood] glucose meter[†] rental programs]

[Complete product line information available by calling: xxx-xxx-xxxx]

[Can be used to] [For use to][Disinfect[s] hard, non-porous [environmental] [and] [healthcare] surfaces]

[Can be used to] [Used to][Disinfect[s] [headsets] [telephones] [[cell] [cellular] [wireless] [mobile] [digital] phone[s]]

[Clean and disinfect surfaces with one [convenient] wipe]

[Cleans, disinfects, and deodorizes]

[Contains 6200 ppm [parts per million] [of] available chlorine]

[Contains 0.62% available chlorine]

[Contains 6500 [parts per million] [ppm] [of] active sodium hypochlorite]

[Contains 0.65% sodium hypochlorite]

[Contains] [0.65% [active] sodium hypochlorite]

[Contains][6500][parts per million] [ppm] [0.65%][of][active][sodium hypochlorite]

[NaOCl][bleach][equivalent to 1:10 dilution of household bleach]

[Contains 6500 ppm NaOCl (yields 0.62% available chlorine)]

[Contains 1:10 dilution (6500ppm) sodium hypochlorite]

[Can be used on] [For use on] [blood] [glucose meters[†]][[Glucometers[†]]]

[*Clostridium difficile*] [*C. difficile*] [*C. diff*] [*C DIFF*] spores]

[[Convenient] [Premeasured] [Premoistened] [Disposable] [Pre-saturated] [towelette]

[Disposable][germicidal] [sporicidal] wipes]

[Disinfects, cleans, deodorizes]

[Disinfectant wipe] [Can be used] [For use] [on][[Telephone[s]]][[cell] [cellular] [wireless] [mobile] [digital] phone[s]]

[Disinfects hard, non-porous healthcare surfaces]

[[Disinfectant] [Disinfecting] [bleach] [sodium hypochlorite] [wipe[s]]

Disinfects [blood glucose meters[†]] [,] [and] [patient care equipment] [,] [and] [point-of-care equipment] and hard, non-porous healthcare surfaces.

[Distributed by] [:]

[Disposable]

[Do not use on glassware, utensils or dishes]

[Easy] [,] [this product] [Product name] [Can be used] [as a] [is a] [one-step] cleaning and disinfecting] [one-step cleaner and disinfectant] bleach wipes[s] [effective against] [that kills] [in the presence of] [[*Clostridium difficile*] [*C. difficile*] [*C. diff*][*C DIFF*] spores] [in three minutes] [in 3 min.][.]

[Easy and convenience to use]

[[Effective against] [Kills] [Bactericidal for] [*Staphylococcus aureus*] [ATCC 6538], [*Salmonella enterica*] [ATCC 10708][,] [and] [*Pseudomonas aeruginosa*] [ATCC 15442]]] [in 5 minutes] [in 5 min.] [in the presence of organic soil (5% blood serum)] [and] [on [precleaned] hard, non-porous [environmental][and][healthcare] surfaces]

[[Effective against] [Virucidal for] [Kills] [+Hepatitis B Virus] [+HBV] [and] [+Human] [+Hepatitis C Virus] [+HCV] [in 30 seconds] [in 30 sec.] [in the presence of organic soil (5% blood serum)] [and] [on [precleaned] hard, non-porous [environmental][and][healthcare] surfaces]

[[Effective against] [Virucidal for] [Kills] [+Human Immunodeficiency Virus Type 1] [+HIV-1] [in 5 minutes] [in 5 min.] [in presence of organic soil (5% blood serum)] [and] [on [precleaned] hard, non-porous [environmental][and][healthcare] surfaces]

{Administrative Note: Bracketed text [] is optional version of text for different packaging.}

{Administrative Note: The terms "towelette(s)", "towel(s)", "wipe(s)", "wiper(s)" and "cloth(s)" ~~and the terms "Premoistened", "Premeasured", "Convenient", "Disposable" and "Pre-saturated", and the terms "Glucometers", "Glucose Meters", and "Blood Glucose Meter"~~ may be used interchangeably throughout.}

[[Equivalent to] household bleach]]
 [This product][Product name]is a one-step cleaner and disinfectant[[that][is][[Effective against] [Sporicidal for] [Kills] [[*Clostridium difficile*] [*C. difficile*] [*C. diff*][*C DIFF*] spores] [ATCC 63598] [in 3 minutes] [in 3 min.] in presence of 5% organic [soil] load [and] [on hard, non-porous [environmental] [and] [healthcare] surfaces] [[Effective against] [Fungicidal for][Kills] *Trichophyton mentagrophytes* [ATCC 9533]]] [in 5 minutes] [in 5 min.] [in presence of organic soil (5% blood serum)] [and] [on [precleaned] hard, non-porous [environmental][and][healthcare] surfaces] [[Effective against] [Bactericidal for][Kills] [[*Staphylococcus aureus*-MRSA[(MRSA)], [[Methicillin Resistant *Staphylococcus aureus* [(MRSA)], [*Staphylococcus aureus* (MRSA)], [MRSA]] [ATCC 33592]]] [in 5 minutes] [in 5 min.] [in presence of organic soil (5% blood serum)] [and] [on [precleaned] hard, non-porous [environmental][and][healthcare] surfaces] [[Effective against] [Bactericidal for][Kills] [[*Enterococcus faecalis*-VRE [(VRE)], [[Vancomycin Resistant *Enterococcus faecalis* [(VRE)], [*Enterococcus faecalis* (VRE)], [VRE] [ATCC 51575]]] [in 5 minutes] [in 5 min.] [in presence of organic soil (5% blood serum)] [and] [on [precleaned] hard, non-porous [environmental][and][healthcare] surfaces] [[Effective against] [Kills] [Bactericidal for] [*Staphylococcus aureus*] [*S. aureus*] [ATCC 6538] [in 5 minutes] [in 5 min.] [in presence of organic soil (5% blood serum)] [and] [on [precleaned] hard, non-porous [environmental][and][healthcare] surfaces] [[Effective against][Bactericidal for] [Kills] *Salmonella enterica* ATCC 10708 [in 5 minutes] [in 5 min.] [in presence of organic soil (5% blood serum)] [and] [on [precleaned] hard, non-porous [environmental][and][healthcare] surfaces] [[Effective against] [Bactericidal for] [Kills] *Pseudomonas aeruginosa* ATCC 15442] [in 5 minutes] [in 5 min.] [in presence of organic soil (5% blood serum)] [and] [on [precleaned] hard, non-porous [environmental][and][healthcare] surfaces] [[Effective against] [Bactericidal for] [Kills] [*Staphylococcus aureus*] [ATCC 6538] [and][,] [*Salmonella enterica*] [ATCC 10708] and [*Pseudomonas aeruginosa*] [ATCC 15442]] [in 5 minutes] [in 5 min.] [in presence of organic soil (5% blood serum)] [and] [on [precleaned] hard, nonporous [environmental] [and] [healthcare] surfaces] [[Effective against][Virucidal for] [Kills] [+Human Immunodeficiency Virus Type 1] [[+HIV-1][,] [and][+Hepatitis B Virus][+HBV] [in presence of organic soil (5% blood serum)] [and] [+Human][+Hepatitis C virus] [+HCV] [in the presence of organic soil ((1% horse serum))][and][on [precleaned] hard, non-porous [environmental] [and] [healthcare] surfaces] [Effective against] [For use in [disinfecting] [and] [cleaning] [Other potentially infectious materials [(OPIM)]] [OPIM] [on hard non-porous surfaces] [Environmental Services][Renal Dialysis][Laboratories][Infection Control] [ICU/CCU][General Nursing] [Nursing][Home Healthcare] [Pediatrics] [Out Patient Care] [Surgery][Respiratory Care] [EMS] [Housekeeping] [Skilled long term care facility[ies]] [Skilled Nursing Facility] [SNF] [dental offices] [physical therapy] [physician offices][radiology][recovery room] [nursing homes] [nursing stations]

[Expiration date] [EXP] [EXP DATE] [XXXXXX]
 [Equivalent to the 1:10 dilution of [sodium hypochlorite][household bleach] following the [guidelines][of][the][CDC][,][and][OSHA][,][and][CMS] [,] [and] [SHEA-IDS] [,] [and] [APIC] [guidelines]
 [For use in [disinfecting] [cleaning] [[Blood containing body fluids]] [blood and body fluid spills] [on hard non-porous surfaces]
 [Formulated] [for] [cleaning and disinfecting] [in [just] one step][.] [Eliminates the need to preclean surfaces prior to disinfecting.]

{Administrative Note: Bracketed text [] is optional version of text for different packaging. }

{Administrative Note: The terms "towelette(s)", "towel(s)", "wipe(s)", "wiper(s)" and "cloth(s)" ~~and~~ the terms "Premoistened", "Premeasured", "Convenient", "Disposable" and "Pre-saturated", and the terms "Glucometers", "Glucose Meters", and "Blood Glucose Meter" may be used interchangeably throughout. }

[Following][Follows] the guidelines of [the] [CDC][,][and][OSHA][,][and] [CSM] [,] [and][SHEA-
IDSA] [,] [and] [APIC]

[Following][Follows] [the guidelines][regulations] of [the] [Federal] [and] [state] [guidelines]
[regulations] [for] [disinfection of][disinfecting][blood][glucose meters†][Glucometers†]

[For disinfection of][For disinfecting][Disinfects][blood][glucose meters†]

[Glucometers†][,][and][patient care equipment][,][and][point-of-care equipment][and] hard, non-
porous healthcare surfaces]

[For complete product line information, call Medtrol, Inc.]

[For maximum product performance store at room temperature or cooler]

[For one-step cleaning and disinfecting] [when][if] [[*Clostridium difficile*] [*C. difficile*] [*C. diff*][*C*
DIFF] spores][are] [likely][to be present][of concern]

[For refilling [Product Name]]

[For surfaces that may come in contact with food, a potable water rinse in required. Do not use on
glassware, utensils, or dishes.]

[For product questions, call [name and phone number]]

[For use in [cleaning and] disinfecting [fecal contamination] on[precleaned][hard, non-porous][high
touch][objects] [and][environmental] [and] [healthcare] [surfaces]

[Follows][Following] the guidelines of [the][CDC][and][APIC][for use in [cleaning and] disinfecting
[possible][fecal contamination][on] [in][precleaned] patient care areas [on][hard, non-porous][high
touch][objects][and][environmental] [and] [healthcare] [surfaces][such as] [bed rails][patient bed
controls][phone and call button][chair[s]][light switches] [room temperature control knobs][sink
tops][toilet seats][flush handles][bedside tables][drawer pull[s]][IV pole][door knobs][and][door
levers] [bathroom handrails][bed pan[s]][tray table][toilet bedpan cleaner][multi-module monitor
[controls] [touch screens][cables]][ventilator control panel][shower head and water control knobs]
[bar code readers][infusion pumps][bedside commodes][wheel chairs][privacy curtains]

[Fresh bleach scent]

[Germicidal wipes]

[Germicidal wipes] [Toallitas Germicidas]

[Germicidal] [Germicide]

[Glucometers†]

[If streaking is observed after disinfecting for the appropriate contact time, wipe with a clean, damp
cloth or paper towel.]

[In the][area] [center] [station][department][s][listed][below][here][:] [Hospitals][Doctors's
Offices][Nursing Homes][Schools] [Dental Offices] [Emergency Rooms]

[Innovative healthcare products designed with a commitment to quality and excellence]

[[Kitchen][and][bathroom][cleaner and disinfectant] [.] [For surfaces that may come in contact with
food, a potable water rinse in required. Do not use on glassware, utensils, or dishes.]

[Kills 99.99% of germs]

[Kills] [[*Clostridium difficile*][*C. difficile*][*C. diff*][*C DIFF*] spores] [in [one] [1] step in [three] [3]
[minutes] [min]

[Kills +HBV [,] [and] +HCV in 30 [seconds] [sec.]

[Kills] [is effective against] 99.9999% [[*Clostridium difficile*] [*C. difficile*] [*C. diff*] [*C DIFF*] spores]
in 3 [minutes] [min] [in one step] on hard, nonporous surfaces][Lot Number] [Lot xxxxxx]

[Made in [the] [U.S.A.] [USA]] [.]

[Manufactured for] [:]

[Manufactured] [and] [Distributed] [Sold] in the [USA] [U.S.A.] [.]

[Meets] OSHA blood borne pathogen standards][in][29 CFR 1910.1030] [and] [Guidelines of the
CDC and CMS Tag F441].

{Administrative Note: Bracketed text [] is optional version of text for different packaging.}

{Administrative Note: The terms "towelette(s)", "towel(s)", "wipe(s)", "wiper(s)" and "cloth(s)" and the terms "Premoistened", "Premeasured", "Convenient", "Disposable" and "Pre-saturated", and the terms "Glucometers", "Glucose Meters", and "Blood Glucose Meter" may be used interchangeably throughout.}

[Meets efficacy standards for hospital disinfection]

[Meets The Joint Commission and CMS requirements]

[Moist inanimate surface wipes]

[Moist [bleach] [sodium hypochlorite] wipes for hard, non-porous [healthcare] [,] [and]

[environmental] [inanimate] surfaces]

[Must be][precleaned][preclean][prior to][before][disinfecting][disinfection][of] hard, non-porous

[environmental][and][healthcare][surfaces] for [+Human][+Hepatitis C Virus][+HCV]

[No mixing] [No measuring]

[No need to pre-clean]

[Not a skin wipe][.] (pictogram)

[Not a baby wipe][.] (pictogram)

[Now kills] {Note to reviewer: to be used with new efficacy claim – limited to 6 months of marketing.}

[Now effective against] {Note to reviewer: to be used with new efficacy claim – limited to 6 months of marketing.}

[One step [cleaner disinfectant] [disinfectant cleaner]

[One-step] [cleaner] [and] [,] [disinfectant] [against] [[Clostridium difficile] [C. difficile] [C. diff][C DIFF] spores] [ATCC 63598]]

[One step cleaning disinfectant that kills [Clostridium difficile] [C. difficile] [C. diff][C DIFF]

spores] [ATCC 63598]], [MRSA], [VRE], [Staphylococcus aureus], [Salmonella enterica],

[Pseudomonas aeruginosa], [Trichophyton mentagrophytes],[+HIV-1 and +HBV]. Preclean prior to disinfecting surfaces for +HCV.

[Packaged] [Packed] for [XXXXXXXX]

[Preclean prior to disinfecting surfaces for +HCV.]

[[Product name][this product] [is a] [are] [for use on hard non-porous [environmental] surfaces in]

[hotels][[kitchen][s] [and][bathroom[s]]][hospitality industry][pharmaceutical exhaust

hoods][biological safety [cabinets][hoods]][janitorial surfaces]

[computer[screen][and]keyboards][electronic digital equipment][telemetry][veterinary

medicine][aviation][law enforcement][clean rooms][ISO9000 environments][extended care

facilities][rehabilitation facilities][cafeterias][restaurants][emergency medical

services][offices][[dental][and][medical][and][clinical][and][hospital] laboratory[ies][lab[s]]

[[Product name][this product] [is a] [are] premoistened disposable towels for use on hard, non-porous

[healthcare][and][environmental] surfaces where control of cross contamination is required]

[[Product Name][These][The][towels] are saturated with [the] a solution [equivalent to] [a] [of]

[prediluted] 1:10 [dilution of] [sodium hypochlorite] [bleach]] [household bleach (sodium

hypochlorite)]

[Product Name] [These wipes] [Meets efficacy standards for hospital disinfection]

[Product Name] [These wipes] [is a] [are] [Bleach disinfectant[s]] [at a] [1:10 dilution] [for] [hospital use]

[Product name[s]][can be used to][help[s]][comply[ies] with] [meet[s]][the] [CDC guidelines] [and]

[OSHA [blood borne pathogen standards in] [rule] [29 CFR 1910.1030] [to disinfect] [for]

[disinfection of] [disinfecting] [blood] [glucose meters†] [Glucometers†]]

[Product name[s]][can be used to][help[s]][comply[ies]with][meet[s]][the][CMS Tag F441

guidelines] [CMS guidelines for Tag F441] [42 CFR 483.65][for] [rigorous cleaning the environment

to remove [[Clostridium difficile][C.] difficile] [C. diff] [C DIFF] spores][,][and can help prevent transmission of the organism]

[Product name[s]][can be used to][help[s]] [comply[ies] with] [meet[s]][the] CMS guidelines for Tag

F441 [42 CFR 483.65] [for] [disinfection of] [disinfecting] [blood] [glucose meters†] [Glucometers†]]

{Administrative Note: Bracketed text [] is optional version of text for different packaging.}

{Administrative Note: The terms "towelette(s)", "towel(s)", "wipe(s)", "wiper(s)" and "cloth(s)" ~~and~~ the terms "Premoistened", "Premeasured", "Convenient", "Disposable" and "Pre-saturated", and the terms "Glucometers", "Glucose Meters", and "Blood Glucose Meter" may be used interchangeably throughout.}

[Product name(s)] meets [CDC] [and] [,] [OSHA] [and] [,] [CMS] guidelines for [disinfection of] [disinfecting][blood][glucose meters†] [Glucometers†]

[Product name] [this product] can be used to clean and disinfect in one step [;] [,] see directions for use [on this label] for cleaning and disinfecting in one step

[Product name(s)] [can be used to] [help(s)] [comply(lies) with] [meet(s)] [the [CDC] [,] [and] [OSHA] [and] [CMS] [guidelines for] [disinfection of] [disinfecting][blood][glucose meters†] [Glucometers†]

[Protect from freezing]

[Presaturated] [towel] [towelette] [wipe]

[Pre-moistened towels with 1:10 dilution of bleach [(0.65%)]

[Ready to Use] [hospital [use] [grade] disinfectant]

[Ready to use] [EPA registered hospital disinfectant]

[Ready to use] [EPA registered hospital [use] [grade] [disinfectant] [bleach wipes]

[Refills for [Product Name]

[Rotate dated product(s] while in inventory]

[Shield from direct sunlight]

[Shelf-stable formula]

[Saturated with a solution that] [Contains 6500 [parts per million] [ppm] [0.65%] [of active] sodium hypochlorite] [NaOCl][bleach]

[See [side] [back][panel(s] [on reverse] [on outer box] for [First Aid][,][and][Directions for Use][,][and][Special instructions for cleaning and decontamination against +HIV-1, +HBV and +HCV][,] [and] [Precautionary Statements][and][Storage and Disposal].

[Single Use Only]

[Suitable for hospital use]

[Suitable for use on hard, nonporpous [inanimate environmental] [and] [healthcare] surfaces]

[Sodium hypochlorite] [0.65%] [active] [sodium hypochlorite] [NaOCl][bleach]

[Sodium hypochlorite] [NaOCl] [bleach] [household bleach]

[Sold by] [:]

[Sporicidal] [Sporicide]

[Sporicidal wipes]

[Sporicidal] [Bactericidal] [Fungicidal] [Virucidal]

[Store at room temperature or cooler for maximum product performance]

[Store [Product Name] [these] [bleach] wipes in sealed packets] [when not in use]

[Store [Product Name] [these] [bleach] wipes in tightly closed canister] [when not in use]

[Store [this] [these] [Product Name] [product(s)] in a cool, dry, and well-ventilated area away from [heat] [,] [and] [open flame] [,] [and] [direct sunlight] [and] [inaccessible to children]

[Suggested areas of usage][on][hard, non-porous][high touch] [objects] [and] [environmental] [and] [healthcare] [surfaces][in patient care areas][such as] [bed rails][patient bed controls][phone and call button][chair(s)][light switches] [room temperature control knobs][sink tops][toilet seats][flush handles] [bedside tables] [drawer pull(s)][IV pole][door knobs][and][door levers][bathroom handrails][bed pan(s)] [tray table][toilet bedpan cleaner][multi-module monitor [controls][touch screens][cables][ventilator control panel][shower head and water control knobs] [bar code readers], [infusion pumps] [bedside commodes] [wheel chairs][privacy curtains][PCV tubing][diagnostic equipment][stretchers][ambulance equipment] [patient monitoring equipment][trash cans][plastic mattress covers][computer keyboards] [instrument stands]

[Test wipe on small inconspicuous area.]

[The [Product Name] [bleach] wipes were specifically [designed] [created] to disinfect [blood] [glucose meters†] [Glucometers†] and [point of care] [bedside] [equipment] [and] [patient care

{Administrative Note: Bracketed text [] is optional version of text for different packaging.}
{Administrative Note: The terms "towelette(s)", "towel(s)", "wipe(s)", "wiper(s)" and "cloth(s)" and the terms "Premoistened", "Premeasured", "Convenient", "Disposable" and "Pre-saturated", and the terms "Glucometers", "Glucose Meters", and "Blood Glucose Meter" may be used interchangeably throughout.}

equipment] [to meet] [to comply with] [the equipment manufacturers maintenance [requirements] [protocols] [procedures].

EPA registered [product] [product name] [with a] [*Clostridium difficile*][*C. difficile*] [*C. diff*] [*C DIFF*] spore kill claim with [a][one step] 3 minute contact time. This product may not yet be available in all 50 states [and Puerto Rico]

EPA registered [product] [product name] [with a] [[+Human][+Hepatitis C Virus][+HCV] kill claim with 30 second contact time. This product may not yet be available in all 50 states [and Puerto Rico] [This Product] [Product name] [kills [+HBV] [and] +HCV] in 30 secs.].

[This product][Product name] [can be used][as a] [is a] [A] [One Step Cleaner [and] [,] [Deodorizer] [and] Disinfectant [effective against] [that kills]: [*Clostridium difficile*] [*C. difficile*] [*C. diff*][*C DIFF*] spores] [,] [*Pseudomonas aeruginosa*] [,] [*Staphylococcus aureus*] [,] [*Salmonella enterica*] [,][*Staphylococcus aureus*-MRSA(MRSA)], [[Methicillin Resistant *Staphylococcus aureus* (MRSA)], [*Staphylococcus aureus* (MRSA)], [MRSA]] [,] [[*Enterococcus faecalis*-VRE [(VRE)], [[Vancomycin Resistant *Enterococcus faecalis* [(VRE)], [*Enterococcus faecalis* (VRE)], [VRE] [,] [+ Hepatitis B Virus] [+HBV] [+Human Immunodeficiency Virus Type 1] [+HIV-1] [,] [and] [*Trichophyton mentagrophytes*] [in the presence of organic soil [5% blood serum]] [and]] [on [precleaned] hard, non-porous [environmental] [and] [healthcare] surfaces]

[This product][Product name] [can be used][as a] [is a] [A Cleaner [and] [,] [Deodorizer] [and] Disinfectant [effective against] [that kills]: [*Clostridium difficile*] [*C. difficile*] [*C. diff*][*C DIFF*] spores] [,] [*Pseudomonas aeruginosa*] [,] [*Staphylococcus aureus*] [,] [*Salmonella enterica*] [,][*Staphylococcus aureus*-MRSA(MRSA)], [[Methicillin Resistant *Staphylococcus aureus* (MRSA)], [*Staphylococcus aureus* (MRSA)], [MRSA]] [,] [[*Enterococcus faecalis*-VRE [(VRE)], [[Vancomycin Resistant *Enterococcus faecalis* [(VRE)], [*Enterococcus faecalis* (VRE)], [VRE] [,] [+ Hepatitis B Virus] [+HBV][,] [+Human][+Hepatitis C Virus] [+HCV] [,] [+Human Immunodeficiency Virus Type 1] [+HIV-1] [,] [and] [*Trichophyton mentagrophytes*] [in the presence of organic soil [5% blood serum]] [and]] [on [precleaned] hard, non-porous [environmental][and][healthcare] surfaces]

[This product][Product name] [can be used][as a] [is a] [A [One Step] Cleaner[,] [Deodorizer] [and] Disinfectant [effective against] [that kills]: [*Clostridium difficile*] [*C. difficile*] [*C. diff*][*C DIFF*] spores] [in the presence of organic soil [5% blood serum]] [and]] [on hard, non-porous [environmental][and][healthcare] surfaces]

[This] [These] [Products[s]] [Product Name] [is] [a] [are] [Germicidal [bleach] wipe[s]]
[This] [These] [Products[s]] [Product Name] [is] [a] [are] [Germicidal] [Germicide] [bleach] [wipe[s]]

[This] [These] [Products[s]] [Product Name] [is] [a] [are] [stabilized] [bleach] [wipe[s]]
[This] [These] [Products[s]] [Product Name] [is] [an] [are] [Antiviral] [bleach] [wipe[s]]
[This] [These] [Products[s]] [Product Name] [is] [an] [are] [Antimicrobial] [bleach] [wipe[s]]
[This] [These] [Products[s]] [Product Name] [is] [an] [are] [Antifungal] [bleach] [wipe[s]]
[This] [These] [Products[s]] [Product Name] [is] [an] [are] [sporicidal] [bleach][wipe[s]]

[This] [These] [Product Name] [wipe[s]] [is] [are] [contain] [a] [saturated] [with] [a] [Solution of] [a] [1:10 [dilution of] [activated] [bleach] [sodium hypochlorite]]

[This] [These] [Product Name] [surface] [wipe[s]] [is] [are] [highly absorbent] [and] [tear-resistant]
[This] [These] [Product Name] [is a] [are] [Bleach [sodium hypochlorite][disinfectant] [disinfecting] wipe[s]]].

[This] [These] [Product Name] [is a] [are] [Ready to Use] [EPA registered] [hospital grade disinfectant] [bleach] [wipes]

[This][These][Product[s]][Product name[s]] [is][are][saturated with a solution][of][that contains] [6500 ppm] [0.65%] [of] [active] [sodium hypochlorite][available chlorine]

{Administrative Note: Bracketed text [] is optional version of text for different packaging.}

{Administrative Note: The terms "towelette(s)", "towel(s)", "wipe(s)", "wiper(s)" and "cloth(s)", and the terms "Premoistened", "Pre-measured", "Convenient", "Disposable" and "Pre-saturated", and the terms "Glucometers", "Glucose Meters", and "Blood Glucose Meter" may be used interchangeably throughout.}

[This][These] [Product[s]] [Product name[s]] [meet OSHA bloodborne pathogen standards in CFR 1910.1030 [and guidelines of [the] [CDC] [and] [CMS Tag F441]] [to disinfect][for][disinfection of][disinfecting][blood] [glucose meters†][Glucometers†].

[This][These] [Product[s]] [Product name] [is a] [one-step] [cleaner] [,] [and][deodorizer][and] [disinfectant that kills *Clostridium difficile* spores, MRSA, VRE, *Staphylococcus aureus*, *Salmonella enterica*, *Pseudomonas aeruginosa*, *Trichophyton mentagrophytes*, +HIV-1 and +HBV.] [Preclean prior to disinfecting surfaces for +HCV.]

[This] [These] [Product Name] [is] [a] [are] [for] [Can be used] [to] [for] [used to] [as a] [clean[s]] [cleaning] [cleaner] [,] [and] [deodorize[s]] [deodorizing] [deodorizer] [,] [and] [to] [decontaminate[s]] [decontaminating] [and disinfect[s]] [disinfecting] [disinfectant]

[This] [These] [Product Name] [is] [are] included on EPA's [List C: EPA's Registered Antimicrobial Products Effective Against Human HIV-1 Virus] [,] [,] [http://www.epa.gov/oppad001/list_c_hiv.pdf] [.]

[This] [These] [Product Name] [is] [are] included on EPA's [List D: EPA's Registered Antimicrobial Products Effective Against Human HIV-1 and Hepatitis B Virus] [,] [,] [http://www.epa.gov/oppad001/list_d_hepatitisbhiv.pdf] [.]

[This] [These] [Product Name] [is] [are] included on EPA's [List F: EPA's Registered Antimicrobial Products Effective against Hepatitis C Virus] [,] [,] [http://www.epa.gov/oppad001/list_f_hepatitisC.pdf]

[This] [These] [Product Name] [is] [are] included on EPA's [List H: EPA's Registered Antimicrobial Products Effective Against Methicillin Resistant *Staphylococcus aureus* (MRSA) and Vancomycin Resistant *Enterococcus faecalis* or *faecium* (VRE)] [,] [,] [http://www.epa.gov/oppad001/list_h_mrsa_vre.pdf] [.]

[This] [These] [Product Name] [is] [are] included on EPA's [List K: EPA's Registered Antimicrobial Products Effective against *Clostridium difficile* spores] [,] [,] [http://www.epa.gov/oppad001/list_k_cdif_spores.pdf] [.]

[This product] [Product name] [is a cleaner disinfectant] [is] [Effective against] [that] [kills] [Blood borne pathogen[s]] [(BBP)] [BBP] [+HIV-1, +HBV and +HCV] [.]

[This product] [Product name] [is a] [cleaner disinfectant] [disinfectant cleaner] [can be used for cleaning and disinfecting] [Effective against] [that kills] [For use in [disinfecting] [cleaning] [blood borne pathogens [(BBP)] [BBP] [+HIV-1, +HBV and +HCV [on hard non-porous surfaces]

[This product][Product name][is a][are][one-step] [*Clostridium difficile* [*C. difficile*] [*C. diff*] [*C DIFF*] spores] [cleaner disinfectant][cleaning disinfectant][disinfecting cleaner]

[This product][Product name][can be used to][clean[s] and disinfect[s]][hard, non-porous][medical equipment surfaces]

[[This product][Product name] contains [towels saturated with] the power of Medtrol[']s] [bleach][sodium hypochlorite] solution]

[This product][is][are][a] [one step cleaner and disinfectant][one step cleaning and disinfecting] [sporicide][that][is] [sporicidal] [bleach wipes][that] [and][can be used to][help[s]][comply[lies]] [with] [meet[s]] the [CDC][and][CMS Tag F441][and][SHEA-IDSA][and][APIC][and][Joint Commission] [guidelines] [standards] [requirements] [recommendations] [for][killing] [*Clostridium difficile*][*C. difficile*][*C DIFF*] spores]

[This product][is][a] [are][one step cleaner and disinfectant] [one step cleaning and disinfecting] [sporicide] [that is] [sporicidal][bleach wipes][that][and][can be used to][help[s]][comply[lies]] [with][meet[s]] the [CDC][and][CMS Tag F441] [and][SHEA-IDSA][and][APIC][guidelines] [standards] [requirements] [recommendations] [for][killing] [*Clostridium difficile*][*C. difficile*][*C. diff*] [*C DIFF*] spores]

[This Product][Product name] [cleans, deodorizes and disinfects in [1][one]step]

{Administrative Note: Bracketed text [] is optional version of text for different packaging.}
{Administrative Note: The terms "towelette(s)", "towel(s)", "wipe(s)", "wiper(s)" and "cloth(s)", ~~and the terms "Premoistened", "Premeasured", "Convenient", "Disposable" and "Pre-saturated", and the terms "Glucometers", "Glucose Meters", and "Blood Glucose Meter"~~ may be used interchangeably throughout.}

[This Product [Product name] [kills [[*Clostridium difficile*][*C. difficile*][*C. diff*][C DIFF] spores in [1] [one] step [in 3][three][minutes][mins.]
[These wipes contain 0.65% sodium hypochlorite [bleach]]
[These] [large] [Product Name] [wipes] [can be used to] [help[s]] [to] [comply with] [make compliance with] [infection control procedures] [easier and more effective]
[To clean [,] [and] disinfect [and] deodorize in one step: Wipe surface with towel until completely wet. Let stand for five minutes at room temperature. Wipe dry or allow to air dry. [Gross soil must be removed prior to disinfecting.] Gloves should be worn.]
[Use[d]]
[Use wipes to kill [*Salmonella enterica* [Salmonella]] [and] [*Staphylococcus aureus* [Staph]] on bathroom hard, non-porous surfaces]
[Use[d] to disinfect hard, non-porous surfaces in hospitals, doctor's offices, nursing homes, schools and dental offices]
[[Use to] [Effectively] [clean[s] and] disinfect[s] common hard, non-porous surfaces]
[Use][This product][product name][as][is][a][can be used][as a][for][one-step cleaner and disinfectant][one-step cleaning and disinfecting] [effective against] [that kills] [in the presence of] [[*Clostridium difficile* [*C. difficile*][*C. diff*][C DIFF] spores][.]
[Use][This product][can be used] [for][For use][is] [in][as][a][one-step] [cleaner and disinfectant] [cleaning and disinfecting][in one step] [disinfectant][disinfecting][of][fecal contamination][of][on][hard, non-porous][high touch][objects][and][environmental] [and] [healthcare][surfaces][when][if] [[*Clostridium difficile* [*C. difficile*] [*C. diff*][C DIFF] spores] [are] [likely][to be present][of concern]
[Use][This product][can be used] [for][For use][is] [in][as][a][one-step] [cleaner and disinfectant][cleaning and disinfecting][in one step] [disinfectant][disinfecting][of][fecal contamination][of][on][hard, non-porous][high touch][objects][and][environmental] [and] [healthcare] [surfaces]
[Use][This product][can be used] [for][For use [in][as][a] [in one step] [disinfectant] [disinfection] [disinfecting][for][of][fecal contamination][of][on][precleaned][hard, non-porous][high touch][objects] [and][environmental] [and] [healthcare] [surfaces] [when][if] [[*Clostridium difficile*][*C. difficile*] [*C. diff*] [C DIFF] spores][are] [likely][to be present][of concern]
[Use][This product][can be used] [for][For use [in][as][a] [disinfectant] [disinfection] [disinfecting] [for] [of][fecal contamination][of][on][precleaned][hard, non-porous][high touch] [objects] [and] [environmental] [and] [healthcare] [surfaces]
[Yields][[0.65%][6500 ppm] available chlorine [0.65%][6500 ppm]
[Where control of the hazards of cross contamination between treated surfaces is of prime importance]

The following pictograms are for optional inclusion to the Super-Chlor product label:

Not a baby wipe pictogram (below)

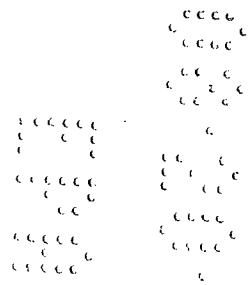

{Administrative Note: Bracketed text [] is optional version of text for different packaging.}

{Administrative Note: The terms "towelette(s)", "towel(s)", "wipe(s)", "wiper(s)" and "cloth(s)" and the terms "Premoistened", "Premeasured", "Convenient", "Disposable" and "Pre-saturated", and the terms "Glucometers", "Glucose Meters", and "Blood Glucose Meter" may be used interchangeably throughout.}



"To maintain product shelf life KEEP LID CLOSED after each use" pictogram (below)

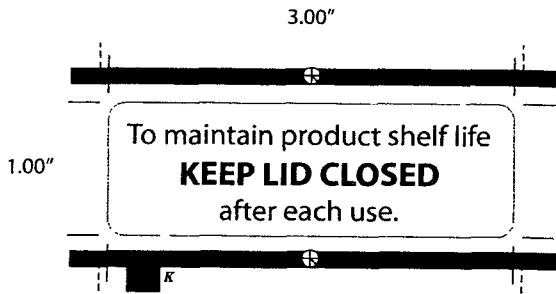

Ship and store this end up pictogram (Below)

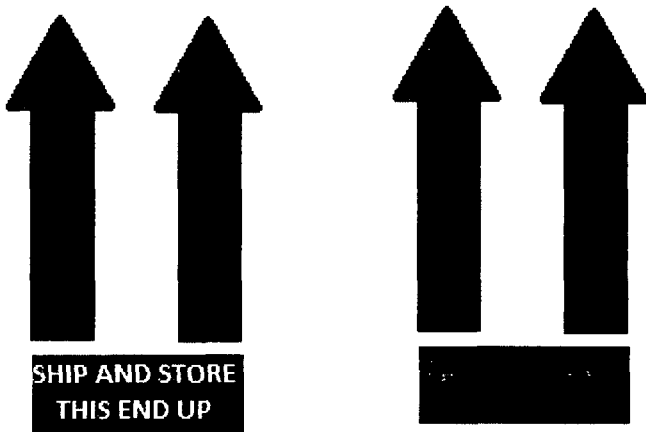

5-Minute Kill Time Clock pictogram (below)

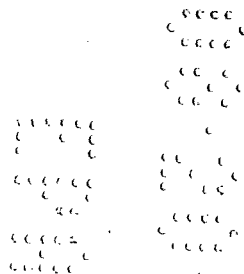

{Administrative Note: Bracketed text [] is optional version of text for different packaging.}

{Administrative Note: The terms "towelette(s)", "towel(s)", "wipe(s)", "wiper(s)" and "cloth(s)", and the terms "Premoistened", "Premeasured", "Convenient", "Disposable" and "Pre-saturated", and the terms "Glucometers", "Glucose Meters", and "Blood Glucose Meter" may be used interchangeably throughout.}



Made in the USA



Not for use on skin logo

