

67702 36

12/12/2012

1/8



U.S. ENVIRONMENTAL PROTECTION AGENCY

Office of Pesticide Programs  
Registration Division (7504P)  
1200 Pennsylvania Ave. N.W.  
Washington D.C. 20460 0001

EPA Reg. Number

67702-36

Date of Issuance

DEC 12 2012

NOTICE OF PESTICIDE

Registration  
 Reregistration  
(under FIFRA as amended)

Term of Issuance

Unconditional

Name of Pesticide Product

PYROL-O

Name and Address of Registrant (include ZIP Code)

W Neudorff GmbH KG  
Postfach 1209, An der Muhle 3  
D-31860 Emmerthal, Germany  
011-49-5155-624-100

Note: Changes in labeling differing in substance from that accepted in connection with this registration must be submitted to and accepted by the Registration Division prior to use of the label in commerce. In any correspondence on this product always refer to the above EPA registration number.

On the basis of information furnished by the registrant the above named pesticide is hereby registered/reregistered under the Federal Insecticide Fungicide and Rodenticide Act

Registration is in no way to be construed as an endorsement or recommendation of this product by the Agency. In order to protect health and the environment the Administrator on his motion may at any time suspend or cancel the registration of a pesticide in accordance with the Act. The acceptance of any name in connection with the registration of a product under this Act is not to be construed as giving the registrant a right to exclusive use of the name or to its use if it has been covered by others.

This product is unconditionally registered in accordance with section 3(c)(5) of FIFRA provided that you

1. Submit and/or cite all data required for registration of your product under section 3(c)(5) of FIFRA when the Agency requires all registrants of similar products to submit such data and submit acceptable responses required for reregistration of your product under section 4 of FIFRA.

(continued on page 2)

Signature of Approving Official

Refer to Page #2

Richard J Gebken Product Manager (10)  
Insecticide Branch, Registration Division (7504P)

Date

DEC 12 2012

- 2 Make the following change(s) to the subject label
  - a Change the product registration number to EPA Reg No 67702-36
  - b Make the following label revisions

General Comment

1 Delete all text throughout the proposed label marked with ~~struckthrough~~

National Organic Program (NOP) Labeling Review comment(s)

- 2 Based upon completion of the NOP labeling reviews for this product including a review of the accepted basic CSF all alternate CSFs and the subject label, the proposed NOP language For Use in Organic Production For Organic Production For Use in Organic Gardening and OMRI Listed is acceptable for this product
- 3 You must submit two (2) copies of the revised final printed labeling incorporating the above changes before releasing the product for shipment if these conditions are not complied with the registration will be subject to cancellation in accordance with section 6(e) of FIFRA Your release for shipment of the product bearing amended labeling constitutes accepting of these conditions

Should W Neudorff GmbH KG wish to add/retain a reference to the company's website on your label please be aware that the website becomes labeling under FIFRA and is subject to review by the Agency If the website is false or misleading, the product would be misbranded and unlawful to sell or distribute under section 12(a)(1)(E) of FIFRA 40 CFR §156.10(a)(5) lists examples of statements EPA may consider false or misleading In addition regardless of whether a website is referenced on your product's label, claims made on the website may not be substantially differ from those claims approved through the registration process Therefore should the Agency find or if it is brought to our attention that a website contains false or misleading statements or claims substantially differing from the EPA approved registration the website will be referred to EPA's Office of Enforcement and Compliance Assurance (OECA) As an alternative W Neudorff GmbH KG may refer consumers to the company's phone number or e-mail address

Copies of your label stamped Accepted with Comments as well as the acute toxicology product chemistry NOP and efficacy reviews completed for this product are enclosed for your records If you have any questions about this label review please contact Mr Carmen J Rodia Jr at (703) 306-0327 or via e-mail at [Rodia.Carmen@epa.gov](mailto:Rodia.Carmen@epa.gov)

Sincerely yours

*For*  
= 

Richard J Gebken  
Product Manager (10)  
Insecticide Branch  
Registration Division (7504P)

- Enclosures*
- Label Stamped Accepted with Comments dated December 12 2012*
  - Acute Toxicity Review dated May 29 2012*
  - Product Chemistry Review #1 dated May 29 2012*
  - Product Chemistry Review #2 dated December 5 2012*
  - NOP Labeling Review #1 dated April 25 2012*
  - NOP Labeling Review #2 dated December 6 2012*
  - Efficacy Review dated June 25 2012*

067702 00036 D459100

ACCEPTED  
With COMMENTS  
In EPA Letter Dated  
*December 12, 2012*  
Under the Federal Insecticide, Fungicide  
and Rodenticide Act, As amended, for the  
pesticide Registered under EPA Reg No:  
67702-35

# PYROL-O

Active Ingredients	By weight
Pyrethrins	0 50%
Canola Oil	89 00%
Other Ingredients	<u>10 50%</u>
Total	100 00%

[The registrant may use one of these statements, either

This product contains 6 837 lbs of canola oil and 0 038 lbs of pyrethrins per gallon

OR

This product contains 0 854 lbs of canola oil and 0 005 lbs of pyrethrins per pint

OR

This product contains 1 708 lbs of canola oil and 0 01 lbs of pyrethrins per quart ]

**KEEP OUT OF REACH OF CHILDREN**

## CAUTION

NET CONTENTS 16 fl oz , 24 fl oz , 32 fl oz , 1 gallon (128 fl oz ) , 200 gallons and  
211 gallons (800 liters)

EPA Reg No 67702-

EPA Establishment No

FIRST AID	
IF ON SKIN OR CLOTHING	<ul style="list-style-type: none"> <li>• Take off contaminated clothing</li> <li>• Rinse skin immediately with plenty of water for 15-20 minutes</li> <li>• Call a poison control center or doctor for treatment advice</li> </ul>
<p>Have the product container or label with you when calling a poison control center or doctor or going for treatment. For additional information on this pesticide product (including health concerns, medical emergencies, or pesticide concern) you may call 1-xxx-xxx-xxxx 24 hours per day 7 days per week [insert the days and hours of operation if this number is less than 7 days a week 24 hours a day and the following sentence: After [insert time after which number may not be called] call your poison control center at 1-800-222-1222 ]</p>	

### PRECAUTIONARY STATEMENTS

**Hazards to Humans and Domestic Animals CAUTION** Avoid contact with skin or clothing. Prolonged or frequently repeated skin contact may cause allergic reactions in some individuals. Wash hands thoroughly with soap and water after handling and before eating, drinking, chewing gum, using tobacco, or using the toilet.

**User Safety Recommendations**

- Users should wash hands with plenty of soap and water before eating drinking chewing gum using tobacco or using the toilet
- Users should remove clothing immediately if pesticide gets inside then wash thoroughly and put on clean clothing

**Environmental Hazards** This product is toxic to aquatic organisms including fish and invertebrates To protect the environment do not allow the pesticide to enter or run-off into storm drains drainage ditches gutters or surface waters Applying this product in calm weather when rain is not predicted for the next 24 hours will help to ensure that wind or rain does not blow or wash pesticide off the treatment area Rinsing application equipment over the treated area will help avoid run-off to water bodies or drainage systems

This product is highly toxic to bees exposed to direct treatment on blooming crops or weeds Do not apply this product or allow it to drift to blooming crops or weeds while bees are actively visiting the treatment area

**DIRECTIONS FOR USE**

It is a violation of Federal law to use this product in a manner inconsistent with its labeling Read entire label before use Use only as directed Shake well before each use

**Use Restrictions**

- Do not make any applications during rain
- Do not water the treated area to the point of run-off
- Do not wet plants to point of runoff or drip
- Do not allow adults children or pets to enter the treated area until sprays have dried
- Do not apply this product in a way that will contact adults children or pets either directly or through drift
- Remove pets birds and cover fish aquariums before spraying
- Do not apply within 21 days of a sulfur application
- Do not use PYROL O spray when temperatures are above 90°F
- Do not apply directly into sewers or drains or to any area like a gutter where drainage to storm sewers water bodies or aquatic habitat can occur Do not allow the product to enter any drain during application
- Remove or cover exposed food and drinking water before application Remove or cover dishes utensils food processing equipment and food preparation surfaces or wash them before use
- Other than applications to building foundations all applications to impervious surfaces such as sidewalks driveways patios porches and structural surfaces (such as windows doors and eaves) are limited to spot and crack-and-crevice applications only
- Do not apply more than 10 times per season
- Do not reapply within 3 days except under extreme pest pressure
- In case of extreme pest pressure do not reapply within 24 hours
- Not for use in outdoor residential misting systems

**Phytotoxicity Note** Oil removes the glaucous (blue) bloom from such evergreens as Colorado blue spruce and Koster spruce Use a 1% solution on oil sensitive plants such as Chamaecyparis Cryptomeria Japanese Holly Red Cedar and Smoke Tree Use care on blooms and buds Test spray a portion of the plant and wait several days to determine if burn occurs before spraying larger areas Some plants are sensitive to this product If in doubt test-spray a small portion of the plant and wait several days to determine if burn occurs before spraying larger areas

**APPLICATION DIRECTIONS**

[The registrant may use one of these application directions either

For a 1% solution mix 2 teaspoons of concentrate with 1 quart (32 fl oz) water or 1 fl oz concentrate with 3 quarts (96 fl oz ) water For a 2% solution mix 4 teaspoons of concentrate with 1 quart (32 fl oz)

water or 2 fl oz concentrate with 3 quarts (96 fl oz) water. Shake well before each use and stir or shake diluted spray frequently during use.

Apply at a rate of 1% or 2% solution. For soft-bodied pests such as aphids and mites, a 1% solution is sufficient. Using hand-held trigger sprayers, hand sprayers, or backpack sprayers, thoroughly spray insect pests with diluted product until all parts of plants are wet. Do not wet plants to point of runoff or drip. Repeat treatment in 1-2 weeks if needed. May be used on edible fruits and vegetables up to and including day of harvest.

OR

Using the following (hose end sprayer) (applicator) instructions, thoroughly spray insect pests with diluted product until plants are wet. Do not wet plants to point of runoff or drip. Repeat treatment in 1-2 weeks if needed. May be used on edible fruits and vegetables up to and including day of harvest.

- 1 Attach garden hose to spray nozzle. Turn on water supply.
- 2 Bend safety tab down and turn control to water.
- 3 Point nozzle toward plants and turn water control knob to On. Product will automatically mix with water. Spray upper and lower leaf surfaces thoroughly.

To Stop Spraying

- 1 When you are finished spraying or if you have to stop spraying at any time, turn the blue knob back to the OFF position.
- 2 Turn off the water from the faucet.
- 3 Turn the blue knob to H<sub>2</sub>O then OFF to drain the water from the hose.
- 4 Unscrew spray nozzle from hose. Remove hose end from container.

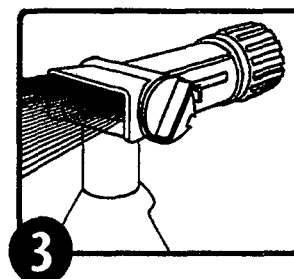
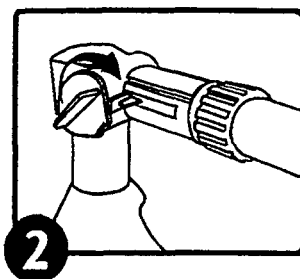
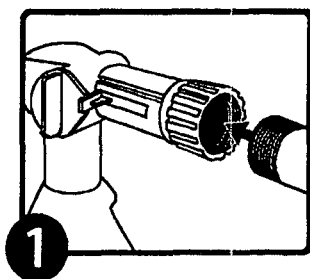

1

#### PESTS/SITES

PYROL-O will kill the following insect pests: aphids, beetles (Colorado potato beetle, flea beetle, Japanese beetle, asparagus beetle), caterpillars (gypsy moth, caterpillars, tent caterpillars, diamondback moth larvae, leafrollers), ants (except Fire Ants, Harvester Ants, Carpenter Ants, and Pharaoh Ants), mealybugs, mites, leafhoppers, scale insects, whitefly, adelgids, plant bugs, fungus gnats, thrips, sawfly larvae, psyllids, spittlebugs, and phylloxera.

**VEGETABLES AND HERBS** Use as directed above on vegetables and herbs such as asparagus, beans, broccoli, Brussels sprouts, cabbage, cauliflower, kale, oriental vegetables, herbs, lettuce, eggplant, peppers, tomatoes, potatoes, cucumbers, melons, and squash. Do not apply more than 4 fl oz of concentrate (400 fl oz of 1% solution or 200 fl oz of 2% solution) per 1000 square feet.

**FRUITS AND NUTS** Use as directed above on fruits and nuts such as apples, avocados, citrus (grapefruit, lemons, oranges, tangerines, limes), peaches, nectarines, apricots, pears, almonds, pecans, walnuts, kiwi fruit, blackberries, loganberries, raspberries, strawberries, and grapes. Do not apply more than 4 fl oz of concentrate (400 fl oz of 1% solution or 200 fl oz of 2% solution) per 1000 square feet.

**ORNAMENTAL TREES AND SHRUBS** Use as directed above on ornamental trees and shrubs such as azaleas birch camellias dogwood holly rhododendrons evergreens and shade trees Do not apply more than 4 fl oz of concentrate (400 fl oz of 1% solution or 200 fl oz of 2% solution) per 1000 square feet See PHYTOTOXICITY section for additional use restrictions

**FLOWERS** Use as directed above on flowers such as asters carnations chrysanthemums geraniums margolds petunias and roses Do not apply more than 4 fl oz of concentrate (400 fl oz of 1% solution or 200 fl oz of 2% solution) per 1000 square feet

**GREENHOUSE USE** For use in home greenhouses on flowering and foliage plants vegetables and fruits Do not apply more than 4 fl oz of concentrate (400 fl oz of 1% solution or 200 fl oz of 2% solution) per 1000 square feet

**DORMANT USE** Kills egg stages of pests present in dormant season and scale insects mites and mealybugs on dormant shrubs (e.g. roses) evergreens fruit trees and shade trees Apply a 2% solution Thoroughly wet the dormant plants or trees Do not apply more than 4 fl oz of concentrate (400 fl oz of 1% solution or 200 fl oz of 2% solution) per 1000 square feet

**HOUSEPLANTS** Do not apply more than 4 fl oz of concentrate (400 fl oz of 1% solution or 200 fl oz of 2% solution) per 1000 square feet

**STORAGE AND DISPOSAL**

Do not contaminate water food or feed by storage or disposal

**PESTICIDE STORAGE** Keep this product in its tightly closed original container when not in use Store in a cool dry (preferable locked) area that is inaccessible to children and animals

**PESTICIDE DISPOSAL** Wastes resulting from the use of this product may be disposed of on site or at an approved waste disposal facility

**CONTAINER HANDLING & DISPOSAL** Nonrefillable container Do not reuse or refill this container

**If empty** Place in trash or offer for recycling if available

**If partly filled** Call your local solid waste agency for disposal instructions Never place any unused product down and indoor or outdoor drain

**BATCH CODE**

[The registrant may use one of these optional statements

**NOTICE TO BUYER**

Seller warrants that this product conforms to the chemical description on this label and is reasonably fit for purposes stated in the Directions for Use subject to the inherent risks described above when used in accordance with Directions for Use under normal conditions To the extent consistent with applicable law this warranty does not extend to use of this product contrary to label directions or under abnormal use conditions or under conditions not reasonably foreseeable to Seller To the extent consistent with applicable law the Seller shall not be liable for any such use To the extent consistent with applicable law the Seller makes no other warranties either expressed or implied

OR

Satisfaction guaranteed

OR

Unconditionally guaranteed

OR

Money back guarantee]

[Marketing claims and product information that may or may not be presented on the container or label

- Dormant and growing season insect spray to kill adelgids aphids armored scale beetle larvae cankerworms caterpillars fungus gnats lace bugs leafhoppers leafminers leafrollers mealybugs mites plant bugs psyllids scale insects spider mites thrips webworms and whiteflies
- Patent #5 700 473
- Kills all accessible stages of listed insects including eggs
- Contact insecticide ovicide
- Easy to use
- Insecticide/miticide
- Kills insects on contact
- Kills insects including beetles caterpillars and aphids
- Kills aphids beetles (Colorado potato beetle flea beetle Japanese beetle asparagus beetle) caterpillars (gypsy moth caterpillars tent caterpillar diamondback moth larvae leafrollers) ants (except Fire Ants Harvester Ants Carpenter Ants and Pharaoh Ants) mealybugs mites leafhoppers scale insects whitefly adelgids plant bugs fungus gnats thrips sawfly larvae psyllids spittlebugs and phylloxera
- For use on vegetables fruits ornamentals shrubs trees and houseplants
- Use on flowers shrubs fruits and vegetables
- Kills Japanese Beetles (on contact)
- Effective on listed soft and hard bodied insects
- Dual action
- Dual killing action
- Broad spectrum (insecticide)
- Kills all stages of insect growth - egg to adult
- Kills (insect) eggs larvae and adults
- Kills insects - eggs to adults
- PYROL-O is a contact killer for listed insect and mite pests
- For best results pests must be contacted directly with spray
- Pyrol™ is a trademark of W Neudorff GmbH KG
- ~~• Made with Pyrol™ Insecticide a trademark of W Neudorff GmbH KG~~
- ~~• Contains Pyrol™ Insecticide a trademark of W Neudorff GmbH KG~~
- Sold under a license of W Neudorff GmbH KG Germany
- Manufactured under a license of W Neudorff GmbH KG Germany



- May be used up to day of harvest
- May be used on edible fruits and vegetables up to and including day of harvest
- Can be used right up until day of harvest
- Use up to day of harvest
- Read entire container label before using this product
- Roses and flowers
- Gardens
- Fruits and vegetables
- Can be used in vegetable gardens
- For use in and around the home
- For use in and around homes and home greenhouses
- For indoor and outdoor uses
- Indoor and outdoor
- [For 16 fl oz container] Makes over 12 gallons of spray
- [For 24 fl oz container] Makes over 18 gallons of spray

- [For 32 fl oz container] Makes up to 25 gallons of spray
- [For 1 gallon container] Makes up to 100 gallons of spray



- For Organic Gardening

Registrant      W Neudorff GmbH KG  
Postfach 1209 An der Muhle 3  
31860 Emmerthal Germany  
Phone 250-652-5888  
[www.neudorffpro.com](http://www.neudorffpro.com)