

## UNITED STATES ENVIRONMENTAL PROTECTION AGENCY

W. Neudorff GmbH KG  
 c/o Walter G. Talarek, P.C.  
 1008 Riva Ridge Drive  
 Great Falls, VA 22066-1620

DEC 07 2011

Subject: Label Amendment to add optional marketing claims, add the pest Oxalis, edit the directions for use, reduce the lower limit of the application rate, and make other label changes.  
 NEU1173H Concentrate  
 EPA Reg. No.: 67702-26  
 Your submission dated August 4, 2011  
 Decision Number: 453067

Dear Mr. Talarek:

The amendment referred to above submitted in connection with registration under the Federal Insecticide, Fungicide, and Rodenticide Act (FIFRA) section 3(c)(5), is acceptable provided that you:

- 1) Submit and/or cite all data required for registration/reregistration of your product under FIFRA section 3(c)(5) when the Agency requires all registrants of similar products to submit such data.
- 2) Submit two (2) copies of your final printed labeling before you release the product for shipment. Final printed labeling means the label or labeling of the product when distributed or sold. Clearly legible reproductions or photo reductions will be accepted for unusual labels, such as those silk-screened directly onto glass or metal containers or large bags or drum labels.

If these conditions are not complied with, the registration will be subject to cancellation in accordance with FIFRA section 6(e). Your release for shipment of the product bearing the amended labeling constitutes acceptance of these conditions. A stamped copy of the label is enclosed for your records. Should you have any questions, you may contact Mr. Colin Walsh directly at (703) 308-0298 or via email at [walsh.colin@epa.gov](mailto:walsh.colin@epa.gov).

Sincerely,

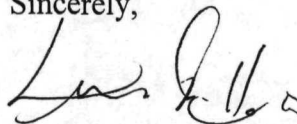

Linda A. Hollis, Chief  
 Biochemical Pesticides Branch  
 Biopesticides and Pollution  
 Prevention Division (7511P)

CONCURRENCES							
SYMBOL	7511P	7511P					
SURNAME	Walsh	Colin					
DATE	11/13/11	12/5/11					

OFFICIAL FILE COPY

2/57

**MASTER LABEL**

**NEU1173H Concentrate**

Active Ingredient:

Iron HEDTA (FeHEDTA) .....	26.52%
Other Ingredients:.....	73.48%
<b>Total:.....</b>	<b>100.00%</b>

SUBLABEL A: Household use on Weeds

SUBLABEL B: Household use on Weeds – Hose-end Sprayer

SUBLABEL C: Household use on Moss

SUBLABEL D: Household use on Moss – Hose-end Sprayer

SUBLABEL E: Commercial use on Weeds

SUBLABEL F: Commercial use on Weeds – Hose-end Sprayer

SUBLABEL G: Commercial use on Moss

SUBLABEL H: Commercial use on Moss – Hose-end Sprayer

EPA REG. NO. 67702-26

EPA EST. 67702-DEU-1

**KEEP OUT OF REACH OF CHILDREN  
CAUTION**

Registrant: W. Neudorff GmbH KG  
An der Muhle 3, Postfach 1209  
D-31860 Emmerthal, Germany  
[www.neudorff.com](http://www.neudorff.com)

Household Use: NET CONTENTS: 5 fl. oz., 10 fl. oz. (two 5 fl. oz. bottles), 12 fl. oz., 15 fl. oz., 16 fl. oz., 20 fl. oz., 24 fl. oz., 32 fl. oz., 1 gallon, 227 gallons

Commercial Use: NET CONTENTS: 1 gallon, 2.5 gallons, 5 gallons, 10 gallons, 20 gallons, 40 gallons, 45 gallons, 50 gallons, 200 gallons, 227 gallons

**ACCEPTED**

**DEC 07 2011**

Under the Federal Insecticide, Fungicide,  
and Rodenticide Act, as amended, for  
the pesticide registered under  
EPA Reg. No. 67702-26

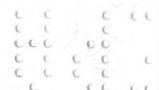

## NEU1173H Concentrate

Active Ingredient:

Iron HEDTA (FeHEDTA) .....	26.52%
Other Ingredients:.....	73.48%
<b>Total:.....</b>	<b>100.00%</b>

**KEEP OUT OF REACH OF CHILDREN**

## CAUTION

FIRST AID	
IF IN EYES	-Hold eye open and rinse slowly and gently with water for 15-20 minutes. -Remove contact lenses, if present, after the first 5 minutes, then continue rinsing eye. -Call a poison control center or doctor for treatment advice.
Have the product container or label with you when calling a poison control center or doctor, or going for treatment. [Optionally, supplemental distributor's may use the following wording and own toll-free hotline number: For medical emergency information, you may call toll free 1-XXX-XXX-XXXX [insert operating hours and days of service]	

### PRECAUTIONARY STATEMENTS

#### HAZARDS TO HUMANS AND DOMESTIC ANIMALS

CAUTION: Causes slight eye irritation. Avoid contact with eyes or clothing. Wash thoroughly with soap and water after handling and before eating, drinking, chewing gum or using tobacco. Prolonged or frequently repeated skin contact may cause allergic reactions in some individuals.

[One of the two following formats must be used:

Format 1:

#### DIRECTIONS FOR USE

It is a violation of Federal Law to use this product in a manner inconsistent with its labeling.

#### Use Sites:

Use to selectively control/suppress broadleaf weeds growing in lawns

#### Pests:

[One of the two following Pest and Application Directions sections must be used. on the labels of products sold or distributed in all states, except California. The



NEU1173H

Page 3 of 56

second section must be used on the labels of products sold or distributed in California:

Controls or suppresses weeds such as but not limited to:

- Black medic (*Medicago lupulina*)
- Broadleaf plantain (*Plantago major*)
- Bull thistle (*Cirsium vulgare*)
- Canada thistle (*Cirsium arvense*)
- Common chickweed (*Stellaria media*)
- Creeping buttercup (*Ranunculus repens*)
- Dandelion (*Taraxicum officinale*)
- Dovefoot geranium (*Geranium molle*)
- English daisy (*Bellis perennis*)
- False dandelion (*Hypochoeris radicata*)
- Healall (*Prunella vulgaris*)
- Moss, liverworts, algae and lichens
- Narrow-leaved plantain (*Plantago lanceolata*)
- Oxalis (*Oxalis* spp.)
- Persian Speedwell (*Veronica persica*)
- Shepherd's-purse (*Capsella bursa-pastoris*)
- Silverweed cinquefoil (*Potentilla anserina*)
- Slender speedwell (*Veronica filiformis*)
- White clover (*Trifolium repens*)
- Wild chamomile (*Matricaria chamomilla*)

### Application Directions For Broadcast Treatment:

Rate of Spray Solution	Rate of Concentrate	Weeds Controlled	Area Treated
2.8 fl. oz./yd <sup>2</sup> or 2.5 ga/1000 ft <sup>2</sup>	12.6 fl. oz/1000 ft <sup>2</sup>	Rate for easy-to-control weeds: black medic ( <i>Medicago lupulina</i> ), slender speedwell ( <i>Veronica filiformis</i> ), wild geranium ( <i>Geranium robertianum</i> ) and moss. This rate can also be used for weed seedlings of: false dandelion ( <i>Hypochoeris radicata</i> ), English daisy ( <i>Bellis perennis</i> ), dandelion ( <i>Taraxacum officinale</i> ) or white clover ( <i>Trifolium repens</i> ).	25,400 ft <sup>2</sup> /2.5 ga jug
5.7 fl. oz./yd <sup>2</sup> or 4.9 ga/1000 ft <sup>2</sup>	25.2 fl. oz/1000 ft <sup>2</sup>	Standard rate for control of most weed species: dandelion ( <i>Taraxacum officinale</i> ), English daisy ( <i>Bellis perennis</i> ), false dandelion ( <i>Hypochoeris radicata</i> ), white clover ( <i>Trifolium repens</i> ), bull thistle ( <i>Cirsium vulgare</i> ), Canada thistle ( <i>Cirsium arvense</i> ), common chickweed ( <i>Stellaria media</i> ), narrow-leaved plantain ( <i>Plantago lanceolata</i> ), dove's foot geranium ( <i>Geranium molle</i> ), oxalis ( <i>Oxalis</i> spp.), lawn burweed ( <i>Soliva ptero-sperma</i> ), and algae, and for the SUPPRESSION of broad-leaved plantain ( <i>Plantago major</i> )	12,700 ft <sup>2</sup> /2.5 ga jug
11.3 fl oz./yd <sup>2</sup> or 9.8 ga/1000 ft <sup>2</sup>	50 fl. oz./1000 ft <sup>2</sup>	Rate for tough perennial weeds such as: creeping buttercup ( <i>Ranunculus repens</i> ) and broad-leaved plantain ( <i>Plantago major</i> )	6340 ft <sup>2</sup> /2.5 ga jug



NEU1173H

Page 4 of 56

Shake well before using. Mix one part [NEU1173H] with 24 parts water (5 oz. in 1 gallon of water). Apply the mixed solution at a rate of 2.5-10 gallons/1000 ft<sup>2</sup> (2.8-11.5 fluid oz./yard<sup>2</sup>), using the chart to determine how much diluted spray to use per area. Any standard hand-held or backpack sprayer can be used. Thoroughly spray weeds. Use a coarse nozzle setting to reduce drift. Uniform coverage is important.

Repeat treatment in 3 to 4 weeks for best results.

#### For Spot Treatment

Shake well before using. Mix one part [NEU1173H] with 24 parts water (5 oz. in 1 gallon of water). Thoroughly spray weeds to point of runoff using any standard hand-held or backpack sprayer. Use a coarse nozzle setting to reduce drift. Repeat treatment in 3 to 4 weeks for best results.

OR

Controls weeds:

- Dandelion (*Taraxicum officinale*)
- English daisy (*Bellis perennis*)
- Moss

Suppresses weeds:

- White clover (*Trifolium repens*)
- Broadleaf plantain (*Plantago major*)
- Narrow-leaved plantain (*Plantago lanceolata*)
- Creeping buttercup (*Ranunculus repens*)
- Slender speedwell (*Veronica filiformis*)

#### Application Directions

Shake well before using. Mix one part [NEU1173H] with 24 parts water (5 oz. in 1 gallon of water). Apply the mixed solution at a rate of 2.5-10 gallons/1000 ft<sup>2</sup> (2.8-11.5 fluid oz./yard<sup>2</sup>). The standard rate for NEU1173H is 5.75 fl. oz./yard<sup>2</sup>; use the higher rate (11.5 fl. oz./yard<sup>2</sup>) on tough perennial weeds, such as buttercup and broad-leaved plantain. NEU1173H may also be used at 2.8 fl.oz./yard<sup>2</sup> (2.5 gallons/1000ft<sup>2</sup>) on moss, black medic, slender speedwell, wild geranium or on weed seedlings of false dandelion, English daisy, dandelion or white clover. Any standard hand-held or backpack sprayer can be used. Thoroughly spray weeds. Use a coarse nozzle setting to reduce drift. Uniform coverage is important.

Repeat treatment in 3 to 4 weeks for best results.

NEU1173H  
Page 5 of 56  
**What will I see?**

Works quickly; dying weeds will be seen within hours of application. Treated weeds, moss or algae will turn brown or black. Occasionally a darkening of the grass leaf blades can occur after treatment, however the grass will recover within a few days to weeks. May stain thatch (dead grass under lawn); this does not affect the health of the grass.

**Use Precautions:**

Do not apply to drought stressed grass; ensure lawn is well watered prior to application. Do not apply when the daytime temperature will exceed 85°F. Do not apply to bentgrass. If unsure of grass sensitivity, test spray a small area of your lawn. Do not apply to newly seeded areas prior to grass seed germination. Avoid spraying desirable plants. Any desirable plants or structures accidentally contacted should be rinsed with water. To avoid staining, wait until treated area dries before re-entry. Do not apply if rainfall is expected within 3 hours of application. Do not irrigate within 3 hours of application. Do not apply to the same area more than 4 times a year.

OR

Format 2:

<b>DIRECTIONS FOR USE</b>	
It is a violation of Federal Law to use this product in a manner inconsistent with its labeling.	
<b>BEFORE YOU USE</b>	Shake well before using.
<b>WHERE TO USE</b>	Use to selectively control/suppress broadleaf weeds growing in lawns
<b>HOW TO USE</b>	Mix 5 fl. oz. of Bayer Advanced Natria Lawn Weed Control Concentrate into 1 gallon of water. Apply the mixed solution at a rate of 0.5 - 1 gallon/100 sq. ft (5.75-11.5 fluid oz./yard <sup>2</sup> ). The standard rate for NEU1173H is 5.75 fl. oz./yard <sup>2</sup> ; use the higher rate (11.5 fl. oz./yard <sup>2</sup> ) on tough perennial weeds, such as buttercup and broad-leaved plantain. NEU1173H may also be used at 2.8 fl.oz./yard <sup>2</sup> (2.5 gallons/1000ft <sup>2</sup> ) on moss, black medic, slender speedwell, wild geranium or on weed seedlings of false dandelion, English daisy, dandelion or white clover. Any standard hand-held or backpack sprayer can be used. Thoroughly spray weeds. Use a coarse nozzle setting to reduce drift. Uniform coverage is important.

<b>WHAT WILL I SEE?</b>	Works quickly; dying weeds will be seen within hours of application. Treated weeds or moss will turn brown or black. Occasionally a darkening of the grass leaf blades can occur after treatment; however, the grass will recover within a few days to weeks. May stain thatch (dead grass under lawn); this does not affect the health of the grass.
<b>PESTS (WEEDS, MOSS &amp; ALGAE)</b>	[insert one of pests sections from Directions for Use above]
<b>USE PRECAUTIONS</b>	<ul style="list-style-type: none"><li>• Do not apply to drought stressed grass. Ensure that lawn is well watered prior to application.</li><li>• Do not apply when the daytime temperature will exceed 85 °F.</li><li>• Do not apply to bentgrass.</li><li>• If unsure of grass sensitivity, test spray a small area of your lawn.</li><li>• Do not apply to newly seeded areas prior to grass seed germination.</li><li>• Avoid spraying desirable plants. Any desirable plants or structures accidentally contacted should be rinsed with water.</li><li>• To avoid staining, wait until treated area dried before re-entry.</li><li>• Do not apply if rainfall is expected within 3 hours of application. Do not irrigate within 3 hours of application.</li><li>• Do not apply to the same area more than 4 times a year.</li></ul>

1

#### **STORAGE AND DISPOSAL**

**PESTICIDE STORAGE:** Store this product in its original container and keep in a secure storage area out of reach of children and domestic animals. Store unused material, tightly closed, in original container only, away from open flame.

#### **PESTICIDE DISPOSAL AND CONTAINER HANDLING:**

Non-refillable container. Do not reuse or refill this container.

**If empty:** Place in trash or offer for recycling if available.

**If partly filled:** Call your local solid waste agency [or call [insert supplemental distributor's toll free number]] for disposal instructions. Never place unused product down any indoor or outdoor drain.

**BATCH CODE:**

[The following claims and product information, may or may not be presented on the product's label and labeling:

-www.neudorff.com





- Weed Killer for Lawns
- Selective Weed Killer
- Selective Broadleaf Weed Killer
- Selective Weed Control
- Selective Broadleaf Weed Control
- Selective Control of Weeds in Lawns
- Selective Control of Broadleaf Weeds in Lawns
- Kills weeds not lawns
- Kills weeds not grasses
- Lawn Weed Killer
- Lawn Weed Control
- Kills moss and weeds
- Moss and weed killer for lawns
- Kills moss and weeds, not lawns
- Kills moss and weeds, not grass
- Water-based
- When diluted, this bottle will treat XXX ft<sup>2</sup>
- Treats up to XXXX ft<sup>2</sup> (of lawn)
- Works in cool weather
- Rainfast in 3 hours
- Works fast
- See results the same day
- See results in hours
- Fast and effective
- Mix with water
- No unpleasant odor
- Does not contain (2,4-D) (MCPA) (Dicamba) (Mecoprop)
- Derived from iron (Fe)
- For non-selective (moss) weed and grass control, use [H01 or NEU1171H –  
*insert product name*]
- Eliminates unwanted moss, algae and lichens quickly
- Kills algae, moss and lichens
- Kills moss and algae
- Moss killer
- Moss, algae and lichen killer
- Kills moss fast
- Kills moss, algae, and lichens quickly and effectively
- Can be used on new lawns (1 week) after grass emergence
- Lawn areas can be re-sown within one day of treatment with NEU1173H
- Can re-seed lawn 1 day after spraying (applying)
- (Controls) (kills) (dandelions) (buttercup) (English daisy) (daisy) (clover)
- One gallon of concentrate will treat up to 10,000 ft<sup>2</sup> (of lawn)
- Can be used to spot treat problem areas
- Can be used to spot treat problem areas in lawns
- Can be used on new lawns (1 week) after grass emergence

NEU1173H

Page 8 of 56

- Weed killer for newly planted lawn
- Even works in cool weather
- Also works in cool weather
- Works in temperatures between 50°F and 85°F (10°C and 29°C)
- Effective at temperatures from 50°F to 85°F (10°C to 29°C)
- Patent pending
- Patent #6,972,273
- Makes over XX gallons
- 1 ounce = 2 tablespoons = 6 teaspoons
- Kills weeds, down to the root
- Kills dandelions, down to the root
- (Helpful Hints:) Best results are obtained when applied in the Spring or Fall when environmental conditions are cool and there is ample moisture
- (Helpful Hints:) The best times to treat weeds are in the Spring when they are small and growing and in the Fall to eliminate many of next year's weeds
- People and pets can enter treated area when spray dries
- Controls broadleaf weeds in lawns
- NEU1173H is a herbicide derived from iron that is used to selectively control/suppress broadleaf weeds growing in lawns
- See side panel for mixing instructions.
- See bottle label inside for complete "directions for use".
- Includes two 5 fl. oz. bottles. Makes 2 gallons [of spray]
- Value [package]. Makes 2 gallons [of spray]
- [Open box] [Box contains 2 bottles of product]
- Refer to leaflet for complete [First Aid], [Directions for Use], [Precautionary Statements], and [Storage and Disposal Instructions]
- READ THE LABEL FIRST!**

#### QUICK FACTS

- Kills Weeds Not Lawns
- Derived from Iron
- Even Works in Cool Weather.
- Can be Used on New Lawns 1 Week After Grass Emergence

#### CONTROLS

- Dandelion, Common Chickweed, Clover and other Listed Broadleaf Weeds
- Moss, Algae and Lichens

#### WHERE TO USE

- On lawns (do not apply to bentgrass)

[phone graphic]

For questions or comments, call toll-free 1-877-BayerAG (1-877-229-3724).

]

[Optional warranty statements. Registrant has choice of using any or none.

**-NOTICE TO BUYER**

NEU1173H

Page 9 of 56

Seller warrants that this product conforms to the chemical description on this label and is reasonably fit for the purposes stated in the Directions for Use, subject to the inherent risks described above, when used in accordance with the Directions for Use under normal conditions. To the extent consistent with applicable law, this warranty does not extend to use of this product contrary to label directions, or under abnormal use conditions, or under conditions not reasonably foreseeable to Seller. To the extent consistent with applicable law, the Seller shall not be liable for any such use. To the extent consistent with applicable law, the Seller makes no other warranties, either expressed or implied.

Or

-Buyer assumes all responsibility for safety and use not in accordance with directions.

Or

-Unconditionally Guaranteed by (company name). **OUR COMMITMENT TO YOUR SATISFACTION:** If you are not happy with the way this product works in your garden, please let us know. We will be happy to replace the product, refund your money, or substitute another (brand name) product. Simply send your name, address and proof of purchase to (Company name & address).

Or

(company name) guarantees if for any reason you are not satisfied with this product, mail us proof of purchase to obtain a full refund of your purchase price.

OR

**Warranty:**

Seller warrants that this product conforms to the chemical description on this label and is reasonably fit for purposes stated on this label only when used in accordance with directions under normal use conditions. To the fullest extent permitted by law, the seller shall not be liable for damages caused by buyer's use of product contrary to label directions, or under abnormal use conditions, or under conditions not reasonably foreseeable to seller. Seller makes no other warranties, either expressed or implied.

OR

**Money Back Guarantee:** If you are not satisfied with this product, we will gladly refund your original purchase price.

]

10/57



## NEU1173H Concentrate

**Active Ingredient:**

Iron HEDTA (FeHEDTA) .....	26.52%
Other Ingredients:.....	73.48%
<b>Total:</b> .....	<b>100.00%</b>

**KEEP OUT OF REACH OF CHILDREN**

## CAUTION

FIRST AID	
IF IN EYES	-Hold eye open and rinse slowly and gently with water for 15-20 minutes. -Remove contact lenses, if present, after the first 5 minutes, then continue rinsing eye. -Call a poison control center or doctor for treatment advice.
Have the product container or label with you when calling a poison control center or doctor, or going for treatment.	

### **PRECAUTIONARY STATEMENTS**

#### **HAZARDS TO HUMANS AND DOMESTIC ANIMALS**

CAUTION: Causes slight eye irritation. Avoid contact with eyes or clothing. Wash thoroughly with soap and water after handling and before eating, drinking, chewing gum or using tobacco. Prolonged or frequently repeated skin contact may cause allergic reactions in some individuals.

#### **DIRECTIONS FOR USE**

It is a violation of Federal Law to use this product in a manner inconsistent with its labeling.

#### **Use Sites:**

Use to selectively control/suppress broadleaf weeds growing in lawns

#### **Pests:**

[One of the two following sections must be used. The first section may be used on the labels of products sold or distributed in all states, except California. The second section must be used on the labels of products sold or distributed in California:

Controls or suppresses the following weeds such as but not limited to: Dandelion, English daisy, False dandelion, White clover, Black medic, Bull thistle, Canada thistle, Common chickweed, Creeping buttercup, Persian Speedwell, Slender speedwell, Broadleaf plantain, Narrow-leaved plantain, Oxalis, Dovefoot

NEU1173H

Page 11 of 56

geranium, Healall, Shepherd's-purse, Silverweed cinquefoil, Wild chamomile, Moss, Liverworts, Algae, Lichens.

OR

Controls the following weeds: Dandelion, English daisy, and Moss.

Suppresses the following weeds: Broadleaf plantain, Narrow-leaved plantain, White clover, Creeping buttercup and Slender speedwell]

### **Application Directions**

Shake well before using.

[Choose one of the following:

Apply this (24oz) container to 470 to 940 square feet. Apply it to 940 ft<sup>2</sup> for standard application; apply it to 470 ft<sup>2</sup> to control tough perennial weeds, such as buttercup and broad-leaved plantain. This container may be applied to up to 1875 ft<sup>2</sup> to control moss, black medic, slender speedwell, wild geranium or on weed seedlings of false dandelion, English daisy, dandelion or white clover.

OR

Apply this (32oz) container to 625 to 1250 square feet. Apply it to 1250 ft<sup>2</sup> for standard application; apply it to 625 ft<sup>2</sup> to control tough perennial weeds, such as buttercup and broad-leaved plantain. This container may be applied to up to 2500 ft<sup>2</sup> to control moss, black medic, slender speedwell, wild geranium or on weed seedlings of false dandelion, English daisy, dandelion or white clover.

OR

Apply this (1 gallon) container to 2500 to 5000 square feet. Apply it to 5000 ft<sup>2</sup> for standard application; apply it to 2500 ft<sup>2</sup> to control tough perennial weeds, such as buttercup and broad-leaved plantain. This container may be applied to up to 10 000 ft<sup>2</sup> to control moss, black medic, slender speedwell, wild geranium or on weed seedlings of false dandelion, English daisy, dandelion or white clover.

]

Uniform coverage is important. Rinse treated areas 24 hours after application. Repeat treatment in 3 to 4 weeks for best results.

[Optional hose-end sprayer directions that may be presented on the container or supplemental wording, either:

Figure 1

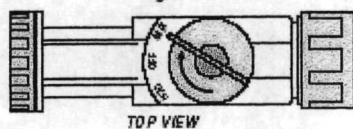

Figure 2



Figure 3

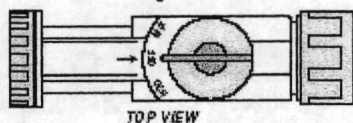
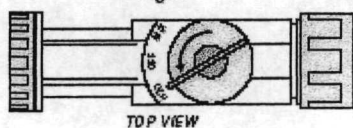

Figure 4



#### To Use This Sprayer:

1. Shake container well.
2. Connect spray nozzle to garden hose.
3. Turn on the water from the faucet. Extend hose to the farthest area to be treated and work back toward the faucet so you don't come in contact with the treated area.
4. When you are ready to spray, turn the knob on top so that it points to the MIX position on the spray head. (Fig. 1)
5. The spray deflector on the front of the hose-end applicator can be rotated to give a stream or fan spray. (Fig. 2)



6. When you are finished spraying or if you have to stop spraying at any time, turn the knob back to the OFF position. (Fig. 3)
7. Turn off the water from the faucet.
8. Turn the knob to H2O then OFF, to drain the water from the hose. (Fig. 4)

OR

1. Attach garden hose to spray nozzle. Turn on water supply.
2. Bend safety tab down and turn control to "water".
3. Point nozzle toward plants and turn water control knob to "On". Product will automatically mix with water. Spray weeds thoroughly.

To Stop Spraying:

1. When you are finished spraying or if you have to stop spraying at any time, turn the blue knob back to the OFF position.
2. Turn off the water from the faucet.
3. Turn the blue knob to H2O then OFF, to drain the water from the hose.
4. Unscrew spray nozzle from hose. Remove hose end from container.
5. Reseal the container with the child-resistant closure. Rinse the hose-end applicator

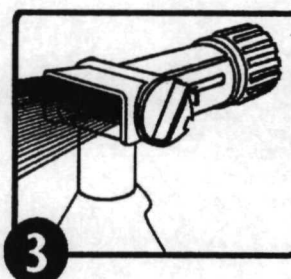
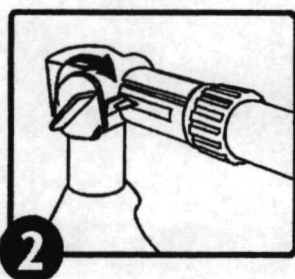
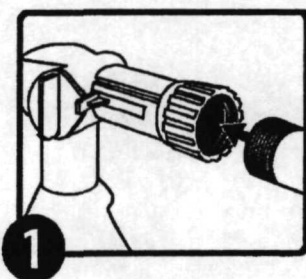



OR

1. Shake container well before using.
2. Connect a garden hose to the Ready Spray nozzle. Make sure the dial on the nozzle is in the "OFF" position with the safety tab in the valve notch.
3. Turn on the water at faucet. Extend hose to the farthest area to be treated and work back toward the faucet so you don't come in contact with the treated area.
4. To BEGIN spraying, point nozzle toward treatment site and
  - a. Bend the safety tab back (located at the right of the yellow dial) with your thumb,

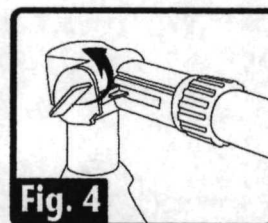
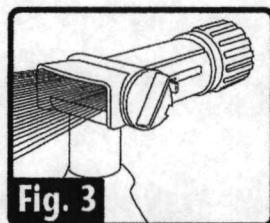
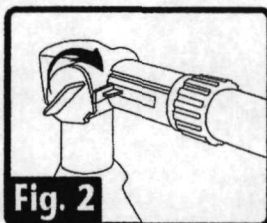
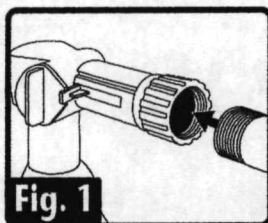
- b. Using your other hand, QUICKLY turn the dial clockwise until it stops. Water will automatically mix with the product.
5. Spray weeds thoroughly. Walk at a steady pace while spraying using an even sweeping motion, slightly overlapping treated areas.
6. To STOP spraying, QUICKLY turn the dial in the opposite direction of "ON" until it stops and the safety tab engages the notch on the valve. Turn water off at faucet. To relieve pressure before removing nozzle from hose, bend the safety tab back and turn dial "ON" until water stops spraying.
7. To STORE unused product, make sure the dial is in the "OFF" position with safety tab in the valve notch. Place in cool area away from heat, sunlight or open flame.



		
<ul style="list-style-type: none"><li>• Ensure that the large Water Control Knob is turned to the "OFF" position.</li><li>• Connect sprayer to garden hose.</li></ul>	<ul style="list-style-type: none"><li>• Turn the small Product Control Button so that the flat side aligns with the tab on the right side of the button, and push the button all the way in.</li><li>• Turn on water at faucet.</li></ul>	<ul style="list-style-type: none"><li>• To spray, point nozzle where you want to spray and turn the large knob all the way to the left.</li><li>• To stop spraying, push small Product Control Button in from opposite side. Turn large Water Control Knob to the right to the "OFF" position and turn off faucet.</li><li>• NOTE: BEFORE DISCONNECTING HOSE (to relieve water pressure): Turn large Water Control Knob to the left; then turn "OFF" again.</li><li>• Disconnect garden hose from sprayer.</li><li>• To prevent accidental discharge when not in use, turn the small Product Control Button so that it is <u>NOT</u> aligned with the tab and cannot be pushed in.</li></ul>

1

### What will I see?

Works quickly; dying weeds will be seen within hours of application. Treated weeds, moss or algae will turn brown or black. Occasionally a darkening of the grass leaf blades can occur after treatment, however the grass will recover within a few days to weeks. May stain thatch (dead grass under lawn); this does not affect the health of the grass.

### Use Precautions:

Do not apply to drought stressed grass; ensure lawn is well watered prior to application. Do not apply when the daytime temperature will exceed 85°F. Do



NEU1173H

Page 16 of 56

not apply to bentgrass. If unsure of grass sensitivity, test spray a small area of your lawn. Do not apply to newly seeded areas prior to grass seed germination. Avoid spraying desirable plants. Any desirable plants or structures accidentally contacted should be rinsed with water. To avoid staining, wait until treated area dries before re-entry. Do not apply if rainfall is expected within 3 hours of application. Do not irrigate within 3 hours of application. Do not apply to the same area more than 2 times a year.

**STORAGE AND DISPOSAL**

**PESTICIDE STORAGE:** Store this product in its original container and keep in a secure storage area out of reach of children and domestic animals. Store unused material, tightly closed, in original container only, away from open flame.

**PESTICIDE DISPOSAL AND CONTAINER HANDLING:**

Non-refillable container. Do not reuse or refill this container.

**If empty:** Place in trash or offer for recycling if available.

**If partly filled:** Call your local solid waste agency [or call [insert supplemental distributor's toll free number]] for disposal instructions. Never place unused product down any indoor or outdoor drain.

**BATCH CODE:**

[The following claims and product information, may or may not be presented on the product's label and labeling:

-[www.neudorff.com](http://www.neudorff.com)



- Weed Killer for Lawns
- Selective Weed Killer
- Selective Broadleaf Weed Killer
- Selective Weed Control
- Selective Broadleaf Weed Control
- Selective Control of Weeds in Lawns
- Selective Control of Broadleaf Weeds in Lawns
- Kills weeds not lawns
- Kills weeds not grasses
- Lawn Weed Killer
- Lawn Weed Control
- Water-based
- With the provided hose-end sprayer, this container will treat XXX ft<sup>2</sup>
- Works in cool weather
- Rainfast in 3 hours
- Works fast
- See results the same day
- See results in hours
- Fast and effective
- No unpleasant odor

NEU1173H

Page 17 of 56

- Does not contain (2,4-D) (MCPA) (Dicamba) (Mecoprop)
- Derived from iron (Fe)
- For non-selective (moss) weed and grass control, use [H01 or NEU1171H –  
*insert product name*]
- Eliminates unwanted moss, algae and lichens quickly
- Kills algae, moss and lichens
- Kills moss and algae
- Moss killer
- Moss, algae and lichen killer
- Kills moss fast
- Kills moss, algae, and lichens quickly and effectively
- Kills moss and weeds
- Moss and weed killer for lawns
- Kills moss and weeds, not lawns
- Kills moss and weeds, not grass
- Lawn areas can be re-sown within one day of treatment with NEU1173H
- Can re-seed lawn 1 day after spraying (applying)
  
- (Controls) (kills) (dandelions) (buttercup) (English daisy) (daisy) (clover)
- One gallon of concentrate will treat up to 10,000 ft<sup>2</sup> (of lawn)
- Treats up to XXXX ft<sup>2</sup> (of lawn)
- Weed killer for newly planted lawn
- Can be used on new lawns (1 week) after grass emergence
- Even works in cool weather
- Also works in cool weather
- Works in temperatures between 50°F and 85°F (10°C and 29°C)
- Effective at temperatures from 50°F to 85°F (10°C to 29°C)
- Patent pending
- Patent #6,972,273
- Kills weeds, down to the root
- Kills dandelions, down to the root
- (Helpful Hints:) Best results are obtained when applied in the Spring or Fall when environmental conditions are cool and there is ample moisture
- (Helpful Hints:) The best times to treat weeds are in the Spring when they are small and growing and in the Fall to eliminate many of next year's weeds
- People and pets can enter treated area when spray dries
- Ready-To-Spray
- Hose-End Bottle
- Hose-End Sprayer
- This product is ready to spray. Just attach this bottle to your garden hose according to directions. Water automatically mixes with the concentrate as you spray.]

[Optional warranty statements. Registrant has choice of using any or none.

**-NOTICE TO BUYER**

Seller warrants that this product conforms to the chemical description on this label and is reasonably fit for the purposes stated in the Directions for Use, subject to the inherent risks described above, when used in accordance with the Directions for Use under normal conditions. To the extent consistent with applicable law, this warranty does not extend to use of this product contrary to label directions, or under abnormal use conditions, or under conditions not reasonably foreseeable to Seller. To the extent consistent with applicable law, the Seller shall not be liable for any such use. To the extent consistent with applicable law, the Seller makes no other warranties, either expressed or implied.

Or

-Buyer assumes all responsibility for safety and use not in accordance with directions.

Or

-Unconditionally Guaranteed by (company name). **OUR COMMITMENT TO YOUR SATISFACTION:** If you are not happy with the way this product works in your garden, please let us know. We will be happy to replace the product, refund your money, or substitute another (brand name) product. Simply send your name, address and proof of purchase to (Company name & address).

Or

(company name) guarantees if for any reason you are not satisfied with this product, mail us proof of purchase to obtain a full refund of your purchase price.]



**SUBLABEL C – HOUSEHOLD USE ON MOSS**

**NEU1173H Concentrate**

**Active Ingredient:**

Iron HEDTA (FeHEDTA) .....	26.52%
Other Ingredients:.....	73.48%
<b>Total:.....</b>	<b>100.00%</b>

**KEEP OUT OF REACH OF CHILDREN**

**CAUTION**

FIRST AID	
IF IN EYES	-Hold eye open and rinse slowly and gently with water for 15-20 minutes. -Remove contact lenses, if present, after the first 5 minutes, then continue rinsing eye. -Call a poison control center or doctor for treatment advice.
Have the product container or label with you when calling a poison control center or doctor, or going for treatment.	

**PRECAUTIONARY STATEMENTS**

**HAZARDS TO HUMANS AND DOMESTIC ANIMALS**

CAUTION: Causes slight eye irritation. Avoid contact with eyes or clothing. Wash thoroughly with soap and water after handling and before eating, drinking, chewing gum or using tobacco. Prolonged or frequently repeated skin contact may cause allergic reactions in some individuals.

**DIRECTIONS FOR USE**

It is a violation of Federal Law to use this product in a manner inconsistent with its labeling.

**Use Sites:**

Use to selectively control moss, algae, lichens, and liverworts growing in lawns.

**Pests:**

Controls moss, algae, lichens, and liverworts.

**Application Directions**

Shake well before using. Mix one part [NEU1173H] with 24 parts water (5 oz. in 1 gallon of water). Apply the mixed solution at a rate of 2.5-5 gallons/1000 ft<sup>2</sup> (2.8-5.75 oz./yard<sup>2</sup>). Any standard hand-held or backpack sprayer can be used.

NEU1173H

Page 20 of 56

Use a coarse nozzle setting to reduce drift. Uniform coverage is important. Repeat treatment if needed.

Repeat treatment in 3 to 4 weeks for best results.

### **What will I see?**

Works quickly. Treated moss or algae will turn brown or black. Occasionally a darkening of the grass leaf blades can occur after treatment, however the grass will recover within a few days to weeks. May stain thatch (dead grass under lawn); this does not affect the health of the grass.

### **Use Precautions:**

Do not apply to drought stressed grass; ensure lawn is well watered prior to application. Do not apply when the daytime temperature will exceed 85°F. Do not apply to bentgrass. If unsure of grass sensitivity, test spray a small area of your lawn. Do not apply to newly seeded areas prior to grass seed germination. Avoid spraying desirable plants. Any desirable plants or structures accidentally contacted should be rinsed with water. To avoid staining, wait until treated area dries before re-entry. Do not apply if rainfall is expected within 3 hours of application. Do not irrigate within 3 hours of application. Do not apply to the same area more than 4 times a year.

### **STORAGE AND DISPOSAL**

**PESTICIDE STORAGE:** Store this product in its original container and keep in a secure storage area out of reach of children and domestic animals. Store unused material, tightly closed, in original container only, away from open flame.

### **PESTICIDE DISPOSAL AND CONTAINER HANDLING:**

Nonrefillable container. Do not reuse or refill this container.

**If empty:** Place in trash or offer for recycling if available.

**If partly filled:** Call your local solid waste agency [or call [insert supplemental distributor's toll free number]] for disposal instructions. Never place unused product down any indoor or outdoor drain.

BATCH CODE:

[The following claims and product information, may or may not be presented on the product's label and labeling:

-[www.neudorff.com](http://www.neudorff.com)



- Selective Moss Killer
- Selective Moss Control
- Kills Moss Without Harming Lawn Grasses
- Kills moss not lawns

NEU1173H

Page 21 of 56

- Kills moss not grasses
- Lawn Moss Killer
- Lawn Moss Control
- Water-based
- When diluted, this bottle will treat XXX ft<sup>2</sup>
- Works in cool weather
- Rainfast in 3 hours
- Works fast
- See results the same day
- See results in hours
- Fast and effective
- No unpleasant odor
- Mix with water
- Does not contain (2,4-D) (MCPA) (Dicamba) (Mecoprop)
- Derived from iron (Fe)
- For non-selective (moss) weed and grass control, use [H01 or NEU1171H – *insert product name*]
- Eliminates unwanted moss, algae and lichens quickly
- Kills algae, moss and lichens
- Kills moss and algae
- Moss killer
- Moss, algae and lichen killer
- Kills moss and weeds
- Moss and weed killer for lawns
- Kills moss and weeds, not lawns
- Kills moss and weeds, not grass
- Kills moss fast
- Kills moss, algae, and lichens quickly and effectively
- Lawn areas can be re-sown within one day of treatment with NEU1173H
- Can re-seed lawn 1 day after spraying (applying)
- (Controls) (kills) (dandelions) (buttercup) (English daisy) (daisy) (clover)
- One gallon of concentrate will treat up to 10,000 ft<sup>2</sup> (of lawn)
- Treats up to XXXX ft<sup>2</sup> (of lawn)
- Can be used to spot treat problem areas
- Can be used to spot treat problem areas in lawns
- Can be used on new lawns (1 week) after grass emergence
- Weed killer for newly planted lawn
- Even works in cool weather
- Also works in cool weather
- Works in temperatures between 50°F and 85°F (10°C and 29°C)
- Effective at temperatures from 50°F to 85°F (10°C to 29°C)
- Patent pending
- Patent #6,972,273
- Makes over XX gallons
- 1 ounce = 2 tablespoons = 6 teaspoons
- (Helpful Hints:) Best results are obtained when applied in the Spring or Fall when environmental conditions are cool and there is ample moisture
- People and pets can enter treated area when spray dries]



[Optional warranty statements. Registrant has choice of using any or none.

**-NOTICE TO BUYER**

Seller warrants that this product conforms to the chemical description on this label and is reasonably fit for the purposes stated in the Directions for Use, subject to the inherent risks described above, when used in accordance with the Directions for Use under normal conditions. To the extent consistent with applicable law, this warranty does not extend to use of this product contrary to label directions, or under abnormal use conditions, or under conditions not reasonably foreseeable to Seller. To the extent consistent with applicable law, the Seller shall not be liable for any such use. To the extent consistent with applicable law, the Seller makes no other warranties, either expressed or implied.

Or

-Buyer assumes all responsibility for safety and use not in accordance with directions.

Or

-Unconditionally Guaranteed by (company name). **OUR COMMITMENT TO YOUR SATISFACTION:** If you are not happy with the way this product works in your garden, please let us know. We will be happy to replace the product, refund your money, or substitute another (brand name) product. Simply send your name, address and proof of purchase to (Company name & address).

Or

(company name) guarantees if for any reason you are not satisfied with this product, mail us proof of purchase to obtain a full refund of your purchase price.]

24/57

## NEU1173H Concentrate

Active Ingredient:

Iron HEDTA (FeHEDTA) .....	26.52%
Other Ingredients:.....	73.48%
<b>Total:.....</b>	<b>100.00%</b>

**KEEP OUT OF REACH OF CHILDREN**

## CAUTION

FIRST AID	
IF IN EYES	-Hold eye open and rinse slowly and gently with water for 15-20 minutes. -Remove contact lenses, if present, after the first 5 minutes, then continue rinsing eye. -Call a poison control center or doctor for treatment advice.
Have the product container or label with you when calling a poison control center or doctor, or going for treatment.	

### **PRECAUTIONARY STATEMENTS**

#### **HAZARDS TO HUMANS AND DOMESTIC ANIMALS**

CAUTION: Causes slight eye irritation. Avoid contact with eyes or clothing. Wash thoroughly with soap and water after handling and before eating, drinking, chewing gum or using tobacco. Prolonged or frequently repeated skin contact may cause allergic reactions in some individuals.

#### **DIRECTIONS FOR USE**

It is a violation of Federal Law to use this product in a manner inconsistent with its labeling.

#### **Use Sites:**

Use to selectively control moss, algae, lichens, and liverworts growing in lawns.

#### **Pests:**

Controls moss, algae, lichens, and liverworts.

#### **Application Directions**

Shake well before using.

[Choose one of the following:

Apply this (24 oz) container to 940 to 1875 ft<sup>2</sup>.

NEU1173H

Page 24 of 56

OR

Apply this (32 oz) container to 1250 to 2500 ft<sup>2</sup>.

OR

Apply this (1 gallon) container to 5000 to 10,000 ft<sup>2</sup>.

1

Uniform coverage is important. Rinse treated areas 24 hours after application.  
Repeat treatment in 3 to 4 weeks for best results.



[Optional hose-end sprayer directions that may be presented on the container or supplemental wording, either:

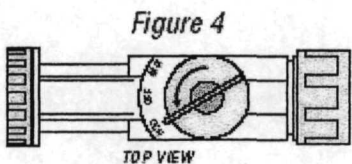
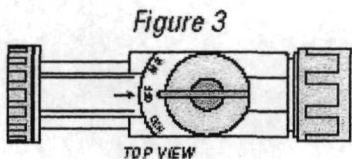
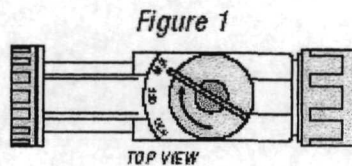

#### To Use This Sprayer:

1. Shake container well.
2. Connect spray nozzle to garden hose.
3. Turn on the water from the faucet. Extend hose to the farthest area to be treated and work back toward the faucet so you don't come in contact with the treated area.
4. When you are ready to spray, turn the knob on top so that it points to the MIX position on the spray head. (Fig. 1)
5. The spray deflector on the front of the hose-end applicator can be rotated to give a stream or fan spray. (Fig. 2)

#### To Stop Spraying

1. When you are finished spraying or if you have to stop spraying at any time, turn the knob back to the OFF position. (Fig. 3)
2. Turn off the water from the faucet.
3. Turn the knob to H2O then OFF, to drain the water from the hose. (Fig. 4)

NEU1173H  
Page 26 of 56  
OR

1. Attach garden hose to spray nozzle. Turn on water supply.
2. Bend safety tab down and turn control to "water".
3. Point nozzle toward plants and turn water control knob to "On". Product will automatically mix with water. Spray moss surfaces thoroughly.

**To Stop Spraying:**

1. When you are finished spraying or if you have to stop spraying at any time, turn the blue knob back to the OFF position.
2. Turn off the water from the faucet.
3. Turn the blue knob to H<sub>2</sub>O then OFF, to drain the water from the hose.
4. Unscrew spray nozzle from hose. Remove hose end from container.
5. Reseal the container with the child-resistant closure. Rinse the hose-end applicator

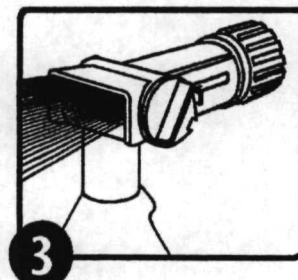
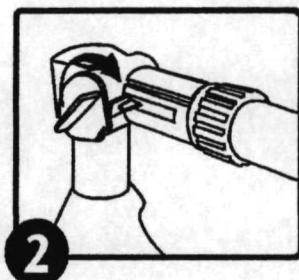
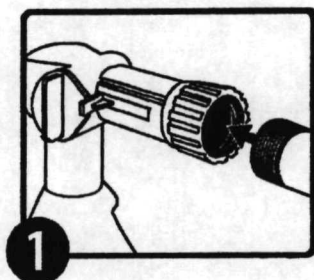



OR

1. Shake container well before using.
2. Connect a garden hose to the Ready Spray nozzle. Make sure the dial on the nozzle is in the "OFF" position with the safety tab in the valve notch.
3. Turn on the water at faucet. Extend hose to the farthest area to be treated and work back toward the faucet so you don't come in contact with the treated area.
4. To BEGIN spraying, point nozzle toward treatment site and
  - a. Bend the safety tab back (located at the right of the yellow dial) with your thumb,
  - b. Using your other hand, QUICKLY turn the dial clockwise until it stops. Water will automatically mix with the product.
5. Spray moss thoroughly. Walk at a steady pace while spraying using an even sweeping motion, slightly overlapping treated areas.
6. To STOP spraying, QUICKLY turn the dial in the opposite direction of "ON" until it stops and the safety tab engages the notch on the valve. Turn water off at faucet. To relieve pressure before removing nozzle from hose, bend the safety tab back and turn dial "ON" until water stops spraying.

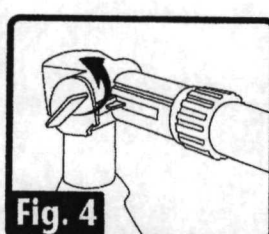
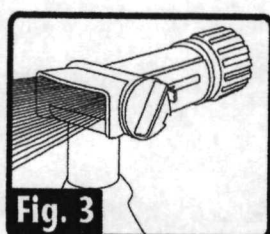
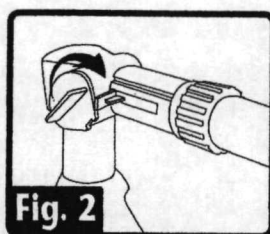
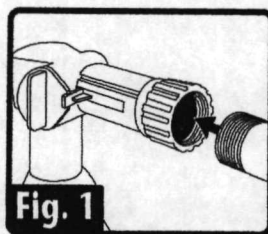
7. To STORE unused product, make sure the dial is in the "OFF" position with safety tab in the valve notch. Place in cool area away from heat, sunlight or open flame.

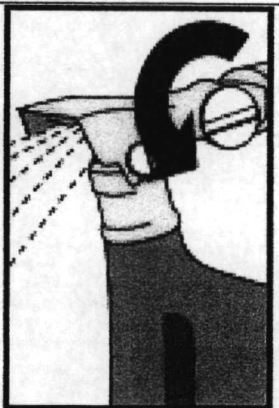

OR

		
<ul style="list-style-type: none"> <li>• Ensure that the large Water Control Knob is turned to the "OFF" position.</li> <li>• Connect sprayer to garden hose.</li> </ul>	<ul style="list-style-type: none"> <li>• Turn the small Product Control Button so that the flat side aligns with the tab on the right side of the button, and push the button all the way in.</li> <li>• Turn on water at faucet.</li> </ul>	<ul style="list-style-type: none"> <li>• To spray, point nozzle where you want to spray and turn the large knob all the way to the left.</li> <li>• To stop spraying, push small Product Control Button in from opposite side. Turn large Water Control Knob to the right to the "OFF" position and turn off faucet.</li> <li>• NOTE: BEFORE DISCONNECTING HOSE (to relieve water pressure): Turn large Water Control Knob to the left; then turn "OFF" again.</li> <li>• Disconnect garden hose from sprayer.</li> <li>• To prevent accidental discharge when not in use, turn the small Product Control Button so that it is <u>NOT</u> aligned with the tab and cannot be pushed in.</li> </ul>



NEU1173H

Page 28 of 56

**What will I see?**

Works quickly. Treated moss or algae will turn brown or black. Occasionally a darkening of the grass leaf blades can occur after treatment, however the grass will recover within a few days to weeks. May stain thatch (dead grass under lawn); this does not affect the health of the grass.

**Use Precautions:**

Do not apply to drought stressed grass; ensure lawn is well watered prior to application. Do not apply when the daytime temperature will exceed 85°F. Do not apply to bentgrass. If unsure of grass sensitivity, test spray a small area of your lawn. Do not apply to newly seeded areas prior to grass seed germination. Avoid spraying desirable plants. Any desirable plants or structures accidentally contacted should be rinsed with water. To avoid staining, wait until treated area dries before re-entry. Do not apply if rainfall is expected within 3 hours of application. Do not irrigate within 3 hours of application. Do not apply to the same area more than 2 times a year.

**STORAGE AND DISPOSAL**

**PESTICIDE STORAGE:** Store this product in its original container and keep in a secure storage area out of reach of children and domestic animals. Store unused material, tightly closed, in original container only, away from open flame.

**PESTICIDE DISPOSAL AND CONTAINER HANDLING:**

Nonrefillable container. Do not reuse or refill this container.

**If empty:** Place in trash or offer for recycling if available.

**If partly filled:** Call your local solid waste agency [or call [insert supplemental distributor's toll free number]] for disposal instructions. Never place unused product down any indoor or outdoor drain.

**BATCH CODE:**

[The following claims and product information, may or may not be presented on the product's label and labeling:

-[www.neudorff.com](http://www.neudorff.com)



- Selective Moss Killer
- Selective Moss Control
- Kills Moss Without Harming Lawn Grasses
- Kills moss not lawns
- Kills moss not grasses
- Lawn Moss Killer
- Lawn Moss Control
- Water-based
- With the provided hose-end sprayer, this container will treat XXX ft<sup>2</sup>

NEU1173H

Page 29 of 56

- Works in cool weather
- Rainfast in 3 hours
- Works fast
- See results the same day
- See results in hours
- Fast and effective
- No unpleasant odor
- Does not contain (2,4-D) (MCPA) (Dicamba) (Mecoprop)
- Derived from iron (Fe)
- For non-selective (moss) weed and grass control, use [H01 or NEU1171H – *insert product name*]
- Eliminates unwanted moss, algae and lichens quickly
- Kills algae, moss and lichens
- Kills moss and algae
- Moss killer
- Moss, algae and lichen killer
- Kills moss fast
- Kills moss, algae, and lichens quickly and effectively
- Kills moss and weeds
- Moss and weed killer for lawns
- Kills moss and weeds, not lawns
- Kills moss and weeds, not grass
- Lawn areas can be re-sown within one day of treatment with NEU1173H
- Can re-seed lawn 1 day after spraying (applying)
- (Controls) (kills) (dandelions) (buttercup) (English daisy) (daisy) (clover)
- One gallon of concentrate will treat up to 10,000 ft<sup>2</sup> (of lawn)
- Treats up to XXXX ft<sup>2</sup> (of lawn)
- Can be used on new lawns (1 week) after grass emergence
- Weed killer for newly planted lawn
- Even works in cool weather
- Also works in cool weathers
- Works in temperatures between 50°F and 85°F (10°C and 29°C)
- Effective at temperatures from 50°F to 85°F (10°C to 29°C)
- Patent pending
- Patent #6,972,273
- (Helpful Hints:) Best results are obtained when applied in the Spring or Fall when environmental conditions are cool and there is ample moisture
- People and pets can enter treated area when spray dries
- Ready-To-Spray
- Hose-End Bottle
- Hose-End Sprayer
- This product is ready to spray. Just attach this bottle to your garden hose according to directions. Water automatically mixes with the concentrate as you spray.]

[Optional warranty statements. Registrant has choice of using any or none.

**-NOTICE TO BUYER**

NEU1173H

Page 30 of 56

Seller warrants that this product conforms to the chemical description on this label and is reasonably fit for the purposes stated in the Directions for Use, subject to the inherent risks described above, when used in accordance with the Directions for Use under normal conditions. To the extent consistent with applicable law, this warranty does not extend to use of this product contrary to label directions, or under abnormal use conditions, or under conditions not reasonably foreseeable to Seller. To the extent consistent with applicable law, the Seller shall not be liable for any such use. To the extent consistent with applicable law, the Seller makes no other warranties, either expressed or implied.

Or

-Buyer assumes all responsibility for safety and use not in accordance with directions.

Or

-Unconditionally Guaranteed by (company name). **OUR COMMITMENT TO YOUR SATISFACTION:** If you are not happy with the way this product works in your garden, please let us know. We will be happy to replace the product, refund your money, or substitute another (brand name) product. Simply send your name, address and proof of purchase to (Company name & address).

Or

(company name) guarantees if for any reason you are not satisfied with this product, mail us proof of purchase to obtain a full refund of your purchase price.]



32/57

## NEU1173H Concentrate

Active Ingredient:

Iron HEDTA (FeHEDTA) .....	26.52%
Other Ingredients:.....	73.48%
<b>Total:.....</b>	<b>100.00%</b>

KEEP OUT OF REACH OF CHILDREN

### CAUTION

FIRST AID	
IF IN EYES	-Hold eye open and rinse slowly and gently with water for 15-20 minutes. -Remove contact lenses, if present, after the first 5 minutes, then continue rinsing eye. -Call a poison control center or doctor for treatment advice.
Have the product container or label with you when calling a poison control center or doctor, or going for treatment.	

### PRECAUTIONARY STATEMENTS

#### HAZARDS TO HUMANS AND DOMESTIC ANIMALS

CAUTION: Causes slight eye irritation. Avoid contact with eyes or clothing. Wash thoroughly with soap and water after handling and before eating, drinking, chewing gum or using tobacco. Prolonged or frequently repeated skin contact may cause allergic reactions in some individuals.

### DIRECTIONS FOR USE

It is a violation of Federal Law to use this product in a manner inconsistent with its labeling.

Read and follow all applicable directions and precautions on this label before using.

**SITES:** Lawns, turf (use on rights of way or non-crop areas), golf courses, parks, playgrounds, cemeteries, athletic fields

#### **Pests:**

[One of the two following Pest and Application Directions sections must be used. on the labels of products sold or distributed in all states, except California. The second section must be used on the labels of products sold or distributed in California:

Controls or suppresses weeds such as but not limited to:

- Black medic (*Medicago lupulina*)

NEU1173H

Page 32 of 56

- Broadleaf plantain (*Plantago major*)
- Bull thistle (*Cirsium vulgare*)
- Canada thistle (*Cirsium arvense*)
- Common chickweed (*Stellaria media*)
- Creeping buttercup (*Ranunculus repens*)
- Dandelion (*Taraxicum officinale*)
- Dovefoot geranium (*Geranium molle*)
- English daisy (*Bellis perennis*)
- False dandelion (*Hypochoeris radicata*)
- Healall (*Prunella vulgaris*)
- Moss, liverworts, algae and lichens
- Narrow-leaved plantain (*Plantago lanceolata*)
- Oxalis (*Oxalis* spp.)
- Persian Speedwell (*Veronica persica*)
- Shepherd's-purse (*Capsella bursa-pastoris*)
- Silverweed cinquefoil (*Potentilla anserina*)
- Slender speedwell (*Veronica filiformis*)
- White clover (*Trifolium repens*)
- Wild chamomile (*Matricaria chamomilla*)

### Application Directions

For Broadcast Treatment:

Rate of Spray Solution	Rate of Concentrate	Weeds Controlled	Area Treated
2.5 ga/1000 ft <sup>2</sup>	12.6 fl. oz/ 1000 ft <sup>2</sup>	Rate for easy-to-control weeds: black medic ( <i>Medicago lupulina</i> ), slender speedwell ( <i>Veronica filiformis</i> ), wild geranium ( <i>Geranium robertianum</i> ) and moss. This rate can also be used for weed seedlings of: false dandelion ( <i>Hypochoeris radicata</i> ), English daisy ( <i>Bellis perennis</i> ), dandelion ( <i>Taraxacum officinale</i> ) or white clover ( <i>Trifolium repens</i> ).	25,400 ft <sup>2</sup> /2.5 ga jug
4.9 ga/1000 ft <sup>2</sup>	25.2 fl. oz/ 1000 ft <sup>2</sup>	<ul style="list-style-type: none"> <li>• Standard rate for control of most weed species: dandelion (<i>Taraxacum officinale</i>), English daisy (<i>Bellis perennis</i>), false dandelion (<i>Hypochoeris radicata</i>), white clover (<i>Trifolium repens</i>), bull thistle (<i>Cirsium vulgare</i>), Canada thistle (<i>Cirsium arvense</i>), common chickweed (<i>Stellaria media</i>), narrow-leaved plantain (<i>Plantago lanceolata</i>), dove's foot geranium (<i>Geranium molle</i>), Oxalis (<i>Oxalis</i> spp.), lawn burweed (<i>Soliva pterosperma</i>), and algae, and for the SUPPRESSION of broad-leaved plantain (<i>Plantago major</i>)</li> </ul>	12,700 ft <sup>2</sup> /2.5 ga jug
9.8 ga/1000 ft <sup>2</sup>	50 fl. oz./ 1000 ft <sup>2</sup>	Rate for tough perennial weeds such as: creeping buttercup ( <i>Ranunculus repens</i> ) and broad-leaved plantain ( <i>Plantago major</i> )	6340 ft <sup>2</sup> /2.5 ga jug

Shake well before using. Mix one part [NEU1173H] with 24 parts water (5 oz. in 1 gallon of water). Apply the mixed solution at a rate of 2.5-10 gallons/1000 ft<sup>2</sup> (2.8-11.5 fluid oz./yard<sup>2</sup>), using the chart to determine how much diluted spray to use per area. Any standard hand-held or backpack sprayer can be used. Thoroughly spray weeds. Use a coarse nozzle setting to reduce drift. Uniform coverage is important.

Repeat treatment in 3 to 4 weeks for best results.

### For Spot Treatment

Shake well before using. Mix one part [NEU1173H] with 24 parts water (5 oz. in 1 gallon of water). Thoroughly spray weeds to point of runoff using any standard hand-held or backpack sprayer. Use a coarse nozzle setting to reduce drift. Repeat treatment in 3 to 4 weeks for best results.

OR

#### Controls weeds:

- Dandelion (*Taraxicum officinale*)
- English daisy (*Bellis perennis*)
- Moss

#### Suppresses weeds:

- White clover (*Trifolium repens*)
- Broadleaf plantain (*Plantago major*)
- Narrow-leaved plantain (*Plantago lanceolata*)
- Creeping buttercup (*Ranunculus repens*)
- Slender speedwell (*Veronica filiformis*)

### Application Directions

Shake well before using. Mix one part [NEU1173H] with 24 parts water (5 oz. in 1 gallon of water). Apply the mixed solution at a rate of 2.5-10 gallons/1000 ft<sup>2</sup> (2.8-11.5 fluid oz./yard<sup>2</sup>). The standard rate for NEU1173H is 5.75 fl. oz./yard<sup>2</sup>; use the higher rate (11.5 fl. oz./yard<sup>2</sup>) on tough perennial weeds, such as buttercup and broad-leaved plantain. NEU1173H may also be used at 2.8 fl.oz./yard<sup>2</sup> (2.5 gallons/1000ft<sup>2</sup>) on moss, black medic, slender speedwell, wild geranium or on weed seedlings of false dandelion, English daisy, dandelion or white clover. Any standard hand-held or backpack sprayer can be used. Thoroughly spray weeds. Use a coarse nozzle setting to reduce drift. Uniform coverage is important.

Repeat treatment in 3 to 4 weeks for best results.

### What will I see?

Works quickly; dying weeds will be seen within hours of application. Treated weeds, moss or algae will turn brown or black. Occasionally a darkening of the grass leaf blades can occur after treatment, however the grass will recover within a few days to weeks. May stain thatch (dead grass under lawn); this does not affect the health of the grass.

### Use Precautions:



NEU1173H

Page 34 of 56

Do not apply to drought stressed grass; ensure lawn is well watered prior to application. Do not apply when the daytime temperature will exceed 85°F. Do not apply to bentgrass. If unsure of grass sensitivity, test spray a small area of your lawn. Do not apply to newly seeded areas prior to grass seed germination. Avoid spraying desirable plants. Any desirable plants or structures accidentally contacted should be rinsed with water. To avoid staining, wait until treated area dries before re-entry. Do not apply if rainfall is expected within 3 hours of application. Do not irrigate within 3 hours of application. Do not apply to the same area more than 4 times a year.

**STORAGE AND DISPOSAL**

Do not contaminate water, food or feed by storage or disposal.

**PESTICIDE STORAGE:** Store in a secure place, away from open fire or flame. Keep container closed and reseal after use. If spilled, use absorbent materials and dispose of in an approved manner.

**PESTICIDE DISPOSAL:** Wastes resulting from the use of this product may be disposed of on site or at an approved waste disposal facility.

**CONTAINER HANDLING:** Nonrefillable container. Do not reuse or refill this container. Triple rinse container (or equivalent) promptly after emptying. Triple rinse as follows:

*(For containers equal to or less than five gallons use these directions:)* Empty the remaining contents into application equipment or a mix tank and drain for 10 seconds after the flow begins to drip. Fill the container  $\frac{1}{4}$  full with water and recap. Shake for 10 seconds. Pour rinsate into application equipment or a mix tank or store rinsate for later use or disposal. Drain for 10 seconds after the flow begins to drip. Repeat this procedure two more times. Offer for recycling, if available.

*(For containers greater than five gallons use these directions:)* Empty the remaining contents into application equipment or a mix tank. Fill the container  $\frac{1}{4}$  full with water. Replace and tighten closures. Tip container on its side and roll it back and forth, ensuring at least one complete revolution, for 30 seconds. Stand the container on its end and tip it back and forth several times. Turn the container over onto its other end and tip it back and forth several times. Empty the rinsate into application equipment or a mix tank or store rinsate for later use or disposal. Repeat this procedure two more times. Offer for recycling, if available.

BATCH CODE:

[The following claims and product information, may or may not be presented on the product's label and labeling:

-[www.neudorff.com](http://www.neudorff.com)



-Weed Killer for Lawns  
-Selective Weed Killer

NEU1173H

Page 35 of 56

- Selective Broadleaf Weed Killer
- Selective Weed Control
- Selective Broadleaf Weed Control
- Selective Control of Weeds in Lawns
- Selective Control of Broadleaf Weeds in Lawns
- Kills weeds not lawns
- Kills weeds not grasses
- Lawn Weed Killer
- Lawn Weed Control
- Water-based
- When diluted, this bottle will treat XXX ft<sup>2</sup>
- Works in cool weather
- Rainfast in 3 hours
- Works fast
- See results the same day
- See results in hours
- Fast and effective
- Mix with water
- No unpleasant odor
- Does not contain (2,4-D) (MCPA) (Dicamba) (Mecoprop)
- Derived from iron (Fe)
- For non-selective (moss) weed and grass control, use [H01 or NEU1171H – *insert product name*]
- Eliminates unwanted moss, algae and lichens quickly
- Kills algae, moss and lichens
- Kills moss and algae
- Moss killer
- Moss, algae and lichen killer
- Kills moss fast
- Kills moss, algae, and lichens quickly and effectively
- Moss and weed killer for lawns
- Lawn areas can be re-sown within one day of treatment with NEU1173H
- Can re-seed lawn 1 day after spraying (applying)
- (Controls) (kills) (dandelions) (buttercup) (English daisy) (daisy) (clover)
- One gallon of concentrate will treat up to 10,000 ft<sup>2</sup> (of lawn)
- Can be used to spot treat problem areas
- Can be used to spot treat problem areas in lawns
- Can be used on new lawns (1 week) after grass emergence
- Even works in cool weather
- Also works in cool weather
- Works in temperatures between 50°F and 85°F (10°C and 29°C)
- Effective at temperatures from 50°F to 85°F (10°C to 29°C)
- Treats up to XXXX ft<sup>2</sup> (of lawn)
- Patent pending
- Patent #6,972,273
- Makes over XX gallons
- 1 ounce = 2 tablespoons = 6 teaspoons
- Kills weeds, down to the root

NEU1173H

Page 36 of 56

-Kills dandelions, down to the root

-(Helpful Hints:) Best results are obtained when applied in the Spring or Fall when environmental conditions are cool and there is ample moisture

-(Helpful Hints:) The best times to treat weeds are in the Spring when they are small and growing and in the Fall to eliminate many of next year's weeds

-People and pets can enter treated area when spray dries]

[Optional warranty statements. Registrant has choice of using any or none.

**-NOTICE TO BUYER**

Seller warrants that this product conforms to the chemical description on this label and is reasonably fit for the purposes stated in the Directions for Use, subject to the inherent risks described above, when used in accordance with the Directions for Use under normal conditions. To the extent consistent with applicable law, this warranty does not extend to use of this product contrary to label directions, or under abnormal use conditions, or under conditions not reasonably foreseeable to Seller. To the extent consistent with applicable law, the Seller shall not be liable for any such use. To the extent consistent with applicable law, the Seller makes no other warranties, either expressed or implied.

Or

-Buyer assumes all responsibility for safety and use not in accordance with directions.

Or

-Unconditionally Guaranteed by (company name). OUR COMMITMENT TO YOUR SATISFACTION: If you are not happy with the way this product works in your garden, please let us know. We will be happy to replace the product, refund your money, or substitute another (brand name) product. Simply send your name, address and proof of purchase to (Company name & address).]

Or

(company name) guarantees if for any reason you are not satisfied with this product, mail us proof of purchase to obtain a full refund of your purchase price.



NEU1173H

Page 37 of 56

**SUBLABEL F – COMMERCIAL USE ON WEEDS – Hose-end Sprayer**

## NEU1173H Concentrate

Active Ingredient:

Iron HEDTA (FeHEDTA) .....	26.52%
Other Ingredients:.....	73.48%
<b>Total:.....</b>	<b>100.00%</b>

**KEEP OUT OF REACH OF CHILDREN**

## CAUTION

FIRST AID	
IF IN EYES	-Hold eye open and rinse slowly and gently with water for 15-20 minutes. -Remove contact lenses, if present, after the first 5 minutes, then continue rinsing eye. -Call a poison control center or doctor for treatment advice.
Have the product container or label with you when calling a poison control center or doctor, or going for treatment.	

### **PRECAUTIONARY STATEMENTS**

#### **HAZARDS TO HUMANS AND DOMESTIC ANIMALS**

CAUTION: Causes slight eye irritation. Avoid contact with eyes or clothing. Wash thoroughly with soap and water after handling and before eating, drinking, chewing gum or using tobacco. Prolonged or frequently repeated skin contact may cause allergic reactions in some individuals.

### **DIRECTIONS FOR USE**

It is a violation of Federal Law to use this product in a manner inconsistent with its labeling.

Read and follow all applicable directions and precautions on this label before using.

**SITES:** Lawns, turf (use on rights of way or non-crop areas), golf courses, parks, playgrounds, cemeteries, athletic fields

#### **Pests:**

[One of the two following sections must be used. The first section may be used on the labels of products sold or distributed in all states, except California. The second section must be used on the labels of products sold or distributed in California:

Controls or suppresses weeds such as but not limited to:

NEU1173H

Page 38 of 56

- Black medic (*Medicago lupulina*)
- Broadleaf plantain (*Plantago major*)
- Bull thistle (*Cirsium vulgare*)
- Canada thistle (*Cirsium arvense*)
- Common chickweed (*Stellaria media*)
- Creeping buttercup (*Ranunculus repens*)
- Dandelion (*Taraxicum officinale*)
- Dovefoot geranium (*Geranium molle*)
- English daisy (*Bellis perennis*)
- False dandelion (*Hypochoeris radicata*)
- Healall (*Prunella vulgaris*)
- Moss, liverworts, algae and lichens
- Narrow-leaved plantain (*Plantago lanceolata*)
- Oxalis (*Oxalis* spp.)
- Persian Speedwell (*Veronica persica*)
- Shepherd's-purse (*Capsella bursa-pastoris*)
- Silverweed cinquefoil (*Potentilla anserina*)
- Slender speedwell (*Veronica filiformis*)
- White clover (*Trifolium repens*)
- Wild chamomile (*Matricaria chamomilla*)

OR

Controls the following weeds: Dandelion, English daisy, and Moss.

Suppresses the following weeds: Broadleaf plantain, Narrow-leaved plantain, White clover, Creeping buttercup and Slender speedwell.]

### Application Directions

Shake well before using. Apply 1 gallon of concentrate to 2500-5000 ft<sup>2</sup>. Apply it to 5000 ft<sup>2</sup> for standard application; apply it to 2500 ft<sup>2</sup> to control tough perennial weeds, such as buttercup and broad-leaved plantain. This container may be applied to up to 10,000 ft<sup>2</sup> to control moss, black medic, slender speedwell, wild geranium or on weed seedlings of false dandelion, English daisy, dandelion or white clover. Uniform coverage is important. Rinse treated areas 24 hours after application. Repeat treatment in 3 to 4 weeks for best results.

[Optional hose-end sprayer directions that may be presented on the container or supplemental wording, either:

Figure 1

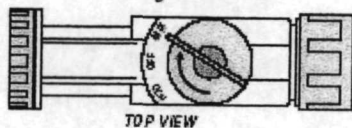

Figure 2



Figure 3

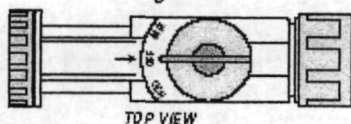
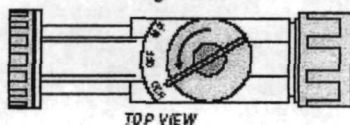

Figure 4



#### To Use This Sprayer:

1. Shake container well.
2. Connect spray nozzle to garden hose.
3. Turn on the water from the faucet. Extend hose to the farthest area to be treated and work back toward the faucet so you don't come in contact with the treated area.
4. When you are ready to spray, turn the knob on top so that it points to the MIX position on the spray head. (Fig. 1)
5. The spray deflector on the front of the hose-end applicator can be rotated to give a stream or fan spray. (Fig. 2)

#### To Stop Spraying

6. When you are finished spraying or if you have to stop spraying at any time, turn the knob back to the OFF position. (Fig. 3)
7. Turn off the water from the faucet.
8. Turn the knob to H2O then OFF, to drain the water from the hose. (Fig. 4)

OR

1. Attach garden hose to spray nozzle. Turn on water supply.



2. Bend safety tab down and turn control to "water".
3. Point nozzle toward plants and turn water control knob to "On". Product will automatically mix with water. Thoroughly spray weeds.

**To Stop Spraying:**

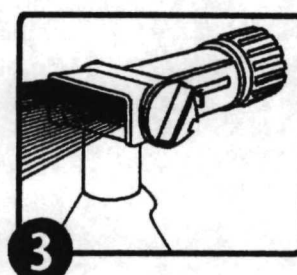
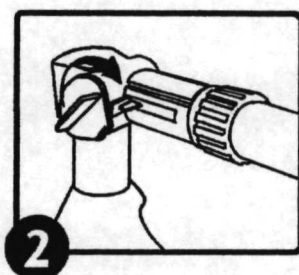
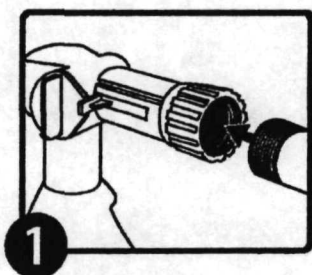

1. When you are finished spraying or if you have to stop spraying at any time, turn the blue knob back to the OFF position.
2. Turn off the water from the faucet.
3. Turn the blue knob to H2O then OFF, to drain the water from the hose.
4. Unscrew spray nozzle from hose. Remove hose end from container.
5. Reseal the container with the child-resistant closure. Rinse the hose-end applicator

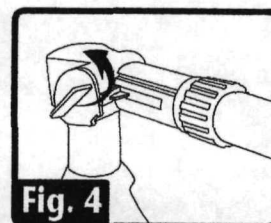
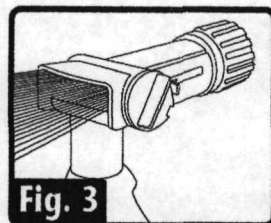
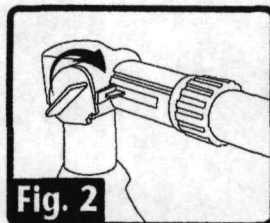
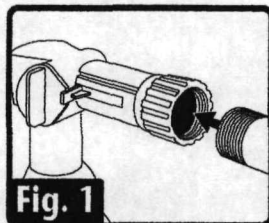

OR

1. Shake container well before using.
2. Connect a garden hose to the Ready Spray nozzle. Make sure the dial on the nozzle is in the "OFF" position with the safety tab in the valve notch.
3. Turn on the water at faucet. Extend hose to the farthest area to be treated and work back toward the faucet so you don't come in contact with the treated area.
4. To BEGIN spraying, point nozzle toward treatment site and
  - a. Bend the safety tab back (located at the right of the yellow dial) with your thumb,
  - b. Using your other hand, QUICKLY turn the dial clockwise until it stops. Water will automatically mix with the product.
5. Spray weeds thoroughly. Walk at a steady pace while spraying using an even sweeping motion, slightly overlapping treated areas.
6. To STOP spraying, QUICKLY turn the dial in the opposite direction of "ON" until it stops and the safety tab engages the notch on the valve. Turn water off at faucet. To relieve pressure before removing nozzle from hose, bend the safety tab back and turn dial "ON" until water stops spraying.
7. To STORE unused product, make sure the dial is in the "OFF" position with safety tab in the valve notch. Place in cool area away from heat, sunlight or open flame.

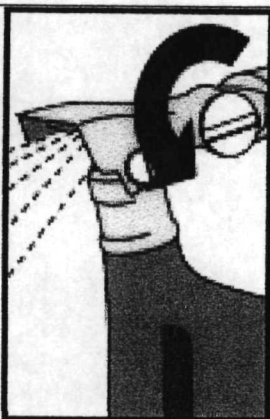

		
<ul style="list-style-type: none"><li>• Ensure that the large Water Control Knob is turned to the "OFF" position.</li><li>• Connect sprayer to garden hose.</li></ul>	<ul style="list-style-type: none"><li>• Turn the small Product Control Button so that the flat side aligns with the tab on the right side of the button, and push the button all the way in.</li><li>• Turn on water at faucet.</li></ul>	<ul style="list-style-type: none"><li>• To spray, point nozzle where you want to spray and turn the large knob all the way to the left.</li><li>• To stop spraying, push small Product Control Button in from opposite side. Turn large Water Control Knob to the right to the "OFF" position and turn off faucet.</li><li>• NOTE: BEFORE DISCONNECTING HOSE (to relieve water pressure): Turn large Water Control Knob to the left; then turn "OFF" again.</li><li>• Disconnect garden hose from sprayer.</li><li>• To prevent accidental discharge when not in use, turn the small Product Control Button so that it is <u>NOT</u> aligned with the tab and cannot be pushed in.</li></ul>

]

### What will I see?

Works quickly; dying weeds will be seen within hours of application. Treated weeds, moss or algae will turn brown or black. Occasionally a darkening of the grass leaf blades can occur after treatment, however the grass will recover within a few days to weeks. May stain thatch (dead grass under lawn); this does not affect the health of the grass.

### Use Precautions:

Do not apply to drought stressed grass; ensure lawn is well watered prior to application. Do not apply when the daytime temperature will exceed 85°F. Do



not apply to bentgrass. If unsure of grass sensitivity, test spray a small area of your lawn. Do not apply to newly seeded areas prior to grass seed germination. Avoid spraying desirable plants. Any desirable plants or structures accidentally contacted should be rinsed with water. To avoid staining, wait until treated area dries before re-entry. Do not apply if rainfall is expected within 3 hours of application. Do not irrigate within 3 hours of application. Do not apply to the same area more than 2 times a year.

**STORAGE AND DISPOSAL**

Do not contaminate water, food or feed by storage or disposal.

**PESTICIDE STORAGE:** Store in a secure place, away from open fire or flame. Keep container closed and reseal after use. If spilled, use absorbent materials and dispose of in an approved manner.

**PESTICIDE DISPOSAL:** Wastes resulting from the use of this product may be disposed of on site or at an approved waste disposal facility.

**CONTAINER HANDLING:** Non-refillable container. Do not reuse or refill this container. Triple rinse container (or equivalent) promptly after emptying. Triple rinse as follows:

*(For containers equal to or less than five gallons use these directions:)* Empty the remaining contents into application equipment or a mix tank and drain for 10 seconds after the flow begins to drip. Fill the container ¼ full with water and recap. Shake for 10 seconds. Pour rinsate into application equipment or a mix tank or store rinsate for later use or disposal. Drain for 10 seconds after the flow begins to drip. Repeat this procedure two more times. Offer for recycling, if available.

*(For containers greater than five gallons use these directions:)* Empty the remaining contents into application equipment or a mix tank. Fill the container ¼ full with water. Replace and tighten closures. Tip container on its side and roll it back and forth, ensuring at least one complete revolution, for 30 seconds. Stand the container on its end and tip it back and forth several times. Turn the container over onto its other end and tip it back and forth several times. Empty the rinsate into application equipment or a mix tank or store rinsate for later use or disposal. Repeat this procedure two more times. Offer for recycling, if available.

**BATCH CODE:**

[The following claims and product information, may or may not be presented on the product's label and labeling:

-[www.neudorff.com](http://www.neudorff.com)



- Weed Killer for Lawns
- Selective Weed Killer
- Selective Broadleaf Weed Killer
- Selective Weed Control

# NEU1173H

Page 44 of 56

- Selective Broadleaf Weed Control
- Selective Control of Weeds in Lawns
- Selective Control of Broadleaf Weeds in Lawns
- Kills weeds not lawns
- Kills weeds not grasses
- Lawn Weed Killer
- Lawn Weed Control
- Water-based
- With the provided hose-end sprayer, this container will treat XXX ft<sup>2</sup>
- Works in cool weather
- Rainfast in 3 hours
- Works fast
- See results the same day
- See results in hours
- Fast and effective
- No unpleasant odor
- Does not contain (2,4-D) (MCPA) (Dicamba) (Mecoprop)
- Derived from iron (Fe)
- For non-selective (moss) weed and grass control, use [NEU1170H or NEU1171H – *insert product name*]
- Eliminates unwanted moss, algae and lichens quickly
- Kills algae, moss and lichens
- Kills moss and algae
- Moss killer
- Moss, algae and lichen killer
- Kills moss fast
- Kills moss, algae, and lichens quickly and effectively
- Moss and weed killer for lawns
- Lawn areas can be re-sown within one day of treatment with NEU1173H
- Can re-seed lawn 1 day after spraying (applying)
- (Controls) (kills) (dandelions) (buttercup) (English daisy) (daisy) (clover)
- One gallon of concentrate will treat up to 10,000 ft<sup>2</sup> (of lawn)
- Can be used on new lawns (1 week) after grass emergence
- Even works in cool weather
- Also works in cool weather
- Works in temperatures between 50°F and 85°F (10°C and 29°C)
- Effective at temperatures from 50°F to 85°F (10°C to 29°C)
- Treats up to XXXX ft<sup>2</sup> (of lawn)
- Patent pending
- Patent #6,972,273
- Kills weeds, down to the root
- Kills dandelions, down to the root
- (Helpful Hints:) Best results are obtained when applied in the Spring or Fall when environmental conditions are cool and there is ample moisture
- (Helpful Hints:) The best times to treat weeds are in the Spring when they are small and growing and in the Fall to eliminate many of next year's weeds
- People and pets can enter treated area when spray dries
- Ready-To-Spray

NEU1173H

Page 45 of 56

-Hose-End Bottle

-Hose-End Sprayer

-This product is ready to spray. Just attach this bottle to your garden hose according to directions. Water automatically mixes with the concentrate as you spray.]

[Optional warranty statements. Registrant has choice of using any or none.

**-NOTICE TO BUYER**

Seller warrants that this product conforms to the chemical description on this label and is reasonably fit for the purposes stated in the Directions for Use, subject to the inherent risks described above, when used in accordance with the Directions for Use under normal conditions. To the extent consistent with applicable law, this warranty does not extend to use of this product contrary to label directions, or under abnormal use conditions, or under conditions not reasonably foreseeable to Seller. To the extent consistent with applicable law, the Seller shall not be liable for any such use. To the extent consistent with applicable law, the Seller makes no other warranties, either expressed or implied.

Or

-Buyer assumes all responsibility for safety and use not in accordance with directions.

Or

-Unconditionally Guaranteed by (company name). **OUR COMMITMENT TO YOUR SATISFACTION:** If you are not happy with the way this product works in your garden, please let us know. We will be happy to replace the product, refund your money, or substitute another (brand name) product. Simply send your name, address and proof of purchase to (Company name & address).]

Or

(company name) guarantees if for any reason you are not satisfied with this product, mail us proof of purchase to obtain a full refund of your purchase price.



## NEU1173H Concentrate

Active Ingredient:

Iron HEDTA (FeHEDTA) .....	26.52%
Other Ingredients: .....	73.48%
<b>Total: .....</b>	<b>100.00%</b>

**KEEP OUT OF REACH OF CHILDREN**

## CAUTION

FIRST AID	
IF IN EYES	-Hold eye open and rinse slowly and gently with water for 15-20 minutes. -Remove contact lenses, if present, after the first 5 minutes, then continue rinsing eye. -Call a poison control center or doctor for treatment advice.
Have the product container or label with you when calling a poison control center or doctor, or going for treatment.	

### **PRECAUTIONARY STATEMENTS**

#### **HAZARDS TO HUMANS AND DOMESTIC ANIMALS**

CAUTION: Causes slight eye irritation. Avoid contact with eyes or clothing. Wash thoroughly with soap and water after handling and before eating, drinking, chewing gum or using tobacco. Prolonged or frequently repeated skin contact may cause allergic reactions in some individuals.

### **DIRECTIONS FOR USE**

It is a violation of Federal Law to use this product in a manner inconsistent with its labeling.

Read and follow all applicable directions and precautions on this label before using.

**PESTS:** Controls moss, algae, lichens, and liverworts growing in lawns and turf.

**SITES:** Lawns, turf (use on rights of way or non-crop areas), golf courses, parks, playgrounds, cemeteries, athletic fields.

### **Application Directions**

Shake well before using.

Mix one part NEU1173H concentrate with 24 parts water (5 oz. in 1 gallon of water). Apply the mixed solution at a rate of 2.5-5 gallons/1000 ft<sup>2</sup> (2.8-5.75

NEU1173H

Page 47 of 56

oz/yard<sup>2</sup>). Any standard hand-held or backpack sprayer can be used. Use a coarse nozzle setting to reduce drift. Uniform coverage is important. Repeat treatment if needed.

### What will I see?

Works quickly. Treated moss or algae will turn brown or black. Occasionally a darkening of the grass leaf blades can occur after treatment, however the grass will recover within a few days to weeks. May stain thatch (dead grass under lawn); this does not affect the health of the grass.

### Use Precautions:

Do not apply to drought stressed grass; ensure lawn is well watered prior to application. Do not apply when the daytime temperature will exceed 85°F. Do not apply to bentgrass. If unsure of grass sensitivity, test spray a small area of your lawn. Do not apply to newly seeded areas prior to grass seed germination. Avoid spraying desirable plants. Any desirable plants or structures accidentally contacted should be rinsed with water. To avoid staining, wait until treated area dries before re-entry. Do not apply if rainfall is expected within 3 hours of application. Do not irrigate within 3 hours of application. Do not apply to the same area more than 4 times a year.

### STORAGE AND DISPOSAL

Do not contaminate water, food or feed by storage or disposal.

**PESTICIDE STORAGE:** Store in a secure place, away from open fire or flame. Keep container closed and reseal after use. If spilled, use absorbent materials and dispose of in an approved manner.

**PESTICIDE DISPOSAL:** Wastes resulting from the use of this product may be disposed of on site or at an approved waste disposal facility.

**CONTAINER HANDLING:** Nonrefillable container. Do not reuse or refill this container. Triple rinse container (or equivalent) promptly after emptying. Triple rinse as follows:

*(For containers equal to or less than five gallons use these directions:)* Empty the remaining contents into application equipment or a mix tank and drain for 10 seconds after the flow begins to drip. Fill the container ¼ full with water and recap. Shake for 10 seconds. Pour rinsate into application equipment or a mix tank or store rinsate for later use or disposal. Drain for 10 seconds after the flow begins to drip. Repeat this procedure two more times. Offer for recycling, if available.

*(For containers greater than five gallons use these directions:)* Empty the remaining contents into application equipment or a mix tank. Fill the container ¼ full with water. Replace and tighten closures. Tip container on its side and roll it back and forth, ensuring at least one complete revolution, for 30 seconds. Stand the container on its end and tip it back and forth several times. Turn the container over onto its other end and tip it back and forth several times. Empty the rinsate into application equipment or a mix tank or store rinsate for later use

or disposal. Repeat this procedure two more times. Offer for recycling, if available.

## BATCH CODE:

[The following claims and product information, may or may not be presented on the product's label and labeling:

-www.neudorff.com



- Selective Moss Killer
- Selective Moss Control
- Kills Moss Without Harming Lawn Grasses
- Kills moss not lawns
- Kills moss not grasses
- Lawn Moss Killer
- Lawn Moss Control
- Water-based
- When diluted, this bottle will treat XXX ft<sup>2</sup>
- Works in cool weather
- Rainfast in 3 hours
- Works fast
- See results the same day
- See results in hours
- Fast and effective
- No unpleasant odor
- Mix with water
- Does not contain (2,4-D) (MCPA) (Dicamba) (Mecoprop)
- Derived from iron (Fe)
- For non-selective (moss) weed and grass control, use [NEU1170H or NEU1171H – *insert product name*]
- Eliminates unwanted moss, algae and lichens quickly
- Kills algae, moss and lichens
- Kills moss and algae
- Moss killer
- Moss, algae and lichen killer
- Kills moss fast
- Kills moss, algae, and lichens quickly and effectively
- Moss and weed killer for lawns
- Lawn areas can be re-sown within one day of treatment with NEU1173H
- (Controls) (kills) (dandelions) (buttercup) (English daisy) (daisy) (clover)
- One gallon of concentrate will treat up to 10,000 ft<sup>2</sup> (of lawn)
- Can be used to spot treat problem areas
- Can be used to spot treat problem areas in lawns
- Can be used on new lawns (1 week) after grass emergence
- Can re-seed lawn 1 day after spraying (applying)



- Even works in cool weather
- Also works in cool weather
- Works in temperatures between 50°F and 85°F (10°C and 29°C)
- Effective at temperatures from 50°F to 85°F (10°C to 29°C)
- Treats up to XXXX ft<sup>2</sup> (of lawn)
- Patent pending
- Patent #6,972,273
- Makes over XX gallons
- 1 ounce = 2 tablespoons = 6 teaspoons
- (Helpful Hints:) Best results are obtained when applied in the Spring or Fall when environmental conditions are cool and there is ample moisture
- People and pets can enter treated area when spray dries]

[Optional warranty statements. Registrant has choice of using any or none.

**-NOTICE TO BUYER**

Seller warrants that this product conforms to the chemical description on this label and is reasonably fit for the purposes stated in the Directions for Use, subject to the inherent risks described above, when used in accordance with the Directions for Use under normal conditions. To the extent consistent with applicable law, this warranty does not extend to use of this product contrary to label directions, or under abnormal use conditions, or under conditions not reasonably foreseeable to Seller. To the extent consistent with applicable law, the Seller shall not be liable for any such use. To the extent consistent with applicable law, the Seller makes no other warranties, either expressed or implied.

Or

-Buyer assumes all responsibility for safety and use not in accordance with directions.

Or

-Unconditionally Guaranteed by (company name). OUR COMMITMENT TO YOUR SATISFACTION: If you are not happy with the way this product works in your garden, please let us know. We will be happy to replace the product, refund your money, or substitute another (brand name) product. Simply send your name, address and proof of purchase to (Company name & address).]

Or

(company name) guarantees if for any reason you are not satisfied with this product, mail us proof of purchase to obtain a full refund of your purchase price.

**NEU1173H Concentrate****Active Ingredient:**

Iron HEDTA (FeHEDTA) .....	26.52%
Other Ingredients:.....	73.48%
<b>Total:.....</b>	<b>100.00%</b>

**KEEP OUT OF REACH OF CHILDREN****CAUTION**

<b>FIRST AID</b>	
<b>IF IN EYES</b>	-Hold eye open and rinse slowly and gently with water for 15-20 minutes. -Remove contact lenses, if present, after the first 5 minutes, then continue rinsing eye. -Call a poison control center or doctor for treatment advice.
Have the product container or label with you when calling a poison control center or doctor, or going for treatment.	

**PRECAUTIONARY STATEMENTS****HAZARDS TO HUMANS AND DOMESTIC ANIMALS**

**CAUTION:** Causes moderate eye irritation. Avoid contact with eyes or clothing. Wash thoroughly with soap and water after handling and before eating, drinking, chewing gum or using tobacco. Prolonged or frequently repeated skin contact may cause allergic reactions in some individuals.

**DIRECTIONS FOR USE**

It is a violation of Federal Law to use this product in a manner inconsistent with its labeling.

Read and follow all applicable directions and precautions on this label before using.

**PESTS:** Controls moss, algae, lichens, and liverworts growing in lawns and turf.

**SITES:** Lawns, turf (use on rights of way or non-crop areas), golf courses, parks, playgrounds, cemeteries, athletic fields.

**Application Directions**

Shake well before using. Apply 1 gallon of concentrate to 5000-10,000 ft<sup>2</sup>. Uniform coverage is important. Rinse treated areas 24 hours after application. Repeat treatment if needed.

[Optional hose-end sprayer directions that may be presented on the container or supplemental wording, either:

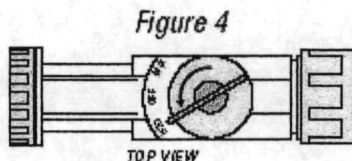
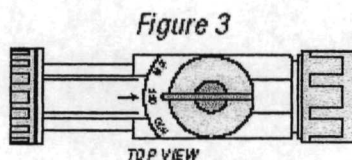
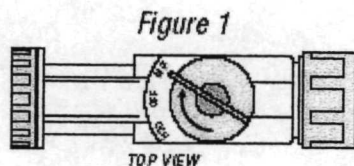

#### To Use This Sprayer:

1. Shake container well.
2. Connect spray nozzle to garden hose.
3. Turn on the water from the faucet. Extend hose to the farthest area to be treated and work back toward the faucet so you don't come in contact with the treated area.
4. When you are ready to spray, turn the knob on top so that it points to the MIX position on the spray head. (Fig. 1)
5. The spray deflector on the front of the hose-end applicator can be rotated to give a stream or fan spray. (Fig. 2)

#### To Stop Spraying:

1. When you are finished spraying or if you have to stop spraying at any time, turn the knob back to the OFF position. (Fig. 3)
2. Turn off the water from the faucet.
3. Turn the knob to H2O then OFF, to drain the water from the hose. (Fig. 4)



OR

1. Attach garden hose to spray nozzle. Turn on water supply.
2. Bend safety tab down and turn control to "water".
3. Point nozzle toward plants and turn water control knob to "On". Product will automatically mix with water. Spray moss thoroughly.

#### To Stop Spraying

1. When you are finished spraying or if you have to stop spraying at any time, turn the blue knob back to the OFF position.
2. Turn off the water from the faucet.
3. Turn the blue knob to H2O then OFF, to drain the water from the hose.
4. Unscrew spray nozzle from hose. Remove hose end from container.
5. Reseal the container with the child-resistant closure. Rinse the hose-end applicator

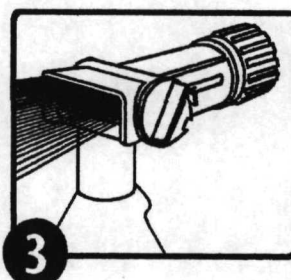
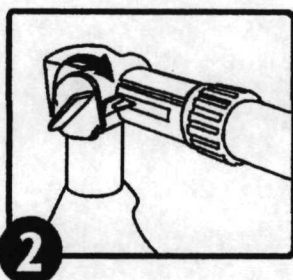
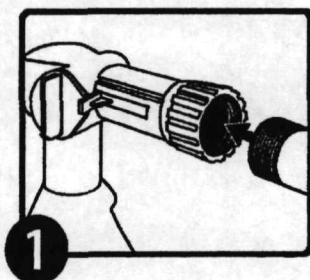

OR



1. Shake container well before using.
2. Connect a garden hose to the Ready Spray nozzle. Make sure the dial on the nozzle is in the "OFF" position with the safety tab in the valve notch.
3. Turn on the water at faucet. Extend hose to the farthest area to be treated and work back toward the faucet so you don't come in contact with the treated area.
4. To BEGIN spraying, point nozzle toward treatment site and
  - a. Bend the safety tab back (located at the right of the yellow dial) with your thumb,
  - b. Using your other hand, QUICKLY turn the dial clockwise until it stops. Water will automatically mix with the product.
5. Spray moss thoroughly. Walk at a steady pace while spraying using an even sweeping motion, slightly overlapping treated areas.
6. To STOP spraying, QUICKLY turn the dial in the opposite direction of "ON" until it stops and the safety tab engages the notch on the valve. Turn water off at faucet. To relieve pressure before removing nozzle from

hose, bend the safety tab back and turn dial "ON" until water stops spraying.

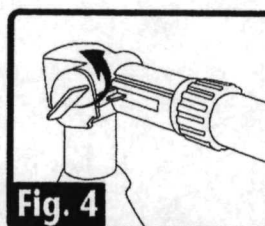
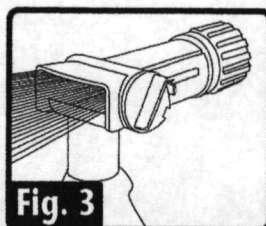
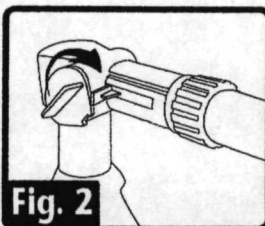
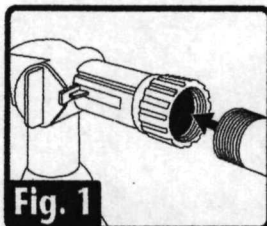
7. To STORE unused product, make sure the dial is in the "OFF" position with safety tab in the valve notch. Place in cool area away from heat, sunlight or open flame.

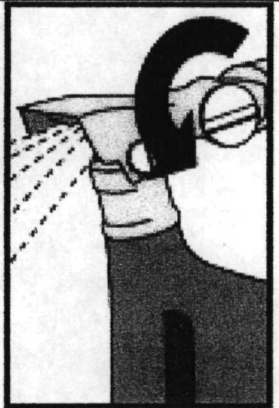

OR

		
<ul style="list-style-type: none"> <li>• Ensure that the large Water Control Knob is turned to the "OFF" position.</li> <li>• Connect sprayer to garden hose.</li> </ul>	<ul style="list-style-type: none"> <li>• Turn the small Product Control Button so that the flat side aligns with the tab on the right side of the button, and push the button all the way in.</li> <li>• Turn on water at faucet.</li> </ul>	<ul style="list-style-type: none"> <li>• To spray, point nozzle where you want to spray and turn the large knob all the way to the left.</li> <li>• To stop spraying, push small Product Control Button in from opposite side. Turn large Water Control Knob to the right to the "OFF" position and turn off faucet.</li> <li>• NOTE: BEFORE DISCONNECTING HOSE (to relieve water pressure): Turn large Water Control Knob to the left; then turn "OFF" again.</li> <li>• Disconnect garden hose from sprayer.</li> <li>• To prevent accidental discharge when not in use, turn the small Product Control Button so that it is <u>NOT</u> aligned with the tab and cannot be pushed in.</li> </ul>

### What will I see?

Works quickly. Treated moss or algae will turn brown or black. Occasionally a darkening of the grass leaf blades can occur after treatment, however the grass will recover within a few days to weeks. May stain thatch (dead grass under lawn); this does not affect the health of the grass.

### Use Precautions:

Do not apply to drought stressed grass; ensure lawn is well watered prior to application. Do not apply when the daytime temperature will exceed 85°F. Do not apply to bentgrass. If unsure of grass sensitivity, test spray a small area of your lawn. Do not apply to newly seeded areas prior to grass seed germination. Avoid spraying desirable plants. Any desirable plants or structures accidentally contacted should be rinsed with water. To avoid staining, wait until treated area dries before re-entry. Do not apply if rainfall is expected within 3 hours of application. Do not irrigate within 3 hours of application. Do not apply to the same area more than 2 times a year.

### STORAGE AND DISPOSAL

Do not contaminate water, food or feed by storage or disposal.

**PESTICIDE STORAGE:** Store in a secure place, away from open fire or flame. Keep container closed and reseal after use. If spilled, use absorbent materials and dispose of in an approved manner.

**PESTICIDE DISPOSAL:** Wastes resulting from the use of this product may be disposed of on site or at an approved waste disposal facility.

**CONTAINER HANDLING:** Nonrefillable container. Do not reuse or refill this container. Triple rinse container (or equivalent) promptly after emptying. Triple rinse as follows:

*(For containers equal to or less than five gallons use these directions:)* Empty the remaining contents into application equipment or a mix tank and drain for 10 seconds after the flow begins to drip. Fill the container ¼ full with water and recap. Shake for 10 seconds. Pour rinsate into application equipment or a mix tank or store rinsate for later use or disposal. Drain for 10 seconds after the flow begins to drip. Repeat this procedure two more times. Offer for recycling, if available.

*(For containers greater than five gallons use these directions:)* Empty the remaining contents into application equipment or a mix tank. Fill the container ¼ full with water. Replace and tighten closures. Tip container on its side and roll it back and forth, ensuring at least one complete revolution, for 30 seconds. Stand the container on its end and tip it back and forth several times. Turn the container over onto its other end and tip it back and forth several times. Empty the rinsate into application equipment or a mix tank or store rinsate for later use or disposal. Repeat this procedure two more times. Offer for recycling, if available.



[The following claims and product information, may or may not be presented on the product's label and labeling:  
-www.neudorff.com



- Selective Moss Killer
- Selective Moss Control
- Kills Moss Without Harming Lawn Grasses
- Kills moss not lawns
- Kills moss not grasses
- Lawn Moss Killer
- Lawn Moss Control
- Water-based
- With the provided hose-end sprayer, this container will treat XXX ft<sup>2</sup>
- Works in cool weather
- Rainfast in 3 hours
- Works fast
- See results the same day
- See results in hours
- Fast and effective
- No unpleasant odor
- Mix with water
- Does not contain (2,4-D) (MCPA) (Dicamba) (Mecoprop)
- Derived from iron (Fe)
- For non-selective (moss) weed and grass control, use [NEU1170H or NEU1171H – *insert product name*]
- Eliminates unwanted moss, algae and lichens quickly
- Kills algae, moss and lichens
- Kills moss and algae
- Moss killer
- Moss, algae and lichen killer
- Kills moss fast
- Kills moss, algae, and lichens quickly and effectively
- Moss and weed killer for lawns
- Lawn areas can be re-sown within one day of treatment with NEU1173H
- Can re-seed lawn 1 day after spraying (applying)
- (Controls) (kills) (dandelions) (buttercup) (English daisy) (daisy) (clover)
- One gallon of concentrate will treat up to 10,000 ft<sup>2</sup> (of lawn)
- Can be used on new lawns (1 week) after grass emergence
- Even works in cool weather
- Also works in cool weather
- Works in temperatures between 50°F and 85°F (10°C and 29°C)
- Effective at temperatures from 50°F to 85°F (10°C to 29°C)
- Treats up to XXXX ft<sup>2</sup> (of lawn)

NEU1173H

Page 56 of 56

-Patent pending

-Patent #6,972,273

-(Helpful Hints:) Best results are obtained when applied in the Spring or Fall when environmental conditions are cool and there is ample moisture

-(Helpful Hints:) The best times to treat weeds are in the Spring when they are small and growing and in the Fall to eliminate many of next year's weeds

-People and pets can enter treated area when spray dries

-Ready-To-Spray

-Hose-End Bottle

-Hose-End Sprayer

-This product is ready to spray. Just attach this bottle to your garden hose according to directions. Water automatically mixes with the concentrate as you spray.]

[Optional warranty statements. Registrant has choice of using any or none.

### **-NOTICE TO BUYER**

Seller warrants that this product conforms to the chemical description on this label and is reasonably fit for the purposes stated in the Directions for Use, subject to the inherent risks described above, when used in accordance with the Directions for Use under normal conditions. To the extent consistent with applicable law, this warranty does not extend to use of this product contrary to label directions, or under abnormal use conditions, or under conditions not reasonably foreseeable to Seller. To the extent consistent with applicable law, the Seller shall not be liable for any such use. To the extent consistent with applicable law, the Seller makes no other warranties, either expressed or implied.

Or

-Buyer assumes all responsibility for safety and use not in accordance with directions.

Or

-Unconditionally Guaranteed by (company name). OUR COMMITMENT TO YOUR SATISFACTION: If you are not happy with the way this product works in your garden, please let us know. We will be happy to replace the product, refund your money, or substitute another (brand name) product. Simply send your name, address and proof of purchase to (Company name & address).]

Or

(company name) guarantees if for any reason you are not satisfied with this product, mail us proof of purchase to obtain a full refund of your purchase price.