



UNITED STATES ENVIRONMENTAL PROTECTION AGENCY
WASHINGTON, D.C. 20460

OFFICE OF CHEMICAL SAFETY
AND POLLUTION PREVENTION

May 11, 2011

W. Neudorff GmbH KG
c/o Walter G. Talarek, P.C.
1008 Riva Ridge Drive
Great Falls, VA 22066-1620

RE: Product Name: NEU1173H Concentrate
EPA Reg. No.: 67702-26
Application for Label Notification dated May 2, 2011 to add the same
optional pest section for products sold and distributed in California only
that is found in sublabels A and B to sublabel E.

Dear Mr. Talarek:

The Biopesticides and Pollution Prevention Division is in receipt of your application for Notification under PR Notice 98-10 dated above. A preliminary screen of this request has been conducted for its applicability under PR Notice 98-10 and it has been determined that the action(s) requested falls within the scope of PR Notice 98-10. Our records have been duly noted, and the label submitted with this application has been stamped "Notification Accepted" and will be placed accordingly in our records.

If you have any questions concerning this action, please feel free to contact Mr. Colin Walsh at (703) 308-0298 or via email at walsh.colin@epa.gov.

Sincerely,

Linda A. Hollis

Linda A. Hollis, Chief
Biochemical Pesticides Branch
Biopesticides and Pollution Prevention
Division (7511P)



United States
Environmental Protection Agency
Washington, DC 20460

☐ Registration
☐ Amendment
☒ Other

OPP Identifier Number

Application for Pesticide - Section I

1. Company/Product Number 67702-26	2. EPA Product Manager Linda Hollis	3. Proposed Classification <input checked="" type="checkbox"/> None <input type="checkbox"/> Restricted
4. Company/Product (Name) NEU1173H Concentrate	PM# 91	
5. Name and Address of Applicant (Include ZIP Code) W. Neudorff GmbH KG c/o Walter G. Talarek PC 1008 Riva Ridge Drive Great Falls, VA 22066-1620 <input type="checkbox"/> Check if this is a new address	6. Expedited Review. In accordance with FIFRA Section 3(c)(3) (b)(i), my product is similar or identical in composition and labeling to: EPA Reg. No. 67702-26 Product Name NEU1173H Concentrate	

Section - II

<input type="checkbox"/> Amendment - Explain below.	<input type="checkbox"/> Final printed labels in response to Agency letter dated _____	Notification Accepted Date: MAY 11 2011 Reviewer: C. Walsh
<input type="checkbox"/> Resubmission in response to Agency letter dated _____	<input type="checkbox"/> "Me Too" Application.	
<input checked="" type="checkbox"/> Notification - Explain below.	<input type="checkbox"/> Other - Explain below.	

Explanation: Use additional page(s) if necessary. (For section I and Section II.)

Notification under PR Notice 98-10 which makes revisions to the product's label. See the enclosed letter to Ms. Linda Hollis, PM 91, for a full explanation of the amendment and the certification required by PR Notice 98-10.

Section - III

1. Material This Product Will Be Packaged In:				2. Type of Container	
Child-Resistant Packaging <input type="checkbox"/> Yes* <input type="checkbox"/> No	Unit Packaging <input type="checkbox"/> Yes <input type="checkbox"/> No	Water Soluble Packaging <input type="checkbox"/> Yes <input type="checkbox"/> No	<input type="checkbox"/> Metal <input type="checkbox"/> Plastic <input type="checkbox"/> Glass <input type="checkbox"/> Paper <input type="checkbox"/> Other (Specify) _____		
* Certification must be submitted					
If "Yes" Unit Packaging wgt.		No. per container			
If "Yes" Package wgt		No. per container			
3. Location of Net Contents Information <input type="checkbox"/> Label <input type="checkbox"/> Container		4. Size(s) Retail Container		5. Location of Label Directions <input type="checkbox"/> On Label <input type="checkbox"/> On Labeling accompanying product	
6. Manner in Which Label is Affixed to Product <input type="checkbox"/> Lithograph <input type="checkbox"/> Paper glued <input type="checkbox"/> Stenciled		<input type="checkbox"/> Other _____			

Section - IV

1. Contact Point (Complete items directly below for identification of individual to be contacted, if necessary, to process this application.)					
Name Walter G. Talarek		Title Authorized Agent		Telephone No. (Include Area Code) 703-759-4837	
Certification I certify that the statements I have made on this form and all attachments thereto are true, accurate and complete. I acknowledge that any knowingly false or misleading statement may be punishable by fine or imprisonment or both under applicable law.					6. Date Application Received (Stamped)
2. Signature 		3. Title Authorized Agent			
4. Typed Name Walter G. Talarek		5. Date May 2, 2011			

LAW OFFICES OF
WALTER G. TALAREK, P.C.

1008 RIVA RIDGE DRIVE
GREAT FALLS, VA 22066-1620

PHONE: 703-759-4837

FAX: 703-759-5548

E-MAIL: WTALAREK@VERIZON.NET

May 2, 2011

DELIVERED BY COURIER

Linda Hollis, PM 91

Biopesticides and Pollution Prevention Division

c/o Document Processing Desk (NOTIF)

Office of Pesticide Programs (7504P)

U.S. Environmental Protection Agency

Room S-4900, One Potomac Yard

2777 S. Crystal Drive

Arlington, VA 22202

Re: NEU1173H Concentrate
EPA Reg. No. 67702-26
Notification

Dear Ms. Hollis:

Please find enclosed W. Neudorff GmbH KG's ("Neudorff's") application for a notification under PR Notice 98-10 regarding its registration for NEU1173H Concentrate, EPA Reg. No. 67702-26. In essence, the notification adds an option to Sublabel E for the use of one of two pests sections. One pests section must be used on labels of products sold or distributed in California. This option was approved previously by notification for Sublabels A and B for this product. See the EPA letter dated October 7, 2010.

Two (2) copies of the revised label are enclosed for your review. One (1) copy of the revised label has the proposed changes highlighted in yellow for your convenience in reviewing this application.

This is a notification of label changes under PR Notice 98-10. This notification is consistent with the provisions of PR Notice 98-10 and EPA regulations at 40 CFR 156.10 and 152.46, and no other changes have been made to the labeling or the confidential statement of formula of this product. I understand that it is a violation of 18 U.S.C. Sec. 1001 to willfully make any false statement to EPA. I further understand that if this notification is not consistent with the terms of PR Notice 98-10, and 40 CFR 156.10 and 152.46, this product may be in violation of FIFRA and I may be subject to enforcement action and penalties under sections 12 and 14 of FIFRA.

MASTER LABEL

NEU1173H Concentrate

Notification Accepted

Active Ingredient:

Iron HEDTA (FeHEDTA) 26.52%

Other Ingredients:..... 73.48%

Total:..... 100.00%

Date: MAY 11 2011

Reviewer: C. Walsh

SUBLABEL A: Household use on Weeds

SUBLABEL B: Household use on Weeds – Hose-end Sprayer

SUBLABEL C: Household use on Moss

SUBLABEL D: Household use on Moss – Hose-end Sprayer

SUBLABEL E: Commercial use on Weeds

SUBLABEL F: Commercial use on Weeds – Hose-end Sprayer

SUBLABEL G: Commercial use on Moss

SUBLABEL H: Commercial use on Moss – Hose-end Sprayer

EPA REG. NO. 67702-26

EPA EST. 67702-DEU-1

**KEEP OUT OF REACH OF CHILDREN
CAUTION**

Registrant: W. Neudorff GmbH KG
An der Muhle 3, Postfach 1209
D-31860 Emmerthal, Germany
www.neudorff.com

Household Use: NET CONTENTS: 5 fl. oz., 10 fl. oz. (two 5 fl. oz. bottles), 12 fl. oz., 15 fl. oz., 16 fl. oz., 20 fl. oz., 24 fl. oz., 32 fl. oz., 1 gallon, 227 gallons

Commercial Use: NET CONTENTS: 1 gallon, 2.5 gallons, 5 gallons, 10 gallons, 20 gallons, 40 gallons, 45 gallons, 50 gallons, 200 gallons, 227 gallons



NEU1173H Concentrate

Active Ingredient:

Iron HEDTA (FeHEDTA)	26.52%
Other Ingredients:.....	73.48%
Total:.....	100.00%

KEEP OUT OF REACH OF CHILDREN

CAUTION

FIRST AID	
IF IN EYES	-Hold eye open and rinse slowly and gently with water for 15-20 minutes. -Remove contact lenses, if present, after the first 5 minutes, then continue rinsing eye. -Call a poison control center or doctor for treatment advice.
Have the product container or label with you when calling a poison control center or doctor, or going for treatment. [Optionally, supplemental distributor's may use the following wording and own toll-free hotline number: For medical emergency information, you may call toll free 1-XXX-XXX-XXXX [insert operating hours and days of service]	

PRECAUTIONARY STATEMENTS

HAZARDS TO HUMANS AND DOMESTIC ANIMALS

CAUTION: Causes slight eye irritation. Avoid contact with eyes or clothing. Wash thoroughly with soap and water after handling and before eating, drinking, chewing gum or using tobacco. Prolonged or frequently repeated skin contact may cause allergic reactions in some individuals.

[One of the two following formats must be used:

Format 1:

DIRECTIONS FOR USE

It is a violation of Federal Law to use this product in a manner inconsistent with its labeling.

Use Sites:

Use to selectively control/suppress broadleaf weeds growing in lawns

Pests:

[One of the two following sections must be used. The first section may be used on the labels of products sold or distributed in all states, except California. The

7/57
NEU1173H

Page 3 of 53

second section must be used on the labels of products sold or distributed in California:

Controls or suppresses the following weeds such as but not limited to: Dandelion, English daisy, False dandelion, White clover, Black medic, Bull thistle, Canada thistle, Common chickweed, Creeping buttercup, Persian Speedwell, Slender speedwell, Broadleaf plantain, Narrow-leaved plantain, Dovefoot geranium, Healall, Shepherd's-purse, Silverweed cinquefoil, Wild chamomile, Moss, Liverworts, Algae, Lichens.

OR

Controls the following weeds: Dandelion, English daisy, and Moss.

Suppresses the following weeds: Broadleaf plantain, Narrow-leaved plantain, White clover, Creeping buttercup and Slender speedwell]

Application Directions

Shake well before using. Mix one part [NEU1173H] with 24 parts water (5 oz. in 1 gallon of water). Apply the mixed solution at a rate of 5-10 gallons/1000 ft² (5.75-11.5 fluid oz./yard²). Any standard hand-held or backpack sprayer can be used. Thoroughly spray weeds. Use a coarse nozzle setting to reduce drift. Uniform coverage is important.

Repeat treatment in 3 to 4 weeks for best results.

What will I see?

Works quickly; dying weeds will be seen within hours of application. Treated weeds, moss or algae will turn brown or black. Occasionally a darkening of the grass leaf blades can occur after treatment, however the grass will recover within a few days to weeks. May stain thatch (dead grass under lawn); this does not affect the health of the grass.

Use Precautions:

Do not apply to drought stressed grass; ensure lawn is well watered prior to application. Do not apply when the daytime temperature will exceed 85°F. Do not apply to bentgrass. If unsure of grass sensitivity, test spray a small area of your lawn. Do not apply to newly seeded areas prior to grass seed germination. Avoid spraying desirable plants. Any desirable plants or structures accidentally contacted should be rinsed with water. To avoid staining, wait until treated area dries before re-entry. Do not apply if rainfall is expected within 3 hours of application. Do not irrigate within 3 hours of application. Do not apply to the same area more than 4 times a year.

OR

Format 2:

DIRECTIONS FOR USE	
It is a violation of Federal Law to use this product in a manner inconsistent with its labeling.	
BEFORE YOU USE	Shake well before using.
WHERE TO USE	Use to selectively control/suppress broadleaf weeds growing in lawns
HOW TO USE	Mix 5 fl. oz. of Bayer Advanced Natria Lawn Weed Control Concentrate into 1 gallon of water. Apply the mixed solution at a rate of 0.5 - 1 gallon/100 sq. ft. Any standard hand-held or backpack sprayer can be used. Thoroughly spray weeds. Use a coarse nozzle setting to reduce drift. Uniform coverage is important.
WHAT WILL I SEE?	Works quickly; dying weeds will be seen within hours of application. Treated weeds or moss will turn brown or black. Occasionally a darkening of the grass leaf blades can occur after treatment; however, the grass will recover within a few days to weeks. May stain thatch (dead grass under lawn); this does not affect the health of the grass.
PESTS (WEEDS, MOSS & ALGAE)	[insert one of pests sections from Directions for Use above]
USE PRECAUTIONS	<ul style="list-style-type: none">• Do not apply to drought stressed grass. Ensure that lawn is well watered prior to application.• Do not apply when the daytime temperature will exceed 85 °F.• Do not apply to bentgrass.• If unsure of grass sensitivity, test spray a small area of your lawn.• Do not apply to newly seeded areas prior to grass seed germination.• Avoid spraying desirable plants. Any desirable plants or structures accidentally contacted should be rinsed with water.• To avoid staining, wait until treated area dried before re-entry.• Do not apply if rainfall is expected within 3 hours of application. Do not irrigate within 3 hours of application.• Do not apply to the same area more than 4 times a year.

STORAGE AND DISPOSAL

PESTICIDE STORAGE: Store this product in its original container and keep in a secure storage area out of reach of children and domestic animals. Store unused material, tightly closed, in original container only, away from open flame.

PESTICIDE DISPOSAL AND CONTAINER HANDLING:

Nonrefillable container. Do not reuse or refill this container.

If empty: Place in trash or offer for recycling if available.

If partly filled: Call your local solid waste agency [or call [insert supplemental distributor's toll free number]] for disposal instructions. Never place unused product down any indoor or outdoor drain.

BATCH CODE:

[The following claims and product information, may or may not be presented on the product's label and labeling:

-www.neudorff.com



- Weed Killer for Lawns
- Selective Weed Killer
- Selective Broadleaf Weed Killer
- Selective Weed Control
- Selective Broadleaf Weed Control
- Selective Control of Weeds in Lawns
- Selective Control of Broadleaf Weeds in Lawns
- Kills weeds not lawns
- Kills weeds not grasses
- Lawn Weed Killer
- Lawn Weed Control
- Water-based
- When diluted, this bottle will treat XXX ft²
- Works in cool weather
- Rainfast in 3 hours
- Works fast
- See results the same day
- See results in hours
- Fast and effective
- Mix with water
- No unpleasant odor
- Does not contain (2,4-D) (MCPA) (Dicamba) (Mecoprop)
- Derived from iron (Fe)
- For non-selective (moss) weed and grass control, use [H01 or NEU1171H – *insert product name*]
- Eliminates unwanted moss, algae and lichens quickly

NEU1173H

Page 6 of 53

- Kills algae, moss and lichens
- Kills moss and algae
- Moss killer
- Moss, algae and lichen killer
- Kills moss fast
- Kills moss, algae, and lichens quickly and effectively
- Can be used on new lawns (1 week) after grass emergence
- Lawn areas can be re-sown within one day of treatment with NEU1173H
- (Controls) (kills) (dandelions) (buttercup) (English daisy) (daisy) (clover)
- One gallon of concentrate will treat up to 5000 ft² (of lawn)
- Can be used to spot treat problem areas
- Can be used to spot treat problem areas in lawns
- Can be used on new lawns (1 week) after grass emergence
- Even works in cool weather
- Also works in cool weather
- Patent pending
- Patent #6,972,273
- Makes over XX gallons
- 1 ounce = 2 tablespoons = 6 teaspoons
- Kills weeds, down to the root
- Kills dandelions, down to the root
- (Helpful Hints:) Best results are obtained when applied in the Spring or Fall when environmental conditions are cool and there is ample moisture
- (Helpful Hints:) The best times to treat weeds are in the Spring when they are small and growing and in the Fall to eliminate many of next year's weeds
- People and pets can enter treated area when spray dries
- Controls broadleaf weeds in lawns
- NEU1173H is a herbicide derived from iron that is used to selectively control/suppress broadleaf weeds growing in lawns
- See side panel for mixing instructions.
- See bottle label inside for complete "directions for use".
- Includes two 5 fl. oz. bottles. Makes 2 gallons [of spray]
- Value [package]. Makes 2 gallons [of spray]
- [Open box] [Box contains 2 bottles of product]
- Refer to leaflet for complete [First Aid], [Directions for Use], [Precautionary Statements], and [Storage and Disposal Instructions]
- READ THE LABEL FIRST!**

QUICK FACTS

- Kills Weeds Not Lawns
- Derived from Iron
- Even Works in Cool Weather.
- Can be Used on New Lawns 1 Week After Grass Emergence

CONTROLS

- Dandelion, Common Chickweed, Clover and other Listed Broadleaf Weeds
- Moss, Algae and Lichens

WHERE TO USE	• On lawns (do not apply to bentgrass)
[phone graphic]	For questions or comments, call toll-free 1-877-BayerAG (1-877-229-3724).

]

[Optional warranty statements. Registrant has choice of using any or none.

-NOTICE TO BUYER

Seller warrants that this product conforms to the chemical description on this label and is reasonably fit for the purposes stated in the Directions for Use, subject to the inherent risks described above, when used in accordance with the Directions for Use under normal conditions. To the extent consistent with applicable law, this warranty does not extend to use of this product contrary to label directions, or under abnormal use conditions, or under conditions not reasonably foreseeable to Seller. To the extent consistent with applicable law, the Seller shall not be liable for any such use. To the extent consistent with applicable law, the Seller makes no other warranties, either expressed or implied.

Or

-Buyer assumes all responsibility for safety and use not in accordance with directions.

Or

-Unconditionally Guaranteed by (company name). **OUR COMMITMENT TO YOUR SATISFACTION:** If you are not happy with the way this product works in your garden, please let us know. We will be happy to replace the product, refund your money, or substitute another (brand name) product. Simply send your name, address and proof of purchase to (Company name & address).

Or

(company name) guarantees if for any reason you are not satisfied with this product, mail us proof of purchase to obtain a full refund of your purchase price.

OR

Warranty:

Seller warrants that this product conforms to the chemical description on this label and is reasonably fit for purposes stated on this label only when used in accordance with directions under normal use conditions. To the fullest extent permitted by law, the seller shall not be liable for damages caused by buyer's use of product contrary to label directions, or under abnormal use conditions, or

NEU1173H

Page 8 of 53

under conditions not reasonably foreseeable to seller. Seller makes no other warranties, either expressed or implied.

OR

Money Back Guarantee: If you are not satisfied with this product, we will gladly refund your original purchase price.

]

SUBLABEL B – HOUSEHOLD USE ON WEEDS – Hose-end Sprayer

NEU1173H Concentrate

Active Ingredient:

Iron HEDTA (FeHEDTA)	26.52%
Other Ingredients:.....	73.48%
Total:.....	100.00%

KEEP OUT OF REACH OF CHILDREN

CAUTION

FIRST AID	
IF IN EYES	-Hold eye open and rinse slowly and gently with water for 15-20 minutes. -Remove contact lenses, if present, after the first 5 minutes, then continue rinsing eye. -Call a poison control center or doctor for treatment advice.
Have the product container or label with you when calling a poison control center or doctor, or going for treatment.	

PRECAUTIONARY STATEMENTS

HAZARDS TO HUMANS AND DOMESTIC ANIMALS

CAUTION: Causes slight eye irritation. Avoid contact with eyes or clothing. Wash thoroughly with soap and water after handling and before eating, drinking, chewing gum or using tobacco. Prolonged or frequently repeated skin contact may cause allergic reactions in some individuals.

DIRECTIONS FOR USE

It is a violation of Federal Law to use this product in a manner inconsistent with its labeling.

Use Sites:

Use to selectively control/suppress broadleaf weeds growing in lawns

Pests:

[One of the two following sections must be used. The first section may be used on the labels of products sold or distributed in all states, except California. The second section must be used on the labels of products sold or distributed in California:

Controls or suppresses the following weeds such as but not limited to: Dandelion, English daisy, False dandelion, White clover, Black medic, Bull thistle, Canada thistle, Common chickweed, Creeping buttercup, Persian Speedwell, Slender speedwell, Broadleaf plantain, Narrow-leaved plantain, Dovefoot geranium,

NEU1173H

Page 10 of 53

Healall, Shepherd's-purse, Silverweed cinquefoil, Wild chamomile, Moss, Liverworts, Algae, Lichens.

OR

Controls the following weeds: Dandelion, English daisy, and Moss.

Suppresses the following weeds: Broadleaf plantain, Narrow-leaved plantain, White clover, Creeping buttercup and Slender speedwell]

Application Directions

Shake well before using. Apply 1 gallon of concentrate/2500 ft². Uniform coverage is important. Rinse treated areas 24 hours after application. Repeat treatment in 3 to 4 weeks for best results.

[Optional hose-end sprayer directions that may be presented on the container or supplemental wording, either:

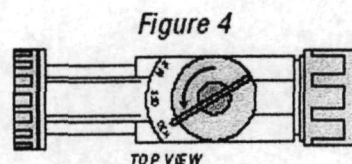
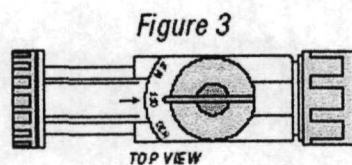
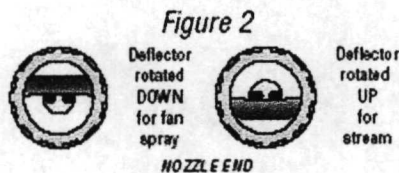
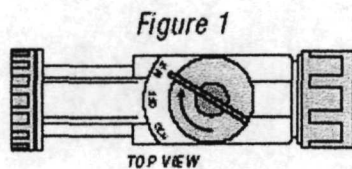

To Use This Sprayer:

1. Shake container well.
2. Connect spray nozzle to garden hose.

NEU1173H

Page 11 of 53

3. Turn on the water from the faucet. Extend hose to the farthest area to be treated and work back toward the faucet so you don't come in contact with the treated area.
4. When you are ready to spray, turn the knob on top so that it points to the MIX position on the spray head. (Fig. 1)
5. The spray deflector on the front of the hose-end applicator can be rotated to give a stream or fan spray. (Fig. 2)

NEU1173H

Page 12 of 53

To Stop Spraying

6. When you are finished spraying or if you have to stop spraying at any time, turn the knob back to the OFF position. (Fig. 3)
7. Turn off the water from the faucet.
8. Turn the knob to H2O then OFF, to drain the water from the hose. (Fig. 4)

OR

1. Attach garden hose to spray nozzle. Turn on water supply.
2. Bend safety tab down and turn control to "water".
3. Point nozzle toward plants and turn water control knob to "On". Product will automatically mix with water. Spray weeds thoroughly.

To Stop Spraying:

1. When you are finished spraying or if you have to stop spraying at any time, turn the blue knob back to the OFF position.
2. Turn off the water from the faucet.
3. Turn the blue knob to H2O then OFF, to drain the water from the hose.
4. Unscrew spray nozzle from hose. Remove hose end from container.
5. Reseal the container with the child-resistant closure. Rinse the hose-end applicator

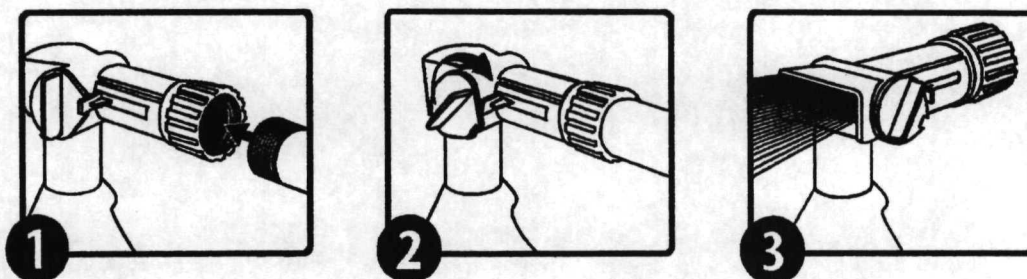



OR

1. Shake container well before using.
2. Connect a garden hose to the Ready Spray nozzle. Make sure the dial on the nozzle is in the "OFF" position with the safety tab in the valve notch.
3. Turn on the water at faucet. Extend hose to the farthest area to be treated and work back toward the faucet so you don't come in contact with the treated area.
4. To BEGIN spraying, point nozzle toward treatment site and
 - a. Bend the safety tab back (located at the right of the yellow dial) with your thumb,

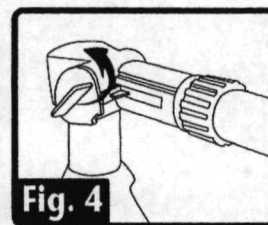
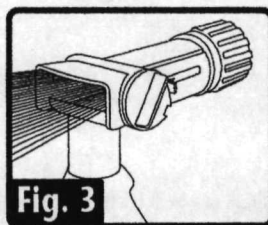
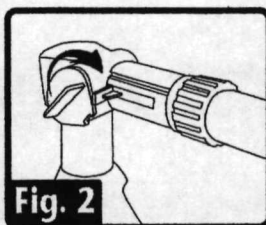
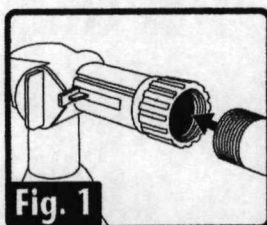
- b. Using your other hand, QUICKLY turn the dial clockwise until it stops. Water will automatically mix with the product.
5. Spray weeds thoroughly. Walk at a steady pace while spraying using an even sweeping motion, slightly overlapping treated areas.
6. To STOP spraying, QUICKLY turn the dial in the opposite direction of "ON" until it stops and the safety tab engages the notch on the valve. Turn water off at faucet. To relieve pressure before removing nozzle from hose, bend the safety tab back and turn dial "ON" until water stops spraying.
7. To STORE unused product, make sure the dial is in the "OFF" position with safety tab in the valve notch. Place in cool area away from heat, sunlight or open flame.

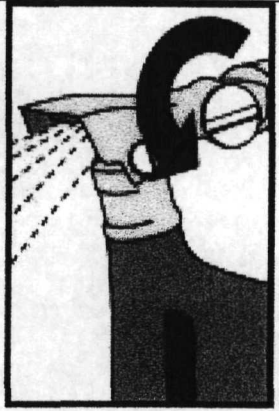

		
<ul style="list-style-type: none">• Ensure that the large Water Control Knob is turned to the "OFF" position.• Connect sprayer to garden hose.	<ul style="list-style-type: none">• Turn the small Product Control Button so that the flat side aligns with the tab on the right side of the button, and push the button all the way in.• Turn on water at faucet.	<ul style="list-style-type: none">• To spray, point nozzle where you want to spray and turn the large knob all the way to the left.• To stop spraying, push small Product Control Button in from opposite side. Turn large Water Control Knob to the right to the "OFF" position and turn off faucet.• NOTE: BEFORE DISCONNECTING HOSE (to relieve water pressure): Turn large Water Control Knob to the left; then turn "OFF" again.• Disconnect garden hose from sprayer.• To prevent accidental discharge when not in use, turn the small Product Control Button so that it is <u>NOT</u> aligned with the tab and cannot be pushed in.

]

What will I see?

Works quickly; dying weeds will be seen within hours of application. Treated weeds, moss or algae will turn brown or black. Occasionally a darkening of the grass leaf blades can occur after treatment, however the grass will recover within a few days to weeks. May stain thatch (dead grass under lawn); this does not affect the health of the grass.

Use Precautions:

NEU1173H

Page 15 of 53

Do not apply to drought stressed grass; ensure lawn is well watered prior to application. Do not apply when the daytime temperature will exceed 85°F. Do not apply to bentgrass. If unsure of grass sensitivity, test spray a small area of your lawn. Do not apply to newly seeded areas prior to grass seed germination. Avoid spraying desirable plants. Any desirable plants or structures accidentally contacted should be rinsed with water. To avoid staining, wait until treated area dries before re-entry. Do not apply if rainfall is expected within 3 hours of application. Do not irrigate within 3 hours of application. Do not apply to the same area more than 2 times a year.

STORAGE AND DISPOSAL

PESTICIDE STORAGE: Store this product in its original container and keep in a secure storage area out of reach of children and domestic animals. Store unused material, tightly closed, in original container only, away from open flame.

PESTICIDE DISPOSAL AND CONTAINER HANDLING:

Nonrefillable container. Do not reuse or refill this container.

If empty: Place in trash or offer for recycling if available.

If partly filled: Call your local solid waste agency [or call [insert supplemental distributor's toll free number]] for disposal instructions. Never place unused product down any indoor or outdoor drain.

BATCH CODE:

[The following claims and product information, may or may not be presented on the product's label and labeling:

-www.neudorff.com



- Weed Killer for Lawns
- Selective Weed Killer
- Selective Broadleaf Weed Killer
- Selective Weed Control
- Selective Broadleaf Weed Control
- Selective Control of Weeds in Lawns
- Selective Control of Broadleaf Weeds in Lawns
- Kills weeds not lawns
- Kills weeds not grasses
- Lawn Weed Killer
- Lawn Weed Control
- Water-based
- With the provided hose-end sprayer, this container will treat XXX ft²
- Works in cool weather
- Rainfast in 3 hours
- Works fast
- See results the same day
- See results in hours

NEU1173H

Page 16 of 53

- Fast and effective
- No unpleasant odor
- Does not contain (2,4-D) (MCPA) (Dicamba) (Mecoprop)
- Derived from iron (Fe)
- For non-selective (moss) weed and grass control, use [H01 or NEU1171H – *insert product name*]
- Eliminates unwanted moss, algae and lichens quickly
- Kills algae, moss and lichens
- Kills moss and algae
- Moss killer
- Moss, algae and lichen killer
- Kills moss fast
- Kills moss, algae, and lichens quickly and effectively
- Lawn areas can be re-sown within one day of treatment with NEU1173H
- (Controls) (kills) (dandelions) (buttercup) (English daisy) (daisy) (clover)
- One gallon of concentrate will treat up to 2500 ft² (of lawn)
- Can be used on new lawns (1 week) after grass emergence
- Even works in cool weather
- Also works in cool weather
- Patent pending
- Patent #6,972,273
- Kills weeds, down to the root
- Kills dandelions, down to the root
- (Helpful Hints:) Best results are obtained when applied in the Spring or Fall when environmental conditions are cool and there is ample moisture
- (Helpful Hints:) The best times to treat weeds are in the Spring when they are small and growing and in the Fall to eliminate many of next year's weeds
- People and pets can enter treated area when spray dries
- Ready-To-Spray
- Hose-End Bottle
- Hose-End Sprayer
- This product is ready to spray. Just attach this bottle to your garden hose according to directions. Water automatically mixes with the concentrate as you spray.]

NEU1173H

Page 17 of 53

[Optional warranty statements. Registrant has choice of using any or none.

-NOTICE TO BUYER

Seller warrants that this product conforms to the chemical description on this label and is reasonably fit for the purposes stated in the Directions for Use, subject to the inherent risks described above, when used in accordance with the Directions for Use under normal conditions. To the extent consistent with applicable law, this warranty does not extend to use of this product contrary to label directions, or under abnormal use conditions, or under conditions not reasonably foreseeable to Seller. To the extent consistent with applicable law, the Seller shall not be liable for any such use. To the extent consistent with applicable law, the Seller makes no other warranties, either expressed or implied.

Or

-Buyer assumes all responsibility for safety and use not in accordance with directions.

Or

-Unconditionally Guaranteed by (company name). **OUR COMMITMENT TO YOUR SATISFACTION:** If you are not happy with the way this product works in your garden, please let us know. We will be happy to replace the product, refund your money, or substitute another (brand name) product. Simply send your name, address and proof of purchase to (Company name & address).

Or

(company name) guarantees if for any reason you are not satisfied with this product, mail us proof of purchase to obtain a full refund of your purchase price.]

SUBLABEL C – HOUSEHOLD USE ON MOSS

NEU1173H Concentrate

Active Ingredient:

Iron HEDTA (FeHEDTA)	26.52%
Other Ingredients:.....	73.48%
Total:.....	100.00%

KEEP OUT OF REACH OF CHILDREN

CAUTION

FIRST AID	
IF IN EYES	-Hold eye open and rinse slowly and gently with water for 15-20 minutes. -Remove contact lenses, if present, after the first 5 minutes, then continue rinsing eye. -Call a poison control center or doctor for treatment advice.
Have the product container or label with you when calling a poison control center or doctor, or going for treatment.	

PRECAUTIONARY STATEMENTS

HAZARDS TO HUMANS AND DOMESTIC ANIMALS

CAUTION: Causes slight eye irritation. Avoid contact with eyes or clothing. Wash thoroughly with soap and water after handling and before eating, drinking, chewing gum or using tobacco. Prolonged or frequently repeated skin contact may cause allergic reactions in some individuals.

DIRECTIONS FOR USE

It is a violation of Federal Law to use this product in a manner inconsistent with its labeling.

Use Sites:

Use to selectively control moss, algae, lichens, and liverworts growing in lawns.

Pests:

Controls moss, algae, lichens, and liverworts.

Application Directions

Shake well before using. Mix one part [NEU1173H] with 24 parts water (5 oz. in 1 gallon of water). Apply the mixed solution at a rate of 5-10 gallons/1000 ft² (5.75-11.5 oz/yard²). Any standard hand-held or backpack sprayer can be used.

NEU1173H

Page 19 of 53

Use a coarse nozzle setting to reduce drift. Uniform coverage is important. Repeat treatment if needed.

Repeat treatment in 3 to 4 weeks for best results.

What will I see?

Works quickly. Treated moss or algae will turn brown or black. Occasionally a darkening of the grass leaf blades can occur after treatment, however the grass will recover within a few days to weeks. May stain thatch (dead grass under lawn); this does not affect the health of the grass.

Use Precautions:

Do not apply to drought stressed grass; ensure lawn is well watered prior to application. Do not apply when the daytime temperature will exceed 85°F. Do not apply to bentgrass. If unsure of grass sensitivity, test spray a small area of your lawn. Do not apply to newly seeded areas prior to grass seed germination. Avoid spraying desirable plants. Any desirable plants or structures accidentally contacted should be rinsed with water. To avoid staining, wait until treated area dries before re-entry. Do not apply if rainfall is expected within 3 hours of application. Do not irrigate within 3 hours of application. Do not apply to the same area more than 4 times a year.

STORAGE AND DISPOSAL

PESTICIDE STORAGE: Store this product in its original container and keep in a secure storage area out of reach of children and domestic animals. Store unused material, tightly closed, in original container only, away from open flame.

PESTICIDE DISPOSAL AND CONTAINER HANDLING:

Nonrefillable container. Do not reuse or refill this container.

If empty: Place in trash or offer for recycling if available.

If partly filled: Call your local solid waste agency [or call [insert supplemental distributor's toll free number]] for disposal instructions. Never place unused product down any indoor or outdoor drain.

BATCH CODE:

[The following claims and product information, may or may not be presented on the product's label and labeling:

-www.neudorff.com



- Selective Moss Killer
- Selective Moss Control
- Kills Moss Without Harming Lawn Grasses
- Kills moss not lawns

NEU1173H

Page 20 of 53

- Kills moss not grasses
- Lawn Moss Killer
- Lawn Moss Control
- Water-based
- When diluted, this bottle will treat XXX ft²
- Works in cool weather
- Rainfast in 3 hours
- Works fast
- See results the same day
- See results in hours
- Fast and effective
- No unpleasant odor
- Mix with water
- Does not contain (2,4-D) (MCPA) (Dicamba) (Mecoprop)
- Derived from iron (Fe)
- For non-selective (moss) weed and grass control, use [H01 or NEU1171H – *insert product name*]
- Eliminates unwanted moss, algae and lichens quickly
- Kills algae, moss and lichens
- Kills moss and algae
- Moss killer
- Moss, algae and lichen killer
- Kills moss fast
- Kills moss, algae, and lichens quickly and effectively
- Lawn areas can be re-sown within one day of treatment with NEU1173H
- (Controls) (kills) (dandelions) (buttercup) (English daisy) (daisy) (clover)
- One gallon of concentrate will treat up to 5000 ft² (of lawn)
- Can be used to spot treat problem areas
- Can be used to spot treat problem areas in lawns
- Can be used on new lawns (1 week) after grass emergence
- Even works in cool weather
- Also works in cool weather
- Patent pending
- Patent #6,972,273
- Makes over XX gallons
- 1 ounce = 2 tablespoons = 6 teaspoons
- (Helpful Hints:) Best results are obtained when applied in the Spring or Fall when environmental conditions are cool and there is ample moisture
- People and pets can enter treated area when spray dries]

[Optional warranty statements. Registrant has choice of using any or none.

-NOTICE TO BUYER

Seller warrants that this product conforms to the chemical description on this label and is reasonably fit for the purposes stated in the Directions for Use, subject to the inherent risks described above, when used in accordance with the Directions for Use under normal conditions. To the extent consistent with applicable law, this warranty does not extend to use of this product contrary to

NEU1173H

Page 21 of 53

label directions, or under abnormal use conditions, or under conditions not reasonably foreseeable to Seller. To the extent consistent with applicable law, the Seller shall not be liable for any such use. To the extent consistent with applicable law, the Seller makes no other warranties, either expressed or implied.

Or

-Buyer assumes all responsibility for safety and use not in accordance with directions.

Or

-Unconditionally Guaranteed by (company name). **OUR COMMITMENT TO YOUR SATISFACTION:** If you are not happy with the way this product works in your garden, please let us know. We will be happy to replace the product, refund your money, or substitute another (brand name) product. Simply send your name, address and proof of purchase to (Company name & address).

Or

(company name) guarantees if for any reason you are not satisfied with this product, mail us proof of purchase to obtain a full refund of your purchase price.]

NEU1173H Concentrate

Active Ingredient:

Iron HEDTA (FeHEDTA)	26.52%
Other Ingredients:.....	73.48%
Total:.....	100.00%

KEEP OUT OF REACH OF CHILDREN

CAUTION

FIRST AID	
IF IN EYES	-Hold eye open and rinse slowly and gently with water for 15-20 minutes. -Remove contact lenses, if present, after the first 5 minutes, then continue rinsing eye. -Call a poison control center or doctor for treatment advice.
Have the product container or label with you when calling a poison control center or doctor, or going for treatment.	

PRECAUTIONARY STATEMENTS

HAZARDS TO HUMANS AND DOMESTIC ANIMALS

CAUTION: Causes slight eye irritation. Avoid contact with eyes or clothing. Wash thoroughly with soap and water after handling and before eating, drinking, chewing gum or using tobacco. Prolonged or frequently repeated skin contact may cause allergic reactions in some individuals.

DIRECTIONS FOR USE

It is a violation of Federal Law to use this product in a manner inconsistent with its labeling.

Use Sites:

Use to selectively control moss, algae, lichens, and liverworts growing in lawns.

Pests:

Controls moss, algae, lichens, and liverworts.

Application Directions

Shake well before using. Apply 1 gallon of concentrate/2500 ft². Uniform coverage is important. Rinse treated areas 24 hours after application. Repeat treatment in 3 to 4 weeks for best results.

NEU1173H

Page 23 of 53

[Optional hose-end sprayer directions that may be presented on the container or supplemental wording, either:

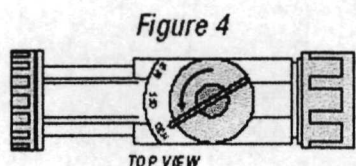
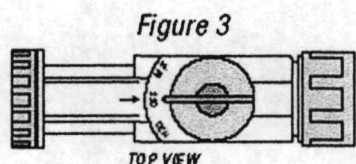
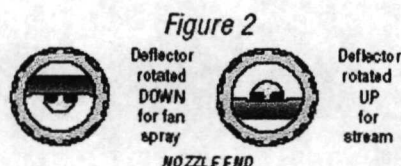
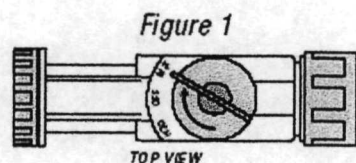

To Use This Sprayer:

1. Shake container well.
2. Connect spray nozzle to garden hose.
3. Turn on the water from the faucet. Extend hose to the farthest area to be treated and work back toward the faucet so you don't come in contact with the treated area.
4. When you are ready to spray, turn the knob on top so that it points to the MIX position on the spray head. (Fig. 1)
5. The spray deflector on the front of the hose-end applicator can be rotated to give a stream or fan spray. (Fig. 2)

To Stop Spraying

1. When you are finished spraying or if you have to stop spraying at any time, turn the knob back to the OFF position. (Fig. 3)
2. Turn off the water from the faucet.
3. Turn the knob to H2O then OFF, to drain the water from the hose. (Fig. 4)

1. Attach garden hose to spray nozzle. Turn on water supply.
2. Bend safety tab down and turn control to "water".
3. Point nozzle toward plants and turn water control knob to "On". Product will automatically mix with water. Spray moss surfaces thoroughly.

To Stop Spraying:

1. When you are finished spraying or if you have to stop spraying at any time, turn the blue knob back to the OFF position.
2. Turn off the water from the faucet.
3. Turn the blue knob to H2O then OFF, to drain the water from the hose.
4. Unscrew spray nozzle from hose. Remove hose end from container.
5. Reseal the container with the child-resistant closure. Rinse the hose-end applicator

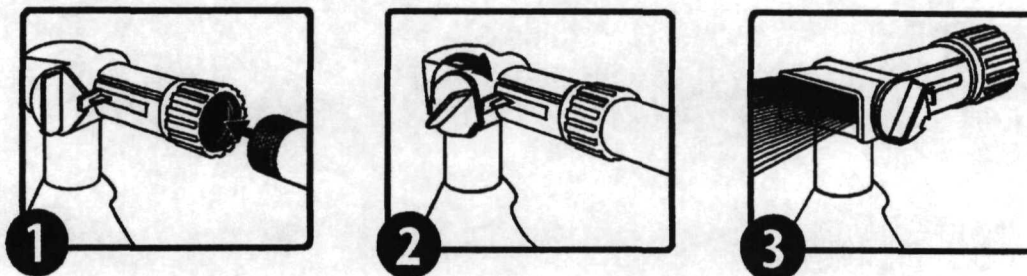



OR

1. Shake container well before using.
2. Connect a garden hose to the Ready Spray nozzle. Make sure the dial on the nozzle is in the "OFF" position with the safety tab in the valve notch.
3. Turn on the water at faucet. Extend hose to the farthest area to be treated and work back toward the faucet so you don't come in contact with the treated area.
4. To BEGIN spraying, point nozzle toward treatment site and
 - a. Bend the safety tab back (located at the right of the yellow dial) with your thumb,
 - b. Using your other hand, QUICKLY turn the dial clockwise until it stops. Water will automatically mix with the product.
5. Spray moss thoroughly. Walk at a steady pace while spraying using an even sweeping motion, slightly overlapping treated areas.
6. To STOP spraying, QUICKLY turn the dial in the opposite direction of "ON" until it stops and the safety tab engages the notch on the valve. Turn water off at faucet. To relieve pressure before removing nozzle from hose, bend the safety tab back and turn dial "ON" until water stops spraying.

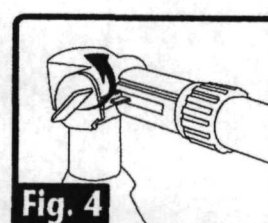
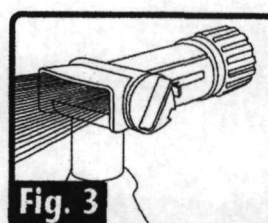
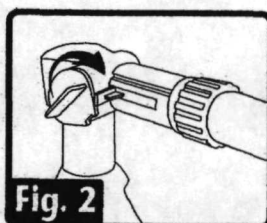
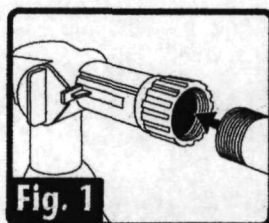
7. To **STORE** unused product, make sure the dial is in the "OFF" position with safety tab in the valve notch. Place in cool area away from heat, sunlight or open flame.

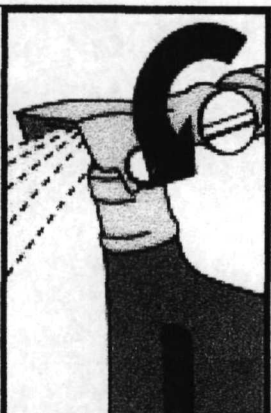

OR

		
<ul style="list-style-type: none"> • Ensure that the large Water Control Knob is turned to the "OFF" position. • Connect sprayer to garden hose. 	<ul style="list-style-type: none"> • Turn the small Product Control Button so that the flat side aligns with the tab on the right side of the button, and push the button all the way in. • Turn on water at faucet. 	<ul style="list-style-type: none"> • To spray, point nozzle where you want to spray and turn the large knob all the way to the left. • To stop spraying, push small Product Control Button in from opposite side. Turn large Water Control Knob to the right to the "OFF" position and turn off faucet. • NOTE: BEFORE DISCONNECTING HOSE (to relieve water pressure): Turn large Water Control Knob to the left; then turn "OFF" again. • Disconnect garden hose from sprayer. • To prevent accidental discharge when not in use, turn the small Product Control Button so that it is <u>NOT</u> aligned with the tab and cannot be pushed in.

What will I see?

Works quickly. Treated moss or algae will turn brown or black. Occasionally a darkening of the grass leaf blades can occur after treatment, however the grass will recover within a few days to weeks. May stain thatch (dead grass under lawn); this does not affect the health of the grass.

Use Precautions:

Do not apply to drought stressed grass; ensure lawn is well watered prior to application. Do not apply when the daytime temperature will exceed 85°F. Do not apply to bentgrass. If unsure of grass sensitivity, test spray a small area of your lawn. Do not apply to newly seeded areas prior to grass seed germination. Avoid spraying desirable plants. Any desirable plants or structures accidentally contacted should be rinsed with water. To avoid staining, wait until treated area dries before re-entry. Do not apply if rainfall is expected within 3 hours of application. Do not irrigate within 3 hours of application. Do not apply to the same area more than 2 times a year.

STORAGE AND DISPOSAL

PESTICIDE STORAGE: Store this product in its original container and keep in a secure storage area out of reach of children and domestic animals. Store unused material, tightly closed, in original container only, away from open flame.

PESTICIDE DISPOSAL AND CONTAINER HANDLING:

Nonrefillable container. Do not reuse or refill this container.

If empty: Place in trash or offer for recycling if available.

If partly filled: Call your local solid waste agency [or call [insert supplemental distributor's toll free number]] for disposal instructions. Never place unused product down any indoor or outdoor drain.

BATCH CODE:

[The following claims and product information, may or may not be presented on the product's label and labeling:

-www.neudorff.com



- Selective Moss Killer
- Selective Moss Control
- Kills Moss Without Harming Lawn Grasses
- Kills moss not lawns
- Kills moss not grasses
- Lawn Moss Killer
- Lawn Moss Control
- Water-based

NEU1173H

Page 27 of 53

With the provided hose-end sprayer, this container will treat XXX ft²

- Works in cool weather
- Rainfast in 3 hours
- Works fast
- See results the same day
- See results in hours
- Fast and effective
- No unpleasant odor
- Does not contain (2,4-D) (MCPA) (Dicamba) (Mecoprop)
- Derived from iron (Fe)
- For non-selective (moss) weed and grass control, use [H01 or NEU1171H – *insert product name*]
- Eliminates unwanted moss, algae and lichens quickly
- Kills algae, moss and lichens
- Kills moss and algae
- Moss killer
- Moss, algae and lichen killer
- Kills moss fast
- Kills moss, algae, and lichens quickly and effectively
- Lawn areas can be re-sown within one day of treatment with NEU1173H
- (Controls) (kills) (dandelions) (buttercup) (English daisy) (daisy) (clover)
- One gallon of concentrate will treat up to 2500 ft² (of lawn)
- Can be used on new lawns (1 week) after grass emergence
- Even works in cool weather
- Also works in cool weather
- Patent pending
- Patent #6,972,273
- (Helpful Hints:) Best results are obtained when applied in the Spring or Fall when environmental conditions are cool and there is ample moisture
- People and pets can enter treated area when spray dries
- Ready-To-Spray
- Hose-End Bottle
- Hose-End Sprayer
- This product is ready to spray. Just attach this bottle to your garden hose according to directions. Water automatically mixes with the concentrate as you spray.]

[Optional warranty statements. Registrant has choice of using any or none.

-NOTICE TO BUYER

Seller warrants that this product conforms to the chemical description on this label and is reasonably fit for the purposes stated in the Directions for Use, subject to the inherent risks described above, when used in accordance with the Directions for Use under normal conditions. To the extent consistent with applicable law, this warranty does not extend to use of this product contrary to label directions, or under abnormal use conditions, or under conditions not reasonably foreseeable to Seller. To the extent consistent with applicable law,

NEU1173H

Page 28 of 53

the Seller shall not be liable for any such use. To the extent consistent with applicable law, the Seller makes no other warranties, either expressed or implied.

Or

-Buyer assumes all responsibility for safety and use not in accordance with directions.

Or

-Unconditionally Guaranteed by (company name). OUR COMMITMENT TO YOUR SATISFACTION: If you are not happy with the way this product works in your garden, please let us know. We will be happy to replace the product, refund your money, or substitute another (brand name) product. Simply send your name, address and proof of purchase to (Company name & address).

Or

(company name) guarantees if for any reason you are not satisfied with this product, mail us proof of purchase to obtain a full refund of your purchase price.]

33/57

NEU1173H Concentrate

Active Ingredient:

Iron HEDTA (FeHEDTA)	26.52%
Other Ingredients:	73.48%
Total:	100.00%

KEEP OUT OF REACH OF CHILDREN

CAUTION

FIRST AID	
IF IN EYES	-Hold eye open and rinse slowly and gently with water for 15-20 minutes. -Remove contact lenses, if present, after the first 5 minutes, then continue rinsing eye. -Call a poison control center or doctor for treatment advice.
Have the product container or label with you when calling a poison control center or doctor, or going for treatment.	

PRECAUTIONARY STATEMENTS

HAZARDS TO HUMANS AND DOMESTIC ANIMALS

CAUTION: Causes slight eye irritation. Avoid contact with eyes or clothing. Wash thoroughly with soap and water after handling and before eating, drinking, chewing gum or using tobacco. Prolonged or frequently repeated skin contact may cause allergic reactions in some individuals.

DIRECTIONS FOR USE

It is a violation of Federal Law to use this product in a manner inconsistent with its labeling.

Read and follow all applicable directions and precautions on this label before using.

SITES: Lawns, turf (use on rights of way or non-crop areas), golf courses, parks, playgrounds, cemeteries, athletic fields

Pests:

[One of the two following sections must be used. The first section may be used on the labels of products sold or distributed in all states, except California. The second section must be used on the labels of products sold or distributed in California:

Controls or suppresses weeds such as but not limited to:

- Black medic (*Medicago lupulina*)

NEU1173H

Page 30 of 53

- Broadleaf plantain (*Plantago major*)
- Bull thistle (*Cirsium vulgare*)
- Canada thistle (*Cirsium arvense*)
- Common chickweed (*Stellaria media*)
- Creeping buttercup (*Ranunculus repens*)
- Dandelion (*Taraxicum officinale*)
- Dovefoot geranium (*Geranium molle*)
- English daisy (*Bellis perennis*)
- False dandelion (*Hypochoeris radicata*)
- Healall (*Prunella vulgaris*)
- Moss, liverworts, algae and lichens
- Narrow-leaved plantain (*Plantago lanceolata*)
- Persian Speedwell (*Veronica persica*)
- Shepherd's-purse (*Capsella bursa-pastoris*)
- Silverweed cinquefoil (*Potentilla anserina*)
- Slender speedwell (*Veronica filiformis*)
- White clover (*Trifolium repens*)
- Wild chamomile (*Matricaria chamomilla*)

OR

Controls weeds:

- Dandelion (*Taraxicum officinale*)
- English daisy (*Bellis perennis*)
- Moss

Suppresses weeds:

- White clover (*Trifolium repens*)
- Broadleaf plantain (*Plantago major*)
- Narrow-leaved plantain (*Plantago lanceolata*)
- Creeping buttercup (*Ranunculus repens*)
- Slender speedwell (*Veronica filiformis*)

Application Directions

Shake well before using. Mix one part [NEU1173H] with 24 parts water (5 oz. in 1 gallon of water). Apply the mixed solution at a rate of 5-10 gallons/1000 ft² (5.75-11.5 fluid oz./yard²). Any standard hand-held or backpack sprayer can be used. Thoroughly spray weeds. Use a coarse nozzle setting to reduce drift. Uniform coverage is important.

Repeat treatment in 3 to 4 weeks for best results.

What will I see?

Works quickly; dying weeds will be seen within hours of application. Treated weeds, moss or algae will turn brown or black. Occasionally a darkening of the

NEU1173H

Page 31 of 53

grass leaf blades can occur after treatment, however the grass will recover within a few days to weeks. May stain thatch (dead grass under lawn); this does not affect the health of the grass.

Use Precautions:

Do not apply to drought stressed grass; ensure lawn is well watered prior to application. Do not apply when the daytime temperature will exceed 85°F. Do not apply to bentgrass. If unsure of grass sensitivity, test spray a small area of your lawn. Do not apply to newly seeded areas prior to grass seed germination. Avoid spraying desirable plants. Any desirable plants or structures accidentally contacted should be rinsed with water. To avoid staining, wait until treated area dries before re-entry. Do not apply if rainfall is expected within 3 hours of application. Do not irrigate within 3 hours of application. Do not apply to the same area more than 4 times a year.

STORAGE AND DISPOSAL

Do not contaminate water, food or feed by storage or disposal.

PESTICIDE STORAGE: Store in a secure place, away from open fire or flame. Keep container closed and reseal after use. If spilled, use absorbent materials and dispose of in an approved manner.

PESTICIDE DISPOSAL: Wastes resulting from the use of this product may be disposed of on site or at an approved waste disposal facility.

CONTAINER HANDLING: Nonrefillable container. Do not reuse or refill this container. Triple rinse container (or equivalent) promptly after emptying. Triple rinse as follows:

(For containers equal to or less than five gallons use these directions:) Empty the remaining contents into application equipment or a mix tank and drain for 10 seconds after the flow begins to drip. Fill the container ¼ full with water and recap. Shake for 10 seconds. Pour rinsate into application equipment or a mix tank or store rinsate for later use or disposal. Drain for 10 seconds after the flow begins to drip. Repeat this procedure two more times. Offer for recycling, if available.

(For containers greater than five gallons use these directions:) Empty the remaining contents into application equipment or a mix tank. Fill the container ¼ full with water. Replace and tighten closures. Tip container on its side and roll it back and forth, ensuring at least one complete revolution, for 30 seconds. Stand the container on its end and tip it back and forth several times. Turn the container over onto its other end and tip it back and forth several times. Empty the rinsate into application equipment or a mix tank or store rinsate for later use or disposal. Repeat this procedure two more times. Offer for recycling, if available.

BATCH CODE:

[The following claims and product information, may or may not be presented on the product's label and labeling:

-www.neudorff.com



- Weed Killer for Lawns
- Selective Weed Killer
- Selective Broadleaf Weed Killer
- Selective Weed Control
- Selective Broadleaf Weed Control
- Selective Control of Weeds in Lawns
- Selective Control of Broadleaf Weeds in Lawns
- Kills weeds not lawns
- Kills weeds not grasses
- Lawn Weed Killer
- Lawn Weed Control
- Water-based
- When diluted, this bottle will treat XXX ft²
- Works in cool weather
- Rainfast in 3 hours
- Works fast
- See results the same day
- See results in hours
- Fast and effective
- Mix with water
- No unpleasant odor
- Does not contain (2,4-D) (MCPA) (Dicamba) (Mecoprop)
- Derived from iron (Fe)
- For non-selective (moss) weed and grass control, use [H01 or NEU1171H –
insert product name]
- Eliminates unwanted moss, algae and lichens quickly
- Kills algae, moss and lichens
- Kills moss and algae
- Moss killer
- Moss, algae and lichen killer
- Kills moss fast
- Kills moss, algae, and lichens quickly and effectively
- Lawn areas can be re-sown within one day of treatment with NEU1173H
- (Controls) (kills) (dandelions) (buttercup) (English daisy) (daisy) (clover)
- One gallon of concentrate will treat up to 5000 ft² (of lawn)
- Can be used to spot treat problem areas
- Can be used to spot treat problem areas in lawns
- Can be used on new lawns (1 week) after grass emergence
- Even works in cool weather
- Also works in cool weather
- Patent pending
- Patent #6,972,273
- Makes over XX gallons
- 1 ounce = 2 tablespoons = 6 teaspoons

NEU1173H

Page 33 of 53

- Kills weeds, down to the root
- Kills dandelions, down to the root
- (Helpful Hints:) Best results are obtained when applied in the Spring or Fall when environmental conditions are cool and there is ample moisture
- (Helpful Hints:) The best times to treat weeds are in the Spring when they are small and growing and in the Fall to eliminate many of next year's weeds
- People and pets can enter treated area when spray dries]

[Optional warranty statements. Registrant has choice of using any or none.

-NOTICE TO BUYER

Seller warrants that this product conforms to the chemical description on this label and is reasonably fit for the purposes stated in the Directions for Use, subject to the inherent risks described above, when used in accordance with the Directions for Use under normal conditions. To the extent consistent with applicable law, this warranty does not extend to use of this product contrary to label directions, or under abnormal use conditions, or under conditions not reasonably foreseeable to Seller. To the extent consistent with applicable law, the Seller shall not be liable for any such use. To the extent consistent with applicable law, the Seller makes no other warranties, either expressed or implied.

Or

-Buyer assumes all responsibility for safety and use not in accordance with directions.

Or

-Unconditionally Guaranteed by (company name). **OUR COMMITMENT TO YOUR SATISFACTION:** If you are not happy with the way this product works in your garden, please let us know. We will be happy to replace the product, refund your money, or substitute another (brand name) product. Simply send your name, address and proof of purchase to (Company name & address).]

Or

(company name) guarantees if for any reason you are not satisfied with this product, mail us proof of purchase to obtain a full refund of your purchase price.

NEU1173H

Page 34 of 53

SUBLABEL F – COMMERCIAL USE ON WEEDS – Hose-end Sprayer

NEU1173H Concentrate

Active Ingredient:

Iron HEDTA (FeHEDTA) 26.52%

Other Ingredients: 73.48%

Total: **100.00%****KEEP OUT OF REACH OF CHILDREN****CAUTION**

FIRST AID	
IF IN EYES	-Hold eye open and rinse slowly and gently with water for 15-20 minutes. -Remove contact lenses, if present, after the first 5 minutes, then continue rinsing eye. -Call a poison control center or doctor for treatment advice.
Have the product container or label with you when calling a poison control center or doctor, or going for treatment.	

PRECAUTIONARY STATEMENTS**HAZARDS TO HUMANS AND DOMESTIC ANIMALS**

CAUTION: Causes slight eye irritation. Avoid contact with eyes or clothing. Wash thoroughly with soap and water after handling and before eating, drinking, chewing gum or using tobacco. Prolonged or frequently repeated skin contact may cause allergic reactions in some individuals.

DIRECTIONS FOR USE

It is a violation of Federal Law to use this product in a manner inconsistent with its labeling.

Read and follow all applicable directions and precautions on this label before using.

SITES: Lawns, turf (use on rights of way or non-crop areas), golf courses, parks, playgrounds, cemeteries, athletic fields

Pests:

Controls or suppresses weeds such as but not limited to:

- Black medic (*Medicago lupulina*)
- Broadleaf plantain (*Plantago major*)
- Bull thistle (*Cirsium vulgare*)
- Canada thistle (*Cirsium arvense*)
- Common chickweed (*Stellaria media*)

NEU1173H

Page 35 of 53

- Creeping buttercup (*Ranunculus repens*)
- Dandelion (*Taraxicum officinale*)
- Dovefoot geranium (*Geranium molle*)
- English daisy (*Bellis perennis*)
- False dandelion (*Hypochoeris radicata*)
- Healall (*Prunella vulgaris*)
- Moss, liverworts, algae and lichens
- Narrow-leaved plantain (*Plantago lanceolata*)
- Persian Speedwell (*Veronica persica*)
- Shepherd's-purse (*Capsella bursa-pastoris*)
- Silverweed cinquefoil (*Potentilla anserina*)
- Slender speedwell (*Veronica filiformis*)
- White clover (*Trifolium repens*)
- Wild chamomile (*Matricaria chamomilla*)

Application Directions

Shake well before using. Apply 1 gallon of concentrate/2500 ft². Uniform coverage is important. Rinse treated areas 24 hours after application. Repeat treatment in 3 to 4 weeks for best results.

[Optional hose-end sprayer directions that may be presented on the container or supplemental wording, either:

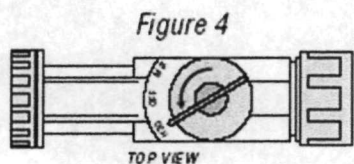
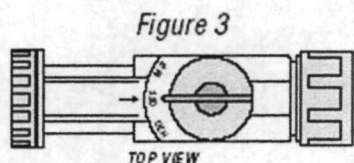
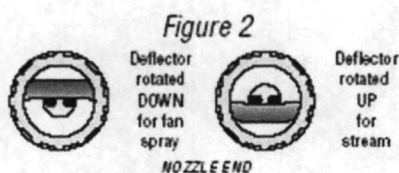
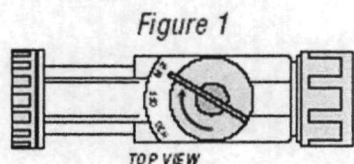

To Use This Sprayer:

1. Shake container well.
2. Connect spray nozzle to garden hose.
3. Turn on the water from the faucet. Extend hose to the farthest area to be treated and work back toward the faucet so you don't come in contact with the treated area.
4. When you are ready to spray, turn the knob on top so that it points to the MIX position on the spray head. (Fig. 1)
5. The spray deflector on the front of the hose-end applicator can be rotated to give a stream or fan spray. (Fig. 2)

To Stop Spraying

6. When you are finished spraying or if you have to stop spraying at any time, turn the knob back to the OFF position. (Fig. 3)
7. Turn off the water from the faucet.
8. Turn the knob to H₂O then OFF, to drain the water from the hose. (Fig. 4)

OR

1. Attach garden hose to spray nozzle. Turn on water supply.

2. Bend safety tab down and turn control to "water".
3. Point nozzle toward plants and turn water control knob to "On". Product will automatically mix with water. Thoroughly spray weeds.

To Stop Spraying:

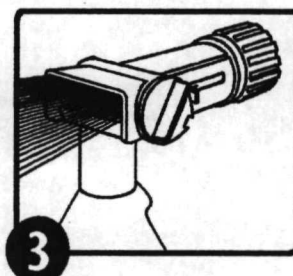
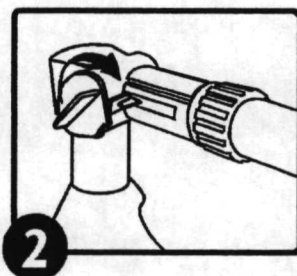
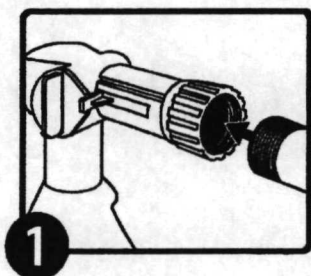

1. When you are finished spraying or if you have to stop spraying at any time, turn the blue knob back to the OFF position.
2. Turn off the water from the faucet.
3. Turn the blue knob to H2O then OFF, to drain the water from the hose.
4. Unscrew spray nozzle from hose. Remove hose end from container.
5. Reseal the container with the child-resistant closure. Rinse the hose-end applicator

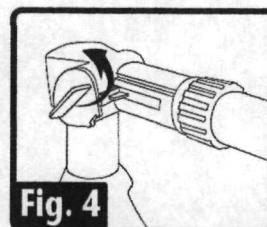
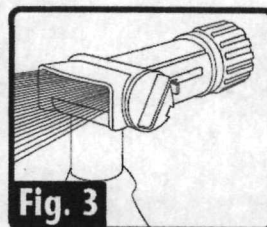
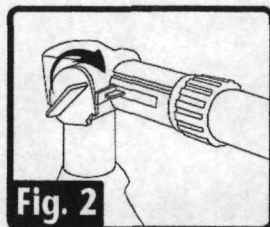
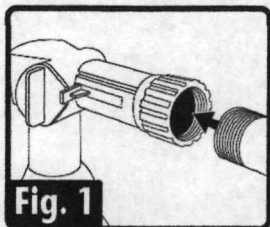

OR

1. Shake container well before using.
2. Connect a garden hose to the Ready Spray nozzle. Make sure the dial on the nozzle is in the "OFF" position with the safety tab in the valve notch.
3. Turn on the water at faucet. Extend hose to the farthest area to be treated and work back toward the faucet so you don't come in contact with the treated area.
4. To BEGIN spraying, point nozzle toward treatment site and
 - a. Bend the safety tab back (located at the right of the yellow dial) with your thumb,
 - b. Using your other hand, QUICKLY turn the dial clockwise until it stops. Water will automatically mix with the product.
5. Spray weeds thoroughly. Walk at a steady pace while spraying using an even sweeping motion, slightly overlapping treated areas.
6. To STOP spraying, QUICKLY turn the dial in the opposite direction of "ON" until it stops and the safety tab engages the notch on the valve. Turn water off at faucet. To relieve pressure before removing nozzle from hose, bend the safety tab back and turn dial "ON" until water stops spraying.
7. To STORE unused product, make sure the dial is in the "OFF" position with safety tab in the valve notch. Place in cool area away from heat, sunlight or open flame.

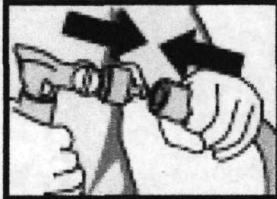

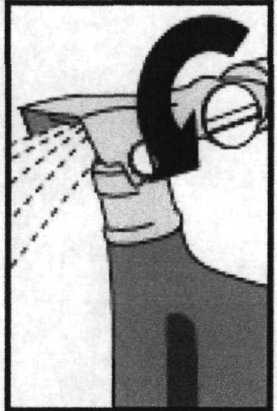
		
<ul style="list-style-type: none"> • Ensure that the large Water Control Knob is turned to the "OFF" position. • Connect sprayer to garden hose. 	<ul style="list-style-type: none"> • Turn the small Product Control Button so that the flat side aligns with the tab on the right side of the button, and push the button all the way in. • Turn on water at faucet. 	<ul style="list-style-type: none"> • To spray, point nozzle where you want to spray and turn the large knob all the way to the left. • To stop spraying, push small Product Control Button in from opposite side. Turn large Water Control Knob to the right to the "OFF" position and turn off faucet. • NOTE: BEFORE DISCONNECTING HOSE (to relieve water pressure): Turn large Water Control Knob to the left; then turn "OFF" again. • Disconnect garden hose from sprayer. • To prevent accidental discharge when not in use, turn the small Product Control Button so that it is <u>NOT</u> aligned with the tab and cannot be pushed in.

]

What will I see?

Works quickly; dying weeds will be seen within hours of application. Treated weeds, moss or algae will turn brown or black. Occasionally a darkening of the grass leaf blades can occur after treatment, however the grass will recover within a few days to weeks. May stain thatch (dead grass under lawn); this does not affect the health of the grass.

Use Precautions:

NEU1173H

Page 40 of 53

Do not apply to drought stressed grass; ensure lawn is well watered prior to application. Do not apply when the daytime temperature will exceed 85°F. Do not apply to bentgrass. If unsure of grass sensitivity, test spray a small area of your lawn. Do not apply to newly seeded areas prior to grass seed germination. Avoid spraying desirable plants. Any desirable plants or structures accidentally contacted should be rinsed with water. To avoid staining, wait until treated area dries before re-entry. Do not apply if rainfall is expected within 3 hours of application. Do not irrigate within 3 hours of application. Do not apply to the same area more than 2 times a year.

STORAGE AND DISPOSAL

Do not contaminate water, food or feed by storage or disposal.

PESTICIDE STORAGE: Store in a secure place, away from open fire or flame. Keep container closed and reseal after use. If spilled, use absorbent materials and dispose of in an approved manner.

PESTICIDE DISPOSAL: Wastes resulting from the use of this product may be disposed of on site or at an approved waste disposal facility.

CONTAINER HANDLING: Nonrefillable container. Do not reuse or refill this container. Triple rinse container (or equivalent) promptly after emptying. Triple rinse as follows:

(For containers equal to or less than five gallons use these directions:) Empty the remaining contents into application equipment or a mix tank and drain for 10 seconds after the flow begins to drip. Fill the container ¼ full with water and recap. Shake for 10 seconds. Pour rinsate into application equipment or a mix tank or store rinsate for later use or disposal. Drain for 10 seconds after the flow begins to drip. Repeat this procedure two more times. Offer for recycling, if available.

(For containers greater than five gallons use these directions:) Empty the remaining contents into application equipment or a mix tank. Fill the container ¼ full with water. Replace and tighten closures. Tip container on its side and roll it back and forth, ensuring at least one complete revolution, for 30 seconds. Stand the container on its end and tip it back and forth several times. Turn the container over onto its other end and tip it back and forth several times. Empty the rinsate into application equipment or a mix tank or store rinsate for later use or disposal. Repeat this procedure two more times. Offer for recycling, if available.

BATCH CODE:

[The following claims and product information, may or may not be presented on the product's label and labeling:

-www.neudorff.com



-Weed Killer for Lawns

-Selective Weed Killer

NEU1173H

Page 41 of 53

- Selective Broadleaf Weed Killer
- Selective Weed Control
- Selective Broadleaf Weed Control
- Selective Control of Weeds in Lawns
- Selective Control of Broadleaf Weeds in Lawns
- Kills weeds not lawns
- Kills weeds not grasses
- Lawn Weed Killer
- Lawn Weed Control
- Water-based
- With the provided hose-end sprayer, this container will treat XXX ft²
- Works in cool weather
- Rainfast in 3 hours
- Works fast
- See results the same day
- See results in hours
- Fast and effective
- No unpleasant odor
- Does not contain (2,4-D) (MCPA) (Dicamba) (Mecoprop)
- Derived from iron (Fe)
- For non-selective (moss) weed and grass control, use [NEU1170H or NEU1171H – *insert product name*]
- Eliminates unwanted moss, algae and lichens quickly
- Kills algae, moss and lichens
- Kills moss and algae
- Moss killer
- Moss, algae and lichen killer
- Kills moss fast
- Kills moss, algae, and lichens quickly and effectively
- Lawn areas can be re-sown within one day of treatment with NEU1173H
- (Controls) (kills) (dandelions) (buttercup) (English daisy) (daisy) (clover)
- One gallon of concentrate will treat up to 2500 ft² (of lawn)
- Can be used on new lawns (1 week) after grass emergence
- Even works in cool weather
- Also works in cool weather
- Patent pending
- Patent #6,972,273
- Kills weeds, down to the root
- Kills dandelions, down to the root
- (Helpful Hints:) Best results are obtained when applied in the Spring or Fall when environmental conditions are cool and there is ample moisture
- (Helpful Hints:) The best times to treat weeds are in the Spring when they are small and growing and in the Fall to eliminate many of next year's weeds
- People and pets can enter treated area when spray dries
- Ready-To-Spray
- Hose-End Bottle
- Hose-End Sprayer

NEU1173H

Page 42 of 53

-This product is ready to spray. Just attach this bottle to your garden hose according to directions. Water automatically mixes with the concentrate as you spray.]

[Optional warranty statements. Registrant has choice of using any or none.

-NOTICE TO BUYER

Seller warrants that this product conforms to the chemical description on this label and is reasonably fit for the purposes stated in the Directions for Use, subject to the inherent risks described above, when used in accordance with the Directions for Use under normal conditions. To the extent consistent with applicable law, this warranty does not extend to use of this product contrary to label directions, or under abnormal use conditions, or under conditions not reasonably foreseeable to Seller. To the extent consistent with applicable law, the Seller shall not be liable for any such use. To the extent consistent with applicable law, the Seller makes no other warranties, either expressed or implied.

Or

-Buyer assumes all responsibility for safety and use not in accordance with directions.

Or

-Unconditionally Guaranteed by (company name). **OUR COMMITMENT TO YOUR SATISFACTION:** If you are not happy with the way this product works in your garden, please let us know. We will be happy to replace the product, refund your money, or substitute another (brand name) product. Simply send your name, address and proof of purchase to (Company name & address).]

Or

(company name) guarantees if for any reason you are not satisfied with this product, mail us proof of purchase to obtain a full refund of your purchase price.

NEU1173H Concentrate

Active Ingredient:	
Iron HEDTA (FeHEDTA)	26.52%
Other Ingredients:.....	73.48%
Total:	100.00%

KEEP OUT OF REACH OF CHILDREN

CAUTION

FIRST AID	
IF IN EYES	<ul style="list-style-type: none">-Hold eye open and rinse slowly and gently with water for 15-20 minutes.-Remove contact lenses, if present, after the first 5 minutes, then continue rinsing eye.-Call a poison control center or doctor for treatment advice.
Have the product container or label with you when calling a poison control center or doctor, or going for treatment.	

PRECAUTIONARY STATEMENTS

HAZARDS TO HUMANS AND DOMESTIC ANIMALS

CAUTION: Causes slight eye irritation. Avoid contact with eyes or clothing. Wash thoroughly with soap and water after handling and before eating, drinking, chewing gum or using tobacco. Prolonged or frequently repeated skin contact may cause allergic reactions in some individuals.

DIRECTIONS FOR USE

It is a violation of Federal Law to use this product in a manner inconsistent with its labeling.

Read and follow all applicable directions and precautions on this label before using.

PESTS: Controls moss, algae, lichens, and liverworts growing in lawns and turf.

SITES: Lawns, turf (use on rights of way or non-crop areas), golf courses, parks, playgrounds, cemeteries, athletic fields.

Application Directions

Shake well before using.

Mix one part NEU1173H concentrate with 24 parts water (5 oz. in 1 gallon of water). Apply the mixed solution at a rate of 5-10 gallons/1000 ft² (5.75-11.5

NEU1173H

Page 44 of 53

oz/yard²). Any standard hand-held or backpack sprayer can be used. Use a coarse nozzle setting to reduce drift. Uniform coverage is important. Repeat treatment if needed.

What will I see?

Works quickly. Treated moss or algae will turn brown or black. Occasionally a darkening of the grass leaf blades can occur after treatment, however the grass will recover within a few days to weeks. May stain thatch (dead grass under lawn); this does not affect the health of the grass.

Use Precautions:

Do not apply to drought stressed grass; ensure lawn is well watered prior to application. Do not apply when the daytime temperature will exceed 85°F. Do not apply to bentgrass. If unsure of grass sensitivity, test spray a small area of your lawn. Do not apply to newly seeded areas prior to grass seed germination. Avoid spraying desirable plants. Any desirable plants or structures accidentally contacted should be rinsed with water. To avoid staining, wait until treated area dries before re-entry. Do not apply if rainfall is expected within 3 hours of application. Do not irrigate within 3 hours of application. Do not apply to the same area more than 4 times a year.

STORAGE AND DISPOSAL

Do not contaminate water, food or feed by storage or disposal.

PESTICIDE STORAGE: Store in a secure place, away from open fire or flame. Keep container closed and reseal after use. If spilled, use absorbent materials and dispose of in an approved manner.

PESTICIDE DISPOSAL: Wastes resulting from the use of this product may be disposed of on site or at an approved waste disposal facility.

CONTAINER HANDLING: Nonrefillable container. Do not reuse or refill this container. Triple rinse container (or equivalent) promptly after emptying. Triple rinse as follows:

(For containers equal to or less than five gallons use these directions:) Empty the remaining contents into application equipment or a mix tank and drain for 10 seconds after the flow begins to drip. Fill the container ¼ full with water and recap. Shake for 10 seconds. Pour rinsate into application equipment or a mix tank or store rinsate for later use or disposal. Drain for 10 seconds after the flow begins to drip. Repeat this procedure two more times. Offer for recycling, if available.

(For containers greater than five gallons use these directions:) Empty the remaining contents into application equipment or a mix tank. Fill the container ¼ full with water. Replace and tighten closures. Tip container on its side and roll it back and forth, ensuring at least one complete revolution, for 30 seconds. Stand the container on its end and tip it back and forth several times. Turn the container over onto its other end and tip it back and forth several times. Empty the rinsate into application equipment or a mix tank or store rinsate for later use

or disposal. Repeat this procedure two more times. Offer for recycling, if available.

BATCH CODE:

[The following claims and product information, may or may not be presented on the product's label and labeling:

-www.neudorff.com



- Selective Moss Killer
- Selective Moss Control
- Kills Moss Without Harming Lawn Grasses
- Kills moss not lawns
- Kills moss not grasses
- Lawn Moss Killer
- Lawn Moss Control
- Water-based
- When diluted, this bottle will treat XXX ft²
- Works in cool weather
- Rainfast in 3 hours
- Works fast
- See results the same day
- See results in hours
- Fast and effective
- No unpleasant odor
- Mix with water
- Does not contain (2,4-D) (MCPA) (Dicamba) (Mecoprop)
- Derived from iron (Fe)
- For non-selective (moss) weed and grass control, use [NEU1170H or NEU1171H – *insert product name*]
- Eliminates unwanted moss, algae and lichens quickly
- Kills algae, moss and lichens
- Kills moss and algae
- Moss killer
- Moss, algae and lichen killer
- Kills moss fast
- Kills moss, algae, and lichens quickly and effectively
- Lawn areas can be re-sown within one day of treatment with NEU1173H
- (Controls) (kills) (dandelions) (buttercup) (English daisy) (daisy) (clover)
- One gallon of concentrate will treat up to 5000 ft² (of lawn)
- Can be used to spot treat problem areas
- Can be used to spot treat problem areas in lawns
- Can be used on new lawns (1 week) after grass emergence
- Even works in cool weather
- Also works in cool weather

NEU1173H

Page 46 of 53

-Patent pending

-Patent #6,972,273

-Makes over XX gallons

-1 ounce = 2 tablespoons = 6 teaspoons

-(Helpful Hints:) Best results are obtained when applied in the Spring or Fall when environmental conditions are cool and there is ample moisture

-People and pets can enter treated area when spray dries]

[Optional warranty statements. Registrant has choice of using any or none.

-NOTICE TO BUYER

Seller warrants that this product conforms to the chemical description on this label and is reasonably fit for the purposes stated in the Directions for Use, subject to the inherent risks described above, when used in accordance with the Directions for Use under normal conditions. To the extent consistent with applicable law, this warranty does not extend to use of this product contrary to label directions, or under abnormal use conditions, or under conditions not reasonably foreseeable to Seller. To the extent consistent with applicable law, the Seller shall not be liable for any such use. To the extent consistent with applicable law, the Seller makes no other warranties, either expressed or implied.

Or

-Buyer assumes all responsibility for safety and use not in accordance with directions.

Or

-Unconditionally Guaranteed by (company name). OUR COMMITMENT TO YOUR SATISFACTION: If you are not happy with the way this product works in your garden, please let us know. We will be happy to replace the product, refund your money, or substitute another (brand name) product. Simply send your name, address and proof of purchase to (Company name & address).]

Or

(company name) guarantees if for any reason you are not satisfied with this product, mail us proof of purchase to obtain a full refund of your purchase price.

NEU1173H Concentrate

Active Ingredient:

Iron HEDTA (FeHEDTA)	26.52%
Other Ingredients:.....	73.48%
Total:	100.00%

KEEP OUT OF REACH OF CHILDREN

CAUTION

FIRST AID	
IF IN EYES	-Hold eye open and rinse slowly and gently with water for 15-20 minutes. -Remove contact lenses, if present, after the first 5 minutes, then continue rinsing eye. -Call a poison control center or doctor for treatment advice.
Have the product container or label with you when calling a poison control center or doctor, or going for treatment.	

PRECAUTIONARY STATEMENTS

HAZARDS TO HUMANS AND DOMESTIC ANIMALS

CAUTION: Causes moderate eye irritation. Avoid contact with eyes or clothing. Wash thoroughly with soap and water after handling and before eating, drinking, chewing gum or using tobacco. Prolonged or frequently repeated skin contact may cause allergic reactions in some individuals.

DIRECTIONS FOR USE

It is a violation of Federal Law to use this product in a manner inconsistent with its labeling.

Read and follow all applicable directions and precautions on this label before using.

PESTS: Controls moss, algae, lichens, and liverworts growing in lawns and turf.

SITES: Lawns, turf (use on rights of way or non-crop areas), golf courses, parks, playgrounds, cemeteries, athletic fields.

Application Directions

Shake well before using. Apply 1 gallon of concentrate/2500 ft². Uniform coverage is important. Rinse treated areas 24 hours after application. Repeat treatment if needed.

[Optional hose-end sprayer directions that may be presented on the container or supplemental wording, either:

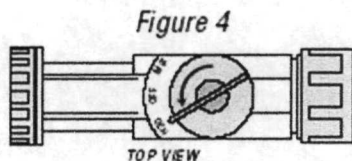
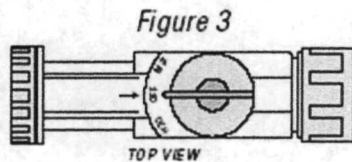
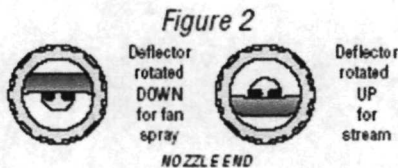
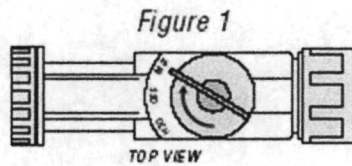

To Use This Sprayer:

1. Shake container well.
2. Connect spray nozzle to garden hose.
3. Turn on the water from the faucet. Extend hose to the farthest area to be treated and work back toward the faucet so you don't come in contact with the treated area.
4. When you are ready to spray, turn the knob on top so that it points to the MIX position on the spray head. (Fig. 1)
5. The spray deflector on the front of the hose-end applicator can be rotated to give a stream or fan spray. (Fig. 2)

To Stop Spraying:

1. When you are finished spraying or if you have to stop spraying at any time, turn the knob back to the OFF position. (Fig. 3)
2. Turn off the water from the faucet.
3. Turn the knob to H2O then OFF, to drain the water from the hose. (Fig. 4)

1. Attach garden hose to spray nozzle. Turn on water supply.
2. Bend safety tab down and turn control to "water".
3. Point nozzle toward plants and turn water control knob to "On". Product will automatically mix with water. Spray moss thoroughly.

To Stop Spraying

1. When you are finished spraying or if you have to stop spraying at any time, turn the blue knob back to the OFF position.
2. Turn off the water from the faucet.
3. Turn the blue knob to H2O then OFF, to drain the water from the hose.
4. Unscrew spray nozzle from hose. Remove hose end from container.
5. Reseal the container with the child-resistant closure. Rinse the hose-end applicator

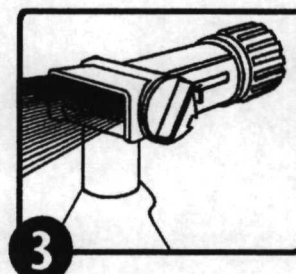
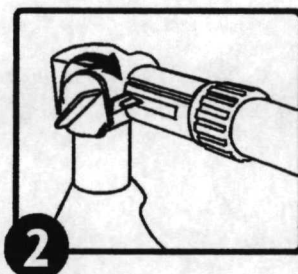
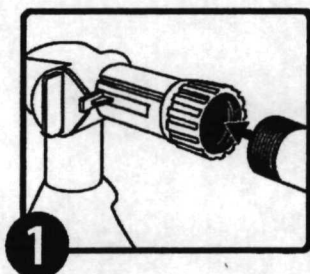

OR

1. Shake container well before using.
2. Connect a garden hose to the Ready Spray nozzle. Make sure the dial on the nozzle is in the "OFF" position with the safety tab in the valve notch.
3. Turn on the water at faucet. Extend hose to the farthest area to be treated and work back toward the faucet so you don't come in contact with the treated area.
4. To BEGIN spraying, point nozzle toward treatment site and
 - a. Bend the safety tab back (located at the right of the yellow dial) with your thumb,
 - b. Using your other hand, QUICKLY turn the dial clockwise until it stops. Water will automatically mix with the product.
5. Spray moss thoroughly. Walk at a steady pace while spraying using an even sweeping motion, slightly overlapping treated areas.
6. To STOP spraying, QUICKLY turn the dial in the opposite direction of "ON" until it stops and the safety tab engages the notch on the valve. Turn water off at faucet. To relieve pressure before removing nozzle from hose, bend the safety tab back and turn dial "ON" until water stops spraying.

7. To STORE unused product, make sure the dial is in the "OFF" position with safety tab in the valve notch. Place in cool area away from heat, sunlight or open flame.

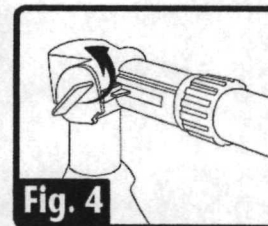
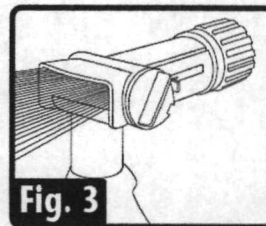
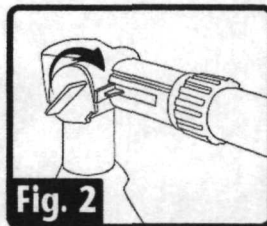
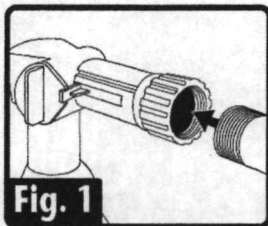

OR

<ul style="list-style-type: none"> • Ensure that the large Water Control Knob is turned to the "OFF" position. • Connect sprayer to garden hose. 	<ul style="list-style-type: none"> • Turn the small Product Control Button so that the flat side aligns with the tab on the right side of the button, and push the button all the way in. • Turn on water at faucet. 	<ul style="list-style-type: none"> • To spray, point nozzle where you want to spray and turn the large knob all the way to the left. • To stop spraying, push small Product Control Button in from opposite side. Turn large Water Control Knob to the right to the "OFF" position and turn off faucet. • NOTE: BEFORE DISCONNECTING HOSE (to relieve water pressure): Turn large Water Control Knob to the left; then turn "OFF" again. • Disconnect garden hose from sprayer. • To prevent accidental discharge when not in use, turn the small Product Control Button so that it is NOT aligned with the tab and cannot be pushed in.

What will I see?

Works quickly. Treated moss or algae will turn brown or black. Occasionally a darkening of the grass leaf blades can occur after treatment, however the grass will recover within a few days to weeks. May stain thatch (dead grass under lawn); this does not affect the health of the grass.

Use Precautions:

Do not apply to drought stressed grass; ensure lawn is well watered prior to application. Do not apply when the daytime temperature will exceed 85°F. Do not apply to bentgrass. If unsure of grass sensitivity, test spray a small area of your lawn. Do not apply to newly seeded areas prior to grass seed germination. Avoid spraying desirable plants. Any desirable plants or structures accidentally contacted should be rinsed with water. To avoid staining, wait until treated area dries before re-entry. Do not apply if rainfall is expected within 3 hours of application. Do not irrigate within 3 hours of application. Do not apply to the same area more than 2 times a year.

STORAGE AND DISPOSAL

Do not contaminate water, food or feed by storage or disposal.

PESTICIDE STORAGE: Store in a secure place, away from open fire or flame. Keep container closed and reseal after use. If spilled, use absorbent materials and dispose of in an approved manner.

PESTICIDE DISPOSAL: Wastes resulting from the use of this product may be disposed of on site or at an approved waste disposal facility.

CONTAINER HANDLING: Nonrefillable container. Do not reuse or refill this container. Triple rinse container (or equivalent) promptly after emptying. Triple rinse as follows:

(For containers equal to or less than five gallons use these directions:) Empty the remaining contents into application equipment or a mix tank and drain for 10 seconds after the flow begins to drip. Fill the container ¼ full with water and recap. Shake for 10 seconds. Pour rinsate into application equipment or a mix tank or store rinsate for later use or disposal. Drain for 10 seconds after the flow begins to drip. Repeat this procedure two more times. Offer for recycling, if available.

(For containers greater than five gallons use these directions:) Empty the remaining contents into application equipment or a mix tank. Fill the container ¼ full with water. Replace and tighten closures. Tip container on its side and roll it back and forth, ensuring at least one complete revolution, for 30 seconds. Stand the container on its end and tip it back and forth several times. Turn the container over onto its other end and tip it back and forth several times. Empty the rinsate into application equipment or a mix tank or store rinsate for later use or disposal. Repeat this procedure two more times. Offer for recycling, if available.

BATCH CODE:

[The following claims and product information, may or may not be presented on the product's label and labeling:

-www.neudorff.com



- Selective Moss Killer
- Selective Moss Control
- Kills Moss Without Harming Lawn Grasses
- Kills moss not lawns
- Kills moss not grasses
- Lawn Moss Killer
- Lawn Moss Control
- Water-based
- With the provided hose-end sprayer, this container will treat XXX ft²
- Works in cool weather
- Rainfast in 3 hours
- Works fast
- See results the same day
- See results in hours
- Fast and effective
- No unpleasant odor
- Mix with water
- Does not contain (2,4-D) (MCPA) (Dicamba) (Mecoprop)
- Derived from iron (Fe)
- For non-selective (moss) weed and grass control, use [NEU1170H or NEU1171H – *insert product name*]
- Eliminates unwanted moss, algae and lichens quickly
- Kills algae, moss and lichens
- Kills moss and algae
- Moss killer
- Moss, algae and lichen killer
- Kills moss fast
- Kills moss, algae, and lichens quickly and effectively
- Lawn areas can be re-sown within one day of treatment with NEU1173H
- (Controls) (kills) (dandelions) (buttercup) (English daisy) (daisy) (clover)
- One gallon of concentrate will treat up to 2500 ft² (of lawn)
- Can be used on new lawns (1 week) after grass emergence
- Even works in cool weather
- Also works in cool weather
- Patent pending
- Patent #6,972,273
- (Helpful Hints:) Best results are obtained when applied in the Spring or Fall when environmental conditions are cool and there is ample moisture
- (Helpful Hints:) The best times to treat weeds are in the Spring when they are small and growing and in the Fall to eliminate many of next year's weeds

-People and pets can enter treated area when spray dries

-Ready-To-Spray

-Hose-End Bottle

-Hose-End Sprayer

-This product is ready to spray. Just attach this bottle to your garden hose according to directions. Water automatically mixes with the concentrate as you spray.]

[Optional warranty statements. Registrant has choice of using any or none.

-NOTICE TO BUYER

Seller warrants that this product conforms to the chemical description on this label and is reasonably fit for the purposes stated in the Directions for Use, subject to the inherent risks described above, when used in accordance with the Directions for Use under normal conditions. To the extent consistent with applicable law, this warranty does not extend to use of this product contrary to label directions, or under abnormal use conditions, or under conditions not reasonably foreseeable to Seller. To the extent consistent with applicable law, the Seller shall not be liable for any such use. To the extent consistent with applicable law, the Seller makes no other warranties, either expressed or implied.

Or

-Buyer assumes all responsibility for safety and use not in accordance with directions.

Or

-Unconditionally Guaranteed by (company name). **OUR COMMITMENT TO YOUR SATISFACTION:** If you are not happy with the way this product works in your garden, please let us know. We will be happy to replace the product, refund your money, or substitute another (brand name) product. Simply send your name, address and proof of purchase to (Company name & address).]

Or

(company name) guarantees if for any reason you are not satisfied with this product, mail us proof of purchase to obtain a full refund of your purchase price.