



UNITED STATES ENVIRONMENTAL PROTECTION AGENCY
WASHINGTON, D.C. 20460

OFFICE OF CHEMICAL SAFETY
AND POLLUTION PREVENTION

October 7, 2010

Walter G. Talarek, P.C.
Authorized Agent, W. Neudorff GmbH KG
1008 Riva Ridge Drive
Great Falls, VA 22066

Subject: Notification to Add Container Sizes, Optional Marketing Claims,
Optional Warranty Statements, and Several Minor Label Changes
Product Name: NEU1173H Concentrate
EPA Reg. No: 67702-26
Your Submission Dated September 21, 2010

Dear Mr. Talarek:

The Biopesticides and Pollution Prevention Division is in receipt of your application for Notification under Pesticide Registration Notices (PRNs) 98-10 and 2007-4, dated above. A screen of the request has been conducted for its applicability under PRNs 98-10 and 2007-4, and it has been determined that the action request falls within the scope of these documents. Our records have been duly noted, and the label submitted with this application has been stamped "Notification Accepted" and will be placed in our records as current and updated. Should you have any questions regarding this action, you may contact Gina Casciano at (703) 605-0513 or via email at casciano.gina@epa.gov.

Sincerely,

Linda Hollis

Linda A. Hollis, Chief
Biochemical Pesticides Branch
Biopesticides and Pollution
Prevention Division (7511P)

91

20557

Please read instructions on reverse before complete form.

Form Approved. O. No. 2070-0060

Print Form



United States
Environmental Protection Agency
Washington, DC 20460

<input type="checkbox"/>	Registration
<input type="checkbox"/>	Amendment
<input checked="" type="checkbox"/>	Other

OPP Identifier Number

Application for Pesticide - Section I

1. Company/Product Number 67702-26	2. EPA Product Manager Linda Hollis	3. Proposed Classification <input checked="" type="checkbox"/> None <input type="checkbox"/> Restricted
4. Company/Product (Name) NEU1173H Concentrate	PM# 91	
5. Name and Address of Applicant (Include ZIP Code) W. Neudorff GmbH KG c/o Walter G. Talarek PC 1008 Riva Ridge Drive Great Falls, VA 22066-1620 <input type="checkbox"/> Check if this is a new address	6. Expedited Review. In accordance with FIFRA Section 3(c)(3) (b)(i), my product is being submitted for expedited review and labeling to: Notification Accepted EPA Reg. No. <u> </u> Date: <u>10/7/10</u> Product Name <u> </u> Reviewer: <u>G. Casciano</u>	

Section - II

<input type="checkbox"/> Amendment - Explain below.	<input type="checkbox"/> Final printed labels in response to Agency letter dated <u> </u>
<input type="checkbox"/> Resubmission in response to Agency letter dated <u> </u>	<input type="checkbox"/> "Me Too" Application.
<input checked="" type="checkbox"/> Notification - Explain below.	<input type="checkbox"/> Other - Explain below.

Explanation: Use additional page(s) if necessary. (For section I and Section II.)

Notification under PR Notice 98-10 which makes revisions to the product's label. See the enclosed letter to Ms. Linda Hollis, PM 91, for a full explanation of the notification and the certification required by PR Notice 98-10.

Section - III

1. Material This Product Will Be Packaged In:				2. Type of Container	
Child-Resistant Packaging <input type="checkbox"/> Yes* <input type="checkbox"/> No	Unit Packaging <input type="checkbox"/> Yes <input type="checkbox"/> No	Water Soluble Packaging <input type="checkbox"/> Yes <input type="checkbox"/> No	<input type="checkbox"/> Metal <input type="checkbox"/> Plastic <input type="checkbox"/> Glass <input type="checkbox"/> Paper <input type="checkbox"/> Other (Specify) <u> </u>		
* Certification must be submitted		If "Yes" Unit Packaging wgt. No. per container	If "Yes" Package wgt. No. per container		
3. Location of Net Contents Information <input type="checkbox"/> Label <input type="checkbox"/> Container		4. Size(s) Retail Container		5. Location of Label Directions <input type="checkbox"/> On Label <input type="checkbox"/> On Labeling accompanying product	
6. Manner in Which Label is Affixed to Product		<input type="checkbox"/> Lithograph <input type="checkbox"/> Paper glued <input type="checkbox"/> Stenciled		<input type="checkbox"/> Other <u> </u>	

Section - IV

1. Contact Point (Complete items directly below for identification of individual to be contacted, if necessary, to process this application.)		
Name Walter G. Talarek	Title Authorized Agent	Telephone No. (Include Area Code) 703-759-4837
2. Signature 		6. Date Application Received (Stamped) <u> </u>
3. Title Authorized Agent		
4. Typed Name Walter G. Talarek		
5. Date September 21, 2010		

Certification
I certify that the statements I have made on this form and all attachments thereto are true, accurate and complete. I acknowledge that any knowingly false or misleading statement may be punishable by fine or imprisonment or both under applicable law.

30 of 57

LAW OFFICES OF
WALTER G. TALAREK, P.C.
1008 RIVA RIDGE DRIVE
GREAT FALLS, VA 22066-1620

PHONE: 703-759-4837
FAX: 703-759-5548
E-MAIL: WTALAREK@VERIZON.NET

September 21, 2010

DELIVERED BY COURIER

Linda Hollis, Chief
Biochemicals Branch
Biopesticides and Pollution Prevention Division
c/o Document Processing Desk (NOTIF)
Office of Pesticide Programs (7504P)
U.S. Environmental Protection Agency
Room S-4900, One Potomac Yard
2777 S, Crystal Drive
Arlington, VA 22202

Re: NEU1173H Concentrate
EPA Reg. No. 67702-26
Notification

Dear Ms. Hollis:

Please find enclosed W. Neudorff GmbH KG's (Neudorff's) application under PR Notice 98-10 for a notification for the registration of NEU1173H Concentrate, EPA Reg. No. 67702-26. In essence, this notification (1) adds four (4) container sizes to the product's registration, and (2) revises the product's label as follows:

1. Adds an option to Sub-label A allowing supplemental distributors to use their toll-free numbers in the First Aid section. In addition, this section has been revised to comport with your letter of September 14, 2010, rejecting Neudorff's July 14, 2010, application for a notification;
2. Adds an option to Sub-label A for the use of one of two formats for the directions for use;
3. Adds an option to Sub-labels A and B for the use of one of two pests sections. One pests section must be used on the labels of products sold or distributed in California;
4. Adds an option to Sub-label A for supplemental distributors to use their toll-free numbers in the disposal sub-section of the Storage and Disposal section;
5. Adds the words "Batch Code" under the Storage and Disposal sections of all sub-labels;

6. Adds ten (10) optional marketing claims to Sub-label A, including two “Quick Facts” boxes, which list some of the information already on the product’s label, and which will be used by Bayer AG, which is one of the supplemental distributors of the product;
7. Adds two optional, alternative warranty statements to Sub-label A;
8. Revises the product’s storage and disposal sections to comport with PR Notice 2007-4 and your letter of September 14, 2010, rejecting Neudorff’s July 14, 2010, application for a notification. However, please note that the statement “Do not contaminate water, food or feed by storage and disposal” and the formatting that you identified were not followed for the household use sub-labels, i.e., Sub-labels A, B, C and D. The prohibitory statement is not required for household use labels. See page 13-2 of the Label Review Manual. Moreover, different formatting is required for household use labels. See page 13-26 of the Label Review Manual; and
9. The claim “Iron (Fe) occurs in nature” has been removed in response to your letter of September 14, 2010, rejecting Neudorff’s September 14, 2010, application for a notification.

Two (2) copies of the revised label are enclosed. One (1) of the copies has the revisions being made by this notification highlighted in yellow.

This notification is consistent with PR Notices 98-10 and EPA's regulations at 40 CFR 152.46, and no other changes have been made to the labeling or the confidential statement of formula of this product. I understand that it is a violation of 18 U.S.C. Sec. 1001 to willfully make any false statement to EPA. I further understand that if this notification is not consistent with the terms of PR Notices 98-10 and 40 CFR 152.46, this product may be in violation of FIFRA and I may be subject to enforcement action and penalties under sections 12 and 14 of FIFRA.

If you have any questions about this notification, please feel free to call me.

Sincerely yours,

Sincerely yours,

W. J. Salant

Walter G. Talarek
Authorized Agent

Enclosure – Application for Notification

1 2 3 4 5 6 7 8 9 10 11 12 13 14 15 16 17 18 19 20 21 22 23 24 25 26 27 28 29 30 31 32 33 34 35 36 37 38 39 40 41 42 43 44 45 46 47 48 49 50 51 52 53 54 55 56 57 58 59 60 61 62 63 64 65 66 67 68 69 70 71 72 73 74 75 76 77 78 79 80 81 82 83 84 85 86 87 88 89 90 91 92 93 94 95 96 97 98 99 100 101 102 103 104 105 106 107 108 109 110 111 112 113 114 115 116 117 118 119 120 121 122 123 124 125 126 127 128 129 130 131 132 133 134 135 136 137 138 139 140 141 142 143 144 145 146 147 148 149 150 151 152 153 154 155 156 157 158 159 160 161 162 163 164 165 166 167 168 169 170 171 172 173 174 175 176 177 178 179 180 181 182 183 184 185 186 187 188 189 190 191 192 193 194 195 196 197 198 199 200 201 202 203 204 205 206 207 208 209 210 211 212 213 214 215 216 217 218 219 220 221 222 223 224 225 226 227 228 229 230 231 232 233 234 235 236 237 238 239 240 241 242 243 244 245 246 247 248 249 250 251 252 253 254 255 256 257 258 259 260 261 262 263 264 265 266 267 268 269 270 271 272 273 274 275 276 277 278 279 280 281 282 283 284 285 286 287 288 289 290 291 292 293 294 295 296 297 298 299 300 301 302 303 304 305 306 307 308 309 310 311 312 313 314 315 316 317 318 319 320 321 322 323 324 325 326 327 328 329 330 331 332 333 334 335 336 337 338 339 340 341 342 343 344 345 346 347 348 349 350 351 352 353 354 355 356 357 358 359 360 361 362 363 364 365 366 367 368 369 370 371 372 373 374 375 376 377 378 379 380 381 382 383 384 385 386 387 388 389 390 391 392 393 394 395 396 397 398 399 400 401 402 403 404 405 406 407 408 409 410 411 412 413 414 415 416 417 418 419 420 421 422 423 424 425 426 427 428 429 430 431 432 433 434 435 436 437 438 439 440 441 442 443 444 445 446 447 448 449 450 451 452 453 454 455 456 457 458 459 460 461 462 463 464 465 466 467 468 469 470 471 472 473 474 475 476 477 478 479 480 481 482 483 484 485 486 487 488 489 490 491 492 493 494 495 496 497 498 499 500 501 502 503 504 505 506 507 508 509 510 511 512 513 514 515 516 517 518 519 520 521 522 523 524 525 526 527 528 529 530 531 532 533 534 535 536 537 538 539 540 541 542 543 544 545 546 547 548 549 550 551 552 553 554 555 556 557 558 559 560 561 562 563 564 565 566 567 568 569 570 571 572 573 574 575 576 577 578 579 580 581 582 583 584 585 586 587 588 589 590 591 592 593 594 595 596 597 598 599 600 601 602 603 604 605 606 607 608 609 610 611 612 613 614 615 616 617 618 619 620 621 622 623 624 625 626 627 628 629 630 631 632 633 634 635 636 637 638 639 640 641 642 643 644 645 646 647 648 649 650 651 652 653 654 655 656 657 658 659 660 661 662 663 664 665 666 667 668 669 670 671 672 673 674 675 676 677 678 679 680 681 682 683 684 685 686 687 688 689 690 691 692 693 694 695 696 697 698 699 700 701 702 703 704 705 706 707 708 709 710 711 712 713 714 715 716 717 718 719 720 721 722 723 724 725 726 727 728 729 730 731 732 733 734 735 736 737 738 739 740 741 742 743 744 745 746 747 748 749 750 751 752 753 754 755 756 757 758 759 760 761 762 763 764 765 766 767 768 769 770 771 772 773 774 775 776 777 778 779 780 781 782 783 784 785 786 787 788 789 790 791 792 793 794 795 796 797 798 799 800 801 802 803 804 805 806 807 808 809 810 811 812 813 814 815 816 817 818 819 820 821 822 823 824 825 826 827 828 829 830 831 832 833 834 835 836 837 838 839 840 841 842 843 844 845 846 847 848 849 850 851 852 853 854 855 856 857 858 859 860 861 862 863 864 865 866 867 868 869 870 871 872 873 874 875 876 877 878 879 880 881 882 883 884 885 886 887 888 889 890 891 892 893 894 895 896 897 898 899 900 901 902 903 904 905 906 907 908 909 910 911 912 913 914 915 916 917 918 919 920 921 922 923 924 925 926 927 928 929 930 931 932 933 934 935 936 937 938 939 940 941 942 943 944 945 946 947 948 949 950 951 952 953 954 955 956 957 958 959 960 961 962 963 964 965 966 967 968 969 970 971 972 973 974 975 976 977 978 979 980 981 982 983 984 985 986 987 988 989 990 991 992 993 994 995 996 997 998 999 1000 1001 1002 1003 1004 1005 1006 1007 1008 1009 1010 1011 1012 1013 1014 1015 1016 1017 1018 1019 1020 1021 1022 1023 1024 1025 1026 1027 1028 1029 1030 1031 1032 1033 1034 1035 1036 1037 1038 1039 104

MASTER LABEL

NEU1173H Concentrate

Active Ingredient:	
Iron HEDTA (FeHEDTA)	26.52%
Other Ingredients:	73.48%
Total:	100.00%

- SUBLABEL A: Household use on Weeds
- SUBLABEL B: Household use on Weeds – Hose-end Sprayer
- SUBLABEL C: Household use on Moss
- SUBLABEL D: Household use on Moss – Hose-end Sprayer
- SUBLABEL E: Commercial use on Weeds
- SUBLABEL F: Commercial use on Weeds – Hose-end Sprayer
- SUBLABEL G: Commercial use on Moss
- SUBLABEL H: Commercial use on Moss – Hose-end Sprayer

EPA REG. NO. 67702-26

EPA EST. 67702-DEU-1

**KEEP OUT OF REACH OF CHILDREN
CAUTION**

Registrant: W. Neudorff GmbH KG
An der Muhle 3, Postfach 1209
D-31860 Emmerthal, Germany
www.neudorff.com

Household Use: NET CONTENTS: 5 fl. oz., 10 fl. oz. (two 5 fl. oz. bottles), 12 fl. oz., 15 fl. oz., 16 fl. oz., 20 fl. oz., 24 fl. oz., 32 fl. oz., 1 gallon, 227 gallons

Commercial Use: NET CONTENTS: 1 gallon, 2.5 gallons, 5 gallons, 10 gallons, 20 gallons, 40 gallons, 45 gallons, 50 gallons, 200 gallons, 227 gallons

Notification Accepted

Date: 10/7/10
Reviewer: G Casciano

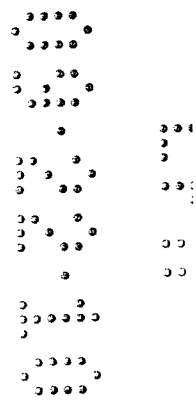

60457

NEU1173H Concentrate

Active Ingredient:

Iron HEDTA (FeHEDTA)	26.52%
Other Ingredients:.....	73.48%
Total:.....	100.00%

KEEP OUT OF REACH OF CHILDREN

CAUTION

FIRST AID	
IF IN EYES	-Hold eye open and rinse slowly and gently with water for 15-20 minutes. -Remove contact lenses, if present, after the first 5 minutes, then continue rinsing eye. -Call a poison control center or doctor for treatment advice.
Have the product container or label with you when calling a poison control center or doctor, or going for treatment. [Optionally, supplemental distributor's may use the following wording and own toll-free hotline number: For medical emergency information, you may call toll free 1-XXX-XXX-XXXX [insert operating hours and days of service]	

PRECAUTIONARY STATEMENTS

HAZARDS TO HUMANS AND DOMESTIC ANIMALS

CAUTION: Causes slight eye irritation. Avoid contact with eyes or clothing. Wash thoroughly with soap and water after handling and before eating, drinking, chewing gum or using tobacco. Prolonged or frequently repeated skin contact may cause allergic reactions in some individuals.

[One of the two following formats must be used:

Format 1:

DIRECTIONS FOR USE

It is a violation of Federal Law to use this product in a manner inconsistent with its labeling.

Use Sites:

Use to selectively control/suppress broadleaf weeds growing in lawns

Pests:

[One of the two following sections must be used. The first section may be used on the labels of products sold or distributed in all states, except California. The

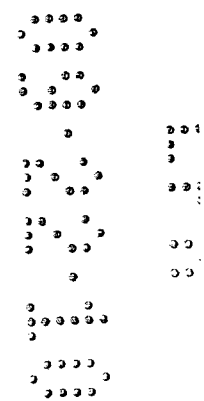

NEU1173H

Page 3 of 53

second section must be used on the labels of products sold or distributed in California:

Controls or suppresses the following weeds such as but not limited to: Dandelion, English daisy, False dandelion, White clover, Black medic, Bull thistle, Canada thistle, Common chickweed, Creeping buttercup, Persian Speedwell, Slender speedwell, Broadleaf plantain, Narrow-leaved plantain, Dovefoot geranium, Healall, Shepherd's-purse, Silverweed cinquefoil, Wild chamomile, Moss, Liverworts, Algae, Lichens.

OR

Controls the following weeds: Dandelion, English daisy, and Moss.

Suppresses the following weeds: Broadleaf plantain, Narrow-leaved plantain, White clover, Creeping buttercup and Slender speedwell]

Application Directions

Shake well before using. Mix one part [NEU1173H] with 24 parts water (5 oz. in 1 gallon of water). Apply the mixed solution at a rate of 5-10 gallons/1000 ft² (5.75-11.5 fluid oz./yard²). Any standard hand-held or backpack sprayer can be used. Thoroughly spray weeds. Use a coarse nozzle setting to reduce drift. Uniform coverage is important.

Repeat treatment in 3 to 4 weeks for best results.

What will I see?

Works quickly; dying weeds will be seen within hours of application. Treated weeds, moss or algae will turn brown or black. Occasionally a darkening of the grass leaf blades can occur after treatment, however the grass will recover within a few days to weeks. May stain thatch (dead grass under lawn); this does not affect the health of the grass.

Use Precautions:

Do not apply to drought stressed grass; ensure lawn is well watered prior to application. Do not apply when the daytime temperature will exceed 85°F. Do not apply to bentgrass. If unsure of grass sensitivity, test spray a small area of your lawn. Do not apply to newly seeded areas prior to grass seed germination. Avoid spraying desirable plants. Any desirable plants or structures accidentally contacted should be rinsed with water. To avoid staining, wait until treated area dries before re-entry. Do not apply if rainfall is expected within 3 hours of application. Do not irrigate within 3 hours of application. Do not apply to the same area more than 4 times a year.

OR

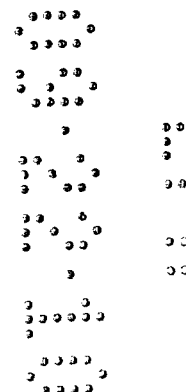

Format 2:

DIRECTIONS FOR USE	
It is a violation of Federal Law to use this product in a manner inconsistent with its labeling.	
BEFORE YOU USE	Shake well before using.
WHERE TO USE	Use to selectively control/suppress broadleaf weeds growing in lawns
HOW TO USE	Mix 5 fl. oz. of Bayer Advanced Natria Lawn Weed Control Concentrate into 1 gallon of water. Apply the mixed solution at a rate of 0.5 - 1 gallon/100 sq. ft. Any standard hand-held or backpack sprayer can be used. Thoroughly spray weeds. Use a coarse nozzle setting to reduce drift. Uniform coverage is important.
WHAT WILL I SEE?	Works quickly; dying weeds will be seen within hours of application. Treated weeds or moss will turn brown or black. Occasionally a darkening of the grass leaf blades can occur after treatment; however, the grass will recover within a few days to weeks. May stain thatch (dead grass under lawn); this does not affect the health of the grass.
PESTS (WEEDS, MOSS & ALGAE)	[insert one of pests sections from Directions for Use above]
USE PRECAUTIONS	<ul style="list-style-type: none">• Do not apply to drought stressed grass. Ensure that lawn is well watered prior to application.• Do not apply when the daytime temperature will exceed 85 °F.• Do not apply to bentgrass.• If unsure of grass sensitivity, test spray a small area of your lawn.• Do not apply to newly seeded areas prior to grass seed germination.• Avoid spraying desirable plants. Any desirable plants or structures accidentally contacted should be rinsed with water.• To avoid staining, wait until treated area dried before re-entry.• Do not apply if rainfall is expected within 3 hours of application. Do not irrigate within 3 hours of application.• Do not apply to the same area more than 4 times a year.

STORAGE AND DISPOSAL

PESTICIDE STORAGE: Store this product in its original container and keep in a secure storage area out of reach of children and domestic animals. Store unused material, tightly closed, in original container only, away from open flame.

PESTICIDE DISPOSAL AND CONTAINER HANDLING:

Nonrefillable container. Do not reuse or refill this container.

If empty: Place in trash or offer for recycling if available.

If partly filled: Call your local solid waste agency [or call [insert supplemental distributor's toll free number]] for disposal instructions. Never place unused product down any indoor or outdoor drain.

BATCH CODE:

[The following claims and product information, may or may not be presented on the product's label and labeling:

-www.neudorff.com



- Weed Killer for Lawns
- Selective Weed Killer
- Selective Broadleaf Weed Killer
- Selective Weed Control
- Selective Broadleaf Weed Control
- Selective Control of Weeds in Lawns
- Selective Control of Broadleaf Weeds in Lawns
- Kills weeds not lawns
- Kills weeds not grasses
- Lawn Weed Killer
- Lawn Weed Control
- Water-based
- When diluted, this bottle will treat XXX ft²
- Works in cool weather
- Rainfast in 3 hours
- Works fast
- See results the same day
- See results in hours
- Fast and effective
- Mix with water
- No unpleasant odor
- Does not contain (2,4-D) (MCPA) (Dicamba) (Mecoprop)
- Derived from iron (Fe)
- For non-selective (moss) weed and grass control, use [H01 or NEU1171H – *insert product name*]
- Eliminates unwanted moss, algae and lichens quickly

NEU1173H

Page 6 of 53

- Kills algae, moss and lichens
- Kills moss and algae
- Moss killer
- Moss, algae and lichen killer
- Kills moss fast
- Kills moss, algae, and lichens quickly and effectively
- Can be used on new lawns (1 week) after grass emergence
- Lawn areas can be re-sown within one day of treatment with NEU1173H
- (Controls) (kills) (dandelions) (buttercup) (English daisy) (daisy) (clover)
- One gallon of concentrate will treat up to 5000 ft² (of lawn)
- Can be used to spot treat problem areas
- Can be used to spot treat problem areas in lawns
- Can be used on new lawns (1 week) after grass emergence
- Even works in cool weather
- Also works in cool weather
- Patent pending
- Patent #6,972,273
- Makes over XX gallons
- 1 ounce = 2 tablespoons = 6 teaspoons
- Kills weeds, down to the root
- Kills dandelions, down to the root
- (Helpful Hints:) Best results are obtained when applied in the Spring or Fall when environmental conditions are cool and there is ample moisture
- (Helpful Hints:) The best times to treat weeds are in the Spring when they are small and growing and in the Fall to eliminate many of next year's weeds
- People and pets can enter treated area when spray dries
- Controls broadleaf weeds in lawns
- NEU1173H is a herbicide derived from iron that is used to selectively control/suppress broadleaf weeds growing in lawns
- See side panel for mixing instructions.
- See bottle label inside for complete "directions for use".
- Includes two 5 fl. oz. bottles. Makes 2 gallons [of spray]
- Value [package]. Makes 2 gallons [of spray]
- [Open box] [Box contains 2 bottles of product]
- Refer to leaflet for complete [First Aid], [Directions for Use], [Precautionary Statements], and [Storage and Disposal Instructions]
- READ THE LABEL FIRST!**

QUICK FACTS

- Kills Weeds Not Lawns
- Derived from Iron
- Even Works in Cool Weather.
- Can be Used on New Lawns 1 Week After Grass Emergence

CONTROLS

- Dandelion, Common Chickweed, Clover and other Listed Broadleaf Weeds
- Moss, Algae and Lichens

110457

WHERE TO USE	• On lawns (do not apply to bentgrass)
[phone graphic]	For questions or comments, call toll-free 1-877-BayerAG (1-877-229-3724).

]

[Optional warranty statements. Registrant has choice of using any or none.

-NOTICE TO BUYER

Seller warrants that this product conforms to the chemical description on this label and is reasonably fit for the purposes stated in the Directions for Use, subject to the inherent risks described above, when used in accordance with the Directions for Use under normal conditions. To the extent consistent with applicable law, this warranty does not extend to use of this product contrary to label directions, or under abnormal use conditions, or under conditions not reasonably foreseeable to Seller. To the extent consistent with applicable law, the Seller shall not be liable for any such use. To the extent consistent with applicable law, the Seller makes no other warranties, either expressed or implied.

Or

-Buyer assumes all responsibility for safety and use not in accordance with directions.

Or

-Unconditionally Guaranteed by (company name). **OUR COMMITMENT TO YOUR SATISFACTION:** If you are not happy with the way this product works in your garden, please let us know. We will be happy to replace the product, refund your money, or substitute another (brand name) product. Simply send your name, address and proof of purchase to (Company name & address).

Or

(company name) guarantees if for any reason you are not satisfied with this product, mail us proof of purchase to obtain a full refund of your purchase price.

OR

Warranty:

Seller warrants that this product conforms to the chemical description on this label and is reasonably fit for purposes stated on this label only when used in accordance with directions under normal use conditions. To the fullest extent permitted by law, the seller shall not be liable for damages caused by buyer's use of product contrary to label directions, or under abnormal use conditions, or

NEU1173H

Page 8 of 53

under conditions not reasonably foreseeable to seller. Seller makes no other warranties, either expressed or implied.

OR

Money Back Guarantee: If you are not satisfied with this product, we will gladly refund your original purchase price.

]

SUBLABEL B – HOUSEHOLD USE ON WEEDS – Hose-end Sprayer

NEU1173H Concentrate

Active Ingredient:

Iron HEDTA (FeHEDTA)	26.52%
Other Ingredients:.....	73.48%
Total:	100.00%

KEEP OUT OF REACH OF CHILDREN

CAUTION

FIRST AID	
IF IN EYES	-Hold eye open and rinse slowly and gently with water for 15-20 minutes. -Remove contact lenses, if present, after the first 5 minutes, then continue rinsing eye. -Call a poison control center or doctor for treatment advice.
Have the product container or label with you when calling a poison control center or doctor, or going for treatment.	

PRECAUTIONARY STATEMENTS

HAZARDS TO HUMANS AND DOMESTIC ANIMALS

CAUTION: Causes slight eye irritation. Avoid contact with eyes or clothing. Wash thoroughly with soap and water after handling and before eating, drinking, chewing gum or using tobacco. Prolonged or frequently repeated skin contact may cause allergic reactions in some individuals.

DIRECTIONS FOR USE

It is a violation of Federal Law to use this product in a manner inconsistent with its labeling.

Use Sites:

Use to selectively control/suppress broadleaf weeds growing in lawns

Pests:

[One of the two following sections must be used. The first section may be used on the labels of products sold or distributed in all states, except California. The second section must be used on the labels of products sold or distributed in California:

Controls or suppresses the following weeds such as but not limited to: Dandelion, English daisy, False dandelion, White clover, Black medic, Bull thistle, Canada thistle, Common chickweed, Creeping buttercup, Persian Speedwell, Slender speedwell, Broadleaf plantain, Narrow-leaved plantain, Dovefoot geranium,

140857

NEU1173H

Page 10 of 53

Healall, Shepherd's-purse, Silverweed cinquefoil, Wild chamomile, Moss, Liverworts, Algae, Lichens.

OR

Controls the following weeds: Dandelion, English daisy, and Moss.

Suppresses the following weeds: Broadleaf plantain, Narrow-leaved plantain, White clover, Creeping buttercup and Slender speedwell]

Application Directions

Shake well before using. Apply 1 gallon of concentrate/2500 ft². Uniform coverage is important. Rinse treated areas 24 hours after application. Repeat treatment in 3 to 4 weeks for best results.

[Optional hose-end sprayer directions that may be presented on the container or supplemental wording, either:

Figure 1

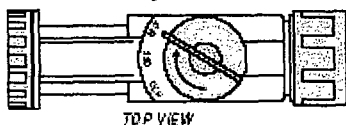

Figure 2



Figure 3

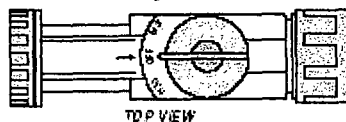
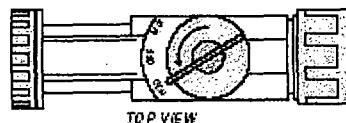

Figure 4



To Use This Sprayer:

1. Shake container well.
2. Connect spray nozzle to garden hose.

NEU1173H

Page 11 of 53

3. Turn on the water from the faucet. Extend hose to the farthest area to be treated and work back toward the faucet so you don't come in contact with the treated area.
4. When you are ready to spray, turn the knob on top so that it points to the MIX position on the spray head. (Fig. 1)
5. The spray deflector on the front of the hose-end applicator can be rotated to give a stream or fan spray. (Fig. 2)

6. When you are finished spraying or if you have to stop spraying at any time, turn the knob back to the OFF position. (Fig. 3)
7. Turn off the water from the faucet.
8. Turn the knob to H2O then OFF, to drain the water from the hose. (Fig. 4)

OR

1. Attach garden hose to spray nozzle. Turn on water supply.
2. Bend safety tab down and turn control to "water".
3. Point nozzle toward plants and turn water control knob to "On". Product will automatically mix with water. Spray weeds thoroughly.

To Stop Spraying:

1. When you are finished spraying or if you have to stop spraying at any time, turn the blue knob back to the OFF position.
2. Turn off the water from the faucet.
3. Turn the blue knob to H2O then OFF, to drain the water from the hose.
4. Unscrew spray nozzle from hose. Remove hose end from container.
5. Reseal the container with the child-resistant closure. Rinse the hose-end applicator

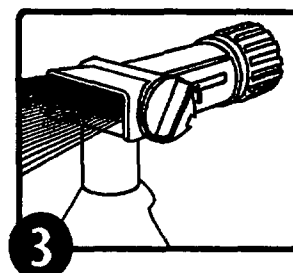
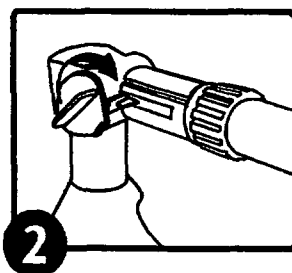
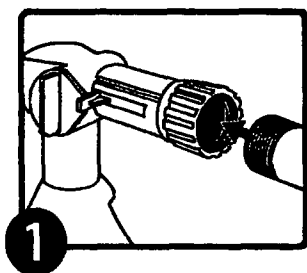



OR

1. Shake container well before using.
2. Connect a garden hose to the Ready Spray nozzle. Make sure the dial on the nozzle is in the "OFF" position with the safety tab in the valve notch.
3. Turn on the water at faucet. Extend hose to the farthest area to be treated and work back toward the faucet so you don't come in contact with the treated area.
4. To BEGIN spraying, point nozzle toward treatment site and
 - a. Bend the safety tab back (located at the right of the yellow dial) with your thumb,

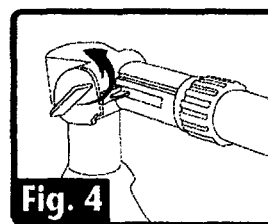
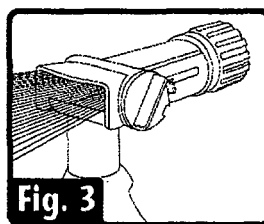
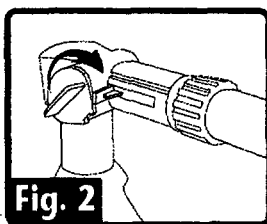
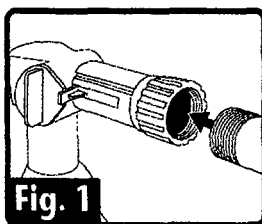
- b. Using your other hand, QUICKLY turn the dial clockwise until it stops. Water will automatically mix with the product.
5. Spray weeds thoroughly. Walk at a steady pace while spraying using an even sweeping motion, slightly overlapping treated areas.
6. To STOP spraying, QUICKLY turn the dial in the opposite direction of "ON" until it stops and the safety tab engages the notch on the valve. Turn water off at faucet. To relieve pressure before removing nozzle from hose, bend the safety tab back and turn dial "ON" until water stops spraying.
7. To STORE unused product, make sure the dial is in the "OFF" position with safety tab in the valve notch. Place in cool area away from heat, sunlight or open flame.

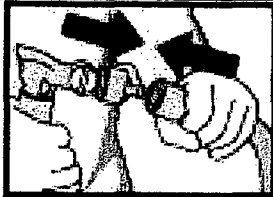

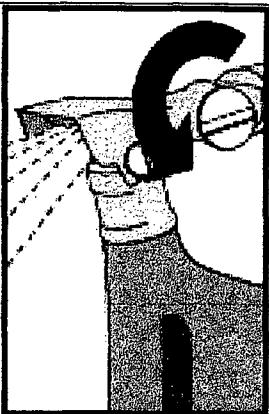
		
<ul style="list-style-type: none"> • Ensure that the large Water Control Knob is turned to the "OFF" position. • Connect sprayer to garden hose. 	<ul style="list-style-type: none"> • Turn the small Product Control Button so that the flat side aligns with the tab on the right side of the button, and push the button all the way in. • Turn on water at faucet. 	<ul style="list-style-type: none"> • To spray, point nozzle where you want to spray and turn the large knob all the way to the left. • To stop spraying, push small Product Control Button in from opposite side. Turn large Water Control Knob to the right to the "OFF" position and turn off faucet. • NOTE: BEFORE DISCONNECTING HOSE (to relieve water pressure): Turn large Water Control Knob to the left; then turn "OFF" again. • Disconnect garden hose from sprayer. • To prevent accidental discharge when not in use, turn the small Product Control Button so that it is <u>NOT</u> aligned with the tab and cannot be pushed in.

]

What will I see?

Works quickly; dying weeds will be seen within hours of application. Treated weeds, moss or algae will turn brown or black. Occasionally a darkening of the grass leaf blades can occur after treatment, however the grass will recover within a few days to weeks. May stain thatch (dead grass under lawn); this does not affect the health of the grass.

Use Precautions:

190457

NEU1173H

Page 15 of 53

Do not apply to drought stressed grass; ensure lawn is well watered prior to application. Do not apply when the daytime temperature will exceed 85°F. Do not apply to bentgrass. If unsure of grass sensitivity, test spray a small area of your lawn. Do not apply to newly seeded areas prior to grass seed germination. Avoid spraying desirable plants. Any desirable plants or structures accidentally contacted should be rinsed with water. To avoid staining, wait until treated area dries before re-entry. Do not apply if rainfall is expected within 3 hours of application. Do not irrigate within 3 hours of application. Do not apply to the same area more than 2 times a year.

STORAGE AND DISPOSAL

PESTICIDE STORAGE: Store this product in its original container and keep in a secure storage area out of reach of children and domestic animals. Store unused material, tightly closed, in original container only, away from open flame.

PESTICIDE DISPOSAL AND CONTAINER HANDLING:

Nonrefillable container. Do not reuse or refill this container.

If empty: Place in trash or offer for recycling if available.

If partly filled: Call your local solid waste agency [or call [insert supplemental distributor's toll free number]] for disposal instructions. Never place unused product down any indoor or outdoor drain.

BATCH CODE:

[The following claims and product information, may or may not be presented on the product's label and labeling:

-www.neudorff.com



- Weed Killer for Lawns
- Selective Weed Killer
- Selective Broadleaf Weed Killer
- Selective Weed Control
- Selective Broadleaf Weed Control
- Selective Control of Weeds in Lawns
- Selective Control of Broadleaf Weeds in Lawns
- Kills weeds not lawns
- Kills weeds not grasses
- Lawn Weed Killer
- Lawn Weed Control
- Water-based
- With the provided hose-end sprayer, this container will treat XXX ft²
- Works in cool weather
- Rainfast in 3 hours
- Works fast
- See results the same day
- See results in hours

NEU1173H

Page 16 of 53

- Fast and effective
- No unpleasant odor
- Does not contain (2,4-D) (MCPA) (Dicamba) (Mecoprop)
- Derived from iron (Fe)
- For non-selective (moss) weed and grass control, use [H01 or NEU1171H – *insert product name*]
- Eliminates unwanted moss, algae and lichens quickly
- Kills algae, moss and lichens
- Kills moss and algae
- Moss killer
- Moss, algae and lichen killer
- Kills moss fast
- Kills moss, algae, and lichens quickly and effectively
- Lawn areas can be re-sown within one day of treatment with NEU1173H
- (Controls) (kills) (dandelions) (buttercup) (English daisy) (daisy) (clover)
- One gallon of concentrate will treat up to 2500 ft² (of lawn)
- Can be used on new lawns (1 week) after grass emergence
- Even works in cool weather
- Also works in cool weather
- Patent pending
- Patent #6,972,273
- Kills weeds, down to the root
- Kills dandelions, down to the root
- (Helpful Hints:) Best results are obtained when applied in the Spring or Fall when environmental conditions are cool and there is ample moisture
- (Helpful Hints:) The best times to treat weeds are in the Spring when they are small and growing and in the Fall to eliminate many of next year's weeds
- People and pets can enter treated area when spray dries
- Ready-To-Spray
- Hose-End Bottle
- Hose-End Sprayer
- This product is ready to spray. Just attach this bottle to your garden hose according to directions. Water automatically mixes with the concentrate as you spray.]

NEU1173H

Page 17 of 53

[Optional warranty statements. Registrant has choice of using any or none.

-NOTICE TO BUYER

Seller warrants that this product conforms to the chemical description on this label and is reasonably fit for the purposes stated in the Directions for Use, subject to the inherent risks described above, when used in accordance with the Directions for Use under normal conditions. To the extent consistent with applicable law, this warranty does not extend to use of this product contrary to label directions, or under abnormal use conditions, or under conditions not reasonably foreseeable to Seller. To the extent consistent with applicable law, the Seller shall not be liable for any such use. To the extent consistent with applicable law, the Seller makes no other warranties, either expressed or implied.

Or

-Buyer assumes all responsibility for safety and use not in accordance with directions.

Or

-Unconditionally Guaranteed by (company name). **OUR COMMITMENT TO YOUR SATISFACTION:** If you are not happy with the way this product works in your garden, please let us know. We will be happy to replace the product, refund your money, or substitute another (brand name) product. Simply send your name, address and proof of purchase to (Company name & address).

Or

(company name) guarantees if for any reason you are not satisfied with this product, mail us proof of purchase to obtain a full refund of your purchase price.]

SUBLABEL C – HOUSEHOLD USE ON MOSS

NEU1173H Concentrate

Active Ingredient:	
Iron HEDTA (FeHEDTA)	26.52%
Other Ingredients:.....	73.48%
Total:.....	100.00%

KEEP OUT OF REACH OF CHILDREN

CAUTION

FIRST AID	
IF IN EYES	-Hold eye open and rinse slowly and gently with water for 15-20 minutes. -Remove contact lenses, if present, after the first 5 minutes, then continue rinsing eye. -Call a poison control center or doctor for treatment advice.
Have the product container or label with you when calling a poison control center or doctor, or going for treatment.	

PRECAUTIONARY STATEMENTS

HAZARDS TO HUMANS AND DOMESTIC ANIMALS

CAUTION: Causes slight eye irritation. Avoid contact with eyes or clothing. Wash thoroughly with soap and water after handling and before eating, drinking, chewing gum or using tobacco. Prolonged or frequently repeated skin contact may cause allergic reactions in some individuals.

DIRECTIONS FOR USE

It is a violation of Federal Law to use this product in a manner inconsistent with its labeling.

Use Sites:

Use to selectively control moss, algae, lichens, and liverworts growing in lawns.

Pests:

Controls moss, algae, lichens, and liverworts.

Application Directions

Shake well before using. Mix one part [NEU1173H] with 24 parts water (5 oz. in 1 gallon of water). Apply the mixed solution at a rate of 5-10 gallons/1000 ft² (5.75-11.5 oz./yard²). Any standard hand-held or backpack sprayer can be used.

NEU1173H

Page 19 of 53

Use a coarse nozzle setting to reduce drift. Uniform coverage is important. Repeat treatment if needed.

Repeat treatment in 3 to 4 weeks for best results.

What will I see?

Works quickly. Treated moss or algae will turn brown or black. Occasionally a darkening of the grass leaf blades can occur after treatment, however the grass will recover within a few days to weeks. May stain thatch (dead grass under lawn); this does not affect the health of the grass.

Use Precautions:

Do not apply to drought stressed grass; ensure lawn is well watered prior to application. Do not apply when the daytime temperature will exceed 85°F. Do not apply to bentgrass. If unsure of grass sensitivity, test spray a small area of your lawn. Do not apply to newly seeded areas prior to grass seed germination. Avoid spraying desirable plants. Any desirable plants or structures accidentally contacted should be rinsed with water. To avoid staining, wait until treated area dries before re-entry. Do not apply if rainfall is expected within 3 hours of application. Do not irrigate within 3 hours of application. Do not apply to the same area more than 4 times a year.

STORAGE AND DISPOSAL

PESTICIDE STORAGE: Store this product in its original container and keep in a secure storage area out of reach of children and domestic animals. Store unused material, tightly closed, in original container only, away from open flame.

PESTICIDE DISPOSAL AND CONTAINER HANDLING:

Nonrefillable container. Do not reuse or refill this container.

If empty: Place in trash or offer for recycling if available.

If partly filled: Call your local solid waste agency [or call [insert supplemental distributor's toll free number]] for disposal instructions. Never place unused product down any indoor or outdoor drain.

BATCH CODE:

[The following claims and product information, may or may not be presented on the product's label and labeling:

-www.neudorff.com



- Selective Moss Killer
- Selective Moss Control
- Kills Moss Without Harming Lawn Grasses
- Kills moss not lawns

NEU1173H

Page 20 of 53

- Kills moss not grasses
- Lawn Moss Killer
- Lawn Moss Control
- Water-based
- When diluted, this bottle will treat XXX ft²
- Works in cool weather
- Rainfast in 3 hours
- Works fast
- See results the same day
- See results in hours
- Fast and effective
- No unpleasant odor
- Mix with water
- Does not contain (2,4-D) (MCPA) (Dicamba) (Mecoprop)
- Derived from iron (Fe)
- For non-selective (moss) weed and grass control, use [H01 or NEU1171H – *insert product name*]
- Eliminates unwanted moss, algae and lichens quickly
- Kills algae, moss and lichens
- Kills moss and algae
- Moss killer
- Moss, algae and lichen killer
- Kills moss fast
- Kills moss, algae, and lichens quickly and effectively
- Lawn areas can be re-sown within one day of treatment with NEU1173H
- (Controls) (kills) (dandelions) (buttercup) (English daisy) (clover)
- One gallon of concentrate will treat up to 5000 ft² (of lawn)
- Can be used to spot treat problem areas
- Can be used to spot treat problem areas in lawns
- Can be used on new lawns (1 week) after grass emergence
- Even works in cool weather
- Also works in cool weather
- Patent pending
- Patent #6,972,273
- Makes over XX gallons
- 1 ounce = 2 tablespoons = 6 teaspoons
- (Helpful Hints:) Best results are obtained when applied in the Spring or Fall when environmental conditions are cool and there is ample moisture
- People and pets can enter treated area when spray dries]

[Optional warranty statements. Registrant has choice of using any or none.

-NOTICE TO BUYER

Seller warrants that this product conforms to the chemical description on this label and is reasonably fit for the purposes stated in the Directions for Use, subject to the inherent risks described above, when used in accordance with the Directions for Use under normal conditions. To the extent consistent with applicable law, this warranty does not extend to use of this product contrary to

NEU1173H

Page 21 of 53

label directions, or under abnormal use conditions, or under conditions not reasonably foreseeable to Seller. To the extent consistent with applicable law, the Seller shall not be liable for any such use. To the extent consistent with applicable law, the Seller makes no other warranties, either expressed or implied.

Or

-Buyer assumes all responsibility for safety and use not in accordance with directions.

Or

-Unconditionally Guaranteed by (company name). **OUR COMMITMENT TO YOUR SATISFACTION:** If you are not happy with the way this product works in your garden, please let us know. We will be happy to replace the product, refund your money, or substitute another (brand name) product. Simply send your name, address and proof of purchase to (Company name & address).

Or

(company name) guarantees if for any reason you are not satisfied with this product, mail us proof of purchase to obtain a full refund of your purchase price.]

NEU1173H

Page 22 of 53

SUBLABEL D – HOUSEHOLD USE ON MOSS – Hose-end Sprayer**NEU1173H Concentrate**

Active Ingredient:

Iron HEDTA (FeHEDTA) 26.52%

Other Ingredients: 73.48%

Total: **100.00%****KEEP OUT OF REACH OF CHILDREN****CAUTION**

FIRST AID	
IF IN EYES	-Hold eye open and rinse slowly and gently with water for 15-20 minutes.
	-Remove contact lenses, if present, after the first 5 minutes, then continue rinsing eye.
	-Call a poison control center or doctor for treatment advice.
Have the product container or label with you when calling a poison control center or doctor, or going for treatment.	

PRECAUTIONARY STATEMENTS**HAZARDS TO HUMANS AND DOMESTIC ANIMALS**

CAUTION: Causes slight eye irritation. Avoid contact with eyes or clothing. Wash thoroughly with soap and water after handling and before eating, drinking, chewing gum or using tobacco. Prolonged or frequently repeated skin contact may cause allergic reactions in some individuals.

DIRECTIONS FOR USE

It is a violation of Federal Law to use this product in a manner inconsistent with its labeling.

Use Sites:

Use to selectively control moss, algae, lichens, and liverworts growing in lawns.

Pests:

Controls moss, algae, lichens, and liverworts.

Application Directions

Shake well before using. Apply 1 gallon of concentrate/2500 ft². Uniform coverage is important. Rinse treated areas 24 hours after application. Repeat treatment in 3 to 4 weeks for best results.

NEU1173H

Page 23 of 53

[Optional hose-end sprayer directions that may be presented on the container or supplemental wording, either:

Figure 1

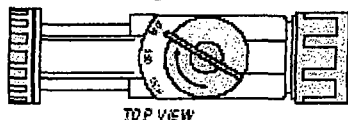

Figure 2



Figure 3

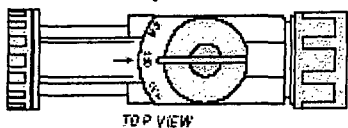
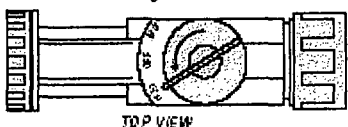

Figure 4



To Use This Sprayer:

1. Shake container well.
2. Connect spray nozzle to garden hose.
3. Turn on the water from the faucet. Extend hose to the farthest area to be treated and work back toward the faucet so you don't come in contact with the treated area.
4. When you are ready to spray, turn the knob on top so that it points to the MIX position on the spray head. (Fig. 1)
5. The spray deflector on the front of the hose-end applicator can be rotated to give a stream or fan spray. (Fig. 2)

To Stop Spraying

1. When you are finished spraying or if you have to stop spraying at any time, turn the knob back to the OFF position. (Fig. 3)
2. Turn off the water from the faucet.
3. Turn the knob to H₂O then OFF, to drain the water from the hose. (Fig. 4)

1. Attach garden hose to spray nozzle. Turn on water supply.
2. Bend safety tab down and turn control to "water".
3. Point nozzle toward plants and turn water control knob to "On". Product will automatically mix with water. Spray moss surfaces thoroughly.

To Stop Spraying:

1. When you are finished spraying or if you have to stop spraying at any time, turn the blue knob back to the OFF position.
2. Turn off the water from the faucet.
3. Turn the blue knob to H2O then OFF, to drain the water from the hose.
4. Unscrew spray nozzle from hose. Remove hose end from container.
5. Reseal the container with the child-resistant closure. Rinse the hose-end applicator

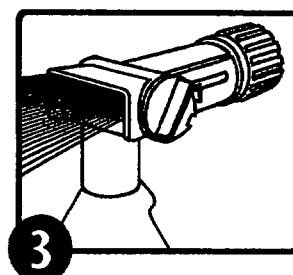
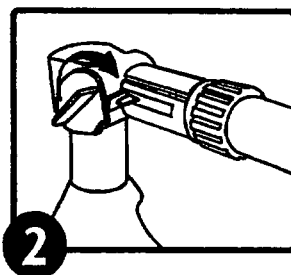
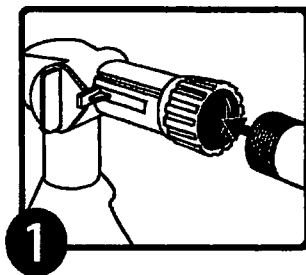

OR

1. Shake container well before using.
2. Connect a garden hose to the Ready Spray nozzle. Make sure the dial on the nozzle is in the "OFF" position with the safety tab in the valve notch.
3. Turn on the water at faucet. Extend hose to the farthest area to be treated and work back toward the faucet so you don't come in contact with the treated area.
4. To BEGIN spraying, point nozzle toward treatment site and
 - a. Bend the safety tab back (located at the right of the yellow dial) with your thumb,
 - b. Using your other hand, QUICKLY turn the dial clockwise until it stops. Water will automatically mix with the product.
5. Spray moss thoroughly. Walk at a steady pace while spraying using an even sweeping motion, slightly overlapping treated areas.
6. To STOP spraying, QUICKLY turn the dial in the opposite direction of "ON" until it stops and the safety tab engages the notch on the valve. Turn water off at faucet. To relieve pressure before removing nozzle from hose, bend the safety tab back and turn dial "ON" until water stops spraying.

7. To STORE unused product, make sure the dial is in the "OFF" position with safety tab in the valve notch. Place in cool area away from heat, sunlight or open flame.

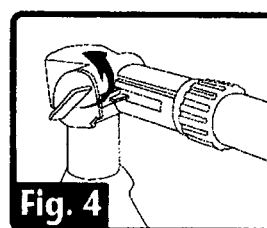
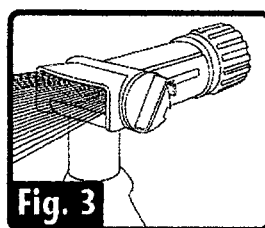
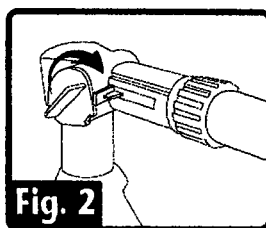
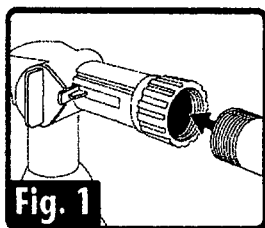

OR

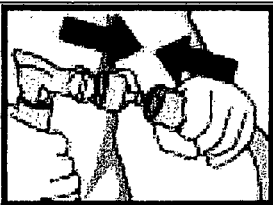
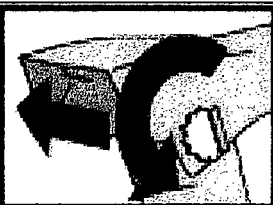
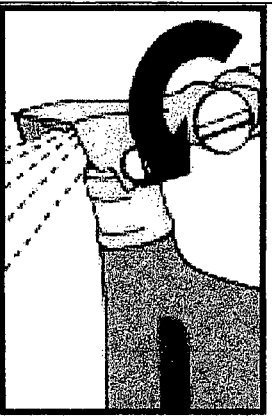
		
<ul style="list-style-type: none"> • Ensure that the large Water Control Knob is turned to the "OFF" position. • Connect sprayer to garden hose. 	<ul style="list-style-type: none"> • Turn the small Product Control Button so that the flat side aligns with the tab on the right side of the button, and push the button all the way in. • Turn on water at faucet. 	<ul style="list-style-type: none"> • To spray, point nozzle where you want to spray and turn the large knob all the way to the left. • To stop spraying, push small Product Control Button in from opposite side. Turn large Water Control Knob to the right to the "OFF" position and turn off faucet. • NOTE: BEFORE DISCONNECTING HOSE (to relieve water pressure): Turn large Water Control Knob to the left; then turn "OFF" again. • Disconnect garden hose from sprayer. • To prevent accidental discharge when not in use, turn the small Product Control Button so that it is <u>NOT</u> aligned with the tab and cannot be pushed in.

What will I see?

Works quickly. Treated moss or algae will turn brown or black. Occasionally a darkening of the grass leaf blades can occur after treatment, however the grass will recover within a few days to weeks. May stain thatch (dead grass under lawn); this does not affect the health of the grass.

Use Precautions:

Do not apply to drought stressed grass; ensure lawn is well watered prior to application. Do not apply when the daytime temperature will exceed 85°F. Do not apply to bentgrass. If unsure of grass sensitivity, test spray a small area of your lawn. Do not apply to newly seeded areas prior to grass seed germination. Avoid spraying desirable plants. Any desirable plants or structures accidentally contacted should be rinsed with water. To avoid staining, wait until treated area dries before re-entry. Do not apply if rainfall is expected within 3 hours of application. Do not irrigate within 3 hours of application. Do not apply to the same area more than 2 times a year.

STORAGE AND DISPOSAL

PESTICIDE STORAGE: Store this product in its original container and keep in a secure storage area out of reach of children and domestic animals. Store unused material, tightly closed, in original container only, away from open flame.

PESTICIDE DISPOSAL AND CONTAINER HANDLING:

Nonrefillable container. Do not reuse or refill this container.

If empty: Place in trash or offer for recycling if available.

If partly filled: Call your local solid waste agency [or call [insert supplemental distributor's toll free number]] for disposal instructions. Never place unused product down any indoor or outdoor drain.

BATCH CODE:

[The following claims and product information, may or may not be presented on the product's label and labeling:

-www.neudorff.com



- Selective Moss Killer
- Selective Moss Control
- Kills Moss Without Harming Lawn Grasses
- Kills moss not lawns
- Kills moss not grasses
- Lawn Moss Killer
- Lawn Moss Control
- Water-based

NEU1173H

Page 27 of 53

With the provided hose-end sprayer, this container will treat XXX ft²

- Works in cool weather
- Rainfast in 3 hours
- Works fast
- See results the same day
- See results in hours
- Fast and effective
- No unpleasant odor
- Does not contain (2,4-D) (MCPA) (Dicamba) (Mecoprop)
- Derived from iron (Fe)
- For non-selective (moss) weed and grass control, use [H01 or NEU1171H – *insert product name*]
- Eliminates unwanted moss, algae and lichens quickly
- Kills algae, moss and lichens
- Kills moss and algae
- Moss killer
- Moss, algae and lichen killer
- Kills moss fast
- Kills moss, algae, and lichens quickly and effectively
- Lawn areas can be re-sown within one day of treatment with NEU1173H
- (Controls) (kills) (dandelions) (buttercup) (English daisy) (daisy) (clover)
- One gallon of concentrate will treat up to 2500 ft² (of lawn)
- Can be used on new lawns (1 week) after grass emergence
- Even works in cool weather
- Also works in cool weather
- Patent pending
- Patent #6,972,273
- (Helpful Hints:) Best results are obtained when applied in the Spring or Fall when environmental conditions are cool and there is ample moisture
- People and pets can enter treated area when spray dries
- Ready-To-Spray
- Hose-End Bottle
- Hose-End Sprayer
- This product is ready to spray. Just attach this bottle to your garden hose according to directions. Water automatically mixes with the concentrate as you spray.]

[Optional warranty statements. Registrant has choice of using any or none.

-NOTICE TO BUYER

Seller warrants that this product conforms to the chemical description on this label and is reasonably fit for the purposes stated in the Directions for Use, subject to the inherent risks described above, when used in accordance with the Directions for Use under normal conditions. To the extent consistent with applicable law, this warranty does not extend to use of this product contrary to label directions, or under abnormal use conditions, or under conditions not reasonably foreseeable to Seller. To the extent consistent with applicable law,

32057

NEU1173H

Page 28 of 53

the Seller shall not be liable for any such use. To the extent consistent with applicable law, the Seller makes no other warranties, either expressed or implied.

Or

-Buyer assumes all responsibility for safety and use not in accordance with directions.

Or

-Unconditionally Guaranteed by (company name). OUR COMMITMENT TO YOUR SATISFACTION: If you are not happy with the way this product works in your garden, please let us know. We will be happy to replace the product, refund your money, or substitute another (brand name) product. Simply send your name, address and proof of purchase to (Company name & address).

Or

(company name) guarantees if for any reason you are not satisfied with this product, mail us proof of purchase to obtain a full refund of your purchase price.]

NEU1173H Concentrate

Active Ingredient:

Iron HEDTA (FeHEDTA)	26.52%
Other Ingredients:.....	73.48%
Total:.....	100.00%

KEEP OUT OF REACH OF CHILDREN

CAUTION

FIRST AID	
IF IN EYES	-Hold eye open and rinse slowly and gently with water for 15-20 minutes. -Remove contact lenses, if present, after the first 5 minutes, then continue rinsing eye. -Call a poison control center or doctor for treatment advice.
Have the product container or label with you when calling a poison control center or doctor, or going for treatment.	

PRECAUTIONARY STATEMENTS

HAZARDS TO HUMANS AND DOMESTIC ANIMALS

CAUTION: Causes slight eye irritation. Avoid contact with eyes or clothing. Wash thoroughly with soap and water after handling and before eating, drinking, chewing gum or using tobacco. Prolonged or frequently repeated skin contact may cause allergic reactions in some individuals.

DIRECTIONS FOR USE

It is a violation of Federal Law to use this product in a manner inconsistent with its labeling.

Read and follow all applicable directions and precautions on this label before using.

SITES: Lawns, turf (use on rights of way or non-crop areas), golf courses, parks, playgrounds, cemeteries, athletic fields

Pests:

Controls or suppresses weeds such as but not limited to:

- Black medic (*Medicago lupulina*)
- Broadleaf plantain (*Plantago major*)
- Bull thistle (*Cirsium vulgare*)
- Canada thistle (*Cirsium arvense*)
- Common chickweed (*Stellaria media*)

NEU1173H

Page 30 of 53

- Creeping buttercup (*Ranunculus repens*)
- Dandelion (*Taraxicum officinale*)
- Dovefoot geranium (*Geranium molle*)
- English daisy (*Bellis perennis*)
- False dandelion (*Hypochoeris radicata*)
- Healall (*Prunella vulgaris*)
- Moss, liverworts, algae and lichens
- Narrow-leaved plantain (*Plantago lanceolata*)
- Persian Speedwell (*Veronica persica*)
- Shepherd's-purse (*Capsella bursa-pastoris*)
- Silverweed cinquefoil (*Potentilla anserina*)
- Slender speedwell (*Veronica filiformis*)
- White clover (*Trifolium repens*)
- Wild chamomile (*Matricaria chamomilla*)

Application Directions

Shake well before using. Mix one part [NEU1173H] with 24 parts water (5 oz. in 1 gallon of water). Apply the mixed solution at a rate of 5-10 gallons/1000 ft² (5.75-11.5 fluid oz./yard²). Any standard hand-held or backpack sprayer can be used. Thoroughly spray weeds. Use a coarse nozzle setting to reduce drift. Uniform coverage is important.

Repeat treatment in 3 to 4 weeks for best results.

What will I see?

Works quickly; dying weeds will be seen within hours of application. Treated weeds, moss or algae will turn brown or black. Occasionally a darkening of the grass leaf blades can occur after treatment, however the grass will recover within a few days to weeks. May stain thatch (dead grass under lawn); this does not affect the health of the grass.

Use Precautions:

Do not apply to drought stressed grass; ensure lawn is well watered prior to application. Do not apply when the daytime temperature will exceed 85°F. Do not apply to bentgrass. If unsure of grass sensitivity, test spray a small area of your lawn. Do not apply to newly seeded areas prior to grass seed germination. Avoid spraying desirable plants. Any desirable plants or structures accidentally contacted should be rinsed with water. To avoid staining, wait until treated area dries before re-entry. Do not apply if rainfall is expected within 3 hours of application. Do not irrigate within 3 hours of application. Do not apply to the same area more than 4 times a year.

STORAGE AND DISPOSAL

Do not contaminate water, food or feed by storage or disposal.

PESTICIDE STORAGE: Store in a secure place, away from open fire or flame. Keep container closed and reseal after use. If spilled, use absorbent materials and dispose of in an approved manner.

PESTICIDE DISPOSAL: Wastes resulting from the use of this product may be disposed of on site or at an approved waste disposal facility.

CONTAINER HANDLING: Nonrefillable container. Do not reuse or refill this container. Triple rinse container (or equivalent) promptly after emptying. Triple rinse as follows:

(For containers equal to or less than five gallons use these directions:) Empty the remaining contents into application equipment or a mix tank and drain for 10 seconds after the flow begins to drip. Fill the container $\frac{1}{4}$ full with water and recap. Shake for 10 seconds. Pour rinsate into application equipment or a mix tank or store rinsate for later use or disposal. Drain for 10 seconds after the flow begins to drip. Repeat this procedure two more times. Offer for recycling, if available.

(For containers greater than five gallons use these directions:) Empty the remaining contents into application equipment or a mix tank. Fill the container $\frac{1}{4}$ full with water. Replace and tighten closures. Tip container on its side and roll it back and forth, ensuring at least one complete revolution, for 30 seconds. Stand the container on its end and tip it back and forth several times. Turn the container over onto its other end and tip it back and forth several times. Empty the rinsate into application equipment or a mix tank or store rinsate for later use or disposal. Repeat this procedure two more times. Offer for recycling, if available.

BATCH CODE:

[The following claims and product information, may or may not be presented on the product's label and labeling:

-www.neudorff.com



- Weed Killer for Lawns
- Selective Weed Killer
- Selective Broadleaf Weed Killer
- Selective Weed Control
- Selective Broadleaf Weed Control
- Selective Control of Weeds in Lawns
- Selective Control of Broadleaf Weeds in Lawns
- Kills weeds not lawns
- Kills weeds not grasses
- Lawn Weed Killer
- Lawn Weed Control
- Water-based
- When diluted, this bottle will treat XXX ft²
- Works in cool weather

NEU1173H

Page 32 of 53

- Rainfast in 3 hours
- Works fast
- See results the same day
- See results in hours
- Fast and effective
- Mix with water
- No unpleasant odor
- Does not contain (2,4-D) (MCPA) (Dicamba) (Mecoprop)
- Derived from iron (Fe)
- For non-selective (moss) weed and grass control, use [H01 or NEU1171H – *insert product name*]
- Eliminates unwanted moss, algae and lichens quickly
- Kills algae, moss and lichens
- Kills moss and algae
- Moss killer
- Moss, algae and lichen killer
- Kills moss fast
- Kills moss, algae, and lichens quickly and effectively
- Lawn areas can be re-sown within one day of treatment with NEU1173H
- (Controls) (kills) (dandelions) (buttercup) (English daisy) (daisy) (clover)
- One gallon of concentrate will treat up to 5000 ft² (of lawn)
- Can be used to spot treat problem areas
- Can be used to spot treat problem areas in lawns
- Can be used on new lawns (1 week) after grass emergence
- Even works in cool weather
- Also works in cool weather
- Patent pending
- Patent #6,972,273
- Makes over XX gallons
- 1 ounce = 2 tablespoons = 6 teaspoons
- Kills weeds, down to the root
- Kills dandelions, down to the root
- (Helpful Hints:) Best results are obtained when applied in the Spring or Fall when environmental conditions are cool and there is ample moisture
- (Helpful Hints:) The best times to treat weeds are in the Spring when they are small and growing and in the Fall to eliminate many of next year's weeds
- People and pets can enter treated area when spray dries]

[Optional warranty statements. Registrant has choice of using any or none.

-NOTICE TO BUYER

Seller warrants that this product conforms to the chemical description on this label and is reasonably fit for the purposes stated in the Directions for Use, subject to the inherent risks described above, when used in accordance with the Directions for Use under normal conditions. To the extent consistent with applicable law, this warranty does not extend to use of this product contrary to label directions, or under abnormal use conditions, or under conditions not

NEU1173H

Page 33 of 53

reasonably foreseeable to Seller. To the extent consistent with applicable law, the Seller shall not be liable for any such use. To the extent consistent with applicable law, the Seller makes no other warranties, either expressed or implied.

Or

-Buyer assumes all responsibility for safety and use not in accordance with directions.

Or

-Unconditionally Guaranteed by (company name). OUR COMMITMENT TO YOUR SATISFACTION: If you are not happy with the way this product works in your garden, please let us know. We will be happy to replace the product, refund your money, or substitute another (brand name) product. Simply send your name, address and proof of purchase to (Company name & address).]

Or

(company name) guarantees if for any reason you are not satisfied with this product, mail us proof of purchase to obtain a full refund of your purchase price.

380257

NEU1173H

Page 34 of 53

SUBLABEL F – COMMERCIAL USE ON WEEDS – Hose-end Sprayer

NEU1173H Concentrate

Active Ingredient:

Iron HEDTA (FeHEDTA) 26.52%

Other Ingredients:..... 73.48%

Total:..... 100.00%

KEEP OUT OF REACH OF CHILDREN

CAUTION

FIRST AID	
IF IN EYES	<p>-Hold eye open and rinse slowly and gently with water for 15-20 minutes.</p> <p>-Remove contact lenses, if present, after the first 5 minutes, then continue rinsing eye.</p> <p>-Call a poison control center or doctor for treatment advice.</p>
Have the product container or label with you when calling a poison control center or doctor, or going for treatment.	

PRECAUTIONARY STATEMENTS

HAZARDS TO HUMANS AND DOMESTIC ANIMALS

CAUTION: Causes slight eye irritation. Avoid contact with eyes or clothing. Wash thoroughly with soap and water after handling and before eating, drinking, chewing gum or using tobacco. Prolonged or frequently repeated skin contact may cause allergic reactions in some individuals.

DIRECTIONS FOR USE

It is a violation of Federal Law to use this product in a manner inconsistent with its labeling.

Read and follow all applicable directions and precautions on this label before using.

SITES: Lawns, turf (use on rights of way or non-crop areas), golf courses, parks, playgrounds, cemeteries, athletic fields

Pests:

Controls or suppresses weeds such as but not limited to:

- Black medic (*Medicago lupulina*)
- Broadleaf plantain (*Plantago major*)
- Bull thistle (*Cirsium vulgare*)
- Canada thistle (*Cirsium arvense*)
- Common chickweed (*Stellaria media*)

NEU1173H

Page 35 of 53

- Creeping buttercup (*Ranunculus repens*)
- Dandelion (*Taraxicum officinale*)
- Dovefoot geranium (*Geranium molle*)
- English daisy (*Bellis perennis*)
- False dandelion (*Hypochoeris radicata*)
- Healall (*Prunella vulgaris*)
- Moss, liverworts, algae and lichens
- Narrow-leaved plantain (*Plantago lanceolata*)
- Persian Speedwell (*Veronica persica*)
- Shepherd's-purse (*Capsella bursa-pastoris*)
- Silverweed cinquefoil (*Potentilla anserina*)
- Slender speedwell (*Veronica filiformis*)
- White clover (*Trifolium repens*)
- Wild chamomile (*Matricaria chamomilla*)

Application Directions

Shake well before using. Apply 1 gallon of concentrate/2500 ft². Uniform coverage is important. Rinse treated areas 24 hours after application. Repeat treatment in 3 to 4 weeks for best results.

[Optional hose-end sprayer directions that may be presented on the container or supplemental wording, either:

Figure 1

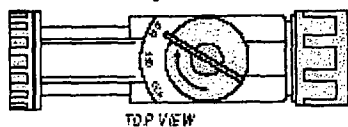

Figure 2

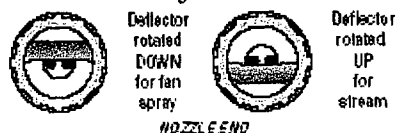

Figure 3

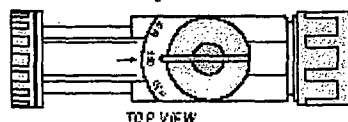
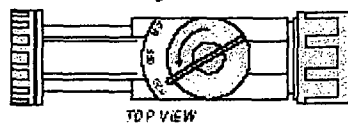

Figure 4



To Use This Sprayer:

1. Shake container well.
2. Connect spray nozzle to garden hose.
3. Turn on the water from the faucet. Extend hose to the farthest area to be treated and work back toward the faucet so you don't come in contact with the treated area.
4. When you are ready to spray, turn the knob on top so that it points to the MIX position on the spray head. (Fig. 1)
5. The spray deflector on the front of the hose-end applicator can be rotated to give a stream or fan spray. (Fig. 2)

To Stop Spraying

6. When you are finished spraying or if you have to stop spraying at any time, turn the knob back to the OFF position. (Fig. 3)
7. Turn off the water from the faucet.
8. Turn the knob to H2O then OFF, to drain the water from the hose. (Fig. 4)

OR

1. Attach garden hose to spray nozzle. Turn on water supply.

NEU1173H

Page 37 of 53

2. Bend safety tab down and turn control to "water".
3. Point nozzle toward plants and turn water control knob to "On". Product will automatically mix with water. Thoroughly spray weeds.

To Stop Spraying:

1. When you are finished spraying or if you have to stop spraying at any time, turn the blue knob back to the OFF position.
2. Turn off the water from the faucet.
3. Turn the blue knob to H2O then OFF, to drain the water from the hose.
4. Unscrew spray nozzle from hose. Remove hose end from container.
5. Reseal the container with the child-resistant closure. Rinse the hose-end applicator

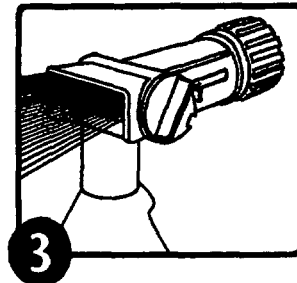
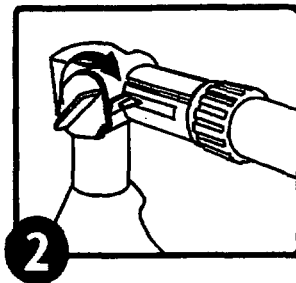
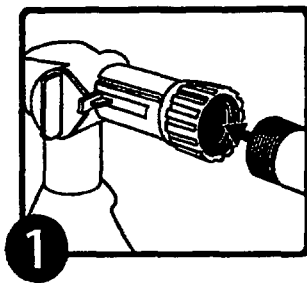

OR

1. Shake container well before using.
2. Connect a garden hose to the Ready Spray nozzle. Make sure the dial on the nozzle is in the "OFF" position with the safety tab in the valve notch.
3. Turn on the water at faucet. Extend hose to the farthest area to be treated and work back toward the faucet so you don't come in contact with the treated area.
4. To BEGIN spraying, point nozzle toward treatment site and
 - a. Bend the safety tab back (located at the right of the yellow dial) with your thumb,
 - b. Using your other hand, QUICKLY turn the dial clockwise until it stops. Water will automatically mix with the product.
5. Spray weeds thoroughly. Walk at a steady pace while spraying using an even sweeping motion, slightly overlapping treated areas.
6. To STOP spraying, QUICKLY turn the dial in the opposite direction of "ON" until it stops and the safety tab engages the notch on the valve. Turn water off at faucet. To relieve pressure before removing nozzle from hose, bend the safety tab back and turn dial "ON" until water stops spraying.
7. To STORE unused product, make sure the dial is in the "OFF" position with safety tab in the valve notch. Place in cool area away from heat, sunlight or open flame.

420857

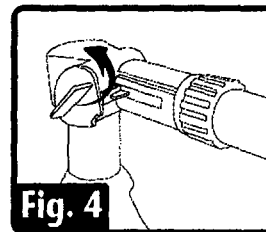
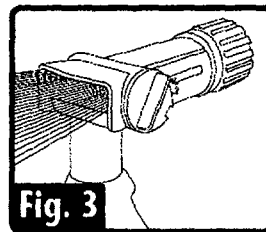
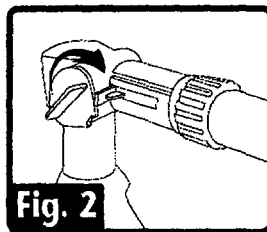
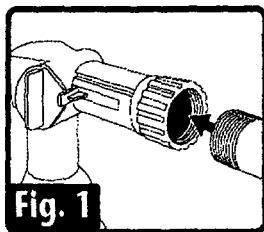

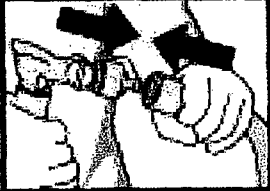
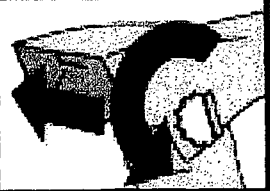
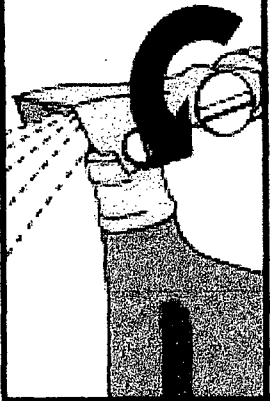
		
<ul style="list-style-type: none"> • Ensure that the large Water Control Knob is turned to the "OFF" position. • Connect sprayer to garden hose. 	<ul style="list-style-type: none"> • Turn the small Product Control Button so that the flat side aligns with the tab on the right side of the button, and push the button all the way in. • Turn on water at faucet. 	<ul style="list-style-type: none"> • To spray, point nozzle where you want to spray and turn the large knob all the way to the left. • To stop spraying, push small Product Control Button in from opposite side. Turn large Water Control Knob to the right to the "OFF" position and turn off faucet. • NOTE: BEFORE DISCONNECTING HOSE (to relieve water pressure): Turn large Water Control Knob to the left; then turn "OFF" again. • Disconnect garden hose from sprayer. • To prevent accidental discharge when not in use, turn the small Product Control Button so that it is <u>NOT</u> aligned with the tab and cannot be pushed in.

1

What will I see?

Works quickly; dying weeds will be seen within hours of application. Treated weeds, moss or algae will turn brown or black. Occasionally a darkening of the grass leaf blades can occur after treatment, however the grass will recover within a few days to weeks. May stain thatch (dead grass under lawn); this does not affect the health of the grass.

Use Precautions:

NEU1173H

Page 40 of 53

Do not apply to drought stressed grass; ensure lawn is well watered prior to application. Do not apply when the daytime temperature will exceed 85°F. Do not apply to bentgrass. If unsure of grass sensitivity, test spray a small area of your lawn. Do not apply to newly seeded areas prior to grass seed germination. Avoid spraying desirable plants. Any desirable plants or structures accidentally contacted should be rinsed with water. To avoid staining, wait until treated area dries before re-entry. Do not apply if rainfall is expected within 3 hours of application. Do not irrigate within 3 hours of application. Do not apply to the same area more than 2 times a year.

STORAGE AND DISPOSAL

Do not contaminate water, food or feed by storage or disposal.

PESTICIDE STORAGE: Store in a secure place, away from open fire or flame. Keep container closed and reseal after use. If spilled, use absorbent materials and dispose of in an approved manner.

PESTICIDE DISPOSAL: Wastes resulting from the use of this product may be disposed of on site or at an approved waste disposal facility.

CONTAINER HANDLING: Nonrefillable container. Do not reuse or refill this container. Triple rinse container (or equivalent) promptly after emptying. Triple rinse as follows:

(For containers equal to or less than five gallons use these directions:) Empty the remaining contents into application equipment or a mix tank and drain for 10 seconds after the flow begins to drip. Fill the container ¼ full with water and recap. Shake for 10 seconds. Pour rinsate into application equipment or a mix tank or store rinsate for later use or disposal. Drain for 10 seconds after the flow begins to drip. Repeat this procedure two more times. Offer for recycling, if available.

(For containers greater than five gallons use these directions:) Empty the remaining contents into application equipment or a mix tank. Fill the container ¼ full with water. Replace and tighten closures. Tip container on its side and roll it back and forth, ensuring at least one complete revolution, for 30 seconds. Stand the container on its end and tip it back and forth several times. Turn the container over onto its other end and tip it back and forth several times. Empty the rinsate into application equipment or a mix tank or store rinsate for later use or disposal. Repeat this procedure two more times. Offer for recycling, if available.

BATCH CODE:

[The following claims and product information, may or may not be presented on the product's label and labeling:

-www.neudorff.com



-Weed Killer for Lawns

-Selective Weed Killer

NEU1173H

Page 41 of 53

- Selective Broadleaf Weed Killer
- Selective Weed Control
- Selective Broadleaf Weed Control
- Selective Control of Weeds in Lawns
- Selective Control of Broadleaf Weeds in Lawns
- Kills weeds not lawns
- Kills weeds not grasses
- Lawn Weed Killer
- Lawn Weed Control
- Water-based
- With the provided hose-end sprayer, this container will treat XXX ft²
- Works in cool weather
- Rainfast in 3 hours
- Works fast
- See results the same day
- See results in hours
- Fast and effective
- No unpleasant odor
- Does not contain (2,4-D) (MCPA) (Dicamba) (Mecoprop)
- Derived from iron (Fe)
- For non-selective (moss) weed and grass control, use [NEU1170H or NEU1171H – *insert product name*]
- Eliminates unwanted moss, algae and lichens quickly
- Kills algae, moss and lichens
- Kills moss and algae
- Moss killer
- Moss, algae and lichen killer
- Kills moss fast
- Kills moss, algae, and lichens quickly and effectively
- Lawn areas can be re-sown within one day of treatment with NEU1173H
- (Controls) (kills) (dandelions) (buttercup) (English daisy) (daisy) (clover)
- One gallon of concentrate will treat up to 2500 ft² (of lawn)
- Can be used on new lawns (1 week) after grass emergence
- Even works in cool weather
- Also works in cool weather
- Patent pending
- Patent #6,972,273
- Kills weeds, down to the root
- Kills dandelions, down to the root
- (Helpful Hints:) Best results are obtained when applied in the Spring or Fall when environmental conditions are cool and there is ample moisture
- (Helpful Hints:) The best times to treat weeds are in the Spring when they are small and growing and in the Fall to eliminate many of next year's weeds
- People and pets can enter treated area when spray dries
- Ready-To-Spray
- Hose-End Bottle
- Hose-End Sprayer

NEU1173H

Page 42 of 53

-This product is ready to spray. Just attach this bottle to your garden hose according to directions. Water automatically mixes with the concentrate as you spray.]

[Optional warranty statements. Registrant has choice of using any or none.

-NOTICE TO BUYER

Seller warrants that this product conforms to the chemical description on this label and is reasonably fit for the purposes stated in the Directions for Use, subject to the inherent risks described above, when used in accordance with the Directions for Use under normal conditions. To the extent consistent with applicable law, this warranty does not extend to use of this product contrary to label directions, or under abnormal use conditions, or under conditions not reasonably foreseeable to Seller. To the extent consistent with applicable law, the Seller shall not be liable for any such use. To the extent consistent with applicable law, the Seller makes no other warranties, either expressed or implied.

Or

-Buyer assumes all responsibility for safety and use not in accordance with directions.

Or

-Unconditionally Guaranteed by (company name). OUR COMMITMENT TO YOUR SATISFACTION: If you are not happy with the way this product works in your garden, please let us know. We will be happy to replace the product, refund your money, or substitute another (brand name) product. Simply send your name, address and proof of purchase to (Company name & address).]

Or

(company name) guarantees if for any reason you are not satisfied with this product, mail us proof of purchase to obtain a full refund of your purchase price.

NEU1173H Concentrate

Active Ingredient:	
Iron HEDTA (FeHEDTA)	26.52%
Other Ingredients:.....	73.48%
Total:.....	100.00%

KEEP OUT OF REACH OF CHILDREN

CAUTION

FIRST AID	
IF IN EYES	<ul style="list-style-type: none">-Hold eye open and rinse slowly and gently with water for 15-20 minutes.-Remove contact lenses, if present, after the first 5 minutes, then continue rinsing eye.-Call a poison control center or doctor for treatment advice.
Have the product container or label with you when calling a poison control center or doctor, or going for treatment.	

PRECAUTIONARY STATEMENTS

HAZARDS TO HUMANS AND DOMESTIC ANIMALS

CAUTION: Causes slight eye irritation. Avoid contact with eyes or clothing. Wash thoroughly with soap and water after handling and before eating, drinking, chewing gum or using tobacco. Prolonged or frequently repeated skin contact may cause allergic reactions in some individuals.

DIRECTIONS FOR USE

It is a violation of Federal Law to use this product in a manner inconsistent with its labeling.

Read and follow all applicable directions and precautions on this label before using.

PESTS: Controls moss, algae, lichens, and liverworts growing in lawns and turf.

SITES: Lawns, turf (use on rights of way or non-crop areas), golf courses, parks, playgrounds, cemeteries, athletic fields.

Application Directions

Shake well before using.

Mix one part NEU1173H concentrate with 24 parts water (5 oz. in 1 gallon of water). Apply the mixed solution at a rate of 5-10 gallons/1000 ft² (5.75-11.5

NEU1173H

Page 44 of 53

oz/yd²). Any standard hand-held or backpack sprayer can be used. Use a coarse nozzle setting to reduce drift. Uniform coverage is important. Repeat treatment if needed.

What will I see?

Works quickly. Treated moss or algae will turn brown or black. Occasionally a darkening of the grass leaf blades can occur after treatment, however the grass will recover within a few days to weeks. May stain thatch (dead grass under lawn); this does not affect the health of the grass.

Use Precautions:

Do not apply to drought stressed grass; ensure lawn is well watered prior to application. Do not apply when the daytime temperature will exceed 85°F. Do not apply to bentgrass. If unsure of grass sensitivity, test spray a small area of your lawn. Do not apply to newly seeded areas prior to grass seed germination. Avoid spraying desirable plants. Any desirable plants or structures accidentally contacted should be rinsed with water. To avoid staining, wait until treated area dries before re-entry. Do not apply if rainfall is expected within 3 hours of application. Do not irrigate within 3 hours of application. Do not apply to the same area more than 4 times a year.

STORAGE AND DISPOSAL

Do not contaminate water, food or feed by storage or disposal.

PESTICIDE STORAGE: Store in a secure place, away from open fire or flame. Keep container closed and reseal after use. If spilled, use absorbent materials and dispose of in an approved manner.

PESTICIDE DISPOSAL: Wastes resulting from the use of this product may be disposed of on site or at an approved waste disposal facility.

CONTAINER HANDLING: Nonrefillable container. Do not reuse or refill this container. Triple rinse container (or equivalent) promptly after emptying. Triple rinse as follows:

(For containers equal to or less than five gallons use these directions:) Empty the remaining contents into application equipment or a mix tank and drain for 10 seconds after the flow begins to drip. Fill the container ¼ full with water and recap. Shake for 10 seconds. Pour rinsate into application equipment or a mix tank or store rinsate for later use or disposal. Drain for 10 seconds after the flow begins to drip. Repeat this procedure two more times. Offer for recycling, if available.

(For containers greater than five gallons use these directions:) Empty the remaining contents into application equipment or a mix tank. Fill the container ¼ full with water. Replace and tighten closures. Tip container on its side and roll it back and forth, ensuring at least one complete revolution, for 30 seconds. Stand the container on its end and tip it back and forth several times. Turn the container over onto its other end and tip it back and forth several times. Empty the rinsate into application equipment or a mix tank or store rinsate for later use

NEU1173H

Page 45 of 53

or disposal. Repeat this procedure two more times. Offer for recycling, if available.

BATCH CODE:

[The following claims and product information, may or may not be presented on the product's label and labeling:

-www.neudorff.com



- Selective Moss Killer
- Selective Moss Control
- Kills Moss Without Harming Lawn Grasses
- Kills moss not lawns
- Kills moss not grasses
- Lawn Moss Killer
- Lawn Moss Control
- Water-based
- When diluted, this bottle will treat XXX ft²
- Works in cool weather
- Rainfast in 3 hours
- Works fast
- See results the same day
- See results in hours
- Fast and effective
- No unpleasant odor
- Mix with water
- Does not contain (2,4-D) (MCPA) (Dicamba) (Mecoprop)
- Derived from iron (Fe)
- For non-selective (moss) weed and grass control, use [NEU1170H or NEU1171H – *insert product name*]
- Eliminates unwanted moss, algae and lichens quickly
- Kills algae, moss and lichens
- Kills moss and algae
- Moss killer
- Moss, algae and lichen killer
- Kills moss fast
- Kills moss, algae, and lichens quickly and effectively
- Lawn areas can be re-sown within one day of treatment with NEU1173H
- (Controls) (kills) (dandelions) (buttercup) (English daisy) (daisy) (clover)
- One gallon of concentrate will treat up to 5000 ft² (of lawn)
- Can be used to spot treat problem areas
- Can be used to spot treat problem areas in lawns
- Can be used on new lawns (1 week) after grass emergence
- Even works in cool weather
- Also works in cool weather

NEU1173H

Page 46 of 53

-Patent pending

-Patent #6,972,273

-Makes over XX gallons

-1 ounce = 2 tablespoons = 6 teaspoons

-(Helpful Hints:) Best results are obtained when applied in the Spring or Fall when environmental conditions are cool and there is ample moisture

-People and pets can enter treated area when spray dries]

[Optional warranty statements. Registrant has choice of using any or none.

-NOTICE TO BUYER

Seller warrants that this product conforms to the chemical description on this label and is reasonably fit for the purposes stated in the Directions for Use, subject to the inherent risks described above, when used in accordance with the Directions for Use under normal conditions. To the extent consistent with applicable law, this warranty does not extend to use of this product contrary to label directions, or under abnormal use conditions, or under conditions not reasonably foreseeable to Seller. To the extent consistent with applicable law, the Seller shall not be liable for any such use. To the extent consistent with applicable law, the Seller makes no other warranties, either expressed or implied.

Or

-Buyer assumes all responsibility for safety and use not in accordance with directions.

Or

-Unconditionally Guaranteed by (company name). **OUR COMMITMENT TO YOUR SATISFACTION:** If you are not happy with the way this product works in your garden, please let us know. We will be happy to replace the product, refund your money, or substitute another (brand name) product. Simply send your name, address and proof of purchase to (Company name & address).]

Or

(company name) guarantees if for any reason you are not satisfied with this product, mail us proof of purchase to obtain a full refund of your purchase price.

51 of 57

NEU1173H

Page 47 of 53

SUBLABEL H – COMMERCIAL USE ON MOSS – HOSE-END SPRAYER

NEU1173H Concentrate

Active Ingredient:

Iron HEDTA (FeHEDTA) 26.52%

Other Ingredients:..... 73.48%

Total:..... 100.00%

KEEP OUT OF REACH OF CHILDREN

CAUTION

FIRST AID	
IF IN EYES	-Hold eye open and rinse slowly and gently with water for 15-20 minutes. -Remove contact lenses, if present, after the first 5 minutes, then continue rinsing eye. -Call a poison control center or doctor for treatment advice.
Have the product container or label with you when calling a poison control center or doctor, or going for treatment.	

PRECAUTIONARY STATEMENTS

HAZARDS TO HUMANS AND DOMESTIC ANIMALS

CAUTION: Causes moderate eye irritation. Avoid contact with eyes or clothing. Wash thoroughly with soap and water after handling and before eating, drinking, chewing gum or using tobacco. Prolonged or frequently repeated skin contact may cause allergic reactions in some individuals.

DIRECTIONS FOR USE

It is a violation of Federal Law to use this product in a manner inconsistent with its labeling.

Read and follow all applicable directions and precautions on this label before using.

PESTS: Controls moss, algae, lichens, and liverworts growing in lawns and turf.

SITES: Lawns, turf (use on rights of way or non-crop areas), golf courses, parks, playgrounds, cemeteries, athletic fields.

Application Directions

Shake well before using. Apply 1 gallon of concentrate/2500 ft². Uniform coverage is important. Rinse treated areas 24 hours after application. Repeat treatment if needed.

NEU1173H

Page 48 of 53

[Optional hose-end sprayer directions that may be presented on the container or supplemental wording, either:

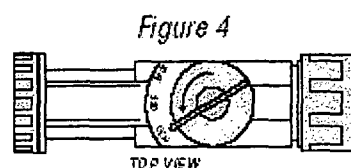
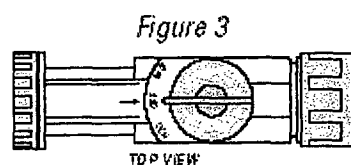
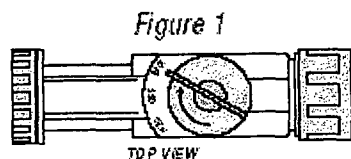

To Use This Sprayer:

1. Shake container well.
2. Connect spray nozzle to garden hose.
3. Turn on the water from the faucet. Extend hose to the farthest area to be treated and work back toward the faucet so you don't come in contact with the treated area.
4. When you are ready to spray, turn the knob on top so that it points to the MIX position on the spray head. (Fig. 1)
5. The spray deflector on the front of the hose-end applicator can be rotated to give a stream or fan spray. (Fig. 2)

To Stop Spraying:

1. When you are finished spraying or if you have to stop spraying at any time, turn the knob back to the OFF position. (Fig. 3)
2. Turn off the water from the faucet.
3. Turn the knob to H2O then OFF, to drain the water from the hose. (Fig. 4)

1. Attach garden hose to spray nozzle. Turn on water supply.
2. Bend safety tab down and turn control to "water".
3. Point nozzle toward plants and turn water control knob to "On". Product will automatically mix with water. Spray moss thoroughly.

To Stop Spraying

1. When you are finished spraying or if you have to stop spraying at any time, turn the blue knob back to the OFF position.
2. Turn off the water from the faucet.
3. Turn the blue knob to H2O then OFF, to drain the water from the hose.
4. Unscrew spray nozzle from hose. Remove hose end from container.
5. Reseal the container with the child-resistant closure. Rinse the hose-end applicator

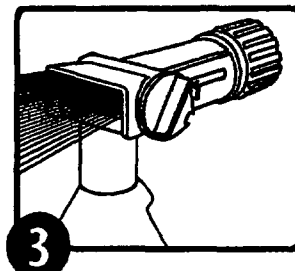
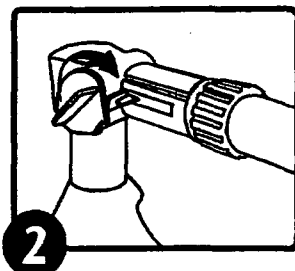
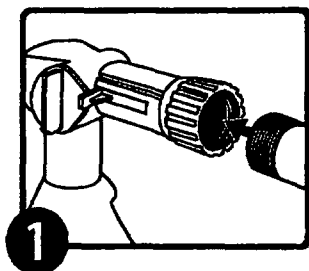

OR

1. Shake container well before using.
2. Connect a garden hose to the Ready Spray nozzle. Make sure the dial on the nozzle is in the "OFF" position with the safety tab in the valve notch.
3. Turn on the water at faucet. Extend hose to the farthest area to be treated and work back toward the faucet so you don't come in contact with the treated area.
4. To BEGIN spraying, point nozzle toward treatment site and
 - a. Bend the safety tab back (located at the right of the yellow dial) with your thumb,
 - b. Using your other hand, QUICKLY turn the dial clockwise until it stops. Water will automatically mix with the product.
5. Spray moss thoroughly. Walk at a steady pace while spraying using an even sweeping motion, slightly overlapping treated areas.
6. To STOP spraying, QUICKLY turn the dial in the opposite direction of "ON" until it stops and the safety tab engages the notch on the valve. Turn water off at faucet. To relieve pressure before removing nozzle from hose, bend the safety tab back and turn dial "ON" until water stops spraying.

NEU1173H

Page 50 of 53

7. To STORE unused product, make sure the dial is in the "OFF" position with safety tab in the valve notch. Place in cool area away from heat, sunlight or open flame.

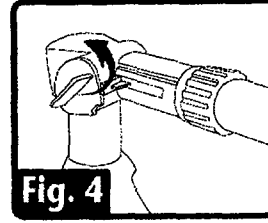
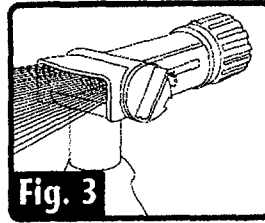
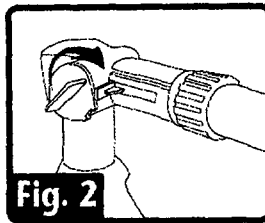
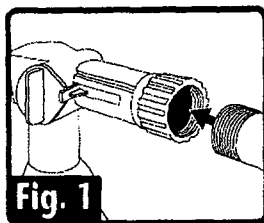

OR

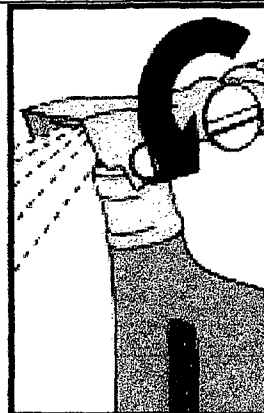
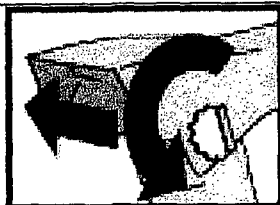
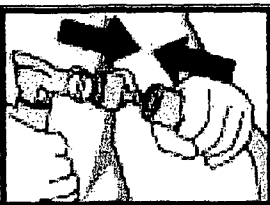

- Ensure that the large Water Control Knob is turned to the "OFF" position.
- Connect sprayer to garden hose.

- Turn the small Product Control Button so that the flat side aligns with the tab on the right side of the button, and push the button all the way in.
- Turn on water at faucet.

- To spray, point nozzle where you want to spray and turn the large knob all the way to the left.
- To stop spraying, push small Product Control Button in from opposite side. Turn large Water Control Knob to the right to the "OFF" position and turn off faucet.
- NOTE: BEFORE DISCONNECTING HOSE (to relieve water pressure): Turn large Water Control Knob to the left; then turn "OFF" again.
- Disconnect garden hose from sprayer.
- To prevent accidental discharge when not in use, turn the small Product Control Button so that it is NOT aligned with the tab and cannot be pushed in.

What will I see?

Works quickly. Treated moss or algae will turn brown or black. Occasionally a darkening of the grass leaf blades can occur after treatment, however the grass will recover within a few days to weeks. May stain thatch (dead grass under lawn); this does not affect the health of the grass.

Use Precautions:

Do not apply to drought stressed grass; ensure lawn is well watered prior to application. Do not apply when the daytime temperature will exceed 85°F. Do not apply to bentgrass. If unsure of grass sensitivity, test spray a small area of your lawn. Do not apply to newly seeded areas prior to grass seed germination. Avoid spraying desirable plants. Any desirable plants or structures accidentally contacted should be rinsed with water. To avoid staining, wait until treated area dries before re-entry. Do not apply if rainfall is expected within 3 hours of application. Do not irrigate within 3 hours of application. Do not apply to the same area more than 2 times a year.

STORAGE AND DISPOSAL

Do not contaminate water, food or feed by storage or disposal.

PESTICIDE STORAGE: Store in a secure place, away from open fire or flame. Keep container closed and reseal after use. If spilled, use absorbent materials and dispose of in an approved manner.

PESTICIDE DISPOSAL: Wastes resulting from the use of this product may be disposed of on site or at an approved waste disposal facility.

CONTAINER HANDLING: Nonrefillable container. Do not reuse or refill this container. Triple rinse container (or equivalent) promptly after emptying. Triple rinse as follows:

(For containers equal to or less than five gallons use these directions:) Empty the remaining contents into application equipment or a mix tank and drain for 10 seconds after the flow begins to drip. Fill the container $\frac{1}{4}$ full with water and recap. Shake for 10 seconds. Pour rinsate into application equipment or a mix tank or store rinsate for later use or disposal. Drain for 10 seconds after the flow begins to drip. Repeat this procedure two more times. Offer for recycling, if available.

(For containers greater than five gallons use these directions:) Empty the remaining contents into application equipment or a mix tank. Fill the container $\frac{1}{4}$ full with water. Replace and tighten closures. Tip container on its side and roll it back and forth, ensuring at least one complete revolution, for 30 seconds. Stand the container on its end and tip it back and forth several times. Turn the container over onto its other end and tip it back and forth several times. Empty the rinsate into application equipment or a mix tank or store rinsate for later use or disposal. Repeat this procedure two more times. Offer for recycling, if available.

BATCH CODE:

[The following claims and product information, may or may not be presented on the product's label and labeling:

-www.neudorff.com



- Selective Moss Killer
- Selective Moss Control
- Kills Moss Without Harming Lawn Grasses
- Kills moss not lawns
- Kills moss not grasses
- Lawn Moss Killer
- Lawn Moss Control
- Water-based
- With the provided hose-end sprayer, this container will treat XXX ft²
- Works in cool weather
- Rainfast in 3 hours
- Works fast
- See results the same day
- See results in hours
- Fast and effective
- No unpleasant odor
- Mix with water
- Does not contain (2,4-D) (MCPA) (Dicamba) (Mecoprop)
- Derived from iron (Fe)
- For non-selective (moss) weed and grass control, use [NEU1170H or NEU1171H – *insert product name*]
- Eliminates unwanted moss, algae and lichens quickly
- Kills algae, moss and lichens
- Kills moss and algae
- Moss killer
- Moss, algae and lichen killer
- Kills moss fast
- Kills moss, algae, and lichens quickly and effectively
- Lawn areas can be re-sown within one day of treatment with NEU1173H
- (Controls) (kills) (dandelions) (buttercup) (English daisy) (daisy) (clover)
- One gallon of concentrate will treat up to 2500 ft² (of lawn)
- Can be used on new lawns (1 week) after grass emergence
- Even works in cool weather
- Also works in cool weather
- Patent pending
- Patent #6,972,273
- (Helpful Hints:) Best results are obtained when applied in the Spring or Fall when environmental conditions are cool and there is ample moisture
- (Helpful Hints:) The best times to treat weeds are in the Spring when they are small and growing and in the Fall to eliminate many of next year's weeds

NEU1173H

Page 53 of 53

- People and pets can enter treated area when spray dries
- Ready-To-Spray
- Hose-End Bottle
- Hose-End Sprayer
- This product is ready to spray. Just attach this bottle to your garden hose according to directions. Water automatically mixes with the concentrate as you spray.]

[Optional warranty statements. Registrant has choice of using any or none.

-NOTICE TO BUYER

Seller warrants that this product conforms to the chemical description on this label and is reasonably fit for the purposes stated in the Directions for Use, subject to the inherent risks described above, when used in accordance with the Directions for Use under normal conditions. To the extent consistent with applicable law, this warranty does not extend to use of this product contrary to label directions, or under abnormal use conditions, or under conditions not reasonably foreseeable to Seller. To the extent consistent with applicable law, the Seller shall not be liable for any such use. To the extent consistent with applicable law, the Seller makes no other warranties, either expressed or implied.

Or

-Buyer assumes all responsibility for safety and use not in accordance with directions.

Or

-Unconditionally Guaranteed by (company name). **OUR COMMITMENT TO YOUR SATISFACTION:** If you are not happy with the way this product works in your garden, please let us know. We will be happy to replace the product, refund your money, or substitute another (brand name) product. Simply send your name, address and proof of purchase to (Company name & address).]

Or

(company name) guarantees if for any reason you are not satisfied with this product, mail us proof of purchase to obtain a full refund of your purchase price.