



UNITED STATES ENVIRONMENTAL PROTECTION AGENCY
WASHINGTON, D.C. 20460

OFFICE OF
PREVENTION, PESTICIDES AND
TOXIC SUBSTANCES

FEB 25 2008

Walter G. Talarek
Authorized Agent for
W. Neudorff GmbH KG
c/o Walter G. Talarek, PC
1008 Riva Ridge Drive
Great Falls, VA 22066-1620

SUBJECT: Applications for Pesticide Notification – Add Logo, Additional Container Size, and
Additional Emergency Phone #/Graphic/Optional Hose-end Sprayer Instructions

NEU1140F RTU Copper Soap	EPA Reg. No. 67702- 1
H02 Moss Killer Concentrate	EPA Reg. No. 67702-12
Sulfur/Pyrethrins Fungicide/Insecticide	EPA Reg. No. 67702-17
Bug-N-Sluggo Insect, Slug and Snail Bait	EPA Reg. No. 67702-24
Applications Dated November 19, 2007	
NEU1140F Copper Soap	EPA Reg. No. 67702- 2
NEU1128 RTU Copper Soap	EPA Reg. No. 67702-13
Applications Dated November 21, 2007	
H02 Moss Killer Concentrate	EPA Reg. No. 67702-12
Application Dated December 13, 2007	

Dear Mr. Talarek:

The Agency is in receipt of your Applications for Pesticide Notification under Pesticide Registration Notice (PRN) 98-10 for the above products. The Registration Division (RD) has conducted a review of these requests for their applicability under PRN 98-10 and finds that the actions requested fall within the scope of PRN 98-10. The labels submitted with the applications have been stamped "Notification" and will be placed in our records. Please note: at the next printing of the subject labels, please include the phrase "To the extent consistent with applicable law," at the beginning of the "NOTICE TO BUYER (WARRANTY)" section.

If you have any questions, please contact me directly at 703-305-6249 or Terri Stowe of my staff at 703-305-6117.

Sincerely,

Rachel C. Holloman

Linda Arrington *for*
Notifications & Minor Formulations Team Leader
Registration Division (7505P)
Office of Pesticide Programs

 United States Environmental Protection Agency Washington, DC 20460	<input type="checkbox"/> Registration <input type="checkbox"/> Amendment <input checked="" type="checkbox"/> Other	OPP Identifier Number
--	--	-----------------------

Application for Pesticide - Section I

1. Company/Product Number 67702-12	2. EPA Product Manager Joanne Miller	3. Proposed Classification <input checked="" type="checkbox"/> None <input type="checkbox"/> Restricted
4. Company/Product (Name) H02 Moss Killer Concentrate	PM# 23	
5. Name and Address of Applicant (Include ZIP Code) W. Neudorff GmbH KG c/o Walter G. Talarek 1008 Riva Ridge Drive Great Falls, VA 22066-1620 <input type="checkbox"/> Check if this is a new address	6. Expedited Review. In accordance with FIFRA Section 3(c)(3)(b)(ii), my product is similar or identical in composition and labeling to: <div style="text-align: center; font-weight: bold; font-size: 1.2em;">NOTIFICATION</div> EPA Reg. No. _____ FEB 25 2008 _____ Product Name _____	

Section - II

<input type="checkbox"/> Amendment - Explain below.	<input type="checkbox"/> Final printed labels in response to Agency letter dated _____
<input type="checkbox"/> Resubmission in response to Agency letter dated _____	<input type="checkbox"/> "Me Too" Application.
<input checked="" type="checkbox"/> Notification - Explain below.	<input type="checkbox"/> Other - Explain below.

Explanation: Use additional page(s) if necessary. (For section I and Section II.)

Label revisions being made by notification under PR Notification 98-10. For a full description of the revisions and the certification required by PR Notice 98-10, please see the attached letter to Ms. Joanne Miller, PM 23.

Section - III

1. Material This Product Will Be Packaged In:				2. Type of Container	
Child-Resistant Packaging <input type="checkbox"/> Yes* <input type="checkbox"/> No	Unit Packaging <input type="checkbox"/> Yes <input type="checkbox"/> No	Water Soluble Packaging <input type="checkbox"/> Yes <input type="checkbox"/> No			<input type="checkbox"/> Metal <input type="checkbox"/> Plastic <input type="checkbox"/> Glass <input type="checkbox"/> Paper <input type="checkbox"/> Other (Specify) _____
* Certification must be submitted		If "Yes" Unit Packaging wgt. No. per container	If "Yes" Package wgt No. per container		
3. Location of Net Contents Information <input type="checkbox"/> Label <input type="checkbox"/> Container		4. Size(s) Retail Container		5. Location of Label Directions <input type="checkbox"/> On Label <input type="checkbox"/> On Labeling accompanying product	
6. Manner in Which Label is Affixed to Product			<input type="checkbox"/> Lithograph <input type="checkbox"/> Paper glued <input type="checkbox"/> Stenciled <input type="checkbox"/> Other _____		

Section - IV

1. Contact Point (Complete items directly below for identification of individual to be contacted, if necessary, to process this application.)		
Name Walter G. Talarek	Title Authorized Agent	Telephone No. (Include Area Code) 703-759-4837
Certification I certify that the statements I have made on this form and all attachments thereto are true, accurate and complete. I acknowledge that any knowingly false or misleading statement may be punishable by fine or imprisonment or both under applicable law.		6. Date Application Received (Stamped)
2. Signature 	3. Title Authorized Agent	
4. Typed Name Walter G. Talarek	5. Date December 13, 2007	

3/25

LAW OFFICES OF
WALTER G. TALAREK, P.C.
1008 RIVA RIDGE DRIVE
GREAT FALLS, VIRGINIA 22066

PHONE: (703) 759-4837
FAX: (703) 759-5548

December 13, 2007

DELIVERED BY COURIER

Joanne Miller
PM 13, Registration Division
c/o Document Process Desk (NOTIF)
Office of Pesticide Programs (7504P)
U.S. Environmental Protection Agency
Room S-4900, One Potomac Yead
2777 S. Crystal Drive
Arlington, VA 22202

Re: H02 Moss Killer Concentrate
EPA Reg. No. 67702-12
Notification

Dear Ms. Miller:

By this notification, W. Neudorff GmbH KG ("Neudorff") is revising the label of H02 Moss Killer Concentrate, EPA Reg. No. 67702-12, to accomplish the following:

1. Add a toll free emergency telephone number to the label's First Aid section of the non-commercial sub-label;
2. Add a picture of a person and a dog along with the warning statement "Do not allow people (other than the applicator) or pets on treatment area during application or until spray has dried" to the Precautionary Statements section of the of the non-commercial sub-label label; and
3. Add alternative, optional hose-end sprayer instructions to the Directions for Use section of the non-commercial sub-label. These alternative directions will be used on the label of the product sold by one of Neudorff's supplemental distributors.

This notification is consistent with PR Notice 98-10 and EPA's regulations at 40 CFR 152.46, and no other changes have been made to the labeling or the confidential statement of formula of this product. I understand that it is a violation of 18 U.S.C. Sec. 1001 to willfully make any false statement to EPA. I further understand that if this notification is not consistent with the terms of PR Notice 98-10 and 40 CFR 152.46, this product may be in violation of FIFRA and I may be subject to enforcement action and penalties under sections 12 and 14 of FIFRA.

4/25

NOTIFICATION

FEB 25 2008

MASTER LABEL

H02 MOSS KILLER CONCENTRATE

Active Ingredient:

Potassium soap of fatty acids	22.11%
Inert Ingredients:.....	77.89%
Total:.....	100.00%

SUBLABEL A: Non-Commercial Use

SUBLABEL B: Commercial Use

KEEP OUT OF REACH OF CHILDREN

WARNING/AVISO

Si usted no entiende la etiqueta busque para que se la explique a usted en detalle. (If you do not understand the label, find someone to explain it to you in detail.)

EPA REG. NO. 67702-12

EPA EST. 67702-WG-1

**Registrant: W. Neudorff GmbH KG,
Postfach 1209, An der Mühle 3,
D-31860 Emmerthal, Germany**

Non-Commercial Use: NET CONTENTS: 8oz, 16oz, 24oz, 32oz, 40oz

**Commercial Use: NET CONTENTS: 0.5 gallon, 1 gallon, 5 gallons, 20 gallons,
55 gallon, 211 gallons**

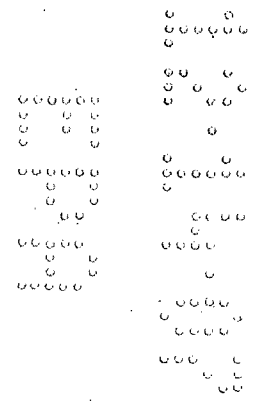

SUBLABEL A: Non-Commercial Use

H02 MOSS KILLER CONCENTRATE

Active Ingredient:

Potassium soap of fatty acids	22.11%
Inert Ingredients:.....	77.89%
Total:	100.00%

KEEP OUT OF REACH OF CHILDREN

WARNING

EPA REG. NO. 67702-12

EPA EST. 67702-WG-1

NET CONTENTS: 8oz, 16oz, 24oz, 32oz, 40oz

FIRST AID	
IF IN EYES	-Hold eye open and rinse slowly and gently with water for 15-20 minutes. -Remove contact lenses, if present, after the first 5 minutes, then continue rinsing. -Call a poison control center or doctor for treatment advice.
IF ON SKIN OR CLOTHING	-Take off contaminated clothing. -Rinse skin immediately with plenty of water for 15-20 minutes. -Call a poison control center or doctor for treatment advice.
Have the product container or label with you when calling a poison control center or doctor or going for treatment. You may also call toll free 1-877-227-3763 for emergency medical treatment information.	

PRECAUTIONARY STATEMENTS

HAZARDS TO HUMANS AND DOMESTIC ANIMALS

WARNING: Causes substantial but temporary eye injury. Causes skin irritation. Do not get in eyes, on skin or on clothing. Wear protective eyewear (goggles, face shield or safety glasses). Wash thoroughly with soap and water after handling. Remove contaminated clothing and wash before reuse.

	Do not allow people (other than applicator) or pets on treatment area during application and until spray has dried.
---	---

ENVIRONMENTAL HAZARDS

This product may be hazardous to aquatic invertebrates. Do not apply directly to water. Do not contaminate water when disposing of equipment washwaters or rinsate.

DIRECTIONS FOR USE

It is a violation of Federal Law to use this product in a manner inconsistent with its labeling.

Read and follow all applicable directions and precautions on this label before using.

PESTS: H02 Moss Killer Concentrate is effective in controlling mosses, algae, lichens, and liverworts.

[The registrant may use one of the two statements:

SITES: H02 Moss Killer Concentrate may be used on lawns, golf courses, parks, playgrounds and ornamental gardens.

Other Sites: H02 may also be used around and on homes and other buildings, and home greenhouses. It may be used on: roofs; cedar shakes and composition shingles; cedar siding; stucco; cedar, redwood and CCA-treated wood decks and fences; brick, stone and concrete walkways, sidewalks and driveways; growing containers; other structural surfaces; hardened bark of trees; bark mulch; pavement; gravel; patios; asphalt; automobile exteriors; and the exteriors of motor homes and boats.

OR

Where to Use:

-H02 Moss Killer Concentrate may be used on lawns, golf courses, parks, playgrounds and ornamental gardens.

-H02 may also be used around and on homes and other buildings, and home greenhouses. It may be used on: roofs; cedar shakes and composition shingles; cedar siding; stucco; cedar, redwood and CCA-treated wood decks and fences; brick, stone and concrete walkways, sidewalks and driveways; growing containers; other structural surfaces; hardened bark of trees; bark mulch; pavement; gravel; patios; asphalt; automobile exteriors; and the exteriors of motor homes and boats.]

APPLICATION DIRECTIONS

Golf Courses: Dilute concentrate by mixing one part concentrate with 19 parts water. For putting greens, fairways and other areas apply 12 to 25 gallons per 1000 ft² (500 to 1000 gallons/acre).

Parks and Playgrounds: Dilute concentrate by mixing one part concentrate with 19 parts water (6.8 oz in 1 gallon water). Thoroughly soak moss with solution, applying 12 to 25 gallons per 1000 ft² (500 to 1000 gallons/acre). For thick moss (greater than 1 inch), use up to 50 gallons per 1000 ft².

Domestic Lawns and Ornamental Gardens: Dilute concentrate by mixing one part concentrate with 19 parts water (6.8 oz in 1 gallon water). Thoroughly soak moss with solution, applying 12 to 25 gallons per 1000 ft² (500 to 1000 gallons/acre). For thick moss (greater than 1 inch), use up to 50 gallons per 1000 ft².

Follow-Up on Golf Courses, Parks, Playgrounds, Domestic Lawns and Ornamental Gardens: Lightly rinse treated areas with water (1 gallon per 1000 ft² or less) 15 to 30 minutes after treatment to avoid grass and plant damage. Test spray a small area prior to using. Do not heavily irrigate for at least 6 hours. Re-apply every 2 weeks or as required. If it rains within one day of treatment, an additional application may be required. Moss will turn brown after a few days. Areas can be re-sown 5 days after treatment.

Other Sites: Dilute concentrate by mixing one part concentrate with 9 to 19 parts water (put 6.8 to 13 oz in 1 gallon water). Apply 8 to 12 gallons of solution per 1000 ft². For thick moss (greater than 1 inch), use 25 gallons of solution per 1000 ft². If moss is dry, thoroughly wet moss with water before treating. Repeat treatment annually, or when new moss or algae are visible.

Automobiles, Motor Homes and Boats: Use on the outside surfaces only. Spray thoroughly with soap solution using hose-end sprayer. Alternatively, dilute concentrate by mixing one part concentrate with 19 parts water (put 6.8 oz in 1 gallon water) in a pail and apply to surfaces using a brush. Scrub surfaces thoroughly and rinse with water.

WHEN TO USE: H02 Moss Killer Concentrate can be used at any time during the year. Best results are obtained with actively growing moss in the spring or fall. Do not use on lawns when temperature exceeds 85°F. During warmer weather apply late in the day. Application during cold weather may delay appearance of moss damage.

METHODS OF APPLICATION: Apply with any standard hand-held sprayer, backpack sprayer, tank sprayer, [hose-end sprayer (optional method)], mop, watering can or brush. Keep sprayer moving to get an even application. In areas of hard water, use water softeners.

[Optional hose-end sprayer directions that may be presented on the container or supplemental wording, either:

-Hose-End Sprayer Directions

Follow the directions for using the Hose-End sprayer. This XXX gallon bottle will cover up to XXX square feet.

How to use hose-end sprayer:

1. Remove the closure and save it for resealing the container when you are finished.
2. Insert the dip tube of the hose-end applicator into the bottle and seal the applicator head tightly to the bottle.
3. Connect spray nozzle to garden hose.
4. Turn on the water from the faucet.
5. When you are ready to spray, turn the blue knob on top so that it points to the MIX position on the spray head. (Fig. 1)
6. The spray deflector on the front of the hose-end applicator can be rotated to give a stream or fan spray. (Fig. 2)
7. When treating lawns, wait 15 to 30 minutes after spraying, and then lightly rinse treated area with water by using the H2O setting on the sprayer. This will reduce the likelihood of grass damage. Roofs and walls do not require rinsing.

To stop spraying:

1. When you are finished spraying or if you have to stop spraying at any time, turn the blue knob back to the OFF position. (Fig. 3)
2. Turn off the water from the faucet.
3. Turn the blue knob to H2O then OFF, to drain the water from the hose. (Fig. 4)
4. Unscrew spray nozzle from hose. Remove hose-end from container.
5. Reseal the container with the child-resistant closure. Rinse the hose-end applicator.]

OR

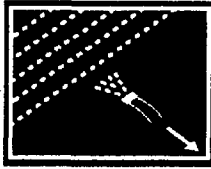
HOW TO USE Shake Well Before Use	CONNECT	<ol style="list-style-type: none"> 1. Shake well before use. 2. Connect sprayer to garden hose. 3. Turn on water. 	
	SPRAY treated, point	<ol style="list-style-type: none"> 1. Extend hose to farthest area to be sprayed. Begin spraying <Insert sprayer-specific language here> 	

	<p><i>Hayes HP-2 and Calmar RTS sprayers:</i> Press lock tab while using other hand to turn sprayer valve to ON position.</p> <p><i>Green Garden RTS sprayer:</i> Turn sprayer valve to ON position.</p> <p>3. Walk at a steady pace while spraying, using an even sweeping motion, and slightly overlap the treated areas. Work back toward the faucet to avoid walking over wet, treated grass.</p> <p>FINISH</p> <p>1. To stop spraying, < Insert sprayer-specific language here. ></p> <p><i>Hayes HP-2 RTS sprayer:</i> Press lock tab while using other hand to turn sprayer valve to OFF position.</p> <p><i>Calmar & Green Garden RTS sprayers:</i> turn sprayer valve to OFF position.</p> <p>2. Turn off water at faucet.</p> <p>3. Relieve water pressure in hose by turning sprayer valve back to WATER position until water slows to a drip then turn sprayer valve to OFF position.</p> <p>4. Disconnect sprayer from hose.</p>
--	--

[Optional Figure:

Diagrams of Hose-End Sprayer

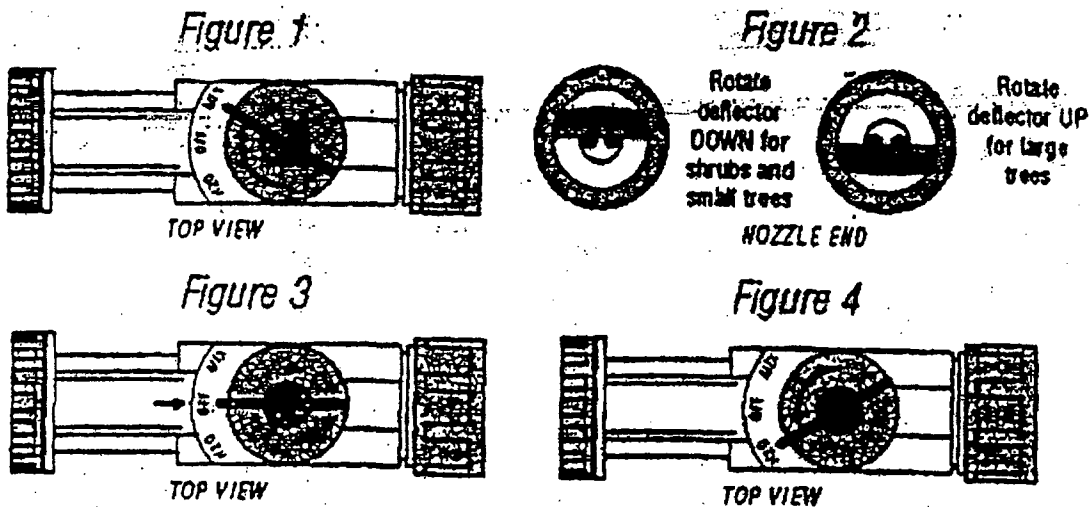

OR

HOSE END SPRAYER INSTRUCTIONS

Shake before using.

HOW TO USE:

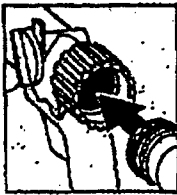

- 1. Attach garden hose to spray nozzle.
- 2. Turn on water supply.

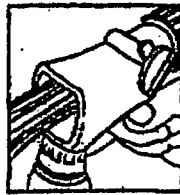

- 4. Point nozzle toward plants and turn water control knob to "On". Product will automatically mix with water. Spray upper and lower leaf surfaces thoroughly.

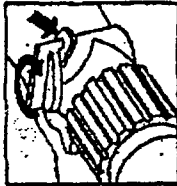

- 3. Bend safety tab down and turn control to "water".



OR

Test Spray Small Area Prior To Using.

Hose-End Sprayer Directions:

This 1 quart bottle will cover up to 500 square feet.

1. Before attaching the sprayer to garden hose, make sure that the blue water flow switch is in the "OFF" position and the red product flow switch is in the up, "CLOSED" position.
2. Connect spray nozzle to garden hose while pointing sprayer in a direction away from face and body.
3. Remove the white plastic safety tab marked "PULL OUT" in front of the red product flow switch.
4. To begin spraying, turn on water at the faucet; move blue water flow switch to the "ON" position; and, turn red product flow switch to the forward, "OPEN" position.

To Stop Spraying:

1. Turn blue water flow switch to "OFF" position and red product flow switch to "CLOSED" position.
2. Turn off the water at the faucet.
3. Unscrew spray nozzle from garden hose, rinse outside of container and store any unused product according to the Storage and Disposal Directions.

Optional Diagram

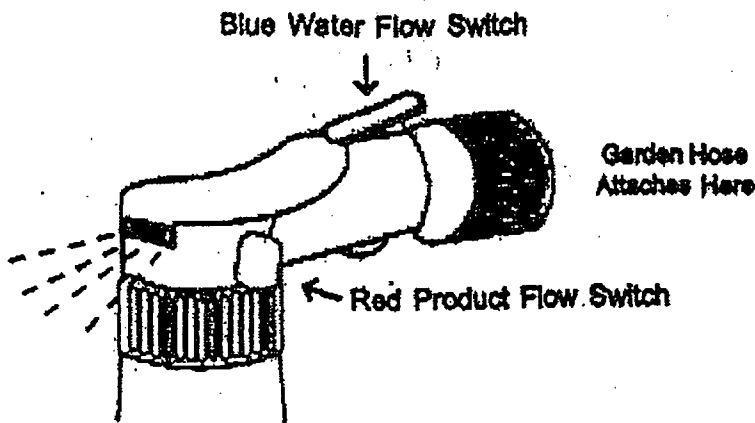

OR

1. Connect your garden hose to the bottle. Be sure the blue water control valve on top of the spray nozzle is in the OFF position. Turn on water at faucet.
2. Twist the small, star-shaped, blue product-control button to align the flat portion with the lock tab. Push the button in to open.
3. To begin spraying, point nozzle toward the area to be treated and turn the blue water control valve to the ON position. Tab will be horizontal. Water automatically mixes with the concentrate as you spray. Spray surfaces thoroughly.
4. To stop spraying, turn the blue water control valve on top of the spray nozzle to OFF. To close, push in the small round button opposite the star-shaped product-control button. Turn off faucet.
5. Relieve water pressure by turning blue water control valve to the ON position until water slows to a drip. Turn blue water control valve back to OFF. Disconnect garden hose from bottle.

Optional Diagram:

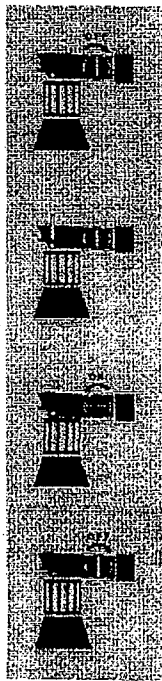

OR:

1. Attach garden hose to spray nozzle. Turn on water supply.
2. Bend safety tab down and turn control to "water".
3. Point nozzle toward plants and turn water control knob to "On". Product will automatically mix with water. Spray upper and lower leaf surfaces thoroughly.

To Stop Spraying:

1. When you are finished spraying or if you have to stop spraying at any time, turn the blue knob back to the OFF position.
2. Turn off the water from the faucet.
3. Turn the blue knob to H₂O then OFF, to drain the water from the hose.
4. Unscrew spray nozzle from hose. Remove hose end from container.
5. Reseal the container with the child-resistant closure. Rinse the hose-end applicator

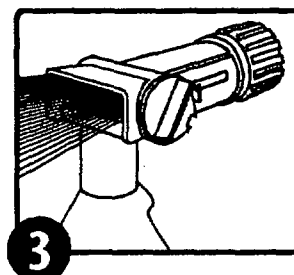
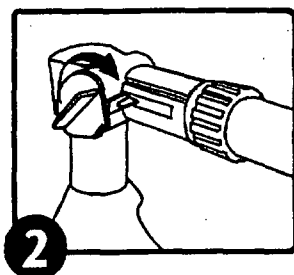
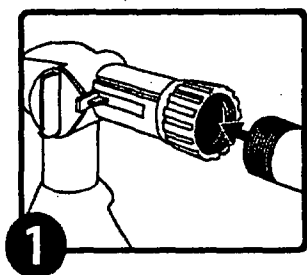

OR

1. Shake container well before using.
2. Connect a garden hose to the Ready Spray nozzle. Make sure the dial on the nozzle is in the "OFF" position with the safety tab in the valve notch.
3. Turn on the water at faucet. Extend hose to the farthest area to be treated and work back toward the faucet so you don't come in contact with the treated area.
4. To BEGIN spraying, point nozzle toward treatment site and
 - a. Bend the safety tab back (located at the right of the yellow dial) with your thumb,
 - b. Using your other hand, QUICKLY turn the dial clockwise until it stops. Water will automatically mix with the product.
5. Spray moss thoroughly. Walk at a steady pace while spraying using an even sweeping motion, slightly overlapping treated areas.
6. To STOP spraying, QUICKLY turn the dial in the opposite direction of "ON" until it stops and the safety tab engages the notch on the valve. Turn water off at faucet. To relieve pressure before removing nozzle from

hose, bend the safety tab back and turn dial "ON" until water stops spraying.

7. To STORE unused product, make sure the dial is in the "OFF" position with safety tab in the valve notch. Place in cool area away from heat, sunlight or open flame.

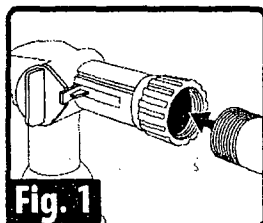

Fig. 1

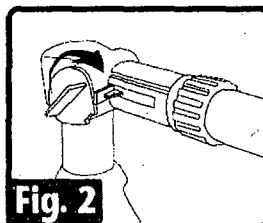

Fig. 2

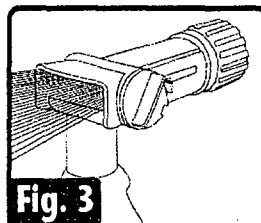

Fig. 3

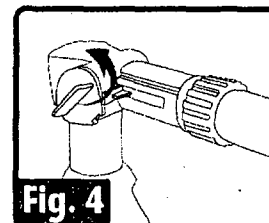

Fig. 4

STORAGE AND DISPOSAL

STORAGE: Store this product in its original container and keep in a secure storage area out of reach of children and domestic animals. Store unused material, tightly closed, in original container only, away from open flame. Do not store at temperatures below 32°F.

CONTAINER DISPOSAL:

If empty: Do not reuse this container. Place in trash or offer for recycling if available.

If partly filled: Call your local solid waste agency or 1-800-CLEAN-UP for disposal instructions. Never place unused product down any indoor or outdoor drain.

[Optional marketing claims and product information that may be presented on the container label or supplemental labeling:

- Quick Facts
- Read the label first!
- Eliminates unwanted moss, algae and lichens quickly
- Won't stain bricks, concrete or asphalt
- Kills within hours
- Fast acting
- Kills algae, moss and lichens
- Soap for killing moss.
- Moss killer.
- Moss, algae and lichen killer.
- Kills moss fast.
- Kills moss, algae, and lichens quickly and effectively.
- Removes green slime.
- Water based.
- Does not contain alcohol.

- Does not contain any metal salts, such as iron or zinc.
- No unpleasant odor.
- Low foaming.
- Will (Does) not stain.
- Will (Does) not stain concrete or other surfaces.
- Will (Does) not stain concrete, pavement, stucco or wood.
- Diluted H₂O₂ Moss Killer Concentrate will not damage painted and metal surfaces.
- Will (Does) not darken grass.
- Will (Does) not damage gutters, metal flashing or downspouts.
- H₂O₂ Moss Killer Concentrate can provide long-term control of moss on wooden roofs and structures.
- Kills moss to prolong life of roofs, decks, patios and walks.
- Destroys moss to prolong life of roofs, decks, patios and walks.
- Controlling moss and algae may add months or years of service to roofs, patios, decks, and such areas.
- H₂O₂ Moss Killer Concentrate is a fast acting moss, algae and lichen killer for use on lawns, roofs, sidewalks, buildings, fences, decks, patios, bark mulch, driveways, and gravel.
- For use on lawns, patios plus roofs & buildings.
- Use on roofs
- Use on lawns
- Higher concentrations of H₂O₂ (10% and higher) may damage some plants. Rinse off of plants and automobiles that are accidentally sprayed.
- For best results on lawns use the higher spray volumes and thoroughly soak moss.
- Spray treated structures with water 1 week after treatment to remove dead moss and algae.
- For best results, physically remove dead moss one week after treatment.
- Pressure washing is a good method of removing dead moss from roofs.
- When spraying roofs it is best to spray "up-slope" to thoroughly treat the ends of the shingles.
- Freshly treated areas may be slippery. To avoid falling do not walk on freshly treated areas. Rinse treated walkways 1 day after treating to reduce slipperiness.
- In case of overspray onto non-target (desirable) plants, rinse immediately to avoid any possible damage.
- One gallon of concentrate will treat up to XXXX ft² of lawn.
- One gallon of concentrate will treat up to XXXX ft² of turf.
- One gallon of concentrate will treat up to XXXX ft² of roof or siding.
- Will not harm adjacent plants when used according to directions.
- May be used on moss, algae and lichens on mature, dormant trees, bark mulch, patios, benches, greenhouses, growing containers, gravel and structural surfaces.
- Ideal for use around homes and other buildings, as well as in gardens and parks.

- Can be used on lawns and structural surfaces (roofs, decks, patios, sidewalks, fences, etc.)
- Kills moss so grass can grow thicker and richer.
- Can be used to spot treat problem areas.
- Can be used to spot treat problem areas in lawns or gardens.
- Will not increase soil acidity.
- Cultural methods such as soil aeration, liming, improving sun exposure, improving drainage, and applying sand to lawns can make conditions less favorable to moss.
- Will not turn moss black.
- Will not blacken moss or darken grass.
- Patent pending
- Patent #XXXXX
- Makes over XX gallons.
- Covers up to XXX sq. ft.
- (Fertilizer code N P K) 0 0 4
- 0 0 4
- Contains 4% potassium, present as potassium soap of fatty acids.
- If the moss is dry, lightly water area to be treated.
- Does not contain ferrous sulfate.
- For household use only.
- Sprayer reaches up to XX feet.
- This product is a fast-acting moss, algae and lichen killer for use on lawns, roofs, patios, fences, bark mulch and driveways. This product will not stain concrete or other surfaces and a single application will control moss and algae for several months to one year.
- What is this product and what will it do:** H02 Moss Killer Concentrate is a fast-acting moss, algae and lichen killer. On wood, concrete and asphalt a single application will control moss and algae for several months to one year. It does not stain concrete, pavement, stucco or wood.
- Where can I use this product?** H02 Moss Killer Concentrate can be used on cedar shakes and composition shingles, cedar siding, stucco, brick, stone or concrete walks and driveways and cedar, redwood or CCA treated wood decks and fences. Other sites include lawns, hardened bark of trees, bark mulch, patios, asphalt and gravel.
- Where can I use this product?** H02 Moss Killer Concentrate can be used on:
 - Lawns, hardened bark of trees, bark mulch, patios, asphalt and gravel
 - Cedar shakes and composition shingles
 - Cedar siding, stucco, brick or stone
 - Concrete walks and driveways
 - Cedar, redwood or CCA treated wood decks and fences
- What will I see?** Moss will quickly yellow and then turn brown. Unless moss is physically removed it may remain where it died until rain or wind remove it.
- 1 ounce = 2 tablespoons = 6 teaspoons
- Ready-To-Spray
- Hose-End Bottle

- Hose-end sprayer
- This product is ready to spray. Just attach this bottle to your garden hose according to directions. Water automatically mixes with the concentrate as you spray.
- Attach to garden hose and spray.
- Moss-Aside™ is a trademark of "W. Neudorff GmbH KG"
- www.neudorff.de



- Made with Moss-Aside™ Moss Killer, a trademark of W. Neudorff GmbH KG
- Contains Moss-Aside™ Moss Killer, a trademark of W. Neudorff GmbH KG
- Sold under a license of "W. Neudorff GmbH KG, Germany".
- Manufactured under a license of W. Neudorff GmbH KG, Germany.
- Before...After!]

[Optional warranty statements. Registrant has choice of using any or none.

-NOTICE TO BUYER (WARRANTY)

Seller warrants that this product conforms to the chemical description on this label and is reasonably fit for purposes stated on this label only when used in accordance with directions under normal use conditions. This warranty does not extend to use of this product contrary to label directions, or under abnormal use conditions, or under conditions not reasonably foreseeable to seller. Buyer assumes all risk of any such use. Seller makes no other warranties, either expressed or implied.

OR

-Buyer assumes all responsibility for safety and use not in accordance with directions.

OR

-Unconditionally Guaranteed by (company name). **OUR COMMITMENT TO YOUR SATISFACTION:** If you are not happy with the way this product works in your garden, please let us know. We will be happy to replace the product, refund your money, or substitute another (brand name) product. Simply send your name, address and proof of purchase to (Company name & address).]

OR

Money Back Guarantee: If you are not satisfied with this product, we will gladly refund your original purchase price.

OR

The (brand name) Promise: Satisfaction guaranteed or your money back! If you apply H02 Moss Killer Concentrate as directed and are not completely satisfied, send proof of purchase from this package and the original cash register receipt to the address below. We will refund the purchase price you paid.

SUBLABEL B: Commercial Use

H02 MOSS KILLER CONCENTRATE

Active Ingredient:	
Potassium soap of fatty acids	22.11%
Inert Ingredients:.....	<u>77.89%</u>
Total:	100.00%

KEEP OUT OF REACH OF CHILDREN

WARNING/AVISO

Si usted no entiende la etiqueta busque para que se la explique a usted en detalle. (If you do not understand the label, find someone to explain it to you in detail.)

EPA REG. NO. 67702-12

EPA EST. 67702-WG-1

NET CONTENTS: 0.5 gallon, 1 gallon, 5 gallons, 20 gallons, 55 gallon, 211 gallons

FIRST AID	
IF IN EYES	<ul style="list-style-type: none"> -Hold eye open and rinse slowly and gently with water for 15-20 minutes. -Remove contact lenses, if present, after the first 5 minutes, then continue rinsing. -Call a poison control center or doctor for treatment advice.
IF ON SKIN OR CLOTHING	<ul style="list-style-type: none"> -Take off contaminated clothing. -Rinse skin immediately with plenty of water for 15-20 minutes. -Call a poison control center or doctor for treatment advice.
Have the product container or label with you when calling a poison control center or doctor or going for treatment.	

PRECAUTIONARY STATEMENTS

HAZARDS TO HUMANS AND DOMESTIC ANIMALS

WARNING: Causes substantial but temporary eye injury. Causes skin irritation. Do not get in eyes, on skin or on clothing.

Personal Protective Equipment (PPE) Requirements: Applicators and other handlers must wear: Coveralls over short-sleeved shirt and short pants, chemical-resistant gloves made of any waterproof material, chemical-resistant footwear plus socks, protective eyewear and chemical-resistant headgear for overhead exposure. A chemical-resistant apron must also be worn when cleaning equipment, mixing or loading.

Discard clothing and other absorbent materials that have been drenched or heavily contaminated with this product's concentrate. Do not reuse them. Follow manufacturer's instructions for cleaning/maintaining PPE. If no such instructions for washables, use detergent and hot water. Keep and wash PPE separately from other laundry.

User Safety Recommendations:

Users should:

Wash hands before eating, drinking, chewing gum, using tobacco or using the toilet.

Remove clothing immediately if pesticide gets inside. Then wash thoroughly and put on clean clothing.

Remove PPE immediately after handling this product. Wash the outside of gloves before removing. As soon as possible, wash thoroughly and change into clean clothing.

ENVIRONMENTAL HAZARDS

This product may be hazardous to aquatic invertebrates. Do not apply directly to water, or to areas where surface water is present, or to intertidal areas below the mean high water mark. Do not contaminate water when cleaning equipment or disposing of equipment washwaters.

DIRECTIONS FOR USE

It is a violation of Federal Law to use this product in a manner inconsistent with its labeling.

Do not apply this product in a manner that will contact workers or other persons, either directly or through drift. Only protected workers may be in the area during application. For any requirements specific to your State or Tribe, consult the agency responsible for pesticide regulation.

Agricultural Use Requirements

Use this product in accordance with its labeling and with the Worker Protection Standard, 40 CFR part 170. This standard contains requirements for the

protection of agricultural workers on farms, forests, nurseries, and greenhouses, and handlers of agricultural pesticides. It contains requirements for training, decontamination, notification, and emergency assistance. It also contains specific instructions and exceptions pertaining to the statements on this label about personal protective equipment (PPE), and restricted-entry interval. The requirements in this box only apply to uses of this product that are covered by the Worker Protection Standard (WPS).

Entry-Restrictions: Do not enter or allow worker entry into treated areas during the restricted-entry interval of 24 hours.

PPE required for early-entry to treated areas that is permitted under the Worker Protection Standard and that involves contact with anything that has been treated, such as plants, soil, or water, wear: coveralls over short-sleeved shirt and short pants, chemical-resistant gloves made of any waterproof material, chemical-resistant footwear plus socks, protective eyewear and chemical-resistant headgear for overhead exposure.

Non-Agricultural Use Requirements

The requirements in this box apply to uses of this product that are NOT within the scope of the Worker Protection Standard for agricultural pesticides (40 CFR Part 170). The WPS applies when this product is used to produce agricultural plants on farms, forests, nurseries, or greenhouses.

Keep unprotected persons and domestic animals out of treated areas until sprays have dried.

Read and follow all applicable directions and precautions on this label before using.

PESTS: H02 Moss Killer Concentrate is effective in controlling mosses, algae, lichens, and liverworts.

SITES: H02 Moss Killer Concentrate may be used in and around nurseries and greenhouses. It may be used on roofs, decks, siding, walkways, fences, growing containers, other structural surfaces, hardened bark of trees, lawns, turf (including golf courses, parks, playgrounds, cemeteries, athletic fields and office and industrial parks), and cultivated areas.

APPLICATION DIRECTIONS

Golf Courses: Dilute concentrate by mixing one part concentrate with 19 parts water. For putting greens, fairways and other areas apply 12 to 25 gallons per 1000 ft² (500 to 1000 gallons/acre).

Parks and Playgrounds: Dilute concentrate by mixing one part concentrate with 19 parts water (6.8 oz in 1 gallon water). Thoroughly soak moss with solution, applying 12 to 25 gallons per 1000 ft² (500 to 1000 gallons/acre). For thick moss (greater than 1 inch), use up to 50 gallons per 1000 ft².

Lawns, Turf and Cultivated Areas: Dilute concentrate by mixing one part concentrate with 19 parts water (6.8 oz in 1 gallon water). Thoroughly soak moss with solution, applying 12 to 25 gallons per 1000 ft² (500 to 1000 gallons/acre). For thick moss (greater than 1 inch), use up to 50 gallons per 1000 ft².

Follow-Up on Grass and Turf: Lightly rinse treated areas with water (1 gallon per 1000 ft² or less) 15 to 30 minutes after treatment to avoid grass/turf damage. Test spray a small area prior to using. Do not heavily irrigate for at least 6 hours. Re-apply every 2 weeks or as required. If it rains within one day of treatment, an additional application may be required. Moss will turn brown after a few days. Areas can be re-sown 5 days after treatment.

Follow-Up on Golf Courses, Parks, Playgrounds, Lawns, Turf and Ornamental Gardens: Lightly rinse treated areas with water (1 gallon per 1000 ft² or less) 15 to 30 minutes after treatment to avoid grass and plant damage. Test spray a small area prior to using. Do not heavily irrigate for at least 6 hours. Re-apply every 2 weeks or as required. If it rains within one day of treatment, an additional application may be required. Moss will turn brown after a few days. Areas can be re-sown 5 days after treatment.

Other Sites: Dilute concentrate by mixing one part concentrate with 9 to 15 parts water (put 8 to 13 oz in 1 gallon water). Apply 8 to 12 gallons of water per 1000 ft². For thick moss (greater than 1 inch), use 25 gallons of water per 1000 ft². If moss is dry, thoroughly wet moss with water before treating. Repeat treatment annually, or when new moss or algae are visible.

WHEN TO USE: H02 Moss Killer Concentrate can be used at any time during the year. Best results are obtained with actively growing moss in the spring or fall. Do not use on lawns (turf) when temperature exceeds 85°F. During warmer weather apply late in the day. Application during cold weather may delay appearance of moss damage.

METHODS OF APPLICATION: Apply with standard spray equipment. Keep sprayer moving to get an even application. In areas of hard water, use water softeners.

USE PRECAUTIONS

Do not use with spreaders or stickers.

STORAGE AND DISPOSAL

Do not contaminate water, food or feed by storage or disposal.

STORAGE: Store in a secure place, away from open fire or flame. Keep container closed and reseal after use. Product may be damaged by freezing.

Do not store product below 32°F. If spilled, use absorbent materials and dispose of in an approved manner.

PESTICIDE DISPOSAL: Wastes resulting from the use of this product may be disposed of on site or at an approved waste disposal facility.

CONTAINER DISPOSAL: Triple rinse (or equivalent). Then offer for recycling or reconditioning, or puncture and dispose of in a sanitary landfill, or by incineration, or, if allowed by state and local authorities, by burning. If burned, stay out of smoke.

[Optional marketing claims and product information that may be presented on the container label or supplemental labeling:

- Eliminates unwanted moss, algae and lichens quickly
- Won't stain bricks, concrete or asphalt
- Kills within hours
- Fast acting
- Kills algae, moss and lichens
- Soap for killing moss.
- Moss killer.
- Moss, algae and lichen killer.
- Kills moss fast.
- Kills moss, algae, and lichens quickly and effectively.
- Removes green slime.
- Water based.
- Does not contain alcohol.
- Does not contain any metal salts, such as iron or zinc.
- No unpleasant odor.
- Low foaming.
- Will (Does) not stain.
- Will (Does) not stain concrete or other surfaces.
- Will (Does) not stain concrete, pavement, stucco or wood.
- Diluted H₂O₂ Moss Killer Concentrate will not damage painted and metal surfaces.
- Will (Does) not darken grass.
- Will (Does) not damage gutters, metal flashing or downspouts.
- H₂O₂ Moss Killer Concentrate can provide long-term control of moss on wooden roofs and structures.
- Kills moss to prolong life of roofs, decks, patios and walks.
- Destroys moss to prolong life of roofs, decks, patios and walks.
- Controlling moss and algae may add months or years of service to roofs, patios, decks, and such areas.

-H02 Moss Killer Concentrate is a fast acting moss, algae and lichen killer for use on lawns, roofs, sidewalks, buildings, fences, decks, patios, bark mulch, driveways, and gravel.

-Higher concentrations of H02 (10% and higher) may damage some plants. Rinse off of plants and automobiles that are accidentally sprayed.

-For best results on lawns use the higher spray volumes and thoroughly soak moss.

-Spray treated structures with water 1 week after treatment to remove dead moss and algae.

-For best results, physically remove dead moss one week after treatment.

-Pressure washing is a good method of removing dead moss from roofs.

-When spraying roofs it is best to spray "up-slope" to thoroughly treat the ends of the shingles.

-Freshly treated areas may be slippery. To avoid falling do not walk on freshly treated areas. Rinse treated walkways 1 day after treating to reduce slipperiness.

-In case of overspray onto non-target (desirable) plants, rinse immediately to avoid any possible damage.

-One gallon of concentrate will treat up to XXXX ft² of lawn.

-One gallon of concentrate will treat up to XXXX ft² of turf.

-One gallon of concentrate will treat up to XXXX ft² of roof or siding.

-Will not harm adjacent plants when used according to directions.

-May be used on moss, algae and lichens on mature, dormant trees, bark mulch, patios, benches, greenhouses, growing containers, gravel and structural surfaces.

-Kills moss so grass can grow thicker and richer.

-Can be used to spot treat problem areas.

-Can be used to spot treat problem areas in lawns or gardens.

-Will not increase soil acidity.

-Cultural methods such as soil aeration, liming, improving sun exposure, improving drainage, and applying sand to lawns can make conditions less favorable to moss.

-Will not turn moss black.

-Will not blacken moss or darken grass.

-Patent pending

-Patent #XXXXXX

-Makes over XX gallons.

-(Fertilizer code N P K) 0 0 4

-0 0 4

-Contains 4% potassium, present as potassium soap of fatty acids.

-If the moss is dry, lightly water area to be treated.

-Does not contain ferrous sulfate.

-This product is a fast-acting moss, algae and lichen killer for use on lawns, roofs, patios, fences, bark mulch and driveways. This product will not stain concrete or other surfaces and a single application will control moss and algae for several months to one year.

-Moss-Aside™ is a trademark of "W. Neudorff GmbH KG"
-www.neudorff.de



- Made with Moss-Aside™ Moss Killer, a trademark of W. Neudorff GmbH KG
- Contains Moss-Aside™ Moss Killer, a trademark of W. Neudorff GmbH KG
- Sold under a license of "W. Neudorff GmbH KG, Germany
- Manufactured under a license of W. Neudorff GmbH KG, Germany.
- Before...After!]

[Optional warranty statements. Registrant has choice of using any or none.

-NOTICE TO BUYER (WARRANTY)

Seller warrants that this product conforms to the chemical description on this label and is reasonably fit for purposes stated on this label only when used in accordance with directions under normal use conditions. This warranty does not extend to use of this product contrary to label directions, or under abnormal use conditions, or under conditions not reasonably foreseeable to seller. Buyer assumes all risk of any such use. Seller makes no other warranties, either expressed or implied.

Or

-Buyer assumes all responsibility for safety and use not in accordance with directions.]