

67702-5

10/03/2007

1/18



UNITED STATES ENVIRONMENTAL PROTECTION AGENCY
WASHINGTON, D.C. 20460

OCT - 3 2007

OFFICE OF
PREVENTION, PESTICIDES AND
TOXIC SUBSTANCES

Walter G. Talarek, P.C.
Agent for W. Neudorff GmbH KG
1008 Riva Ridge Drive
Great Falls, Va 22066

Dear Mr. Talarek

Subject: NEU1161
EPA Reg.No. 67702-5
Submission dated 7/20/07

The labeling referred to above, submitted in connection with registration under the Federal Insecticide, Fungicide, and Rodenticide Act, as amended, is acceptable. Please note that a notice of availability of EPA's reregistration eligibility document (RED) for products containing pyrethrins was published in the Federal Register on July 26, 2006 (71 FR 42387) (<http://www.epa.gov/fedrgstr/EPA-PEST/2006/July/Day-26/p11913.htm>). Additional data and/or labeling changes maybe required for products containing pyrethrins. If you have questions, please call Ann Sibold at 703 305-6502.

Sincerely,

A handwritten signature in cursive script, appearing to read "Ann Sibold".

for
Richard Gebken
Product Manager 10
Insecticide Branch
Registration Division (7505P)

MASTER LABEL

NEU1161

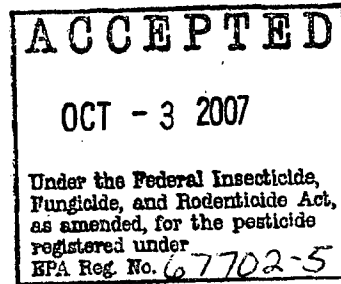

Active Ingredients	By Wt.
Pyrethrins	0.5%
Canola Oil	89.5%
Other Ingredients.....	10.0%
Total	100.0%

[The registrant may use one of these statements, either

This product contains 6.875 lbs. of canola oil and 0.038 lbs. of pyrethrins per gallon.

OR

This product contains 0.859 lbs. of canola oil and 0.005 lbs. of pyrethrins per pint.

OR

This product contains 1.718 lbs. of canola oil and 0.01 lbs. of pyrethrins per quart.]

SUBLABEL A: Home Garden and Home Greenhouse Use

SUBLABEL B: Commercial Agriculture Use

KEEP OUT OF REACH OF CHILDREN

CAUTION

EPA Reg. No. 67702-5
Patent #5,700,473

EPA Establishment # 67702-WG-1

Manufactured by: W. Neudorff GmbH KG
An der Muhle 3, Postfach 1209
D-31860 Emmerthal, Germany

Home Garden and Home Greenhouse Use: NET CONTENTS: 16 fl.oz, 24 fl.oz, 32 fl.oz,
1 gallon (128 fl.oz)

Commercial Agriculture Use: NET CONTENTS: 1 gallon, 5 gallons, 2.5 gallons, 20
gallons, 45 gallons

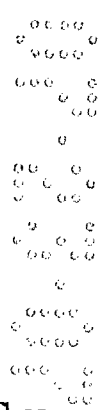

SUBLABEL A: Home Garden and Home Greenhouse Use

NEU1161

Active Ingredients	By Wt.
Pyrethrins	0.5%
Canola Oil	89.5%
Other Ingredients.....	10.0%
Total	100.0%

[The registrant may use one of these statements, either

This product contains 6.875 lbs. of canola oil and 0.038 lbs. of pyrethrins per gallon.

OR

This product contains 0.859 lbs. of canola oil and 0.005 lbs. of pyrethrins per pint.

OR

This product contains 1.718 lbs. of canola oil and 0.01 lbs. of pyrethrins per quart.]

KEEP OUT OF REACH OF CHILDREN

CAUTION

EPA Reg. No. 67702-5
Patent #5,700,473

EPA Establishment # 67702-WG-1

FIRST AID	
IF ON SKIN OR CLOTHING	-Take off contaminated clothing. -Rinse skin immediately with plenty of water for 15-20 minutes. -Call a poison control center or doctor for treatment advice.
Have the product container or label with you when calling a poison control center or doctor or going for treatment.	

NET CONTENTS: 16 fl.oz, 24 fl.oz, 32 fl.oz, 1 gallon.

PRECAUTIONARY STATEMENTS

Hazards to Humans and Domestic Animals: CAUTION. Harmful if swallowed or absorbed through the skin. Prolonged or frequently repeated skin contact may cause allergic reactions in some individuals. Avoid contact with skin, eyes or clothing Wash thoroughly with soap and water after handling and before eating, drinking, chewing gum or using tobacco.

User Safety Recommendations

- Users should wash hands with plenty of soap and water before eating, drinking, chewing gum, using tobacco, or using the toilet.
- Users should remove clothing immediately if pesticide gets inside. Then wash thoroughly and put on clean clothing.

Environmental Hazards: This product is toxic to aquatic organisms including fish and invertebrates. Do not apply directly to water or near water. Drift and run-off may be hazardous to fish in water adjacent to treated areas. Do not contaminate water when disposing of equipment, washwater, or rinsate. See Directions for Use for additional precautions and requirements.

DIRECTIONS FOR USE

It is a violation of Federal law to use this product in a manner inconsistent with its labeling.

Only for use in home gardens and home greenhouses.

USE RESTRICTIONS

- Do not wet plants to point of runoff or drip.
- Do not allow adults, children or pets to enter the treated area until sprays have dried.
- Do not apply this product in a way that will contact adults, children, or pets, either directly or through drift.
- Do not apply within 21 days of a sulfur application.
- Do not use NEU1161 spray when temperatures are above 90°F.
- Do not apply directly to or near water, storm drains, or drainage ditches. Do not apply when windy. To prevent product run-off, do not over water the treated area(s) or apply when heavy rain is expected. Rinse applicator over lawn or garden area only.
- Do not apply more than 10 times per season.
- Do not reapply within 3 days except under extreme pest pressure.
- In case of extreme pest pressure do not reapply within 24 hours.
- Not for use in outdoor residential misting systems.

Phytotoxicity:

Oil removes the glaucous (blue) bloom from such evergreens as Colorado blue spruce and Koster spruce. Use a 1% solution on oil sensitive plants such as: Chamaecyparis, Cryptomeria, Japanese Holly, Red Cedar and Smoke Tree. Use care on blooms and buds. Test spray a portion of the plant and wait several days to determine if burn occurs before spraying larger areas. Some plants are sensitive to this product. If in doubt, test-spray a small portion of the plant and wait several days to determine if burn occurs before spraying larger areas.

Read entire label before use. Use only as directed. Shake well before each use. Thoroughly wet all parts of the plants. Repeat treatment in 1 - 2 weeks if necessary. May be used on edible fruits and vegetables up to and including day of harvest.

APPLICATION INSTRUCTIONS

[The registrant may use one of these application directions, either

INSTRUCTIONS FOR MIXING

For a 1% solution, mix 2 teaspoons of concentrate with 1 quart (32 fl. oz) water, or 1 fl. oz. concentrate with 3 quarts (96 fl. oz.) water. For a 2% solution, mix 4 teaspoons of concentrate with 1 quart (32 fl. oz) water, or 2 fl. oz. concentrate with 3 quarts (96 fl. oz.) water. Shake well before each use and stir or shake diluted spray frequently during use.

OR

Hose-End Sprayer Directions

Follow the directions for using the Hose-End sprayer.

How to use hose-end sprayer:

1. Connect spray nozzle to garden hose.
2. Turn on the water from the faucet.
3. When you are ready to spray, turn the blue knob on top so that it points to the MIX position on the spray head. (Fig. 1)
4. The spray deflector on the front of the hose-end applicator can be rotated to give a stream or fan spray. (Fig. 2)

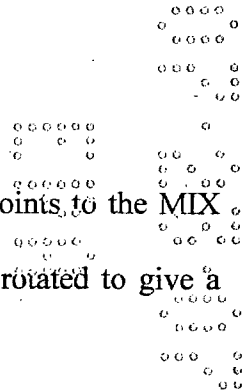

To stop spraying:

1. When you are finished spraying or if you have to stop spraying at any time, turn the blue knob back to the OFF position. (Fig. 3)
2. Turn off the water from the faucet.
3. Turn the blue knob to H₂O then OFF, to drain the water from the hose. (Fig. 4)
4. Unscrew spray nozzle from hose. Remove hose-end from container.]

[Optional Figure:

Figure 1

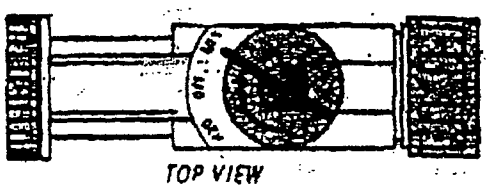

Figure 2

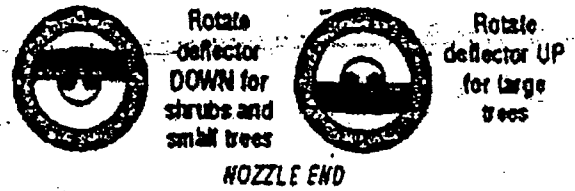

Figure 3

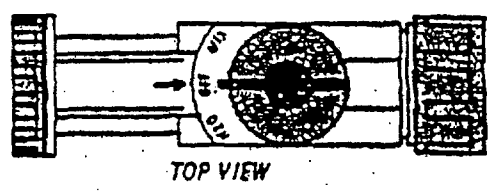
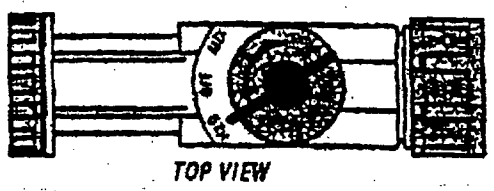

Figure 4



OR

HOSE END SPRAYER INSTRUCTIONS

Shake before using.

HOW TO USE:

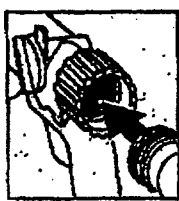

1. Attach garden hose to spray nozzle.
2. Turn on water supply.



4. Point nozzle toward plants and turn water control knob to "On". Product will automatically mix with water. Spray upper and lower leaf surfaces thoroughly.

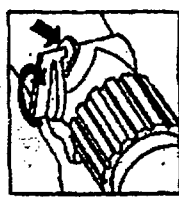

3. Bend safety tab down and turn control to "water".

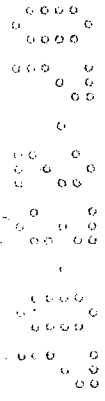

OR:

1. Attach garden hose to spray nozzle. Turn on water supply.
2. Bend safety tab down and turn control to "water".
3. Point nozzle toward plants and turn water control knob to "On". Product will automatically mix with water. Spray upper and lower leaf surfaces thoroughly.

To Stop Spraying:

1. When you are finished spraying or if you have to stop spraying at any time, turn the blue knob back to the OFF position.
2. Turn off the water from the faucet.
3. Turn the blue knob to H₂O then OFF, to drain the water from the hose.
4. Unscrew spray nozzle from hose. Remove hose end from container.

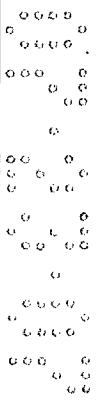
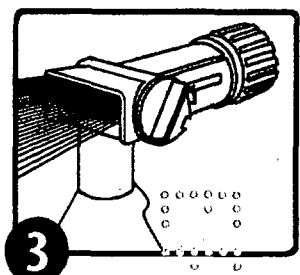
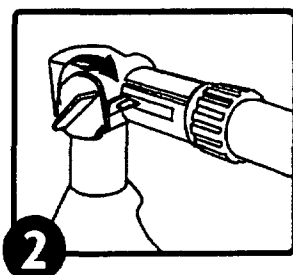
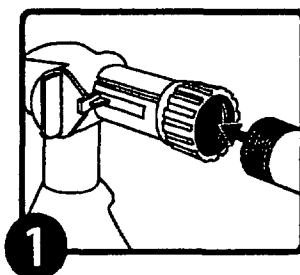

1

STORAGE AND DISPOSAL

STORAGE: Store this product in its original container and keep in a secure storage area out of reach of children and domestic animals.

DISPOSAL:

If empty: Do not reuse this container. Place in trash or offer for recycling if available.

If partly filled: Call your local solid waste agency for disposal instructions. Never place unused product down any indoor or outdoor drain.

PESTS AND APPLICATION INSTRUCTIONS

NEU1161 will kill the following insect pests: aphids, beetles (Colorado potato beetle, flea beetle, Japanese beetle, asparagus beetle), caterpillars (gypsy moth caterpillars, tent caterpillar, diamondback moth larvae, leafrollers), ants (except Fire Ants, Harvester Ants, Carpenter Ants and Pharaoh Ants), mealybugs, mites, leafhoppers, scale insects, whitefly, adelgids, plant bugs, fungus gnats, thrips, sawfly larvae, psyllids, spittlebugs, and

phylloxera. Apply a 1% or 2% solution. For soft-bodied pests such as aphids and mites, a 1% solution is sufficient. Using hand-held trigger sprayers, hand sprayers or backpack sprayers, thoroughly spray insect pests with diluted product until plants are wet. Do not wet plants to point of runoff or drip. Repeat treatment in 1-2 weeks if needed.

HOME GARDEN USE

For use outdoors on fruit and nut trees (apples, cherries, peaches, pears, nuts); flowering, foliage plants; corn; melons; tomatoes; vegetables (beans, cabbage, cucurbits, peas, potatoes); figs; small fruits (grapes, strawberry, raspberry); citrus; ornamental and shade trees (birch, evergreens, holly, oak). Do not apply more than 4 fl. oz. of concentrate (400 fl.oz. of 1% solution or 200 fl. oz. of 2% solution) per 1000 square feet.

HOME GREENHOUSE USE

For use in home greenhouses on flowering, foliage plants; melons; tomatoes; vegetables (beans, cabbage, cucurbits, peas, potatoes); small fruits (grapes, strawberry, raspberry). Do not apply more than 4 fl. oz. of concentrate (400 fl.oz. of 1% solution or 200 fl. oz. of 2% solution) per 1000 square feet.

DORMANT USE

Kills egg stages of pests present in dormant season and scale insects, mites and mealybugs on dormant shrubs (roses), evergreens, fruit trees and shade trees. Apply a 2% solution. Thoroughly wet the dormant plants or trees. Do not apply more than 4 fl. oz. of concentrate (400 fl.oz. of 1% solution or 200 fl. oz. of 2% solution) per 1000 square feet.

[Marketing claims and product information that may or may not be presented on the container or label:

- Dormant and growing season insect spray to kill adelgids, aphids, armored scale, beetle larvae, cankerworms, caterpillars, fungus gnats, lace bugs, leafhoppers, leafminers, leafrollers, mealybugs, mites, plant bugs, psyllids, scale insects, spider mites, thrips, webworms and whiteflies.
- Patent #5,700,473
- Kills all accessible stages of listed insects, including eggs.
- Contact insecticide, ovicide.
- Fast acting – kills on contact
- Contains pyrethrins and canola oil botanical insecticides.
- Easy to use
- Insecticide/miticide
- NEU1161 is a contact killer for listed insect and mite pests.
- For best results, pests must be contacted directly with spray.
- Pyrol™ is a trademark of W. Neudorff GmbH KG
- Made with Pyrol™ Insecticide, a trademark of W. Neudorff GmbH KG

9/18

- Contains Pyrol™ Insecticide, a trademark of W. Neudorff GmbH KG



- May be used up to day of harvest
- May be used on edible fruits and vegetables up to and including day of harvest
- Can be used right up until day of harvest.
- Read Entire Container Label Before Using This Product
- Roses and flowers
- Gardens
- Fruits and vegetables
- Can be used in vegetable gardens
- [For 16. fl. oz container] Makes over 12 gallons of spray
- [For 24 fl. oz. container] Makes over 18 gallons of spray
- [For 32 fl. oz container] Makes up to 25 gallons of spray
- [For 1 gallon container] Makes up to 100 gallons of spray]

[The registrant may use one of these optional statements:

“NOTICE TO BUYER

Seller warrants that this product conforms to the chemical description on this label and is reasonably fit for the purposes stated in the Directions for Use, subject to the inherent risks described above, when used in accordance with the Directions for Use under normal conditions. To the extent consistent with applicable law, this warranty does not extend to use of this product contrary to label directions, or under abnormal use conditions, or under conditions not reasonably foreseeable to Seller. To the extent consistent with applicable law, the Seller shall not be liable for any such use. To the extent consistent with applicable law, the Seller makes no other warranties, either expressed or implied.

OR

- Satisfaction guaranteed

OR

- Unconditionally guaranteed

OR

- Money back guarantee]

Manufactured by: W. Neudorff GmbH KG
 An der Muhle 3, Postfach 1209
 D-31860 Emmerthal, Germany

10/18

SUBLABEL B: Commercial Agriculture Use

NEU1161

Active Ingredients	By Wt.
Pyrethrins	0.5%
Canola Oil	89.5%
Other Ingredients.....	10.0%
Total	100.0%

[The registrant may use one of these statements, either

This product contains 6.875 lbs. of canola oil and 0.038 lbs. of pyrethrins per gallon.

OR

This product contains 0.859 lbs. of canola oil and 0.005 lbs. of pyrethrins per pint.

OR

This product contains 1.718 lbs. of canola oil and 0.01 lbs. of pyrethrins per quart.]

KEEP OUT OF REACH OF CHILDREN

CAUTION

EPA Reg. No. 67702-5
Patent #5,700,473

EPA Establishment # 67702-WG-1

FIRST AID	
IF ON SKIN OR CLOTHING	-Take off contaminated clothing. -Rinse skin immediately with plenty of water for 15-20 minutes. -Call a poison control center or doctor for treatment advice.
Have the product container or label with you when calling a poison control center or doctor or going for treatment.	

NET CONTENTS: 1 gallon, 5 gallons, 20 gallons, 45 gallons

PRECAUTIONARY STATEMENTS

Hazards to Humans and Domestic Animals: CAUTION. Harmful if swallowed or absorbed through the skin. Prolonged or frequently repeated skin contact may cause allergic reactions in some individuals. Avoid contact with skin, eyes or clothing. Wash

thoroughly with soap and water after handling and before eating, drinking, chewing gum or using tobacco.

Personal Protective Equipment (PPE) Requirements: Mixers, loaders, applicators and other handlers must wear the following: long-sleeved shirt and long pants; shoes plus socks; and waterproof gloves. Follow manufacturer's instructions for maintaining PPE. If no such instructions for washables, use detergent and hot water. Keep and wash PPE separately from other laundry. Discard clothing and other absorbent material that have been drenched or heavily contaminated with the product's concentrate. Do not reuse them.

User Safety Recommendations

- Users should wash hands before eating, drinking, chewing gum, using tobacco, or using the toilet.
- Users should remove clothing immediately if pesticide gets inside. Then wash thoroughly and put on clean clothing.
- Users should remove PPE immediately after handling this product. Wash the outside of gloves before removing. As soon as possible, wash thoroughly and change into clean clothing.

Environmental Hazards: This product is toxic to aquatic organisms, including fish and invertebrates. Drift and runoff may be hazardous to aquatic organisms in water adjacent to treated areas. This product may contaminate water through runoff. This product has a potential for runoff for several weeks after application. Poorly draining soils and soils with shallow water tables are more prone to produce runoff that contains this product.

This product is highly toxic to bees exposed to direct treatment on blooming crops or weeds. Do not apply this product or allow it to drift to blooming crops or weeds while bees are actively visiting the treatment area.

[For container sizes under 5 gallons, use the following statement:

Do not apply directly to water or to areas where surface water is present or to intertidal areas below the mean high water mark. Do not contaminate water when cleaning equipment or disposing of equipment washwaters. Observe the most restrictive of the labeling limitations and precautions of all products used in mixtures.]

[For container sizes of 5 gallons or more, use the following statement:

Do not discharge effluent containing this product into lakes, streams, ponds, estuaries, oceans or other water unless in accordance with the requirements of a National Pollutant Discharge Elimination System (NPDES) permit and the permitting authority has been notified in writing prior to discharge. Do not discharge effluent containing this product to sewer systems without previously notifying the local sewage treatment plant authority.

For guidance contact your State Water Board or Regional Office of the EPA. Observe the most restrictive of the labeling limitations and precautions of all products used in mixtures.]

DIRECTIONS FOR USE

It is a violation of Federal law to use this product in a manner inconsistent with its labeling.

USE RESTRICTIONS

- Do not wet plants to point of runoff or drip.
- Do not apply more than 10 times per season.
- Do not reapply within 3 days except under extreme pest pressure.
- In case of extreme pest pressure, do not reapply within 24 hours.
- Do not harvest until spray has dried.
- Do not apply to cotton within 14 days of seed harvest.
- Do not apply this product in a way that will contact workers or other persons, either directly or through drift. Only protected handlers may be in the area during application.
- Do not apply within 21 days of a sulfur application.
- Do not use NEU1161 spray when temperatures are above 90°F.

Spray Drift Management for Agriculture Crops:

Avoiding spray drift at the application site is the responsibility of the applicator and the grower. The interactions of many equipment (boom sprayer, pressurized handheld/backpack sprayer, airblast sprayer, insectigation) and weather-related factors determine the potential for spray drift. The applicator and the grower are responsible for considering all these factors when making decisions.

- Do not apply at wind speeds greater than 10 mph at the application site.
- Do not make any type of application into temperature inversions.
- Apply as a medium or coarser spray (ASABE standard 572).
- Do not release spray at a height greater than 4 feet above the ground or crop canopy.

Phytotoxicity:

Oil removes the glaucous (blue) bloom from such evergreens as Colorado blue spruce and Koster spruce. Use a 1% solution on oil sensitive plants such as: Chamaecyparis, Cryptomeria, Japanese Holly, Red Cedar and Smoke Tree. Use care on blooms and buds. If concerned about sensitivity of plants, test spray a portion of the plant and wait several days to determine if burn occurs before spraying larger areas.

Read entire label. Use only as directed. Mix well before each use. Thoroughly wet all parts of the plants. Repeat treatment in 1 - 2 weeks if necessary. May be used on edible crops up to and including day of harvest.

AGRICULTURAL USE REQUIREMENTS

rates may be exceeded. This product cannot be mixed with any product containing a label prohibition against such mixing.

For foliage application the spray tank must be free of any sulfur residue before using this material. Do not combine sulfur sprays with this material on foliage during spring and summer months. Do not apply within 21 days of a sulfur application. If in doubt, spray a portion of one tree previously treated with sulfur and wait several days to determine if burn occurs.

When used in combination with or immediately before or after spraying, this product may increase the phytotoxicity of fungicides such as Captan, or copper compounds. If in doubt, treat a small area with a combination spray and wait several days to determine if burn occurs.

MIXING

For 2% solution, mix 2 parts concentrate with 98 parts water. For 1% solution, mix 1 part concentrate with 99 parts water. For soft-bodied pests such as aphids and mites, use 1% solution. Shake well before each use and stir or shake diluted spray frequently during use.

1. Add sufficient water to the mixing tank to allow proper agitation by pump or paddles.
2. Continue stirring while adding first the NEU1161 then the remaining water.
3. Continue to stir throughout use.
4. If using equipment without pump or paddle, shake often during use.
5. Flush fluid in sprayer hose lines back into the tank if the solution has remained unstirred for more than 20 minutes.

OUTDOOR PESTS/SITES APPLICATION INSTRUCTIONS

Repeat in 7 to 14 days, as needed, up to three applications per growing season. Apply 2% diluted product except for soft-bodied pests such as aphids and mites. For these pests a 1% dilution rate is sufficient. Mix well before each use. Apply at a rate of 65 gal/acre of 2% dilution and 65-130 gal/acre of 1% dilution. Do not apply more than 1.3 gallons of concentrate per acre per application.

Crop	Pest	Application Rate of Diluted Concentrate
Fruit trees: apples, apricots, cherries, nectarines,	aphids, apple red bug, caterpillars, European red mite,	Dormant, pre-bloom and summer use

peaches, pears, plums, prunes	fruittree leafroller, leafhoppers, mites, pear psylla, plant bugs, sawfly larvae, scales, spider mites	1%: 65 – 130 gallons/acre 2%: 65 gallons/acre
Flowering, foliage and bedding plants - greenhouse and outdoors	aphids, caterpillars, fungus gnats, lace bugs, leafminers, mealybugs, mites, scales, thrips, whiteflies	1%: 65 – 130 gallons/acre 2%: 65 gallons/acre
Sugar beets	leafminer, mites	1%: 65 – 130 gallons/acre 2%: 65 gallons/acre
Cotton	aphids, mites, whiteflies, leafhoppers	When insects appear-repeat weekly as needed 1%: 65 – 130 gallons/acre 2%: 65 gallons/acre
Soybeans, melons, tomatoes, vegetables: asparagus, beans, beets, broccoli, Brussels sprouts, cabbage, cauliflower, celery, collards, cucurbits, eggplant, kale, lettuce, lima beans, mustard greens, peas, potatoes, peppers, radishes, spinach, squash, turnips.	aphids, adelgids, armored scale, asparagus beetle, beetle larvae, blister beetles, cabbage looper, cabbage worms, cankerworms, caterpillars, Colorado potato beetle, diamondback moth larvae, earwigs, flea beetle, harlequin bug, imported cabbageworm, Japanese beetles, leafhoppers, leafminers, leafrollers, mealybugs, Mexican bean beetles, mites, psyllids, plant bugs, soft scales, sowbugs, stink bugs, thrips, spotted cucumber beetles, webworms, whiteflies	Summer use 1%: 65 – 130 gallons/acre 2%: 65 gallons/acre
Small fruits: grapes, strawberry, blueberry, raspberry, cranberry, blackberry.	aphids, caterpillars, grape phylloxera, leafhoppers, Lygus bugs, mealybugs, mites, scales, spittlebugs, whiteflies	Dormant and summer use 1%: 65 – 130 gallons/acre 2%: 65 gallons/acre
Nut crops: almonds, filberts, macadamias, pecans, pistachios, walnuts	aphids, caterpillars, leafhoppers, leafrollers, mites, plant bugs, scales, spittlebugs, thrips, whiteflies	Dormant, pre-bloom and summer use 1%: 65 – 130 gallons/acre 2%: 65 gallons/acre
Citrus	aphids; citrus mealybug; mites; scales: red, black, yellow	Post-bloom, summer or fall

	& purple	1%: 65 – 130 gallons/acre 2%: 65 gallons/acre
Herbs and spices: anise (aniseed), basil, caraway, chicory, chives, coriander, cumin, dill, fennel (Italian and sweet), marjoram, sweet oregano, mint, nasturtium, paprika, parsley, rosemary, sage, savory, tarragon and thyme.	aphids, caterpillars, mites, plant bugs, whiteflies	When insects appear, repeat weekly as needed. 1%: 65 – 130 gallons/acre 2%: 65 gallons/acre
Ornamental and shade trees, flower and foliage plants, birch, flowering cherry, dogwood, evergreens, hawthorn, holly, magnolia, maple, oak, flowering peach, privet, pyracantha, sycamores	aphids, adelgids, caterpillars, gall mites, gypsy moth caterpillars and adults, lace bugs, leaf beetle larvae, leafhoppers, mealybugs, mites, plant bugs (immature), psyllids, sawfly larvae, scales, spider mites, tent caterpillars, whiteflies	Dormant, pre-bloom and summer use 1%: 65 – 130 gallons/acre 2%: 65 gallons/acre

GREENHOUSE USE:

Repeat in 7 to 14 days, as needed, up to three applications per growing season. Apply 2% diluted product except for soft-bodied pests such as aphids and mites. For these pests use a 1% dilution rate. Mix well before each use. Apply at a rate of 0.20 fl. oz./square foot of 2% dilution and 0.20 – 0.40 fl. oz./square foot of 1% dilution. Do not apply more than 0.004 fl. oz. of concentrate per square foot per application.

Crop	Pest	Application Rate of Diluted Concentrate
Flowering, foliage and bedding plants	aphids, caterpillars, fungus gnats, lace bugs, leafminers, mealybugs, mites, scales, thrips, whiteflies	1%: 0.20 – 0.40 fl. oz./square foot 2%: 0.20 fl. oz./square foot
Soybeans, melons, tomatoes, vegetables: asparagus, beans, beets, broccoli, Brussels sprouts, cabbage, cauliflower, celery, collards, cucurbits, eggplant, kale, lettuce, lima beans, mustard greens, peas, potatoes, peppers, radishes,	aphids, adelgids, armored scale, asparagus beetle, beetle larvae, blister beetles, cabbage looper, cabbage worms, cankerworms, caterpillars, Colorado potato beetle, diamondback moth larvae, earwigs, flea beetle, harlequin bug, imported cabbageworm, Japanese beetles,	Summer use 1%: 0.20 – 0.40 fl. oz./square foot 2%: 0.20 fl. oz./square foot

16/18

spinach, squash, turnips.	leafhoppers, leafminers, leafrollers, mealybugs, Mexican bean beetles, mites, psyllids, plant bugs, soft scales, sowbugs, stink bugs, thrips, spotted cucumber beetles, webworms, whiteflies	
Small fruits: grapes, strawberry, blueberry, raspberry, cranberry, blackberry.	aphids, caterpillars, grape phylloxera, leafhoppers, Lygus bugs, mealybugs, mites, scales, spittlebugs, whiteflies	Dormant and summer use 1%: 0.20 – 0.40 fl. oz./square foot 2%: 0.20 fl. oz./square foot
Herbs and spices: anise (aniseed), basil, caraway, chicory, chives, coriander, cumin, dill, fennel (Italian and sweet), marjoram, sweet oregano, mint, nasturtium, paprika, parsley, rosemary, sage, savory, tarragon and thyme.	aphids, caterpillars, mites, plant bugs, whiteflies	When insects appear, repeat weekly as needed. 1%: 0.20 – 0.40 fl. oz./square foot 2%: 0.20 fl. oz./square foot

DORMANT USE

Kills egg stages of pests present in dormant season and scale insects, mites and mealybugs on dormant shrubs, evergreens, woody plants, fruit trees and shade trees.

Apply 2% solution at a rate of 65 gal of diluted solution/acre. Do not apply more than 1.3 gallons of concentrate per acre per application.

CHEMIGATION

Do not apply this product through any type of irrigation system.

STORAGE AND DISPOSAL

Do not contaminate water, food or feed by storage and disposal.

PESTICIDE STORAGE: Store this product in its original container and keep in a secure storage area out of reach of children and domestic animals.

PESTICIDE DISPOSAL: Wastes resulting from the use of this product may be disposed of on site or at an approved waste disposal facility.

CONTAINER DISPOSAL: Triple rinse container. Then offer for recycling or reconditioning, or puncture and dispose of in a sanitary landfill, or incineration, or, if allowed by state and local authorities, by burning. If burned, stay out of smoke.

[Marketing claims and product information that may or may not be presented on the container or label:

- Dormant and growing season insect spray for kill of adelgids, aphids, armored scale, beetle larvae, cankerworms, caterpillars, fungus gnats, lace bugs, leafhoppers, leafminers, leafrollers, mealybugs, mites, plant bugs, psyllids, scale insects, spider mites, thrips, webworms and whiteflies.
- Patent #5,700,473
- Kills all accessible stages of listed insects, including eggs.
- Contact insecticide, ovicide.
- Fast acting – kills on contact
- Contains pyrethrins and canola oil botanical insecticides.
- Easy to use
- Insecticide/miticide
- NEU1161 is a contact killer for listed insect and mite pests.
- For best results, pests must be contacted directly with spray.
- Pyrol™ is a trademark of W. Neudorff GmbH KG
- Made with Pyrol™ Insecticide, a trademark of W. Neudorff GmbH KG
- Contains Pyrol™ Insecticide, a trademark of W. Neudorff GmbH KG



- May be used up to day of harvest
- May be used on edible crops up to and including day of harvest
- Can be used right up until day of harvest.
- Read Entire Container Label Before Using This Product

[The registrant may use one of these optional statements.

NOTICE TO BUYER

Seller warrants that this product conforms to the chemical description on this label and is reasonably fit for the purposes stated in the Directions for Use, subject to the inherent risks described above, when used in accordance with the Directions for Use under normal conditions. To the extent consistent with applicable law, this warranty does not extend to use of this product contrary to label directions, or under abnormal use conditions, or under conditions not reasonably foreseeable to Seller. To the extent consistent with applicable law, the Seller shall not be liable for any such use. To the extent consistent with applicable law, the Seller makes no other warranties, either expressed or implied."

OR

- Satisfaction guaranteed

OR

- Unconditionally guaranteed

OR

- Money back guarantee]

Manufactured by: W. Neudorff GmbH KG
An der Muhle 3, Postfach 1209
D-31860 Emmerthal, Germany

