



67690-3

8-3-2001

1/10

Please read instructions on reverse before completing form.

Form Approved, OMB No. 2070-0060, Approval expires 2-28-95



United States
Environmental Protection Agency
Washington, DC 20460

Registration
 Amendment
 Other

OPP Identifier Number

Application for Pesticide - Section I

1. Company/Product Number 67690-3	2. EPA Product Manager Joanne Miller	3. Proposed Classification <input checked="" type="checkbox"/> None <input type="checkbox"/> Restricted
4. Company/Product (Name) Sonar SRP	PM# 23	
5. Name and Address of Applicant (Include ZIP Code) SePRO Corporation 11550 N. Meridian Street, Suite 600 Carmel, IN 46032 <input type="checkbox"/> Check if this is a new address	6. Expedited Review. In accordance with FIFRA Section 3(c)(3)(b)(i), my product is similar or identical in composition and labeling to: EPA Reg. No. _____ Product Name _____	

Section - II

<input type="checkbox"/> Amendment - Explain below.	<input checked="" type="checkbox"/> Final printed labels in response to Agency letter dated _____
<input type="checkbox"/> Resubmission in response to Agency letter dated _____	<input type="checkbox"/> "Me Too" Application.
<input checked="" type="checkbox"/> Notification - Explain below.	<input type="checkbox"/> Other - Explain below.

NOTIFICATION

AUG 3 - 2001

Explanation: Use additional page(s) if necessary. (For section I and Section II.)

Notification to add various package sizes per PR Notice 98-10.

Section - III

1. Material This Product Will Be Packaged In:				2. Type of Container	
Child-Resistant Packaging <input type="checkbox"/> Yes <input checked="" type="checkbox"/> No	Unit Packaging <input type="checkbox"/> Yes <input checked="" type="checkbox"/> No	Water Soluble Packaging <input type="checkbox"/> Yes <input checked="" type="checkbox"/> No		<input type="checkbox"/> Metal	<input type="checkbox"/> Plastic
				<input type="checkbox"/> Glass	<input type="checkbox"/> Paper
* Certification must be submitted		If "Yes" Unit Packaging wgt.	No. per container	If "Yes" Package wgt	No. per container
3. Location of Net Contents Information <input checked="" type="checkbox"/> Label <input type="checkbox"/> Container		4. Size(s) Retail Container Various		5. Location of Label Directions <input type="checkbox"/>	
6. Manner in Which Label is Affixed to Product <input type="checkbox"/> Lithograph <input type="checkbox"/> Paper glued <input type="checkbox"/> Stenciled				<input type="checkbox"/> Other _____	

Section - IV

1. Contact Point (Complete items directly below for identification of individual to be contacted, if necessary, to process this application.)		
Name James Messina	Title Project Manager, Pesticide Registration	Telephone No. (Include Area Code) 202 293-5374
Certification I certify that the statements I have made on this form and all attachments thereto are true, accurate and complete. I acknowledge that any knowingly false or misleading statement may be punishable by fine or imprisonment or both under applicable law.		6. Date Application Received (Stamped)
2. Signature 	3. Title Novigen Sciences, Inc., Authorized Representative of SePRO Corporation	
4. Typed Name James Messina	5. Date August 2, 2001	

2/10

NOTIFICATION

AUG 3 - 2001



Sonar* SRP

CAUTION PRECAUCION

Si usted no entiende la etiqueta, busque a alguien para que se la explique a usted en detalle. (If you do not understand this label, find someone to explain it to you in detail).

Refer to inside of label booklet for additional precautionary information and Directions for Use.

Notice: Read the entire label before using. Use only according to label directions. Before buying or using this product, read "Warranty Disclaimer" and "Limitation of Remedies" inside label booklet.

In case of emergency endangering health or the environment involving this product, call INFOTRAC 1-800-535-5035.

EPA Reg. No. 67690-3

EPA Est. 39578-TX-1
SC-73-3260

A herbicide for management of aquatic vegetation in fresh water ponds, lakes, reservoirs, potable water sources, drainage canals, irrigation canals and rivers.

Active ingredient:

fluridone: 1-methyl-3-phenyl-5-[3-(trifluoromethyl)phenyl]-4(1H)-pyridinone....	5.0%
Inert ingredients.....	95.0%
Total.....	100.0%

Contains "0.05X" pounds active ingredient per "X"-pound container
["X" = net container weight]

Keep Out of Reach of Children

*Trademark of SePRO Corporation
SePRO Corporation • Camel, IN 46032, U.S.A.

Herbicide

Net Weight -

Cover

3/10

NOTES

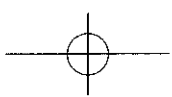
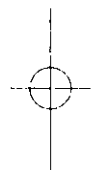
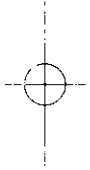

4/10

Precautionary Statements

Hazards to Humans and Domestic Animals

Keep Out of Reach of Children

CAUTION PRECAUCION

Si usted no entiende la etiqueta, busque a alguien para que se la explique a usted no detalle. (If you do not understand this label, find someone to explain it to you in detail).

Harmful if Swallowed, Absorbed Through Skin, or if Inhaled

Avoid breathing of dust or contact with skin, eyes or clothing. Wash thoroughly with soap and water after handling. Remove contaminated clothing and wash before reuse.

First Aid

If in eyes: Flush eyes with plenty of water. Get medical attention if irritation persists.

If on skin: Wash with plenty of soap and water. Get medical attention if irritation persists.

if swallowed: Call a physician or poison control center, drink one or two glasses of water and induce vomiting by touching back of throat with finger. Do not induce vomiting or give anything by mouth to an unconscious person.

If inhaled: Remove victim to fresh air. If not breathing, give artificial respiration, preferably mouth-to-mouth. Get medical attention.

Environmental Hazards

Follow use directions carefully so as to minimize adverse effects on nontarget organisms. In order to avoid impact on threatened or endangered aquatic plant or animal species, users must consult their State Fish and Game Agency or the U.S. Fish and Wildlife Service before making applications.

Do not contaminate untreated water when disposing of equipment washwaters. Trees and shrubs growing in water treated with Sonar SRP may occasionally develop chlorosis. Do not apply in tidewater/brackish water.

Lowest rates should be used in shallow areas where the water depth is considerably less than the average depth of the entire treatment site, for example, shallow shoreline areas.

Directions for Use

It is a violation of Federal Law to use this product in a manner inconsistent with its labeling.
Read all Directions Carefully Before Applying Sonar SRP.

STORAGE AND DISPOSAL

Do not contaminate water, food or feed by storage or disposal.

Storage: Store in original container only. Do not store near feed or foodstuffs. In case of leak or spill, contain material and dispose as waste.

Pesticide Disposal: Wastes resulting from use of this product may be used according to label directions or disposed of at an approved waste disposal facility.

Container Disposal: Triple rinse (or equivalent). Then offer for recycling or reconditioning, or puncture and dispose of in a sanitary landfill, or by incineration, or if allowed by State and Local authorities, by burning. If burned, stay out of smoke.

General Information

Sonar SRP herbicide is a selective systemic aquatic herbicide for management of aquatic vegetation in fresh water ponds, lakes, reservoirs, drainage canals, irrigation canals, and rivers. Sonar SRP is a pelleted formulation containing 5% fluridone. Sonar is absorbed from water by plant shoots and from hydrosol by the roots of aquatic vascular plants. It is important to maintain Sonar in contact with the target plants for as long as possible. Rapid water movement or any condition which results in rapid dilution of Sonar in treated water will reduce its effectiveness. In susceptible plants, Sonar inhibits the formation of carotene. In the absence of carotene, chlorophyll is rapidly degraded by sunlight. Herbicidal symptoms of Sonar appear in seven to ten days and appear as white (chlorotic) or pink growing points. Under optimum conditions 30 to 90 days are required before the desired level of aquatic weed management is achieved with Sonar. Species susceptibility to Sonar SRP may vary depending on time of year, stage of growth and water movement. For best results, apply Sonar SRP prior to initiation of weed growth or when weeds begin active growth. Application to mature target plants may require higher application rates and may take longer to control.

Sonar SRP is not corrosive to application equipment.

The label provides recommendations on the use of a chemical analysis for the active ingredient. SePRO Corporation recommends the use of an Enzyme-Linked Immunoassay (ELISA Test) for the determination of the active ingredient concentration in the water. Contact SePRO Corporation for the utilization of this test, known as FasTEST, for the incorporation of this analysis in your treatment program. Other proven chemical analyses for the active ingredient may also be used. The chemical analysis, FasTEST, is referenced in this label as the preferred method for the rapid determination of the concentration of the active ingredient in the water.

Application rates are provided in pounds of Sonar SRP to achieve a desired concentration of the active ingredient in part per billion (ppb). The maximum application rate or sum of all application rates is 90 ppb in ponds and 150 ppb in lakes and reservoirs per annual growth cycle. This maximum concentration is the amount of product calculated as the target application rate, NOT determined by testing the residues of the active ingredient in the treated water.

General Use Precautions

- **Obtain Required Permits:** Consult with appropriate state or local water authorities before applying this product. Permits may be required by state or local public agencies.
- **Hydroponic Farming:** Do not use Sonar SRP treated water for hydroponic farming.
- **WATER USE RESTRICTIONS FOLLOWING APPLICATIONS WITH SONAR SRP (DAYS)**

Application Rate	Drinking†	Fishing	Swimming	Livestock/Pet Consumption	Irrigation††
Maximum Rate (150 ppb) or less	0	0	0	0	7-30

† Note below, under Potable Water Intakes, the information for application of Sonar A.S. within 1/4 miles (1320) feet of a functioning potable water intake.

†† Note below, under Irrigation, the specific time frames for each water body type and crop type

• **Potable Water Intakes:** Concentrations of the active ingredient fluridone up to 150 ppb are allowed in potable water sources; however, in lakes and reservoirs or other sources of potable water, **DO NOT APPLY** Sonar SRP at application rates greater than 20 ppb within one-fourth mile (1320 feet) of any functioning potable water intake. At application rates of 8-20 ppb, Sonar SRP **MAY BE APPLIED** where functioning potable water intakes are present. **Note: Existing potable water intakes which are no longer in use, such as those replaced by connections to potable water wells or a municipal water system, are not considered to be functioning potable water intakes.**

• **Irrigation:** Irrigation with Sonar SRP treated water may result in injury to the irrigated vegetation. SePRO Corporation recommends following these precautions and informing those who irrigate from areas treated with Sonar SRP of the irrigation time frames presented in the table below. These time frames are suggestions which should be followed to reduce the potential for injury to vegetation irrigated with water treated with Sonar SRP. Greater potential for crop injury occurs where Sonar SRP treated water is applied to crops grown on low organic and sandy soils.

Application Site	Days After Application		
	Established Tree Crops	Established Row Crops/Turf/Plants	Newly Seeded Crops/Seedbeds or Areas to be Planted Including Overseeded Golf Course Greens
† Ponds and Static Canals	7	30	30
Canals	7	7	30
Rivers	7	7	7
†† Lakes and Reservoirs	7	7	7

† For purposes of Sonar SRP labeling, a pond is defined as a body of water 10 acres or less in size. A lake or reservoir is greater than 10 acres.

†† In lakes and reservoirs where one-half or greater of the body of water is treated, use the pond and static canal irrigation precautions.

Where the use of Sonar SRP treated water is desired for irrigating crops prior to the time frames established above, the use of FastEST is recommended to measure the concentration in the treated water. Where FastEST has determined that concentrations are less than 10 parts per billion, there are no irrigation precautions for irrigating

established tree crops, established row crops or turf. For tobacco, tomatoes, peppers or other plants within the Solanaceae Family and newly seeded grasses such as overseeded golf course greens, do not use Sonar SRP treated water if concentration are greater than 5 ppb.

Plant Control Information

Sonar SRP selectivity is dependent upon dosage, time of year, stage of growth, method of application, and water movement. The following categories, controlled, partially controlled, and not controlled are provided to describe expected efficacy under ideal treatment conditions using higher to maximum label rates. Use of lower rates will increase selectivity of some species listed as controlled or partially controlled. Additional aquatic plants may be controlled, partially controlled, or tolerant to Sonar SRP. Consult an aquatic specialist prior to application of Sonar SRP to determine a plant's susceptibility to Sonar SRP.

Vascular Aquatic Plants Controlled by Sonar SRP†

Submersed Plants:

- bladderwort (*Utricularia* spp.)
- common coontail (*Ceratophyllum demersum*)*
- common Elodea (*Elodea canadensis*)*
- egeria, Brazilian Elodea (*Egeria densa*)
- fanwort, Cabomba (*Cabomba caroliniana*)
- hydrilla (*Hydrilla verticillata*)
- naiad (*Najas* spp.)*
- pondweed (*Potamogeton* spp., except Illinois pondweed)*
- watermilfoil (*Myriophyllum* spp. except variable-leaf milfoil)

Shoreline Grasses:

- paragrass (*Urochloa mutica*)

†Species denoted by an asterisk are native plants that are often tolerant to Sonar at lower use rates. Please consult an aquatic specialist for recommended Sonar SRP use rates when selective control of exotic species is desired.

Vascular Aquatic Plants Partially Controlled by Sonar SRP:

Floating Plants:

- Salvinia (*Salvinia* spp.)

Emersed Plants:

- alligatorweed (*Alternanthera philoxeroides*)
- American lotus (*Nelumbo lutea*)
- cattail (*Typha* spp.)
- creeping waterprimrose (*Ludwigia peploides*)
- parrotfeather (*Myriophyllum aquaticum*)
- smartweed (*Polygonum* spp.)
- spatterdock (*Nuphar luteum*)
- spikerush (*Eleocharis* spp.)
- waterlily (*Nymphaea* spp.)
- waterpurslane (*Ludwigia palustris*)
- watershield (*Brasenia schreberi*)

Submersed Plants:

- Illinois pondweed (*Potamogeton illinoensis*)
- limnophila (*Limnophila sessiliflora*)
- tapegrass, American eelgrass (*Vallisneria americana*)
- watermilfoil—variable-leaf (*Myriophyllum heterophyllum*)

Shoreline Grasses:

- barnyardgrass (*Echinochloa crusgalli*)
- giant cutgrass (*Zizaniopsis miliacea*)
- reed canarygrass (*Phalaris arundinacea*)
- southern watergrass (*Hydrochloa carolinensis*)
- torpedograss (*Panicum repens*)

Vascular Aquatic Plants Not Controlled by Sonar SRP:

Floating Plants:

- floating waterhyacinth (*Eichhornia crassipes*)
- waterlettuce (*Pistia stratiotes*)

Emersed Plants:

- American frogbit (*Limnobium spongia*)
- arrowhead (*Sagittaria* spp.)
- bacopa (*Bacopa* spp.)
- big floatingheart, banana lily (*Nymphoides aquatica*)
- bulrush (*Scirpus* spp.)
- pickernelweed, lanceleaf (*Pontederia* spp.)
- rush (*Juncus* spp.)
- water pennywort (*Hydrocotyle* spp.)

Shoreline Grasses:

- maidencane (*Panicum hemitomon*)

Note: algae (chara, nitella, and filamentous species are not controlled by Sonar SRP)

Application Directions

The aquatic plants present in the treatment site should be identified prior to application to determine their susceptibility to Sonar SRP. It is important to determine the area (acres) to be treated and the average depth in order to select the proper application rate. Do not exceed the maximum labeled rate for a given treatment site per annual growth cycle.

Application to Ponds

Sonar SRP may be applied to the entire surface area of a pond. For single applications, rates may be selected to provide 45 to 90 ppb to the treated water, although actual concentrations in treated water may be substantially lower at any point in time due to the slow-release formulation of this product. When treating for optimum selective control, lower rates may be applied for sensitive target species. Use the higher rate within the rate range where there is a dense weed mass, when treating more difficult to control species, and for ponds less than 5 acres in size with an average depth less than 4 feet. Application rates necessary to obtain these concentrations in treated water are shown in the following table. For additional application rate calculations, refer to page 5—Application Rate Calculations-Ponds, Lakes and Reservoirs. Split or multiple applications are recommended where dilution of treated water is anticipated; however, the sum of all applications should total 45 to 90 ppb and must not exceed a total of 90 ppb per annual growth cycle.

7/10

Average Water Depth of Treatment Site (feet)	Pounds of Sonar SRP per Treated Surface Acre	
	45 ppb	90 ppb
1	2.5	5
2	5	10
3	7.5	15
4	10	20
5	12.5	25
6	15	30
7	17	34
8	19.5	39
9	22	44
10	24.5	49

Average Water Depth of Treatment Site (feet)	Pounds of Sonar SRP Per Treated Surface Acre	
	16 ppb	90 ppb
1	0.9	5
2	1.7	10
3	2.6	15
4	3.5	20
5	4.3	25
6	5.2	30
7	6.0	34
8	6.9	39
9	7.8	44
10	8.6	49
11	9.5	54
12	10.4	59
13	11.2	64
14	12.1	68
15	13.0	73
16	13.8	78
17	14.7	83
18	15.6	88
19	16.4	93
20	17.3	98

Application to Lakes and Reservoirs

The following treatments are recommended for treating both whole lakes or reservoirs and partial areas of lakes or reservoirs (bays, etc.). For best results in treating partial lakes and reservoirs, Sonar SRP treatment areas should be a minimum of 5 acres in size. Treatment of areas smaller than 5 acres or treatment of narrow strips such as boat lanes or shorelines may not produce satisfactory results due to dilution by untreated water. Rate ranges are provided as a guide to include a wide range of environmental factors, such as target species, plant susceptibility, selectivity and other aquatic plant management objectives. Application rates and methods should be selected to meet the specific lake/reservoir aquatic plant management goals.

A. Whole Lake or Reservoir Treatments (Limited or No Water Discharge)

1. Single Application to Whole Lakes or Reservoirs
 Where single applications to whole lakes or reservoirs are desired, apply Sonar SRP at an application rate of 16 to 90 ppb. Application rates necessary to obtain these concentrations in treated water are shown in the following table. For additional rate calculations, refer to page 5—Application Rate Calculation-Ponds, Lakes and Reservoirs. Choose an application rate to meet the aquatic plant management objective. **Where greater plant selectivity is desired such as when controlling Eurasian watermilfoil and curlyleaf pondweed, choose an application rate lower in the rate range.** For other plant species, SePRO recommends contacting an aquatic specialist in determining when to choose application rates lower in the rate range to meet specific plant management goals. Use the higher rate within the rate range where there is a dense weed mass or when treating more difficult to control plant species or in the event of a heavy rainfall event where dilution has occurred. In these cases, a second application or more may be required; however, the sum of all applications cannot exceed 150 ppb per annual growth cycle. Refer to the following Section (No. 2) Split or Multiple Applications for guidelines and maximum rate allowed.

2. Split or Multiple Applications to Whole Lakes or Reservoirs

To meet certain plant management objectives, split or multiple applications may be desired in making whole lake treatments. Split or multiple application programs are desirable when the objective is to use the minimum effective dose and to maintain this lower dose for the sufficient time to ensure efficacy and enhance selectivity. Under these situations, use the lower rates (16 to 75 ppb) within the rate range. **In controlling Eurasian watermilfoil and curlyleaf pondweed and where greater plant selectivity is desired, choose an application rate lower in the rate range.** For other plant species, SePRO recommends contacting an aquatic specialist in determining when to choose application rates lower in the rate range to meet specific plant management goals. For split or repeated applications, the sum of all applications must not exceed 150 ppb per annual growth cycle.

Note: In treating lakes or reservoirs that contain potable water intakes and the application requires treating within 1/4 mile of a potable water intake, no single application can exceed 20 ppb. Additionally, the sum of all applications cannot exceed 150 ppb per annual growth cycle.

B. Partial Lake or Reservoir Treatments

Where dilution of Sonar SRP with untreated water is anticipated, such as in partial lake or reservoir treatments, split or multiple applications may be used to extend the contact time to the target plants. The application rate and use frequency of Sonar SRP in a partial lake is highly dependent upon the treatment area. Higher application rates may be required and frequency of applications will vary depending upon the potential of untreated water

8/10

diluting the Sonar SRP concentration in the treatment area. Use higher rates where greater dilution with untreated water is anticipated.

1. Application Sites Greater Than 1/4 Mile from a Functioning Potable Water Intake

For single applications, apply Sonar SRP at application rates from 45 to 150 ppb. Split or multiple applications may be made, however, the sum of all applications cannot exceed 150 ppb per annual growth cycle. Split applications should be conducted to maintain a sufficient concentration in the target area for a period of 45 days or longer. The use of FasTEST is recommended to maintain the desired concentration in the target area over time.

2. Application Sites Within 1/4 Mile of a Functioning Potable Water Intake

In treatment areas that are within 1/4 mile of a potable water intake, no single application can exceed 20 ppb. When utilizing split or repeated applications of Sonar SRP for sites which contain a potable water intake, FasTEST is required to determine the actual concentration in the water. Additionally, the sum of all applications cannot exceed 150 ppb per annual growth cycle.

Application Rate Calculation - Ponds, Lakes and Reservoirs

The amount of Sonar SRP to be applied to provide the desired ppb concentration of active ingredient equivalents in treated water may be calculated as follows:

- Pounds of Sonar SRP required per treated acre = Average water depth of treatment site x Desired ppb concentration of active ingredient equivalents x 0.054

For example, the pounds per acre of Sonar SRP required to provide a concentration of 25 ppb of active ingredient equivalents in water with an average depth of 5 feet is calculated as follows:

$5 \times 25 \times 0.054 = 6.75$ pounds per treated surface acre.

Note: Calculated rates should not exceed the maximum allowable rate in pounds per treated surface acre for the water depth listed in the application rate table for the site to be treated.

Application to Drainage Canals, Irrigation Canals and Rivers

Static Canals:

In static drainage and irrigation canals, Sonar SRP should be applied at the rate of 20 to 40 pounds per surface acre.

Moving Water Canals and Rivers:

The performance of Sonar SRP will be enhanced by restricting or reducing water flow. In slow moving bodies of water use an application technique that maintains a concentration of 10 to 40 ppb in the applied area for a minimum of 45 days. Sonar SRP can be applied by split

or multiple broadcast applications or by metering in the product to provide a uniform concentration of the herbicide based upon the flow pattern. The use of FasTEST is recommended to maintain the desired concentration in the target area over time.

Static or Moving Water Canals or Rivers Containing a Functioning Potable Water Intake

In treating a static or moving water canal or river which contains a functioning potable water intake, applications of Sonar SRP greater than 20 ppb must be made more than 1/4 mile from a functioning potable water intake. Applications less than 20 ppb may be applied within 1/4 mile from a functioning potable water intake; however, if applications of Sonar SRP are made within 1/4 mile from a functioning water intake, the FasTEST must be utilized to demonstrate that concentrations do not exceed 150 ppb at the potable water intake.

Application Rate Calculation - Drainage Canals, Irrigation Canals and Rivers

The amount of Sonar SRP to be applied through a metering system to provide the desired ppb concentration of active ingredient in treated water may be calculated as follows:

1. Average flow rate (feet per second) x average width (ft.) x average depth (ft.) x 0.9 = CFS (cubic feet per second)
2. CFS x 1.98 = acre feet per day (water movement)
3. Acre feet per day x desired ppb x 0.054 = pounds Sonar SRP required per day

Conditions of Sale and Warranty Disclaimer

SePRO Corporation only warrants that the product conforms to the chemical description on the label and is reasonably fit for the purposes stated on the label when used in strict accordance with the Directions for Use. This limited warranty is provided in lieu of all other expressed or implied warranties. SePRO Corporation specifically disclaims all other warranties, expressed or implied, including but not limited to, any warranty of merchantability or fitness for a particular purpose. SePRO shall not be liable for any damages resulting from any use or handling of this product and SePRO's sole liability and user's exclusive remedy shall be limited as set forth below under the heading "Limitation of Remedies".

9/10

Limitation of Remedies

The exclusive remedy for any losses or damages resulting from this product (including claims based on contract, negligence, strict liability, or other legal theories) shall be limited to, at SePRO Corporation's election, one of the following:

- (1) Refund of purchase price paid by buyer or user for product bought, or
- (2) Replacement of amount of product used.

SePRO Corporation shall only be responsible for refund of purchase price or replacement of product upon prompt notification of any such claim in writing within thirty (30) days of occurrence. SePRO Corporation shall not be held liable for any loss or damages in connection with the handling or use of this product, including but not limited to direct or indirect consequential, individual damages or loss of profits.

No written or verbal statement or agreements can vary the terms of the above Warranty Disclaimer or this Limitation of Remedies. SePRO does not authorize any employee, agent or representative to make any other warranty, guarantee or representation concerning this product.



Sonar^{*} SRP

A herbicide for management of aquatic vegetation in fresh water ponds, lakes, reservoirs, potable water sources, drainage canals, irrigation canals and rivers.

Active ingredient:

fluridone: 1-methyl-3-phenyl-5-[3-(trifluoromethyl)phenyl]-4(1 <i>H</i>)-pyridinone	5.0%
Inert ingredients	95.0%
Total	100.0%

Contains "0.05X" pounds active ingredient per "X"-pound container
["X" = net container weight]

Precautionary Statements

Hazards to Humans and Domestic Animals

Keep Out of Reach of Children

CAUTION PRECAUCION

Si usted no entiende la etiqueta, busque a alguien para que se la explique a usted no detalle. (If you do not understand this label, find someone to explain it to you in detail).

Harmful If Swallowed, Absorbed Through Skin, Or If Inhaled

Avoid breathing of dust or contact with skin, eyes or clothing. Wash thoroughly with soap and water after handling. Wash exposed clothing before reuse.

Herbicide

First Aid

If in eyes: Flush eyes with plenty of water.

Get medical attention if irritation persists.

If on skin: Wash with plenty of soap and water.

Get medical attention if irritation persists.

If swallowed: Call a physician or poison control center, drink one or two glasses of water and induce vomiting by touching back of throat with finger. Do not induce vomiting or give anything by mouth to an unconscious person.

If inhaled: Remove victim to fresh air. If not breathing, give artificial respiration, preferably mouth-to-mouth. Get medical attention.

Environmental Hazards

Follow use directions carefully so as to minimize adverse effects on nontarget organisms. In order to avoid impact on threatened or endangered aquatic plant or animal species, users must consult their State Fish and Game Agency or the U.S. Fish and Wildlife Service before making applications.

See additional Environmental Hazards under Precautionary Statements inside label booklet.

Refer to label booklet for additional precautionary information and Directions for Use including Storage and Disposal.

Notice: Read the entire label. Use only according to label directions. **Before buying or using this product, read "Warranty Disclaimer" and "Limitation of Remedies" inside label booklet.**

In case of emergency endangering health or the environment involving this product, call Infotrac 1-800-535-5053.

EPA Reg. No. 67690-3

EPA Est. 39578-TX-1
SC-73-3260

*Trademark of SePRO Corporation
SePRO Corporation • Carmel, IN 46032, U.S.A.

Net Weight

PEEL FILM HERE

10/10