

67619-13

07-10-2007

1/8

Note: Bold, italicized text and (italicized text within parentheses) is information for the reader and is not part of the label. [Bracketed] information and phrase sequence are optional unless specified in 40 CFR 156.10. Variables such as CAPITALIZATION, plurals or singular, bold and italics are optional unless specified in 40 CFR. Listed uses and use sites can be used partially or in their entirety. Underlined text is new. Strike-through (~~text~~) means removed.

EPA Reg. No. 67619-13 CPPC Storm Page 1 of 8

ACCEPTED  
JUL 10 2007  
...fungicides, and  
...for the  
...under  
67619-13

# CPPC STORM

KEEP OUT OF REACH OF CHILDREN.

**WARNING:** Eye irritant. Use only in well ventilated areas.

SEE BACK LABEL FOR ADDITIONAL PRECAUTIONARY STATEMENTS.

Active Ingredient:  
Sodium Hypochlorite ..... 2.40%  
Other Ingredients: ..... 97.60%  
Total ..... 100.00%  
(Available Chlorine...2.28%)

NET WT \_\_\_\_\_

### PRECAUTIONARY STATEMENTS: HAZARDS TO HUMANS AND DOMESTIC ANIMALS.

**WARNING:** Causes substantial, but temporary, eye injury. Do not get in eyes or on clothing. Avoid contact with skin. Wear protective eyewear. Wash thoroughly with soap and water after handling and before eating, drinking, chewing gum, or using tobacco. Remove and wash contaminated clothing before reuse. Vapors may irritate. Use only in well ventilated areas. Avoid prolonged breathing of vapors. Not recommended for use by persons with heart conditions or chronic respiratory problems such as asthma, emphysema or obstructive lung disease.

#### FIRST AID:

**IF IN EYES:** Hold eye open and rinse slowly and gently with water for 15-20 minutes. Remove contact lenses, if present, after the first 5 minutes, then continue rinsing eyes. Call a poison control center or doctor for treatment advice. **IF ON SKIN OR CLOTHING:** Take off contaminated clothing. Rinse skin immediately with plenty of water for 15-20 minutes. Call a poison control center or doctor for treatment advice. **IF INHALED:** Move person to fresh air. If person is not breathing, call 911 or an ambulance, then give artificial respiration, preferably mouth-to-mouth if possible. **IF SWALLOWED:** Call a poison control center or doctor immediately for treatment advice. Have person sip a glassful of water if able to swallow. Do not induce vomiting unless told to do so by a poison control center or doctor. Do not give anything by mouth to an unconscious person. Call a poison control center or doctor for further treatment advice. Have the product container or label with you when calling a poison control center or doctor, or going for treatment. NOTE TO PHYSICIAN: Probable mucosal damage may contraindicate the use of gastric lavage.

**PHYSICAL AND CHEMICAL HAZARDS:** This product contains bleach. Do not use or mix this product with other chemicals such as products containing ammonia, toilet bowl cleaners, rust removers, vinegar or acid. To do so will release hazardous gases.

**STORAGE AND DISPOSAL:** Store this product in a cool [dry] area [away from direct sunlight and heat] to avoid deterioration. Do not reuse empty container. -or- Refill only with this product. Offer empty container for recycling. If recycling is not available, discard container in trash.



Clorox Customer Assistance 1-888-797-7225. Any Questions? The experts at Clorox are standing by to answer any of your questions. -or- Questions or Comments? Call [toll-free] 1-888-797-7225. Satisfaction Guaranteed! At Clorox we have prided ourselves in making consistent quality products [for over 75 -or- insert number years], and we are dedicated to ensuring your total satisfaction with our product. If you are not completely satisfied, please call the number below -or- 1-888-797-7225. For MSDS information please go to [www.cloroxprofessional.com](http://www.cloroxprofessional.com)

Contains no phosphorus.  
Mfd. for & ©2007 Clorox Professional Products Company, Oakland, CA 94612  
Commercial Solutions is a registered trademark of Clorox Professional Products Company. Clorox is a registered trademark of The Clorox Company.  
Made in the USA  
EPA Reg. No. 67619-13 EPA Est. No. 5813-CA-03, CA-4, CA-5, GA-1, OH-1, PR-1, 71106-GA-1 (Actual EPA Est. No. in code below)  
Visit us at [www.cloroxprofessional.com](http://www.cloroxprofessional.com) R0621-6.1

2/8

Note: **Bold, italicized text** and *(italicized text within parentheses)* is information for the reader and is not part of the label. [Bracketed] information and phrase sequence are optional unless specified in 40 CFR 156.10. Variables such as CAPITALIZATION, plurals or singular, bold and italics are optional unless specified in 40 CFR. Listed uses and use sites can be used partially or in their entirety. Underlined text is new. Strike-through (~~text~~) means removed.

EPA Reg. No. 67619-13 CPPC Storm Page 2 of 8

# CPPC STORM

**ACCEPTED**  
JUL 10 2007  
The Federal Insecticide, Fungicide, and  
Rodenticide Act, for the  
registered under  
67619-13

## AVOID PROLONGED BREATHING OF VAPOR

Use in well ventilated areas. Open windows and turn on fans before use. If the vapors bother you, leave the room while this product is working. For sensitive skin or prolonged use, wear gloves.

[Refill only with this product]

Alternate for Refill Bottle: To Refill (Spray Bottles):

- |   |  |  |
|---|--|--|
| <p><b>Remove</b></p> <p>1. Remove trigger sprayer -or- cap from empty bottle.</p> | <p><b>Pour</b></p> <p>2. Unscrew cap on refill and pour contents directly into empty bottle.</p> | <p><b>Use</b></p> <p>3. Replace trigger sprayer and use as you normally would.</p> |
|---|--|--|

## DIRECTIONS FOR USE

It is a violation of Federal law to use this product in a manner inconsistent with its labeling.

### DISINFECTION

To [clean and] disinfect [and deodorize] hard, nonporous surfaces: [Set trigger to SPRAY or FOAM.] Spray 6-8 inches from surface until surface is thoroughly wet. Let stand for contact time listed below -or- on label. Wipe excess. [Rinse.] Allow to air dry. Rinse with potable water for food-contact surfaces. For all others, no rinsing is required. Gross filth should be removed prior to disinfecting. [If streaking is observed, wipe with a clean, damp [cloth or] paper towel.]

Pathogen:	TB	Bacteria	+Viruses	**Bloodborne Pathogens	Parvoviruses	Mold/Mildew/Fungi
Contact Time:	1 minute	30 seconds <sup>†</sup>	1 minute	1 minute	5 minutes	5 minutes

-and/or-

### ORGANISMS:

#### Mycobacterium:

Mycobacterium bovis [(BCG)] (Tuberculosis -or- TB) [OT 105401]\*\*

#### Bacteria:

- <sup>†</sup>Acinetobacter baumannii [ATCC 15308]\*
- <sup>†</sup>Enterococcus faecalis, vancomycin resistant -or- Vancomycin resistant Enterococcus faecalis [(VRE)] [ATCC 51575]\*
- <sup>†</sup>Escherichia coli [(E. coli)] [ATCC 11229]\*
- <sup>†</sup>Legionella pneumophila [(Legionella)] [ATCC 33153]\*
- <sup>†</sup>Methicillin resistant Staphylococcus aureus [(MRSA)] [ATCC 33592]\*
- <sup>†</sup>Pseudomonas aeruginosa [(Pseudomonas)] [ATCC 15442]\*
- <sup>†</sup>Salmonella enterica -or- [Salmonella choleraesuis] [(Salmonella)] [ATCC 10708]\*
- <sup>†</sup>Shigella dysenteriae [ATCC 11835]\*
- <sup>†</sup>Staphylococcus aureus [ATCC 6538]\*
- <sup>†</sup>Streptococcus pneumoniae [(Strep)] [ATCC 6305]\*
- <sup>†</sup>Streptococcus pyogenes [(Strep)] [ATCC 12344]\*

Clostridium difficile [(Vegetative Form<sup>‡</sup>)] [ATCC 9689]\*\*

Klebsiella pneumoniae [ATCC 4352]\*\*

Listeria monocytogenes [(Listeria)] [ATCC 19117]\*\*

<sup>‡</sup> Killing the vegetative cells can help reduce the bioburden of Clostridium difficile on environmental surfaces.

#### Viruses Non-enveloped:

- <sup>†</sup> Adenovirus [type 2] [ATCC VR-846] [(Strain Adenoid 6)]\*\*
- [(common cause of respiratory infections)]
- <sup>†</sup> [Human] Hepatitis A [(Virus)] [(HAV)] [(Strain HM-175)]\*\*
- <sup>†</sup> Norovirus -or- Norwalk virus [(as Feline Calicivirus)] [ATCC VR-782]\*\*
- <sup>†</sup> Poliovirus [type 1] [ATCC VR-1000] [(Strain Brunhilde)]\*\*
- <sup>†</sup> Rhinovirus [type 37] [ATCC VR-1147] [(Strain 151-1)]\*\* [(leading) causative agent of the common cold]
- <sup>†</sup> Rotavirus [(Strain WA)]\*\* [(causative agent of viral diarrhea)]

#### Viruses Enveloped:

- <sup>†</sup> Avian Influenza A [Avian Flu] [Bird Flu] [ATCC VR-2072]\*\*
- <sup>†</sup> Herpes simplex virus [type 2] -or- [Human] Herpesvirus [type 2] [ATCC VR-734] [(Strain G)]\*\* [(causative agent of genital herpes)]
- <sup>†</sup> <sup>†</sup> HIV type 1 [(Strain HTLV-IIIB)]\*
- <sup>†</sup> [Human] Coronavirus [ATCC VR-740] [(Strain 229E)]\*\* [(additional) causative agent of the common cold]
- <sup>†</sup> <sup>†</sup> [Human] Hepatitis B [(Virus)] [(HBV)] [(as duck HBV)]\*\*
- <sup>†</sup> [Human] Hepatitis C [(Virus)] [(HCV)] [(as bovine viral diarrhea virus)]\*\*
- <sup>†</sup> [Human] Parainfluenza [virus] [type 1] [ATCC VR-907]\*\* [(Strain Sendai)]
- <sup>†</sup> Influenza A [ATCC VR-544] [(Strain Hong Kong)]\*\* [(representative of the common flu virus)]
- <sup>†</sup> Respiratory syncytial virus [(RSV)] [ATCC VR-26] [(Strain Long)]\*\* [(cause of respiratory infections in infants)]

#### Bloodborne Pathogens:

- <sup>†</sup> <sup>†</sup> HIV type 1 [Human Immunodeficiency Virus] [(Strain HTLV-IIIB)]\*
- <sup>†</sup> <sup>†</sup> [Human] Hepatitis B [(Virus)] [(HBV)] [(as duck HBV)]\*\*

#### Parvoviruses Non-enveloped:

- Canine parvovirus [ATCC VR-2017] [(Strain Cornell)]\*\*\*
- Feline parvovirus -and/or- [(Feline panleukopenia virus)] [ATCC VR-648] [(Strain Philips-Roxane)]\*\*\*

#### Mold, Mildew, Fungi:

- Aspergillus niger [(mildew)] [ATCC 16404]\*\*
- Trichophyton mentagrophytes [(Athlete's Foot Fungus)] [ATCC 26323]\*\*
- Penicillium chrysogenum [ATCC 10106]\*\*\*
- Alternaria alternata [ATCC 6663]\*\*\*
- Cladosporium herbarum [ATCC 28987]\*\*\*
- Mucor bainieri [ATCC 42642]\*\*\*

\*30 second contact time  
\*\*1 minute contact time  
\*\*\*5 minute contact time

3/8

Note: **Bold, italicized text** and (*italicized text within parentheses*) is information for the reader and is not part of the label. [Bracketed] information and phrase sequence are optional unless specified in 40 CFR 156.10. Variables such as CAPITALIZATION, plurals or singular, bold and italics are optional unless specified in 40 CFR. Listed uses and use sites can be used partially or in their entirety. Underlined text is new. Strike-through (~~) means removed.~~

EPA Reg. No. 67619-13 CPPC Storm Page 3 of 8

# CPPC STORM

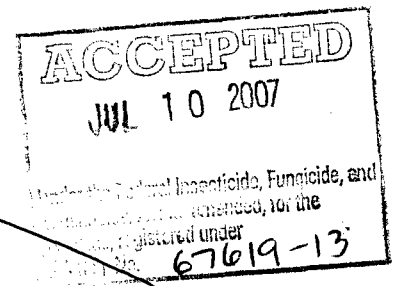

**The following is only for products with medical devices listed on the label:**

This product is not to be used as a terminal sterilant/high level disinfectant on any surface or instrument that (1) is introduced directly into the human body, either into or in contact with the bloodstream, or normally sterile areas of the body, or (2) contacts intact mucous membranes, but which does not ordinarily penetrate the blood barrier or otherwise enter normally sterile areas of the body. This product may be used to preclean or decontaminate critical or semi-critical medical devices prior to sterilization or high level disinfection.

**Special Instructions for Use Against HIV-1, HBV, and HCV**

This product kills HIV-1, HBV and HCV on precleaned environmental surfaces/objects previously soiled with blood/body fluids in health care settings or other settings in which there is an expected likelihood of soiling of inanimate surfaces/objects with blood or body fluids, and in which the surfaces/objects likely to be soiled with blood or body fluids can be associated with the potential for transmission of Human Immunodeficiency Virus (HIV-1) (associated with AIDS), Human Hepatitis B [(Virus)] (HBV) and Human Hepatitis C [(Virus)] (HCV).

**Special instructions for using this product to clean and decontaminate against HIV-1, HBV and HCV on surfaces/objects soiled with blood/body fluids:**

**Personal Protection:** When handling items soiled with blood or body fluids, use disposable impervious gloves, gowns, masks and eye coverings.

**Cleaning Procedure:** Blood and other body fluids must be thoroughly cleaned from surfaces and other objects before applying this product.

**Contact Time:** Allow surfaces to remain wet for 30 seconds. Wipe excess. [Rinse.] Allow to air dry. For all other organisms, see directions for contact times.

**Disposal of Infectious Materials:** Use disposable impervious gloves, gowns, masks and eye coverings. Blood and other body fluids should be autoclaved and disposed of according to local regulations for infectious waste disposal.

**To clean -and/or- remove stains:** [Set trigger to SPRAY or FOAM.] Spray, wait a few minutes, [rinse] and allow to air dry.

[If streaking is observed, wipe with a clean, damp [cloth or] paper towel.] [If excess foam dries on nozzle, rinse with warm water.]

**To remove mildew stains:** Turn nozzle to FOAM position. Spray 6-8 inches from surface until surface is thoroughly covered. Allow foam to deeply penetrate mildew and problem areas. Wipe with a wet sponge or cloth, and rinse. Heavy mildew buildup may require a longer contact time, or two cleanings. [If excess foam dries on nozzle, rinse with warm water.] [This product may not be able to remove soap scum and mildew embedded in hard water deposits, old grout or silicone caulking.]

**To clean soap scum:** Spray, wait a few minutes, wipe with sponge. Heavy soap scum or mildew buildup may need two cleanings. This product may not be able to remove soap scum and mildew embedded in hard water deposits, old grout or silicone caulking. [If excess foam dries on nozzle, rinse with warm water.]

**To clean and disinfect toilet bowls:** Flush toilet and add 1 cup of this product to bowl. Brush to thoroughly wet all surfaces including under rim. Let stand 5 minutes before flushing.

**Floors:** Mop washable floors including no-wax floors, linoleum, vinyl and ceramic tile with 1 cup of this product per gallon of warm water. Rinse for best shine.

Works on grout, [bath]tubs, toilets, fiberglass, shower doors, vinyl curtains, counters -or- countertops, sinks, glass, plastic, glazed ceramic tile, unglazed ceramic tile, no-wax floors, basement floors, windowsills, refrigerator seals, and under the sink. Rinse immediately after use on rubber, plastic and vinyl. [Avoid prolonged contact with metal and old porcelain as this product can react with these materials and leave a "rusty" stain.] Do not use on wood or painted surfaces unless you plan to refinish or repaint them. [This product may not be able to remove soap scum and mildew embedded in hard water deposits, old grout or silicone caulking.] Avoid contact with aluminum, clothes, fabric, carpet or paper surfaces as they will discolor.

**FARM PREMISE AND POULTRY HOUSE DISINFECTANT [INSTRUCTIONS]:**

**[Directions For Use:]**

1. Do not use in milking stalls, milking parlors, or milk houses (for phenolics, cresylic acid, and pine oils).
2. Remove all poultry or animals and feeds from premises, trucks, vehicles, coops, crates, and enclosures.
3. Remove all litter and manure or droppings from floors, walls and surfaces of barns, pens, stalls, chutes, and other facilities and fixtures occupied or traversed by animals or poultry.
4. Empty all troughs, racks, and other feeding and watering appliances.
5. Thoroughly clean all surfaces with soap or detergent and rinse with water.
6. Saturate all surfaces with the recommended disinfecting solution for a period of 10 minutes.
7. Immerse all halters, ropes, and other types of equipment used in handling and restraining animals, as well as forks, shovels, and scrapers used for removing litter and manure.
8. Ventilate buildings, cars, boats, coops, and other closed spaces. Do not house livestock or poultry or employ equipment until treatment has been absorbed, set, or dried.
9. Thoroughly scrub all treated feed racks, mangers, troughs, automatic feeders, fountains, and waterers with soap or detergent, and rinse with potable water before reuse.

4/8

Note: **Bold, italicized text** and (*italicized text within parentheses*) is information for the reader and is not part of the label. [Bracketed] information and phrase sequence are optional unless specified in 40 CFR 156.10. Variables such as CAPITALIZATION, plurals or singular, **bold** and *italics* are optional unless specified in 40 CFR. Listed uses and use sites can be used partially or in their entirety. Underlined text is new. Strike-through (~~text~~) means removed.

EPA Reg. No. 67619-13 CPPC Storm Page 4 of 8

# CPPC STORM

**ACCEPTED**  
JUL 10 2007  
Under the Federal Insecticide, Fungicide, and  
Rodenticide Act, this product is registered under  
EPA Reg. No. 67619-13

## Cleaning Claims:

- Bathrooms, sinks and faucets and floor areas
- Cleans
- [Clorox®] essential for the purest clean
- Commercial solutions
- Contains bleach
- Fresh lingering bleach scent
- Just spray and wipe; no scrubbing required!
- Leaves a fresh bleach scent
- Leaves no residue
- [New] sudsing -or- foaming action
- Plus [with] Clorox® Bleach
- Pool and outdoor areas
- Removes (*insert stain(s)/soil(s) from list below*)
- Removes stains
- [The] smell of clean

## Stains/Soils:

- Blood
- Body oils
- Coffee [stains]
- Dead skin
- Dirt
- Fecal matter
- Fingerprints
- Food residue[s] -or- soil[s]
- Fruit [stains]
- Grease
- Grime
- Laboratory stains
- Mildew stains
- Mold stains
- Other common soils -and/or- stains
- Other organic matter
- Tea [stains]
- Urine

## ALLERGEN DESTRUCTION

To [clean and] destroy specified allergens: [Set trigger to SPRAY or FOAM.] Spray, wait 1 minute, and wipe excess. [Rinse.] Allow to air dry. [If streaking is observed, wipe with a clean, damp [cloth or] paper towel.]

### Allergens:

- Cockroach matter -or- particles
- Dust mite matter -or- particles
- Pet dander -or- dog and cat dander

### Claims:

- Breaks Down Many Allergens[!]
- Destroys Many Allergens[!]
- Destroys -or- deactivates dust mite matter -or- particles, cockroach matter -or- particles, and pet dander allergens [found in dust]
- [Penetrates and] breaks down dust mite matter -or- particles, cockroach matter -or- particles, and pet dander allergens [found in dust]
- Reduces dust mite matter -or- particles, cockroach matter -or- particles, and pet dander allergens [found in dust]
- Reduces Many Allergens[!]
- This product kills germs and destroys many allergens while cleaning hard, nonporous surfaces.

## General Claims:

- Convenient
- Does not contain mercury
- Does not contain nonylphenol ethoxylates (NPEs) -and/or- alkylphenol ethoxylates (APEs)
- Does not contain VOCs
- Easy and convenient to use
- Easy to handle
- Eliminates [daily] mixing and measuring
- Foam trigger eliminates airborne particles associated with sprays
- Foam trigger helps to minimize potential overspray
- Mercury free
- No measuring
- No mixing
- Nonylphenol ethoxylate (NPE) -and/or- alkylphenol ethoxylate (APE) free
- Ready to use
- Shelf-stable formula
- Stable for one year
- [Contains] the power of Clorox Bleach [without the strong odor]
- [Visit -or- Check [out] [our website at]] [www.cloroxprofessional.com](http://www.cloroxprofessional.com) [for more information] [on Clorox®]
- VOC free

5/8

Note: **Bold, italicized text** and (*italicized text within parentheses*) is information for the reader and is not part of the label. [Bracketed] information and phrase sequence are optional unless specified in 40 CFR 156.10. Variables such as CAPITALIZATION, plurals or singular, bold and *italics* are optional unless specified in 40 CFR. Listed uses and use sites can be used partially or in their entirety. Underlined text is new. Strike-through (~~text~~) means removed.

EPA Reg. No. 67619-13 CPPC Storm Page 5 of 8

# CPPC STORM

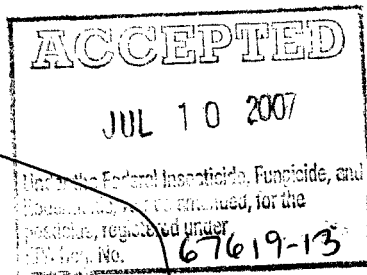

## Pesticidal/Disinfecting Claims:

- Clean[s] -and/or- disinfect[s] [the] [your] (*list any use site*) [against] [from] [99.9% of] [household] germs -and/or- bacteria -and/or- virus[es] [this season]
- Clean[s] -and/or- disinfect[s] [the] [your] (*list any use site*) [against] [from] [99.9% of] [household] bacteria
- Clean[s] away -and/or- kill[s] -and/or- eliminate[s] -and/or- disinfect[s] -and/or- destroy[s] -and/or- remove[s] -and/or- wipe[s] away -or- out -and/or- attack[s] -and/or- get[s] rid of [99.9% of] [the] [common (*list any use site*) bacteria -and/or- germs -and/or- virus[es]]
- Clean[s] away -and/or- kill[s] -and/or- eliminate[s] -and/or- disinfect[s] -and/or- destroy[s] -and/or- remove[s] -and/or- wipe[s] away -or- out -and/or- attack[s] -and/or- get[s] rid of [99.9% of] [the] bacteria -and/or- germs -and/or- virus[es] [commonly found in -or- on (*list any use site*)]
- Destroys mold and mildew in [just] 5 minutes
- Destroys mold, mildew and bacteria [in just 5 minutes]
- Disinfects as it cleans big jobs
- Disinfects as it kills [destroys] [eliminates] common household mold, mildew and bacteria
- Disinfects as it kills [destroys] [eliminates] [wipes out] [removes] mildew
- Disinfects with bleach
- [Effective] (*list any use site*) disinfectant -and/or- cleaner
- Eliminates mold and mildew in [just] 5 minutes
- Eliminates mold, mildew and bacteria [in just 5 minutes]
- Even mold isn't too tough for this product!
- Fight[s] -and/or- kill[s] -and/or- effective against [99.9% of] [*Salmonella choleraesuis*] -or- *Salmonella enterica* [(*Salmonella*)]
- Fight[s] -and/or- kill[s] -and/or- effective against [99.9% of] *Escherichia coli* [(*E. coli*)]
- Fight[s] -and/or- kill[s] -and/or- effective against Avian flu [virus] [on environmental -and/or- hard, nonporous surfaces]
- Fight[s] -and/or- kill[s] -and/or- effective against cold -and/or- flu [virus[es]]
- Fight[s] -and/or- stop[s] -and/or- prevent[s] -and/or- reduce[s] the spread of [99.9% of] [illness-causing] bacteria -and/or- viruses -and/or- germs on hard, nonporous surfaces [in your] (*list any use site*) [this cold -and/or- flu season]
- Got Mold? Kill [Destroy] [Eliminate] [Wipe out] [Remove] it with this product!
- Kills [Destroys] [Eliminates] 99.9% of household molds
- Kills [Destroys] [Eliminates] 99.9% of household molds and mildew in just 5 minutes
- Kills [Destroys] [Eliminates] and removes mold and mildew
- Kills [Destroys] [Eliminates] mildew without scrubbing
- Kills [Destroys] [Eliminates] mold and mildew
- Kills [Destroys] [Eliminates] tough mildew without scrubbing
- Kills [Destroys] [Eliminates] tough mold and mildew without scrubbing
- Kills [Destroys] [Eliminates] tough mold, mildew and bacteria in just 5 minutes
- Kills [Destroys] [Eliminates] [Wipes out] [Removes] mold, mildew and bacteria as it cleans
- Kills [Destroys] [Eliminates] [Wipes out] [Removes] visible mold
- Kills [Eliminates] and destroys mold and mildew
- Kills mold and mildew in [just] 5 minutes
- Kills mold, mildew and bacteria [in just 5 minutes]
- Kills most common household molds
- Lifts off and cleans soap scum to penetrate, kill and destroy mold, mildew and bacteria
- Mold is alive. Kill [Destroy] [Eliminate] [Wipe out] [Remove] it with this product[!]
- Penetrates to eliminate and destroy tough mold, mildew and bacteria at its source
- Penetrates to kill and destroy tough mold, mildew and bacteria at its source
- Proven to kill most common household molds[!]
- This product doesn't just clean [the] stains, it kills [destroys] [eliminates] [wipes out] [removes] [the] mold[!]
- This product kills *Staphylococcus aureus* [(*Staph*)], *Streptococcus pyogenes* [(*Strep*)], *Trichophyton mentagrophytes* [(*Athlete's Foot Fungus*)], *Aspergillus niger* [(*mildew*)], *Salmonella choleraesuis* [(*Salmonella*)], *Pseudomonas aeruginosa* [(*Pseudomonas*)], *Penicillium chrysogenum* [(*Penicillium*)], *Alternaria alternata*, *Cladosporium herbarum*, *Mucor bainieri*
- You've got mold. Kill [Destroy] [Eliminate] [Wipe out] [Remove] it with this product.

6/8

Note: **Bold, italicized text** and (*italicized text within parentheses*) is information for the reader and is not part of the label. [Bracketed] information and phrase sequence are optional unless specified in 40 CFR 156.10. Variables such as CAPITALIZATION, plurals or singular, bold and italics are optional unless specified in 40 CFR. Listed uses and use sites can be used partially or in their entirety. Underlined text is new. Strike-through (~~text~~) means removed.

EPA Reg. No. 67619-13 CPPC Storm Page 6 of 8

ACCEPTED

JUL 10 2007  
Under the Federal Insecticide, Fungicide,  
and Rodenticide Act (FIFRA), for the  
purpose, registered under  
EPA Reg. No. 67619-13

# CPPC STORM

## Pesticidal/Disinfecting Claims continued:

### For use with Formula A02:

- Attacks mildew at its roots
- Gets into and eliminates mildew even in hard-to-clean places – without scrubbing
- Kills mold and mildew at its roots
- Kills mold and mildew in hard-to-clean areas [places] [such as caulking, corners, crevices, cracks]
- Penetrates to kill and destroy tough mold, mildew and bacteria at its source
- Penetrates to kill mildew in hard-to-clean places
- [Seeks out] -and- kills mildew at its roots
- [Seeks out and] kills mildew even in hard-to-clean places
- This product has a penetrating foam that seeks out and kills mildew even in tile grout, caulking and corners
- This product penetrates deep beneath the surface
- With Deep Penetrating Foam

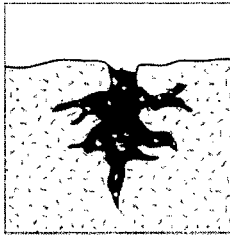

Mildew grows deep in cracks.

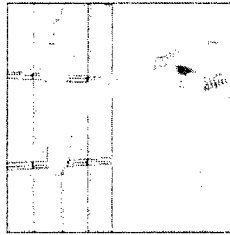

Foam penetrates deep to [kill] [get] mildew at its roots.

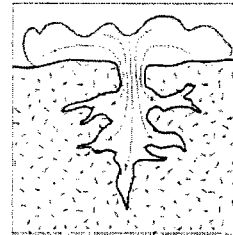

- [5 minute] broad spectrum no-rinse disinfectant for non-food contact surfaces
- A Clorox breakthrough in [medical/dental/veterinary/health care] bleach disinfection
- [A] one-step cleaner/disinfectant
- Aids in reducing -or- in the reduction of cross-contamination between treated surfaces
- Assures proper dilution strength, product effectiveness and standardizes technique
- Bactericide -or- Bactericidal
- Broad spectrum disinfectant [with Clorox® Bleach]
- [Cleans and] disinfects [hard, nonporous surfaces]
- Cleans, deodorizes and disinfects
- Deodorizes by killing the germs that cause odors
- Disinfecting formula
- Disinfects [and deodorizes]
- Disinfects and deodorizes by killing germs and their odors
- Effective against -or- Kills (*insert any organism(s) listed under the DISINFECTION section*) [in the presence of organic soil [(5% blood serum)]]
- Effective against -or- Kills a wide range of bacteria including *Staphylococcus aureus*, *Salmonella choleraesuis*, *Pseudomonas aeruginosa* [in the presence of organic soil [(5% blood serum)]]
- [Effectively] disinfects [hard, nonporous] [environmental] surfaces
- Eliminates odors [caused by germs -or- bacteria -and/or- mildew] at their source
- Eliminates -or- Reduces odors [caused by germs -or- bacteria -and/or- mildew]
- Exhibits effective virucidal activity
- Fungicide -or- Fungicidal
- Germicide -or- Germicidal
- Kills bacteria, viruses, mold, mildew
- Kills many common bacteria and viruses
- Kills odor-causing bacteria -or- germs
- Kills -or- Destroys mold and mildew
- Kills -or- Effective against bacteria
- Kills -or- Effective against germs
- Kills -or- Effective against viruses
- Meets [the disinfection requirements of] OSHA[']s Bloodborne Pathogen Guidelines -or- Standards
- Mildewcide -or- Mildewcidal
- Multi-purpose disinfectant
- Prevents -or- controls mold and mildew growth
- Pseudomonocidal
- [Ready-to-use] hospital [grade] disinfectant
- Reduces the risk of infection and cross-contamination
- Staphylocidal
- Streptocidal
- The answer to your disinfecting needs
- The easy, convenient way to clean and disinfect with Clorox Bleach
- [The] quick -and/or- easy -and/or- convenient way to disinfect
- [This product] controls the spread of germs on most hard, nonporous surfaces
- This product meets AOAC efficacy testing requirements -or- standards for hospital disinfection
- Tuberculocide -or- Tuberculocidal
- Use where control of the hazards of cross-contamination between treated surfaces is of prime importance
- Virucide -or- Virucidal

7/8

Note: **Bold, italicized text** and (*italicized text within parentheses*) is information for the reader and is not part of the label. [Bracketed] information and phrase sequence are optional unless specified in 40 CFR 156.10. Variables such as CAPITALIZATION, plurals or singular, bold and italics are optional unless specified in 40 CFR. Listed uses and use sites can be used partially or in their entirety. Underlined text is new. Strike-through (~~xxx~~) means removed.

# CPPC STORM

ACCEPTED  
JUL 10 2007  
67619-13

**Pesticidal/Disinfecting Claims continued:**

- A disinfectant for use on (*insert use site(s) from tables 1-5*)
- [Cleans and] disinfects (*insert use site(s) from tables 1-5*)
- Disinfects hard, nonporous surfaces [throughout the (*insert use site(s) from tables 1-5*)]
- Easy and convenient disinfecting [throughout the (*insert use site(s) from tables 1-5*)]

**TABLE ONE Medical:**

**USE SITES**

Ambulances -or- [Emergency Medical] Transport Vehicles  
Anesthesia Rooms or Areas  
[Assisted Living -or- Full Care] Nursing Homes  
CAT Lab[oratories]  
Central Service Areas  
Central Supply Rooms -or- Areas  
Critical Care Units -or- CCUs  
Dialysis Clinics  
Emergency Rooms -or- ERs  
Health Care Settings -or- Facilities  
Home Health Care [Settings]  
[Hospital] Kitchens  
Hospitals  
Intensive Care Units -or- ICUs  
Laboratories  
[Medical] Clinics  
Medical Facilities  
Medical -or- Physician's -or- Doctor's Offices  
Newborn -or- Neonatal Nurseries

Nursing -or- Nurses' Stations  
Orthopedics  
Outpatient Clinics  
Patient Restrooms  
Patient Rooms  
[Pediatric] Examination Rooms -or- Areas  
Pharmacies  
Physical Therapy Rooms -or- Areas  
Radiology -or- X-Ray Rooms -or- Areas  
Recovery Rooms  
Respiratory Therapy Rooms -or- Areas  
Surgery Rooms -or- Operating Rooms -or- ORs

**SURFACES**

bed pans  
[exam -or- examination] tables  
external surfaces of [medical] equipment  
-or- [medical] equipment surfaces  
external [surfaces of] ultrasound transducers  
gurneys  
hard, nonporous [environmental] hospital  
-or- medical surfaces  
[hospital -or- patient] bed railings -or- linings  
-or- frames  
IV poles  
patient chairs  
plastic mattress covers  
reception counters -or- desks -or- areas  
stretchers  
wash basins  
wheelchairs

**TABLE TWO Dental:**

**USE SITES**

Dental Operatories  
Dental -or- Dentist's Offices

**SURFACES**

dental countertops  
dental operatory surfaces  
dentist -or- dental chairs

hard, nonporous [environmental] dental surfaces  
light lens covers  
reception counters -or- desks -or- areas

**TABLE THREE Veterinary:**

**USE SITES**

Animal Housing Facilities  
Animal Life Science Laboratories  
[Animal -or- Pet] Grooming Facilities  
Kennels  
Pet Areas  
Pet Shops -or- Stores  
Small Animal Facilities  
Veterinary Clinics -or- Facilities  
Veterinary Offices  
Veterinary -or- Animal Hospitals

**SURFACES**

animal equipment  
automatic feeders  
cages  
external surfaces of [veterinary] equipment  
feed racks  
fountains  
hard, nonporous [environmental] veterinary  
surfaces  
pens  
reception counters -or- desks -or- areas  
stalls  
troughs  
veterinary care surfaces  
watering appliances

8/8

Note: **Bold, italicized text** and (*italicized text within parentheses*) is information for the reader and is not part of the label. [Bracketed] information and phrase sequence are optional unless specified in 40 CFR 156.10. Variables such as CAPITALIZATION, plurals or singular, bold and italics are optional unless specified in 40 CFR. Listed uses and use sites can be used partially or in their entirety. Underlined text is new. Strike-through (~~text~~) means removed.

# CPPC STORM

**ACCEPTED**  
JUL 10 2007  
Under the Federal Insecticide, Fungicide, and  
Rodenticide Act, this product is registered for use  
as a disinfectant.  
67619-13

**TABLE FOUR** Food Service:

**USE SITES**

- Bars
- Cafeterias
- Commercial -or- Institutional Kitchens
- Delis
- Fast Food Chains -or- Restaurants
- Food Preparation and Processing Areas
- Food [Service -or- Processing] Establishments
- Food Serving Areas
- Other Food Service Establishments
- Restaurants
- School Kitchens

**SURFACES**

- any washable (food and non-food contact) hard, nonporous inanimate surface where *disinfection is required, excluding glassware, utensils or dishes*
- appliances
- dish racks
- drainboards
- food cases
- food trays
- freezers
- hoods

- microwaves
- outdoor furniture (except cushions and wood frames)
- ovens
- refrigerators
- salad bar sneeze guards
- stoves -or- stovetops

A potable water rinse is required for food contact surfaces.  
Do not use on glassware, utensils, or dishes.

**TABLE FIVE** Miscellaneous/General:

**USE SITES**

- Airplanes
- Blood Banks
- Bowling Alleys
- Butcher Shops
- Churches
- Colleges
- Correctional Facilities
- Day Care Centers
- Dormitories
- Factories
- Funeral Homes
- Grocery Stores
- Gymnasiums -or- Gyms
- Health Club Facilities
- Hotels
- Industrial Facilities
- Laundromats
- Laundry Rooms
- Locker Rooms
- Manufacturing Plants -or- Facilities
- Military Installations
- Motels
- Produce Areas
- Public Areas
- Recreational Centers -or- Facilities
- Restrooms -or- Restroom Areas
- School Buses
- Schools
- Shelters
- Shower Rooms
- Storage Rooms -or- Areas
- Supermarkets
- Trains
- Universities

**SURFACES**

- [bathroom] fixtures
- [bath]tubs
- behind and under counters
- behind and under sinks
- booster chairs
- cabinets
- ceilings
- chairs
- [computer] monitors
- counters -or- countertops
- cribs
- desks
- [diaper -or- infant] changing tables
- diaper pails
- doorknobs
- exterior -or- external toilet surfaces
- exterior -or- external urinal surfaces
- faucets
- floors
- garbage -or- trash cans
- [grocery store -or- supermarket] carts
- hampers
- hand railings
- headsets
- highchairs
- lamps
- linoleum
- playpens
- shelves
- showers -or- shower stalls
- sinks
- stall doors
- tables
- [tiled] walls
- toilet rims
- toilet seats
- towel dispensers
- vanity tops -or- vanities

**SURFACE MATERIALS**

- [baked] enamel
- chrome
- [common] hard, nonporous [household -or- environmental] surfaces
- fiberglass
- Formica
- glass
- glazed ceramic [tile]
- glazed porcelain
- laminated surfaces
- Marlite
- plastic [laminated]
- porcelain enamel
- stainless steel
- synthetic marble
- vinyl [tile]
- similar hard, nonporous surfaces except for those excluded by the label

Not Recommended For Use On  
-or- Avoid contact with:

- aluminum
- brass
- carpet
- chipped enamel
- clear plastic
- clothes
- copper
- fabric
- natural marble
- painted surfaces
- sealed granite
- silver
- unfinished wood