

67505-3

1/28/2014

1/26



UNITED STATES ENVIRONMENTAL PROTECTION AGENCY
WASHINGTON, D.C. 20460-0001

OFFICE OF CHEMICAL SAFETY
AND POLLUTION PREVENTION

January 28, 2014

Mr. Edward Lawrence
V.P. Regulatory Affairs
Ecto Development Corporation
850 NW Pink Hill Road
Blue Springs, MO 64015-7738

**Subject: Acceptance of Amended Master Labeling; Incorporation of Various Updates
ECTO DOG FLEA AND TICK INSECTICIDE WITH IGR, EPA Reg. No. 67505-3
Your Submissions Dated March 19, 2013 & Resubmissions Dated June 6, 2013, June 13, 2013,
July 11, 2013, September 4, 2013, September 11, 2013, September 30, 2013, November 5, 2013 &
December 4, 2013, and January 8, 2014**

Dear Mr. Lawrence:

The Agency, in accordance with the Federal Insecticide, Fungicide and Rodenticide Act (FIFRA), as amended, has completed reviewing all of the information submitted with your application to support the reregistration of the referenced product in connection with the **RED for Permethrin**, and has concluded that your submission is acceptable.

PLEASE NOTE: This product is not being reregistered under sections 3(c)5 and 4(g) of FIFRA at this time.

Please note that the record for this product currently contains the accepted CSFs listed below. Any previously dated CSFs are superseded.

- Basic CSF, dated October 18, 2013
- Alternate CSF #1, dated October 18, 2013
- Alternate CSF #2, dated October 18, 2013
- Alternate CSF #3, dated October 18, 2013
- Alternate CSF #4, dated October 18, 2013

Should you wish to add/retain a reference to the company's website, smart phone/tablet app and/or a QR code reader on your product label, please be aware that the website, smart phone/tablet app and/or a QR code reader becomes labeling under FIFRA and is subject to review by the Agency. If the website, smart phone/tablet app, and/or a QR code reader is false or misleading, the product would be misbranded and unlawful to sell or distribute under section 12(a)(1)(E) of FIFRA. 40 CFR §156.10(a)(5) lists examples of statements EPA may consider false or misleading. In addition, regardless of whether a website, smart phone/tablet app, and/or a QR code reader is referenced on a product's label, claims made on the website, smart phone/tablet app, and/or a QR code reader may not be substantially differ from those claims approved through the registration process. Therefore, should the Agency find, or if it is brought to our attention that a website, smart phone/tablet app, and/or a QR code reader contains false or misleading statements or claims substantially differing from the EPA-approved registration, the website, smart phone/tablet app, and/or a QR code reader will be referred to EPA's Office of Enforcement and Compliance Assurance (OECA). As an alternative, you may refer consumers to the company's phone number or e-mail address.

As per the Agency's letter dated September 30, 2011, Ecto Development Corporation has been required to submit quarterly enhanced incident reports and quarterly sales information in doses sold for the referenced product since January 1, 2012. As the primary registrant, quarterly enhanced incident reporting and quarterly sales information must collectively include all products sold under this registration number, including all distributor products. As of the date of this letter, the Agency has not received any of the required enhanced incident reports or quarterly sales information from Ecto Development Corporation for the subject product. Your registration for the subject product is time-limited and expires on November 6, 2014. If the referenced quarterly enhanced incident reports and quarterly sales information is not submitted, the Agency will not renew the registration for this product.

A copy of your updated master label stamped "Accepted" is enclosed for your records. Please note that this letter does not supersede anything contained within the Agency's letter dated September 30, 2011 and the conditions of acceptance detailed in the Agency's letter dated November 6, 2012. If you have any questions about this label review, please contact Mr. Carmen J. Rodia, Jr. at (703) 306-0327 or via e-mail at Rodia.Carmen@epa.gov or Mr. Richard J. Gebken at (703) 305-6701 or via e-mail at Gebken.Richard@epa.gov during the hours of 9:00 A.M. to 5:30 P.M. EST.

Sincerely Yours,

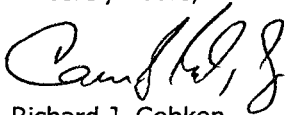
FOR

Richard J. Gebken
Product Manager (10)
Insecticide Branch
Registration Division (7504P)

Enclosure: Updated Master Label Stamped "Accepted," dated January 28, 2014
067505-00003 D413351, D471004, D472767, D476776 & D485405

3/26

[FRONT PANEL]

ECTO DOG FLEA AND TICK INSECTICIDE WITH IGR [PRODUCT NAME]
PLEASANT CITRUS SCENT
FLEA AND TICK CONTROL FOR DOGS AND PUPPIES OVER 12 WEEKS OF AGE
[Picture of dog in weight range]

"SMALL DOGS 5-15 LBS" [AND] "Use Only For Dogs between 5 & 15 lbs", [OR] "Use Only For Dogs 5 to 15 lbs."
"MEDIUM DOGS 16-33 LBS" [AND] "Use Only for Dogs between 16 & 33 lbs", [OR] "Use Only for Dogs 16 to 33 lbs."
"LARGE DOGS 34- 66 LBS" [AND] "Use Only for Dogs between 34 & 66 lbs" [OR] "Use Only for Dogs 34 to 66 lbs."
"XLARGE DOGS OVER 66 LBS" [AND] "Use Only for Dogs over 66 lbs" [OR] "Use Only for Dogs over 66 lbs."

[Only 1 of the weight ranges (listed above) per package label]

[1 Tube Pack =] "1 Month Supply" / "1 Applicator" [or] 1-pak (1 X 1.5mL)^[*]
[3 Tube Pack =] "3 Month Supply" / "3 Applicators" [or] 3-pak (3 X 1.5mL)^[*]
[4 Tube Pack =] "4 Month Supply" / "4 Applicators" [or] 4-pak (4 X 1.5 mL)^[*]
[6 Tube Pack =] "6 Month Supply" / "6 Applicators" [or] 6-pak (6 X 1.5mL)^[*]
[*] [Tube mL size dose to reflect dog size. (1.0mL small dog, 1.5mL medium dog, 3.0mL large dog, 4.5mL x-large dog)]

[Number of Applications in package - Only 1 of above descriptions per package]

ACCEPTED
January 28, 2014
Under the Federal Insecticide, Fungicide,
and Rodenticide Act, as amended, for the
pesticide registered under:
EPA Reg. No. 67505-3

DO NOT USE ON CATS – MAY BE FATAL

- BREAKS FLEA LIFE CYCLE!
- KILLS AND REPELS FLEAS UP TO 4 WEEKS!
- KILLS FLEA EGGS FOR UP TO 123 DAYS!
- PREVENTS FLEA EGGS FROM DEVELOPING INTO BITING ADULTS FOR UP TO 123 DAYS!
- KILLS AND REPELS MOSQUITOES FOR UP TO FOUR WEEKS!
- PROTECTS AGAINST MOSQUITOES UP TO 4 WEEKS!
- PROTECTS AGAINST BLOOD FEEDING BY MOSQUITOES (vector of Heart Worm) UP TO 4 WEEKS!
- KILLS AND REPELS TICKS FOR UP TO 4 WEEKS!
- KILLS AND REPELS DEER TICKS (which may carry Lyme disease) FOR UP TO 4 WEEKS!
- KILLS AND REPELS BROWN DOG TICKS (Rhipicephalus sanguineus) FOR UP TO 4 WEEKS!
- KILLS AND REPELS AMERICAN DOG TICKS (Dermacentor variabilis) FOR UP TO 4 WEEKS!
- MONTHLY APPLICATION!
- MONTHLY FLEA, TICK AND MOSQUITO TREATMENT!
- KILLS AND REPELS FLEAS AND TICKS FOR UP TO (A MONTH) [OR] (4 WEEKS)!
- KILLS AND REPELS ADULT FLEAS FOR UP TO 4 WEEKS!
- KILLS FLEA EGGS [FOR UP TO 4 MONTHS] [FOR 123 DAYS]
- KILLS AND REPELS TICKS FOR UP TO 4 WEEKS INCLUDING DEER TICKS! (which may carry Lyme disease), BROWN DOG TICKS & AMERICAN DOG TICKS!
- KILLS AND REPELS [ADULT FLEAS] FOR UP TO 4 WEEKS!

[The following "Triple Action" statements, if used, must be worded & formatted exactly as listed below]

[1] TRIPLE ACTION: Kills flea eggs for up to 4 months [OR] 123 days. Prevents flea eggs from developing into biting adults for up to 4 months [OR] 123 days. Kills and repels fleas, lice, mosquitoes & ticks for up to 4 weeks.**

**Including Brown Dog, American Dog and Deer Ticks (which may carry Lyme disease).

[2] TRIPLE ACTION: Kills and repels fleas, lice, mosquitoes & ticks for up to 4 weeks.**
Kills flea eggs for up to 4 months [OR] 123 days. Prevents flea eggs from developing into biting adults for up to 4 months [OR] 123 days.

**Including Brown Dog, American Dog and Deer Ticks (which may carry Lyme disease).

4/26

[FRONT PANEL – CON'T]

[3] TRIPLE ACTION: Kills and repels fleas, lice, mosquitoes & ticks for up to 4 weeks.** Repels mosquitoes, lice, and mites on dogs for up to 4 weeks. Prevents flea eggs from developing into biting adults for up to 4 months [OR] 123 days.

**Including Brown Dog, American Dog and Deer Ticks (which may carry Lyme disease).

[4] TRIPLE ACTION: Kills fleas, lice, mosquitoes & ticks for up to 4 weeks.** Repels mosquitoes, lice, and mites on dogs for up to 4 weeks. Prevents flea eggs from developing into biting adults for up to 4 months [OR] 123 days.

**Including Brown Dog, American Dog and Deer Ticks (which may carry Lyme disease).

[5] TRIPLE ACTION: Kills and repels fleas, lice, mosquitoes & ticks for up to 4 weeks.** Repels lice and mosquitoes on dogs for up to 4 weeks. Prevents flea eggs from developing into biting adults for up to 4 months [OR] 123 days.

**Including Brown Dog, American Dog and Deer Ticks (which may carry Lyme disease).

ACTIVE INGREDIENTS

| | |
|---|----------------------|
| * Permethrin: (CAS #52645-53-1) | 45.0 % |
| Pyriproxyfen: (CAS #95737-68-1) (Nylar**) | 5.0 % |
| OTHER INGREDIENTS | 50.0 % |
| | TOTAL 100.0 % |

* cis/trans ratio: Max 55% (+) cis and min 45% (+) trans

U.S. Patent No. 5,942,525

(Nylar**) is a Registered Trademark of McLaughlin Gormley King Company

KEEP OUT OF THE REACH OF CHILDREN

CAUTION

SEE SIDE/BACK PANEL FOR ADDITIONAL PRECAUTIONARY STATEMENTS

[OR]

SEE INSIDE FLAP [OR] FLAP / INSERT FOR ADDITIONAL PRECAUTIONARY STATEMENTS

Net Contents: 0.09 fl. oz. ("3-pak" [OR] "3 tubes" of 0.03 fl. oz. (1 mL / tube) [OR]
0.15 fl. oz. ("3-pak" [OR] "3 tubes" of 0.05 fl. oz. (1.5mL)/ tube) [OR]
0.30 fl. oz. ("3-pak" [OR] "3 tubes" of 0.10 fl. oz. (3 mL / tube) [OR]
0.45 fl. oz. ("3-pak" [OR] "3 tubes" of 0.15 fl. oz. (4.5 mL / tube)

[Note: Net Contents listed is for a 3-pak / 3 tube pack, the same format used for 1, 4, & 6 tube packs]

EPA Reg No. 67505-3 [OR] 67505-3-88966 [OR] 67505-3-2781

EPA Est. No.: 088969-IN-001 [OR] 2781-NC-1

Manufactured For: Ecto Development Corporation
Blue Springs, MO 64015
[OR Distributor & Distributing Co. Logo
(i.e. VetIQ® [or] Happy Jack®)]

[Background on all "No Cat icons & wording to be yellow]
DO NOT USE ON CATS MAY BE FATAL

Keep away from treated dogs for 24 hours.
If applied to or ingested by a cat, contact
your veterinarian immediately.



[Minimum 1.5 x 1.5 cm size for
"no cat image" on yellow background]
[No yellow package / box used]

MADE IN THE USA

ALTERNATE MARKETING CLAIMS BASED UPON ME-TOO APPLICATIONS

For use on Dogs and puppies over 12 weeks of age

- Kills, repels, and prevents re-infestation of fleas for up to 4 weeks
 - Prevents re-infestation of fleas for up to 4 weeks
 - Kills flea eggs for up to 8 weeks
 - Kills flea eggs for up to 6 weeks
 - Kills flea eggs for up to 4 weeks
 - Breaks the flea life cycle
- Kills, repels, and prevents re-infestation of ticks for up to 4 weeks
- Kills, repels mosquitoes, lice, and mites on dogs for up to 4 weeks
 - Kills and repels lice, mites and mosquitoes on dogs for up to 4 weeks
- Kills 5 different kinds of pests on dogs
- Kills five different kinds of pests on dogs
- Kills 5 different canine pests
- Kills five different canine pests
- Kills canine pests belonging to Five different orders
- Kills canine pests belonging to 5 different orders
- Seven in one Protection
- 7-in-1 Protection
- Six-in-One Protection
- 6-in-1 Protection
- Five-in-One Protection
- 5 in 1 Protection
- When applied to the dog, permethrin disperses in the pet's skin oils. Fleas become hyperactive and exhibit a "hot foot" behavior where they will scurry across the animal and then jump off and die.
- Pyriproxyfen stops the "next generation" of fleas and ticks from infecting your dog and premises.

6/26

[SIDE/BACK PANEL]

**ECTO DOG FLEA AND TICK INSECTICIDE WITH IGR [PRODUCT NAME]
FOR DOGS & PUPPIES OVER 12 WEEKS OF AGE**

**READ ENTIRE LABEL BEFORE EACH USE
USE ONLY ON DOGS OVER 12 WEEKS OF AGE [OR]
Only for Dogs (dog's weight range) and over 12 weeks of age)**

DO NOT USE ON CATS – MAY BE FATAL

[Optional Listing of Tube number and size in package]

- | |
|---|
| [1 Tube Pack =] (Dog's weight range) 1 – (size of tube in mL) Tube |
| [3 Tube Pack =] (Dog's weight range) 3 – (size of tube in mL) Tubes |
| [4 Tube Pack =] (Dog's weight range) 4 – (size of tube in mL) Tubes |
| [6 Tube Pack =] (Dog's weight range) 6 – (size of tube in mL) Tubes |

[Number of Applications in package - Only 1 of above descriptions per package]

**PRECAUTIONARY STATEMENTS
HAZARDS TO HUMANS AND DOMESTIC ANIMALS
CAUTION**

Hazards to Humans: Harmful if swallowed or absorbed through the skin. Avoid contact with skin, eyes or clothing. Causes moderate eye irritation. Wash thoroughly with soap and water after handling and before eating, drinking, chewing gum, using tobacco, or using the toilet. Remove and wash contaminated clothing before reuse.

Hazards to Domestic Animals: FOR EXTERNAL USE ON DOGS ONLY. Do not use on puppies under 12 weeks of age. Consult a veterinarian before using this product on debilitated, aged, medicated, pregnant, or nursing dogs. Consult a veterinarian before using on dogs with known organ dysfunction. **DO NOT USE ON CATS** or animals other than dogs. Cats which actively groom or engage in close physical contact with treated dogs may be at risk of serious harmful effect. Keep cats away from treated dogs for 24 hours. If applied to or ingested by a cat, contact your veterinarian immediately. Certain medications can interact with pesticides. It is advisable to consult a veterinarian before using this product with ANY other pesticide or drug.

Adverse Reactions: Some dogs may be sensitive to ingredients in this product. Adverse reactions in dogs may include skin sensitivity, lethargy, increased pruritus (itchiness), erythema (redness), rash and hair discoloration or hair loss at the application site. Observe the dog following treatment. Sensitivity may occur after using ANY pesticide product for pets. If signs of sensitivity occur, bathe your dog with a mild soap and rinse with large amounts of water. If signs continue, consult a veterinarian immediately. Keep cats away from treated dogs for 24 hours. Adverse reactions in cats could include neurological effects such as inactivity, tremors, and convulsions. If applied to or ingested by a cat, contact your veterinarian immediately.

FIRST AID

-
- If Swallowed** - Call a poison control center or doctor immediately for treatment advice.
 - Have person sip a glass of water if able to swallow.
 - Do not induce vomiting unless told to do so by a poison control center or doctor.
 - Do not give anything by mouth to an unconscious person.
- If in Eyes** - Hold eyes open and rinse slowly and gently with water for 15–20 minutes.
 - Remove contact lenses, if present, after the first 5 minutes, then continue rinsing eyes.
 - Call a poison control center or doctor for treatment advice.
- If on Skin or Clothing:**
 - Take off contaminated clothing. Rinse skin immediately with plenty of water for 15-20 minutes. Call a poison control center or doctor immediately for treatment advice.

7/26

[SIDE / BACK PANEL (CON'T)]

HOT LINE NUMBER

Have the product container or label with you when calling a poison control center or doctor, or going for treatment. For additional information on this pesticide product (including health concerns, medical emergencies, or pesticide concerns), you may call 1-8XX-XXX-XXXX, twenty-four (24) hours per day, seven (7) days per week.

For consumer questions call: 1-8XX-XXX-XXXX

ENVIRONMENTAL HAZARDS

This product is extremely toxic to fish. Do not add directly to water. Do not contaminate water when disposing of product or packaging.

DIRECTIONS FOR USE

It is a violation of Federal law to use this product in a manner inconsistent with its labeling.

USE RESTRICTIONS:

DO NOT USE ON CATS OR KITTENS - MAY BE FATAL
USE ONLY ON DOGS OR PUPPIES 12 WEEKS OF AGE OR OLDER.
DO NOT ALLOW CHILDREN TO APPLY THIS PRODUCT.
Do not apply to dogs/puppies weighing less than 5 lbs. [for smallest size dog package only].
Do not use more than one tube per dog/puppy and do not retreat more than once per month.
Do not get the dog's eyes or mouth and do not allow your dog/puppy to ingest this product.

HOW TO APPLY:

[Only one of following descriptions per label, based upon dog size.]

[Dogs 5 to 15 lbs]

Use Only For Dogs Between 5 -[&] 15 lbs: (1.0 mL applicator tubes) Apply one tube (1.0 mL) of product solution as a spot or stripe to the dog's back between the shoulder blades. Do not use on dogs less than 5 pounds. [Used with separately listed statement #8 below]

[OR (Alternate language – for combining “how to apply” and “how to open” tube type)]

Use Only For Dogs 5 -[to] 15 lbs: (1.0 mL applicator tubes) [Insert wording for tube type used – options listed below, #1 through #7] Apply one tube (1.0 mL) of product solution as a spot to the skin at three different locations along the dog's back between the shoulder blades and base of the tail. Do not use on dogs less than 5 pounds. Squeeze tube to apply all of the solution to the dog's skin.

[Dogs 16 to 33 lbs]

Use Only for Dogs Between 16 & 33 lbs: (1.5 mL applicator tubes) Apply one tube (1.5 mL) of product solution as a spot to the skin at three different locations along the dog's back between the shoulder blades and base of the tail. [Used with separately listed statement #8 below]

[OR (Alternate language – for combining “how to apply” and “how to open” tube type)]

Use Only for Dogs 16 -[to] 33 lbs: (1.5 mL applicator tubes) [Insert wording for tube type used – options listed below, #1 through #7] Apply one tube (1.5 mL) of product solution as a spot to the skin at three different locations along the dog's back between the shoulder blades and base of the tail. Squeeze tube to apply all of the solution to the dog's skin.

8/26

[SIDE / BACK PANEL (CON'T)]

DIRECTIONS FOR USE (Continued)

[Dogs 34 to 66 lbs]

[Use Only for Dogs Between 34 & 66 lbs: (3 mL applicator tubes) Apply approximately half of the tube (1.5 mL) of product solution as a spot or stripe to the dog's back between the shoulder blades and apply the rest of the tube's contents (1.5 mL) as a spot or stripe to the dog's back directly in front of the base of the tail. [Used with separately listed statement #8 below] **[OR]**

[(3 mL applicator tube) Apply the entire tube (3.0 mL) as a continuous stripe on the dog's back starting between the shoulder blades and ending directly in front of the base of the tail. [Used with separately listed statement #8 below]

[OR (Alternate language – for combining “how to apply” and “how to open” tube type)]

Use Only for Dogs 34 -[to] 66 lbs: [(3 mL applicator tubes) [Insert wording for tube type used – options listed below, #1 through #7] Apply approximately half of the tube (1.5 mL) of product solution as a spot or stripe to the skin on the dog's back between the shoulder blades and apply the rest of the tube's contents (1.5 mL) as a spot or stripe to the skin on the dog's back directly in front of the base of the tail. Squeeze tube to apply all of the solution to the dog's skin. **[OR]**

[(3 mL applicator tube) [Insert wording for tube type used – options listed below, #1 through #7] Apply the entire tube (3.0 mL) as a spot to the skin at three or more different locations along the dog's back between the shoulder blades and base of the tail. Squeeze tube to apply all of the solution to the dog's skin.

[Dogs over 66 lbs.]

Use Only for Dogs Over 66 lbs: (4.5 mL applicator tubes) Apply approximately half of the tube (2.25 mL) of product solution as a spot or stripe to the dog's back between the shoulder blades and apply the rest of the tube's contents (2.25 mL) as a spot or stripe to the dog's back directly in front of the base of the tail. **DO NOT USE MORE THAN A 4.5 mL DOSE REGARDLESS OF DOG SIZE.** [Used with separately listed statement #8 below] **[OR]**

(4.5 mL applicator tubes) Apply the entire tube (4.5 mL) as a continuous stripe on the dog's back starting between the shoulder blades and ending directly in front of the base of the tail. **DO NOT USE MORE THAN A 4.5 mL DOSE REGARDLESS OF DOG SIZE.** [Used with separately listed statement #8 below]

[OR (Alternate language – for combining “how to apply” and “how to open” tube type)]

[Use Only for Dogs Over 66 lbs: (4.5 mL applicator tubes) [Insert wording for tube type used – options listed below, #1 through #7] Apply approximately half of the tube (2.25 mL) of product solution as a spot or stripe to the skin on the dog's back between the shoulder blades and apply the rest of the tube's contents (2.25 mL) as a spot or stripe to the skin on the dog's back directly in front of the base of the tail. **DO NOT USE MORE THAN A 4.5 mL DOSE REGARDLESS OF DOG SIZE.**] Squeeze tube to apply all of the solution to the dog's skin. **[OR]**

[(4.5 mL applicator tubes) [Insert wording for tube type used – options listed below, #1 through #7] Apply the entire tube (4.5 mL) as a spot to the skin at three or more different locations along the dog's back between the shoulder blades and base of the tail. **DO NOT USE MORE THAN A 4.5 mL DOSE REGARDLESS OF DOG SIZE.** Squeeze tube to apply all of the solution to the dog's skin.

SIDE / BACK PANEL (CON'T)

DIRECTIONS FOR USE (Continued)

[Wording for insertion above, based upon packaging tube type]

[1] [FOR TWIST TUBES]: Remove product from package. Holding tube upright, twist off cap. Invert tube over dog and use open end to part dog's hair.

[2] [FOR RATCHET TUBES]: Remove product tube from package. Holding tube upright, pull off cap. Turn the cap around and place opposite end of cap back on tube. Twist cap to break seal, remove cap from tube. Invert tube over dog and use open end to part dog's hair.

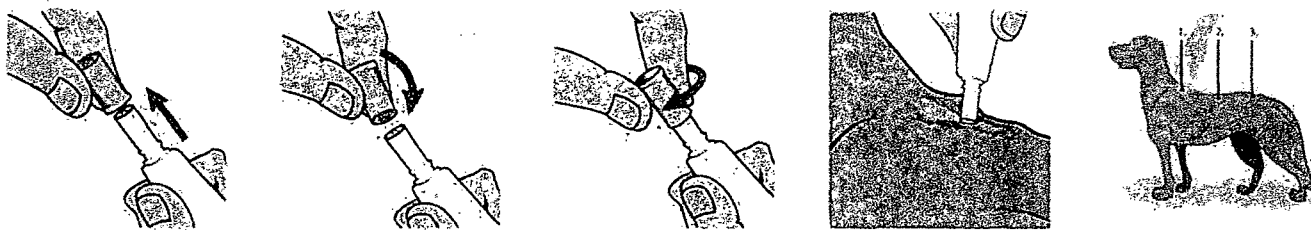

[Pictorial for Ratchet Tubes / Drawing of how to apply]

[3] [FOR TUBES IN BLISTER CARD]: Remove product tube from package. Holding tube with the notched end pointing up and away from face and body, snap or cut off narrow end at notches. Invert tube over dog and use open end to part dog's hair.

[4] [FOR FLAT CARD UNIT-DOSE PACKAGING]: Separate cards along the perforated line. Holding separated card by its wide end with narrow end pointed up and away from face and body, cut along dotted line. Invert card over dog and use narrow end of the card to part dog's hair.

[5] [FOR FLAT CARD UNIT DOSE PACKAGING]: [For push pin type applicator] Remove one product tube from the card. With cap end pointed up and away from face and body, depress cap to pierce tube end. Carefully remove cap and invert tube over dog, with tube close to dog's skin.

[6] [FOR FOLDING CARD OR TABBED CARD UNIT-DOSE PACKAGING]: Remove product tab by tearing along perforation. Holding tab with tube end pointed up and away from face and body, cut along dotted line. Invert tab over dog and use narrow end of the card to part dog's hair.

[7] [BLISTER CARD WITH TRI-LAYER TUBES]: Remove product tube(s) from package. Fold along perforation between tubes and tear off one tube. {Return unused tubes to package} Holding tube with notched end pointing up and away from face and body, snap off narrow end at notches. Invert tube over dog and use open end to part dog's hair.

[8] FOR PERFORATED 3-PAK TUBE STRIPS WITH BREAKAWAY TABS ON EACH TUBE: Separate one tube at a time from the 3-pak strip. Holding tube upright and away from face and body, snap the tip of the tube open. Invert tube over dog and use open end to part dog's hair.

_ FOR DROPPER BOTTLE MULTI-DOSE PACKAGING: Insert dropper tube into insecticide solution, squeeze bulb and then release to fill tube barrel to 1.0 mL (1.5mL) (3.0 mL) (4.5 mL) line. Position dropper tube end in the dog's hair next to skin and squeeze bulb to apply all of the solution to the dog's skin as indicated for dog's size.

10/26

SIDE / BACK PANEL (CON'T)

DIRECTIONS FOR USE (Continued)

ECTO DOG FLEA AND TICK INSECTICIDE WITH IGR [PRODUCT NAME] is an effective and easy to use product. Treating your dog with this product prevents flea eggs from developing into biting adults for up to [4 months] 123 days. As with all flea and tick control products, this product should be used as part of a program aimed at reducing flea populations in the dog's environment (bedding, carpets, kennel, yard). Consult your veterinarian, for program recommendations.

STORAGE AND DISPOSAL

Do not contaminate water, food, or feed by storage and disposal.

Pesticide Storage: Store this product in a cool, dry (preferably locked) place away from heat and open flame, in an area inaccessible to children and animals. Protect from freezing.

Pesticide Disposal: Non-refillable container. If empty: Do not reuse or refill this container. Place in trash or offer for recycling if available. If partly filled: Call your local solid waste agency for disposal instructions. Never place unused product down any indoor or outdoor drain.

NOTICE OF WARRANTY

NOTE: Seller warrants this product complies with the specifications expressed in this label. To the extent consistent with applicable law, Seller makes no other warranties and disclaims all other warranties, express or implied, including but not limited to warranties of merchantability and fitness for the intended purpose. To the extent consistent with applicable law, Sellers liability or default, breach, or failure under this label shall be limited to the amount of the purchase price. To the extent consistent with applicable law, Seller shall have no liability for consequential damages.

SEE INSIDE FLAP AND INSERT FOR ADDITIONAL PRECAUTIONARY STATEMENTS

**KEEP OUT OF THE REACH OF CHILDREN
CAUTION**

U.S. Patent No. 5,942,525 (Nylar**) is a Registered Trademark of McLaughlin Gormley King Company

Manufactured For: Ecto Development Corp.
Blue Springs, MO 64015
[OR Distributor, Address, & Distributing Co. Logo
(i.e. VetIQ® [or] Happy Jack®)]

EPA Reg. No.: 67505-3 [OR]
67505-3-88966 [OR] 67505-3-2781

EPA Est. No.: 088969-IN-001 [OR] 2781-NC-1

LOT NO: _____ MADE IN USA
[Background on all "No Cat icons & wording to be yellow]

DO NOT USE ON CATS MAY BE FATAL
Keep away from treated dogs for 24 hours.
If applied to or ingested by a cat, contact your veterinarian immediately.



[Minimum 1.5 x 1.5 cm size for no cat image" on yellow background]
[No yellow package / box used]

11/26

[OPTIONAL INSIDE FLAP – Contains information not located on SIDE/BACK panel or duplication of information]

ECTO DOG FLEA AND TICK INSECTICIDE WITH IGR [PRODUCT NAME]

**READ ENTIRE LABEL BEFORE EACH USE
USE ONLY ON DOGS OVER 12 WEEKS OF AGE**

DO NOT USE ON CATS – MAY BE FATAL

**PRECAUTIONARY STATEMENTS
HAZARDS TO HUMANS AND DOMESTIC ANIMALS
CAUTION**

Hazards to Humans: Harmful if swallowed or absorbed through the skin. Avoid contact with skin, eyes or clothing. Causes moderate eye irritation. Wash thoroughly with soap and water after handling and before eating, drinking, chewing gum, using tobacco, or using the toilet. Remove and wash contaminated clothing before reuse.

Hazards to Domestic Animals: FOR EXTERNAL USE ON DOGS ONLY. Do not use on puppies under 12 weeks of age. Consult a veterinarian before using this product on debilitated, aged, medicated, pregnant, or nursing dogs. Consult a veterinarian before using on dogs with known organ dysfunction. **DO NOT USE ON CATS** or animals other than dogs. Cats which actively groom or engage in close physical contact with treated dogs may be at risk of serious harmful effect. Keep cats away from treated dogs for 24 hours. If applied to or ingested by a cat, contact your veterinarian immediately. Certain medications can interact with pesticides. It is advisable to consult a veterinarian before using this product with ANY other pesticide or drug.

Adverse Reactions: Some dogs may be sensitive to ingredients in this product. Adverse reactions in dogs may include skin sensitivity, lethargy, increased pruritus (itchiness), erythema (redness), rash and hair discoloration or hair loss at the application site. Observe the dog following treatment. Sensitivity may occur after using ANY pesticide product for pets. If signs of sensitivity occur, bathe your dog with a mild soap and rinse with large amounts of water. If signs continue, consult a veterinarian immediately. Keep cats away from treated dogs for 24 hours. Adverse reactions in cats could include neurological effects such as inactivity, tremors, and convulsions. If applied to or ingested by a cat, contact your veterinarian immediately.

FIRST AID

-
- If Swallowed** - Call a poison control center or doctor immediately for treatment advice.
 - Have person sip a glass of water if able to swallow.
 - Do not induce vomiting unless told to do so by a poison control center or doctor.
 - Do not give anything by mouth to an unconscious person.
 - If in Eyes** - Hold eyes open and rinse slowly and gently with water for 15–20 minutes.
 - Remove contact lenses, if present, after the first 5 minutes, then continue rinsing eyes.
 - Call a poison control center or doctor for treatment advice.
 - If on Skin or Clothing:**
 - Take off contaminated clothing. Rinse skin immediately with plenty of water for 15-20 minutes. Call a poison control center or doctor immediately for treatment advice.

HOT LINE NUMBER

Have the product container or label with you when calling a poison control center or doctor, or going for treatment. For additional information on this pesticide product (including health concerns, medical emergencies, or pesticide concerns), you may call 1-8XX-XXX-XXXX, twenty-four (24) hours per day, seven (7) days per week.

12/26

[OPTIONAL INSIDE FLAP (CON'T)]

ENVIRONMENTAL HAZARDS

This product is extremely toxic to fish. Do not add directly to water. Do not contaminate water when disposing of product or packaging.

STORAGE AND DISPOSAL

Do not contaminate water, food, or feed by storage and disposal.

Pesticide Storage: Store this product in a cool, dry (preferably locked) place that is away from heat and open flame, in an area inaccessible to children and animals. Protect from freezing.

Pesticide Disposal: Non-refillable container. If empty: Do not reuse or refill this container. Place in trash or offer for recycling if available. If partly filled: Call your local solid waste agency for disposal instructions. Never place unused product down any indoor or outdoor drain.

SIDE EFFECTS

Monitor your dog after application. Side effects may include signs of skin irritation such as redness, scratching, or other signs of discomfort. Gastrointestinal signs such as vomiting or diarrhea have also been reported. If these or other side effects occur, consult your veterinarian or call 1-8XX-XXX-XXX

**KEEP OUT OF THE REACH OF CHILDREN
CAUTION**

For consumer questions call 1-8XX-XXX-XXXX

SEE INSERT FOR ADDITIONAL PRECAUTIONARY STATEMENTS

[Background on all "No Cat icons & wording to be yellow]

DO NOT USE ON CATS MAY BE FATAL
Keep away from treated dogs for 24 hours.
If applied to or ingested by a cat, contact your veterinarian immediately.



[Minimum 1.5 x 1.5 cm size for
"no cat image" on yellow background]
[No yellow package / box used]

13/
26

[OPTIONAL: PRODUCT INSERT #1 (for inclusion with product tubes)]

ECTO DOG FLEA AND TICK INSECTICIDE WITH IGR [Product Name]

READ ENTIRE LABEL BEFORE EACH USE

USE ONLY FOR DOGS "5 TO 15 LBS" [OR "16 TO 33 LBS", "34 TO 66 LBS" OR "OVER 66 LBS", depending on dog's size] and OVER 12 WEEKS OF AGE

KEEP OUT OF THE REACH OF CHILDREN

CAUTION

ACTIVE INGREDIENTS

| | |
|---|----------------|
| * Permethrin: (CAS #52645-53-1) | 45.0 % |
| Pyriproxyfen: (CAS #95737-68-1) (Nylar**) | 5.0 % |
| Other Ingredients | <u>50.0 %</u> |
| TOTAL | 100.0 % |

* cis/trans ratio: Max 55% (+) cis and min 45% (+) trans

U.S. Patent No. 5,942,525

(Nylar**) is a Registered Trademark of McLaughlin Gormley King Company

- MONTHLY FLEA, TICK AND MOSQUITO TREATMENT!
- BREAKS FLEA LIFE CYCLE!
- PREVENTS FLEA EGGS FROM DEVELOPING INTO BITING ADULTS FOR UP TO 123 DAYS!
- KILLS FLEA EGGS [FOR UP TO 4 MONTHS] [FOR 123 DAYS]
- KILLS AND REPELS TICKS FOR UP TO 4 WEEKS INCLUDING DEER TICKS! (which may carry Lyme disease), BROWN DOG TICKS & AMERICAN DOG TICKS!
- KILLS AND REPELS MOSQUITOES!

[Product Name] **ECTO DOG FLEA AND TICK INSECTICIDE WITH IGR** is an effective and easy to use product. Treating your dog with this product prevents flea eggs from developing into biting adults for up to [4 months] 123 days. As with all flea and tick control products, this product should be used as part of a program aimed at reducing flea populations in the dog's environment (bedding, carpets, kennel, yard). Consult your veterinarian, for program recommendations

DIRECTIONS FOR USE

It is a violation of Federal law to use this product in a manner inconsistent with its labeling.

USE RESTRICTIONS:

- DO NOT USE ON CATS OR KITTENS- MAY BE FATAL
- USE ONLY ON DOGS OR PUPPIES 12 WEEKS OF AGE OR OLDER.
- DO NOT ALLOW CHILDREN TO APPLY THIS PRODUCT
- Do not apply to dogs/puppies weighing less than 5 lbs. [for smallest size dog package only]
- Do not use more than one tube per dog/puppy and do not retreat more than once per month.
- Do not get into the dog's eyes or mouth and do not allow your dog/puppy to ingest this product.

HOW TO APPLY:

[Only one of following descriptions per label, based upon dog size.]

[Dogs 5 to 15 lbs]

Use Only For Dogs Between 5 -[&] 15 lbs: (1.0 mL applicator tubes) Apply one tube (1.0 mL) of product solution as a spot or stripe to the dog's back between the shoulder blades. Do not use on dogs less than 5 pounds. [Used with separately listed statement #8 below]

14/
26

[OPTIONAL: PRODUCT INSERT #1 CON'T (for inclusion with product tubes)]

[OR (Alternate language – for combining “how to apply” and “how to open” tube type)]

Use Only For Dogs 5 -[to] 15 lbs: (1.0 mL applicator tubes) [Insert wording for tube type used – options listed below, #1 through #7] Apply one tube (1.0 mL) of product solution as a spot to the skin at three different locations along the dog’s back between the shoulder blades and base of the tail. Do not use on dogs less than 5 pounds. Squeeze tube to apply all of the solution to the dog's skin.

[Dogs 16 to 33 lbs]

Use Only for Dogs Between 16 & 33 lbs: (1.5 mL applicator tubes) Apply one tube (1.5 mL) of product solution as a spot to the skin at three different locations along the dog’s back between the shoulder blades and base of the tail. [Used with separately listed statement #8 below]

[OR (Alternate language – for combining “how to apply” and “how to open” tube type)]

Use Only for Dogs 16 -[to] 33 lbs: (1.5 mL applicator tubes) [Insert wording for tube type used – options listed below, #1 through #7] Apply one tube (1.5 mL) of product solution as a spot to the skin at three different locations along the dog’s back between the shoulder blades and base of the tail.] Squeeze tube to apply all of the solution to the dog's skin.

[Dogs 34 to 66 lbs]

Use Only for Dogs Between 34 & 66 lbs: (3 mL applicator tubes) Apply approximately half of the tube (1.5 mL) of product solution as a spot or stripe to the dog’s back between the shoulder blades and apply the rest of the tube’s contents (1.5 mL) as a spot or stripe to the dog’s back directly in front of the base of the tail. [Used with separately listed statement #8 below] [OR]

[(3 mL applicator tube) Apply the entire tube (3.0 mL) as a continuous stripe on the dog’s back starting between the shoulder blades and ending directly in front of the base of the tail. [Used with separately listed statement #8 below]

[OR (Alternate language – for combining “how to apply” and “how to open” tube type)]

Use Only for Dogs 34 -[to] 66 lbs: [(3 mL applicator tubes) [Insert wording for tube type used – options listed below, #1 through #7] Apply approximately half of the tube (1.5 mL) of product solution as a spot or stripe to the skin on the dog’s back between the shoulder blades and apply the rest of the tube’s contents (1.5 mL) as a spot or stripe to the skin on the dog’s back directly in front of the base of the tail. Squeeze tube to apply all of the solution to the dog’s skin. [OR]

(3 mL applicator tube) [Insert wording for tube type used – options listed below, #1 through #7] Apply the entire tube (3.0 mL) as a spot to the skin at three or more different locations along the dog’s back between the shoulder blades and base of the tail. Squeeze tube to apply all of the solution to the dog's skin.

[Dogs over 66 lbs.]

Use Only for Dogs Over 66 lbs: (4.5 mL applicator tubes) Apply approximately half of the tube (2.25 mL) of product solution as a spot or stripe to the dog’s back between the shoulder blades and apply the rest of the tube’s contents (2.25 mL) as a spot or stripe to the dog’s back directly in front of the base of the tail. DO NOT USE MORE THAN A 4.5 mL DOSE REGARDLESS OF DOG SIZE. [Used with separately listed statement #8 below] [OR]

(4.5 mL applicator tubes) Apply the entire tube (4.5 mL) as a continuous stripe on the dog’s back starting between the shoulder blades and ending directly in front of the base of the tail. DO NOT USE MORE THAN A 4.5 mL DOSE REGARDLESS OF DOG SIZE. [Used with separately listed statement #8 below]

15/26

[OPTIONAL: PRODUCT INSERT #1 CON'T (for inclusion with product tubes)]

[OR (Alternate language – for combining “how to apply” and “how to open” tube type)]

[Use Only for Dogs Over 66 lbs: (4.5 mL applicator tubes) [Insert wording for tube type used – options listed below, #1 through #7] Apply approximately half of the tube (2.25 mL) of product solution as a spot or stripe to the skin on the dog’s back between the shoulder blades and apply the rest of the tube’s contents (2.25 mL) as a spot or stripe to the skin on the dog’s back directly in front of the base of the tail. DO NOT USE MORE THAN A 4.5 mL DOSE REGARDLESS OF DOG SIZE.] Squeeze tube to apply all of the solution to the dog’s skin. [OR]

(4.5 mL applicator tubes) [Insert wording for tube type used – options listed below, #1 through #7] Apply the entire tube (4.5 mL) as a spot to the skin at three or more different locations along the dog’s back between the shoulder blades and base of the tail. DO NOT USE MORE THAN A 4.5 mL DOSE REGARDLESS OF DOG SIZE. Squeeze tube to apply all of the solution to the dog’s skin.

[Wording for insertion above, based upon packaging tube type]

[1] [FOR TWIST TUBES]: Remove product from package. Holding tube upright, twist off cap. Invert tube over dog and use open end to part dog’s hair

[2] [FOR RATCHET TUBES]: Remove product tube from package. Holding tube upright, pull off cap. Turn the cap around and place opposite end of cap back on tube. Twist cap to break seal, remove cap from tube. Invert tube over dog and use open end to part dog’s hair.

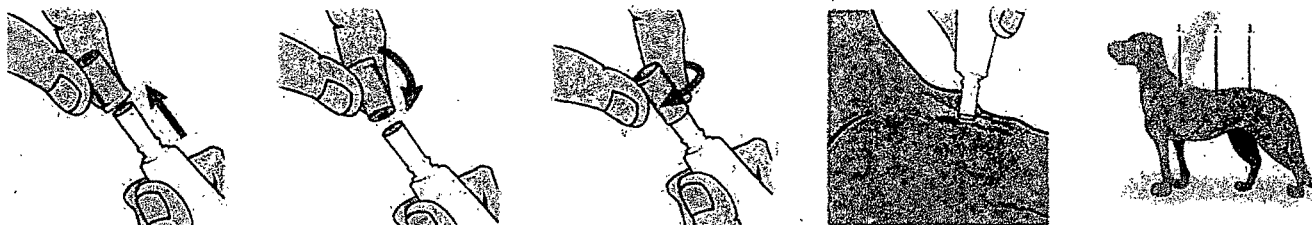

[Pictorial for Ratchet Tubes/ Drawing of how to apply]

[3] [FOR TUBES IN BLISTER CARD]: Remove product tube from package. Holding tube with the notched end pointing up and away from face and body, snap or cut off narrow end at notches. Invert tube over dog and use open end to part dog’s hair.

[4] [FOR FLAT CARD UNIT-DOSE PACKAGING]: Separate cards along the perforated line. Holding separated card by its wide end with narrow end pointed up and away from face and body, cut along dotted line. Invert card over dog and use narrow end of the card to part dog’s hair.

[5] [FOR FLAT CARD UNIT DOSE PACKAGING]: [For push pin type applicator] Remove one product tube from the card. With cap end pointed up and away from face and body, depress cap to pierce tube end. Carefully remove cap and invert tube over dog, with tube close to dog’s skin-

[6] [FOR FOLDING CARD OR TABBED CARD UNIT-DOSE PACKAGING]: Remove product tab by tearing along perforation. Holding tab with tube end pointed up and away from face and body, cut along dotted line. Invert tab over dog and use narrow end of the card to part dog’s hair.

[7] [BLISTER CARD WITH TRI-LAYER TUBES]: Remove product tube(s) from package. Fold along perforation between tubes and tear off one tube. {Return unused tubes to package} Holding tube with notched end pointing up and away from face and body, snap off narrow end at notches. Invert tube over dog and use open end to part dog’s hair.

[8] FOR PERFORATED 3-PAK TUBE STRIPS WITH BREAKAWAY TABS ON EACH TUBE: Separate one tube at a time from the 3-pak strip. Holding tube upright and away from face and body, snap the tip of the tube open. Invert tube over dog and use open end to part dog’s hair. Squeeze tube firmly to apply all of the solution to the dog’s skin.

16 / 26

[OPTIONAL: PRODUCT INSERT #1 CON'T (for inclusion with product tubes)]

STORAGE AND DISPOSAL

Do not contaminate water, food, or feed by storage and disposal.

Pesticide Storage: Store this product in a cool, dry (preferably locked) place away from heat and open flame, in an area inaccessible to children and animals. Protect from freezing.

Pesticide Disposal: Non-refillable container. If empty: Do not reuse or refill this container. Place in trash or offer for recycling if available. If partly filled: Call your local solid waste agency for disposal instructions. Never place unused product down any indoor or outdoor drain.

PRECAUTIONARY STATEMENTS

HAZARDS TO HUMANS AND DOMESTIC ANIMALS

CAUTION

Hazards to Humans: Harmful if swallowed or absorbed through the skin. Avoid contact with skin, eyes or clothing. Causes moderate eye irritation. Wash thoroughly with soap and water after handling and before eating, drinking, chewing gum, using tobacco, or using the toilet. Remove and wash contaminated clothing before reuse.

Hazards to Domestic Animals: FOR EXTERNAL USE ON DOGS ONLY. Do not use on puppies under 12 weeks of age. Consult a veterinarian before using this product on debilitated, aged, medicated, pregnant, or nursing dogs. Consult a veterinarian before using on dogs with known organ dysfunction. **DO NOT USE ON CATS** or animals other than dogs. Cats which actively groom or engage in close physical contact with treated dogs may be at risk of serious harmful effect. Keep cats away from treated dogs for 24 hours. If applied to or ingested by a cat, contact your veterinarian immediately. Certain medications can interact with pesticides. It is advisable to consult a veterinarian before using this product with ANY other pesticide or drug.

[Background on all "No Cat icons & wording to be yellow]

DO NOT USE ON CATS MAY BE FATAL
Keep away from treated dogs for 24 hours.
If applied to or ingested by a cat, contact your veterinarian immediately.



[Minimum 1.5 x 1.5 cm size for "no cat image" on yellow background]
[No yellow package / box used]

FIRST AID

- If Swallowed**
- Call a poison control center or doctor immediately for treatment advice.
 - Have person sip a glass of water if able to swallow.
 - Do not induce vomiting unless told to do so by a poison control center or doctor.
 - Do not give anything by mouth to an unconscious person.

- If in Eyes**
- Hold eyes open and rinse slowly and gently with water for 15–20 minutes.
 - Remove contact lenses, if present, after the first 5 minutes, then continue rinsing eyes.
 - Call a poison control center or doctor for treatment advice.

- If on Skin or Clothing:**
- Take off contaminated clothing. Rinse skin immediately with plenty of water for 15-20 minutes. Call a poison control center or doctor immediately for treatment advice

HOT LINE NUMBER

Have the product container or label with you when calling a poison control center or doctor, or going for treatment. For additional information on this pesticide product (including health concerns, medical emergencies, or pesticide concerns), you may call 1-8XX-XXX-XXXX, twenty-four (24) hours per day, seven (7) days per week.

17/
26

[OPTIONAL: PRODUCT INSERT #1 CON'T (for inclusion with product tubes)]

Adverse Reactions: Some dogs may be sensitive to ingredients in this product. Adverse reactions in dogs may include skin sensitivity, lethargy, increased pruritus (itchiness), erythema (redness), rash and hair discoloration or hair loss at the application site. Observe the dog following treatment. Sensitivity may occur after using ANY pesticide product for pets. If signs of sensitivity occur, bathe your dog with a mild soap and rinse with large amounts of water. If signs continue, consult a veterinarian immediately. Keep cats away from treated dogs for 24 hours. Adverse reactions in cats could include neurological effects such as inactivity, tremors, and convulsions. If applied to or ingested by a cat, contact your veterinarian immediately.

ENVIRONMENTAL HAZARDS

This product is extremely toxic to fish. Do not add directly to water. Do not contaminate water when disposing of product or packaging.

NOTICE OF WARRANTY

Note: Seller warrants this product complies with the specifications expressed in this label. To the extent consistent with applicable law, Seller makes no other warranties and disclaims all other warranties, express or implied, including but not limited to warranties of merchantability and fitness for the intended purpose. To the extent consistent with applicable law, Sellers liability or default, breach, or failure under this label shall be limited to the amount of the purchase price. To the extent consistent with applicable law, Seller shall have no liability for consequential damages.

SIDE EFFECTS

Monitor your dog after application. Side effects may include signs of skin irritation such as redness, scratching, or other signs of discomfort. Gastrointestinal signs such as vomiting or diarrhea have also been reported. If these or other side effects occur, consult your veterinarian or call 1-8XX-XXX-XXX

For consumer questions call 1-8XX-XXX-XXXX

Manufactured For: Ecto Development Corporation [OR Distributor]
Blue Springs, MO 64015

EPA Reg. No.: 67505-3

[Background on all "No Cat icons & wording to be yellow]
DO NOT USE ON CATS MAY BE FATAL
Keep away from treated dogs for 24 hours.
If applied to or ingested by a cat, contact
your veterinarian immediately.



[Minimum 1.5 x 1.5 cm size for
"no cat image" on yellow background]
[No yellow package / box used]

18/
26

[OPTIONAL: PRODUCT INSERT – Monthly Reminder (for inclusion with product tubes)]

[Printed on approximately 3'x4" peel off paper, located inside package – not visible from outside]

[Product Name] **ECTO DOG FLEA AND TICK INSECTICIDE WITH IGR**

Use these calendar stickers to remind you when your dog is due for it's next monthly application.

[Background on all "No Cat icons & wording to be yellow]

DO NOT USE ON CATS MAY BE FATAL
Keep away from treated dogs for 24 hours.
If applied to or ingested by a cat, contact
your veterinarian immediately.



[Minimum 1.5 x 1.5 cm size for
"no cat image" on yellow background]
[No yellow package / box used]

Monthly Sticker
Do Not Use on Cats

Month 1

Monthly Sticker
Do Not Use on Cats

Month 2

Monthly Sticker
Do Not Use on Cats

Month 3

Monthly Sticker
Do Not Use on Cats

Month 4

[Number of sticker dependent upon tube content of package]

19/
26

[OPTIONAL: PRODUCT INSERT #2 (for inclusion with product tubes)]

ECTO DOG FLEA AND TICK INSECTICIDE WITH IGR [Product Name]
(size of tube in mL) for Dogs that weigh (Dog's weight range)

**KEEP OUT OF THE REACH OF CHILDREN
CAUTION**

ACTIVE INGREDIENTS

| | |
|---|----------------------|
| * Permethrin: (CAS #52645-53-1) | 45.0 % |
| Pyriproxyfen: (CAS #95737-68-1) (Nylar**) | 5.0 % |
| OTHER INGREDIENTS | 50.0 % |
| | TOTAL 100.0 % |

* cis/trans ratio: Max 55% (+) cis and min 45% (+) trans

U.S. Patent No. 5,942,525

(Nylar**) is a Registered Trademark of McLaughlin Gormley King Company

- Kills and repels ticks for up to 4 weeks!
- Prevents re-infestation of fleas for up to 4 weeks
- Kills flea eggs for up to 4 months
- Kills and repels lice, mites and mosquitoes on dogs for up to 4 weeks

DIRECTIONS FOR USE

It is a violation of Federal law to use this product in a manner inconsistent with its labeling.

USE RESTRICTIONS:

DO NOT USE ON CATS OR KITTENS- MAY BE FATAL

USE ONLY ON DOGS OR PUPPIES 12 WEEKS OF AGE OR OLDER.

DO NOT ALLOW CHILDREN TO APPLY THIS PRODUCT

Do not apply to dogs/puppies weighing less than 5 lbs (for smallest size dog package only)

Do not use more than one tube per dog/puppy and do not retreat more than once per month.

Do not get in the dog's eyes or mouth and do not allow your dog/puppy to ingest this product.

[Only one of following descriptions per label, based upon dog size.]

[Dogs 5 to 15 lbs]

Use Only For Dogs Between 5 -[&] 15 lbs:

(1.0 mL applicator tubes)

Apply one tube (1.0 mL) of product solution as a spot or stripe to the dog's back between the shoulder blades. Do not use on dogs less than 5 pounds. [Used with separately listed statement #8 below]

[Dogs 16 to 33 lbs]

Use Only for Dogs Between 16 & 33 lbs:

(1.5 mL applicator tubes)

Apply one tube (1.5 mL) of product solution as a spot to the skin at three different locations along the dog's back between the shoulder blades and base of the tail. [Used with separately listed statement #8 below]

[OPTIONAL: PRODUCT INSERT #2 - CON'T (for inclusion with product tubes)]

[Dogs 34 to 66 lbs]

Use Only for Dogs Between 34 & 66 lbs:

(3 mL applicator tubes)

Apply approximately half of the tube (1.5 mL) of product solution as a spot or stripe to the dog's back between the shoulder blades and apply the rest of the tube's contents (1.5 mL) as a spot or stripe to the dog's back directly in front of the base of the tail. [Used with separately listed statement #8 below]

[OR]

Apply the entire tube (3.0 mL) as a continuous stripe on the dog's back starting between the shoulder blades and ending directly in front of the base of the tail. [Used with separately listed statement #8 below]

[Dogs over 66 lbs.]

Use Only for Dogs Over 66 lbs:

(4.5 mL applicator tubes)

Apply approximately half of the tube (2.25 mL) of product solution as a spot or stripe to the dog's back between the shoulder blades and apply the rest of the tube's contents (2.25 mL) as a spot or stripe to the dog's back directly in front of the base of the tail. **DO NOT USE MORE THAN A 4.5 mL DOSE REGARDLESS OF DOG SIZE.** [Used with separately listed statement #8 below]

[OR]

Apply the entire tube (4.5 mL) as a continuous stripe on the dog's back starting between the shoulder blades and ending directly in front of the base of the tail. **DO NOT USE MORE THAN A 4.5 mL DOSE REGARDLESS OF DOG SIZE.** [Used with separately listed statement #8 below]

HOW TO APPLY:

FOR PERFORATED 3-PAK TUBE STRIPS WITH BREAKAWAY TABS ON EACH TUBE: Separate one tube at a time from the 3-pak perforated strip. Holding tube upright and away from face and body, snap the tip of the tube open. Invert tube over dog and use open end to part dog's hair. Squeeze tube firmly to apply all of the solution to the dog's skin.

[Pictorial / Drawing of how to apply]

ECTO DOG FLEA AND TICK INSECTICIDE WITH IGR [PRODUCT NAME] is an effective and easy to use product. -Treating your dog with this product prevents flea eggs from developing into biting adults for up to [4 months] 123 days. As with all flea and tick control products, this product should be used as part of a program aimed at reducing flea populations in the dog's environment (bedding, carpets, kennel, yard). Consult your veterinarian, for program recommendations.

SIDE EFFECTS

Monitor your dog after application. Side effects may include signs of skin irritation such as redness, scratching, or other signs of discomfort. Gastrointestinal signs such as vomiting or diarrhea have also been reported. If these or other side effects occur, consult your veterinarian or call 1-8XX- XXX-XXX

21/
26

[OPTIONAL: PRODUCT INSERT #2 - CON'T (for inclusion with product tubes)]

**PRECAUTIONARY STATEMENTS
HAZARDS TO HUMANS AND DOMESTIC ANIMALS
CAUTION**

Hazards to Humans: Harmful if swallowed or absorbed through the skin. Avoid contact with skin, eyes or clothing. Causes moderate eye irritation. Wash thoroughly with soap and water after handling and before eating, drinking, chewing gum, using tobacco, or using the toilet. Remove and wash contaminated clothing before reuse.

Hazards to Domestic Animals: FOR EXTERNAL USE ON DOGS ONLY. Do not use on puppies under 12 weeks of age. Consult a veterinarian before using this product on debilitated, aged, medicated, pregnant, or nursing dogs. Consult a veterinarian before using on dogs with known organ dysfunction. **DO NOT USE ON CATS** or animals other than dogs. Cats which actively groom or engage in close physical contact with treated dogs may be at risk of serious harmful effect. Keep cats away from treated dogs for 24 hours. If applied to or ingested by a cat, contact your veterinarian immediately. Certain medications can interact with pesticides. It is advisable to consult a veterinarian before using this product with ANY other pesticide or drug.

FIRST AID

- If Swallowed**
 - Call a poison control center or doctor immediately for treatment advice.
 - Have person sip a glass of water if able to swallow.
 - Do not induce vomiting unless told to do so by a poison control center or doctor.
 - Do not give anything by mouth to an unconscious person.
- If in Eyes**
 - Hold eyes open and rinse slowly and gently with water for 15–20 minutes.
 - Remove contact lenses, if present, after the first 5 minutes, then continue rinsing eyes.
 - Call a poison control center or doctor for treatment advice.
- If on Skin or Clothing:**
 - Take off contaminated clothing. Rinse skin immediately with plenty of water for 15-20 minutes. Call a poison control center or doctor immediately for treatment advice

HOT LINE NUMBER

Have the product container or label with you when calling a poison control center or doctor, or going for treatment. For additional information on this pesticide product (including health concerns, medical emergencies, or pesticide concerns), you may call 1-8XX-XXX-XXXX, twenty-four (24) hours per day, seven (7) days per week.

Adverse Reactions: Some dogs may be sensitive to ingredients in this product. Adverse reactions in dogs may include skin sensitivity, lethargy, increased pruritus (itchiness), erythema (redness), rash and hair discoloration or hair loss at the application site. Observe the dog following treatment. Sensitivity may occur after using ANY pesticide product for pets. If signs of sensitivity occur, bathe your dog with a mild soap and rinse with large amounts of water. If signs continue, consult a veterinarian immediately. Keep cats away from treated dogs for 24 hours. Adverse reactions in cats could include neurological effects such as inactivity, tremors, and convulsions. If applied to or ingested by a cat, contact your veterinarian immediately.

22/
26

[OPTIONAL: PRODUCT INSERT #2 - CON'T (for inclusion with product tubes)]

ENVIRONMENTAL HAZARDS

This product is extremely toxic to fish. Do not add directly to water. Do not contaminate water when disposing of product or packaging.

STORAGE AND DISPOSAL

Do not contaminate water, food, or feed by storage and disposal.

Pesticide Storage: Store this product in a cool, dry (preferably locked) place away from heat and open flame, in an area inaccessible to children and animals. Protect from freezing.

Pesticide Disposal: Non-refillable container. If empty: Do not reuse or refill this container. Place in trash or offer for recycling if available. If partly filled: Call your local solid waste agency for disposal instructions. Never place unused product down any indoor or outdoor drain.

NOTICE OF WARRANTY

Note: Seller warrants this product complies with the specifications expressed in this label. To the extent consistent with applicable law, Seller makes no other warranties and disclaims all other warranties, express or implied, including but not limited to warranties of merchantability and fitness for the intended purpose. To the extent consistent with applicable law, Sellers liability or default, breach, or failure under this label shall be limited to the amount of the purchase price. To the extent consistent with applicable law, Seller shall have no liability for consequential damages.

For consumer questions call 1-8XX-XXX-XXXX

Manufactured For: Ecto Development Corporation [OR Distributor]
Blue Springs, MO 64015

EPA Reg. No.: 67505-3 [OR] 67505-3-271

EPA Est. No.: 2781-NC-1

[Background on all "No Cat icons & wording to be yellow]

DO NOT USE ON CATS MAY BE FATAL
Keep away from treated dogs for 24 hours.
If applied to or ingested by a cat, contact
your veterinarian immediately.



[Minimum 1.5 x 1.5 cm size for
"no cat image" on yellow background]
[No yellow package / box used]

23/26

TUBE LABEL [Folding card and flat card packaging designs]

ECTO DOG FLEA AND TICK INSECTICIDE WITH IGR [PRODUCT NAME]

PERMETHRIN 45%
PYRIPROXYFEN 5%

**KEEP OUT OF REACH OF CHILDREN
CAUTION**

[CAT ICON IN CIRCLE WITH SLASH THROUGH IT LOCATED ON TUBE]

[Background on all "No Cat icons & wording to be yellow]

DO NOT USE ON CATS MAY BE FATAL
Keep away from treated dogs for 24 hours.
If applied to or ingested by a cat, contact
your veterinarian immediately.



[Minimum 1.5 x 1.5 cm size for
"no cat image" on yellow background]
[No yellow package / box used]

READ DIRECTIONS AND PRECAUTIONS BEFORE USING

[ONE OF THE FOLLOWING TEXTS PER TUBE OR VIAL – SEE ATTACHMENT A]

Only for Dogs 5 to 15 lbs.
and over 12 weeks of age.

Only for Dogs 16 to 33 lbs,
and over 12 weeks of age.

Only for Dogs 34 to 66 lbs.
and over 12 weeks of age.

Only for Dogs over 66 lbs.
and over 12 weeks of age

EPA Reg No. 67505-3 [OR] 67505-3-88966 [OR] 67505-3-2781

EPA Est. No. 088969-IN-001 [OR] 2781-NC-1

Lot No. _____

24/
26

TAB LABEL [Folding card and tabbed card packaging designs]

ECTO DOG FLEA AND TICK INSECTICIDE WITH IGR [PRODUCT NAME]

ACTIVE INGREDIENTS

| | |
|---|----------------|
| * Permethrin: (CAS #52645-53-1) | 45.0 % |
| Pyriproxyfen: (CAS #95737-68-1) (Nylar**) | 5.0 % |
| OTHER INGREDIENTS | 50.0 % |
| TOTAL | 100.0 % |

* cis/trans ratio: Max 55% (+) cis and min 45% (+) trans

U.S. Patent No. 5,942,525
(Nylar**) is a Registered Trademark of McLaughlin Gormley King Company

**KEEP OUT OF REACH OF CHILDREN
CAUTION**

[Background on all "No Cat icons & wording to be yellow]

DO NOT USE ON CATS MAY BE FATAL
Keep away from treated dogs for 24 hours.
If applied to or ingested by a cat, contact
your veterinarian immediately.



[Minimum 1.5 x 1.5 cm size for
"no cat image" on yellow background]
[No yellow package / box used]

SEE MAIN LABEL FOR ADDITIONAL
PRECAUTIONS AND INSTRUCTIONS FOR USE.

[ONE OF THE FOLLOWING TEXTS PER TAB – SEE ATTACHMENT A]

Only for Dogs 5 to 15 lbs.
and over 12 weeks of age.

Only for Dogs 16 to 33 lbs,
and over 12 weeks of age.

Only for Dogs 34 to 66 lbs.
and over 12 weeks of age.

Only for Dogs over 66 lbs.
and over 12 weeks of age

EPA Reg No. 67505-3 [OR] 67505-3-88966 [OR] 67505-3-2781

EPA Est. No. 088969-IN-001 [OR] 2781-NC-1

Lot No. _____

OUTER BOX LABEL (Contains the following labeling plus full product label)

ECTO DOG FLEA & TICK INSECTICIDE WITH IGR [PRODUCT NAME]

NYLAR™ inhibits development of the mature stages of the flea for up to 4 months preventing them from reaching the biting adult stage.

(Nylar) Registered Trademark of McLaughlin Gormley King Company

PICTURE OF THE FLEA LIFE CYCLE HERE

As part of a complete flea control program, use a suitable outdoor yard spray. Indoors, use, a suitable carpet spray / powder and clean dog bedding and premises

4 STEPS FOR COMPLETE FLEA CONTROL

Consult your veterinarian prior to using this product with ANY other pesticide or drug.

Step 1 – Shampoo or dip your dog.

Step 2 – Treat indoor and outdoor premises with indoor and outdoor sprays, foggers and powders.

Step 3 – Apply Ecto Dog Flea and Tick Insecticide with IGR [PRODUCT NAME] for up to four weeks of adult flea and tick control.

Step 4 – Maintenance treatments with on-animal sprays and powders.

[Background on all "No Cat icons & wording to be yellow]

DO NOT USE ON CATS MAY BE FATAL
Keep away from treated dogs for 24 hours.
If applied to or ingested by a cat, contact your veterinarian immediately.



[Minimum 1.5 x 1.5 cm size for "no cat image" on yellow background]
[No yellow package / box used]

ATTACHMENT A

VIEW OF APPLICATOR VIAL / TUBE LABELING [OR IMMEDIATE CONTAINER LABELING]

[PRODUCT NAME]

**Only For Dogs 5 to 15 lbs.
and over 12 weeks of age.**

**KEEP OUT OF REACH OF CHILDREN
CAUTION**

EPA Reg. No.: 67505-3 [OR] 67505-3-88966 [OR] 67505-3-2781

READ DIRECTIONS AND PRECAUTIONS BEFORE USING

[Black print for text & "No Cat Icon" / yellow background under icon & associated wording]

DO NOT USE ON CATS MAY BE FATAL
Keep away from treated dogs for 24 hours.
If applied to or ingested by a cat, contact
your veterinarian immediately.



[ONE OF THE FOLLOWING TEXTS PER VIAL / TUBE OR IMMEDIATE CONTAINER LABELING]

Only for Dogs 5 to 15 lbs.
and over 12 weeks of age.

Only for Dogs 16 to 33 lbs,
and over 12 weeks of age.

Only for Dogs 34 to 66 lbs.
and over 12 weeks of age.

Only for Dogs over 66 lbs.
and over 12 weeks of age