

**UNITED STATES ENVIRONMENTAL PROTECTION AGENCY**

WASHINGTON, D.C. 20460

OFFICE OF
CHEMICAL SAFETY
AND POLLUTION PREVENTION

November 06, 2012

Mr. Edward Lawrence
Ecto Development Corporation
850 NW Pink Hill Road
Blue Springs, MO 64015

Subject: Application for Pesticide Amendment
Ecto Dog Flea and Tick Insecticide with IGR
EPA Reg. No. 67505-3
Your Submission Dated June 14, 2012
Decision No: 466287

Dear Mr. Lawrence:

The labeling referred to above, submitted in connection with registration under the Federal Insecticide, Fungicide, and Rodenticide Act, as amended, is acceptable subject to the conditions of registration and label comments below. Two (2) copies of the finished labeling must be submitted prior to releasing the product for shipment. A stamped copy of the label is enclosed for your records.

Conditions of acceptance

1. This registration is now time-limited and expires two years from the date of this letter.
2. Please consider limiting the formulations of this product to one basic confidential statement of formula. The Agency may require this in the future and no additional alternate formulations or minor formulation amendments will be approved for this product in the future.
3. You must submit quarterly enhanced incident reports and quarterly sales information in doses sold for this product beginning January 1, 2012.

Please flag any Confidential Business Information as such. Enhanced incident reporting should be submitted to the Product Manager. Quarterly sales information should be submitted to the Registration Division, Immediate Office (attn: Kaitlon Keller).

The following is a list of information that must be included in the quarterly reports for each incident:

EPA Registration Number

Product name (brand name)

Lot #

Where purchased: internet, store, veterinarian

Active Ingredient(s)

Weight range for product

Date on which incident occurred. (mm/dd/yyyy)

State in which the incident occurred. (standard 2 letter abbreviation)

Registrant case #

Species: dog, cat, other (specify)

Breed: (as reported by pet owner)

Age: months or years

Sex: M, F, or neutered

Weight: pounds

Primary Route of Exposure: dermal, oral, other animal, inhalation, other

Body System: neurological, dermatological, GI, respiratory, ocular, other

Major signs noted with separate column for each sign, using standard terminology

Time to Onset: (hours, days)

Treated by veterinarian: yes or no

First time product used: yes or no

Misuse: use on incorrect species, overdose, too frequent dosing, other (describe)

Any known precondition

EPA Severity Code: death, major, moderate, minor

Outcome: died, recovered, still treated, unknown

4. Along with the enhanced incident reporting, you must submit an analysis of the incidents seen, to include the following details:

- All incidents should be reported including all minor dermal and ocular irritation reports.
- Summary table for dogs showing number of incidents of each severity code for each route of exposure. Each incident should only be reported once. If one incident has several routes of exposure, the order should be ocular > oral > dermal. In other words, an incident with both oral and dermal exposure would be reported as oral exposure, and an incident with both ocular and oral exposure would be reported as ocular exposure.
- A similar summary table for cats (misuse or secondary exposure) showing number of incidents of each severity code for each route of exposure.

- Summary table for dogs and table for cats showing number of incidents that are believed due to secondary exposure (e.g., multi-pet households).
- A summary table for dogs showing number of incidents for each severity code for these age ranges: <3 months, 3-6 months, 6-9 months, 9-12 months, 1 yr, 2 yr, 3 yr, 4 yr, 5 yr, 6 yr, 7 yr, 8 yr, 9 yr, 10 yr, 11 yr, 12 yr, 13 yr, 14 yr, 15 yr, >15 yr.
- A summary table showing the number of dog incidents for each severity code for each pet weight range on the product label.
- A summary table for dog weight showing number of incidents for each product weight range. This table should show number of incidents in dogs weighing less than that product weight range, number of incidents in dogs in lower half of weight range, number of incidents in dogs in upper half of weight range, and dogs weighing more than the product weight range.
- Table showing number of incidents for each dog breed.
- Table showing number of incidents in dogs for each clinical sign.
- Table showing number of incidents in dogs for each organ system.

Report aggregate incidents, but do not combine moderate and minor incidents.

If EPA determines that future mitigation measures are necessary for all spot-on products, the Agency will inform registrants and if needed, EPA may take regulatory action. If you have any questions contact Driss Benmhend at 703-308-9525 or by e-mail at: Benmhend.driss@epa.gov.

Sincerely,

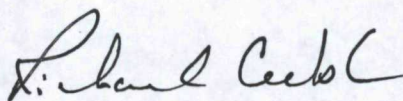

Richard Gebken
Product Manager 10,
Insecticide Branch
Registration Division (7505P)

Enclosure: Label stamped "Accepted"

4/14

[FRONT PANEL]
ECTO DOG FLEA AND TICK INSECTICIDE WITH IGR
PLEASANT CITRUS SCENT
FLEA AND TICK CONTROL FOR DOGS AND PUPPIES OVER 12 WEEKS OF AGE

[Picture of dog in weight range]

[Use Only For Dogs between 5 & 15 lbs. [OR] Use Only For Dogs 5 to 15 lbs.]
[Use Only for Dogs between 16 & 33 lbs. [OR] Use Only for Dogs 16 to 33 lbs.]
[Use Only for Dogs between 34 & 66 lbs. [OR] Use Only for Dogs 34 to 66 lbs.]
[Use Only for Dogs over 66 lbs.]

[Only 1 of above descriptions per package label]

DO NOT USE ON CATS – MAY BE FATAL

**ACCEPTED
With COMMENTS
In EPA Letter Dated:**

NOV 06 2012
Under the Federal Insecticide, Fungicide
and Rodenticide Act, As amended, for the
pesticide registered under EPA Reg. No:

67505-3

- BREAKS FLEA LIFE CYCLE!
- KILLS AND REPELS FLEAS UP TO 4 WEEKS!
- KILLS FLEA EGGS AND LARVAE FOR UP TO 123 DAYS!
- PREVENTS FLEA EGGS FROM DEVELOPING INTO BITING ADULTS FOR UP TO 4 WEEKS!
- KILLS AND REPELS MOSQUITOES!
- PROTECTS AGAINST MOSQUITOES UP TO 4 WEEKS!
- KILLS AND REPELS TICKS FOR UP TO 4 WEEKS!
- KILLS AND REPELS DEER TICKS (which may carry Lyme disease) FOR UP TO 4 WEEKS!
- KILLS AND REPELS BROWN DOG TICKS (*Rhipicephalus sanguineus*) FOR UP TO 4 WEEKS!
- KILLS AND REPELS AMERICAN DOG TICKS (*Dermacentor variabilis*) FOR UP TO 4 WEEKS!
- MONTHLY APPLICATION!
- MONTHLY FLEA, TICK AND MOSQUITO TREATMENT!
- KILLS AND REPELS FLEAS AND TICKS FOR UP TO A MONTH!
- KILLS AND REPELS ADULT FLEAS FOR UP TO 4 WEEKS!
- KILLS FLEA EGGS AND LARVAE [FOR UP TO 4 MONTHS] [FOR 123 DAYS]
- KILLS AND REPELS TICKS FOR UP TO 4 WEEKS INCLUDING DEER TICKS! (which may carry Lyme disease), BROWN DOG TICKS & AMERICAN DOG TICKS!
- KILLS AND REPELS [ADULT FLEAS] FOR UP TO 4 WEEKS!

ACTIVE INGREDIENTS

* Permethrin: (CAS #52645-53-1) 45.0 %
Pyriproxyfen: (CAS #95737-68-1) (Nylar**) 5.0 %

OTHER INGREDIENTS 50.0 %
TOTAL 100.0 %

* cis/trans ratio: Max 55% (+) cis and min 45% (+) trans

U.S. Patent No. 5,942,525

(Nylar**) is a Registered Trademark of McLaughlin Gormley King Company

KEEP OUT OF THE REACH OF CHILDREN

**DO NOT USE ON CATS
CAUTION**

SEE SIDE/BACK PANEL FOR ADDITIONAL PRECAUTIONARY STATEMENTS

Net Contents: [0.09 fl. oz. (3 tubes of 0.03 fl. oz. (1 mL) / tube] OR [0.15 fl. oz. (3 tubes of 0.05 fl. oz. (1.5mL) / tube) OR [0.30 fl. oz. (3 tubes of 0.10 fl. oz. (3 mL) / tube] OR [0.45 fl. oz. (3 tubes of 0.15 fl. oz. (4.5 mL) / tube]

EPA Reg. No.: 67505-3

EPA: Est. No.:

Manufactured For: Ecto Development Corporation
Blue Springs, MO 64015

**DO NOT USE ON CATS
- MAY BE FATAL**

["No Cat" Icon on front panel
– lower right corner]

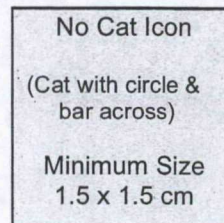

SIDE/BACK PANEL
ECTO DOG FLEA AND TICK INSECTICIDE WITH IGR

READ ENTIRE LABEL BEFORE EACH USE
USE ONLY ON DOGS OVER 12 WEEKS OF AGE

DO NOT USE ON CATS – MAY BE FATAL

PRECAUTIONARY STATEMENTS
HAZARDS TO HUMANS AND DOMESTIC ANIMALS
CAUTION

Hazards to Humans: Harmful if swallowed. Avoid contact with eyes or clothing. Causes moderate eye irritation. Wash thoroughly with soap and water after handling.

Hazards to Domestic Animals: FOR EXTERNAL USE ON DOGS ONLY. Do not use on puppies under 12 weeks of age. Consult a veterinarian before using this product on debilitated, aged, medicated, pregnant, or nursing dogs. Consult a veterinarian before using on dogs with known organ dysfunction. **DO NOT USE ON CATS** or animals other than dogs. Cats which actively groom or engage in close physical contact with treated dogs may be at risk of serious harmful effect. Keep cats away from treated dogs for 24 hours. If applied to or ingested by a cat, contact your veterinarian immediately. Certain medications can interact with pesticides. It is advisable to consult a veterinarian before using this product with ANY other pesticide or drug.

Adverse Reactions: Some animals may be sensitive to ingredients in this product. Reactions in dogs may include skin sensitivity. Dogs may show lethargy, increased pruritus (itchiness), erythema (redness), rash and hair discoloration or hair loss at the application site. Observe the dog following treatment. Sensitivity may occur after using ANY pesticide product for pets. If signs of sensitivity occur bathe your dog with a mild soap and rinse with large amounts of water. If signs continue, consult a veterinarian immediately.

Keep cats away from treated dogs for 24 hours. If applied to or ingested by a cat, contact your veterinarian immediately.

FIRST AID

If Swallowed

- Call a poison control center or doctor immediately for treatment advice.
- Have person sip a glass of water if able to swallow.
- Do not induce vomiting unless told to do so by a poison control center or doctor.
- Do not give anything by mouth to an unconscious person.

If in Eyes

- Hold eyes open and rinse slowly and gently with water for 15–20 minutes.
- Remove contact lenses, if present, after the first 5 minutes, then continue rinsing eyes.
- Call a poison control center or doctor for treatment advice.

SIDE EFFECTS

Monitor your dog after application. Side effects may include signs of skin irritation such as redness, scratching, or other signs of discomfort. Gastrointestinal signs such as vomiting or diarrhea have also been reported. If these or other side effects occur, consult your veterinarian or call 1-800- XXX-XXX

HOT LINE NUMBER

Have the product container or label with you when calling a poison control center or doctor, or going for treatment. You may also contact 1-800-XXX-XXXX for emergency medical treatment information.

No Cat Icon

(Cat with circle &
bar across)
Minimum Size
1.5 x 1.5 cm

DO NOT USE ON CAT
- MAY BE FATAL

["No Cat" Icon on back panel
– lower right corner]

6/14

**SIDE / BACK PANEL
ECTO DOG FLEA AND TICK INSECTICIDE WITH IGR**

ENVIRONMENTAL HAZARDS

This product is extremely toxic to fish. Do not add directly to water. Do not contaminate water when disposing of product or packaging.

DIRECTIONS FOR USE

It is a violation of Federal law to use this product in a manner inconsistent with its labeling.

USE RESTRICTIONS:

DO NOT USE ON CATS OR KITTENS- MAY BE FATAL

USE ONLY ON DOGS OR PUPPIES 12 WEEKS OF AGE OR OLDER.

Do not apply to dogs/puppies weighing less than 5 lbs (for smallest size dog package only)

Do not use more than one tube per dog/puppy and do not retreat more than once per month.

Do not get the dog's eye or mouth and do not allow your dog/puppy to ingest this product.

[Only one of following descriptions per label, based upon dog size.]

[Dogs 5 to 15 lbs]

[Use Only For Dogs Between 5 -[&] 15 lbs: (1.0 mL applicator tubes) Apply one tube (1.0 mL) of product solution as a spot or stripe to the dog's back between the shoulder blades. Do not use on dogs less than 5 pounds. **OR** [Alternate language]

[Use Only For Dogs 5 -[to] 15 lbs: (1.0 mL applicator tubes) Apply one tube (1.0 mL) of product solution as a spot to the skin at three different locations along the dog's back between the shoulder blades and base of the tail. Do not use on dogs less than 5 pounds.

[Dogs 16 to 33 lbs]

[Use Only for Dogs Between 16 & 33 lbs: (1.5 mL applicator tubes) Apply one tube (1.5 mL) of product solution as a spot or stripe to the dog's back between the shoulder blades.] **OR** [Alternate language]

[Use Only for Dogs 16 -[to] 33 lbs: (1.5 mL applicator tubes) Apply one tube (1.5 mL) of product solution as a spot to the skin at three different locations along the dog's back between the shoulder blades and base of the tail.]

[Dogs 34 to 66 lbs]

[Use Only for Dogs Between 34 & 66 lbs: (3 mL applicator tubes) Apply approximately half of the tube (1.5 mL) of product solution as a spot or stripe to the dog's back between the shoulder blades and apply the rest of the tube's contents (1.5 mL) as a spot or stripe to the dog's back directly in front of the base of the tail.] **OR**

[(3 mL applicator tube) Apply the entire tube (3.0 mL) as a continuous stripe on the dog's back starting between the shoulder blades and ending directly in front of the base of the tail.] **OR** [Alternate language]

"No Cat Icon"

(Cat with circle
& bar across)
Minimum Size
1.5 x 1.5 cm

**DO NOT USE ON CATS
- MAY BE FATAL**

["No Cat" Icon on back panel
- lower right corner]

7/14

**SIDE / BACK PANEL
ECTO DOG FLEA AND TICK INSECTICIDE WITH IGR**

DIRECTIONS FOR USE (Continued)

[Use Only for Dogs 34 -[to] 66 lbs: [(3 mL applicator tubes) Apply approximately half of the tube (1.5 mL) of product solution as a spot or stripe to the skin on the dog's back between the shoulder blades and apply the rest of the tube's contents (1.5 mL) as a spot or stripe to the skin on the dog's back directly in front of the base of the tail.] **OR**

[(3 mL applicator tube) Apply the entire tube (3.0 mL) as a spot to the skin at three or more different locations along the dog's back between the shoulder blades and base of the tail.]

[Dogs over 66 lbs.]

[Use Only for Dogs Over 66 lbs: (4.5 mL applicator tubes) Apply approximately half of the tube (2.25 mL) of product solution as a spot or stripe to the dog's back between the shoulder blades and apply the rest of the tube's contents (2.25 mL) as a spot or stripe to the dog's back directly in front of the base of the tail. DO NOT USE MORE THAN A 4.5 mL DOSE REGARDLESS OF DOG SIZE.] **OR**

[(4.5 mL applicator tubes) Apply the entire tube (4.5 mL) as a continuous stripe on the dog's back starting between the shoulder blades and ending directly in front of the base of the tail. DO NOT USE MORE THAN A 4.5 mL DOSE REGARDLESS OF DOG SIZE.] **OR** [Alternate language]

[Use Only for Dogs Over 66 lbs: (4.5 mL applicator tubes) Apply approximately half of the tube (2.25 mL) of product solution as a spot or stripe to the skin on the dog's back between the shoulder blades and apply the rest of the tube's contents (2.25 mL) as a spot or stripe to the skin on the dog's back directly in front of the base of the tail. DO NOT USE MORE THAN A 4.5 mL DOSE REGARDLESS OF DOG SIZE.] **OR**

4.5 mL applicator tubes) Apply the entire tube (4.5 mL) as a spot to the skin at three or more different locations along the dog's back between the shoulder blades and base of the tail. DO NOT USE MORE THAN A 4.5 mL DOSE REGARDLESS OF DOG SIZE.]

"No Cat Icon"

(Cat with circle
& bar across)
Minimum Size
1.5 x 1.5 cm

**DO NOT USE ON CATS
- MAY BE FATAL**

["No Cat" Icon on back panel]
- lower right corner]

SIDE / BACK PANEL ECTO DOG FLEA AND TICK INSECTICIDE WITH IGR

DIRECTIONS FOR USE (Continued)

HOW TO APPLY:

FOR TWIST TUBES: Remove product from package. Holding tube upright, twist off cap. Invert tube over dog and use open end to part dog's hair. Squeeze tube firmly to apply all of the solution to the dog's skin. Wrap tube and put in trash.

FOR RATCHET TUBES: Remove product tube from package. Holding tube upright, pull off cap. Turn the cap around and place opposite end of cap back on tube. Twist cap to break seal, remove cap from tube. Invert tube over dog and use open end to part dog's hair. Squeeze tube to apply all of the solution to the dog's skin. Wrap tube and put in trash.

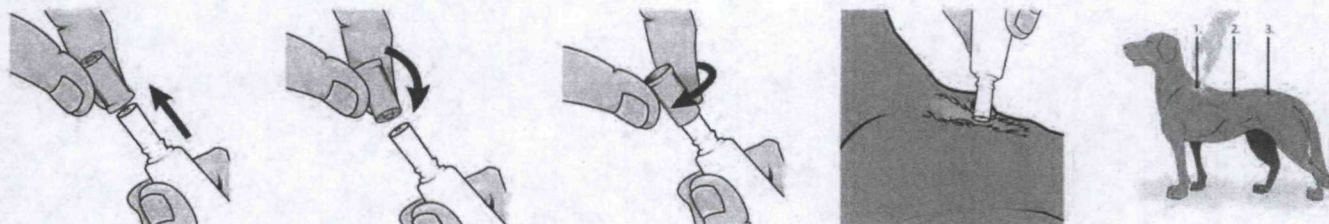

FOR TUBES IN BLISTER CARD: Remove product tube from package. Holding tube with the notched end pointing up and away from face and body, snap or cut off narrow end at notches. Invert tube over dog and use open end to part dog's hair. Squeeze tube firmly to apply all of the solution to the dog's skin. Wrap tube and put in trash.

FOR FLAT CARD UNIT-DOSE PACKAGING: Separate cards along the perforated line. Holding separated card by its wide end with narrow end pointed up and away from face and body, cut along dotted line. Invert card over dog and use narrow end of the card to part dog's hair. Squeeze tube firmly to apply all of the solution to the dog's skin. Wrap tube and put in trash.

FOR FLAT CARD UNIT DOSE PACKAGING: [For push pin type applicator] Remove one product tube from the card. With cap end pointed up and away from face and body, depress cap to pierce tube end. Carefully remove cap, invert tube over dog, with tube close to dog's skin, squeeze tube to apply product. Wrap empty tube and put in trash.

FOR FOLDING CARD OR TABBED CARD UNIT-DOSE PACKAGING: Remove product tab by tearing along perforation. Holding tab with tube end pointed up and away from face and body, cut along dotted line. Invert tab over dog and use narrow end of the card to part dog's hair. Squeeze tube firmly to apply all of the solution to the dog's skin. Wrap tab and put in trash.

BLISTER CARD WITH TRI-LAYER TUBES: Remove product tube(s) from package. Fold along perforation between tubes and tear off one tube. {Return unused tubes to package} Holding tube with notched end pointing up and away from face and body, snap off narrow end at notches. Invert tube over dog and use open end to part dog's hair. Squeeze tube firmly to apply all of the solution to the dog's skin. Wrap tube and put in trash.

"No Cat Icon"

(Cat with circle
& bar across)
Minimum Size
1.5 x 1.5 cm

**DO NOT USE ON CATS
- MAY BE FATAL**

["No Cat" Icon on back panel]
- lower right corner]

9/14

SIDE / BACK PANEL
ECTO DOG FLEA AND TICK INSECTICIDE WITH IGR

DIRECTIONS FOR USE (Continued)

FOR MULTI-DOSE PACKAGING: Withdraw 1.0mL (1.5mL) (3.0 mL) (4.5 mL) of solution at a time. Apply entire given dose directly to the skin at the indicated locations.

FOR DROPPER BOTTLE MULTI-DOSE PACKAGING: Insert dropper tube into insecticide solution, squeeze bulb and then release to fill tube barrel to 1.0 mL (1.5mL) (3.0 mL) (4.5 mL) line. Position dropper tube end in the dog's hair next to skin and squeeze bulb to apply all of the solution to the dog's skin as indicated for dog's size.

ECTO DOG FLEA AND TICK INSECTICIDE WITH IGR is an effective and easy to use product. This product has demonstrated greater than 92% control of fleas within one day of application. Treating your dog with this product prevents flea eggs from developing into biting adults for up to [4 months] 123 days. As with all flea and tick control products, this product should be used as part of a program aimed at reducing flea populations in the dog's environment (bedding, carpets, kennel, yard). Consult your veterinarian, for program recommendations.

STORAGE AND DISPOSAL

Pesticide Storage: Store in a cool, dry place away from heat and open flame. Protect from freezing.

Pesticide Disposal: Non-refillable container. If empty: Do not reuse or refill this container. Place in trash or offer for recycling if available. If partly filled: Call your local solid waste agency for disposal instructions. Never place unused product down any indoor or outdoor drain.

NOTICE OF WARRANTY

NOTE: Seller warrants this product complies with the specifications expressed in this label. To the extent consistent with applicable law, Seller makes no other warranties and disclaims all other warranties, express or implied, including but not limited to warranties of merchantability and fitness for the intended purpose. To the extent consistent with applicable law, Sellers liability or default, breach, or failure under this label shall be limited to the amount of the purchase price. To the extent consistent with applicable law, Seller shall have no liability for consequential damages.

"No Cat Icon"

(Cat with circle
& bar across)
Minimum Size
1.5 x 1.5 cm

DO NOT USE ON CATS
- MAY BE FATAL

["No Cat" Icon on back panel
— lower right corner]

ALTERNATE MARKETING CLAIMS BASED UPON ME-TOO APPLICATIONS

For use on Dogs and puppies over 12 weeks of age

[Kills, repels, and prevents re-infestation of fleas for up to 5 weeks]

[Kills, repels, and prevents re-infestation of fleas for up to 4 weeks]

[Kills flea eggs and larvae for up to 8 weeks]

[Kills flea eggs and larvae for up to 6 weeks]

[Kills flea eggs and larvae for up to 4 weeks]

[Breaks the flea life cycle]

[Kills, repels, and prevents re-infestation of ticks for up to 6 weeks]

[Kills, repels, and prevents re-infestation of ticks for up to 4 weeks]

[Kills, repels mosquitoes, lice, and mites on dogs for up to 4 weeks]

[Kills 5 different kinds of pests on dogs]

[Kills five different kinds of pests on dogs]

[Kills 5 different canine pests]

[Kills five different canine pests]

[Kills canine pests belonging to Five different orders]

[Kills canine pests belonging to 5 different orders]

[Seven in one Protection]

[7-in-1 Protection]

[Six-in-One Protection]

[6-in-1 Protection]

[Five-in-One Protection]

[5-in-1 Protection]

11/14

TUBE LABEL (folding card and flat card packaging designs)

ECTO DOG FLEA AND TICK INSECTICIDE WITH IGR

PERMETHRIN 45% W/W
PYRIPROXYFENN 5% W/W

KEEP OUT OF REACH OF CHILDREN

[CAT ICON IN CIRCLE WITH SLASH THROUGH IT
LOCATED ON TUBE]



**DO NOT USE ON CATS
- MAY BE FATAL**

READ DIRECTIONS AND PRECAUTIONS BEFORE USING

[ONE OF THE FOLLOWING TEXTS PER TUBE OR VIAL – SEE ATTACHMENT A]

Only for Dogs 5 to 15 lbs.
and over 12 weeks of age.

Only for Dogs 16 to 33 lbs,
and over 12 weeks of age.

Only for Dogs 34 to 66 lbs.
and over 12 weeks of age.

Only for Dogs over 66 lbs.
and over 12 weeks of age

EPA Reg No. 67505-3
Lot No. 0000000

12/14

TAB LABEL (folding card and tabbed card packaging designs)

ECTO DOG FLEA AND TICK INSECTICIDE WITH IGR

ACTIVE INGREDIENTS

* Permethrin: (CAS #52645-53-1)45.0%

* Pyriproxyfen: (CAS #95737-68-1)5.0%

* cis/trans ration: Max 55% (+) cis and min 45% (+) trans

KEEP OUT OF REACH OF CHILDREN

**[CAT ICON IN CIRCLE WITH SLASH THROUGH IT
LOCATED ON TAB LABEL]**



**DO NOT USE ON CATS
- MAY BE FATAL**

**SEE MAIN LABEL FOR ADDITIONAL
PRECAUTIONS AND INSTRUCTIONS FOR USE.**

[ONE OF THE FOLLOWING TEXTS PER TAB – SEE ATTACHMENT A]

Only for Dogs 5 to 15 lbs.
and over 12 weeks of age.

Only for Dogs 16 to 33 lbs,
and over 12 weeks of age.

Only for Dogs 34 to 66 lbs.
and over 12 weeks of age.

Only for Dogs over 66 lbs.
and over 12 weeks of age

EPA Reg No. 67505-3
Lot No. 0000000

13/14

OUTER BOX LABEL (Contains the following labeling plus full product label)

ECTO DOG FLEA & TICK INSECTICIDE WITH IGR

NYLAR™ inhibits development of the mature stages of the flea for up to 4 months preventing them from reaching the biting adult stage.

(Nylar) Registered Trademark of McLaughlin Gormley King Company

PICTURE OF THE FLEA LIFE CYCLE HERE

As part of a complete flea control program, use a suitable outdoor yard spray. Indoors, use, a suitable carpet spray / powder and clean dog bedding and premises

**4 STEPS FOR
COMPLETE FLEA CONTROL**

Step 1 – Shampoo or dip your dog.

Step 2 – Treat indoor and outdoor premises with indoor and outdoor sprays, foggers and powders.

Step 3 – Apply Ecto Dog Flea and Tick Insecticide with IGR for up to four weeks of adult flea and tick control.

Step 4 – Maintenance treatments with on-animal sprays and powders.

DO NOT USE ON CATS

"No Cat Icon"

(Cat with circle
& bar across)
Minimum Size
1.5 x 1.5 cm

**DO NOT USE ON CATS
- MAY BE FATAL**

14/14

ATTACHMENT A

VIEW OF APPLICATOR VIAL / TUBE LABELING [OR IMMEDIATE CONTAINER LABELING]

| | |
|--|--|
| <p>Keep out of reach of Children</p> <p>READ DIRECTIONS AND PRECAUTIONS BEFORE USING</p> <p>Only For Dogs 5 to 15 lbs. and over 12 weeks of age.</p> <p>EPA Reg. No. 67505-3</p> | <div><p>"No Cat Icon"</p><p>(Cat with circle & bar across) Minimum Size 1.5 x1.5 cm</p></div> <p>DO NOT USE ON CATS - MAY BE FATAL</p> |
|--|--|

[ONE OF THE FOLLOWING TEXTS PER VIAL / TUBE OR IMMEDIATE CONTAINER LABELING]

Only for Dogs 5 to 15 lbs.
and over 12 weeks of age.

Only for Dogs 16 to 33 lbs,
and over 12 weeks of age.

Only for Dogs 34 to 66 lbs.
and over 12 weeks of age.

Only for Dogs over 66 lbs.
and over 12 weeks of age