



U.S. ENVIRONMENTAL PROTECTION AGENCY
 Office of Pesticide Programs
 Antimicrobials Division (7510P)
 1200 Pennsylvania Ave., N.W.
 Washington, D.C. 20460

EPA Reg. Number:

67262-44

Date of Issuance:

4/16/18

NOTICE OF PESTICIDE:

Registration
 Reregistration
 (under FIFRA, as amended)

Term of Issuance:

Conditional

Name of Pesticide Product:

Granular Trichlor 21

Name and Address of Registrant (include ZIP Code):

Recreational Water Products, Inc.
 c/o Delta Analytical Corp.
 12510 Prosperity Drive, Suite 160
 Silver Spring, MD 20904

Note: Changes in labeling differing in substance from that accepted in connection with this registration must be submitted to and accepted by the Antimicrobials Division prior to use of the label in commerce. In any correspondence on this product always refer to the above EPA registration number.

On the basis of information furnished by the registrant, the above named pesticide is hereby registered under the Federal Insecticide, Fungicide and Rodenticide Act.

Registration is in no way to be construed as an endorsement or recommendation of this product by the Agency. In order to protect health and the environment, the Administrator, on his motion, may at any time suspend or cancel the registration of a pesticide in accordance with the Act. The acceptance of any name in connection with the registration of a product under this Act is not to be construed as giving the registrant a right to exclusive use of the name or to its use if it has been covered by others.

This product is conditionally registered in accordance with FIFRA section 3(c)(7)(A). You must comply with the following conditions:

1. Submit and/or cite all data required for registration/reregistration/registration review of your product under FIFRA when the Agency requires all registrants of similar products to submit such data.

Signature of Approving Official:

Demson Fuller, Product Manager 32
 Regulatory Management Branch II
 Antimicrobials Division (7510P)

Date:

4/16/18

2. Be aware that proposed data requirements have been identified in a Chlorinated Isocyanurates Final Work Plan. For more information on these proposed data requirements, you may contact the Reevaluation Team Leader (Team 36): <http://www2.epa.gov/pesticide-contacts/contacts-office-pesticide-programsantimicrobial-division>:
3. Make the following label changes before you release the product for shipment:
 - Revise the EPA Registration Number to read, “EPA Reg. No. 67262-44.”
4. Submit one copy of the final printed label for the record before you release the product for shipment.

Should you wish to add/retain a reference to the company’s website on your label, then please be aware that the website becomes labeling under the Federal Insecticide Fungicide and Rodenticide Act and is subject to review by the Agency. If the website is false or misleading, the product would be misbranded and unlawful to sell or distribute under FIFRA section 12(a)(1)(E). 40 CFR 156.10(a)(5) list examples of statements EPA may consider false or misleading. In addition, regardless of whether a website is referenced on your product’s label, claims made on the website may not substantially differ from those claims approved through the registration process. Therefore, should the Agency find or if it is brought to our attention that a website contains false or misleading statements or claims substantially differing from the EPA approved registration, the website will be referred to the EPA’s Office of Enforcement and Compliance.

If you fail to satisfy these data requirements, EPA will consider appropriate regulatory action including, among other things, cancellation under FIFRA section 6(e). Your release for shipment of the product constitutes acceptance of these conditions. A stamped copy of the label is enclosed for your records. Please also note that the record for this product currently contains the following CSFs:

- Basic CSF dated 10/04/2017
- Alternate CSF 1 dated 10/04/2017

If you have any questions, you may contact Ben Chambliss at (703) 308-8174 or via email at chambliss.ben@epa.gov.

Sincerely,



Demson Fuller, Product Manager 32
Regulatory Management Branch II
Antimicrobials Division (7510P)
Office of Pesticide Programs

Enclosure: Stamped label

*{All text in brackets [xxx] is optional and may or may not be included on a final label.}
{All text in braces {xxx} is administrative and will not appear on a final label.}*

Granular Trichlor 21

ACTIVE INGREDIENT:	
Trichloro-s-triazinetrione	58.9%
OTHER INGREDIENTS	41.1%
TOTAL INGREDIENTS	100.0%

Available Chlorine: 54%

KEEP OUT OF REACH OF CHILDREN
DANGER

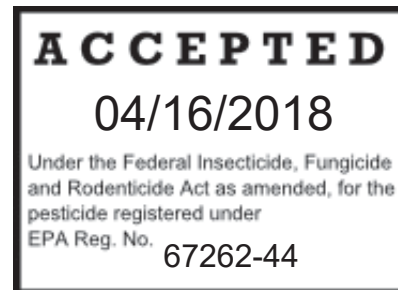

See [back] [side] panel for First Aid and additional precautionary statements. *{If First Aid appears on back or side panel}*
See [back] [side] panel for additional Precautionary Statements. *{If First Aid appears on front panel}*

MANUFACTURED FOR:
RECREATIONAL WATER PRODUCTS
[AQUA CHEM DIVISION]
[PoolTime Division]
PO BOX 1449
BUFORD, GEORGIA 30515

NET [CONTENT] [WEIGHT]: *{as indicated on container}*

EPA REG. NO. 67262-UU
EPA EST. NO. 5185-GA-1 [(BL)] {or} [(Z)]
7616-CA-1 [(C)]

{If multiple EPA Establishment Numbers appear on the label.}
[Actual establishment shown in code above or below label printed on [bottle] [container]]
[Letter designation in lot code printed above or below on [bottle] [container] identifies actual establishment.]

*{Optional marketing statements that may be used with **directions for swimming pool sanitization, pool shock, algaecide or pool closing/winter pool shock.**}*

[Stabilized Granules]
[Do not mix with other products]
[Ideal for pool start-ups]
[Stabilized Chlorinator]
[Routine Chlorinator]
[For everyday use]
[Granular Chlorinating Concentrate]
[Kills Bacteria]
[Controls Bacteria]
[With Sunlight Protector]
[[Easy-to-use],[multifunctional] chlorinating granules protect against algae and bacteria for water that stays [clean], [clear] [&] [free of visible algae]]
[Kills algae]
[Controls algae]
[Algaecide]
[For superchlorination]
[Shock treatment]
[Destroys swimmer wastes*]
[Destroys swimmer contaminants*]
[Removes organic contaminants [for clear water] *]
[Removes swimmer contaminants [for clear water] *]
[*[such as] [body & suntan oils] [body oils] [&] [suntan oils] [&] [sweat] [perspiration] [&] [lotions] [&] [urine]]
[Restores water clarity]
[Do not mix with other products]
[Fast dissolving shock treatment]
[Kills Bacteria & Algae]
[No pre-dissolving]
[For In-ground and Above-ground Pools]
[The 6-in-1 difference]
[[3-in-1] [4-in-1] [5-in-1] [6-in-1] [pool] [all-purpose] [formula] [sanitizer] [sanitizer & shock] [shock]]
[[3-in-1] [4-in-1] [5-in-1] [6-in-1] [formula]]
[[3-in-1] [4-in-1] [6-in-1] [sanitizer] [shock] [algaecide] [pool algae killer] [pool algae preventer] [6-in-1 [action]]]
[4-in-1] [Formula] [Action]
[[3-in-1] [4-in-1] [5-in-1] [6-in-1] [pool] [all-purpose] [formula] [shock] [algaecide]]
[Sunlight protected] [removes organic contaminants*] [removes swimmer contaminants*] [clears water]]
[*[such as] [body & suntan oils] [body oils] [&] [suntan oils] [&] [sweat] [perspiration] [&] [lotions] [&] [urine]]
[Kills [& prevents] green & black pool algae]
[[With] Algae-killing formula]
[Sunlight protected [for longer lasting chlorine]
[Protected against sunlight [to last longer]]

[Reduces chlorine odor]
[Directly to water]
[Add directly to water]
[For use with all filter types] [**]
[** [D.E.,] [Sand,] [Cartridge,] [Zeolite]]
[For use with all surface types][***]
[All surface types][***]
[*** [Aggregate,] [Concrete,] [Fiberglass,] [Gunite,] [Plaster,] [Vinyl]]
[Easy 1 2 3 Pool Care Brand System]
[Step 2]
[Chlorinate]
[Step 3]
[Shock]
[Easy 1 2 3 Pool Care Brand System]
[Do not store in direct sunlight]
[Store out of direct sunlight]
[Fast dissolving]
[Clarifies water]
[Clears cloudy water]
[Clears water]
[Creates sparkling water]
[Pool closing shock treatment]
[Makes spring start up easier]
[TO OPEN CUT ALONG DOTTED LINE WITH SCISSORS] {Statement to appear in upper corner
of child resistant bag when product is sold in a bag.}
[One pound treats 12,000 gallons]
[[Plus] [+]Clarifies Water]
[[Plus] [+] [Blue] [Advantage]]

{Optional marketing statements that may be used with swimming pool sanitization.}

[Stabilized Granules]
[Do not mix with other products]
[Ideal for pool start-ups]
[Stabilized Chlorinator]
[Routine Chlorinator]
[For everyday use]
[Granular Chlorinating Concentrate]
[Kills Bacteria]
[Controls Bacteria]
[[Easy-to-use],[multifunctional] chlorinating granules protect against algae and bacteria for water
that stays [clean], [clear] [&] [free of visible algae]]

{Optional marketing statements that may be used with **pool shock**.}

[For superchlorination]
[Shock treatment]
[Stabilized chlorinator]
[Restores water clarity]
[Do not mix with other products]
[Fast dissolving shock treatment]
[Kills Bacteria & Algae]
[No pre-dissolving]
[For In-ground and Above-ground Pools]
[The 6-in-1 difference]
[[3-in-1] [4-in-1] [5-in-1] [6-in-1] [pool] [all-purpose] [formula] [shock]]
[[3-in-1] [4-in-1] [5-in-1] [6-in-1] [formula][Action]]

[[3-in-1] [4-in-1] [5-in-1] [6-in-1] [shock] [pool algae killer] [pool algae preventer] [Sunlight protected] [removes organic contaminants*] [removes swimmer contaminants*] [clears water]]

[[4-in-1] [6-in-1] [Kills bacteria] [Removes organic contaminants*] [Reduces chlorine odor] [Reduces chlorine odor] [Restores water clarity]]

[Removes organic contaminants* [for clear water]]
[Removes swimmer contaminants* [for clear water]]
[Destroys swimmer wastes*]
[Destroys swimmer contaminants*]

[*[such as] [body & suntan oils] [body oils] [&] [suntan oils] [&] [sweat] [perspiration] [&] [lotions] [&] [urine]]

[Kills green & black pool algae]
[[With] Algae-killing formula]
[Sunlight protected [for longer lasting chlorine]
[Protected against sunlight [to last longer]]
[Reduces chlorine odor]
[[Add] Directly to water]
[For use with all filter types]
[For pools up to 5,000 gallons] {for small pool product offering}
[Easy open] {for 1lb bottle application}
[Easy pour] {for 1lb bottle application}
[Powers through filth for fresh, clear water]
[Step 3]
[Shock]
[Fast dissolving]
[Clarifies water]
[Clears cloudy water]
[Clears water]
[Creates sparkling water]
[Pool closing shock treatment]

[Makes spring start up easier]

{The “4-step System” box below may be placed on the label to allow easy product category identification by consumers.}

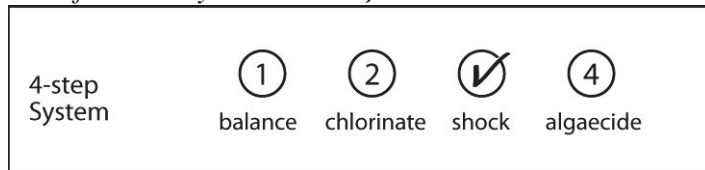

*{Optional marketing statements that may be used with **spa sanitizing.**}*

[Stabilized chlorinator for spas]

[For Spas & Hot Tubs]

[Stabilized Chlorinator]

[Routine Chlorinator]

[For everyday use]

[Granular Chlorinating Concentrate]

[Destroys Contaminants*]

[*][such as] [body & suntan oils] [body oils] [&] [suntan oils] [&] [sweat] [perspiration] [&] [lotions] [&] [urine]]

[Kills Bacteria]

[Controls Bacteria]

[Do not mix with other products]

[Clears [cloudy] water]

[Fast Dissolving [sanitizer [and] [&] shock]]

[For clean, clear spa water]

[For Chlorine Spas]

*{Optional marketing statements that may be used with **spa and hot tub shock treatment.**}*

[Shock Treatment for Spas]

[For Spas & Hot Tubs]

[Spa Treatment]

[Destroys Algae]

[Destroys Bacteria]

[Destroys Algae and Bacteria]

[Fast Dissolving]

[For Crystal Clear Spa Water]

[For Crystal Clear Water]

[For Sparkling Water]

[For Sparkling, Clear Water]

[Oxidizes Undesirable Compounds*]

[Destroys undesirable compounds*]

[Destroys contaminants*]

[*][such as] [body & suntan oils] [body oils] [&] [suntan oils] [&] [sweat] [perspiration] [&] [lotions] [&] [urine]]

[Do not mix with other products]

[Clears [cloudy] water]
 [Fast Dissolving [shock]]
 [For clean, clear spa water]
 [For Chlorine Spas]

{Following chart is optional}

[Application Methods]	Directly to water or skimmer]
[Surface Types]	Aggregate Concrete Fiberglass Gunite Plaster [Vinyl]]
[Filter Types]	D.E., Sand, Cartridge, Zeolite]

{Spanish statement directing Spanish speakers to obtain assistance before using product. Translates in English to: “If you do not understand the (this) label, find someone to explain it to you in detail.”}
 [Si usted no entiende la etiqueta, busque a alguien para que se lo explique a usted en detalle.]

[For Pools] *{For use with products that have pool use directions}*
 [For Pools Only] *{For use with products that have pool use directions}*
 [Not for use in Spas] *{For use with products that have pool use directions}*
 [For Spas] *{For use with products that have spa use directions}*
 [For Spas Only] *{For use with products that have spa use directions}*

{Directions to be used for swimming pool sanitization.}

POOL SANITIZER

WHY TO USE THIS PRODUCT: This product is a quick dissolving stabilized granular swimming pool sanitizer, which when applied according to label directions, will release sufficient chlorine to retard the growth of harmful algae and control bacteria. This product's quick dissolve characteristics not only make it appropriate for all pool types, but won't leave behind the grit and haze other granular products can. Unlike calcium hypochlorite or liquid chlorine (bleach), this product's stabilized formula protects against sun light burn off, making it an efficient type of granular sanitizer for pools.

IMPORTANT NOTES

1. When using other products, as outlined in directions for this product, always follow label directions for those products.
2. Damage may be caused by direct contact of this product with pool surface or materials such as colored plaster, vinyl, wood or fiberglass.
3. This product may promote metal stains on pool surfaces. Always check water for metal content and if present, remove metals with a stain & scale inhibitor prior to the addition of this product.
4. Sunlight, rainfall, temperature, number of swimmers and frequency of pool use affect the rate of chlorine level loss. Adjust cleaning and chemical maintenance accordingly. To destroy undesirable compounds and keep pool clear, shock pool on a regular basis, typically every 1 to 2 weeks.

DIRECTIONS FOR USE:

It is a violation of Federal Law to use this product in any manner inconsistent with its labeling. Read entire label and use strictly in accordance with precautionary statements and directions.

BEFORE YOU BEGIN

1. Ensure all pool equipment is working properly. Clean or backwash filter following manufacturer's directions.
2. Adjust stabilizer levels to 40-50 ppm by adding [Stabilizer] [Chlorine Stabilizer].
3. Check water pH, alkalinity and calcium hardness with a test kit. Adjust pH to 7.2 - 7.6 by adding [pH Down] [pH Decreaser] to lower pH, or by adding [pH Up] [pH Add] to raise pH. Adjust alkalinity to 80 - 125 ppm for plaster pools, 125 - 150 for [vinyl or] fiberglass pools by adding [Alkalinity Increaser] [Alkalinity Plus]. Adjust calcium hardness to 200 - 275 ppm for plaster pools, 175 - 225 for [vinyl or] fiberglass pools by adding Calcium Hardness Increaser. Be sure to follow label directions.

APPLICATION METHODS: DO NOT pre-dissolve this product before adding to pool or skimmer. DO NOT mix this product with any other products or chemicals. Always apply this product in its dry form using a clean dry plastic cup or scoop. Do not use this cup for any other purpose. This product should be applied through the skimmer or directly to pool as follows:

Directly to Skimmer: Add product in dry form directly through the skimmer with the basket removed and the pump running. Replace the skimmer basket and keep the pump running for at least 2 to 4 hours.

Directly to Pool: Add product in dry form directly to the pool water, with the pump running for at least 2 to 4 hours. If your pool has a bleachable surface, such as vinyl, colored plaster, painted or fiberglass, use skimmer application, or add directly to pool, brushing visible product until completely dissolved to avoid bleaching.

NOW USE THIS PRODUCT [(apply per above application methods)]:

START-UP/INITIAL TREATMENT:

1. If water is cloudy or green, superchlorinate pool with appropriate shock product until pool is clear.
2. With pump running and pool not in use, use a clean, dry, empty plastic scoop to broadcast 4 ounces of this product per 12,000 gallons of water directly into the deep end of the pool.
3. After two hours, test chlorine level (residual). Repeat treatments until you obtain a chlorine level of 1-4 ppm.
4. Add an algae preventative to keep your pool free of algae growth.

ROUTINE MAINTENANCE:

1. Check the chlorine level of your pool frequently with a test kit or test strips. Add this product as needed to maintain a chlorine level of 1-4 ppm. You may need to test and add product as often as each day.
2. With pump running and pool not in use, use a clean, dry, empty plastic scoop to broadcast 2-3 ounces of this product per 12,000 gallons of water directly into the deep end of the pool.

Reentry into treated swimming pools is prohibited above levels of 4 ppm chlorine due to risk of body injury.

{Combined use directions for swimming pool sanitization, shock, algaecide and pool closing}

DIRECTIONS FOR USE:

It is a violation of Federal Law to use this product in any manner inconsistent with its labeling. Read entire label and use strictly in accordance with precautionary statements and directions.

Test & balance water prior to use. Adjust pH to 7.2-7.6 [and free chlorine to 1 – 4 ppm]. Visit [website] for [free water analysis] [&] [personalized product and dosage recommendations].

Use: Protects against algae and bacteria for water that stays clean, clear & free of visible algae.

Application Methods	
Always apply in dry form using a designated clean, dry plastic scoop.	
Directly to Pool	Add product to deepest area of pool. Brush visible product until dissolved to avoid surface damage. Operate filter and pump for at least 2-4 [hrs] [hours].
Directly to Skimmer (recommended for water under 70° F)	Add product in dry form directly through the skimmer with the basket removed (along with any product in skimmer) and the pump operating. Rinse the skimmer of any undissolved product. Replace the skimmer basket (along with any removed product) and keep the pump running for at least 2 to 4 hours.

Dosage per 12,000 gallons	When/How to Use (apply per above application methods)
4 oz	To Reach 1-4 ppm at Start-Up Test and repeat application as needed to reach 1-4 ppm of chlorine.
2-3oz	To Sanitize Daily or as needed to maintain 1-4 ppm of chlorine.
1 lb	To Shock Weekly or if water is cloudy or green.
1 lb – Light algae 2 lb – Heavy algae	To Kill Algae <ol style="list-style-type: none"> 1. Brush algae from pool surfaces prior to use. 2. Apply product at night per above application methods. 3. Repeat after 24 [hrs] [hours] if needed.

For Best Results: Use weekly and apply more product after heavy use, high temperatures, or rain [to maintain 1 – 4 ppm].

[**To Close Pool:** Add 2 [lb] [pound] per 12,000 gallons per above application methods. Next add algaecide per closing directions. [Visit [website] for pool closing instructions.]]

Re-entry into treated swimming pools is prohibited above levels of 4ppm chlorine due to risk of body injury.

{Directions to be used for pool shock.}

DIRECTIONS FOR USE:

It is a violation of Federal Law to use this product in any manner inconsistent with its labeling. Read entire label and use strictly in accordance with precautionary statements and directions.

Test & balance water prior to use. Adjust pH to 7.2-7.6 [and free chlorine to 1 – 4 ppm]. Visit [website] for [free water analysis] [&] [personalized product and dosage recommendations].

Use: Destroys organic contaminants* & odors for clear [swim-ready] [ready-to-swim] water.

Application Methods	
Directly to Pool	Add product in dry form to deepest area of pool. Brush visible product until dissolved to avoid surface damage. Operate filter and pump for at least 2-4 [hrs] [hours].
Directly to Skimmer (recommended for water under 70° F)	Add product in dry form directly through the skimmer with the basket removed (along with any product in skimmer) and the pump operating. Rinse the skimmer of any undissolved product. Replace the skimmer basket (along with any removed product) and keep the pump running for at least 2 to 4 hours.

Dosage per 12,000 gallons	When/How to Use (apply per above application methods)
1 lb	To Shock Weekly or if water is cloudy or green.

For Best Results: Use weekly and apply more product after heavy use, high temperatures, or rain.

[**To Close Pool:** Add 2 [lb] [pound] per 12,000 gallons per above application methods. Next add algaecide per closing directions. [Visit [website] for pool closing instructions.]]

*[such as] [body & suntan oils] [body oils] [&] [suntan oils] [&] [sweat] [perspiration] [&] [lotions] [&] [urine]

Re-entry into treated swimming pools is prohibited above levels of 4 ppm chlorine due to risk of bodily injury.

{Directions to be used for spa sanitizing}

SPA SANITIZING

WHY TO USE THIS PRODUCT: This product is a quick dissolving stabilized granular spa sanitizer, which when applied according to label directions, will release sufficient chlorine to retard the growth of harmful algae and control bacteria.

IMPORTANT NOTES

1. When using other products, as outlined in directions for this product, always follow label directions for those products.
2. This product may cause damage to spa or hot tub finish or materials such as colored plaster, vinyl, wood or fiberglass surfaces. Avoid spilling granules on spa surface.
3. This product may promote metal stains on spa or hot tub surfaces. Always check water for metal content and if present, remove metals with a stain & scale inhibitor prior to the addition of this product.
4. Sunlight, rainfall, temperature, frequency of spa and hot tub use affect the rate of chlorine loss. Adjust cleaning and chemical maintenance accordingly.

BEFORE YOU BEGIN

1. Ensure all spa equipment is working properly. Clean or backwash filter following manufacturer's directions.
2. Check water pH, alkalinity and calcium hardness with a test kit. Adjust pH to 7.2 - 7.6 by adding [pH Down] [pH Decreaser] to lower pH, or by adding [pH Up] [pH Add] to raise pH. Adjust alkalinity to 80 - 125 ppm for plaster spas, 125 - 150 for [vinyl or] fiberglass spas by adding [Alkalinity Increaser] [Alkalinity Plus]. Adjust calcium hardness to 200 - 275 ppm for plaster spas, 175 - 225 for [vinyl or] fiberglass spas by adding Calcium Hardness Increaser.

DIRECTIONS FOR USE:

It is a violation of Federal Law to use this product in any manner inconsistent with its labeling. Read entire label and use strictly in accordance with precautionary statements and directions.

NOW USE THIS PRODUCT:

FOR ROUTINE MAINTENANCE DOSES:

1. With pump on, add 1/2 teaspoon of this product per 100 gallons of water (or 5 teaspoons per 1,000 gallons) directly to spa water as an initial treatment.
2. Repeat at 15 to 20 minute intervals until a residual of 3-5 ppm of available chlorine is established as determined by test kit.
3. A test kit must be used regularly to determine the frequency of additional doses of this product needed to maintain 3-5 ppm of available chlorine in the water.

[SUPERCHLORINATION OR SHOCK TREATMENT] [SUPERCHLORINATION] [SHOCK TREATMENT]

[Superchlorinate] [or] [shock] weekly as part of your routine maintenance program, or more frequently following heavy spa use. With pump on, add one teaspoon of this product per 100 gallons of water (or ¼ cup per 1,000 gallons) directly to the spa water. Allow circulating pump to operate for 15-20 minutes. Do not enter spa until chlorine level is between 3 – 5 ppm.

Reentry into treated spas is prohibited above levels of 5 ppm chlorine due to risk of body injury.

{Directions to be used for spa and hot tub shock treatment.}

SHOCK TREATMENT FOR SPAS AND HOT TUBS

WHY TO USE THIS PRODUCT: This product is a fast-dissolving, granular product used for periodic shocking to eliminate the organic compounds (such as [body & suntan oils] [body oils] [suntan oils], [sweat] [perspiration], lotions and urine) in a spa or hot tub which cause odors and cloudy water. This product will raise residual chlorine levels but is not intended for use as a routine sanitizer.

IMPORTANT NOTES:

1. When using other products, as outlined in directions for this product, always follow label directions for those products.
2. Damage may be caused by direct contact of this product with spa surface or materials such as colored plaster, vinyl, wood or fiberglass.
3. This product may promote metal stains on spa surfaces. Always check water for metal content and if present, treat with a stain & scale inhibitor prior to the addition of this product.
4. Sunlight, rainfall, temperature, frequency of spa use affect the rate of sanitizer loss. Adjust cleaning and chemical maintenance accordingly. Use this product to shock weekly or more often as needed.

DIRECTIONS FOR USE:

It is a violation of Federal Law to use this product in any manner inconsistent with its labeling. Read entire label and use strictly in accordance with precautionary statements and directions.

BEFORE YOU BEGIN:

1. Ensure all spa equipment is working properly. Clean or backwash filter following manufacturer's directions.
2. Adjust stabilizer levels to a minimum of 40-50 ppm in outdoor spas by adding stabilizer.
3. Check water alkalinity, pH and calcium hardness with a test kit. Adjust alkalinity to 80-125 ppm for plaster spas, 125-150 for other types of spas by adding an alkalinity increaser. Adjust pH to 7.2 - 7.6 by adding a pH decreaser to lower pH, or by adding a pH increaser to raise pH. Adjust calcium hardness to 200-275 ppm for plaster spas, 175-225 for other types of spas by adding a calcium hardness increaser.
4. Ensure chlorine level is between 3-5 ppm before using this product.

NOW USE THIS PRODUCT:

1. With pump on, add 1 teaspoon of this product per 100 gallons of water (or ¼ cup per 1,000 gallons) directly to spa water.
1. Allow circulating pump to operate for 15-20 minutes.
2. Use this product weekly as part of your routine maintenance program, or more frequently following heavy spa use.
4. Do not enter spa until chlorine level is between 3 – 5 ppm.

Reentry into treated spas is prohibited above levels of 5 ppm chlorine due to risk of body injury.

{Storage and Disposal directions when product is sold in bottles/buckets.}

[STORAGE AND DISPOSAL: Keep this product dry in original tightly closed container when not in use. Store in a cool, dry, well ventilated area away from heat or open flame. In case of decomposition, isolate container if possible and flood area with large amounts of water to dissolve all material before discarding this container. Keep area ventilated until all fumes are gone. Do not contaminate food or feed by storage or disposal. **CONTAINER DISPOSAL:** Non-refillable container. Do not reuse or refill this container. Offer for recycling, if available. Triple rinse container (or equivalent) promptly after emptying.]

{Storage and Disposal directions when product is sold in bags.}

[STORAGE AND DISPOSAL: Keep this product dry in its original unopened bag until use. Store in a cool, dry, well ventilated area away from heat or open flame. In case of decomposition, isolate container if possible and flood area with large amounts of water to dissolve all material before discarding this container. Keep area ventilated until all fumes are gone. Do not contaminate food or feed by storage or disposal. **CONTAINER DISPOSAL:** Non-refillable container. Do not reuse or refill this container. Offer for recycling, if available. Triple rinse container (or equivalent) promptly after emptying.]

PRECAUTIONARY STATEMENTS:

HAZARDS TO HUMANS AND DOMESTIC ANIMALS: DANGER: Corrosive: Causes irreversible eye damage. Harmful if swallowed, inhaled, or absorbed through skin. Do not get in eyes or on clothing. Avoid contact with skin. Avoid breathing dust or fumes. Wear goggles or safety glasses and rubber gloves when handling this product. Wash thoroughly with soap and water after handling and before eating, drinking, chewing gum, using tobacco or using the toilet. Remove and wash contaminated clothing before reuse.

{When First Aid is not located on front panel of label, it will be separated by line rules from adjacent text and be in a different color.}

FIRST AID: IF IN EYES: Hold eye open and rinse slowly and gently with water for 15-20 minutes. Remove contact lenses, if present, after the first 5 minutes, then continue rinsing eye. Call a poison control center or doctor for treatment advice. **IF ON SKIN OR CLOTHING:** Take off contaminated clothing. Rinse skin immediately with plenty of water for 15-20 minutes. Call a poison control center or doctor for treatment advice. **IF INHALED:** Move person to fresh air. If person is not breathing, call 911 or an ambulance, then give artificial respiration, preferably mouth-to-mouth, if possible. Call poison control center or doctor for treatment advice. **IF SWALLOWED:** Call poison control center or doctor immediately for treatment advice. Have person sip a glass of water if able to swallow. Do not induce vomiting unless told to do so by the poison control center or doctor. Do not give anything by mouth to an unconscious person.

Have the product container or label with you when calling a poison control center or doctor, or going for treatment. [IN CASE OF MEDICAL EMERGENCY, CALL [1-877-800-5553] [or other phone number]

Note to Physician: Probable mucosal damage may contraindicate the use of gastric lavage.

PHYSICAL OR CHEMICAL HAZARDS: CONTAINS AN OXIDIZING AGENT: DO NOT mix with other products or chemicals. Never add water to product. Always add product in dry form directly to pool or pool skimmer. Use clean dry utensils. Do not add this product to any dispensing device containing remnants of any other product. Such use may cause a violent reaction leading to fire or explosion. Contamination with organic matter or other chemicals will start a chemical reaction and generate heat, hazardous gas, possible fire, and explosion. In case of contamination or decomposition, do not reseal container. If possible, isolate container in open air or well-ventilated area. Flood area with large volumes of water.

{Environmental hazards statement for end-use products in containers of less than 50 pounds (solid, dry weight).}

[ENVIRONMENTAL HAZARDS: This pesticide is toxic to fish and aquatic organisms.]

{Environmental hazards statement for end-use products in containers equal to or greater than 50 pounds (solid, dry weight).}

[ENVIRONMENTAL HAZARDS: This pesticide is toxic to fish and aquatic organisms. Do not discharge effluent containing this product into lakes, streams, ponds, estuaries, oceans or other waters unless in accordance with the requirements of a National Pollutant Discharge Elimination System (NPDES) permit and the permitting authority has been notified in writing prior to discharge. Do not discharge effluent containing this product to sewer systems without previously notifying the local sewage treatment plant authority. For guidance contact your State Water Board or Regional Office of the EPA.]

[NOTE: Buyer assumes all responsibility for safety and use not in accordance with directions.]

[NOTE: User assumes all responsibility for use not in accordance with directions.]

HOW TO CALCULATE POOL CAPACITY

Shape of Pool	Gallons of water
Rectangular	Average depth x average length x average width x 7.5
Circular	Diameter x diameter x average depth x 5.9
Oval	Full width x full length x average depth x 5.9
Irregular	Consult pool builder

{The following is optional text to be used at Recreational Water Products' discretion. This information is non-essential and will be provided only as a courtesy. Will not appear on all labels.}

[NOTE: Any questions or comments about Aqua Chem Products? [In the continental U.S. call 1-800-252-POOL (7665).] [Ask for your free pool care booklet.]
 [Questions or comments, Call 1-800-252-POOL (7665).]
 [[Questions?] [Pool Care Tips?] [1-800-SOS-POOL]]
 [Visit the Aqua Chem website at www.aquachem.com]
 [Visit the Clorox Pool&Spa website at www.cloroxpool.com]
 [Visit the Pool Essentials website at www.poolessentials.com]
 [Visit the PoolTime website at www.pooltime.com]
 [Visit the Brand Name website at www.brandname.com]

{Optional Graphics}

{Reader Notes: The QR (quick reference) square provides a symbol that is used with a smart phone so that the user can quickly link to information about the product/brand. "FPO" is "for position only". A working quick reference square will be provided on production labels.}



{Child Hazard Graphic}



{Reader Notes: In a three step pool program the 3 steps are: 1-balance water, 2-sanitize water, 3 - shock water. The Easy 1, 2, 3 Pool Care Brand System logo is to remind the consumer know there are multiple steps in pool care.}

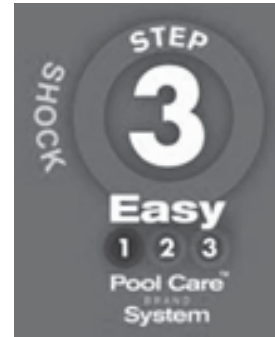

{Reader Notes: "6 in 1 Formula" is to let the consumer know that this product provides 6 benefits in one product: (1) oxidizes, (2) clarifies, (3) prevents corrosion, (4) prevents scale, (5) protects equipment, (6) softens water.}



{Reader Notes: "4 in 1 Formula" is to let the consumer know that this product provides 4 benefits in one product: (1) balance, (2) sanitize (chlorinate), (3) shock, (4) algicide. The "4-step System" graphics below may be placed on the label to allow easy product category identification by consumers.}





{ Reader Notes: Sanitizers are marketed as step three of a five step program to treat swimming pool water for Pool Time brand.}



{ Reader Notes: Shocks are marketed as step four of a five step program to treat swimming pool water for Pool Time brand.}

{Reader Notes: Testing is marketed as step one of a five step program to treat swimming pool water for Pool Time brand.}



{App content includes pool information (i.e., pool volume calculator, analysis from the test strip) product recommendations and store locator, and troubleshooting. It is for the convenience of the user and tracks pool history. Graphics approved on other RWP product labels.}



{App content includes pool information (i.e., analysis from the test strip), products to use and where to buy them, common problems and maintenance information. It is for the convenience of the user and tracks pool history. Graphics approved on other RWP product labels.}

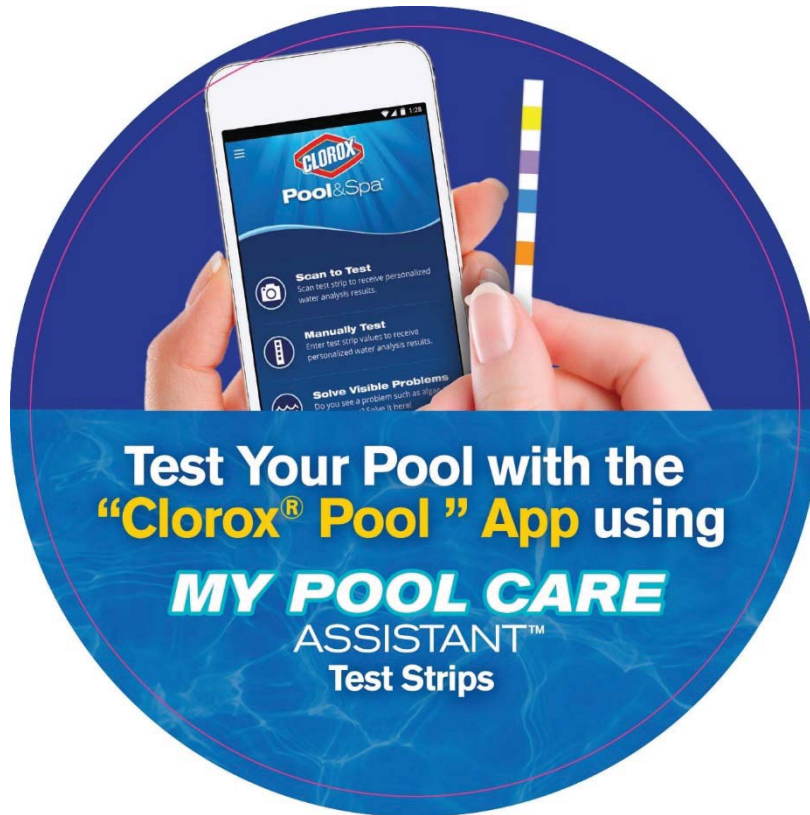

**Test Your Pool with the
“Clorox® Pool” App using
MY POOL CARE
ASSISTANT™
Test Strips**



**MY
POOL CARE
ASSISTANT™
Anytime, Anywhere
Solutions**

TEST YOUR POOL USING THE “CLOROX® POOL” APP

**Use
Multi-Use Smart Strips™
or now with the
3-Way Test Kit**

{The icon below may be used in conjunction with algae kill claims on this label. The statement “Kills algae” may be replaced with similar statements from elsewhere on this label.}



[[Easy-to-use],[multifunctional] chlorinating granules protect against algae and bacteria for water that stays [clean], [clear] [&] [free of visible algae]]

[Algaecide]

[Kills Bacteria & Algae]

[[3-in-1] [4-in-1] [5-in-1] [6-in-1] [sanitizer] [shock] [algaecide] [pool algae killer] [pool algae preventer]

[[3-in-1] [4-in-1] [5-in-1] [6-in-1] [pool] [all-purpose] [formula] [shock] [algaecide]]

[Kills [& prevents] green & black pool algae]

[[With] Algae-killing formula]

[[3-in-1] [4-in-1] [5-in-1] [6-in-1] [shock] [pool algae killer] [pool algae preventer] [Sunlight protected] [removes organic contaminants*] [removes swimmer contaminants*] [clears water]

*[such as] [body & suntan oils] [body oils] [&] [suntan oils] [&] [sweat] [perspiration] [&] [lotions] [&] [urine]]

[[With] Algae-killing formula]

[Destroys Algae]

[Destroys Algae and Bacteria]

{The icon below may be used in conjunction with sunlight protection claims on this label. The statement “Stability for sunlight protection” may be replaced with similar statements listed immediately below the icon.}



[[Sunlight protected] [removes organic contaminants*] [removes swimmer contaminants*] [clears water]]

[[3-in-1] [4-in-1] [5-in-1] [6-in-1] [shock] [pool algae killer] [pool algae preventer] [Sunlight protected] [removes organic contaminants*] [removes swimmer contaminants*] [clears water]

*[such as] [body & suntan oils] [body oils] [&] [suntan oils] [&] [sweat] [perspiration] [&] [lotions] [&] [urine]

[Sunlight protected [for longer lasting chlorine]

[Protected against sunlight [to last longer]]

{The icon below may be used in conjunction with filtration claims on this label. The statement “Clarifier enhances filtration” may be replaced with similar statements listed immediately below the icon.}

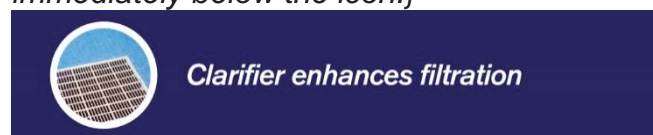

[[Plus] [+] Clarifier Enhances Filtration]
[[Plus] [+]Enhances Filtration]
[[Plus] [+]Improves Filtration]
[[Plus] [+]Improves Filter Performance]

{The icon below may be used in conjunction with water clarifier claims on this label. The statement “Water clarifier” may be replaced with similar statements listed immediately below the icon.}



[Restores water clarity]
[Clarifies water]
[Clears [cloudy] water]
[Clears water]
[Creates sparkling water]
[[Plus] [+]Clarifies Water]

[[3-in-1] [4-in-1] [6-in-1] [shock] [pool algae killer] [pool algae preventer] [Sunlight protected]
[removes organic contaminants*] [removes swimmer contaminants*] [clears water]]

[[4-in-1] [Kills bacteria] [Removes organic contaminants*] [Reduces chlorine odor] [Reduces
chlorine odor] [Reduces eye irritation] [Restores water clarity] [Does not bleach pool surfaces]
[Won't bleach pool surfaces]]

[*[such as] [body & suntan oils] [body oils] [&] [suntan oils] [&] [sweat] [perspiration] [&] [lotions]
[&] [urine]]

[For Crystal Clear Spa Water]
[For Crystal Clear Water]
[For Sparkling Water]
[For clean, clear spa water]

{The icon below may be used in conjunction with green algae claims on this label. The statement “Basic green algae” may be replaced with similar statements listed immediately below the icon.}



[Kills [& prevents] green & black pool algae]

{The icon below may be used in conjunction with black algae claims on this label. The statement “Tough black algae” may be replaced with similar statements listed immediately below the icon.}



[Kills [& prevents] green & black pool algae]

{The icon below may be used in conjunction with killing bacteria claims on this label. The statement “Kills bacteria” may be replaced with similar statements listed immediately below the icon.}



[Kills Bacteria]

[Controls Bacteria]

[[Easy-to-use],[multifunctional] chlorinating granules protect against algae and bacteria for water that stays [clean], [clear] [&] [free of visible algae]]

[Kills Bacteria & Algae]

[[4-in-1] [Kills bacteria] [Removes organic contaminants*] [Reduces chlorine odor] [Reduces chlorine odor] [Reduces eye irritation] [Restores water clarity] [Does not bleach pool surfaces] [Won't bleach pool surfaces]]

[*[such as] [body & suntan oils] [body oils] [&] [suntan oils] [&] [sweat] [perspiration] [&] [lotions] [&] [urine]]

[Destroys Bacteria]

[Destroys Algae and Bacteria]

{The icon below may be used in conjunction with swimmer contaminant claims on this label. The statement “Removes swimmer contaminants” may be replaced with similar statements listed immediately below the icon.}



[Destroys swimmer wastes**]

[Destroys swimmer contaminants**]

[[Removes swimmer contaminants [for clear water] **]

[[Sunlight protected] [removes organic contaminants**] [removes swimmer contaminants**]
[clears water]]

[[3-in-1] [4-in-1] [6-in-1] [shock] [pool algae killer] [pool algae preventer] [Sunlight protected]
[removes organic contaminants**] [removes swimmer contaminants**] [clears water]

[[4-in-1] [Kills bacteria] [Removes organic contaminants**] [Reduces chlorine odor] [Reduces
chlorine odor] [Reduces eye irritation] [Restores water clarity] [Does not bleach pool surfaces]
[Won't bleach pool surfaces]]

[Destroys Contaminants**]

[Oxidizes Undesirable Compounds**]

[Destroys undesirable compounds**]

**[such as] [body & suntan oils] [body oils] [&] [suntan oils] [&] [sweat] [perspiration] [&]
[lotions] [&] [urine]]

{The icon below may be used in conjunction with a claim on this label that the product is both a sanitizer and shock. The statement “Sanitizer and Shock” may be replaced with similar statements from elsewhere on this label.}

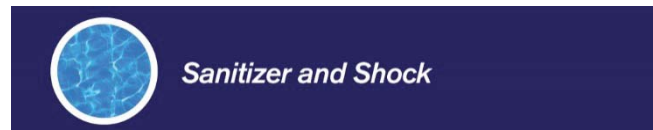

[[3-in-1] [4-in-1] [6-in-1] [pool] [all-purpose] [formula] [sanitizer] [sanitizer & shock] [shock]]

Tamper Evident Tear Strip
Tear away by using "ring pull" on either side of lid

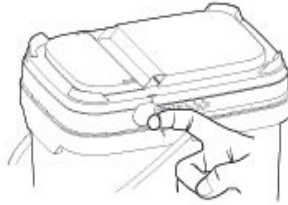

To open the lid (after the tear strip is removed)

Step-1

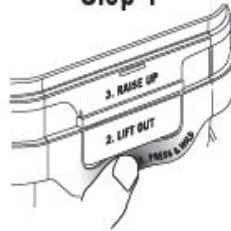

Step-2



Step-3



Tamper Evident Tear Strip

Tear away by using "ring pull" on either side of lid

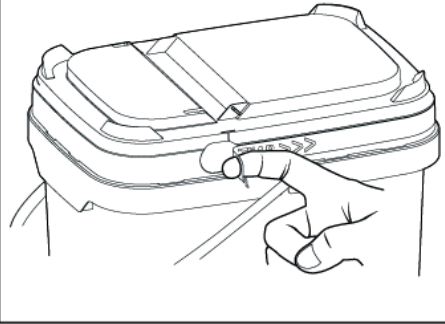

**To open the lid
(after the tear strip is removed)**

Step-1

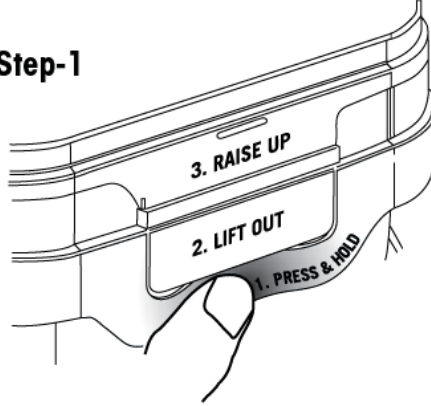

Step-2

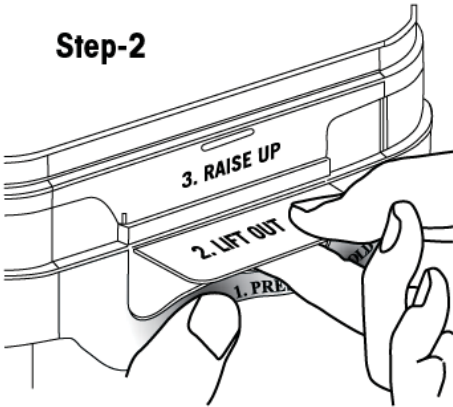

Step-3

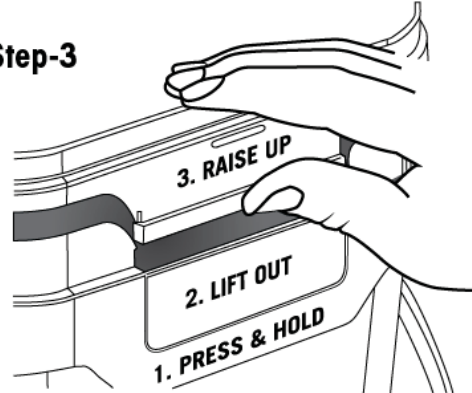

Do not store in direct sunlight