



OFFICE OF CHEMICAL SAFETY AND POLLUTION PREVENTION

WASHINGTON, D.C. 20460

September 23, 2025

SENT BY EMAIL

Perri Moeller
perri.moeller@tsgconsulting.com
KING TECHNOLOGY INC.

Subject: Labeling Notification per Pesticide Registration Notice (PRN) 98-10 - Submission for Minor Label Changes
Product Name: Spa Chlorine Disinfectant
Admin Number: 53735-14
EPA Receipt Date: 10/12/2024
Action Case Number: 00633007

Dear Perri Moeller:

The U.S. Environmental Protection Agency is in receipt of your application for notification under Pesticide Registration Notice 98-10 for the above referenced product. The EPA has conducted a review of this request for its applicability under PRN 98-10 and finds that the action requested falls within the scope of PRN 98-10.

The labeling submitted with this application has been stamped "Notification" and will be placed in our records.

Should you wish to add/retain a reference to your company's website on your label, then please be aware that the website becomes labeling under the Federal Insecticide, Fungicide, and Rodenticide Act and is subject to review by the EPA. If the website is false or misleading, the product will be considered to be misbranded and sale or distribution of the product is unlawful under FIFRA section 12(a)(1)(E). 40 CFR § 156.10(a)(5) lists examples of statements the EPA may consider false or misleading. In addition, regardless of whether a website is referenced on your product's label, claims made on the website may not substantially differ from those claims approved through the registration process. Therefore, should the EPA find or if it is brought to our attention that a website contains statements or claims substantially differing from statements or claims made in connection with obtaining a FIFRA section 3 registration, the website will be referred to the EPA's Office of Enforcement and Compliance Assurance.

If you have questions, please contact John Hall via email at hall.john.j@epa.gov.

Sincerely,

John Hall, Risk Manager
RMB1, AD
Office of Pesticide Programs

[All text in brackets {xxx} is optional and may or may not be included on a final label.]
[All text in braces [xxx] is administrative and will not appear on a final label.]
[Note to reviewer: All references of hot tub are interchangeable with the word spa]

[MASTER LABEL]

NOTIFICATION

SPA CHLORINE DISINFECTANT Prefilled Chlorine Hot Tub Sanitizer

53735-14

The applicant has certified that no changes, other than those reported to the Agency have been made to the labeling. The Agency acknowledges this notification by letter dated:

09/23/2025

Active Ingredients:

1,3-dichloro-5, 5-Dimethylhydantoin.....81.1%

1,3-dichloro-5-ethyl-5-methylhydantoin.....16.1%

Other Ingredients:..... 2.8%

Total:.....100.0%

**Keep Out of Reach of Children
DANGER**

{SEE PRECAUTIONARY STATEMENTS ON BACK PANEL}

{See Enclosed Instruction {Product Label} {Instruction Manual} for Complete Directions for Use}

EPA Reg. No.: 53735-14

Net Wt.: xxx grams

EPA Est. No.: xxxxx-xx

Manufactured for: King Technology, Inc.
6000 Clearwater Dr
Minnetonka, MN 55343

[Note to Reviewer: In accordance with 40 CFR 156.68(d), all first aid statements, as prescribed, will appear on the front panel of the product label.]

FIRST AID: If in Eyes: Hold eye open and rinse slowly and gently with water for 15-20 minutes. Remove contact lenses, if present, after the first 5 minutes, then continue rinsing eye. Call a poison control center or doctor for treatment advice. If on Skin or Clothing: Take off contaminated clothing. Rinse skin immediately with plenty of water for 15-20 minutes. Call a poison control center or doctor for treatment advice. If Swallowed: Call poison control center or doctor immediately for treatment advice. Have person sip a glass of water if able to swallow. Do not induce vomiting unless told to do so by the poison control center or doctor. Do not give anything by mouth to an unconscious person. Have the product container or label with you when calling a poison control center or doctor, or going for treatment. If Inhaled: Move person to fresh air. If person is not breathing, call 911 or an ambulance, then give artificial respiration, preferably by mouth-to-mouth, if possible. Call a poison control center or doctor for further treatment advice. Note to Physician: Probable mucosal damage may contraindicate the use of gastric lavage. Measures against circulatory shock, respiratory depression, and convulsion may be needed.

IN CASE OF MEDICAL EMERGENCY CALL 1-800-424-9300.

PRECAUTIONARY STATEMENTS:

HAZARDS TO HUMANS AND DOMESTIC ANIMALS: DANGER: Corrosive. Causes irreversible eye and skin damage. May be fatal if swallowed. Irritating to nose and throat. Avoid breathing dust and fumes. Do not get in eyes, on skin or on clothing. Wear goggles or safety glasses and rubber gloves when handling product. Wash thoroughly with soap and water after handling and before eating, drinking, chewing gum, using tobacco or using the toilet. Remove and wash contaminated clothing before reuse.

PHYSICAL AND CHEMICAL HAZARDS: STRONG OXIDIZING AGENT: Do not mix with other chemicals. Mix only with water. Never add water to product. Always add product to large quantities of water. Use clean dry utensils. Do not add this product to any dispensing device containing remnants of any other product. Such use may cause a violent reaction leading to fire and explosion. Contamination with moisture, organic matter or other chemicals will start a chemical reaction and generate heat, hazardous gas, possible fire and explosion. In case of contamination or decomposition, do not reseal container. If possible, isolate container in open air or well-ventilated area. Flood area with large volumes of water.

ENVIRONMENTAL HAZARDS: This pesticide is toxic to fish and aquatic organisms.

Note: Buyer assumes all responsibility for safety and use not in accordance with directions.

[EPA Est. No. xxxxx-xx-x (X); xxxxx-xx-x (X)
Beginning of batch code indicates Est. No.]

[Product Description and Directions for Use with In-Line System]

Product Description: The SPA CHLORINE DISINFECTANT is a revolutionary way to maintain a low level of {chlorine} {sanitization} {disinfection} {tailor-made} {perfect} for use with the {53735-11 Brand Name} that reduce{s} chlorine use {up to 75%*}. {Together they make hot tub care a breeze with up to 75% less chlorine* so the water feels softer and looks crystal clear with no smelly odors, no adding chlorine daily and no weekly shocking. Swimsuit colors stay bright and hot tub surfaces maintain their brilliance longer.}

Directions for Use: It is a violation of federal law to use this product in a manner inconsistent with its labeling.

For use in hot tubs up to 600 gallons. Use the SPA CHLORINE DISINFECTANT with the {53735-11 Brand Name} in the {Brand System}. Ensure all hot tub equipment is working properly. Operate the pump and filter as recommended by your hot tub manufacturer. Clean filter following manufacturer's directions. May be used with a previously filled hot tub unless it was sanitized with bromine or biguanides {or the cyanuric acid level is higher than 80 ppm}. Then drain and fill hot tub with fresh water before using this product.

Balance the water {according to the water balance guidelines} with pH between 7.2 – {7.6} {7.8} and Total Alkalinity {at} {between} 80 {to} {and} {100} {120} ppm. Begin with {a free chlorine residual of 0.5 to 1.0 ppm in the hot tub from} {53735-12 Brand Name} {53735-13 Brand Name} start-up shock {or an EPA approved hot tub chlorine shock} following the directions for that product. {When using other products as outlined in directions for this product, always follow directions on those products.}

Setting the Output: {The SPA CHLORINE DISINFECTANT is prefilled and adjustable to meet the needs of each hot tub use. Initially set cartridge per your gallon size: x {-x} gallons - setting x, x {-x} gallons – setting x, x {-x} gallons – setting x, x {-x} gallons – setting x.} Hold the bottom and turn the top of the cartridge until the correct number appears in the setting window. {See the setting chart in the manual {based on gallons} {for best results}.} {setting window}

{UsingThe In-line {Mineral} {Hot Tub} System} {Inserting the Cartridge}: Open cap of Inline System, {push down and turn cartridge holder counter-clockwise to unlock.} Pull holder out. Snap SPA CHLORINE DISINFECTANT into {lower} {bottom} section marked "Bromine or SmartChlor". The {53735-11 Brand Name} cartridge will be in the top section marked "Minerals." {Make sure to line up indent on cartridge with raised line on holder. After cartridge is snapped in,} replace holder {and turn holder clockwise until it stops} {by lining up arrow on holder with arrow on system lip, push down and rotate clockwise to lock in place.} Replace cap.} {When using the {53735-11 Brand Name}, maintain a free chlorine level of 0.5 – 1.0 ppm.}

{Using the {Brand} {Filter} {Weir} {Basket} System: In the {weir} {basket} are two round openings. Insert SPA CHLORINE DISINFECTANT into one opening and push

down firmly to ensure the cartridge is snapped in place. Insert {53735-11 Brand Name} into the other opening in the same way.}

Replacing the Cartridge: When empty the {Brand} Test Strips will show a lighter color than the out indicator on the {Brand} Test Strip label. When this happens remove the SPA CHLORINE DISINFECTANT from the system, drain the water and shake slightly to see if it is empty. Follow disposal instructions and replace with a new SPA CHLORINE DISINFECTANT. Do not discard or recycle cartridge if a small amount of chlorine remains. Place back in the in-line system until completely empty.

{Keeping the pH in the proper range of 7.2 to {7.6} {7.8} will allow SPA CHLORINE DISINFECTANT to keep the free chlorine level between 0.5 and 1.0 ppm with little adjusting.} {To ensure the effectiveness of SPA CHLORINE DISINFECTANT, always maintain proper water balance.}

Shock the hot tub {with Brand Name} when you replace SPA CHLORINE DISINFECTANT or {once a month}. {With SPA CHLORINE DISINFECTANT less shocking is required because it maintains a consistent level of sanitization even when people enter the hot tub.}

| Before draining a treated hot tub contact your local sanitary sewer and storm drain authorities and follow their discharge instructions. Do not discharge hot tub water to any location that flows to a gutter or storm drain or natural water body unless discharge is allowed be state and local authorities. |

REENTRY into treated hot tubs is prohibited above levels of 5 ppm available {free} chlorine as measured by a suitable test kit due to risk of bodily injury.

[Product Description and Directions for Use with Floating/Flipping System]

Product Description: The SPA CHLORINE DISINFECTANT is a revolutionary way to maintain a low level of chlorine **tailor-made** for use with {53735-11 Brand Name} that reduce{s} chlorine use {up to 75%*}. {Together they make {hot tub} {swim spa} care a breeze with up to 75% less chlorine* so the water feels softer and looks crystal clear with no smelly odors, no adding chlorine daily and no weekly shocking. Swimsuit colors stay bright and {hot tub} {swim spa} surfaces maintain their brilliance longer.}

Directions for Use: It is a violation of federal law to use this product in a manner inconsistent with its labeling.

For use in {hot tubs} {swim spas} up to {600} {3000} gallons. Use only with the {53735-11 Brand Name} {in the {Brand} Sanitizing System}. Ensure all {hot tub} {swim spa} equipment is working properly. Operate the pump and filter as recommended by your {hot tub} {swim spa} manufacturer. Clean filter following manufacturer's directions. May be used with a previously filled {hot tub} {swim spa} unless it was sanitized with bromine or biguanides {or the cyanuric acid level is higher than 80 ppm}. Then drain and fill {hot tub} {swim spa} with fresh water before using this product. {Multiple systems may be used for larger gallons (example: 2 up to 1200 gallons, 3 up to 1800 gallons, etc.).}

Start-up: Balance the water {according to the water balance guidelines} with pH between 7.2 – {7.6} {7.8} and Total Alkalinity at 80 to {100} {120} ppm. {Begin with} {Establish} a free chlorine residual of 0.5 to 1.0 ppm in the {hot tub} {swim spa} {from} {with} {53735-12 Brand Name} {53735-13 Brand Name} start-up shock or an EPA approved hot tub chlorine shock following the directions for that product. {When using other products as outlined in directions for this product, always follow directions on those products.}

To assemble:

- Remove outer packaging
- {Align arrows on {color} {53735-11 Brand Name} {mineral cartridge} and {color} SPA CHLORINE DISINFECTANT (chlorine cartridge)}
- Push together and twist to lock}
- {Insert SPA CHLORINE DISINFECTANT into the section of the reusable floating holder that fits that shape. Make sure it snaps in securely and stays in place. Insert {53735-11 Brand Name} into the other section in the same way.}
- {Set the dial on the {SPA CHLORINE DISINFECTANT} {chlorine cartridge} (see Setting Chart in manual)}
- Place entire system in the {hot tub} {swim spa} water. {Multiple systems may be used for larger gallons (2 up to 1200 gallons, 3 up to 1800 gallons, etc.).}
- {{Weekly} {Periodically} test the water to ensure pH balance and a 0.5 to 1.0 ppm free chlorine level}
- {Adjust cartridge setting if needed }

- {Shock the {hot tub} {swim spa} {with Brand Name} {non-chlorine shock} when replacing SPA CHLORINE DISINFECTANT or once a month}

Replacing the Cartridge: When {the system flips over} {or} {the Test Strip shows a lighter color than the out indicator on the Test Strip label}, replace the SPA CHLORINE DISINFECTANT by rotating the two cartridges until the arrows align and pull apart. Drain the water from the old SPA CHLORINE DISINFECTANT and shake slightly to see if it is empty. Follow disposal instructions and replace with a new SPA CHLORINE DISINFECTANT. {If using multiple systems, one may flip over before the other. Always replace SPA CHLORINE DISINFECTANT as soon as each system flips over.} {Do not wait for both to flip before replacing SPA CHLORINE DISINFECTANT.} Do not discard or recycle cartridge if a small amount of chlorine remains. Place in the {hot tub} {swim spa} to float on its own until completely empty.

- {Keeping the pH in the proper range of 7.2 to {7.6} {7.8} will allow SPA CHLORINE DISINFECTANT to keep the free chlorine level between 0.5 and 1.0 ppm with little adjusting.} {To ensure the effectiveness of SPA CHLORINE DISINFECTANT, always maintain proper water balance.}
- With SPA CHLORINE DISINFECTANT less shocking is required because it maintains a consistent level of sanitization even when people enter the {hot tub} {swim spa}.

Before draining a treated {hot tub} {swim spa} contact your local sanitary sewer and storm drain authorities and follow their discharge instructions. Do not discharge {hot tub} {swim spa} water to any location that flows to a gutter or storm drain or natural water body unless discharge is allowed by state and local authorities.

REENTRY into treated {hot tubs} {swim spas} is prohibited above levels of 5 ppm available {free} chlorine as measured by a suitable test kit due to risk of bodily injury.

[The following copy is engraved into the plastic container]

Not a toy

No es un juguete

Keep Out of Reach of Children

DANGER

EPA Reg. No.: 53735-14{-xxxxx}

Patents: {kingtechnology.com/IP} [OR] {heycoolpool.com/IP}

[Product Description and Directions for Use with Filter Well Systems]

Product Description: The SPA CHLORINE DISINFECTANT {custom designed for {Brand} Spas {with Brand {Filter} {Filtration} {System}} is a revolutionary way to maintain a low level of chlorine ~~tailor made~~ for use with the {53735-11 Brand Name} that reduces chlorine use {up to 75%*}. {Together they make hot tub care a breeze with up to 75% less chlorine* so the water feels softer and looks crystal clear with no smelly odors, no adding chlorine daily and no weekly shocking. Swimsuit colors stay bright and hot tub surfaces maintain their brilliance longer.}

Directions for Use: It is a violation of federal law to use this product in a manner inconsistent with its labeling.

For use in hot tubs up to 600 gallons. Use only with the {53735-11 Brand Name} {in the {Sanitizing} System for {Brand Spas}}. Ensure all hot tub equipment is working properly. Operate the pump and filter as recommended by your hot tub manufacturer. Clean filter following manufacturer's directions. May be used with a previously filled hot tub unless it was sanitized with bromine or biguanides {or the cyanuric acid level is higher than 80 ppm}. Then drain and fill hot tub with fresh water before using this product. {Multiple systems may be used for larger gallons (example: 2 up to 1200 gallons, 3 up to 1800 gallons, etc.).}

{Start-up:} Balance the water according to the water balance guidelines with pH between 7.2 – {7.6} {7.8} and total alkalinity at 80 to {100} {120} ppm. {Begin with} {establish} a free chlorine residual of 0.5 to 1.0 ppm in the hot tub {with} {from} {53735-12 Brand Name} {53735-13 Brand Name} start-up shock or an EPA approved hot tub chlorine shock following the directions for that product. {When using other products as outlined in directions for this product, always follow directions on those products.}

Setting the Output: The SPA CHLORINE DISINFECTANT is prefilled and adjustable to meet the needs of each hot tub use. Initially set cartridge per your {Brand Spa} {model number} {gallon size: x {-x} gallons - setting x, x {-x} gallons – setting x, x {-x} gallons – setting x, x {-x} gallons – setting x}. Turn the dial on the bottom of the cartridge to the correct setting {based on your gallons or model number}. {See the setting chart in the manual for best results.}

[OPTION FOR BRAND A SPAS SERIES X] Using The System {With #, # and # Series}: Remove filter snap cap and weir door/filter plate. Remove cartridge {holder} {carrier} {caddy} from hot tub by pulling up on the handle. Snap cartridge into one opening of the {holder} {carrier} {caddy}. With the {Brand} logo facing the {holder} {carrier} {caddy}, put the dial end of cartridge into the {holder} {carrier} {caddy} first by connecting the tab on the {holder} {carrier} {caddy} with the indent in the cartridge. Then push the top part of the cartridge in until it snaps into place. For best results insert the {53735-11 Brand Name} into the other opening. When cartridge is snapped in, replace cartridge {holder} {carrier} {caddy} between the filter cartridges under weir door/ filter plate pushing down until it stays in place. Then replace the filter snap cap.}

[OPTION FOR BRAND A SPAS SERIES XX] Using the System {With # Series} {With {Brand} Filter}:

- {Turn off main power to the hot tub and} remove the JetPak {covering the [Brand] filter holder} {that is usually} to the right of the main control {panel}}.
- {Remove {Brand} Filter Holder by taking hold of the handle, {pushing it into the hot tub} {pulling it away from the side of the hot tub} and lift out.}
- Insert {53735-11 Brand Name} and SPA CHLORINE DISINFECTANT into the two openings {on the outside of the {Brand} Filter Holder} {provided in the {Brand} Filter Holder} {below the filter cartridge}. Push cartridges in until they {are latched} {lock into position} {snap into place}.
- To remove cartridges, {push them in {and lift up to release from lock} {until they are free of the latches}, then slide them out} {pull up on one end of cartridge and lift out}.
- Replace {Brand} Filter Holder and the JetPak{ over it. Turn on main power.}
- {For swim spas with 2 {Brand} Filters, insert x {53735-11 Brand Name} and x SPA CHLORINE DISINFECTANT into the openings {in} {on} the {outside of} 2 {Brand} Filter Holders} {below each filter cartridge}. {Push cartridges in until they are latched.}}

[Callouts for this section] {Brand} Filter Holder, Two openings for cartridges, Cartridges installed, Latches

[OPTION FOR BRAND B SPAS] Using The System with {Brand Spas}:

- Remove the filter cover.
- Remove {Brand Spas} cartridge {holder} {carrier} {caddy} if already installed using the handle at the top of the {holder} {carrier} {caddy}.
- Open the arms of the {Brand} cartridge {holder} {carrier} {caddy} until they snap into position.
- With the {Brand} logo facing up on the {53735-11 Brand Name}, place the bottom of the rounded edge of the cartridge into the front of {the upper} {the lower} {one} opening of the {holder} {carrier} {caddy} and push the cartridge back until it locks into place.
- Follow the same procedure with the SPA CHLORINE DISINFECTANT in the {other} {upper} {lower} opening.
- With the {Brand} cartridges facing the inside of the hot tub and the handle of the {holder} {carrier} {caddy} at the top, slide the {holder} {carrier} {caddy} down over the filter cartridge that does NOT have a grid underneath it until it covers the entire length of the filter cartridge.
- Rotate the {Brand} {holder} {carrier} {caddy} until it touches the other filter cartridge.
- Re-install the filter cover.

[OPTION FOR BRAND B SPAS FLOATER] Using The System as Floater:

- Remove outer packaging
- Set the dial on the {53735-11 Brand Name} to wide open on setting x.
- Set the dial on the SPA CHLORINE DISINFECTANT to the setting number based on your hot tub {model number} {gallons} (see setting chart in manual).
- Insert the two cartridges into the {holder} {carrier} {caddy} one at a time. Put bottom of cartridge into the {holder} {carrier} {caddy} bracket first with setting dial facing out. Then push cartridge in place.
- Place entire system in the hot tub to float.
- {Shock the hot tub {with Brand Name} {non-chlorine shock} when replacing SPA CHLORINE DISINFECTANT or once a month}

[OPTION FOR BRAND C SPAS] Using The System with {Brand Spas}:

- Remove the filter lid.
- With the filter cartridge in place, slide the {Brand} {holder} {carrier} {caddy} down over the pipe where the nut is that holds the filter cartridge on. Make sure the openings for the {Brand} cartridges are facing the filter area and the fin on the {holder} {carrier} {caddy} goes between two pleats on the filter cartridge. Push the {holder} {carrier} {caddy} down using the top handle until it snaps in place.
- With the {Brand} logo of the {53735-11 Brand Name} facing up, place the bottom of the rounded edge of the cartridge into the front of the {holder} {carrier} {caddy} opening closest to the {outside} of the hot tub and push the cartridge back until it locks into place.
- Follow the same procedure to insert the SPA CHLORINE DISINFECTANT in the other opening.
- Make sure the cartridges are completely under water. If not, add water to the hot tub until the cartridges are covered {and balance the pH and Total Alkalinity}.
- Re-install the filter lid.

[OPTION D]

- Remove the filter {lid} {cover}.
- Insert {Brand} {holder} {carrier} {caddy} in the filter well area per the diagram.
- Snap {53735-11 Brand Name} into one opening and SPA CHLORINE DISINFECTANT into the other opening.
- Re-install the filter {lid} {cover}.

Replacing the Cartridge: When empty the {Brand} Test Strips will show a lighter color than the out indicator on the {Brand} Test Strip label. When this happens remove the SPA CHLORINE DISINFECTANT from the {system} {holder} {carrier} {caddy}, drain the water and shake slightly to see if it is empty. Follow disposal instructions and replace with a new SPA CHLORINE DISINFECTANT. Do not discard or recycle cartridge if a small amount of chlorine remains. Place back in the system until completely empty.

- {Keeping the pH in the proper range of 7.2 to {7.6} 7.8 will allow SPA CHLORINE DISINFECTANT to keep the free chlorine level between 0.5 and 1.0 ppm with little adjusting.} {To ensure the effectiveness of SPA CHLORINE DISINFECTANT, always maintain proper water balance.}
- Shock the hot tub {with Brand Name} when you replace SPA CHLORINE DISINFECTANT or once a month. {With SPA CHLORINE DISINFECTANT less shocking is required because it maintains a consistent level of sanitization even when people enter the hot tub.} {NOTE: If shocking every other week, you may turn the SPA CHLORINE DISINFECTANT dial down one setting to help extend the life of {SPA CHLORINE DISINFECTANT} {the sanitizer in the water}.

Before draining a treated hot tub contact your local sanitary sewer and storm drain authorities and follow their discharge instructions. Do not discharge hot tub water to any location that flows to a gutter or storm drain or natural water body unless discharge is allowed by state and local authorities.

REENTRY into treated hot tubs is prohibited above levels of 5 ppm available {free} chlorine as measured by a suitable test kit due to risk of bodily injury.

Product Description and Directions for Use with Swim Spas

Product Description: The SPA CHLORINE DISINFECTANT is a revolutionary way to maintain a low level of chlorine ~~tailor-made~~ for use with {53735-11 Brand Name} that reduce{s} chlorine use {up to 75%*}. {Together they make swim spa water care a breeze with up to 75% less chlorine* so the water feels softer and looks crystal clear with no smelly odors, no adding chlorine daily and no weekly shocking. Swimsuit colors stay bright and swim spa surfaces maintain their brilliance longer.}

Replace the Pool Frog Mineral Reservoir after 4 months or when draining and refilling swim spa with fresh water.

Directions for Use: It is a violation of Federal Law to use this product in a manner inconsistent with its labeling.

For use in swim spas up to {2500} {3000} gallons. Use only with the {53735-11 Brand Name}. Ensure all swim spa equipment is working properly. Operate the pump and filter as recommended by your swim spa manufacturer. Clean filter following manufacturer's directions. May be used with a previously filled swim spa unless it was sanitized with bromine or biguanides or the cyanuric acid level is above 80 ppm. If any of those conditions apply, drain and refill the swim spa with fresh water before using this product.

[OPTION A – VERSION 1 AND 2]

Simply follow these easy steps:

1. Remove outer packaging from the {53735-11 Brand Name} and SPA CHLORINE DISINFECTANT.
2. [VERSION 1] {Place {#} {53735-11 Brand Name} {pouch} {pod} {sachet} {bag} into one cartridge and {#} SPA CHLORINE DISINFECTANT into the other cartridge.} {Connect cartridges together} {Slide cartridges into {carrier} {housing} {holder} {station}}.
[VERSION 2] {Remove stickers from each end of SPA CHLORINE DISINFECTANT.} Align SPA CHLORINE DISINFECTANT with tab guides on {53735-11 Brand Name}. Push together until you hear the cartridge click into place. [Callout on sticker:] {Remove before using cartridge}
3. Adjust to setting number based on swim spa gallon size (see setting chart in manual). If a dual zone swim spa, set according to the gallons of the swimming area only.
4. Attach to side {railing} of swim spa {with the tether provided} and let it float in the swim spa.
5. If you like, remove {Brand} System from the swim spa while soaking or exercising. Lift out {Brand} System and let drain into the swim spa. Place on any surface not susceptible to chlorine bleaching. Remember to return it to the

swim spa afterwards.

[OPTION B]

Simply follow these easy steps:

1. Remove outer packaging from the {53735-11 Brand Name} and the SPA CHLORINE DISINFECTANT.
2. Place 1 {53735-11 Brand Name} {pouch} {pod} {sachet} {bag} in the {carrier} {housing} {holder} {station} along with a specific number of SPA CHLORINE DISINFECTANT {pouches} {pods} {sachets} {bags} based on gallon size per the chart in the manual:
3. Attach {carrier} {housing} {holder} {station} to side of swim spa with {suction cups} {over the side weight} {bracket} {straps}.
4. {Adjust to setting number based on swim spa gallon size (see setting chart in manual)}

Replacing Cartridges

- A. When the {product flips over} {{Brand} Test Strips indicate} {out indicator signal appears on the product} {that} the SPA CHLORINE DISINFECTANT is empty, remove the empty SPA CHLORINE DISINFECTANT {pouches} {pods} {sachets} {bags} {cartridges} and replace with {a} new one{s}.
- SPA CHLORINE DISINFECTANT will last {about} {up to} {2 to 3} {2 to 4} {3 to 4} {4} weeks for an average 2000 gallon swim spa depending on swim spa usage.
 - {This system naturally {lists} {sits at a tilt} in the water. To check if SPA CHLORINE DISINFECTANT is empty, lift up and drain all the water from the system {and set back in the swim spa to see if it flips over completely}. {You should be able to tell by looking if there is still SPA CHLORINE DISINFECTANT left in the cartridge.} {Disconnect SPA CHLORINE DISINFECTANT and shake to see if you can hear material inside.}
 - If only a small amount is left {add} {attach} a new SPA CHLORINE DISINFECTANT {pouch} {pod} {sachet} {bag} {cartridge} {and {hook} {attach} the old cartridge on the tether until it is completely empty}.
 - When empty, discard in trash or offer for recycling if available.
- B. After 4 months or when draining and refilling the swim spa, the {color} {53735-11 Brand Name} must be replaced even if you hear the spent minerals inside.

- {Keeping the pH in the proper range of 7.2 to {7.6} {7.8} will allow SPA CHLORINE DISINFECTANT to keep the free chlorine level between 0.5 and 1.0 ppm with little adjusting.} {To ensure the effectiveness of SPA CHLORINE DISINFECTANT, always maintain proper water balance.}
- {With SPA CHLORINE DISINFECTANT less shocking is required because it maintains a consistent level of sanitization even when people enter the swim spa.}

Before draining a treated swim spa, contact your local sanitary sewer and storm drain authorities and follow their discharge instructions. Do not discharge swim spa water to any location that flows to a gutter or storm drain or natural water body unless discharge is allowed by state and local authorities.

- {Keeping the pH in the proper range of 7.2 to {7.6} {7.8} will allow SPA CHLORINE DISINFECTANT to keep the free chlorine level between 0.5 and 1.0 ppm with little adjusting.} {To ensure the effectiveness of SPA CHLORINE DISINFECTANT, always maintain proper water balance.}

- {With SPA CHLORINE DISINFECTANT less shocking is required because it maintains a consistent level of sanitization even when people enter the swim spa.}

REENTRY into treated swim spas is prohibited above levels of 5 ppm available {free} chlorine as measured by a suitable test kit due to risk of bodily injury.

STORAGE AND DISPOSAL: Do not contaminate food or feed by storage and disposal.

Pesticide Storage: Keep this product dry in original tightly closed container when not in use. Store in a cool, dry, well-ventilated area away from heat. Moisture may decompose this product and cause a violent reaction leading to fire and explosion. In case of decomposition, isolate container, if possible, and flood area with large amounts of water to dissolve material before discarding this container

Pesticide Disposal: Product or rinsates that cannot be used must be diluted with water before disposal in a sanitary sewer.

Container Handling: Non-refillable container. Do not reuse or refill this container. Clean container promptly after emptying. Then offer for recycling if available or puncture and dispose of in a sanitary landfill, or by incineration.

[Disclaimers]

* Compared to the ANSI minimum recommended chlorine level of 2.0 ppm for a residential hot tub swim spa.

** Compared to daily shocking or shocking each time the hot tub swim spa is used

∞ For pools and hot tubs and swim spas

[Operational Instructions for In-Line System]

[All text is optional]

[Representative icons/graphic images may be represented next to each step of the instructions]

In-Line Sanitizing System Operating Instructions

{{Brand}} is the hot tub sanitizing system that takes the guess-work out of water care so you always feel at ease while enjoying your hot tub.

- {{Brand}} creates Fresh Mineral Water[∞] that's cleaner, clearer and softer.
- {{Brand}} employs SPA CHLORINE DISINFECTANT Technology that knows when and how much free chlorine is needed so it uses up to 75% less.*
- {{Brand}} requires far less shocking – only once a month!

[Callouts]: {53735-11 Brand Name} {{color}}, SPA CHLORINE DISINFECTANT {{color}}

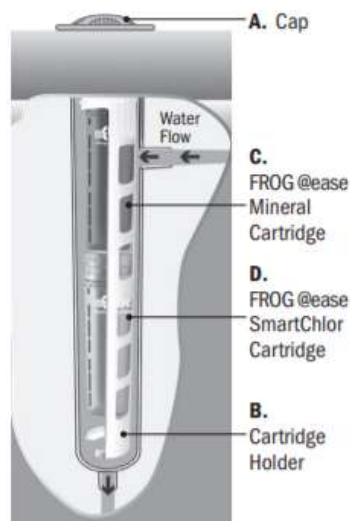

Cut-away view of cartridges snapped into holder and placed into the In-Line System.

This image and callout is optional

{The In-Line System is made up of (A) a cap that is easily distinguishable among the fittings on the top of the hot tub, (B) a cartridge holder that pulls out of the system, (C) a {53735-11 Brand Name} that helps control bacteria in the water and (D) a SPA CHLORINE DISINFECTANT that helps support the minerals while oxidizing contaminants like body oils and ammonia compounds responsible for smelly chloramines. The cartridges are adjustable to meet your specific hot tub water care needs.}

Step One: Prepare the Hot Tub

Water Balance Guidelines

pH:	7.2-7.6 {{Max: 7.8}}
Total Alkalinity:	80-{{100}} {{120}} ppm
{{Calcium}} {{Total}} Hardness:	150-250 ppm
Total Dissolved Solids:	<1500
Cyanuric Acid:	0-50 ppm {{Max: 80}}

1. {Fill hot tub with fresh water.} Have your dealer test your water before filling the hot tub. If using source water that is high in calcium, iron, or other metals, {see} your dealer {may recommend} {before filling the hot tub.} {It may require} the use of a metal control product. If previously using bromine and switching to {{Brand}}, you must drain and refill your hot tub before using this product. If previously using dichlor you may convert to {{Brand}} without having to drain the hot tub as long as the cyanuric acid level is below 80 ppm.
2. Clean or replace filter cartridges when dirty (*Follow manufacturer's instructions*).
3. Balance water by following steps a through d in order. **IMPORTANT:** Always follow printed instructions on the balancing chemical packages. Add balancing chemicals in

small increments one at a time with the jets on and wait {2} {6} hours before testing again and adding any additional balancing chemicals.

- a. Take a water sample from the hot tub and dip a {Brand} Test Strip into it.
- b. Look at the Total Alkalinity reading first. {Use {Brand Name}} {Adjustments should be made} to bring the Total Alkalinity in the range of 80 – {100} {120} ppm prior to making any adjustments to pH even if it throws pH off further. {Since pH tends to rise in hot tubs, maintaining a Total Alkalinity closer to the low end of 80 will make managing the hot tub easier.} {If your pH tends to fall, then maintain Total Alkalinity closer to {100} {120} ppm.}
- c. After Total Alkalinity is in range, test for pH. It should be between 7.2 and {7.6} {7.8}. If higher or lower, add {Brand Name} {a pH adjuster}. {Again, due to rising pH in hot tubs, try to maintain as close to the low end of 7.2 as possible.}
- d. {Lastly} test for Total Hardness {again. If you were able to use fill water low in hardness, you may now have to add {Brand Name} {Hardness Increaser} to maintain} {It should be} between 150 and 250 ppm. {If higher, partially drain the hot tub (about 6 inches) and fill with water low in calcium. If lower, add {Brand Name} {Calcium Increaser}.}

{If balancing takes longer than 2 days, shock the water {with {53735-12 Brand Name} {53735-13 Brand Name}} and maintain a chlorine level while continuing balancing.}

4. **Very Important!** After balancing and before using cartridges, {if you haven't already added a shock during balancing,} establish an initial residual of 0.5-1.0 ppm free chlorine with {53735-12 Brand Name} {53735-13 Brand Name} start-up shock, included in this package, {that quickly dissolves with an effervescent fizzing action} – one packet per 600 gallons.
5. Heat water to the manufacturers recommended temperature.

Step Two: Set the Cartridges

Remove the shrink wrap from both cartridges before proceeding.

- Set the {insert color} {53735-11 Brand Name} to #6 (hold the bottom and turn the top until 6 appears in the window). No further adjustments are necessary for the life of the cartridge.
- Set the {insert color} SPA CHLORINE DISINFECTANT to the setting that matches your hot tub size in gallons. SPA CHLORINE DISINFECTANT will maintain a low 0.5 to 1.0 ppm chlorine level as long as the pH stays within 7.2 and {7.6} {7.8} so there is little need to adjust the cartridge setting. If needed, you have two additional settings to increase output.

INITIAL START-UP SETTING

SPA CHLORINE DISINFECTANT Setting Chart	
Gallons	Setting #
X-X	#
X-X	#
X-X	#
X-X	#
{X-X}	{#}
{X-X}	{#}

[Note to reviewer: the hot tub gallon range in the setting chart will be between 200 and 600 gallons]

Step Three: Put the System to Work

[OPTION 1] {In-Line System}

1. Open cap of In-Line System and set aside. DO NOT OPEN CAP WHILE JETS ARE ON.
2. Remove holder by {pushing down and} turning counterclockwise {1/8th turn} before pulling out.
3. Snap the {53735-11 Brand Name} into the area marked “Minerals” (top portion) and the SPA CHLORINE DISINFECTANT into the area marked “Bromine or SmartChlor” (bottom portion) {making sure to line up the indentation at the top of the cartridges with the raised area on the holder}.

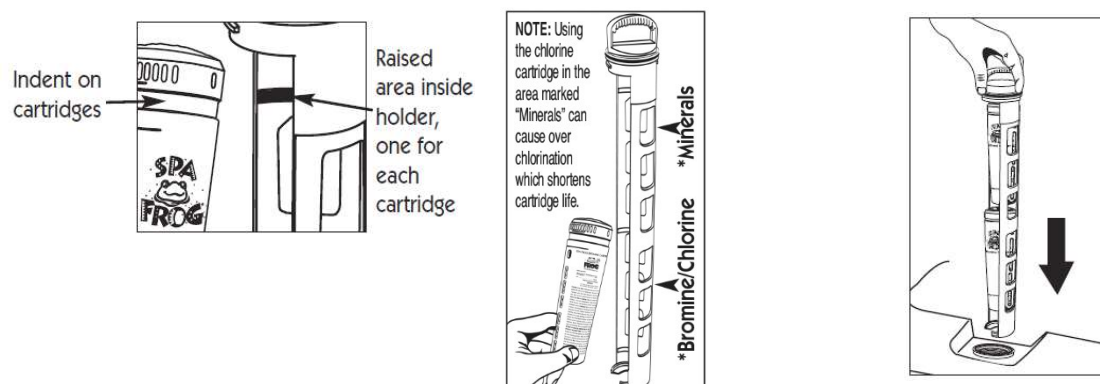

4. Slowly insert holder into system (see diagrams). {Line up holder arrow-① with system arrow-②.} Push down {until holder tabs-③ go past system tabs-④} and turn holder to the right (clockwise) until it stops. To ensure a locked position, attempt to pull holder up. If it stays in place, the lock is secure.

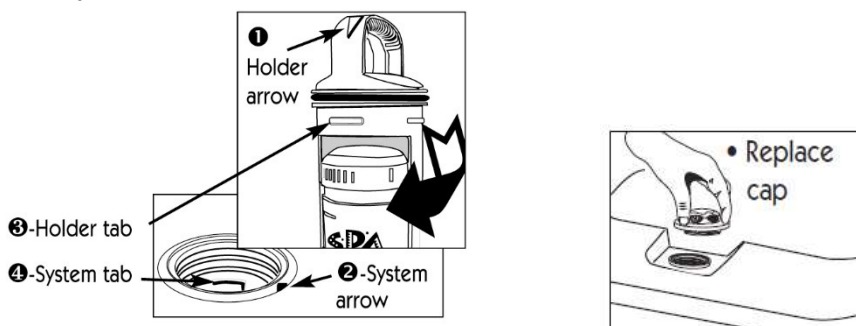

[OPTION 2] {Filter {Weir} {Basket} System}

- Insert {53735-11 Brand Name} into one opening of the {weir} {basket} and push down firmly until it {clicks} {snaps} {locks} in place securely. [Callout:] Openings for {Brand} Cartridges
- Insert SPA CHLORINE DISINFECTANT into the other opening in the same way.

Replacing Cartridges

- Replace {insert color} {53735-11 Brand Name} every four months or when draining and refilling the hot tub.

- Discard it in the trash even if it appears to have media left inside.
- Don't attempt to reuse: The minerals are spent after 4 months.
- Replace {insert color} SPA CHLORINE DISINFECTANT when empty based on the {Brand} test strip showing a lighter color than the out indicator on the {test strip} bottle.
 - The life of the cartridge varies depending on hot tub size and number of users. The SPA CHLORINE DISINFECTANT will last {about} {up to} {2 to 3} {2 to 4} {3 to 4} {4} weeks for an average 400 gallon hot tub.
 - Drain water from cartridge to ensure it is empty.
 - Discard in trash or offer for recycling if available.

Step Four: Routine Hot Tub Care:

{Always follow the directions for operating your particular hot tub.}

1. Drain and refill hot tub {as directed by your {hot tub manufacturer} {or every four months when {Brand} minerals need to be replaced}. {Whenever you drain and refill, make sure to replace your {Brand} Minerals.}
 - {To sign up for a subscription to receive Pool Frog Mineral Reservoir every 4 months, contact {Brand website}.}
2. Run filtration system as recommended by your {hot tub manufacturer to maintain proper water flow through the {In-Line} System.
3. Regularly test the water with {Brand} Test Strips and follow directions in Step One for maintaining pH, Total Alkalinity, {and {Calcium} {Total} Hardness} NOTE: pH is affected by bather load, chemicals used, evaporation and the make-up of your source water so maintaining water balance regularly is important.
4. SPA CHLORINE DISINFECTANT will maintain a 0.5 – 1.0 ppm free chlorine level as long as the water is balanced.

NOTE: Free chlorine levels are reduced up to 75%* when using {Brand} minerals.

NOTE: Why {Brand} Test Strips? The SPA CHLORINE DISINFECTANT forms a chlorine reserve that will be inaccurately measured as total chlorine on other test strips. Unlike conventional chlorine, the SPA CHLORINE DISINFECTANT reserve readily shifts to free chlorine as needed, maintaining hot tub health with a low level of chlorine.

5. Shock the hot tub with {Brand Name}, a non-chlorine shock for easy single-dose shocking when you replace the SPA CHLORINE DISINFECTANT or once a month. {Do not use a dichlor shock due to the build-up of cyanuric acid that will negatively affect SPA CHLORINE DISINFECTANT'S effectiveness.}

{NOTE: If shocking every other week, you may turn the SPA CHLORINE DISINFECTANT dial down one setting to help extend the life of {SPA CHLORINE DISINFECTANT} [the sanitizer in the water].}

6. Replace your SPA CHLORINE DISINFECTANT {when empty} and {replace} the complete {Brand} System (that comes with a {53735-11 Brand Name}) as directed under Step 3: Put the System to Work.
7. Lubricate In-Line holder o-ring twice a year with a silicone lubricant.

Troubleshooting

Cloudy Water or Low Chlorine Levels

- Shock the hot tub with {Brand Name}, a non-chlorine shock. {Do not use dichlor shock due to the build-up of cyanuric acid that will negatively affect SPA CHLORINE DISINFECTANT'S effectiveness.}
- Check water balance. pH and Total Alkalinity need to be in the proper ranges for the {Brand} System to work correctly
- Check SPA CHLORINE DISINFECTANT and replace if empty—see instructions under Step 3: Put the System to Work.
- If SPA CHLORINE DISINFECTANT is not empty, turn dial setting up 1 number while maintaining water balance. If needed turn dial up again.
- Check your calendar. The entire {Brand} {In-Line} System, including the a {53735-11 Brand Name}, needs to be replaced every four months. Without the minerals, SPA CHLORINE DISINFECTANT will not be enough to sanitize the hot tub.

SPA CHLORINE DISINFECTANT Life

- If hot tub is larger than 400 gallons with significant bather load, you may require a higher dial setting which will shorten cartridge life.
- If you think the cartridge setting is too high, you can turn the dial setting down 1 number while maintaining water balance. If needed turn the dial down again.

High Chlorine Levels

- This is highly unlikely with {Brand} because SPA CHLORINE DISINFECTANT is self-regulating. However, if you use standard test strips, it may appear that total chlorine is higher than the free chlorine.
- No worries—the strip is measuring the SPA CHLORINE DISINFECTANT reserve, which will shift to free chlorine as needed. Please always use the {Brand} Test Strips that were included with your System.

Learn more at frogproducts.com or call 800.222.0169

Register your In-Line System at frogproducts.com

Ver la versión en español de este manual en frogproducts.com

Made in USA

Patents: kingtechnology.com/IP

[Operational Instructions for Floating/Flipping System]

[All text is optional]

[Representative icons/graphic images may be represented next to each step of the instructions]

Floating Sanitizing System Operating Instructions

This is not a toy. For sanitizing {hot tubs} {swim spas} only! Keep out of reach of children when using the hot tub.

{Brand} is the hot tub sanitizing system that takes the guess-work out of water care so you always feel at ease while enjoying your hot tub.

{The {Brand} Floating System has two replaceable cartridges.

- Top Half {insert color} = {53735-11 Brand Name}
- Bottom Half {insert color} = SPA CHLORINE DISINFECTANT

The combination provides the Fresh Mineral Water[∞] benefits of cleaner, clearer and softer water that's easier to take care of.

Read entire operating instructions for complete directions for use.

Step One: Prepare the {Hot Tub} {Swims Spa}

1. {Fill {hot tub} {swim spa} with fresh water.} Have your dealer test your water before filling the {hot tub} {swim spa}. If using source water that is high in calcium, iron or other metals, {see} your dealer {may recommend} {before filling the {hot tub} {swim spa}}. {It may require} the use of a metal control product. If previously using bromine and switching to {Brand}, you must drain and refill your {hot tub} {swim spa} before using this product. If previously using dichlor you may convert to {Brand} without having to drain the {hot tub} {swim spa} as long as the cyanuric acid level is below 80 ppm.
2. Clean and replace filter cartridges when dirty (*Follow manufacturer's instructions*).
3. Balance water following steps a through d in order. IMPORTANT: Always follow printed instructions on the balancing chemical packages. Add balancing chemicals in small increments one at a time with the jets on and wait {2} {6} hours before testing again and adding any additional balancing chemicals.
 - a. Take a water sample from the {hot tub} {swim spa} and dip a {Brand} Test Strip into it.
 - b. Look at the Total Alkalinity reading first. {Use {Brand Name} {Adjustments should be made} to bring the Total Alkalinity in the range of 80 – {100} {120} ppm prior to making any adjustments to pH even if it throws pH off further. {Since pH tends to rise in hot tubs, maintaining a Total Alkalinity closer to the low end of 80 will make managing the hot tub easier.} {If your pH tends to fall, then maintain Total Alkalinity closer to {100} {120} ppm.}}
 - c. After Total Alkalinity is in range, test for pH. It should be between 7.2 and {7.6} {7.8}. If higher or lower, add {Brand Name} {a pH adjuster}. {Again, due to rising pH in {hot tubs} {swim spas}, try to maintain as close to the low end of 7.2 as possible.}}

Water Balance Guidelines

pH:	7.2 – 7.6 {(Max: 7.8)}
Total Alkalinity:	80 – {100} {120} ppm
{Total} Hardness:	150-250 ppm
Total Dissolved Solids:	<1500
Cyanuric Acid:	0-50 ppm {(Max: 80)}

- d. {Lastly} test for Total Hardness {again. If you were able to use fill water low in hardness, you may now have to add {Brand Name} {Hardness Increaser} to maintain} {It should be} between 150 and 250 ppm. {If higher, partially drain the {hot tub} {swim spa} (about 6 inches) and fill with water low in calcium. If lower, add {Brand Name} {Calcium Increaser}.}

{If balancing takes longer than 2 days, shock the water {with {53735-12 Brand Name} {53735-13 Brand Name}} and maintain a chlorine level while continuing balancing.}

4. **Very Important!** After balancing and before using cartridges, {if you haven't already added a shock during balancing,} establish an initial residual of 0.5-1.0 ppm free chlorine with {53735-12 Brand Name} {53735-13 Brand Name} start-up shock, {included in this package,} {that quickly dissolves with an effervescent fizzing action} – one packet per 600 gallons.
5. Heat water to the manufacturer's recommended temperature {before using cartridges}.

Step Two: Put the {Brand} System to Work:

INITIAL START-UP SETTING

{Brand Name} Setting Chart	
Gallons	Setting #
# – #	#
# - #	#
# - #	#
# - #	#
{# - #}	{#}
{# - #}	{#}

[Note to reviewer: The hot tub gallon range in the setting chart will be between 200 and 600 gallons while the swim spa gallon range will be between 1000 and 3000 gallons]

Simply follow these easy steps:

1. Remove outer packaging from the SPA CHLORINE DISINFECTANT.
2. **[OPTION 1:]** Line up arrows on both cartridges, push together and lock.
[OPTION 2:] Insert {53735-11 Brand Name} into the section of the reusable holder that fits that shape. Make sure it snaps in securely. Insert the SPA CHLORINE DISINFECTANT into the other section in the same way.
3. Twist the dial on the SPA CHLORINE DISINFECTANT to the setting number for your {hot tub} {swim spa} (see chart based on gallons). [Diagram Callout: Setting # on the SPA CHLORINE DISINFECTANT]
4. Toss into the {hot tub} {swim spa}. It will float in the water at a slight tilt. {Multiple systems may be used for larger gallons (2 up to 1200 gallons, 3 up to 1800 gallons, etc.).}
5. If you like, remove {Brand} from the {hot tub} {swim spa} while soaking. Lift out {Brand} and let drain into the {hot tub} {swim spa}. Place on any surface not susceptible to chlorine bleaching. Remember to return it to the {hot tub} {swim spa} afterwards.

Replacing Cartridges

- A. When the {Brand} Floating System flips completely over, remove the {insert color}

SPA CHLORINE DISINFECTANT.

- SPA CHLORINE DISINFECTANT will last about {up to} {2 to 3} {2 to 4} {3 to 4} {4} weeks for an average {400 gallon hot tub} {or 2000 gallon swim spa}
 - Floating System naturally {lists} {tilts} in the water. To check if SPA CHLORINE DISINFECTANT is empty, lift up and drain all water from the system, then replace in the {hot tub} {swim spa} and see if it flips completely.
 - Detach SPA CHLORINE DISINFECTANT by twisting to align with “unlock” arrow and pull apart.
 - Attach new cartridge (see Step 2: Put the System to Work). {If using multiple systems, one may flip over before the other. Always replace SPA CHLORINE DISINFECTANT as soon as each system flips over.} {Do not wait for both to flip before replacing SPA CHLORINE DISINFECTANT.}
 - Discard in trash or offer for recycling if available. NOTE: If the SPA CHLORINE DISINFECTANT still contains a small amount after detaching, place in {hot tub} {swim spa} to float on its own until empty. Do not let it sink to bottom as it may bleach {hot tub} {swim spa} surface.
- B. After 4 months or when draining and refilling the {hot tub} {swim spa}, the {insert color} {53735-11 Brand Name} must be replaced even if you hear the spent minerals inside. This cartridge is available only in the {Brand System}.

Step Three: Routine {Hot Tub} {Swim Spa} Care

1. Drain and refill {hot tub} {swim spa} as directed by your {hot tub} {swim spa} manufacturer {or every four months when {Brand} minerals need to be replaced}. Whenever you drain and refill, make sure to replace your {Brand} Minerals.
2. Run filtration system as recommended by your {hot tub} {swim spa} manufacturer.
3. Regularly test water with {Brand} Test Strips and follow directions in Step One for maintaining pH, Total Alkalinity, and {Calcium} {Total} Hardness.

NOTE: pH is affected by bather load, chemicals used, evaporation and the make-up of your source water so maintaining water balance regularly is important.

4. SPA CHLORINE DISINFECTANT will maintain a 0.5 to 1.0 ppm free chlorine level as long as the water is balanced.

NOTE: Free chlorine levels are reduced up to 75%* when using {Brand} minerals.

NOTE: Why {Brand} Test Strips? The SPA CHLORINE DISINFECTANT forms a chlorine reserve that will be inaccurately measured as total chlorine on other test strips. Unlike conventional chlorine, the SPA CHLORINE DISINFECTANT reserve readily shifts to free chlorine as needed, maintaining {hot tub} {swim spa} health with a low level of chlorine.

5. Shock the {hot tub} {swim spa} with {Brand Name}, a non-chlorine shock for easy single-dose shocking when you replace the SPA CHLORINE DISINFECTANT, or once a month. {Do not use a dichlor shock due to the buildup of cyanuric acid that will negatively affect {53735-14 Brand Name}'s effectiveness.}

{NOTE: If shocking every other week, you may turn the SPA CHLORINE DISINFECTANT dial down one setting to help extend the life of {SPA CHLORINE DISINFECTANT} {the sanitizer in the water}.}

6. Replace the SPA CHLORINE DISINFECTANT when the system flips over and **{replace}** the complete {Brand} System that includes a {53735-11 Brand} as directed under {Replacing Cartridges} {Step 2: Put the System to Work}.

Troubleshooting

Cloudy Water or Low Chlorine Levels

- Shock the {hot tub} {swim spa} with {Brand Name}, a non-chlorine shock. {Do not use a dichlor shock due to the buildup of cyanuric acid that will negatively affect {53735-14 Brand Name}'s effectiveness.}
- Check water balance. pH and Total Alkalinity need to be in the proper ranges for the {Brand} System to work correctly.
- Check SPA CHLORINE DISINFECTANT and replace if empty—see instructions under {Replacing Cartridges} {Step 2: Put{ting} the System to Work}.
- If SPA CHLORINE DISINFECTANT is not empty, turn dial setting up one number while maintaining water balance. If needed turn the dial up again.
- Check your calendar. The entire {Brand} System, including **the a** {53735-11 Brand Name}, needs to be replaced every four months. Without the minerals, SPA CHLORINE DISINFECTANT will not be enough to sanitize the {hot tub} {swim spa}.

SPA CHLORINE DISINFECTANT Life

- If {hot tub is larger than 400 gallons} {swim spa is larger than 2000 gallons) with significant bather load, you may require a higher dial setting which will shorten cartridge life.
- If you think the cartridge setting is too high, you can turn the dial setting down one number while maintaining water balance. If needed turn the dial down again.
- If {Brand} system is continually sucked into the skimmer or filter well, tether the product to the tub away from the jets.
- Remove {Brand} system while using the hot tub with the jets running.

High Chlorine Levels

- This is highly unlikely with {Brand System} because SPA CHLORINE DISINFECTANT is self-regulating. However, if you use standard test strips, it may appear that total chlorine is higher than the free chlorine.
- No worries—the strip is measuring the SPA CHLORINE DISINFECTANT reserve, which will shift to free chlorine as needed. Please always use the {Brand} Test Strips that were included with your System.

Learn more at frogproducts.com or call 800.222.0169

Register your {Brand System} at frogproducts.com

Ver la versión en español de este manual en frogproducts.com

Made in USA

Patents: kingtechnology.com/IP

[Operational Instructions for {Filter Well} Systems]

[All text is optional]

[Representative icons/graphic images may be represented next to each step of the instructions]

{Brand} Sanitizing System Operating Instructions {for Brand Spas}

{Brand} is a hot tub sanitizing system custom designed for {Brand Spas} {brand products} {with} {featuring} {Brand Filter} {System} that takes the guess-work out of water care so you always feel at ease while enjoying your hot tub.

{The {Brand} System has two replaceable cartridges.

- {left} {Insert Color} = {53735-11 Brand Name}
- {right} {Insert Color} = SPA CHLORINE DISINFECTANT

{Classic Cartridges (triangle)} {Simplicity Cartridges (round)}

The combination provides the Fresh Mineral Water[∞] benefits of cleaner, clearer and softer water that's easier to take care of.

Read entire operating instructions for complete directions for use.

Step One: Prepare the Hot Tub

1. {Fill hot tub with fresh water.} Have your dealer test your water before filling hot tub. If using source water that is high in calcium, iron or other metals, {see} your dealer {may recommend} {before filling the tub}. {It may require} the use of a metal control product. If previously using bromine and switching to SPA CHLORINE DISINFECTANT, you must drain and refill your hot tub before using this product. If previously using dichlor you may convert to SPA CHLORINE DISINFECTANT without having to drain the hot tub as long as your cyanuric acid level is below 80 ppm.
2. Clean or replace filter cartridges when dirty (*Follow manufacturer's instructions*).
3. Balance water following steps a through d in order. IMPORTANT: Always follow printed instructions on the balancing chemical packages. Add balancing chemicals in small increments one at a time with the jets on and wait {2} {6} hours before testing again and adding any additional balancing chemicals.
 - a. Take a water sample from the hot tub and dip a {Brand} Test Strip into it.
 - b. Look at the Total Alkalinity reading first. {Use {Brand Name}} {Adjustments should be made} to bring the Total Alkalinity in the range of 80 – {100} {120} ppm prior to making any adjustments to pH even if it throws pH off further. {Since pH tends to rise in hot tubs, maintaining a Total Alkalinity closer to the low end of 80 will make managing the hot tub easier.} {If your pH tends to fall, then maintain Total Alkalinity closer to {100} {120} ppm.}
 - c. After the Total Alkalinity is in range, test for pH. It should be between 7.2 and {7.6} {7.8}. If higher or lower, add {Brand Name} {a pH adjuster}. {Again, due

Water Balance Guidelines

pH:	7.2-7.6 {(Max: 7.8)}
Total Alkalinity:	80-{100} {120} ppm
{Calcium}{Total} Hardness:	150-250 ppm
Total Dissolved Solids:	<1500
Cyanuric Acid:	0-50 ppm {(Max: 80)}

to rising pH in hot tubs, try to maintain as close to the low end of 7.2 as possible.}

- d. Lastly test for Total Hardness {again. If you were able to use fill water low in hardness, you may now have to add {Brand Name} {Hardness Increaser} to maintain} {It should be} between 150 and 250 ppm. {If higher, partially drain the hot tub (about 6 inches) and fill with water low in calcium. If lower, add {Brand Name} {Calcium Increaser}.}

{If balancing takes longer than 2 days, shock the water {with {53735-12 Brand Name} {53735-13 Brand Name}} and maintain a chlorine level while continuing balancing.}

4. **Very Important!** After balancing and before using cartridges, {if you haven't already added a shock during balancing,} establish an initial residual of 0.5-1.0 ppm free chlorine with {53735-12 Brand Name} {53735-13 Brand Name} start-up shock, included in this package, {that quickly dissolves with an effervescent {fizzing} action} – one packet per 600 gallons.
5. Heat water to the manufacturers recommended temperature

Step Two: Set{ting} the Cartridges

{SPA CHLORINE DISINFECTANT} Setting Chart} {For {Classic} {Simplicity} {Cartridges} x Shaped {Cartridge}}		
{Brand} Models	{Gallons}	Setting #
a, b, c	{x-x}	#
d, e, f	{x-x}	#
g, h, i	{x-x}	#
j, k, l	{x-x}	#
m, n, o	{x-x}	#
p, q, r	{x-x}	#
s, t, u	{x-x}	#

[Note to reviewer: the hot tub gallon range in the setting chart will be between 200 and 600 gallons]

- Remove the SPA CHLORINE DISINFECTANT from its bag before proceeding.
- Set the {insert color} {53735-11 Brand Name} to {#} {the highest setting} using the dial {on the bottom} of the cartridge. No further adjustments are necessary for the life of the cartridge.
- Set the {insert color} SPA CHLORINE DISINFECTANT to the setting that matches your hot tub {model number} {or} {size in gallons} {and the type of cartridge being used}. If needed, you may increase or decrease the dial setting.
- Once set, the SPA CHLORINE DISINFECTANT will maintain a low 0.5 to 1.0 ppm chlorine level as long as the pH stays within 7.2 and {7.6} {7.8} so there is little need to adjust the cartridge setting.

Step Three: Put the System to Work

[OPTION FOR BRAND A SPAS SERIES X] For {Brand} {#, # and #} Series {Between filter cartridges}

- Remove filter snap cap.
- Hold weir door/filter plate out into the hot tub slightly or remove from the hot tub.
- If cartridge {holder} {carrier} {caddy} is already installed between the filter cartridges, remove by pulling up on the handle.
- Snap the {53735-11 Brand Name} into one opening of the cartridge {holder} {carrier} {caddy}. With the {Brand} logo facing the {holder} {carrier} {caddy}, put the dial end of cartridge into the {holder} {carrier} {caddy} first by connecting the tab on the {holder} {carrier} {caddy} with the indent in the cartridge.
- Then push the top part of the cartridge in until it snaps into place.
- Follow the same procedure for the SPA CHLORINE DISINFECTANT into the other opening.
- With the {insert color} SPA CHLORINE DISINFECTANT facing the inside of the hot tub, insert cartridge {holder} {carrier} {caddy} between the filter cartridges under the weir door/filter plate pushing down until it stays in place.
- Replace filter snap cap.

[Callouts for this section] Dial end of Cartridge, {Holder} {Carrier} {Caddy}, Detail of Cartridge, {Holder} {Carrier} {Caddy} Tab, Cartridge Top, {53735-11 Brand Name}, SPA CHLORINE DISINFECTANT

[OPTION FOR BRAND A SPAS SERIES XX] For {Brand} {#, # and #} Series {with {using} {Brand} Filter} {Holder} {Housing} {System}} {Using the {Brand} Filter LidSystem}

- {Turn off main power to the hot tub and} remove the JetPak {covering the {Brand} Filter {Holder} {System}} {that is usually} {to the right of the main control} {panel}}.
- {Remove {Brand} Filter {Holder} {System} by taking hold of the handle, {pushing it into the hot tub} {pulling it away from the side of the hot tub} and lift out.}
- {Remove cap from SPA CHLORINE DISINFECTANT and {53735-11 Brand Name} by squeezing the bottom and turning.}
- Insert {53735-11 Brand Name} and SPA CHLORINE DISINFECTANT into the two openings {on the outside of the {Brand} Filter {Holder} {Housing} {System}} {provided in the {Brand} Filter {Holder} {System}} {below the filter cartridge}. Push cartridges in until they {are latched} {lock into position} {snap into place}.
 - {If using the {Brand Cartridges} with the {Brand} {Holder} {Housing}, ask your dealer for an adapter clip that will allow the triangle shaped cartridges to work.}
- To remove cartridges, {push them in {and lift up to release from lock} {until they are free of the latches}, then slide them out} {pull up {on one end} {at the top} of cartridge and lift out}.
- Replace {{Brand} Filter {Holder} {System} and} {the} JetPak{ over it. Turn on main power.}
- {For swim spas with 2 {Brand} Filters, insert x {53735-11 Brand Name} and x SPA CHLORINE DISINFECTANT into the openings {in the 2 {Brand} Filter {Holders} {Systems}} {below each filter cartridge}. {Push cartridges in until they are latched.}}

[Callouts for this section] {Brand} Filter {Holder} {Housing}, Two openings for cartridges, Cartridges installed, Latches, Pull Up, {Brand System}

[OPTION FOR BRAND B SPAS]

- Remove the filter cover.
- If the {Brand} {holder} {carrier} {caddy} is already installed, remove {holder} {carrier} {caddy} by pulling up and away from filter cartridge using the handle at the top of the {holder} {carrier} {caddy}.
- Open the arms of the {holder} {carrier} {caddy} until they snap into position. The handle with the {Brand} logo is the top of the {holder} {carrier} {caddy}.
- Inserting the {53735-11 Brand Name} into the {holder} {carrier} {caddy}: Place the bottom of the rounded edge of the cartridge into the front of the lower opening of the {holder} {carrier} {caddy} and push the cartridge back until it locks into place.
- Follow the same procedure with the SPA CHLORINE DISINFECTANT in the upper opening.
- NOTE: To remove cartridges tilt away from the {holder} {carrier} {caddy} by pulling at the center top of the cartridge rather than the sides.
- Unscrew both hot tub filter cartridges to find the one that does not have a grid underneath it. Once determined, screw both filter cartridges back in place.
- Installing the {Brand} {holder} {carrier} {caddy}: With the {Brand} cartridges facing the inside of the hot tub and the handle of the {holder} {carrier} {caddy} at the top, slide the {holder} {carrier} {caddy} down over the filter cartridge that does NOT have the grid underneath it until it covers the entire length of the filter cartridge. If necessary, spread the arms on the {holder} {carrier} {caddy} to get them around the filter cartridge.
 - NOTE: On some {Brand} Spas, the filter cartridge over the grid is a 2-part cartridge system with a plastic base. Always install the {Brand} cartridge {holder} {carrier} {caddy} on the 1-piece filter cartridge.
- In order to re-install the filter cover, you must first rotate the {Brand} {holder} {carrier} {caddy} by pulling the top part out about 1/2" away from the filter cartridge and turning the {holder} {carrier} {caddy} until it touches the other filter cartridge.
- Re-install the filter cover.

[OPTION FOR BRAND B SPAS FLOATER] Simply follow these easy steps:

- Insert the {two cartridges} {{53735-11 Brand Name} and {SPA CHLORINE DISINFECTANT}} into the {holder} {carrier} {caddy} one at a time. Put bottom of cartridge into {holder} {carrier} {caddy} bracket with setting dial facing out. Then push cartridge in place.
- Place into the hot tub to float.
- If you like, remove {Brand} System from the hot tub while soaking. Lift out {Brand} System and let drain into the hot tub. Place on any surface not susceptible to chlorine bleaching. Remember to return it to the hot tub afterwards.

[OPTION FOR BRAND C SPAS]

- Remove the filter lid.
- {Attach the adaptor to the back of the {holder} {carrier} {caddy} by inserting the tabs on the adaptor into the large opening in the {holder} {carrier} {caddy} and rotating clockwise until it clicks in place.}
- Installing the {Brand} cartridge {holder} {carrier} {caddy}: With the filter cartridge in place, slide the {Brand} {holder} {carrier} {caddy} down over the pipe where the nut is that holds the filter cartridge on.
- Make sure the openings for the {Brand} cartridges are facing the filter area and the fin on the {Brand} {holder} {carrier} {caddy} goes between two pleats on the filter

cartridge. Push the {holder} {carrier} {caddy} down using the top handle until it snaps in place.

- Inserting the {53735-11 Brand Name} into the {holder} {carrier} {caddy}: Place the bottom of the rounded edge of the cartridge into the front of the {holder} {carrier} {caddy} opening closest to the outside of the hot tub and push the cartridge back until it locks into place.
- Follow the same procedure to insert the SPA CHLORINE DISINFECTANT in the opening closest to the inside of the hot tub. NOTE: To remove cartridges, tilt away from the {holder} {carrier} {caddy} by pulling at the center top of the cartridge rather than the sides.
- Make sure the cartridges are completely under water. If not, add water to the hot tub until the cartridges are covered.
- Re-install the filter lid.

[Callouts for this section] Nut, Pipe, Wall of filter well, Fin, Insert, Remove, Back of holder, Adaptor tab, attach and rotate clockwise, front of holder with adaptor in place

[OPTION D]

- Remove the filter {lid} {cover}.
- Insert {Brand} {holder} {carrier} {caddy} in the filter well area per the diagram
- Snap {53735-11 Brand Name} into one opening and SPA CHLORINE DISINFECTANT into the other opening.
- Re-install the filter {lid} {cover}.

Replacing Cartridges

- Replace {insert color} {53735-11 Brand Name} every four months or when draining and refilling the hot tub
 - Discard it in the trash even though you will hear the spent media left inside
 - Don't attempt to reuse: the minerals are spent after 4 months
- Replace {insert color} SPA CHLORINE DISINFECTANT when empty based on the {Brand} Test Strip showing a lighter color than the out indicator on the {test strip} bottle.
 - The life of the cartridge varies depending on hot tub size and number of users.
 - SPA CHLORINE DISINFECTANT will last {about} {up to} {2 to 3} {2 to 4} {3 to 4} {4} {weeks} {1 month} {for an average 400 gallon hot tub}.
 - Drain water from cartridge to ensure it is empty
 - Discard in trash or offer for recycling if available

Step Four: Routine Hot Tub Care

1. Drain and refill hot tub as directed by your hot tub manufacturer {or every four months when {Brand} minerals need to be replaced}. {Whenever you drain and refill, make sure to replace your {Brand} Minerals.}
2. Run filtration system as recommended by your hot tub manufacturer to maintain proper water flow through the system.
3. Regularly test water with {Brand} Test Strips and follow directions in Step One for maintaining pH, Total Alkalinity and {Calcium} {Total} Hardness.

NOTE: pH is affected by bather load, chemicals used, evaporation and the make-up of your source water so maintaining water balance regularly is important.

4. SPA CHLORINE DISINFECTANT will maintain a 0.5 – 1.0 ppm free chlorine level as long as the water is balanced.

NOTE: Free chlorine levels are reduced up to 75%* when using {Brand} minerals.

{NOTE: Why {Brand} Test Strips? The SPA CHLORINE DISINFECTANT forms a chlorine reserve that will be inaccurately measured as total chlorine on other test strips. Unlike conventional chlorine, the SPA CHLORINE DISINFECTANT reserve readily shifts to free chlorine as needed, maintaining hot tub health with a low level of free chlorine.

5. Shock the hot tub with {Brand Name}, a non-chlorine shock for easy single-dose shocking when you replace the SPA CHLORINE DISINFECTANT Cartridge or once a month. {Do not use a dichlor shock due to the build-up of cyanuric acid that will negatively affect SPA CHLORINE DISINFECTANT's effectiveness.}

{NOTE: If shocking every other week, you may turn the SPA CHLORINE DISINFECTANT dial down one setting to help extend the life of {SPA CHLORINE DISINFECTANT} {the sanitizer in the water}.}

6. Replace your SPA CHLORINE DISINFECTANT {when empty} and {replace the} complete {Brand} system (that comes with a {53735-11 Brand Name}) as directed under Step 3: Put the System to Work.
7. {Parts of the filter {including the filter cap} may discolor during use. This is normal. Follow manufacturer guidelines for filter replacement.} {It is normal for {parts of} the filter {cap} to discolor over time.} {Filter {cap} discoloration may occur.}

Troubleshooting

Cloudy Water {or Low Chlorine Levels}

- Shock the hot tub with {Brand Name} {or} {a} {non-chlorine shock}. {Do not use a dichlor shock due to the buildup of cyanuric acid that will negatively affect {53735-14 Brand Name}'s effectiveness.}
- Check water balance. pH and Total Alkalinity need to be in the proper ranges for the {Brand} System to work correctly. {Since pH tends to rise in hot tubs, maintain Total Alkalinity and pH closer to the lower end of the ideal range on the {Brand} Test Strip.}
- Check SPA CHLORINE DISINFECTANT and replace if empty—see instructions under Step 3: Put the System to Work.
- If SPA CHLORINE DISINFECTANT is not empty, turn dial setting up one number while maintaining water balance. If needed turn dial up again.
- Check your calendar. The entire {Brand} System, including a {53735-11 Brand Name}, needs to be replaced every four months. Without the minerals, SPA CHLORINE DISINFECTANT will not be enough to sanitize the hot tub.

SPA CHLORINE DISINFECTANT Life

- If hot tub is larger than 400 gallons with significant bather load, you may require a higher dial setting which will shorten cartridge life.
- If you think the cartridge setting is too high, you can turn the dial setting down one number while maintaining water balance. If needed turn dial down again.

High Chlorine Levels

- This is highly unlikely with {Brand} System because SPA CHLORINE

DISINFECTANT is self-regulating. However, if you use standard test strips, it may appear that total chlorine is higher than the free chlorine.

- No worries—the strip is measuring the SPA CHLORINE DISINFECTANT reserve, which will shift to free chlorine as needed. Please always use the {Brand} Test Strips that were included with your System.

{Brand Spas} and {Brand System} are registered trademarks of {Brand}

Learn more at frogproducts.com or call 800.222.0169

Register your {Brand} Sanitizing System at frogproducts.com

Ver la versión en español de este manual en frogproducts.com

Made in USA

Patents: kingtechnology.com/IP

Operational Instructions for Swim Spas

[All text is optional]

[Representative icons/graphic images may be represented next to each step of the instructions]

Sanitizing System for Swim Spas Operating Instructions

This is not a toy. For sanitizing swim spas only! Keep out of reach of children when using the swim spa.

{Brand} is the swim spa sanitizing system that takes the guess-work out of water care, so you always feel at ease while enjoying your swim spa.

{53735-11 Brand Name} Directions for Use: For use in {the swimming area of} swim spas up to {2500} {3000} gallons (not including an {add on} {attached} hot tub). Use with the SPA CHLORINE DISINFECTANT. Ensure all swim spa equipment is working properly. Operate the pump and filter as recommended by your swim spa manufacturer. Clean filter following manufacturer's directions. May be used with a previously filled swim spa unless it was sanitized with bromine or biguanides or the cyanuric acid level is above 80 ppm. If any of those conditions apply, drain and refill the swim spa with fresh water before using this product.

Read entire operating instructions for complete directions for use

Step One: Prepare the Swim Spa

1. Have your dealer test your water before filling the swim spa. If using source water that is high in total hardness, iron or other metals, your dealer may recommend the use of a metal control product. If previously using bromine and switching to {Brand System}, you must drain and refill your swim spa before using this product. If previously using dichlor you may convert to {Brand System} without having to drain the swim spa as long as the cyanuric acid level is below 80 ppm.
2. Clean or replace filter cartridges when dirty (*Follow manufacturer's instructions*).
3. Balance water following steps a through d in order. IMPORTANT: Always follow printed instructions on the balancing chemical packages. Add balancing chemicals in small increments one at a time with the jets on and wait {2} {6} hours before testing again and adding any additional balancing chemicals.
 - a. Take a water sample from the swim spa and dip a {Brand} Test Strip into it.
 - b. Look at the Total Alkalinity reading first. {Use {Brand Name}} {Adjustments should be made} to bring the Total Alkalinity in the range of 80 – {100} {120} ppm prior to making any adjustments to pH even if it throws pH off further. {Since pH tends to rise in swim spas, maintaining a Total Alkalinity closer to the low end of 80 will make managing the swim spa easier.} {If your pH tends to fall, then maintain Total Alkalinity closer to {100} {120} ppm.}
 - c. After Total Alkalinity is in range, test for pH. It should be between 7.2 and {7.6} {7.8}. If higher or lower, add {Brand Name} {a pH adjuster}. {Again, due to rising pH in swim spas, try to maintain as close to the low end of 7.2 as possible.}
 - d. {Lastly} test for Total Hardness again. If you were able to use fill water low in

Water Balance Guidelines

pH:	7.2 – 7.6 {(Max: 7.8)}
Total Alkalinity:	80 – {100} {120} ppm
Total Hardness:	150-250 ppm
Total Dissolved Solids:	<1500
Cyanuric Acid:	0-50 ppm {(Max: 80)}

hardness, you may now have to add {Brand Name} {Hardness Increaser} to maintain between 150 and 250 ppm.

If balancing takes longer than 2 days, shock the water {with {53735-12 Brand Name} {53735-13 Brand Name}} and maintain a chlorine level while continuing balancing.

4. **Very Important!** After balancing and before using cartridges, {if you haven't already added a shock during balancing} establish an initial residual of 0.5-1.0 ppm free chlorine with {{53735-12 Brand Name} {53735-13 Brand Name} {start-up shock} {included in this package} {that quickly dissolves with an effervescent fizzing action} – one packet per X gallons}} {5 Tablespoons of dichlor}. {Always add shock while running the jets and then wait 2 hours to test the water again.}
5. Heat water to the swim spa manufacturer's recommended temperature before using this product. {Always maintain a temperature of at least X degrees but no higher than the swim spa manufacturer's recommendation.}

Step Two: Put the System To Work

The {Brand} {Floating} System has two replaceable {components} {cartridges} {sanitizers}.

- {insert color} = {53735-11 Brand Name}
- {insert color} = SPA CHLORINE DISINFECTANT

The combination provides the Fresh Mineral Water[∞] benefits of cleaner, clearer and softer water that's easier to take care of.

[OPTION 1 – VERSION A AND B]

Simply follow these easy steps:

1. Remove outer packaging from the {53735-11 Brand Name} and SPA CHLORINE DISINFECTANT. {NOTE: Small mineral particles may have dislodged from the {53735-11 Brand Name} in shipping. Simply discard particles in trash.}
2. **[VERSION A]** {Place {#} {53735-11 Brand Name} {pouch} {pod} {sachet} {bag} into one cartridge and {#} SPA CHLORINE DISINFECTANT into the other cartridge.} {Connect cartridges together} {Slide cartridges into {carrier} {housing} {holder} {station}.

[VERSION B] {Remove stickers from both ends of SPA CHLORINE DISINFECTANT.} Align the SPA CHLORINE DISINFECTANT with tab guides on the {53735-11 Brand Name}. Push together until you hear the cartridge click into place. [CALLOUTS:] Tabs, Tab Guides {Stickers on cartridge}

3. Adjust to setting number based on swim spa gallon size (see setting chart). If a dual zone swim spa, set according to the gallons of the swimming area only.

{SPA CHLORINE DISINFECTANT} Setting Chart		
Gallons	Setting #	{Setting # if shocking twice a month}
X – X	#	#
X – X	#	#
X – X	#	#

X – X	#	#
X - X	#	#
X - X	#	#

[Note to Reviewer: The swim spa gallon range will be between 1000 and 3000 gallons]

4. Attach to {side} {railing} of swim spa {with the tether provided} and let it float in the swim spa.
5. If you like, remove {Brand} System from the swim spa while soaking or exercising. Lift out {Brand} System and let drain into the swim spa. Place on any surface not susceptible to chlorine bleaching. Remember to return it to the swim spa afterwards.

Replacing Cartridges

- A. When the {product flips over} {{Brand} Test Strips indicate} {out indicator signal appears on the product} the SPA CHLORINE DISINFECTANT is empty; remove the empty SPA CHLORINE DISINFECTANT {pouch} {pod} {sachet} {bag} {cartridge} and replace with a new one.
 - SPA CHLORINE DISINFECTANT will last {about} {up to} {2 to 3} {2 to 4} {3 to 4} {4} weeks for an average 2000 gallon swim spa depending on swim spa usage.
 - This system naturally {lists} {sits at a tilt} in the water. To check if SPA CHLORINE DISINFECTANT is empty, lift up and drain all the water from the system {and set back in the swim spa to see if it flips over completely}. {You should be able to tell by looking; if there is still SPA CHLORINE DISINFECTANT left in the cartridge.} {Disconnect SPA CHLORINE DISINFECTANT and shake to see if you can hear material inside.}
 - If only a small amount is left {add} {attach} a new SPA CHLORINE DISINFECTANT {pouch} {pod} {sachet} {bag} {cartridge} {and hook the old cartridge on the tether until it is completely empty}.
 - When empty, discard in trash or offer for recycling if available.
- B. After 4 months or when draining and refilling the swim spa, the {color} {53735-11 Brand Name} must be replaced even if you hear the spent minerals inside.

[OPTION 2]

Simply follow these easy steps:

1. Remove outer packaging from the {53735-11 Brand Name} and the SPA CHLORINE DISINFECTANT.
2. Place 1 {53735-11 Brand Name} {pouch} {pod} {sachet} {bag} in the {carrier} {housing} {holder} {station} along with a specific number of SPA CHLORINE DISINFECTANT {pouches} {pods} {sachets} {bags} based on gallon size per the chart below:

SPA CHLORINE DISINFECTANT Chart		
Gallons	{# of Pouches}	{Setting #}
X – X	#	#
X – X	#	#
X – X	#	#

X – X	#	#
X-X	#	#
X-X	#	#

[Note to Reviewer: The swim spa gallon range will be between 1000 and 3000 gallons]

3. Attach {carrier} {housing} {holder} {station} to side of swim spa with {suction cups} {over the side weight} {bracket} {straps}.
4. {Adjust to setting number based on swim spa gallon size (see setting chart).}

Replacing Cartridges

- A. When the {{Brand} Test Strips indicate} {out indicator signal appears on the product} that the SPA CHLORINE DISINFECTANT is empty, remove the empty SPA CHLORINE DISINFECTANT {pouches} {pods} {sachets} {bags} and replace with new ones.
 - SPA CHLORINE DISINFECTANT will last {about} {up to} {2 to 3} {2 to 4} {3 to 4} {4} weeks for an average 2000 gallon swim spa depending on swim spa usage.
 - When empty, discard pouch in trash.
- B. After 4 months or when draining and refilling the swim spa, the {53735-11 Brand Name} must be replaced even if you hear the spent minerals inside the pouch.

Step Three: Routine Swim Spa Care

- Drain and refill swim spa as directed by your swim spa manufacturer. Whenever you drain and refill, make sure to replace your {Brand} Minerals.
- Run filtration system as recommended by your swim spa manufacturer {or at least 3 hours per day}.
- Regularly test water with {Brand} Test Strips and follow directions in Step 1: Prepare the Swim Spa for maintaining pH, Total Alkalinity and Total Hardness.

NOTE: pH is affected by weather, bather load, chemicals used, evaporation and the make-up of your source water so maintaining water balance regularly is important.

- SPA CHLORINE DISINFECTANT will maintain a 0.5 to 1.0 ppm free chlorine level as long as the water is balanced.

NOTE: Free chlorine levels are reduced up to 75%* when using {53735-11 Brand Name} with SPA CHLORINE DISINFECTANT.

{NOTE: Why {Brand} Test Strips? The SPA CHLORINE DISINFECTANT forms a chlorine reserve that will be inaccurately measured as total chlorine on other test strips. Unlike conventional chlorine, the SPA CHLORINE DISINFECTANT reserve readily shifts to free chlorine as needed, maintaining swim spa health with a low level of chlorine.

- Shock the swim spa with {{Brand Name} } for easy single-dose shocking} or} {any non-chlorine shock} when you replace the SPA CHLORINE DISINFECTANT, or once a month. {Do not use a dichlor shock due to the buildup of cyanuric acid that will negatively affect {53735-14 Brand Name}'s effectiveness.}

{NOTE: If shocking every other week, you may turn the SPA CHLORINE DISINFECTANT

dial down one setting to help extend the life of the {SPA CHLORINE DISINFECTANT} {sanitizer in the water}.

- Replace the SPA CHLORINE DISINFECTANT when the {pouches} {pods} {sachets} {bags} {cartridges} are empty, {system flips over} and {replace} the complete {Brand} System that includes a {53735-11 Brand Name} as directed under Step 2: Put the System to Work.

Troubleshooting

Cloudy Water {or Low Chlorine Levels}

- Shock the swim spa with {Brand Name} {or} {a} {non-chlorine shock}. {Do not use a dichlor shock due to the buildup of cyanuric acid that will negatively affect {53735-14 Brand Name}'s effectiveness.}
- Check water balance. pH and Total Alkalinity need to be in the proper ranges for the {Brand} System to work correctly.
- Check SPA CHLORINE DISINFECTANT and replace if empty—see instructions under Step 2: Put the System to Work
- If SPA CHLORINE DISINFECTANT is not empty, adjust setting up 1 number while maintaining water balance. If needed adjust setting up again.
- Check your calendar. The entire {Brand System}, including {the a} {53735-11 Brand Name}, needs to be replaced every four months. Without the minerals, SPA CHLORINE DISINFECTANT will not be enough to sanitize the swim spa.

SPA CHLORINE DISINFECTANT} Life

- If swim spa is larger than 2000 gallons with significant bather load, you may require a higher setting which will shorten the cartridge life.
- If you think the cartridge setting is too high, you can adjust the setting down 1 number while maintaining water balance. If needed adjust the setting down again.
- {If {Brand} System continually is {sucked} {pulled} {drawn} into the skimmer or filter well, tether the product to the {tub-side {railing}} away from the jets {using the cord provided}.}
- Remove {Brand} System while using the {hot tubswim spa} with the jets running.

High Chlorine Levels

- This is highly unlikely with {Brand System} because SPA CHLORINE DISINFECTANT is self-regulating. However, if you use standard test strips, it may appear that total chlorine is higher than the free chlorine.
- No worries—the strip is measuring the SPA CHLORINE DISINFECTANT reserve, which will shift to free chlorine as needed. Please always use the {Brand} Test Strips that were included with your System.

Learn more at frogproducts.com or call 800.222.0169

Register your [Brand} System at frogproducts.com

Ver la versión en español de este manual en frogproducts.com

Made in USA

Patents: kingtechnology.com/IP

[All text on this page is optional]

SPA CHLORINE DISINFECTANT dissolves slower than standard chlorine products making it easier to maintain a low level, and easier to avoid over chlorination

No {additional} shocking {needed} {required} before or after {each} hot tub use
With fewer pH adjustments and less shocking required, SPA CHLORINE DISINFECTANT uses less chemicals than standard hot tub water treatments

Reduces overall chemical use with less shocking and pH adjustments

The SPA CHLORINE DISINFECTANT forms a chlorine {bank} {reserve} that is measured using a total chlorine test. This chlorine {bank} {reserve} readily shifts to free chlorine as needed to maintain a desirable low level of chlorine available for disinfection.

Unlike {all} other chlorines, there is no need to shock when the total chlorine is {twice the level of} {higher than} the free chlorine. Instead, the chlorine {bank} {reserve}, (measured as total chlorine) is waiting to shift to free chlorine as {needed} {it is depleted}. This also allows for the SPA CHLORINE DISINFECTANT {to oxidize odor causing contaminants {like chloramines}} {to nearly eliminate odor causing contaminants} from your hot tub water.

When testing your water, there is no need to compare the total chlorine level to the free. Simply maintain a low 0.5-1.0 ppm free chlorine at all times. However if you notice your total chlorine dropping, that is a good sign that the cartridge may be getting {nearly} empty.

SPA CHLORINE DISINFECTANT {boosts the concentration of} {super charges} {Brand} minerals for even greater effectiveness

For cleaner, clearer and softer water that cuts the use of chlorine by 75%*
Each SPA CHLORINE DISINFECTANT molecule contains 2 chlorine atoms – one for immediate use and one left in reserve to release as {needed} {bather load varies}
The simple science of maintaining a consistent sanitizer level
No peak and valley sanitizing

Proprietary blend of minerals {with} {plus} SPA CHLORINE DISINFECTANT Technology {for sanitizing hot tubs}
Adjust{able}{s} up to {600} {2500} {3000} gallons
Fresh Mineral Water[∞] with SPA CHLORINE DISINFECTANT Technology

SPA CHLORINE DISINFECTANT Technology
{Hot Tub} {Swim Spa} {Sanitizer}

{An} innovative slow dissolving mineral system {that destroys bacteria while using {up to 75%} less chlorine* – creating cleaner, clearer and softer water}

{1 floating hot tub {sanitizer} {sanitizing system}} {#2 pre-filled cartridges} {1 # {53735-11 Brand Name} {1 # SPA CHLORINE DISINFECTANT} {+} {plus} {#} {Brand} Test Strips {+} {plus} {&} {and} {#} {53735-12 Brand Name} {start-up} {shock}
Fresh Mineral Water[∞] {Easy}

[All text on this page is optional]

THE ALTERNATIVE WAY TO SANITIZE

A fresh approach to clean, clear water using mineral technology that uniquely offers these 4 advantages

1. {Cleaner because it} kills bacteria two {2} ways – with minerals and {a low level of} {chlorine} {SPA CHLORINE DISINFECTANT Technology}
2. Minerals help keep the pH balanced for Clearer water that shines
3. Minerals condition the water for a Softer feel
4. Cartridges are pre-filled {for} {no mess, no guess, no stress} making maintenance Easier.

Replace the SPA CHLORINE DISINFECTANT when system flips over ({on average} {about every} {approximately every} {typically in} {{2}{3}-{4}} {up to 4} weeks)

Replace {53735-11 Brand Name} in {Brand} System every 4 months

{Learn more at} {For more advantages see} www.freshmineralwater.com

{Uses} Up to 75% less chlorine* {with no {frustrating} yo-yo chlorine levels} [ICON: 75% in circle]

Cuts chlorine use up to 75%* while maintaining a constant level

Uses only 25% of normal chlorine levels

Chlorine lasts 3X longer with SPA CHLORINE DISINFECTANT and {Brand} Minerals

{Only} Shock {only} once {a} {per} month [ICON: Calendar with one day colored in]

Self {shocking} {refreshing} {chlorinating} water care system

Self regulates {chlorine levels} for continuous crystal clear water [ICON: Level scale with one water drop on left side]

When you hop in, SPA CHLORINE DISINFECTANT goes to work keeping water clean and clear

Prefilled cartridges for no touching or measuring chlorine

Easy on hot tub surfaces with less odors [ICON: Water drop on lines representing water in circle]

Won't fade swimsuits – easier on skin or hair with less chlorine in the water

Single color match for easy reading – {exclusively with} {only from} {Brand} Test Strips

[ICON: Target]

{Brand} Test Strips – the only sure test for SPA CHLORINE DISINFECTANT

Simple Go – No Go water testing only from {Brand} products

The easy test strips only from {Brand}

The chlorine that {reacts} {responds} to hot tub use by maintaining a consistent chlorine level

Unlike normal chlorine that is used up when you get in, SPA CHLORINE DISINFECTANT continues to maintain the same level

The {vigilant} {proactive} {responsive} {reactionary} chlorine that consistently {sanitizes your water} {keeps your water clean and clear}

[All text on this page is optional]

{Fresh Mineral Water[∞] Cartridge} {53735-11 Brand Name} {(insert color)} Lasts 4 months
SPA CHLORINE DISINFECTANT {(insert color)} lasts {up to} {2}{3}-{4} {weeks} {1 month}
Floats in the hot tub
Flips over when the SPA CHLORINE DISINFECTANT is empty

No adding chlorine daily
Eliminates a cap full a day
No daily maintenance

No measuring, no math, no doubt.
Intelligent water care
All the clean without all the chlorine
No guesswork. Just less work.

Minerals Destroy Bacteria for less chlorine use
SPA CHLORINE DISINFECTANT slowly releases chlorine when needed
Together they create Fresh Mineral Water[∞] that's Cleaner, Clearer, Softer and Easier

The Mineral Innovation

- Reduces chlorine use up to 75%*
- Conditions the water for softness
- Easy on hot tub surfaces with less odors
- Lasts four full months

The Breakthrough Science {Technology} of SPA CHLORINE DISINFECTANT

- Maintains a consistent 0.5 ppm {sanitizer} {disinfectant} {chlorine} level
- Uniquely time-released with a chlorine reserve ready when needed
- Easier to test with {Brand} Test Strips and one color match
- Oxidizes contaminants so far less shocking is required

It floats in the hot tub and flips over when the SPA CHLORINE DISINFECTANT is empty

Minerals and SPA CHLORINE DISINFECTANT completely sanitize any hot tub with no need for ozone, UV or other devices.
Compatible with ozone {UV} if desired

Hassle free hot tub sanitization {water care} {maintenance}
Water looks and feels luxurious
SPA CHLORINE DISINFECTANT isn't susceptible to big swings in sanitizer levels after use.
It maintains a consistent level that just works!

Step into {easy} {relax}
More innovation. Less upkeep.
More wows. Less ughs.

The difference between {liking and loving your hot tub {perfect pH and pHew!} {green and clean}}

[All text on this page is optional]

How can anything this hard on bacteria feel so soft
Feel the difference
For Hot Tubs

{Plus} {Also} {Package} {Bundle} {Kit} {Set} {contains} {includes}
{53735-11 Brand Name} {(shown left)}
SPA CHLORINE DISINFECTANT
{# {53735-12 Brand Name} {53735-13 Brand Name}}
{# {Brand Name} Test Strips}
{# {Brand Name} Non-Chlorine Shock {packets} {pouches}}

Product shown is actual size
{Replacement Cartridges} {Cartridge Kit} for {Brand} {Floating} [or] {In-Line} {Sanitizing}
System{s}

Cut on dotted line to open
Yes, it does revolve around you
Relax {&} {and} Enjoy
{Replace} {3-4 Weeks}

{Brand System} has no {cyanuric acid} {CYA} that can build-up quickly leaving chlorine ineffective and requiring you drain the water prematurely.

Dichlor adds {cyanuric acid} {CYA} to the hot tub with every dose. {Brand System} does not. {Cyanuric acid} {CYA} too high? It's time to drain your hot tub. {Brand System} has no {cyanuric acid} {CYA} so you could still be enjoying your hot tub.

{Cyanuric acid} {CYA} protects the chlorine from sunlight's destruction} {from being burned off by the sun}. Since hot tubs are covered, there is no need to protect the water from the sun so there is no need for {cyanuric acid} {CYA}.

When {cyanuric acid} {CYA} gets too high in a dichlor hot tub, the water is over stabilized. The result is:

- Dichlor becomes less effective, decreasing its bacteria-killing power
- The water becomes {hazy} {cloudy} or algae appears
- An unsafe hot tub for family and friends
- You have to drain your water and start again.

Did you know when you use dichlor, your {building up {cyanuric acid} {CYA}} {creating a {cyanuric acid} {CYA} bath} {asking for trouble with {cyanuric acid} {CYA} build up}?

The {Brand} difference is what we don't put in {it} {Brand}

With no {cyanuric acid} {CYA} in SPA CHLORINE DISINFECTANT, you can {extend the life of your hot tub water} {{go longer between} {reduce the hassles of constant} draining and refilling}

[Additional copy for Water Balance Guide insert for Spa Chlorine Disinfectant use with {53735-11 Brand Name}] [All copy is optional]

Water Balance Guide for Hot Tubs {{or} {and} Swim Spas}: How to get your water relaxation ready. Before you {fill and} balance {-have water tested}:

Step 1 – {Test} your fill water for {Total} Hardness. {Take a sample of the water you plan to use to fill your hot tub {or swim spa} to your dealer and check for {Total} Hardness.} If {your fill water is} over 250 ppm {in Total Hardness}, don't use that water to fill your hot tub {or swim spa}! {Find a soft water source or use} A {simple} hose filter {from your local dealer can solve your issue} {to soften the water}.

Step 2 – {Test} for metals. {After the hot tub is filled, take a sample of that water to your dealer to check for metals.} If {the water you use} {it} tests high for metals, use a {stain and scale or} metal out product {before balancing}.

4 Tips for successful weekly water balancing:

1. Always balance in order with Step 1: Total Alkalinity, then Step 2: pH and then Step 3: recheck {water} {Total} Hardness.

Step 1: Total Alkalinity 80-120 ppm: Starting with Total Alkalinity (TA) first will make it much easier to balance the pH. Low TA: add {Brand Name} {TA Increaser or TA Up}. High TA: add {Brand Name} {the same product that lowers pH usually called pH Decreaser or pH Down}.

STOP: Proceed to pH ONLY when Total Alkalinity is between 80 and 120 ppm

Step 2: pH 7.2-{7.6} {7.8}: pH is important for maintaining clean, clear water that doesn't attack surfaces or irritate skin. Low pH: add {Brand Name} {a pH Increaser or pH Up product}. High pH: add {Brand Name} {a pH Decreaser or pH Down product}.

STOP: Proceed to {Water} {Total} Hardness ONLY when pH is between 7.2 and {7.6} {7.8}.

Step 3: {Water} {Total} Hardness 150-250 ppm: Check {Water} {Total} Hardness AGAIN to make sure the calcium level is not too low so the water does not corrode surfaces. Low {Water} {Total} Hardness: if {Water} {Total} Hardness is under 150 ppm, add {Brand Name} {Calcium} {Hardness} {Increaser}.

2. Add adjustment chemicals in small increments (follow label directions carefully)
3. Wait {2} {6} hours between adjustments so your adjustment chemical has time to work
4. If balancing takes longer than 2 days, add {53735-12 Brand Name} {53735-13 Brand Name} {a chlorine shock} to maintain sanitizer levels.

When Total Alkalinity is 80-120, pH is 7.2-{7.6} {7.8} and {water} {total} hardness is 150-250 ppm, your water is balanced.

Troubleshooting Tips for {Brand} Systems

Many users tell us the {Brand} System is the easiest water care system they have ever used. The key is to maintain water balance and make sure you replace the {Brand} SPA CHLORINE DISINFECTANT when empty (approximately every {2 to 3} {2 to 4} {3 to 4} {4} weeks). Here are a few tips should you experience one of these issues:

Cloudy Water / Under Chlorination

1. Shock the hot tub {or swim spa} with {Brand}, a non-chlorine shock. {Do not use a dichlor shock due to the build-up of cyanuric acid that will negatively affect SPA CHLORINE DISINFECTANT'S effectiveness.}

2. Check your water balance. If your pH or TA is off, SPA CHLORINE DISINFECTANT will not be as effective. Most often the free chlorine residual is low when the pH is too high. Add {Brand Name} {pH Down} to bring the pH into the ideal range of 7.2-{7.6} {7.8}. The free chlorine residual will then come back up to 0.5 ppm after the pH adjustment has been made.
3. Check to see if your SPA CHLORINE DISINFECTANT is empty. If using a floating version of {Brand Name}, in some circumstances, the system may not completely flip over. Pull it out of the hot tub {or swim spa} and drain all the water. Then put it back in. If it immediately flips over, it's empty. For any {Brand} System, you can also shake the cartridge slightly to feel if there is any SPA CHLORINE DISINFECTANT material left inside. {For swim spas, you should be able to tell by looking if the SPA CHLORINE DISINFECTANT is empty.}
4. Make sure your {Brand} Minerals have not been used for more than 4 months. When you hear minerals left inside the {insert color} cartridge, it is because one of the minerals does not completely dissolve. The mineral that does the bacteria fighting however only lasts 4 months so you must replace the {53735-11 Brand Name} at that time or whenever you drain and refill your hot tub {or swim spa}. We suggest making a note on your calendar for the replacement date of the minerals and be sure to replace every time you drain and refill your hot tub {or swim spa}.

High Combined Chlorine Levels

1. This is normal! With the {Brand} System self-regulating process, there is a chlorine reserve that converts to free chlorine automatically when needed.
2. When testing SPA CHLORINE DISINFECTANT with a standard {other} test strip{s}, you will see the total chlorine is higher than the free chlorine. The total is the SPA CHLORINE DISINFECTANT reserve that is inactive. When the hot tub {or swim spa} needs more free chlorine to kill bacteria, it pulls from the reserve. Therefore, no shocking is required when the total reading is different than the free reading.
3. {Due to the unique properties of SPA CHLORINE DISINFECTANT that does not work like standard chlorine,} To prevent confusion, always use {Brand} Test Strips. A 30-count bottle comes with every {Brand} System. {To learn more about testing this technology, visit frogproducts.com}

[All text on this page is optional]

{Dichlor is hard} {End the chore of Dichlor} {{Brand} does everything Dichlor does but easier}
with:

- {No} yo-yo chlorine levels
- {No} daily chlorine dosing
- {No} touching or {spilling} {measuring} chlorine
- {No} wondering how much to add

Enjoy Spa Ease with {Brand}

Spa Ease: what you experience with {Brand} products

Create Spa Ease in your hot tub

Sanitizing made easy – that's Spa Ease

Spa Ease – as easy as 1, 2, Ahh

Fits all 2013 and later model {Brand} Spas excluding models X5L and X6R

Fits {Brand Spas} {Series} {Models} {Collections} {one or more model number} {one or more model name}

Download {the} free {Brand} {Water Care} App

Tap into the App – Watercare guide for hot tubs and pools

- Easy water testing advice
- Water care at your fingertips
- Helpful reminders and more

Expert advice, reminders & more

Simple water care at your fingertips

Put your mind and body at ease

Rediscover the simple joy of owning a hot tub

Goodbye constant monitoring.

Hello to being at ease.

Pure relaxation is within reach.

Say hello to easy-water-care.

Say hello to the “aahs.”

Say hello to simple.

Welcome to easy

Ready. Set. Relax.

The only thing to measure: the number of “aahs.”

Easy does it

Be at ease.

Be crystal clear.

Chore be gone

Relaxation: Dial in.

[All text on this page is optional]

Floating Model, Cartridge {holder} {carrier} {caddy} {station} sold separately
Cloudy water solved – 9 out of 10 recommend {Brand}
Unlock the secret to clear water

[INSERT CARD]

STOP – Switching to {53735-11 Brand Name}? [ICON: Stop sign]

Here are helpful tips

If previously using bromine, you must drain and refill hot tub before using {Brand}

If previously using dichlor, you may convert to {Brand} without draining the hot tub as long as the cyanuric acid level is below {50} {80} ppm. See your dealer for details.

Always use the {Brand} Test Strips that were included with your {Brand} System

Download the free {Brand} Water Care App [ICON: QR Code]

Easy water testing advice and reminders at your fingertips [ICON: Phone image with Water Testing text on it]

To learn more, visit frogproducts.com and visit the {Brand} Test Strips page

Swim Smarter. Soak Smarter. Be Smarter

Designed for Work Outs, and Sit Ins

Keep Your Work Outs out of water care

A lifestyle of easy water care

Now with x% more SPA CHLORINE DISINFECTANT

SPA CHLORINE DISINFECTANT {made of {100%} recyclable plastic} {and is} {fully recyclable when empty} {see emblem on bottom of package}

More SPA CHLORINE DISINFECTANT, More Relaxing & Now Recyclable

Smart, Easy & Recyclable

Now easier to recycle {plastic cartridges}

For easy shocking that is effective and fast {always} use {Brand Name}

To help maintain Fresh Mineral Water[∞], {always} shock with {Brand Name}

Once a month or when replacing your SPA CHLORINE DISINFECTANT use the fast and convenient {Brand Name} – one packet for up to {600} {3000} gallons

All {Brand} empty replacement products are recyclable through {Brand} recycling program. Collect used and empty products and return to a participating dealer. Learn more at frogproducts.com/terracycle

Up to 4 months worth of “ahhhs”

{Everything you need} {Complete water care} for up to 4 months

{Contains} Up to a 4-month supply included {inside}

Soak in the softness

The system will slowly flip over – replace when empty

For use in the {Brand Name} {Floating} {In-Line} {Sanitizing} System

Our free app makes it easy

[All text on this page is optional]

{Brand}... cruise control for your {pool} {hot tub}

Don't get in the {pool} {hot tub} without {Brand}

Discover {a fresher approach to water care} {the fresh alternative to salt} {the difference {of} Fresh Mineral Water[∞]}

The fresh {alternative to standard water care} {way to good clean fun}

{Refreshingly} {Shockingly} {clean} {clear} {comfortable} {enjoyable}

Unconditional Satisfaction Guarantee

You'll LOVE the {Brand} Mineral Floating System or your money back!

Refer a Friend to {Brand} and {get} {earn} a free {xxx} {53735-11 Brand Name}.

Custom-{fit} {designed} {Bundle} for {Brand Spas} {with} {featuring} {Brand} {Filter} {Filtration} {System}

Scan code to view instruction manual{, videos and additional product information} {or visit {frogproducts.com} {kingtechnology.com}}

Subscribe for easy product replacements every 4 months

The {simple and smart} {DIY water} sanitizing solution for your hot tub

Shock the {hot tub} {swim spa} {with Brand Name}"

Sold Separately

Not included

{Remove} {Tear off} {Cut off} {label} {bag} {out packaging} before using product and {retain} {keep} {instructions nearby} {for future reference}.

Use only with {53735-11 Brand Name} in {Brand} System {for swim spas}

For {Brand Name} with the {Brand Name} {Filter} {Filtration} {System} produced [year] or later {Now} Lasts 3-4 weeks {for an average 400 gallon hot tub} {on larger hot tubs {400-600 gallons}}

Chlorine extender

Extended SPA CHLORINE DISINFECTANT life {for larger hot tubs}

Longer cartridge life means less work and more convenience

{{Brand System} with} A larger cartridge for greater satisfaction {on larger hot tubs}

Get a longer life to your SPA CHLORINE DISINFECTANT

[Phone App Icon for SPA CHLORINE DISINFECTANT used with 53735-11]



Download the **FREE**
FROG Water Care App



[The following descriptions represent icons/graphic images that may appear on labeling:

- Logos identifying each alternative brand name (ABN)
- Product images of SPA CHLORINE DISINFECTANT and other products used with it
- Various images of people relaxing in a hot tub or swimming/relaxing in a swim spa; the following is a representation of the kind of graphic treatment possible:]



[Recycling symbols for SPA CHLORINE DISINFECTANT and {53735-11 Brand Name} Family of Products]

[Note to reviewer: The following is a representative recycling image for SPA CHLORINE DISINFECTANT with {53735-11 Brand Name}. A simple recycling symbol may be used.]

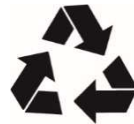
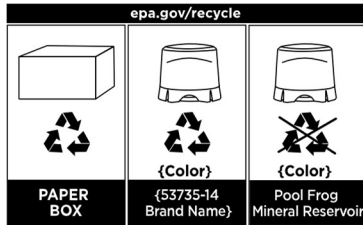

[SPA CHLORINE DISINFECTANT Family of Products – the following images are representative of current products and may or may not appear on product labeling. Silver cartridges contain SPA CHLORINE DISINFECTANT – the blue cartridges are {53735-11 Brand Name}]

In-Line System:



Floating System:



Brand A:



Brand A X Series:



Brand B:



Brand B Floater:



Brand C:

