



UNITED STATES ENVIRONMENTAL PROTECTION AGENCY
WASHINGTON, DC 20460

OFFICE OF CHEMICAL SAFETY
AND POLLUTION PREVENTION

September 1, 2020

Abigail T.D. Wacek
Senior Regulatory Consultant
King Technology, Inc.
530 11th Avenue South
Hopkins, MN 55343

Subject: Label Amendment – Application to Update Use Directions and Optional Label Text
Product Name: “Spa Chlorine Disinfectant”
EPA Registration Number: 53735-14
Application Date: February 7, 2020
Decision Number: 560766

Dear Ms. Wacek:

The amended label referred to above, submitted in connection with registration under the Federal Insecticide, Fungicide and Rodenticide Act, as amended, is acceptable. This approval does not affect any conditions that were previously imposed on this registration. You continue to be subject to existing conditions on your registration and any deadlines connected with them.

A stamped copy of your labeling is enclosed for your records. This labeling supersedes all previously accepted labeling. You must submit one copy of the final printed labeling before you release the product for shipment with the new labeling. In accordance with 40 CFR 152.130(c), you may distribute or sell this product under the previously approved labeling for 18 months from the date of this letter. After 18 months, you may only distribute or sell this product if it bears this new revised labeling or subsequently approved labeling. “To distribute or sell” is defined under FIFRA section 2(gg) and its implementing regulation at 40 CFR 152.3.

Should you wish to add/retain a reference to the company’s website on your label, then please be aware that the website becomes labeling under the Federal Insecticide Fungicide and Rodenticide Act and is subject to review by the Agency. If the website is false or misleading, the product would be misbranded and unlawful to sell or distribute under FIFRA section 12(a)(1)(E). 40 CFR 156.10(a)(5) list examples of statements EPA may consider false or misleading. In addition, regardless of whether a website is referenced on your product’s label, claims made on the website may not substantially differ from those claims approved through the registration process. Therefore, should the Agency find or if it is brought to our attention that a website contains false or misleading statements or claims substantially differing from the EPA approved registration, the website will be referred to the EPA’s Office of Enforcement and Compliance.

Your release for shipment of the product constitutes acceptance of these conditions. If these conditions are not complied with, the registration will be subject to cancellation in accordance with FIFRA section 6.

Page 2 of 2
EPA Reg. No. 53735-14
Decision No. 560766

If you have any questions, please contact Michael Varco by phone at 703-347-0403, or via email at Varco.Michael@epa.gov.

Sincerely,

A handwritten signature in black ink, appearing to read "DF", with a long horizontal line extending to the right.

Demson Fuller, Product Manager 32
Regulatory Management Branch I
Antimicrobials Division (7510P)
Office of Pesticide Programs

Enclosure

[All text in brackets {xxx} is optional and may or may not be included on a final label.]

[All text in braces [xxx] is administrative and will not appear on a final label.]

[MASTER LABEL]

SPA CHLORINE DISINFECTANT Prefilled Chlorine {Spa} {Hot Tub} Sanitizer

Active Ingredients:

1,3-dichloro-5, 5-Dimethylhydantoin.....81.1%

1,3-dichloro-5-ethyl-5-methylhydantoin.....16.1%

Other Ingredients:..... 2.8%

Total:.....100.0%

A C C E P T E D

09/01/2020

Under the Federal Insecticide, Fungicide
and Rodenticide Act as amended, for the
pesticide registered under
EPA Reg. No. 53735-14

**Keep Out of Reach of Children
DANGER**

{SEE PRECAUTIONARY STATEMENTS ON BACK PANEL}

**{See Enclosed Instruction {Label} {Instruction Manual} for Complete Directions
for Use}**

EPA Reg. No.: 53735-14

Net Wt.: xxx grams

EPA Est. No.: xxxxx-xx

Manufactured By: King Technology, Inc.
530 11th Ave S
Hopkins, MN 55343

[Note to Reviewer: In accordance with 40 CFR 156.68(d), all first aid statements, as prescribed, will appear on the front panel of the product label.]

FIRST AID: If in Eyes: Hold eye open and rinse slowly and gently with water for 15-20 minutes. Remove contact lenses, if present, after the first 5 minutes, then continue rinsing eye. Call a poison control center or doctor for treatment advice. If on Skin or Clothing: Take off contaminated clothing. Rinse skin immediately with plenty of water for 15-20 minutes. Call a poison control center or doctor for treatment advice. If Swallowed: Call poison control center or doctor immediately for treatment advice. Have person sip a glass of water if able to swallow. Do not induce vomiting unless told to do so by the poison control center or doctor. Do not give anything by mouth to an unconscious person. Have the product container or label with you when calling a poison control center or doctor, or going for treatment. If Inhaled: Move person to fresh air. If person is not breathing, call 911 or an ambulance, then give artificial respiration, preferably by mouth-to-mouth, if possible. Call a poison control center or doctor for further treatment advice. Note to Physician: Probable mucosal damage may contraindicate the use of gastric lavage. Measures against circulatory shock, respiratory depression, and convulsion may be needed.

IN CASE OF MEDICAL EMERGENCY CALL 1-800-424-9300.

PRECAUTIONARY STATEMENTS:

HAZARDS TO HUMANS AND DOMESTIC ANIMALS: DANGER: Corrosive. Causes irreversible eye and skin damage. May be fatal if swallowed. Irritating to nose and throat. Avoid breathing dust and fumes. Do not get in eyes, on skin or on clothing. Wear goggles or safety glasses and rubber gloves when handling product. Wash thoroughly with soap and water after handling and before eating, drinking, chewing gum, using tobacco or using the toilet. Remove and wash contaminated clothing before reuse.

PHYSICAL AND CHEMICAL HAZARDS: STRONG OXIDIZING AGENT: Do not mix with other chemicals. Mix only with water. Never add water to product. Always add product to large quantities of water. Use clean dry utensils. Do not add this product to any dispensing device containing remnants of any other product. Such use may cause a violent reaction leading to fire and explosion. Contamination with moisture, organic matter or other chemicals will start a chemical reaction and generate heat, hazardous gas, possible fire and explosion. In case of contamination or decomposition, do not reseal container. If possible, isolate container in open air or well-ventilated area. Flood area with large volumes of water.

ENVIRONMENTAL HAZARDS: This pesticide is toxic to fish and aquatic organisms.

Note: Buyer assumes all responsibility for safety and use not in accordance with directions.

[Product Description and Directions for Use with In-Line System]

Product Description: The SPA CHLORINE DISINFECTANT is {a} {an} {innovative} {revolutionary} way to maintain a low level of {chlorine} {sanitization} {disinfection} {tailor made} {perfect} for use with the {53735-11 Brand Name} that reduce{s} chlorine use. Together they make {spa} {hot tub} care a breeze with up to 75% less chlorine* so the water feels softer and looks crystal clear with no smelly odors, no adding chlorine daily and no weekly shocking. Swimsuit colors stay bright and {spa} {hot tub} surfaces maintain their brilliance longer. {Experience the difference {53735-11 Brand Name} and SPA CHLORINE DISINFECTANT will make in your {spa} {hot tub}.}

Directions for Use: It is a violation of federal law to use this product in a manner inconsistent with its labeling.

For use in {spas} {hot tubs} up to {500} {600} gallons. Use the SPA CHLORINE DISINFECTANT with the {53735-11 Brand Name} in the {In-Line System} . Ensure all {spa} {hot tub} equipment is working properly. Operate the pump and filter {for at least 3 hours per day} {as recommended by your hot tub manufacturer}. Clean filter following manufacturer's directions. May be used with a previously filled {hot tub} {spa} unless it was sanitized with bromine or biguanides. Then drain and fill {spa} {hot tub} with fresh water before using this product.

{Start-up:} Balance the water according to the water balance guidelines with pH between 7.2 – 7.8 and total alkalinity at 80 to 120 ppm. {After balancing,} {Begin with} {establish} a free chlorine residual of 0.5 to 1.0 ppm in the {spa} {hot tub} {with} {from {53735-12 Brand Name} start-up shock} {that came in the package} {or} an EPA approved {spa} {hot tub} chlorine shock following the directions for that product. {When using other products as outlined in directions for this product, always follow directions on those products.}

Setting the Output: The SPA CHLORINE DISINFECTANT is prefilled and adjustable to meet the needs of each {spa} {hot tub} use. Initially set cartridge per your gallon size: x {-x} gallons - setting x, x {-x} gallons – setting x, x {-x} gallons – setting x, x {-x} gallons – setting x, Hold the bottom and turn the top of the cartridge until the correct number appears in the setting window. {See the setting chart in the manual for best results.}

{Using}The In-line Mineral {Spa} {Hot Tub} System} {Inserting the Cartridge}: Open cap of Inline System, push down and turn cartridge holder counter-clockwise to unlock. Pull holder out. Snap cartridge into {lower} {bottom} section {marked {"Bromine} {or Chlorine} {or SmartChlor} "}. The {53735-11 Brand Name} cartridge will be in the top section marked "Minerals." Make sure to line up indent on cartridge with raised line on holder. After cartridge is snapped in, replace holder by lining up arrow on holder with arrow on system lip, push down and rotate clockwise to lock in place. Replace cap.

Replacing the Cartridge: When empty the {Brand} Test Strips will show a lighter color than the out indicator on the {Brand} Test Strip label. When this happens remove the SPA CHLORINE DISINFECTANT from the system, drain the water and shake slightly to see if it is empty. Follow disposal instructions and replace with a new SPA CHLORINE DISINFECTANT. Do not discard or recycle cartridge if a small amount of chlorine remains. Place back in the in-line system until completely empty.

Keeping the pH in the proper range of 7.2 to 7.8 will allow SPA CHLORINE DISINFECTANT to keep the free chlorine level between 0.5 and 1.0 ppm with little adjusting. {If your Test Strip consistently shows lighter than the {free} {active} chlorine block on the Test Strip label, then adjust your setting up by one number. If showing a darker color, lower the setting one number.}

Shock the {spa} {hot tub} {with Brand Name} when you replace SPA CHLORINE DISINFECTANT or {once a month}. {Add clarifier occasionally if the water should become cloudy.} With SPA CHLORINE DISINFECTANT less shocking is required because {of the chlorine {bank} {reserve} (measured as total chlorine) that is {ready to use} {automatically converted to {active} {free} chlorine} when needed} {it maintains a consistent level of sanitization even when people enter the {spa} {hot tub}}.

REENTRY into treated {spas} {hot tubs} is prohibited above levels of 5 ppm available {free} chlorine as measured by a suitable test kit due to risk of bodily injury.

[Product Description and Directions for Use with Floating/Flipping System]

Product Description: The SPA CHLORINE DISINFECTANT is {a} {an} {innovative} {revolutionary} way to maintain a low level of {chlorine} {sanitization} {disinfection} {tailor made} {perfect} for use with {53735-11 Brand Name} that reduce{s} chlorine use. Together they make {spa} {hot tub} {swim spa} care a breeze with up to 75% less chlorine* so the water feels softer and looks crystal clear with no smelly odors, no adding chlorine daily and no weekly shocking. Swimsuit colors stay bright and {spa} {hot tub} surfaces maintain their brilliance longer.

Directions for Use: It is a violation of federal law to use this product in a manner inconsistent with its labeling.

For use in {spas} {hot tubs} {swim spas} up to {500} {600} {3000} gallons. Use only with the {53735-11 Brand Name}. Ensure all {spa} {hot tub} {swim spa} equipment is working properly. Operate the pump and filter {for at least 3 hours per day} {as recommended by your hot tub manufacturer}. Clean filter following manufacturer's directions. May be used with a previously filled {spa} {hot tub} {swim spa} unless it was sanitized with bromine or biguanides. Then drain and fill {spa} {hot tub} {swim spa} with fresh water before using this product.

Start-up: Balance the water according to the water balance guidelines with pH between 7.2 – 7.8 and total alkalinity at 80 to 120 ppm. {After balancing} {Begin with} {Establish} a free chlorine residual of 0.5 to 1.0 ppm in the {spa} {hot tub} {swim spa} {from} {with} {{53735-12 Brand Name} start-up shock} {that came with the package} {or} {an EPA approved {spa} {hot tub} chlorine shock} {or by other means} following the directions for that product. {When using other products as outlined in directions for this product, always follow directions on those products.}

To assemble:

- Remove outer packaging
- Align arrows on {color} {53735-11 Brand Name} and {color} SPA CHLORINE DISINFECTANT
- Push together and twist to lock
- {Set the dial on the SPA CHLORINE DISINFECTANT (see Setting Chart in manual)}
- Place entire system in the {spa} {hot tub} water.
- {{Weekly} {Periodically} test the water to ensure pH balance and a 0.5 to 1.0 ppm free chlorine level}
- {Adjust cartridge setting if needed }
- Shock the {hot tub} {spa} {with Brand Name} {non-chlorine shock} when replacing SPA CHLORINE DISINFECTANT or once a month

Replacing the Cartridge: When {the system flips over} {or} {the Test Strip shows a lighter color than the out indicator on the Test Strip label}, replace the SPA CHLORINE DISINFECTANT by rotating the two cartridges until the arrows align and

pull apart. Drain the water from the old SPA CHLORINE DISINFECTANT and shake slightly to see if it is empty. Follow disposal instructions and replace with a new SPA CHLORINE DISINFECTANT. Do not discard or recycle cartridge if a small amount of chlorine remains. Place in the {spa} {hot tub} {swim spa} to float on its own until completely empty.

{Additional Information:

- Keeping the pH in the proper range of 7.2 to 7.8 will allow SPA CHLORINE DISINFECTANT to keep the free chlorine level between 0.5 and 1.0 ppm with little adjusting. If your Test Strip consistently shows lighter than the {free} {active} chlorine block on the Test Strip label, then adjust your setting up by one number. If showing a darker color, lower the setting one number.}
- With SPA CHLORINE DISINFECTANT less shocking is required because {of the chlorine {bank} {reserve} that is {ready to use} {automatically converted to {active} {free} chlorine} when needed} {it maintains a consistent level of sanitization even when people enter the {spa} {hot tub} {swim spa}.}

REENTRY into treated {spas} {hot tubs} {swim spas} is prohibited above levels of 5 ppm available {free} chlorine as measured by a suitable test kit due to risk of bodily injury.

[The following copy is engraved into the plastic container]

Not a toy

No es un juguete

Keep Out of Reach of Children

DANGER

EPA Reg. No.: 53735-14{-xxxxx}

{kingtechnology.com} [OR] {heycoolpool.com}

{U.S. & Foreign patents pending}

{Patents} {Patent Pending}: {kingtechnology.com/IP} [OR] {heycoolpool.com/IP}

[Product Description and Directions for Use with Filter Well Systems]

Product Description: The SPA CHLORINE DISINFECTANT {specially made} {custom {fit} {designed}} {exclusively} for {Brand} Spas is {a} {an} {innovative} {revolutionary} way to maintain a low level of {chlorine} {sanitization} {disinfection} {tailor made} {perfect} for use with the {53735-11 Brand Name} that reduce{s} chlorine use. Together they make {spa} {hot tub} care a breeze with up to 75% less chlorine* so the water feels softer and looks crystal clear with no smelly odors, no adding chlorine daily and no weekly shocking. Swimsuit colors stay bright and {spa} {hot tub} surfaces maintain their brilliance longer. {Experience the difference {53735-11 Brand Name} and SPA CHLORINE DISINFECTANT will make in your {spa} {hot tub}.}

Directions for Use: It is a violation of federal law to use this product in a manner inconsistent with its labeling.

For use in {spas} {hot tubs} up to {500} {600} gallons. Use only with the {53735-11 Brand Name} in the {Sanitizing} System for {Brand Spas}. Ensure all {spa} {hot tub} equipment is working properly. Operate the pump and filter {for at least 3 hours per day} {as recommended by your hot tub manufacturer}. Clean filter following manufacturer's directions. May be used with a previously filled {hot tub} {spa} unless it was sanitized with bromine or biguanides. Then drain and fill {spa} {hot tub} with fresh water before using this product.

{Start-up:} Balance the water according to the water balance guidelines with pH between 7.2 – 7.8 and total alkalinity at 80 to 120 ppm. {After balancing,} {Begin with} {establish} a free chlorine residual of 0.5 to 1.0 ppm in the {spa} {hot tub} {with} {from {53735-12 Brand Name} start-up shock} {that came in the package} {or} an EPA approved {spa} {hot tub} chlorine shock following the directions for that product. {When using other products as outlined in directions for this product, always follow directions on those products.}

Setting the Output: The SPA CHLORINE DISINFECTANT is prefilled and adjustable to meet the needs of each {spa} {hot tub} use. Initially set cartridge per your {Brand} Spa model number} {gallon size: x {-x} gallons - setting x, x {-x} gallons – setting x, x {-x} gallons – setting x, x {-x} gallons – setting x,} Turn the dial on the bottom of the cartridge to the correct setting. {See the setting chart in the manual for best results.}

[OPTION FOR BRAND A SPAS SERIES X] Using The System For #, # and

Series: Remove filter snap cap and weir door/filter plate. Remove cartridge {holder} {carrier} from hot tub by pulling up on the handle. Snap cartridge into {one} {top} {bottom} {left side} {right side} {front} back} opening of the carrier. With the {Brand} logo facing the {holder} {carrier}, put the dial end of cartridge into the {holder} {carrier} first by connecting the tab on the {holder} {carrier} with the indent in the cartridge. Then push the top part of the cartridge {up} {in} until it snaps into place. For best results insert the {53735-11 Brand Name} Cartridge into the other opening. When

cartridge is snapped in, replace cartridge {holder} {carrier} between the filter cartridges under weir door/ filter plate pushing down until it stays in place. Then replace the filter snap cap.}

[OPTION FOR BRAND A SPAS SERIES XX] Using the System For # Series

- Turn off main power to the {spa} {hot tub} and remove the JetPak to the right of the main control.
- Remove Simplicity Filter Holder by taking hold of the handle, pushing it {into} {towards the middle of} the {spa} {hot tub} and lift out.
- Insert {53735-11 Brand Name} and SPA CHLORINE DISINFECTANT into the two openings below the filter cartridge. Push cartridges in until they are latched
- To remove cartridges, push them in until they are free of the latches, then slide them out.
- Replace Simplicity Filter Holder and the JetPak over it. Turn on main power.

[Callouts for this section] Simplicity Filter Holder, Two openings for cartridges, Cartridges installed

[OPTION FOR BRAND B SPAS] Using The System: Remove the filter cover.

Remove cartridge {holder} {carrier} if already installed using the handle at the top of the holder. Open the arms of the {Brand} cartridge {holder} {carrier} until they snap into position. With the {Brand} logo facing up on the {53735-11 Brand Name}, place the bottom of the rounded edge of the cartridge into the front of {the upper} {the lower} {one} opening of the {holder} {carrier} and push the cartridge back until it locks into place. Follow the same procedure with the SPA CHLORINE DISINFECTANT in the {other} {upper} {lower} opening. With the {Brand} cartridges facing the inside of the hot tub and the handle of the {holder} {carrier} at the top, slide the {holder} {carrier} down over the filter cartridge that does NOT have a grid underneath it until it covers the entire length of the filter cartridge. Rotate the {Brand} {holder} {carrier} until it touches the other filter cartridge. Re-install the filter cover.}

[OPTION FOR BRAND B SPAS FLOATER] To assemble:

- Remove outer packaging
- Set the dial on the {53735-11 Brand Name} to wide open on setting x.
- Set the dial on the SPA CHLORINE DISINFECTANT to the setting number based on your {spa} {hot tub} model number (see setting chart in manual).
- Insert the two cartridges into the holder one at a time. Put bottom of cartridge into the holder bracket first with setting dial facing out. Then push cartridge in place.
- Place entire system in the {spa} {hot tub} to float.
- {{Weekly} {Periodically} test the water to ensure pH balance and a 0.5 to 1.0 ppm free chlorine level}
- {Adjust cartridge setting if needed }

- Shock the {hot tub} {spa} {with Brand Name} {non-chlorine shock} when replacing SPA CHLORINE DISINFECTANT or once a month

[OPTION FOR BRAND C SPAS] Using The System: Remove the filter lid. With the filter cartridge in place, slide the {Brand} {holder} {carrier} down over the pipe where the nut is that holds the filter cartridge on. Make sure the openings for the {Brand} cartridges are facing the filter area and the fin on the holder goes between two pleats on the filter cartridge. Push the {holder} {carrier} down using the top handle until it snaps in place. {Do not install on the other side of the filter cartridge.} With the {Brand} logo of the {53735-11 Brand Name} facing up, place the bottom of the rounded edge of the cartridge into the front of the {holder} {carrier} opening closest to the {outside} {inside} of the {spa} {hot tub} and push the cartridge back until it locks into place. Follow the same procedure to insert the SPA CHLORINE DISINFECTANT in the {other} opening. Make sure the cartridges are completely under water. If not, add water to the {spa} {hot tub} until the cartridges are covered and balance the pH and Total Alkalinity. Re-install the filter lid.}

[OPTION D]

- Remove the filter {lid} {cover}.
- Insert {Brand} {holder} {carrier} in the filter well area per the diagram.
- Snap {53735-11 Brand Name} into one opening and SPA CHLORINE DISINFECTANT into the other opening.
- Re-install the filter {lid} {cover}.

Replacing the Cartridge: When empty the {Brand} Test Strips will show a lighter color than the out indicator on the {Brand} Test Strip label. When this happens remove the SPA CHLORINE DISINFECTANT from the {system} {holder}, drain the water and shake slightly to see if it is empty. Follow disposal instructions and replace with a new SPA CHLORINE DISINFECTANT. Do not discard or recycle cartridge if a small amount of chlorine remains. Place back in the system until completely empty.

Keeping the pH in the proper range of 7.2 to 7.8 will allow SPA CHLORINE DISINFECTANT to keep the free chlorine level between 0.5 and 1.0 ppm with little adjusting. {If your Test Strip consistently shows lighter than the {free} {active} chlorine block on the Test Strip label, then adjust your setting up by one number. If showing a darker color, lower the setting one number.}

Shock the {spa} {hot tub} {with Brand Name} when you replace SPA CHLORINE DISINFECTANT or once a month. With SPA CHLORINE DISINFECTANT less shocking is required because it maintains a consistent level of sanitization even when people enter the {spa} {hot tub}.

REENTRY into treated {spas} {hot tubs} is prohibited above levels of 5 ppm available {free} chlorine as measured by a suitable test kit due to risk of bodily injury.

STORAGE AND DISPOSAL: Do not contaminate food or feed by storage and disposal.

Pesticide Storage: Keep this product dry in original tightly closed container when not in use. Store in a cool, dry, well-ventilated area away from heat. Moisture may decompose this product and cause a violent reaction leading to fire and explosion. In case of decomposition, isolate container if possible and flood area with large amounts of water to dissolve material before discarding this container

Pesticide Disposal: Product or rinsates that cannot be used must be diluted with water before disposal in a sanitary sewer.

Container Handling: Non-refillable container. Do not reuse or refill this container. Clean container promptly after emptying. Then offer for recycling if available or puncture and dispose of in a sanitary landfill, or by incineration.

[Disclaimers]

* Compared to the ANSI minimum recommended chlorine level of 2.0 ppm for a residential {spa} {hot tub}.

** Compared to daily shocking or shocking each time the {spa} {hot tub} is used

[Operational Instructions for In-Line Mineral Spa System]

[All text is optional]

In-Line Sanitizing System Operating Instructions

{{Brand}} is the {spa} {hot tub} sanitizing system that takes the guess work out of water so you always feel at ease while enjoying your {spa} {hot tub}.

- {Brand} creates Fresh Mineral Water that's cleaner, clearer and softer
- {Brand} employs SPA CHLORINE DISINFECTANT Technology that knows when and how much free chlorine is needed so it uses up to 75% less.*
- {Brand} requires far less shocking – only once a month!}

Register your In-Line System at frogproducts.com

* Compared to the minimum ANSI recommended chlorine level of 2.0 ppm for a {spa} {hot tub}.

{Let Us Dissect This System For You: The complete In-Line System}

The In-Line System is made up of (A) a cap that is easily distinguishable among the fittings on the top {rim} {edge} of the {spa} {hot tub}, (B) a cartridge holder that pulls out of the installed system inside the {spa} {hot tub}, (C) a {53735-11 Brand Name} that helps control bacteria in the water and (D) a {chlorine} {sanitizer} {disinfectant} SPA CHLORINE DISINFECTANT cartridge that helps support the minerals while oxidizing contaminants like body oils {and ammonia compounds responsible for smelly chloramines}. The cartridges are adjustable to meet your specific {spa} {hot tub} water care needs.



A. Cap

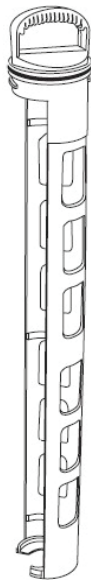

B. Cartridge Holder



C. {53735-11 Brand Name}



D. {Chlorine} {Sanitizer} {Disinfectant} SPA CHLORINE DISINFECTANT Cartridge

Cut-away view of cartridges snapped into holder and placed into the In-Line System.

{Start Up} {Step One: Prepar{e}{ing} the {Spa} {Hot Tub} {Follow all directions from your {spa} {hot tub} manufacturer on filling and balancing the water in your {spa} {hot tub}. Standard guidelines for balancing the water are as follows:}



Water Balance Guidelines

pH:	7.2-7.6 7.8
Total Alkalinity:	80-120 ppm
Calcium Hardness:	150-250 ppm
Total Dissolved Solids:	<1500
{Stabilizer} {Conditioner} {Cyanuric Acid}: {0}{20}{30}-{50}{80} ppm	
{*Free Chlorine:	0.5-1.0 ppm}

1. Fill {spa} {hot tub} with fresh water. If using source water that is high in calcium, iron or other metals, see your dealer before filling the tub. {It may require the use of a metal control product.} If previously using bromine {and switching to {Brand}}, you must drain and refill {your {spa} {hot tub}} {before using this product}. {If previously using dichlor you may convert to {Brand} without having to drain the {spa} {hot tub} as long as the {stabilizer} {conditioner} {cyanuric acid} level is below {50}{80} ppm.
2. Clean or replace filter cartridges {when dirty} (*Follow manufacturer's instructions*).
3. Balance water following steps a through d in order. **IMPORTANT:** Always follow printed instructions on the balancing chemical packages. Add balancing chemicals in small increments one at a time with the jets on and wait 6 hours before testing again and adding any additional balancing chemicals.
 - a. Take a water sample from the {spa} {hot tub} and dip a {Brand} Test Strip into it.
 - b. Look at the Total Alkalinity reading first. Adjustments should be made to bring the Total Alkalinity in the range of 80 – 120 ppm prior to making any adjustments to pH even if it throws pH off further. {Since pH tends to rise in hot tubs, maintaining a Total Alkalinity closer to the low end of 80 will make managing the hot tub easier.}
 - c. After Total Alkalinity is in range, test for pH. It should be between 7.2 and 7.8. If higher or lower, add a pH adjuster. {Again, due to rising pH in hot tubs, try to maintain as close to the low end of 7.2 as possible.}
 - d. Lastly test for Calcium Hardness. It should be between 150 and 250 ppm. If higher, partially drain the {spa} {hot tub} (about 6 inches) and fill with water low in calcium. If lower, add Calcium Increaser.

{If balancing takes longer than 2 days, shock the water and maintain a chlorine level while continuing balancing.}

4. **Very Important!** After balancing and before using cartridges, {establish} {ensure there is} an initial residual of 0.5-1.0 ppm free chlorine with {{53735-12 Brand Name} start-up shock { included in this package}} {an EPA registered chlorine shock.} {that quickly dissolves with an effervescent {fizzing} action – one packet per {500} {600} gallons}

5. {Heat water to the manufacturers recommended temperature.}

Step Two: Set the Cartridges

{The {Brand} In-Line System uses two replaceable cartridges.

- {Insert Color} = {53735-11 Brand Name}
- {Insert Color} = SPA CHLORINE DISINFECTANT

The combination provides the Fresh Mineral Water benefits of cleaner, clearer and softer water that’s easier to take care of. Remove the shrink wrap from both cartridges before proceeding.}

- Set the {insert color} {53735-11 Brand Name} to #6 (hold the bottom and turn the top until 6 appears in the window). No further adjustments are necessary for the life of the cartridge.
- Set the {insert color} SPA CHLORINE DISINFECTANT to the setting that matches your {spa} {hot tub} size in gallons {and pump run time per day}. SPA CHLORINE DISINFECTANT will maintain a low 0.5 to 1.0 ppm chlorine level as long as the pH stays within 7.2 and 7.8 so there is little need to adjust the cartridge setting. If needed, you {may increase or decrease the dial setting} {have two additional settings to increase output}.

INITIAL START-UP SETTING

SPA CHLORINE DISINFECTANT Setting Chart	
Gallons	Setting #
x-x	#
x-x	#
x-x	#
x-x	#

[Note to reviewer: the spa/hot tub gallon range in the setting chart will be between 200 and 600 gallons]

{NOTE: The more you use the {spa} {hot tub}, for instance when you first {get it} {own it}, the greater the setting to achieve at least 0.5 ppm. (This may require a higher setting than what is listed in the chart.) If usage decreases or the chlorine level is greater than 1.0 ppm, lower the setting.}

Step Three: Put{ting} the System to Work

1. Open cap of In-Line System and set aside. DO NOT OPEN CAP WHILE JETS ARE ON.
2. Remove holder by pushing down and turning counterclockwise 1/8th turn before pulling out.
 - {Remove spent cartridges by pushing bottom out through openings in back of holder. Then grab cartridge and pull out.}
3. Snap the {53735-11 Brand Name} into the area marked “Minerals” (top portion) and the SPA CHLORINE DISINFECTANT Cartridge into the area marked {“Bromine”} {or Chlorine”} {or SmartChlor”} (bottom portion) making sure to line up the indentation at the top of the cartridges with the raised area on the holder.

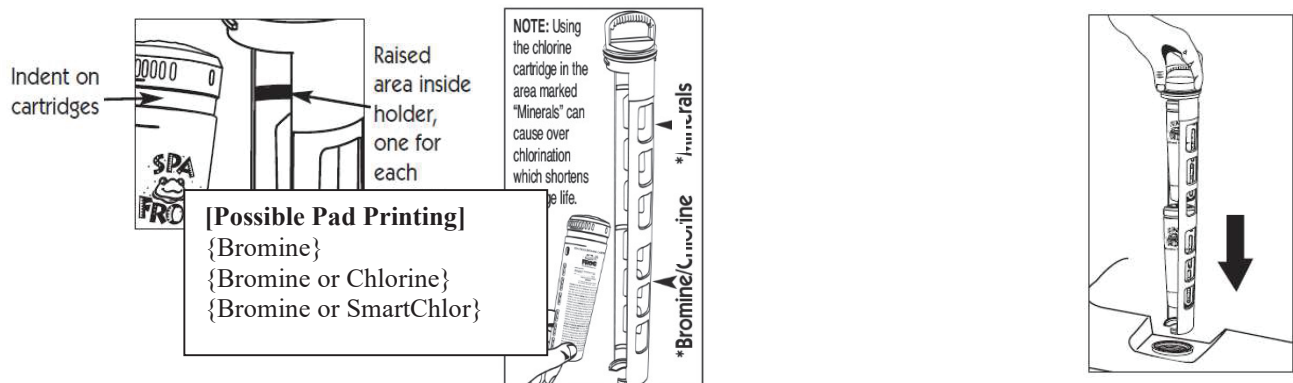

- Slowly insert holder into system (see diagrams). Line up holder arrow-① with system arrow-②. Push down until holder tabs-③ go past system tabs-④ and turn holder to the right (clockwise) until it stops. To ensure a locked position, attempt to pull holder up. If it stays in place, the lock is secure.

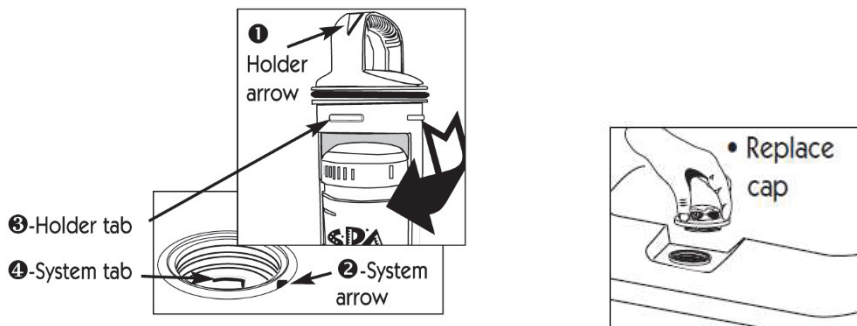

Replacing Cartridges

- {Replace {insert color} {53735-11 Brand Name} every four months or when draining and refilling the {spa} {hot tub}
 - Discard it in the trash even if it appears to have media left inside
 - Don't attempt to reuse: the minerals are spent after 4 months
 - {Use the enclosed stickers to remind you when it's time to replace}
- Replace {insert color} SPA CHLORINE DISINFECTANT when empty based on the {Brand} test strip showing a lighter color than the out indicator {on the {test strip} bottle}
 - The life of the cartridge varies depending on {spa} {hot tub} size and number of users. The SPA CHLORINE DISINFECTANT will last {about 3-4} {up to 4} weeks for an average 400 gallon hot tub.
 - Drain water from cartridge to ensure it is empty
 - Discard in trash or offer for recycling if available}

{Step Four: Routine} {Regular} {Spa} {Hot Tub} Care {Procedures}:

Always follow the directions for operating your particular {spa} {hot tub}.

- Drain and refill {spa} {hot tub} {as directed by your {spa} {hot tub} manufacturer} {or every four months when {Brand} minerals need to be replaced}.

2. Run filtration system as {manufacturer recommends} {directed by your {spa} {hot tub} manufacturer} {to maintain proper water flow through the In-Line System {or at least 3 hours per day}}.
3. {Periodically} {Regularly} {Weekly} test the water {with {Brand} Test Strips and follow directions in {Step One} {Start-up} for maintaining pH, total alkalinity, {and calcium hardness} NOTE: pH is affected by {weather} bather load, chemicals used, evaporation and the make-up of your source water so maintaining water balance regularly is important. {Use {Brand} Test Strips {that came with your {Brand}system} or a test kit to routinely check your pH, Total Alkalinity and Calcium Hardness.}

4. SPA CHLORINE DISINFECTANT will maintain {at least a 0.5 ppm } {a 0.5 – 1.0 ppm} free chlorine {level {as long as the water is balanced} {at all times}. {On the {Brand}Test Strip is an Out Indicator that shows when the SPA CHLORINE DISINFECTANT is empty.} {The SPA CHLORINE DISINFECTANT forms a chlorine {bank} {reserve} that is measured as total chlorine on a standard test strip/kit. This chlorine {bank} {reserve} readily shifts to free chlorine as needed to maintain {a desirable} {our recommended} low level of chlorine {available for disinfection}.} {Based on average {spa} {hot tub} usage,} chlorine will last {on average} {about} {up to} {2} {3}-4 weeks for {spas} {hot tubs} {up to} {of} {350} {400} {500} {600} gallons.}

NOTE: Free chlorine levels are reduced up to 75%* when using {Brand} minerals {and SPA CHLORINE DISINFECTANT Technology}. {NOTE: Why {Brand} Test Strips? The SPA CHLORINE DISINFECTANT forms a chlorine reserve that will be inaccurately measured as total chlorine on other test strips. Unlike conventional chlorine, the SPA CHLORINE DISINFECTANT reserve readily shifts to free chlorine as needed, maintaining spa health with a low level of chlorine.}

5. Shock the {spa} {hot tub} with {{Brand Name} for easy single-dose shocking} {granular chlorine or} {a non-chlorine shock} {when you replace the SPA CHLORINE DISINFECTANT Cartridge or once a month} {if the water looks cloudy} {and/or add a {spa} {hot tub} clarifier according to label directions}. {With SPA CHLORINE DISINFECTANT, far less shocking is required compared to standard water treatments that require weekly shocking or shocking after every use.} See troubleshooting for other issues.
6. {Remember to} Replace your {{53735-11 Brand Name} and SPA CHLORINE DISINFECTANT} {SPA CHLORINE DISINFECTANTs and complete {Brand}System (that comes with a {53735-11 Brand Name})} as directed {under {"Adjusting and When to Replace"} {"Step 3: Put{ting} the System to Work"}}
7. Lubricate in-line holder o-ring twice a year with a silicone lubricant.

Troubleshooting

Cloudy Water {or Low Chlorine Levels}

- Shock the {spa} {hot tub} with {Brand Name} {or} {a non-chlorine shock}
- Check water balance. pH and Total Alkalinity need to be in the proper ranges for the {Brand} System to work correctly
- Check SPA CHLORINE DISINFECTANT and replace if empty—see instructions under {Replacing Cartridges} {Step 3: Put{ting} the System to Work}

- If SPA CHLORINE DISINFECTANT is not empty, turn dial setting up 1 number while maintaining water balance. If needed turn dial up again.
- Check your calendar. The entire {Brand} In-Line System, including the {53735-11 Brand Name}, needs to be replaced every four months. Without the minerals, SPA CHLORINE DISINFECTANT will not be enough to sanitize the {spa} {hot tub}.

SPA CHLORINE DISINFECTANT Life

- If hot tub is larger than 400 gallons or has significant bather load, you may require a higher dial setting which will shorten cartridge life.
- If you think the cartridge setting is too high, you can turn the dial setting down 1 number while maintaining water balance. If needed turn the dial down again.

High Chlorine Levels

- This is highly unlikely with {Brand} because SPA CHLORINE DISINFECTANT is self-regulating. However, if you use standard test strips, it may appear that total chlorine is higher than the free chlorine. No worries—the strip is measuring the SPA CHLORINE DISINFECTANT reserve, which will shift to free chlorine as needed. Please always use the {Brand} Test Strips that were included with your System.

Learn more at frogproducts.com or call 800.222.0169

[Operational Instructions for Floating/Flipping System] [All text is optional]

Floating {Sanitizing} System {Operat{ion}{ing}} Instructions

This is not a toy. For {sanitizing} {disinfecting} {spas} {hot tubs} {swim spas} only!

{Brand} is the hot tub sanitizing system that takes the guess work out of water so you always feel at ease while enjoying your hot tub.

- {{Brand} creates Fresh Mineral Water that's cleaner, clearer and softer
- {Brand} employs SPA CHLORINE DISINFECTANT Technology that knows when and how much free chlorine is needed so it uses up to 75% less.*
- {Brand} flips over when it's time to replace the SPA CHLORINE DISINFECTANT
- {Brand} requires far less shocking – only once a month!}}

* Compared to the minimum ANSI recommended chlorine level of 2.0 ppm for a {spa} {hot tub}.

Read entire operating instructions for complete directions for use.

{Step One: Prepar{e}{ing} the {Spa} {Hot Tub} {Swims Spas} {Start Up}

1. Fill {spa} {hot tub} {swim spa} with fresh water. If using source water that is high in calcium, iron or other metals, see your dealer before filling the {spa} {hot tub}. {It may require the use of a metal control product.} If previously using bromine and switching to {Brand}, you must drain and refill your {spa} {hot tub} {swim spa} {before using this product}. {If previously using dichlor you may convert to {Brand} without having to drain the {spa} {hot tub} {swim spa} as long as the {stabilizer} {conditioner} {cyanuric acid} level is below {50} {80} ppm.}
2. Clean and replace filter cartridges when dirty (*Follow manufacturer's instructions*).
3. Balance water following steps a through d in order. IMPORTANT: Always follow printed instructions on the balancing chemical packages. Add balancing chemicals in small increments one at a time with the jets on and wait 6 hours before testing again and adding any additional balancing chemicals.
 - a. Take a water sample from the {spa} {hot tub} {swim spa} and dip a {Brand} Test Strip into it.
 - b. Look at the Total Alkalinity reading first. Adjustments should be made to bring the Total Alkalinity in the range of 80 – 120 ppm prior to making any adjustments to pH even if it throws pH off further. {Since pH tends to rise in hot tubs, maintaining a Total Alkalinity closer to the low end of 80 will make managing the hot tub easier.}
 - c. After Total Alkalinity is in range, test for pH. It should be between 7.2 and 7.8. If higher or lower, add a pH adjuster. {Again, due to rising pH in {spas} {hot tubs} {swim spas}, try to maintain as close to the low end of 7.2 as possible.}
 - d. Lastly test for Calcium Hardness. It should be between 150 and 250 ppm. If higher, partially drain the {spa} {hot tub} {swim spa} (about 6 inches) and fill with water low in calcium. If lower, add Calcium Increaser.

{If balancing takes longer than 2 days, shock the water and maintain a chlorine level while continuing balancing.}

Water Balance Guidelines

pH:	7.2 – {7.6} {7.8}
Total Alkalinity:	80 – 120 ppm
Calcium Hardness:	150-250 ppm
Total Dissolved Solids:	<1500
{Stabilizer} {Conditioner}	
{Cyanuric Acid}:	{0}{20}{30}-{50}{80} ppm
{*Free Chlorine:	0.5 – 1.0 ppm}

4. **Very Important!** After balancing and before using cartridges, {establish} {ensure there is} an initial residual of 0.5-1.0 ppm free chlorine with {{53735-12 Brand Name} start-up shock {included in this package}} that quickly dissolves with an effervescent fizzing action – one packet per {500} {600} gallons.}

5. Heat water to the manufacturer’s recommended temperature {before using cartridges}.

Step Two: Put{ting} the {Brand} System to Work:

INITIAL START-UP SETTING

SPA CHLORINE DISINFECTANT Setting Chart	
Gallons	Setting #
# – #	#
# - #	#
# - #	#
# - #	#

[Note to reviewer: the spa/hot tub gallon range in the setting chart will be between 200 and 600 gallons while the swim spa gallon range will be between 1000 and 3000 gallons]

{The {Brand} Floating System has two replaceable cartridges.

- {insert color} = {53735-11 Brand Name}
- {insert color} = SPA CHLORINE DISINFECTANT

The combination provides the Fresh Mineral Water benefits of cleaner, clearer and softer water that’s easier to take care of.

[OPTION 1] Simply follow these easy steps:

1. Remove outer packaging from the SPA CHLORINE DISINFECTANT.
2. Line up arrows on both cartridges, push together and lock.
3. Twist the dial on the SPA CHLORINE DISINFECTANT to the setting number for your {spa} {hot tub} {swim spa} (see chart based on gallons)
4. Toss into the {spa} {hot tub} {swim spa}. It will float in the water at a slight tilt.
5. If you like, remove {Brand} from the {spa} {hot tub} {swim spa} while {bathing} {soaking}. Lift out {Brand} and let drain into the {spa} {hot tub} {swim spa}. Place on any surface not susceptible to chlorine bleaching. Remember to return it to the {spa} {hot tub} {swim spa} afterwards.}

Replacing Cartridges

- A. SPA CHLORINE DISINFECTANT: When the {Brand} Floating System flips completely over, remove the {insert color} SPA CHLORINE DISINFECTANT {chlorine} cartridge
 - SPA CHLORINE DISINFECTANT will last {about} {up to 4} {3-4} weeks {/} {for an average} 400 gallon {spa} {hot tub} {or 2000 gallon swim spa}
 - Floating System naturally lists in the water. To check if SPA CHLORINE DISINFECTANT is empty, lift up and drain all water from the system, then

- replace in the {spa} {hot tub} {swim spa} and see if it flips completely.
 - Detach SPA CHLORINE DISINFECTANT SPA CHLORINE DISINFECTANT by twisting to align with “unlock” arrow and pull apart
 - Attach new cartridge (see Step 2: Put{ting} the System to Work
 - Discard in trash or offer for recycling if available. Note: If the SPA CHLORINE DISINFECTANT still contains a small amount after detaching, place in {spa} {hot tub} {swim spa} to float on its own until empty. Do not let it sink to bottom as it may bleach {spa} {hot tub} {swim spa} surface.
- B. {53735-11 Brand Name}: After 4 months or when draining and refilling the {spa} {hot tub} {swim spa}, the {53735-11 Brand Name} must be replaced even if you hear the spent minerals inside. This cartridge is available only in the {Brand System}.

Step Three: {Routine} {Regular} {Spa} {Hot Tub} Care

1. Drain and refill {spa} {hot tub} {swim spa} {as directed by your {spa} {hot tub} {swim spa} manufacturer} {or every four months when {Brand} minerals need to be replaced}. {Whenever you drain and refill, make sure to replace your {Brand} Minerals.}
2. Run filtration system as recommended by your {spa} {hot tub} {swim spa} manufacturer {or at least 3 hours per day}.
3. {Periodically} {Regularly} {Weekly} test water {with {Brand} Test Strips} and follow directions in {Step One} {Start-up} for maintaining pH, total alkalinity, and calcium hardness .

NOTE: pH is affected by {weather} bather load, chemicals used, evaporation and the make-up of your source water so maintaining water balance regularly is important.

4. SPA CHLORINE DISINFECTANT will maintain {at least a 0.5 ppm} {a 0.5 to 1.0 ppm} free {active} chlorine level as long as the water is balanced.

NOTE: Free chlorine levels are reduced up to 75%* when using {Brand} minerals {and SPA CHLORINE DISINFECTANT Technology}

{NOTE: Why {Brand} Test Strips? The SPA CHLORINE DISINFECTANT forms a chlorine reserve that will be inaccurately measured as total chlorine on other test strips. Unlike conventional chlorine, the SPA CHLORINE DISINFECTANT reserve readily shifts to free chlorine as needed, maintaining {spa} {hot tub} health with a low level of chlorine.}

5. Shock the {spa} {hot tub} {swim spa} with {granular chlorine or} {{Brand Name} for easy single-dose shocking} {a non-chlorine shock} when you replace the SPA CHLORINE DISINFECTANT, or once a month {or if the water looks cloudy}.
6. Replace the SPA CHLORINE DISINFECTANT when the system flips over and the complete {Brand} System that includes a {53735-11 Brand} as directed under “Replacing Cartridges”.

Troubleshooting

Cloudy Water {or Low Chlorine Levels}

- Shock the {spa} {hot tub} {swim spa} with {Brand Name} {or} {non-chlorine shock}
- Check water balance. pH and Total Alkalinity need to be in the proper ranges for the {Brand} System to work correctly
- Check SPA CHLORINE DISINFECTANT and replace if empty—see instructions

under {Replacing Cartridges} {Step 2: Put{ting} the System to Work}

- If SPA CHLORINE DISINFECTANT is not empty, turn dial setting up 1 number while maintaining water balance. If needed turn the dial up again.
- Check your calendar. The entire {Brand} System, including the {53735-11 Brand Name}, needs to be replaced every four months. Without the minerals, SPA CHLORINE DISINFECTANT will not be enough to sanitize the {spa} {hot tub} {swim spa}.

SPA CHLORINE DISINFECTANT Life

- If {{spa} {hot tub} is larger than 400 gallons} {swim spa is larger than 2000 galons) with significant bather load, you may require a higher dial setting which will shorten cartridge life .
- If you think the cartridge setting is too high, you can turn the dial setting down 1 number while maintaining water balance. If needed turn the dial down again.
- If {Brand} system continually is sucked into the skimmer or filter well, tether the product to the tub away from the jets.
- Remove {Brand} system while using the hot tub with the jets running.

High Chlorine Levels

- This is highly unlikely with {Brand System} because SPA CHLORINE DISINFECTANT is self-regulating. However, if you use standard test strips, it may appear that total chlorine is higher than the free chlorine. No worries—the strip is measuring the SPA CHLORINE DISINFECTANT reserve, which will shift to free chlorine as needed. Please always use the {Brand} Test Strips that were included with your System.

Learn more at frogproducts.com or call 800.222.0169
Register your Floating System at frogproducts.com

[Operational Instructions for {Filter Well} Systems]
[All text is optional]

{Brand} Sanitizing System Operating Instructions

{Brand} is a {spa} {hot tub} sanitizing system {{specially made} {custom {fit} {designed}} {exclusively} for {Brand} Spas} that takes the guess work out of water care so you always feel at ease while enjoying your {spa} {hot tub}.

- {Brand} System creates Fresh Mineral Water that's cleaner, clearer and softer
- {Brand} System employs SPA CHLORINE DISINFECTANT Technology that knows when and how much free chlorine is needed so it uses up to 75% less.*
- {Brand} System requires far less shocking – only once a month!}

* Compared to the minimum ANSI recommended chlorine level of 2.0 ppm for a {spa} {hot tub}.

Read entire operating instructions for complete directions for use.

Step One: Prepar{e}{ing} the {Hot Tub} {Spa}

1. Fill {spa} {hot tub} with fresh water. If using source water that is high in calcium, iron or other metals, see your dealer before filling the tub. {It may require the use of a hose filter and/or metal control product.} If previously using bromine and switching to SPA CHLORINE DISINFECTANT, you must drain and refill your {spa} {hot tub} before using this product. If previously using dichlor you may convert to SPA CHLORINE DISINFECTANT without having to drain the {spa} {hot tub} {as long as your {stabilizer} {conditioner} {cyanuric acid} level is below {50} {80} ppm}.
2. Clean or replace filter cartridges {when dirty} (*Follow manufacturer's instructions*).
3. Balance water following steps a through d in order. **IMPORTANT:** Always follow printed instructions on the balancing chemical packages. Add balancing chemicals in small increments one at a time with the jets on and wait 6 hours before testing again and adding any additional balancing chemicals.
 - a. Take a water sample from the {spa} {hot tub} and dip a {Brand} Test Strip into it.
 - b. Look at the Total Alkalinity reading first. Adjustments should be made to bring the Total Alkalinity in the range of 80 – 120 ppm prior to making any adjustments to pH even if it throws pH off further. {Since pH tends to rise in hot tubs, maintaining a Total Alkalinity closer to the low end of 80 will make managing the hot tub easier.}
 - c. After the Total Alkalinity is in range, test for pH. It should be between 7.2 and 7.8. If higher or lower, add a pH adjuster. {Again, due to rising pH in hot tubs, try to maintain as close to the low end of 7.2 as possible.}
 - d. Lastly test for Calcium Hardness. It should be between 150 and 250 ppm. If higher, partially drain the {spa} {hot tub} (about 6 inches) and fill with water low

Water Balance Guidelines

pH:	7.2- {7.6} {7.8}
Total Alkalinity:	80-120 ppm
Calcium Hardness:	150-250 ppm
Total Dissolved Solids:	<1500
{Stabilizer} {/} {Conditioner}	
{Cyanuric Acid}:	{0}{20} {30}- {50} {80} ppm
{*Free Chlorine:	0.5 – 1.0 ppm}

in calcium. If lower, add Calcium Increaser.

{If balancing takes longer than 2 days, shock the water and maintain a chlorine level while continuing balancing.}

4. **Very Important!** After balancing and before using cartridges, {establish} {ensure there is} an initial residual of 0.5-1.0 ppm {free} chlorine with {{53735-12 Brand Name} start-up shock {included in this package} that quickly dissolves with an effervescent {fizzing} action – one packet per {500} {600} gallons} {a chlorine shock}.
5. Heat water to the manufacturers recommended temperature

{Step Two: Set{ting} the Cartridges}

The {Brand} System uses two replaceable cartridges.

- {Insert Color} = {53735-11 Brand Name}
- {Insert Color} = SPA CHLORINE DISINFECTANT

SPA CHLORINE DISINFECTANT Setting Chart		
{Brand} Models	{Gallons}	Setting #
a, b, c	{x-x}	#
d, e, f	{x-x}	#
g, h, i	{x-x}	#
j, k, l	{x-x}	#

[Note to reviewer: the spa/hot tub gallon range in the setting chart will be between 200 and 600 gallons]

The combination provides the Fresh Mineral Water benefits of cleaner, clearer and softer water that's easier to take care of.

- Remove the SPA CHLORINE DISINFECTANT from its bag before proceeding.
- Set the {insert color} {53735-11 Brand Name} to # using the dial {on the bottom} of the cartridge. No further adjustments are necessary for the life of the cartridge.
- Set the {insert color} SPA CHLORINE DISINFECTANT to the setting that matches your {spa} {hot tub} {model number} {or {size in gallons}. If needed, you may increase or decrease the dial setting.
- Once set, SPA CHLORINE DISINFECTANT will maintain a low 0.5 to 1.0 ppm chlorine level as long as the pH stays within 7.2 and 7.8 so there is little need to adjust the cartridge setting.

Step Three: Put{ting} the System to Work

[OPTION FOR BRAND A SPAS SERIES X] For #, # and # Series

- Remove filter snap cap. Hold weir door/filter plate out into the hot tub slightly or remove from the hot tub.
- If cartridge {holder} {carrier} is already installed between the filter cartridges, remove by pulling up on the handle.
- Snap the {53735-11 Brand Name} into {one} {top} {bottom} {left side} {right side} {front} {back} opening of the cartridge {holder} {carrier}. With the {Brand} logo facing the {holder} {carrier}, put the dial end of cartridge into the {holder} {carrier} first by connecting the tab on the {holder} {carrier} with the indent in the cartridge. Then push the top part of the cartridge {up} {in} until it snaps into place.
- Follow the same procedure for the SPA CHLORINE DISINFECTANT into the other opening.
- With the {insert color} SPA CHLORINE DISINFECTANT facing the inside of the hot tub, insert cartridge {holder} {carrier} between the filter cartridges under the weir

door/filter plate pushing down until it stays in place.

- Replace filter snap cap.

[Callouts for this section] {Dial end of} Cartridge, {Holder} {Carrier}, {Detail of Cartridge} {Holder} {Carrier} Tab

[OPTION FOR BRAND A SPAS SERIES XX] For # Series

- Turn off main power to the {spa} {hot tub} and remove the JetPak to the right of the main control.
- Remove Simplicity Filter Holder by taking hold of the handle, pushing it {into} {towards the middle of} the {spa} {hot tub} and lift out.
- Insert {53735-11 Brand Name} and SPA CHLORINE DISINFECTANT into the two openings below the filter cartridge. Push cartridges in until they are latched.
- To remove cartridges, push them in until they are free of the latches, then slide them out.
- Replace Simplicity Filter Holder and the JetPak over it. Turn on main power.

[Callouts for this section] Simplicity Filter Holder, Two openings for cartridges, Cartridges installed

[OPTION FOR BRAND B SPAS]

- Remove the filter cover.
- If the {Brand} cartridge {holder} {carrier} is already installed, remove {holder} {carrier} by pulling up and away from filter cartridge using the handle at the top of the {holder} {carrier}.
- Open the arms of the {Brand} cartridge {holder} {carrier} until they snap into position. The handle with the {Brand} logo is the top of the {holder} {carrier}.
- Inserting the {53735-11 Brand Name} into the holder: With the {Brand} logo facing up, place the bottom of the rounded edge of the cartridge into the front of {the upper} {the lower} {one} opening of the {holder} {carrier} and push the cartridge back until it locks into place.
- Follow the same procedure with the SPA CHLORINE DISINFECTANT in the {other} {upper} {lower} opening.
- Unscrew both hot tub filter cartridges to find the one that does not have a grid underneath it. Once determined, screw both filter cartridges back in place.
- Installing the {Brand} {holder} {carrier}: With the {Brand} cartridges facing the inside of the hot tub and the handle of the {holder} {carrier} at the top, slide the {holder} {carrier} down over the filter cartridge that does NOT have the grid underneath it until it covers the entire length of the filter cartridge. If necessary, spread the arms on the {holder} {carrier} to get them around the filter cartridge.
 - Note: {On some {Brand} Spas} {Sometimes}, the filter cartridge over the grid is a {2 part} {ProClarity™} {cartridge system with a plastic base}. Always install the {Brand} cartridge {holder} {carrier} on the {1 piece} {other} filter cartridge.
- In order to re-install the filter cover, you must first rotate the {Brand} {holder} {carrier} by pulling the top part out about ½" away from the filter cartridge and turning the {holder} {carrier} until it touches the other filter cartridge.
- Re-install the filter cover.

[Callouts for this section] {Rounded edge of} Cartridge, {Holder} {Carrier}, {Front of} {Holder} {Carrier} Opening, Filter Cartridge grid

[OPTION FOR BRAND B SPAS FLOATER] Simply follow these easy steps:

- Remove outer packaging from SPA CHLORINE DISINFECTANT.
- Set the dial on the {53735-11 Brand Name} to wide open on setting x.
- Set the dial on the SPA CHLORINE DISINFECTANT to the setting number based on your {spa} {hot tub} model number (see chart).
- Insert the two cartridges into the holder one at a time. Put bottom of cartridge in the holder bracket first with setting dial facing out. Then push cartridge in place.
- Place into the {spa} {hot tub} to float.
- If you like, remove {Brand} System from the {spa} {hot tub} while {bathing} {soaking}. Lift out {Brand} System and let drain into the {spa} {hot tub}. Place on any surface not susceptible to chlorine bleaching. Remember to return it to the {spa} {hot tub} afterwards.

[OPTION FOR BRAND C SPAS]

- Remove the filter lid.
- Installing the {Brand} cartridge {holder} {carrier}: with the filter cartridge in place, slide the {Brand} {holder} {carrier} down over the pipe where the nut is that holds the filter cartridge on. Make sure the openings for the {Brand} cartridges are facing the filter area and the fin on the {Brand} {holder} {carrier} goes between two pleats on the filter cartridge. Push the {holder} {carrier} down using the top handle until it snaps in place. {Do not install on the other side of filter cartridge.}
- Inserting the {53735-11 Brand Name} into the {holder} {carrier}: With the {Brand} logo facing up, place the bottom of the rounded edge of the cartridge into the front of the {holder} {carrier} opening closest to the {outside} {inside} of the {spa} {hot tub} and push the cartridge back until it locks into place.
- Follow the same procedure to insert the SPA CHLORINE DISINFECTANT in the {other} opening {closest to the {outside} {inside} of the {spa} {hot tub}}.
- Make sure the cartridges are completely under water. If not, add water to the {spa} {hot tub} until the cartridges are covered and balance the pH and Total Alkalinity.
- Re-install the filter lid.

[Callouts for this section] {Rounded edge of} Cartridge, {Holder} {Carrier}, {Front of} {Holder} {Carrier} Opening, Filter Cartridge Nut, Wall of Spa

[OPTION D]

- Remove the filter {lid} {cover}.
- Insert {Brand} {holder} {carrier} in the filter well area per the diagram
- Snap {53735-11 Brand Name} into one opening and SPA CHLORINE DISINFECTANT into the other opening.
- Re-install the filter {lid} {cover}.

Replacing Cartridges

- Replace {insert color} {53735-11 Brand Name} every four months or when draining and refilling the {spa} {hot tub}
 - Discard it in the trash even though you will hear the spent media left inside
 - Don't attempt to reuse: the minerals are spent after 4 months
 - {This cartridge is available only in the {Brand} System}
- Replace {insert color} SPA CHLORINE DISINFECTANT when empty based on the {Brand} test strip showing a lighter color than the out indicator {on the {test strip} bottle}
 - The life of the cartridge varies depending on {spa} {hot tub} size and number

of users. The SPA CHLORINE DISINFECTANT will last {about 3-4} {up to 4} {2-4} weeks for an average 400 gallon hot tub.

- Drain water from cartridge to ensure it is empty
- Discard in trash or offer for recycling if available

Step Four: Routine {Spa} {Hot Tub} Care:

1. Drain and refill {spa} {hot tub} as directed by your {spa} {hot tub} manufacturer} {or every four months when {Brand} minerals need to be replaced}. {Whenever you drain and refill, make sure to replace your {Brand} Minerals.}
2. Run filtration system as {directed} {recommended} by your {spa} {hot tub} manufacturer to maintain proper water flow through the system.
3. Regularly test water with {Brand} Test Strips and follow directions in Step One for maintaining pH, Total Alkalinity and Calcium Hardness.

NOTE: pH is affected by {weather} bather load, chemicals used, evaporation and the make-up of your source water so maintaining water balance regularly is important.

4. SPA CHLORINE DISINFECTANT will maintain {at least a 0.5 ppm} {a 0.5 – 1.0 ppm} free chlorine level as long as the water is balanced.

NOTE: Free chlorine levels are reduced up to 75%* when using {Brand} minerals {and SPA CHLORINE DISINFECTANT Technology}.

{NOTE: Why {Brand} Test Strips? The SPA CHLORINE DISINFECTANT forms a chlorine reserve that will be inaccurately measured as total chlorine on other test strips. Unlike conventional chlorine, the SPA CHLORINE DISINFECTANT reserve readily shifts to free chlorine as needed, maintaining spa health with a low level of free chlorine.}

5. Shock the {spa} {hot tub} with {granular chlorine or} {{Brand Name} for easy single-dose shocking} {a non-chlorine shock} } {when you replace the SPA CHLORINE DISINFECTANT Cartridge or once a month} {or if the water looks cloudy}.
6. {Remember to} Replace your SPA CHLORINE DISINFECTANT and complete {Brand} system (that comes with a {53735-11 Brand Name}) as directed {under “Step 3: Put{ting} the System to Work”}.

Troubleshooting

Cloudy Water {or Low Chlorine Levels}

- Shock the {spa} {hot tub} with {Brand Name} {or} {a non-chlorine shock}
- Check water balance. pH and Total Alkalinity need to be in the proper ranges for the {Brand} System to work correctly. {Since pH tends to rise in hot tubs, maintain Total Alkalinity and pH closer to the lower end of the ideal range on the {Brand} Test Strip.}
- Check SPA CHLORINE DISINFECTANT and replace if empty—see instructions under {Step 3:} {Put{ting} the System to Work} {Replacing Cartridges}
- If SPA CHLORINE DISINFECTANT is not empty, turn dial setting up 1 number while maintaining water balance. If needed turn dial up again.
- {Check} {Mark} your calendar. The entire {Brand} System, including a {53735-11 Brand Name}, needs to be replaced every four months. Without the minerals, SPA CHLORINE DISINFECTANT will not be enough to sanitize the {spa} {hot tub}. Simply purchase a new {Brand} System package for a new {53735-11 Brand Name}.

SPA CHLORINE DISINFECTANT Life

- If hot tub is larger than 400 gallons or has significant bather load, you may require a higher dial setting which will shorten cartridge life.
- If you think the cartridge setting is too high, you can turn the dial setting down 1

number while maintaining water balance. If needed turn the dial down again.

High Chlorine Levels

- This is highly unlikely with {Brand} System because SPA CHLORINE DISINFECTANT is self-regulating {the free chlorine levels}. However, if you use standard test strips, it may appear that total chlorine is higher than the free chlorine. No worries—the strip is measuring the SPA CHLORINE DISINFECTANT reserve, which will shift to free chlorine as needed. Please always use the {Brand} Test Strips that were included with your System.

Learn more at frogproducts.com or call 800.222.0169
Register your {Brand} Sanitizing System at frogproducts.com

[All text on this page is optional]

A perfect companion to {minerals} {reduced chlorine systems}
The chlorine that makes it easy to maintain 0.5 ppm free chlorine.

Don't just use chlorine – use {less!} {chlorine with a {twist} {difference} {distinction}}

The controlled-release chlorine {that's ready when {you need it} {needed}} {that lasts for weeks}

Ideal for high bather loads as chlorine is ready when {you need it} {needed}

A more efficient way to use chlorine {that} {to} disinfect{s} and oxidize{s}

Reduces {free} chlorine use up to 75%* {when used with {Brand} minerals}

The low-chlorine solution for {Brand} mineral systems

SPA CHLORINE DISINFECTANT dissolves slower than standard chlorine products making it easier to maintain a low level, and easier to avoid over chlorination

Reduces the need to shock

No {additional} shocking {needed} {required} before or after {each} {spa} {hot tub} use

Reduces shocking by up to 75%**

Less work with prefilled cartridges, precise output and {fewer} {minimal} shock treatments

The chlorine {that actually helps maintain a neutral pH} {with a built-in pH stabilizer}

{Because} {When} {the} {your} pH {stays} {is} neutral, {the} {your} {free} chlorine is {more effective} {at its best}.

With fewer pH adjustments and less shocking required, SPA CHLORINE DISINFECTANT uses less chemicals than standard {spa} {hot tub} water treatments

Reduces overall chemical use with less shocking and pH adjustments

SPA CHLORINE DISINFECTANT {cartridge} contains chlorine but with a {positive} {beneficial} {innovative} twist

- It reduces the potential for pH decline
- It prevents smelly {chloramine} odors
- It nearly eliminates shocking
- It helps prevent over chlorinating {It lasts longer when used with minerals}
- {With minerals, it lasts longer}

[All text on this page is optional]

The SPA CHLORINE DISINFECTANT forms a chlorine {bank} {reserve} that is measured using a total chlorine test. This chlorine {bank} {reserve} readily shifts to free chlorine as needed to maintain a desirable low level of chlorine available for disinfection.

Unlike {all} other chlorines, there is no need to shock when the total chlorine is {twice the level of} {higher than} the free chlorine. Instead, the chlorine {bank} {reserve}, (measured as total chlorine) is waiting to shift to free chlorine as {needed} {it is depleted}. This also allows for the SPA CHLORINE DISINFECTANT {to oxidize odor causing contaminates {like chloramines}} {to nearly eliminate odor causing contaminates} from your {spa} {hot tub} water.

When testing your water, there is no need to compare the total chlorine level to the free. Simply maintain a low 0.5-1.0 ppm free chlorine at all times. However if you notice your total chlorine dropping, that is a good sign that the cartridge may be getting{nearly} empty.

SPA CHLORINE DISINFECTANT {boosts the concentration of} {super charges} {Brand} minerals for even greater effectiveness

The {combination} of {Brand} minerals and SPA CHLORINE DISINFECTANT is very effective in hot water environments as it is easier to maintain a low chlorine level.

Mineral System with Smart Chlor

For cleaner, clearer and softer water that cuts the use of chlorine by 75%*

Each SPA CHLORINE DISINFECTANT molecule contains 2 chlorine atoms – one for immediate use and one left in reserve to release as {needed} {bather load varies}

The simple science of maintaining a consistent sanitizer level

No peak and valley sanitizing

Smart Chlor creating a {reserve} {bank} of untapped chlorine that continually converts into active chlorine against bacteria

Floating {Sanitizer} {Sanitizing System} for {hot tubs} {spas}

Proprietary blend of minerals {with} {plus} SPA CHLORINE DISINFECTANT Technology

Adjust{able}{s} up to 600 gallons

Automatic All-in-One {Hot Tub} {Spa} Care

Complete {Hot Tub} {Spa} Care System

{Creates} Fresh Mineral Water with SPA CHLORINE DISINFECTANT

{An} innovative slow dissolving mineral system {that destroys bacteria while using {up to 75%} less chlorine* – creating cleaner, clearer and softer water}

{1 floating {spa} {hot tub} {sanitizer} {sanitizing system}} {2 pre-filled cartridges} + {plus} # {Brand} Test Strips + {plus} {and} # {53735-12 Brand Name} {start-up shock} Fresh Mineral Water {Easy}

[All text on this page is optional]

An {exclusive} {unique} {proprietary} {innovative} {stand out} water care system from {Brand} that delivers 4 primary advantages

EXPERIENCE THE DIFFERENCE

Our exclusive water care system works in a whole different way. The combination of {Brand} minerals and a low level of chlorine allows you to enjoy these 4 advantages.

THE ALTERNATIVE WAY TO SANITIZE

A fresh approach to clean, clear water using mineral technology that uniquely offers these 4 advantages

THE WATER SANITIZING SOLUTION

Our water care system works differently to eliminate bacteria so you enjoy 4 advantages

AN ALTERNATIVE APPROACH TO WATER CARE

With {Brand} minerals and a low level of chlorine, you'll experience fresh water with these 4 advantages

{Brand} introduces an exclusive water care system that delivers 4 primary advantages.

1. Cleaner because it kills bacteria two {2} ways – with minerals and {a low level of}pre chlorine
2. Minerals help keep the pH balanced for Clearer water that shines
3. Minerals condition the water for Softer effects {feel}
4. Cartridges are pre-filled {for} {no mess, no guess, no stress} making maintenance Easier.

Replace the SPA CHLORINE DISINFECTANT when system flips over ({on average} {about every} {approximately every} {typically in} {{2}{3}-4} {up to 4} weeks)

Replace {53735-11 Brand Name} in {Brand} System every 4 months

{Learn more at} {For more advantages see} www.freshmineralwater.com

{Uses} Up to 75% less chlorine* {with no {frustrating} yo-yo chlorine levels}

Cuts chlorine use up to 75%* while maintaining a constant level

Uses only 25% of normal chlorine levels

Chlorine lasts 3X longer with SPA CHLORINE DISINFECTANT and {Brand} Minerals

Shock {only} once a {per} month

The unique SPA CHLORINE DISINFECTANT technology does the work with far less shocking

Here's a shock – No need for weekly shocking your {hot tub} {spa}

The chlorine that automatically shocks the water for 4 weeks

Self {shocking} {refreshing} {chlorinating} water care system

So little shocking, it's shocking!

Takes the shock out of {hot tub} {spa} care

[All text on this page is optional]

No shocking the {hot tub} {spa} after each use
{Hot Tub} {Spa} Water Care – for once you're not in for a shock
Making a little chlorine go a long way
Just what you need – and no more
Because less is more

Self regulates {chlorine levels} for continuous crystal clear water
The unique chlorine reserve goes into action only when needed
The two step chlorine that's time released to meet {hot tub} {spa} demand
When you hop in, SPA CHLORINE DISINFECTANT goes to work keeping water
clean and clear

Easy on {hot tub} {spa} surfaces with less odors
Won't fade swimsuits or dry out skin or hair
Protects your {hot tub} {spa} investment while providing a more enjoyable experience
Easy on your nose

Single color match for easy reading – {exclusively with} {only from} {Brand} Test
Strips
{Brand} Test Strips – the only sure test for SPA CHLORINE DISINFECTANT
Simple Go – No Go water testing only from {Brand} products
The easy test strips only from {Brand}

The innovation of SPA CHLORINE DISINFECTANT
These benefits provided {brought to you} by {the breakthrough technology of} SPA
CHLORINE DISINFECTANT {Technology}.
The chlorine that {reacts} {responds} to {hot tub} {spa} use by maintaining a
consistent chlorine level
Unlike normal chlorine that is used up when you get in, SPA CHLORINE
DISINFECTANT continues to maintain the same level
The {vigilant} {proactive} {responsive} {reactionary} chlorine that consistently
{sanitizes your water} {keeps your water clean and clear}When you get in, normal
chlorine levels drop but SPA CHLORINE DISINFECTANT remains constant

Fresh Mineral Water Cartridge Lasts 4 months
SPA CHLORINE DISINFECTANT lasts {2}{3}-4 weeks
Floats in the {hot tub} {spa}
Flips over when the SPA CHLORINE DISINFECTANT is empty

No adding chlorine daily
No more daily spoon fulls of chlorine
Ditch the daily dosing
Eliminates a cap full a day
No daily maintenance
Stop spoon-feeding your {hot tub} {spa}! {It can take care of itself}

[All text on this page is optional]

Sporks are for drive-ins, not {spa} {hot tub} care

No measuring, no math, no doubt.

Intelligent water care

You don't have to be a genius to see it's {working} {innovative} {amazing} {smart} {not your ordinary water care} {in a class by itself}

A real breakthrough in {hot tub} {spa} {water} care. A real break for you.

All the clean without all the chlorine

No guesswork. Just less work.

{Hot Tub} {Spa} {water} care doesn't have to be so hard

To find out how you can be more {Brand} visit frogproducts.com

Whew, the honey-do-list {your to do list} just got shorter

To find out how you can shorten your honey-do {to do} list visit frogproducts.com

{Brand} at your service

Nicknamed "the butler" our innovative slow dissolving mineral system with SPA CHLORINE DISINFECTANT for {hot tubs} {spas} will no doubt leave you more at ease

To find out how you can get your own butler visit frogproducts.com

Crystal clear {hot tub} {spa} – chemistry degree not required

{Brand} is @automatic

Minerals Destroy Bacteria for less chlorine use

SPA CHLORINE DISINFECTANT slowly releases chlorine when needed

Together they create Fresh Mineral Water that's Cleaner, Clearer, Softer and Easier

The Mineral Innovation

- Reduces chlorine use up to 75%*
- Conditions the water for softness
- Easy on {spa} {hot tub} surfaces with less odors
- Lasts four full months

The Breakthrough Science {Technology} of SPA CHLORINE DISINFECTANT

- Maintains a consistent 0.5 ppm {sanitizer} {disinfectant} {chlorine} level
- Uniquely time released with a chlorine reserve ready when needed
- Easier to test with {Brand} Test Strips and one color match
- Oxidizes contaminants so far less shocking is required

How {Brand/Product} Works

- The Fresh Mineral Water Cartridge snaps together with the SPA CHLORINE DISINFECTANT
- It floats in the hot tub {spa} and flips over when the SPA CHLORINE DISINFECTANT is empty
- Replace the SPA CHLORINE DISINFECTANT (every {2}{3}-4 weeks) and recycle the empty one

[All text on this page is optional]

Minerals and SPA CHLORINE DISINFECTANT completely sanitize any hot tub {spa} with no need for ozone, UV or other devices.
Compatible with ozone {UV} if desired

Start with a freshly filled {hot tub} {spa} or convert any {hot tub} {spa} to Fresh Mineral Water with SPA CHLORINE DISINFECTANT
No corrosion issues with SPA CHLORINE DISINFECTANT

Hassle free {hot tub} {spa} sanitization {water care} {maintenance}
Water looks and feels luxurious
SPA CHLORINE DISINFECTANT isn't susceptible to big swings in sanitizer levels after use. It maintains a consistent level that just works!

{Welcome to the} spoon-free zone
Step into easy
{Hot tub-life} {Spa-life}. Made easy
Take it easy on yourself

Easy-does-it
Easy-to-tell
Easy-to-see
Easy-to-use
Easy-to-understand
Easy-to-follow
Easy-to-wow
Easy-to-read
Easy-to-decode
More innovation. Less stress.
More innovation. Less upkeep.
More wows. Less ughs.

The difference between {liking and loving your {spa} {hot tub} {perfect pH and pHew!}
{green and clean}
How can anything this hard on bacteria feel so soft
Feel the difference
For {Hot Tubs} {Spas}

{Plus} {Also} {Includes} {#} {Brand} test strips and {#} {53735-12 Brand Name} start-up shock
{Kit} Contains, 1 {53735-11 Brand Name}, 1 SPA CHLORINE DISINFECTANT, 1 {53735-12 Brand Name} start-up shock packet and 1 bottle of # {Brand} Test Strips
{Kit} Contains, {3} {4} SPA CHLORINE DISINFECTANT Cartridges and {3} {4} {maintenance} {non-chlorine} shock packets
{1} {3} Replacement {SPA CHLORINE DISINFECTANT} Cartridge{s}
Product shown is actual size

[All text on this page is optional]

[Protective Seal Copy]

Remove this {seal} {label} before use. Hold over the {hot tub} {spa} and allow any {fines} {particles} to dissolve in the water.

{Brand} Smart Technology
35 years of water treatment innovation
Yes, it does revolve around you
Relax & Enjoy

SPA CHLORINE DISINFECTANT {in the {Brand} systems} contains no {cyanuric acid} {{CYA}}. Therefore it will not cause {cyanuric acid} {CYA} build-up that reduces the {effectiveness} {efficiency} of chlorine.

SPA CHLORINE DISINFECTANT {in the {Brand} systems} destroys bacteria {and organic contaminants} without over-stabilizing your hot tub or adding additional {cyanuric acid} {CYA} to your water.

With no {cyanuric acid} {{CYA}} in SPA CHLORINE DISINFECTANT, hot tub water does not get {dull} {old} {used up} as quickly. That means with {Brand}, water will last a full 4 months before needing to be drained and refilled.

{Brand System} has no {cyanuric acid} {CYA} that can build-up quickly leaving chlorine ineffective and requiring you drain the water prematurely. Dichlor adds {cyanuric acid} {CYA} to the hot tub with every dose. {Brand System} does not.
{Cyanuric acid} {CYA} too high? It's time to drain your hot tub. {Brand System} has no {cyanuric acid} {CYA} so you could still be enjoying your hot tub.

{Cyanuric acid} {CYA} protects the chlorine from sunlight's destruction} {from being burned off by the sun}. Since hot tubs are covered, there is no need to protect the water from the sun so there is no need for {cyanuric acid} {CYA}. When {cyanuric acid} {CYA} gets too high in a dichlor hot tub, the water is over stabilized. The result is:

- Dichlor becomes less effective, decreasing its bacteria-killing power
- The water becomes {hazy} {cloudy} or algae appears
- An unsafe hot tub for family and friends
- You have to drain your water and start again.

Did you know when you use dichlor, your {building up {cyanuric acid} {CYA}} {creating a {cyanuric acid} {CYA} bath} {asking for trouble with {cyanuric acid} {CYA} build up}?

The {Brand} difference is what we don't put in {it} {Brand}

[All text on this page is optional]

With no {cyanuric acid} {CYA} in SPA CHLORINE DISINFECTANT, you can {extend the life of your hot tub water} {{go longer between} {reduce the hassles of constant} draining and refilling}

[Alternate copy for email registration card]

Welcome to {Brand} hot tub water care courtesy of {Brand} with Fresh Mineral Water and SPA CHLORINE DISINFECTANT Technology. To help you get the most from your {Brand} System, we'd like to send you a few helpful start-up and basic maintenance tips via e-mail. Simply complete this card and throw it in the mail or visit kingtechnology.com and frogproducts.com and click on Join our

Newsletter. If you have any questions, please call our Customer Service Department at 800-222-0169. Sign up for helpful e-mails today!

Connect with us for special offers and helpful tips. Provide your email to receive offers, helpful hints, product information and more. Sign up now and be entered in our monthly drawing to win a special {Brand} gift. These include {Brand} product, water bottles, towels, and more. Or register online at frogproducts.com

Product Purchased: Flippin' FROG, Flippin' FROG XL, SPA FROG Floating System, Filter FROG, {Brand} Floating System, {Brand} In-Line System

Please Print: Name, email (please print carefully – you can opt out from receiving emails at any time., phone (home, mobile, work), Retailer (if known), city, state

[Additional copy for Water Balance Guide insert for Spa Chlorine Disinfectant use with {53735-11 Brand Name} – All copy is optional]

Hot Tub Water Balance Guide: How to get your hot tub relaxation ready. Before you balance: Step 1 – Test your water for hardness. Take a sample of the water you plan to use to fill your hot tub to your dealer and check for hardness. If over 250 ppm, don't use that water to fill your hot tub! A simple hose filter from your local dealer can solve your issue.

Step 2 – After the hot tub is filled, take a sample of that water to your dealer to check for metals. If it tests high for metals, use a metal out product.

4 Tips for successful weekly balancing:

1. Always balance in order with Step 1: Total Alkalinity, then Step 2: pH and then Step 3: recheck water hardness.

Step 1: Total Alkalinity 80-120 ppm: Starting with Total Alkalinity (TA) first will make it much easier to balance the pH. Low TA: add TA Increaser or TA Up. High TA: add the same product that lowers pH usually called pH Decreaser or pH Down.

STOP: Proceed to pH ONLY when Total Alkalinity is between 80 and 120 ppm

Step 2: pH 7.2-7.8: pH is important for maintaining clean, clear water that doesn't attack surfaces or irritate skin. Low pH: add a pH Increaser or pH Up product. High pH: add a pH Decreaser or pH Down product.

[All text on this page is optional]

STOP: Proceed to Water Hardness ONLY when pH is between 7.2 and 7.8.

Step 3: Water Hardness 150-250 ppm: Check Water Hardness AGAIN to make sure the calcium level is not too low so the water does not corrode surfaces. Low Water Hardness: if Water Hardness is under 150 ppm, add Calcium Increaser.

2. Add adjustment chemicals in small increments (follow label directions carefully)
3. Wait 6 hours between adjustments as your adjustment chemical has time to work
4. If balancing takes longer than 2 days, add a chlorine shock to maintain sanitizer levels.

When Total Alkalinity is 80-120, pH is 7.2-7.8 and water hardness is 150-250 ppm, your water is balanced.

Troubleshooting Tips for {Brand} Floating or In-Line Systems

Hot tub owners tell us the {Brand} System is the easiest water care system they have ever used. The key is to maintain water balance and make sure you replace the {Brand} SPA CHLORINE DISINFECTANT when empty (approximately every 3-4 weeks). Here are a few tips should you experience one of these issues:

Cloudy Water / Under Chlorination

1. Check your water balance. If your pH or TA is off, SPA CHLORINE DISINFECTANT will not be as effective. Most often the free chlorine residual is low when the pH is too high. Add pH Down to bring the pH into the ideal range of 7.2-7.8. The free chlorine residual will then come back up to 0.5 ppm after the pH adjust has been made.
2. Check to see if your {Brand} SPA CHLORINE DISINFECTANT is empty. In some circumstances, the system may not completely flip over. Pull it out of the hot tub and drain all the water. Then put it back in. If it immediately flips over, it's empty. You can also shake it slightly to feel if there is any SPA CHLORINE DISINFECTANT material left in side.
3. Make sure your {Brand} Minerals have not been used for more than 4 months. When you hear minerals left inside the blue cartridge, it is because one of the minerals does not completely dissolve. The mineral that does the bacteria fighting however only lasts 4 months so you must replace the minerals at that time. We suggest making a note on your calendar for the replacement date of the minerals and be sure to replace every time you drain and refill your hot tub

High Combined Chlorine Levels

1. This is normal! With the {Brand} self-regulating process, there is a chlorine reserve that converts to free chlorine automatically when needed.
2. When testing SPA CHLORINE DISINFECTANT with a standard test strip, you will see the total chlorine is higher than the free chlorine. The total is the SPA CHLORINE DISINFECTANT reserve that is inactive. When the hot tub needs more free chlorine to kill bacteria, it pulls from the reserve. Therefore, no shocking is required when the total reading is different than the free reading.

To prevent confusion, always use {Brand} Test Strips. A 30-count bottle comes with every {Brand} Floating and In-Line System.

Dichlor is difficult to maintain at consistent levels {and requires constant dosing}

{Take the pain out of hot tub care} {Make it easy} with {Brand}

Stop doing things the hard way

Switch {from Dichlor} to {Brand} and you'll never go back {to Dichlor}

[All text on this page is optional]

Ease {up} {your hot tub care} {. Try} {with} {Brand}

The easiest thing you'll ever do

Dichlor is a {drag} {chore}

{Dichlor is hard} {End the chore of Dichlor} {{Brand} does everything Dichlor does but easier}
with:

- {No} yo-yo chlorine levels
- {No} daily chlorine dosing
- {No} touching or spilling chlorine
- {No} wondering how much to add

Enjoy Spa Ease with {Brand}

Spa Ease: what you experience with {Brand} products

Create Spa Ease in your {spa} {hot tub}

Sanitizing made easy – that's Spa Ease

Spa Ease – as easy as 1, 2, Ahh

Fit's all 2013 and later model {Brand} Spas excluding models X5L and X6R

Download {the} free {Brand} {Water Care} App

Tap into the App – Watercare guide for {spas} {hot tubs} and pools

- Easy water testing advice
- Water care at your fingertips
- Helpful reminders and more

Expert advice, reminders & more

Simple water care at your fingertips

Put your mind and body at ease

Not just clean, Serene

Rediscover the simple joy of owning a hot tub

Powered by Fresh Mineral Water

Easier to manage with pre-filled cartridges

Reduces shocking to only once a month

Same {great product} {innovative technology} – {new name} new look

Goodbye constant monitoring. Hello to being at ease.

Pure relaxation is within reach.

Say hello to easy-water-care.

Say hello to the "aahs."

Say hello to simple.

Welcome to easy

Innovation meets simplicity

Ready. Set. Relax.

Relax. We're here to help.

Hurray, no more daily monitoring.

The only thing to measure: the number of "aahs."

From ah-ha to aaahhh

[All text on this page is optional]

Congrats, you're seconds away from pure relaxation.
Woo-hoo, no daily chores. (Because you're already opening a hot-tub sanitizer package, no need to identify that's it's hot tub water cleaning chore.)
Welcome "aahs."
Welcome to the FROG-revolution
Innovation awaits...
Easy does it
Relax, you got this.
Open to innovation
Say hello to your hot tub butler
Relaxation starts here.
EXHALE
Be at ease. Be crystal clear.
Soak in simplicity
Chore be gone
Ease. Soak it in.
Relaxation: Dial in.

[Phone App Icon for SPA CHLORINE DISINFECTANT used with 53735-11]

