

PM-90

Reg # 47629-2

193

ROACH BAIT SYSTEMS KNOCKDOWN

KNOCKDOWN BRAND ROACH BAIT SYSTEMS

3 F R E E KNOCKDOWN

BRAND ROACH

15 1/2 Bait Systems

Trampas con Cebo para Cucarachas

• Knockdown Prices
and Kill Roaches

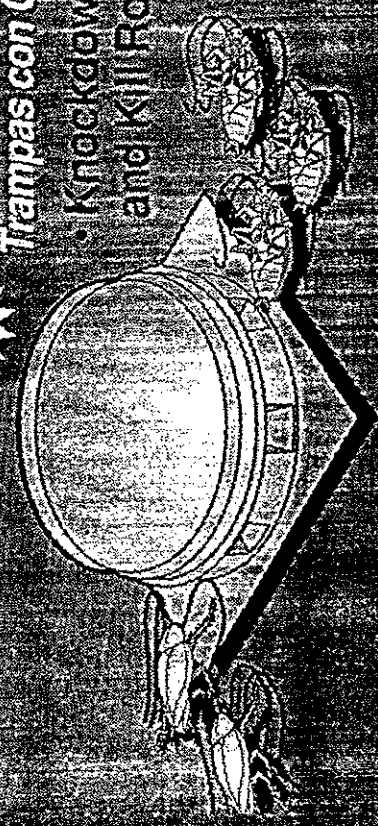

For residential-commercial use only.

Net Weight (3125 oz. (87.5g)) 15 Bait Systems

CAUTION

Keep out of the reach of children and pets.

BEST AVAILABLE COPY

KNOCKDOWN BRAND ROACH BAIT SYSTEMS

ACTIVE INGREDIENTS
Cyfluthrin (0.05%)
Permethrin (0.05%)
Piperonyl Butoxide (1.0%)
INERT INGREDIENTS
Total 100%

293

BEST AVAILABLE COPY

KNOCKDOWN

BRAND

Attractant lures roaches from the nest.
Made from boric acid, which kills roaches.
Tiene una substancia fuerte que atrae a las cucarachas del nido.
Hecho del acido borico, que mata a las cucarachas.

DIRECTIONS: To use, fill the bait stations with the attractant. Place the bait stations in areas where roaches are likely to be present. For best results, use in areas where roaches are likely to be present.

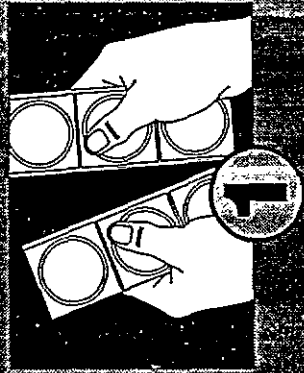

1

Remove from bait stations.
Se debe retirar de las estaciones de cebo.

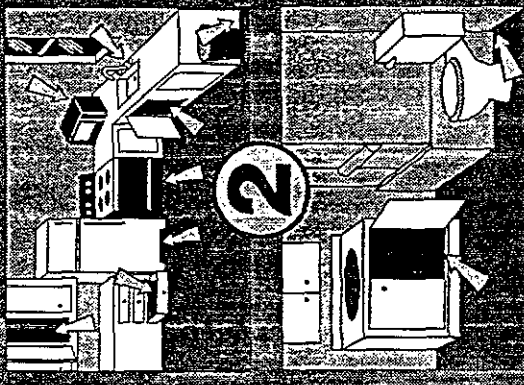

2

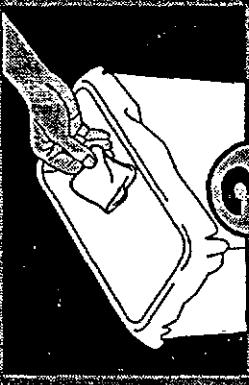

3

Wipe and spray traps with insecticide.
Limpiar y rociar las trampas con insecticida.

Wipe and spray traps with insecticide.
Limpiar y rociar las trampas con insecticida.

Wipe and spray traps with insecticide.
Limpiar y rociar las trampas con insecticida.

Wipe and spray traps with insecticide.
Limpiar y rociar las trampas con insecticida.

CAUTION

KEEP OUT OF REACH OF CHILDREN.
MANTENER FUERA DEL ALCANCE DE LOS NIÑOS.

PRECAUTION: THIS PRODUCT IS TOXIC TO HUMANS AND DOMESTIC ANIMALS.
PRECAUCION: ESTE PRODUCTO ES TOXICO PARA LOS SERES HUMANOS Y LOS ANIMALES DOMESTICOS.

Place traps in bedrooms, bathrooms, and other places where roaches have been seen.
Colocar las trampas en dormitorios, baños y otros lugares donde se hayan visto cucarachas.

Place traps in bedrooms, bathrooms, and other places where roaches have been seen.
Colocar las trampas en dormitorios, baños y otros lugares donde se hayan visto cucarachas.

Place traps in bedrooms, bathrooms, and other places where roaches have been seen.
Colocar las trampas en dormitorios, baños y otros lugares donde se hayan visto cucarachas.

Place traps in bedrooms, bathrooms, and other places where roaches have been seen.
Colocar las trampas en dormitorios, baños y otros lugares donde se hayan visto cucarachas.

Place traps in bedrooms, bathrooms, and other places where roaches have been seen.
Colocar las trampas en dormitorios, baños y otros lugares donde se hayan visto cucarachas.

Place traps in bedrooms, bathrooms, and other places where roaches have been seen.
Colocar las trampas en dormitorios, baños y otros lugares donde se hayan visto cucarachas.

Place traps in bedrooms, bathrooms, and other places where roaches have been seen.
Colocar las trampas en dormitorios, baños y otros lugares donde se hayan visto cucarachas.

Place traps in bedrooms, bathrooms, and other places where roaches have been seen.
Colocar las trampas en dormitorios, baños y otros lugares donde se hayan visto cucarachas.

Place traps in bedrooms, bathrooms, and other places where roaches have been seen.
Colocar las trampas en dormitorios, baños y otros lugares donde se hayan visto cucarachas.

Place traps in bedrooms, bathrooms, and other places where roaches have been seen.
Colocar las trampas en dormitorios, baños y otros lugares donde se hayan visto cucarachas.

Place traps in bedrooms, bathrooms, and other places where roaches have been seen.
Colocar las trampas en dormitorios, baños y otros lugares donde se hayan visto cucarachas.

Place traps in bedrooms, bathrooms, and other places where roaches have been seen.
Colocar las trampas en dormitorios, baños y otros lugares donde se hayan visto cucarachas.

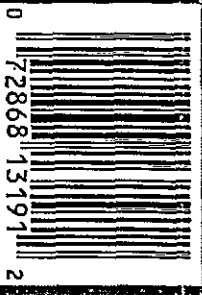

KNOCKDOWN

BRAND

ROACH BAIT SYSTEMS

ACCEPTED

27 Nov 1996
Under the Federal Insecticide, Fungicide, and Rodenticide Act, as amended, for the pesticide registered under EPA Reg. No. 47629-2

393

KNOCKDOWN
BRAND
ROACH BAIT SYSTEM
THIS SIDE UP

Active Ingredients:

German Cockroach Pheromone.....	0.004 %
Boric Acid.....	46.998 %
Inert Ingredients.....	52.998 %
TOTAL.....	100.000 %

NET WT. .0875 oz. (2.5g) KEEP OUT OF REACH
EPA Reg. No. 47629 OF CHILDREN AND PETS.
EPA Est. No. 55501-AL-01 **CAUTION**

PRECAUTIONARY STATEMENTS,
DIRECTIONS FOR USE & DISPOSAL: See outer carton

Woodstream
69 N. Locust ST.
Lifitz, PA 17543

ACCEPTED

7
20 November 1996

Under the Federal Insecticide,
Fungicide, and Rodenticide Act,
as amended, for the pesticide
registered under
EPA Reg. No. 47629-2

393