

instapure® water filter
by Water Pik

FAUCET MODEL F-1
Gives clearer, better tasting water for drinking, cooking, ice cubes, tea and coffee.

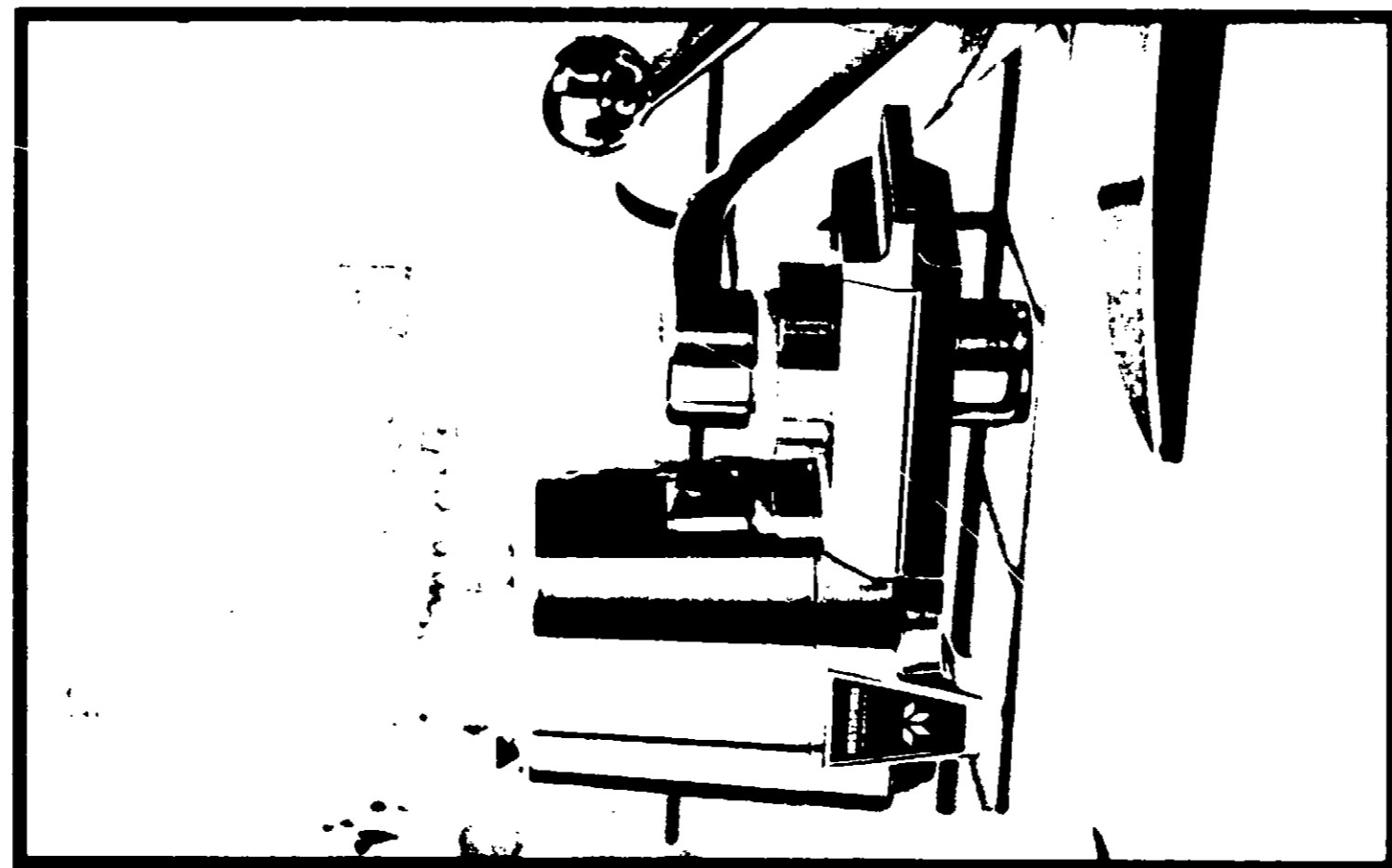

CAUTION:
Keep Out of Reach of Children.

ACTIVE INGREDIENT
Elemental Silver 0.2%
INERT INGREDIENTS 99.8%

instapure® water filter
by Water Pik

FAUCET MODEL F-1
instapure® water filter
by Water Pik

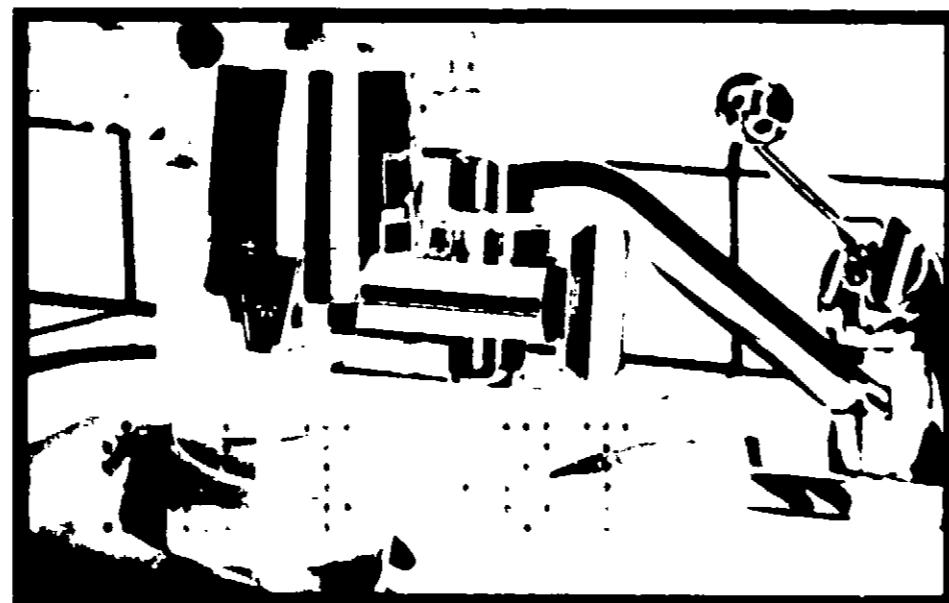

1. Flip Filter Switch down for filtered water.

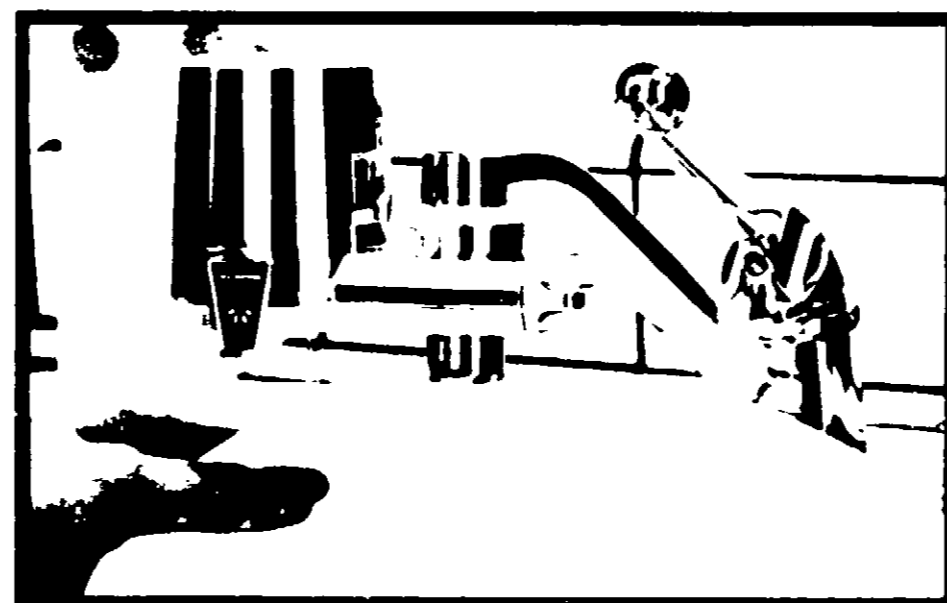

2. Keep Filter Switch level for unfiltered tap water supply.

WORKS WITH A SIMPLE FLIP OF A SWITCH

CONTENTS: ONE INSTAPURE® WATER FILTER MODEL F-1.

COMPLETE WITH FILTER CARTRIDGE AND INSTRUCTION BOOKLET

ACCEPTED

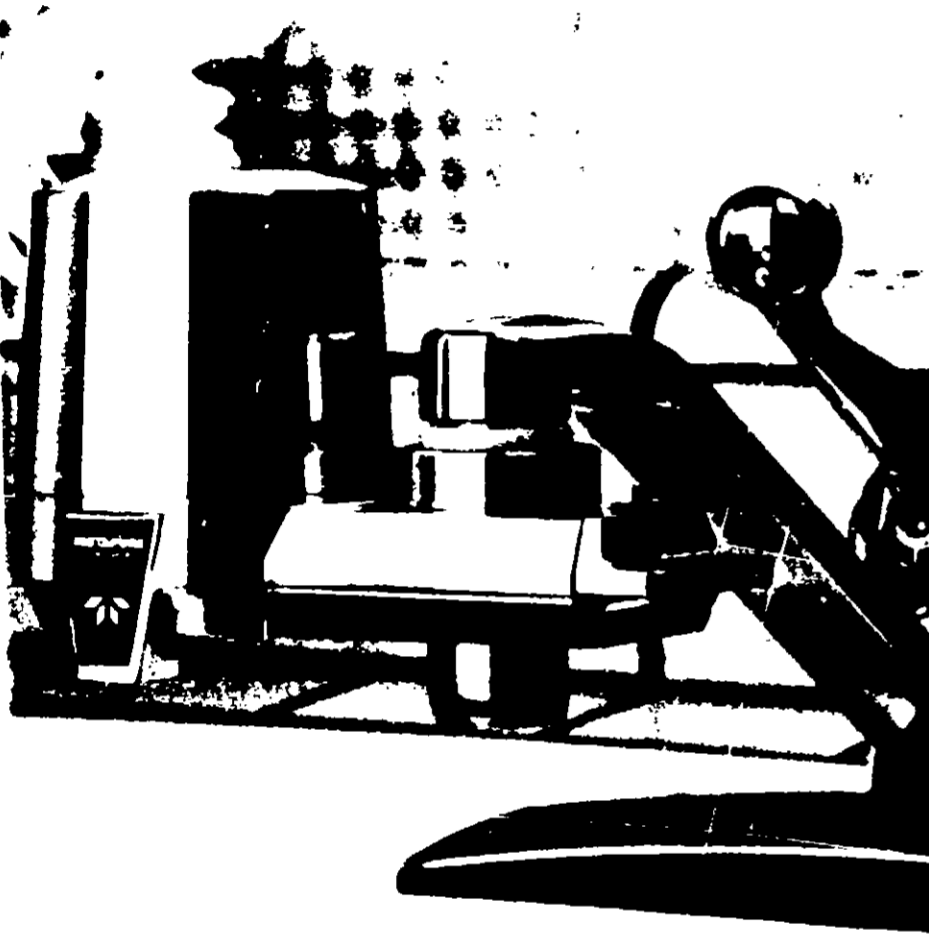

Introducing the
Instapure® Water Filter
by Water Pik.

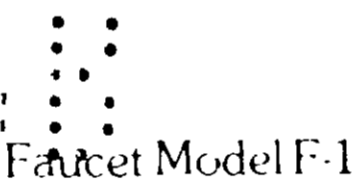
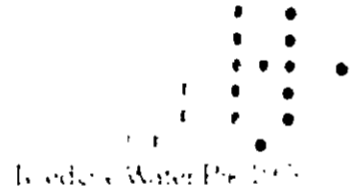
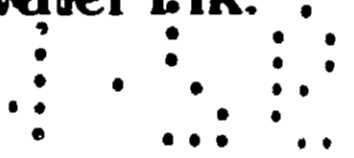

Water Pik

Faucet Model F-1

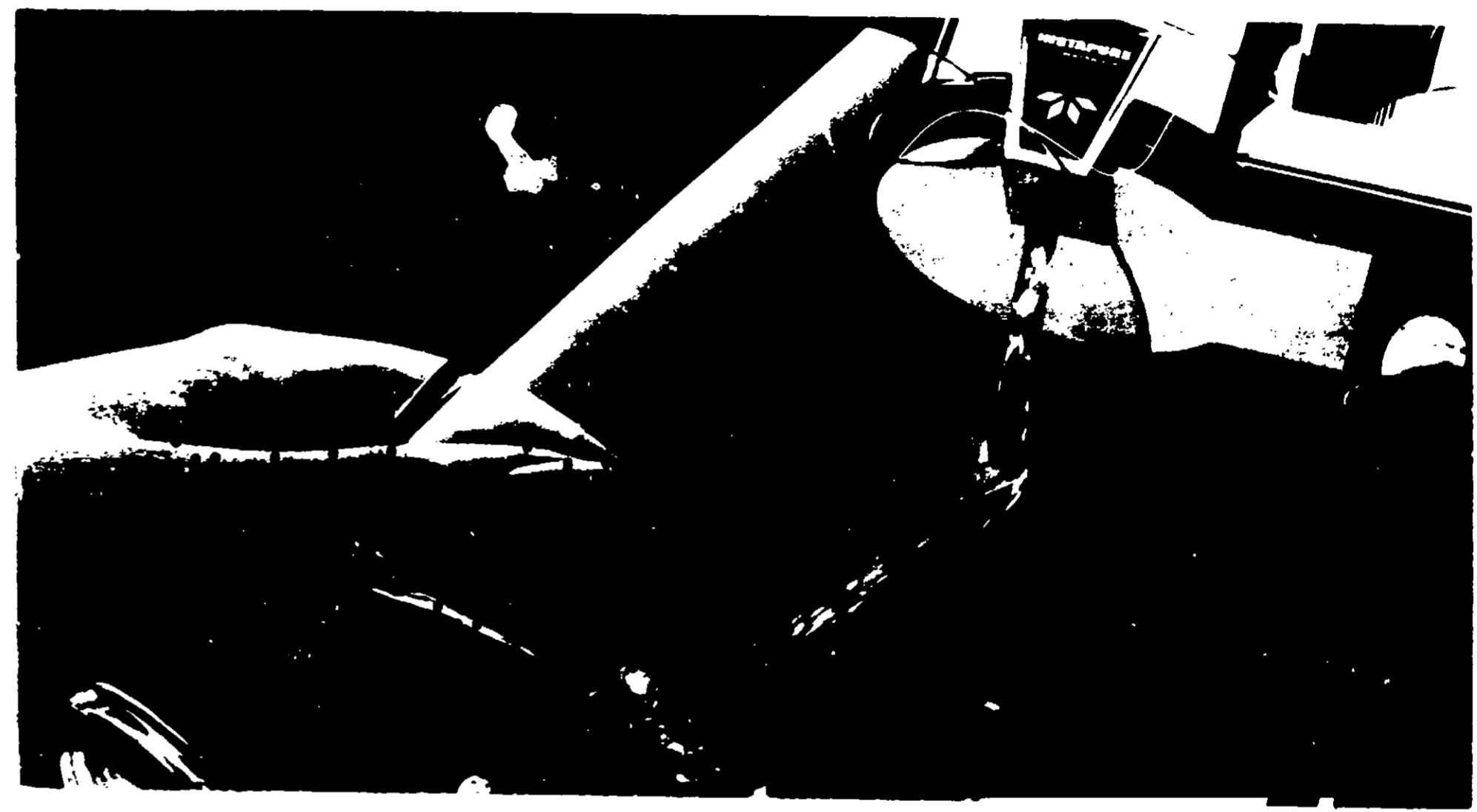

ACCEPTED

Comments

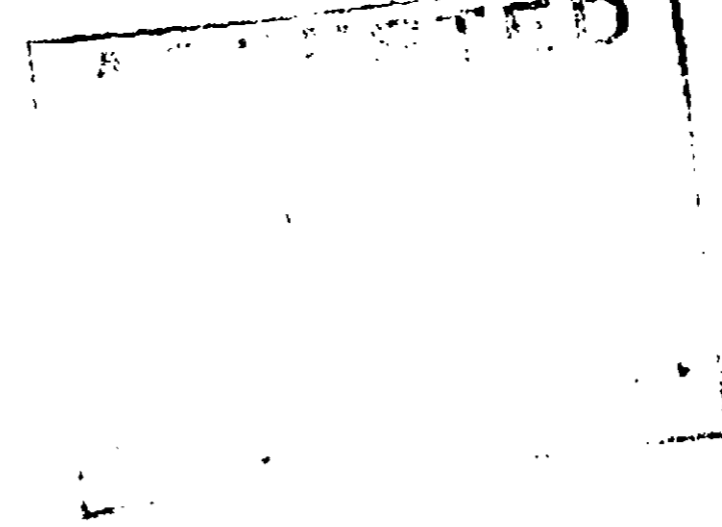

The Instapure® Water Filter is scientifically designed to remove chlorine and suspended particles without removing minerals or fluoride. The Instapure Water Filter inhibits growth of bacteria within the filter. It gives you clearer, better tasting water. For drinking, cooking, ice cubes, tea and coffee.

Instapure® Water Filter

Simple

The Instapure Water Filter is simple to install. Simple to operate.

Turn switch "Down" for filtered water.

Turn switch "Level" for unfiltered tap water.

Instapure® Water Filter

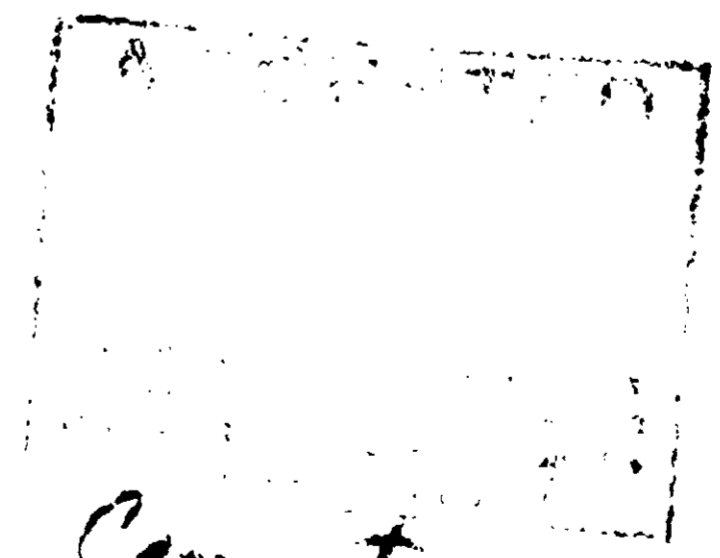
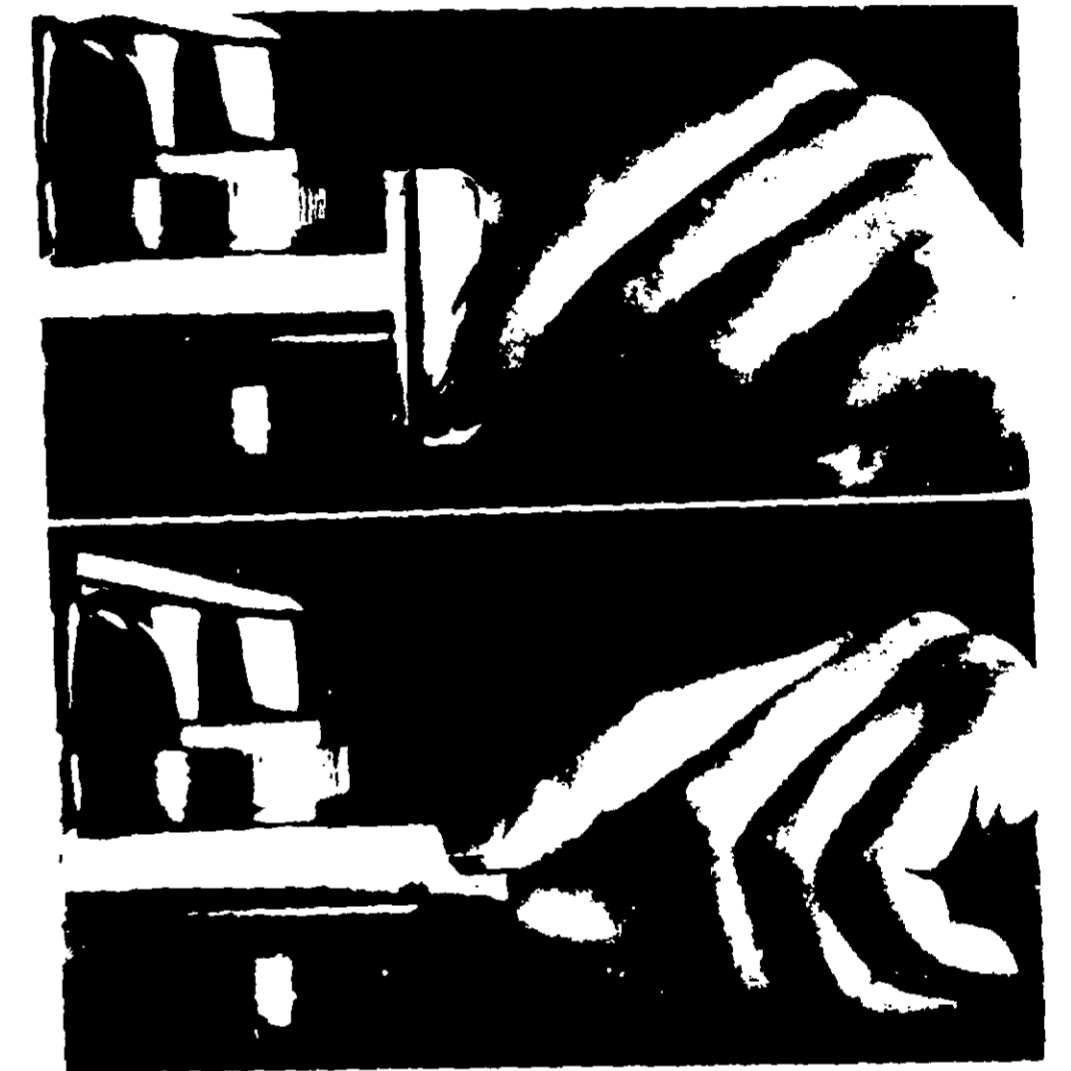

Comments

The Filter

To insure maximum efficiency, each Instapure Water Filter must be changed every 200 gallons. Exactly how long the filter will last depends on the size of your family, how much filtered water you use and the condition of the water in your



community. The average daily usage for a family of four is two gallons, and therefore the filter should be changed every three months.

You may need to change the filter before the 200 gallon limit if the flow of water from your Instapure Water Filter begins to slow or if you notice a change in the taste or appearance of the filtered water.

To change the filter, simply unscrew the sprayer face, lift out the old filter cartridge and insert a new one.

Each Instapure Replacement Filter should be "flushed" with approximately one gallon of cold water before use to remove carbon fines.

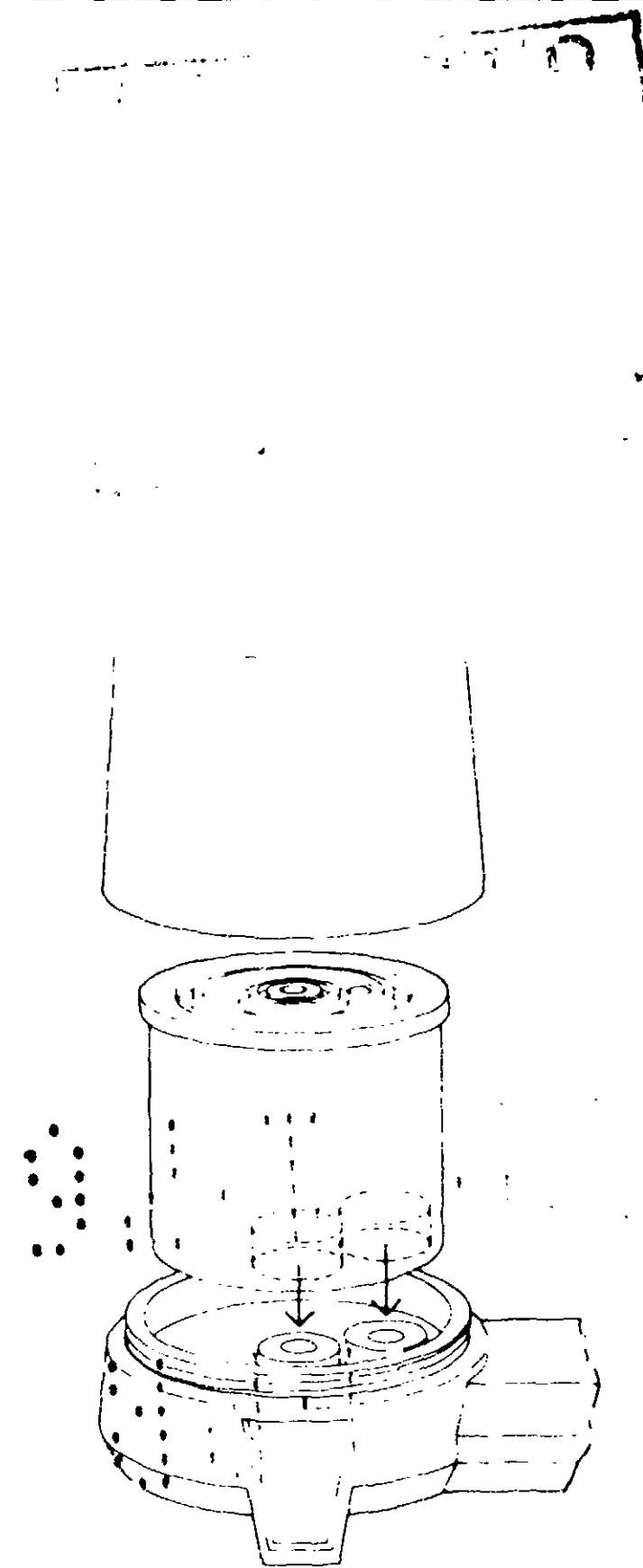

NOTE: The Instapure Water Filter has been designed for use in homes with pretreated municipal water systems. It operates most effectively with cold water and should not be used with hot water.

The Instapure Water Filter does not demineralize water and does not replace distilled water for use in your steam iron.

The Instapure Water Filter has been thoroughly laboratory tested over the 200 gallon life span of the filter to insure that the filtered water will never exceed the maximum silver level of 50 parts per billion allowed for potable water.

The Instapure Water Filter functions most reliably at a flow rate of one gallon per minute or less.

DISPOSAL: Used filter should be wrapped in newspaper and discarded with trash.

Comments

Installation Instructions:

No plumber needed.

Step 1: Use the adapter with a 1/2" pipe to connect to faucet.

Step 2: Unscrew Retaining Sleeve (1) and attach Adapter (2) to faucet. See Step 1 for faucet connection.

Step 3: FOR INTERNAL THREADED FAUCETS ONLY. See Step 1 for faucet connection.

Secure the Faucet Basket (3) on the Sink. Basket (3) will prevent the faucet from vibrating and leaking. The Sink Basket (3) is not required for external threaded faucets. See Step 1 for faucet connection. Be sure to use the correct Retaining Sleeve (1) for your faucet.

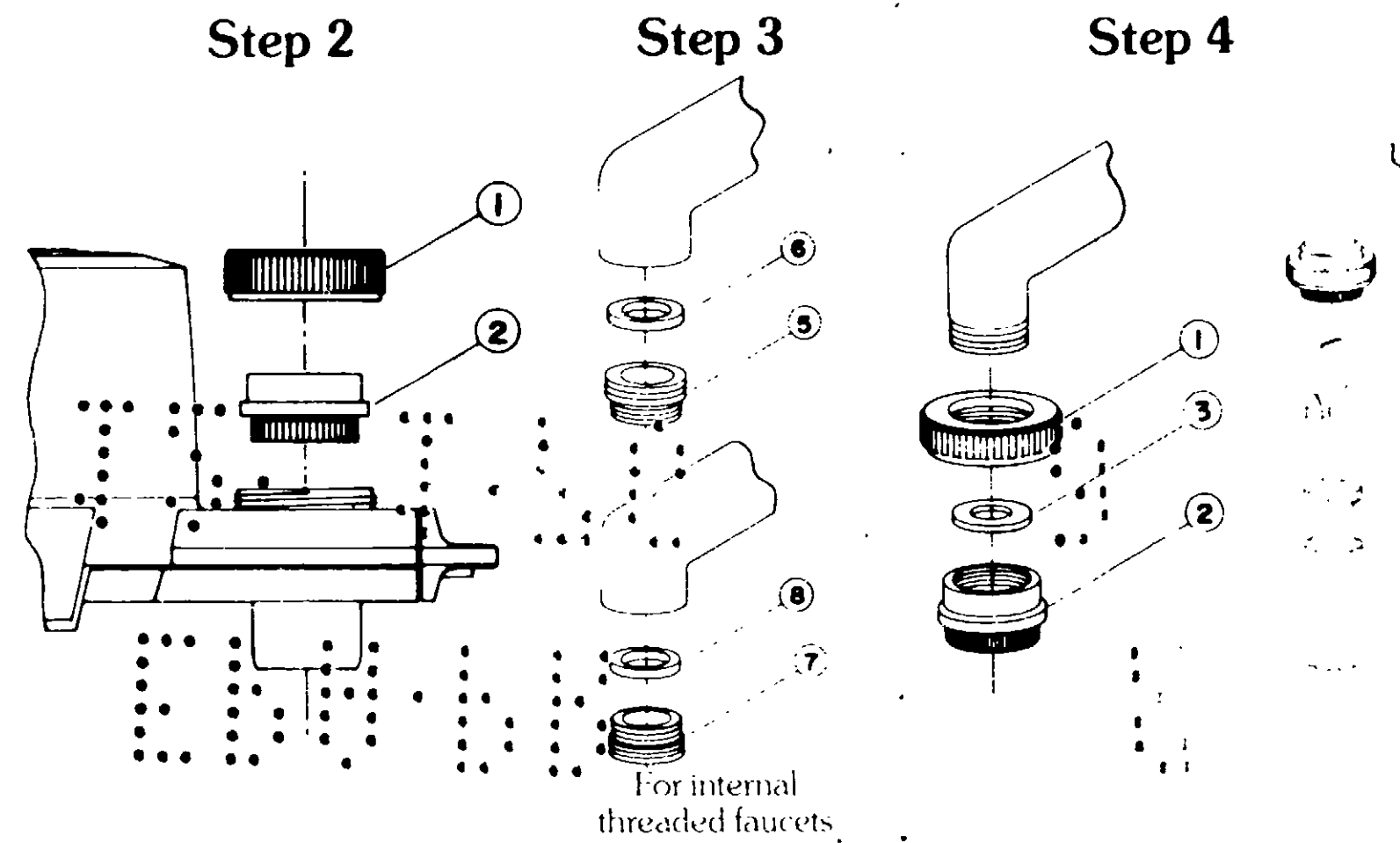

Step 4: Insert Small Black Washer (4) into threaded end of Adapter (2) and slip Retaining Sleeve (1) over threaded end of Adapter (2) as shown. Screw Adapter (2) onto faucet (5) being careful not to cross thread and tighten with a screwdriver as shown. Do not tighten with pliers as this may damage Adapter. Retaining Sleeve (1) should be free to turn.

Instructions Continued On Next Page

General Classification

It is a violation of Federal Law to use this product in a manner inconsistent with its labeling.

Connect

1-800-333-3333

1-800-333-3333

Step 5

Step 5: Place Large Black Washer (1) into knurled recess in top of your Instapure unit. Hold assembly in position shown so that the Filter Cover is directly to the left of the unit. Lift your Instapure unit up onto knurled portion of Adapter while screwing Return Sleeve down onto the threaded fitting on the Instapure unit. Tighten firmly by hand. Plugs may be used providing a front plug is placed between the plugs and the Return Sleeve to prevent scratching.

Step 6: Insert filter and run approximately 1 gallon of water through filter to remove air bubbles. Not illustrated.

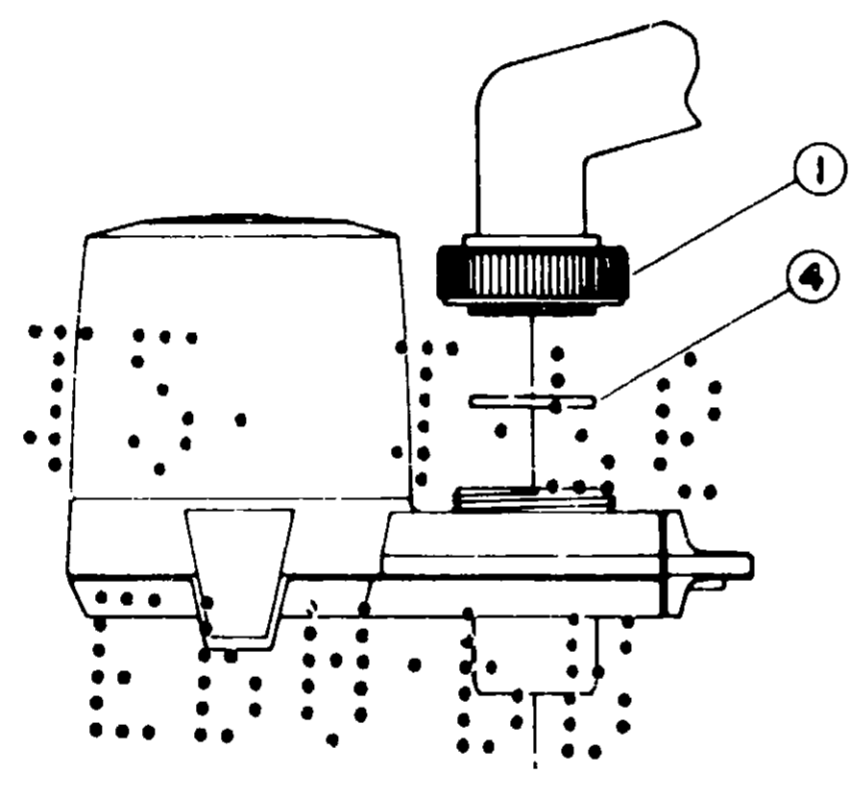

© 1997 Teledyne Water Pik, Inc.
All rights reserved.

Full 1 Year Mechanical Warranty

Teledyne Water Pik warrants to the owner of this new Instapure® Water Filter by Water Pik that it is free from defects in materials and workmanship for one year from date of purchase. If the product proves to be defective, return it to an authorized service station or to Teledyne Water Pik, 1730 E. Prospect Street, Fort Collins, Colorado 80521, for repair or replacement at no charge.

The efficacy of the chemical ingredients of the replaceable filter will diminish through normal use and therefore, after installation and commencement of use, is not included within the terms of this warranty.

1-800-333-3333

Comments

10/15/10

10/15/10

instapure[®]
water:filter
by WaterPik

7 30

EBN

WaterPik 17301 Prospect Street Fort Collins, Colorado 80521

Printed in U.S.A. Form Number: Z1P0156

Comments