



UNITED STATES ENVIRONMENTAL PROTECTION AGENCY
WASHINGTON, DC 20460

OFFICE OF CHEMICAL SAFETY
AND POLLUTION PREVENTION

May 13, 2020

Ms. Catherine Kickham
Director of Strategic Development
Wexford Labs, Inc.
325 Leffingwell Avenue
Kirkwood, MO 63122

Subject: PRIA Label Amendment – Emerging Viral Pathogens
Product Name: Wexford Disinfectant Wipes
EPA Registration Number: 34810-37
Application Date: March 15, 2020
Decision Number: 561115

Dear Ms. Kickham:

The amended label referred to above, submitted in connection with registration under the Federal Insecticide, Fungicide and Rodenticide Act, as amended, is acceptable. This approval does not affect any conditions that were previously imposed on this registration. You continue to be subject to existing conditions on your registration and any deadlines connected with them.

A stamped copy of your labeling is enclosed for your records. This labeling supersedes all previously accepted labeling. You must submit one copy of the final printed labeling before you release the product for shipment with the new labeling. In accordance with 40 CFR 152.130(c), you may distribute or sell this product under the previously approved labeling for 18 months from the date of this letter. After 18 months, you may only distribute or sell this product if it bears this new revised labeling or subsequently approved labeling. "To distribute or sell" is defined under FIFRA section 2(gg) and its implementing regulation at 40 CFR 152.3.

Because you have opted to add statements pertaining to emerging viral pathogens to your label as described in the August 19, 2016, Guidance to Registrants: Process For Making Claims Against Emerging Viral Pathogens Not On EPA-Registered Disinfectant Labels ("Guidance"), https://www.epa.gov/sites/production/files/2016-09/documents/emerging_viral_pathogen_program_guidance_final_8_19_16_001_0.pdf, you are subject to the following additional terms of registration:

1. You may make statements pertaining to emerging viral pathogens only through the following communications outlets: technical literature distributed exclusively to health care facilities, physicians, nurses and public health officials, "1-800" consumer information services, social media sites and company websites (non-label related). These statements shall not appear on marketed (final print) product labels.

2. Your statements pertaining to emerging viral pathogens must adhere to the format approved on the Agency-accepted master label.
3. You may make statements pertaining to emerging viral pathogens only upon a disease outbreak that meets all the following criteria:
 - a. The causative organism must be a virus that causes an infectious disease that has appeared in a human or animal population in the U.S. for the first time, or that may have existed previously but is rapidly increasing in incidence or geographic range.
 - i. For human disease, the outbreak is listed in one of the following Centers for Disease Control (CDC) publications:
 - A. CDC Current Outbreak List for “U.S. Based Outbreaks” (www.cdc.gov/outbreaks),
 - B. CDC Current Outbreak List for “Outbreaks Affecting International Travelers” with an “Alert” or “Advisory” classification (www.cdc.gov/outbreaks) (also released through the CDC’s Health Alert Network (HAN) notification process)
 - C. Healthcare-Associated Infections (HAIs) Outbreaks and Patient Notifications page (www.cdc.gov/hai/outbreaks)
 - ii. For animal disease, the outbreak is identified as an infectious disease outbreak in animals within the U.S. on the World Organization for Animal Health (OIE) Weekly Disease Information page (www.oie.int/wahis_2/public/wahid.php/Diseaseinformation/WI).
 - A. The CDC or OIE has identified the taxonomy, including the viral family and/or species, of the pathogen and provides notice to the public of the identity of the emerging virus that is responsible for an infectious disease outbreak. Based on the taxonomy of the outbreak pathogen identified by the CDC or OEI, the pathogen's viral subgroup is small non-enveloped, large non-enveloped, or enveloped.
 - B. The virus can be transmitted via environmental surfaces (non-vector transmission), and environmental surface disinfection has been recommended by the CDC, OIE or EPA to control the spread of the pathogen.
4. You may begin communicating statements pertaining to emerging viral pathogens only upon CDC or OIE’s publication per term 3.a. of an outbreak of an emerging viral pathogen meeting all of the criteria of term 3. You must cease and remove all such non-label communications intended for consumers no later than 24 months after the original publication of the outbreak per term 3.a., unless the Agency issue written guidance to the contrary due to continued public health concerns. The emerging pathogen claim language may remain on the master label.

5. Terms from points 1 through 4 above shall become immediately void and ineffective if registration for use against Feline Calicivirus (surrogate for Norovirus) and Rhinovirus Type 14 Strain 1059 is suspended or cancelled or no longer meets the criteria for a disinfectant claim (see EPA Product Performance Test Guideline 810.2200). In addition, terms B.1 through B.4 above shall become immediately void and ineffective upon your receipt of evidence of ineffectiveness against any pathogen in a less-resistant Spaulding category.

Should you wish to add/retain a reference to the company's website on your label, then please be aware that the website becomes labeling under the Federal Insecticide Fungicide and Rodenticide Act and is subject to review by the Agency. If the website is false or misleading, the product would be misbranded and unlawful to sell or distribute under FIFRA section 12(a)(1)(E). 40 CFR 156.10(a)(5) list examples of statements EPA may consider false or misleading. In addition, regardless of whether a website is referenced on your product's label, claims made on the website may not substantially differ from those claims approved through the registration process. Therefore, should the Agency find or if it is brought to our attention that a website contains false or misleading statements or claims substantially differing from the EPA approved registration, the website will be referred to the EPA's Office of Enforcement and Compliance.

Your release for shipment of the product constitutes acceptance of these conditions. If these conditions are not complied with, the registration will be subject to cancellation in accordance with FIFRA section 6. If you have any questions, you may contact disinfectants list at disinfectantslist@epa.gov.

Sincerely,

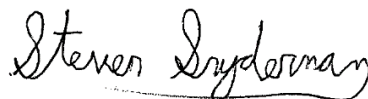

Steven Snyderman, Acting Product Manager 33
Regulatory Management Branch 1
Antimicrobials Division (7510P)
Office of Pesticide Programs

Enclosure: stamped label

[WEXFORD DISINFECTANT WIPES]

ACTIVE INGREDIENT:	
Citric Acid	0.60%
OTHER INGREDIENTS:	<u>99.40%</u>
[Includes biodegradable detergents]	
TOTAL	100.00%

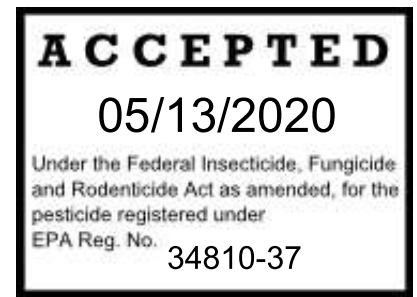

KEEP OUT OF REACH OF CHILDREN
[CAUTION]

[See [left] [side] [right] [back] [bottom] panel for Precautionary Statements and First Aid]

[PRECAUTIONARY STATEMENTS]
[HAZARD TO HUMANS AND DOMESTIC ANIMALS]

[CAUTION: Causes moderate eye irritation. Avoid contact with eyes or clothing. Wash thoroughly with soap and water after handling and before eating, drinking, chewing gum, using tobacco, or using the toilet.]

[FIRST AID]

[IF IN EYES: Hold eyelids open and flush with a steady, gentle stream of water for 15 minutes. Remove contact lenses, if present, after the first five minutes, then continue rinsing. Call a Poison Control Center or doctor for further treatment advice.]

Net Contents: _____
X Pre-moistened Towelettes (X)" x (X)"
(e.g. 100 Pre- moistened Towelettes 7"x 8")

[Barcode] [DOT Symbols] [QR Code]
[Country of origin (insert country)] [Manufactured/Made in (insert country)]

STORAGE AND DISPOSAL:

Do not leave containers open during storage. No special handling is required. **Towelette:** Do not reuse towelette. Dispose of used towelette in trash. **Dispenser:** Nonrefillable container. Do not reuse or refill this container. Offer for recycling if available.

or

Dispose of used towelette in trash. Do not leave container open during storage. Do not reuse or refill empty container. Offer for recycling if available.

or

Store airtight at room temperature. Dispose of used towelette in trash. [Nonrefillable container.] Do not reuse or refill this empty container. Offer empty container for recycling. If recycling is not available, discard in trash.

EPA Reg. No. 34810-37
EPA Est. No. [insert Est. No. here]

[SDS #: [insert SDS number here]] [Reorder #: [insert reorder number here]]

Wexford Labs, Inc. 325 Leffingwell Avenue Kirkwood, Missouri 63122

EFFICACY CLAIMS

<u>[BACTERICIDAL]</u>	ATCC and/or Strain
[Bactericidal [Activity]][In the presence of 5 % blood serum,] [is effective against]	
<i>5 minutes</i>	
[Carbapenem-resistant Klebsiella pneumoniae]	[ATCC BAA-1705]
[Enterococcus faecalis Vancomycin Resistant [VRE]]	[ATCC 51575]
[Escherichia coli O157:H7]	[ATCC 43888]
[Listeria monocytogenes]	[ATCC 19117]
[Pseudomonas aeruginosa]	[ATCC 15442]
[Salmonella enterica [formerly Salmonella Choleraesuis]]	[ATCC 10708]
[Staphylococcus aureus]	[ATCC 6538]
[Staphylococcus aureus - MRSA]	[ATCC 33592]
[Staphylococcus epidermidis - MRSE]	[ATCC 51625]
<i>10 minutes</i>	
[Acinetobacter baumannii]	[ATCC 19606]
<u>[VIRUCIDAL*]</u>	ATCC and/or Strain
[In the presence of 5 % blood serum,] [is effective against]	
<i>3 minutes</i>	
[Hepatitis B (HBV), [Duck Hepatitis B (DHBV) as surrogate]]	[Grimaud Strain]
[Hepatitis C [HCV], [Bovine Viral Diarrhea Virus [BVDV] as surrogate]]	[Strain NADL]
<i>5 minutes</i>	
[Adenovirus Type 2]	[Strain VR-846]
[Feline Calicivirus [surrogate for Norovirus]]	[Strain F-9]
[Herpes Simplex Virus Type 1]	[Strain VR-733]
[Herpes Simplex Virus Type 2]	[Strain VR-734]
[Human Immunodeficiency Virus Type 1(HIV-1) (AIDS Virus)]	[Strain HTLV-IIIB]
[Influenza A Virus]	[Strain Hong Kong][H3N2]
[Pandemic 2009 H1N1 Influenza A Virus [formerly called swine flu]]	[Pandemic 2009 H1N1]
[Respiratory Syncytial Virus]	[Strain VR-26]
[Rhinovirus][Type 14]	[Strain 1059]
[Rotavirus]	[Strain WA, Univ. of Ottawa]
[Vaccinia Virus]	[Strain VR-119]
<i>10 minutes</i>	
[Canine Parvovirus [CPV]]	[Strain VR-2017, Cornell]
[Poliovirus Type 1]	[Strain VR-58]

Bold, italicized text is information for the reader and is not part of the label. [Bracketed information is optional text.] Highlighted text is new. Strike-through (text) means removed

[FUNGICIDAL]	ATCC and/or Strain
[In the presence of 5 % blood serum,] [is effective against]	
5 minutes	[ATCC 10231]
[Candida albicans]	[ATCC 9533]
[Trichophyton interdigitale][T.interdigitale]	[ATCC 9533]
[TUBERCULOCIDAL]**][At 20°C / 68°F [**]on previously cleaned hard non-porous inanimate surfaces.	ATCC and/or Strain
5 minutes	
[Mycobacterium bovis][Mycobacterium tuberculosis] [M. bovis] [TB]	[BCG] [Organon Teknika Corp.]

<<ALLERGENS>>

- Wipe(s) away dirt [and] [germs][and][allergens]
- **Allergens[†]**—This product removes the following allergens: [cat dander], [cockroach debris/matter/particles], [dog dander], [dust mite debris/matter/particles], [pet dander], [pollen particles] [from timothy grass], [grass].

OPTIONAL MARKETING CLAIMS

DISINFECTION CLAIMS

- [Cleans][Disinfects][Deodorizes][Germicidal] [Tuberculocidal][Fungicidal][Virucidal*]
- [Antibacterial] kitchen cleaner
- [Antibacterial] bathroom cleaner
- [Antibacterial] household cleaner
- [Antibacterial] formula
- Disinfects while you clean
- Clean and disinfect in one step
- Disinfects & deodorizes
- Kills 99.9 % of [household] germs
- Disinfectant formula
- Germicidal Detergent
- Everywhere disinfectant
- [Eliminates] [Fights] [Effective Against] [Kills] 99.9 % of Bacteria
- [Eliminates] [Fights] [Effective Against] [Kills] 99.9 % of Viruses*
- Broad Spectrum [Hospital] [Disinfectant] [Germicide]
- [Eliminates] [Kills] over 99.9% of bacteria & viruses* including flu virus*
- Broad spectrum germicidal
- [Eliminates] [Kills] cold & flu
- [Eliminates]Kills [cold] [&] [flu] viruses*
- [Kill[s]] [Remove[s]] [Effective against][Eliminates] [the following] [organisms:]
 - [the virus that causes the flu] [flu virus][Influenza A2]
 - [Avian Influenza A] [(H3N2)] [virus] [(Avian Reassortant)]
 - [Human Immunodeficiency Virus type 1] [HIV-1]
 - [Pseudomonas] [Pseudomonas aeruginosa] [(ATCC 15442)]
 - [the viruses* that causes the cold] [cold virus*] [Rhinovirus type 37]
 - [Salmonella enterica] [(Salmonella choleraesuis)] [Salmonella] [(ATCC 10708)]
 - [Staph] [Staphylococcus aureus] [(ATCC 6538)]
 - [MRSA] [resistant Staph](ATCC 33592)]
 - [Hep[atitis]] B [HBV], [Duck Hepatitis B (DHBV) as surrogate]]
 - [Pandemic 2009 H1N1 Influenza A Virus [formerly called swine flu]][H1N1][Influenza A]
 - [Feline Calicivirus [surrogate for Norovirus]][Norovirus]
 - [Respiratory Syncytial Virus [RSV]][RSV]
 - [Staphylococcus epidermis - MRSE [ATCC 51625]][MRSE]
 - [Rotavirus]
- [One step cleaning -and/or- disinfecting -and/or- deodorizing]
- [Disinfect -and/or- touch-up clean] [Cleans -and/or- disinfects -and/or- deodorizes] [In one easy step]
- Kills [over] 99.9 % of [household germs] [kitchen germs] [bathroom germs] [germs] [.] [botanically] [on hard, non[-]porous surfaces]
- Wipe away germs and allergens
- Wipe away germs and allergens [even on toys]
- Kills TB
- One step disinfectant
- Helps reduce the risk of cross-contamination between treated surfaces
- Effective against [Norovirus] [Salmonella] [E. coli]

Bold, italicized text is information for the reader and is not part of the label. [Bracketed information is optional text.] Highlighted text is new. Strike-through (text) means removed

- Disinfecting Wipe
- Disinfectant Wipe
- Antibac Bathroom Wipes
- Antibac All Purpose Wipes

CLEANING AND DEODORIZING CLAIMS

- Quick and easy cleaning
- Effectively controls odor
- [Eliminates] odor-causing bacteria
- [Eliminates] odor
- Multi-Purpose
- Multi-Purpose Cleaner
- Multi-Surface [formulation]
- Carpet Cleaner and Deodorizer
- Bathroom Cleaner
- Everyday Cleaner
- One Step
- Clean without a [harsh] [strong] chemical[s]
- Removes allergens

SURFACE COMPATIBILITY AND USAGE CLAIMS

- No haze
- [Virtually] [haze-free] [film-free] [shine] [clean]
- [Low-haze] [Low-Film] [No-Film] [Clear-Drying] [Formula] [Wipe] clean[s] thoroughly
- For plastic and painted surfaces, spot test on an inconspicuous area before use.
- [This product or product name] will not harm most surfaces: including acrylic, sealed fiberglass and vinyl.
- Do not use on unpainted wood.
- Note: Do not use on unpainted wood or natural marble or brass.
- For plastic and painted surfaces, spot test on an inconspicuous area before use.
- Will not damage hard, non[-]porous surfaces
- Dries clear on mirrors and glass
- No streak
- Streak free
- Dries clear

INGREDIENT CLAIMS

- [Please visit our website (*insert url*) for more information on [ingredients][contents]]
- Non-corrosive ingredients
- Bleach Free
- Botanical
- Botanical Cleaning
- Botanical surface cleaner with natural essential oil[s]
- Botanical ingredient[s]
- Botanically derived ingredient[s]
- Botanical active ingredient
- Botanically derived active ingredient
- [Botanically based] product]
- Plant-based
- Effective plant-based formula
- Plant-based cleaning power
- Dye free [formula]
- Bleach[-]free
- Paraben[-]free
- Phenol[-]free
- Alcohol[-]free
- Free of glycol solvents
- Free of chlorine of formaldehyde
- Free of gluten
- Free of phosphate
- Free of formaldehyde
- Free from harsh chemicals
- [Contains no][No] [Does not contain] [bleach,] [added dyes,] [added colors,] [perfumes,] [(volatile organic compounds)], [ammonia], [phosphates], [phosphorus], [chlorine bleach], [dyes], [synthetic fragrances,] [volatile solvents,] [known or suspected endocrine disruptors,] [glycol ethers,][chlorinated compounds,] [or] [chlorine] [alcohol][phenol][MIT][BIT]
- Does not contain [bleach] [ammonia] [chlorine]
- Does not contain [Triclosan] [Parabens]
- Made without Parabens and Phthalates
- [Free of][no] dye and/or perfumes
- Free of [glycol solvents] [chlorine of formaldehyde] [gluten] [phosphate]
- No harsh chemicals
- No artificial fragrance
- Powered by botanical actives [and essential oils]
- For ingredient information, go to (*insert url*)
- A list of [this product's] [product name] ingredients is available at [insert company website].
- [For more information][Visit our website][**company url**]
- made] [formulated][using] [with] essential oils
- Effective botanical [formula][wipes]
- [Cleans] [disinfects] with [botanically-derived ingredients] [plant-based ingredients]

MISCELLANEOUS CLAIMS

- Ready to Use
- Non-Irritating
- Non-corrosive
- We're here to help when life happens.
- Change the way you clean with a product that's simple to use and can help clean up life's everyday messes
- Inspired by nature
- No Rinse required [even on [children's] [toys]]^a
- [Please rinse toys][Rinse toys with potable water] ****note: rinsing toys is not required with this product, but it is acceptable for distributor to make this statement***
- Rinse free [formula]^a
- No Rinse^a
- No Rinse Formula^a
- Rinse Free Formula^a
- No Rinse Disinfectant^a
- Tough on [dirt] [germs], easy to use.
- [Can be used] around pets
- When used as directed, safe for use around [pets][cats and dogs]
- Good for use around cats and dogs
- Made in USA
- Fragrance free [formula]
- Proven effective on most hard surfaces
- No harsh fumes
- Non-flammable
- [Contains][Includes] Biodegradable detergents
- [Contains][Includes] Biodegradable ingredients
- The surfactants contained in this product are biodegradable. [Surfactants are cleaning agents]
- Safely store out of reach of children
- Store safely out of reach of children
- Do not use as a diaper wipe or for personal cleansing.
- This is not a baby wipe!
- [Made from [x]% [recycled plastic] [post consumer resin]]

^aExcept on food contact surfaces which require potable water rinse

*(indicates Virus)

- **FRAGRANCE DESCRIPTORS**

{Note to reviewer: each scent list in “**Fragrance Descriptors**” section may also be represented by a graphic depicting the corresponding scent, except when referring to a type of food, in this case the graphic will be submitted to the Agency for review.}

[Apple Blossoms]	[Glacier Mint]	[Outdoor Fresh]
[Apple]	[Green Tea Citrus]	[Pacific Rose Apple]
[Arctic breeze]	[Honey Spiced Fig]	[Paradise Escape]
[Bamboo]	[Indian Mango Orange]	[Peach]
[Bramley Apple Blossom]	[Island Springs]	[Pear]
[Cherry]	[Japanese Cherry Blossom]	[Pine]
[Citron]	[Lavender + Sage]	[Pink Grapefruit]
[Citrus Burst]	[Lavender Vanilla [Orchid]]	[Purple Wildflower]
[Citrus Fresh]	[Lemon [Scent]]	[Ruby Red Grapefruit]
[Citrus Splash]	[Lemon Breeze]	[Scent Free]
[Citrus]	[Lemon Squeeze]	[Spearmint]
[Clean and Fresh]	[Lemon Ginger Reed]	[Strawberry]
[Clean Mint]	[Lemon Ginger]	[Sunshine Vetiver]
[Clean Sparkle]	[Lemon Verbena]	[Sweet Pea Bloom]
[Cleanmint]	[Lemon Ylang Flower]	[Sweet Pea]
[Cool Mint]	[Lemon Ylang]	[Tropical]
[Cotton Breeze]	[Lime Blossom]	[Unscented]
[Cotton Lily]	[Mandarin Green Tea]	[Waterfall Mist]
[Crystal Clean]	[Match Fleur]	[White Diamonds]
[Crystal Mint]	[Mint]	[Wild Lemon Ylang]
[Cucumber Sage]	[Mountain Green]	[Wild Lime Verbena]
[Dye and Fragrance free]	[Naked & Free]	[Wildflower]
[Eucalyptus Mint]	[Ocean Breeze]	[Winter Fresh]
[Floral Woods]	[Orange Fresh]	[Wintergreen]
[Floral]	[Orange Mango Lily]	[Wintermint]
[Fragrance free]	[Orange Mango]	
[Fresh][<i>listed descriptor</i>]	[Orange Zest]	
[[Fresh] Citrus]	[Orange]	
[Fresh Meadows]		
[Fresh Scent]		
[Fresh Squeezed]		

DIRECTIONS FOR USE: [Please read all directions carefully before using this product.] It is a violation of Federal Law to use this product in a manner inconsistent with its labeling. [Product is ready to use.] Preclean areas with [gross filth and] visible soil prior to disinfection.

[DISPENSER DIRECTIONS:]

Option 1

[To start feed, remove large cover. Pull up the towelette corner from the center of the towelette roll, twist it into a point and thread it through the hole in the container cover. Pull through about one inch. Replace cover. Pull out first towelette and snap off at a 90° angle. Remaining towelettes feed automatically ready for their next use. When through using, keep small center cap closed to prevent moisture loss.]

Option 2

Open lid. Pull out wipe from center of roll and through lid. Close lid to retain moisture

Option 3

TO OPEN PACKAGE:

Remove cover. Pull up wipe corner from center of roll. Thread through hole in the cover. Replace cover. Open center cap on cover to remove wipe. When not using, close center cap securely to prevent moisture loss.

Option 4

Flip open lid. To remove first wipe, pull up on wipe and remove wipe through wavy dispensing opening. The next wipe will pop up automatically. Always snap lid securely between uses to retain moisture.

[Flat Pack opening instructions]

Option 1

TO OPEN PACKAGE:

Slowly peel back label. Pull out wipes as needed. Reseal label to retain moisture.

Option 2

TO OPEN PACKAGE:

[Open plastic lid.] Slowly peel back label. Pull out wipes as needed. Reseal label to retain moisture. [Close lid].

[Alternative directions for individual subregistrants in Appendix]

[TO [CLEAN]/[DEODORIZE]] [Cleaning Instructions]:

[Apply to surface[s] [as needed].][Wipe clean.]

[Unfold premoistened cloth and wipe area to be cleaned for 30 seconds or until clean.]

[Spot check to test for compatibility]

TO DISINFECT or Disinfecting Instructions:

Option 1

[Unfold premoistened cloth and] Wipe hard non-porous area or item to be disinfected. Wet all surfaces thoroughly. [The surface must remain wet for at least] [Leave for] [3][5][10]^s minutes. [Wipe or] Let air dry.

Option 2

Wet the hard, non-porous surface with the wipe. Allow surface to remain visibly wet for [3][5][10][§] minutes. Allow to air dry.

Option 3

Use to disinfect hard, nonporous areas. Wipe surface to be disinfected. Allow treated surface to remain visibly wet for [3][5][10][§] minutes.

Option 4 (for use in Bona mopping systems)

Remove, unfold the cleaning pad, place mop on top of [green][blue] fastening strips. To Disinfect: Mop [surface][desired area][with pad], ensuring surface remains wet for [3][5][10][§] minutes. Dispose after use, do not flush. [Do not follow the disinfect directions for an entire wood or laminate floor due to excess moisture being introduced, which could cause damage]

When food contact surfaces are listed, the following is REQUIRED:

No rinsing or wiping is required except on food contact surfaces which require a potable water rinse after [use][treatment][disinfection]

OR

Rinse all food contact surfaces with potable water after [use][treatment][disinfection]

When only non-food contact surfaces are listed, the following is optional:

[No rinsing or wiping is required.]

Optional:

[FUNGICIDAL DIRECTIONS]: This product is effective against *Trichophyton interdigitale* (athlete's foot fungus and a cause of ringworm) on inanimate surfaces [in locker rooms, dressing rooms, exercise facilities, and shower and bath areas]. [Follow disinfection directions.]

§NOTE: Use contact time in accordance with organisms listed on the distributed product label.

[Veterinary Practice / Animal Care / Animal Laboratory / Zoos / Pet Shop / Kennels Disinfection Directions]: For cleaning and disinfecting hard nonporous surfaces: equipment used for animal food or water, utensils, instruments, cages, kennels, stables, catteries, etc. Remove all animals and feeds from premises, animal transportation vehicles, crates, etc. Remove all litter, droppings and manure from floors, walls and surfaces of facilities occupied or traversed by animals. Empty all feeding and watering appliances. Thoroughly clean all surfaces with soap or detergent and rinse with water. Saturate surfaces with [this product] for a period of 10 minutes. Wipe or allow to air dry. Thoroughly scrub all treated surfaces that come into contact with food, including equipment used for feeding or watering, with soap or detergent and rinse with potable water before reuse. Do not house animals or employ equipment until treatment has been absorbed, set or dried.]

USAGE CLAIMS

[Suitable] [Intended] [for use] [on] [in]

[AREAS OF USE:]

[Athletic Facilities]	[Kennels]
[Bathrooms]	[Kitchens]
[Classrooms]	[Laboratories or other small animal facilities]
[Day care centers]	[Locker Rooms]
[Dental offices]	[Medical Offices]
[Grocery Stores]	[Nurseries]
[Grooming Facilities]	[Nursing homes]
[Gyms]	[Schools]
[Health Care Facilities]	[Shopping Centers]
[Hospitals]	[Spas]
[Institutional facilities]	[Veterinary Clinics]
[Institutions]	

{Note to Reviewer: Emerging Viral Pathogen claims shall be made only through the following communications outlets: technical literature distributed exclusively to health care facilities, physicians, nurses and public health officials, "1-800" consumer information services, social media sites and company websites (non-label related). These statements shall not appear on marketed (final print) product labels.}

EMERGING VIRAL PATHOGENS

This product meets the criteria to make claims against certain emerging viral pathogens from the following viral category[ies]:

- Enveloped virus
- Large non-enveloped virus
- Small, non-enveloped virus

For an emerging viral pathogen that is a/an...	...follow the direction for use for the following organisms on the label:
Enveloped virus	Rhinovirus Type 14 Strain 1059
Large, non-enveloped virus	Rhinovirus Type 14 Strain 1059
Small, non-enveloped virus	Feline Calicivirus [surrogate for Norovirus] Rhinovirus Type 14 Strain 1059

Statements shall adhere to one of the following formats:

1. [Product name] has demonstrated effectiveness against viruses similar to [name of emerging virus] on hard, non-porous surfaces. Therefore, [product name] can be used against [name of emerging virus] when used in accordance with the directions for use against Rhinovirus Type 14 [and/or] Feline Calicivirus [surrogate for Norovirus] on hard, non-porous surfaces. Refer to the [CDC or OIE] website at [pathogen-specific website address] for additional information.
2. [Name of illness/outbreak] is caused by [name of emerging virus]. [Product name] kills similar viruses and therefore can be used against [name of emerging virus] when used in accordance with the directions for use against Rhinovirus Type 14 [and/or] Feline Calicivirus [surrogate for Norovirus] on hard, non-porous surfaces. Refer to the [CDC or OIE] website at [website address] for additional information.

TYPES OF SURFACES/USE SITES:] (Graphic –depicting surface)

[On washable hard, nonporous surfaces of:]

[Ambulance patient care surfaces]	[Glazed Porcelain]	[Radiology equipment surfaces]
[Anesthesia equipment surfaces]	[Handrailings]	[Refrigerators (exterior surface)]
[Appliances]	[Highchairs]	[Respirators]
[Baby/infant care surfaces]	[Immobilization devices]	[Respiratory care equipment surfaces]
[Backboards]	[Infant care equipment]	[Sealed Granite]
[Baked Enamel]	[Isolettes]	[Shopping carts]
[Bathing units]	[Keyboards]	[Shower floors/walls]
[Bathroom[s] [tubs] [tiles]]	[Kitchen] [appliances]	[Sinks]
[Bed railings]	[Kitchen] [countertop[s]]	[Skin care equipment/surfaces]
[Beds]	[Kitchen surfaces]	[Smart [Phones] [Watches]]
[Blood pressure devices]	[Laboratory equipment/surfaces]	[Smart Screens]
[Cabinets]	[Light lens covers]	[Soaking containers]
[Car Interiors]	[Lights]	[Stainless Steel]
[Chairs]	[Lumens]	[Stalls]
[Changing tables]	[Medical equipment surfaces/devices]	[Surgical equipment surfaces]
[Children’s toys]	[Metal]	[Surgical microscopes]
[Chrome]	[Mice/Mouse]	[Tables]
[Computer surfaces]	[Microscopes]	[Tablets]
[Computers]	[Mirrors]	[Telephones]
[Counters]	[MRI equipment surfaces]	[Toilet Seats]
[Countertops]	[Neonatal/nursery surfaces]	[Toilets (rims, seats and exterior surfaces)]
[CPR manikins]	[Nonporous athletic mats]	[Toys]
[CT equipment/surfaces]	[Obstetrical equipment surfaces]	[Training tables]
[Curing lights]	[Operating room lights/tables]	[Transportation equipment surfaces]
[CuVerro® antimicrobial copper]	[Ophthalmic equipment surfaces/devices]	[Trash Cans]
[Dental equipment surfaces/devices]	[Optical wear (excluding contact lenses)]	[Trays]
[Desks]	[Oxygen hoods]	[Vinyl]
[Doorknobs]	[Patient bed surfaces]	[Walls]
[Exam tables]	[Patient stretchers]	[Work stations]
[Exercise equipment]	[Patient stretchers]	[Wrestling mats]
[Fixtures]	[Patient transport surfaces]	[X-ray equipment/surfaces]
[Floors]	[Pet Habitats]	
[Furniture]	[Physical therapy equipment]	
[Garbage cans]	[Plastic]	
[Glass]	[Play mats]	
[Glazed ceramic tile]	[Play-care equipment]	
[Glazed porcelain]	[PPE (Personal Protective Equipment)]	

Where medical devices are listed as applicable sites, the following will be included as required by PR 94-4 . Otherwise, the all language on this page is OPTIONAL

DECONTAMINATION OF CRITICAL OR SEMI-CRITICAL DEVICES PRIOR TO TERMINAL STERILIZATION/HIGH LEVEL DISINFECTION: This product is not to be used as a terminal sterilant/high level disinfectant on any surface or instrument that (1) is introduced directly into the human body, either into or in contact with the bloodstream or normally sterile areas of the body, or, (2) contacts intact mucous membranes but which does not ordinarily penetrate the blood barrier or otherwise enter normally sterile areas of the body. This product may be used to preclean or decontaminate critical or semi-critical medical devices prior to sterilization or high-level disinfection.

The following special instructions must be included on the label if the product is used as a hospital-grade disinfectant rather than retail/household.

[This Product] KILLS HIV ON PRE-CLEANED ENVIRONMENTAL SURFACES/OBJECTS PREVIOUSLY SOILED WITH BLOOD/BODY FLUIDS in all settings in which there is an expected likelihood of soiling of hard, non-porous surfaces/objects with blood or body fluids and in which the surfaces/objects likely to be soiled with blood or body fluids can be associated with the potential for transmission of human immunodeficiency virus Type 1 (HIV-1) (associated with AIDS virus).

SPECIAL INSTRUCTIONS FOR CLEANING AND DECONTAMINATING SURFACES/OBJECTS SOILED WITH BLOOD AND BODY FLUIDS WHICH MAY CONTAIN HIV-1 (AIDS virus).

PERSONAL PROTECTION: When handling objects soiled with blood or body fluids use disposable latex gloves, gowns, mask and eye coverings.

CLEANING PROCEDURE: Blood and other body fluids must be thoroughly cleaned from surfaces and objects before application of the disinfectant.

CONTACT TIME: Leave precleaned surfaces wet for five minutes to mitigate HIV-1 virus. Use a (5) (10) minute contact time to kill all bacteria, viruses* and fungi listed on the label. Contact time in accordance with organisms listed on the distributed product label.

DISPOSAL OF INFECTIOUS MATERIAL: Blood and other fluids should be autoclaved and disposed of according to Federal, State and Local regulations for infectious waste disposal.

Revised: 5/13/2020

**APPENDIX 1:
THE FOLLOWING OPTIONAL LANGUAGE AND
GRAPHICS ARE AVAILABLE FOR USE BY
APPROVED SUBREGISTRANTS**

The following statement is required when registering product as Designed for the Environment:

For ingredient information, go to [www.wexfordlabs.com/DfE/wipes.html]

or

A list of [this product's] [product name] ingredients is available at
[insert company website].

or

[For more information][Visit our website][*company url*]



[www.epa.gov/pesticides/regulating/
labels/design-dfe-pilot.html](http://www.epa.gov/pesticides/regulating/labels/design-dfe-pilot.html)

For Home Made Simple

[company logo]

Make It Simple. Make It Home. Make It You.



It's been our mission since 2003 to help families create homes they love to live in. That's why we've crafted a line of plant-based cleaning products that really work. Simply what you need to build your happy, healthy home that reflects who you are and helps you take care of it too.



Alternate Dispenser Instructions

TO OPEN PACKAGE: Open the lid and pull up wipe from center of the roll. Feed wipe through guide pulling it through to next perforation.

The next wipe will pop up automatically. Always close lid securely between uses to retain moisture.

For ECOS

[company logo]

**See the Clean.
Feel the Love.™**



**MAJORITY
WOMEN
OWNED**



For Lemi Shine
Alternate Dispenser Instructions



[Flip open lid. To remove first wipe pull up on wipe and remove wipe through wavy dispensing opening. The next wipe will pop up automatically. Always snap lid securely between uses to retain moisture.]



*Lemi Shine (Supplemental Registrant)
Company Logo*

For Bona

[company logo]

- For use on unwaxed, polyurethane finished wood, ceramic tile with sealed grout lines, sealed granite, or laminate flooring
- Treating spots, spills or small areas will minimize the risk of water damage.
- Regular cleaning with the Bona family of Floor Cleaners is safe for all urethane finished hardwood and sealed hard-surface floors.
- Just mop and toss!
- GENERAL INFORMATION: Have the product container or label with you when calling a poison control center or doctor or going for treatment. For non-emergency and general information on product use, etc., information pertaining to this product, call the National Pesticides Information Center at 1-800-858-7378 (NPIC web site: www.npic.orst.edu). For emergencies, call the poison control center 1-800-222-1222.
- STORAGE AND DISPOSAL: Store in original container, in a cool and well-ventilated area, inaccessible to children. Do not leave container open during storage. To avoid waste, use all material in this container according to label directions. Do not reuse this container for any other purpose. Do not reuse or refill this container. Discard in trash or offer for recycling if available.
- A Bona system™ Cleaning Pad
- Disposable Wet Cleaning Pads for Hard Surface Floors
- Use of this product on unsealed surfaces may cause staining. Do not use on unfinished, oiled or waxed wood floors, non-sealed tiles, carpet floor, or marble.



1 Remove, unfold the cleaning pad, place mop on top of blue fastening strips

Quitar, desplegar el paño de limpieza colocar trapeador encima de las tiras azules de fijación



2 Mop Fregar



3 Dispose after use, do not flush
Deseche después de usar, no los deseche en el inodoro.



1 Remove, unfold the cleaning pad, place mop on top of green fastening strips

Quitar, desplegar el paño de limpieza, colocar trapeador encima de las tiras verdes de fijación



2 Mop Fregar



3 Dispose after use, do not flush
Deseche después de usar, no los deseche en el inodoro.



Revive, Restore or Refinish™ your hardwood floors using a Bona Certified Craftsman®. Find a hand-picked professional at Bona.com.

For Method

[company logo]

- we have more laundry, cleaning + hand soap at [website url]"
- you think you're so smart don't you? Well...you are, okay? you win"
- germ* buster. There's a new antibac in town and its made from a formula that's tough on grease and grime and easy on surfaces. Plus, you'll be happy to know that it kills 99.9% of germs*, leaving behind the pleasant scent of victory
- you can feel good about using these [botanical][,] wipes everywhere[†]
 - [cribs][bibs][+][baby mobiles]
 - big doggone messes
 - bathroom sinks, tubs + tile
 - and the kitchen sink

[†]on hard, nonporous surfaces

For Schmidt's

[company logo]

Schmidt's Lavender+Sage scent botanical disinfecting wipe kills 99.9% of household germs while you clean, without the harsh chemicals. [Kill][Eliminate] cold and flu viruses, [wipe away][remove allergens], and [remove][defeat] odor-causing bacteria with our one-step formula powered by botanical actives and essential oils. [Appropriate][Approved] for use on most household surfaces, with no streaking.



Great Quality. Guaranteed.
Return the package and the receipt for replacement or money back.
1-877-505-2267 or visit us online at walmart.com

Made in USA with Pride logo™ is a trademark of U.S. Nonwovens Corp. All rights reserved.



Great Quality. Great Price. Guaranteed.
Our guarantee is our promise that you'll be fully satisfied with the quality of every Great Value product. If for any reason you aren't happy, we'll replace it or return your money. Whichever you prefer. All you need is the package. It's that simple. Guaranteed.
Tell us what you think... 1-877-505-2267 or online at walmart.com/greatvalue



Great Quality. Guaranteed.
Return the package for replacement or money back.
1-877-505-2267 or visit us online at walmart.com



Cleans. Disinfects. Guaranteed.
Return the package and the receipt for replacement or money back.
1-877-505-2267 or visit us online at walmart.com



100% Guaranteed
 We're committed to providing premium quality products at an exceptional value. If you're not completely satisfied we'll refund your money.

100% Garantizado
 Estamos comprometidos a ofrecer productos de alta calidad a un valor excepcional. Si no está completamente satisfecho, le devolveremos su dinero.

100% Guaranteed
 We're committed to providing premium quality products at an exceptional value. If you're not completely satisfied we'll refund your money.

100% Garantizado
 Estamos comprometidos a ofrecer productos de alta calidad a un valor excepcional. Si no está completamente satisfecho, le devolveremos su dinero.

MEMBER'S SELECTION®

100% Guaranteed
 We're committed to providing premium quality products at an exceptional value. If you're not completely satisfied we'll refund your money.

100% Garantizado
 Estamos comprometidos a ofrecer productos de alta calidad a un valor excepcional. Si no está completamente satisfecho, le devolveremos su dinero.



Use on mop head.



TO OPEN:

1. Cut off top of pouch with scissors.
2. Remove wipes from pouch.
3. Place wipes in plastic tub.
4. Discard empty pouch into trash.

TO USE WITH MOP:

1. Unfold top wipe in tub by pulling sides of the cloth over edges of tub.
2. Place sweeper on head.
3. Wrap wipe around head of sweeper.
4. Push edges of wipe into top of sweeper head.
5. Begin wiping. No rinsing required.
6. After use, remove soiled wipe and discard in trash. Do not flush.

Tuck & Go

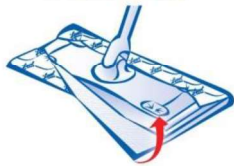

Note to reviewer: Representative graphic of wipe tub and/or hand pulling out wipe fabric may be added to the final printed label.

Note to reviewer: A representative graphic of a substrate may be added to the label. Only a graphic of the substrate actually in the canister can be added to the final printed label.



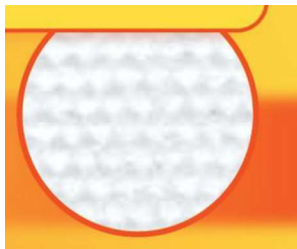

{Note to reviewer: the graphic to the left denotes a picture of a substrate. It will only be added to the final printed label if this substrate is actually in the canister can.}

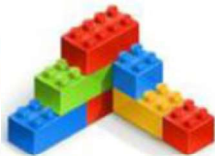

TO OPEN PACKAGE:

- Flip open dispensing cap and remove entire lid from canister by lifting upward.
- Locate wipe at center of roll, twist corner to a point and thread through small opening in lid. **DO NOT PUSH FINGER THROUGH OPENING.**
- Replace lid and pull sheet up at an angle. Remaining wipes feed automatically.
- When finished, snap lid cap shut to retain moisture.



[graphic depicting outdoor fresh scent]



	We Promise to make good products at good prices for good people. Enjoy!
	Thank You Target gives 5% of its income to the community to support education, the arts, social services and volunteerism.



- ✔ item replaced
- ✔ money refunded

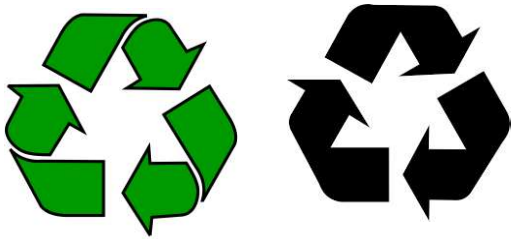

Bold, italicized text is information for the reader and is not part of the label. [Bracketed information is optional text.] Highlighted text is new. Strike-through (text) means removed



[company logo]



[company logo]

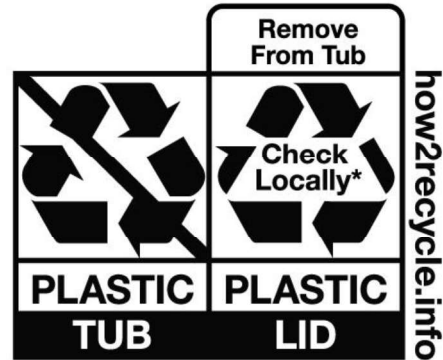

***Not recycled in all communities**

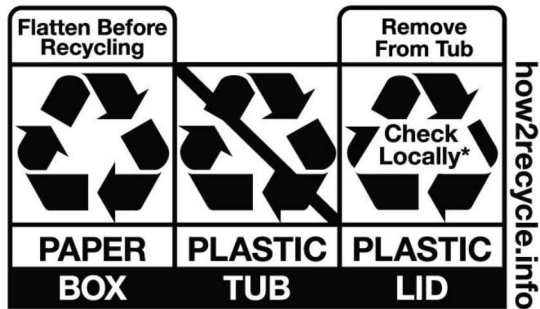

***Not recycled in all communities**



Listed number can be updated to reflect subregistrant's certification

NSF Listing
D2 158328
Product Category: D2
PRODUCT CATEGORY DEFINITION: D2-
Antimicrobial agents not requiring rinse



can be displayed in black/white

[Instagram]

[Facebook]

[Twitter]

