



U.S. ENVIRONMENTAL PROTECTION AGENCY
Office of Pesticide Programs
Registration Division (7505P)
1200 Pennsylvania Ave., N.W.
Washington, D.C. 20460

EPA Reg. Number:

11556-190

Date of Issuance:

4/10/25

NOTICE OF PESTICIDE:

☒ Registration
☐ Reregistration

(under FIFRA, as amended)

Term of Issuance:

Conditional, Time-Limited
Expires: 4/10/2027

Name of Pesticide Product:

Advantage XD Dog

Name and Address of Registrant (include ZIP Code):

Johnna Bridges
Elanco US Inc.
450 Elanco Circle
Indianapolis, IN 46221

Note: Changes in labeling differing in substance from that accepted in connection with this registration must be submitted to and accepted by the Registration Division prior to use of the label in commerce. In any correspondence on this product always refer to the above EPA registration number.

On the basis of information furnished by the registrant, the above named pesticide is hereby registered under the Federal Insecticide, Fungicide and Rodenticide Act.

Registration is in no way to be construed as an endorsement or recommendation of this product by the Agency. In order to protect health and the environment, the Administrator, on his motion, may at any time suspend or cancel the registration of a pesticide in accordance with the Act. The acceptance of any name in connection with the registration of a product under this Act is not to be construed as giving the registrant a right to exclusive use of the name or to its use if it has been covered by others.

This product is conditionally registered in accordance with FIFRA section 3(c)(7)(A). You must comply with the following conditions:

1. Submit and/or cite all data required for registration/reregistration/registration review of your product under FIFRA when the Agency requires all registrants of similar products to submit such data.

Signature of Approving Official:

Michael Walsh, Product Manager 11
Invertebrate & Vertebrate Branch 2, Registration Division (7505P)

Date:

4/10/25

2. This registration is time-limited and expires 4/10/2027.
3. You must submit quarterly enhanced incident reports and quarterly sales information in doses sold for this product beginning within 3 months of the date the product is first released for shipment, on the first day of the quarter (i.e., January 1, April 1, July 1, or October 1). Please flag any Confidential Business Information as such. Submit enhanced incident reporting and quarterly sales information to the Product Manager's attention. The following is a list of information that must be included in the quarterly reports for each incident:
 - EPA Registration Number
 - Product name (brand name)
 - Lot #
 - Where purchased: internet, store, veterinarian
 - Active Ingredient(s)
 - Weight range for product
 - Date on which incident occurred (mm/dd/yyyy)
 - State in which the incident occurred (standard 2 letter abbreviation)
 - Registrant case #
 - Species: dog, cat, other (specify)
 - Breed: (as reported by pet owner)
 - Age: months or years
 - Sex: M, F, or neutered
 - Weight: pounds
 - Primary Route of Exposure: dermal, oral, other animal, inhalation, other
 - Body System: neurological, dermatological, GI, respiratory, ocular, other
 - Major signs noted with separate column for each sign, using standard terminology
 - Time to Onset: (hours, days)
 - Treated by veterinarian: yes or no
 - First time product used: yes or no
 - Misuse: use on incorrect species, overdose, too frequent dosing, other (describe)
 - Any known precondition
 - EPA Severity Code: death, major, moderate, minor
 - Outcome: died, recovered, still treated, unknown
4. Along with the enhanced incident reporting, you must submit an analysis of the incidents seen, to include the following details:
 - All incidents should be reported including all minor dermal and ocular irritation reports.
 - Summary table for dogs showing number of incidents of each severity code for each route of exposure. Each incident should only be reported once. If one incident has several routes of exposure, the order should be ocular > oral > dermal. In other words,

an incident with both oral and dermal exposure would be reported as oral exposure, and an incident with both ocular and oral exposure would be reported as ocular exposure.

- A similar summary table for cats (misuse or secondary exposure) showing number of incidents of each severity code for each route of exposure.
- Summary table for cats and table for dogs showing number of incidents that are believed due to secondary exposure (e.g., multi-pet households).
- A summary table for dogs showing number of incidents for each severity code for these age ranges: <3 months, 3-6 months, 6-9 months, 9-12 months, 1 yr, 2 yr, 3 yr, 4 yr, 5 yr, 6 yr, 7 yr, 8 yr, 9 yr, 10 yr, 11 yr, 12 yr, 13 yr, 14 yr, 15 yr, >15 yr.
- A summary table showing the number of dog incidents for each severity code for each pet weight range on the product label, as applicable.
- A summary table for dog weight showing number of incidents for each product weight range. This table should show number of incidents in dogs weighing less than that product weight range, number of incidents in dogs in lower half of weight range, number of incidents in dogs in upper half of weight range, and dogs weighing more than the product weight range, as applicable.
- Table showing number of incidents for each dog breed, where provided.
- Table showing number of incidents in dogs for each clinical sign.
- Table showing number of incidents in dogs for each organ system.
- Report aggregate incidents, but do not combine moderate and minor incidents.

If EPA determines that future mitigation measures are necessary for all pet spot-ons, the Agency will inform registrants. If mitigation measures are necessary, EPA may take regulatory action.

5. The data requirements for storage stability and corrosion characteristics (Guidelines 830.6317 and 830.6320) are not satisfied. A one year study is required to satisfy these data requirements. You have 18 months from the date of registration to provide these data.
6. Make the following label changes before you release the product for shipment:
 - Revise the EPA Registration Number to read, "EPA Reg. No. 11556-190."
7. Submit one copy of the final printed label for the record before you release the product for shipment.

Should you wish to add/retain a reference to the company's website on your label, then please be aware that the website becomes labeling under the Federal Insecticide Fungicide and Rodenticide Act and is subject to review by the Agency. If the website is false or misleading, the product would be misbranded and unlawful to sell or distribute under FIFRA section 12(a)(1)(E). 40 CFR 156.10(a)(5) list examples of statements EPA may consider false or misleading. In addition, regardless of whether a

website is referenced on your product's label, claims made on the website may not substantially differ from those claims approved through the registration process. Therefore, should the Agency find or if it is brought to our attention that a website contains false or misleading statements or claims substantially differing from the EPA approved registration, the website will be referred to the EPA's Office of Enforcement and Compliance.

If you fail to satisfy these data requirements, EPA will consider appropriate regulatory action including, among other things, cancellation under FIFRA section 6(e). Your release for shipment of the product constitutes acceptance of these conditions. A stamped copy of the label is enclosed for your records.

Please note that the record for this product currently contains the following CSFs:

- Basic CSF dated 07/01/2022

If you have any questions, please contact Briana Hanlon by phone at (202) 566-2716, or via email at hanlon.briana@epa.gov.

Attachment

{NOTE TO REVIEWER: Optional language in [brackets]; {Braces} indicate Note to Reviewer and will not be included on final label.}

{MASTER LABEL}: Dog sizes 4-15 lbs (1.0 mL tube); 16-30 lbs (2.0 mL tube); 31-60 lbs (4.0 mL tube); and more than 60 lbs (6.0 mL tube)}

{FRONT PANEL}

Advantage XD Dog

{“Dog” font size will be 40% to 75% of the height of the largest letter in the primary brand name.}

SPINETORAM {Will appear in close proximity to product name}

AN [EIGHT WEEK] [2 MONTH] TOPICAL SOLUTION FOR THE PREVENTION AND TREATMENT OF FLEA INFESTATIONS ON DOGS AND PUPPIES

{A large, clear picture of a dog in the appropriate weight range for product will appear on the front panel. See page 14.}

{NOTE TO REVIEWER: One of the statements below will appear prominently in a box on front panel}

{SMALL DOG} ONLY FOR DOGS AND PUPPIES [EIGHT] [8] WEEKS OF AGE AND OLDER AND WEIGHING BETWEEN 4 AND 15 LBS

{MEDIUM DOG} ONLY FOR DOGS AND PUPPIES [EIGHT] [8] WEEKS OF AGE AND OLDER AND WEIGHING BETWEEN 16 AND 30 LBS

{LARGE DOG} ONLY FOR DOGS AND PUPPIES [EIGHT] [8] WEEKS OF AGE AND OLDER AND WEIGHING BETWEEN 31 AND 60 LBS

{EXTRA LARGE DOG} ONLY FOR DOGS AND PUPPIES [EIGHT] [8] WEEKS OF AGE AND OLDER AND WEIGHING [MORE THAN] [>] 60 LBS

{Selected optional marketing claims bulleted and pictograms from pages 11-14}

ACTIVE INGREDIENT

Spinetoram.....	15.0%
Other Ingredients	85.0%
	TOTAL 100.0%

KEEP OUT OF REACH OF CHILDREN

CAUTION

SEE BACK PANEL FOR FIRST AID AND ADDITIONAL PRECAUTIONARY STATEMENTS

READ ALL DIRECTIONS BEFORE USING THIS PRODUCT

NET CONTENTS

{NOTE TO REVIEWER: Only one weight band per package.}

{Small Dog} [1] [one] [2] [two] [3] [three] [4] [four] [5] [five] [6] [six] [7] [seven] [8]
[eight] [9] [nine] [10] [ten] [11] [eleven] [12] [twelve] – [0.0338 fl oz] [1.0 mL]
[applicator[s]] [application[s]] [dose[s]] [tube[s]]

{Medium Dog} [1] [one] [2] [two] [3] [three] [4] [four] [5] [five] [6] [six] [7] [seven] [8]
[eight] [9] [nine] [10] [ten] [11] [eleven] [12] [twelve] – [0.0676 fl oz] [2.0 mL]
[applicator[s]] [application[s]] [dose[s]] [tube[s]]

{Large Dog} [1] [one] [2] [two] [3] [three] [4] [four] [5] [five] [6] [six] [7] [seven] [8]
[eight] [9] [nine] [10] [ten] [11] [eleven] [12] [twelve] – [0.1353 fl oz] [4 mL]
[applicator[s]] [application[s]] [dose[s]] [tube[s]]

{Extra Large Dog} [1] [one] [2] [two] [3] [three] [4] [four] [5] [five] [6] [six] [7] [seven] [8]
[eight] [9] [nine] [10] [ten] [11] [eleven] [12] [twelve] – [0.2029 fl oz] [6 mL]
[applicator[s]] [application[s]] [dose[s]] [tube[s]]



{BACK PANEL}

{NOTE TO REVIEWER: Dog sizes 4-15 lbs (1.0 mL tube); 16-30 lbs (2.0 mL tube); 31-60 lbs (4.0 mL tube); and more than 60 lbs (6.0 mL tube). Only appropriate information for weight band in the package will be provided.}

DIRECTIONS FOR USE

It is a violation of Federal law to use this product in a manner inconsistent with its labeling.

RESTRICTIONS

Do not allow children to apply product. Do not allow children to come in contact with the treated animal until after the product has dried. {Small Dog} [Do not use on dogs or puppies less than 8 weeks of age and weighing less than 4 [lbs] [pounds]]. {Medium Dog} [Do not use on dogs or puppies less than 8 weeks of age and weighing less than 16 [lbs] [pounds]]. {Large Dog} [Do not use on dogs or puppies less than 8 weeks of age and weighing less than 31 [lbs] [pounds]]. {Extra Large Dog} [Do not use on dogs or puppies less than 8 weeks of age and weighing less than 60 [lbs] [pounds]]. Do not double dose dogs. Do not allow your dog to ingest this product. Dog must be dry at time of application. **Do not apply more than one dose every two months.**

More detailed directions for use, including storage and disposal, are included in the box. Read the entire label, directions for use and frequency of application each time before using this product.

For prevention and treatment of fleas, part the hair between the shoulder blades and apply the contents of the applicator tube to a single spot on the skin of the dog. Do not apply on the surface of the dog's hair coat. Place the empty applicator tube in the trash.

Application every two months [every other month] is recommended to prevent and treat flea infestations on dogs and puppies 8 weeks and older and weighing [more than] [>] 4 [lbs] [pounds]. Advantage XD Dog kills fleas for [two months] [8 weeks] after application.

PRECAUTIONARY STATEMENTS

HAZARDS TO HUMANS AND DOMESTIC ANIMALS

HAZARDS TO HUMANS

CAUTION. Harmful if swallowed. Causes moderate eye irritation. Wash thoroughly with soap and water after handling and before eating, drinking, chewing gum, using tobacco or using the toilet. Avoid contact with eyes or clothing.

HAZARDS TO DOMESTIC ANIMALS

FOR USE ON DOGS AND PUPPIES ONLY. For external use only. As with any product, consult your veterinarian before using the product on medicated, debilitated, aged, pregnant or nursing animals or animals known to be sensitive to pesticides.

SIDE EFFECTS:

Monitor your dog after application. Side effects may include signs of application site reactions such as application site hair loss, hair change (greasy, clumping or matting) or redness, inflammation and itching. Other side effects such as inactivity, vomiting and inappetence have also been reported. If these or any other side effects occur, consult your veterinarian, your dog's healthcare expert. For technical assistance or to report a side effect, call Elanco at 1-888-545-5973.

{The "Side Effects" box will be located at the lower right-hand corner of the back panel.}

FIRST AID**IF SWALLOWED:**

- Call a poison control center or doctor immediately for treatment advice.
- Have person sip a glass of water if able to swallow.
- Do not induce vomiting unless told to by a poison control center or doctor.
- Do not give anything by mouth to an unconscious person.

IF IN EYES:

- Hold eye open and rinse slowly and gently with water for 15-20 minutes.
- Remove contact lenses if present, after the first 5 minutes, then continue rinsing.
- Call a poison control center or doctor for treatment advice.

Have the product container or label with you when calling a poison control center or doctor or going for treatment. For medical emergencies, call the poison control center at 1-800-222-1222.

Manufactured for
Elanco US Inc.
450 Elanco Circle
Indianapolis, IN 46221

EPA Reg. No. 11556-XXX
EPA Est. No.

{Note to Reviewer: One of the two options below will be used.}



Keep cats away from treated dogs for 24 hours. If applied or ingested, contact your veterinarian immediately.



DO NOT USE ON CATS. Keep cats away from treated dogs for 24 hours. If applied or ingested, contact your veterinarian immediately.

{PACKAGE INSERT}

Advantage XD Dog

{“Dog” font size will be 40% to 75% of the height of the largest letter in the primary brand name.}

SPINETORAM {Will appear in close proximity to product name}

AN [EIGHT WEEK] [2 MONTH] TOPICAL SOLUTION FOR THE PREVENTION AND
TREATMENT OF FLEA INFESTATIONS ON DOGS AND PUPPIES

{NOTE TO REVIEWER: One of the statements below will appear prominently in a box
on front panel}

{SMALL DOG} ONLY FOR DOGS AND PUPPIES [EIGHT] [8] WEEKS OF AGE AND
OLDER AND WEIGHING BETWEEN 4 AND 15 LBS

{MEDIUM DOG} ONLY FOR DOGS AND PUPPIES [EIGHT] [8] WEEKS OF AGE AND
OLDER AND WEIGHING BETWEEN 16 AND 30 LBS

{LARGE DOG} ONLY FOR DOGS AND PUPPIES [EIGHT] [8] WEEKS OF AGE AND
OLDER AND WEIGHING BETWEEN 31 AND 60 LBS

{EXTRA LARGE DOG} ONLY FOR DOGS AND PUPPIES [EIGHT] [8] WEEKS OF
AGE AND OLDER AND WEIGHING [MORE THAN] [>] 60 LBS

ACTIVE INGREDIENT

Spinetoram*	15.0%
Other Ingredients	85.0%
TOTAL	100.0%

*CAS #s 187166-40-1 and 187166-15-0

KEEP OUT OF REACH OF CHILDREN

CAUTION

FIRST AID

IF SWALLOWED:

- Call a poison control center or doctor immediately for treatment advice.
- Have person sip a glass of water if able to swallow.
- Do not induce vomiting unless told to by a poison control center or doctor.
- Do not give anything by mouth to an unconscious person.

IF IN EYES:

- Hold eye open and rinse slowly and gently with water for 15-20 minutes.
- Remove contact lenses if present, after the first 5 minutes, then continue rinsing.
- Call a poison control center or doctor for treatment advice.

Have the product container or label with you when calling a poison control center or doctor or going for treatment. For medical emergencies, call the poison control center at 1-800-222-1222.

PRECAUTIONARY STATEMENTS HAZARDS TO HUMANS AND DOMESTIC ANIMALS

HAZARDS TO HUMANS

CAUTION. Harmful if swallowed. Causes moderate eye irritation. Wash thoroughly with soap and water after handling and before eating, drinking, chewing gum, using tobacco or using the toilet. Avoid contact with eyes or clothing.

HAZARDS TO DOMESTIC ANIMALS

For external use only. FOR USE ON DOGS AND PUPPIES WEIGHING MORE THAN 4 [LBS] [POUNDS] ONLY. As with any product, consult your veterinarian before using the product on medicated, debilitated, aged, pregnant or nursing animals or animals known to be sensitive to pesticides.

SIDE EFFECTS:

Monitor your dog after application. Side effects may include signs of application site reactions such as application site hair loss, hair change (greasy, clumping or matting) or redness, inflammation and itching. Other side effects such as inactivity, vomiting and inappetence have also been reported. If these or any other side effects occur, consult your veterinarian, your dog's healthcare expert. For technical assistance or to report a side effect, call Elanco at 1-888-545-5973.

{Note to Reviewer: One of the two options below will be used.}



Keep cats away from treated dogs for 24 hours. If applied or ingested, contact your veterinarian immediately.



DO NOT USE ON CATS. Keep cats away from treated dogs for 24 hours. If applied or ingested, contact your veterinarian immediately.

DIRECTIONS FOR USE

It is a violation of Federal law to use this product in a manner inconsistent with its labeling.

RESTRICTIONS

Read the entire label, directions for use and frequency of application each time before using this product. Follow all directions and precautionary statements carefully. Do not allow children to apply product. Do not allow children to come in contact with the treated animal until after the product has dried. {Small Dog} [Do not use on dogs or puppies less than 8 weeks of age and weighing less than 4 [lbs] [pounds]]. {Medium Dog} [Do not use on dogs or puppies less than 8 weeks of age and weighing less than 16 [lbs] [pounds]]. {Large Dog} [Do not use on dogs or puppies less than 8 weeks of age and weighing less than 31 [lbs] [pounds]]. {Extra Large Dog} [Do not use on dogs or puppies less than 8 weeks of age and weighing less than 60 [lbs] [pounds]]. Do not double dose dogs. Do not allow your dog to ingest this product. Dog must be dry at time of application. **Do not apply more than one dose every two months.**

FREQUENCY OF APPLICATION

{Small Dog} To kill fleas and prevent reinfestations on dogs, apply one applicator tube every two months [every other month] only to dogs and puppies 8 weeks of age and older and weighing [more than] [>] 4 [lbs] [pounds].

{Medium Dog} To kill fleas and prevent reinfestations on dogs, apply one applicator tube every two months [every other month] only to dogs and puppies 8 weeks of age and older and weighing [more than] [>] 16 [lbs] [pounds].

{Large Dog} To kill fleas and prevent reinfestations on dogs, apply one applicator tube every two months [every other month] only to dogs and puppies 8 weeks of age and older and weighing [more than] [>] 31 [lbs] [pounds].

{Extra Large Dog} To kill fleas and prevent reinfestations on dogs, apply one applicator tube every two months [every other month] only to dogs and puppies 8 weeks of age and older and weighing [more than] [>] 60 [lbs] [pounds].

HOW TO APPLY: [SMALL] [MEDIUM] PUPPY/DOG

1. Remove one applicator tube.
2. Hold applicator tube in an upright position and twist tip to open.
3. Between the shoulder blades, part the hair until the skin is visible. Place the tip of the tube directly above the skin and squeeze the tube 2-4 times to expel the contents of the tube directly on the skin. Avoid getting the product in your dog's eyes or mouth.
4. Discard empty applicator tube into trash.

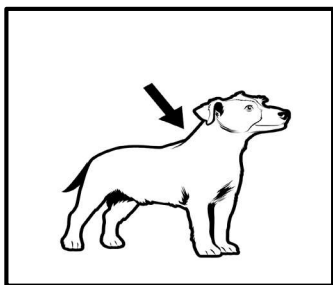
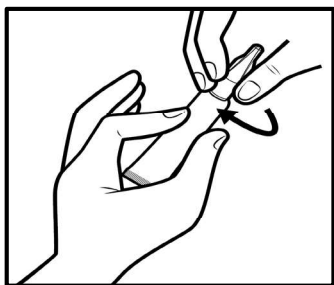

Application every two months [every other month] is recommended to prevent and treat flea infestations on the dog. Advantage XD Dog continues killing fleas for [two full months] [eight full weeks] after application.

HOW TO APPLY: [LARGE] [EXTRA LARGE] PUPPY/DOG

1. Remove one applicator tube.
2. Hold applicator tube in an upright position and twist tip to open.
3. Starting at the shoulder blades, part hair until the skin is visible. Place the tip of the tube directly above the skin and squeeze the tube to expel the contents directly on the skin in [3][three] different spots down the center of dog's back until tube is empty. Avoid getting the product in your dog's eyes or mouth.
4. Discard empty applicator tube into trash.

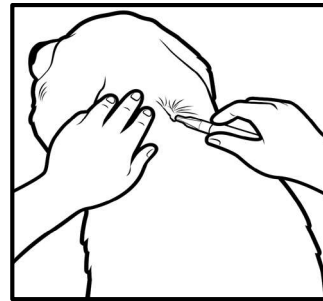
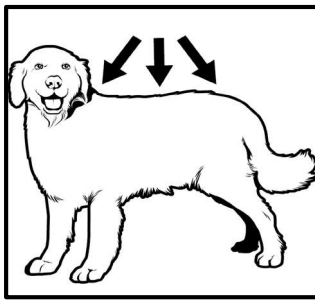
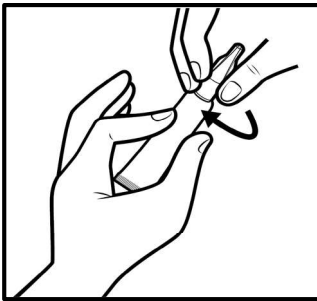

STORAGE AND DISPOSAL

Do not contaminate water, food or feed by storage and disposal.

Pesticide Storage:

Store in original package in a cool dry place inaccessible to children and animals.

Pesticide Disposal and Container Handling: Call your local waste agency or equivalent organization for disposal instructions. Unless otherwise instructed, place in trash. Never pour unused product down the drain or on the ground.

Container Handling:

If empty: Non-refillable container. Do not reuse this container. Place in the trash or offer for recycling if available.

If partly filled: Call your local solid waste agency for disposal instructions. Never place unused product down any indoor or outdoor drain.

LIMITED WARRANTY, DISCLAIMER, AND LIMITATION OF DAMAGES

By using, buying or handling this product, user and/or buyer accepts the following terms. Subject to the inherent risks referred to above, and to the extent consistent with applicable law, Elanco US Inc.'s ("Elanco") sole and exclusive limited warranty is that this product conforms to the chemical description on the label and is reasonably fit for the purposes stated on the label, when used in accordance with the label under normal use conditions. To the extent consistent with applicable law, the above exclusive express limited warranty is void if the product is used contrary to the label. TO THE EXTENT CONSISTENT WITH APPLICABLE LAW, ELANCO MAKES NO OTHER EXPRESS OR IMPLIED WARRANTY. TO THE EXTENT CONSISTENT WITH APPLICABLE LAW, ELANCO DISCLAIMS ANY IMPLIED WARRANTY OF MERCHANTABILITY OR FITNESS FOR A PARTICULAR PURPOSE OR OTHERWISE, AND DISCLAIMS ANY OTHER EXPRESS WARRANTY. No agent of Elanco is

authorized to make any other warranty, except in writing with a specific reference to this warranty. ***To the extent consistent with applicable law, Elanco shall not be liable whatsoever for special, incidental or consequential damages resulting from the use or handling of this product. To the extent consistent with applicable law, the sole and exclusive remedy of the user and/or buyer for any and all losses, injuries, or damages, regardless of the legal theory, shall not exceed the purchase price paid for the product, or the replacement of product.*** To the extent the above disclaimer of warranties disclaims implied warranties, it may be limited or ineffective if you are a “consumer” and this product is a “consumer product,” as those terms are defined by the Magnuson Moss Act, 15 U.S.C. § 2301, in which case the duration of any implied warranties is limited to the earlier of either the applicable statute of limitation or repose, and in no case will any implied warranty extend beyond the term of the Exclusive Express Limited Warranty for the product. To the extent consistent with applicable law, some states do not allow the exclusion or limitation of incidental or consequential damages, so the above limitation or exclusion may not apply to you.

Manufactured for
Elanco US Inc.
450 Elanco Circle
Indianapolis, IN 46221

EPA Reg. No. 11556-XXX
EPA Est. No.

{APPLICATOR LABEL}

Advantage XD Dog

Spinetoram 15%

{Small Dog} [0.0338 fl oz] [1.0 mL]
{Medium Dog} [0.0676 fl oz] [2.0 mL]
{Large Dog} [0.1353 fl oz] [4 mL]
{Extra Large Dog} [0.2020 fl oz] [6 mL]

EPA Reg. No. 11556-XXX

CAUTION

Keep Out of Reach of Children

Read Entire Label Before Use

Elanco

[TWIST TO OPEN]

[Lot No] xxx



{Optional Marketing Claims (for Small, Medium, Large, Extra Large Dog)}

1. Every [2] [two] months
2. Every [8] [eight] weeks
3. Every other month
4. Topical for [dogs] [dogs and puppies]
5. Topical Application for [dogs] [dogs and puppies]
6. Topical Solution for [dogs] [dogs and puppies]
7. Topical flea treatment for [dogs] [dogs and puppies]
8. Topical flea prevention for [dogs] [dogs and puppies]
9. Topical flea protection for [dogs] [dogs and puppies]
10. Single topical [spot-on] application for [dogs] [dogs and puppies]
11. Lasts [two] [2] months
12. Long lasting flea control [through] [for] [2 months][8 weeks]
13. [2 months] [8 weeks] Extended Duration [last] [for] [2 months] [8 weeks]
14. 2-month Formula
15. Single [topical] [spot-on] application
16. {Small Dog} For the prevention and treatment of [fleas] [flea infestations]
[*Ctenocephalides felis*] only for use on dogs [and puppies] 8 [eight] weeks of age or older and weighing 4 [four] [lbs] [pounds] or more
17. {Medium Dog} For the prevention and treatment of [fleas] [flea infestations]
[*Ctenocephalides felis*] only for use on dogs [and puppies] 8 [eight] weeks of age or older and weighing 16 [sixteen] [lbs] [pounds] or more
18. {Large Dog} For the prevention and treatment of [fleas] [flea infestations]
[*Ctenocephalides felis*] only for use on dogs [and puppies] 8 [eight] weeks of age or older and weighing 31 [thirty-one] [lbs] [pounds] or more
19. {Extra Large Dog} For the prevention and treatment of [fleas] [flea infestations]
[*Ctenocephalides felis*] only for use on dogs [and puppies] 8 [eight] weeks of age or older and weighing 60 [sixty] [lbs] [pounds] or more
20. Kills fleas through contact
21. Kills fleas for [8 weeks] [2 months]
22. Prevents [flea[s]] [re]infestations on [dogs] [dogs and puppies]
23. Convenient
24. Easy to apply [Easy to use]
25. Kills fleas which may cause flea allergy dermatitis [FAD]
26. [Long Lasting] one treatment prevents further flea infestations on [dogs] [dogs and puppies] for [8] [eight] weeks [2 [two] months]
27. [Long Lasting] one treatment remains effective for [8] [eight] weeks [2 months]
28. [Long Lasting] remains effective for [8] [eight] weeks [2 months]
29. Provides continuous [8] [eight] week flea protection on [dogs][dogs and puppies]
30. Protects dogs against flea [re]infestation
31. Long lasting squeeze-on [topical] [spot on] for [8 weeks] [2 months]
32. Fragrance free
33. {Small Dog} Formulated for dogs [and puppies] [8] [eight] weeks of age or older and weighing 4 [four] lbs [pounds] or more
34. {Medium Dog} Formulated for dogs [and puppies] [8] [eight] weeks of age or older and weighing 16 [sixteen] lbs [pounds] or more
35. {Large Dog} Formulated for dogs [and puppies] [8] [eight] weeks of age or older and weighing 31 [thirty-one] lbs [pounds] or more
36. {Extra Large Dog} Formulated for dogs [and puppies] [8] [eight] weeks of age or older and weighing 60 [sixty] lbs [pounds] or more
37. Kills fleas that may carry tapeworm
38. For indoor and outdoor dogs and puppies

39. Kills fleas that may cause anemia
40. Long-lasting flea control [through] [for] 8 [eight] weeks
41. The primary target of action of spinetoram on insects is an activation of nicotinic acetylcholine receptors [nAChRs].
42. Spinetoram does not interact with known insecticidal binding sites of other nicotinic or GABAergic insecticides such as neonicotinoids, fiproles, milbemycins, avermectins, and cyclodienes.
43. Insects in contact with spinetoram show involuntary muscle contractions and tremors resulting from activation of motor neurons.
44. Prolonged spinetoram-induced hyperexcitation results in prostration and paralysis resulting in death of fleas.
45. Spinetoram, the active ingredient in Advantage XD Dog, is a member of the spinosyn class of pesticides.
46. Available in four sizes [weight amounts] [weight bands] for different sized dogs: 4-15 lbs, 16-30 lbs, 31-60 lbs, and over 60 lbs. {Note to Reviewer: Product is not sold as a multi-pack. This is an optional marketing claim to be used on promotional items, for example, to inform end user of available weight range options.}
47. {Small Dog} Protects dogs and puppies [8] [eight] weeks of age and older and weighing [4] [four] [lbs] [pounds] or more from fleas [for eight weeks] [two months]
48. {Medium Dog} Protects dogs and puppies [8] [eight] weeks of age and older and weighing [16] [sixteen] [lbs] [pounds] or more from fleas [for eight weeks] [two months]
49. {Large Dog} Protects dogs and puppies [8] [eight] weeks of age and older and weighing [31] [thirty-one] [lbs] [pounds] or more from fleas [for eight weeks] [two months]
50. {Extra Large Dog} Protects dogs and puppies [8] [eight] weeks of age and older and weighing [60] [sixty] [lbs] [pounds] or more from fleas [for eight weeks] [two months]
51. [Treatment] [Application][Administration] every 2 [two] months [every other month] [every 8 weeks] [year-round] is recommended for optimal control and prevention of flea infestation on [dogs][dogs and puppies]
52. [1] [one] [2] [two] [3] [three] [4] [four] [5] [five] [6] [six] [7] [seven] [8] [eight] [9] [nine] [10] [ten] [11] [eleven] [12] [twelve] [applications] [applicator tubes] [individual doses] [topical applicators] [dose] [doses] [tube] [tubes]
53. Single Pack [Single dose] [individual dose] [single application] [single tube]
54. Multi Dose Pack [Multi Pack] [Multi Tube Pack] {Note to Reviewer: This is to let end user know that there is more than one application/tube in the pack. Different weight bands will not be sold in same pack.}
55. {Small Dog} One [size] application is effective for dogs and puppies 8 weeks of age and older and weighing between 4 and 15 [lbs] [pounds]
56. {Medium Dog} One [size] application is effective for dogs and puppies 8 weeks of age and older and weighing between 16 and 30 [lbs] [pounds]
57. {Large Dog} One [size] application is effective for dogs and puppies 8 weeks of age and older and weighing between 31 and 60 [lbs] [pounds]
58. {Extra Large Dog} One [size] application is effective for dogs and puppies 8 weeks of age and older and weighing [more than] [>] 60 lbs [pounds]
59. {Small Dog} One dose [(1 mL)] size for dogs and puppies 8 weeks of age and older and weighing between 4 and 15 [lbs] [pounds].
60. {Medium Dog} One dose [(2 mL)] size for dogs and puppies 8 weeks of age and older and weighing between 16 and 30 [lbs] [pounds].
61. {Large Dog} One dose [(4 mL)] size for dogs and puppies 8 weeks of age and older and weighing between 31 and 60 [lbs] [pounds].

62. {Extra Large Dog} One dose [(6 mL)] size for dogs and puppies 8 weeks of age and older and weighing [more than] [>] 60 [lbs] [pounds].
63. {Small Dog} One [applicator tube] [1 mL] [size] [package] [dose] [treatment] [application] treats dogs and puppies 8 weeks of age and older and weighing between 4 and 15 [lbs] [pounds].
64. {Medium Dog} One [applicator tube] [2 mL] [size] [package] [dose] [treatment] [application] treats dogs and puppies 8 weeks of age and older and weighing between 16 and 30 [lbs] [pounds].
65. {Large Dog} One [applicator tube] [4 mL] [size] [package] [dose] [treatment] [application] treats dogs and puppies 8 weeks of age and older and weighing between 31 and 60 [lbs] [pounds].
66. {Extra Large Dog} One [applicator tube] [6 mL] [size] [package] [dose] [treatment] [application] treats dogs and puppies 8 weeks of age and older and weighing [more than] [>] 60 [lbs] [pounds].
67. {Small Dog} Protects dogs and puppies 8 weeks of age and older and weighing between 4 and 15 [lbs] [pounds] from fleas for [8 weeks] [2 months].
68. {Medium Dog} Protects dogs and puppies 8 weeks of age and older and weighing between 16 and 30 [lbs] [pounds] from fleas for [8 weeks] [2 months].
69. {Large Dog} Protects dogs and puppies 8 weeks of age and older and weighing between 31 and 60 [lbs] [pounds] from fleas for [8 weeks] [2 months].
70. {Extra Large Dog} Protects dogs and puppies 8 weeks of age and older and weighing [more than] [>] 60 [lbs] [pounds] from fleas for [8 weeks] [2 months].
71. Kills fleas through contact so fleas don't have to bite [a] [your] dog to die.
72. [2 Month] [8 Week] Topical flea [Treatment][Prevention][Protection] for your [dog][dog and puppy]
73. 1 Dose = 2 Months
74. 2 Doses = 4 Months
75. 3 Doses = 6 Months
76. 4 Doses = 8 Months
77. 5 Doses = 10 Months
78. 6 Doses = 12 Months
79. Apply 1 time for 2 months of flea protection on [dogs][dogs and puppies]
80. Apply 1x for 2 months of flea protection on [dogs][dogs and puppies]
81. Apply once for 2 months of flea protection on [dogs][dogs and puppies]
82. 2 month flea [protection][prevention][treatment] for [dogs][dogs and puppies]
83. [2][Two] month flea protection, [1][one] easy application for [dogs][dogs and puppies]
84. [2][Two] months of flea protection for [dogs][dogs and puppies]
85. [2][Two] months of flea protection in [a single][1][one] application for [dogs][dogs and puppies]

Optional Icons



{Extended Duration, Each Dose Lasts Two Months}



Flea Treatment [&] [and] Prevention



Kills [thru] [through] contact



{Color of tube on packaging will vary and corresponds to the weight bands on packaging. Actual tube color will not vary by weight band.}



{Representative dog; each outer carton will have a representative picture of a dog in the appropriate age and weight range for the product.}

{Representative dog picture optional on insert/leaflet, blister pack, pouch, tube}

{Alternative Trade Names}

- Advantage XD Small Dog
- Advantage XD Medium Dog
- Advantage XD Large Dog
- Advantage XD Extra Large Dog
- Advantage 2M Small Dog
- Advantage 2M Medium Dog
- Advantage 2M Large Dog
- Advantage 2M Extra Large Dog
- Advantage XX Small Dog
- Advantage XX Medium Dog
- Advantage XX Large Dog
- Advantage XX Extra Large Dog
- Cheristin Plus Small Dog
- Cheristin Plus Medium Dog
- Cheristin Plus Large Dog
- Cheristin Plus Extra Large Dog