

9688-208

9/29/2010

1/11



UNITED STATES ENVIRONMENTAL PROTECTION AGENCY
WASHINGTON, D.C. 20460

OFFICE OF CHEMICAL SAFETY
AND POLLUTION PREVENTION

Jessica Goldberg
Chemsico
P.O. Box 142642
St. Louis, MO 63114-0642

SEP 29 2010

Subject: EPA Reg. 9688-208 / Chemsico Herbicide RTU DFC Notification

Dear Ms. Goldberg:

The Agency is in receipt of your Application for Pesticide Notification under Pesticide Registration Notice (PRN) 98-10 dated 8-26-10 for the product EPA Reg. 9688-208 / Chemsico Herbicide RTU DFC. The Registration Division (RD) has conducted a review of this request for its applicability under PRN 98-10 and finds that the action requested falls within the scope of PRN 98-10. The label submitted with the application has been stamped "Notification" and will be placed in our records.

If you have any questions please call Erik Kraft at 703-308-9358 or email at Kraft.Erik@epa.gov or Kathryn Montague at 703-305-1243 or Montague.Kathryn@epa.gov.

Sincerely,

A handwritten signature in cursive script, appearing to read "Kathryn Montague".

Kathryn Montague
Team Leader
Herbicide Branch, Team 23
Registration Division (7504P)

	United States Environmental Protection Agency Office of Pesticide Programs (H7505C) Washington, DC 20460 Application for Pesticide:	<input type="checkbox"/> Registration <input type="checkbox"/> Amendment <input checked="" type="checkbox"/> Other	OPP Identifier Number
---	---	--	-----------------------

Section I

1. Company/Product Number 9688-208	2. Product Manager K. Montague	3. Proposed Classification <input checked="" type="checkbox"/> None <input type="checkbox"/> Restricted
4. Company/Product (Name) Chemisco Herbicide RTU DFC	PM# 23	
5. Name and Address of Applicant (include ZIP Code) Chemisco, Div. Of United Industries Corp. P.O. Box 142642 St. Louis, MO 63114 <input type="checkbox"/> Check if this is a new address		6 Expedited Review. In accordance with FIFRA Section 3(c)(3) (b)(i), my product is similar or identical in composition and labelling to: EPA Reg. No. _____ Product Name _____

Section II

<input type="checkbox"/> Amendment - Explain below <input type="checkbox"/> Resubmission in response to Agency letter dated _____ <input checked="" type="checkbox"/> Notification - Explain below.	<input type="checkbox"/> Final printed label in response to Agency letter date <input type="checkbox"/> "ME TOO" Application. <input type="checkbox"/> Other - explain below
---	--

Explanation: Use additional page(s) if necessary. (For section I and Section II.)
 Notification per PR Notice 98-10 to add additional marketing claims, to revise the current optional Directions for Use sprayer instructions, and to revise the current Storage and Disposal section to accommodate a newly designed "Easy Action Pump Sprayer" applicator. (Please see cover letter for details.)

Section III

1. Material in Which This Product Will Be Packaged:					
Child-Resistant Packaging <input type="checkbox"/> Yes * <input type="checkbox"/> No	Unit Packaging <input type="checkbox"/> Yes <input type="checkbox"/> No	Water-Soluble Packaging <input type="checkbox"/> Yes <input type="checkbox"/> No	2. Type of Container <input type="checkbox"/> Metal <input type="checkbox"/> Plastic <input type="checkbox"/> Glass <input type="checkbox"/> Paper <input type="checkbox"/> Other (Specify) _____		
* Certification must be submitted		If "YES," Unit package wgt No. per container	If "YES," Package wgt No. per container		
3. Location of Net Contents Information <input type="checkbox"/> Label <input type="checkbox"/> Container		4. Size(s) of Retail Container		5. Location of Label Directions <input type="checkbox"/> On Label <input type="checkbox"/> On Labeling accompanying product	
6. Manner in Which Label Is Affixed To Product <input type="checkbox"/> Lithographed <input type="checkbox"/> Paper glued <input type="checkbox"/> Stenciled			<input type="checkbox"/> Other _____		

Section IV

1. Contact Point (Complete items directly below for identification of the individual to be contacted, if necessary, to process this application)

Name Jessica Goldberg	Title Regulatory Affairs Specialist	Telephone No. (include Area Code) 314-683-2438
---------------------------------	---	--

Certification I certify that the statements I have made on this form and all attachments thereto are true, accurate, and complete. I acknowledge that any knowingly false or misleading statement may be punishable by fine or imprisonment or both under applicable law.		6 Date Application Received (Stamped)
2. Signature 	3. Title Regulatory Affairs Specialist	[Stamp Area]
4. Typed Name Jessica Goldberg	5. Date August 26, 2010	

Chemsico Herbicide RTU DFC

[SEE APPENDIX FOR CONSOLIDATED LIST OF MARKETING CLAIMS

NOTIFICATION
SEP 29 2010

Active Ingredients:	
Diquat Dibromide.....	0.18%
Fluazifop-p-butyl.....	0.06%
Dicamba, dimethylamine salt.....	0.04%
Other ingredients.....	99.72%
[Total.....	100.00%]

KEEP OUT OF REACH OF CHILDREN

CAUTION See (side)(back) (inside) (panel) (booklet) for additional precautionary statements

Net Contents: 1 Gallon (128 fl oz /3.78L)

OPTIONAL PRODUCT FACT BOX I

Product Facts

Container treats [more than][over] 200 weeds [24 fl oz.]
 Container treats [more than][over] 500 weeds [1/2 gal, 2L][Container treats 150 sq ft]
 Container treats [more than][over] 1000 weeds [1 gal, 4 L][Container treats 300 sq ft]
 Container treats [more than][over] 1300 weeds [5L] [Container treats 390 sq ft]
 Container treats [more than][over] 1500 weeds [6L] [Container treats 470 sq ft]
 Container treats [more than][over] 2000 weeds [2 gal] [Container treats 600 sq ft]

KILLS WEEDS

[illustrate grassy, broadleaf and woody weeds]
 ALL TYPES OF WEEDS [AND][&] GRASSES

WHERE TO USE:

- On patios, walkways or driveways
- In flower beds
- Around shrubs [and][&] trees
- Along fences [and][&] foundations
- Other areas in your yard
- Edging around lawns
- For ornamental garden plot preparation
- Lawn renovation

Questions & comments:(phone icon) (computer icon)
 Call 800-332-5533 or www.(address)

OPTIONAL PRODUCT FACT BOX II

PRODUCT FACTS

WHAT IT DOES: Kills all types of weeds and grasses [down to the root]

WHERE TO USE: Outdoors [icon]: On patios, walkways, driveways; around flowers, shrubs and [or] trees; along fences, foundations, and in large areas [for ornamental garden plot preparation] [For Lawn Replacement]

WHEN TO USE: For best results, apply during warm, sunny weather (above 60°F)

Questions & Comments:
 (icon telephone) (icon computer)
 Call 1-800-332-5553 or visit our website.

OPTIONAL MARKETING LANGUAGE

[Chemsico Herbicide RTU DFC eliminates all types of common weeds and grasses [as listed]. (*illustrations*) This product can be used [for] [edging around lawns] [ornamental garden plot preparation] in driveways, walkways, curbs, along fences and foundations, near trees and shrubs, in flower beds, mulch beds and other similar areas of the yard to get rid of undesirable vegetation.]

[This product [is a non-selective herbicide that] will kill any vegetation contacted. It enters plants through the leaves and moves down to the roots. This will ensure that the entire plant is eliminated. Avoid direct spray or drift onto desirable plants, lawn grasses, shrubs, and trees. Protect desirable plants and vegetation with a piece of plastic or cardboard. If desirable plants are accidentally sprayed, wash plants with water immediately. This product has no soil activity and thus will not affect nearby untreated plants.]

[This container covers approximately 300 sq. ft. Coverage may be reduced if large brush species are treated.]

[KILLS] [CONTROLS] MOST COMMON [TOUGH] WEEDS AND GRASSES INCLUDING:

[Annual weeds and grasses: Annual ryegrass, annual bluegrass, barnyardgrass, beggarweed, black medic, blue medic, blue toadflax, brassbuttons, blue mustard, bromegrass, bur clover, buttercup, cheeseweed, chickweed, clover, common groundsel, common lambsquarters, common plantain, common ragweed, crabgrass, creeping beggarweed, diffuse lovegrass, dog fennel, evening primrose, false dandelion, fall panicum, fennel, fiddleneck, field pennycress, field sandbur, filaree, Florida pusley, foxtail, garden spurge, goosegrass, green foxtail, hemp sesbania, henbit, horseweed/marestail, ironweed, knotweed, lambsquarters, little bitter cress, London rocket, maiden cane, mallow, mayweed, mouseear chickweed*, oxalis*, Pennsylvania smartweed, pennywort, pigweed, prickly lettuce, prostrate spurge, puncture vine, purslane, redroot, pigweed, sandspur, shepherdspurge, smartweed, smooth cat's ear, smooth pigweed, sowthistle, spotted spurge, sprangletop, spurges, tansy mustard, tansy ragwort, teaweed, Texas panicum, tumble mustard, velvetleaf, wild geranium*, witch grass, wild mustard, yellow nutgrass, yellow oxalis (and many other annual grasses and weeds)]

[Perennial weeds, grasses, brush:

Alder, artichoke thistle, bahiagrass, barnyardgrass, bentgrass, Bermudagrass, bluegrass, broadleaf plantain, brownseed, paspalum, buckhorn plantain, bull thistle, Canada thistle, cattail, ceanothus, centipedegrass, cocklebur, cogongrass, common milkweed, common ragweed, coral beard, creeping Charlie, curly dock, dallisgrass, dandelion, dewberry, dog fennel, false dandelion, fescue species, field bindweed, guineagrass, hairy crabgrass, horsetail, horseradish, iceplant, Johnsongrass, Kentucky bluegrass, kikuyugrass, knapweed, knawel, lantana, maiden cane, milkweed, mouseear chickweed*, nimblewill, nutgrass (nutsedge), oldenlandia,

orchardgrass, oxalis*, pampasgrass, pennywort, perennial ryegrass, plantain, purple cudweed*, purple nutsedge, quackgrass, quaking aspen, ragweed, red clover, smooth bromegrass, sourdock, sowthistle, St. Augustine grass, tall fescue, tansy ragwort, Timothy, torpedograss, trumpetcreeper, vaseygrass, Virginia creeper, white clover, whitetop, wild barley, wild blackberry, wild carrot, wild morning-glory, wild oats, yarrow, yellow nutgrass, yellow starthistle, zoysia.]

*annual or perennial

STOP. Read entire label before use**DIRECTIONS FOR USE**

It is a violation of Federal law to use this product in a manner inconsistent with its labeling. *For outdoor residential use only.*



Do not allow people or pets to touch treated plants until the sprays have dried.

APPLICATION RESTRICTIONS

Do not apply this product in a way that will contact any person or pet, either directly or through drift. Only persons applying this product may be in the area during application.

USER SAFETY RECOMMENDATIONS

Clothing and protective equipment exposed to this product should be washed in detergent and hot water. Such items should be kept and washed separately from other laundry.

Users should wash hands before eating, drinking, chewing gum, using tobacco or using the toilet. Users should remove clothing immediately if pesticide gets inside. Then wash thoroughly and put on clean clothing.

Users should remove clothing and protective equipment immediately after handling this product. As soon as possible, wash thoroughly and change into clean clothing.

[How to use] [Application Instructions]

Chemsico Herbicide RTU DFC is pre-mixed and ready to use and is formulated for "spot" treatment of weeds and grasses. [It is ideal for tough to reach weeds found in flowerbeds.] Use it on driveways and walkways, or around fences, trees, flower beds, shrubs and other areas in your yard. [It can also be used for lawn renovation.]

[How To Apply]

- Completely [wet] [cover] the foliage [leaves] of the target vegetation [plant]. Do not overspray.
- Sprayed plants begin yellowing and wilting in about 24 hrs, with complete kill, including the roots, in 1 to 2 weeks.
- Protect desirable plants with a piece of plastic or cardboard.
- If desirable plants are accidentally sprayed, wash plants with water immediately.
- Do not mow, cut or otherwise disturb treated [vegetation] [weeds] or [plants] for at least 7 days following application.
- Do not use on or around edible feed or food crops.

[When to Apply] [Use Tips]

- For best results apply during warm, sunny weather (above 60°F) when weeds are actively growing and no rain is forecast for 24 hours. Rainfall or watering 2 hours [15 minutes] after application will not wash away effectiveness.
- To avoid drift to desirable plants, apply when the air is calm.

Not recommended for spot weed treatment in established lawns since lawn grasses will also be killed.

[OPTIONAL EDGER TEXT]

Chemsico Herbicide RTU DFC is an easy edger for use along driveways, walkways, curbs, sidewalk cracks, around landscaping, ornamentals, trees, and shrubs. Use in larger areas such as patios and brick and gravel walks. [This product treats 1200 linear feet (3 inch wide band)]

[SPRINKLER CAP APPLICATOR]

1. Remove cap from applicator head and make sure that the applicator head is screwed firmly on the bottle.
2. Hold the bottle about 2 to 6 inches from the area to be treated. Invert the bottle and apply product to thoroughly cover unwanted vegetation. The width of the stream may be adjusted by either raising or lowering the bottle.
3. Use just enough product to completely [cover] [wet] the [vegetation] [plant].

[OPTION A: Hand Sprayer Application]

How to prime and care for your sprayer:

1. **CONNECT TRIGGER SPRAYER.** Unscrew and discard the [white] cap on the bottle. Insert the hose into the bottle and tighten the cap securely.
2. **PRIME SPRAYER.** Turn the sprayer nozzle one-half turn counter-clockwise. Hold the sprayer lower than the bottle and squeeze the trigger several times until it sprays. Adjust the nozzle to coarse spray pattern. Avoid sprays which are too fine because they can drift and damage other plants.

3. Spray unwanted grass & weeds until completely [covered] [wet].

[OPTION B: Trigger Sprayer applicator]

1. Turn nozzle to coarse spray pattern. Avoid sprays which are too fine because they can drift and damage other plants.
2. Spray unwanted grass & weeds until completely [covered] [wet].

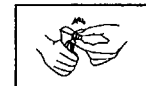
**[OPTION C: Nested Sprayer Application]**

1. Pull tab outward.
2. Rotate lock ring counterclockwise to unlock.
3. Pull sprayer to uncoil tubing.
4. Prime sprayer. Turn the sprayer nozzle one-half turn counter-clockwise. Hold the sprayer lower than the bottle and squeeze the trigger several times until it sprays. Adjust the nozzle to coarse spray pattern. Avoid sprays which are too fine because they can drift and damage other plants.
5. Spray unwanted grass & weeds until completely [covered] [wet].
6. To replace, return sprayer to bottle opening.
7. Drape tubing through slot in the spray handle.
8. Turn lock ring clockwise to lock.

[OPTIONAL D: Captive Sprayer Application]**HOW TO USE****BEFORE USE:**

1. Shake well before each use.
2. Peel sticker from flip-top cap and open cap. Discard sticker.
3. Remove sprayer from its slot beneath the bottle handle and remove and discard plastic wrap. Pull black hose tip to completely extend tubing.
4. Firmly press black hose tip into opening in cap until it snaps into place.
5. Hold sprayer below the level of the container and prime by pumping trigger several times until product is dispensed.
6. Adjust nozzle to desired setting.

AFTER USE:

7. To store, turn sprayer nozzle off.
8. DO NOT disconnect hose.
9. Return sprayer to its slot. Hose can be pushed back into sprayer handle.

[WHEN TO REPLANT]

- All ornamental flowers, trees and (&) shrubs may be planted **1 day after** application.

FOR LAWN RENOVATION/REPLACEMENT**[HOW [ALTERNATE: WHEN] TO USE]**

1. Determine size of area to be treated—measure length and width in feet then multiply to determine coverage area in sq ft (length x width).
2. Use this product to remove [kill] the old lawn and existing weeds and grasses.
3. For best results, apply in spring or fall, when daytime temperatures are at least 60°F.
4. If the lawn is dry [Under dry conditions], water lawn every other day for a week before applying Chemsico Herbicide RTU DFC
5. Do not mow for 7 days before or after treatment.
6. One gallon treats 300 sq ft.

TIPS FOR REPLANTING

- After 7 days, prepare the soil for planting by raking or roto-tilling the lawn. **[Wait 7 days after last application to rake, till or replant with seed or sod]**
- Rake up and remove loosened thatch or debris.
- Mix in starter fertilizer and soil amendments, if needed. Level the soil.
- Apply seed according to directions on seed package, or install sod. Grass seed must have good contact with soil to germinate and grow.
- Keep area moist for 2 weeks to establish new lawn, then water as needed.

STORAGE AND DISPOSAL**[OPTION A: Hand Sprayer and Nested Sprayer Application]**

Pesticide Storage: Turn the nozzle to "OFF" position and store with sprayer above the level of liquid in container to prevent leakage.

Pesticide Disposal: **If empty:** Nonrefillable container. Do not reuse or refill this container. Offer for recycling, if available. **If partly filled:** Call your local solid waste agency for disposal instructions. Never place unused product down any indoor or outdoor drain.

[OPTION B: Trigger Sprayer and Sprinkler Cap]

Pesticide Storage: Store in a cool, dry area away from heat or open flame.

Pesticide Disposal: **If empty:** Nonrefillable container. Do not reuse or refill this container. Offer for recycling, if available. **If partly filled:** Call your local solid waste agency or for disposal instructions. Never place unused product down any indoor or outdoor drain.

PRECAUTIONARY STATEMENTS**Hazards to Humans and Domestic Animals**

CAUTION. Causes moderate eye irritation. Avoid contact with eyes or clothing. Wear long-sleeved shirt, long pants, shoes, and socks.

FIRST AID: **If in Eyes:** Hold eye open and rinse slowly and gently with water for 15-20 minutes. Remove contact lenses, if present, after the first 5 minutes, then continue rinsing eye. Call a Poison Control Center or doctor for treatment advice. **If on Skin or Clothing:** Take off contaminated clothing. Rinse skin with plenty of water for 15-20 minutes. Call a Poison Control Center or doctor for treatment advice.

Have the product container or label with you when calling a Poison Control Center or doctor, or going for treatment.

Environmental Hazards

This pesticide is toxic to aquatic invertebrates. Do not apply directly to water. Do not contaminate water when disposing of equipment washwaters.

NOTICE: To the extent required by applicable law, buyer assumes all responsibility for safety and use not in accordance with directions.

Made in the USA by Chemsico, Division of United Industries Corp., P. O. Box 142642, St. Louis, MO 63114-0642

[Questions or Comments? call 1-800-332-5553]

[**If you are not satisfied with this product for any reason, send your written request for a refund to the address below, together with the original dated store receipt showing the price you paid. Please allow 6-8 weeks for processing.]

EPA Reg. No. 9688-208

EPA Est. No. 9688-MO-1 © 2009

ALTERNATE LABEL FORMAT

STOP. Read entire label before use

DIRECTIONS FOR USE

It is a violation of Federal law to use this product in a manner inconsistent with its labeling. *For outdoor residential use only.*



Do not allow people or pets to touch treated plants until the sprays have dried.

APPLICATION RESTRICTIONS

Do not apply this product in a way that will contact any person or pet, either directly or through drift. Only persons applying this product may be in the area during application.

USER SAFETY RECOMMENDATIONS

Clothing and protective equipment exposed to this product should be washed in detergent and hot water. Such items should be kept and washed separately from other laundry.

Users should wash hands before eating, drinking, chewing gum, using tobacco or using the toilet. Users should remove clothing immediately if pesticide gets inside. Then wash thoroughly and put on clean clothing.

Users should remove clothing and protective equipment immediately after handling this product. As soon as possible, wash thoroughly and change into clean

[EASY ACTION PUMP [SPRAYER] Directions] [HOW TO USE THE EASY ACTION PUMP [SPRAYER]]

1. For the initial use, remove the tie that is securing the handle to the base of the pump.
2. REMOVE THE WAND from the holster and PULL THE HOSE from the storage compartment.
3. Make sure the sprayer wand is securely tightened to the spray handle. (Graphical representation.)
4. TURN THE PUMP HANDLE CLOCKWISE to tightly seal the pump to the bottle and unlock the pump handle for pumping. (Graphical representation)
5. RAISE THE PUMP HANDLE FROM THE BOTTLE AND PUMP until you begin to feel resistance. (Graphical representation)
6. Secure the pump handle for carrying by pushing the handle into the base of the pump and turn the handle counterclockwise one quarter turn to lock. (Graphical representation)

7. BEGIN SPRAYING by pushing down on the spray handle trigger. (Graphical representation)
8. ROTATE THE NOZZLE AT THE TIP of the wand to adjust the spray from a direct spray to a broadcast mist. (Graphical representation)
9. For continuous spray, push the trigger down and slide it forward to lock. SLIDE THE TRIGGER BACK TO RELEASE it from the lock position.

Note: If sprayer does not function properly, remove nozzle cover and check nozzle and holes in rubber component for obstructions. Replace nozzle cover and use as instructed above.]

[Hand Sprayer Application]

How to prime and care for your sprayer:

1. CONNECT TRIGGER SPRAYER. Unscrew and discard the [white] cap on the bottle. Insert the hose into the bottle and tighten the cap securely.
2. PRIME SPRAYER. Turn the sprayer nozzle one-half turn counter-clockwise. Hold the sprayer lower than the bottle and squeeze the trigger several times until it sprays. Adjust the nozzle to coarse spray pattern. Avoid sprays which are too fine because they can drift and damage other plants.
3. Spray unwanted grass & weeds until completely [covered] [wet].

[Nested Sprayer Application]

1. Pull tab outward.
2. Rotate lock ring counterclockwise to unlock.
3. Pull sprayer to uncoil tubing.
4. Prime sprayer. Turn the sprayer nozzle one-half turn counter-clockwise. Hold the sprayer lower than the bottle and squeeze the trigger several times until it sprays. Adjust the nozzle to coarse spray pattern. Avoid sprays which are too fine because they can drift and damage other plants.
5. Spray unwanted grass & weeds until completely [covered] [wet].
6. To replace, return sprayer to bottle opening.
7. Drape tubing through slot in the spray handle.
8. Turn lock ring clockwise to lock.

[Captive Sprayer Application]

HOW TO USE

BEFORE USE:

1. Shake well before each use.
2. Peel sticker from flip-top cap and open cap. Discard sticker.
3. Remove sprayer from its slot beneath the bottle handle and remove and discard plastic wrap. Pull black hose tip to completely extend tubing.
4. Firmly press black hose tip into opening in cap until it snaps into place.
5. Hold sprayer below the level of the container and prime by pumping trigger several times until product is dispensed.
6. Adjust nozzle to desired setting.

AFTER USE:

7. To store, turn sprayer nozzle off.
8. DO NOT disconnect hose.
9. Return sprayer to its slot. Hose can be pushed back into sprayer handle.

[EZSPRAY™ Directions]

1. [Unwrap sprayer.] Remove sprayer from side holder. [Unwrap the tubing] [Gently pull tubing out]. (Graphical representation.)
2. Remove seal from top of cap. Unplug cap. (Graphical representation.)
3. Securely snap the [yellow] plug into hole on cap. (Graphical representation.)
4. Remove plastic tab near [top] [bottom] of sprayer to activate batteries. (Graphical representation.)
5. Twist nozzle to adjust spray from CLOSE to SPRAY or STREAM. (Graphical representation.)
6. [When priming the sprayer, hold sprayer level to the ground. Sprayer may not prime if it is held at an angle. Once primed, it will spray in any direction. (Graphical representation.)]

HOW TO USE THE EzSpray™

1. Aim toward target [weeds/plants] [Area to be treated], and away from people and pets.
2. Press the trigger to spray.
3. Release the trigger to stop spray.

After use: 1. Twist nozzle completely to CLOSE position. 2. Secure sprayer upright in [holder] [holster]. 3. **Failure to adjust nozzle completely to CLOSE position and properly secure sprayer in [holder][holster] may result in leakage and damage to property or injury to people or animals.**

To replace batteries: 1. [Slide battery compartment door to unlatch and open.] [Push release button near nozzle and lift up on battery hatch.] 2. Remove used batteries and insert [four] [two] new AA batteries **in correct positions** as marked per diagram inside of battery compartment. Never insert the positive end where the negative end belongs and vice versa. **Always** use a complete set of new batteries of the same type when replacing batteries. **Never** mix alkaline, carbon-zinc or rechargeable batteries. 3. Securely close battery compartment door. 4. **Always** follow manufacturer's recommendations for use and disposal of batteries.

Additional Operating Notes: Do not submerge in water. Before each use inspect sprayer carefully, make sure hose is flexible and not kinked, worn or cracked, and that all connections are tight. When storing sprayer for prolonged periods remove batteries.

[How to use] [Application Instructions] [When To Use]

Chemsico Herbicide RTU DFC is pre-mixed and ready to use and is formulated for "spot" treatment of weeds and grasses. [It is ideal for tough to reach weeds found in flowerbeds.] Use it on driveways and walkways, or around fences, trees, flower beds, shrubs and other areas in your yard. [It can also be used for lawn renovation.]

[How To Apply] [Alt: General Weed Control]

- Completely [wet] [cover] the foliage [leaves] of the target vegetation [plant]. Do not overspray.
- Sprayed plants begin yellowing and wilting in about 24 hrs, with complete kill, including the roots, in 1 to 2 weeks.
- Protect desirable plants with a piece of plastic or cardboard.
- If desirable plants are accidentally sprayed, wash plants with water immediately.
- Do not mow, cut or otherwise disturb treated [vegetation] [weeds] or [plants] for at least 7 days following application.
- Do not use on or around edible feed or food crops.

[When to Apply] [Use Tips] [General Use Tips]

- For best results apply during warm, sunny weather (above 60°F) when weeds are actively growing and no rain is forecast for 24 hours. Rainfall or watering 2 hours [15 minutes] after application will not wash away effectiveness.
- To avoid drift to desirable plants, apply when the air is calm.

Not recommended for spot weed treatment in established lawns since lawn grasses will also be killed.

[When To Replant]

All ornamental flowers, trees and (&) shrubs may be planted **1 day after** application.

[FOR] LAWN RENOVATION/REPLACEMENT**[HOW [ALTERNATE: WHEN] TO USE]**

- Determine size of area to be treated—measure length and width in feet then multiply to determine coverage area in sq ft (length x width).
- Use this product to remove [kill] the old lawn and existing weeds and grasses.
- For best results, apply in spring or fall, when daytime temperatures are at least 60°F.
- If the lawn is dry [Under dry conditions], water lawn every other day for a week before applying Chemsico Herbicide RTU DFC
- Do not mow for 7 days before or after treatment.
- One gallon treats 300 sq ft.

TIPS FOR REPLANTING

- After 7 days, prepare the soil for planting by raking or roto-tilling the lawn. **[Wait 7 days after last application to rake, till or replant with seed or sod]**
- Rake up and remove loosened thatch or debris.
- Mix in starter fertilizer and soil amendments, if needed. Level the soil.
- Apply seed according to directions on seed package, or install sod. Grass seed must have good contact with soil to germinate and grow.

- Keep area moist for 2 weeks to establish new lawn, then water as needed

REFILL DIRECTIONS

Refill only with Spectracide TripleStrike Grass & Weed Killer Concentrate. Remove cap. Carefully measure and mix 10 fl oz (20 Tbsp) in one gallon of water. Replace and tightly close cap. Wipe off any spilled product.

STORAGE AND DISPOSAL

[Hand Sprayer and Nested Sprayer Applicators]

Pesticide Storage: Turn the nozzle to "OFF" position and store with sprayer above the level of liquid in container to prevent leakage.

Pesticide Disposal: If empty: Nonrefillable container. Do not reuse or refill this container. Offer for recycling, if available. **If partly filled:** Call your local solid waste agency for disposal instructions. Never place unused product down any indoor or outdoor drain.

[EZSPRAY Sprayer]

Pesticide Storage: Turn the nozzle to "CLOSE" position. To prevent leakage, attach sprayer to clip. Store this product only in its original container in a secure storage area away from sources of heat or open flame. Protect product from freezing.

Pesticide Disposal: If empty: Nonrefillable container. Do not reuse or refill this container. Offer for recycling, if available. **If partly filled:** Call your local solid waste agency for disposal instructions. Never place unused product down any indoor or outdoor drain.

[EASY ACTION PUMP [SPRAYER]]

Pesticide Storage: Slowly turn the pump handle counterclockwise to loosen the pump mechanism from the bottle to release pressure. Turn the handle back clockwise to seal the unit for storage. Turn the handle counterclockwise one quarter turn to lock the handle. Push the hose back into the storage compartment. Place the wand back in the holster. Store this product in its original container in a secure storage area. **Pesticide Disposal: If empty:** Nonrefillable container. Do not reuse or refill this container unless the directions for use allow a different (concentrated) product to be diluted in the container. Place in trash or offer for recycling if available. **If partly filled:** Call your local solid waste agency for disposal instructions. Never place unused product down any indoor or outdoor drain.

CHEMSICO HERBICIDE RTU DFC MARKETING CLAIMS

1. *Guaranteed Results [or your money back] [Money Back Guarantee*]
2. [Better] [Best] value
3. [Formula] enters the plant within one to two hours [won't wash off]

4. Improved Formula
5. [Spot] Treatment for Ornamental Garden] Replanting
6. Absorbed into the plant
7. Absorbed on Contact
8. Can be Used Over the Root Zones of Trees, Shrubs or Desirable Plants
9. Control that doesn't wash away
10. Controls [Hardy] [Tough] [Hard To Kill] Weeds and Grasses
11. Dead [weeds] [and] [grass] in 24 hours [and they'll never come back]
12. Dead Weeds Guaranteed* [*Or Your Money Back]
13. Does not have soil activity
14. Do-it-yourself weed killer
15. Effective even if it rains
16. Eliminates [kills] all common weeds and grasses
17. Eliminates Roots & Weeds, [Guaranteed*]
18. Eliminates Weeds, [Guaranteed*]
19. Exclusive Formula
20. Fast & [and] complete
21. Fast Acting [Formula]
22. Faster results than the leading brand
23. Fastest Replanting Available
24. For [Spot] Treatment of Unwanted Weeds and Grasses
25. For use [Ideal] [Can be Used] [Use in and around] [in] [on] [for] [along] flowerbeds
26. For Use [Use] [Ideal] [Can be Used] [Use in and around] [in] [on] [for] [along] [around] [fences], [driveways], [walkways], [shrubs], [trees] [ornamentals] [Walks] [Mulch Beds] [Gravel] [and] [Driveways] [Curbs]
27. For walks, drives, fences, patios and similar areas
28. Keeps Working, Even If it Rains
29. Kills All Treated Weeds
30. Kills Even Tough Weeds & Grasses
31. Kills from the Inside Out
32. Kills over 155 types of weeds [as listed]
33. Kills over 155 varieties of broadleaf and grassy weeds [as listed]
34. Kills the Entire Plant
35. Kills the Root
36. Kills the Root So Weeds Won't Grow Back
37. Kills the Root!
38. Kills the Weed you see and the Root you Don't
39. Kills Weeds and Unwanted Grasses
40. Kills Weeds and Unwanted Grasses, [Roots and All]
41. Kills Weeds in [a] [one] day
42. No Measuring
43. No Mixing [Required] [Necessary]

44. No residual activity in soil
45. No Root, No Weeds, [Guaranteed]
46. No Soil Activity
47. Not even the leading brand [is faster] [is as fast]
48. Overnight results
49. Quick-Kill Formula
50. Rainfast in 2 hours for control that doesn't wash away [won't wash away]
51. Rainfast in Hours – Starts to enter the Plant on Contact
52. Rainproof in 2 hours
53. Rainproof in 2 Hours for Control That Won't Wash Away
54. Ready-To-Use
55. Replant flowers, trees & shrubs [in half the time of other brands] [the same weekend]
56. Can be used around trees & shrubs
57. Satisfaction guaranteed [or your money back] [with proof of purchase]
58. See Results in 24 hrs!
59. Starts to work in 24 hours
60. Starts Working in Hours
61. Systemic formula
62. Systemic Weed and Grass Killer
63. Triple Action Formula
64. Water-based
65. Won't Wash Away
66. Works First Time, [Every time]
67. Works in 24 hours
- Works the first time [guaranteed*] * Or Your Money Back
68. Works 3 Ways : (1)Results in 24 hrs, (2) Kills over 155 varieties of Broadleaf & Grassy Weeds as listed, (3) Kills the Root
69. Starts Working Immediately !
70. Use on Paved & Landscaped Areas
71. Visible Results as Fast as 3 Hours
72. Rainfast in 15 Minutes
73. EzSpray Power Action Sprayer [batteries included]
74. [Please Read Before Use] – When Priming, Hold Sprayer Level to the Ground. If Held at an Angle, Sprayer Will not Prime
75. EzSpray Easy Setup
76. Continuous Spray
77. Increased Pressure for (5 Minute) Continuous Spray
78. Up to 5 minutes of Continuous Spray
79. Adjustable Spray Patterns [For Spot Application][Covers Large Area]
80. Extended Wand for Hard-to-Reach Areas
81. Locking Trigger Reduces Hand Fatigue
82. Easy Action Pump [Sprayer]

83. No Assembly Required