



U.S. ENVIRONMENTAL PROTECTION AGENCY  
Office of Pesticide Programs  
Registration Division (H7505C)  
401 "M" St., S.W.  
Washington, D.C. 20460

EPA Reg. Number:  
9688-201

Date of Issuance:  
NOV 27 2002

Term of Issuance: Unconditional

Name of Pesticide Product:  
Chemsico Home Insect  
Control G

NOTICE OF PESTICIDE:

Registration  
 Reregistration

(under FIFRA, as amended)

Name and Address of Registrant (include ZIP Code):

Chemsico, Division of United Industries Corp.  
P.O. Box 142642  
St. Louis, MO 63114

Note: Changes in labeling differing in substance from that accepted in connection with this registration must be submitted to and accepted by the Registration Division prior to use of the label in commerce. In any correspondence on this product always refer to the above EPA registration number.

On the basis of information furnished by the registrant, the above named pesticide is hereby registered/reregistered under the Federal Insecticide, Fungicide and Rodenticide Act.

Registration is in no way to be construed as an endorsement or recommendation of this product by the Agency. In order to protect health and the environment, the Administrator, on his motion, may at any time suspend or cancel the registration of a pesticide in accordance with the Act. The acceptance of any name in connection with the registration of a product under this Act is not to be construed as giving the registrant a right to exclusive use of the name or to its use if it has been covered by others.

This product is unconditionally registered in accordance with FIFRA sec. 3(c)(5). Once a pesticide is registered, however, it is not regarded as permanently acceptable. Registration does not eliminate the need for continual reassessment of pesticides. If the Agency determines that, at any time, additional data are required to maintain in effect an existing registration, the Agency will require submission of such data under FIFRA section (3).

1. Make the following labeling changes:
  - a. Revise the EPA Registration Number to read "EPA Reg. No. 9688-201"
  - b. This is a 100% repackaging of EPA Reg. No. 3125-530. Therefore identify "Other Ingredients" beneath the ingredient statement.
  - c. Under Wood Infesting Pests, second bullet, add the following statement to the end of the paragraph "For active termite infestations get a professional inspection".
2. Please submit three (3) copies of your final printed label before you release the product for shipment. Refer to the A-79 enclosure for a further description of final printed labeling.

A stamped copy of the label is enclosed for your records. If you have any questions regarding this action, please contact BeWanda Alexander of my team at (703) 305-7460.

Signature of Approving Official:

*BeWanda Alexander for*  
George T. LaRocca

Date:

NOV 27 2002

# CHEMSICO Home Insect Control G

## Optional Product Fact Box

**PRODUCT FACTS**

**What It Does:** Kills Ants and Roaches in Seconds  
**Where to Use:** Indoors as spot or crack and crevice spray. Outdoors as a perimeter treatment.  
**When To Use:** When insects or damage first appear.  
**Questions & Comments:** Call 1-800-xxx-xxxx or Visit our Website at [www.zzzzzzz.com](http://www.zzzzzzz.com)

[Please see Appendix for Complete List of Marketing Claims]

**ACCEPTED  
with COMMENTS  
In EPA Letter Dated:  
NOV 27 2002**

Under the Federal Insecticide, Fungicide, and Rodenticide Act, as amended, the pesticide registered under EPA Reg. No. 9688-201

Active Ingredient:  
 Cyfluthrin ..... 0.1%  
 Other Ingredients: ..... 99.9%

*list other ingredients as on me me-to label*

**KEEP OUT OF REACH OF CHILDREN**

**CAUTION:** See back [panel] [booklet] for additional precautionary statements

**NET CONTENTS** 24 fl. oz. (709 mL) or 1 gallon (3.78 L)

## STOP. READ ENTIRE LABEL BEFORE USE.

### DIRECTIONS FOR USE

It is a violation of Federal law to use this product in a manner inconsistent with its labeling. *For Indoor/Outdoor Residential Use Only.*



**Keep children and pets away from treated areas until spray has dried.**

- Do not spray the product into fish pools, ponds, streams or lakes.
- Indoors, do not use as a space spray (do not spray into the air).
- Remove animal feeding dishes before spraying.
- Do not use on surfaces where food is prepared or where food is exposed.
- Before spraying indoors, remove birds from area and tightly cover or remove fish bowls and aquariums.
- This product is not intended for application to plants and lawns.

### HOW TO USE

[How to prime and care for your sprayer:]

1. After shaking product well, remove cap from container and replace with sprayer hose and cap assembly. Tighten securely.
2. Turn sprayer nozzle one half turn counter-clockwise. Hold sprayer below the level of container and prime by pumping trigger 10 - 15 times until product is dispensed. Adjust nozzle to fine spray or jet stream as needed.
3. To store, turn nozzle to "OFF" position and [store with sprayer above level of liquid in container to prevent leakage] [store sprayer on hook located near bottle handle to prevent leakage].

8  
2  
8

[Bracketed text – Optional]

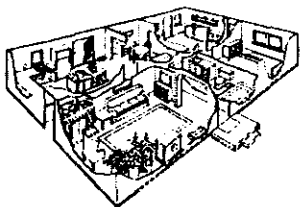
**INDOOR USE**

Typical areas that may require treatment

- Hold container upright while spraying. Direct nozzle about 12 inches from surface to be treated.
- Spray around baseboards, into cracks and crevices and other places where insects live and hide (under sinks, cabinets, refrigerators, damp areas, etc.) until surfaces are wet. Avoid excessive wetting of linoleum, asphalt tiles or plastic.
- For long lasting residual action leave spray undisturbed. The product will keep on killing up to 32 weeks [8 months]

**INDOOR PESTS CONTROLLED**

**Crawling Pests:** Ants (except Pharaoh), Bedbugs, Carpet Beetles, Centipedes, Cockroaches, Crickets, Earwigs, Firebrats, Millipedes, Pillbugs, Silverfish, Sowbugs, Spiders.

**Flying Pests:** Clothes moths, Flies, Gnats, Midges, Mosquitoes, Moths, Wasps, Yellow Jackets.

**Pantry & Stored Product Pests:** Beetles (exposed adults & immature stages): Cadelle, Cigarette, Confused Flour, Dermestid, Drugstore, Granary Weevil, Hide, Larder, Leather, Lesser Grain Borer, Lesser Mealworm, Merchant Grain, Mealworm, Red Flour, Rice weevil, Sawtoothed Grain, Warehouse

**Moths:** Indian Meal, Mediterranean Flour

**OUTDOOR USE**

Typical areas that may require treatment.

- Apply to exterior surfaces of the home.

- Spray a band 3 to 4 feet wide around and alongside the foundation and porches of the house.
- Treat soil, turf or walkways adjacent to foundation and porches. Also treat 1 to 2 feet up along the side of the dwelling.
- For more serious problems, a wider band of treatment, up to 10 feet may be necessary.
- Spray with the wind to avoid drifting of the spray onto skin or clothing.
- Treat where dissimilar building materials meet, such as where brick meets wood trim or where siding meets window edges or where cracks are visible, or around and into any openings where utilities enter the home. Spray around doors and window frames.
- Treat outside surfaces of garages, carports, patios, driveways and sidewalks if insects are present.
- Treat other problem areas such as around wood piles, storage sheds and other areas of insect infestation as needed. Spray on ant trails and ant hills.
- For wasps, hornets, yellow jackets: Application to nests should be made late in evening when insects are at rest.
- To aid in control of fire ants in lawns and other outdoor home recreation areas, thoroughly drench the entire mound area. Spray provides contact activity and residual in the active mound. Use a coarse spray and apply gently to avoid disturbing ants. Note: For best results apply in cold weather 65° to 85° F, or in early morning or late evening hours. Treat new mounds as they appear.

**Outdoor/Perimeter Pests**

Ants, Bees, Box elder bugs, Carpenter Ants, Cecidflies, Centipedes, Clusterflies, Cockroaches, Crickets, Earwigs, Elm leaf beetles, Fire Ants, Firebrats, Flies, Fleas, Gnats, Ground Beetles, Hornets, Imported Red Fire Ants, Midges, Millipedes, Mosquitoes, Moths, Scorpions, Silverfish, Spiders, Ticks (including Deer Ticks), Wasps, Yellow Jackets

**WOOD INFESTING PESTS**

- For control of termites and wood-infesting beetles found above ground, apply to voids and holes in damaged wood, and in spaces between wooden structures and between the sill plate and foundation where wood is exposed.
- Apply spray to exposed worker and winged reproductive forms of termites. This type of application is intended to be a supplemental treatment for the control of drywood and above ground subterranean termites and other wood-infesting insects. It is not intended as a substitute for soil treatments for termite control.
- For control of swarming or reproductive stages of termites, apply a coarse spray to cover the swarm or area on which they collect.
- For control of carpenter ants around houses and other structures, apply around doors and windows and other places where carpenter ants may enter premises. Spray into cracks and crevices or voids where these ants or their nests are present. Use a sufficient amount of coarse spray to cover the area.
- For control of carpenter bees in structures, spray the liquid directly into bee entrance holes. Leave the entrance holes open for 24 hours to be certain that returning adult bees are killed. When there is no activity, the hole may be sealed with a suitable sealant.

**Wood Infesting Pests**

Beetles (Ambrosia, Deathwatch, False Powderpost, Old House Borer, Powderpost), Carpenter Ants, Carpenter Bees, Termites (Subterranean, Formosan, Drywood)

**STORAGE AND DISPOSAL**

**Storage:** Store in an area out of the reach of children, preferably a locked storage cabinet. Protect from freezing.

**Disposal: If empty:** Do not reuse this container. Place in trash or offer for recycling if available. **If partly filled:** Call your local solid waste agency or 1-800-CLEANUP for disposal instructions. Never place unused product down any indoor or outdoor drain.

**PRECAUTIONARY STATEMENTS**

**Hazards to Humans and Domestic Animals**

**CAUTION:** Harmful if swallowed or inhaled. Causes eye irritation. Avoid contact with skin, eyes or clothing. Wash thoroughly with soap and water after handling. Avoid breathing vapors or spray mist. Remove contaminated clothing and wash clothing before reuse.

**FIRST AID**

**If Swallowed:** Call a Poison Control Center or doctor immediately for treatment advice. Have person sip a glass of water if able to swallow. Do not induce vomiting unless told to do so by a Poison Control Center or doctor. Do not give anything by mouth to an unconscious person.

**If Inhaled:** Move person to fresh air. If person is not breathing, call 911 or ambulance, then give artificial respiration, preferably mouth-to-mouth if possible. Call a Poison Control Center or doctor for further treatment advice

**If in Eyes:** Hold eye open and rinse slowly and gently with water for 15-20 minutes. Remove contact lenses, if present, after the first 5 minutes, then continue rinsing eye. Call a Poison Control Center or doctor for treatment advice

Have the product container or label with you when calling a Poison Control Center or doctor, or going for treatment.

**Environmental Hazards**

This pesticide is highly toxic to aquatic invertebrates and fish. Do not apply directly to water. Do not contaminate water when disposing of equipment washwaters or rinsate.

**NOTICE: Buyer assumes all responsibility for safety and use not in accordance with directions.**

*[Questions or comments? Call 1-800-332-5553]*

*[If you are not satisfied with this product for any reason send your written request for a refund to the address below, together with the original dated store receipt showing the price you paid. Please allow 6-8 weeks for processing]*

Made in the USA for  
Chemsico, Division of United Industries Corporation  
P.O. Box 142642, St. Louis, MO 63114-0642

EPA Reg. No. 9688-  
EPA Est. No. 9688-MO-1  
©2002

ALTERNATE TABULAR LABEL FORMAT  
FRONT PANEL

**CHEMSICO** Home  
Insect Control G

[See Appendix for Optional List of Marketing Claims]

Active Ingredient:  
Cyfluthrin ..... 0.1%  
Other Ingredients: ..... 99.9%

KEEP OUT OF REACH OF CHILDREN

CAUTION: See back [panel] [booklet] for additional precautionary statements

NET CONTENTS 24 fl. oz. (709 mL) or 1 gallon (3.78 L)

4  
2  
8

## BACK PANEL

<b>QUICK FACTS</b>	
<ul style="list-style-type: none"> <li>• Kills Ants and Roaches in Seconds</li> <li>• Continues Killing Up to 8 Months Indoors</li> <li>• Keeps Insects out of Your Home</li> <li>• Non-Staining</li> </ul>	
<b>KILLS</b>	Ants, Cockroaches, Fleas, Spiders and other listed pests
<b>WHERE TO USE</b>	Indoors as spot or crack and crevice spray. Outdoors as perimeter treatment.
<b>PHONE ICON/ COMPUTER ICON</b>	
Questions & Comments: Call 1-800-xxx-xxxx or Visit our Website at <a href="http://www.zzzz.com">www.zzzz.com</a>	

## STOP. READ ENTIRE LABEL BEFORE USE.

<b>DIRECTIONS FOR USE</b>	
It is a violation of Federal law to use this product in a manner inconsistent with its labeling. <i>For Indoor/Outdoor Residential Use Only.</i>	
<b>BEFORE YOU USE</b>	<ul style="list-style-type: none"> <li>• Do not spray the product into fish pools, ponds, streams or lakes.</li> <li>• Indoors, do not use as a space spray (do not spray into the air).</li> <li>• Remove animal feeding dishes before spraying.</li> <li>• Do not use on surfaces where food is prepared or where food is exposed.</li> <li>• Before spraying indoors, remove birds from area and tightly cover or remove fish bowls and aquariums.</li> <li>• Keep children and pets away from treated areas until spray has dried.</li> <li>• This product is not intended for application to plants and lawns.</li> </ul>
<b>HOW TO USE</b>	<b>INDOOR USE</b>
	<ul style="list-style-type: none"> <li>• Hold container upright while spraying. Direct nozzle about 12 inches from surface to be treated.</li> <li>• Spray around baseboards, into cracks and crevices and other places where insects live and hide (under sinks, cabinets, refrigerators, damp areas, etc.) until surfaces are wet. Avoid excessive wetting of linoleum, asphalt tiles or plastic.</li> <li>• For long lasting residual action leave spray undisturbed. The product will keep on killing up to 32 weeks [8 months].</li> </ul>

## OUTDOOR USE

- Apply to exterior surfaces of the home.
- Spray a band 3 to 4 feet wide around and alongside the foundation and porches of the house.
- Treat soil, turf or walkways adjacent to foundation and porches. Also treat 1 to 2 feet up along the side of the dwelling.
- For more serious problems, a wider band of treatment, up to 10 feet may be necessary.
- Spray with the wind to avoid drifting of the spray onto skin or clothing.
- Treat where dissimilar building materials meet, such as where brick meets wood trim or where siding meets window edges or where cracks are visible, or around and into any openings where utilities enter the home. Spray around doors and window frames.
- Treat outside surfaces of garages, carports, patios, driveways and sidewalks if insects are present.
- Treat other problem areas such as around wood piles, storage sheds and other areas of insect infestation as needed. Spray on ant trails and ant hills.
- For wasps, hornets, yellow jackets: Application to nests should be made late in evening when insects are at rest.
- To aid in control of fire ants in lawns and other outdoor home recreation areas, thoroughly drench the entire mound area. Spray provides contact activity and residual in the active mound. Use a coarse spray and apply gently to avoid disturbing ants. Note: For best results apply in cold weather 65° to 85° F, or in early morning or late evening hours. Treat new mounds as they appear.

## WOOD INFESTING PESTS

- For control of termites and wood-infesting beetles found above ground, apply to voids and holes in damaged wood, and in spaces between wooden structures and between the sill plate and foundation where wood is exposed.
- Apply spray to exposed worker and winged reproductive forms of termites. This type of application is intended to be a supplemental treatment for the control of drywood and above ground subterranean termites and other wood-infesting insects. It is not intended as a substitute for soil treatments for termite control.
- For control of swarming or reproductive stages of termites, apply a coarse spray to cover the swarm or area on which they collect.

	<ul style="list-style-type: none"> <li>For control of carpenter ants around houses and other structures, apply around doors and windows and other places where carpenter ants may enter premises. Spray into cracks and crevices or voids where these ants or their nests are present. Use a sufficient amount of coarse spray to cover the area.</li> <li>For control of carpenter bees in structures, spray the liquid directly into bee entrance holes. Leave the entrance holes open for 24 hours to be certain that returning adult bees are killed. When there is no activity, the hole may be sealed with a suitable sealant.</li> </ul>
--	---

<b>PESTS CONTROLLED [KILLS]</b>	<b>INDOOR PESTS</b>
	<b>Crawling Pests:</b> Ants (except Pharaoh), Bedbugs, Carpet Beetles, Centipedes, Cockroaches, Crickets, Earwigs, Firebrats, Millipedes, Pillbugs, Silverfish, Sowbugs, Spiders.
	<b>Flying Pests:</b> Clothes moths, Flies, Gnats, Midges, Mosquitoes, Moths, Wasps, Yellow Jackets
	<b>Pantry &amp; Stored Product Pests:</b> Beetles (exposed adults & immature stages): Cadelle, Cigarette, Confused Flour, Dermestid, Drugstore, Granary Weevil, Hide, Larder, Leather, Lesser Grain Borer, Lesser Mealworm, Merchant Grain, Mealworm, Red Flour, Rice weevil, Sawtoothed Grain, Warehouse <b>Moths:</b> Indian Meal, Mediterranean Flour

<b>PESTS CONTROLLED [KILLS]</b>	<b>OUTDOOR/PERIMETER PESTS</b>
	Ants, Bees, Box elder bugs, Carpenter Ants, Cecidflies, Centipedes, Clusterflies, Cockroaches, Crickets, Earwigs, Elm leaf beetles, Fire Ants, Firebrats, Flies, Fleas, Gnats, Ground Beetles, Hornets, Imported Red Fire Ants, Midges, Millipedes, Mosquitoes, Moths, Scorpions, Silverfish, Spiders, Ticks (including Deer Ticks), Wasps, Yellow Jackets
	<b>WOOD INFESTING PESTS</b>
	<b>Beetles:</b> Ambrosia, Deathwatch, False Powderpost, Old House Borer, Powderpost <b>Carpenter Ants</b> <b>Carpenter Bees</b> <b>Termites</b> Subterranean, Formosan, Drywood

**STORAGE AND DISPOSAL**

**Storage:** Store in an area out of the reach of children, preferably a locked storage cabinet. Protect from freezing.

**Disposal:** If empty: Do not reuse this container. Place in trash or offer for recycling if available. If partly filled: Call your local solid waste agency or 1-800-CLEANUP for disposal instructions. Never place unused product down any indoor or outdoor drain.

**PRECAUTIONARY STATEMENTS****Hazards to Humans and Domestic Animals****CAUTION**

- Harmful if swallowed or inhaled.
- Causes eye irritation.
- Avoid contact with skin, eyes, or clothing.
- Wash thoroughly with soap and water after handling.
- Avoid breathing vapors or spray mist.
- Remove contaminated clothing and wash clothing before reuse.

**FIRST AID**

<b>If Swallowed</b>	<ul style="list-style-type: none"> <li>Call a Poison Control Center or doctor immediately for treatment advice.</li> <li>Have person sip a glass of water if able to swallow.</li> <li>Do not induce vomiting unless told to do so by a Poison Control Center or doctor.</li> <li>Do not give anything by mouth to an unconscious person</li> </ul>
<b>If Inhaled</b>	<ul style="list-style-type: none"> <li>Move person to fresh air.</li> <li>If person is not breathing, call 911 or an ambulance, then give artificial respiration, preferably mouth-to-mouth if possible.</li> <li>Call a Poison Control Center or doctor for further treatment advice</li> </ul>
<b>If in Eyes</b>	<ul style="list-style-type: none"> <li>Hold eye open and rinse slowly and gently with water for 15-20 minutes.</li> <li>Remove contact lenses, if present, after the first 5 minutes, then continue rinsing eye.</li> <li>Call a Poison Control Center or doctor for treatment advice.</li> </ul>

Have the product container or label with you when calling a Poison Control Center or doctor, or going for treatment.

Environmental Hazards
<ul style="list-style-type: none"> <li>• This pesticide is highly toxic to aquatic invertebrates and fish. Do not apply directly to water.</li> <li>• Do not contaminate water when disposing of equipment washwaters or rinsate.</li> </ul>



**NOTICE: Buyer assumes all responsibility for safety and use not in accordance with directions.**

**[Questions or comments? Call 1-800-332-5553]**

**[\*If you are not satisfied with this product for any reason send your written request for a refund to the address below, together with the original dated store receipt showing the price you paid. Please allow 6-8 weeks for processing]**

Made in the USA for  
Chemsico, Division of United Industries Corporation  
P.O. Box 142642, St. Louis, MO 63114-0642

EPA Reg. No. 9688-  
EPA Est. No. 9688-MO-1  
©2002

## APPENDIX

### CHEMSICO HOME INSECT CONTROL G OPTIONAL MARKETING CLAIMS

- Kills on Contact
- Kills roaches [and Fleas]
- Kills both adult and pre-adult (larvae) fleas
- Kills ticks (including ticks which may transmit Lyme disease)
- Helps protect your home from invading ants
- Also stops spiders, roaches, fleas, and ticks
- Fast [killing] [acting]
- Kills Fast, [lasts long]
- Long Lasting [Insect Control] [Residual Control] [Residual Killing Power]
- Kills Most Common Household Insect Pests
- Kills most common pests, including ants and cockroaches
- Kills Invading Insects [around basements, foundations and baseboards]
- Kills the insects you see, kills the ones you don't see
- Kills Ants and Roaches in Seconds
- Kills [even] hidden bugs
- Kills the bugs you see and kills the bugs you don't see
- Kills both adult and pre-adult [larvae] fleas
- Kills a Wide Range of Crawling, Flying and Wood infesting Pests
- Use indoors and outdoors
- For Indoor and Outdoor Use
- Indoor protection for up to [4, 5, 6, 7, 8] months
- Indoor & Outdoor Insect Killer
- For residual control of nuisance pests for up to 8 months
- Also Kills with Residual Action
- Just One Application Quickly Kills Insects – Continues Killing up to [16, 20, 24, 28, 32] weeks [4, 5, 6, 7, 8] months indoors
- Fast acting with residual control [for up to eight [8] months]
- Fast Acting – Long Lasting
- Double Protection – Use Inside and Outside
- Use as an outdoor barrier treatment – helps keep insects from entering your home
- Creates an insect barrier around your home
- Protects your home from invading pests (ants, roaches, spiders, others listed)

- Economical do-it-yourself pest control
- Do-it-yourself pest control
- Easy to use ready spray
- Ready-To-Use
- Sprayer included
- No lingering odor
- Leaves no odor
- No oily residue
- Water-based [Formula]
- Non-staining
- Guaranteed\*