

JUN -4 1996

PM 13

Chemsico

HOME INSECT CONTROL D

- Kills roaches • Kills fleas • Kills ticks (including ticks which transmit Lyme disease) • Kills on contact • Kills fast • Fast killing • Kills ticks on contact • Kills both adult and pre-adult (larvae) fleas for up to 8 weeks (2 months) • Kills fleas and their hatching eggs • Breaks the flea life cycle • Kills hidden bugs • Kills even hidden bugs • Kills the bugs you see and kills the bugs you don't see • Keeps killing • Keeps on killing • Continues to kill cockroaches (roaches) and ants for up to 16 weeks (4 months) • Lasts up to 16 weeks (4 months)
 - Protects for up to 16 weeks (4 months)
- Water-based • Non-staining • No oily residue • No odor • Leaves no odor • No unpleasant odor • No lingering odor • Use indoors and outdoors • Sprayer included • Ready-to-use • Economical do-it-yourself pest control • Do-it-yourself pest control

Active Ingredient:
 Tralomethrin (1R,3S)[(1'RS)(1'', 2', 2'', 2'-tetrabromoethyl)]
 2,2-dimethylcyclopropanecarboxylic acid (S)-alpha-cyano-
 3-phenoxybenzyl ester 0.03%
 Inert Ingredients: 99.97%
 Tralomethrin supplied under license from AgrEvo Environmental Health,

KEEP OUT OF REACH OF CHILDREN

CAUTION See side for additional precautionary statements

NET CONTENTS 1 GALLON

Chemsico Home Insect Control D

- Do-it-yourself Pest Control • Fast Killing • Kills Even Hidden Bugs • Keeps on Killing • Water-Based (Non-Staining, No Odor)

STOP! (optional) READ ENTIRE LABEL BEFORE USE.

DIRECTIONS FOR USE

It is a violation of Federal law to use this product in a manner inconsistent with its labeling. For home use.

(Optional) Sprayer Instructions

How to prime and care for your sprayer:

1. After shaking product well, remove cap from container and replace with sprayer hose and cap assembly. Tighten securely.
2. Turn sprayer nozzle one half turn counter-clockwise. Hold sprayer below the level of container and prime by pumping trigger 10-15 times until product is dispensed. Adjust nozzle to fine spray or jet stream as needed.
3. To store, turn nozzle to "OFF" position and store with sprayer above level of liquid in container to prevent leakage.

Shake Well Before Using INDOORS

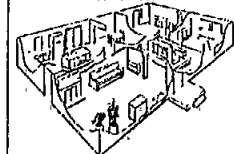

• Typical areas that may require insecticide treatment.

INDOORS

Spray areas where cockroaches, Palmetto bugs, ants, clover mites, crickets, firebrats, water bugs, silverfish and spiders are found or normally occur including dark corners of rooms and closets, cracks and crevices in walls; along and behind baseboards; beneath and behind sinks, stoves, refrigerators and cabinets; around plumbing and other utility installations. For ants, apply to ant trails; around doors and windows and wherever else ants may find entrance. For control of carpet beetles, thoroughly spray along baseboards and edges of carpeting, under carpeting, rugs and furniture, in closets and on shelving, and wherever else insects are seen or suspected. For

Under the Federal Insecticide, Fungicide, and Rodenticide Act as amended, this pesticide complies with the requirements of the Act.

control of fleas and brown dog ticks, thoroughly spray pet beds, resting quarters, nearby cracks and crevices, along and behind baseboards, window and door frames and localized areas of floor and floor covering where fleas and ticks may be present. Pet bedding should be replaced with clean fresh bedding after treating the area. **Do not treat pets with this product.** To control the source of flea infestations, pets should be treated with a product registered for application to animals.

Note: Check carpet manufacturer's warranty and care and maintenance information before using product on your specific brand of carpeting.

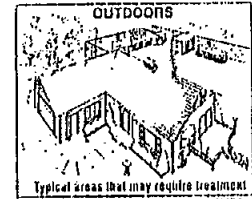

• Typical areas that may require insecticide treatment.

OUTDOORS:

Flies, mosquitoes: For use only as an aid in reducing annoyance from these insects. Spray outside surfaces of screens, doors, window frames or wherever insects may enter the room. Also spray surfaces around light fixtures, on porches, in garages and other places where insects alight or congregate. Repeat as needed. **Ants, ticks (including ticks which transmit Lyme disease), crickets, fleas and earwigs:** For treatment of infestation of these insects in areas where there are weeds or bushy non-crop areas, spray infested areas thoroughly. When treating for ticks, give special attention to areas frequented by pets. For ants, thoroughly wet hills and runways. Repeat as needed.

PRECAUTIONS: People and pets should not be allowed in treated areas until spray has dried.

STORAGE AND DISPOSAL

Store in cool, dry area away from heat or open flame. Discard container in trash.

PRECAUTIONARY STATEMENTS

Hazards to Humans and Domestic Animals

CAUTION: Harmful if inhaled. Avoid breathing vapor or spray

9688-87

1/2