



OFFICE OF CHEMICAL SAFETY AND POLLUTION PREVENTION

WASHINGTON, D.C. 20460

March 4, 2025

Jean Marcelin
Sr. Regulatory Affairs Manager
Professional Disposables International (PDI) Inc.
Electronic Transmittal: jmarcelin@pdipdi.com

Subject: PRIA Label Amendment – Addition of feline calicivirus and measles virus; updates to label language; minor updates to directions for use; modifications and additions to use sites; and minor formatting changes
Product Name: Sani-Cloth Germicidal Wipes
EPA Registration Number: 9480-4
Received Date: 4/30/2024
Action Case Number: 00610534

Dear Jean Marcelin:

The application referred to above, submitted under the Federal Insecticide, Fungicide and Rodenticide Act (FIFRA), as amended is acceptable under FIFRA sec 3 (c)(5). You must submit and/or cite all data required for registration/reregistration/registration review of your product when the Agency requires all registrants of similar products to submit such data.

A stamped copy of your labeling is enclosed for your records. This labeling supersedes all previously accepted labeling. Pursuant to 40 CFR 156.10(a)(6), you must submit one (1) copy of the final printed labeling before you release the product for shipment with the new labeling. In accordance with 40 CFR 152.130(c), you may distribute or sell this product under the previously approved labeling for 18 months from the date of this letter. After 18 months, you may only distribute or sell this product if it bears this new revised labeling or subsequently approved labeling. "To distribute or sell" is defined under FIFRA section 2(gg) and its implementing regulation at 40 CFR 152.3.

Should you wish to add/retain a reference to the company's website on your label, then please be aware that the website becomes labeling under FIFRA and is subject to review by the Agency. See FIFRA section 2(p)(2). If the website is false or misleading, the product would be misbranded and unlawful to sell or distribute under FIFRA section 12(a)(1)(E). 40 CFR

156.10(a)(5) lists examples of statements EPA may consider false or misleading. In addition, regardless of whether a website is referenced on your product's label, claims made on the website may not substantially differ from those claims approved through the registration process, FIFRA section 12(a)(1)(B). Therefore, should the Agency find or if it is brought to our attention that a website contains false or misleading statements or claims substantially differing from the EPA approved registration, the website will be referred to the EPA's Office of Enforcement and Assurance.

Your release for shipment of the product constitutes acceptance of these conditions. If these conditions are not complied with, the registration will be subject to cancellation in accordance with FIFRA section 6. If you have any questions, please contact Kasey Chambers at 202-566-0743 or chambers.katelyn@epa.gov.

Sincerely,

A handwritten signature in cursive script that reads "Heather A. Garvie".

Heather A. Garvie
Senior Regulatory Advisor
Regulatory Management Branch 2
Antimicrobials Division
Office of Pesticide Programs

Enclosure

ACCEPTED

03/04/2025

Under the Federal Insecticide, Fungicide
and Rodenticide Act as amended, for the
pesticide registered under
EPA Reg. No. 9480-4

SANI-CLOTH® GERMICIDAL WIPES GERMICIDAL DISPOSABLE CLOTH

[On front panel]

ACTIVE INGREDIENTS:

n-Alkyl (68% C ₁₂ , 32% C ₁₄) dimethyl ethylbenzyl ammonium chlorides.....	0.25%
n-Alkyl (60% C ₁₄ , 30% C ₁₆ , 5%C ₁₂ , 5%C ₁₈) dimethyl benzyl ammonium chlorides.....	0.25%
Isopropyl Alcohol.....	55.00%
OTHER INGREDIENTS:.....	44.50%
TOTAL	100.00%

[Does not include the weight of the [cloth] [towelette] [or] [wipe]]

KEEP OUT OF REACH OF CHILDREN [AND PETS] WARNING

See [back] [outer] [carton] [side] [container[s]] [inside] [panel] for additional precautionary statements
[For packet use: See outer container for additional precautionary statements]

[CONTAINS:] [or Net Contents] [and/or Net Wt.] ____oz. (g) [or lb[s.] (kg)] [or lb[s.] oz. (g)]
____ [# OF CLOTHS][PREMOISTENED][WET]WIPES [SIZE of each cloth is optional]

[On any panel]

EPA Reg. No.: 9480-4

EPA Est. No.: 9480-NY-1 [or others]

or

EPA Est. No.: A=9480-NY-1, C=72956-AR-1 [or others]

Alpha character will precede batch code on product [OR Beginning of batch code indicates Est. No.]

[Manufactured by [or for]:]

Professional Disposables International, Inc.

400 Chestnut Ridge Road, Woodcliff Lake, NJ 07677 [USA]

[For information call:] [phone number to be inserted]

[Made in [USA] [of] [with] [domestic and [foreign] [imported] materials] [insert country]]

THE INFORMATION IN BOX IS NOT PART OF THE LABELING

[] - Statements in brackets are optional or instructional. Italicized words in brackets are instructional.

A footnote can be used to list organisms. Bacteria and virus can be separated into footnotes 1 and 2 if desired.

When organisms are listed next to a claim, the organisms may be listed in a footnote instead of directly next to the claim

Sequence and placement of phrases is optional unless specified in 40 CFR 156.10.

Capitalization, plurals or singular, bold and italics are all variable unless specified in 40 CFR

The terms "Wipe(s)", "Towel(s)", "Towelette(s)" and "Cloth(s)" can be used Interchangeably throughout except for the product primary brand name
which can be only changed by notification or amendment.

The word "and" and symbol "&" can be used interchangeably

All directions may be written in numbered form or in paragraph form

Graphics, symbols, and logos may vary in color.

All use surfaces and/or use sites on the label may be used in conjunction with an image of the use surface and/or use site.

April 30, 2024

PRECAUTIONARY STATEMENTS:**Hazards to humans and domestic animals.**

WARNING: Causes substantial but temporary eye damage. Do not get in eyes or on clothing. Avoid contact with skin. Wash hands thoroughly with soap and water after handling and before eating, drinking, chewing gum, using tobacco, or using [the] toilet [or restroom]. Remove and wash contaminated clothing before reuse.

PHYSICAL OR CHEMICAL HAZARD[S]:

Combustible. Do not use or store near heat or open flame.

FIRST AID:

If in eye[s]: Hold eye[s] open, rinse slowly and gently with water for 15-20 minutes. Remove contact lenses, if present, after the first 5 minutes, then continue rinsing eye[s]. **If on skin:** Take off contaminated clothing. Rinse skin immediately with plenty of water for 15-20 minutes.

Call [or Contact] a Poison Control Center or doctor [or healthcare professional] for treatment advice. Have the product container or label with you when calling [or contacting] a Poison Control Center or doctor [or healthcare professional] or going for treatment. For additional information or in case of emergency call [or contact] the Poison Control Center toll free at 1-800-222-1222.

DIRECTIONS FOR USE: It is a violation of Federal law to use this product in a manner inconsistent with its labeling.[See directions for use on the container[s] inside.] [*For packet use:* See directions for use on the outer container.] [*For canister with peel back labels:* Peel [back] for additional labeling *OR* Peel [back] label for additional information.] [Consult [equipment] manufacturer's instructions prior to use.] [[For surfaces,] Test wipe on small inconspicuous area before use.] Do not use on natural marble, unpainted wood or colored grout.

[Dispensing directions]

[Use one of the following as applicable to type of container:]

[GENERIC]

TO DISPENSE [TOWELETTES] [or WIPES] [or TOWELS] [or CLOTHS]: Open lid. Pull out wipe. Close lid tightly.

THE INFORMATION IN BOX IS NOT PART OF THE LABELING

[] - Statements in brackets are optional or instructional. Italicized words in brackets are instructional. A footnote can be used to list organisms. Bacteria and virus can be separated into footnotes 1 and 2 if desired.

When organisms are listed next to a claim, the organisms may be listed in a footnote instead of directly next to the claim

Sequence and placement of phrases is optional unless specified in 40 CFR 156.10.

Capitalization, plurals or singular, bold and italics are all variable unless specified in 40 CFR

The terms "Wipe(s)", "Towel(s)", "Towelette(s)" and "Cloth(s)" can be used interchangeably throughout except for the product primary brand name which can be only changed by notification or amendment.

The word "and" and symbol "&" can be used interchangeably

All directions may be written in numbered form or in paragraph form

Graphics, symbols, and logos may vary in color.

All use surfaces and/or use sites on the label may be used in conjunction with an image of the use surface and/or use site.

April 30, 2024

[Canister]

TO DISPENSE [TOWELETTES] [or WIPES] [or TOWELS] [or CLOTHS]:

Remove lid [.] [and discard inner seal] [from container *or* canister.] Find center of wipe roll, remove first wipe for use, twist corner of next wipe into a point and thread through the hole in the [container *or* canister] lid. Pull through about one inch. Replace lid. Dispense remaining wipes as necessary by pulling out at an angle. When not in use keep [center cap of] lid closed to prevent moisture loss.

[Canister Lid with two openings]

TO DISPENSE [TOWELETTES] [or WIPES] [or TOWELS] [or CLOTHS]: Remove lid [.] [and discard inner seal] [from container *or* canister.] Find center of wipe roll, remove first wipe for use, thread next wipe through the hole in the [container *or* canister] lid. Pull through at least one inch. Replace lid. To secure wipe, pull wipe down into small opening. Dispense single wipes as necessary by pulling out at an angle through the small opening. Dispense multiple wipes as necessary by pulling vertically through the large opening. Pull down into small opening to tear. When not in use keep [center cap of] lid closed to prevent moisture loss.

[SlimPack/TrimPack/JetPack]

TO DISPENSE [TOWELETTES] [or WIPES] [or TOWELS] [or CLOTHS]: Open package lid. Completely remove inner seal. Find center of wipe roll, remove first wipe for use, thread next wipe through the hole in the container [or canister *or*] packaging] lid. To secure wipe, pull wipe down into small opening. Dispense single wipes as necessary by pulling out at an angle through the small opening. Dispense multiple wipes as necessary by pulling vertically through the large opening. Pull down into small opening to tear. Snap lid closed after use to retain moisture.

[Travel pack]

TO DISPENSE [TOWELETTES] [or WIPES] [or TOWELS] [or CLOTHS]: Peel back label slowly. Pull out wipes as needed and reseal label. Unfold wipe.

[Box]

Open along perforations as indicated. Remove packets as needed.

[Packet or Package]

TO DISPENSE [TOWELETTES] [or WIPES] [or TOWELS] [or CLOTHS]: Tear open packet [or package]. Unfold wipe and use as directed. Discard after single use.

[For use on small single packets only: [Not labeled for individual sale [or distribution] [See dispenser [or container *or* box *or* case *or* outer packaging] for [additional *or* full label] information].

THE INFORMATION IN BOX IS NOT PART OF THE LABELING

[] - Statements in brackets are optional or instructional. Italicized words in brackets are instructional. A footnote can be used to list organisms. Bacteria and virus can be separated into footnotes 1 and 2 if desired.

When organisms are listed next to a claim, the organisms may be listed in a footnote instead of directly next to the claim

Sequence and placement of phrases is optional unless specified in 40 CFR 156.10.

Capitalization, plurals or singular, bold and italics are all variable unless specified in 40 CFR

The terms "Wipe(s)", "Towel(s)", "Towelette(s)" and "Cloth(s)" can be used interchangeably throughout except for the product primary brand name which can be only changed by notification or amendment.

The word "and" and symbol "&" can be used interchangeably

All directions may be written in numbered form or in paragraph form

Graphics, symbols, and logos may vary in color.

All use surfaces and/or use sites on the label may be used in conjunction with an image of the use surface and/or use site.

April 30, 2024

Soft pack/Flow pack/Ecopak/Portable pack]

TO DISPENSE [TOWELETTES] [or WIPES] [or TOWELS] [or CLOTHS]: Open package lid. [Completely remove inner seal.] [or Press and peel back.] Pull out wipe. [(The next wipe pops up automatically.)] Snap lid closed after use to retain moisture.

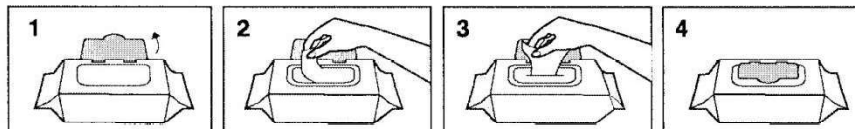

[Bulk Pack/Bulk Flex Pack/ Bulk Eco Pak]

TO DISPENSE [TOWELETTES] [or WIPES] [or TOWELS] [or CLOTHS]: Open package lid. Push down around [the] ring area to break the seal and then pull on [the] ring to completely remove inner seal. Align [the] opening in the lid to the center of the wipe roll, remove first wipe for use, then thread next wipe through the hole in the packaging lid. To secure wipe, pull wipe down into small opening. Dispense single wipes as necessary by pulling out at an angle through the small opening. Dispense multiple wipes as necessary by pulling through the large opening. Pull down into small opening to tear. Snap lid closed after use to retain moisture.

[Pail & Refill Packaging]

REFILL [PACKET] [or PACKAGE] [or POUCH] [or CANISTER][or BUCKET][or PAIL][or DISPENSER]:

This refill package is made for use only in a [product name] container [or canister or bucket or pail or dispenser]; do not use this product in a container [or canister or bucket or pail or dispenser] for another product. Do not use the refill wipes in a container [or canister or bucket or pail or dispenser] that is cracked or broken. Discard the cracked or broken container [or canister or bucket or pail or dispenser] in accordance with the container [or canister or bucket or pail or dispenser] disposal instructions on the label.

[Option 1]

TO DISPENSE [TOWELETTES] [or WIPES] [or TOWELS] [or CLOTHS]: Remove [entire] lid from container [or canister or bucket or pail or dispenser]. Tear open refill packet [or package] [or pouch] at notch [or mark] [or arrow] and place [wipe] roll in empty container [or canister or bucket or pail or dispenser]. Follow information on container [or canister or bucket or pail or dispenser] to dispense wipes.

[Option 2]

TO DISPENSE [TOWELETTES] [or WIPES] [or TOWELS] [or CLOTHS]: Remove [entire] lid from container [or canister or bucket or pail or dispenser]. Tear open refill packet [or package] [or pouch] at notch [or mark] [or arrow]. Place [entire] refill packet [or package] [or pouch] of wipes in empty container [or canister or bucket or pail or dispenser]. Follow information on container [or canister or bucket or pail or dispenser] to dispense wipes.

THE INFORMATION IN BOX IS NOT PART OF THE LABELING

[] - Statements in brackets are optional or instructional. Italicized words in brackets are not included. Italicized words in brackets are instructional.

A footnote can be used to list organisms. Bacteria and virus can be separated into footnotes 1 and 2 if desired.

When organisms are listed next to a claim, the organisms may be listed in a footnote instead of directly next to the claim

Sequence and placement of phrases is optional unless specified in 40 CFR 156.10.

Capitalization, plurals or singular, bold and italics are all variable unless specified in 40 CFR

The terms "Wipe(s)", "Towel(s)", "Towelette(s)" and "Cloth(s)" can be used interchangeably throughout except for the product primary brand name which can be only changed by notification or amendment.

The word "and" and symbol "&" can be used interchangeably

All directions may be written in numbered form or in paragraph form

Graphics, symbols, and logos may vary in color.

All use surfaces and/or use sites on the label may be used in conjunction with an image of the use surface and/or use site.

April 30, 2024

CONTAINER [or CANISTER or BUCKET or PAIL or DISPENSER] [numbers optional]

TO DISPENSE [TOWELETTES] [or WIPE(S)] [or TOWELS] [or CLOTH(S)]:

1. Remove [the] lid from [the] [pail or bucket or container or canister or dispenser].
2. [Press] open [the] [dispenser at center of [the] lid].
3. Open [the] refill [packet] [package] [pouch] then place in [pail or bucket or container or canister or dispenser].
4. Locate [the] first wipe at [the] center of [the] roll.
5. Feed [the] first wipe through [the] dispensing orifice.
6. Reapply [the] lid to [the] [pail or bucket or container or canister or dispenser].
7. Dispense [the] wipe.

FOR THE REFILL[S] [PACKET] [PACKAGE] [POUCH] [CANISTER][BUCKET][PAIL] DISPENSER]:

1. Remove [the] lid from [the] [pail or bucket or container or canister or dispenser].
2. Remove [the] empty refill [packet] [package] [pouch] material from [the] [pail or bucket or container or canister or dispenser].
3. [Press] open [the] [dispenser at center of [the] lid].
4. Open [the] refill [packet] [package] [pouch] then place in [pail or bucket or container or canister or dispenser].
5. Locate [the] first wipe at [the] center of [the] roll.
6. Feed [the] first wipe through [the] dispensing orifice.
7. Reapply [the] lid to [the] [pail or bucket or container or canister or dispenser].
8. Dispense [the] wipe.

The following statement may be added to the inner seals or perforation of packaging formats containing inner seals or perforation: REMOVE COMPLETELY

THE INFORMATION IN BOX IS NOT PART OF THE LABELING

[] - Statements in brackets are optional or instructional. Italicized words in brackets are instructional. A footnote can be used to list organisms. Bacteria and virus can be separated into footnotes 1 and 2 if desired.

When organisms are listed next to a claim, the organisms may be listed in a footnote instead of directly next to the claim

Sequence and placement of phrases is optional unless specified in 40 CFR 156.10.

Capitalization, plurals or singular, bold and italics are all variable unless specified in 40 CFR

The terms "Wipe(s)", "Towel(s)", "Towelette(s)" and "Cloth(s)" can be used interchangeably throughout except for the product primary brand name which can be only changed by notification or amendment.

The word "and" and symbol "&" can be used interchangeably

All directions may be written in numbered form or in paragraph form

Graphics, symbols, and logos may vary in color.

All use surfaces and/or use sites on the label may be used in conjunction with an image of the use surface and/or use site.

April 30, 2024

[Disinfection directions]

TO [CLEAN] [AND] [,] DISINFECT [AND DEODORIZE] HARD, NONPOROUS SURFACES: If present, use a wipe to remove visible soil prior to disinfecting. Unfold [a] [clean] wipe and thoroughly wet surface. Allow surface to remain visibly wet for contact time(s) listed on the label [OR for two (2) minute[s]]. Use additional [or enough] wipe(s) [, if needed,] to ensure [continuous] visibly wet contact time(s) listed on the label. [or two (2) minute[s] visibly wet contact time.] [or Repeated use of the product may be required to ensure that the surface remains visibly wet for contact time(s) listed on the label [or for two (2) minute[s]]. Let air dry. A potable water rinse is required for food contact surfaces. *[If label includes cleaning claims for grease, soap scum, grime, dirt, messes, soil, add the following as the first sentence: A precleaning step is required for [grease] [,] [soap scum] [,] [grime] [,] [dirt] [,] [messes] [,] visible soil.]*

[The following sets of directions are optional and for hospital/medical facility use only:]

[The following instructions are to be included on production labels when claims against HIV, and/or HBV and/or HCV are listed; one, two or all three of the viruses may be included on claims and directions in production labels.]

†KILLS HIV-1 (AIDS VIRUS), HEPATITIS B VIRUS (HBV) AND HEPATITIS C VIRUS (HCV) ON THE PRECLEANED ENVIRONMENTAL SURFACES/OBJECTS [AND PRECLEANED EXTERNAL SURFACES OF ULTRASOUND TRANSDUCERS[,] SCOPES [OR] [AND] PROBE[S]] PREVIOUSLY SOILED WITH BLOOD/ BODILY FLUIDS at room temperature (68°- 77°F) *or* (20°- 25°C) in healthcare or other settings in which there is an expected likelihood of soiling of inanimate surfaces/objects with blood or bodily fluids, and in which the surfaces/objects likely to be soiled with bodily fluids can be associated with the potential for transmission of Human Immunodeficiency Virus Type 1 (HIV-1) (associated with AIDS), Hepatitis B Virus (HBV) and Hepatitis C Virus (HCV).

†SPECIAL INSTRUCTIONS FOR CLEANING AND DECONTAMINATION AGAINST HIV-1, HEPATITIS B VIRUS (HBV) AND HEPATITIS C VIRUS (HCV) ON SURFACES/OBJECTS SOILED WITH BLOOD/BODILY FLUIDS:

Personal protection: When handling HIV-1 (AIDS Virus), HBV or HCV infected blood or bodily fluids; wear disposable protective gloves, protective gowns, masks and eye coverings[,] [per facility protocol].

Cleaning procedure: All blood and other bodily fluids must be thoroughly cleaned from surfaces and objects before disinfection by the [germicidal] wipe.

Disposal of infectious materials: Used wipe that may be contaminated with blood and other bodily fluids should be disposed of according to local regulation for infectious waste disposal.

Contact time: Use [germicidal] wipe to thoroughly wet surface. Allow surface to remain visibly wet [for] two (2) minutes. Use additional [or enough] wipe(s) [, if needed,] to ensure [continuous] two (2) minute[s] visibly wet contact time. [or Repeated use of the product may be required to ensure that the surface remains visibly wet for two (2) minute[s]]. Let air dry.

THE INFORMATION IN BOX IS NOT PART OF THE LABELING

[] - Statements in brackets are optional or instructional. Italicized words in brackets are not included. Italicized words in brackets are instructional.

A footnote can be used to list organisms. Bacteria and virus can be separated into footnotes 1 and 2 if desired.

When organisms are listed next to a claim, the organisms may be listed in a footnote instead of directly next to the claim

Sequence and placement of phrases is optional unless specified in 40 CFR 156.10.

Capitalization, plurals or singular, bold and italics are all variable unless specified in 40 CFR

The terms "Wipe(s)", "Towel(s)", "Towelette(s)" and "Cloth(s)" can be used Interchangeably throughout except for the product primary brand name which can be only changed by notification or amendment.

The word "and" and symbol "&" can be used interchangeably

All directions may be written in numbered form or in paragraph form

Graphics, symbols, and logos may vary in color.

All use surfaces and/or use sites on the label may be used in conjunction with an image of the use surface and/or use site.

April 30, 2024

[The following instructions are to be included on production labels when claims against C.auris is listed.]

Special Instructions for cleaning prior to disinfection against *Candida auris*:

Personal protection: Wear appropriate barrier protection such as gloves, gowns, masks, and eye coverings [per facility protocol].

Cleaning procedure: Fecal matter/waste must be thoroughly cleaned from surfaces/objects before disinfection by application with [product name] [this product]. Precleaning is to include vigorous wiping and/or scrubbing and all visible soil is removed. Surfaces in patient rooms are to be cleaned in an appropriate manner, such as from right to left or left to right, on horizontal surfaces, and top to bottom, on vertical surfaces, to minimize spreading the organism. Restrooms are to be cleaned last. Do not reuse soiled cloths.

Infectious waste disposal: Materials used in the cleaning process that may contain feces/wastes are to be disposed of immediately in accordance with local regulations for infectious materials disposal.

Contact time: Use [germicidal] wipe to thoroughly wet surface. Allow surface to remain visibly wet for two (2) minutes. Use additional [or enough] wipe(s) [if needed,] to ensure [continuous] two (2) minute visibly wet contact time. [or Repeated use of the product may be required to ensure that the surface remains visibly wet for two (2) minutes.] Let air dry.

[The following sets of directions are optional]

ULTRASOUND TRANSDUCERS, SCOPES [AND][OR] PROBES: For use on external surfaces of ultrasound transducers, scopes [and][or] probes only prior to high-level disinfection [(HLD)].

To disinfect [and decontaminate] prior to high-level disinfection [or HLD]: [Pre]clean gel from external surface of ultrasound transducer, scope[and] [or] probe by using a clean washcloth or [germicidal] wipe. Then, follow instructions to disinfect.

THE INFORMATION IN BOX IS NOT PART OF THE LABELING

[] - Statements in brackets are optional or instructional. Italicized words in brackets are instructional. A footnote can be used to list organisms. Bacteria and virus can be separated into footnotes 1 and 2 if desired.

When organisms are listed next to a claim, the organisms may be listed in a footnote instead of directly next to the claim

Sequence and placement of phrases is optional unless specified in 40 CFR 156.10.

Capitalization, plurals or singular, bold and italics are all variable unless specified in 40 CFR

The terms "Wipe(s)", "Towel(s)", "Towelette(s)" and "Cloth(s)" can be used Interchangeably throughout except for the product primary brand name which can be only changed by notification or amendment.

The word "and" and symbol "&" can be used interchangeably

All directions may be written in numbered form or in paragraph form

Graphics, symbols, and logos may vary in color.

All use surfaces and/or use sites on the label may be used in conjunction with an image of the use surface and/or use site.

April 30, 2024

STORAGE AND DISPOSAL:

Do not contaminate water, food, or feed by storage and disposal. *[Statement not required for residential or household use products.]*

[Use storage/disposal statement A if canister, tub, bucket, pail or refill dispenser directions used. Use storage/disposal statement B if travel pack, Soft pack/Flow pack/Ecopak/Portable pack, pouch, Bulk Pack/Bulk Flex Pack/ Bulk Eco Pak or [refill] [packet/package] directions used.]

[Statement A:]

Storage: Do not store near heat or open flame. When not in use keep [center cap of] lid closed to prevent moisture loss. **Towelette Disposal:** Do not reuse towelette. Dispose of used towelette in trash. Do not flush in toilet. **Canister [or Container or Bucket or Pail or Dispenser] Handling:** Nonrefillable canister [or container or bucket or pail or dispenser]. Do not reuse or refill this canister [or container or bucket or pail or dispenser]. Offer for recycling. If recycling is not available, put in trash collection.

[If refillable dispenser is being used, substitute the following: Refill Package [or Canister or Container or Bucket or Pail or Dispenser] Handling : Offer for recycling. If recycling is not available, discard in trash [collection].]

[Statement B:]

Storage: Do not store near heat or open flame. **Towelette Disposal:** Do not reuse towelette. Dispose of used towelette in trash. Do not flush in toilet. **Packet [or Package or Pouch or Container or Dispenser] Handling:** Put empty travel pack [or Portable Pack or Soft Pack or Flow Pack or Ecopak or Bulk pack or [refill] packet or packaging or pouch]] in trash [collection].

THE INFORMATION IN BOX IS NOT PART OF THE LABELING

[] - Statements in brackets are optional or instructional. Italicized words in brackets are instructional. A footnote can be used to list organisms. Bacteria and virus can be separated into footnotes 1 and 2 if desired.

When organisms are listed next to a claim, the organisms may be listed in a footnote instead of directly next to the claim

Sequence and placement of phrases is optional unless specified in 40 CFR 156.10.

Capitalization, plurals or singular, bold and italics are all variable unless specified in 40 CFR

The terms "Wipe(s)", "Towel(s)", "Towelette(s)" and "Cloth(s)" can be used Interchangeably throughout except for the product primary brand name which can be only changed by notification or amendment.

The word "and" and symbol "&" can be used interchangeably

All directions may be written in numbered form or in paragraph form

Graphics, symbols, and logos may vary in color.

All use surfaces and/or use sites on the label may be used in conjunction with an image of the use surface and/or use site.

April 30, 2024

[Optional Use Sites]

Table 1: Hard, nonporous use sites/surfaces

[Areas of Use] [Hospital and Healthcare Settings] [May be used on hard, nonporous surfaces in [or of]] [or For use on hard, nonporous surfaces of [or in]] [Optional Use Sites] [:] [For complete list, see EPA Master Label]

<ul style="list-style-type: none"> • Administrative desk[s] [or area[s]] • Activity room[s] [or area[s]] • Airplanes • Airports • Ambulance equipment surfaces • Ambulance[s] • Ambulatory Surgical Centers (ASC) • Amalgamators • Anesthesia administration sites • Anesthesia machines • Animal [care facilities][holding or grooming areas][hospitals][life science lab[oratories][s]] • [Animal] kennels • Apheresis machines • Assisted Living Facilities • Athletic facilities • Automobile[s] [or Car] [interiors][exteriors] • ATM[s][or Card readers][machines] • Barbershops • Barbells • Bariatric chambers • Basins • Basements • Bassinets • Bathroom fixtures • Bathroom [surface][s] • [Bath]tubs • Beauty salons • Bed rail[s] [or railing[s]] • Bedside furniture [or table[s]] • Bladder scans • Boats • Blood glucose meters • Blood pressure [cuffs][monitors] • Booster seats • Bowling alleys • Breath apparatus [full face] • Business and Industry [B&I] • Business [offices][buildings] • Breakroom[s] • Cabinet [knob][s] • Call button[s] • Camper vehicles • Campground [facilities][areas] • Cardiac gym equipment 	<ul style="list-style-type: none"> • Cardiac monitors • Cardiology facilities [or clinics[s]] • Cargo vessels • Carts • Cash registers • Casinos • CATH Labs • Chair[railing][armrest][s] • Chapel [and/or Spiritual care area[s]] • Child[or Nursery] seats • Children's furniture [or play area[s]] • Church[es] [offices] [buildings] • [Cell]phones • Central Supply [Rooms][Areas] • Classrooms • Clinics • Closets • College[s][facilities][dorms] • Computer[s][monitors][mouses] [keyboards] • Commercial establishments • [Common] Living [areas][rooms] • Computers On Wheels [or COW] • Consultation room[s] [or area[s]] • Correctional facilities • Corridor[s] • Counter[top][s] • Cribs • Critical Care Units [or CCU] • [Cruise] ships • CT scanner[s] • Daycare [Centers][settings][facilities] • Defibrillators • Delivery [or postal] trucks • Dental chairs • Dental countertops • Dental curing lights • Dental equipment • Dental [offices][clinics] • Dental operator surfaces • Dental [tools] [and] [unit][instrument trays] • [Dental] [Reception][Waiting] Area • Desk[top][s] • Diagnostic [and Imaging] area[s] • Diagnostic equipment 	<ul style="list-style-type: none"> • Dialysis Clinic[s] [or facility] [or facilities] [or machine[s]] [or chair[s]] • [Diaper]Changing [Tables][Stations] • Diaper pails • Display cabinets • Dining area[s] • Doctors' [or Physicians'] [Office[s]][Clinic[s]] • Donation Centers • [[blood][plasma][semen][milk][apheresis]] • Door[knob][handle][s] • Dopplers • Dressing rooms • Drug stores • Electronic thermometers • Elevator [button][s] • Emergency Medical Settings • Emergency Rooms [or E.R] • Emergency vehicles • Endodontic equipment [such as apex locators] • Entrance [and Exit] area[s] • Equine farms • Exam table[s] [or room[s]] [or area[s]] • Exercise facilities [or equipment] • Exterior surfaces of toilet[tank][s] • Exterior surfaces of urinals • Exterior surfaces of washers [and dryers] • Eye Surgical Centers • Face shields • Factories • Farms • Faucets • Fax machines • Filing cabinet[s] [doors][handles] • Firehouses • Fire trucks • First aid station[s] • Fitness [centers][studios] • [Finished][Sealed] • [Hardwood] Floors • Fixtures • Funeral homes • Garages • Garbage [or trash] cans • Gas station
---	---	---

THE INFORMATION IN BOX IS NOT PART OF THE LABELING

[] - Statements in brackets are optional or instructional. Italicized words in brackets are not included. Italicized words in brackets are instructional.

A footnote can be used to list organisms. Bacteria and virus can be separated into footnotes 1 and 2 if desired.

When organisms are listed next to a claim, the organisms may be listed in a footnote instead of directly next to the claim

Sequence and placement of phrases is optional unless specified in 40 CFR 156.10.

Capitalization, plurals or singular, bold and italics are all variable unless specified in 40 CFR

The terms "Wipe(s)", "Towel(s)", "Towelette(s)" and "Cloth(s)" can be used Interchangeably throughout except for the product primary brand name which can be only changed by notification or amendment.

The word "and" and symbol "&" can be used interchangeably

All directions may be written in numbered form or in paragraph form

Graphics, symbols, and logos may vary in color.

All use surfaces and/or use sites on the label may be used in conjunction with an image of the use surface and/or use site.

April 30, 2024

<ul style="list-style-type: none"> • Glazed tiled walls • Government facilities • Grocery cart child seats • Grocery cart [handle][s] • Grocery stores • Grooming establishments • Gurneys • Gyms [or Gymnasium] • Gym equipment • Hallway[s] • Hampers • Handheld scanners • Handles • Handrail[s] • Headsets • Healthcare facilities • Healthcare settings • Health club[s] [facilities] • Home Healthcare [Centers] • Home [residence][s] • Hospices • Hospitality • Hospitals • Hotels • Household[bathrooms] • Housekeeping area[s] • Imaging equipment • Indoors • Industrial [establishments][facilities] • Industry • Infant[or child]care equipment surfaces • Infant incubators • Infant warmers • In-patient[or Out-patient] facilities • In-store demos • Intensive Care Units [or ICU] • Isolation room[s] [or area[s]] • Isolettes • IV poles • IV pumps • Janitorial area[s] • Kennel[s] [or Animal holding area[s]] • Kiosks • Laboratory [equipment] [and] [surfaces] • Laborator[y][ies] • Laundromats • Laundry rooms • Lavatories • Lawn chair[s][furniture][vinyl or plastic] • [Lead] X-ray [shield][apron][jacket][s] • Libraries • [Life] science lab[orator][ies][y] • Livestock [or Swine] [or Poultry Facilities] • Light switch[es] 	<ul style="list-style-type: none"> • Light handle[s] • Locker room[s][facilities] • Long Term Care Centers[or Facilities] • Lounges • Loupes • Malls • Manufacturing [facilities][plants] • Massage parlors • Medical equipment [or cart[s]] • Medical Intensive Care Units [or MICU] • Medication cart[s] • Military [institutions][bases][camps] • Mortuaries • Motel[s][lodges][inns] • [Motor][Mobile]homes • Movie theaters • MRI machine[s] • Neonatal Intensive Care Units [or NICU] • Newborn nursery • Nurseries • Nurses' stations • Nursing [or monitoring] station[s] • Nursing homes • Nursing rooms [or areas] • Office equipment • Oncology Facilities [or clinic[s]] • Operatory surfaces • Operating Room[s] [or OR] • [Operating Room[s] [or OR]] Light handle[s] • Operating room [table[s] [and/or light[s]] • Operating theater • Operatory light switches • Ophthalmic Offices • Ophthalmoscopes • Orthopedic[s][Unit] • Oscopes • Out-Patient Surgical Centers [or OPSC] • Oxygen hoods • Patient [Care Area[s]] [or treatment area[s]] [or treatment room[s]] • Patient delivery equipment • Patient lift equipment • Patient monitoring equipment • Patient support equipment • Patient Room[s] [or area[s]] • Patios • Pediatric Intensive Care Units [or PICU] • Pediatrics Unit • Personal protective safety equipment • Pet [shops][areas] • Pharmaceutical production facilities • Pharmacies • Pharmacy [counter[s]] • Phone booths 	<ul style="list-style-type: none"> • Physical Therapy (PT) equipment surfaces • Physical Therapy [Unit][Center] [Area[s]] • Physician office[s] [or clinic[s]] • Play [areas][grounds][centers][rooms] • Police cars • Police stations • [Police][Fire][EMT][Emergency] [Ambulance] vehicles • POS systems [or tablets][or digital menu boards] • Post Anesthesia Care Unit [or PACU] • Post-Operative [Care Unit] [or area[s]] • Pre-Operative [Care Unit] [or area[s]] • Prisons • Procedure [area[s]] [or rooms] • Pulse oximeters • Public [or school] buses • Public [facilities][places][areas][centers] [establishments][booths] [transportations] • Public telephones • Pulp motors • Pulp testers • Radiology equipment • Radiology Unit • Railings • Recovery rooms • Reception area • Reception desk • Recreational [centers][vehicles] • Rehabilitation [Center][rooms][Unit][area] • Remote controls • Rental cars • Resident room[s] [or area[s]] • Respiratory therapy equipment • Respiratory Therapy [Unit][areas] • Resorts • Restaurants • Rest [rooms][stops] • Retail [stores][establishments] • RVs • Schools • Seats • Senior Living Facilities • Shelters • Shopping Centers • Shopping cart [handle][s] • Shower[&][bath][areas] • Shower[s] [stalls] • Skilled Nursing Facility[y][ies] • Slit lamps • [Small]Animal facilities • Spas • Specialty clinic[s]
---	---	--

THE INFORMATION IN BOX IS NOT PART OF THE LABELING

[] - Statements in brackets are optional or instructional. Italicized words in brackets are not included. Italicized words in brackets are instructional. A footnote can be used to list organisms. Bacteria and virus can be separated into footnotes 1 and 2 if desired.

When organisms are listed next to a claim, the organisms may be listed in a footnote instead of directly next to the claim

Sequence and placement of phrases is optional unless specified in 40 CFR 156.10.

Capitalization, plurals or singular, bold and italics are all variable unless specified in 40 CFR

The terms "Wipe(s)", "Towel(s)", "Towelette(s)" and "Cloth(s)" can be used interchangeably throughout except for the product primary brand name which can be only changed by notification or amendment.

The word "and" and symbol "&" can be used interchangeably

All directions may be written in numbered form or in paragraph form

Graphics, symbols, and logos may vary in color.

All use surfaces and/or use sites on the label may be used in conjunction with an image of the use surface and/or use site.

April 30, 2024

<ul style="list-style-type: none"> • Specialized medical equipment • Spine back boards • [Sporting][Concert][Event] Venues • Stadiums • Staff breakroom[s] [or area[s]] [or station[s]] [or office[s]] [or lounge] • Sterile Processing Areas • Stethoscopes • Sterile Processing Areas • Stethoscopes • Stools • Storage [area[s]] [or room[s]] • Stretchers • Subways • Supermarkets • Surgery areas • Surgery Intensive Care Unit [or SICU] • Surgical Center[s] [or table[s]] • Sinks • Table[top]s • Tack shops • Taxis • Telemetry equipment • [Tele]phones • Therapy room[s] [or area[s]] • Therapy equipment • Toilet seats • Toilet rims [or handles] • Toys • Trailers • Trains • Transportation [centers][terminals] • Transport[ation] vehicles • Treatment table[s] [and or chair[s]] • Triage room[s]] [or area[s]] • Tympanic thermometers • Ultrasound monitors • Ultrasound probes • Ultrasound transducers • Universities • Urgent Care Center[s] • Ultrasound equipment • Vehicle surfaces [including: [hard plastic][metal flooring][steering wheels][seats][walls] • Vanity tops • Vending Machine[s] • Veterinary [offices][hospitals][clinics][facilities] • Waiting [Room[s]][or area[s]][or room chairs] 	<ul style="list-style-type: none"> • Warehouse[club][s] • Walker[s] • Weight-lifting surfaces • Wellness centers • Wheelchair[s] • Workstations • Workstations On Wheels (WOW) • X-Ray [equipment][or machine[s]][or surfaces] 	
---	--	--

THE INFORMATION IN BOX IS NOT PART OF THE LABELING

[] - Statements in brackets are optional or instructional. Italicized words in brackets are instructional. A footnote can be used to list organisms. Bacteria and virus can be separated into footnotes 1 and 2 if desired.

When organisms are listed next to a claim, the organisms may be listed in a footnote instead of directly next to the claim

Sequence and placement of phrases is optional unless specified in 40 CFR 156.10.

Capitalization, plurals or singular, bold and italics are all variable unless specified in 40 CFR

The terms "Wipe(s)", "Towel(s)", "Towelette(s)" and "Cloth(s)" can be used Interchangeably throughout except for the product primary brand name which can be only changed by notification or amendment.

The word "and" and symbol "&" can be used interchangeably

All directions may be written in numbered form or in paragraph form

Graphics, symbols, and logos may vary in color.

All use surfaces and/or use sites on the label may be used in conjunction with an image of the use surface and/or use site.

April 30, 2024

[Terminal Sterilant Disclaimer per PR Notice 94-4]

[The following paragraph must be used if hospital and healthcare use sites are on the label.]

This product is not to be used as a terminal sterilant/high level disinfectant on any surface or instrument that (1) is introduced directly into the human body, either into or in contact with the bloodstream or normally sterile areas of the body, or (2) contacts intact mucous membranes but which does not ordinarily penetrate the blood barrier or otherwise enter normally sterile areas of the body. This product may be used to preclean or decontaminate critical or semi-critical medical devices prior to [sterilization] [or] [high level disinfection][or HLD].

Table 2: Surface Materials

[For use on the following [:] [types of surfaces:]]

<ul style="list-style-type: none">• ABS plastic• Acrylic• Aluminum• Aluminum silicate• Brass• Chrome• Copper• Corian® Y• Crystal• Fiberglass• Finished-and/or-painted wood• Finished woodwork• Formica® YY• Galvanized metal• Galvanized steel• Glazed ceramic[tile]• Glazed enamel [tile]• Glazed porcelain [tile]• Glazed tile• Glass• High Density Polyethylene (HDPE)• Laminate• Laminated surfaces• Laminated wood	<ul style="list-style-type: none">• Linoleum• Marble• Marlite• Metal• Mirrors• Nickel• Painted wallboard• PEX (cross linked polyethylene)• Plastic laminate• Plastic• Plexiglas® YY• Polyester• Porcelain• Polybutylene Terephthalate (PBT)• Polycarbonate• Polypropylene• Polystyrene• Polyurethane• PVC• Quartz• Rubber• Sealed cement	<ul style="list-style-type: none">• Sealed fiberglass• Sealed [or Glazed] porcelain• Sealed granite• Sealed grout• Sealed limestone• Sealed [synthetic] marble• Sealed [or finished] hardwood [floors]• Sealed slate• Sealed stone• Sealed terra cotta• Sealed terrazzo• Sealed wood• [Stainless] Steel• Treated wood surfaces• Titanium• Titanium-coated [and/or] [medical grade] stainless steel• Vinyl• Zinc
--	---	--

THE INFORMATION IN BOX IS NOT PART OF THE LABELING

[] - Statements in brackets are optional or instructional. Italicized words in brackets are not included. Italicized words in brackets are instructional.

A footnote can be used to list organisms. Bacteria and virus can be separated into footnotes 1 and 2 if desired.

When organisms are listed next to a claim, the organisms may be listed in a footnote instead of directly next to the claim

Sequence and placement of phrases is optional unless specified in 40 CFR 156.10.

Capitalization, plurals or singular, bold and italics are all variable unless specified in 40 CFR

The terms "Wipe(s)", "Towel(s)", "Towelette(s)" and "Cloth(s)" can be used Interchangeably throughout except for the product primary brand name which can be only changed by notification or amendment.

The word "and" and symbol "&" can be used interchangeably

All directions may be written in numbered form or in paragraph form

Graphics, symbols, and logos may vary in color.

All use surfaces and/or use sites on the label may be used in conjunction with an image of the use surface and/or use site.

April 30, 2024

[Symbols including asterisks, bullets or footnotes and similar may be used to designate categories of organisms.]
[ATCC numbers are not required to be listed on production label. Organisms may be listed in a table and in any order.]

Table 3: List of Disinfection Organisms
Disinfection

Contact Time	Microorganisms	Identification Number	Antibiotic Resistance demonstrated
2 Min[ute[s]]	Multi-Drug Resistant Bacteria		
	<i>Acinetobacter baumannii</i>	[ATCC 19606]	
	<i>Enterobacter cloacae</i> NDM-1 positive	[CDC 1000654]	
	ESBL Producing <i>Escherichia coli</i> (<i>E.coli</i>)	[ATCC BAA-196]	
	<i>Klebsiella pneumoniae</i> – KPC-2 positive, ST258 (Multi-drug and Carbapenem resistant)	[CDC 2008030]	[Effect against organism resistant to Ertapenem, Ampicillin, Ampicillin/Sulbactam, Cefazolin, Cefepime, Ceftazidime, Ceftriaxone, Ciprofloxacin, Gentamicin, Imipenem, Levofloxacin, Piperacillin/Tazo, Tobramycin, Trimethoprim/Sulfa Meropenem and Intermediate resistant to Amikacin]
	Methicillin Resistant <i>Staphylococcus aureus</i> (MRSA)	[ATCC 33592]	
	Vancomycin Resistant <i>Enterococcus faecalis</i> (VRE)	[ATCC 51299]	
	Bacteria		
	<i>Bordetella pertussis</i>	[ATCC 12743]	
	<i>Burkholderia cepacia</i>	[ATCC 25416]	
	<i>Campylobacter jejuni</i>	[ATCC 29428]	
	<i>Escherichia coli</i> (<i>E. coli</i>)	[ATCC 11229]	
	<i>Escherichia coli</i> O157:H7	[ATCC 35150]	
	<i>Klebsiella pneumoniae</i>	[ATCC 4352]	
	<i>Pseudomonas aeruginosa</i>	[ATCC 15442]	
	<i>Salmonella enterica</i>	[ATCC 10708]	
	<i>Staphylococcus aureus</i>	[ATCC 6538]	
	Bloodborne Pathogens		
	*Hepatitis B Virus (HBV) - Duck HBV [†] [Strain 7/31/07]		
	*Hepatitis C Virus (Human) (HCV) – Bovine Diarrhea Virus [†] [Strain Oregon C24v-genotype 1]		
	*HIV-1 (AIDS virus) [†] [Strain HTLV-III _B]		
	Non-Enveloped Viruses*		
	*Adenovirus Type 5	[ATCC VR-5]	
	*Rhinovirus	[ATCC VR-1110]	
	*Rotavirus [Strain WA]		
	*Feline Calicivirus (Surrogate for Human Norovirus) [Strain:] F9]	[ATCC VR-782]	
	Enveloped Viruses*		
	*Herpes Simplex Virus type 2	[ATCC VR-734]	
	*Human Coronavirus [Strain 229E]	[ATCC VR-740]	
	*Influenza A Virus H3N2 Strain	[ATCC VR-544]	
	*Influenza A (H1N1) Virus [Strain A/Malaya/302/54]	[ATCC VR-98]	
	*Respiratory Syncytial Virus [(RSV)]		
	*Vaccinia Virus	[ATCC VR-1354]	
	*Measles Virus [Strain:] Edmonston]	[ATCC VR-24]	
	Pathogenic Fungi		
	<i>Candida albicans</i>	[ATCC 14053]	
	<i>Candida auris</i>	[AR-BANK #0381] [from CDC]	
	<i>Trichophyton interdigitale</i>	[ATCC 9533]	

THE INFORMATION IN BOX IS NOT PART OF THE LABELING

[] - Statements in brackets are optional or instructional. Italicized words in brackets are not included. Italicized words in brackets are instructional. A footnote can be used to list organisms. Bacteria and virus can be separated into footnotes 1 and 2 if desired.
When organisms are listed next to a claim, the organisms may be listed in a footnote instead of directly next to the claim
Sequence and placement of phrases is optional unless specified in 40 CFR 156.10.
Capitalization, plurals or singular, bold and italics are all variable unless specified in 40 CFR
The terms "Wipe(s)", "Towel(s)", "Towelette(s)" and "Cloth(s)" can be used interchangeably throughout except for the product primary brand name which can be only changed by notification or amendment.
The word "and" and symbol "&" can be used interchangeably
All directions may be written in numbered form or in paragraph form
Graphics, symbols, and logos may vary in color.
All use surfaces and/or use sites on the label may be used in conjunction with an image of the use surface and/or use site.

April 30, 2024

1min[ute]	Enveloped Viruses*		
	*Severe Acute Respiratory Syndrome-Related Coronavirus 2 (SARS-CoV-2) [(COVID-19 Virus)] [USA-WA1/2020]	[BEI Resources, NR-52281]	
	Mycobacterium (TB) [Tuberculocidal]		
	<i>Mycobacterium bovis</i> BCG (TB) [(Tuberculosis)] (68°F or 20°C)	[ATCC 35743]	

THE INFORMATION IN BOX IS NOT PART OF THE LABELING

[] - Statements in brackets are optional or instructional. Italicized words in brackets are instructional. A footnote can be used to list organisms. Bacteria and virus can be separated into footnotes 1 and 2 if desired. When organisms are listed next to a claim, the organisms may be listed in a footnote instead of directly next to the claim. Sequence and placement of phrases is optional unless specified in 40 CFR 156.10. Capitalization, plurals or singular, bold and italics are all variable unless specified in 40 CFR. The terms "Wipe(s)", "Towel(s)", "Towelette(s)" and "Cloth(s)" can be used interchangeably throughout except for the product primary brand name which can be only changed by notification or amendment. The word "and" and symbol "&" can be used interchangeably. All directions may be written in numbered form or in paragraph form. Graphics, symbols, and logos may vary in color. All use surfaces and/or use sites on the label may be used in conjunction with an image of the use surface and/or use site.

April 30, 2024

[Note: The following Emerging Viral Pathogen claims will not appear on product labels]

Emerging Viral Pathogen Claims

This product qualifies for emerging viral pathogen claims per the EPA's 'Guidance to Registrants: Process for Making Claims Against Emerging Viral Pathogens not on EPA-Registered Disinfectant Labels' when used in accordance with the appropriate use directions indicated below.

This product meets the criteria to make claims against certain emerging viral pathogens from the following viral category[ies]:

- Enveloped Viruses
- Large, Non-Enveloped Viruses
- Small, Non-Enveloped Viruses

<i>For an emerging viral pathogen that is a/an...</i>	<i>...follow the directions for use for the following organisms on the label:</i>
Enveloped virus	Rotavirus, Strain WA
Large, non-enveloped virus	Rhinovirus (ATCC VR-1110)
Small, non-enveloped virus	Rhinovirus (ATCC VR-1110) Feline Calicivirus (Surrogate for Human Norovirus), Strain F-9 (ATCC VR-782)

[**Product name**] has demonstrated effectiveness against viruses similar to [**name of emerging virus**] on **hard, nonporous surfaces**. Therefore, [**product name**] can be used against [**name of emerging virus**] when used in accordance with the directions for use against [**name of supporting virus(es)**] on **hard, nonporous surfaces**. Refer to the [**CDC or OIE**] website at [**pathogen specific website address**] for additional information.

[**Name of illness/outbreak**] is caused by [**name of emerging virus**]. [**Product Name**] kills similar viruses and therefore can be used against [**name of emerging virus**] when used in accordance with the directions for use against [**name of supporting virus(es)**] on **hard, nonporous surfaces**. Refer to the [**CDC or OIE**] website at [**website address**] for additional information.

THE INFORMATION IN BOX IS NOT PART OF THE LABELING

[] - Statements in brackets are optional or instructional. Italicized words in brackets are not included. Italicized words in brackets are instructional. A footnote can be used to list organisms. Bacteria and virus can be separated into footnotes 1 and 2 if desired. When organisms are listed next to a claim, the organisms may be listed in a footnote instead of directly next to the claim. Sequence and placement of phrases is optional unless specified in 40 CFR 156.10. Capitalization, plurals or singular, bold and italics are all variable unless specified in 40 CFR. The terms "Wipe(s)", "Towel(s)", "Towelette(s)" and "Cloth(s)" can be used interchangeably throughout except for the product primary brand name which can be only changed by notification or amendment. The word "and" and symbol "&" can be used interchangeably. All directions may be written in numbered form or in paragraph form. Graphics, symbols, and logos may vary in color. All use surfaces and/or use sites on the label may be used in conjunction with an image of the use surface and/or use site.

April 30, 2024

Optional Claims and Descriptors [Note: Deodorizing directions must be used when deodorizing claims (claims involving odor control) are used]

Disinfecting claims

- An effective method to deodorize and disinfect against odor-causing organisms on hard, nonporous surfaces listed on this label.
- An effective way to disinfect hard, nonporous environmental surfaces listed on this label
- A nonwoven disposable cloth for use in hospitals and other critical care areas where reduction between treated surfaces is required
- Antibacterial
- Antimicrobial
- [Antibacterial] [Antimicrobial] health club equipment wipe
- [Bactericidal][,] [Tuberculocidal][,] [Fungicidal] [and] [Virucidal*] in [only] [just] [2 [two] minutes]
- Can help reduce cross contamination between treated hard, nonporous surfaces
- [Convenient] [Portable] way to disinfect hard, nonporous surfaces
- Deodorizes, and kills common household germs*
- [Destroys] [Deactivates] SARS-CoV-2 [the virus that causes COVID-19] [in hospitals] ‡
- Disinfect external surfaces of ultrasound transducers
- Disinfect the precleaned surface
- Disinfecting towelettes
- Disinfects [and deodorizes] in 2 [Two] minutes
- Disinfects grocery cart handles *or* shopping cart handles *or* grocery cart child seats *or* shopping cart child seats
- Disinfects hard, nonporous surface in 2 minutes
- [Disinfects] hard, nonporous surfaces [that people touch]
- Disinfects [health club equipment] [treadmill handles] [elliptical handles] [exercise bike handles] [weight benches]
- Disinfects [in [just] two [2] minutes]
- [Disinfects][Kills] [Effective against] Norovirus [Feline Calicivirus] in 2 [or two] minutes
- Disinfects on the go¶▲
- Effective against bathroom bacteria and viruses*‡ [use at least two bacteria and two viruses from the organism list]
- [Effective against] [kills] Norovirus [in 2 [or two] minutes]
- Effective against SARS-CoV-2 [Coronavirus] [Novel Coronavirus] [the virus that causes COVID-19] [in 1 minute]‡
- Effective against [:] [the following microorganisms on hard, nonporous surfaces] [list organism(s)]
- Effective in the presence of 5% blood serum contamination
- [Effective against all listed organisms in the presence of organic soil (5% blood serum)]
[*] [Product name] is virucidal against Adenovirus Type 5, Herpes Simplex Type 2 (causative agent of genital herpes), Influenza A virus H3N2 Strain (representative of the common flu virus), Influenza A (H1N1) virus, Human Coronavirus, Respiratory Syncytial Virus [RSV], Rhinovirus, Rotavirus, and Vaccinia virus in the presence of organic soil (5% blood serum).
- [Extra] large [disinfecting] [Y" x Z" compared to our A" x B" size] wipe[s]
- [Helps] [kill][s] [eliminate][s] 99.9% odor-causing bacteria
- Helps reduce cross contamination between treated hard, nonporous surfaces

THE INFORMATION IN BOX IS NOT PART OF THE LABELING

[] - Statements in brackets are optional or instructional. Italicized words in brackets are not included. Italicized words in brackets are instructional. A footnote can be used to list organisms. Bacteria and virus can be separated into footnotes 1 and 2 if desired.

When organisms are listed next to a claim, the organisms may be listed in a footnote instead of directly next to the claim

Sequence and placement of phrases is optional unless specified in 40 CFR 156.10.

Capitalization, plurals or singular, bold and italics are all variable unless specified in 40 CFR

The terms "Wipe(s)", "Towel(s)", "Towelette(s)" and "Cloth(s)" can be used interchangeably throughout except for the product primary brand name which can be only changed by notification or amendment.

The word "and" and symbol "&" can be used interchangeably

All directions may be written in numbered form or in paragraph form

Graphics, symbols, and logos may vary in color.

All use surfaces and/or use sites on the label may be used in conjunction with an image of the use surface and/or use site.

April 30, 2024

- Helps reduce the spread of SARS-CoV-2 [Coronavirus] [Novel Coronavirus] [the virus that causes COVID-19]¢ on treated, hard, non-porous surfaces.
- Hospital disinfectant [or disinfection] [use only when hospital use sites on label]
- Kills bacteria and viruses* in the bathroom [use at least two bacteria and two viruses from the organism list:] [or on the exterior toilet] surfaces
- Kills bacteria in 2 minutes
- [Kills] [or Disinfects] Norovirus [Feline Calicivirus] [in 2 [or two] minutes]
- [Kills] [Effective against] [Candida auris] [or] C. auris in two [or 2] minutes
- [Kills] [Effective against] [MRSA] [(Methicilin Resistant Staphylococcus aureus)]
- Kills household [or exterior toilet surface] [or bathroom germs*]
- Kills odor causing bacteria
- Kills [or Effective against] TB in 1 [One] minute
- *Kills SARS-CoV-2 [Coronavirus] [Novel Coronavirus] [the virus that causes COVID-19] [in 1 minute] on hard, non-porous surfaces
- Kills SARS-CoV-2 [Coronavirus] [Novel Coronavirus] [the virus that causes COVID-19] [in 1 minute]¢
- Leaves [bathroom] [office] disinfected [and smelling fresh]
- Multi-purpose disinfectant ¢
- On-the-go disinfectant ¢▲
- Perfect for disinfecting exterior toilet surfaces [or around the exterior toilet surface]
- [[Product name] is a premoistened, nonwoven durable wipe containing a quaternary/alcohol-based solution. Recommended for use in hospitals and other critical care areas where the reduction of cross-contamination between treated surfaces is required. [Suitable for use on equipment requiring alcohol-based products.] Use on hard, nonporous surfaces and equipment listed on this label made of stainless steel, plastic, Formica® and glass. [Formica® is a registered trademark of The Diller Corporation.]
- Proven efficacy against SARS-CoV-2 [Coronavirus] [Novel Coronavirus] [the virus that causes COVID-19] [in 1 minute]¢
- Reduce cross contamination between treated hard, nonporous surfaces
- Removes 99.9% [of] Norovirus [in 2] minutes
- Scrubbing power of a sponge in a disinfecting wipe
- The 2-minute germicidal wipe [or disinfectant wipe]
- Thick, wipes are [bactericidal][,] [Tuberculocidal] [and] [virucidal*] in 2 minutes
- Thick, large wipe disinfects hard, nonporous surfaces
- [Use this product to] Kill germs and bacteria instead of germ paper towels, sponges and rags
- [Use to] Disinfect[s] hard, nonporous environmental surfaces listed on this label
- Where the reduction of cross contamination between treated surfaces is of prime importance
- [Wipes out 99.9%] [Kills] [list organisms] in [just] [2 minutes]
- [Wipes out 99.9%] [Kills] [the] flu virus* (*Influenza A virus H3N2 Strain)
- [Wipes out 99.9%] [Kills] viruses* and bacteria [including the flu virus* (*Influenza A virus H3N2 Strain)]
- Wipes out 99.9% SARS-CoV-2 [Coronavirus] [Novel Coronavirus] [the virus that causes COVID-19] [in 1 minute]¢
- [Wiping] [soft] side for disinfecting

THE INFORMATION IN BOX IS NOT PART OF THE LABELING

[] - Statements in brackets are optional or instructional. Italicized words in brackets are not included. Italicized words in brackets are instructional. A footnote can be used to list organisms. Bacteria and virus can be separated into footnotes 1 and 2 if desired.

When organisms are listed next to a claim, the organisms may be listed in a footnote instead of directly next to the claim

Sequence and placement of phrases is optional unless specified in 40 CFR 156.10.

Capitalization, plurals or singular, bold and italics are all variable unless specified in 40 CFR

The terms "Wipe(s)", "Towel(s)", "Towelette(s)" and "Cloth(s)" can be used Interchangeably throughout except for the product primary brand name which can be only changed by notification or amendment.

The word "and" and symbol "&" can be used interchangeably

All directions may be written in numbered form or in paragraph form

Graphics, symbols, and logos may vary in color.

All use surfaces and/or use sites on the label may be used in conjunction with an image of the use surface and/or use site.

April 30, 2024

General cleaning and deodorizing claims

- Eliminates odors
- Gets rid of [or eliminates] odors
- Odor elimination [or neutralization]
- [Quickly] eliminates [lingering] [food] odors on surfaces
- [Use to] Deodorize hard, nonporous surfaces

Formula related claims

- Always ready to use
- A Quaternary ammonium chloride and Isopropyl Alcohol solution impregnated in a wiping cloth
- Are pre-measured to have the recommended amount of germicidal solution, wipe after wipe.
- Assures proper dilution strength, product effectiveness and standardized technique
- Bleach-free [formula]
- Compatible for use on hard, nonporous surfaces commonly found in healthcare settings listed on this label
- Contains [*name of active ingredient*], the [same] active ingredient used in [*Brand-name*]
- Does not contain bleach
- No measuring
- No mixing
- [Premixed], [premeasured], [premoistened]
- Ready to Use
- Requires no mixing or measuring and are ready-to-use
- Suitable for use on equipment requiring alcohol-based products
- With a bleach-free formula

Packaging related claims

- Contains [*number*] canisters [plus] [and] [*number*] refills
- Designed for [EVS][ES][Environmental Services][housekeeping][services][ease of use][nurses][healthcare professionals]
- [Designed to] [Fit(s)] in [Environmental services] [EVS] [ES] [janitorial] cart
- Dispenses one wipe at a time
- [Easy] [convenient] [dispensing] lid [closure] [cap] [package]
- Easy drop-in refill[s]
- [Easy] pop-up-tub
- Easy start lid [package]
- Easy to use [easy to refill]
- Easy to use package [canister] [container] keeps [your] wipes moist
- [Economical] Refill[s] [one] [1] [two] [2] [three] [3] [four] [4] [various numbers] -pack
- [Economical] Refills [now] available
- Extra-large wipe in [Bulk Pack/Bulk Flex Pack/ Bulk Eco Pak]
- Includes ___ count refill [pack] [contains] ___ wipes
- Less [reduced] packaging [less to throw away]
- Moisture lock lid
- Multi-pack
- [Multi [-refill] pack]

THE INFORMATION IN BOX IS NOT PART OF THE LABELING

[] - Statements in brackets are optional or instructional. Italicized words in brackets are instructional. A footnote can be used to list organisms. Bacteria and virus can be separated into footnotes 1 and 2 if desired.

When organisms are listed next to a claim, the organisms may be listed in a footnote instead of directly next to the claim

Sequence and placement of phrases is optional unless specified in 40 CFR 156.10.

Capitalization, plurals or singular, bold and italics are all variable unless specified in 40 CFR

The terms "Wipe(s)", "Towel(s)", "Towelette(s)" and "Cloth(s)" can be used interchangeably throughout except for the product primary brand name which can be only changed by notification or amendment.

The word "and" and symbol "&" can be used interchangeably

All directions may be written in numbered form or in paragraph form

Graphics, symbols, and logos may vary in color.

All use surfaces and/or use sites on the label may be used in conjunction with an image of the use surface and/or use site.

April 30, 2024

- [New and improved] [SlimPack] [TrimPack] [JetPack] [format]
- Next wipe pops up automatically [everytime] [!]
- No canister needed
- No threading [required]
- One [wipe] at a time dispensing
- [Package] [*Insert type of package*] made from [x%] recycled materials
- Pop-up [dispensing] [top]
- Portable
- Pull n/ Go [pack]
- Recyclable [package]
- Reduces [packaging] waste [by x%] [when compared to regular canister *or* bucket *or* pail]
- [Refill] package contains [one] [1] [two] [2] [three] [3] [four] [4] [various numbers] [wet] [pre-moistened] [wipe] [refill[s]] [roll[s]]
- Refill [size] [pack] [value pack]
- Refillable [with ____# wipes] [dispenser] refill [pack] [for dispenser]
- Resealable [stay-moist] pouch [package] [container] inside
- Reuse your [empty] canisters [again [and again] [!]
- Tear at perforation
- [The new] [SlimPack] [TrimPack] [JetPack] [format]
- This [outer] [selling] [package] [container][canister] contains x% post consumer [material] [plastic] [resin]
- Tub refill
- Tub with pop-up action
- Twin pack
- [Use to] refill[s] [count] [wipe] canisters *or* tubs
- X% [more] [wipes] [free] [vs. Z count] [canisters] [packs]
- X% reduction in packaging [material]

Towelette related claims

- ____% bigger [[quilted] wipes] [vs. X" x Y" wipes]
- [Absorbs] [Absorbent] wipe
- Cellulosic nonwoven disposable cloth
- [Cloth-like texture] [Textured] [strong] [for] [with] scrubbing power
- [Diamond] [-] [embossed] wipe is low-linting [for sensitive equipment surfaces]
- Double-sided scrubbing wipes
- [Durable], [low-lint] wipe designed for sensitive equipment surfaces
- Extra-large wipe [in [bulk] [flex] pack] [in bulk eco pak] [in bulk pack]]
- New larger, thicker wipe [with diamond-embossed design]
- New thicker wipe with diamond-embossed design
- No [pinched fingers] [rips] [tears]
- Non-scratching [wipe]
- Nonwoven disposable cloth
- Picks up [particles] [dust] [dirt] [hair] [crumbs]
- Strong, durable [diamond] [-] [embossed] textured wipe deodorizes
- Strong, [durable] [low-lint] wipe [designed for sensitive equipment surfaces]

THE INFORMATION IN BOX IS NOT PART OF THE LABELING

[] - Statements in brackets are optional or instructional. Italicized words in brackets are not included. Italicized words in brackets are instructional. A footnote can be used to list organisms. Bacteria and virus can be separated into footnotes 1 and 2 if desired.

When organisms are listed next to a claim, the organisms may be listed in a footnote instead of directly next to the claim

Sequence and placement of phrases is optional unless specified in 40 CFR 156.10.

Capitalization, plurals or singular, bold and italics are all variable unless specified in 40 CFR

The terms "Wipe(s)", "Towel(s)", "Towelette(s)" and "Cloth(s)" can be used Interchangeably throughout except for the product primary brand name which can be only changed by notification or amendment.

The word "and" and symbol "&" can be used interchangeably

All directions may be written in numbered form or in paragraph form

Graphics, symbols, and logos may vary in color.

All use surfaces and/or use sites on the label may be used in conjunction with an image of the use surface and/or use site.

April 30, 2024

- Textured [diamond] [-] [embossed] design [deodorizes hard, nonporous surfaces]
- Thick, textured wipe with [diamond] [-] [embossed] design
- Wipe [material] made from [x] % [sustainable] [ingredients] [fibers] *[May be used only when cellulose wipe material used]*

General claims

- X" x Y" [wipes]
- ____# pre-saturated towelettes X" x Y"
- © [insert year] [insert company name]
- A Sani-Surface® Brand
- Convenient
- Does not produce mist or overspray
- Easy [and convenient] way to [touch-up] [bathroom] [office] everyday
- Economy
- [Effective] For daily use
- Eliminates potential for overspray
- [Just] [pull] wipe and toss
- No sponges, no rags, no buckets, no mess
- Not for in-home use
- Not for sale in [insert name of state(s)]
- Not for sale [or use] after [insert date]
- Sample
- Time to reorder
- Trial
- Use by [insert date]
- Use on hard, nonporous surfaces only: [stainless steel] [Formica®] [glass] [glass tables] [glazed tile] [Test wipe on small inconspicuous area first.] [Formica® is a registered trademark of The Diller Corporation]
- Value
- Versatile
- Wet wipes

6 months only claims (may be used for 6 months on marketed label)

- [Better] [New] [Improved] [Stronger] [Thicker] Wipe [!]
- [Better] [new] [&] [improved] [dispensing] lid [closure] [cap] [package] [dispensing] [better [than before]]
- New and improved
- New [Bulk][Flex][Eco][Pak][Pack] [!]
- [New] [Package] [packaging] uses [x%] less material (plastic) [then] [when compared to] [regular] containers [or canisters]
- New thicker and larger diamond-embossed wipe cleans more surface area
- [Now] [Reinforced] [With] Quilted [strength]
- Now with [%] more towel
- Now with [#] more wipes
- [Scrubs] (&) [cleans] [better than ever]
- [Stronger] [more] [durable] [wipe]
- Thick[er] [wipe] [with] cloth-like texture

THE INFORMATION IN BOX IS NOT PART OF THE LABELING

[] - Statements in brackets are optional or instructional. Italicized words in brackets are instructional. A footnote can be used to list organisms. Bacteria and virus can be separated into footnotes 1 and 2 if desired.

When organisms are listed next to a claim, the organisms may be listed in a footnote instead of directly next to the claim

Sequence and placement of phrases is optional unless specified in 40 CFR 156.10.

Capitalization, plurals or singular, bold and italics are all variable unless specified in 40 CFR

The terms "Wipe(s)", "Towel(s)", "Towelette(s)" and "Cloth(s)" can be used interchangeably throughout except for the product primary brand name which can be only changed by notification or amendment.

The word "and" and symbol "&" can be used interchangeably

All directions may be written in numbered form or in paragraph form

Graphics, symbols, and logos may vary in color.

All use surfaces and/or use sites on the label may be used in conjunction with an image of the use surface and/or use site.

April 30, 2024

- X% [Bigger] [larger] [quilted] wipes
- [x%] thicker wipes

Footnotes

Y Corian [®] is a [registered] trademark of E. I. du Pont de Nemours and Company

YY Formica [®] is a [registered] trademark of The Diller Corporation

YYY Plexiglas [®] is a [registered] trademark of Arkema, Inc.

¢[on] hard, nonporous surfaces [of] [identified on this label]

*Kills SARS-CoV-2 [Coronavirus] [Novel Coronavirus] [the virus that causes COVID-19] [in 1 minute] on hard, nonporous surfaces

+*[Insert organism(s) from Table 3]*

▲When used according to disinfection directions

THE INFORMATION IN BOX IS NOT PART OF THE LABELING

[] - Statements in brackets are optional or instructional. Italicized words in brackets are instructional. A footnote can be used to list organisms. Bacteria and virus can be separated into footnotes 1 and 2 if desired.

When organisms are listed next to a claim, the organisms may be listed in a footnote instead of directly next to the claim

Sequence and placement of phrases is optional unless specified in 40 CFR 156.10.

Capitalization, plurals or singular, bold and italics are all variable unless specified in 40 CFR

The terms "Wipe(s)", "Towel(s)", "Towelette(s)" and "Cloth(s)" can be used Interchangeably throughout except for the product primary brand name which can be only changed by notification or amendment.

The word "and" and symbol "&" can be used interchangeably

All directions may be written in numbered form or in paragraph form

Graphics, symbols, and logos may vary in color.

All use surfaces and/or use sites on the label may be used in conjunction with an image of the use surface and/or use site.

April 30, 2024

[Graphics depicting use sites listed on this label can appear on product label and labeling.] [The following graphics and statements are optional. They may be placed anywhere on label/container.]

Company logos

[The following are company logos for use on PDI product labels. The purpose of the logo is for easy recognition of PDI products in the marketplace.]



Supplemental distributor logos

[The following are logos for use on supplemental distributor labels.]



THE INFORMATION IN BOX IS NOT PART OF THE LABELING

[] - Statements in brackets are optional or instructional. Italicized words in brackets are not included. Italicized words in brackets are instructional. A footnote can be used to list organisms. Bacteria and virus can be separated into footnotes 1 and 2 if desired.

When organisms are listed next to a claim, the organisms may be listed in a footnote instead of directly next to the claim

Sequence and placement of phrases is optional unless specified in 40 CFR 156.10.

Capitalization, plurals or singular, bold and italics are all variable unless specified in 40 CFR

The terms "Wipe(s)", "Towel(s)", "Towelette(s)" and "Cloth(s)" can be used Interchangeably throughout except for the product primary brand name which can be only changed by notification or amendment.

The word "and" and symbol "&" can be used interchangeably

All directions may be written in numbered form or in paragraph form

Graphics, symbols, and logos may vary in color.

All use surfaces and/or use sites on the label may be used in conjunction with an image of the use surface and/or use site.

April 30, 2024

The following statements are optional and may appear as verbiage or as a graphic:

DO NOT FLUSH
NOT A BABY WIPE
NOT A SKIN WIPE
NOT FOR USE ON SKIN
FOR USE ON HARD, NONPOROUS SURFACES ONLY

Advisory graphics



Use site graphics



THE INFORMATION IN BOX IS NOT PART OF THE LABELING

[] - Statements in brackets are optional or instructional. Italicized words in brackets are not included. **Italicized words in brackets are instructional.** A footnote can be used to list organisms. Bacteria and virus can be separated into footnotes 1 and 2 if desired.

When organisms are listed next to a claim, the organisms may be listed in a footnote instead of directly next to the claim

Sequence and placement of phrases is optional unless specified in 40 CFR 156.10.

Capitalization, plurals or singular, bold and italics are all variable unless specified in 40 CFR

The terms "Wipe(s)", "Towel(s)", "Towelette(s)" and "Cloth(s)" can be used interchangeably throughout except for the product primary brand name which can be only changed by notification or amendment.

The word "and" and symbol "&" can be used interchangeably

All directions may be written in numbered form or in paragraph form

Graphics, symbols, and logos may vary in color.

All use surfaces and/or use sites on the label may be used in conjunction with an image of the use surface and/or use site.

April 30, 2024

Efficacy graphics



THE INFORMATION IN BOX IS NOT PART OF THE LABELING

[] - Statements in brackets are optional or instructional. Italicized words in brackets are not included. Italicized words in brackets are instructional. A footnote can be used to list organisms. Bacteria and virus can be separated into footnotes 1 and 2 if desired.

When organisms are listed next to a claim, the organisms may be listed in a footnote instead of directly next to the claim

Sequence and placement of phrases is optional unless specified in 40 CFR 156.10.

Capitalization, plurals or singular, bold and italics are all variable unless specified in 40 CFR

The terms "Wipe(s)", "Towel(s)", "Towelette(s)" and "Cloth(s)" can be used Interchangeably throughout except for the product primary brand name which can be only changed by notification or amendment.

The word "and" and symbol "&" can be used interchangeably

All directions may be written in numbered form or in paragraph form

Graphics, symbols, and logos may vary in color.

All use surfaces and/or use sites on the label may be used in conjunction with an image of the use surface and/or use site.

April 30, 2024