

9480-4

10/21/2008

1 of 18

UNITED STATES ENVIRONMENTAL PROTECTION AGENCY

OCT 21 2008

Ms. Cristina Griffin  
Agent for PDI  
PDI, Health Care Div. of Nice-Pack Products, Inc.  
c/o Delta Analytical Corp.  
12510 Prosperity Drive, Suite 160  
Silver Spring, MD 20904

Subject: **Sani-Cloth Germicidal Wipes Germicidal Disposable Cloth**  
EPA Registration Number 9480-4  
Application Dated June 30, 2008  
EPA Received Date July 10, 2008

Dear: Ms. Griffin:

The following amendment, submitted in connection with registration under the Federal Insecticide, Fungicide, and Rodenticide Act (FIFRA), as amended, is acceptable with the following comments:

**Proposed Amendments:**

- Add organisms and minor label changes

**Efficacy Review:**

- The proposed label claims that the product, Sani-Cloth Germicidal Wipe (also known as Super Sani-Cloth), is an effective disinfectant against *Acinetobacter baumannii* on hard, non-porous surfaces in the presence of organic soil (5% blood serum) for a 2-minute contact time. This claim is supported by the submitted data.
- The proposed label claims that the product, Sani-Cloth Germicidal Wipe (also known as Super Sani-Cloth), is an effective disinfectant against *Campylobacter jejuni* and Influenza A (H1N1) virus on hard, non-porous surfaces in the presence of organic soil (5% blood serum) for a 2-minute contact time. This claim is supported by the submitted data.

**CONCURRENCES**

SYMBOL							
SURNAME							
DATE							

2018

3. The "First Aid" and "Precautionary Statements" sections on the label indicate to avoid contact with skin. Because the product is a towelette, the "Precautionary Statements" must be revised to state that suitable hand protection (e.g., gloves) must be worn at all times when dispensing and using the product.

The pictures on pages 13 and 15 of the proposed label also must be removed or changed. The pictures show ungloved hands using the towelette product.

4. Information provided on Agency website.  
([http://www.epa.gov/oppad001/label\\_guidance\\_avian.htm#towelette](http://www.epa.gov/oppad001/label_guidance_avian.htm#towelette))

**Towelette Products - Commercial, Industrial, Institutional, Agricultural and Residential Uses (For Avian Influenza claims):** Avian influenza A label claims will be accepted for these types of products provided efficacy data has been submitted and accepted to support the label claim. It should be clear that the use is only for surfaces which are not conducive to treatment by immersion or excess liquid (e.g., electrical panels, cash registers, door knobs and similar "high touch" surfaces). For uses in hospital/medical/health facilities, the directions for use for hospital disinfection must be followed. For all other use sites, general disinfection directions for use must be followed.

**Label Claims:** Featured statements/phrases, emphasized/enlarged lettering, special graphics, or any product name that employs the terms "**Avian influenza A**" or "**Bird Flu**", are unacceptable. Featured statements/phrases, emphasized/enlarged lettering or special graphics that are employed for the primary purpose of especially promoting or drawing attention to product efficacy against **avian influenza A**, are also unacceptable. For example, a featured, incomplete phrase such as "Kills avian influenza A" will not be permitted, but the phrase "Kills avian influenza A on pre-cleaned environmental surfaces" is acceptable.

5. The following change is required on the proposed label:

- Under the "Cleaning procedure" section on page 5, change "Open, unfold first germicidal wipe to remove heavy soil" to read "Open, unfold, and use first germicidal wipe to remove heavy soil."
- Remove the claim "Traps particles dust dirt hair crumbs" as the towelette has not demonstrated the ability to trap macroscopic debris.

30/18

**General Comments:**

Should you have any questions or comments concerning this letter, please contact Drusilla Copeland on (703) 308-6224.

Sincerely,



Velma Nobel

Product Manager (31)

Regulatory Management Branch I

Antimicrobials Division (7510CP)

Enclosure: Efficacy Review approved dated 9/9/08 and label

4 of 18

ACCEPTED  
with COMMENTS  
in EPA Letter Dated:

OCT 21 2008

Under the Federal Insecticide,  
Fungicide, and Rodenticide Act as  
amended, for the pesticide,  
registered under EPA Reg. No.

9480-4

ACCEPTED  
with COMMENTS  
in EPA Letter Dated:

Under the Federal Insecticide,  
Fungicide, and Rodenticide Act as  
amended, for the pesticide,  
registered under EPA Reg. No.

# SANI-CLOTH® GERMICIDAL WIPES

## GERMICIDAL DISPOSABLE CLOTH

ACTIVE INGREDIENTS:

n-Alkyl (68% C<sub>12</sub>, 32% C<sub>14</sub>) dimethyl ethylbenzyl ammonium chlorides..... 0.25%

n-Alkyl (60% C<sub>14</sub>, 30% C<sub>16</sub>, 5% C<sub>12</sub>, 5% C<sub>18</sub>) dimethyl benzyl ammonium chlorides..... 0.25%

OTHER INGREDIENTS..... 99.50%

TOTAL 100.00%

KEEP OUT OF REACH OF CHILDREN  
DANGER

See back [side] panel for additional precautionary statements

NET CONTENTS

\_\_\_ # OF CLOTHS [SIZE of each cloth]

EPA Reg. No.: 9480-4

EPA Est. No. : 9480-NY-1

or

EPA Est. No. A=9480-NY-1, B=72956-WI-1

Alpha character will precede batch code on product

[Manufactured by [or for]]:

Professional Disposables International, Inc.

Two Nice-Pak Park, Orangeburg, NY 10962-1376

[website address] [phone number]

First Aid:

Call a poison control center or doctor for treatment advice. Have the product container or label with you when calling a poison control center or doctor, or going for treatment

If in eyes:

-Hold eye open and rinse slowly and gently with water for 15-20 minutes. Remove contact lenses, if present, after the first 5 minutes, then continue rinsing.

If on skin:

-Take off contaminated clothing.

-Rinse skin immediately with plenty of water for 15-20 minutes.

[For additional information in case of emergency call toll free [phone number to be inserted]].

The terms "wipe(s)", "towel(s)", "towelette(s)", and "cloth(s)" and the product name may be used interchangeably except for within the product primary brand name.

5 of 18

**Precautionary Statements**

**Hazards to Humans and Domestic Animals**

Danger. Causes irreversible eye damage. Harmful if absorbed through skin. Do not get in eyes or on clothing. Avoid contact with skin. Wash thoroughly with soap and water after handling and before eating, drinking, chewing gum, using tobacco, or using restroom. Remove and wash contaminated clothing before reuse.

**Physical or chemical hazard**

Combustible. Do not use or store near heat or open flame. Do not use on natural marble, windows, unpainted wood, brass, clear plastic or colored grout.

Bactericidal

Tuberculocidal

Virucidal\*

[Bactericidal, Tuberculocidal and Virucidal\* in 2 minutes]

\*Adenovirus Type 5 [ATCC VR-5], Herpes Simplex Type 2 [ATCC VR-734], Influenza A2/Hong Kong [ATCC VR-544], Influenza A (H1N1) virus [ATCC VR-98] Strain A/Malaya/302/54, Human Coronavirus [ATCC VR-740] Strain 229E, Respiratory Syncytial Virus [RSV], Rhinovirus [ATCC VR-1110], Rotavirus Strain WA, Vaccinia virus [ATCC VR-1354], HIV-1<sup>†</sup>, Hepatitis B Virus<sup>†</sup>, Hepatitis C Virus<sup>†</sup>

[\*]Virucidal against Adenovirus Type 5, Herpes Simplex Type 2, Influenza A2/Hong Kong, Influenza A (H1N1) virus, Human Coronavirus, Respiratory Syncytial Virus [RSV], Rhinovirus, Rotavirus, Vaccinia virus, HIV-1<sup>†</sup>, Hepatitis B Virus<sup>†</sup>, Hepatitis C Virus<sup>†</sup>

[Product name] kills bacteria listed on this label

Acinetobacter baumannii [ATCC 19606]

Burkholderia cepacia [ATCC 25416]

Campylobacter jejuni [ATCC 29428]

Candida albicans [ATCC 14053]

Escherichia coli (E. coli) [ATCC 11229]

Escherichia coli O157:H7 [ATCC 35150]

ESBL Producing Escherichia coli (E. coli) [ATCC BAA-196]

Klebsiella pneumoniae [ATCC 4352]

Methicillin Resistant Staphylococcus aureus (MRSA) [ATCC 33592]

Mycobacterium bovis BCG (Tuberculosis) [ATCC 35743]

Pseudomonas aeruginosa [ATCC 15442]

Salmonella enterica [ATCC 10708]

Staphylococcus aureus [ATCC 6538]

Vancomycin Resistant Enterococcus faecalis (VRE) [ATCC 51299]

in the presence of organic soil (5% blood serum)

[\*][Product name] is virucidal against Adenovirus Type 5, Herpes Simplex Type 2 (causative agent of genital herpes), Influenza A2/Hong Kong (representative of the common flu virus), Influenza A (H1N1) virus, Human Coronavirus, Respiratory Syncytial Virus [RSV], Rhinovirus, Rotavirus, and Vaccinia virus in the presence of organic soil (5% blood serum).

<sup>†</sup>KILLS HIV-1 (AIDS VIRUS), HEPATITIS B VIRUS (HBV) AND HEPATITIS C VIRUS (HCV) ON THE PRE-CLEANED ENVIRONMENTAL SURFACES/OBJECTS AND PRE-CLEANED EXTERNAL SURFACES OF ULTRASOUND TRANSDUCERS AND PROBES PREVIOUSLY SOILED WITH BLOOD/BODY FLUIDS in two (2) minutes at room temperature (68°- 77°F) or (20°- 25°C) in healthcare or other settings in which there is an expected likelihood of soiling of inanimate surfaces/objects with blood or body fluids, and in which the surfaces/objects likely to be soiled with blood or body fluids can be associated with the potential for transmission of Human Immunodeficiency Virus Type 1 (HIV-1) (associated with AIDS), Hepatitis B Virus (HBV) and Hepatitis C Virus (HCV).

The terms "wipe(s)", "towel(s)", "towelette(s)", and "cloth(s)" and the product name may be used interchangeably except for within the product primary brand name.

[Product name] is a premoistened, non-woven durable wipe containing a quaternary/alcohol based solution. Recommended for use in hospitals and other critical care areas where the control of the hazards of cross-contamination between treated surfaces is required. Use on hard non-porous surfaces and equipment listed on this label made of stainless steel, plastic, Formica® and glass. Some organisms are removed from the surface by thoroughly wiping the surface with the wipe. Most remaining organisms are killed within two (2) minutes by exposure to the liquid in the wipe.

**Areas of Use:**

Hospital and Healthcare Settings: Ambulances, Ambulatory Surgical Centers (ASC), Anesthesia, CAT Labs, CCU, Central Supply, Clinics, Dental Offices, Dialysis Clinics, Doctors Offices, Donation Centers [blood][plasma][semen][milk][apheresis], Emergency Medical Settings, Emergency Rooms, E.R., Emergency Vehicles, Eye Surgical Centers, Healthcare Settings, Health Care Facilities, Home Health Care, Hospices, Hospitals, ICU, Isolation Areas, Laboratory, Laundry rooms, Neonatal Intensive Care Units (NICU), Newborn nursery, Nursing homes, Operating Rooms (OR), Ophthalmic Offices, Orthopedics, Out-Patient Surgical Centers (OPSC), Patient Care Areas, Pediatrics, Pediatric Intensive Care Units (PICU), Physical therapy, Physician's offices, Radiology, Recovery Rooms, Rehabilitation, Respiratory therapy, Surgery, Surgical Centers, Transport vehicles and X-Ray.

and/or

**Critical Care Areas:** CCU, Emergency Rooms, E.R., ICU, Neonatal Intensive Care Units (NICU), Operating Rooms, Pediatric Intensive Care Units (PICU) and Surgery.

and

Hospital, Healthcare, and Critical Care Use Sites: May be used on hard non-porous surfaces of: ambulance equipment surfaces; bed railings; cabinets; carts; chairs; counters; dental chairs; dental countertops; dental unit instrument trays; endodontic equipment such as apex locators; exam tables; gurneys; infant incubators [interior and exterior surfaces of]; infant warmers [interior and exterior surfaces of]; isolettes; IV poles; laboratory equipment and surfaces; loupes; operating room tables and lights; operator light switches; oxygen hoods; physical therapy (PT) equipment surfaces; slit lamps; spine back boards; stethoscopes; stretchers; stools; tables; telephones; toilet seats; and hard non-porous outside surfaces of: amalgamators and dental curing lights; anesthesia machines and respiratory therapy equipment; apheresis machines, diagnostic equipment, dialysis machines; patient monitoring equipment, patient support and delivery equipment, pulp testers and motors; toilets; and ultrasound transducers and probes.

**Grocery Stores or Shopping Centers or Supermarkets or Delicatessens:** Disinfects grocery cart handles and grocery cart child seats. Disinfects shopping cart handles and child seats.

**Nursery or Daycare Centers: Bassinets [interior and exterior surfaces of],** changing tables, cribs, diaper changing stations, diaper pails, infant/child care equipment surfaces, trash cans, toys and other hard, non-porous surfaces listed on this label.

**Bathroom[s] or Public Restrooms: Basins, [bath]tubs,** bathroom fixtures, cabinets, countertops, doorknobs, faucet[s], handles, hampers, handrails, shower[s] [stalls], showers, sinks, glazed tiled walls, glazed tiles, toilet [handle] [rim] [seats] [tank] [and other exterior surfaces of], urinals [exterior surfaces of] and vanity tops, and other hard non-porous surfaces listed on this label.

**Health club facilities and Gyms:** Gym equipment, weight-lifting surfaces and other hard non-porous surfaces listed on this label.

**Schools or Classrooms or Office Buildings or Public Facilities or Manufacturing Facilities or Libraries or Public Telephones:** Cabinets, chairs, computers, computer monitors, computer mice, counters, countertops, desks, desktops, doorknobs, fax machines, filing cabinets, filing doors, filing handles, garbage cans, headsets, keyboards, railings, seats, sinks, tables, tabletops, telephones, toys, trash cans, work stations, and other hard non-porous surfaces listed on this label.

**Transport vehicles, school busses, public busses, fire trucks, police cars:** Hard non porous surfaces of vehicles including steering wheel, hard plastic or metal flooring, seats, and walls.

The terms "wipe(s)", "towel(s)", "towelette(s)", and "cloth(s)" and the product name may be used interchangeably except for within the product primary brand name.

**Restaurants:** Hard non porous, non food contact surfaces only including chairs, display cabinets, garbage cans, booster seats, floor, sinks, bathroom surfaces, glazed tiled walls, telephones, cash registers, and doorknobs.

This product is not to be used as a terminal sterilant/high level disinfectant on any surface or instrument that (1) is introduced directly into the human body, either into or in contact with the bloodstream or normally sterile areas of the body, or (2) contacts intact mucous membranes but which does not ordinarily penetrate the blood barrier or otherwise enter normally sterile areas of the body. This product may be used to preclean or decontaminate critical or semi-critical medical devices prior to sterilization or high level disinfection.

[Use one of the following as applicable to type of container.]

**[To Dispense TOWELETTES] [or WIPES] [or TOWELS] [or CLOTHS]:**

Remove lid [and discard inner seal] [from container or canister.] Find center of wipe roll, remove first wipe for use, twist corner of next wipe into a point and thread through the hole in the [container or] canister lid. Pull through about one inch. Replace lid. Dispense remaining wipes as necessary by pulling out at an angle. When not in use keep [center cap of] lid closed to prevent moisture loss.

**TRAVEL PACK:**

Peel back label slowly. Pull out wipes as needed and reseal label. Unfold wipe.

**BOX:**

Open along perforations as indicated. Remove packets as needed.

**PACKET/PACKAGE:**

Tear open packet [package]. Unfold wipe and use as directed. Discard after single use.

**SOLO® PAK:**

Open package lid. Completely remove inner seal. Pull out wipe. (The next wipe pops up automatically.) Snap lid closed after use to retain moisture.

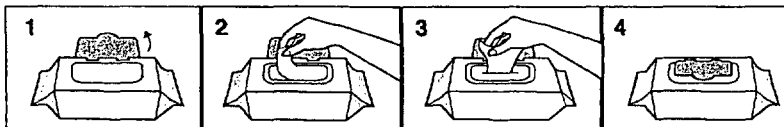

DO NOT FLUSH • STORE AT ROOM TEMPERATURE  
DISPOSE OF USED WIPES IN TRASH RECEPTACLE • KEEP SOLO®  
LID CLOSED WHEN NOT IN USE  
SOLO® is a registered trademark of Nice-Pak Products, Inc.

**REFILL PACKET**

This refill package is made for use only in a [product name] [container or] canister; do not use this product in a [container or] canister for another product. Do not use the refill wipes in a container that is cracked or broken. Discard the cracked or broken container in accordance with the container disposal instructions on the label.

**[Option 1]**

Remove [entire] lid from [container or] canister. Tear open refill [package] at [notch] [mark] [arrow] and place [wipe] roll in empty [container or] canister. Follow information on [container or] canister to dispense wipes.

**[Option 2]**

Remove [entire] lid from [container or] canister. Tear open refill [package] at [notch] [mark] [arrow]. Place [entire] refill package of wipes in empty [container or] canister. Follow information on [container or] canister to dispense wipes.

The terms "wipe(s)", "towel(s)", "towelette(s)", and "cloth(s)" and the product name may be used interchangeably except for within the product primary brand name.

009480-00004.20080625.EPA amend organisms.pdf June 25, 2008

Page 4 of 15

80718

**GENERIC:**

Open lid. Pull out wipe. Close lid tightly.

Bucket [or pail or container]

1. Remove the lid from the [pail or bucket or container.]
2. Press open the dispenser at center of the lid.
3. Open the refill pack.
4. Locate the first wipe at the center of the roll.
5. Feed the first wipe through the dispensing orifice.
6. Reapply the lid to the [pail or bucket or container.]
7. Dispense the wipe.

For the refills:

1. Remove the lid from the [pail or bucket or container.]
2. Remove the empty refill pack material from the [pail or bucket or container.]
3. Press open the dispenser at center of the lid.
4. Open the refill pack.
5. Locate the first wipe at the center of the roll.
6. Feed the first wipe through the dispensing orifice.
7. Reapply the lid to the pail.
8. Dispense the wipe.

**DIRECTIONS FOR USE**

It is a violation of Federal law to use this product in a manner inconsistent with its labeling.

**TO DISINFECT [AND DEODORIZE]:** To disinfect nonfood contact surfaces only: Use a wipe to remove heavy soil. Unfold a clean wipe and thoroughly wet surface. Treated surface must remain visibly wet for a full two (2) minutes. Use additional wipe(s) if needed to assure continuous two (2) minute wet contact time. Let air dry. [When TB is included on the label, add the following or use the TB directions below:] These directions also apply to Mycobacterium bovis BCG (Tuberculosis) at 68°F (20°C).

[The following sets of directions are optional and for hospital/medical facility use only:

Tuberculosis (TB) [Outbreaks]: This product is effective against Mycobacterium bovis BCG (Tuberculosis) in one minute at 68°F (20°C). Use a wipe to remove heavy soil. Unfold a clean wipe and thoroughly wet surface. Treated surface must remain visibly wet for one (1) full minute. Use additional wipe(s) if needed to assure continuous one (1) minute wet contact time. Let air dry. Although efficacy at a one (1) minute contact time has been shown to be adequate against TB, this time is not sufficient for other organisms on the label. Therefore a 2 minute wet contact time must be used for all listed non TB organisms.

and/or

Ultrasound transducers and probes: For use on external surfaces of ultrasound transducers and probes only. To disinfect: Pre-clean gel from external surface of ultrasound transducer or probe to be disinfected by using a clean washcloth. Then thoroughly wet the probe with a wipe. Treated surface must remain visibly wet for a full two (2) minutes. Use additional wipe(s) if needed to assure continuous two (2) minute wet contact time. Let air dry.]

**†SPECIAL INSTRUCTIONS FOR CLEANING AGAINST HIV-1, HEPATITIS B VIRUS AND HEPATITIS C VIRUS OF SURFACES/OBJECTS SOILED WITH BLOOD/BODY FLUIDS**

**Personal protection:** When using this product, wear disposable protective gloves, protective gowns, face masks, or eye coverings as appropriate when handling HIV-1 (AIDS Virus), HBV or HCV infected blood or body fluids.

**Cleaning procedure:** All blood and other body fluids must be thoroughly cleaned from surfaces and objects before disinfection by the germicidal wipe. Open, unfold first germicidal wipe to remove heavy soil.

**Disposal of infectious materials:** Dispose of used wipe in accordance with local regulations for infectious waste disposal.

**Contact time:** Use second germicidal wipe to thoroughly wet surface. Allow to remain wet two (2) minutes, let air dry.

<p>The terms "wipe(s)", "towel(s)", "towelette(s)", and "cloth(s)" and the product name may be used interchangeably except for within the product primary brand name.</p> <p>009480-00004.20080625.EPA amend organisms.pdf</p> <p>Page 5 of 15</p> <p>June 25, 2008</p>
---



90918

[Use storage/disposal statement A if container or canister directions used. Use storage/disposal statement B if travel pack or [refill] packet/package directions used.]

**Storage and disposal**

*Statement A: For [container or] [canisters and] refill dispensers:*

**Storage:** Do not store near heat or open flame. When not in use keep center cap of lid closed to prevent moisture loss.

**Towelette Disposal:** Do not reuse towelette. Dispose of used towelette in trash. Do not flush in toilet.

**Dispenser Disposal:** Do not reuse empty container. Triple rinse and offer for recycling. If recycling is not available, put in trash collection.

[If refillable container is being used, substitute the following: **Refill Dispenser Disposal:** Triple rinse cracked or broken containers and offer for recycling. If recycling is not available, discard in trash.]

*Statement B: For packets, travel packs, and [refill] packets or packages:*

**Storage:** Do not store near heat or open flame.

**Towelette Disposal:** Do not reuse towelette. Dispose of used towelette in trash. Do not flush in toilet.

**Travel Pack [or Solo® Pak or Refill Packet] [or [bulk] package]] Disposal:** Put empty travel pack [or Solo® Pak or refill packet] [or packaging]] in trash collection.

The terms "wipe(s)", "towel(s)", "towelette(s)", and "cloth(s)" and the product name may be used interchangeably except for within the product primary brand name.

100A18

**Optional Claims and Descriptors** [Note: Deodorizing directions must be used when deodorizing claims (claims involving odor control) are used]

X" x Y" [wipes]

\_\_\_% bigger [[quilted] wipes] [vs. X" x Y" wipes]

\_\_\_# pre-saturated towelettes X" x Y"

© [insert year] [insert company name]

[Absorbs] [Absorbent] [wipe]

After use, just toss wipe(s) away

Always ready to use

An effective method to deodorize and disinfect against odor-causing organisms on hard non-porous surfaces listed on this label.

An effective way to disinfect hard, non-porous environmental surfaces listed on this label.

A non-woven disposable cloth for use in hospitals and other critical care areas where control between treated surfaces is required.

Antibacterial

Antimicrobial

[Antibacterial] [Antimicrobial] health club equipment wipe

A Quaternary [ammonium chloride] solution impregnated in a wiping cloth

Are pre-measured to have the recommended amount of germicidal solution, wipe after wipe.

A Sani-Surface® Brand

Assures proper dilution strength, product effectiveness and standardized technique.

Bleach-free [formula]

Can help reduce the risk of cross contamination on treated surfaces

Cellulosic non-woven disposable cloth

[Cloth-like texture] [Textured] [strong] [for] [with] scrubbing power

Contains [name of active ingredient], the [same] active ingredient used in [Brand-name]

Contains [number] canisters [plus] [and] [number] refills

Convenient

Deodorize hard, non-porous surfaces [Use to]

Deodorizes, and kills common household germs\*

Diamond-embossed wipe is low-linting [for sensitive equipment surfaces]

Disinfect external surfaces of ultrasound transducers

Disinfect the precleaned surface

Disinfecting towelettes

Disinfects and deodorizes in 2 minutes

Disinfects grocery cart handles or shopping cart handles or grocery cart child seats or shopping cart child seats

Disinfects hard non-porous environmental surfaces listed on this label [Use to]

Disinfects hard, non-porous surface in 2 minutes

[Disinfects] hard surfaces [that people touch]

Disinfects [health club equipment] [treadmill handles][elliptical handles][exercise bike handles][weight benches]

Disinfects [in [just] two [2] minutes] .

Disinfects on the go

Dispenses one wipe at a time

Does not contain bleach

Does not produce mist or overspray

Double-sided scrubbing wipes

Durable, low-lint wipe designed for sensitive equipment surfaces

Easy

Easy [and convenient] way to [touch-up] [bathroom] [office] everyday

[Easy] [convenient] [dispensing] lid [closure] [cap] [package]

Easy drop-in refill[s]

[Easy] pop-up-tub

Easy start lid [package]

Easy to use [easy to refill]

Easy to use package [canister] [container] keeps [your] wipes moist

The terms "wipe(s)", "towel(s)", "towelette(s)", and "cloth(s)" and the product name may be used interchangeably except for within the product primary brand name.

[Economical] Refill[s] [one] [1] [two] [2] [three] [3] [four] [4] [various numbers] -pack

[Economical] Refills [now] available

Economy

Effective against bathroom bacteria and viruses\* [use at least two bacteria and two viruses from this list:]

(Escherichia coli O157:H7, Salmonella enterica, Staphylococcus aureus, Herpes Simplex Type 2 (causative agent of genital herpes), \*Influenza A2/Hong Kong (representative of the common flu virus), Rhinovirus, Rotavirus)

Effective against [the following micro-organisms on hard, non-porous surfaces] [list organisms]

Effective in the presence of 5% blood serum contamination

Eliminates odors

Eliminates potential for overspray

Extra large [disinfecting] [Y" x Z" compared to our A" x B" size] wipes

Fast [Convenient] [Portable] way to disinfect hard non-porous surfaces

For daily use

Gets rid of -or- eliminates odors

[Helps] [kill][s] [eliminate][s] odor-causing bacteria

Helps prevent cross contamination on treated surfaces

Hospital disinfectant [disinfection] [use only when hospital use sites on label]

Includes \_\_\_ count refill [pack] [contains] \_\_\_ wipes

Just -or- simply wipe exterior toilet surface -or- bathroom germs+ away

Just [pull] wipe and toss

Kill germs+ and bacteria instead of germ paper towels, sponges and rags [Use this product to]

Kills bacteria and viruses\* in the bathroom [use at least two bacteria and two viruses from this list:]

(Escherichia coli O157:H7, Salmonella enterica, Staphylococcus aureus, Herpes Simplex Type 2 (causative agent of genital herpes), \*Influenza A2/Hong Kong (representative of the common flu virus), Rhinovirus, Rotavirus) -or- on the exterior toilet surfaces

Kills bacteria in 2 minutes

[Kills] [Effective against] [MRSA] [(Methicilin Resistant Staphylococcus aureus)]

Kills household -or- exterior toilet surface -or- bathroom germs+ [use at least two bacteria and two viruses from this list:] (Escherichia coli O157:H7, Salmonella enterica, Staphylococcus aureus, Herpes Simplex Type 2 (causative agent of genital herpes), \*Influenza A2/Hong Kong (representative of the common flu virus), Rhinovirus, Rotavirus)

Kills odor causing bacteria

Leaves [bathroom] [office] disinfected [and smelling fresh]

Less [reduced] packaging [less to throw away]

Moisture lock lid

Multi-pack

Multi-purpose disinfectant [Multi [-refill] pack]

New larger, thicker wipe [with diamond-embossed design]

New thicker wipe with diamond-embossed design

Next wipe pops up automatically [everytime] [!]

No canister needed

No measuring

No mixing

No [pinched fingers] [rips] [tears]

No sponges, no rags, no buckets, no mess

No threading [required]

Non-scratching [wipe]

Non-woven disposable cloth

Not for sale in [insert name of state(s)]

Odor [elimination] [neutralization]

One [wipe] at a time dispensing

On-the-go disinfectant

[Package][insert type of package] made from [x%] recycled materials

Picks up [Traps] [particles] [dust] [dirt] [hair] [crumbs]

Perfect for disinfecting exterior toilet surfaces -or- around the exterior toilet surface

Pop-up [dispensing] [top]

The terms "wipe(s)", "towel(s)", "towelette(s)", and "cloth(s)" and the product name may be used interchangeably except for within the product primary brand name.

Portable  
 [Premixed], [premeasured], [premoistened]  
 Pull n/ Go [pack]  
 Quick  
 Quick [and easy] [and convenient] way to disinfect  
 Quick and easy way to disinfect [bathroom –or- exterior toilet surfaces] [hard, nonporous surfaces]  
 [Quickly] eliminates [lingering] [food] odors on surfaces  
 Ready to Use  
 Recyclable [package]  
 Reduce [risk of cross contamination] [on hard non-porous surfaces]  
 Reduces [packaging] waste [by x%] [when compared to regular canister or bucket or pail]  
 [Refill] package contains [one] [1] [two] [2] [three] [3] [four] [4] [various numbers] [wet] [pre-moistened] [wipe]  
 [refill[s]] [roll[s]]  
 Refill [size] [pack] [value pack]  
 Refillable [with \_\_\_# wipes] [dispenser] refill [pack] [for dispenser]  
 Requires no mixing or measuring and are ready-to-use  
 Resealable [stay-moist] pouch [package] [container] inside  
 Reuse your [empty] canisters [again [and again] [!]  
 Sample  
 Scrubbing power of a sponge in a disinfecting wipe  
 Strong, durable diamond-embossed textured wipe deodorizes  
 Strong, durable low-lint wipe [designed for sensitive equipment surfaces]  
 Tear at perforation  
 Textured diamond-embossed design [deodorizes hard, non-porous surfaces]  
 The 2-minute germicidal wipe [disinfectant wipe]  
 Thick, heavy duty wipes are bactericidal, tuberculocidal and virucidal\* in 2 minutes  
 Thick, large wipe disinfects  
 Thick, textured wipe with diamond-embossed design  
 This [outer] [selling] [package] [container][canister] contains x% post consumer [material][plastic][resin]  
 Time to reorder  
 Trial  
 Tub refill  
 Tub with pop-up action  
 Twin pack  
 Use on hard, non-porous surfaces only: [stainless steel] [Formica®] [glass] [glass tables] [glazed tile] [Test  
 wipe on small inconspicuous area first.]  
 Use to preclean or decontaminate critical or semi-critical medical devices prior to sterilization / high-level  
 disinfection  
 [Use to] refill[s] [count] [wipe] canisters or tubs  
 Value  
 Versatile  
 Wet wipes  
 Where control of the hazards of cross contamination between treated surfaces is of prime importance  
 Wipe [material] made from [x] % [sustainable] [ingredients] [fibers] [May be used only when cellulose wipe  
 material used]  
 [Wipes out] [Kills] [common] [household] [bacteria] [viruses\*] [germs\*]  
 [Wipes out] [Kills] [eliminates] [list organisms] in [just] [2 minutes]  
 [Wipes out] [Kills] [the] flu virus\* (\*Influenza A2/Hong Kong)  
 [Wipes out] [Kills] viruses\* and bacteria [including the flu virus\* (\*Influenza A2/Hong Kong)]  
 [Wiping] [soft] side for disinfecting  
 With a bleach-free formula  
 X% [more] [wipes] [free] [vs. Z count] [canisters] [packs]  
 X% reduction in packaging [material]

The terms “wipe(s)”, “towel(s)”, “towelette(s)”, and “cloth(s)” and the product name may be used interchangeably  
 except for within the product primary brand name.

009480-00004.20080625.EPA amend organisms.pdf June 25, 2008  
Page 9 of 15

**[Note: The following claims can be used only for 6 months]**

[Better] [New] [Improved] [Stronger] [Thicker] Wipe [!]

[Better] [new] [&amp;] [improved] [dispensing] lid [closure] [cap] [package] [dispensing] [better] [than before]

New and improved

[New] [Package] [packaging] uses [x%] less material (plastic) [then] [when compared to] [regular] containers [or canisters]

New thicker and larger diamond-embossed wipe cleans more surface area

[Now] [Reinforced] [With] Quilted [strength]

Now with [%] more towel

Now with [#] more wipes

[Scrubs] (&amp;) [cleans] [better than ever]

[Stronger] more durable [wipe]

Thick[er] [wipe] [with] cloth-like texture

X% [Bigger] [larger] [quilted] wipes

[x%] thicker wipes

**Master Label Reader Notes***[A footnote can be used to list organisms shown on page 2. Bacteria and virus can be separated into footnotes 1 and 2 if desired.]**[When organisms are listed next to a claim, the organisms may be listed in a footnote instead of directly next to the claim]**[† All pesticidal "germ" claims must be linked to bacteria (minimum: Salmonella and Staph) and at least one virus. For example: Front panel: "Kills germs\*" Back panel: "Kills Salmonella enterica, Staphylococcus aureus, Herpes Simplex Type 2, and Influenza A/Hong Kong".]*

The terms "wipe(s)", "towel(s)", "towelette(s)", and "cloth(s)" and the product name may be used interchangeably except for within the product primary brand name.

140A18

**CLEANING:** *[cleaning directions and claims are grouped on this page]*

**DIRECTIONS FOR USE:**

**[CLEANING] [and] [DEODORIZING]:** Wipe surface with towelette until clean. Let air dry.

**CLAIMS:**

An effective method to clean against odor-causing organisms on hard non-porous surfaces listed on this label.

A One Step▲ Cleaner [and disinfectant] (except precleaning is required for blood and body fluids)

Built-in [tough] scrubbing fibers help clean away tough

Cleans

Cleans and disinfects [on the go]

Cleans grocery carts and shopping carts

Diamond-embossed pattern [texture] provides effective cleaning

Easy One Step▲ Cleaning [and disinfecting] (except precleaning is required for heavy soil and blood and body fluids)

Leaves bathroom fresh and clean in [just] minutes

Leaves [bathroom] [office] clean [and disinfected] [and smelling fresh]

Multi-purpose cleaner [Multi [-refill] pack]

Perfect for cleaning [and disinfecting] around the toilet

Premoistened [wet] household cleaning wipe

Premoistened with specially formulated cleaners to handle daily clean-ups without bottles, sponges or buckets [This product is]

Quick [and easy] [and convenient] way to clean [and disinfect]

Quick and easy way to clean [and disinfect] [bathroom –or- exterior toilet surfaces] [hard, nonporous surfaces]

[So] surfaces are more than [just] [clean] [they're] [disinfected]

[Soft] side for [cleaning] dirt away

Strong, durable diamond-embossed textured wipe cleans [and deodorizes]

Textured diamond-embossed design [cleans hard, non-porous surfaces] [helps remove soil from surfaces]

Textured for better [cleaning] [scrubbing] power

[Textured] [scrubby] [rough] side for [scrubbing] [cleaning] [removing] [wiping] [tough] [stains] [soils] [messes]

Textured wipe for effective cleaning

Thick, large wipe cleans

Virtually [Lint Free] [streak free] [clean] [shine]

Wipe away odors

[Wipes out] [Kills] germs\* [or bacteria] [while it cleans] [that cause odor]

[Wiping] [soft] side for [wiping] dirt away [and disinfecting]

*▲If one step cleaner claims used and HIV-1,HBV, and/or HBC claims and/or directions for ultrasound transducers are included on the label, then the following also must be included on the same panel of the label:*

*▲a pre-cleaning step is required for HIV-1 [and] [or] use on ultrasound transducers [or probes]. If HIV-1, HBV, and/or HBC or ultrasound transducers are not listed on the label, any of the one step cleaning/disinfecting claims may be used without the phrase requiring pre-cleaning.*

The terms “wipe(s)”, “towel(s)”, “towelette(s)”, and “cloth(s)” and the product name may be used interchangeably except for within the product primary brand name.

[The following graphics and statements are optional.  
They may be placed anywhere on label/container.]

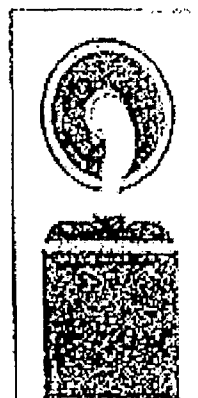

**NOT A BABY WIPE**

**NOT FOR USE ON SKIN**

*This graphic shows use of the wipe dispenser.*



**FINISHED FLOORS**

The terms "wipe(s)", "towel(s)", "towelette(s)", and "cloth(s)" and the product name may be used interchangeably except for within the product primary brand name.

[The following graphics and statements are optional. They may be placed anywhere on label/container.]

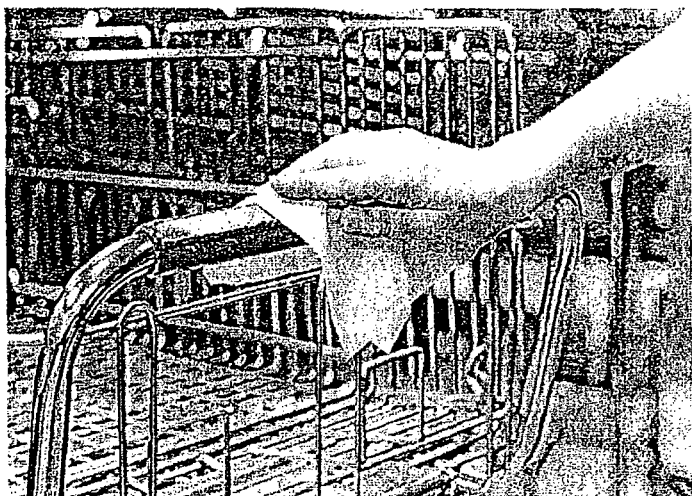
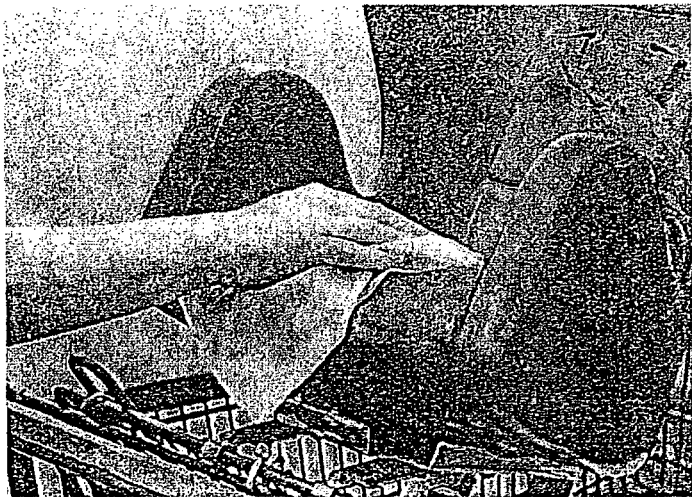

The terms "wipe(s)", "towel(s)", "towelette(s)", and "cloth(s)" and the product name may be used interchangeably except for within the product primary brand name.



[The following graphics and statements are optional.  
They may be placed anywhere on label/container.]



Not a Skin Wipe.  
For Use on Hard Surfaces Only.



Not a Skin Wipe.  
For Use on Hard Surfaces Only.

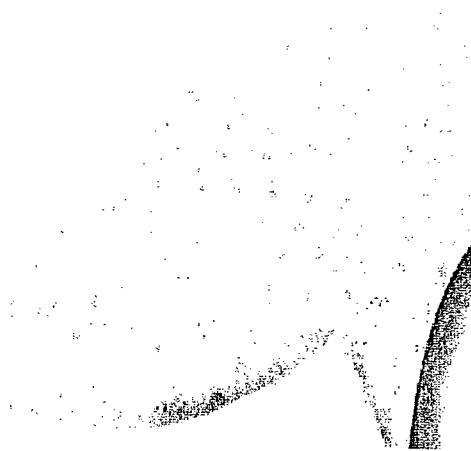

[One side scrubs]  
[One side wipes]

The terms "wipe(s)", "towel(s)", "towelette(s)", and "cloth(s)" and the product name may be used interchangeably except for within the product primary brand name.

[The following graphics and statements are optional.  
They are used to show examples of places the product can be used]

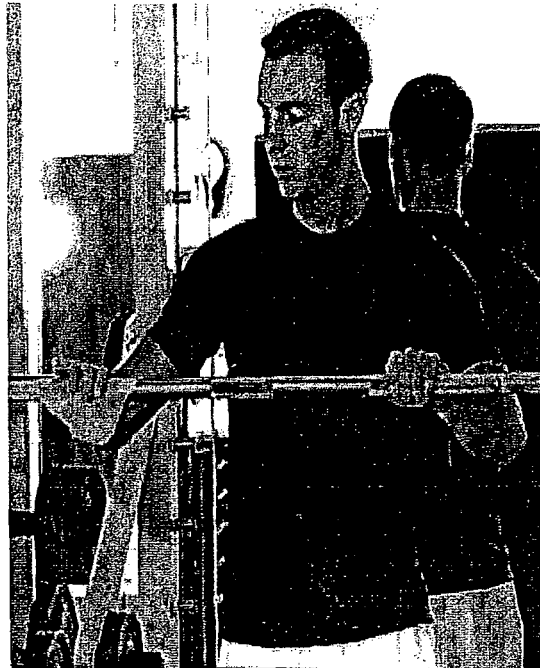
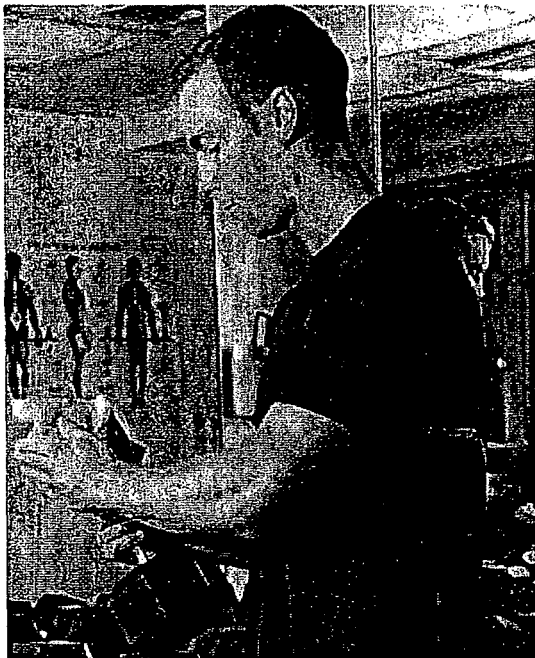
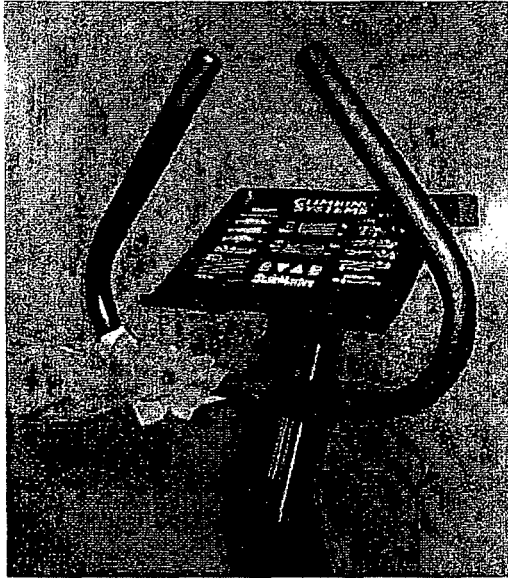

The terms "wipe(s)", "towel(s)", "towelette(s)", and "cloth(s)" and the product name may be used interchangeably except for within the product primary brand name.