

NOV - 1 2007

Ms. Cristina Griffin
Agency for
Professional Disposables International, Inc. (PDI)
c/o Delta Analytical Corp.
12510 Prosperity Drive, Suite 160
Silver Spring, MD 20904

Subject: **Sani-Cloth Germicidal Disposable Wipes**
EPA Registration Number 9480-4
Notification Application Dated October 15, 2007

Dear Ms. Griffin:

This will knowledge receipt of your notification, submitted under the provisions of FIFRA section 3c 9. Based on a review of the submitted material the following comment apply.

Proposed Amendment:

Label comments Per EPA letter dated 9/18/2007

General Comment:

Based on a review of the material submitted, the following comment apply:

The notification is acceptable. A copy has been inserted in your file for future reference.

Should you have any questions concerning this letter please contact Drusilla Copeland at (703) 308-6224 or Velma Noble (70) 308-6233

Sincerely,

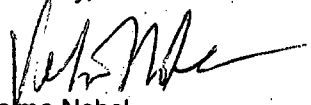

Velma Noble
Product Manager (31)
Regulatory Management Branch I
Antimicrobials Division (7510P)

CONCURRENCES

SYMBOL							
SURNAME							
DATE							

2817



United States
Environmental Protection Agency
 Washington, DC 20460

Registration
 Amendment
 Other

OPP Identifier Number
NOTIF

Application for Pesticide - Section I

1. Company/Product Number 9480-4	2. EPA Product Manager Velma Noble	3. Proposed Classification <input type="checkbox"/> None <input type="checkbox"/> Restricted
4. Company/Product (Name) Professional Disposables International, Inc. (PDI)/ Sani-Cloth Germicidal Wipes	PM# 31	
5. Name and Address of Applicant (Include ZIP Code) Professional Disposables International, Inc. (PDI) c/o Delta Analytical Corp. 12510 Prosperity Drive, Suite 160 Silver Spring, MD 20904 <input type="checkbox"/> Check if this is a new address	6. Expedited Review. In accordance with FIFRA Section 3(c)(3)(b)(i), my product is similar or identical in composition and labeling to: EPA Reg. No. _____ Product Name _____	

Section - II

Amendment - Explain below
 Resubmission in response to Agency letter dated _____
 Notification - Explain below.
 Final printed labels in response to Agency letter dated _____
 "Me Too" Application.
 Other - explain below.

Explanation: Use additional page(s) if necessary. (For section I and Section II.)
Notification per PR Notice 98-10 to add minor changes and reader's notes to master label.

This notification is consistent with the provisions of PR Notice 98-10 and EPA regulations at 40 CFR 152.46, and no other changes have been made to the labeling or the confidential statement of formula of this product. I understand that it is a violation of 18 U.S.C. Sec. 1001 to willfully make any false statement to EPA. I further understand that if this notification is not consistent with the terms of PR Notice 98-10 and 40 CFR 152.46, this product may be in violation of FIFRA and I may be subject to enforcement action and penalties under sections 12 and 14 of FIFRA.

Section - III

1. Material this Product will be Packaged in:

Child-Resistant Packaging <input type="checkbox"/> Yes* <input type="checkbox"/> No	Unit Packaging <input type="checkbox"/> Yes <input type="checkbox"/> No	Water Soluble Packaging <input type="checkbox"/> Yes <input type="checkbox"/> No	2. Type of Container <input type="checkbox"/> Metal <input type="checkbox"/> Plastic <input type="checkbox"/> Glass <input type="checkbox"/> Paper <input type="checkbox"/> Other (Specify) _____
* Certification must be submitted.		If "Yes," Unit Package wgt. No. per container	If "Yes," Unit Package wgt. No. per container

3. Location of Net Contents Information
 Label Container

4. Size(s) of Retail Container

5. Location of Label Direction
 On Label
 On Labeling accompanying product

6. Manner in Which Label is Affixed to Product
 Lithograph
 Paper glued
 Stenciled
 Other _____

Section - IV

1. Contact Point (Complete items directly below for identification of individual to be contacted, if necessary, to process this application.)

Name Cristina Griffin	Title Agent for Professional Disposables International, Inc. (PDI)	Telephone No. (Include Area Code) 301-580-7971
---------------------------------	--	--

Certification
 I certify that the statements I have made on this form and all attachments thereto are true, accurate and complete. I acknowledge that any kind of knowingly false or misleading statement may be punishable by fine or imprisonment or both under applicable law.

2. Signature 	3. Title Agent for Professional Disposables International, Inc. (PDI)	6. Date Application Received (Stamped)
4. Typed Name Cristina Griffin	5. Date October 15, 2007	



3 8 17

October 15, 2007

Document Processing Desk (NOTIF)
Office of Pesticide Programs (7504P)
U.S. Environmental Protection Agency
One Potomac Yard
2777 S. Crystal Drive, Room S-4900
Arlington VA 22202

Attn: Velma Noble, PM 31

RE: Notification per PR Notice 98-10 to add minor changes and reader's notes to master label
Product: Sani-Cloth Germicidal Wipes, EPA Reg. No. 9480-4
Company: Professional Disposables International, Inc. (PDI)

Dear Ms. Noble:

On behalf of PDI, I am submitting a notification per PR Notice 98-10 for the product Sani-Cloth Germicidal Wipes, EPA Reg. No. 9480-4.

Background

In EPA's stamped label dated Sept 19, 2007, EPA provided sixteen label comments. A few of the comments require interpretation. Since the wording is crucial for the final printed label to avoid contradictory statements, we will submit the final printed label to satisfy EPA's stamped label requirements, after the notification is approved. We also are adding a few minor label changes unrelated to EPA's stamped label comments.

Label Changes

All label notification changes are highlighted in the label and described below:

Minor Change: Page 1

- Change to one of the establishment numbers
- Adding "manufactured for" as an option
- Substituting the company name to reflect EPA's change of name/ownership approval of June 29, 2007.

Adding deodorizing heading and reader's note :

EPA's stamped label letter of 9/19/07, Labeling Comment #1 e stated: "On page 6 of the label reference is made that product can be used to deodorize hard non porous surfaces. However, no directions are provided. The claim must either be deleted or directions provided." We have

added optional "Deodorizing" directions on page 9 and on page 6 have added a reader's note "[Note: Deodorizing directions must be used when deodorizing claims (claims involving odor control) are used.]"

Adding reader's note to clarify bathroom bacteria claims

EPA's stamped label letter of 9/19/07, Labeling Comment #1 g stated: "On page 6 of the proposed label list the relevant bacteria and viruses after the claims "Effective against bathroom bacteria." We have added the reader's note

"use at least two bacteria and two viruses from this list"

and have added the bacteria and viruses as requested.

Adding a mark to "germ" claims and a reader's note to clarify

EPA's letter states that the term "germs" must be qualified anywhere it appear on the label. We have added a mark wherever the word "germs" appears to link it to the following reader's note on page 8:

[*All "germ" claims must be linked to bacteria (minimum: Salmonella and Staph) and at least one virus with an asterisk or footnote. For example: Front panel: "Effective against household germs*" Back panel: "*Kills Salmonella enterica, Staphylococcus aureus, Herpes Simplex Type 2, and Influenza A/Hong Kong"]

Flu virus claims

We have added "Influenza A2/Hong kong" wherever the claims "flu virus" appear. We also have added the following reader's note at the bottom of page 8 as a clarification:

"[When organisms are listed next to a claim, the organisms may be listed in a footnote instead of directly next to the claim]"

Added Graphics

We have added the following graphics to the label

- A graphic showing spot cleaning of finished floors (page 10)

Enclosures

- EPA form 8570-1
- 1 copy of the revised label (additions highlighted)

If you have any questions regarding this submission, please contact me at 301-680-7971 or cgriffin@delta-ac.com.

Sincerely,

Cristina Griffin
Agent for PDI

Enclosures

cc: David Jones, PDI

SANI-CLOTH® GERMICIDAL WIPES GERMICIDAL DISPOSABLE CLOTH

ACTIVE INGREDIENTS:

n-Alkyl (68% C ₁₂ , 32% C ₁₄) dimethyl ethylbenzyl ammonium chlorides.....	0.25%
n-Alkyl (60% C ₁₄ , 30% C ₁₆ , 5% C ₁₂ , 5% C ₁₈) dimethyl benzyl ammonium chlorides.....	0.25%
OTHER INGREDIENTS	99.50%
TOTAL	100.00%

KEEP OUT OF REACH OF CHILDREN
DANGER

See back [side] panel for additional precautionary statements

NET CONTENTS

___ # OF CLOTHS [SIZE of each cloth]

EPA Reg. No.: 9480-4

EPA Est. No. : 9480-NY-1

or

EPA Est. No. A=9480-NY-1, B=72956-WI-1

Alpha character will precede batch code on product

[Manufactured by [or for]]:

Professional Disposables International, Inc.

Two Nice-Pak Park, Orangeburg, NY 10962-1376

[website address] [phone number]

First Aid:

Call a poison control center or doctor for treatment advice. Have the product container or label with you when calling a poison control center or doctor, or going for treatment

If in eyes:

-Hold eye open and rinse slowly and gently with water for 15-20 minutes. Remove contact lenses, if present, after the first 5 minutes, then continue rinsing.

If on skin:

-Take off contaminated clothing.

-Rinse skin immediately with plenty of water for 15-20 minutes.

The terms "wipe(s)", "towel(s)", "towelette(s)", and "cloth(s)" and the product name may be used interchangeably except for within the product primary brand name.

Precautionary Statements

Hazards to Humans and Domestic Animals

Danger. Causes irreversible eye damage. Harmful if absorbed through skin. Do not get in eyes or on clothing. Avoid contact with skin. Wash thoroughly with soap and water after handling and before eating, drinking, chewing gum, using tobacco, or using restroom. Remove and wash contaminated clothing before reuse.

Physical or chemical hazard

Combustible. Do not use or store near heat or open flame. Do not use on natural marble, windows, unpainted wood, brass, clear plastic or colored grout.

[in accordance with EPA stamped label of November 1, 2006, "all ATCC numbers for the organisms tested should appear on the label."]

Bactericidal

Tuberculocidal

Virucidal*

[Bactericidal, Tuberculocidal and Virucidal* in 2 minutes]

*Adenovirus Type 5 (ATCC VR-5), Herpes Simplex Type 2 (ATCC VR-734), Influenza A2/Hong Kong (ATCC VR-544), Human Coronavirus (ATCC VR-740) Strain 229E, Respiratory Syncytial Virus (RSV), Rhinovirus (ATCC VR-1110), Rotavirus Strain WA, Vaccinia virus (ATCC VR-1354), HIV-1[†], Hepatitis B Virus[†], Hepatitis C Virus[†]

Virucidal against Adenovirus Type 5, Herpes Simplex Type 2, Influenza A2/Hong Kong, Human Coronavirus, Respiratory Syncytial Virus (RSV), Rhinovirus, Rotavirus, Vaccinia virus, HIV-1[†], Hepatitis B Virus[†], Hepatitis C Virus[†]

[Product name] kills bacteria listed on this label

Burkholderia cepacia (ATCC 25416)

Candida albicans (ATCC 14053)

Escherichia coli (E. coli) (ATCC 11229)

Escherichia coli O157:H7(ATCC 35150)

ESBL Producing Escherichia coli (E. coli) (ATCC BAA-196)

Klebsiella pneumoniae (ATCC 4352)

Methicillin Resistant Staphylococcus aureus (MRSA) (ATCC 33592)

Mycobacterium bovis BCG (Tuberculosis) (ATCC 35743)

Pseudomonas aeruginosa (ATCC 15442)

Salmonella enterica (ATCC 10708)

Staphylococcus aureus (ATCC 6538)

Vancomycin Resistant Enterococcus faecalis (VRE) (ATCC 51299)

in the presence of organic soil (5% blood serum)

[Product name] is virucidal against Adenovirus Type 5, Herpes Simplex Type 2 (causative agent of genital herpes), Influenza A2/Hong Kong (representative of the common flu virus), Human Coronavirus, Respiratory Syncytial Virus (RSV), Rhinovirus, Rotavirus, and Vaccinia virus in the presence of organic soil (5% blood serum).

[†]KILLS HIV-1 (AIDS VIRUS), HEPATITIS B VIRUS (HBV) AND HEPATITIS C VIRUS (HCV) ON THE PRE-CLEANED ENVIRONMENTAL SURFACES/OBJECTS AND PRE-CLEANED EXTERNAL SURFACES OF ULTRASOUND TRANSDUCERS AND PROBES PREVIOUSLY SOILED WITH BLOOD/BODY FLUIDS in two (2) minutes at room temperature (68°- 77°F) or (20°- 25°C) in healthcare or other settings in which there is an expected likelihood of soiling of inanimate surfaces/objects with blood or body fluids, and in which the surfaces/objects likely to be soiled with blood or body fluids can be associated with the potential for transmission of Human Immunodeficiency Virus Type 1 (HIV-1) (associated with AIDS), Hepatitis B Virus (HBV) and Hepatitis C Virus (HCV).

The terms "wipe(s)", "towel(s)", "towelette(s)", and "cloth(s)" and the product name may be used interchangeably except for within the product primary brand name.

[Product name] is a premoistened, non-woven durable wipe containing a quaternary/alcohol based solution. Recommended for use in hospitals and other critical care areas where the control of the hazards of cross-contamination between treated surfaces is required. Use on hard non-porous surfaces and equipment listed on this label made of stainless steel, plastic, Formica® and glass. Some organisms are removed from the surface by thoroughly wiping the surface with the wipe. Most remaining organisms are killed within two (2) minutes by exposure to the liquid in the wipe.

Areas of Use:

Hospital and Healthcare Settings: Ambulances, Ambulatory Surgical Centers (ASC), Anesthesia, CAT Labs, CCU, Central Supply, Clinics, Dental Offices, Dialysis Clinics, Doctors Offices, Donation Centers [blood][plasma][semen][milk][apheresis], Emergency Medical Settings, Emergency Rooms, E.R., Emergency Vehicles, Eye Surgical Centers, Healthcare Settings, Health Care Facilities, Home Health Care, Hospices, Hospitals, ICU, Isolation Areas, Laboratory, Laundry rooms, Neonatal Intensive Care Units (NICU), Newborn nursery, Nursing homes, Operating Rooms (OR), Ophthalmic Offices, Orthopedics, Out-Patient Surgical Centers (OPSC), Patient Care Areas, Pediatrics, Pediatric Intensive Care Units (PICU), Physical therapy, Physician's offices, Radiology, Recovery Rooms, Rehabilitation, Respiratory therapy, Surgery, Surgical Centers, Transport vehicles and X-Ray.

and/or

Critical Care Areas: CCU, Emergency Rooms, E.R., ICU, Neonatal Intensive Care Units (NICU), Operating Rooms, Pediatric Intensive Care Units (PICU) and Surgery.

and

Hospital, Healthcare, and Critical Care Use Sites: May be used on hard non-porous surfaces of: ambulance equipment surfaces; bed railings; cabinets; carts; chairs; counters; dental chairs; dental countertops; dental unit instrument trays; endodontic equipment such as apex locators; exam tables; gurneys; infant incubators [interior and exterior surfaces of]; infant warmers [interior and exterior surfaces of]; isolettes; IV poles; laboratory equipment and surfaces; loupes; operating room tables and lights; operatory light switches; oxygen hoods; physical therapy (PT) equipment surfaces; slit lamps; spine back boards; stethoscopes; stretchers; **stools**; tables; telephones; toilet seats; and hard non-porous outside surfaces of: amalgamators and dental curing lights; anesthesia machines and respiratory therapy equipment; apheresis machines, diagnostic equipment, dialysis machines; patient monitoring equipment, patient support and delivery equipment, pulp testers and motors; toilets; and ultrasound transducers and probes.

Grocery Stores or Shopping Centers or Supermarkets or Delicatessens: Disinfects grocery cart handles and grocery cart child seats. Disinfects shopping cart handles and child seats.

Nursery or Daycare Centers: Bassinets [interior and exterior surfaces of], changing tables, cribs, diaper changing stations, diaper pails, infant/child care equipment surfaces, trash cans, toys and other hard, non-porous surfaces listed on this label.

Bathroom[s] or Public Restrooms: Basins, [bath]tubs, bathroom fixtures, cabinets, countertops, doorknobs, faucet[s], handles, hampers, handrails, shower[s] [stalls], showers, sinks, glazed tiled walls, glazed tiles, toilet [handle] [rim] [seats] [tank] [and other exterior surfaces of], urinals [exterior surfaces of] and vanity tops, and other hard non-porous surfaces listed on this label.

Health club facilities and Gyms: Gym equipment, weight-lifting surfaces and other hard non-porous surfaces listed on this label.

Schools or Classrooms or Office Buildings or Public Facilities or Manufacturing Facilities or Libraries or Public Telephones: Cabinets, chairs, computers, computer monitors, computer mouses, counters, countertops, desks, desktops, doorknobs, fax machines, filing cabinets, filing doors, filing handles, garbage cans, headsets, keyboards, railings, seats, sinks, tables, tabletops, telephones, toys, trash cans, work stations, and other hard non-porous surfaces listed on this label.

The terms "wipe(s)", "towel(s)", "towelette(s)", and "cloth(s)" and the product name may be used interchangeably except for within the product primary brand name.

Transport vehicles, school busses, public busses, fire trucks, police cars: Hard non porous surfaces of vehicles including steering wheel, hard plastic or metal flooring, seats, and walls.

Restaurants: Hard non porous, non food contact surfaces only including chairs, display cabinets, garbage cans, booster seats, floor, sinks, bathroom surfaces, glazed tiled walls, telephones, cash registers, and doorknobs.

This product is not to be used as a terminal sterilant/high level disinfectant on any surface or instrument that (1) is introduced directly into the human body, either into or in contact with the bloodstream or normally sterile areas of the body, or (2) contacts intact mucous membranes but which does not ordinarily penetrate the blood barrier or otherwise enter normally sterile areas of the body. This product may be used to pre-clean or decontaminate critical or semi-critical medical devices prior to sterilization or high level disinfection.

Directions for use

It is a violation of Federal law to use this product in a manner inconsistent with its labeling.

Dispenser directions:

Canister directions:

To start feed: Remove lid and discard inner seal from canister. Find center of wipe roll, remove first wipe for use, twist corner of next wipe into a point and thread through the hole in the canister lid. Pull through about one inch. Replace lid. Dispense remaining wipes as necessary by pulling out at an angle. When not in use keep center cap of lid closed to prevent moisture loss.

Travel pack directions:

Peel back label slowly. Pull out wipes as needed and reseal label. Unfold wipe.

Box directions:

Open along perforations as indicated. Remove packets as needed.

Packet:

Tear open packet. Unfold wipe and use as directed. Discard after single use.

SOLO® PAK:

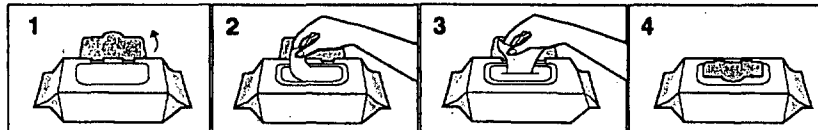

DO NOT FLUSH • STORE AT ROOM TEMPERATURE
DISPOSE OF USED WIPES IN TRASH RECEPTACLE • KEEP SOLO®
LID CLOSED WHEN NOT IN USE

REFILL PACKET

This refill package is made for use only in a [product name] canister; do not use this product in a canister for another product. Do not use the refill wipes in a container that is cracked or broken. Discard the cracked or broken container in accordance with the container disposal instructions on the label.

[Option 1]

Remove [entire] lid from canister. Tear open refill [package] at [notch] [mark] [arrow] and place [wipe] roll in empty canister. Follow directions on canister to dispense wipes.

[Option 2]

Remove [entire] lid from canister. Tear open refill [package] at [notch] [mark] [arrow]. Place [entire] refill package of wipes in empty canister. Follow directions on canister to dispense wipes.

The terms "wipe(s)", "towel(s)", "towelette(s)", and "cloth(s)" and the product name may be used interchangeably except for within the product primary brand name.

GENERIC:

Open lid. Pull out wipe. Close lid tightly.

DISINFECTING: To disinfect nonfood contact surfaces only: Use a wipe to remove heavy soil. Unfold a clean wipe and thoroughly wet surface. Treated surface must remain visibly wet for a full two (2) minutes. Use additional wipe(s) if needed to assure continuous two (2) minute wet contact time. Let air dry. *[When TB is included on the label, add the following or use the TB directions below.]* These directions also apply to Mycobacterium bovis BCG (Tuberculosis) at 68°F (20°C).

[The following sets of directions are optional and for hospital/medical facility use only:

Tuberculosis (TB) [Outbreaks]:

This product is effective against Mycobacterium bovis BCG (Tuberculosis) in one minute at 68°F (20°C). Use a wipe to remove heavy soil. Unfold a clean wipe and thoroughly wet surface. Treated surface must remain visibly wet for one (1) full minute. Use additional wipe(s) if needed to assure continuous one (1) minute wet contact time. Let air dry. Although efficacy at a one (1) minute contact time has been shown to be adequate against TB, this time is not sufficient for other organisms on the label. Therefore a 2 minute wet contact time must be used for all listed non TB organisms.

and/or

Ultrasound transducers and probes:

For use on external surfaces of ultrasound transducers and probes only.

To disinfect: Pre-clean gel from external surface of ultrasound transducer or probe to be disinfected by using a clean washcloth. Then thoroughly wet the probe with a wipe. Treated surface must remain visibly wet for a full two (2) minutes. Use additional wipe(s) if needed to assure continuous two (2) minute wet contact time. Let air dry.]

†SPECIAL INSTRUCTIONS FOR CLEANING AGAINST HIV-1, HEPATITIS B VIRUS AND HEPATITIS C VIRUS OF SURFACES/OBJECTS SOILED WITH BLOOD/BODY FLUIDS

Personal protection: When using this product, wear disposable protective gloves, protective gowns, face masks, or eye coverings as appropriate when handling HIV-1 (AIDS Virus), HBV or HCV infected blood or body fluids.

Cleaning procedure: All blood and other body fluids must be thoroughly cleaned from surfaces and objects before disinfection by the germicidal wipe. Open, unfold first germicidal wipe to remove heavy soil.

Disposal of infectious materials: Dispose of used wipe in accordance with local regulations for infectious waste disposal.

Contact time: Use second germicidal wipe to thoroughly wet surface. Allow to remain wet two (2) minutes, let air dry

[Use storage/disposal statement A if canister directions used. Use storage/disposal statement B if travel pack or packet directions used.]

Storage and disposal

Statement A: For canisters and refill dispensers:

Storage: Do not store near heat or open flame. When not in use keep center cap of lid closed to prevent moisture loss.

Towelette Disposal: Do not reuse towelette. Dispose of used towelette in trash. Do not flush in toilet.

Dispenser Disposal: Do not reuse empty container. Triple rinse and offer for recycling. If recycling is not available, put in trash collection.

[If refillable container is being used, substitute the following: Refill Dispenser Disposal: Triple rinse cracked or broken containers and offer for recycling. If recycling is not available, discard in trash.]

Statement B: For packets, travel packs, and [refill] packets:

Storage: Do not store near heat or open flame.

Towelette Disposal: Do not reuse towelette. Dispose of used towelette in trash. Do not flush in toilet.

Travel Pack [or Solo® Pak or Refill Packet] Disposal: Put empty travel pack [or Solo® Pak or refill packet] in trash collection.

The terms "wipe(s)", "towel(s)", "towelette(s)", and "cloth(s)" and the product name may be used interchangeably except for within the product primary brand name.

Optional Claims and Descriptors [Note: Deodorizing directions must be used when deodorizing claims (claims involving odor control) are used]

X" x Y" [wipes]

___% bigger [[quilted] wipes] [vs. X" x Y" wipes]

___# pre-saturated towelettes X" x Y"

After use, just toss wipe(s) away

Always ready to use

An effective method to deodorize and disinfect against odor-causing organisms on hard non-porous surfaces listed on this label.

An effective way to disinfect hard, non-porous environmental surfaces listed on this label.

A non-woven disposable cloth for use in hospitals and other critical care areas where control between treated surfaces is required.

Antibacterial

Antimicrobial

A Sani-Surface® Brand

Are pre-measured to have the recommended amount of germicidal solution, wipe after wipe.

Assures proper dilution strength, product effectiveness and standardized technique.

Bleach-free [formula]

Can help reduce the risk of cross contamination on treated surfaces

Cellulosic non-woven disposable cloth

Contains [name of active ingredient], the [same] active ingredient used in [Brand-name]

Contains [number] canisters [plus] [and] [number] refills

Convenient

Deodorize hard, non-porous surfaces [Use to]

Deodorizes, and kills common household germs*

Diamond-embossed wipe is low-linting [for sensitive equipment surfaces]

Disinfects [in [just] two [2] minutes]

Disinfect external surfaces of ultrasound transducers

Disinfect the precleaned surface

Disinfects and deodorizes

Disinfects hard, non-porous surface in 2 minutes

Disinfects and deodorizes in 2 minutes

Disinfecting towelettes

Disinfects grocery cart handles or shopping cart handles or grocery cart child seats or shopping cart child seats

Disinfects hard non-porous environmental surfaces listed on this label [Use to]

Dispenses one wipe at a time

Does not contain bleach

Does not produce mist or overspray

Double-sided scrubbing wipes

Durable, low-lint wipe designed for sensitive equipment surfaces

Easy

Easy [and convenient] way to [touch-up] [bathroom] [office] everyday

Easy drop-in refill[s]

[Easy] pop-up-tub

Easy start lid [package]

Easy to use [easy to refill]

[Economical] Refill[s] [one] [1] [two] [2] [three] [3] [four] [4] [various numbers] -pack

[Economical] Refills [now] available

Economy

Effective against bathroom bacteria and viruses [use at least two bacteria and two viruses from this list:] (Escherichia coli O157:H7, Salmonella enterica, Staphylococcus aureus, Herpes Simplex Type 2 (causative agent of genital herpes), Influenza A2/Hong Kong, (representative of the common flu virus), Rhinovirus, Rotavirus)

Effective against [the following micro-organisms on hard, non-porous surfaces] [list organisms]

Eliminates odors

The terms "wipe(s)", "towel(s)", "towelette(s)", and "cloth(s)" and the product name may be used interchangeably except for within the product primary brand name.
F:\shared\labels\pdi\9480-4\2007\9480-4 EPA notif label 101507.doc Page 6 of 13 October 15, 2007

Extra large disinfecting wipes
 Fast [Convenient] [Portable] way to disinfect hard non-porous surfaces
 For daily use
 Gets rid of –or- eliminates odors
 Helps prevent cross contamination on treated surfaces
 Includes ___ count refill [pack] [contains] ___ wipes
 Just –or- simply wipe exterior toilet surface –or- bathroom germs away
 Just [pull] wipe and toss
 Kill germs* and bacteria instead of germ paper towels, sponges and rags [Use this product to
 Kills bacteria and viruses in the bathroom] [use at least two bacteria and two viruses from this list:]
(Escherichia coli O157:H7, Salmonella enterica, Staphylococcus aureus, Herpes Simplex Type 2 (causative agent of genital herpes), Influenza A2/Hong Kong (representative of the common flu virus), Rhinovirus, Rotavirus) –or- on the exterior toilet surfaces
 Kills bacteria in 2 minutes
 Kills household –or- exterior toilet surface –or- bathroom germs [use at least two bacteria and two viruses from this list:] (Escherichia coli O157:H7, Salmonella enterica, Staphylococcus aureus, Herpes Simplex Type 2 (causative agent of genital herpes), Influenza A2/Hong Kong (representative of the common flu virus), Rhinovirus, Rotavirus)
 Leaves [bathroom] [office] disinfected [and smelling fresh]
 Multi-pack
 Multi-purpose disinfectant [Multi [-refill] pack]
 New and improved [use this for 6 months after announced improvement]
 New thicker wipe with diamond-embossed design
 New larger, thicker wipe [with diamond-embossed design]
 Next wipe pops up automatically [everytime] [!]
 No canister needed
 No measuring
 No mixing
 No sponges, no rags, no buckets, no mess
 Non-woven disposable cloth
 Now with [%] more towel [use this for 6 months after converting to larger towel]
 Now with [#] more wipes [use this for 6 months after converting to a larger number of towels]
 On-the-go disinfectant
 Perfect for disinfecting exterior toilet surfaces –or- around the exterior toilet surface
 Pop-up dispensing
 Pop-up [top]
 Portable
 Premeasured
 Premixed
 Premixed, premeasured, premoistened
 Premoistened
 Pull n/ Go [pack]
 Quick
 Quick [and easy] [and convenient] way to disinfect
 Quick and easy way to disinfect bathroom –or- exterior toilet surfaces
 Quick and easy way to disinfect hard, nonporous surfaces
 Ready to Use
 [Refill] package contains [one] [1] [two] [2] [three] [3] [four] [4] [various numbers] [wet] [premoistened] [wipe] [refill[s]] [roll[s]]
 Refill [size] [pack] [value pack]
 Refillable [with ___# wipes] [dispenser] refill [pack] [for dispenser]
 Requires no mixing or measuring and are ready-to-use
 Resealable pouch [package] [container] inside
 Reuse your [empty] canisters [again [and again] [!]
 Sample
 Scrubbing power of a sponge in a disinfecting wipe

The terms "wipe(s)", "towel(s)", "towelette(s)", and "cloth(s)" and the product name may be used interchangeably except for within the product primary brand name.

Strong, durable diamond-embossed textured wipe deodorizes
 Strong, durable low-lint wipe [designed for sensitive equipment surfaces]
 Tear at perforation
 Textured diamond-embossed design deodorizes hard, non-porous surfaces
 Textured diamond-embossed design
 The 2-minute germicidal wipe [disinfectant wipe]
 Thick, heavy duty wipes are bactericidal, tuberculocidal and virucidal in 2 minutes
 Thick, large wipe disinfects
 Thick, textured wipe with diamond-embossed design
 Time to reorder
 Trial
 Tub with pop-up action
 Tub refill
 Twin pack
 Use to preclean or decontaminate critical or semi-critical medical devices prior to sterilization /
 high-level disinfection
 [Use to] refill[s] [count] [wipe] canisters or tubs
 Value
 Versatile
 Wet wipes
 Where control of the hazards of cross contamination between treated surfaces is of prime importance
 [Wipes out] [Kills] [common] [household] [bacteria] [viruses*] [germs]
 [Wipes out] [Kills] [eliminates] [list organisms] in [just] [2 minutes]
 [Wipes out] [Kills] [the] flu virus (Influenza A2/Hong Kong)
 [Wipes out] [Kills] viruses* and bacteria [including the flu virus (Influenza A2/Hong Kong)]
 [Wiping] [soft] side for disinfecting
 With a bleach-free formula
 © [insert year] [insert company name]

1 [A footnote can be used to list organisms shown on page 2. Bacteria and virus can be separated into footnotes 1 and 2 if desired.]

[When organisms are listed next to a claim, the organisms may be listed in a footnote instead of directly next to the claim]

[* All pesticidal "germ" claims must be linked to bacteria (minimum: Salmonella and Staph) and at least one virus. For example: Front panel: "Kills germs*" Back panel: "Kills Salmonella enterica, Staphylococcus aureus, Herpes Simplex Type 2, and Influenza A/Hong Kong"

The terms "wipe(s)", "towel(s)", "towelette(s)", and "cloth(s)" and the product name may be used interchangeably except for within the product primary brand name.

CLEANING: [cleaning directions and claims have been grouped on this page (they were previously incorporated into other parts of the label)]

DIRECTIONS FOR USE:

[CLEANING] [and] [DEODORIZING]: Wipe surface with towelette until clean. Let air dry.

CLAIMS:

- An effective method to clean against odor-causing organisms on hard non-porous surfaces listed on this label.
- A One Step[†] Cleaner [and disinfectant] (except precleaning is required for blood and body fluids)
- Cleans
- Cleans and disinfects
- Cleans grocery carts and shopping carts
- Diamond-embossed pattern [texture] provides effective cleaning
- Easy One Step[†] Cleaning [and disinfecting] (except precleaning is required for heavy soil and blood and body fluids)
- Leaves [bathroom] [office] clean [and disinfected] [and smelling fresh]
- Leaves bathroom fresh and clean in [just] minutes
- Multi-purpose cleaner [Multi [-refill] pack]
- New thicker and larger diamond-embossed wipe cleans more surface area [use this for 6 months after converting to larger towel]
- Perfect for cleaning [and disinfecting] around the toilet
- Premoistened [wet] household cleaning wipe
- Premoistened with specially formulated cleaners to handle daily clean-ups without bottles, sponges or buckets [This product is]
- Quick [and easy] [and convenient] way to clean [and disinfect]
- Quick and easy way to clean [and disinfect] bathroom –or- exterior toilet surfaces
- Quick and easy way to clean [and disinfect] hard, nonporous surfaces
- [So] surfaces are more than [just] [clean] [they're] [disinfected]
- [Soft] side for [cleaning] dirt away
- Strong, durable diamond-embossed textured wipe cleans [and deodorizes]
- Textured wipe for effective cleaning
- Textured diamond-embossed design cleans hard, non-porous surfaces
- Textured diamond-embossed design helps remove soil from surfaces
- [Textured] [scrubby] [rough] side for [scrubbing] [cleaning] [removing] [wiping] [tough] [stains] [soils] [messes]
- Thick, large wipe cleans
- Wipe away odors
- [Wipes out] [Kills] germs[‡] [while it cleans]
- [Wiping] [soft] side for [wiping] dirt away [and disinfecting]

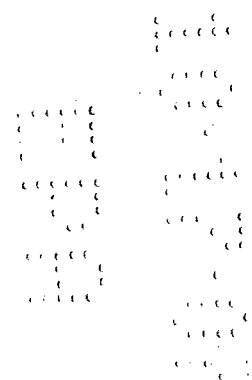

The terms "wipe(s)", "towel(s)", "towelette(s)", and "cloth(s)" and the product name may be used interchangeably except for within the product primary brand name.

F:\shared\labels\pdf\9480-4\2007\9480-4 EPA notif label 101507.doc October 15, 2007

Page 9 of 13

[The following graphics and statements are optional.
They may be placed anywhere on label/container.]

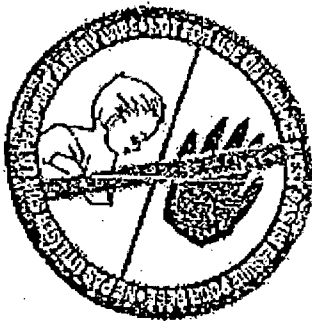

NOT A BABY WIPE

NOT FOR USE ON SKIN

This graphic shows use of the wipe dispenser.

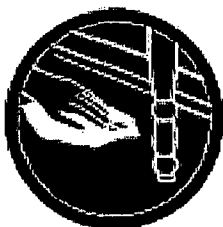

FINISHED FLOORS

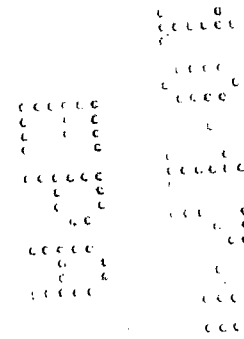

The terms "wipe(s)", "towel(s)", "towelette(s)", and "cloth(s)" and the product name may be used interchangeably except for within the product primary brand name.

[The following graphics and statements are optional.]

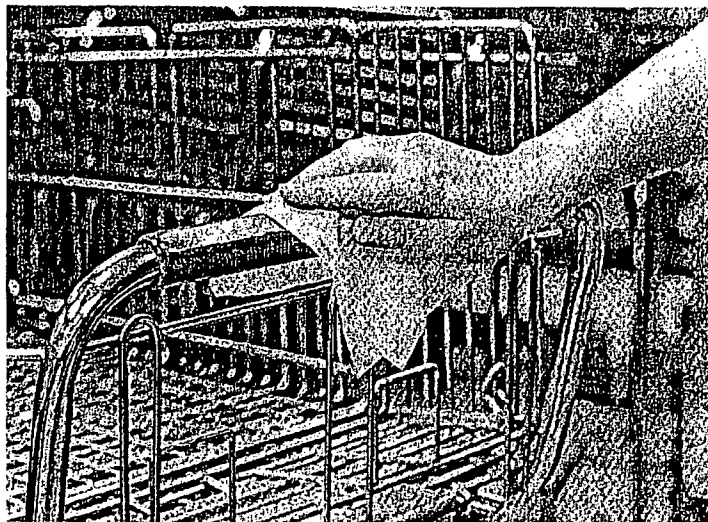
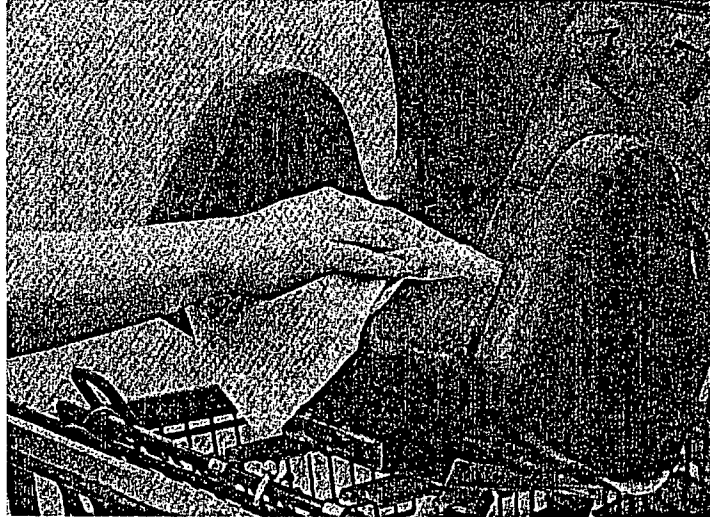

They may be placed anywhere on label/container.]

The terms "wipe(s)", "towel(s)", "towelette(s)", and "cloth(s)" and the product name may be used interchangeably except for within the product primary brand name.

[The following graphics and statements are optional.
They may be placed anywhere on label/container.]



Not a Skin Wipe.
For Use on Hard Surfaces Only.



Not a Skin Wipe.
For Use on Hard Surfaces Only.

The terms "wipe(s)", "towel(s)", "towelette(s)", and "cloth(s)" and the product name may be used interchangeably except for within the product primary brand name.

[The following graphics and statements are optional.
They may be placed anywhere on label/container.]



[One side scrubs]
[One side wipes]

