

8845-30
111
5
DEC 23 1985

Dr. R. L. Lipsey
Kenco Chemical & Mfg. Corp.
P.O. Box 6246
Jacksonville, FL 32236

Dear Dr. Lipsey:

Subject: Add Use on Ornamental Plants
Use of Hose End Sprayer
Rid-A-Bug Brand DD7-2
EPA Registration No. 8845-30
Your Application Dated November 22, 1985

The amendment referred to above, submitted in connection with registration under FIFRA sec. 3(c)(7)(A) is acceptable provided that you:

1. Submit and/or cite all data required for registration/reregistration of your product under FIFRA sec. 3(c)(5) when the Agency requires all registrants of similar products to submit such data.
2. Submit five (5) copies of your final printed labeling before you release the product for shipment.

If these conditions are not complied with, the registration will be subject to cancellation in accordance with FIFRA sec. 6(e). Your release for shipment of the product constitutes acceptance of these conditions.

A stamped copy of the label is enclosed for your records.

Sincerely yours,

Jay S. Ellenberger
Product Manager (12)
Insecticide-Rodenticide Branch
Registration Division (TS-767)

Enclosure

163659
18/03
300

92981:Ellenberger:16359,16358:RD:85/21:KENCO:12/19/85:Del:12/31/85:eg:VO

CONCURRENCES

| SYMBOL | SURNAME | DATE | | | | | | |
|--------|---------|------|--|--|--|--|--|--|
| | | | | | | | | |
| | | | | | | | | |
| | | | | | | | | |



Spectracide®

DURSBAN® LIQUID

Spectracide®
NO MIXING

It is a violation of Federal law to use this product in a manner inconsistent with its labeling.

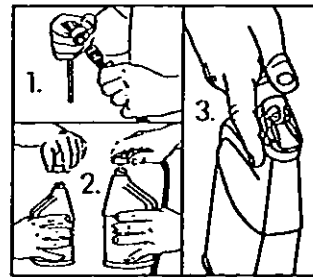
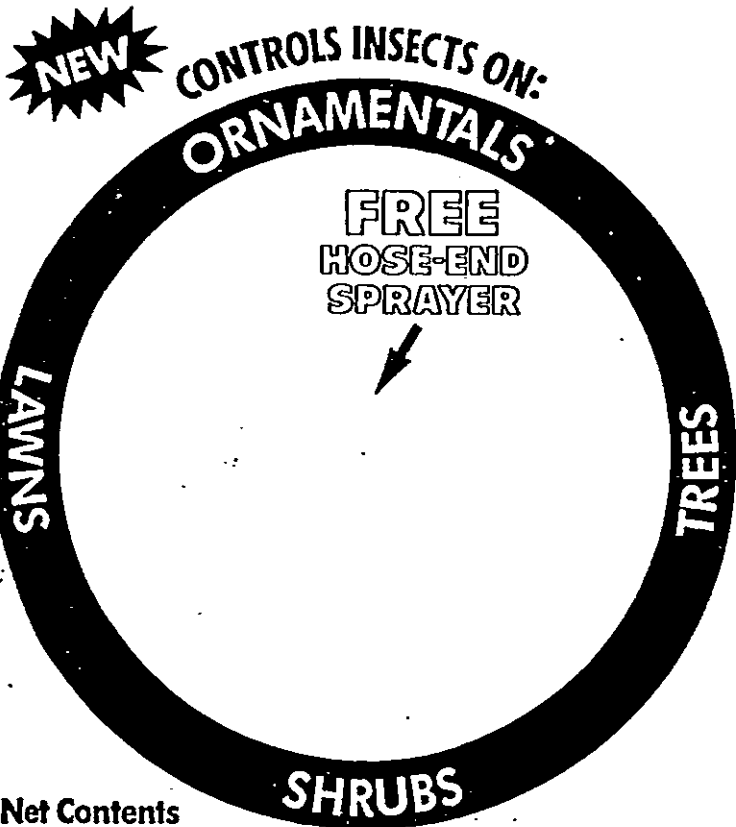

HOW TO USE

SHAKE SPECTRACIDE® DURSBAN LIQUID WELL BEFORE USING

1. Screw hose into back of yellow sprayer cap.
2. Remove white cap from bottle (save cap for storage after use). Insert sprayer unit into bottle and secure tightly by turning bottle counterclockwise.
3. Turn on water supply. TO START FLOW OF INSECTICIDE, place index finger over hole on right side of yellow sprayer cap.
4. Spray evenly and completely over lawns and other infested areas. To use on ornamentals, spray Spectracide Dursban Liquid to the point of runoff. Hold about 3 feet above surface, moving at a steady pace to insure consistent, thorough coverage.
5. When treatment is complete, or you wish TO STOP FLOW OF INSECTICIDE for any reason, simply remove finger from hole to break siphon action.
6. TO STORE REMAINING INSECTICIDE: Turn off water supply and remove bottle from sprayer unit and hose by turning bottle clockwise. Replace white cap on bottle and tighten securely. Unscrew hose from sprayer unit and rinse unit in clear water. Place insecticide plus sprayer assembly back into carton and store in cool place.

Net Contents
16 fl. oz.

ACTIVE INGREDIENTS:
Chlorpyrifos 6.00%
Aromatic Petroleum Solvent 3.36%
INERT INGREDIENTS: 90.64%
TOTAL: 100.00%

**KEEP OUT OF REACH
OF CHILDREN
CAUTION**

See back panel for
additional precautions.

**NO MIXING — EASY-TO-USE
CONCENTRATED
COVERS 3,500 SQ. FT. OF LAWN**

**EASY-TO-USE
CONCENTRATED**

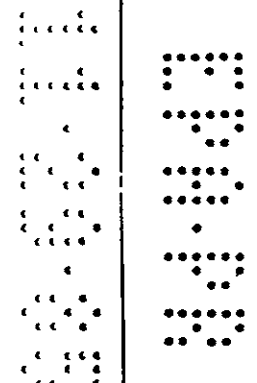

ACCEPTED
with CC-125, 1983
In EPA Label 125, 1983

DE 000 00

8845-30

Spectracide® DURSBAN® LIQUID

- READY-TO-USE HOSE END SPRAYER CAP ENCLOSED
- NO WASTE SIPHON FEED...CONTROL WITH ONE FINGER
- MIXES AUTOMATICALLY...NO MEASURING...NO MESS
 - WATER-BASED...WON'T BURN LAWNS
- RESIDUAL ACTION KEEPS KILLING FOR 4 WEEKS

PRECAUTIONARY STATEMENTS

Hazards to Humans and Domestic Animals

CAUTION: Harmful if swallowed. May be absorbed through skin. Avoid contact with skin, eyes and clothing. Keep away from feed and foodstuffs. Keep children and pets away from treated areas until dry. Wash hands thoroughly after using.

NOTE TO PHYSICIAN: Active ingredients contain a cholinesterase inhibitor. Treat symptomatically. Atropine is antidote.

STATEMENT OF PRACTICAL TREATMENT

IF SWALLOWED: Call physician immediately. Drink 1 or 2 glasses of water and induce vomiting by touching back of throat with finger.

IF ON SKIN: Remove contaminated clothing and wash exposed areas thoroughly with soap and water.

IF IN EYES: Flush thoroughly with clean water.

IF INHALED: Move to fresh air.

ENVIRONMENTAL HAZARDS

This product is toxic to fish, birds and other wildlife. Do not apply directly to water. Do not contaminate water by cleaning of equipment or disposal of wastes.

DISPOSAL

Do not reuse empty container or hose-end sprayer. Wrap and put in trash collection.

EPA Reg. No. 8845-30
EPA Est. No. 54487-GA-1, 769-GA-1
Form No. 30600-B ©1985

Manufactured for:
Kenco Chemical & Mfg. Corp.
Jacksonville, Florida 32205-6246

Spectracide® is a registered trademark of Kenco Chemical & Mfg. Corp.
*Dursban is a registered trademark of Dow Chemical Company.



Spectracide® NO MIXING

Use SPECTRACIDE DURSBAN LIQUID on lawns, flowers, shrubs, evergreens, vines, shade and flowering trees to control these insects:

| | |
|--------------|------------------|
| Ants | Mealybugs |
| Aphids | Millipedes |
| Armyworms | Mole Crickets |
| Bagworms | Palmetto Bogs |
| Centipedes | Silverfish |
| Chiggers | Sod Webworms |
| Chinchbugs | Sowbugs |
| Cockroaches | Spiders |
| Crickets | Spittlebugs |
| Cutworms | Thrips (exposed) |
| Earwigs | Ticks |
| Fleas | Waterbugs |
| Grasshoppers | Whiteflies |
| Leafhoppers | |

Note: Do not use on azaleas, camelias, poinsettias, rose bushes or variegated ivy because of possible injury to these plants.

EASY-TO-USE CONCENTRATED