



UNITED STATES ENVIRONMENTAL PROTECTION AGENCY
WASHINGTON, D.C. 20460

OFFICE OF CHEMICAL SAFETY
AND POLLUTION PREVENTION

April 30, 2021

Angela M. Coco
Product Development Engineer
Hercon Environmental
Aberdeen Road, P.O. Box 435
Emigsville, PA 17318-0435

Subject: Non-PRIA (Pesticide Registration Improvement Act) Labeling Amendment – Update directions for use; Add graphics; Update options claims; Update warranty statement; Updates to reflect supplemental distributor packaging

Product Name: Hercon® LURE N KILL Japanese Beetle
EPA Registration Number: 8730-57
Application Date: 02/08/2021
OPP Submission Number: 1064752

Dear Ms. Coco:

The amended labeling referred to above, submitted in connection with registration under the Federal Insecticide, Fungicide, and Rodenticide Act (FIFRA), as amended, is acceptable.

This approval does not affect any terms or conditions that were previously imposed on this registration. You continue to be subject to existing terms or conditions on your registration and any deadlines connected with them.

A stamped copy of your labeling is enclosed for your records. This labeling supersedes all previously accepted labeling. You must submit one (1) copy of the final printed labeling before you release this product for shipment with the new labeling. In accordance with 40 CFR § 152.130(c), you may distribute or sell this product under the previously approved labeling for 18 months from the date of this letter. After 18 months, you may only distribute or sell this product if it bears this new revised labeling or subsequently approved labeling. “To distribute or sell” is defined under FIFRA section 2(gg) and its implementing regulation at 40 CFR § 152.3.

Should you wish to add/retain a reference to your company’s website on your label, then please be aware that the website becomes labeling under FIFRA and is subject to review by the U.S. Environmental Protection Agency (EPA). If the website is false or misleading, the product will be considered to be misbranded and sale or distribution of the product is unlawful under FIFRA section 12(a)(1)(E). 40 CFR § 156.10(a)(5) lists examples of statements the EPA may consider false or misleading. In addition, regardless of whether a website is referenced on your product’s label, claims

Page 2 of 2
EPA Reg. No. 8730-57
OPP Submission No. 1064752

made on the website may not substantially differ from those claims approved through the registration process. Therefore, should the EPA find or if it is brought to our attention that a website contains false or misleading statements or claims substantially differing from the EPA-approved registration, the website will be referred to the EPA's Office of Enforcement and Compliance Assurance.

Your release for shipment of this product constitutes acceptance of these terms. If these terms are not complied with, this registration will be subject to cancellation in accordance with FIFRA section 6.

If you have any questions, please contact Susannah Powell via email at powell.susannah@epa.gov.

Sincerely,

A handwritten signature in blue ink that reads "Andrew C. Bryceland". The signature is fluid and cursive, with the first name being the most prominent.

Andrew Bryceland, Team Leader
Biochemical Pesticides Branch
Biopesticides and Pollution
Prevention Division (7511P)
Office of Pesticide Programs

Enclosure

ACCEPTED
04/30/2021
Under the Federal Insecticide, Fungicide
and Rodenticide Act as amended, for the
pesticide registered under
EPA Reg. No. 8730-57

HERCON® LURE N KILL® JAPANESE BEETLE

- Master Label Includes:
- Main Label
 - Sub-registrant labels/ Label text specific to supplemental distributors
 - Optional Label Claims

HERCON® LURE N KILL® JAPANESE BEETLE

Alternative Brand Names (henceforth ABN):

LURE N KILL ® JAPANESE BEETLE

JAPANESE BEETLE DUAL LURE

EPA Reg. No. 8730-57

Made in the USA by:

Aberdeen Road Company d/b/a HERCON ENVIRONMENTAL

P.O. Box 435 Emigsville, PA 17318-0435

EPA Est. No. 8730-PA-01

Questions? 866-4-HERCON

®"HERCON" is a registered trademark of Aberdeen Road Company, Emigsville, PA.

{Bait pack sample wrapper templates. Not to scale. NOTE: Product sold in additional packaging container with complete market label}

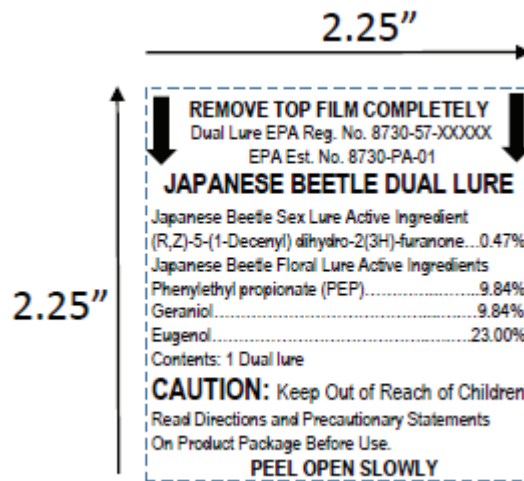
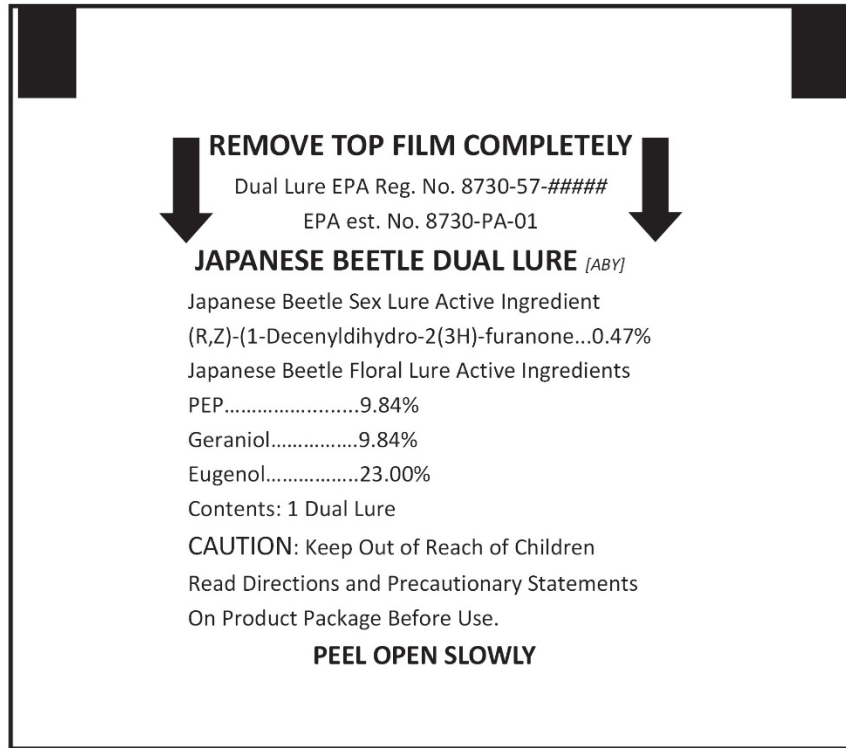

MAIN LABEL

HERCON® LURE N KILL® JAPANESE BEETLE

[refill][ABN]

JAPANESE BEETLE SEX LURE

ACTIVE INGREDIENT: BY BW

(R,Z)-5-(1-Decenyl) dihydro-2(3H)-furanone.....00.47%[†] OTHER
INGREDIENTS:.....99.53%
TOTAL:.....100.00%

[†] Equivalent to 1 mg japonilure pheromone A.I./dispenser Net Weight 0.008 oz (0.23 g)/Sex Lure.

JAPANESE BEETLE FLORAL (FOOD) LURE

ACTIVE INGREDIENT: BY BW

Phenylethyl propionate (PEP).....9.84%
Geraniol.....9.84%
Eugenol.....23.00% **OTHER**
INGREDIENTS:.....57.32%
TOTAL:.....100.00%

Net Weight: 0.26 oz (7.4 g)/Floral Lure

CONTENTS: One Sex Lure/Floral Lure Bait Pack NET WEIGHT: 0.27 oz (7.63 g)/Bait Pack

KEEP OUT OF REACH OF CHILDREN

CAUTION

(See other panel for additional precautionary statements)

[Master Label- (main label) Back Panel]

This LURE N KILL® Japanese Beetle Bait Pack consists of a dual sex lure and floral (food) lure system, which attracts two to five times more Japanese beetles than traps with only a single lure. The lures combine to draw male and female Japanese beetles into a trap...and away from valuable ornamentals, fruit trees, vegetables, flowers and shrubs.

This product contains no killing agent to damage the environment and will not harm beneficial insects or attract nuisance animals. Because of the unique controlled release system, the japonilure sex pheromone and floral attractant bait pack is designed to last for the entire trapping season. This LURE N KILL® Japanese Beetle Trap Bait pack was developed for the LURE N KILL® Japanese Beetle Trap but may also be used with other brands of Japanese Beetle traps.

PRECAUTIONARY STATEMENTS

Hazards to Humans and Domestic Animals

CAUTION: Harmful if absorbed through skin. Avoid contact with skin, eyes and clothing. Causes moderate eye irritation. Harmful if swallowed. Wash hands thoroughly with soap and water after handling and before eating, drinking, chewing gum, using tobacco or using the toilet.

FIRST AID

If on skin or clothing:
<ul style="list-style-type: none"> - Take off contaminated clothing. - Rinse skin immediately with plenty of water for 15-20 minutes. - Call a poison control center or doctor for treatment advice.
If in eyes:
<ul style="list-style-type: none"> - Hold eye open and rinse slowly and gently with water for 15-20 minutes. Remove contact lenses, if present, after the first 5 minutes, then continue rinsing eye. - Call a poison control center or doctor for treatment advice.
If Swallowed:
<ul style="list-style-type: none"> - Call poison control center or doctor immediately for treatment advice. - Have person sip a glass of water if able to swallow* - Do not induce vomiting unless told to do so by the poison control center or doctor. - Do not give anything by mouth to an unconscious person
Have the product container or label with you when calling a poison control center or doctor, or going for treatment. Contact 1-800-858-7378 for emergency medical treatment advice.

DIRECTIONS FOR USE:

It is a violation of Federal law to use this product in a manner inconsistent with its labeling.

Do not open protective pouch until ready to use. Remove the bait from its protective package. Peel the protective cover (marked peel) from the LURE N KILL® Japanese Beetle Sex Lure/Floral Lure Bait Pack.

Remove the paper from the adhesive strip on the back of the Sex Lure/Floral Lure Bait Pack and attach the bait onto the trap vane.

Do not attempt to peel apart the bait pack. Best results are obtained by attaching the bait pack to the lower third of the trap vane.

REPLACEMENT:

Under ordinary weather conditions, LURE N KILL® Japanese Beetle Sex Lure/Floral Lure Bait Pack should be effective for about 12 weeks.

STORAGE AND DISPOSAL:

Do not contaminate water, food, or feed by storage and disposal.

PESTICIDE STORAGE: Store unopened sex lure/floral lure bait pack in a cool dry place or refrigerate until ready for use.

PESTICIDE DISPOSAL: Wastes resulting from the use of this product must be disposed of on site or at an approved waste disposal facility.

CONTAINER DISPOSAL: Non-refillable container. Do not reuse or refill this container. Wrap container and put in trash or offer for recycling

WARRANTY: To the extent consistent with applicable law, HERCON ENVIRONMENTAL makes no warranty, express or implied, for any particular purposes concerning the product, other than those which are contained on this label. HERCON ENVIRONMENTAL will not accept liability for damage or injury resulting from misuse.

Made in the USA by ABERDEEN ROAD COMPANY
d/b/a HERCON ENVIRONMENTAL
Emigsville, PA 17318-0467

EPA Reg. No 8730-57 EPA Est. No. 8730-PA-001

HERCON® and LURE N KILL® are registered trademarks of Aberdeen Road Company.

[Optional Marketing Claims]

Bait Pack Containing Long-Lasting Sex Lure and Floral (Food) Lure.
For Use in LURE N KILL® and Other Japanese Beetle Traps.
Protects Your Yard!
Lasts The Entire Beetle Season!
Easy to use.
No sprays.
No mess.

[Additional Optional Information]

[[Subregistrant] guarantee: If for any reason you, the consumer, are not satisfied with this product, mail us your original proof of purchase to obtain a full refund of your purchase price.]

Reuse this trap as many times as desired.

[Lure/Attractant] Refill(s) Available.

[Additional] [Disposable] [Liner] Bags Available Reusable Trap with [Lure/Attractant] Refill

[Additional] Lure/Attractant Refill(s) & Disposable [Liner] Bags Available Reuse Trap as Many Times as Desired. [Additional] Lure/Attractant Refill(s) & Disposable/Disposal [Liner] Bags Are Available for Purchase.

SUB-REGISTRANT LABEL A

{Note to Reviewer: This sub-registrant may package the Japanese beetle bait pack with the sub-registrant's Japanese Beetle Trap in the same carton or as a separate refill pack. The Japanese beetle bait pack serves as an attractant for the trap. The following label represents text that may appear on the outer carton label or label insert with a trap. Main carton/package may present the label information in multiple languages}

[Packaging Front Panel]

[Brand Name/ABY]

[THE] **JAPANESE BEELTE TRAP** [REFILL]

JAPANESE BEETLE FLORAL (FOOD) LURE

ACTIVE INGREDIENT	BY WT.
Phenylethyl propionate (PEP).....	9.84%
Geraniol.....	9.84%
Eugenol.....	23.00%
OTHER INGREDIENTS:.....	<u>57.32%</u>
TOTAL:.....	100.00%

Net Weight: 0.26 oz (7.4 g)/Floral Lure

JAPANESE BEETLE SEX LURE

ACTIVE INGREDIENT	BY WT.
(R,Z)-5-(1-Decenyl) dihydro-2(3H)-furanone.....	00.47%†
OTHER INGREDIENTS:.....	<u>99.53%</u>
TOTAL:.....	100.00%

† Equivalent to 1 mg japonilure pheromone A.I./dispenser
Net Weight 0.008 oz (0.23 g)/Sex Lure.

NET WEIGHT: 0.27 oz (7.63 g)/Bait Pack

KEEP OUT OF REACH OF CHILDREN

CAUTION

(SEE OTHER PANEL FOR ADDITIONAL PRECAUTIONARY STATEMENTS)

[Model No. 70102]

EPA Reg. No. 8730-57-42697

EPA est. No. 084829-PA-001

[back panel]

DIRECTIONS FOR USE:

It is a violation of Federal law to use this product in a manner inconsistent with its labeling.

TRAP ASSEMBLY.

1. Slide vanes together at the slots to form a cross.
2. Attach the twist tie by inserting about 4" through the holes in the top vane assembly as shown in the diagram and twist to secure the trap.
3. Attach one of the disposable collection bags to the vane assembly by gently sliding the holes in the bag over the cutout hooks on the lower end of the trap vanes.

BAIT PLACEMENT

4. Remove the bait pack from its protective packaging. Peel the protective cover from the [sub-

registrant] Japanese Beetle Trap Bait Pack.

5. Peel the paper from the adhesive strip on the back of the sex/floral lure bait pack and attach the bait onto the trap vane. Best results are obtained by attaching the bait pack to the lower third of the trap vane.

**TRAP PLACEMENT,
APPLICATION RATE AND USE:**

1. Place traps as beetles emerge and are noticed.
2. Place traps on the generally upwind side of vegetable gardens, flower gardens, ornamental shrub plantings and other outside landscape planting attacked by the beetles. Apply traps at the rate of one trap per 50 linear feet along two sides of plant perimeters. For example, if the site is 1-50 linear feet, place only one trap on each of the two sides. If the site is 51-100 linear feet, place two traps on each of the two sides, etc. DO NOT enclose the treated site with traps.
3. Hang traps from any suitable post or stand in sunny areas 3 to 5 feet above the ground.
4. Place traps at least 10 feet away from the plantings as they may attract beetles to foliage if placed closer.
5. Replace bags when full. If trap catches decline and beetles are still present, replace bait pack. Remove traps from site when beetles are no longer present.

STORAGE AND DISPOSAL

Do not contaminate water, food or feed by storage and disposal.

PESTICIDE STORAGE: Store unopened sex lure/floral lure bait pack in a cool dry place or refrigerate until ready to use.

PESTICIDE DISPOSAL: Wastes resulting from the use of this product must be disposed of on site or at an approved waste disposal facility.

CONTAINER DISPOSAL: Non-refillable container. Do not reuse or refill this container. Wrap container and put in trash or offer for recycling if available.

PRECAUTIONARY STATEMENTS

Hazards to Humans and Domestic Animals

CAUTION: Do not open protective pouch until ready to use. Harmful if absorbed through skin. Avoid contact with skin, eyes and clothing. Causes moderate eye irritation. Harmful if swallowed. Wash hands thoroughly with soap and water after handling and before eating, drinking, chewing gum, using tobacco or using the toilet.

FIRST AID

If on Skin or Clothing: • Take off contaminated clothing. • Rinse skin immediately with plenty of water for 15-20 minutes. • Call a poison control center or doctor for treatment advice.

If in Eyes: • Hold eye open and rinse slowly and gently with water for 15-20 minutes. • Remove contact lenses, if present, after the first 5 minutes, then continue rinsing eye. • Call a poison control center or doctor for treatment advice.

If Swallowed: • Call the poison control center or doctor immediately for treatment advice. • Have the person sip a glass of water if able to swallow. • Do not induce vomiting unless told to do so by the poison control center or doctor. • Do not give anything by mouth to an unconscious person.

Have the product container or label with you when calling a poison control center or doctor or going for treatment. Contact 1-800-858-7378 for emergency medical treatment advice.

{Additional languages may be included}

[WARRANTY: To the extent consistent with applicable law, [HERCON ENVIRONMENTAL/sub-registrant] makes no warranty, express or implied, for any particular purposes concerning the product, other than those which are contained on this label. [HERCON ENVIRONMENTAL/sub-registrant] will not accept liability for damage or injury resulting from misuse.]

[UPC Barcode]

[*Optional Marketing Claims*]

Jumbo size.

Easy to use.

Protects your yard.

No sprays, no mess.

Lasts the entire beetle season

www.saferbrand.com

[*Additional Optional text*]

[Sub-registrant] guarantee: If for any reason you, the consumer, are not satisfied with this product, mail us your original proof of purchase to obtain a full refund of your purchase price.

Reuse this trap as many times as desired.

[Lure/Attractant] Refill(s) Available.

[Additional] [Disposable] [Liner] Bags Available Reusable Trap with [Lure/Attractant] Refill

[Additional] Lure/Attractant Refill(s) & Disposable [Liner] Bags Available Reuse Trap as Many Times as Desired. [Additional] Lure/Attractant Refill(s) & Disposable/Disposal [Liner] Bags Are Available for Purchase.

[*Optional images*]

{**Color and style may vary**}

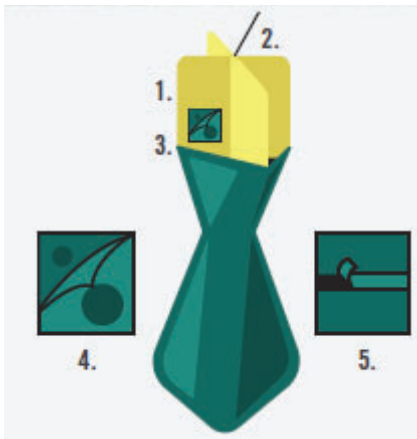

SUB-REGISTRANT LABEL B

{Note to Reviewer: This sub-registrant may package the Japanese beetle bait pack with the sub-registrant’s Japanese Beetle Trap in the same carton or as a separate refill pack. The Japanese beetle bait pack serves as an attractant for the trap. The following label represents text that may appear on the outer carton label or label insert with a trap. Main carton/package may present the label information in multiple languages}

[Packaging Front Panel]

[Brand Name/ABY]

[THE] JAPANESE BEELTE BAIT [REFILL]

JAPANESE BEETLE SEX LURE

ACTIVE INGREDIENT	BY WT.
(R,Z)-5-(1-Decenyl) dihydro-2(3H)-furanone.....	00.47%†
OTHER INGREDIENTS:.....	99.53%
TOTAL:.....	100.00%

† Equivalent to 1 mg japonilure pheromone A.I./dispenser
Net Weight 0.008 oz (0.23 g)/Sex Lure.

JAPANESE BEETLE FLORAL (FOOD) LURE

ACTIVE INGREDIENT	BY WT.
Phenylethyl propionate (PEP).....	9.84%
Geraniol.....	9.84%
Eugenol.....	23.00%
OTHER INGREDIENTS:.....	57.32%
TOTAL:.....	100.00%

Net Weight: 0.26 oz (7.4 g)/Floral Lure

KEEP OUT OF REACH OF CHILDREN

CAUTION

(See other panel for additional precautionary statements)

NET WEIGHT: 0.27 oz (7.63 g)/Bait Pack
CONTENTS: One sex lure/floral lure bait pack

[back panel]

THE JAPANESE BEETLE BAIT

PRECAUTIONARY STATEMENTS HAZARDS TO HUMANS AND DOMESTIC ANIMALS

CAUTION: Do not open protective pouch until ready to use. Harmful if absorbed through skin. Avoid contact with skin, eyes and clothing. Causes moderate eye irritation. Harmful if swallowed. Wash hands thoroughly with soap and water after handling and before eating, drinking, chewing gum, using tobacco or using the toilet.

FIRST AID

If on Skin or Clothing: Take off contaminated clothing. Rinse skin immediately with plenty of water for 15-20 minutes. Call a poison control center or doctor for treatment advice.

If in Eyes: Hold eye open and rinse slowly and gently with water for 15-20 minutes. Remove contact lenses, if present, after the first 5 minutes, then continue rinsing eye. Call a poison control center or doctor for treatment advice.

If Swallowed: Call the poison control center or doctor immediately for treatment advice. Have the person sip a glass of water if able to swallow. Do not induce vomiting unless told to do so by the poison control center or doctor. Do not give anything by mouth to an unconscious person.

Have the product container or label with you when calling a poison control center or doctor or going for treatment. Contact 1-800-858-7378 for emergency medical treatment advice.

DIRECTIONS FOR USE:

It is a violation of Federal law to use this product in a manner inconsistent with its labeling.

Do not open protective pouch until ready to use. Remove the bait from its protective package. Peel the protective cover from the [sub-registrant] Japanese Beetle Bait Pack. Remove the paper from the adhesive strip on the back of the bait pack and attach the bait onto the trap vane. **Do not attempt to peel apart the bait pack.** Best results are obtained by attaching the bait pack to the lower third of the trap vane.

REPLACEMENT: Under ordinary weather conditions, [sub-registrant] Japanese Beetle Bait Pack should be effective for about 12 weeks.

STORAGE AND DISPOSAL

Do not contaminate water, food or feed by storage and disposal. **Pesticide Storage:** Store unopened sex lure/floral lure bait pack in a cool dry place or refrigerate until ready to use. **Pesticide Disposal:** Wastes resulting from the use of this product must be disposed of on site or at an approved waste disposal facility. **Container Disposal:** Non-refillable container. Do not reuse or refill this container. Wrap container and put in trash or offer for recycling if available.

[WARRANTY: To the extent consistent with applicable law, [HERCON ENVIRONMENTAL/sub-registrant] makes no warranty, express or implied, for any particular purposes concerning the product, other than those which are contained on this label. [HERCON ENVIRONMENTAL/sub-registrant] will not accept liability for damage or injury resulting from misuse.]

EPA Reg. No. 8730-57-42697

EPA Est. No. 089287-PA-001

[Model #70006 0319]

Made in USA

[UPC Barcode]

[*Optional Marketing Claims*]

Jumbo size.

Easy to use.

Protects your yard.

No sprays, no mess.

Lasts the entire beetle season

[Additional Optional text]

Reuse this trap as many times as desired.

[Lure/Attractant] Refill(s) Available.

[Additional] [Disposable] [Liner] Bags Available Reusable Trap with [Lure/Attractant] Refill

[Additional] Lure/Attractant Refill(s) & Disposable [Liner] Bags Available Reuse Trap as Many Times as Desired. [Additional] Lure/Attractant Refill(s) & Disposable/Disposal [Liner] Bags Are Available for Purchase.

SUB-REGISTRANT LABEL C

{Note to Reviewer: This is for the sub-registrant's refill pack. The following label represents text that may appear on the outer carton label or label insert. Main carton/package may present the label information in multiple languages}

[Front Panel]

[BRAND NAME/ ABN] JAPANESE BEETLE TRAP REFILL

[ABN]

JAPANESE BEETLE FLORAL (FOOD) LURE

ACTIVE INGREDIENT:	BY WT.
Phenylethyl propionate (PEP).....	9.84%
Geraniol.....	9.84%
Eugenol.....	23.00%
OTHER INGREDIENTS:	<u>57.32%</u>
TOTAL:	100.00%

Net Weight: 0.26 oz (7.4 g)/Floral Lure

JAPANESE BEETLE SEX LURE

ACTIVE INGREDIENT:	BY WT
(R,Z)-5-(1-Decenyl) dihydro-2(3H)-furanone.....	00.47% [†]
OTHER INGREDIENTS:	<u>99.53%</u>
TOTAL:	100.00%

[†] Equivalent to 1 mg japonilure pheromone A.I./dispenser

Net Weight 0.008 oz (0.23 g)/Sex Lure

CONTENTS: Two Sex Lure/Floral Lure Bait Packs

NET WEIGHT: 0.27 oz (7.63 g)/Bait Pack

[WARRANTY: To the extent consistent with applicable law, [HERCON ENVIRONMENTAL/sub-registrant] makes no warranty, express or implied, for any particular purposes concerning the product, other than those which are contained on this label. [HERCON ENVIRONMENTAL/sub-registrant] will not accept liability for damage or injury resulting from misuse.]

This Japanese Beetle Bait Pack consists of a dual sex lure and floral (food) lure system, which attracts two to five times more Japanese beetles than traps with only a single lure. The lures combine to draw male and female Japanese beetles into a trap...and away from valuable ornamentals, fruit trees, vegetables, flowers and shrubs. This product contains no killing agent to damage the environment and will not harm beneficial insects or attract nuisance animals. Because of the unique controlled release system, the japonilure sex pheromone and floral attractant bait pack is designed to last for the entire trapping season.

**KEEP OUT OF REACH OF CHILDREN
CAUTION**

See other panel for additional precautionary statements

[Side Panel]

PACKAGE CONTAINS:

2 Bags
2 Bait Packs

[Back Panel]

DIRECTIONS FOR USE:

It is a violation of Federal law to use this product in a manner inconsistent with its labeling.

Do not open protective pouch until ready to use. Remove the bait from its protective package. Peel the protective cover (marked peel) from the [sub-registrant/ABY] Japanese Beetle Trap Refill sex lure/floral lure bait pack. Remove the paper from the adhesive strip on the back of the sex lure/floral lure bait pack and attach the bait onto the trap vane.

Do not attempt to peel apart the bait pack. Best results are obtained by attaching the bait pack to the lower third of the trap vane.

REPLACEMENT:

Under ordinary weather conditions, [sub-registrant] Japanese Beetle Trap Refill sex lure/floral lure bait pack should be effective for about 12 weeks.

STORAGE AND DISPOSAL:

Do not contaminate water, food, or feed by storage and disposal.

PESTICIDE STORAGE: Store unopened sex lure/floral lure bait pack in a cool dry place or refrigerate until ready for use.

PESTICIDE DISPOSAL: Wastes resulting from the use of this product must be disposed of on site or at an approved waste disposal facility.

CONTAINER DISPOSAL: Non-refillable container. Do not reuse or refill this container. Wrap container and put in trash or offer for recycling.

PRECAUTIONARY STATEMENTS

Hazards to Humans and Domestic Animals

CAUTION: [Do not open protective pouch until ready to use.] Harmful if absorbed through skin. Avoid contact with skin, eyes and clothing. Causes moderate eye irritation. Harmful if swallowed. Wash hands thoroughly with soap and water after handling and before eating, drinking, chewing gum, using tobacco or using the toilet

FIRST AID

If on skin or clothing:

- Take off contaminated clothing.
- Rinse skin immediately with plenty of water for 15-20 minutes.
- Call a poison control center or doctor for treatment advice.

If in eyes:

- Hold eye open and rinse slowly and gently with water for 15-20 minutes. Remove contact lenses, if present, after the first 5 minutes, then continue rinsing eye.
- Call a poison control center or doctor for treatment advice.

If Swallowed:

- Call poison control center or doctor immediately for treatment advice.
- Have person sip a glass of water if able to swallow*
- Do not induce vomiting unless told to do so by the poison control center or doctor.
- Do not give anything by mouth to an unconscious person

Have the product container or label with you when calling a poison control center or doctor, or going for treatment. Contact **1-800-858-7378** for emergency medical treatment advice.

{label may include directions in additional languages}

EPA Reg. No. 8730-57-91557

EPA Est. No. 91557-NJ-1

[UPC BARCODE]

[Possible Images]



[*Optional Marketing Claims*]

Bait Pack Containing Long-Lasting Sex Lure and Floral (Food) Lure.

For Use in LURE N KILL® and Other Japanese Beetle Traps.

Protects Your Yard!

Lasts The Entire Beetle Season!

Easy to use.

No sprays.

No mess.

For use in [sub-registrant] JAPANESE BEETLE TRAP

[*Additional Optional Information*]

[Sub-registrant] guarantee: If for any reason you, the consumer, are not satisfied with this product, mail us your original proof of purchase to obtain a full refund of your purchase price.

[WARRANTY: To the extent consistent with applicable law, [HERCON ENVIRONMENTAL/sub-registrant] makes no warranty, express or implied, for any particular purposes concerning the product, other than those which are contained on this label. [HERCON ENVIRONMENTAL/sub-registrant] will not accept liability for damage or injury resulting from

misuse.]

Reuse this trap as many times as desired.

[Lure/Attractant] Refill(s) Available.

[Additional] [Disposable] [Liner] Bags Available Reusable Trap with [Lure/Attractant] Refill
[Additional] Lure/Attractant Refill(s) & Disposable [Liner] Bags Available Reuse Trap as Many
Times as Desired. [Additional] Lure/Attractant Refill(s) & Disposable/Disposal [Liner] Bags Are
Available for Purchase.

SUB-REGISTRANT LABEL D

{Note to Reviewer: This sub-registrant may package the Japanese beetle bait pack with the sub-registrant's Japanese beetle trap in the same carton or as a refill pack. The Japanese beetle bait pack serves as an attractant for the trap. The following text below represents text that may appear on the outer carton label of a trap. Main carton/package may present the label information in multiple languages}

[Package/Carton Front Panel]

[BRAND NAME/ABN] JAPANESE BEETLE TRAP

[ABN]

JAPANESE BEETLE FLORAL (FOOD) LURE

ACTIVE INGREDIENT:	BY WT
Phenylethyl propionate (PEP).....	9.84%
Geraniol.....	9.84%
Eugenol.....	23.00%
OTHER INGREDIENTS:.....	57.32%
TOTAL:.....	100.00%

Net Weight: 0.26 oz (7.4 g)/Floral Lure

JAPANESE BEETLE SEX LURE

ACTIVE INGREDIENT:	BY WT
(R,Z)-5-(1-Decenyl) dihydro-2(3H)-furanone.....	00.47%†
OTHER INGREDIENTS:.....	99.53%
TOTAL:.....	100.00%

† Equivalent to 1 mg japonilure pheromone A.I./dispenser

Net Weight 0.008 oz (0.23 g)/Sex Lure

NET WEIGHT: 0.27 oz (7.63 g)/Bait Pack

[Net Contents: 1 trap/ 2 traps/ 3 Traps/ 6 traps]

[WARRANTY: To the extent consistent with applicable law, [HERCON ENVIRONMENTAL/sub-registrant] makes no warranty, express or implied, for any particular purposes concerning the product, other than those which are contained on this label. [HERCON ENVIRONMENTAL/sub-registrant] will not accept liability for damage or injury resulting from misuse.]

This Japanese Beetle Bait Pack consists of a dual sex lure and floral (food) lure system, which attracts two to five times more Japanese beetles than traps with only a single lure. The lures combine to draw male and female Japanese beetles into a trap...and away from valuable ornamentals, fruit trees, vegetables, flowers and shrubs. This product contains no killing agent to damage the environment and will not harm beneficial insects or attract nuisance animals. Because of the unique controlled release system, the japonilure sex pheromone and floral attractant bait pack is designed to last for the entire trapping season.

**KEEP OUT OF REACH OF CHILDREN
CAUTION**

See other panel for additional precautionary statements

[Package/carton Side panels and/or Back Panel]

DIRECTIONS FOR USE:

It is a violation of Federal law to use this product in a manner inconsistent with its labeling.

Trap assembly:

1. Slide vanes together at the slots to form a cross.
2. Attach the twist tie by inserting about 4” through the holes in the top vane assembly as shown in the diagram and twist to secure the trap.
3. Attach one of the disposable collection bags to the vane assembly by gently sliding the holes in the bag over the cutout hooks on the lower end of the trap vanes.

Bait placement:

4. Remove the bait pack from its protective package. Peel the protective cover (marked “peel”) from the Japanese Beetle Sex Lure/Floral Lure Bait Pack.
5. Peel the paper from the adhesive strip on the back of the sex/floral lure bait pack and attach the bait onto the trap vane. Do Not Attempt To Peel Apart The Bait. Best results are obtained by attaching the bait pack to the lower third of the trap vane.

TRAP PLACEMENT, APPLICATION RATE AND USE:

1. Place traps as beetles emerge and are noticed.
2. Place traps on the generally upwind side of vegetable gardens, flower gardens, ornamental shrub plantings and other outside landscape planting attacked by the beetles. Apply traps at the rate of one trap per 50 linear feet along two sides of plant perimeters. For example, if the site is 1-50 linear feet, place only one trap on each of the two sides. If the site is 51-100 linear feet place two traps on each of the two sides, etc. DO NOT enclose the treated site with traps.
3. Hang traps from any suitable post or stand in sunny areas 3 to 5 feet above the ground.
4. Place traps at least 10 feet away from the plantings as they may attract beetles to the foliage if placed closer.
5. Replace bags when full. If trap catches decline and beetles are still present, replace bait pack. Remove traps from the site when beetles are no longer present.

[Package/carton Side panels and/or Back Panel]

[Japanese Beetle Trap contains:]

[1 Bag] [3 Bags]

[2 interlocking vanes] [6 Interlocking vanes]

[1 lid]

[1 twist tie] [3 twist ties]

[1 bait pack] [3 bait packs]

STORAGE AND DISPOSAL:

Do not contaminate water, food, or feed by storage and disposal.

PESTICIDE STORAGE: Store unopened sex lure/floral lure bait pack in a cool dry place or refrigerate until ready for use.

PESTICIDE DISPOSAL: Wastes resulting from the use of this product must be disposed of on site or at an approved waste disposal facility.

CONTAINER DISPOSAL: Non-refillable container. Do not reuse or refill this container. Wrap container and put in trash or offer for recycling.

PRECAUTIONARY STATEMENTS

Hazards to Humans and Domestic Animals

CAUTION: Do not open protective pouch until ready to use. Harmful if absorbed through skin. Avoid contact with skin, eyes and clothing. Causes moderate eye irritation. Harmful if swallowed. Wash hands thoroughly with soap and water after handling and before eating, drinking, chewing gum, using tobacco or using the toilet.

water after handling and before eating, drinking, chewing

FIRST AID

If on skin or clothing:

- Take off contaminated clothing.
- Rinse skin immediately with plenty of water for 15-20 minutes.
- Call a poison control center or doctor for treatment advice.

If in eyes:

- Hold eye open and rinse slowly and gently with water for 15-20 minutes. Remove contact lenses, if present, after the first 5 minutes, then continue rinsing eye.
- Call a poison control center or doctor for treatment advice.

If Swallowed:

- Call poison control center or doctor immediately for treatment advice.
- Have person sip a glass of water if able to swallow*
- Do not induce vomiting unless told to do so by the poison control center or doctor.
- Do not give anything by mouth to an unconscious person

Have the product container or label with you when calling a poison control center or doctor, or going for treatment. Contact **1-800-858-7378** for emergency medical treatment advice.

{label may include directions in additional languages}

EPA Est. No. 91557-NJ-1
EPA Reg. No. 8730-57-91557

[UPC BARCODE]

[*Optional Marketing Claims*]

Bait Pack Containing Long-Lasting Sex Lure and Floral (Food) Lure.
For Use in LURE N KILL® and Other Japanese Beetle Traps.
Protects Your Yard[!]
Traps over a 5,000 sq. ft. Area
Lasts [The] Entire Beetle Season!
Easy to use[.][:]
No sprays[.]
No mess[.]
For use in [BRAND NAME/sub-registrant] JAPANESE BEETLE TRAP

[*Additional Optional Information*]

[Sub-registrant] guarantee: If for any reason you, the consumer, are not satisfied with this product, mail us your original proof of purchase to obtain a full refund of your purchase price.

[WARRANTY: To the extent consistent with applicable law, [HERCON ENVIRONMENTAL/sub-registrant] makes no warranty, express or implied, for any particular purposes concerning the product, other than those which are contained on this label. [HERCON ENVIRONMENTAL/sub-registrant] will not accept liability for damage or injury resulting from misuse.]

Reuse this trap as many times as desired.

[Lure/Attractant] Refill(s) Available.

[Additional] [Disposable] [Liner] Bags Available Reusable Trap with [Lure/Attractant] Refill

[Additional] Lure/Attractant Refill(s) & Disposable [Liner] Bags Available Reuse Trap as Many Times as Desired. [Additional] Lure/Attractant Refill(s) & Disposable/Disposal [Liner] Bags Are Available for Purchase.

[Possible Images. Color/appearance may vary]

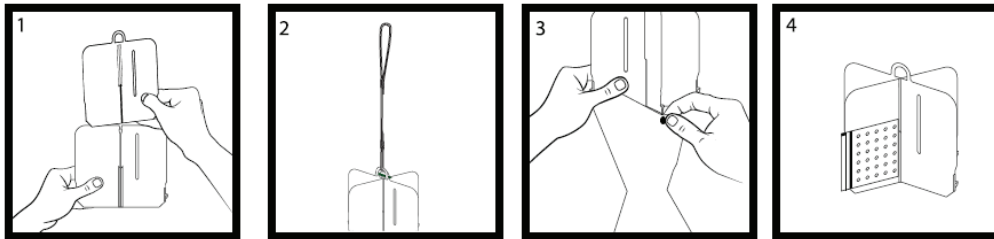

SUB-REGISTRANT LABEL E

{Note to Reviewer: This sub-registrant may package the Japanese beetle bait pack with the sub-registrant's Japanese beetle trap in the same carton or as a refill pack. The Japanese beetle bait pack serves as an attractant for the trap. The following text below represents text that may appear on the label insert of a trap. AP&G Co. may present the label information in multiple languages}

[Beetle trap instructions Insert, English Panel one/front panel]

[BRAND NAME/ABN] JAPANESE BEETLE TRAP

[ABN]

Japanese Beetle Floral (Food) Lure

ACTIVE INGREDIENTS:	BY WT
Phenylethyl propionate (PEP).....	9.84%
Geraniol.....	9.84%
Eugenol.....	23.00%
OTHER INGREDIENTS:.....	57.32%
TOTAL:.....	100.00%

Net Weight: 0.26 oz (7.4 g)/Floral Lure

Japanese Beetle Sex Lure

ACTIVE INGREDIENT:	BY WT
(R,Z)-5-(1-Decenyl) dihydro-2(3H)-furanone.....	00.47%†
OTHER INGREDIENTS:.....	99.53%
TOTAL:.....	100.00%

† Equivalent to 1 mg japonilure pheromone A.I./dispenser

Net Weight 0.008 oz (0.23 g)/Sex Lure

NET WEIGHT: 0.27 oz (7.63g)/Bait Pack

[CONTENTS: One Sex Lure/Floral Lure Bait Packs [Contents may appear on outer packaging but not on insert]]

[WARRANTY: To the extent consistent with applicable law, [HERCON ENVIRONMENTAL/sub-registrant] makes no warranty, express or implied, for any particular purposes concerning the product, other than those which are contained on this label. [HERCON ENVIRONMENTAL/sub-registrant] will not accept liability for damage or injury resulting from misuse.]

**KEEP OUT OF REACH OF CHILDREN
CAUTION**

See inside booklet for First Aid, additional precautionary Statements and complete Directions for Use.

[Insert English Panel two]

DIRECTIONS FOR USE:

It is a violation of Federal law to use this product in a manner inconsistent with its labeling.

TRAP ASSEMBLY:

1. Slide vanes together at the slots to form a cross.
2. Attach the twist tie by inserting about 4” through the holes in the top vane assembly as shown in the diagram and twist to secure the trap.
- 3 Attach one of the disposable collection bags to the vane assembly by gently sliding the holes in the bag over the cutout hooks on the lower end of the trap vanes. [image]

BAIT PLACEMENT:

4. Remove the bait pack from its protective package. Peel the protective cover (marked “peel”) from the Japanese Beetle Sex Lure/Floral Lure Bait Pack.
5. Peel the paper from the adhesive strip on the back of the sex/floral lure bait pack and attach the bait onto the trap vane. Do Not Attempt To Peel Apart The Bait. Best results are obtained by attaching the bait pack to the lower third of the trap vane.

TRAP PLACEMENT, APPLICATION RATE AND USE:

1. Place traps as beetles emerge and are noticed.
2. Place traps on the generally upwind side of vegetable gardens, flower gardens, ornamental shrub plantings and other outside landscape planting attacked by the beetles. Apply traps at the rate of one trap per 50 linear feet along two sides of plant perimeters. For example, if the site is 1-50 linear feet, place only one trap on each of the two sides. If the site is 51-100 linear feet place two traps on each of the two sides, etc. DO NOT enclose the treated site with traps.
3. Hang traps from any suitable post or stand in sunny areas 3 to 5 feet above the ground.
4. Place traps at least 10 feet away from the plantings as they may attract beetles to the foliage if placed closer.
5. Replace bags when full. If trap catches decline and beetles are still present, replace bait pack. Remove traps from the site when beetles are no longer present.

STORAGE AND DISPOSAL: Do not contaminate water, food, or feed by storage and disposal.
PESTICIDE STORAGE: Store unopened sex lure/floral lure bait pack in a cool dry place or refrigerate until ready for use.
PESTICIDE DISPOSAL: Wastes resulting from the use of this product must be disposed of on site or at an approved waste disposal facility.
CONTAINER DISPOSAL: Non-refillable container. Do not reuse or refill this container. Wrap container and put in trash or offer for recycling.

[Insert English Panel three]

PRECAUTIONARY STATEMENTS:

Hazards to Humans and Domestic Animals

CAUTION: Do not open protective pouch until ready to use. Harmful if absorbed through skin. Avoid contact with skin, eyes and clothing. Causes moderate eye irritation. Harmful if swallowed. Wash hands thoroughly with soap and water after handling and before eating, drinking, chewing gum, using tobacco or using the toilet.

FIRST AID

If on skin or clothing:
<ul style="list-style-type: none"> - Take off contaminated clothing. - Rinse skin immediately with plenty of water for 15-20 minutes. - Call a poison control center or doctor for treatment advice.
If in eyes:

<ul style="list-style-type: none"> - Hold eye open and rinse slowly and gently with water for 15-20 minutes. Remove contact lenses, if present, after the first 5 minutes, then continue rinsing eye. - Call a poison control center or doctor for treatment advice.
If Swallowed:
<ul style="list-style-type: none"> - Call poison control center or doctor immediately for treatment advice. - Have person sip a glass of water if able to swallow* - Do not induce vomiting unless told to do so by the poison control center or doctor. - Do not give anything by mouth to an unconscious person
Have the product container or label with you when calling a poison control center or doctor, or going for treatment. Contact 1-800-858-7378 for emergency medical treatment advice.

{label may include directions in additional languages}

[Insert Back Panel]

EPA Est. No. 91557-NJ-1
EPA Reg. No. 8730-57-91557

[UPC BARCODE]

[Optional Marketing Claims]

Bait Pack Containing Long-Lasting Sex Lure and Floral (Food) Lure.
For Use in LURE N KILL® and Other Japanese Beetle Traps.
Protects Your Yard[!]
Traps over a 5,000 sq. ft. Area
Lasts [The] Entire Beetle Season!
Easy to use[.][:]
No sprays[.]
No mess[.]
For use in [BRAND NAME/sub-registrant] JAPANESE BEETLE TRAP

[Additional Optional Information]

[Sub-registrant] guarantee: If for any reason you, the consumer, are not satisfied with this product, mail us your original proof of purchase to obtain a full refund of your purchase price.

Reuse this trap as many times as desired.
[Lure/Attractant] Refill(s) Available.
[Additional] [Disposable] [Liner] Bags Available Reusable Trap with [Lure/Attractant] Refill
[Additional] Lure/Attractant Refill(s) & Disposable [Liner] Bags Available Reuse Trap as Many Times as Desired. [Additional] Lure/Attractant Refill(s) & Disposable/Disposal [Liner] Bags Are Available for Purchase.

[Possible Images. Color/appearance may vary]

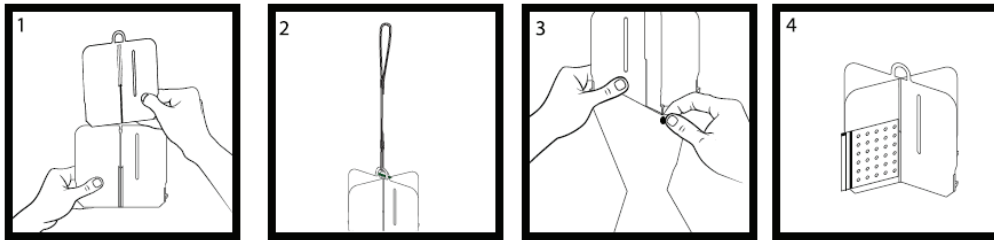

SUB-REGISTRANT LABEL F

{Note to Reviewer: This sub-registrant may package the Japanese beetle bait pack with the sub-registrant's trap in the same carton or as a refill pack. The Japanese beetle bait pack serves as an attractant for the trap. The following text below represents text that may appear on the outer carton/package label of a trap.}

[Package Front Panel]

[BRAND NAME/ABN] Japanese Beetle Mass Trap [Refill]

[ABN]

Japanese Beetle Sex Lure Active Ingredients:

ACTIVE INGREDIENT:	BY WT.
(R,Z)-5-(1-Decenyl) dihydro-2(3H)furanone.....	00.47%†
OTHER INGREDIENTS:.....	99.53%
TOTAL.....	100.00%

† Equivalent to 1 mg japonilure pheromone A.I./dispenser
Net Weight 0.008 oz (0.23 g)/Sex Lure.

JAPANESE BEETLE FLORAL (FOOD) LURE

ACTIVE INGREDIENT:	BY WT.
Phenylethyl propionate (PEP).....	9.84%
Geraniol.....	9.84%
Eugenol.....	23.00%
OTHER INGREDIENTS:.....	57.32%
TOTAL:.....	100.00%

Net Weight: 0.26 oz (7.4 g)/Floral Lure
CONTENTS: One Sex Lure/Floral Lure Bait Pack
NET WEIGHT: 0.27 oz (7.63 g)/Bait Pack

- [Japanese Beetle Trap Package:]
- [Top trap, including square funnel and set of interlocking vanes.]
- [Waxed-Cardboard Base]
- [One Bait Pack]
- [Two water-draining bags Four landscaping staples]
- [One complete trap assembly guide]

**KEEP OUT OF REACH OF CHILDREN
CAUTION**

(See other panel for additional precautionary statements)

[Package Back Panel]

JAPANESE BEETLE TRAP COMPONENTS:

TOP TRAP: Make the trap quick and easy to assemble.

LURE: Bait pack utilizing japonilure, the powerful Japanese beetle sex pheromone (attractant) and the three-component floral lure to attract both male and female beetle throughout the entire beetle season.

BEETLE DISPOSAL BAGS: Makes disposal of dead beetles easy to do. BASE: Made of double-layer waxed cardboard to stand up to the elements

LANDSCAPE STAPLES: To secure trap to ground.

This [sub-registrant] Japanese Beetle Bait Pack consists of a dual sex lure and floral (food) lure system, which attracts two to five times more Japanese beetles than traps with only a single lure. The lures combine to draw male and female Japanese beetles into a trap...and away from valuable ornamentals, fruit trees, vegetables, flowers and shrubs. This product contains no killing agent to damage the environment and will not harm beneficial insects or attract nuisance animals. Because of the unique controlled release system, the japonilure sex pheromone and floral attractant bait pack is designed to last for the entire trapping season.

PRECAUTIONARY STATEMENTS

-Hazards to Humans and Domestic Animals-

CAUTION: Do not open protective pouch until ready to use. Harmful if absorbed through skin. Avoid contact with skin, eyes and clothing. Causes moderate eye irritation. Harmful if swallowed. Wash hands thoroughly with soap and water after handling and before eating, drinking, chewing gum, using tobacco or using the toilet.

Storage and disposal

Do not contaminate water, food, or feed by storage and disposal.

PESTICIDE STORAGE: Store unopened sex lure/floral lure bait pack in a cool dry place or refrigerate until ready for use.

PESTICIDE DISPOSAL: Wastes resulting from the use of this product must be disposed of on site or at an approved waste disposal facility.

CONTAINER DISPOSAL: Non-refillable container. Do not reuse or refill this container. Wrap container and put in trash or offer for recycling.

First aid

If on skin or clothing:

- Take off contaminated clothing.
- Rinse skin immediately with plenty of water for 15-20 minutes.
- Call a poison control center or doctor for treatment advice.

If in eyes:

- Hold eye open and rinse slowly and gently with water for 15-20 minutes. Remove contact lenses, if present, after the first 5 minutes, then continue rinsing eye.
- Call a poison control center or doctor for treatment advice.

If Swallowed:

- Call poison control center or doctor immediately for treatment advice.
- Have person sip a glass of water if able to swallow*
- Do not induce vomiting unless told to do so by the poison control center or doctor.
- Do not give anything by mouth to an unconscious person

Have the product container or label with you when calling a poison control center or doctor, or going for treatment. Contact **1-800-858-7378** for emergency medical treatment advice.

Usage:

- The onset and end of Japanese beetle activity will vary by several weeks depending on weather. Warm, humid conditions will cause them to emerge earlier. Cold and rain will delay their activity. Be proactive and deploy traps before significant damage occurs.

- Check trap periodically and empty as needed. Empty trap more frequently to minimize odor of dead beetles, which may impede effectiveness of lure.
- Replace lure every 3 months, or as needed.
- Generally, beetles trapped in the container will die after several hours in the heat and sun. Pour/dump dead beetles from the bag into a trash container.

Directions for Use

It is a violation of Federal law to use this product in a manner inconsistent with its labeling. Before assembling trap, read enclosed directions for Japanese beetle trap assembly. Use one bait pack for each Japanese beetle trap. Apply the lure to the vane of the Japanese beetle trap. **REPLACEMENT:** Under ordinary weather conditions, [sub-registrant/ABN] Japanese Beetle Sex Lure/Floral Lure Bait Pack should be effective for about 12 weeks. Do not open protective pouch until ready to use. Remove the bait from its protective package. Peel the protective cover (marked peel) from the [sub-registrant/ABN] Japanese Beetle Sex Lure/Floral Lure Bait Pack. Remove the paper from the adhesive strip on the back of the Sex Lure/Floral Lure Bait Pack and attach the bait onto the trap vane. Do not attempt to peel apart the bait pack.

ASSEMBLY / SETUP:

Fold base into shape using tabs to hold sides together; bend flaps at bottom of base so that they lay flush with the ground.

Assemble top trap device by inserting side tab into slot; cross vane pieces slide into each other and then into four center slots on top of square funnel. Entire top trap assembly then slides into center square hole of lid.

Pull included plastic bag through center hole, hold in place with top trap. Make sure plastic bag does not block funnel.

Use landscape staples to secure trap to ground. Consider using weights such as bricks or rocks if placing trap on hard surface.

PLACE / SET LURE:

Peel away the clear plastic layer, which covers the “windows” of the sex lure and floral lure compartments. **DO NOT REMOVE LURES FROM BAIT PACK.**

Peel off the back paper covering the sticky side of the pouch.

Press the sticky side on any surface of the cross vane until it stays in place.

[WARRANTY: To the extent consistent with applicable law, [HERCON ENVIRONMENTAL/sub-registrant] makes no warranty, express or implied, for any particular purposes concerning the product, other than those which are contained on this label. [HERCON ENVIRONMENTAL/sub-registrant] will not accept liability for damage or injury resulting from misuse.]

Made in the USA [For sub-registrant] by
 ABERDEEN ROAD COMPANY [d/b/a HERCON ENVIRONMENTAL]
 Emigsville, PA 17318-0467

EPA Reg. No. 8730-57-93792

EPA Est No. 93792-MO-1

[Optional Marketing Claims]

Bait Pack Containing Long-Lasting Sex Lure and Floral (Food) Lure.

For Use in [sub-registrant] and Other Japanese Beetle Traps.

The Waxed Cardboard base is guaranteed to last the entire beetle season.

One complete trap assembly guide

[Additional optional text]

[Lure/Attractant] Refill(s) Available

[Additional] [Disposable] [Liner] Bags Available Reusable Trap with [Lure/Attractant] Refill

[Additional] Lure/Attractant Refill(s) & Disposable [Liner] Bags Available Reuse Trap as Many Times as Desired. [Additional] Lure/Attractant Refill(s) & Disposable/Disposal [Liner] Bags Are Available for Purchase.

SUB-REGISTRANT LABEL G

{Note to Reviewer: This sub-registrant may package the Japanese beetle bait pack with the [sub-registrant] Japanese Beetle Mass Trap in the same carton or as a refill pack. The Japanese beetle bait pack serves as an attractant for the trap. The following text below represents text that may appear on an insert with the trap.}

[Package Insert]

[LURE N KILL® JAPANESE BEETLE/ ABN]

[sub-registrant] Japanese Beetle Mass Trap [Refill]

[Homeowner's Japanese Beetle Trap Assembly Guide]

Japanese Beetle Sex Lure Active Ingredients:

ACTIVE INGREDIENT:	BY WT.
(R,Z)-5-(1-Decenyl) dihydro-2(3H)furanone.....	00.47%†
OTHER INGREDIENTS:.....	99.53%
TOTAL.....	100.00%

† Equivalent to 1 mg japonilure pheromone A.I./dispenser
Net Weight 0.008 oz (0.23 g)/Sex Lure.

JAPANESE BEETLE FLORAL (FOOD) LURE

ACTIVE INGREDIENT:	BY WT.
Phenylethyl propionate (PEP).....	9.84%
Geraniol.....	9.84%
Eugenol.....	23.00%
OTHER INGREDIENTS:.....	57.32%
TOTAL:.....	100.00%

Net Weight: 0.26 oz (7.4 g)/Floral Lure
CONTENTS: One Sex Lure/Floral Lure Bait Pack
NET WEIGHT: 0.27 oz (7.63 g)/Bait Pack

[Japanese Beetle Trap Package:]

[Top trap, including square funnel and set of interlocking vanes.]
[Waxed-Cardboard Base]
[One Bait Pack]
[Two water-draining bags Four landscaping staples]
[One complete trap assembly guide]

**KEEP OUT OF REACH OF CHILDREN
CAUTION**

(See other pages for additional precautionary statements)

This waxed cardboard mass-trapping [sub-registrant] Japanese Beetle Trap is easily assembled by interlocking the two bright yellow vanes and attaching a dual sex lure and floral (food) lure bait pack which attract two to five times more Japanese beetles than traps with only a single lure. The beetles attracted by the sex and floral lures and the vanes' bright color, strike the vane and fall into the box and die.

The active ingredient in the sex lure is japonilure, the exact copy of the powerful Japanese beetle sex pheromone (attractant), released by the adult female beetle to attract her mate. The food lure consists of three components which give off a distinctive floral scent that attracts both male and female beetles throughout the entire beetle season. This product contains no killing agent to damage the environment and will not harm beneficial insects or attract nuisance animals.

JAPANESE BEETLE TRAP COMPONENTS:

TOP TRAP: Make the trap quick and easy to assemble.

LURE: Bait pack utilizing japonilure, the powerful Japanese beetle sex pheromone (attractant) and the three-component floral lure to attract both male and female beetle throughout the entire beetle season.

BEETLE DISPOSAL BAGS: Makes disposal of dead beetles easy to do.

BASE: Made of double-layer waxed cardboard to stand up to the elements

LANDSCAPE STAPLES: To secure trap to ground.

PRECAUTIONARY STATEMENTS

-Hazards to Humans and Domestic Animals-

CAUTION: Do not open protective pouch until ready to use. Harmful if absorbed through skin. Avoid contact with skin, eyes and clothing. Causes moderate eye irritation. Harmful if swallowed. Wash hands thoroughly with soap and water after handling and before eating, drinking, chewing gum, using tobacco or using the toilet.

First aid

If on skin or clothing:

- Take off contaminated clothing.
- Rinse skin immediately with plenty of water for 15-20 minutes.
- Call a poison control center or doctor for treatment advice.

If in eyes:

- Hold eye open and rinse slowly and gently with water for 15-20 minutes. Remove contact lenses, if present, after the first 5 minutes, then continue rinsing eye.
- Call a poison control center or doctor for treatment advice.

If Swallowed:

- Call poison control center or doctor immediately for treatment advice.
- Have person sip a glass of water if able to swallow*
- Do not induce vomiting unless told to do so by the poison control center or doctor.
- Do not give anything by mouth to an unconscious person

Have the product container or label with you when calling a poison control center or doctor, or going for treatment. Contact **1-800-858-7378** for emergency medical treatment advice.

Directions for Use:

It is a violation of Federal law to use this product in a manner inconsistent with its labeling.

Before assembling trap, read enclosed directions for Japanese beetle trap assembly [Read directions for Japanese beetle trap assembly BEFORE using the bait pack]. Use one bait pack for each Japanese beetle trap. Apply the lure to the vane of the Japanese beetle trap. **REPLACEMENT:** Under ordinary weather conditions, [sub-registrant] Japanese Beetle Sex Lure/Floral Lure Bait Pack should be effective for about 12 weeks.

[TRAP] ASSEMBLY DIRECTIONS:

Fold base into shape using tabs to hold sides together; bend flaps at bottom of base so that they lay flush with the ground.

Assemble top trap device by inserting side tab into slot; cross vane pieces slide into each other and then into four center slots on top of square funnel. Entire top trap assembly then slides into center square hole of lid.

Pull included plastic bag through center hole, hold in place with top trap. Make sure plastic bag does not block funnel.

Use landscape staples to secure trap to ground. Consider using weights such as bricks or rocks if placing trap on hard surface.

[SETUP]

[ATTACHING THE DUAL LURE:] Peel away the clear plastic layer, which covers the “windows” of the sex lure and floral lure compartments. **DO NOT REMOVE LURES FROM BAIT PACK.**

Peel off the back paper covering the sticky side of the pouch. Press the sticky side on any surface of the cross vane until it stays in place. [ATTACHING THE DUAL LURE: Remove the lure from its protective pouch. Peel off the backing paper covering the sticky side of sex lure. Attach sex lure by pressing the sticky side against the yellow vane surface.]

Storage and disposal

Do not contaminate water, food, or feed by storage and disposal.

PESTICIDE STORAGE: Store unopened sex lure/floral lure bait pack in a cool dry place or refrigerate until ready for use.

PESTICIDE DISPOSAL: Wastes resulting from the use of this product must be disposed of on site or at an approved waste disposal facility.

CONTAINER DISPOSAL: Non-refillable container. Do not reuse or refill this container. Wrap container and put in trash or offer for recycling.

[WARRANTY: To the extent consistent with applicable law, [HERCON ENVIRONMENTAL/sub-registrant] makes no warranty, express or implied, for any particular purposes concerning the product, other than those which are contained on this label. [HERCON ENVIRONMENTAL/sub-registrant] will not accept liability for damage or injury resulting from misuse.]

Made in the USA [For sub-registrant] by
ABERDEEN ROAD COMPANY [d/b/a HERCON ENVIRONMENTAL]
Emigsville, PA 17318-0467

EPA Reg. No. 8730-57-93792
EPA Est No. 93792-MO-1

[Optional Marketing Claims]

Bait Pack Containing Long-Lasting Sex Lure and Floral (Food) Lure.
For Use in [sub-registrant] and Other Japanese Beetle Traps.
The Waxed Cardboard base is guaranteed to last the entire beetle season.
One complete trap assembly guide

[Additional optional text]

[Lure/Attractant] Refill(s) Available
[Additional] [Disposable] [Liner] Bags Available Reusable Trap with [Lure/Attractant] Refill
[Additional] Lure/Attractant Refill(s) & Disposable [Liner] Bags Available Reuse Trap as Many

Times as Desired. [Additional] Lure/Attractant Refill(s) & Disposable/Disposal [Liner] Bags Are Available for Purchase.