



UNITED STATES ENVIRONMENTAL PROTECTION AGENCY
WASHINGTON, DC 20460

OFFICE OF CHEMICAL SAFETY
AND POLLUTION PREVENTION

August 17, 2018

Emily Phalen
R&D
Contec, Inc.
252 Locust Grove
Spartanburg, SC 29303

Subject: PRIA Label and CSF Amendment – Adding new organisms to the label and updating the CSFs
Product Name: PeridoxRTU (Brand) One-Step Germicidal Wipes
EPA Registration Number: 8383-14
Application Date: 03/27/2018
Decision Number: 539779

Dear Ms. Phalen:

The amended label and CSFs referred to above, submitted in connection with registration under the Federal Insecticide, Fungicide and Rodenticide Act, as amended, are acceptable. This approval does not affect any conditions that were previously imposed on this registration. You continue to be subject to existing conditions on your registration and any deadlines connected with them.

A stamped copy of your labeling is enclosed for your records. This labeling supersedes all previously accepted labeling. You must submit one copy of the final printed labeling before you release the product for shipment with the new labeling. In accordance with 40 CFR 152.130(c), you may distribute or sell this product under the previously approved labeling for 18 months from the date of this letter. After 18 months, you may only distribute or sell this product if it bears this new revised labeling or subsequently approved labeling. "To distribute or sell" is defined under FIFRA section 2(gg) and its implementing regulation at 40 CFR 152.3.

Please note that the record for this product currently contains the following CSFs:

- Basic CSF dated 03/27/2018
- Alternate CSF 1 dated 03/27/2018
- Alternate CSF 2 dated 03/27/2018
- Alternate CSF 3 dated 03/27/2018
- Alternate CSF 4 dated 03/27/2018
- Alternate CSF 5 dated 03/27/2018

Should you wish to add/retain a reference to the company's website on your label, then please be aware that the website becomes labeling under the Federal Insecticide Fungicide and Rodenticide Act and is subject to review by the Agency. If the website is false or misleading, the product

would be misbranded and unlawful to sell or distribute under FIFRA section 12(a)(1)(E). 40 CFR 156.10(a)(5) list examples of statements EPA may consider false or misleading. In addition, regardless of whether a website is referenced on your product's label, claims made on the website may not substantially differ from those claims approved through the registration process. Therefore, should the Agency find or if it is brought to our attention that a website contains false or misleading statements or claims substantially differing from the EPA approved registration, the website will be referred to the EPA's Office of Enforcement and Compliance.

Your release for shipment of the product constitutes acceptance of these conditions. If these conditions are not complied with, the registration will be subject to cancellation in accordance with FIFRA section 6. If you have any questions, you may contact Aline Heffernan at 703-347-8602 or via email at heffernan.aline@epa.gov.

Sincerely,



John Hebert, Chief
Regulatory Management Branch 1
Antimicrobials Division (7510P)
Office of Pesticide Programs

Enclosure: Stamped Label

{Note to reviewer: All text in brackets [...] or parenthesis (...) is interchangeable or optional and may or may not be included on a final label. All text in braces {...} is for administrative purposes only and will not appear on a final label. Portions or all of the label may be bilingual. Variables such as CAPITALIZATION, plurals or singular, bold and italics are optional unless specified in 40 CFR. Listed uses and use sites can be used partially or in their entirety. Strike-through text means it has been removed. Highlighted text is new or laid out differently.} Portions or all of the label may be bilingual.

{FRONT PANEL}

[PeridoxRTU¹ (Brand) One-Step Germicidal Wipe]

Sporicidal[§], Tuberculocidal, Virucidal†, Fungicidal, Bactericidal

ACTIVE INGREDIENTS:

Hydrogen Peroxide 4.40%

Peroxyacetic Acid 0.23%

INERT INGREDIENTS: 95.37%

TOTAL INGREDIENTS 100.00%

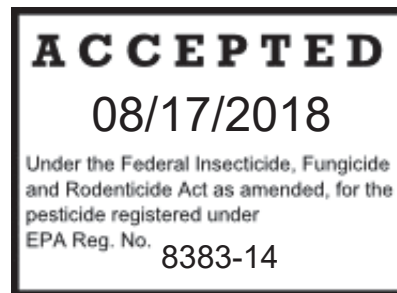

Keep Out Of Reach Of Children

WARNING

See back panel for additional precautionary statements

NET WT XXXX oz. (XXX liters) {Number may change prior to commercialization}

NET CONTENTS XXXX {Number may change prior to commercialization}

Pre-[Moistened][Saturated] Wipes XX"[in] x XX"[in] [(XX x XX cm)] {Number may change prior to commercialization}

E.P.A. Reg. No. 8383-14 {Registration number will appear on printed label}

E.P.A. Est. No. XXXX-XX-XXX {EPA Establishment number will appear on printed label}

[§]Pre-cleaning required. See back panel.

¹ May be alternately marketed under the brand names Vorro, Athletix, Contec XHD, Contec ATH, Contec Clean, Contec Professional, Contec Healthcare, PeridoxRTU and may be used in conjunction with "[Brand] One-Step Germicidal Wipe" or "[Brand] One-Step Germicidal Wipe" or "[Brand] Surface Sporocidal Wipe(s)", "[Brand] Surface Sporocidal Wipe(s)", "[Brand] (Sporicidal) (Wipe) with [(PeridoxRTU)(Peridox)] Technology"

{Note to reviewer: All text in brackets [...] or parenthesis (...) is interchangeable or optional and may or may not be included on a final label. All text in braces {...} is for administrative purposes only and will not appear on a final label. Portions or all of the label may be bilingual. Variables such as CAPITALIZATION, plurals or singular, bold and italics are optional unless specified in 40 CFR. Listed uses and use sites can be used partially or in their entirety. Strike-through text means it has been removed. Highlighted text is new or laid out differently.} Portions or all of the label may be bilingual.

[PeridoxRTU¹ (Brand) One-Step Germicidal Wipes] kill these organisms at the following contact times:

EFFICACY: [See Reference Sheet for a complete list of [pathogenic] organisms] [this product {or product name} is effective against] [A powerful disinfectant effective against]:

EFFICACY	
Sporicidal (3 minutes)	
<i>Clostridium difficile</i> spores	6 minutes
Bactericidal Claim (30 seconds)	
<i>Acinetobacter baumannii</i>	30 seconds
<i>Community-Acquired Methicillin Resistant Staphylococcus aureus [CA-MRSA]</i>	30 seconds
<i>Enterococcus faecalis VRE</i>	30 seconds
<i>ESBL-producing Escherichia coli</i>	30 seconds
<i>Escherichia coli O157:H7</i>	30 seconds
<i>Klebsiella pneumoniae</i>	30 seconds
<i>Legionella pneumophila</i>	30 seconds
<i>Listeria monocytogenes</i>	30 seconds
<i>Pseudomonas aeruginosa</i>	30 seconds
<i>Salmonella enterica</i>	30 seconds
<i>Serratia marcescens</i>	30 seconds
<i>Shigella sonnei</i>	30 seconds
<i>Staphylococcus aureus MRSA</i>	30 seconds
<i>Staphylococcus aureus, Vancomycin Resistant [VRSA]</i>	30 seconds
<i>Streptococcus pneumoniae, Penicillin Resistant (PRSP)</i>	30 seconds
Bactericidal Claim (2 minutes)	
<i>Campylobacter jejuni</i>	2 minutes
<i>Enterobacter aerogenes</i>	2 minutes
<i>Enterococcus hirae</i>	2 minutes
<i>Haemophilus influenzae</i>	2 minutes
<i>Proteus vulgaris</i>	2 minutes
<i>Salmonella typhimurium</i>	2 minutes
<i>Streptococcus pyogenes</i>	2 minutes
<i>Vibrio cholerae</i>	2 minutes
Virucidal Claim (30 seconds)	
Adenovirus type 2 (Adenoid 6) (ATCC VR-846)	30 seconds
Avian Influenza A Virus	30 seconds
Avian Influenza A (H5N1) Virus	30 seconds
Hepatitis B Virus (HBV)	30 seconds
Hepatitis C Virus (HCV)	30 seconds

{Note to reviewer: All text in brackets [...] or parenthesis (...) is interchangeable or optional and may or may not be included on a final label. All text in braces {...} is for administrative purposes only and will not appear on a final label. Portions or all of the label may be bilingual. Variables such as CAPITALIZATION, plurals or singular, bold and italics are optional unless specified in 40 CFR. Listed uses and use sites can be used partially or in their entirety. Strike-through text means it has been removed. Highlighted text is new or laid out differently.} Portions or all of the label may be bilingual.

Herpes Simplex Type 1	30 seconds
Herpes Simplex Type 2	30 seconds
HIV Type 1	30 seconds (HIV-1)
Human Coronavirus	30 seconds
Influenza A (H1N1) Virus	30 seconds
Respiratory Syncytial Virus	30 seconds
Rotavirus	30 seconds
Virucidal Claim (2 minutes)	
Avian Influenza A virus (H5N1)	2 minutes
Norovirus (Feline Calicivirus surrogate)	5 minutes
Poliovirus Type 1	5 minutes
Rhinovirus	5 minutes
Fungicidal Claim	
<i>Aspergillus niger</i> (non-porous surfaces)	1 minute
<i>Candida albicans</i>	1 minute
<i>Trichophyton mentagrophytes</i>	1 minute
Tuberculocidal Claim (1 minute)	
<i>Mycobacterium tuberculosis var. bovis</i>	1 minute

DISPENSING DIRECTIONS:

To open: Remove lid by twisting counter-clockwise and pulling up. [Discard inner seal from canister.] [Replace lid firmly.] [Close lid tightly].

To thread: Locate [(wipe)(towel)(towelette)(cloth)] at the center of the roll and insert corner of [(wipe)(towel)(towelette)(cloth)] through opening in lid. Twist corner of first [(wipe)(towel)(towelette)(cloth)] into a point and thread through the opening in the lid. Pull 1” (2.5cm) of [(wipe)(towel)(towelette)(cloth)] through the opening. [Replace lid firmly.] [Close lid tightly] [by twisting clockwise to lock lid into position].

To Dispense: Dispense by pulling [(wipes)(towels)(towelettes)(cloths)] through the opening. Dispenses one [(wipe)(towels)(towelettes)(cloths)] at a time. [Remaining [(wipes)(towels)(towelettes)(cloths)] automatically feed through for next use.] Close [top] [lid] tightly [between uses] [to prevent moisture loss].

{optional language for rigid top flexible flat pack/or rigid top tub}: Open top. Remove desired amount of [(wipes)(towels)(towelettes)(cloths)]. Close top when finished [to prevent moisture loss].

{optional language for peel-back flexible flat pack}: Carefully pull back [(seal)(label)]. Remove needed [(wipes)(towels)(towelettes)(cloths)]. Reseal between uses [to prevent moisture loss].

DIRECTIONS FOR USE: It is a violation of Federal law to use this product in a manner inconsistent with its labeling.

{Note to reviewer: All text in brackets [...] or parenthesis (...) is interchangeable or optional and may or may not be included on a final label. All text in braces {...} is for administrative purposes only and will not appear on a final label. Portions or all of the label may be bilingual. Variables such as CAPITALIZATION, plurals or singular, bold and italics are optional unless specified in 40 CFR. Listed uses and use sites can be used partially or in their entirety. Strike-through text means it has been removed. Highlighted text is new or laid out differently.} Portions or all of the label may be bilingual.

[PRODUCT NAME] can be used for disinfection and sanitization

[To Clean, Disinfect and Deodorize] [Combination Disinfection and Cleaning] : For nonfood contact surfaces only.

First, use a [PeridoxRTU¹ (Brand) One-Step Germicidal Wipe] to remove heavy soil if present, or if disinfecting against *C. difficile* spores. Then, use a new, clean wipe to disinfect. [Fold wipe [in half] to form a palm-sized [XX" x XX"] pad]. Thoroughly wipe area to be disinfected at room temperature [(20-24°C)]. Work from clean sections to dirty sections, refolding wipe periodically to expose a clean wipe surface. Treated area must remain visibly wet for a minimum of 6 minutes for sporicidal activity and non-enveloped viruses, 60 seconds for tuberculocidal and fungicidal activity, and 30 seconds for bactericidal activity and enveloped viruses. [Refer to chart for effective [(kill)(contact)] time of target organisms. Wipe target area enough to remain visibly wet for the specified kill time. Let air dry. [No rinsing required.] Do not reuse [or rewet] dried out wipes.

{The following graphics illustrating use directions may be included on the label and will only be used if applicable to the packaging the label would appear on}

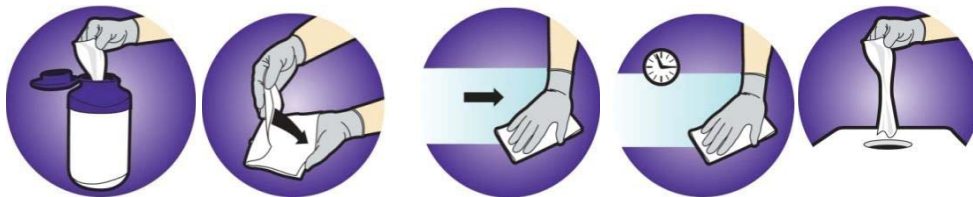

This product is not to be used as a terminal sterilant/high level disinfectant on any surface or instrument that (1) is introduced directly into the human body, either into or in contact with the blood stream or normally sterile areas of the body, or (2) contacts intact mucous membranes but which does not ordinarily penetrate the blood barrier or otherwise enter normally sterile areas of the body. [For use on non-critical surfaces only]. This product may be used to pre-clean or decontaminate critical or semi-critical medical devices prior to sterilization or high level disinfection.

[S]For *C. difficile* Sporicidal Disinfection:]

Personal Protection: Wear appropriate barrier protection such as gloves, gowns, masks [or] [and] eye covering.

Cleaning Procedure: Fecal matter/waste must be thoroughly cleaned from surfaces/objects before disinfection by application with a [(wipes)(towels)(towelettes) (cloths)]. Cleaning is to include vigorous wiping and/or scrubbing, until all visible soil is removed. Special attention is needed for high-touch surfaces. Surfaces in patient rooms are to be cleaned in an appropriate manner, such as from right to left or left to right, on horizontal surfaces, and top to bottom, on vertical surfaces, to minimize spreading of the spores. Restrooms are to be cleaned last. Do not reuse soiled cloths. Do not discard used wipes into toilet bowls.

Infectious Materials Disposal: Materials used in the cleaning process that may contain feces/waste are to be disposed of immediately in accordance with local regulations for infectious materials disposal.

{optional additional directions for use}

{Note to reviewer: All text in brackets [...] or parenthesis (...) is interchangeable or optional and may or may not be included on a final label. All text in braces {...} is for administrative purposes only and will not appear on a final label. Portions or all of the label may be bilingual. Variables such as CAPITALIZATION, plurals or singular, bold and italics are optional unless specified in 40 CFR. Listed uses and use sites can be used partially or in their entirety. Strike-through text means it has been removed. Highlighted text is new or laid out differently.} Portions or all of the label may be bilingual.

Ultrasound transducers and probes:

For use on external surfaces of ultrasound transducers and probes only. Pre-clean gel from external surface of ultrasound transducer or probe to be disinfected with a clean (wipe)(cloth). Wipe probe with [PeridoxRTU¹ (Brand) One-Step Germicidal Wipe]. Treated areas must remain visibly wet for a minimum of 6 minutes. Let air dry [No rinsing required.] Do not reuse dried out wipes.

[Specific Instructions for Blood Borne Pathogens:] KILLS HIV-1, HEPATITIS B VIRUS (HBV) AND HEPATITIS C VIRUS (HCV) ON PRE-CLEANED ENVIRONMENTAL SURFACES/OBJECTS PREVIOUSLY SOILED WITH BLOOD/BODY FLUIDS in health care settings and other settings in which there is an expected likelihood of soiling of inanimate surfaces/objects with blood/body fluids, and in which the surfaces/object likely to be soiled with blood/body fluids can be associated with the potential for transmission of Human Immunodeficiency Virus Type 1 (HIV-1) (associated with AIDS), Hepatitis B Virus, and Hepatitis C Virus.

SPECIAL INSTRUCTIONS FOR CLEANING AND DECONTAMINATION AGAINST HIV-1 (AIDS Virus), [HEPATITIS B VIRUS] HBV and [HEPATITIS C VIRUS] HCV OF SURFACE/OBJECTS SOILED WITH BLOOD/BODY FLUIDS.

Personal Protection: *{select one of the statements}* [Clean up should always be done wearing protective gloves, gowns, masks and eye protection.] [Disposable latex or vinyl gloves, gowns, face masks, or eye coverings as appropriate, must be worn during all cleaning of body fluids, blood, and decontamination.]

Cleaning Procedure: Blood/body fluids must be thoroughly cleaned from surfaces/objects before application of this product.

Contact Time: *{select one of the first two statements}* [Surface must remain visibly wet for 30 seconds to kill HIV-1, HBV and HCV.] [Leave surface visibly wet for 30 seconds to kill HIV-1, HBV and HCV.] Use contact times listed for all other organisms claimed. *{or}* [Consult Chart for all other contact times.]

Disposal of Infectious Material: Blood/body fluids should be autoclaved and disposed of according to Federal, State, and local regulations for infectious waste disposal.

Areas of Use:

Disinfectant for use on hard, non-porous surfaces in: *{sites will be selected from the following}* Animal Life Science Laboratories, Bathrooms, Churches, [ISO Class (number)] Cleanrooms, (Sterile) Compounding Facilities, Clinics, Colleges, Cosmetic Processing Facilities, Critical Care Units, Cruise Ships, Dialysis Centers, Funeral Homes, Dental Offices, Health Clubs, Hospices, Hospitality Establishments, Hospitals, Home Health Care, Hotels, Industrial Facilities, Institutions, Laboratories, Nail Salons, Nursing Homes, Medical Device Manufacturing, Morgues, Office Buildings, Oncology Centers, Outpatient Centers, Pharmaceutical Production Facilities, Pharmacies, Physical Therapy Locations, Physicians Offices, Public Facilities, Radiology, Recreational Facilities, Rehabilitation Centers, Research Laboratories, Retail and Wholesale Establishments, Shelters, Storage Areas, Surgery Centers, Locker Rooms, Long-Term

{Note to reviewer: All text in brackets [...] or parenthesis (...) is interchangeable or optional and may or may not be included on a final label. All text in braces {...} is for administrative purposes only and will not appear on a final label. Portions or all of the label may be bilingual. Variables such as CAPITALIZATION, plurals or singular, bold and italics are optional unless specified in 40 CFR. Listed uses and use sites can be used partially or in their entirety. Strike-through text means it has been removed. Highlighted text is new or laid out differently.} Portions or all of the label may be bilingual.

Care Facilities, The interior areas of the following Transport Vehicles: including ships, airplanes, automobiles, trucks, ambulances, and trains.

(For General Uses – Medical and Dental)

For Use in Health Care, [Dental], [Medical] [Facilities] and [Hospitals][Nursing Homes][clinics]{or insert any of the Medical/Dental Institutional Use sites from table 4}

This product is a one-step (hospital-use) germicidal (disinfectant) cleaner and deodorant (odor-counteractant) (odor neutralizer) designed for general cleaning, (and) disinfecting, (deodorizing) (of) hard, non-porous environmental surfaces.

It cleans quickly by removing {insert any soil from table 1} found in {insert any of the Medical/Dental Institutional Use sites from table 4}.

This product [or product name] is designed for use on hard, non-porous environmental surfaces: {insert any surface material from table 2} associated with [(high)(hand)(multi)] touch environmental surfaces [floors], [walls], [ceilings] – {or insert any Medical/Dental hard non-porous surface from table 3} – or – any hard non-porous washable (non-food contact) surface where disinfection is required. (This product's non-dulling formula eliminates the time and labor normally required for rinsing). (It (also) reduces odor-causing bacteria leaving surfaces smelling clean and fresh).

(For Veterinary Use)

For Use in Veterinary clinics,[Animal] [Premises] [facilities] [such] [as] [Pet (stores) (shops)], and [Animal [Life Science] Laboratories][Animal Housing][Animal Quarters and Kennels]{or insert any of the Veterinary Institutional Use sites from table 4} This product is a one-step germicidal (disinfectant) cleaner and deodorant (odor-counteractant) (odor neutralizer) designed for general cleaning, (and) disinfecting, (deodorizing) (of) hard, non-porous environmental surfaces.

It cleans quickly by removing {use any soil from table 1} found in [Animal] [Premises] [facilities] [such] [as] {insert any of the Veterinary Institutional Use sites from table 4}.

This product [or product name] is designed for use on hard, non-porous environmental surfaces: {insert any surface material from table 2} associated with hand touch environmental surfaces, [floors], [walls], [ceilings] – {or insert any Veterinary hard non-porous surface from table 3} – or – any hard non-porous washable (nonfood contact) surface where disinfection is required. (This product's non-dulling formula eliminates the time and labor normally required for rinsing). (It (also) reduces odor-causing bacteria leaving surfaces smelling clean and fresh).

(For Miscellaneous Use)

For Use [in] [on] [at] [Public areas], [Retail Businesses], [Office Buildings], [Educational Institutions], [Public Transportation System(s)], [Transportation Terminals], [Lodging Establishments], [Athletic/Recreational Facilities], [Non-food handling areas of Food Service Establishments/Restaurants] and Manufacturing facilities] [such as] {or insert any of the Miscellaneous Institutional Use site from table 4}
This product is a one-step germicidal disinfectant (detergent) cleaner and deodorant (odor-counteractant) (odor neutralizer) designed for use on hard, non-porous environmental surfaces

{Note to reviewer: All text in brackets [...] or parenthesis (...) is interchangeable or optional and may or may not be included on a final label. All text in braces {...} is for administrative purposes only and will not appear on a final label. Portions or all of the label may be bilingual. Variables such as CAPITALIZATION, plurals or singular, bold and italics are optional unless specified in 40 CFR. Listed uses and use sites can be used partially or in their entirety. Strike-through text means it has been removed. Highlighted text is new or laid out differently.} Portions or all of the label may be bilingual.

[Critical Care Areas]: *{sites will be selected from the following}* CCU, Emergency Rooms, ICU, Med-Surg, Neonatal Intensive Care Units (NICU), Operating Rooms, Pediatric Intensive Care Units (PICU), [and] Surgery.

[For Use on] [Disinfection of] Surfaces in Pharmaceutical and Cosmetic Processing Facilities:

This product {or product name} is recommended for use on hard, non-porous environmental surfaces such as floors, walls and processing equipment in pharmaceutical and cosmetic processing facilities [Pharmaceutical compounding and pharmaceutical manufacturing], [Controlled Environments such as cleanrooms with ISO classifications].

[Use Sites]: [May be used on hard non-porous surfaces of] *{surfaces will be selected from the following}* autoclaves, bed railings, blood glucose monitors, Biological Safety Cabinets (BSCs), Biosafety Cabinets (BSCs), Restricted Access Barrier Systems (RABS), Closed Restricted Access Barrier Systems (C-RABS), Open Restricted Access Barrier Systems (O-RABS), Mobile Cleanrooms, Half Suit Isolators, cabinets, (cleanroom) carts, chairs, closets, controlled environments, counters, countertops, desks, exam tables, exteriors of (refrigerators)(freezers), furniture, garbage cans, glove boxes, gurneys, Isolator Hood surfaces, isolettes, infant incubators and care cribs, IV poles, operation tables, pass through doors, door handles, doorknobs, patient room beds, phlebotomy trays, Primary Engineering Controls (PECs), PVC tubing, recycling bins, Secondary Engineering Controls (SECs), sterile compounding hoods, stethoscopes, stretchers, tables, bathrooms, sinks, faucets, toilet seats [and rims], towel dispensers, hand railings, lamps, light switch panels, stall doors, bath tubs, showers, hampers, tiled walls, telephones, door knobs, vanities, non-porous shelves, display cases, walls, [and] work surfaces.

For Use as a Bowl Cleaner/Disinfectant in Toilet Bowls:

1. Pre-clean heavily soiled areas.
2. Empty toilet bowl by forcing water through the trap. Use one wipe on exposed surfaces in toilet bowl.
3. Wipe entire surface area, especially under the rim.
4. Allow entire surface to remain wet for one (1) minute.
5. Flush toilet. Discard wipe in [(trash receptical) (garbage) (garbage can)]. Do Not Flush Wipe In Toilet.
6. Use [(fresh) (new)] wipe for high touch surfaces found on toilet.
7. Discard used wipes in [(trash receptical) (garbage) (garbage can)]. Do Not Flush Wipe In Toilet.

Hard non-porous external surfaces of: *{surfaces will be selected from the following}* ambulance equipment, diagnostic equipment, dialysis machines, mammography equipment, patient monitoring equipment, respiratory equipment, ultrasound transducers and probes, [and] patient support and delivery equipment.

[PeridoxRTU¹ (Brand) One-Step Germicidal Wipe] [is compatible with] [will not harm] *{surfaces will be selected from the following}* acrylic, aluminum, brass, copper, Corian®, glass, glazed porcelain, glazed tile, [(High-Density Polyethylene)(HDPE)], laminate flooring and countertops, [(Liquid Crystal Display)(LCD)] screens, [(Low-Density

{Note to reviewer: All text in brackets [...] or parenthesis (...) is interchangeable or optional and may or may not be included on a final label. All text in braces {...} is for administrative purposes only and will not appear on a final label. Portions or all of the label may be bilingual. Variables such as CAPITALIZATION, plurals or singular, bold and italics are optional unless specified in 40 CFR. Listed uses and use sites can be used partially or in their entirety. Strike-through text means it has been removed. Highlighted text is new or laid out differently.} Portions or all of the label may be bilingual.

Polyethylene)(LDPE)], medical tubing, nickel, painted surfaces, polycarbonate, polypropylene, polyurethane varnish, [Polyvinyl Chloride] [PVC], silicone rubber, stainless steel, vinyl, vinyl rubber, and zinc alloy.

{Table 1 – Institutional Soils}

- Blood
- Body oils
- Dead skin
- Dirt
- Fecal matter
- Finger prints
- Food residue[s] – or soil[s] ‡
- Grime
- Laboratory stains
- Mold stains
- Other common soils –and/or- stains
- Other organic matter
- Urine
- ‡Non-food contact surfaces

{Table 2 – Surface Materials}

- Chrome
- Crystal (non-food contact items)
- Enamel
- Fiberglass (fixtures)
- Formica*
- Glass
- Glazed ceramic
- Glazed porcelain
- Glazed tile
- Linoleum
- Metals [except copper and brass]
- Mirrors
- Plastic laminate
- Plastic surfaces
- Sealed fiberglass [polyester, vinylester and epoxy resins]
- Sealed granite
- Sealed grout
- Stainless steel
- Synthetic marble
- Vinyl
- *Formica is a registered trademark of the Formica Corporation

{Table 3 – Institutional Hard Non-porous surfaces}

Medical and Dental:

{Note to reviewer: All text in brackets [...] or parenthesis (...) is interchangeable or optional and may or may not be included on a final label. All text in braces {...} is for administrative purposes only and will not appear on a final label. Portions or all of the label may be bilingual. Variables such as CAPITALIZATION, plurals or singular, bold and italics are optional unless specified in 40 CFR. Listed uses and use sites can be used partially or in their entirety. Strike-through text means it has been removed. Highlighted text is new or laid out differently.} Portions or all of the label may be bilingual.

- amalgamators -and/or- dental curing lights
- anesthesia machines
- autoclaves
- baskets
- bedpans
- bedrails
- [bedside] commodes
- bedside tables
- blood pressure (BP) cuffs±
- blood pressure (BP) monitors
- cabinet [(knobs)(handles)]
- call boxes
- CAT -or- Computerized Axial Tomography equipment
- carts
- chairs
- closet [handles]
- computer peripherals
- computer screens
- computer tables
- cords
- counters
- [crash] [emergency] carts
- dental countertops
- dental operatory surfaces
- dentists' -or- dental chairs
- dental unit instrument trays
- desktops
- diagnostic equipment
- [exterior of] dialysis machines
- docking stations
- [exam -or- examination] tables
- external surfaces of [medical] equipment - or- [medical] equipment surfaces
- [external] [surfaces of] ultrasound transducers [-and/or- probes]
- Exterior of refrigerators
- Exterior of freezer(s)
- exterior of pipes
- footboards
- glucometers
- gurneys
- handheld [electronic] devices
- headboards
- [hospital - or – patient] bed[s] [springs][railings][frames][lining]
- Infant incubators and care cribs±
- IV poles [stands]

{Note to reviewer: All text in brackets [...] or parenthesis (...) is interchangeable or optional and may or may not be included on a final label. All text in braces {...} is for administrative purposes only and will not appear on a final label. Portions or all of the label may be bilingual. Variables such as CAPITALIZATION, plurals or singular, bold and italics are optional unless specified in 40 CFR. Listed uses and use sites can be used partially or in their entirety. Strike-through text means it has been removed. Highlighted text is new or laid out differently.} Portions or all of the label may be bilingual.

- IV pumps (exterior surface)
- keyboards
- laptops
- light lens covers
- loupes
- Mannequins used in CPR training
- mammography equipment
- [Mayo] [instrument] stands
- medication carts
- [computer] mouse mobile devices
- mobile electronic equipment
- mobile workstations
- mouse pads
- [Surfaces of] MRI -or- Magnetic Resonance Imaging equipment
- nurse-call [devices] [buttons] [and cords]
- operating room tables and lights
- operatory light switches
- oxygen hoods
- overbed tables
- paddles
- pagers
- patient chairs
- patient monitoring equipment
- patient support and delivery equipment
- phlebotomy trays
- physical therapy (PT) equipment surfaces
- phone cradle
- plastic mattress covers
- power cords
- pulse oximeters
- PVC tubing
- Reception counters –or- desks –or- areas
- remote controls
- respirators
- respiratory therapy equipment
- scales
- sequential compression devices
- shower fixtures
- side rails
- slit lamps
- small surfaces
- spine backboards
- stethoscopes
- stools
- stretchers

{Note to reviewer: All text in brackets [...] or parenthesis (...) is interchangeable or optional and may or may not be included on a final label. All text in braces {...} is for administrative purposes only and will not appear on a final label. Portions or all of the label may be bilingual. Variables such as CAPITALIZATION, plurals or singular, bold and italics are optional unless specified in 40 CFR. Listed uses and use sites can be used partially or in their entirety. Strike-through text means it has been removed. Highlighted text is new or laid out differently.} Portions or all of the label may be bilingual.

- support bars
- tablet PCs
- toilet handholds
- traction devices
- tray tables
- walls [around toilet] [in patient rooms]
- wash basins
- wheelchairs
- X-ray equipment
- ± hard, nonporous surfaces of

{Table 3 – Veterinary Hard Non-porous surfaces}

- animal equipment
- animal crates
- automatic feeders‡
- buckets
- brushes
- cages
- carts
- dog runs
- examination tables
- exterior surfaces of fountains
- external surfaces of veterinary equipment
- exterior surfaces of watering appliances
- farm vehicles (trucks) ±
- feed racks
- fencing±
- food baths
- gates
- gathering [guiding] equipment
- grooming equipment
- handling equipment
- harnesses & leashes±
- pens
- reception counters -or- desks -or- areas
- [wash] stalls
- transportation crates
- troughs
- veterinary care surfaces
- ± hard, nonporous surfaces of
- ‡Non-food contact surfaces

{Table 4 – Medical and Dental Institutional use sites}

- Ambulances -or- [Emergency] [Medical] Transport Vehicles
- Ambulatory Surgical Centers (ASC)

{Note to reviewer: All text in brackets [...] or parenthesis (...) is interchangeable or optional and may or may not be included on a final label. All text in braces {...} is for administrative purposes only and will not appear on a final label. Portions or all of the label may be bilingual. Variables such as CAPITALIZATION, plurals or singular, bold and italics are optional unless specified in 40 CFR. Listed uses and use sites can be used partially or in their entirety. Strike-through text means it has been removed. Highlighted text is new or laid out differently.} Portions or all of the label may be bilingual.

- Anesthesia Rooms or Areas
- [Assisted Living] [Full Care] Nursing Homes
- Carts
- CAT Lab[oratories]
- Central Service Areas
- Central Supply Rooms -or- Areas
- [Sterile] Compounding Pharmacies
- Critical Care Units -or- CCUs
- Dental Operatories
- Dental -or- Dentist's Offices
- Dialysis Clinics [Facilities]
- Doctors' Offices
- Donation Centers [blood] [plasma] [semen] [milk] [apheresis]
- Emergency Rooms -or- ERs
- Examination Rooms
- Eye Surgical Centers
- Exterior of refrigerators
- Exterior of freezer(s)
- Health Care Settings -or- Facilities
- Hospices
- Intensive Care Units -or- ICU[s] [areas]
- Isolation Areas
- Laundry Rooms
- Laboratories
- Long Term Care Facilities
- [Medical] Clinics
- Medical Facilities
- Medical -or- Physician's -or- Doctor's Offices
- Newborn -or- Neonatal [Nurseries] [Intensive Care] Units [NICU]
- Nursing -or- Nurses' Stations
- Oncology [centers]
- Operating Rooms
- Ophthalmic Offices
- Orthopedics
- Out-Patient [Surgical Centers (OPSC)] [Clinics] [Facilities]
- Patient Areas
- Patient Restrooms
- Patient Rooms
- [Pediatric] Examination Rooms -or- Areas
- Pediatric Intensive Care Units [PICU]
- Pharmacies
- Physical Therapy Rooms -or- Areas
- Physicians' Offices
- Psychiatric Facilities
- Public [Care] Areas

{Note to reviewer: All text in brackets [...] or parenthesis (...) is interchangeable or optional and may or may not be included on a final label. All text in braces {...} is for administrative purposes only and will not appear on a final label. Portions or all of the label may be bilingual. Variables such as CAPITALIZATION, plurals or singular, bold and italics are optional unless specified in 40 CFR. Listed uses and use sites can be used partially or in their entirety. Strike-through text means it has been removed. Highlighted text is new or laid out differently.} Portions or all of the label may be bilingual.

- Radiology -or- X-Ray Rooms -or- Areas
- Recovery Rooms
- Rehabilitation Centers
- Respiratory Therapy Rooms -or- Areas
- Surgery Rooms -or- Operating Rooms - or-ORs
- Urgent Care Centers
- Waiting Rooms -or- Waiting Areas

{Table 4 – Veterinary Institutional use sites}

- Animal [Pet] Housing [Kennels] [Facilities]
- Animal Holding Areas
- Animal Life Science Laboratories
- [Animal -or- Pet] Grooming Facilities
- Animal [(Refuge)(Rescue)] [Shelter] [Facilities]
- Animal Transportation Vehicles
- Barns
- Breeding Establishments
- Catteries
- Dairy Farms
- Equine Farms
- Farms
- Fish [Farm] [Facilities]
- Greenhouses
- Hatcheries
- Kennels
- Livestock -and/or- Swine -and/or- Poultry Facilities
- Pet [Areas] [Quarters]
- Pet Shops -or- Stores
- Pet [Animal] Care Facilities
- Small Animal Facilities
- Tack Shops
- Veterinary Clinics -or- Facilities
- Veterinary [Offices] [Waiting Rooms]
- Veterinary -or- Animal Hospitals
- Veterinary [Examination Rooms]
- Veterinary [X-ray Rooms]
- Veterinary [Operating Rooms]
- Zoos

{Table 4 – Miscellaneous}

- Airplanes [Airports]
- Amusement parks
- Apartment [housing]
- Basements
- Bowling Alleys

{Note to reviewer: All text in brackets [...] or parenthesis (...) is interchangeable or optional and may or may not be included on a final label. All text in braces {...} is for administrative purposes only and will not appear on a final label. Portions or all of the label may be bilingual. Variables such as CAPITALIZATION, plurals or singular, bold and italics are optional unless specified in 40 CFR. Listed uses and use sites can be used partially or in their entirety. Strike-through text means it has been removed. Highlighted text is new or laid out differently.} Portions or all of the label may be bilingual.

- Buses
- Non-food handling areas of [Cafeterias][Breakrooms]
- Campers
- Campgrounds
- Changing areas
- Churches
- Colleges
- Convenience Stores
- Convention Centers
- Correctional Facilities
- Cruise Ships
- Crisis (Crime) Scene(s)
- [Home] Day Care [Centers]
- Dorms
- Dormitories
- Elevators
- Factories
- Non-food handling areas of Fast Food Restaurants
- Funeral Homes
- Gas Stations
- Greenhouses
- Health Club[s] [Facilities]
- Hotels
- Industrial Facilities
- Institutional [Bathrooms]
- [Institutional] Laundromats
- Institutions
- Kennels
- Libraries
- Locker Rooms
- Lounges
- Malls
- General Merchandise Stores, Discount Retailers
- Military Installations
- [Mortuaries] [Morgues]
- Motels
- [Police -and/or- Fire] Vehicles
- Public Areas
- Public Facilities
- Public Restrooms
- Public Telephone[s] [Booths]
- Recreational Centers -or- Facilities
- Rest Stops
- Restrooms -or- Restroom Areas
- Retail and Wholesale Establishments

{Note to reviewer: All text in brackets [...] or parenthesis (...) is interchangeable or optional and may or may not be included on a final label. All text in braces {...} is for administrative purposes only and will not appear on a final label. Portions or all of the label may be bilingual. Variables such as CAPITALIZATION, plurals or singular, bold and italics are optional unless specified in 40 CFR. Listed uses and use sites can be used partially or in their entirety. Strike-through text means it has been removed. Highlighted text is new or laid out differently.} Portions or all of the label may be bilingual.

- Retail Businesses
- [Retail] [Wholesale] Florists
- RVs
- School Buses
- Schools
- Shelters
- [Shipping containers] [Sea containers]
- Shopping Centers
- Shops
- Shower Rooms
- Spas [Massage/Facial] [Hair/Nail] [Salons]
- Sports Arenas
- Sports Stadiums
- Subways
- Non-food handling areas of Supermarkets
- Tanning spas
- Tattoo Parlors
- Transportation Terminals
- Trailers
- Trains
- Universities
- Warehouse Clubs

{List of surface materials, hard non-porous surfaces and use site for use in the Residential Use products}

{Table 5 – Residential Soils}

- Baby food‡
- Bathtub rings
- Coffee
- Crayon / pencil marks
- Fingerprints
- Grime
- Handprints
- Heel/Scuff marks
- Smudges
- Soap scum
- Sticky Food Messes‡
- Tough soils
- ‡Non-food contact surfaces

{Table 6 – Residential Hard Non-porous surfaces}

- Outer surfaces of air vents
- Appliances exterior
- Athletic equipment
- Bathrooms

{Note to reviewer: All text in brackets [...] or parenthesis (...) is interchangeable or optional and may or may not be included on a final label. All text in braces {...} is for administrative purposes only and will not appear on a final label. Portions or all of the label may be bilingual. Variables such as CAPITALIZATION, plurals or singular, bold and italics are optional unless specified in 40 CFR. Listed uses and use sites can be used partially or in their entirety. Strike-through text means it has been removed. Highlighted text is new or laid out differently.} Portions or all of the label may be bilingual.

- Bathroom fixtures
- [Bathroom] [kitchen] faucet
- Bathroom doorknobs
- Bathtubs
- Bed frames
- [Behind and under] counters±
- [Behind and under] sinks±
- Blood Pressure monitors
- Burner trays
- Cabinets
- Cages
- Cell[ular] – or digital phones
- [Hard surfaces of] Chairs (not including high chairs)
- Changing tables
- Closets [handles]
- Computers
- Computer keyboards
- Computer mouse±
- Computer peripherals
- Computer screen
- Cords
- Countertop
- Cupboard
- Desk[s][tops]
- Diaper pails
- Door [knobs] [handles] [frames]
- Exercise equipment
- Exercise mats±
- Exterior of refrigerators
- Exterior of freezer(s)
- Exterior of toilet surfaces
- Exterior of pipes
- Footboards
- Finished hardwood [(floor(s)) (flooring)]
- Fixture [(chrome) (stainless steel)]
- [(Floor(s)) (Flooring)] (glazed tile)
- [(Floor(s)) (Flooring)] (vinyl)
- Furniture [hard surfaces]
- Garbage [trash] can [bin]
- Glazed ceramic tile
- Glazed porcelain tile
- [Hand] railings
- [Hard±, and soft □ surfaces of] car [boat] [trailer] [interior]
- Infant cribs
- [Inside of] drawers

{Note to reviewer: All text in brackets [...] or parenthesis (...) is interchangeable or optional and may or may not be included on a final label. All text in braces {...} is for administrative purposes only and will not appear on a final label. Portions or all of the label may be bilingual. Variables such as CAPITALIZATION, plurals or singular, bold and italics are optional unless specified in 40 CFR. Listed uses and use sites can be used partially or in their entirety. Strike-through text means it has been removed. Highlighted text is new or laid out differently.} Portions or all of the label may be bilingual.

- Grill exterior
- Laminated surfaces
- Lamps
- Light fixture
- Medicine cabinet
- Metal blinds
- Metal surfaces
- Microwave exterior
- [Hard surfaces of] [outdoor]Patio furniture]
- Oven exterior
- Packing benches
- Phone cradles
- Piano keys
- Picnic table
- Plastic laundry basket
- Recycling bins
- Refrigerator / Freezer exterior
- Remote controls
- Sealed concrete
- Sealed granite
- Shelves
- Shower[door][curtain]
- Showers [stalls]
- Sink [basin]
- Stainless steel surfaces
- Stereo consoles
- Storage bins
- Stool
- Strollers
- Tables
- Tabletop
- Telephone
- Tiled walls
- Toilet handholds
- Toilet rims [seats]
- Toys±
- Training toilets
- Tools
- [Bathroom] vanity
- Vinyl
- [Washable] walls
- Wash basins
- Walkers
- Washing machine exterior
- Windows

{Note to reviewer: All text in brackets [...] or parenthesis (...) is interchangeable or optional and may or may not be included on a final label. All text in braces {...} is for administrative purposes only and will not appear on a final label. Portions or all of the label may be bilingual. Variables such as CAPITALIZATION, plurals or singular, bold and italics are optional unless specified in 40 CFR. Listed uses and use sites can be used partially or in their entirety. Strike-through text means it has been removed. Highlighted text is new or laid out differently.} Portions or all of the label may be bilingual.

- Work bench
- ± hard, nonporous surfaces of

{Table 7 - Residential/Household use sites}

- Basement
- Bathroom
- Bedroom
- Dorm rooms
- Dining room
- Exercise room
- Family room
- Garage
- Garbage room
- Kitchen‡
- Laundry room
- Living room
- Nursery [room]
- Outdoor [patio] furniture
- Pet areas
- Playroom
- Restroom
- Storage room
- Tool shed
- Washrooms

‡Non-food contact surfaces

PRECAUTIONARY STATEMENTS
HAZARDS TO HUMANS AND DOMESTIC ANIMALS

WARNING: Causes substantial but temporary eye injury. Do not get in eyes or on clothing. Wear protective eyewear such as goggles, face shield, or safety glasses. Harmful if swallowed. Wash thoroughly with soap and water after handling and before eating, drinking, chewing gum, using tobacco or using the toilet. Remove and wash contaminated clothing before reuse.

PHYSICAL AND CHEMICAL HAZARDS: This product contains an oxidizing agent. Avoid contact with other sanitizers, cleaners, or organic substances. Do not store near heat or open flame.

FIRST AID

If in eyes: Hold eye open and rinse slowly and gently with water for 15-20 minutes. Remove contact lenses, if present, after the first 5 minutes, then continue rinsing. Call a poison control center or doctor for treatment advice. Have the product container or label with you when calling a poison control center or doctor, or going for treatment.

{Note to reviewer: All text in brackets [...] or parenthesis (...) is interchangeable or optional and may or may not be included on a final label. All text in braces {...} is for administrative purposes only and will not appear on a final label. Portions or all of the label may be bilingual. Variables such as CAPITALIZATION, plurals or singular, bold and italics are optional unless specified in 40 CFR. Listed uses and use sites can be used partially or in their entirety. Strike-through text means it has been removed. Highlighted text is new or laid out differently.} Portions or all of the label may be bilingual.

FOR EMERGENCY MEDICAL INFORMATION [CALL TOLL FREE 1-800-222-1222 {*in the United States*}] [CALL LOCAL EMERGENCY NUMBER]

Storage and Disposal To be reviewed based on packaging chosen

Do not contaminate water, food or feed by storage and disposal.

Pesticide Storage: {*select at least one of the following statements*} Store [at room temperature] [between 20 – 25 [degrees][°] Celsius] [68 – 77 [degrees][°] Fahrenheit]. [Store this product in a cool, dry area away from direct sunlight and heat.] [Store in original container in areas inaccessible to children.] [When not in use keep lid closed to prevent moisture loss.]

Pesticidal Disposal: Wipe: [Do not reuse wipe.] [Dispose of] [Discard] used wipe in trash. [DO NOT FLUSH.] Dispenser: [If empty:] Nonrefillable container. Do not reuse or refill this container. Place in trash or offer for recycling, if available. [If partly filled: Call your local solid waste agency for disposal instructions.] [Discard used [(towels)(wipes) (cloths) (towelettes)] and container in trash or take container to recycling center.)(Recycle container).]

[Distributed by] [Manufactured For] [Manufactured By] Contec, Inc., 525 Locust Grove, Spartanburg, SC 29303, USA

For questions/comments, please contact Contec, Inc.
1-864-503-8333

[www.contecinc.com] [www.contechealthcare.com] [www.contecclean.com]

®/* Trademarks of Contec, Inc.

™ Trademark of Contec, Inc.

XXXXXX {*Product code will appear on label. Number may change prior to commercialization*}

Made in USA

Made with [(Peridox)(PeridoxRTU™)] [Disinfectant] [Technology]
{*internal specification numbers may also appear on label*}

{*Lot code and expiration date may appear on either the container or label*}

{Note to reviewer: All text in brackets [...] or parenthesis (...) is interchangeable or optional and may or may not be included on a final label. All text in braces {...} is for administrative purposes only and will not appear on a final label. Portions or all of the label may be bilingual. Variables such as CAPITALIZATION, plurals or singular, bold and italics are optional unless specified in 40 CFR. Listed uses and use sites can be used partially or in their entirety. Strike-through text means it has been removed. Highlighted text is new or laid out differently.} Portions or all of the label may be bilingual.

{Sporicidal claims}

Kills 99.9999% [C.diff] [*C. difficile*] [*Clostridium difficile*] [spores] in 6 [minutes] [min]!

Kills [bacteria] [fungi] [mold] [TB] [viruses†] on surfaces.

Kills [bacteria] [fungi] [*Clostridium difficile* spores] [viruses†]

Kills [C.diff] [*C. difficile*] [*Clostridium difficile*] [spores] in 6 [minutes] [min]!

Sporicidal[§], Virucidal†, Bactericidal, Fungicidal, and Tuberculocidal

[Wipe out] [Kill] [C. diff] [*C. difficile*] [*Clostridium difficile*] [spores]

Kills [MRSA] [*Staphylococcus aureus* MRSA] in 30 [seconds] [sec]!

{Influenza A H1N1 Claims}

This product [PeridoxRTU¹ (Brand) One-Step Germicidal Wipe] has demonstrated effectiveness against influenza A virus and is expected to inactivate all influenza A viruses including Pandemic 2009 H1N1 Influenza A virus.

This product [PeridoxRTU¹ (Brand) One-Step Germicidal Wipe] has demonstrated effectiveness against Influenza A Virus [H1N1] and Avian Influenza Virus [H5N1] and is expected to inactivate all Influenza A viruses including Pandemic 2009 H1N1.

Kills Pandemic 2009 H1N1 Influenza A virus.

{General efficacy claims}

Can help reduce the risk of cross contamination between treated surfaces

[Cleans], [Disinfects] and [Deodorizes]

Powered with [(Peridox)(PeridoxRTU®)] Technology

One-Step Germicidal

Germicidal Detergent Wipe(s)

Hydrogen Peroxide/PAA Wipe(s)

Kills [Community-Acquired Methicillin Resistant *Staphylococcus aureus* [CA-MRSA] [and] Methicillin Resistant *Staphylococcus aureus* [MRSA] in 30 seconds!

[PeridoxRTU¹ (Brand) One-Step Germicidal Wipe] is effective against the following organisms at the following contact times: {insert organism name and contact time from table}

{Note to reviewer: All text in brackets [...] or parenthesis (...) is interchangeable or optional and may or may not be included on a final label. All text in braces {...} is for administrative purposes only and will not appear on a final label. Portions or all of the label may be bilingual. Variables such as CAPITALIZATION, plurals or singular, bold and italics are optional unless specified in 40 CFR. Listed uses and use sites can be used partially or in their entirety. Strike-through text means it has been removed. Highlighted text is new or laid out differently.} Portions or all of the label may be bilingual.

Kills Mycobacterium tuberculosis [TB] in [just] [1] minute.

Disinfects external surface of ultrasound transducers

Disinfects hard non-porous [environmental] surfaces listed on this label

Kills {insert organism name from Table} in just {insert contact time from table}

[Product Name] [are] [is] intended for [cleaning] [and] [disinfecting] hard non-porous surfaces where control of cross contamination of treated surfaces is required.

{Ease of use}

After use, just throw wipe(s) away

Always ready to use

[An effective method to deodorize and disinfect] [Effectively deodorizes and disinfectants] against odor-causing organisms on hard non-porous surfaces [listed on this label]

[An effective way to] [Effectively] disinfect hard, non-porous environmental surfaces [listed on this label]

Cleans and disinfects in one step.

Dispenses one wipe at a time

Does not produce mist or spray

[Convenient] [Portable] way to disinfect hard non-porous surfaces

Portable way to conveniently disinfect hard non-porous surfaces

[PeridoxRTU¹ (Brand) One-Step Germicidal Wipe] may be used to clean and disinfect in one step; [see directions for use on this label for cleaning and disinfecting in one step].

[[No mess], [No Dilution], [No rinse], [No dirty rags]]

No [mixing], [measuring] or [rinsing] required.

No sponges, no rags, no buckets, no mess

No rinsing required.

One-Step Presaturated Germicidal Wipe

{Note to reviewer: All text in brackets [...] or parenthesis (...) is interchangeable or optional and may or may not be included on a final label. All text in braces {...} is for administrative purposes only and will not appear on a final label. Portions or all of the label may be bilingual. Variables such as CAPITALIZATION, plurals or singular, bold and italics are optional unless specified in 40 CFR. Listed uses and use sites can be used partially or in their entirety. Strike-through text means it has been removed. Highlighted text is new or laid out differently.} Portions or all of the label may be bilingual.

[(Premoistened)(Pre-wetted)]

[PeridoxRTU¹ (Brand) One-Step Germicidal Wipe] [s are] [is] pre-moistened with a unique, stabilized Hydrogen Peroxide Peroxyacetic Acid solution and [are][is] ready-to-use.

[Easy way to] [Easily] disinfect hard, nonporous surfaces

[Easy way to] [Easily] clean [and disinfect] bathrooms

Ready to Use[!]

Simple and easy to use

[The [easy], [effective], and [convenient]] [Easily, effectively, and conveniently] way to disinfect surfaces.

Use of this product does not produce mist in the air

{General claims}

Alcohol-Free [Formula]

Phenolic Free

[Big] Sheet Size _" x _"

__% bigger [wipes] [vs. _" x _" wipes]

Bleach-free [formula]

Bonus

Convenient

[Does not contain alcohol [No alcohol] [Contains no alcohol]

[Does not contain bleach] [No bleach] [Contains no bleach]

For daily use

Get a fresh, clean [PeridoxRTU¹ (Brand) One-Step Germicidal] wipe every time.

Chlorine free

No chlorine

Quaternary Ammonium Free

{Note to reviewer: All text in brackets [...] or parenthesis (...) is interchangeable or optional and may or may not be included on a final label. All text in braces {...} is for administrative purposes only and will not appear on a final label. Portions or all of the label may be bilingual. Variables such as CAPITALIZATION, plurals or singular, bold and italics are optional unless specified in 40 CFR. Listed uses and use sites can be used partially or in their entirety. Strike-through text means it has been removed. Highlighted text is new or laid out differently.} Portions or all of the label may be bilingual.

No Quaternary Ammonium

Active ingredients break down to Oxygen, Water, and Vinegar.

New! {used for 6 months only}

[New {used for 6 months only}] One-Step Germicidal [Detergent] Wipe(s)

Non-corrosive.

Dispenses one [Wet] Wipe!

Pop-up dispensing

Pop-up [top]

__# Presaturated [towelettes] [wipes] _" x _"

Unique lid design for one-hand [carrying] [transport].

[Use(d) to] Deodorize(s) hard non-porous surfaces

_" x _" [wipes]

[(Improved)(Introducing)] {used for 6 months only} {descriptor to be inserted}
[fragrance] [smell]

New {used for 6 months only} {descriptor to be inserted} [fragrance] [smell]



Not a baby wipe.

Graphics

{may be selected from the following, black/white or color version, and/or or similar graphics may be used}

PeridoxRTU™ Disinfectant Logo	
PeridoxRTU™ Disinfectant Logo	
Contec Inc Healthcare logo	
Contec, Inc. Logo	

{Note to reviewer: All text in brackets [...] or parenthesis (...) is interchangeable or optional and may or may not be included on a final label. All text in braces {...} is for administrative purposes only and will not appear on a final label. Portions or all of the label may be bilingual. Variables such as CAPITALIZATION, plurals or singular, bold and italics are optional unless specified in 40 CFR. Listed uses and use sites can be used partially or in their entirety. Strike-through text means it has been removed. Highlighted text is new or laid out differently.} Portions or all of the label may be bilingual.

Contec, Inc. Professional Logo	
No-Baby Graphic	 <p style="text-align: center;">or</p>
Wipe Use Graphic	