

MAR 31 1994

S 458300  $\frac{301}{18}$ 

J.J. Mauget Co.  
2810 No. Figueroa Street  
Los Angeles, CA 90065

Attention: Mr. Dale I. Dodds

Subject: Inject-A-Cide  
EPA Reg. No. 7946-10  
Your Letter of December 7, 1993  
Our Letter of December 6, 1993

In your letter of December 7, 1993, you submitted revised labeling for this product because our December 6, 1993, letter indicated that your "final printed label" did not conform to your last accepted label of August 10, 1992 in major ways. We forwarded a copy of your submission to our Office of Compliance Monitoring (OCM) for possible action. In addition, you wanted to add a Worker Protection Statement (WPS) to your label.

The labeling referred to above, submitted in connection with registration under the Federal Insecticide, Fungicide and Rodenticide Act (FIFRA), as amended, is acceptable provided that you:

1. On the Front Panel, place the paragraph on direct supervision directly below the Restricted Use Statement ("For Retail ... certification"), followed in a separate paragraph by:

Note: J.J. Mauget Co. must approve all training instructors and all governmental and private applicator organizations.

2. On your Ingredient Statement, you have replaced the **chemical** name with the **common** name. It is acceptable to use the common name, but you must follow it immediately with the chemical name.
3. Remove the parentheses from your DANGER and PHYSICAL OR CHEMICAL HAZARDS sections.
4. Place the DIRECTIONS FOR USE heading and misuse statement, which are currently on the Left Panel, with the rest of your use directions, which are on the Near Right Panel beginning with "GENERAL DIRECTIONS".

We note that you have submitted WPS labels in accordance with the instructions in PR Notices 93-7 and 93-11. As indicated above, the new protective language in those submissions must be incorporated into the labeling for any shipments released after the deadlines that have been established. You may opt to do so immediately if you are electing the self-verification option, or after acceptance by the special Agency WPS review group. Finished printed labels should be submitted after acceptance by the WPS group and in accordance with their instructions.

If these conditions are not complied with, the registration will be subject to cancellation in accordance with FIFRA section 6(e). Your release for shipment of the product bearing the amended labeling constitutes acceptance of these conditions.

A stamped copy of the labeling is enclosed for your records.

Sincerely yours,

Robert A. Forrest  
Product Manager (14)  
Insecticide-Rodenticide Branch  
Registration Division (H7504C)

- Enclosures: 1. Stamped label  
2. A-79 Enclosure  
3. FR Notice (3/11/94)

cc Michael Wood (EPA Headquarters Enforcement)

Peacock WP#4:A:7946A.10:305-5407,-6600:3/31/94

### GENERAL DIRECTIONS

Apply injector units at 6 inch intervals of trunk circumference at base of tree. Consult the enclosed pamphlet "Directions for use and application of Mauguet Injector Units" for specific details. Disinfect the insertion tool before treating subsequent trees.

### RESTRICTIONS

- Do not inject trees that are less than two inches in diameter.
- Do not inject trees within two weeks of any other spray or soil chemical treatment.
- Do not treat trees that are suffering from stress such as lack of moisture or herbicide damage.
- This product is NOT to be used on trees which will produce food within the year following treatment (i.e. maple syrup)

### STORAGE AND DISPOSAL

**STORAGE:** In a cool place with units in an upright position.  
**DISPOSAL:** Dispose of empty capsules in sanitary landfill or by incineration if approved by State and local authorities.



ACCEPTED with COMMENTS in EPA Letter Dated  
**MAR 31 1994**

Under the Federal Insecticide, Fungicide, and Rodenticide Act as amended, for the pesticide registered under EPA Reg. No. 7946-10.

NOTE: All training instructors and all governmental and private applicator organizations must be approved by the J.J. Mauguet Co.

### NOTICE OF WARRANTY

J.J. Mauguet Co. makes no warranty of merchantability, fitness for any purpose or otherwise, expressed or implied concerning this product or its uses which extend beyond the use of the product under normal conditions in accord with the statements made on this label.

SEE SIDE LABEL FOR APPLICATION INFORMATION

### INJECT-A-CIDE APPLICATIONS

CROP OR USE	INSECT/PESTS	REMARKS	
Cedars	Bark Beetle	Treat anytime from early Spring thru October. Repeat after new invasion.	
Cottonwoods	Aphids	Apply when wingless forms appear.	
Cypress	Bark Beetles	Treat anytime from early Spring thru October. Repeat after new invasion.	
	Mites	Apply after mite eggs hatch.	
Douglas Fir	Cone Moths	Apply to heavy, current cone crop trees during or shortly after eggs are deposited.	
	Engraver Beetle	Treat anytime from early Spring thru October. Repeat after new invasion.	
Elms	Elm Leafbeetle	Apply after eggs are present or during early larval feeding.	
Juniper	Bark Beetle	Treat anytime from early Spring thru October. Repeat after new invasion.	
Pines (Except Pinon)	Engraver Beetle (5 spined)	Treat anytime from early Spring thru October. Repeat after new invasion.	
	Engraver Beetle (Monterey)		
	Flathead Borer		
	Mountain Pine Beetle		
	Red Turpentine Beetle		
	Black Turpentine Beetle	April to June	
	Western Pine Beetle		
	Jeffrey Needle Miner		
	Mites		Apply after mite eggs hatch.
	Nantucket Pine Tip Moth		Treat when larval damage is first evident.
Pine	Pine Needle Aphid	Apply when wingless forms appear.	
	Pine Needle Scale	Apply when crawlers appear.	
Redwood	Bark Beetle	When active infestation sites are present.	
	Mites	Apply after mite eggs hatch.	
	Needle Scale	Apply when crawler appear.	
Spruce	Adulges	Apply fr. May - June	
Walnuts & Pecans (Non bearing)	Aphids	Apply when wingless form appear.	
	Mites	Apply after mite eggs hatch.	

**BEST AVAILABLE COPY**

SEE FRONT LABEL FOR COMPLETE INFORMATION  
 J.J. MAUGUET CO., LOS ANGELES, CA 90065  
 Made in U.S.A.  
 Print Date 3-92

### PRECAUTIONARY STATEMENTS

HAZARDS TO HUMANS AND DOMESTIC ANIMALS

## DANGER

"Causes irreversible eye damage. May be fatal if inhaled, swallowed or absorbed through skin. Do not get in eyes, on skin or on clothing. Do not breathe vapor or spray mist. Wear goggles or face shield. Wear a mask or pesticide respirator jointly approved by the Mining Enforcement and Safety Administration and the National Institute for Occupational Safety and Health. Wash thoroughly with soap and water after handling and before eating, drinking, or smoking. Remove contaminated clothing and wash before reuse."

REPEATED EXPOSURES TO CHOLINESTERASE INHIBITORS SUCH AS ARE CONTAINED IN THIS PRODUCT MAY, WITHOUT WARNING, CAUSE PROLONGED SUSCEPTIBILITY TO VERY SMALL DOSES OF ANY CHOLINESTERASE INHIBITOR.

### ENVIRONMENTAL HAZARDS

This pesticide is toxic to fish and wildlife.

Do not apply directly to water or wetlands (swamps, bogs, marshes and potholes.)

Do not contaminate water by cleaning of equipment or disposal of waste.

"Flammable, keep away from heat or open flame."

### NOTE TO PHYSICIANS:

INJECT-A-CIDE (Contains Metasystox R) is a cholinesterase inhibitor. If signs of cholinesterase inhibition appear, atropine is antidotal. 2-PAM may also be used in conjunction with atropine but should not be used alone.

### IN CASE OF EMERGENCY:

(1-800-858-7378) is the telephone number of the National Pesticide Telecommunications Network.

### DIRECTIONS FOR USE

It is a violation of Federal law to use this product in a manner inconsistent with its labeling.

Made in U.S.A.

## RESTRICTED USE PESTICIDE Due to Reproductive Effects

FOR RETAIL SALE AND USE ONLY BY CERTIFIED APPLICATORS OR PERSONS UNDER THEIR DIRECT SUPERVISION AND ONLY FOR THOSE USES COVERED BY THE CERTIFIED APPLICATOR'S CERTIFICATION.

Mauget

# INJECT-A-CIDE®

(Contains • Metasystox-R •)

INTERNAL TREATMENT BY MICRO-INJECTION FOR SYSTEMIC SUPPRESSION OF CERTAIN INSECTS ON ORNAMENTAL TREES

Direct supervision for this product is defined as the certified applicator being physically present during mixing, loading, equipment repair, and equipment cleaning. Certified applicators must ensure that all persons involved in these activities under their direct supervision are informed of the precautionary statements.

### ACTIVE INGREDIENT

OXYDEMETON METHYL ..... 50%

INERT INGREDIENT ..... 50%

Total 100%

KEEP OUT OF REACH OF CHILDREN

## DANGER

STATEMENT OF PRACTICAL TREATMENT

Call a physician or poison control center in all cases of suspected poisoning.

IF SWALLOWED. Vomiting should be induced. Administer water freely and induce vomiting by giving one dose (½ oz or 15 ml) of syrup of ipecac. If vomiting does not occur within 10 to 20 minutes, administer second dose. If syrup of ipecac is not available, induce vomiting by sticking finger down throat. Repeat until vomit fluid is clear. Never give anything by mouth to unconscious person. Professional medical assistance should be secured immediately.

IF ON SKIN. Remove contaminated clothing and wash skin with soap and warm water. Get medical attention.

IF EYES ARE CONTAMINATED. Wash with flowing water for at least 15 minutes. Get medical attention.

IF INHALED. Remove victim to fresh air. If not breathing give artificial respiration (preferably mouth-to-mouth.) Get medical attention.

MFG. BY

TOWN, STATE

ESTABLISHMENT NO.

EPA REGISTRATION NO.

TOTAL NET CONTENTS

J.J. MAUGET CO.

LOS ANGELES, CA 90065

EPA EST. NO. 7946-CA-1

7946-10

300 individual units

vol. 3 ml wt. .1 oz

METASYSTOX is a Reg. TM of the Parent Company of Farbenfabriken Bayer GmbH, Leverkusen.

BEST AVAILABLE COPY

## Micro-Injection With A 600-800 RPM

### Alternate Drilling Method of Setting Feeder Tubes:

With the advent of the cordless rechargeable drill, the insertion tool is often being supplanted by the use of drills with fast (1 hour) rechargeable power packs by either 12 volt or 110 volt systems. Using a 11/64" drill bit at 600 - 750 rpm, clean holes are drilled 1/4" to 3/8" into the xylem at the root collar (within 4" of ground level). The placement of the feeder tubes is the same as with the insertion tool. The feeder tubes may be inserted into the drilled holes by gently tapping with a plastic or rubber hammer. The use of an insertion tool at this point may insure that the feeder tube is not clogged with cuttings. Usually the act of applying the capsule will place the feeder tube to the desired depth.

### To Apply Capsules:

Pressurize capsule "B" by forcing cap #6 downward to engage bottom locking ring #7. Capsule is then connected to preset feeder tube by means of hole #4. Turn capsule upside down and force or tap capsule on tube until the internal seal within the capsule is ruptured "C". Overall distance of capsule on tube should be approximately 1/8" as it is controlled by collar on plastic feeder tube.

### Removing Capsule and Feeder Tube:

Allow capsule to remain in place "C" until completely empty. Capsule may be revolved on the feeder tube for visual inspection to determine when empty. Allow capsule to remain in a downward position at least 1 minute prior to removing. This will clear opening #4 of material. Pull feeder tube from trunk with a pair of pliers.

**DANGER: KEEP OUT OF REACH OF CHILDREN.**

### Precautions:

Do not treat trees that are under stress such as lack of moisture, diseased or suffering from herbicide damage. Trees of less than two (2) inches in diameter should not be injected. Don't inject trees within a two week period of any other treatments to the soil or foliage. Stemix multinutrients may at certain times produce a slight leaf scorching and/or light defoliation. Where this occurs, trees usually recover with a flush of healthy green tissue as the growing period continues.

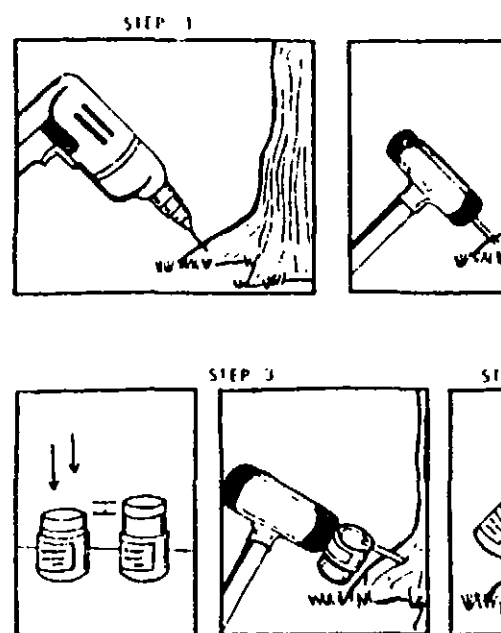

Measure DBH (Diameter Breast) by two to determine the number of placement to root collar (about 4 inch the stimulated root flares or high point).

- Step 1** Drill with 11/64 inch drill bit
- Step 2** Insert aluminum feeder tube beveled end at 45° angle from hole. Tap lightly with a rubber or plastic hammer.  
\* See instructions for Plastic
- Step 3** Place capsule on firm flat surface. Pressing with bottom of foot, pressurize capsule. Turn capsule upside down and align starter hole. Tap on capsule until inner diaphragm ruptured.
- Step 4** Turn the capsule right side up and push it onto the end of the tube to flow through the tube into the hole in the tree.
- Step 5** Allow time for the tree to absorb the capsule upside down for removal. Dispose of capsules through State and Local authorities.

**BEST AVAILABLE COPY**

## Placement of Capsules

1. Always place capsule on root-buttrass at *soil line*.
2. Always place capsule in sound wood.
3. When *insertion tool* is used, set feeder tube  $\frac{3}{8}$ "  $\pm$   $\frac{1}{2}$ " into active conducting wood tissue.
4. When *drill* is used, place feeder tube  $\frac{3}{8}$ " into active conducting wood tissue.

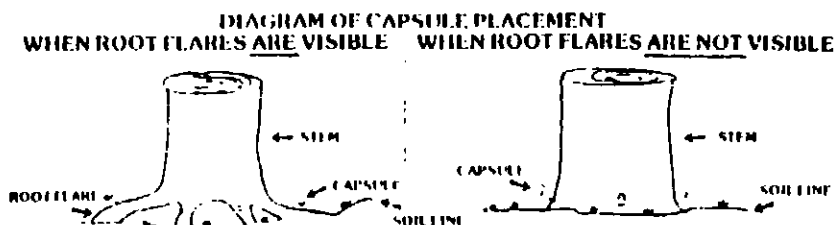

## Inject Only In Sound Wood

STEMIX (contains nutrient and mineral solutions as labeled) Older deciduous trees respond to corrective injections more rapidly during bud swelling or shortly afterwards. Time evergreen applications with the period just preceding a flush growth. Autumn injections are excellent for results the following year. A STEMIX treated tree will generally appear healthier than a closely untreated tree for one to five years or more.

STEMIX promotes leaf development and stimulates feeder root growth encouraging better utilization of commercial fertilizers.

STEMIX also works for trees which need a nutritional boost because of: - poor soil conditions - paving or blacktop over root system - loss of part of root system due to construction - continued insect attack - effects of air pollution.

STEMIX provides effective results in tree jobs involving: treatment with insecticides and fungicides - corrective surgery and pruning - flood damage - tree transplanting - freeze damage - trees exposed to fire.

**CAUTION:** Trees which have Phytophthora (Water mold) disease (Black root rot) will be stimulated by a STEMIX injection causing it to die sooner than it normally would. Do not use Stemix for at least six months after you use Inject-A-Mycin "S". Remove all capsules within one week.

## Directions for Use of MAUGET MICRO-INJECTION COMPONENTS When Using Insertion Tool

Measure DBH (Diameter Breast High) in inches or circumference in inches divided by 6 to determine diameter of feeder tubes and capsules to use. Transfer placement (about 4 inches above ground level) on the stem to the stimulator high points. Although not as desirable, placement may be above breast high or higher if circumstances so dictate. If no root collar, placement should be 6 feet or more above ground level. Whenever forking occurs within a few feet above root collar, placement should be 6 feet or more above root collar. Whenever forking occurs within a few feet above root collar, treat forking limbs as individual trees if you wish.

It is extremely important that the feeder tube be set to a depth into xylem #9-10. If set too deeply, flow may be blocked in the heart wood; if set too shallow, leakage of fluid may be forced back through the bark. The feeder tube should be cut to allow for a  $\frac{1}{4}$  inch plus or minus error.

## To Set Feeder Tube into Tree:

Refer to Diagram:

Place feeder tube #2 on penetrating pin #1 of the insertion tool. Drive the diagonally cut end of the tube outward. (A)

Hold hammer at right angle to tree bark and strike with a hammer until hard wood #10 is encountered. Continue to drive tool until the tool penetrating pin. Continue to drive tool until the tool penetrating pin. Continue to drive tool until the tool penetrating pin. After initial entry, do not attempt to use tool to divert the tool. As a bent penetrating pin will result.

Remove tool by rotating a few turns to free from the tree and pull straight out. It is important that the tube be removed from the tree after this extraction as the seal between tube and bark may be broken. Disinfect insertion tool before or between additional injections with household bleach in 12 parts water or spray with 70% alcohol. Do not use isopropyl rubbing alcohol.

**BEST AVAILABLE COPY**

# Mauget INJECTOR UNIT DIAGRAM

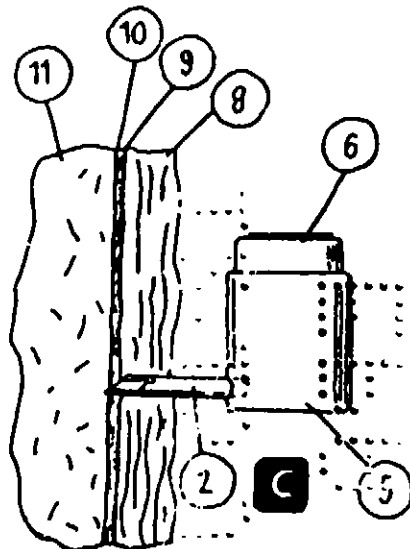
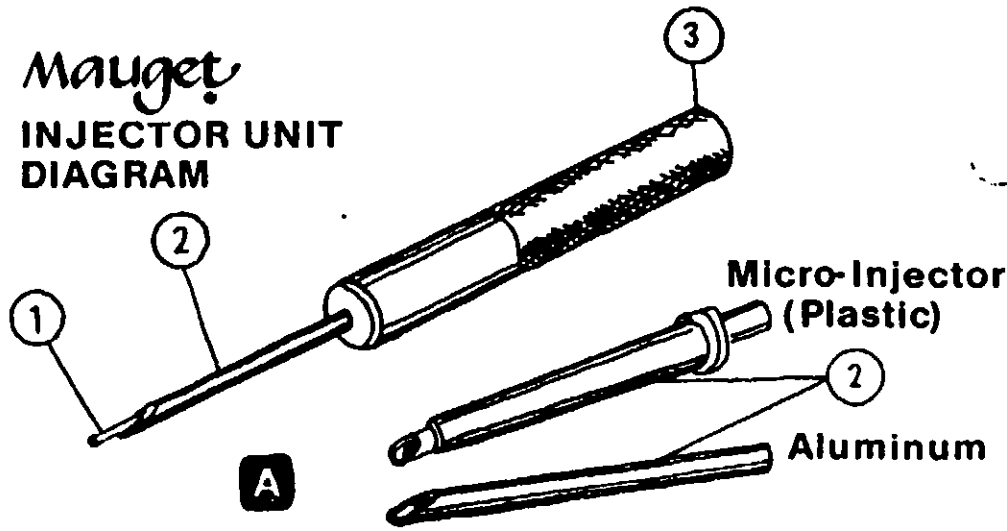

- Fig. "A" INSERTION TOOL  
 Fig. "B" CAPSULE AS RECEIVED  
 Fig. "C" PRESSURIZED CAPSULE  
 CONNECTED TO TREE
- 1 Penetrating Pin
  - 2 Feeder Tube
  - 3 Driving End of Tool
  - 4 Connection Hole in Capsule
  - 5 Lower Member of Capsule (double wall)
  - 6 Upper Member of Capsule (single wall)
  - 7 Final Locking Ring
  - 8 Bark
  - 9-10 Xylem Area (Sapwood)
  - 10-11 Heart Wood Area

REAMER (not shown) is used to remove aluminum from the Inserting Tool. Place Reamer and Inserting Tool together with Penetrating Pin inside Reamer. Hold together and rotate to remove any aluminum from seat of Inserting Tool.

**BEST AVAILABLE COPY**

## \* Instructions for the Use of the Mauget Micro-Injector

The improved Mauget Micro-Injector requires techniques different from its predecessor the metal Micro-Injector. The steps below will guide you in the correct use of the Micro-Injector.

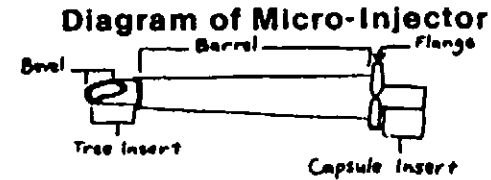

1. Predrill the injection site at a slight downward angle at the root flare using an 11/64" diameter clean, sharp bit to a depth of 3/8" into the vigorous wood (xylem) tissue. On thick bark trees, a 3/16" drill bit may be desirable.

2. Place, by hand, the capsule insert with flange notch upward into a compressed inverted capsule. Push the capsule insert flush with the internal capsule membrane.

3. Then, by hand firmly seat the tree insert portion of the Micro-Injector with the attached inverted capsule into the pre-drilled injection site.

4. Next, with one hand tap the top corner of the capsule directly behind the Micro-Injector with a plastic mallet while steadying the capsule with the other hand. This action will simultaneously seat the Micro-Injector into the tree while releasing the compound from the capsule into the tree.

5. Now turn the capsule upright to allow the contents to enter the tree through the injection site.

6. When the contents have emptied from the capsule, turn it upside down to allow any material to drain away from the capsule opening. Remove all capsules within 7 days.

7. Next grasp the Micro-Injector at the flange and draw it straight back in one motion out of the injection site. In one step you have removed the Micro-Injector and capsule. When using pesticides follow all safety procedures outlined in the label and directions.

8. Dispose of the used capsules and Micro-Injectors in compliance with the laws of the State in which they are being used.

9. Practice only with fertilizers.

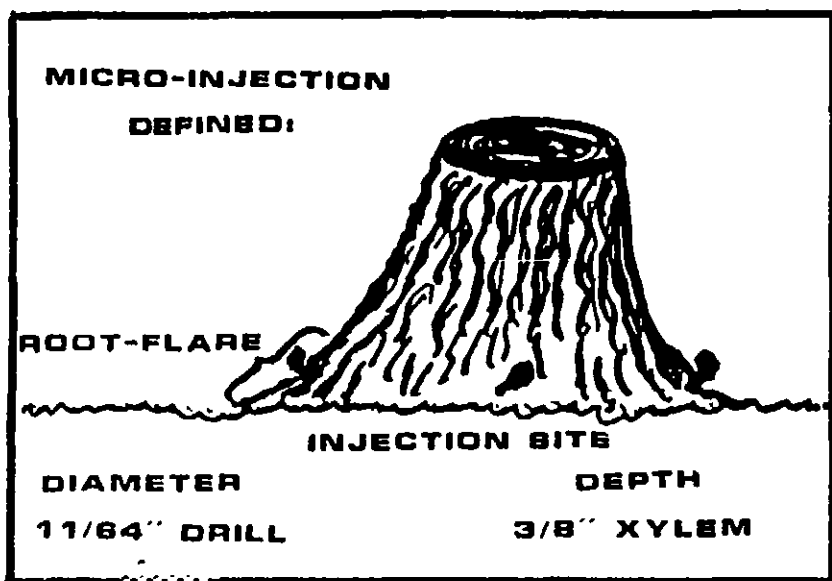

**BEST AVAILABLE COPY**

# *Directions*

for use and  
application of

## **Mauget Micro-Injection System**

ACCEPTED  
with COMMENTS  
in EPA Letter Dated

MAR 31 1994

Under the Federal Insecticide,  
Fungicide, and Rodenticide Act  
as amended, for the pesticide  
registered under EPA Reg. No.

7946-10

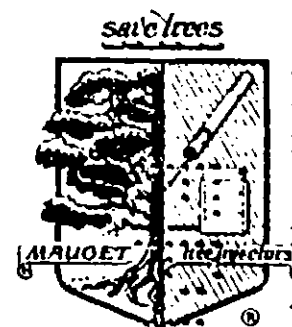

**J.J. MAUGET CO., INC.**

2810 NO. FIGUEROA ST., LOS ANGELES



**REPEATED EXPOSURE TO CHOLINESTERASE INHIBITORS SUCH AS ARE CONTAINED IN THIS PRODUCT MAY, WITHOUT WARNING, CAUSE PROLONGED SUSCEPTIBILITY TO VERY SMALL DOSES OF ANY CHOLINESTERASE INHIBITOR.**

Do not rub eyes or mouth with hands. If you feel sick in any way, **STOP WORK** and get help right away. See "Statement of Practical Treatment" for First Aid.

**WEAR THE FOLLOWING PROTECTIVE CLOTHING DURING HANDLING, APPLICATION AND REMOVAL OF CAPSULES:**

Wear a protective suit of one or two pieces that covers all parts of the body except head, hands and feet. Wear chemical resistant gloves and chemical resistant shoes, shoe coverings or boots. Wear goggles or a face shield. Wear a pesticide respirator approved by the Mining Enforcement and Safety Administration and the National Institute for Occupational Safety and Health.

**IMPORTANT!** Before removing gloves, wash them with soap and water. Always wash hands, face and arms with soap and water before smoking, eating, drinking or toileting.

**AFTER WORK**, take off all clothing and shoes. Shower using soap and water. Wear only clean clothes. Do not wear contaminated clothing. Wash protective clothing and protective equipment with soap and water after each use. Respirators must be cleaned and filters replaced according to instructions included with the respirators. Personal and protective clothing worn during use must be laundered separately from household articles.

**INJECT-A-CIDE (Contains Metasystox R)**

**DANGER: KEEP OUT OF THE REACH OF CHILDREN.**

10 11

## Statement of Practical Treatment

**Call a physician or poison control center in all cases of suspected poisoning.**

**IF SWALLOWED:** Vomiting should be induced. Administer water freely and induce vomiting by giving one dose (½ oz. or 15ml) of syrup of ipecac. If vomiting does not occur within 10 to 20 minutes, administer second dose. If syrup of ipecac is not available, induce vomiting by sticking finger down throat. Repeat until vomit fluid is clear. Never give anything by mouth to an unconscious person. Professional medical assistance should be secured immediately.

**IF ON SKIN:** Remove contaminated clothing and wash skin with soap and warm water. Get medical attention.

**IF EYES ARE CONTAMINATED:** Wash with flowing water for at least 15 minutes. Get medical attention.

**IF INHALED:** Remove victim to fresh air. If not breathing, give artificial respiration (preferably mouth-to-mouth.) Get medical attention.

**IF POISON SYMPTOMS APPEAR:** (See Poison Symptoms below): Keep patient prone and quiet. Start artificial respiration immediately if patient is not breathing. Transport patient immediately to the nearest hospital.

### **Note to Physician:**

This product contains a cholinesterase inhibitor.

**POISON SYMPTOMS:** Symptoms include weakness, headache, tightness in chest, blurred vision, non-reactive pin-point pupils, salivation, sweating, nausea, vomiting, diarrhea and abdominal cramps.