

6836-313

09/14/2009
UNITED STATES ENVIRONMENTAL PROTECTION AGENCY

1/28

UNITED STATES ENVIRONMENTAL PROTECTION AGENCY
WASHINGTON, D.C. 20460

OFFICE OF PREVENTION, PESTICIDES AND TOXIC SUBSTANCES

SEP 14 2009

Ms. Joanna Holcombe
H&S Chemicals Division
c/o Lonza, Inc.
90 Boroline Road
Allendale, NJ 07401

SUBJECT: Lonza Disinfectant Wipes
EPA Registration No.: 6836-313
Amendment Date: June 8 2009
EPA Receipt Date: June 10, 2009

Dear Ms. Holcombe,

The following amendment submitted in connection with registration under FIFRA, as amended, is acceptable with the conditions listed below.

Proposed Amendment

- Update Storage and Disposal per PRN 2007-4
- Update Company Address and add optional statements

Conditions

Revise the label as follows:

1. Revise the 7th, 8th, 9th, and 10th claims on page 11 by listing the species name of the fungus this product mitigates, Trichophyton mentagrophytes, athlete's foot fungus.
- 2) Revise the "Disposal of Infectious Materials" statements under HIV directions on page 24 to be in compliance with PR Notice 200-5, Mandatory Labeling, by deleting the term, should, and stating "must."

General Comments

A stamped copy of the label accepted with conditions is enclosed. Submit three (3) copies of your final printed label before distributing or selling the product bearing the revised labeling.

CONCURRENCES							
SYMBOL							
SURNAME							
DATE							

UNITED STATES ENVIRONMENTAL PROTECTION AGENCY

2/28

Should you have any questions or comments concerning this letter, please contact
Jacqueline McFarlane at (703) 308-6416.

Sincerely,

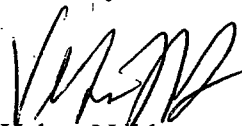

Velma Noble
Product Manager (31)
Regulatory Management Branch I
Antimicrobials Division (7510P)

Enclosure: Stamped Label

CONCURRENCES							
SYMBOL							
SURNAME							
DATE							

3/28

LONZA DISINFECTANT WIPES

One Step Cleaner / Disinfectant / Deodorizer

FRESH / (SUMMER) CITRUS/ FLORAL/ MINT/ PINE / LEMON / WOODY/
LIME / MELON/ CLEAN / WATERFALL / (ULTIMATE) ORANGE / (SPARKLING) APPLE /
INVIGORATING BREEZE / SPRING GARDEN / LAVENDER (FRESH) / GRAPEFRUIT
FRAGRANCE / (ULTRA FRESH) SCENT / SCENTED

Active Ingredients:

Octyl decyl dimethyl ammonium chloride	0.069%
Dioctyl dimethyl ammonium chloride	0.028%
Didecyl dimethyl ammonium chloride	0.042%
Alkyl (C ₁₄ , 50%; C ₁₂ , 40%; C ₁₆ , 10%) dimethyl benzyl ammonium chloride	0.093%
Other Ingredients:	99.768%
Total	*100.000%

* Includes weight of absorbent wipe.

KEEP OUT OF REACH OF CHILDREN CAUTION

See (left) (side) (right) (back) panel for Precautionary Statements and First Aid

Manufactured by:
Lonza Inc.
90 Boroline Road
Allendale, NJ 07401

EPA Reg. No. 6836-313

EPA Est. No. (as indicated on container)

Net Contents: insert # (premoistened) (towelettes) (wipes) (disinfecting) (antibacterial)
(cleaning) (wet) (multi-purpose) (touch-up) (pre-moistened cloths) (sheets)

Net Contents: (expressed as avoirdupois pounds and ounces) (optional: wipe
dimensions:) X x X [inches] [in.]

[Barcode]

(Note to Reviewer: for multi-packs)
(2-pack)
(3-pack)

ACCEPTED
with COMMENTS
in EPA Letter Dated:

SEP 14 2009
Under the Federal Insecticide,
Fungicide, and Rodenticide Act as
amended, for the pesticide
registered under EPA Reg. No. 6836-313

PRECAUTIONARY STATEMENTS
HAZARDS TO HUMANS AND DOMESTIC ANIMALS

Caution. Causes moderate eye irritation. Avoid contact with eyes or clothing. Wash thoroughly with soap and water after handling.

FIRST AID

If in eyes: Hold eye open and rinse slowly and gently with water for 15-20 minutes. Remove contact lenses, if present, after first 5 minutes, then continue rinsing eye.

Call a poison control center or doctor for treatment advice. Have the product container or label with you when calling poison control center or doctor or going for treatment.

(Note to reviewer: The nonrefillable container statement will be removed when instructions for how the pesticide user refills the container are included:)

STORAGE AND DISPOSAL

(Nonrefillable container.) Store in original container in areas inaccessible to children. Keep securely closed. Do not reuse or refill this container (except as described). (Reuse) (Refill) empty container only with Lonza Disinfectant Wipes (refills). (If not refilling,) Discard empty container in trash or recycle (if available).

Questions?

Comments?

Call (Insert phone number)

5/28

(Note to reviewer: The following is considered optional marketing language :)

(Note to reviewer: The following claims containing "New" may only be used for a period of six months after EPA's approval of a revised or alternate formula, beginning when the product is first sold or distributed.)

New
New Wipes
2 New Wipes
New larger (bigger)-sized wipe
Introducing
New Larger Size
New Top
New (thick) (textured) wipe
New easy to dispense
New EZ (to start lid) (start package) (Grab Lid)
New Easy (Start Lid) (Start Package) (Grab Lid)
Introducing new
New (Convenient) (Amazing) Package
New easy-glide dispensing top
New tougher wipe for tougher cleaning
New tougher wipe for your tough(er) jobs

Tough Cleaning at your Fingertips!

Convenient (size)
Value Size
Bonus Size
Travel (Size) (pack)
Refill (size) (pack) (*Refill for Lonza Disinfectant Wipes container*) (tub)

Ready to Use
Premoistened
Cleans
Disinfects
Deodorizes
Antibacterial
Cleaning

For Homes, Institutional and Industrial Use

(text for pop up containers only)

Pop up
Pop and go
Pop and Clean

(Note to reviewer: The following is considered optional marketing language:)

- (After use), just toss wipe away (in trash)(in garbage).
- (All) (Multi-purpose) kitchen (everyday) (daily) (touch-up) (cleaning)
- (Finally) a wipe that cleans and disinfects
- (Premoistened) (wet) disinfecting (textured) (antibacterial) (wipes) (towelettes) (cloths)
- (Quick) (easy) way to (clean and) disinfect (in one step)
- (With a) (fresh) (clean) (citrus) (lemon) fragrance
- (With proven) Antibacterial Action
- Multi-purpose
- Multi-surface
- All around the house (disinfecting) (cleaning formula)
- Ammonia Free (formula)
- An effective way to clean and deodorize against odor-causing bacteria.
- Antibacterial Formula
- Baked-on messes
- Better (package) (dispensing)
- Bleach Free (formula)
- Breakthrough package
- (A) Clean you can trust
- Clean with just a wipe or a touch up
- Cleaning just got a whole lot easier
- Cleans and disinfects in one (easy) step
- Cleans and disinfects (without scratching) (surfaces)
- Cleans things you never thought a wipe could
- Cleans (tough messes) (tough grease) (baked on grease) (sticky messes)
- Cleans what you can't see
- Cloth-like (textured) (strong)
- (Cloth-like texture) (Textured) for scrubbing power
- Cloths (Wipes) quickly remove dirt, spots and smudges
- Convenience of a wipe (a cloth)
- Convenient
- (Convenient) (Hassle-free) (One-hand) dispensing
- Cuts through (tough) (dirt) (stains) (grime) (soils) (dried on stains) (dried on soils)
- Cuts (tough) grease, kills bacteria****
- Disinfecting (Disinfectant) (cleaner) (cleaning wipes) (wipes) (cloths) (formula) (with the fresh scent of Febreze)
- Disinfects (as it cleans) (and scrubs in one easy step) (without (a) (the) (that) disinfectant smell)
- Disinfects while cleaning (up) stubborn messes
- Dispenses better
- Dispenses Like A Tissue(Tough Like A Cloth (Towel))

7/68

(Note to reviewer: The following is considered optional marketing language:)

- Does not contain (chlorine) bleach or ammonia.
- Dual action-cleans up stubborn messes while it disinfects
- Easy (dispensing) (Glide Lid)
- Easy-glide dispensing top
- (Easy) (EZ) start
- Easy dispense (lid) (package)
- Easy to (open) (thread) (access lid) (dispense)
- Easy to use
- Effective in the presence of 5% serum contamination
- Effectively disinfects common household surfaces
- Extra Power for your tough cleaning jobs
- Extra Power wipe for cleaning extra tough (jobs) (messes)
- Fast drying; leaves no dull or sticky residue
- For a cleaner, fresher (home) (house), great for (all around) the (house) (home) (kitchen) (bath)
- For a Powerful Clean
- For everyday messes
- For (light touch ups) (quick clean-ups) (in one easy step)
- For household surfaces (all around the house) indoor and outdoor
- For the quick touch ups, try Lonza Disinfectant Wipes
- For use (at home), (away from home), (in public places) (on the go)
- For when a regular wipe (just) can't get the job done
- Freshens (as you clean)
- Fresh, clean scent
- Gets up stuck-on messes (so you don't have to get on hands and knees)
- Greasy messes
- Great for cleaning around the toilet
- Grimy messes
- Handles daily clean-ups with no need for additional sprays, sponges or buckets.
- Heavy (light) duty (jobs)
- Helps you finish (cleaning) fast (quickly)
- (Just like a tissue box) (Tissue box dispensing)
- Just (pull) (pop) wipe and toss.
- Kills bacteria**** (while it cleans)
- Kills common household bacteria
- (Kills) (Eliminates) (Removes) (Destroys) 99.9% of bacteria
- (Kills) (Eliminates) (Removes) (Destroys) 99.9% of bacteria, leaves (leaving) surfaces (clean and) disinfected
- (Kills) (Eliminates) (Removes) (Destroys) avian influenza A (H3N2) (and) (H5N1) on pre-cleaned environmental surfaces

(Note to reviewer: The following is considered optional marketing language:)

- (Kills) (Eliminates) (Removes) (Destroys) [Insert pathogen or pathogens other than avian influenza A from lists on pages 16-17] (on (pre-cleaned) environmental surfaces)
- Kills germs
- Kills the Flu Virus* On Hard Nonporous Surfaces
- Leaves a clean, fresh scent
- Leaves (no residue) (a streak free shine)
- Leaves surfaces clean and disinfected
- Leaves your (house) (bathroom) (kitchen) fresh and clean
- Light, clean scent
- (Long lasting) (lasts a long time) (goes further) (last longer)
- Makes (your job) (cleaning) (easier) (easy)
- More cleaning in one wipe
- No harsh scent
- No (mixing) (spraying) (mess) (and / or fuss) (no muss)
- No (more) (pinched fingers) (rips) (tears)
- No rinsing required
- No sprays, no sponges, no mess
- Non-abrasive
- Non-scratch(ing)
- Non-scratching
- Now cleaning is (faster) (easier) than (ever) (before)
- One at a time (dispensing, like a tissue box)
- One step (clean) (cleaning)
- One wipe at a time dispensing
- One wipe goes a long way
- Package breakthrough
- Patent pending
- Phosphate free
- Picks up more messes than other wipes
- Portable
- Powers through (tough messes) (the dirt) (the grime)
- Quick easy clean-ups.
- Reduce (risk of cross contamination) (on hard non-porous surfaces)
- Removes the grime to give you more time (alt: Removes the grime so you have more time)
- Saves steps
- Saves Time
- Specially designed package that easily dispenses one at a time
- Specially formulated for use in the (kitchen) (bathroom)
- Sticky messes
- (Strong) (Thick) wipe
- Strong wipe for Heavy Duty cleaning
- Strong wipe for tougher (jobs) (messes)

(Note to reviewer: The following is considered optional marketing language:)

- The convenient way to disinfect your household surfaces
- The convenient way to keep your home looking "just cleaned"
- The smart (way to) clean(and disinfect)
- The wipe that disinfects while it cleans (up (stubborn) (stuck-on) messes)
- The wipe that is (strong) (durable) (thick) (heavy) enough to scrub (and) (clean)
- The wipe to use when you don't have much time
- These (wipes) (towelettes) (cloths) will not harm (most) surfaces.
- Thick (wipe), cloth-like texture
- Thicker
- Thicker than an ordinary wipe.
- This product contains no (phosphates or) phosphorous (compounds).
- Touch Up
- Tough cleaning (made easy) (made easier) (at your fingertips)
- Tough enough to do the bigger cleaning jobs.
- (Tough) (Thick) wipe(s) for tough (cleaning) (messes)
- Tough(er) wipe for tough(er) cleaning (jobs)
- Tough like a towel
- Two in one action (cleans and disinfects in one easy step)
- Use (daily) to clean bathroom soils such as soap, soap scum, toothpaste, hair spray, hair gel, cosmetics, shaving cream, hand or body lotion.
- Will not scratch
- Wipes are good for quick touchups
- With a cloth-like 3D texture
- With extra cleaning power (wipes) (sheets) (cloths)
- With (extra) scrubbing power
- With extra strength (wipes) (sheets) (cloths)
- Worry free (disinfecting) (cleaning)
- No more need to get on your hands and knees to (scrub) (or clean) stubborn spots.
- (Antimicrobial) (antibacterial) (disinfecting)
- (Textured cloth) gets up stubborn stuck on messes
- 3 (steps) in 1- wipes, scrubs and disinfects (so you finish faster)
- Cleans faster because the (scrubbies) (texture) removes (stubborn) (stuck on) (dirt) (messes)
- Dual (action) (purpose) (scrubs) wipes)
- No more need to get on your hands and knees to (scrub) (or clean) stubborn spots.
- Scrub-N-Wipe(s)
- Scrubs like no other (wipe)
- Scrubs like no other (wipe)
- Textured (cloths) (towelettes) clean floors faster (and easier)
- Textured (Wipe) (cloth) (towelette) (for tough jobs) (for tough cleaning)

(Note to reviewer: The following is considered optional marketing language:)

- Powers through tough messes
- Powers through tough messes all over the house
- Thicker, cloth-like feel for tough messes
- Thicker
- Variety Pack
- Easier dispensing
- Fewer rips, bunches, and snags
- Dispenses like a tissue, cleans like a cloth
- Easy dispensing (and) (tough texture) (for the ultimate wipes experience)
- (Helps) (eliminate)(neutralize) (odors) (with Febreze fresh scent)
- Leaves a (light) (clean) (fresh) scent
- A fresh take on tough cleaning
- With Febreze freshness (fresh scent)
- Wipes out odors
- Odor (elimination) (neutralization)(-eliminating)(neutralizing) power (of Febreze)
- Powerful cleaning with Febreze fresh scent(s)
- Powerful cleaner for kitchen and bath
- (Eliminates)(Neutralizes) odors (and freshens) on contact
- Powers through odor
- Tough on odor
- Long lasting scent
- For a long lasting scent experience
- Tough cleaning without the tough cleaning smell
- Don't just mask odors – (eliminate)(neutralize) them
- Power(s) through (tough) (messes) (dirt) (and grease) and (help(s)) (eliminate(s))(neutralize(s)) odors (with Febreze fresh scent)
- Powerful cleaning plus odor-(elimination)(neutralization) with Febreze fresh scent
- Powerful cleaning and helps (eliminate)(neutralize) odors with Febreze fresh scent.

(Note to reviewer: The following is considered optional marketing language:)

- Eliminate dirt and (neutralize) odor
- Leave behind a Febreze fresh scent.
- (Helps) (eliminate(s)) (neutralize(s)) odors with Febreze fresh scent.
- Powerful cleaning with Febreze fresh scent.
- Traps and locks away dirt
- Cleans (grease) better than ever
- (Our) toughest wipe ever
- Improved scrubbing texture
- Clean more with less
- Textured for better (cleaning) (scrubbing) power
- More scrubbing power
- Our most powerful cleaning formula ever
- (Scrubs) (cleans) better than ever
- Guaranteed (to clean longer) (you'll use fewer wipes to clean more)
- Get it done with one
- Cleans more than ever
- More cleaning power per wipe
- One wipe will get it done
- Traps & locks away (dirt) (grease) (messes) (crumbs) (hair) (lint) (dust) (dirty greasy messes)
- With (Magic Lock) (Magic Scrub) (Trap n' Lock) (Magic Quilt) fiber(s)
- Traps and locks grease and grime
- Clean to a virtually streak-free shine
- Low-streak formula is great on (glass) (mirrors) (dark countertops) (stainless steel) (stovetops) (stainless)
- (New) (Now) (less-residue) (low-residue) (low-streak) formula
- Now (2x) (3x) (4x) (5x) the (grease) cleaning power
- Now cleans better on grease
- (25%) (30%) (50%) more grease cleaning power
- (30%) thicker wipes
- Large Size, Small Size, Bonus Pack
- XX% More (Free) Wipes, Bonus Size, (Bonus) (Free) (27-ct) (35-ct) Wipes, XX for the Price of YY.
- Great for Everyday (Disinfecting) (Cleaning) (Wiping) (Messes)
- (Designed) (Built) for Everyday (Disinfecting) (Cleaning) (Wiping) (Messes)
- (Designed) (Built) for disinfecting and (cleaning) (wiping) everyday messes
- (Everyday) (Regular) Wiping
- (Everyday) (Regular) Cleaning
- (Everyday) (Regular) (Cleaning) Wipes
- Daily (Surface) (Disinfectant) (Cleaner)
- Everyday (Surface) (Disinfectant) (Cleaner)
- (Unique) (Special) (Thick) (Quilted) Texture for Tough (Messes) (Cleaning)

(Note to reviewer: The following is considered optional marketing language:)

- (Special) (Unique) 3-D Texture for Tough Messes
- (Great) (Designed) (Built) for Tough (Messes) (Cleaning)
- (Great) (Designed) (Built) (Tough) (Textured Design) for your Toughest Messes
- 30% Thicker and Quilted Texture (for Tough) (Messes) (Cleaning)
- Textured to Pick Up Particles
- (Quilted Texture) (Textured) to (Scrub) (Power) (Fight) Through Tough Messes
- Grooved for (Grime) (Tough Messes) (Grease)
- Tough (Textured) Wipes
- Our most powerful (grease) (deep) cleaning wipe ever
- Wipes to a (Clean) Shine (Sparkle)
- Wipes Through (Tough) (Everyday) (Messes) (Grease) (Grim)
- Wipes Away (Tough) (Everyday) (Messes) (Grease) (Grim)
- Wipes Out (Tough) (Everyday) (Messes) (Grease) (Grim)
- Wipes Up (Tough) (Everyday) (Messes) (Grease) (Grim)
- Cuts Through (Tough) (Messes) (Grease) (Grim)
- Cleans to a (Sparkle) (Shine)
- Life is Messy, (Wipe) (Clean) it up
- Life doesn't stop for messes, (Wipe) (Clean) it up
- (Assorted) (Mixed) (Special) (Variety) (Multiple) (Multi) (Bundle) (Pack)
- (Regular) (and) (Everyday) Wipe Pack
- (Special) School (Variety) (Bundle) (Pack)
- Back to School (Variety) (Special) (Bundle) (Pack)
- (2) (Two) (1) (One) For You (1) (One) For School
- (Send) Bring Wipes (Me) to School
- Great for Cleaning a Classroom
- (Great) for (Spring) (Home) (Kitchen) (Bathroom) (Dorm) (Office) (Cart) (Car) Cleaning
- (Great) for Cleaning Your (Home) (Kitchen) (Bathroom) (Room) (Dorm) (Office) (Cart) (Car)
- Spring Cleaning (Special) (Value) (Bonus) Pack)
- Tough Enough to Clean a Classroom
- Clean and Disinfect from Classroom to Playground (and everything in between)
- Disinfecting Wipes
- Sanitizing Wipes
- (Disinfecting) (Sanitizing) Formula
- (Kills) (Fights) Germs (Influenza Type A/Brazil, the Flu Virus) (Bacteria) (Bacteria and Viruses) (Viruses)
- (Kills) (Fights) Wipe Out (Germs) (Influenza Type A/Brazil, the Flu Virus) (Bacteria) (Viruses)
- Wipe Away (Germs) (Influenza Type A/Brazil, the Flu Virus) (Bacteria) (Viruses)
- Wipe Up (Germs) (Influenza Type A/Brazil, the Flu Virus) (Bacteria) (Viruses)
- Disinfect (Your Desk) (Your Office) (Your Room) (Daily) (Everyday)

(Note to reviewer: The following is considered optional marketing language:)

- Disinfect (Surfaces) (Your House) (Your Kitchen) (Your Bathroom) (Daily) (Everyday)
- Remove (99.9% of) (Bacteria) (Germs) (from Your) (Surfaces) (Home) (Kitchen) (Bathroom) (Office)
- Kills 99.9% of Germs (Bacteria) (Viruses) (Bacteria and Viruses)
- Kills 99.9% of Germs (Bacteria) (Viruses) (Bacteria and Viruses)
- Kills (Wipes Out) (99.9%) (of) (Rotavirus, the Diarrhea Causing Virus) (Listeria) (MRSA) (Methicillin-Resistant Staphylococcus Aureus) (Norwalk)
- Wipe down your seat. Bring [wet] [wipes] [or] [handi-wipes] to wipe down the [arm rests] [window areas] [seatbelt clasps] [and] [tray table] where you'll be sitting.
- Kills Mold, Mildew, & Fungus
- Kills Foot Fungus
- Kills Athletes Foot Fungus
- Kills Bathroom shower fungus and mold
- Streakfree
- Stronger Wipe
- Thicker wipe (cushionyTHICK™)

Cleaning Advice? Visit www.mrclean.com

CONTAINS NO PHOSPHATE

Scent Names

(Note to reviewer: Each block below also represents a graphic depicting the corresponding scent with the exception of citrus, apple, and berries, which would be submitted to the Agency for review.)

•	(with) (Febreze) (fresh scent) [scent name] (fresh scent)
•	[scent names]
•	Meadows & Rain
•	Lavender Vanilla & Comfort
•	Vanilla Lavender & Comfort
•	Citrus & Light
•	Spring & Renewal
•	Linen & Sky
•	Rocky Springs & Cool
•	Apple Spice & Delight
•	Powder & Elegance
•	Blossoms & Breeze
•	Summer & Splash
•	Berries & Paradise

(Note to reviewer: The following is considered optional marketing language:)

- [Substrate] [Wipe] [Towelette] [Cloth] composed of 100% [x%] recycled materials
- [Substrate] [Wipe] [Towelette] [Cloth] composed of 100% [x%] renewable materials
- [Substrate] [Wipe] [Towelette] [Cloth] [material] derived 100% from [wood pulp] [cotton] [cellulose] [recycled cellulose]
- [Flushable] [and Dispersible] substrates [wipes] [towelette] [cloth]
- 100% Cotton Wipe fabric
- ~~Biodegradable wipe fabric~~
- Wipe fabric made from 100% renewable resources
- Only use approved refill packs.

(Note to reviewer: the following claims relate to the packaging)

- Package is 100% recyclable
- Package contains xx% recycled materials
- Package contains xx% post consumer waste
- [Eco-shape Canister]
- [Made with] X% less plastic
- [Made with] X% less plastic [than similar size containers][than previous(ly) used container(s)]
- [Less Oil Consumption], [Landfill Waste], [Production Energy], [and] [Freight Energy]
- [This product was] [Produced] [Manufactured] with [100%] [x%] wind energy
- Packaged with 100% [x%] wind energy
- Converted with 100% [x%] wind energy
- Produced with Wind Energy
- Energy Efficient Canister

(Note to reviewer: The following is considered optional marketing language:)

Lonza Disinfectant Wipes:

- deliver non-acid disinfectant and cleaning performance
- (are a heavy duty disinfectant cleaner that) cleans, disinfects and deodorizes in one labor saving step.
- deodorizes by killing microorganisms (bacteria) that cause offensive odors.
- (improves labor results by) effectively controls (controlling) malodors.
- will disinfect, clean and deodorize surfaces in rest rooms and toilet areas, behind and under sinks and counters, garbage cans and garbage storage areas, and other places where bacterial growth can cause malodors.
- is formulated for use in daily maintenance programs with a balance of detergents, biocides and malodor counteractants that deliver effective cleaning, disinfecting and malodor control.
- is a complete, chemically balanced disinfectant
- will not leave grit or soap scum.
- is a (one-step) disinfectant cleaner that is effective against a broad spectrum of bacteria when used as directed.
- is a proven "one-step" disinfectant - cleaner which is effective the presence of 5% serum contamination.
- (Kills) (eliminates) (kitchen) (bathroom) (household) bacteria.
- (Kills) (eliminates) common household bacteria.
- Starts killing (bacteria) on contact
- Kills (eliminates) bacteria
- help you accomplish things you never thought a wipe could do
- (wipes) (cloths) (sheets) help you to accomplish things you never thought a wipe could do
- (help) take the hassle out of dispensing disinfecting wipes. The Easy-Glide Lid dispenses wipes one-at-a-time, like a tissue-box, so you get the number of wipes you want with no pinched fingers, (torn wipes), (or) (jammed lids). Plus they kill bacteria**** to keep your (family's) home (clean). Use it on bathroom and kitchen surfaces like countertops, appliances, door handles, light switches, toilets, sinks, and tubs.
- are designed for your toughest tasks. They are (thick and strong) (thicker and stronger) to stand up to (tough) (your toughest) messes, and they have a cloth-like texture for extra scrubbing power. Plus they kill bacteria**** to (help) keep your (family's) (home) (clean). Try it (them) on (your) tough (toughest) messes in the kitchen and bathroom, like baked-on grease on your stove (top), sticky messes on your counters, and built-up grime on your bathroom sinks.

Cross-contamination is of major (housekeeping) concern. **Lonza Disinfectant Wipes** have been formulated to aid in the reduction of cross-contamination in the home, schools, institutions and industry.

(Note to reviewer: The following is considered optional marketing language:)

Use Lonza Disinfectant Wipes:

- in federally inspected Meat & Poultry Plants as a disinfectant on all surfaces in inedible product processing areas, non-processing areas and / or exterior areas..
- as a disinfectant on hard, nonporous surfaces.
- in kitchens, bathrooms and other household areas.
- to clean and disinfect finished floors, sinks and tubs.
- for non-scratch cleaning of showers and tubs, shower doors and curtains, fixtures and exterior toilet bowl surfaces.
- to clean and disinfect non-porous personal (safety) (protection) equipment, protective headgear, hard hats, half mask respirators, full face breathing apparatus, gas masks, goggles, spectacles, face shields, silicone rubber or PVC hearing protectors and vinyl covered ear muffs. Rinse all equipment that comes in contact with skin before reuse with clean warm water (about 120°F), and allow to air dry. (Caution: Cleaning at 120°F temperature will avoid overheating and distortion of the personal (safety) (protection) equipment that would necessitate replacement.
- to clean and disinfect hard non-porous surfaces of gym equipment, exercise machines, wrestling mats and gymnastic equipment.

(Note to reviewer: The following is considered optional marketing language:)

Lonza Disinfectant Wipes are a one-step disinfectant and Bactericidal according to the current AOAC Use-Dilution Test Method modified in the presence of 5% organic serum against:

or

Lonza Disinfectant Wipes are effective against (Kills) (Eliminates) (Removes) (Destroys):

****[Bacteria]

Staphylococcus aureus (Staph)

Salmonella enterica (Salmonella)

Pseudomonas aeruginosa [Pseudomonas]

Campylobacter jejuni [Campylobacter]

Acinetobacter baumannii

Brevibacterium ammoniagenes [Brevibacterium]

Campylobacter jejuni

Community Associated Methicillin-Resistant Staphylococcus aureus

- [CA-MRSA] (NRS384) (USA300)

Community Associated Methicillin-Resistant Staphylococcus aureus

- [CA-MRSA] (NRS123) (USA400)

Enterobacter aerogenes

Enterococcus faecalis [Enterococcus]

Enterococcus faecalis- Vancomycin Resistant [VRE]

Escherichia coli [E. coli]

ESBL Escherichia coli – [Extended spectrum beta-lactamase producing E. coli]

Klebsiella pneumoniae [Klebsiella]

Legionella pneumophila

Pseudomonas cepacia [Pseudomonas]

Salmonella schottmuelleri [Salmonella]

Salmonella typhi [Salmonella]

Serratia marcescens [Serratia]

Shigella dysenteriae [Shigella]

Staphylococcus aureus - Methicillin-Resistant [MRSA]

Staphylococcus aureus - Multi-Drug Resistant

Staphylococcus aureus-Vancomycin Intermediate Resistant – [VISA]

Streptococcus pyogenes [Strep] [a cause of scarlet fever]

Vibrio cholerae

(Continued from previous page)

[Viruses:]

- *Hepatitis B Virus [HBV]
- *Hepatitis C Virus [HCV]
- *Herpes Simplex Virus Type 1
- *Herpes Simplex Virus Type 2
- *HIV-1 [AIDS Virus]
- *Human Coronavirus
- *Influenza Type A / Brazil [Influenza] [(the) Flu (Virus)]
- *Norwalk Virus [Norovirus]
- *Respiratory Syncytial Virus [RSV]
- *Rotavirus [Diarrhea-causing virus]
- *SARS Associated Coronavirus [SARS] [cause of Severe Acute Respiratory Syndrome]
- *Vaccinia [Pox Virus]

[Animal Viruses:]

Avian Influenza (virus) (H3N2)
Avian Influenza (virus) (H5N1)
Avian Infectious Bronchitis Virus
Canine Distemper Virus
Feline Calicivirus
Newcastle's Disease Virus
Pseudorabies Virus

[Fungi:]

Aspergillus niger
Trichophyton mentagrophytes [the Athlete's Foot Fungus]
[A cause of Ringworm of the foot]

(Note to reviewer: The following is considered optional marketing language:)

(Note to reviewer: Each block below also represents a graphic depicting the corresponding area of use. The graphics will only represent individual objects or outsides or insides of buildings as described below. No people or food will be depicted in graphics.)

(AREAS OF USE:)

Use Lonza Disinfectant Wipes in:

Bathrooms	Hotels
Children's room	Institutional facilities
Homes (households)	Institutions
Kitchens	Laundry rooms
Living room	Locker rooms
	Motels
Dental offices	Playrooms
Hospitals	Prisons
Medical Offices	Public facilities
Nursing homes	Public rest rooms
	Salons
Day care centers	Schools
Nurseries	Shower and bath areas
	Sick rooms
Bars	
Cafeterias	Camp grounds
Convenience stores	Play ground equipment
Food processing plants	
Food storage areas	Airplanes
Institutional kitchens	Airports
Restaurants	Ambulances
USDA inspected food processing facilities	Boats
	Buses
Athletic facilities	Campers
Barber shops	Cars
Business and office buildings	Emergency (Police) (EMS) (Fire) (Rescue) vehicles
Colleges	Mobile homes
Correctional facilities	Ships
Dressing rooms	Taxis
Exercise facilities	Trailers
Factories	Trains
Family Rooms (Dens)	
Health clubs	Transportation terminals

(Note to reviewer: The following is considered optional marketing language:)
 (Note to reviewer: Each block below also represents a graphic depicting the corresponding type of surface. No people or food will be depicted in graphics. Only exteriors of microwaves and refrigerators will be depicted. Toy graphics will be submitted to Agency for review.)

(TYPES OF SURFACES:)

Use **Lonza Disinfectant Wipes** on washable hard, nonporous surfaces of:

Appliances	Shower stalls
Bathroom fixtures	Sinks (bathroom, kitchen)
Bathtubs [Fiberglass]	Storage areas
Cabinets	Stoves (stovetops)
Cages	Tables, (picnic tables)
Car seat	Telephones
Chairs	Exterior Toilet bowl surfaces
Computer keyboards	Toilet seats
Counters (countertops)	Toys***
Cupboards	Tubs
Desks	Tiles, glazed
Diaper changing (tables)(counters)	Walls
Diaper pails	Tanning Beds
Doorknobs	Non-critical medical device surfaces:
Equipment tables	Beds [Medical] [Hospital]
Faucets	Bed frames
Faucet Handles	Bed rails
Floors	Crutches
Finished floors	Defibrillators
Garbage cans	Gurneys
Glass	Non-critical [hospital] [medical] equipment surfaces
Highchairs	[Medical] Examining tables
Lab benches	[Medical] [Hospital] Lamps
Linoleum	Rescue tools
Light switches	Resuscitators
Laminate flooring	[Medical] [Hospital] Scales
Microwave ovens - exteriors	Stands
Non-Wooden Outdoor (patio) furniture except cushions and wood frames	Stretchers
Refrigerators - exteriors	Stethoscopes
Refrigerated storage and display equipment	Walkers
Sealed floors	Wheel chairs
Showers	Ultra-sound transducers and equipment
Shopping cart handles	

***Rinse toys with clean, potable water after disinfecting.

(Note to reviewer: The following is considered optional marketing language:)

(TYPES OF SURFACES:)

Use **Lonza Disinfectant Wipes** on washable hard, nonporous surfaces of:

<u>Other hard nonporous surfaces made of:</u>
Acrylic
Finished woodwork
Formica®
Glass
Glazed ceramic
Glazed enameled surfaces
Glazed porcelain
Metal
Plastic (such as polystyrene or polypropylene)
Sealed granite
Sealed marble
Sealed quartz
Sealed stone
Stainless steel
Upholstery- vinyl and plastic

Note: Do not use on unpainted wood, natural marble or brass.

(Note to reviewer: The following is considered optional marketing language:)

(For canister)

To Open Package:

Remove cover. Pull up (towelette) (wipe) (cloth) corner from center of roll. Thread through hole in the cover. Replace cover. Open center cap on cover to remove wipe. When not in use (When not using), close center cap (securely) to prevent moisture loss.

or (For carton or tub)

To Open Package: Open cover and slowly peel back label on pouch. Remove (Pull out) (wipe) (towelette) (cloth) as needed. To retain moisture, reseal (pouch) (bag) by firmly pressing seal back on the (pouch) (bag) and close (carton or tub) cover.

or (For refill, pouch or bag:)

To Open Package:

(Slowly) peel back the label (open seal). Remove (Pull out) (wipe) (towelette) (cloth) as needed. To retain moisture, reseal (pouch) (bag) by firmly pressing seal back on the (pouch) (bag)

or (for the Travel Pack size):

To Open Package: Slowly peel back label. (Pull out) (Remove) (wipes) (towelettes) (cloths) as needed. Reseal label to retain moisture.

or To Open Package: Open ziplock (Tear edge of pack). (Pull out) (Remove) (wipes) (towelettes) (cloths) as needed. Reseal ziplock to retain moisture.

or (for the single cloth or sample pack):

To Open Package: Tear (pouch) open (at top edge of pouch) (at tear notch) (along dotted line) (where indicated) (edge of pack). (Pull out) (Remove) (Wipe) (Towelette) (Cloth).

(For product supplied in a single use pouch with a folded towellete, include the following:)
Unfold (Wipe) (Towelette) (Cloth)

or

To Open Package: (Remove package seal(s)) (Remove safety seal(s)) (Flip) Open lid. To remove first wipe (sheet) (wet cloth) cloth pull up on wipe and remove wipe through (dispensing) opening (wavy dispensing opening) (orifice). (The next wipe will pop up automatically). (Always) close (snap) lid securely between uses (to retain moisture).

or

To Open Package: (Remove package seal(s)) (Remove safety seal(s)). Open (Flip open lid (package)). To start (remove) (first) wipe (sheet) (wet cloth) take the edge of wipe from large opening to the small dispensing opening and pull up. (The next wipe (sheet) (wet cloth) (cloth) will pop up automatically.) (Always) close (snap) lid securely between uses (to retain moisture).

(Note to reviewer: The following is considered optional marketing language:)

or

To Open Package: Open Lid. To start wipes, pull up on wipe and move wipe into the small dispensing opening (orifice) (aperture) (hole) (wave) and (pull sheet up to remove wipe) remove wipe. (The next wipe (sheet) (wet cloth) will pop up automatically). (Always) close (snap) lid securely between uses (to retain moisture).

or

To Open Package: Flip open(up) the lid(cover)(top)(cap)(dispensing lid). Thread the wipe (first wipe)(cloth)(first cloth)(sheet) through the dispensing lid and pull up to remove wipe from package. The next wipe (sheet)(cloth) pops up automatically. Close lid securely between uses to retain moisture(prevent moisture loss).

or

To Open Package: Press the three (3) ridges with your thumb and push up on the cap(top)(lid) to open(lid). To remove wipe (sheet) (wet cloth) (cloth) (towelette) pull up on wipe and remove wipe through (dispensing) opening (wavy dispensing opening) (orifice). (The next wipe will pop up automatically).

or

To Open Package: Press the three (3) ridges with your thumb and push up on the cap(top)(lid) to open(lid). Thread the wipe (sheet) (wet cloth) (cloth) (towelette) through the dispensing lid and pull up to remove wipe from package. The next wipe will pop(pull) up automatically. (Always) Close (snap) lid securely between uses (to retain moisture).

or

To Open Package: Press the three (3) ridges with your thumb and push up on the lid to open. Thread the wipe through the dispensing lid and pull up to remove wipe from package. The next wipe will pop up automatically. Close lid securely between uses to retain moisture.

or

To Open Package: Push the area marked ("Press") ("Push") ("Press Here") ("Push Here") with your thumb and push up on the lid to open. Thread the wipe through the dispensing lid and pull up to remove wipe from package. The next wipe will pop up automatically. Close lid securely between uses to retain moisture.

DIRECTIONS FOR USE:

It is a violation of Federal law to use this product in a manner inconsistent with its labeling.

TO CLEAN AND DEODORIZE:

Wipe surface with (wipe) (towelette) (cloth) (sheet). Let air dry. Discard used (wipe) (towelette) (cloth) (sheet) in trash. Do not flush in toilet.

TO CLEAN AND DISINFECT (DISINFECTION / VIRUCIDAL* / FUNGICIDAL / MOLD AND MILDEW CONTROL DIRECTIONS):

Wipe (hard, nonporous) surface with (wipe) (towelette) (cloth) (sheet) until surface is visibly wet. (Use enough wipes to thoroughly wet surfaces.) (Use (enough) (extra) wipes to keep surfaces (visibly) wet for 10 minutes.) (Keep surfaces (visibly) wet for 10 minutes.) (Wipe surface and let it remain (visible) wet for 10 minutes.) Allow surface to remain wet for 10 minutes. (Let air dry.) ((Let) Permit surface to (air) dry.)

If surfaces are extremely dirty, clean first with another (wipe) (towelette) (cloth) (sheet) before disinfecting.

Discard used (wipe) (towelette) (cloth) (sheet) in trash. Do not flush (in toilet).

Rinse food contact surfaces with clean, potable water after disinfecting. Do not use to disinfect dishes, glassware or utensils.

Do not use as a diaper wipe or for personal cleansing.

(Note; Not recommended for unpainted wood, natural marble or brass.)

For fungicidal activity, Lonza Disinfectant Wipes is an effective fungicide against Trichophyton mentagrophytes [the athlete's foot fungus] in areas such as locker rooms, dressing rooms, shower and bath areas and exercise facilities.

Lonza Disinfectant Wipes is a one-step fungicide.

For mold and mildew, Lonza Disinfectant Wipes will effectively inhibit the growth of mold and mildew and the odors caused by them when applied to hard, nonporous surfaces. Follow disinfection instructions. Repeat treatment every seven days, or more often if new growth appears.

***KILLS HIV AND HBV AND HCV ON PRE-CLEANED ENVIRONMENTAL SURFACES / OBJECTS PREVIOUSLY SOILED WITH BLOOD / BODY FLUIDS** in health care settings or other settings in which there is an expected likelihood of soiling of inanimate surfaces / objects with blood or body fluids, and in which the surfaces / objects likely to be soiled with blood or body fluids can be associated with the potential for transmission of Human Immunodeficiency Virus Type 1 (HIV-1) (associated with AIDS) or Hepatitis B Virus (HBV) or Hepatitis C Virus (HCV).

SPECIAL INSTRUCTIONS FOR CLEANING AND DECONTAMINATION AGAINST HIV-1 OR HBV OR HCV ON SURFACES / OBJECTS SOILED WITH BLOOD / BODY FLUIDS.

Personal protection: Clean-up must always be done wearing protective gloves, gowns, masks and eye protection.

Cleaning procedure: Blood and other body fluids containing HIV or HBV or HCV must be thoroughly cleaned from surfaces and objects before application of Lonza Disinfectant Wipes. Lonza Disinfectant Wipes (this product) (wipe) (towellete) (cloth) (sheet) can be used for this purpose.

Contact time: Leave surface wet for 1 minute (60 seconds) for HIV-1 and 10 minutes for HBV and HCV. Use a 10-minute contact time for disinfection against all other viruses, bacteria and fungi claimed.

Disposal of infectious material: Blood, body fluids, cleaning materials and clothing should be autoclaved and disposed of according to local regulations for infectious waste disposal.

(Note to reviewer: If Avian Influenza A is listed on the label the following statement is required.)

This product is for use on hard nonporous surfaces not conducive to treatment by immersion or excess liquid against Avian Influenza A.

DIRECTIONS FOR FLOOR WIPE USE:

It is a violation of Federal Law to use this product in a manner inconsistent with its labeling.

TO CLEAN AND DEODORIZE: Wipe surface with wipe. Let air dry. Discard used wipe in trash. Do not flush in toilet.

TO CLEAN AND DISINFECT: Pre-clean floor in normal manner. (Attach a premoistened wipe to the mop head using the (velcro) (fasteners) provided.) Thoroughly wet floor with wipes. (Change wipe when soiled.) or (Replace with a fresh wipe once visibly soiled or no longer thoroughly wetting the surface.) Allow surface to remain visibly wet for 10 minutes. Let air dry. On average, one wipe will clean [10] [x] square feet of floor. For a larger area you may need to use more than one wipe. Discard used wipe in trash. Do not flush. Do not use to disinfect dishes, glassware or utensils. Do not use as a diaper wipe or for personal cleansing. Contact manufacturer of wood floors prior to use.

Note: Not recommended for unpainted wood, natural marble or brass.
Do not use on unfinished, oiled or waxed wood, unsealed tiles or carpet.
Keep container flat and lid securely closed to keep cloths moist.

(Optional representative graphic)

Use on
mop
head.

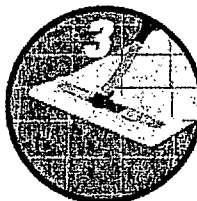
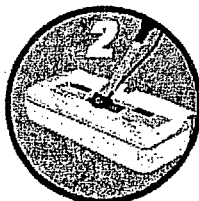
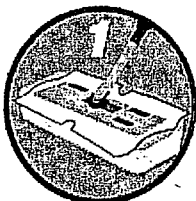

TO OPEN:

1. Cut off top of pouch with scissors.
2. Remove wipes from pouch.
3. Place wipes in plastic tub.
4. Discard empty pouch into trash.

TO USE WITH MOP:

1. Unfold top wipe in tub by pulling sides of the cloth over edges of tub.
2. Place sweeper on head
3. Wrap wipe around head of sweeper.
4. Push edges of wipe into on top of sweeper head.
5. Begin wiping. No rinsing required.
6. After use, remove soiled wipe and discard in trash. Do not flush.

PACKET LABEL TO BE USED WITH MASTER CONTAINER LABEL

LONZA DISINFECTANT WIPES

EPA. Reg. No. 6836-313

EPA. Est. No. *(insert EPA Est. No. here)*

Net Contents:

Net Contents: (expressed as avoirdupois pounds and ounces)
(optional - wipe dimensions:) X x X [inches] [in.]

Active Ingredients:

Octyl decyl dimethyl ammonium chloride 0.069%

Dioctyl dimethyl ammonium chloride 0.028%

Didecyl dimethyl ammonium chloride 0.042%

Alkyl (C₁₄, 50%; C₁₂, 40%; C₁₆, 10%)
dimethyl benzyl ammonium chloride 0.093%

Other Ingredients:..... 99.768%

Total *100.000%

* Includes weight of absorbent wipe.

KEEP OUT OF REACH OF CHILDREN

CAUTION

See outer container for Precautionary Statements and Use directions

DISPOSAL: Dispose (wipe) (towelette) (Cloth) in trash after use. Discard empty (pouch) (packet) in trash.

Lonza Inc.
90 Boroline Road
Allendale, NJ 07401