

5813-58

UNITED STATES ENVIRONMENTAL PROTECTION AGENCY

1113

04/26/2007



UNITED STATES ENVIRONMENTAL PROTECTION AGENCY
Washington, D.C. 20460

APR 26 2007

OFFICE OF
PREVENTION, PESTICIDES
AND TOXIC SUBSTANCES

Monica Waite
Registration Specialist
The Clorox Company
c/o PS&RC; P.O. Box 493
Pleasanton, CA 94566

Subject: Spruce - Ups
EPA Reg. No. 5813-58
Application Dated March 23, 2007
Receipt Date: March 27, 2007

Dear Monica Waite

The following notification submitted in connection with registration under the provisions of PR Notice 98-10, Federal Insecticide, Fungicide, and Rodenticide Act (FIFRA) section 3(c)9. is acceptable.

Proposed Notification

- Addition Graphics to Label.

Comments

Based on a review of the material submitted, the following comments apply:
This application for notification to add graphics is acceptable. A copy has been placed in our records for future reference.

Note: Remove the graphic of bear from label as this product is to be used on hard non-porous surfaces and the teddy bear is qualified as a porous surface.

Should you have any questions or comments concerning this letter, please contact Velma Noble at (703) 308-6233.

Sincerely,

Velma Noble
Product Manager (31)
Regulatory Management Branch1
Antimicrobial Division (7510c)

CONCURRENCES

7510c							
4-17-07							



United States
Environmental Protection Agency
Washington, DC 20460

☐ Registration
☐ Amendment
☒ Other

OPP Identifier Number

MW0031

Application for Pesticide - Section I

1. Company/Product Number 5813-58	2. EPA Product Manager Velma Noble	3. Proposed Classification <input type="checkbox"/> None <input type="checkbox"/> Restricted
4. Company/Product (Name) Spruce-Ups	PM# 31	
5. Name and Address of Applicant (Include ZIP Code) The Clorox Company c/o PS&RC; P.O. Box 493 Pleasanton, CA 94566-0803 <input type="checkbox"/> Check if this is a new address	6. Expedited Review. In accordance with FIFRA Section 3(c)(3) (b)(i), my product is similar or identical in composition and labeling to: EPA Reg. No. _____ Product Name _____	

Section - II

<input type="checkbox"/> Amendment - Explain below.	<input type="checkbox"/> Final printed labels in response to Agency letter dated _____
<input type="checkbox"/> Resubmission in response to Agency letter dated _____	<input type="checkbox"/> "Me Too" Application.
<input checked="" type="checkbox"/> Notification - Explain below.	<input type="checkbox"/> Other - Explain below.

Explanation: Use additional page(s) if necessary. (For section I and Section II.)

Notification of "Designer Series" (fresh scent) label graphics. Enclosed are one (1) color copy and five (5) black and white copies of the graphics labels along with one copy of the federal label (highlighted). This notification is consistent with the provisions of PR Notice 98-10 and EPA regulations at 40 CFR 152.46, and no other changes have been made to the labeling or the confidential statement of formula of this product. I understand that it is a violation of 18 U.S.C. Sec. 1001 to willfully make any false statement to EPA. I further understand that if this notification is not consistent with the terms of PR Notice 98-10 and 40 CFR 152.46, this product may be in violation of FIFRA and I may be subject to enforcement action and penalties under sections 12 and 14 of FIFRA.

Section - III

1. Material This Product Will Be Packaged In:			
Child-Resistant Packaging <input type="checkbox"/> Yes <input type="checkbox"/> No	Unit Packaging <input type="checkbox"/> Yes <input type="checkbox"/> No	Water Soluble Packaging <input type="checkbox"/> Yes <input type="checkbox"/> No	2. Type of Container <input type="checkbox"/> Metal <input type="checkbox"/> Plastic <input type="checkbox"/> Glass <input type="checkbox"/> Paper <input type="checkbox"/> Other (Specify) _____
* Certification must be submitted		If "Yes" Unit Packaging wgt. No. per container	If "Yes" Package wgt No. per container
3. Location of Net Contents Information <input type="checkbox"/> Label <input type="checkbox"/> Container		4. Size(s) Retail Container	5. Location of Label Directions <input type="checkbox"/>
6. Manner in Which Label is Affixed to Product <input type="checkbox"/> Lithograph <input type="checkbox"/> Paper glued <input type="checkbox"/> Stenciled <input type="checkbox"/> Other _____			

Section - IV

1. Contact Point (Complete items directly below for identification of individual to be contacted, if necessary, to process this application.)			
Name J. Evelyn Lawson	Title Senior Regulatory Information Scientist	Telephone No. (Include Area Code) 925-425-6842	
Certification I certify that the statements I have made on this form and all attachments thereto are true, accurate and complete. I acknowledge that any knowingly false or misleading statement may be punishable by fine or imprisonment or both under applicable law.			6. Date Application Received (Stamped)
2. Signature 	3. Title Registration Specialist		
4. Typed Name Monica Waite	5. Date March 21, 2007		

Note: **Bold, italicized text is information for the reader and is not part of the label.** [Bracketed information is optional text.]
Text separated by a diamond bullet (◆) denotes -and/or- options. Underlined text is new. Strike-through (~~text~~) means removed.

EPA Reg. No. 5813-58 Spruce-Ups Page 1 of 7

Spruce-Ups™

KEEP OUT OF REACH OF CHILDREN CAUTION

See back panel for additional precautionary statements.

For travel/trial sizes or dispensers: [Not for personal cleansing]

**For dispensers: [Do not use as a diaper wipe or for personal cleansing]
[For complete instructions -or- directions, see pouch]**

Questions or Comments? Please visit www.clorox.com or call us toll free at 1-800-227-1860. [Learn more at cloroxclassrooms.com] Mfd. for & © 1997-2004 The Clorox Company, Oakland, CA 94612. Clorox is a registered trademark of The Clorox Company. EPA Reg. No. 5813-58. EPA Est. No. 56952-AR-1, -WI-1, 8251-WI-1, -WI-2, -WI-3, -WI-4, -WI-5, 58455-IN-1, 5813-CA-4, 52631-NJ-1, 71681-IL-1, -IL-2. See Batch Code for Actual Est. No. US Patent(s) [pending]:

ACTIVE INGREDIENTS:

n-Alkyl (C14, 60%; C16, 30%; C12, 5%; C18, 5%)
Dimethyl Benzyl Ammonium Chloride 0.145%
n-Alkyl (C12, 68%; C14, 32%) Dimethyl Ethylbenzyl
Ammonium Chloride 0.145%
OTHER INGREDIENTS 99.710%
Contains no phosphorus

____ Premoistened -or- Wet [Scrubbing] Wipes -or- Refills -or- Packages

Package made from ____ % post-consumer recycled plastic.

For Canister:

TO OPEN PACKAGE: [Open lid and] pull out wipe from center of roll. [The] next sheet pops up automatically. [When finished,] close lid to retain moisture.

-or-

For Canister:

TO OPEN PACKAGE: Flip open dispensing flap and remove lid by lifting upward. Pull up corner of **CENTER SHEET**, twist to a point, and thread through small opening in lid. DO NOT push finger through opening; [your finger may become stuck]. Replace lid and **PULL WIPE AT AN ANGLE**, the next sheet pops up automatically. When finished, close lid flap to retain moisture.

For Tub and Pouch/Refill:

TO OPEN PACKAGE: [Flip open dispensing flap and remove lid by lifting upward.] Place refill -or- pouch in tub. Open pouch by peeling back seal. Insert sheet through opening in lid. Replace lid. The next sheet pops up automatically. When finished, close lid flap to retain moisture.

For pouch only:

TO OPEN PACKAGE: [Open pouch by] peel[ing] back seal. When finished, close to retain moisture.

For Multi-pack Refills:

TO OPEN PACKAGE:

- [Open [existing] container -or- canister according to label directions].
- [Tear] open [refill -or- package] by pulling on [the] tear strip -or- removing seal -or- pulling on the back -or- seal -or- tearing at notch.
- Remove [one] refill [from refill package -or- sleeve -or- container -or- pouch -or- bag].
- [Open refill [by pulling on [the] tear strip -or- removing seal -or- pulling on the back -or- seal -or- tearing at notch.]]
- [Turn upside down.] Slide -or- insert [pre-moistened] wipes -or- refill into existing -or- empty canister -or- container.
- Replace lid [on existing canister].
- Close refill package -or- sleeve -or- container -or- pouch -or- bag.

For Dispenser and Pouch/Refill:

TO ATTACH [DISPENSER]: Clean surface with rubbing alcohol and let it dry. Peel paper from adhesive [pads] [strips] and attach to surface. Press firmly for 10 seconds [(for best results, open refill door and apply pressure directly over adhesive [pads] [strips])]. Can be attached to tile, glass, finished wood and metal surfaces. Not recommended for use on wallpaper, [painted wallboard, plasterboard or drywall,] bare wood, or particleboard.

TO REFILL [DISPENSER]: Remove label from pouch. Slide pouch into dispenser through refill door. Open lid and pull first wipe through opening; next wipe pops up automatically.

TO REMOVE [DISPENSER]: Insert knife, twine or dental floss between dispenser and wall. Carefully cut tape between adhesive surfaces. Remove remaining residue with thumbnail or mild adhesive remover. Caution: improper removal may damage surfaces.

-or-

TO REMOVE [DISPENSER]: Hold [dispenser] [bracket] [with one hand]. Grab removable tab [with other hand]. [Slowly] pull tab several inches [in direction of arrow] [along mounting surface] until [bracket] [dispenser] releases. [Repeat with second tab.]

-or-

- Insert green plastic lid into the dispenser cover with the flap open and pointing back towards the stand. (Replace the green plastic lid each time the dispenser is refilled with wipes.)
- Cut or tear open pouch evenly at notch.
- Place pouch inside the dispenser. (Do not remove roll of wipes from pouch.)
- Insert corner of center sheet through opening on the green plastic lid. (Do not push finger through the opening.)
- Close dispenser cover.
- Pull first wipe at an angle to ensure proper threading.

Note: Bold, italicized text is information for the reader and is not part of the label. [Bracketed information is optional text.]
Text separated by a diamond bullet (◆) denotes -and/or- options. Underlined text is new. Strike-through (~~text~~) means removed.

EPA Reg. No. 5813-58 Spruce-Ups Page 2 of 7

DIRECTIONS FOR USE

IT IS A VIOLATION OF FEDERAL LAW TO USE THIS PRODUCT IN A MANNER INCONSISTENT WITH ITS LABELING.

TO CLEAN: Wipe surface [clean] with a wipe -or- with this product; let air dry.

TO SANITIZE: Use to sanitize/deodorize hard, nonporous surfaces: wipe surface; use enough wipes for treated surfaces to remain visibly wet for 30 seconds. Let surface dry. For highly soiled surfaces, clean excess dirt first.

TO DISINFECT (AND DEODORIZE): Use to disinfect hard, nonporous surfaces; wipe surface to be disinfected. Use enough wipes for treated surface to remain visibly wet for 4 minutes. Let surface dry. For highly soiled surfaces, clean excess dirt first. [Pre-clean all vehicles including mats, crates, cabs and wheels.]

This product is not to be used as a terminal sterilant/high level disinfectant on any surface or instrument that (1) is introduced directly into the human body, either into or in contact with the bloodstream or normally sterile areas of the body or (2) contact intact mucous membranes but does not ordinarily penetrate the blood barrier or otherwise enter normally sterile areas of the body. This product may be used to pre-clean or decontaminate critical or semi-critical medical devices prior to sterilization or high level disinfection.

Specific instructions for scrubbing wipes -or- heavy duty wipes:

TO CLEAN: Use the textured -or- scrubbing side of the wipe to remove tough soils. Use the soft -or- smooth side to wipe dirt away. If the textured -or- scrubbing side gets dirty, fold the wipe, keeping the textured -or- scrubbing side inside. Let air dry.

TO SANITIZE (AND DEODORIZE): Use the soft -or- smooth side of wipe to sanitize/deodorize hard, nonporous surfaces; wipe surface; use enough wipes for treated surfaces to remain wet for 30 seconds. Let surface dry. For highly soiled surfaces, clean excess dirt first.

TO DISINFECT: Use the soft -or- smooth side of wipe to disinfect hard, nonporous surfaces; wipe surface to be disinfected. Use enough wipes for treated surfaces to remain visibly wet for 4 minutes. Let surface dry. For highly soiled surfaces, clean excess dirt first.

Not for cleaning or sanitizing skin. Do not use as a diaper wipe or for personal cleansing.

Not recommended [for use] on [soft] [glossy] [shiny] [polished] [plastics] [metals] [wood] [copper] [aluminum] [painted surfaces] [fabric]. [If in doubt,] [test] on a small inconspicuous area [before using].

These wipes -or- this product will not harm most surfaces including acrylic, fiberglass and vinyl. Not recommended for use on unpainted wood [or glass].

For surfaces that may come in contact with food a potable water rinse is required.

PRECAUTIONARY STATEMENTS

HAZARDS TO HUMANS AND DOMESTIC ANIMALS.

CAUTION: Causes moderate eye irritation. Avoid contact with eyes or clothing. Wash thoroughly with soap and water after handling.

FIRST AID: If in eyes: Hold eye open and rinse slowly and gently with water for 15-20 minutes. Remove contact lenses, if present, after the first 5 minutes, then continue rinsing eye. Call a poison control center for treatment advice. Have the product container or label with you when calling a poison control center or doctor, or going for treatment. For further information, call (800) 227-1860.

PHYSICAL OR CHEMICAL HAZARDS

Do not use or store near heat or open flame.

STORAGE AND DISPOSAL

Canister -or- Tub:

Dispose of wipe in trash after use. Do not flush. Tightly close lid between uses to retain moisture. Do not reuse empty container. -or- Refill only with this product. Wrap container and discard in trash. -or- Offer empty container for recycling. If recycling is not available discard container in trash.

[Pouch] (Refill):

[Dispenser and Pouch/Refill]

Dispose of wipe in trash after use. Do not flush. [Reseal pouch between uses to retain moisture] [, if used without tub]. Do not reuse empty container. Discard in trash.



American
Red Cross

CHARITY LANGUAGE/LOGO/SYMBOL — front panel

Dedicated to a Healthier World
Help Clorox raise \$1 million for the American Red Cross.
See details on back.



Dedicated to a Healthier World

CHARITY LANGUAGE/LOGO/SYMBOL — back panel

More than 11 million people seek health and safety skills from the American Red Cross every year. Clorox proudly supports the American Red Cross by donating 3¢ for each specially marked unit of this product sold for one year beginning April 2007, up to a maximum donation of \$1 million. For more information about how the American Red Cross and Clorox can help protect you and your family, visit www.clorox.com/redcross. The American Red Cross name and emblem are used with its permission, which in no way constitutes an endorsement, express or implied, of any product or company.

Note: **Bold, italicized text is information for the reader and is not part of the label.** [Bracketed information is optional text.]
Text separated by a diamond bullet (◆) denotes -and/or- options. Underlined text is new. Strikethrough (~~text~~) means removed.

EPA Reg. No. 5813-58 Spruce-Ups Page 3 of 7

Antibacterial Claims:

- 30 second sanitization¹
- Anti-bacterial wipes -or- formula
- Bacteria-fighting -or- Germ-fighting formula
- Be ready for school by including Clorox Disinfecting Wipes on your [back to school] [home] shopping list
- Can reduce the spread of illness-causing [kitchen] [school] [classroom] [bathroom] [restroom] [household] [office] [work -or- office place] bacteria[†] -and/or- germs[*] [on hard, nonporous surfaces]
- Can help reduce the risk of cross-contamination [on treated surfaces]
- Clean -and/or- disinfect on the go
- Cleaner and disinfectant in one
- Cleaning -and/or- disinfecting power -and/or- effectiveness of Clorox® so your [bathroom] [home] [house] [school] [classroom] [kitchen] [office] [work -or- office place] [environment] is free of [grime] [dirt] [soils] [soap scum] you can see and germs -and/or- bacteria you can't [see]
- Cleans -and/or- disinfects -and/or- deodorizes
- [Clorox Disinfecting Wipes have] the power of Clorox® to clean [tough] [bathroom -and/or- restroom -and/or- school -and/or- classroom -and/or- kitchen -and/or- household -and/or- office -and/or- workplace] [grime] [dirt] [soils] and kill bathroom germs[*] -and/or- bacteria[†]
- Convenient cart disinfecting
- Disinfect -and/or- touch-up clean
- Disinfect before you shop
- Disinfect your cart
- Disinfecting wipes -or- formula
- Disinfects in [just] 4 minutes
- Disinfects [odor causing] [common] [household] [kitchen -and/or- bathroom] bacteria^{1,2}
- [Easily] [Effectively] [Conveniently] clean[s] -and/or- disinfect[s]
- [Easy] [convenient] way to clean -and/or- disinfect
- [Easy] Cleaning -and/or- disinfecting to go
- [Effective] [bathroom -and/or- restroom -and/or- kitchen -and/or- household -and/or- office -and/or- workplace] disinfectant -and/or- cleaner
- [Eliminates] [Destroys] [Attacks] [Gets rid of] [99.9% of] [common] [household] germs[*] -and/or- bacteria[†]
- [Eliminates] [Destroys] [Attacks] [Gets rid of] [99.9% of] bacteria -and/or- germs [all] around [your] [the] [bathroom -or- restroom] [kitchen] [school] [classroom] [home] [house] [office] [work -or- office place] [environment]
- For use at home or on the go
- Just one step kills 99.9% of [germs] [bacteria]
- Kills 99.9% of bacteria in [just] 30 seconds¹
- Kills 99.9% of [common] household germs¹
- Kill[s] [99.9% of] -or- Effective against -or- [Disinfect Bacteria¹, *] [that can cause foodborne illness] -or- [that cause odor] -or- [that cause scum and slime on hard surfaces] in [just] 4 minutes
- Kill[s] 99.9% of -or- Remove[s] -or- Effective against [odor causing] [Common] [household] [kitchen -and/or- bathroom] bacteria¹
- Kills 99.9% of germs² that cause cold and flu viruses
- Kill[s] -or- Remove[s] -or- Effective against [Common] Household Viruses³
- Kill[s] -or- Remove[s] -or- Effective against Human coronavirus [ATCC VR 740]
- Kill[s] -or- Remove[s] -or- Effective against Influenza A2 virus [ATCC VR 544] [the virus that causes the cold and flu] -or- Rotavirus WA [diarrhea-causing virus]
- Kill[s] -or- Remove[s] -or- Effective against [the following] [organisms]:
 - Campylobacter jejuni [ATCC 29428]
 - [E. coli] [Escherichia coli 0157:H7] [ATCC 51657]
 - [Herpes] (Herpes simplex virus type 1)
 - Human coronavirus [ATCC VR 740]
 - [HIV] (Human immunodeficiency virus type 1)
 - [the virus that causes the] [flu] [virus] (Influenza A2) [ATCC VR 544]
 - [Kleb] (Klebsiella pneumoniae) [ATCC 4352]
 - [Listeria] (Listeria monocytogenes) [ATCC 19117]
 - [Pseudomonas] (Pseudomonas aeruginosa) [ATCC 15442]
 - [RSV] (Respiratory syncytial virus) [ATCC VR 26]
 - [the virus that causes the] [cold] [virus] (Rhinovirus type 14) [ATCC VR 284]
 - [the virus that causes the] [diarrhea] [virus] (Rotavirus WA)
 - [Salmonella] (Salmonella choleraesuis) [ATCC 10708]
 - [Staph] (Staphylococcus aureus) [ATCC 6538]
 - [Strep] (Streptococcus pyogenes) [ATCC 19615]
- Kills [the] [common] cold and/or flu virus[es]¹
- Kills the virus[es] that cause[s] [the] [common] cold[s] and/or flu³
- Leaves hard, nonporous surfaces disinfected
- Moist with cleaners -and/or- disinfectants
- One step cleaning -and/or- disinfecting -and/or- deodorizing
- [One step cleaning -and/or- disinfecting -and/or- deodorizing] [Disinfect -and/or- touch-up clean] [Cleans -and/or- disinfects -and/or- deodorizes] Anytime -or- Daily -or- Every day -or- In one easy step -or- Everywhere -or- Anywhere
- [One step cleaning -and/or- disinfecting -and/or- deodorizing] [Disinfect -and/or- touch-up clean] [Cleans -and/or- disinfects -and/or- deodorizes] on hard, nonporous [bathroom -and/or- kitchen] surfaces -or- on household surfaces [every day] -or- Throughout the house [kitchen and bathroom] -or- All over your house
- Put Clorox Disinfecting Wipes on your school supply list to help keep your child's classroom clean [and reduce the spread of germs on hard surfaces]
- Quick and easy cart disinfecting
- Sanitizes in [just] 30 seconds¹
- [Teachers] Clean up the classroom [with Clorox Disinfecting Wipes]
- [The product are] the quick and easy way to [touch-up] [clean] [and] disinfect
- There are many uses for Clorox® Disinfecting Wipes and here are a few:
 - bathroom surfaces
 - kitchen surfaces
 - kid's -or- child's [play]room or family den
 - window blinds
- This [cleaner -and/or- disinfectant] combines cleaning and disinfecting [in one product] [in one step]
- [Touch-up] Clean[s] and disinfect[s]
- Use [in public -or- common] places where [germs may be of concern] [you are concerned about germs]
- Use [the product] -or- [the wipes] to [disinfect] -and/or- [touch-up clean]
- Wet [household -and/or- disinfecting] wipes
- Wipe away the cold -and/or- flu virus [this season].
- Wipe away the germs that cause the cold -and/or- flu [virus] [this season]
- Wipes away 99.9% of germs² that cause cold and flu
- [Wipe away] [Eliminate] [Remove] [Clean] [Disinfect] [Germs -and/or- bacteria] on Use Table 1 and Use Table 2

¹ [Kleb] Klebsiella pneumoniae [ATCC 4352], [Staph] Staphylococcus aureus [ATCC 6538],
² [Kleb] Klebsiella pneumoniae [ATCC 4352], [Staph] Staphylococcus aureus [ATCC 6538], [Salmonella] Salmonella choleraesuis [ATCC 10708], [Pseudomonas] Pseudomonas aeruginosa [ATCC 15442],
 [E. coli] Escherichia coli 0157:H7 [ATCC 51657], [Listeria] Listeria monocytogenes [ATCC 19117], Campylobacter jejuni [ATCC 29428], [Strep] Streptococcus pyogenes [ATCC 19615]
³ Rotavirus WA, Influenza A2 [ATCC VR 544], Rhinovirus type 14 [ATCC VR 284]

6/13

Note: **Bold, italicized text is information for the reader and is not part of the label.** [Bracketed information is optional text.]
Text separated by a diamond bullet (◆) denotes -and/or- options. Underlined text is new. Strike-through (~~text~~) means removed.

EPA Reg. No. 5813-58 Spruce-Ups Page 4 of 7

General/Cleaning Claims:

- After use, just toss wipe[s] away
- Also available in [the] [Lemon,] [Fresh,] [Kitchen,] [and] [Lavanda] [varieties]
- Also available in [the] 75 count Value [Size] and the 9 count To Go Size[s]
- Also available in the _____ count size
- [Also] [Now] [Great] [Made] [Works well]] [Appropriate] [on -or- for] [stainless steel -and/or- metal -and/or- glass surfaces] [stovetops -and/or- microwaves -and/or- refrigerators -and/or- faucets -and/or- sinks -and/or- mirrors -and/or- dark tile] [with] [because of] [due to] [the] [new] [low-streak -or- residue formula]
- Bleach-free [formula]
- Check out our website for [more] [the latest] information on germs that affect your family [www.clorox.com] -or- [www.cloroxdisinfectingwipes.com]
- Classrooms -or- schools are cleaner with this product -or- [disinfecting] wipes
- Clean before you shop
- Clean up the classroom [with this product -or- wipes]
- Clean with just a wipe -or- touch
- Clean your cart
- [Clean] [cleaning] -and/or- [disinfect] [disinfecting] without stopping [your life] [your family's life]
- [Cleaning -and/or- disinfecting] that fits into your life
- Cleans and leaves scent
- [Cleans, disinfects, and] removes dust and/or pet dander and/or dust mite matter [, all in one step]
- Cleans on the spot with [fresh] [pleasant] [nice] [good] [great] [strong] [relaxing] [pleasing] [warm] [orange] [lemon] [lavender] fragrance
- Cleans to a shine!
- Cleans with a [fresh] [pleasant] [nice] [good] [great] [strong] [relaxing] [pleasing] [warm] [orange] [lemon] [lavender] smell -or- scent
- Clorox® Disinfecting Wipes are your daily defense against germs
- Convenient
- Convenient cart cleaning
- Deodorizing/deodorizes
- Does not contain bleach
- Donate this product [to your child's classroom -or- school]**
- Don't miss a beat with Clorox Disinfecting Wipes
- Don't stop [your] [family] life for [cleaning -and/or- disinfecting]
- Easy
- [Easily] removes -or- cleans tough bathroom -and/or- restroom -and/or- kitchen -and/or- household -and/or- office -and/or- workplace [dirt] [soils] [grime] [soap scum] [!]
- [Easily] wipes clean
- [Even] Better scrubbing -and/or- cleaning [power]
- Every hard non-porous surface in [your] [the] [kitchen] [bathroom] [house] deserves -or- can -or- could use a wipe
- Everything [you need] is already in the wipe
- Fast
- For a cleaner -and/or- fresher [bathroom] [restroom] [kitchen] [home] [house] [place] [work -or- office place] [work -or- office environment]
- For daily use
- For daily [use] [cleaning -and/or- disinfecting]
- For [light] -or- touch-up - daily -or- quick cleaning -or- clean-ups [in one easy step]
- For household surfaces indoor and outdoor
- For use at home or in public areas -or- places
- For use on grocery cart and basket handles
- For use while traveling
- Freshens [the] [your] [bathroom] [restroom] [kitchen] [home] [house] [place] [work -or- office place] [work -or- office environment]
- Great for the classroom
- [Great] for [the] school(s) -or- classroom(s)
- [Great] For traveling -or- For use at work -or- For use in public restrooms -or- For use on hard surfaces -or- For floor(s) [touch-ups] -or- For touch-up cleaning
- [Hey Mom] Take this -or- this product to [my] classroom -or- school -or- teacher**
- [Hey Mom] Take this product -or- me to [my] classroom -or- school -or- teacher**
- Holds up to your toughest messes -or- jobs -or- stains
- [Improved formula] [for] [low -or- less -or- lower] streaking -or- residue!
- It's from Clorox®, so it's more than clean
- It's from Clorox®, so you know you can trust it
- Just pull, wipe clean and toss
- Leaves your bathroom fresh and clean
- Life doesn't have to stop for cleaning
- Life [doesn't] [shouldn't] [have to] stop for [cleaning -and/or- disinfecting]
- [Look] [Now] Less streaking -or- residue
- [Low-streak -or- residue] [Formula -or- Wipe] [Cleans] [is] appropriate -or- great for [kitchen -and/or- bathroom -and/or- household] [surfaces] [places] [like] [stainless steel -and/or- metal -and/or- glass -and/or- mirrors -and/or- dark tile] [stovetops -and/or- microwaves -and/or- refrigerators -and/or- faucets -and/or- sinks]
- [Low-streak -or- residue] [Formula -or- Wipe] [Delivers] [A] Clean you can [see -and/or- smell -and/or- feel] [notice]
- [Low-streak -or- residue] [Formula -or- Wipe] Clean[s] thoroughly
- [Low-streak -or- residue] [Formula -or- Wipe] [For a] more -or- visible -or- apparent -or- noticeable -or- satisfying clean
- [Low-streak -or- residue] [Formula -or- Wipe] [Great] [Use it] [For] [cleaning -and/or- disinfecting] Every day[, on] hard non-porous [surface[s]]
- [Low-streak -or- residue] [Formula -or- Wipe] [leaves] Less -or- Fewer [visible] spots -or- spotting -or- blotches -or- marks [than] [ever] before]
- [Low-streak -or- residue] [Formula -or- Wipe] [Lets you] Clean multiple [household] surfaces [with wipes]
- [Low-streak -or- residue] [Formula -or- Wipe] [Lets you] Clean[s] [throughout] [around] [in] [the -or- your] [house]*
- Low/lower streak[ing] formula
- Makes [cleaning -and/or- disinfecting] [your job] easier [in the kitchen -and/or- bathroom -and/or- house] [in the work -or- office place] [at work]
- Makes your job easier in the kitchen/bathroom
- Maximum Cleaning, Minimum Effort
- Moist Household [Cleaning] Wipes
- [More] efficient [bathroom] [kitchen] [home] [household] [office] cleaning -and/or- disinfecting
- Multi-Surface formula
- [Low-streak -or- residue] [Formula -or- Wipe] For all of your [kitchen] [bathroom] [household] surfaces [like] [stainless steel -and/or- metal -and/or- glass -and/or- mirrors] [stovetops -and/or- microwaves -and/or- refrigerators -and/or- faucets -and/or- sinks]
- No [mixing -and/or- spraying -and/or- fuss -and/or- need to rinse]
- [Now] Even stronger -and/or- more durable [than ever]
- [One] [Versatile] [low-streaking -or- residue] wipe for [all] hard non-porous [kitchen -and/or- bathroom -and/or- household] surfaces
- Perfect for cleaning up around the toilet
- Quick
- Quick and Easy Cart Cleaning
- Quick and Easy Cleaning Everywhere
- Quick and Easy Cleaning for Kitchen Surfaces*
- Reduces dust and/or pet dander and/or dust mite matter
- [Removes] [Eliminates] [Attacks] [Gets rid of] [Melts away] tough [soap scum] [bathroom -and/or- restroom -and/or- kitchen -and/or- household -and/or- office -and/or- workplace] [dirt] [soils] [grime]] [!]
- Simplifies [cleaning -and/or- disinfecting]
- Simplify [cleaning -and/or- disinfecting]

R0192-29.1

Note: **Bold, italicized text is information for the reader and is not part of the label.** [Bracketed information is optional text.]
Text separated by a diamond bullet (◆) denotes -and/or- options. Underlined text is new. Strike-through (~~text~~) means removed.

EPA Reg. No. 5813-58 Spruce-Ups Page 5 of 7

General/Cleaning Claims: continued

- Some [moments] [things] shouldn't be interrupted
- Specially formulated for a variety of surfaces -or- kitchen surfaces
- [Specially formulated] For [use in] the bathroom
- Specially formulated to clean [a variety of surfaces] [throughout -or- all over -or- around] the house -or- kitchen and bathroom
- [Specially formulated] Use daily [to clean bathroom soils such as soap, soap scum, toothpaste, hair spray, hair gel, cosmetics, shaving cream and hand and body lotion]
- Spot clean[ing] -or- touch-up clean[ing] with a [fresh] [pleasant] [nice] [good] [great] [strong] [relaxing] [pleasing] [warm] [orange] [lemon] [lavender] smell -or- scent
- Spruce-Ups are premoistened with a special cleaning formula to handle daily clean-ups without bottles, sponges, or buckets
- Strong -or- durable enough for [tough] [messes] [jobs] [stains] [difficult -or- uneven surfaces] [all around the house]
- [The] [All- -or- Multi- purpose -or- occasion] wipe: [cleans] [great] [works [well]] [on -or- in -or- for] [kitchen -and/or- bathroom -and/or- household] surfaces -or- places [like] stainless steel -and/or- metal -and/or- glass -and/or- mirrors
- [The] [All- -or- Multi- purpose -or- occasion] wipe: [cleans] [great] [works [well]] [on -or- in -or- for] [kitchen -and/or- bathroom -and/or- household] surfaces -or- places [like] stovetops -and/or- microwaves -and/or- refrigerators -and/or- faucets -and/or- sinks
- The convenient way to keep your home looking "just cleaned"
- The [convenient] [easy] [effective] way to keep your [home] [house] [bathroom] [kitchen] [common areas] [office] [work -or- office] [area] [place] [environment]] looking "just cleaned"
- The cleaning power -and/or- effectiveness of Clorox® [that easily removes bathroom -and/or- restroom -and/or- kitchen -and/or- household [dirt] [soils] [grime] [like soap scum] [!]]
- The easy way to clean -and/or- disinfect [all over] [your] [the] [bathroom] [kitchen] [house] [office] [work -or- office] [place] [environment]] [place]
- The easy way to keep your [home] [house] [bathroom] [kitchen] [common areas] [office] [office -or- work] [place] [environment]] [place] clean every day
- The easy way to keep your house clean every day
- The easy way to clean all over the house
- The easy way to touch-up clean your bathroom every day
- [The product -or- the wipes are] [always] ready to use
- The smell of clean
- The wipe that does it all...anytime
- Tough on grime -and/or- soap scum -and/or- dirt -and/or- [other] [tough] [bathroom -or- restroom] [kitchen] [household] [office] [work -or- office place] soils[!]
- Trap[s] -and/or- pick[s] up -and/or- grip[s] -and/or- grab[s] -and/or- hold[s] particles -and/or- dust -and/or- dirt -and/or- hair -and/or- crumbs
- [Trapper] [pockets] [ridges] [texture] get[s] into [crevices] [nooks & crannies] [cracks] [uneven places] for a [more thorough] [better] clean
- Try Me
- Use Everywhere -or- Anywhere on hard nonporous surfaces
- Use [in] [public] places where germs may be of concern
- Use on [grocery] carts and baskets
- Use on [grocery] cart handles and basket handles
- Use on hard nonporous surfaces anywhere [you travel] [throughout the house]
- Use [the product] -or- the wipe[s] throughout the house
- [Use the product -or- the wipes] for [light] touch-up -or- light -or- every day -or- daily -or- quick cleaning -or- clean-ups [all over the house] [anytime] -or- [anywhere]
- [Virtually] streak free [shine] [clean]
- Will not harm most surfaces
- Wipe away [the] [tough] bathroom -and/or- restroom -and/or- kitchen -and/or- household -and/or- office -and/or- workplace] [soils] [dirt] [grime]
- With a bleach free formula
- [Wipe] Cleans better -and/or- lasts longer [than ever]
- With a pleasant fragrance
- Works [great] on [shiny] [high gloss] [high shine] surfaces [such as stainless steel -and/or- mirrors -and/or- glass tables -and/or- chrome -and/or- [dark] enamel -and/or- [dark] tile -and/or- dark surfaces]

This claim is not to be used with any one-step cleaning and disinfecting claim on the label

• Cuts Grease

* Hard, nonporous, non-food contact surfaces

*Confirm school policy allows for use and/or donation of product. Parents should deliver donations [directly] to schools.

Fragrance/Scent Descriptors and Claims:

- Berry [blast] [breeze] [boom] [burst] [fresh]
- Blossom [blast] [breeze] [burst] [clean] [fresh]
- Bursting [petals] [bouquet]
- Cascading [clean] [falls]
- Floral [blast] [breeze] [burst] [clean] [fresh] [fusion]
- Fresh [blast] [breeze] [burst]
- Fruit(y) [blast] [breeze] [burst] [clean] [fresh] [fusion]
- Garden [bloom] [breeze] [escape] [fresh] [power] [surge]
- Herbal [blast] [breeze] [clean] [energy] [fresh] [fusion]
- Island [bloom] [bouquet] [breeze] [power]
- Lavender [blast] [breeze] [burst] [clean] [fresh] [fusion]
- Lemon [blast] [breeze] [burst] [clean] [fresh] [fusion]
- Lime [blast] [breeze] [burst] [clean] [fresh] [fusion]
- Mandarin [Orange]
- Mint [burst] [cooling] [rush]
- Morning [burst] [clean] [dew] [fresh] [fusion] [mist]
- Mountain [breeze] [clean] [fresh] [spring]
- Ocean [breeze] [fresh] [winds]
- Orange [blast] [breeze] [burst] [fresh] [fusion]
- Petal [breeze] [pink] [rush]
- Rain [clean] [fresh] [fusion] [shower]
- Red apple [rush]
- Rose [of the tropics]
- Shower [breeze] [burst] [fresh] [fusion]
- Spring [bloom] [breeze] [burst] [clean] [shower]
- Sweet [blast] [breeze] [burst] [fruit] [clean]
- Tropical [bloom] [rainfall] [rose] [shower]
- Waterfall [clean] [burst] [rush] [splash]
- Whitewater [clean] [burst] [falls] [mist] [rush] [splash]
- Wildflower [clean] [blast] [breeze] [burst] [escape] [fusion] [power]

Any claim above could be preceded by bold -or- clean -or- crisp -or- fresh -or- good -or- great -or- invigorating -or- light -or- long-lasting -or- nice -or- pleasant -or- pleasing -or- refreshing -or- relaxing -or- strong -or- warm

Any claim above could be followed with aroma -or- bouquet -or- fragrance -or- perfume -or- odor -or- scent -or- smell

Note: **Bold, italicized text is information for the reader and is not part of the label.** [Bracketed information is optional text.]
Text separated by a diamond bullet (◆) denotes -and/or- options. Underlined text is new. Strike-through (~~text~~) means removed.

EPA Reg. No. 5813-58 Spruce-Ups Page 6 of 7

Packaging Claims:

- 40% Bigger quilted wipes*
- 40% more wipes* [*vs. 35 count Clorox Disinfecting Wipes canister]
- 5"x6" wipes
- As easy as grabbing -or- dispensing [facial] tissues [from a box]
- Attach [em] [them] [wipes] where you need -or- use [em] [them] [most]
- Attachable [dispenser] -or- [Safely] attaches -or- can be attached [to] [tile] [glass] [mirrors] [windows] [finished wood] [cabinets] [metal surfaces] [metal appliances] [painted] [wallboard] [plasterboard] [drywall]
- Big size
- [Big] [Value] Can
- [Buy] Two for home, one for school -or- the car -or- purse -or- to go
- [Can] [easily] Slip -or- Fit into a [purse] [pocket] [diaper bag] [backpack] [glove compartment -or- box] [car] [minivan] [SUV] [lunch box -or- bag] [briefcase] [luggage] [suitcase]
- Clorox® brings beauty [artistry] [elegance] [trendy] to cleaning!
- Collect all [of the Designer Series] canisters!
- [Contains] Same Clorox® wipes [you love] -or- same wipes, easier to grab
- [Convenient] [Size]
- [Convenient and] easy to use
- Decorate your [home] [kitchen] [bathroom] counter(s) [office] [bathroom(s)] [with designer wipes]
- Designer -or- Decorator -or- Holiday -or- Seasonal series
- Dispenses [Comes out] one wipe at a time
- Double -or- Super Value [Size] [Pack]
- [Easy] [Better] [New] [&] [Improved] Dispensing
- [Easy] [Better] [New] [&] [Improved] [Dispensing] Lid -or- Closure -or- Cap
- Easy Breezy Dispensing
- [Easy] One-handed [dispensing] -or- Dispense [wipes] with [only] [just] one hand -or- Grab [wipes] [a wipe] [and wipe] with [just] [only] one hand -or- [Easily] Grab [wipes] one at a time
- Easy -or- EZ Start Lid -or- Cap
- Easy pop [top]
- Easy start & stop [lid]
- Easy to carry
- Easy to Open -or- Thread
- Easy to Use Lid
- Fits almost anywhere
- Hassle free lid
- Includes 50 count refill [pack] -or- Contains 50 wipes
- [It's] the easy way to grab a wipe
- Just like grabbing -or- dispensing [facial] tissues [from a box]
- [Makes] [wipes] [as] easy to grab [as they are to use]
- Moisture lock lid
- Multi-refill pack
- [New] [Now] [even] stronger [wipe(s)] [a] [Better Wipe(s)] [!]
- No Hassle Lid -or- Cap
- No surface damage -or- [Adhesive] Removes without damage [or residue] -or- [Adhesive] Removes without damaging [most] [household] surfaces -or- Holds on strongly -or- Comes off cleanly
- No hassle lid
- No threading [required]
- No wasted wipes
- [Now] 25% -or- 35% -or- 50% -or- 75% -or- 100% -or- 150% stronger[!]
- [Now] 2x -or- 2.5x -or- 3x -or- 4x -or- 5x stronger[!]
- [Now] [even] more wipes [per package -or- container -or- canister]
- [Now] insert number wipes [per package -or- container -or- canister]
- Perfect size for kitchens -or- bathrooms
- Pop-up [top]
- Portable -or- Can be reattached [with bracket]
- Portable size
- Pull 'n' go
- Pull-N-Wipe Lid -or- Cap
- [Puts] [Put] wipes where you need -or- use them -or- want them
- [Puts] [Put] wipes within [easy] [arm's] reach -or- at your fingertips
- Quick -and/or- easy -and/or- fast -and/or- convenient -and/or- versatile
- Ready pull
- Refill pack
- Refillable [with 50 wipes] -or- [Dispenser] Refill [pack] [for dispenser]
- Regular [wipe] [size] -or- Large [wipe] [size]
- [The Designer Series is] Beautiful [elegant] enough to leave out [on counter(s)] [desk(s)] [in bathroom] [in kitchen] [in office]
- Three pack -or- multi-pack
- Twin pack -or- two pack -or- dual pack
- To Go [pack] [size]
- [To Go] [Purse] [Trial] [Travel] [Pocket] Size -or- Pouch -or- Pak
- Travel [size -or- pack]
- Trial [size -or- pack] -or- Paper towel size [8.5"x11"]
- Tub refill
- Value pack
- Value size
- Value Twin
- [Wipes] Stay[s] wet -or- moist longer
- [With] Pop action

*vs 7"x8" size

*In comparison to [prior] [past] [previous] [old] wipe [material] -or- Versus [prior] [past] [previous] [old] wipe [material]

Heavy Duty Claims:

- [Better] [Improved] [Stronger] [Thicker] Wipe!
- Cleans -or- Removes -or- Good for -or- Great on -or- Works great on [tough] [soap scum] [baked-on] [grease] [soils] [messes] [spaghetti sauce] [kitchen messes] [dirt] [soils] [bathroom messes]
- Disinfect and scrub clean
- [Cloth-like] [softer] [feel]
- Dissolve[s] -and/or- Pick[s] up dirt, [don't] [doesn't] [just] push it around
- [Double] [Dual] [Two]-sided scrubbing wipes
- [Double] [Triple] Reinforced wipe
- Dual action
- Easy to grip -and/or- hold -and/or- handle
- Feels like a cloth
- Ideal -or- Great for many cleaning jobs in the kitchen [and the bathroom]
- [Now] [Reinforced] [with] Quilted [strength]
- Now with DuraPly -or- DoubleWeave -or- SupraQuilt -or- SmartWeave -or- PowerPockets -or- UltraWeave -or- DuraMesh -or- DuraQuilt -or- DuraWeave cloth [for] [added strength] [better cleaning] [better crumb -and/or- dust pick up] [to trap -and/or- pick up -and/or- grip -and/or- grab -and/or- hold particles -and/or- dust -and/or- dirt -and/or- hair -and/or- crumbs]
- Now with DuraPly -or- DoubleWeave -or- SupraQuilt -or- SmartWeave -or- PowerPockets -or- UltraWeave -or- DuraMesh -or- DuraQuilt -or- DuraWeave fibers [for] [added strength] [better cleaning] [better crumb -and/or- dust pick up] [to trap -and/or- pick up -and/or- grip -and/or- grab -and/or- hold particles -and/or- dust -and/or- dirt -and/or- hair -and/or- crumbs]
- Now with DuraPly -or- DoubleWeave -or- SupraQuilt -or- SmartWeave -or- PowerPockets -or- UltraWeave -or- DuraMesh -or- DuraQuilt -or- DuraWeave [for] [added strength] [better cleaning] [better crumb -and/or- dust pick up] [to trap -and/or- pick up -and/or- grip -and/or- grab -and/or- hold particles -and/or- dust -and/or- dirt -and/or- hair -and/or- crumbs]
- Now with DuraPly -or- DoubleWeave -or- SupraQuilt -or- SmartWeave -or- PowerPockets -or- UltraWeave -or- DuraMesh -or- DuraQuilt -or- DuraWeave technology [for] [added strength] [better cleaning] [better crumb -and/or- dust pick up] [to trap -and/or- pick up -and/or- grip -and/or- grab -and/or- hold particles -and/or- dust -and/or- dirt -and/or- hair -and/or- crumbs]
- One side is like a scrubbing sponge, the other is like a wipe
- Soft side for wiping -or- cleaning dirt away and disinfecting
- Specially formulated -or- designed -or- with patented technology to [clean better] -or- [trap -and/or- pick up -and/or- grip -and/or- grab -and/or- hold particles -and/or- dust -and/or- dirt -and/or- hair -and/or- crumbs]
- Stays wet longer -or- holds moisture longer
- Textured -or- scrubby -or- rough [side] -or- [scrubbing fibers] for [scrubbing] [cleaning] [removing] [wiping] [tough] [stains] [soils] [messes]
- The scrubbing [power] [side] of a sponge in a disinfecting wipe
- [Virtually] Lint Free
- Wiping -or- smooth -or- soft side for cleaning dirt away and disinfecting
- [With] [moisture] [trapper] pockets -or- ridges -or- [added] [more] texture to trap -and/or- pick up -and/or- grip -and/or- grab -and/or- hold particles -and/or- dust -and/or- dirt -and/or- hair -and/or- crumbs
- [Wow] Scrubs like a sponge

9/13

Note: **Bold, italicized text is information for the reader and is not part of the label.** [Bracketed information is optional text.]
Text separated by a diamond bullet (◆) denotes -and/or- options. Underlined text is new. Strike-through (~~text~~) means removed.

EPA Reg. No. 5813-58 Spruce-Ups Page 7 of 7

Use on hard, nonporous surfaces in:

Airplane -or- Plane [Lavatory
-or- Lavatories] [Tray Tables]
Airports
Ambulances
Automobiles
Basements
Bathrooms -or- Locker Room
Facilities [Surfaces]
Boats
Bowling Alleys
Buses
Butcher Shops
Cafeterias
Camper[s] -or- RV[s] -or- Trailer[s]
-or- [Mobile] Home[s]
Campgrounds
Cars
Church[es]
Common [Classroom] [School]
[Play] Areas
Convenience Stores
Correctional Facilities
[Damp] Storage Areas
Day Care Centers
Dens
Dorms
Elder Care Centers

[Elementary] Schools -or- Colleges
-or- Universities
Elevators
Emergency Vehicles
Factory[ies] -or- Plants
Family Rooms/Areas
Fast Food Restaurants
Fitness Center[s] [Equipment]
Garages
Gas Stations
Grocery Stores
Gymnasiums
Gyms
Health Clubs
Home Centers
Homes [House holds]
Hotels
[Households]
Industrial Facilities
Institutional Kitchens
[Institutional] Laundromats
Institutions
Jungle Gym[s]
Kennels
Kid's -or- Child's [Play]rooms or
[Family] Dens
Kitchen[s] [Surfaces]
Laboratories

Use Sites: Table 1

Lavatories
Living Areas -or- Rooms
Locker Rooms
Lounges
Malls
[Manufacturing] Plants
Markets
Mass Merchandisers, Discount
Retailers -and/or- General
Merchandise Stores
[Medical] Clinics
[Medical -or- Dental -or- Physician's
-or- Doctor's -or- Nurse's -or-
Pediatrician's] [Office[s]] [Waiting
Room[s]] [Exam[ination] Room[s]]
-or- Table[s]]
Military Installations
Motels
Motor Homes
Motor -or- House Boats
Nurseries
Nursing Home[s] -or- Convalescent
Home[s] -or- Senior [Citizens']
Home[s]
Offices
Pet Areas
Pharmacies
Play Areas
Play Rooms
Playground Equipment
Playgrounds
[Police -and/or- Fire] Vehicles
Public Facilities
Public Restrooms
Public Telephone[s] [Booths]
Recreational Centers [Facilities]
[Rental] Cars
Rest Stops
Restaurants
Restrooms
School Buses
School -or- City -or- Public Transit
-or- Commuter Buses
Schools
Shelters
Ships
Shops
Storage Areas
Subways
Supermarkets
Trains
Trolleys
Vacation Homes
Vehicle [Interior[s]] [Exterior[s]]
Veterinary Clinics
Warehouse Clubs
Workplace [Office]

For use on non-critical surfaces in:

Dental Offices
Hospitals

Laboratories
Medical Clinics

Nursing Homes
Patient Rooms

Physician Offices
Veterinary Offices

For use on hard, nonporous surfaces [such as]:

Appliances [Appliance]
[Exterior[s]] [Surfaces] [Outside of]
Baby Furniture [Cribs, Changing
Tables, Diaper Pails]
Basements
[Bathroom] [Kitchen] Faucets
[Handles]
[Bath]tubs
Bed Rails
Bed Springs and Frames
Bidet[s]
Blinds
Cabinets/Cupboards
Cages
Car Interiors
Cat -and/or- Dog -and/or- Pet Dish[es]
-or- Soiled Surface[s]
[Children's] Furniture
Chrome
Chrome Exterior Surfaces of Urinals
and/or Toilets
[Classroom] Desks
Closets
[Clothes] [Diaper] Hampers
Computer[s] [Keyboards]
Cooler Exteriors
Counters
Countertops
Desks
[Diaper] Changing Tables/Areas
Diaper Pails
Dining Room Surfaces -and/or-
Tables -and/or- Fast Food
Restaurant Tables

[Dining] [Fast Food] [Kitchen] [Picnic]
[Play] [Restaurant] [Tray] Tables
[Door] [Cabinet] [Appliance] Knobs
Door Frames
Doorknobs
Drain Boards
Drawer Pulls
Dressing Carts
Drinking Fountains*
Elevator Buttons
Faucets
[Filing] Cabinets
Finished Hardwood[s]
Floors
Floors Around Toilets
Garbage Cans
Garbage Disposals
General Use[s]
Glass [tables -or- tabletops]
Glazed Tiles
[Grocery] Basket Handles
[Grocery] Cart Handles
[Grocery Store] Carts
Gym Equipment
Hampers
Hand Dryer Buttons
Handrails
High chairs*
Non-Food Contact Surfaces of
High chairs
[Kid's] Play [Structures] [Equipment]
[Furniture] [Tables]
Lamps

Use Surfaces: Table 2

Laundry Rooms
Light Switches [Fixtures] [Panels]
Lockers
[Manual] Pencil Sharpeners
[Medicine] Cabinets
Metal Work Benches
Microwave[s] [Exterior[s]]
[Outside[s] of]
Mirrors [bathroom]
Office -or- Bedside Furniture
Office Machinery
Paper Towel [Dispensers] [Holders]
Patio Furniture/Lawn Chairs
Pet Areas/Surfaces
Picnic Tables
Plastic Shower Curtains
Playground Equipment
Playpens
Porta-Pottie[ies] -or- Portable
Bathroom[s]
[Public -or- Pay] Telephones -or-
Phone Booths
Range Hoods
Recycling Bins
Refrigerator Door Handles
Refrigerator[s] Exterior[s]
[Outside of]
Restaurant High Chairs
[Salad Bar] [Buffet] [Cafeteria]
Sneeze Guard[s]
[School] [Toys] [Supplies] Surface[s]
[Shower] Doors
Shower [Walls]
Showers
Signs
Sinks
Staplers
Stereo Consoles
Stove Tops
Tables
[Tiled] Walls
[Toilet] [Toilet Flush] [Faucet]
[Telephone] [Dishwasher] [Cabinet]
[Door] Handles
Toilet -and/or- Urinal Exterior[s]
[Surfaces] -or- Exterior Toilet
Surfaces
Toilet Seats
Toys*
Toy Boxes
Toy Storage Bins
Training Toilets
Training Tools
Trash Cans
Trash Compactors
[TV] [Remote[s]] [Controls]
[Under] Sinks
Vending Machine Surfaces
[Vinyl] Wallpaper
Walkers
Walls
Washing Machines [Washers -and/or-
Dryers] [Exterior[s]] [Outside of]
Wastebaskets
[Water] [Drinking] Fountain [Toggles]
[Handles]
Wheelchairs
Windows
* rinse with water after wiping with
-or- using the product

10/13

EPA Reg. No. 5813-58 Clorox Disinfecting Wipes [Fresh Scent]
Page 1 of 4

Artwork below is shown at approximately 100% of actual size



CLOROX **DISINFECTING WIPES**
TOALLITAS DESINFECTANTES

BLEACH-FREE

ACTIVE INGREDIENTS:
n-Alkyl (C14, 60% ; C16, 30% ; C12, 5% ; C18, 5%)
Dimethyl Benzyl Ammonium Chloride . . . 0.145%
n-Alkyl (C12, 68% ; C14, 32%) Dimethyl
Ethylbenzyl Ammonium Chloride . . . 0.145%
OTHER INGREDIENTS . . . 99.710%
CONTAINS NO PHOSPHORUS NO CONTIENE FOSFORO

35 WET WIPES
7" x 8" (17.7 cm x 20.3 cm)

KEEP OUT OF REACH OF CHILDREN
CAUTION: **MANTÉNGASE FUERA DEL ALCANCE DE LOS NIÑOS**
PRECAUCIÓN: **Si usted no entiende esta etiqueta, busque a alguien para que se la explique a usted en detalle.**

Artcode 12786.XXX (tc)

11/13

EPA Reg. No. 5813-58 Clorox Disinfecting Wipes (Fresh Scent)
Page 2 of 4

Artwork below is shown at approximately 125% of actual size

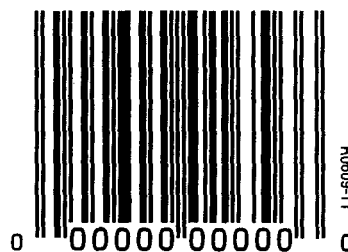
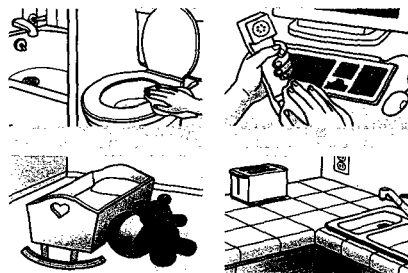
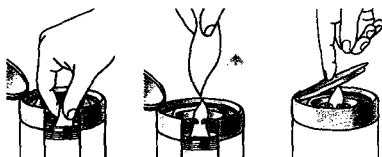

Artcode 12786.XXX (tc)

12/13

Artwork below is shown at approximately 100% of actual size

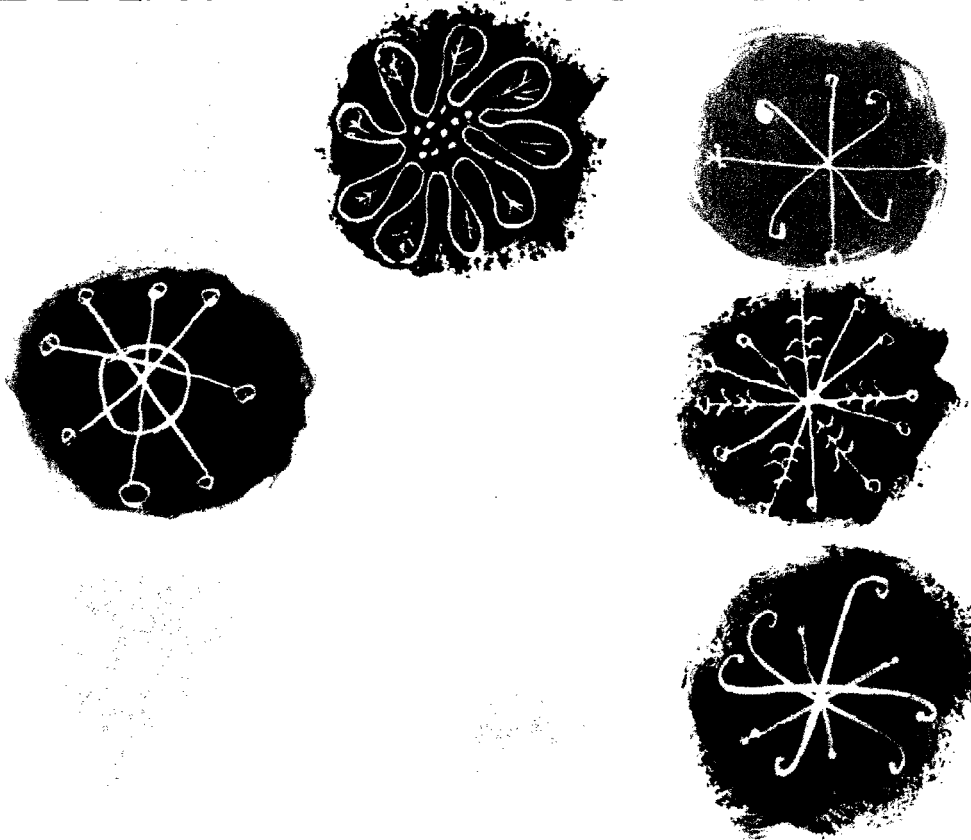
**DISINFECTING WIPES**
TOALLITAS DESINFECTANTES**BLEACH-FREE****ACTIVE INGREDIENTS:**

n-Alkyl (C14, 60%; C16, 30%; C12, 5%; C18, 5%)
 Dimethyl Benzyl Ammonium Chloride . . . 0.145%
 n-Alkyl (C12, 68%; C14, 32%) Dimethyl
 Ethylbenzyl Ammonium Chloride . . . 0.145%
OTHER INGREDIENTS . . . 99.710%
CONTAINS NO PHOSPHORUS/NO CONTIENE FÓSFORO

Fresh Scent • Aroma Fresco**35 WET WIPES**
7" x 8" (17.7 cm x 20.3 cm)**KEEP OUT OF REACH OF CHILDREN****CAUTION:** SEE BACK PANEL FOR ADDITIONAL
PRECAUTIONARY STATEMENTS**MANTÉNGASE FUERA DEL ALCANCE DE LOS NIÑOS****PRECAUCIÓN:** VEA EL PANEL POSTERIOR PARA
DECLARACIONES PREVENTIVAS ADICIONALES.
Si usted no entiende la etiqueta, busque a alguien para
que se la explique a usted en detalle.

Artcode 12786.XXX (tc)

13/13

EPA Reg. No. 5813-58 Clorox Disinfecting Wipes (Fresh Scent)
Page 4 of 4

Artwork below is shown at approximately 125% of actual size

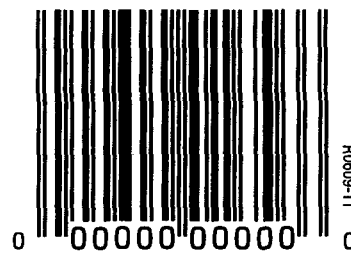
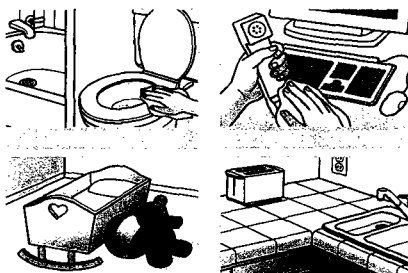
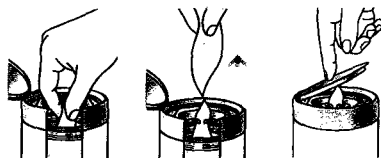

R0609-11

0 00000 00000 0

Artcode 12786.XXX (tc)