



OFFICE OF CHEMICAL SAFETY AND POLLUTION PREVENTION

WASHINGTON, D.C. 20460

December 8, 2023

Ashley Ashe
Regulatory Affairs Team Leader
KIK Consumer Products
1725 North Brown Road
Lawrenceville, GA 30043
Electronic Transmittal: Ashley.Ashe@KIKCorp.com

Subject: Label Amendment – Changes Required by the Boric Acid
Interim Registration Review Decision
Product Name: Super Puck
EPA Registration Number: 5185-460
Received Date: 12/3/2018
Decision Number: 548164

Dear Ashley Ashe:

The amended label referred to above, submitted in connection with registration under the Federal Insecticide, Fungicide and Rodenticide Act (FIFRA), as amended, is acceptable. This approval does not affect any conditions that were previously imposed on this registration. You continue to be subject to existing conditions on your registration and any deadlines connected with them.

The Agency, in accordance with the Federal Insecticide, Fungicide and Rodenticide Act (FIFRA), as amended, has completed reviewing all of the information submitted with your application to support the Registration Review of the above referenced product in connection with the Boric Acid Amended Interim Registration Review Decision, and has concluded that your submission is acceptable.

A stamped copy of your labeling is enclosed for your records. This labeling supersedes all previously accepted labeling. Pursuant to 40 CFR 156.10(a)(6) you must submit one copy of the final printed labeling before you release the product for shipment with the new labeling. In accordance with 40 CFR 152.130(c), you may distribute or sell this product under the previously approved labeling for 12 months from the date of this letter. After 12 months, you may only distribute or sell this product if it bears this new revised

labeling or subsequently approved labeling. "To distribute or sell" is defined under FIFRA section 2(gg) and its implementing regulation at 40 CFR 152.3.

Should you wish to add/retain a reference to the company's website on your label, then please be aware that the website becomes labeling under FIFRA and is subject to review by the Agency. See FIFRA section 2(p)(2). If the website is false or misleading, the product would be misbranded and unlawful to sell or distribute under FIFRA section 12(a)(1)(E). 40 CFR 156.10(a)(5) list examples of statements EPA may consider false or misleading. In addition, regardless of whether a website is referenced on your product's label, claims made on the website may not substantially differ from those claims approved through the registration process, FIFRA section 12(a)(1)(B). Therefore, should the Agency find or if it is brought to our attention that a website contains false or misleading statements or claims substantially differing from the EPA approved registration, the website will be referred to the EPA's Office of Enforcement and Compliance.

Your release for shipment of the product constitutes acceptance of these conditions. If these conditions are not complied with, the registration will be subject to cancellation in accordance with FIFRA section 6. If you have any questions, please contact Megan Snyderman by phone at 202-566-0639 or via email at snyderman.megan@epa.gov.

Sincerely,



Eric Miederhoff, Branch Chief
Reevaluation Branch
Antimicrobials Division (7510P)
Office of Pesticide Programs

Enclosure:

{All text in brackets [xxx] is optional and may or may not be included on a final label.}

{All text in braces {xxx} is administrative and will not appear on a final label.}

SUPER PUCK

{Master Label}

ACTIVE INGREDIENTS:

Trichloro-s-triazinetriene	72.3%
Boron sodium oxide (B ₄ Na ₂ O ₇), pentahydrate	6.8%
OTHER INGREDIENTS:	20.9%
TOTAL INGREDIENTS	100.0%

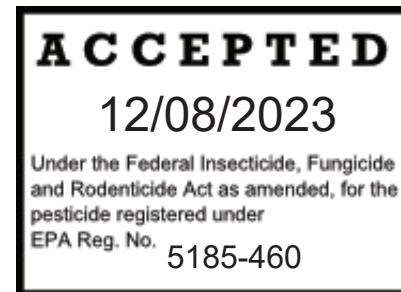

KEEP OUT OF THE REACH OF CHILDREN

DANGER

See [back] [side] panel for First Aid and additional Precautionary Statements.

BIO-LAB, INC.
PO BOX 300002
LAWRENCEVILLE, GEORGIA 30049

EPA REG. NO. 5185-460
EPA EST. NO. 5185-GA-1 [(BL)] {or} [(Z)]
7616-CA-1 [(C)]

{If multiple EPA Establishment Numbers appear on the label.}

[Actual establishment shown in code above or below label printed on [bottle] [container]]

[Letter designation in lot code printed above or below on [bottle] [container] identifies actual establishment.]

Net [Contents] [Weight]: *{as indicated on container}*

{Optional marketing statements that may be used with any application.}

[Patented Technology * with additional Patents Pending]

[* U.S. Patent No. 5,514,287]

[Multi-Functional]

[Dual Active Sanitizing System]

[Sanitizer / Clarifier / Algae Protection]
 [Less Odor / Gassing]
 [Concentrated]
 [Concentrated sanitizer]
 [Less product, less work, more pools]
 [Sanitizing Tablet]
 [Continuous Clarification and Sanitization]
 [Multi-functional [sanitizer] [clarifier] [algae preventer] [sunlight protector]]
 [Multi-action [sanitizer] [clarifier] [algae preventer] [sunlight protector]]
 [1-step solution for clear water]
 [1-step solution for clean water]
 [1-step solution for clean, clear water]
 [Easy, one-step solution for clean water]
 [Easy, one-step solution for clear water]
 [Easy, one-step solution for clean, clear water]
 [One-step [sanitizer] [clarifier] [algae preventer] [sunlight protector]]
 [1-step [sanitizer] [clarifier] [algae preventer] [sunlight protector]]
 [3-in-1]
 [3-in-1 formula [includes] [including] [with] [sanitizer] [clarifier] [algae preventer]]
 [4-in-1]
 [4-in-1 formula [includes] [including] [with] [sanitizer] [clarifier] [algae preventer] [sunlight protector]]
 [Long lasting]
 [Long lasting sanitization]
 [Slow dissolving]
 [Slow dissolving sanitizer]
 [Concentrated, stabilized, slow-dissolving sanitizer]
 [Concentrated, slow dissolving sanitizer]
 [Controls bacteria]
 [Controls algae]
 [Prevents algae]
 [Clarifies water]
 [Sanitization]
 [Algae prevention]
 [Clarification]
 [Sunlight protection]
 [With sunlight protection]
 [Sunlight protected]
 [With built-in sunlight protection]
 [With built-in sunlight protector]
 [Creates crystal clear water]
 [For crystal clear water]
 [Provides [crystal] [sparkling] clear water]

{The “BioGuard Care System” below may be placed on the label to allow easy product identification by consumers.}

[BioGuard Care System (X) Sanitizer () Shock () [Algicide][Algaecide]]

{The “Pool Essentials System” box below may be placed on the label to allow easy product category identification by consumers.}

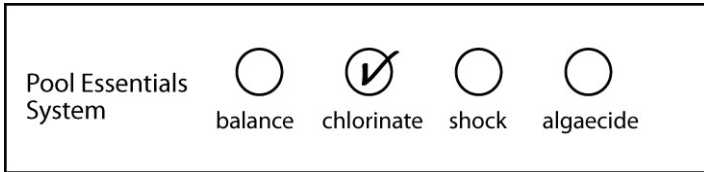

{The “4-step System” box below may be placed on the label to allow easy product category identification by consumers.}

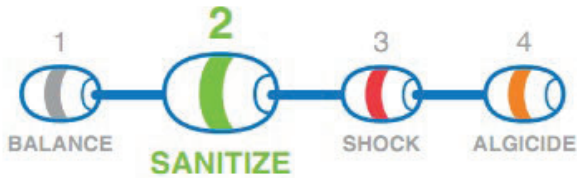
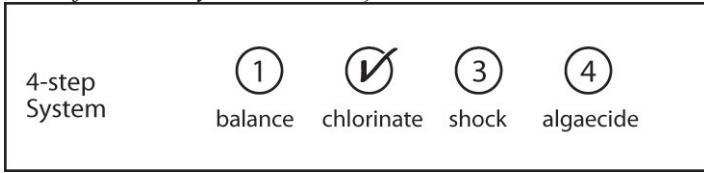

4-Step System ① ② ③ ④

{Optional marketing statements that may be used with floating canister containing tablets.}
[For Floater Application]

{Optional marketing statements that may be used with E Type Canister.}
[For E Type Canisters]

{Optional marketing statements that may be used with BioLab Universal Canister. }

[For Erosion Feeders]

{Optional marketing statements that may be used with BioLab Dial Adjusted Floater. }

[TO OPEN, CUT ALONG DOTTED LINE WITH SCISSORS] *{For use when packaged in child resistant bag.}*

[Convenient]

[No handling chemicals]

[Easy-to-use]

[Easy-use floater]

[Easy-to-use dial]

[Easy, adjustable dial]

[Adjustable dial]

[Adjustable rotating dial]

[Easy, flow-control dial]

[With flow-control dial]

[Flow-control dial]

[Flow-regulation dial]

[Easy rotating dial]

[Adjust n' go ring]

[Adjustable ring]

[Easy-adjust ring]

[Easy-to-control sanitizer flow]

[Easy-to-use [flow-control ring] [adjustable ring] [adjustable dial] [flow control dial]]

[Easy-to-adjust [flow-control ring] [adjustable ring] [adjustable dial] [flow control dial]]

[Easy-to-adjust sanitizer flow]

[[Multi-functional] [4-in-1] [3-in-1] formula saves time]

[[Easy] [convenient] [single-use] application saves time]

[Spend less time applying products]

[Use fewer products]

[Non-refillable]

[Single use]

[One-time use]

[Maintains a 1-4 ppm of chlorine for up to [four] [4] weeks]

[Maintains a 1-4 ppm of chlorine for up to [one] [1] month]

[Great for use during [long] vacations]

[[Ideal] for [small] [pop-up] [inflatable] [above ground] [in-ground] [all] pools]

[[Great] for [small] [pop-up] [inflatable] [above ground] [in-ground] [all] pools]

[For use in [small] [pop-up] [inflatable] [above ground] [in-ground] [all] pools]

[Ideal for small[er] pools]

[Ideal for use in above ground pools]

[Use for clean water]

[Use for clear water]

[Use for clean, clear water]

[For clean water]

[For clear water]

[For clean, clear water]

[For clean, clear water all month [long]]

[For use in small[er] pools]

[For use in in-ground and above ground pools]

[For use in in-ground pools]
[For use in above ground pools]
[Lasts up to [one] [1] month]
[Lasts up to [four] [4] weeks]
[Lasts [one] [1] month]
[Lasts [four] [4] weeks]
[[4] [four] week protection against [bacteria] [and] [algae]]
[[1] [one] month protection against [bacteria] [and] [algae]]
[Month long protection against [bacteria] [and] [algae]]
[Use for continuous protection against [bacteria] [and] [algae]]
[Provides continuous protection against [bacteria] [and] [algae]]
[Continuously protects against [bacteria] [and] [&] [algae]]
[Protects against [bacteria] [algae] [and] [contaminants] for [clear water] [for clean water] [for clean and clear water]]
[Controls bacteria and prevents algae for [clear] [inviting] water]
[Kills bacteria and prevents algae for clean, clear water]
[[Crystal] clear water with less effort]
[[Crystal clear] [and] [&] [clean] water all month long]
[Clean water with less effort]
[Less effort for clear water]
[Less effort for clean water]
[Less effort for clean, clear water]
[Clean, clear water with less effort]
[Keeps water clean [for up to [1] [one] month]]
[Keeps water clear [for up to [1] [one] month]]
[Keeps water clean [for up to [4] [four] weeks]]
[Keeps water clear [for up to [4] [four] weeks]]
[Keeps water clean [and] [&] clear [for up to [1] [one] month]]
[Keeps water clean [and] [&] clear [for up to [4] [four] weeks]]

{Directions to be used with large (approximately 3") tablets as a swimming pool sanitizer.}

SWIMMING POOL SANITIZER

When used as directed, this product is an effective stabilized chlorinating disinfecting agent. This slow dissolving product releases sufficient chlorine to reduce the growth of harmful algae and microorganisms in your pool.

DIRECTIONS FOR USE: It is a violation of Federal Law to use this product in a manner inconsistent with its labeling. Read entire label and use strictly in accordance with precautionary statements and directions.

Ensure all pool equipment is working properly. Backwash the filter system following manufacturer's directions. Adjust pH to between 7.2-7.6. Add stabilizer to establish a minimum level of 20-30 ppm to reduce the degradative effects of sunlight upon the chlorine residual. Superchlorinate the pool so that a chlorine residual of between 1-4 ppm is obtained. When using other products as outlined in directions for this product, always follow directions on those products.

WHEN USED IN AUTOMATIC CHLORINATORS AND FLOATERS:

This product can be used in proportioning mechanisms such as automatic chlorinators and floaters as a maintenance treatment. Fill unit with this product and adjust the feeding mechanism to assure a constant treatment level of 1-4 ppm available chlorine in the pool water. Normally 1-2 ounces of this product per 10,000 gallons daily. Use a test kit to monitor chlorine levels and adjust the chlorine feed mechanism as needed. Check and refill chlorinator as needed. Do not let this product come in direct contact with vinyl liners or other bleachable surfaces as damage may occur. This product contains a clarifier/flocculating agent that helps the filter system remove impurities from water via filtration. Backwash the filter system following manufacturer's directions.

WHEN USED IN SKIMMERS:

This product may be used in plastic skimmers only if skimmer and the piping between skimmer and pump are plastic. Do not add other chemicals through the skimmer when using this product in skimmer as an explosion or fire may result. Do not turn pump off for more than 8 hours in vinyl pools when pucks are in skimmer. Initially add two of this product per 10,000 gallons of water. Add additional product as determined by a test kit to maintain available chlorine levels of 1-4 ppm. This product contains a clarifier/flocculating agent that helps the filter system remove impurities from water via filtration. Backwash the filter system following manufacturer's directions.

Reentry into treated swimming pools is prohibited above levels of 4 ppm chlorine due to risk of body injury.

DISCHARGE DIRECTIONS FOR COMMERCIAL AND RESIDENTIAL POOL USES -

Before draining a treated pool, contact your local sanitary sewer and storm drain authorities and follow their discharge instructions. Do not discharge treated pool water to any location that flows to a gutter, storm drain or natural water body unless discharge is allowed by state and local authorities.

{Directions to be used with small (approximately 1") tablets as a swimming pool sanitizer.}

SWIMMING POOL SANITIZER

When used as directed, this product is an effective stabilized chlorinating disinfecting agent. This slow dissolving product releases sufficient chlorine to reduce the growth of harmful algae and micro-organisms in your pool.

DIRECTIONS FOR USE: It is a violation of Federal Law to use this product in a manner inconsistent with its labeling. Read entire label and use strictly in accordance with precautionary statements and directions.

Ensure all pool equipment is working properly. Clean or backwash filter following manufacturer's directions. Adjust pH to between 7.2-7.6. Add stabilizer to establish a minimum stabilizer level of 30-40 ppm to reduce the degradative effects of sunlight upon the chlorine residual. Superchlorinate the pool so that a chlorine residual of between 1-4 ppm is obtained. When using other products as outlined in directions for this product, always follow directions on those products.

FOR USE IN AUTOMATIC CHLORINATORS AND FLOATERS:

This product can be used in feeding mechanisms such as automatic chlorinators and floaters as a maintenance treatment. Fill unit with this product and adjust the feeding mechanism to assure a constant treatment level of 1-4 ppm available chlorine in the pool water. Normally, 1-2 ounces of this product per 10,000 gallons will be needed daily. Use a test kit or test strips to monitor chlorine levels and adjust the chlorine feed mechanism as needed. Check and refill chlorinator as needed. Do not let this product come in direct contact with vinyl liners or other bleachable surfaces as damage may occur.

Reentry into treated swimming pools is prohibited above levels of 4 ppm chlorine due to risk of body injury.

DISCHARGE DIRECTIONS FOR COMMERCIAL AND RESIDENTIAL POOL USES -

Before draining a treated pool, contact your local sanitary sewer and storm drain authorities and follow their discharge instructions. Do not discharge treated pool water to any location that flows to a gutter, storm drain or natural water body unless discharge is allowed by state and local authorities.

{Directions to be used with floating canister containing tablets.}

SWIMMING POOL SANITIZER

This product regulates the chlorine that sanitizes your pool. When used as directed, this product controls algae and micro-organisms in your pool for several weeks.

DIRECTIONS FOR USE: It is a violation of Federal Law to use this product in a manner inconsistent with its labeling. Read entire label and use strictly in accordance with precautionary statements and directions.

Ensure all pool equipment is working properly. Backwash the filter system following manufacturer's directions. Adjust pH to between 7.2-7.6. Add stabilizer to establish a minimum level of 20-30 ppm to reduce the degradative effects of sunlight upon the chlorine residual. Superchlorinate the pool so that a chlorine residual of between 1-4 ppm is obtained. When using other products as outlined in directions for this product, always follow directions on those products. Floater is marked in gallon increments from 5,000 to 40,000 gallons. To use, cut off all feeder nubs on both sides of cartridge up to and including the one corresponding to your pool's size. If pool is between sizes marked, open next higher nubs. Use a sharp knife and cut in direction away from your body and limbs. Make certain holes are wide open to allow water to flow through freely.

Place floater with open holes in center of the pool. After 24 hours check residual chlorine level with a test kit. If residual chlorine level is below 1.0 ppm cut-off one additional nub until chlorine stabilizes at 1-4 ppm. If the residual chlorine is too high, seal one set of holes with waterproof plastic tape. When ready for replacement, this product will float on its side.

Do not completely submerge floater, allow to sink or allow holes to become clogged. This could trap excess amount of chlorine gas possibly resulting in a violent explosion. Do not attempt to open or refill this product. This product contains a clarifier/flocculating agent that helps the filter system remove impurities from water via filtration. Backwash the filter system following manufacturer's directions.

Reentry into treated swimming pools is prohibited above levels of 4 ppm chlorine due to risk of body injury.

DISCHARGE DIRECTIONS FOR COMMERCIAL AND RESIDENTIAL POOL USES -

Before draining a treated pool, contact your local sanitary sewer and storm drain authorities and follow their discharge instructions. Do not discharge treated pool water to any location that flows to a gutter, storm drain or natural water body unless discharge is allowed by state and local authorities.

{Directions to be used with E Type Canister.}

SWIMMING POOL SANITIZER (TYPE E REFILL CARTRIDGE)

This product when used as directed, automatically releases the correct amount of chlorine to sanitize your pool. This reduces the growth of harmful algae and micro-organisms in your pool for several weeks. This product is not a floating device and is only to be used with automatic chlorinating systems such as a refill for automatic chlorinating systems using the Type "E" refill cartridge.

DIRECTIONS FOR USE: It is a violation of federal law to use this product in any manner inconsistent with its labeling. Read entire label and use strictly in accordance with precautionary statements and directions.

Ensure all pool equipment is working properly. Backwash the filter system following manufacturer's directions. Adjust pH to between 7.2-7.6. Add stabilizer to establish a minimum level of 20-30 ppm cyanuric acid to reduce the degradative effects of sunlight upon the chlorine residual. Superchlorinate the pool so that a chlorine residual of between 1-4 ppm is obtained. When using other products as outlined in directions for this product, always follow directions on those products. Do not attempt to open or refill this cartridge. Punch out numbered hole in cartridge corresponding to pool size as indicated below. Use a large nail, sharp knife or similar tool for this purpose. Place cartridge on a solid surface and work carefully to avoid injury.

Pool Capacity in Gallons	Open Hole Number.
10,000.....	1
20,000.....	2
30,000.....	3
40,000.....	4
50,000.....	5
60,000.....	6

For pools of intermediate size, open hole for next larger capacity. (Example: for 25,000 gallon pool, open hole number 3.) For pools larger than 60,000 gallons, use 2 (or more) cartridges and divide the number of holes to opened equally among them. (Example: For 80,000 gallon pool, use 2 cartridges and open hole #4 on each.) Place cartridge (or cartridges) in chlorinator (follow equipment manufacturer's directions for installation of the Type "E" cartridge) and wait for 24 hours. Test pool after 24 hours. Check chlorine level with test kit. Correct range should be 1-4 ppm. If level is below 1 ppm, punch out next higher number. If level is above 4 ppm, cover highest hole with water proof tape. Make additional adjustments as required to maintain a 1-4 ppm chlorine level.

Reentry into treated swimming pools is prohibited above levels of 4 ppm chlorine due to risk of body injury.

DISCHARGE DIRECTIONS FOR COMMERCIAL AND RESIDENTIAL POOL USES -

Before draining a treated pool, contact your local sanitary sewer and storm drain authorities and follow their discharge instructions. Do not discharge treated pool water to any location that flows to a gutter, storm drain or natural water body unless discharge is allowed by state and local authorities.

{Directions to be used with BioLab Universal Canister.}

SWIMMING POOL SANITIZER FOR USE IN EZ CLOR, CLOR-TROL 1200, FOXAMATIC OR ANTHONY T-120 AUTOMATIC CHLORINATORS

This product when used as directed, continuously releases the correct amount of chlorine to sanitize your pool. This reduces the growth of harmful algae and micro-organisms in your pool for several weeks. This product is to be used with automatic chlorinating systems or as a floater.

DIRECTIONS FOR USE: It is a violation of federal law to use this product in any manner inconsistent with its labeling. Read entire label and use strictly in accordance with precautionary statements and directions.

Ensure all pool equipment is working properly. Backwash the filter system following manufacturer's directions. Adjust pH to between 7.2-7.6. Add stabilizer to establish a minimum level of 20-30 ppm cyanuric acid to reduce the degradative effects of sunlight upon the chlorine residual. Superchlorinate the pool so that a chlorine residual of between 1-4 ppm is obtained. When using other products as outlined in directions for this product, always follow directions on those products.

ALL CHLORINATORS EXCEPT CLO-TROL 1200 and ANTHONY T-120.

Unscrew cap and remove cap liner exposing slits. Place cap liner in a dry, clean empty plastic bag. Save cap liner for possible use of the canister as a vacation floater. Screw cap back on canister. Punch out numbered hole in canister corresponding to pool size as indicated below. Make sure holes are punched out completely. Place canister on a solid surface and work carefully to avoid injury.

Pool Capacity in Gallons	Open Hole Number.
12,000.....	1
15,000.....	1,2
18,000.....	1,2,3
20,000.....	1,2,3,4
24,000.....	1,2,3,4,5

For pools of intermediate size, open hole for next larger capacity. For pools larger than 24,000 gallons, use 2 (or more) cartridges and divide the number of holes to opened equally among them. (Example: For 42,000 gallon pool, use 2 cartridges and open holes #1, 2, 3 and 4 on each.) Place canister or canisters in chlorinator and wait for 24 hours. Then check chlorine level with test kit. Correct range should be 1.0-4.0 ppm. If residual level is above 4.0 ppm, wait 24 hours and recheck.

CLOR-TROL 1200 AND ANTHONY T-120 CHLORINATORS

Unscrew cap and remove cap liner exposing slits. Place cap liner in a dry, clean empty plastic bag. Save cap liner for possible use of the canister as a vacation floater. Screw cap back on canister. Punch out only hole numbered "A" in canister. Place canister on a solid surface and work carefully to avoid injury. Place canister or canisters in chlorinator and wait for 24 hours. Then check chlorine level with test kit. Correct range should be 1.0-4.0 ppm. If residual level is above 4.0 ppm, wait 24 hours and recheck. Adjust the chlorine output by raising or lowering the canister in the chlorinator using the stair step treads provided.

CHLORINATOR CANISTER AS VACATION FLOATER

In white plaster pools only, the chlorinator canister can be used to treat your pool when away on a trip without leaving the pump running. This canister flips on its side when empty. Remove canister from chlorinator and unscrew cap and replace cap liner. Punch holes #1 and #2 if not already punched. Place canister in center of pool.

Reentry into treated swimming pools is prohibited above levels of 4 ppm chlorine due to risk of body injury.

DISCHARGE DIRECTIONS FOR COMMERCIAL AND RESIDENTIAL POOL USES -

Before draining a treated pool, contact your local sanitary sewer and storm drain authorities and follow their discharge instructions. Do not discharge treated pool water to any location that flows to a gutter, storm drain or natural water body unless discharge is allowed by state and local authorities.

{Directions to be used with BioLab Dial Adjusted Floater.}

SWIMMING POOL SANITIZER

{Optional marketing paragraphs A}

[[Super Puck] *{or}* [This product] contains tablets featuring our [unique] [patented] blend that provides [4-in-1] [multi-action] [sanitation], [clarification], [algae prevention], [and] [sunlight protection] [protection]. [Super Puck] *{or}* [This product] releases this formula continuously for clean, clear water.]

[[Super Puck] *{or}* [This product] keeps water clean with less effort and no handling of chlorinating tablets. Simply rotate the [flow-control ring] [adjustable ring] [adjustable dial] [flow control dial] to correspond to your pool size and place the floater in the water for [4-in-1] sanitation for up to [[1] [one] month]] [[4] [four] weeks].

{Optional marketing paragraphs B}

[[No matter what type of pool you own there is a Super Puck solution for you.] This ready-to-use floater with [flow-control ring] [adjustable ring] [adjustable dial] [flow control dial] and [multifunctional] [multi-action] [4-in-1] formula makes pool care easy. Simply adjust the [dial] [ring] to your pool size and place it in the pool for [clean] [and] [&] [crystal clear] water for up to [[1] [one] month]] [[4] [four] weeks].]

[Each tablet contains a [unique] [patented] blend that provides [4-in-1] [multifunctional] [multi-action] [sanitization], [clarification], [algae prevention], [algae protection] [and] [sunlight protection].]

[By using [Super Puck] *{or}* [this product] you:

- [Spend less time applying products]
- [Save money by using fewer products]
- [Have less maintenance steps]
- [Avoid handling chlorinating tablets]]

DIRECTIONS FOR USE: It is a violation of federal law to use this product in any manner inconsistent with its labeling. Read entire label and use strictly in accordance with precautionary statements and directions.

[Step 1:] [1.]

{Option A}

Before use, adjust water balance levels to the following:

Water Balance Levels	
pH	7.2 – 7.6
Stabilizer	30 – 40 ppm
Chlorine residual	1 – 4 ppm

{Option B}

[Test and balance water before using this product. Adjust pH to 7.2 – 7.6, stabilizer to 30 – 40 ppm, and make sure the pool has a chlorine residual between 1 – 4 ppm.]

[Step 2:] [2.] Adjust the [flow-control ring] [adjustable ring] [adjustable dial] [flow control dial] to pool size:

S: ≤ 7,500 gallons

M: ≤ 10,000 gallons

L: ≤ 13,000 gallons

[Step 3:] [3.] Place floater in pool and hold upright until it fills with water. Then leave to float.

[Step 4:] [4.] After 24 hrs, check the chlorine level to ensure 1 – 4 ppm is maintained.

{Option A}

- If below 1 ppm, adjust the [flow-control ring] [adjustable ring] [adjustable dial] [flow control dial] to a larger pool size.
- If above 4 ppm, adjust the [flow-control ring] [adjustable ring] [adjustable dial] [flow control dial] to a smaller pool size.

{Option B}

Chlorine Residual	[flow-control ring] [ring] [dial] [flow control dial] Setting
< 1 ppm	Adjust to larger pool size
> 4 ppm	Adjust to smaller pool size

[Step 5:] [5.] Replace when the floater [has tipped on its side] [is empty].

Note:

- Hot weather, heavy pool usage or rain may require the [flow-control ring] [adjustable ring] [adjustable dial] [flow control dial] [ring] [dial] to be adjusted to a larger pool size.
- Shock pool water weekly. During shock treatment, remove floater from pool and drain. Place floater in an empty, clean, dry plastic container in a location inaccessible to children and pets. Place floater back in pool when the process is completed.
- Do not completely submerge floater or allow holes to become clogged. This could trap an excess amount of chlorine gas possibly resulting in a violent explosion.
- Do not attempt to open or refill this product.

Reentry into treated swimming pools is prohibited above levels of 4 ppm chlorine due to risk of body injury.

DISCHARGE DIRECTIONS FOR COMMERCIAL AND RESIDENTIAL POOL USES -

Before draining a treated pool, contact your local sanitary sewer and storm drain authorities and follow their discharge instructions. Do not discharge treated pool water to any location that flows to a gutter, storm drain or natural water body unless discharge is allowed by state and local authorities.

STORAGE AND DISPOSAL: Keep this product dry in original tightly closed container when not in use. Store in a cool, dry, well-ventilated area away from heat or open flame. Do not contaminate food or feed by storage or disposal. **CONTAINER DISPOSAL:** Non-refillable container. Do not reuse or refill this container. Triple rinse container (or equivalent) promptly after emptying. Offer for recycling if available or place in trash.

PRECAUTIONARY STATEMENTS

HAZARDS TO HUMANS AND DOMESTIC ANIMALS: DANGER: Corrosive. Causes irreversible eye damage and skin burns. May be fatal if swallowed. Do not get in eyes, on skin or on clothing. Wear goggles or safety glasses and use rubber gloves when handling this product. Irritating to nose and throat. Avoid breathing dust. Wash thoroughly with soap and water after handling and before eating, drinking, chewing gum, using tobacco, or using the toilet. Remove and wash contaminated clothing before reuse.

FIRST AID: IF IN EYES: Hold eye open and rinse slowly and gently with water for 15-20 minutes. Remove contact lenses, if present, after the first 5 minutes, then continue rinsing eye. Call a poison control center or doctor for treatment advice. **IF ON SKIN OR CLOTHING:** Take off contaminated clothing. Rinse skin immediately with plenty of water for 15-20 minutes. Call a poison control center or doctor for treatment advice. **IF INHALED:** Move person to fresh air. If person is not breathing, call 911 or an ambulance, then give artificial respiration, preferably mouth-to-mouth, if possible. Call poison control center or doctor for treatment advice. **IF SWALLOWED:** Call poison control center or doctor immediately for treatment advice. Have person sip a glass of water if able to swallow. Do not induce vomiting unless told to do so by the poison control center or doctor. Do not give anything by mouth to an unconscious person.

Have the product container or label with you when calling a poison control center or doctor, or going for treatment. [IN CASE OF MEDICAL EMERGENCY, CALL [1-303-623-5716] [1-877-800-5553] [telephone number supplied by supplemental registrant].]

Note to Physician: Probable mucosal damage may contraindicate the use of gastric lavage.

PHYSICAL OR CHEMICAL HAZARDS: STRONG OXIDIZING AGENT: Do not mix with other chemicals. Mix only with water. Never add water to product. Always add product to large quantities of water. When using automatic feeding devices, always follow manufacturer's directions as to the proper addition of sanitizer product to chlorinators. Use clean dry utensils. Do not add this product to any dispensing device containing remnants of any other product. Such use may cause a violent reaction leading to fire or explosion. Contamination with moisture, organic matter or other chemicals will start a chemical reaction and generate heat, hazardous gas, possible fire and explosion. In case of contamination or decomposition, do not reseal container. If possible, isolate container in open air or well-ventilated area. Flood area with large volumes of water.

ENVIRONMENTAL HAZARDS: This pesticide is toxic to fish and aquatic organisms.

In the Directions for Use section see specific “Discharge Directions for Commercial and Residential Pool Uses.”

[**NOTE:** Buyer assumes all responsibility for safety and use not in accordance with directions.]

{The following is optional text to be used at BioLab’s discretion with swimming pool use directions. This information is non-essential and will be provided only as a courtesy. Will not appear on all swimming pool products.}

[HOW TO CALCULATE POOL CAPACITY

Shape of Pool Gallons of water

- Rectangular Average depth x average length x average width x 7.5
- Circular Diameter x diameter x average depth x 5.9
- Oval Full width x full length x average depth x 6.7
- Irregular Consult pool builder]

{Revision 11/30/18}

Tamper Evident Tear Strip
Tear away by using "ring pull" on either side of lid



To open the lid (after the tear strip is removed)

Step-1

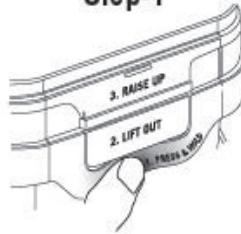

Step-2



Step-3

