

4822-469

03-29-2004

47

United States Environmental Protection Agency

Ms. Kelly K. Rahn, Registration Specialist  
S. C. Johnson & Son, Inc.  
1525 Howe Street  
Racine, WI 53403-2236

MAR 29 2004

Subject: Amendment to revise the label in accordance with the Federal Fungicide and Rodenticide Act (FIFRA) as amended.

Product Name: Repellent LMO

Registration No.: 4822-469

Date of Submission: May 2, 2003, October 13, 2003, and March 29, 2003.

Dear Ms. Rahn,

The labeling referred to above, submitted in connection with registration under the Federal Insecticide, Fungicide, and Rodenticide Act (FIFRA), is acceptable subject to the comments listed below. Five copies of the finished labeling must be submitted prior to releasing the product for shipment.

- The statement "Pad is designed to taste bitter to help prevent ingestion." contained within the Hazards to Humans and Domestic Animals" section, is not FIFRA mandated language from the specific use pattern, nor a product classification from a FIFRA toxicity category. This language and associated graphics as shown below is considered a product attribute and not a Hazard to Humans.

**Pad is designed to taste bitter to help prevent ingestion.  
(Contains Bitrex.) (Bitrex ® is a trademark of Macfarlan Smith. Ltd.)**

It should be moved either to the front of the "principal display panel as a marketing claim, inserted into the directions for use near the graphics, or in the Directions for Use within a general use discussion. The statement, "Be sure to wash hands after handling." may remain in the Hazards to Humans and Domestic Animals section.

If you have any questions, you may contact Richard J. Gebken, at (703) 305-6701.

Sincerely,



Richard Gebken  
Acting Product Manager 10  
Insecticide Branch  
Registration Division (7505C)

Enclosure

004822-00469 5748144.wpd

CONCURRENCES

SYMBOL ▶	H7505C							
SURNAME ▶	RGEBKEN							
DATE ▶	Mar 29, 2004							

# OFF!

## POWERPAD

REFILLS

REPELS MOSQUITOES FROM AN AREA UP TO  
**15x15 FEET**

Refill  
chipboard  
pp 1 of 2

# OFF!

## POWERPAD

REFILLS



### 3 REFILLS

CONTAINS 3 MOSQUITO REPELLENT PADS, 3 CANDLES

UP TO 12 HOURS  
OF PROTECTION—  
EACH PAD LASTS UP TO 4 HOURS

THE POWER TO REPEL  
IS IN THE PAD!

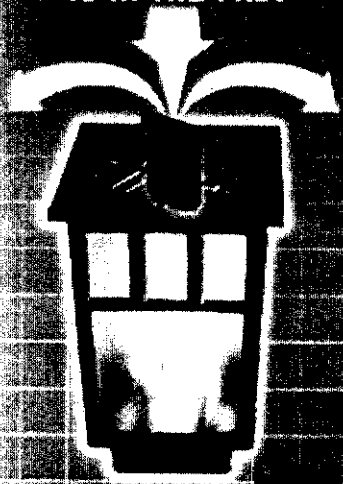

**KEEP OUT OF REACH OF CHILDREN** ACTIVE INGREDIENT:  
**CAUTION** FOR DETAILED USE DIRECTIONS AND SAFETY 4-cis/trans allethrin... 21.97%  
INFORMATION, SEE SIDE AND BACK PANELS. INERT INGREDIENTS... 78.03%

NET WT.: 0.57 OZ. EACH  
TOTAL NET WT.: 1.71 OZ.  
FOR OUTDOOR USE ONLY  
**Johnson**  
A FAMILY COMPANY

PADS ARE DESIGNED  
TO RELEASE  
REPELLENT WHEN  
HEATED BY CANDLE.

QUESTIONS? COMMENTS? Call 800-551-5232 or write Helen Johnson  
Sold by: ©2004 S.C. Johnson & Son, Inc., Racine, WI 53403-2236 U.S.A.  
All Rights Reserved. Pack Made in USA. Candles Made in Canada  
[www.mosquitoes.com](http://www.mosquitoes.com)

90%

For Position Only  
Check Code Number Before  
Generating Actual Bar Code  
0 46500 02884 X  
X XXXXX XXXXX X

Die Number: 4

Refill chipboard op 2of2

### DIRECTIONS FOR USE:

It is a violation of Federal law to use this product in a manner inconsistent with its labeling.

### TO REPLACE PAD/CANDLE COMBINATION:

Pads are designed to release repellent when heated by candle. When candle is used up and will not relight, replace both candle and pad. Avoid contamination of food.

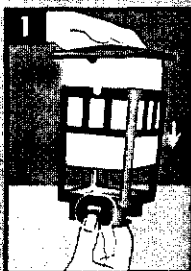

1 Detach unit top from base. Make sure flame is extinguished and unit is cool before changing pad.

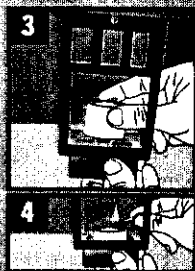

3 IMPORTANT: Remove used candle cup and firmly press new candle cup with fresh candle onto base post.

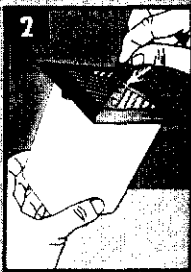

2 Remove used pad from top of unit. Remove new repellent pad from package being careful not to cut, bend, or alter pad shape. Gently slide narrow end of pad into slot in top of unit.

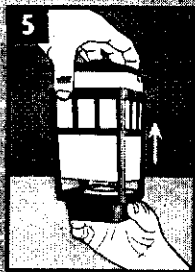

4 Light candle. Reattach unit top and base. Do not place repellent pad or matches on or in candle cup.

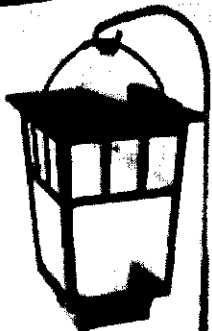
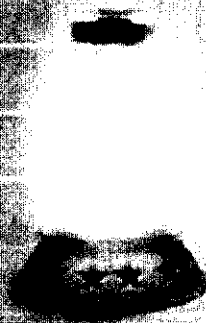

REPELS MOSQUITOES FROM AN AREA UP TO 15x15 FEET

### PRECAUTIONARY STATEMENTS HAZARDS TO HUMANS AND DOMESTIC ANIMALS

CAUTION: Harmful if swallowed or inhaled. Avoid breathing vapors. KEEP OUT OF REACH OF CHILDREN. For outdoor use only. Do not use indoors, in a tent or enclosed area. Adhesive colored wax top is hot while in use.



Pad is designed to taste bitter to help prevent ingestion. BE SURE TO WASH HANDS AFTER HANDLING.

FIRST AID: Have the person breathe fresh air. If swallowed, induce vomiting only if the person is conscious and able to swallow. If inhaled, move person to fresh air. If person is not breathing, call 911 or an ambulance. For more information, contact your local health department.

If swallowed: Call your local poison control center immediately for treatment advice. Have person sip a glass of water if able to swallow. Do not induce vomiting unless told to do so by a poison control center or doctor. Do not give anything by mouth to an unconscious person.

If inhaled: Move person to fresh air. If person is not breathing, call 911 or an ambulance. For more information, contact your local health department.

ENVIRONMENTAL PRECAUTIONS: Do not apply directly to water, to the ground, or to other surfaces where water, soil, or food may be present.

PHYSICAL AND CHEMICAL HAZARDS: Do not mix with any other repellent. Before lighting candle make sure wick is trimmed to 1/4 inch. Exposed top of candle cup and pads, matches or other items may become very hot.

NEVER BURN CANDLE UNATTENDED.

Do not use in enclosed areas. Do not use in areas where children, pets, or food may be present. Do not use in areas where children, pets, or food may be present. Do not use in areas where children, pets, or food may be present.

STORAGE: Prolonged storage of opened repellent pads in outdoor conditions may decrease effectiveness. Store unused pads in an area inaccessible to children and pets. DISPOSAL: Before disposing, empty package by using the product according to the label. Pad: Place exhausted pad in trash. Candle: After allowing exhausted candle to cool, place cup in trash. Unused pads: Call your local solid waste agency or 1-800-529-3394 for disposal instructions. Never place unused product down any indoor or outdoor drain.

# OFF!® REPELLENT PAD

KEEP OUT OF REACH OF CHILDREN. CAUTION: HARMFUL IF SWALLOWED OR INHALED. SEE OUTER CARTON FOR ADDITIONAL PRECAUTIONARY STATEMENTS.

**ACTIVE INGREDIENT:**

d-cis/trans allethrin . . . . . 21.97%

INERT INGREDIENTS . . . . . 78.03%

QUESTIONS? COMMENTS? Call 800-558-5252 or write Helen Johnson

Sold by: ©2001 S.C. Johnson & Son, Inc.  
Racine, WI 53403-2236 U.S.A.

All Rights Reserved.

Made in Italy. EPA Reg. No. 4822-469,  
EPA Est. No. 43917-ITA-1

NET CONTENTS:  
1 PAD NET WT.: .057 OZ.



A FAMILY COMPANY

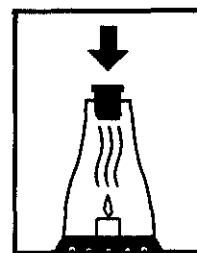

Bitrex® is a trademark of Mactarlan Smith, Ltd.



**PAD IS DESIGNED TO TASTE BITTER TO HELP PREVENT INGESTION.**

**BE SURE TO WASH HANDS AFTER HANDLING.**



449465



ACCEPTED  
with COMMENTS  
in EPA Letter Dated  
MAR 29 2004  
Under the Federal Insecticide,  
Fungicide, and Rodenticide Act,  
as amended, for the pesticide  
registered under EPA Reg. No.  
4822-467

15x15

LANTERN  
**POWERPAD**  
**OFF!**

Lantern  
chipboard  
pp1 of 3

THE POWER TO REPEL  
IS IN THE PAD!

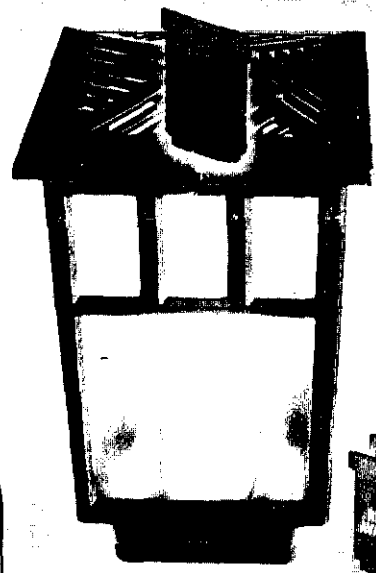

- REPELS MOSQUITOES FROM AN AREA UP TO 15 FT. BY 15 FT. (225 SQ. FT.)
  - NO EXPOSED FLAME WHEN IN USE
  - EACH PAD LASTS UP TO 4 HOURS
- OFF!**  
POWERPAD

# OFF! POWERPAD

PROTECTION CHART	OFF! POWERPAD
DOES NOT USE CITRONELLA. USES HEAT ACTIVATED REPELLENT PAD	✓
REPELS MOSQUITOES FROM AN AREA UP TO 225 SQ. FT.	✓
REPELS MOSQUITOES THAT MAY CARRY WEST NILE VIRUS	✓
EACH PAD LASTS UP TO 4 HOURS	✓

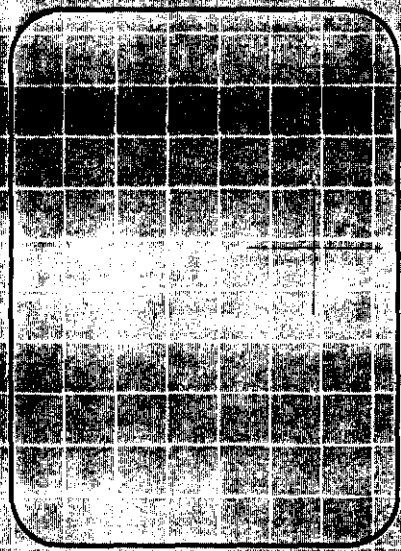

REPELS MOSQUITOES FROM AN AREA UP TO  
**15x15**  
FEET

# OFF! POWERPAD LANTERN



REPELS MOSQUITOES FROM AN AREA UP TO  
**15x15**  
FEET

ASSEMBLES TO **4 FEET** PROVEN EFFECTIVE IN EXTREME MOSQUITO CONDITIONS.

PROTECTION CHART	OFF! POWERPAD
DOES NOT USE CITRONELLA. USES HEAT ACTIVATED REPELLENT PAD	✓
REPELS MOSQUITOES FROM AN AREA UP TO 225 SQ. FT.	✓
REPELS MOSQUITOES THAT MAY CARRY WEST NILE VIRUS	✓
EACH PAD LASTS UP TO 4 HOURS	✓

ACTIVE INGREDIENT:  
4-allylthioanisole ..... 21.97%  
INERT INGREDIENTS ..... 78.03%  
KEEP OUT OF REACH OF CHILDREN  
CAUTION: MAY BE IRRITATING TO SKIN

NET WT.: 1.057 OZ.

Johnson  
A FAMILY COMPANY

Lantern  
chipboard  
pp 2 of 3

**PRECAUTIONARY STATEMENTS**  
HAZARDS TO HUMANS AND DOMESTIC ANIMALS  
CAUTION: Avoids or irritates on contact. Avoid breathing vapors. KEEP OUT OF REACH OF CHILDREN. For outdoor use only. Do not use in enclosed areas. Do not use in areas where children play or food is prepared. Do not use in areas where food is prepared.

FIRST AID  
RASH: Wash with soap and water.

100%  
For Position Only  
Check Code Number Before  
Generating Actual Bar Code  
0 46500 13073 X

**TO REPLACE PAD/CANDLE COMBINATION:**

- When ready to use, pull down the lamp shade.
- Lower lantern from base.
- Hold cork down to extinguish and remove wick.
- Pull out wick and pad and slide in prepared lamp pad.
- Reinsert wick and pad and firmly reinsert cork. Push down cork into seat.
- To avoid fire hazard, use only OFFIC brand wicks and pads.
- Light candle. Note flame base and keep away from the lampshade and fuel.

**CLEANING INSTRUCTIONS:** Before handling, remove the wick and pad from the lantern. Wash with a wet cloth only. **NOTES:** To avoid overheating, do not touch the wick or pad when the lantern is lit.

OFFIC PRODUCTS IS A DIVISION OF OFFIC INDUSTRIES, INC.  OFFIC INDUSTRIES, INC. 10000 W. 15th Ave. Denver, CO 80202

**REFILLABLE. WORKS WITH OFFIC MOSQUITO LAMP & LANTERN REFILLS.**

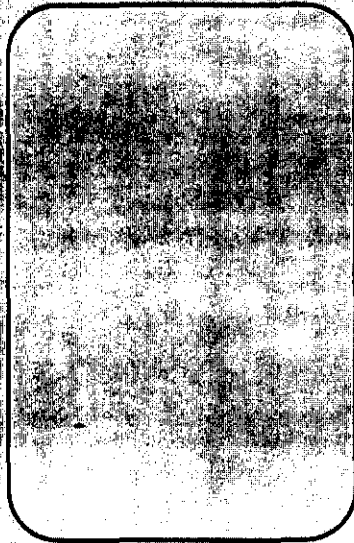

Lantern chipboard pp 3 of 3

**DIRECTIONS FOR USE:**

It is a violation of Federal law to use this product in a manner inconsistent with its labeling.

					
1. Remove the cork and wick.	2. Insert the wick and pad.	3. Push the cork down.	4. Light the candle.	5. Adjust the shade.	6. Final assembly.

**HELPFUL HINTS:**

• To avoid overheating, do not touch the wick or pad when the lantern is lit.  
• To avoid fire hazard, use only OFFIC brand wicks and pads.  
• To avoid overheating, do not touch the wick or pad when the lantern is lit.  
• To avoid fire hazard, use only OFFIC brand wicks and pads.

