



U.S. ENVIRONMENTAL PROTECTION AGENCY  
 Office of Pesticide Programs  
 Registration Division (7505P)  
 1200 Pennsylvania Ave., N.W.  
 Washington, D.C. 20460

EPA Reg. Number:

2724-813

Date of Issuance:

2/20/18

NOTICE OF PESTICIDE:

Registration  
 Reregistration

(under FIFRA, as amended)

Term of Issuance:

Conditional, Time-Limited  
 Expires: 02/20/2020

Name of Pesticide Product:

RF2170 A/T COMBO

Name and Address of Registrant (include ZIP Code):

James McFadden  
 Central Garden & Pet Company  
 1501 E. Woodfield Road, Suite 200W  
 Schaumburg, IL 60173

**Note:** Changes in labeling differing in substance from that accepted in connection with this registration must be submitted to and accepted by the Registration Division prior to use of the label in commerce. In any correspondence on this product always refer to the above EPA registration number.

On the basis of information furnished by the registrant, the above named pesticide is hereby registered under the Federal Insecticide, Fungicide and Rodenticide Act.

Registration is in no way to be construed as an endorsement or recommendation of this product by the Agency. In order to protect health and the environment, the Administrator, on his motion, may at any time suspend or cancel the registration of a pesticide in accordance with the Act. The acceptance of any name in connection with the registration of a product under this Act is not to be construed as giving the registrant a right to exclusive use of the name or to its use if it has been covered by others.

This product is conditionally registered in accordance with FIFRA section 3(c)(7)(A). You must comply with the following conditions:

1. Submit and/or cite all data required for registration/reregistration/registration review of your product under FIFRA when the Agency requires all registrants of similar products to submit such data.

Signature of Approving Official:

Elizabeth Fertich, Product Manager 04  
 Invertebrate-Vertebrate Branch I, Registration Division (7505P)

Date:

2/20/18

2. You are required to comply with the data requirements described in the DCI or EDSP Order identified below:

- a. Etofenprox GDCI-128965-1041

You must comply with all of the data requirements within the established deadlines. If you have questions about the Generic DCI or EDSP Order listed above, you may contact the Chemical Review Manager in the Pesticide Reevaluation Division:

<http://iaspub.epa.gov/apex/pesticides/f?p=chemicalsearch:1>

3. The Agency has found your company to be in compliance with the terms and conditions for the subject product, and is extending the two-year registration restriction. This registration is time-limited and expires 02/20/2020.
4. Please note that the product is still subject to all other previously required conditions of registration. Your company is required to adhere to the spot-on label mitigation, and to submit quarterly enhanced incident reports and quarterly sales information as stated in the initial registration notice dated 12/02/2011.
5. Submit one copy of the final printed label for the record before you release the product for shipment.

Should you wish to add/retain a reference to the company's website on your label, then please be aware that the website becomes labeling under the Federal Insecticide Fungicide and Rodenticide Act and is subject to review by the Agency. If the website is false or misleading, the product would be misbranded and unlawful to sell or distribute under FIFRA section 12(a)(1)(E). 40 CFR 156.10(a)(5) list examples of statements EPA may consider false or misleading. In addition, regardless of whether a website is referenced on your product's label, claims made on the website may not substantially differ from those claims approved through the registration process. Therefore, should the Agency find or if it is brought to our attention that a website contains false or misleading statements or claims substantially differing from the EPA approved registration, the website will be referred to the EPA's Office of Enforcement and Compliance.

If you fail to satisfy these data requirements, EPA will consider appropriate regulatory action including, among other things, cancellation under FIFRA section 6(e). Your release for shipment of the product constitutes acceptance of these conditions. A stamped copy of the label is enclosed for your records.

Please note that the record for this product currently contains the following CSFs:

- Basic CSF dated 11/17/2017

If you have any questions, please contact Helen Hull-Sanders by phone at 703-347-0243, or via email at [hull-sanders.helen@epa.gov](mailto:hull-sanders.helen@epa.gov).

Enclosure

Text within braces { } denotes notes to reviewer.  
Text within brackets [ ] denotes optional language.  
Text within parentheses ( ) is meant to be included on the label  
Text within carets < > is not optional, but is replaceable

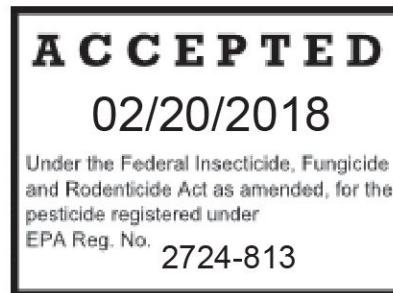

## RF2170 A/T COMBO

{Include "Cat" in product name and Text for "Cat" must be 75% the height of largest letter in primary Brand Name}

{A large, clear picture of a cat in the weight range for the product as packages will appear on the front panel of the label.}

{Front Panel }- For Use Only on Cats and Kittens [5 lbs. and over] [over 2.5 lbs but under 5 lbs] & 12 weeks of age or older

{FRONT PANEL}

**ACTIVE INGREDIENTS:**

(S)-Methoprene.....3.6%  
Etofenprox) .....40.0%

**OTHER INGREDIENTS:** .....56.4%

Total 100.0%

**KEEP OUT OF REACH OF CHILDREN**

See back panel for First Aid and additional Precautionary Statements

EPA Reg. No. 2724-813

EPA Est. No.

Net Contents:

**1, 3 or 6x** [0.034 fl oz (1 mL)] [tubes][vials][cartridges] Cats/Kittens over 2.5 lbs and under 5 lbs)/(or}

**1, 3 or 6x** [0.061 fl oz (1.8 mL)].[tubes][vials][cartridges] (Cats/Kittens 5 lbs and over)

**Lot Number**



## {**SUBLABEL A – APPLICATOR DEVICE PACKAGE**}

{BACK PANEL}

{References to [tube][vial] or [cartridge] will be consistent in the printed label}

### **{1.} DIRECTIONS FOR USE WITH APPLICATOR**

#### **READ ENTIRE LABEL BEFORE USE**

**USE ONLY ON CATS OR KITTENS 12 WEEKS OF AGE AND OLDER AND [OVER 2.5 LBS AND UNDER 5 LBS][5 LBS AND OVER]**

[formulated for cats [& kittens]][For use on cats only][Do not use on animals other than cats or kittens]

#### **INTRODUCTION:**

A unique, convenient applicator for you.

The [brand] Applicator is designed to make applying flea and deer tick control easier, more precise -- and neater - than ever before. You simply insert the appropriate [brand] [tube] [vial][cartridge] for your cat/kitten into the applicator, close it and squeeze to apply. The applicator's ergonomic, contoured shape [design] makes it easy to grip and a built-in fin [tip] [comb] helps to spread [part] the [your] cat's/kitten's hair to allow the liquid to more readily [better] reach [apply] the [to] [your cat's/kitten's] skin. The [tube] [vial] [cartridge] is sealed inside, so you can be confident that the liquid goes onto your cat/kitten - and not your hand.

<RF2170 A/T Combo> is a topically applied [long-lasting] [flea and deer tick treatment] product specifically formulated for cats and kittens with [containing] [it also contains] an insect growth regulator (IGR)[S-Methoprene][\*InfestStop™] [to prevent and control flea infestations on cats][to kill fleas before they hatch][which prevents flea eggs from maturing into biting adults]. It [This product] also contains the flea, deer tick, and mosquito killing agent [Etofenprox], which kills biting adult fleas, deer ticks, and mosquitoes your cat/kitten may acquire from its surroundings. A single application of <RF2170 A/T Combo> will provide flea egg hatch inhibition for up to 30 days [1 month][4 weeks]. Each package contains enough product for [1][3][6] monthly applications ([30][90][180] days of protection [control]). <RF2170 A/T Combo> provides relief from flea infestations for up to 1 month [4 weeks][30 days] by killing adult fleas and flea eggs. Adult fleas can live on your cat while producing vast numbers of eggs, which drop off your cat and develop in the surrounding environment. <RF2170 A/T Combo> [is designed to] kill(s) adult fleas and flea eggs, breaking the flea life cycle and providing your cat/kitten relief from flea bites at the same time.

\*(S)-Methoprene

After application, your cat's/kitten's [ordinary] [innate] skin oils [disperse] carry <RF2170 A/T Combo> over your cat's/kitten's body for protection against biting adult fleas and the development of flea eggs. [(This product) may stain leather and suede fabrics for (24)(24 to 48) hours after application.] Once adult fleas are evident on your cat/kitten, there is likely an infestation of flea eggs and flea larvae in your home. To completely kill the existing flea population, you may need to treat your home and your cat's bedding (home sprays, foggers), as well as your yard (yard spray/outdoor fogger) with traditional flea products approved for use on pets, around the home, or in your yard. <RF2170 A/T Combo> can be used in conjunction with other [Brand Name] premise products. As with all flea products, [they are ][<RF2170 A/T Combo is>] most effective when used as part of a total program aimed at reducing all stages of fleas in the cat's/kitten's environment. [Brand Name] products [They] are designed to complement each other in an integrated program for flea, deer tick, and mosquito management. To assure proper treatment, we recommend use of [Brand Name] products as directed to treat all pets in the household, as well as the indoor and outdoor home environments.]

**DIRECTIONS FOR USE:** It is a violation of Federal Law to use this product in a manner inconsistent with its labeling. Read and follow all directions and precautions on this product label. [If you choose to apply treatment directly to cat without using the applicator device, read and follow the Directions For Use for Direct Application to Cat on this package.]



This product contains [1][3][6] monthly dosages [one monthly dose], each [1 [0.034 fl oz] 1.8 ml [cc] [0.061 fl oz]].

#### USE RESTRICTIONS:

Do not apply more than once every month. Do not use more than one [tube][vial][cartridge] per cat. Do not use on kittens less than 12 weeks old. Do not get this product in your cat's eyes or mouth. Do not allow your cat to ingest this product. Do not get this product in cat's/kitten's eyes or mouth. Do not apply to cats weighing less than [2.5 lbs][5 lbs.]. In multiple cat households, do not allow the cats to groom each other until the product has dried. Do not allow children to apply this product. Do not spread <RF2170 A/T COMBO> by hand over the cat/kitten. Do not bathe the cat/kitten within the first 24 hours after Spot On® [squeeze on] has been applied.

<RF2170 A/T COMBO> works by application directly to the cat's/kitten's skin, not to the hair. When applying, use applicator device tip to push aside cat's/kitten's hair to allow direct application to the skin. {(Note: Application now assumes one [tube][vial] [cartridge] per cat per application)}

<The RF2170 A/T COMBO> provides a unique applicator device that allows cat/kitten owners to treat their cats/kittens more securely, and dispose of liquid cartridges [tubes][vials]with less mess. [Note: Each package contains sufficient [tubes][vials][cartidges] for [1][3][6] applications]

[1 mL [0.034 fl oz] dose for use on cats and kittens over 2.5 lbs and under 5 lbs only and 12 weeks of age or older.

1.8 mL [0.061 fl oz] dose for use on cats and kittens 5 lbs. and over only and 12 weeks of age or older. {Same size applicators with different fill amounts}

To apply the <RF2170 A/T COMBO> treatment, use one disposable liquid [tube][vial][cartridge] [for each application] with the applicator device. Do not use more than one [tube][vial][cartridge] per cat.

#### 1. OPEN [icon]

Use finger scoop to lift open [color] door [of applicator device].

#### 2. LOAD [icon]

[To Load, place [tube ][cartridge] [vial] white side up [under the [color] tabs] into the applicator] [with [tip end][front] of [tube][vial][cartridge] placed under tab on door] [Tip end of [tube][vial] [cartridge] must fit under the [U-shaped] [notch][tab] in the [color] [lid] [door]]. [Ensure that [tube ][vial][cartridge] fits securely in the applicator.]

#### 3. CLOSE [icon]

[Gently] close the [color, e.g. green] door of the applicator [and] the [tube][vial][cartridge] will snap open.

#### 4. APPLY [icon]

The cat/kitten should be dry and standing for easy application.

[To apply, use tip to part hair and get next to cat's/kitten's skin at the base of the skull. Press [shape e.g. square] [thumb pad][button] on [color] door of applicator and squeeze out the entire contents of the [tube][vial] [cartridge] onto the cat's/kitten's skin.]

-OR-

[To **APPLY** Use front edge of applicator to part fur and get next to cat's/kitten's skin at one spot at the base of the skull. Press [shape e.g. square] [button] on applicator door. Repeat until [tube][vial][cartridge] is empty.]

-OR-

[To **APPLY** Use tip to part fur and get next to cat's/kitten's skin. **Press** [shape e.g. square] [button] on applicator door [x times to empty [tube][vial][cartridge]] at one spot at the base of the skull.]

Households with more than one cat/kitten should prevent cats/kittens from grooming each other until solution has dried. [Although the cat's/kitten's skin and hair oils will [over time] distribute the application over the entire cat/kitten, brushing the cat/kitten 12-24 hours after treatment will help to distribute the material over the skin.]

5. DISPOSE [icon]

To dispose of empty [tube][vial][cartridge], open [color, e.g. green] applicator door and drop [empty] [tube][vial][cartridge] into trash or offer for recycling if available. Close applicator device door and [return applicator to package until next use][store in original package.]

6. RETREAT AFTER [30 DAYS] [4 weeks][1 month]

Do not reapply product for 30 days. Do not treat more than once per month.

{Note: Each package contains sufficient [tubes]/[vials][cartridges] for [1][3][6] applications}

<RF2170 A/T COMBO> is most effective when used as part of a total flea and deer tick management program. Use other [Brand Name] products registered for residential area control of these pests in conjunction with this treatment. Monthly treatments are required for control and prevention of fleas.[The successive feeding activity of fleas on cats may elicit a hypersensitivity skin disorder known as flea allergy dermatitis (FAD). Treatment of cats with <RF2170 A/T COMBO> kills fleas that may cause this condition. .]

[TREATMENT SCHEDULE

Dosage: Use only 1 applicator every [30 days][4 weeks][1 month] per cat/kitten

Cat's/Kitten's Name	First Treatment Date	Second Treatment Date (30 Days From 1 <sup>st</sup> )	Third Treatment Date (30 Days From 2 <sup>nd</sup> )

NOTES: \_\_\_\_\_

REMINDER: I purchased [Brand Name] from \_\_\_\_\_ ]

**STORAGE AND DISPOSAL:** **Storage:** Store in a cool, dry (preferably locked) area away from children and animals. Do not store unused applicator [tubes][vials]cartridges] separately from their packaging. **Pesticide Disposal and Container Handling: If empty:** Do not reuse empty [tube][vial]cartridge]. Place in trash or offer for recycling if available. **If partly filled:** Call your local solid waste agency for disposal instructions. Never place unused product down any indoor or outdoor drain.

**PRECAUTIONARY STATEMENTS**

**HAZARDS TO HUMANS AND DOMESTIC ANIMALS**

**HAZARDS TO HUMANS:** Repeated exposure to etofenprox can cause skin irritation. Wash hands thoroughly with soap and water after handling and before eating, drinking, chewing gum, using tobacco, or using the toilet. Remove and wash contaminated clothing before reuse.

**HAZARDS TO DOMESTIC ANIMALS:** For External Use on Cats Only. **Do not use on kittens weighing less than [2.5] [5] pounds. Do not use on kittens less than 12 weeks old.** This product is not a substitute for prescribed heartworm preventative. Consult a veterinarian before using this product on debilitated, aged, pregnant or nursing cats. Certain medications can interact with pesticides. Consult a veterinarian before using on medicated cats. Sensitivities may occur after using ANY pesticide product for cats. If signs of sensitivity occur, bathe your cat with mild soap and rinse with large amounts of water. If signs continue, consult a veterinarian immediately. Due to the bitter taste of the product, oral exposure could result in salivation. Be careful not to get



any product in the cat's mouth during application. For multiple cat households, prevent the cats from grooming each other until the product has dried. If the salivation continues or other clinical signs are noted, please call 1-800-brand phone number.

{This box will appear in lower right hand corner of back panel.}

**SIDE EFFECTS:** Monitor your cat after application. Side effects may include signs of skin irritation such as redness, scratching, or other signs of discomfort. Gastrointestinal signs such as vomiting or diarrhea have also been reported. If these or other side effects occur, consult your veterinarian or [brand name] at 1-800-brand phone number.

**WARRANTY AND CONDITIONS OF SALE:**

Seller warrants that this product conforms to the chemical specifications expressed on the label. To the extent consistent with applicable law, Seller makes no other warranties, and disclaims all other warranties, express or implied, including but not limited to warranties of merchantability and fitness for the intended purpose. To the extent consistent with applicable law, seller's liability for default, breach, or failure under this label shall be limited to the amount of the purchase price. To the extent consistent with applicable law, Seller shall have no liability for consequential damages.

In case of emergency or for product information, call 1-800-xxx-xxxx or contact your veterinarian if your cat/kitten is experiencing an adverse event.

To learn more about treating current infestations and preventing future outbreaks, please, visit our website: [www.adamspetcare.com](http://www.adamspetcare.com)

[www.biospot.com](http://www.biospot.com)

[www.biospotactivecare.com](http://www.biospotactivecare.com)

[www.vpl.com](http://www.vpl.com)

[For more information, call our experts at 1-800-xxx-xxx (weekdays, 9am – 5 pm EST)]

To learn more, visit [ [www.adamspetcare.com](http://www.adamspetcare.com) ]

[www.biospot.com](http://www.biospot.com)

[www.biospotactivecare.com](http://www.biospotactivecare.com)

[www.vpl.com](http://www.vpl.com)

For product use information, call [phone number] or visit our Web site: [www.adamspetcare.com](http://www.adamspetcare.com)

[www.biospot.com](http://www.biospot.com)

[www.biospotactivecare.com](http://www.biospotactivecare.com)

[www.vpl.com](http://www.vpl.com)

InfestStop is a trademark of Farnam Companies inc.

Wellmark International  
1501 East Woodfield Road 200W  
Schaumburg, IL 60173  
Made in USA

{TEXT FOR LIQUID TUBE / CARTRIDGE / VIAL}

<Product name>

Etofenprox 40%, (S)-Methoprene 3.6%

KEEP OUT OF REACH OF CHILDREN

READ ENTIRE DIRECTIONS BEFORE EACH USE

EPA Reg. No. 2724-813

Net Contents [0.034 fl oz (1 mL)] [tubes][vials][cartridges] or [0.061 fl oz (1.8 mL)].[tubes][vials][cartridges]

Lot Number



For External Use Only on Cats/Kittens [5 lbs. and over] [over 2.5 lbs but under 5 lbs] & 12 weeks  
of age or older  
{BACK PANEL}

**Directions for Use/Icons**

To apply the treatment, use applicator device with ONLY ONE liquid tube per application / per cat

Use finger scoop to lift **OPEN** pink door



To **LOAD** place tube **WHITE** side UP into applicator with tip end of tube placed under tab on door



Gently **CLOSE** door the tube will snap open.

To **APPLY** Use tip to part fur and get next to cat's skin.



**Press** square on door at one spot between shoulders

To **DISPOSE** of empty tube open door and drop tube into trash



**{2.} DIRECTIONS FOR USE FOR DIRECT APPLICATION TO CAT**

**READ ENTIRE LABEL BEFORE USE**

**USE ONLY ON CATS OR KITTENS 12 WEEKS OF AGE AND OLDER AND [OVER 2.5 LBS AND UNDER 5 LBS][5 LBS AND OVER]**

[formulated for cats & kittens][For use on cats only][Do not use on animals other than cats or kittens]

**DIRECTIONS FOR USE:** It is a violation of Federal Law to use this product in a manner inconsistent with its labeling. Read and follow all directions and precautions on this product label.

This product contains [1][3][6] monthly dosages [one monthly dose], each [1 mL [0.034 fl oz]] {or} [1.8 mL [0.061 fl oz]].

**USE RESTRICTIONS:**

Do not apply more than once every month. Do not use more than one [tube][vial][cartridge] per cat. Do not use on kittens less than 12 weeks old. Do not get this product in your cat's eyes or mouth. Do not allow your cat to ingest this product. Do not get this product in cat's/kitten's eyes or mouth. Do not apply to cats weighing less than [2.5 lbs.][5 lbs.] In multiple cat households, do not allow the cats to groom each other until the product has dried. Do not allow children to apply this product. Do not spread <RF2170 A/T COMBO> by hand over the cat/kitten. Do not bathe the cat/kitten within the first 24 hours after Spot On® [squeeze on] has been applied.

<RF2170 A/T COMBO> works by application directly to the cat's/kitten's skin, not to the hair. Do not get this product in cat's/kitten's eyes or mouth. {Note: Application now assumes one [tube][vial] [cartridge] per cat per application}

**[APPLICATION METHOD]**

1. **OPEN** [icon]: [Remove one [tube][vial][cartridge] from the package and hold in an upright position (pointed away from your face).] [Bend at perforation and tear off 1<sup>st</sup> month's [tube][vial][cartridge].] [Hold [tube][vial][cartridge] upright] and snap tip back, away from face and body.
2. **APPLY** [icon]: The cat/kitten should be dry and standing for easy application. Use tip of [tube][vial] [cartridge] prior to application of the product, to gently lift the cat's or kitten's hair coat on the back of the neck at the base of the skull, position the tip of the [tube][vial] [cartridge] on the cat's exposed skin and squeeze out the [entire] contents of the [tube][vial] [cartridge] onto the cat's skin.

Households with more than one cat should prevent cats from grooming each other until solution has dried. [Although the cat's/kitten's skin and hair oils will [over time] distribute the application over the entire cat/kitten, brushing the cat/kitten 12-24 hours after treatment will help to distribute the material over the skin.]

3. **DISPOSE** [icon]: To dispose of empty [tube][vial][cartridge], drop [empty] [tube] [vial][cartridge] into trash or offer for recycling if available.
4. **RETREAT**: Repeat application once [monthly][every 30 days][every 4 weeks].

{Note: Each package contains sufficient cartridges/tubes/vials for [1][3][4][6] applications [1 ml [cc] [0.034 fl oz] dose for use on cats and kittens over 2.5 lbs and under 5 lbs only and 12 weeks of age or older. }

1.8 ml [cc] [0.061 fl oz] dose for use on cats and kittens 5 lbs. and over only and 12 weeks of age or older.} {Same size applicators with different fill amounts}

<RF2170 A/T COMBO> is most effective when used as part of a total flea and deer tick management program. Use other [Brand Name] products registered for residential area control of these pests in conjunction with this treatment. Monthly treatments are required for control and



prevention of fleas.[The successive feeding activity of fleas on cats may elicit a hypersensitivity skin disorder known as flea allergy dermatitis (FAD). Treatment of cats with <RF2170 A/T COMBO> kills fleas that may cause this condition. ]

OPTIONAL GRAPHICS

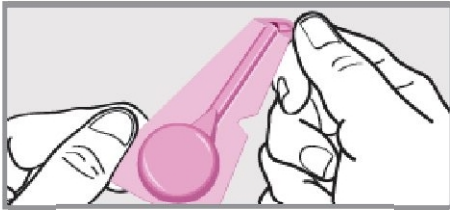
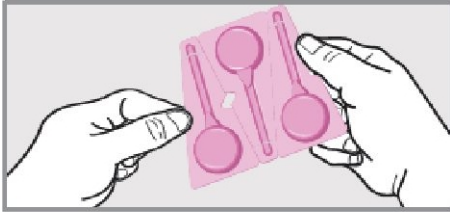

[TREATMENT SCHEDULE

Dosage: Use only 1 applicator every [30 days][4 weeks][1 month] per cat/kitten

Cat's/Kitten's Name	First Treatment Date	Second Treatment Date ([30 Days][4 weeks][1 month] From 1 <sup>st</sup> )	Third Treatment Date ([30 Days][4 weeks][1 month] From 2 <sup>nd</sup> )

NOTES: \_\_\_\_\_

REMINDER: I purchased [Brand Name] from \_\_\_\_\_ ]

**{SUBLABEL B FOR REFILL PACKAGE }**

**{For use with applicator device or direct application to cat without applicator device}**

{Front Panel}

[Product Name] {Text for "Cat" must be 75% the height of largest letter in primary Brand Name}

{A large, clear picture of a cat in the weight range for the product as packages will appear on the front panel of the label.}

For Use Only on Cats and Kittens [5 lbs. and over] [over 2.5 lbs but under 5 lbs] & 12 weeks of age or older

[Flea & Deer Tick] [Treatment] [and] [Control]

**ACTIVE INGREDIENTS:**

(S)-Methoprene (CAS # 65733-16-6) .....3.6%

Etofenprox (CAS # 80844-07-1) .....40.0%

**OTHER INGREDIENTS:** .....56.4%

Total .....100.0%

**KEEP OUT OF REACH OF CHILDREN**

See back panel for First Aid and additional Precautionary Statements

EPA Reg. No. 2724-813

EPA Est. No.

Net Contents:

**1, 3 or 6x** [0.034 fl oz (1 mL)] [tubes][vials][cartridges] Cats/Kittens over 2.5 lbs and under 5 lbs){or}

**1, 3 or 6x** [0.061 fl oz (1.8 mL)].[tubes][vials][cartridges] (Cats/Kittens 5 lbs and over)

**Lot No.**

{Back Panel}

**READ ENTIRE LABEL BEFORE USE**

**USE ONLY ON CATS OR KITTENS 12 WEEKS OF AGE AND OLDER AND [OVER 2.5 LBS AND UNDER 5 LBS][5 LBS AND OVER]**

[formulated for cats [& kittens]][For external use on cats only][Do not use on animals other than cats and kittens]

**INTRODUCTION:**

A unique, convenient applicator for you.

The [brand] Applicator is specially designed to make applying flea and deer tick control easier, more precise -- and neater - than ever before. You simply insert the appropriate [brand] [tube] [vial][cartridge] for your cat/kitten into the applicator, close it and squeeze to apply. The applicator's ergonomic, contoured shape [design] makes it easy to grip and a built-in fin [tip] [comb] helps to spread [part] the [your] cat's/kitten's hair to allow the liquid to more readily [better] reach [apply] the [to] [your cat's/kitten's] skin. The [tube] [vial] [cartridge] is sealed inside, so you can be confident that the liquid goes onto your cat/kitten - and not your hand.

<RF2170 A/T Combo> is a topically applied [long-lasting] [flea and deer tick treatment] product specifically formulated for cats and kittens with [containing] [it also contains] an insect growth regulator (IGR)[S-Methoprene][\*InfestStop™][to prevent and control flea infestations][to kill fleas before they hatch][which prevents flea eggs from maturing into biting adults]. It [This product] also contains the flea, deer tick, and mosquito killing agent [Etofenprox], which kills biting adult fleas, deer ticks, and mosquitoes your cat/kitten may acquire from its surroundings. A single application of <RF2170 A/T Combo> will provide flea egg hatch inhibition for up to 30 days [1 month][4 weeks]. Each package contains enough product for [1][3][6] monthly applications ([30][90][180] days of protection [control]). <RF2170 A/T Combo> provides relief from flea infestations for up to 1 month [4 weeks][30 days] by killing adult fleas and flea eggs. Adult fleas can live on your cat while producing vast numbers of eggs, which drop off your cat and develop in the surrounding environment. <RF2170 A/T Combo> [is designed to] kill(s) adult fleas and flea eggs, breaking the flea life cycle and providing your cat/kitten relief from flea bites at the same time.  
\*(S)-Methoprene)

After application, your cat's/kitten's [ordinary] [innate] skin oils [disperse] carry <RF2170 A/T Combo> over your cat's/kitten's body for protection against biting adult fleas and the development of flea eggs. [(This product) may stain leather and suede fabrics for (24)(24 to 48) hours after application.] Once adult fleas are evident on your cat/kitten, there is likely an infestation of flea eggs and flea larvae in your home. To completely kill the existing flea population, you may need to treat your home and your cat's bedding (home sprays, foggers), as well as your yard (yard spray/outdoor fogger) with traditional flea products approved for use on pets, around the home, or in your yard. <RF2170 A/T Combo> can be used in conjunction with other [Brand Name] premise products. As with all flea products, [they are] [<RF2170 A/T Combo> is] most effective when used as part of a total program aimed at reducing all stages of fleas in the cat's/kitten's environment. [Brand Name] products [They] are designed to complement each other in an integrated program for flea, deer tick, and mosquito management. To assure proper treatment, we recommend use of [Brand Name] products as directed to treat all pets in the household, as well as the indoor and outdoor home environments.]

{Note: full Directions for Use to be used if space allows}

**DIRECTIONS FOR USE:** It is a violation of Federal Law to use this product in a manner inconsistent with its labeling. Read and follow all directions and precautions on this product label.



## **{1.} DIRECTIONS FOR USE WITH APPLICATOR**

[To apply the <RF2170 A/T Combo> treatment with the {Brand Name} applicator, use one disposable liquid [cartridge][tube][vial][for each application] with the applicator device.] [Remove one refill [cartridge][tube][vial] from the package and insert into opened [Brand Name] applicator device. Make application according to label directions supplied with the [Brand Name] applicator device.] If you need directions for application, please call 1-800-(brand phone number).

[If you choose to apply directly to cat without using the applicator device, read and follow the Directions For Use for Direct Application to Cat on this package.]

## **{2.} DIRECTIONS FOR USE FOR DIRECT APPLICATION TO CAT**

### **READ ENTIRE LABEL BEFORE USE**

**USE ONLY ON CATS OR KITTENS 12 WEEKS OF AGE AND OLDER AND [OVER 2.5 LBS AND UNDER 5 LBS][5 LBS AND OVER]**

[formulated for cats [& kittens] only][For use on cats only][Do not use on animals other than cats and kittens]

**DIRECTIONS FOR USE:** It is a violation of Federal Law to use this product in a manner inconsistent with its labeling. Read and follow all directions and precautions on this product label.

This product contains [1][3][6] monthly dosages [one monthly dose], each [1 mL [0.034 fl oz]] {or} [1.8 mL [0.061 fl oz]].

### **USE RESTRICTIONS:**

Do not apply more than once every month. Do not use more than one [tube][vial][cartridge] per cat. Do not use on kittens less than 12 weeks old. Do not get this product in your cat's eyes or mouth. Do not allow your cat to ingest this product. Do not get this product in cat's/kitten's eyes or mouth. Do not apply to cats weighing less than 2.5 lbs. In multiple cat households, do not allow the cats to groom each other until the product has dried. Do not allow children to apply this product. Do not spread <RF2170 A/T COMBO> by hand over the cat/kitten. Do not bathe the cat/kitten within the first 24 hours after Spot On® [squeeze on] has been applied.

<RF2170 A/T COMBO> works by application directly to the cat's/kitten's skin, not to the hair. {Note: Application now assumes one tube[vial] [cartridge] per cat per application}

### **[APPLICATION METHOD]**

1. **OPEN** [icon]: [Remove one [tube][vial][cartridge] from the package and hold in an upright position (pointed away from your face).] [Bend at perforation and tear off 1<sup>st</sup> month's[tube][vial]cartridge].] [Hold the [tube][vial]cartridge] upright] and snap tip back, away from face and body.
2. **APPLY** [icon]: The cat/kitten should be dry and standing for easy application. Use tip of [tube][vial] [cartridge] prior to application of the product, to gently lift the cat's or kitten's hair coat on the back of the neck at the base of the skull, position the tip of the [tube][vial] [cartridge] on the cat's exposed skin and squeeze out the [entire] contents of the [tube][vial] [cartridge] onto the cat's skin.

Households with more than one cat should prevent cats from grooming each other until solution has dried. [Although the cat's/kitten's skin and hair oils will [over time] distribute the application over the entire cat/kitten, brushing the cat/kitten 12-24 hours after treatment will help to distribute the material over the skin.]

3. **DISPOSE** [icon]: To dispose of empty [tube][vial][cartridge], drop [empty] [tube] [vial][cartridge] into trash or offer for recycling if available.
4. **RETREAT**: Repeat application once [monthly][every 4 weeks][every 30 days].

{Note: Each package contains sufficient cartridges/tubes/vials for [1][3][6] applications}  
{[1 mL [0.034 fl oz] dose for use on cats and kittens over 2.5 lbs and under 5 lbs only and 12 weeks of age or older.  
1.8 mL [0.061 fl oz] dose for use on cats and kittens 5 lbs. and over only and 12 weeks of age or older.} {Same size applicators with different fill amounts}}

<RF2170 A/T COMBO> is most effective when used as part of a total flea and deer tick management program. Use other [Brand Name] products registered for residential area control of these pests in conjunction with this treatment. Monthly treatments are required for control and prevention of fleas.[The successive feeding activity of fleas on cats may elicit a hypersensitivity skin disorder known as flea allergy dermatitis (FAD). Treatment of cats with <RF2170 A/T COMBO> kills fleas that may cause this condition .]

{OPTIONAL GRAPHICS}

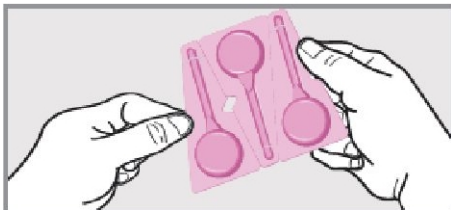

[TREATMENT SCHEDULE

Dosage: Use only 1 applicator every [30 days][4 weeks][1 month] per cat/kitten

Cat's/Kitten's Name	First Treatment Date	Second Treatment Date ([30 Days][4 weeks][1 month] From 1 <sup>st</sup> )	Third Treatment Date ([30 Days][4 weeks][1 month] From 2nd)

NOTES: \_\_\_\_\_

REMINDER: I purchased [Brand Name] \_\_\_\_\_ from \_\_\_\_\_ ]

**{Precautionary/First Aid and Storage/Disposal} text included as on Sub-label A}**

**WARRANTY AND CONDITIONS OF SALE:**

Seller warrants that this product conforms to the chemical specifications expressed on the label. To the extent consistent with applicable law, Seller makes no other warranties, and disclaims all other warranties, express or implied, including but not limited to warranties of merchantability and fitness for the intended purpose. To the extent consistent with applicable law, seller's liability for default, breach, or failure under this label shall be limited to the amount of the purchase price. To the extent consistent with applicable law, Seller shall have no liability for consequential damages.

In case of emergency or for product information, call 1-800-xxx-xxxx or contact your veterinarian if your cat/kitten is experiencing an adverse event.

To learn more about treating current infestations and preventing future outbreaks, please, visit our website: [[www.adamspetcare.com](http://www.adamspetcare.com)]

[[www.biospot.com](http://www.biospot.com)]

[[www.biospotactivecare.com](http://www.biospotactivecare.com)]

[[www.vpl.com](http://www.vpl.com)]

[For more information, call our experts at 1-800-xxx-xxx (weekdays, 9am – 5 pm EST)]

To learn more, visit [[www.adamspetcare.com](http://www.adamspetcare.com)]

[[www.biospot.com](http://www.biospot.com)]

[[www.biospotactivecare.com](http://www.biospotactivecare.com)]

[[www.vpl.com](http://www.vpl.com)]

For product use information, call [phone number] or visit our Web site:[[www.adamspetcare.com](http://www.adamspetcare.com)]

[[www.biospot.com](http://www.biospot.com)]

[[www.biospotactivecare.com](http://www.biospotactivecare.com)]

[[www.vpl.com](http://www.vpl.com)]

InfestStop is a trademark of Farnam Companies inc.

Wellmark International  
1501 East Woodfield Road 200W  
Schaumburg, IL 60173  
Made in USA



{TEXT FOR LIQUID TUBE / CARTRIDGE / VIAL}

<Product name>

Etofenprox 40%, (S)-Methoprene 3.6%

KEEP OUT OF REACH OF CHILDREN

READ ENTIRE DIRECTIONS BEFORE EACH USE

EPA Reg. No. 2724-813

Net Contents [0.034 fl oz (1 mL)] [tubes][vials][cartridges] or [0.061 fl oz (1.8 mL)].[tubes][vials][cartridges]

Lot Number

For External Use Only on Cats/Kittens [5 lbs. and over] [over 2.5 lbs but under 5 lbs] & 12 weeks of age or older

{OPTIONAL MARKETING CLAIMS}

**{General/Protection claims}**

1 mL [0.034 fl oz] for cats [kittens] over 2.5 lbs and under 5 lbs.; 1.8 mL [0.061 fl oz] for cats/kittens 5 lbs. and over and 12 weeks of age or older.

Do not use more than one [tube][vial][cartridge] per cat

For use only on cats/kittens [weighing] [over 2.5 lbs and under 5 lbs.][5 lbs. and over] and 12 weeks of age or older.

[Flea & deer tick] treatment for cats [& kittens]

Flea & Deer Tick [Protective] for cats [& kittens]

[formula for cats/kittens][flea prevention and treatment formulated for use only on cats and kittens [12 weeks of age and older]

Spot On® [Topical][Non-systemic] treatment for cats/kittens

Spreads [over time] with cat's movement (skin and hair oils)

Flea, Deer Tick, and Mosquito Treatment [Control][Prevention][Relief] for Cats & Kittens

5 in 1 Control [Protection][Treatment] (Fleas, Flea Eggs, flea larvae, Deer Ticks, and Mosquitoes)

4 in 1 Control [Protection][Treatment] (Fleas, Flea Eggs, Deer Ticks, and Mosquitoes)

[1 month][monthly][4 week][30 day] protection from [fleas, deer ticks, & flea eggs]

[Monthly] [4 week][30 day] treatment for [fleas, flea eggs, & deer ticks]

Flea [and deer tick][and mosquito] control for your cat/kitten

A smart approach to flea control

[Brand] Provides a novel [smart] approach to flea, deer tick, and mosquito control

Improved flea, deer tick, and mosquito control

Keeps fleas, deer ticks, and mosquitoes under control

Spot On® [Plus] Insect Control [Treatment and Prevention]

A flea control program

Controls flea, deer tick, and mosquito problems on your cat/kitten

Protection from Fleas, deer ticks, and mosquitoes

Provide your cat/kitten with protection from fleas, deer ticks, and mosquitoes, right from the start

Direct on-animal protection from fleas, deer ticks, and mosquitoes

Provides relief [protection] from fleas, deer ticks, and mosquitoes

Once-a-month [topical][Spot On®] protection from fleas and deer ticks

[Reapply monthly] [Suitable for year-round use][Month] sticker for home calendar

Monthly application for most effective protection

When it comes to fleas and deer ticks, there's no room for compromise [Brand Name]

[Satisfaction guaranteed or your money back]

[money back guarantee]

[Applicator][Patent Pending]

### **Kills/Repels/Controls Claims**

[Actively] Kills [Controls] [adult] fleas, deer ticks, [flea larvae], and flea eggs for [up to][30 days]  
[4 weeks][1 month][per application]  
[Actively] Kills [fleas][deer ticks][flea eggs][larvae][&][and][mosquitoes][by contact]  
[Protects for up to [30 days][Four/4] Weeks][One month][Four/4 Week [Flea] [Deer Tick][Mosquito]  
Treatment]  
[1 month][monthly][30 days][4 weeks]protection [from fleas, deer ticks, & flea eggs]  
Controls fleas, deer ticks, and mosquitoes & prevents flea reinfestations on cats  
[Kills deer ticks] (for up to 1 month [4 weeks][30 days][1 month]) [per application]  
Starts killing fleas within 15 minutes  
Starts working on contact  
[Kills adult fleas, deer ticks, mosquitoes, flea eggs and flea larvae] [Dual protection (against fleas  
and deer ticks)]  
[Dual Action kills adult fleas and prevents flea development]  
Kills [and/or Repels] mosquitoes [for up to 28 days][by contact]  
[Kills Fleas and Deer Ticks by Contact]  
controls fleas, deer ticks, and mosquitoes  
Controls fleas, deer ticks, and mosquitoes & prevents flea reinfestations  
[Kills deer ticks] (for up to 1 month [4 weeks][30 days]) [per application]  
Protects your [cat][kitten] from fleas, deer ticks, and mosquitoes (which may transmit heartworm)  
Kills [Controls] deer ticks that may transmit [Lyme disease][and Cytauzoonosis] for up to  
[1 month][4 weeks] [30 days]  
Protect your [cat/kitten] from [against] deer ticks that may transmit Lyme disease  
Kills [and repels] mosquitoes that may transmit heartworm  
Prevents mosquitoes from feeding on cats  
Kills fleas that may cause flea allergy dermatitis, flea bite anemia, and tapeworm infestation  
Preventative treatment for fleas that may cause flea allergy dermatitis, flea bite anemia, and  
tapeworm infestation  
Controls fleas, deer ticks, and mosquitoes that cause highly irritating [insect] bites

[All text below represents one label statement with any selected line]

[Protect your family and cat/kitten from:]

[When your cat has fleas and deer ticks, your family and cat/kitten may be exposed to:]

Fleas that may cause:

Flea allergy dermatitis

Tapeworm infestation

### **IGR /Flea egg/life cycle Claims:**

[Plus][Contains][With] PRECOR® [vIGRen®][S-Methoprene][\*InfestStop™], an insect growth  
regulator for flea control  
Contains [Features][\*InfestStop™] an Insect Growth Regulator (IGR) to inhibit the development of  
flea eggs  
Flea control for cats with [PRECOR®][vIGRen®] [\*InfestStop™] Insect Growth Regulator (IGR)  
[(S)-Methoprene][\*InfestStop™] Insect Growth Regulator (IGR) interrupts the development of the  
flea life cycle [at the egg stage]  
[(S)-Methoprene][\*InfestStop™] Insect Growth Regulator (IGR) prevents the development of flea  
eggs into adult fleas and [inhibits the development of flea eggs into adult fleas]  
Controlling flea reproduction is the first step in controlling flea populations on your cat/kitten  
[(S)-Methoprene][\*InfestStop™] Insect Growth Regulator (IGR) prevents flea reinfestation on your  
cat/kitten  
Flea treatment and preventative with an [insecticide] adulticide and [\*InfestStop™] Insect Growth  
Regulator (IGR)  
[With [S-Methoprene][\*InfestStop™] Insect Growth Regulator [IGR] to Break Flea Life Cycle]



Controls[Kills][Lasts][Works][Protects] flea infestations for up to [1 month][4 weeks]  
[Contains [\*InfestStop™] an Insect Growth Regulator (IGR) to kill flea eggs and prevent flea development  
for [1 month][30 days][4 weeks]  
[Controls flea reinfestation for [1 month][30 days][4 weeks]  
Breaks the flea life cycle for [up to] [1 month][4 weeks][30 days]  
Kills [Controls] flea eggs for up to [30 days][1 month][4 weeks][per application]  
Kills flea eggs, the source of home flea infestations and cat/kitten re-infestations, for up to [30  
days][1 month][4 weeks]  
[Kills][Prevents][Keeps] flea eggs from hatching for up to [30 days][1 month][4 weeks]  
Prevents flea eggs from developing into biting adults for up to [30 days][1 month][4 weeks][per  
application]  
An effective flea topical [A Spot On®] product that kills adult fleas and halts the development of  
flea eggs [immature stages in the flea life cycle]  
Prevents re-infestation on cats for up to [1 month][30 days][4 weeks]  
Controls existing fleas and flea eggs, plus [and][prevents] future flea infestations  
Interrupts normal flea development [Stops the flea life cycle]  
Interrupts the flea life cycle  
Kills [flea] eggs before they hatch into biting adults  
Kills hatching [developing] flea eggs  
One-two punch controls fleas and flea eggs  
Plus kills flea eggs and larvae to prevent future infestations on cats  
**\*(S)-Methoprene {Must occur on same panel wherever InfestStop™ is used}**

#### **Prevention Claims**

Preventing fleas and deer ticks from infesting your cat/kitten is much easier than treating an  
existing problem  
Flea prevention has never been easier  
Prevents flea, deer tick, and mosquito infestations on cats  
Prevents flea recurrence on cats  
Control flea infestations on cats by preventing them  
Flea prevention on cats is the best flea control strategy  
Quick and sure flea, deer tick, and mosquito prevention for cats  
A quick and sure way to avert a flea problem is to [prevent it] use a preventative  
It is far easier to prevent fleas than to control them  
Flea control involves [requires] preventative measures [for your cat/kitten][and]  
[Year-round][Flea Treatment][Preventative]  
Use a flea preventative year-round (to prevent painful bites, itching and scratching, discomfort

#### **Application claims**

[#] pack [# days'] [#] doses [1/2/3/4/5/6] months supply  
One [tube][vial][cartridge] gives [1 month][4 weeks][30 days] of protection  
[Pre-measured][Convenient][and][&][No mess][easy][simple] to [use][handle][apply] disposable  
[tube][vial][cartridge]  
Convenient [and effective], once-a-month [liquid][topical][Spot On] solution  
Practical solution  
Simple choice [flea & deer tick control]  
A [One] simple application provides your cat/kitten with protection for up to [1 month]  
Apply to one spot for head to tail (total body) flea protection [control]  
Apply to 1 spot - spreads over the cat's/kitten's [entire] body [from head to tail] through [ordinary]  
[innate] [native] skin oils  
Spreads [over time] with cat's/kitten's [ordinary] [innate] skin oils  
[Plus] Contains a coat conditioner  
[Once][One] Monthly Application  
Easy to use [once] monthly application [liquid] prevents [and controls] fleas [& deer ticks]  
Reapply [Repeat] [once] monthly



Repeat [treatment] every month  
Monthly Control [Relief][treatment]

### **Applicator Claims**

Unique shape [for cats & kittens 5 lbs and over] [for cats & kittens over 2.5 lbs and under 5 lbs] and 12 weeks of age or older.  
[Exclusive][Pinpoint][Applicator] for [pinpoint][exact][direct][easy][direct to skin] application  
For pinpoint accuracy  
Helps provide accurate dosing  
Provides just the right dose [in just the right place]  
Direct to your cat's/kitten's skin  
Easily penetrates hair  
The [exclusive] [applicator] [easily penetrates hair][fur][coat] for [improved][direct] application [directly to your cat's/kitten's skin]  
Easy to apply [identify][use] applicator  
The right choice [applicator] for the right cat/kitten  
Make [Select] the right choice applicator  
Choice [selection] is simple  
Easy choice  
Simple choice delivery system  
Easy to use applicator [provides direct on-animal protection]  
EZ-squeeze [Easy squeeze] applicator  
Contemporary design  
[brand name] Applicator [helps to] prevent getting liquid on [your] hands  
[brand name] Applicator tip parts hair to help [liquid][application] get down to [the][your][cat's/kitten's] skin  
Ergonomically contoured [ergonomic][shape][design] for easy handling [ease of use] [easy use]  
For use with [only][brand name][disposable][liquid dispensing] [tubes] [vials] [cartridges]  
[brand name] [applicator][has][provides][allows for][delivers] better grip  
[brand name][provides] re-closable [re-sealable] packaging for [easy] storage  
Closing [the][brand name applicator] door automatically opens the [disposable][liquid dispensing] [tube] [vial][cartridge]  
[Includes] unique [brand][applicator]  
Puts the liquid on your cat/kitten - not your hands  
Directs the liquid onto your cat/kitten - not your hands [away from your hands]  
Applies liquid to your cat's/kitten's skin - not yours  
Helps prevent applying the wrong spot-on [dose] [product] on [to] the wrong pet  
A more confident, secure application  
Convenient, easy to use ACCU-TIP [Applicator]  
Will not drip after opening  
[Easy to use] Longer applicator tip for easy application to long-haired cats  
Longer applicator tip is ideal for long-haired cats/kittens

### **Thermoform claims**

[disposable] [liquid dispensing] [tube] [cartridge][vial]  
[brand name][disposable][liquid dispensing] [tube][vial][cartridge] tip [helps][to] spread out liquid [on your][cat/kitten]  
Unique [cartridge] [tube][vial] with flow control  
[no mess][application][tube][cartridge][vial]

### **Promotional Package Copy**

One month free  
One free month supply included  
Bonus pack  
Free [applicator device ] [tube][vial][cartridge]][inside]  
For use with [brand] applicator  
Applicator [device] not included  
[brand] Refill Pack [brand][applicator [device] not included]

**Refill Claims**

For use [only] with [brand name][Applicator]  
[1][3][4][6] monthly treatments) [1][3][4][6] Months Supply [24][48] doses  
Easy to use [convenient] refills  
[Can be used with][Use with][Brand Name applicator  
[Brand Name applicator [Refills][Refill Pack]  
Refill Pack [for][Brand Name] applicator  
Refills [Refill Pack] available

**Product Claims**

Odorless  
Effective Control [Relief][Prevention]  
Starts working by contact  
Dual-action for immediate and long-lasting effects  
[Flea prevention] Helps stop itching and scratching [from flea bites]

**Brand Claims**

[Brand] protecting pets for over 30 years  
We (Brand) put(s) your cat(s) first  
Brand...putting [your cat] cats first  
Smarter Pet Care  
Right choice = best defense  
Perfect choice  
Brand – caring & committed  
Brand makes the choice simple