



UNITED STATES ENVIRONMENTAL PROTECTION AGENCY  
WASHINGTON, DC 20460

OFFICE OF CHEMICAL SAFETY  
AND POLLUTION PREVENTION

January 9, 2015

James McFadden, Ph.D.  
Wellmark International  
1501 Woodfield Road, Suite 200 West  
Schaumburg, IL 60173

Subject: Label Amendment – Add Brown Dog Tick Nymphs and Larvae Claims  
Product Name: RF2164 A/T Combo  
EPA Registration Number: 2724-811  
Application Date: August 18, 2014  
Decision Number: 494848

Dear Dr. McFadden:

The amended label referred to above, submitted in connection with registration under the Federal Insecticide, Fungicide and Rodenticide Act, as amended, is acceptable. This approval does not affect any conditions that were previously imposed on this registration. You continue to be subject to existing conditions on your registration and any deadlines connected with them.

A stamped copy of your labeling is enclosed for your records. This labeling supersedes all previously accepted labeling. You must submit one copy of the final printed labeling before you release the product for shipment with the new labeling. In accordance with 40 CFR 152.130(c), you may distribute or sell this product under the previously approved labeling for 18 months from the date of this letter. After 18 months, you may only distribute or sell this product if it bears this new revised labeling or subsequently approved labeling. "To distribute or sell" is defined under FIFRA section 2(gg) and its implementing regulation at 40 CFR 152.3.

Should you wish to add/retain a reference to the company's website on your label, then please be aware that the website becomes labeling under the Federal Insecticide Fungicide and Rodenticide Act and is subject to review by the Agency. If the website is false or misleading, the product would be misbranded and unlawful to sell or distribute under FIFRA section 12(a)(1)(E). 40 CFR 156.10(a)(5) list examples of statements EPA may consider false or misleading. In addition, regardless of whether a website is referenced on your product's label, claims made on the website may not substantially differ from those claims approved through the registration process. Therefore, should the Agency find or if it is brought to our attention that a website contains false or misleading statements or claims substantially differing from the EPA approved registration, the website will be referred to the EPA's Office of Enforcement and Compliance.

Your release for shipment of the product constitutes acceptance of these conditions. If these conditions are not complied with, the registration will be subject to cancellation in accordance

Page 2 of 2  
EPA Reg. No. 2724-811  
Decision No. 494848

with FIFRA section 6. If you have any questions, please contact Maggie Rudick by phone at 703-347-0257, or via email at [rudick.maggie@epa.gov](mailto:rudick.maggie@epa.gov).

Sincerely,

A handwritten signature in black ink, appearing to be 'KBD', enclosed within a hand-drawn oval.

Kable Bo Davis, Product Manager 3  
Invertebrate & Vertebrate Branch 1  
Registration Division (7505P)  
Office of Pesticide Programs

Enclosure

# RF2164 A/T COMBO

Alternate brand name: Vet-Kem® Ovitrol® X-Tend™ Flea & Tick Spot On® for Dogs  
(Toy 6-12 lbs., Small 13-31 lbs., Medium 32-55 lbs., Large 56-80 lbs.,  
Extra Large 81 lbs. and over)

[Include "Dog" in product name and the Text for "Dog" must be at least 75% of the largest letter in the Brand Name]

**Front Panel - For Use ONLY on Toy (6-12 lbs.), Small (13-31 lbs.), Medium (32-55 lbs.), Large (56 - 80 lbs.), and Extra Large (81 lbs. and over) Dogs/Puppies (10 Weeks of age or older)**

**Front Panel - For Use ONLY on Dogs (Over 6 lbs) & Puppies (10 Weeks of age or older )**

**[Flea & Tick [& Mosquito][Treatment] [and] Control]**

**Spot-On Flea & Tick Control ONLY for Dogs (Over 6 lbs) & Puppies (10 Weeks of age or older)**

## General Claims:

5 size categories provide [smaller] weight ranges to improve [maintain][deliver] efficacy [performance][flea and tick][control][protection] on [for] your dog/puppy

Effective on indoor and outdoor dogs/puppies

([1][3][4][6] monthly treatments) [1][3][4][6] Months Supply [24][48] doses

Spreads with dog's/puppy's movement (skin and hair oils)

[Formula][Contains lanolin for coat conditioning]

[Water Resistant] [to keep killing fleas and ticks in humid and wet conditions]

[Fast Acting][Long Lasting][Kills Fleas and Ticks by Contact]

[Fresh][Clean][Scent][Smell]

[Reapply monthly] [Suitable for year-round use][Month] sticker for home calendar

[Satisfaction guaranteed or your money back]

[Patent Pending]

[Can be used in households with dogs and cats]

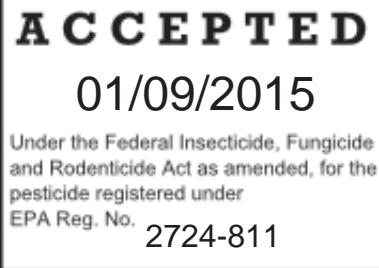

## Efficacy Claims:

Each tube [cartridge][vial] [application] [kills fleas & ticks for 3 weeks] and [kills and repels mosquitoes for 3 to 4 weeks]

[Protects for up to [Four/4] Weeks][One month][Four/4 Week [Flea][Tick][Mosquito] Treatment]

[Controls fleas, ticks and mosquitoes for up to one month][Monthly treatment for control of fleas, ticks and mosquitoes]

[Aids in Control of Ticks for up to 30 days]

[Starts Killing Fleas and Ticks within 15 minutes]

[Dual Action kills adult fleas and prevents flea development]

[Kills fleas, ticks, mosquitoes, flea eggs and flea larvae] [Dual protection (against fleas and ticks)]

(Indicated) for the treatment of adult ticks, tick nymphs and tick larvae of the *Rhipicephalus sanguineus* (Brown dog tick) which (can)(may) (carry)(transmit) Rocky Mountain Spotted Fever and Canine Ehrlichiosis.

(Indicated) for the treatment and control of adult fleas, flea eggs, flea larvae, ticks, brown dog tick nymphs, brown dog tick larvae (immature ticks), and mosquitoes in dogs 10 weeks of age and older

Kills fleas, flea eggs, flea larvae, ticks, brown dog tick nymphs, brown dog tick larvae (immature ticks), and mosquitoes

Kills (Brown dog) [tick nymphs][and][kills][tick larvae][to prevent them from growing up into (biting, breeding) adults

Kills all stages of the (flea) (and) (tick) life cycle(s)

Breaks the (flea) (and) (tick) life cycle(s)

Kills all biting stages of (brown dog) ticks

Kills [brown dog tick nymphs][and][kills][brown dog tick larvae]

Kills adult (brown dog) ticks, nymphs and larvae

Kills the Deer Tick, which may transmit Lyme Disease

Kills and Repels mosquitoes (the major carrier of canine heartworm)

Monthly application for most effective protection

### IGR Claims:

[Contains [InfestStop™] an Insect Growth Regulator (IGR) to kill flea eggs and prevent flea development for [] up to [75 days][10 weeks][2.5 months]]

[Contains [InfestStop™] [an Insect Growth Regulator (IGR) to kill flea eggs and larvae]

[Breaks Flea Life Cycle for up to [75 days][10 weeks][2.5 months]

An important step in breaking the flea life cycle

[Controls flea reinfestation for [] up to [75 days][10 weeks][2.5 months]

[With [InfestStop™][S-Methoprene] Insect Growth Regulator [IGR] to Break Flea Life Cycle]

InfestStop/Infestop™ logo

Plus[[Contains][With] PRECOR® [vIGRen®][S-Methoprene][\*InfestStop™], the first insect growth regulator for flea control

[(S)-Methoprene][\*InfestStop™] Insect Growth Regulator (IGR) interrupts the development of the flea life cycle [at the egg stage]

[(S)-Methoprene][\*InfestStop™] Insect Growth Regulator (IGR) prevents the development of flea eggs into adult fleas and [inhibits the development of flea eggs into adult fleas]

Flea control for dogs with PRECOR® [vIGRen®][\*InfestStop™] Insect Growth Regulator (IGR)

[Kills][Prevents][Keeps] flea eggs from hatching for up to [75 days][2.5 months][10 weeks]

**\*(S)-Methoprene (Must occur on same panel wherever \*InfestStop™ is used)**

### Applicator Claims

Contemporary design

[brand name] [Applicator] helps to prevent getting liquid on [your] hands

[brand name] [Applicator] tip parts hair to help [liquid][application] get down to [the][your][dog's/puppy's] skin

Ergonomically contoured [ergonomic][shape][design] for easy handling [ease of use] [easy use]

For use with [only][brand name][disposable][liquid dispensing] tubes [pods] [vials] [cartridges]

[brand name] [applicator][has][provides][allows for][delivers] better grip

[brand name][provides] re-closable [re-sealable] packaging for [easy] storage

Closing [the][brand name][applicator] door automatically opens the [disposable][liquid dispensing] tube [pod][vial][cartridge]

[brand name] [Applicator] [will not drip after opening]

[brand name] [Applicator] Won't drip when set down as you go fetch the [your] dog/puppy

Includes unique [brand] applicator

Puts the liquid on your dog/puppy – not your hands

Directs the liquid onto your dog [/puppy] – not your hands

Directs the liquid onto your dog [/puppy] – away from your hands

Applies liquid to your dog's [/puppy's] skin – not yours

Helps prevent applying the wrong spot-on [dose] [product] on [to] the wrong pet

Convenient, easy to use ACCU-TIP [Applicator] [DISPENSER]

[Easy to use] Longer applicator tip for easy application to long-haired dogs/puppies

### Thermoform claims

[disposable][liquid dispensing] tube [cartridge][vial][pod]

(Note tube/vial/cartridge/pod used interchangeably)

[brand name][disposable][liquid dispensing] [tube][vial][pod] tip [helps][to] spread out liquid [on your][dog/puppy]

Unique [cartridge] [tube][vial][pod] with flow control

[no drip][no mess][application][tube][cartridge][vial][pod]

### Promotional Package Copy

One month [dose] free

One free month supply [dose] included

Bonus pack

Free [applicator][tube][vial][cartridge][pod][inside]

Designed not to drip when set on top of the counter, or table, or other flat surface.

For use with [brand] applicator

Applicator [device] not included

[brand] Refill Pack [brand][applicator [device] not included]

**Refill Claims**

For use [only] with [brand name][Applicator]  
([1][3][4][6] monthly treatments) [1][3][4][6] Months Supply [24][48] doses  
Easy to use [convenient] refills  
[Can be used with] [Use with] [Brand Name] applicator  
[Brand Name (e.g., Adams or Bio Spot, Smart Shield)] [Applicator] [Refills][Refill Pack]  
[Refill Pack] [for][Brand Name] Applicator  
[tube][cartridge][vial][pod] refill pack [refills]  
Refills [Refill Pack] available  
[refill][tube][cartridge][vial][pod] design

**Applicator name options (applicator device is used in text)**

Applicator  
Tool  
Device  
Applicator Device  
Application Tool

**Thermoform name options (tube, cartridge and vial are used in the text)**

Ampoule  
Cartridge  
Packet  
Pod  
Refill  
Tube  
Vial

(Front panel)

**ACTIVE INGREDIENTS:**

Etofenprox (CAS # 80844-07-1) .....	30.0%
S-Methoprene (CAS # 65733-16-6) .....	3.6%
Piperonyl Butoxide (CAS # 51-03-6)* .....	5.0%
<b>OTHER INGREDIENTS:</b> .....	<b>61.4%</b>
<b>TOTAL</b>	<b>100.0%</b>

\*(butyl carbityl) (6-propylpiperonyl ether) and related compounds

**KEEP OUT OF REACH OF CHILDREN**

**CAUTION**

See Back Panel for Additional Precautionary Statements

**NET CONTENTS:**    One: 0.05 fl oz (1.5 cc) [vial][tube][cartridge] (Toy Dogs)/[and Puppies]  
0.10 fl oz (3.0 cc) [vial] [tube][cartridge] (Small Dogs)/[and Puppies]  
0.15 fl oz (4.5 cc) [vial][tube][cartridge] (Medium Dogs)/[and Puppies]  
0.20 fl oz (6.0 cc) [vial][tube][cartridge] (Large Dogs)/[and Puppies]  
0.30 fl oz (9.0 cc) [vial][tube][cartridge] (Extra Large Dogs)[and Puppies]

EPA Reg. No. 2724-811  
EPA Est. No.  
Lot/Batch No.:



Minimum of 1.5 cm X 1.5 cm

## SUBLABEL A – APPLICATOR DEVICE PACKAGE

### 1. DIRECTIONS FOR USE WITH APPLICATOR RF2164 A/T COMBO

#### [Back Panel]

[RF2164 A/T COMBO] prevents flea eggs from developing into adult fleas [] for up to [75 days][10 weeks][2.5 months]. RF2164 A/T COMBO also kills fleas and ticks for 3 weeks and kills and repels mosquitoes for 3 to 4 weeks.]

Effective flea & tick control for your dog/puppy.

[brand] provides flea and tick protection for dogs/puppies for up to 30-days – and protection from flea reinfestation for up to [75 days][10 weeks][2.5 months] . That’s because it doesn’t just kill adult fleas and ticks, it also prevents reinfestation by knocking out flea eggs and larvae that could hatch later on. Plus, it kills and repels mosquitoes.

A unique, convenient applicator for you. The [brand] Applicator is specially designed to make applying flea and tick control easier, more precise -- and neater – than ever before. You simply insert the appropriate [brand] tube [vial][cartridge] for your dog/puppy into the applicator, close it and squeeze to apply. The applicator’s ergonomic, contoured shape [design] makes it easy to grip and a built-in fin [tip] [comb] helps to spread [part] the [your] dog’s/puppy’s hair to allow the liquid to more readily [better] reach [apply] the [to] [your dog’s/puppy’s] skin. The tube [vial][cartridge] is sealed inside, so you can be confident that the liquid goes onto your dog/puppy – and not your hand. Plus, if the applicator is laid down on a table, counter or other flat surface, it won’t run out or drip.

**DIRECTIONS FOR USE:** It is a violation of Federal Law to use this product in a manner inconsistent with its labeling. **IMPORTANT! READ ENTIRE LABEL BEFORE EACH USE. FOR USE ONLY ON DOGS/PUPPIES (10 WEEKS OF AGE OR OLDER) DO NOT USE ON OTHER ANIMALS!** Read and follow all directions and precautions on this product label. [If you choose to apply directly to dog without using the applicator device, read and follow the Directions for Use For Direct Application to Dog on this package.]

#### **USE RESTRICTIONS**

THIS PRODUCT IS FOR INDOOR USE ONLY.

Do Not Allow Children to Apply this Product.

Do not apply this product to puppies less than 10 weeks of age, and do not apply this product to other animals!

Do not apply this product to dogs/puppies weighing less than 6 lbs. (for smallest size dog package only)

Do not allow your dog/puppy to ingest this product.

Apply this product once every 30 days unless a retreatment is necessary. Do not make the repeat retreatment sooner than 8 days following the initial treatment. Do not use more than one tube [vial][cartridge] per dog/puppy and do not retreat more than once per month.

RF2164 A/T COMBO works by application directly to the dog’s/puppy’s skin, not to the hair. When applying, use applicator device tip to push aside dog’s/puppy’s hair to allow direct application to the skin. Do not get this product in dog’s/puppy’s eyes or mouth.

[(Note: Application now assumes one tube[vial][cartridge] per dog/puppy per application)]

The RF2164 A/T COMBO provides a unique applicator device that allows dog/puppy owners to treat their dogs/puppies more securely, and dispose of liquid cartridges [tubes][vials]with less mess.

[Note: Each package contains sufficient cartridges/tubes/vials for [X] applications]

**[DFU Set No. 1]**

**FOR USE ONLY ON [TOY] (OVER 6 LBS) [SMALL][MEDIUM] DOGS/PUPPIES (10 WEEKS OF AGE OR OLDER)**

**To apply the [RF2164 A/T COMBO] treatment, use one disposable liquid cartridge [tube][vial][for each application] with the applicator device.**

1. OPEN [icon]

Use finger scoop to lift open [color, e.g. green] door.

2. LOAD [icon] (2 alternate statements)

-[To Load, place tube [cartridge][vial] white side up into the open applicator with front of tube placed under tab on door]

-[To Load, place tube [cartridge][vial] white side up into the [open] applicator with tip end of tube placed under [color][U-shaped] tab on door]

[Ensure that tube [cartridge][vial] fits securely in the applicator.]

3. CLOSE [icon]

Gently close the [color, e.g. green] door [and] the tube will snap open.

4. APPLY [icon]

The dog/puppy should be standing for easy application. To apply, use [front edge of applicator] [tip] to part hair and get next to dog's/puppy's skin. Press [circle] [[round] thumb pad] on [color-green] door [number-once] at each of [two] (Toy dogs (Over 6 lbs) or puppies(10 weeks of Age or Older) [three] (Small Dogs/puppies (10 weeks of Age or Older) (Medium dogs/puppies (10 weeks of Age or Older) evenly placed spots between the shoulder to the base of the tail. Do not apply an excessive amount of the solution at any one spot that could cause some of the solution to run off the side of the dog/puppy. Do not spread RF2164 A/T COMBO by hand over the dog/puppy. Although the dog's/puppy's skin and hair oils will distribute the application over the entire dog/puppy, brushing the dog/puppy 12-24 hours after treatment will help to distribute the material over the skin.

5. DISPOSE [icon]

[When finished, hold applicator device over trash.] To dispose of empty tube, open [color, e.g. green] door and drop empty tube into trash or offer for recycling if available. [Close applicator device door and store in original package.]

[Note: Each package contains sufficient cartridges/tubes/vials for [X] applications]

**FOR USE ONLY ON [LARGE][EXTRA LARGE] DOGS/PUPPIES (10 WEEKS OF AGE OR OLDER)**

- 1 ...(same as above)
- 2 ... “ “
- 3 ... “ “
- 4 APPLY [icon]

The dog should be standing for easy application. To apply, use [front edge of applicator][tip] to part hair and get next to dog’s/puppy’s skin. Press [circle] [[round] thumb pad] on [color][green] door [number-once] at each of four or five evenly placed spots between the shoulder to the base of the tail.

Do not apply an excessive amount of the solution at any one spot that could cause some of the solution to run off the side of the dog/puppy. Do not spread RF2164 A/T COMBO by hand over the dog/puppy. Although the dog’s/puppy’s skin and hair oils will distribute the application over the entire dog/puppy, brushing the dog/puppy 12-24 hours after treatment will help to distribute the material over the skin.

- 5 ...(same as above)
- 6 ... “ “

[Note: Each package contains sufficient cartridges/tubes/vials for [X] applications]

RF2164 A/T COMBO is most effective when used as part of a total flea and tick management program. Use other [Brand Name ] products registered for residential area control of these pests in conjunction with this treatment. Monthly treatments are required for optimal control and prevention of fleas.

[The successive feeding activity of fleas on dogs/puppies may elicit a hypersensitivity skin disorder known as flea allergy dermatitis (FAD). Treatment of dogs/puppies with RF2164 A/T COMBO rapidly kills fleas and may reduce the incidence of this condition.] [RF2164 A/T COMBO is water resistant and remains efficacious following exposure to rainfall or swimming.]

[TREATMENT SCHEDULE			
Dosage: 1 [cartridge] [tube][vial] every 30 days per dog/puppy			
Dog’s/Puppy’s Name	First Treatment Date	Second Treatment Date (30 Days From 1 <sup>st</sup> )	Third Treatment Date (30 Days From 2 <sup>nd</sup> )

Reminder: I purchased RF2164 A/T COMBO from: \_\_\_\_\_

NOTES: \_\_\_\_\_

Treatment table can be expanded based on package size. (6 months)]

**STORAGE and DISPOSAL: Pesticide Storage:** Keep this product in its tightly closed original container when not in use. Store in a cool, dry (preferably locked) area that is inaccessible to children and animals. Liquid Cartridge [vial][tube] **Container Disposal: If empty:** Do not reuse cartridge [vial] [tube]. Place in trash or offer for recycling if available. **If partially filled:** Call your local solid waste agency for disposal instructions. Never place unused product down any indoor or outdoor drain.



## PRECAUTIONARY STATEMENTS

### HAZARDS TO HUMANS AND DOMESTIC ANIMALS - CAUTION

**DO NOT USE ON DOGS LESS THAN 6 LBS OR PUPPIES LESS THAN 10 WEEKS OF AGE.** For external use only. Causes moderate eye irritation. Avoid contact with eyes or clothing. Wash hands thoroughly with soap and water after handling and before eating, drinking, chewing gum, using tobacco, or using the toilet. Repeated exposure to etofenprox can cause skin irritation. Consult a veterinarian before using this product on debilitated, aged, pregnant, nursing, or animals on medication. Sensitivities may occur after using ANY pesticide product for pets. If signs of sensitivity occur, bathe your dog/puppy with mild soap and rinse with large amounts of water. If signs continue, consult a veterinarian immediately.

Some dogs/puppies may experience hair loss or temporary skin irritation at the application site. If signs persist or become more severe, contact veterinarian immediately and report incident to company at 1-800-XXX-XXXX.

FIRST AID	
If in eyes	<ul style="list-style-type: none"><li>• Hold eye open and rinse slowly and gently with water for 15-20 minutes.</li><li>• Remove contact lenses, if present, after first 5 minutes, then continue rinsing</li><li>• Call a poison control center or doctor for treatment advice.</li></ul>
<b>HOT LINE NUMBER:</b> Have the product container or label with you when calling a poison control center or doctor or going for treatment. For additional information on this pesticide product (including health concerns, medical emergencies or pesticide incidents), you may also call 1-800-XXX-XXXX 24 hours/day, 7 days/week.	

### WARRANTY AND CONDITIONS OF SALE:

Seller warrants that this product conforms to the chemical specifications expressed on the label. To the extent consistent with applicable law, Seller makes no other warranties, and disclaims all other warranties, express or implied, including but not limited to warranties of merchantability and fitness for the intended purpose. To the extent consistent with applicable law, seller's liability for default, breach, or failure under this label shall be limited to the amount of the purchase price. To the extent consistent with applicable law, Seller shall have no liability for consequential damages.

In case of emergency or for product information, call 1-800-xxx-xxxx or contact your veterinarian if your pet is experiencing an adverse event.

Wellmark International  
1501 E. Woodfield Road. 200W  
Schaumburg, Illinois 60173  
**[zodiacpet.com]**  
Made in USA

**Side Effects:** Monitor your dog after application. Side effects may include signs of skin irritation such as redness, scratching, or other signs of discomfort. Gastrointestinal signs such as vomiting or diarrhea have also been reported. If these or other side effects occur, consult your veterinarian or [Brand name] at [phone number].

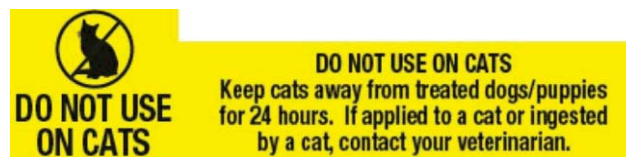

TEXT FOR LIQUID TUBE/CARTRIDGE/VIAL

Product name

Etofenprox 30%, (S)-Methoprene 3.6%, Piperonyl Butoxide 5%

KEEP OUT OF REACH OF CHILDREN

CAUTION

READ DIRECTIONS BEFORE USING

EPA Reg. No. 2724-811

Net Contents



**DO NOT USE  
ON CATS**

**For Use Only on Toy (6-12 lbs.), Small (13-31 lbs.), Medium (32-55 lbs.), Large (56 -80 lbs.), and Extra Large (81 lbs. and over) Dogs/Puppies (10 Weeks of age or older)**

Alternate Sets of ICONS for the RF2164 A/T COMBO

**[ICON SET 1]**

**[OPEN]**

**[LOAD]**

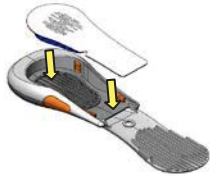

**[CLOSE]**



**[APPLY]**



**[DISPOSE]**



[ICON SET 2] ALTERNATE ICONS FOR DIRECTIONS FOR USE (will be specific to dog's/puppy's size)

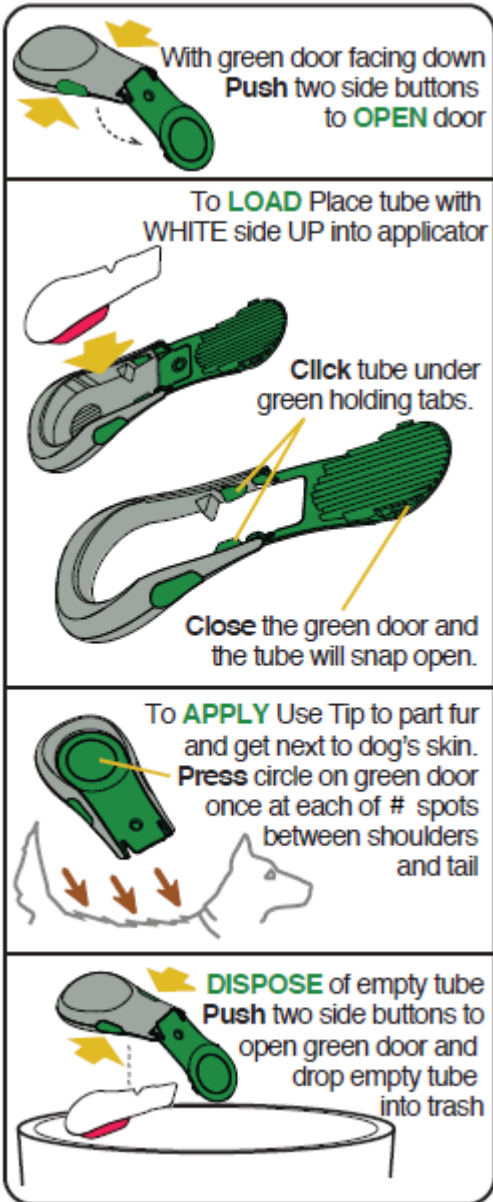

("#Spots" is a variable dependent on size)  
Door color may change based on brand.  
(Alternate LOAD icon)

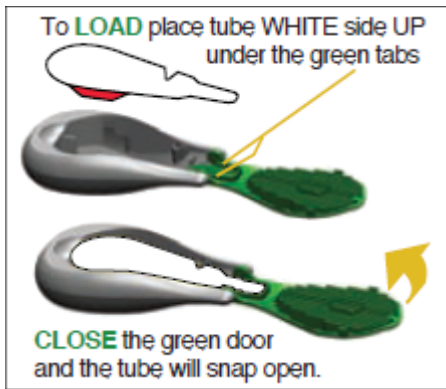

[ICON SET 3] ALTERNATE ICONS FOR DIRECTIONS FOR USE (will be specific to dog's/puppy's size)



(“#Spots” is a variable dependent on size)  
 Door color may change based on brand.

## 2. DIRECTIONS FOR USE FOR DIRECT APPLICATION TO DOG/PUPPY

### USE RESTRICTIONS

THIS PRODUCT IS FOR INDOOR USE ONLY.

Do Not Allow Children to Apply this Product.

Do not apply this product to puppies less than 10 weeks of age, and do not apply this product to other animals!

Do not apply this product to dogs/puppies weighing less than 6 lbs. (for smallest size dog package only)

Do not allow your dog/puppy to ingest this product.

Apply this product once every 30 days unless a retreatment is necessary. Do not make the repeat retreatment sooner than 8 days following the initial treatment. Do not use more than one tube [vial][cartridge] per dog/puppy and do not retreat more than once per month.

RF2164 A/T COMBO works by application directly to the dog's/puppy's skin, not to the hair. When applying, manually push aside dog's/puppy's hair to allow direct application to the skin. Do not get this product in dog's/puppy's eyes or mouth.

[(Note: Application assumes one applicator per animal per application)]

[Note: Each package contains sufficient tubes/applicators for [X] applications]

### FOR USE ONLY ON [TOY] (OVER 6 LBS)[SMALL][MEDIUM] DOGS/PUPPIES (10 WEEKS OF AGE OR OLDER)

1. [Bend at perforation and tear off first applicator [tube].]
2. [Hold applicator [tube][and bend area of plastic at perforation, tear off and discard.]] Hold applicator [tube] upright and snap tip back, away from face and body.
3. The dog/puppy should be standing for easy application. Apply RF2164 A/T COMBO evenly to [two spots](toy dogs (over 6 lbs) or puppies (10 weeks of age or older))[three spots](small or medium dogs/puppies (10 weeks of age or older)) on the top of the back from the shoulder to the base of the tail. At each spot, part the hair until the skin is visible. Place the tip of the tube on the skin and gently squeeze to expel a portion of the solution on the skin. Do not apply an excessive amount of the solution at any one spot that could cause some of the solution to run off the side of the dog/puppy.
4. Do not spread RF2164 A/T COMBO by hand over the dog/puppy. Although the dog's/puppy's skin and hair oils will distribute the application over the entire dog/puppy, brushing the dog/puppy 12-24 hours after application will help to distribute the material over the skin..
5. Discard empty [tube][applicator] as described in Storage and Disposal
6. Do not reapply product for 30 days unless re-treatment is required, but not sooner than 8 days following the initial treatment. Do not retreat more than once per month.

[Note: Each package contains sufficient tubes/applicators for [X] applications]

## OPTIONAL GRAPHICS

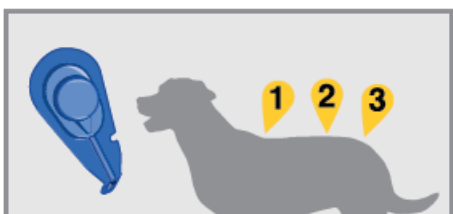
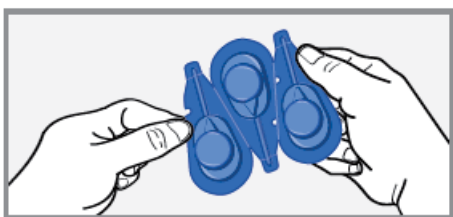

# of spots is a variable dependent on dog size

### **FOR USE ONLY ON [LARGE][EXTRA LARGE] DOGS OR PUPPIES (10 WEEKS OF AGE OR OLDER)**

1. [Bend at perforation and tear off first applicator [tube].]
2. [Hold applicator [tube][and bend area of plastic at perforation, tear off and discard.]]  
Hold applicator [tube] upright and snap tip back, away from face and body
3. The dog/puppy should be standing for easy application. Apply RF2164 A/T COMBO evenly to four or five spots on the top of the back from the shoulder to the base of the tail. At each spot, part the hair until the skin is visible. Place the tip of the tube on the skin and gently squeeze to expel a portion of the solution on the skin. Do not apply an excessive amount of the solution at any one spot that could cause some of the solution to run off the side of the dog/puppy.
4. Do not spread RF2164 A/T COMBO by hand over the dog/puppy. Although the dog's/puppy's skin and hair oils will distribute the application over the entire dog/puppy, brushing the dog/puppy 12-24 hours after application will help to distribute the material over the skin..
5. Discard empty [tube][applicator] as described in Storage and Disposal
6. Do not reapply product for 30 days unless re-treatment is required, but not sooner than 8 days following the initial treatment. Do not retreat more than once per month.

OPTIONAL GRAPHICS

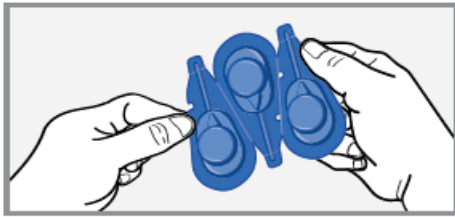

RF2164 A/T COMBO is most effective when used as part of a total flea and tick management program. Use other [Brand Name ] products registered for residential area control of these pests in conjunction with this treatment. Monthly treatments are required for optimal control and prevention of fleas.

[The successive feeding activity of fleas on dogs/puppies may elicit a hypersensitivity skin disorder known as flea allergy dermatitis (FAD). Treatment of dogs/puppies with RF2164 A/T COMBO rapidly kills fleas and may reduce the incidence of this condition.] [RF2164 A/T COMBO is water resistant and remains efficacious following exposure to rainfall or swimming.]

[TREATMENT SCHEDULE Dosage: 1 [cartridge] [tube][vial] every 30 days per dog/puppy			
Dog's/Puppy's Name	First Treatment Date	Second Treatment Date (30 Days From 1 <sup>st</sup> )	Third Treatment Date (30 Days From 2 <sup>nd</sup> )

Reminder: I purchased RF2164 A/T COMBO from: \_\_\_\_\_

NOTES: \_\_\_\_\_

Treatment table can be expanded based on package size. (6 months)]



**SUB-LABEL B FOR REFILLPACKAGE**

**(For use with applicator device or direct application to dog/puppy without applicator device)**

(Front Panel)

[Product Name]

[Include “Dog” in product name and theText for “Dog” must be at least 75% of the largest letter in Brand Name]

**Front Panel - For Use Only on Toy (6-12 lbs.), Small (13-31 lbs.), Medium (32-55 lbs.), Large (56 -80 lbs.), and Extra Large (81 lbs. and over) Dogs/Puppies (10 Weeks of age or older)**

[Flea & Tick [& Mosquito][Treatment] [and] Control]

**Spot-On Flea & Tick Control ONLY for Dogs (Over 6 lbs)/Puppies (10 Weeks of Age or Older)**

**ACTIVE INGREDIENTS:**

Etofenprox (CAS # 80844-07-1) .....30.0%

S-Methoprene (CAS # 65733-16-6) .....3.6%

Piperonyl Butoxide (CAS # 51-03-6)\* .....5.0%

**OTHER INGREDIENTS:** .....61.4%

**TOTAL** .....100.0%

\*(butyl carbityl) (6-propylpiperonyl ether) and related compounds

**KEEP OUT OF REACH OF CHILDREN**

**CAUTION**

See Back Panel for Additional Precautionary Statements

EPA Reg. No. 2724-811

EPA Est No.

**NET CONTENTS:**

One 0.05 fl oz (1.5 cc) [vial][tube][cartridge] (Toy Dogs (Over 6 lbs)/Puppies)(10 Weeks of Age or Older)

0.10 fl OZ (3.0 cc) [vial] [tube][cartridge] (Small Dogs/Puppies)/(10 Weeks of Age or Older)

0.15 fl oz (4.5 cc) [vial][tube][cartridge] (Medium Dogs/Puppies)/ (10 Weeks of Age or Older)

0.20 fl oz (6.0 cc) [vial][tube][cartridge] (Large Dogs/Puppies) (10 Weeks of Age or Older)

0.30 fl oz (9.0 cc) [vial][tube][cartridge] (Extra Large Dogs) (10 Weeks of Age or Older)



Minimum of 1.5 cm X 1.5 cm

**[Back Panel]**

[RF2164 A/T COMBO] prevents flea eggs from developing into adult fleas for up to [75 days][10 weeks][2.5 months]. RF2164 A/T COMBO also kills fleas and ticks for 3 weeks and kills and repels mosquitoes for 3 to 4 weeks.]

[Effective flea & tick control for your dog/puppy.  
[brand] provides flea and tick protection for dogs/puppies for up to 30-days – and protection from flea reinfestation for up to [75 days][10 weeks][2.5 months]. That’s because it doesn’t just kill adult fleas and ticks, it also prevents reinfestation by knocking out flea eggs and larvae that could hatch later on. Plus, it kills and repels mosquitoes.]

[Note: full directions for use to be used if space allows]

**DIRECTIONS FOR USE:** It is a violation of Federal Law to use this product in a manner inconsistent with its labeling. **IMPORTANT! READ ENTIRE LABEL BEFORE EACH USE. FOR USE ONLY ON DOGS (OVER 6 LBS) OR PUPPIES 10 WEEKS OF AGE OR OLDER. DO NOT USE ON OTHER ANIMALS!**

Read and follow all directions and precautions on this product label.

[To apply the RF2164 A/T COMBO treatment with the [Brand Name] applicator, use one disposable liquid cartridge [tube][vial][for each application] with the applicator device.]

[Remove one refill tube [cartridge][vial] from the package and insert into opened [brand name] applicator device. Make application according to label directions supplied with the [brand name] applicator device.] If you need directions for application, please call 1-800-XXX-XXXX.

[However, if you choose to apply directly to dog/puppy without using the applicator device, read and follow the Directions for Use For Direct Application to Dog /Puppy on this package.]

**(DIRECTIONS FOR USE FOR DIRECT APPLICATION TO DOG/PUPPY)**

**[USE RESTRICTIONS**

THIS PRODUCT IS FOR INDOOR USE ONLY.

Do Not Allow Children to Apply this Product.

Do not apply this product to puppies less than 10 weeks of age, and do not apply this product to other animals!

Do not apply to dogs/puppies weighing less than 6 lbs. (for smallest size dog package only)

Do not allow your dog/puppy to ingest this product.

Apply this product once every 30 days unless a retreatment is necessary. Do not make the retreatment sooner than 8 days following the initial treatment. Do not use more than one tube per dog/puppy and do not retreat more than once per month.

RF2164 A/T COMBO works by application directly to the dog’s/puppy’s skin, not to the hair. When applying, manually push aside dog’s/puppy’s hair to allow direct application to the skin. Do not get this product in dog’s/puppy’s eyes or mouth.

[(Note: Application assumes one applicator per animal per application)]

[Note: Each package contains sufficient tubes/applicators for [X] applications]

**FOR USE ONLY ON [TOY (OVER 6 LBS)][SMALL][MEDIUM] DOGS OR PUPPIES (10 WEEKS OF AGE OR OLDER)**

1. [Bend at perforation and tear off first applicator [tube].]
2. [Hold applicator [tube][and bend area of plastic at perforation, tear off and discard.]] Hold applicator [tube] upright and snap tip back, away from face and body.
3. The dog/puppy should be standing for easy application. Apply RF2164 A/T COMBO evenly to [two spots](toy dogs/puppies)[three spots](small or medium dogs/puppies) on the top of the back from the shoulder to the base of the tail. At each spot, part the hair until the skin is visible. Place the tip of the tube on the skin and gently squeeze to expel a portion of the solution on the skin. Do not apply an excessive amount of the solution at any one spot that could cause some of the solution to run off the side of the dog/puppy.
4. Do not spread RF2164 A/T COMBO by hand over the dog/puppy. Although the dog's/puppy's skin and hair oils will distribute the application over the entire dog/puppy, brushing the dog/puppy 12-24 hours after application will help to distribute the material over the skin.
5. Discard empty [tube][applicator] as described in Storage and Disposal
6. Do not reapply product for 30 days unless re-treatment is required, but not sooner than 8 days after the initial treatment. Do not retreat more than once per month.

[Note: Each package contains sufficient tubes/applicators for [X] applications]

OPTIONAL GRAPHICS

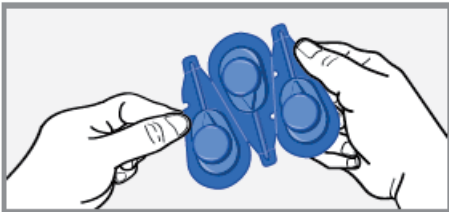

# of spots is a variable dependent on dog size

**FOR USE ONLY ON [LARGE][EXTRA LARGE] DOGS/PUPPIES (10 WEEKS OF AGE OR OLDER)**

1. [Bend at perforation and tear off first applicator [tube].]
2. [Hold applicator [tube][and bend area of plastic at perforation, tear off and discard.]]  
Hold applicator [tube] upright and snap tip back, away from face and body
3. The dog/puppy should be standing for easy application. Apply RF2164 A/T COMBO evenly to four or five spots on the top of the back from the shoulder to the base of the tail. At each spot, part the hair until the skin is visible. Place the tip of the tube on the skin and gently squeeze to expel a portion of the solution on the skin. Do not apply an excessive amount of the solution at any one spot that could cause some of the solution to run off the side of the dog/puppy.
4. Do not spread RF2164 A/T COMBO by hand over the dog/puppy. Although the dog's/puppy's skin and hair oils will distribute the application over the entire dog/puppy, brushing the dog/puppy 12-24 hours after application will help to distribute the material over the skin..
5. Discard empty [tube][applicator] as described in Storage and Disposal
6. Do not reapply product for 30 days unless re-treatment is required, but not sooner than 8 days after the initial treatment. Do not retreat more than once per month.

**OPTIONAL GRAPHICS**

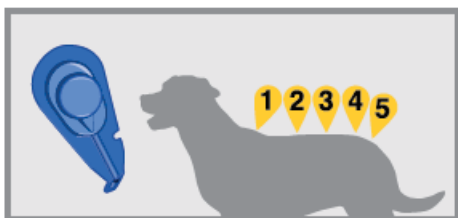

RF2164 A/T COMBO is most effective when used as part of a total flea and tick management program. Use other [Brand Name ] products registered for residential area control of these pests in conjunction with this treatment. Monthly treatments are required for optimal control and prevention of fleas.

[The successive feeding activity of fleas on dogs/puppies may elicit a hypersensitivity skin disorder known as flea allergy dermatitis (FAD). Treatment of dogs/puppies with RF2164 A/T COMBO rapidly kills fleas and may reduce the incidence of this condition.] [RF2164 A/T COMBO is water resistant and remains efficacious following exposure to rainfall or swimming.]

[TREATMENT SCHEDULE Dosage: 1 [cartridge] [tube][vial] every 30 days per dog/puppy			
Dog's/Puppy's Name	First Treatment Date	Second Treatment Date (30 Days From 1 <sup>st</sup> )	Third Treatment Date (30 Days From 2 <sup>nd</sup> )

Reminder: I purchased RF2164 A/T COMBO from: \_\_\_\_\_

NOTES: \_\_\_\_\_

Treatment table can be expanded based on package size. (6 months)]

**(Precautionary/First Aid and Storage/Disposal) text included)**

**WARRANTY AND CONDITIONS OF SALE:**

Seller warrants that this product conforms to the chemical specifications expressed on the label. To the extent consistent with applicable law, Seller makes no other warranties, and disclaims all other warranties, express or implied, including but not limited to warranties of merchantability and fitness for the intended purpose. To the extent consistent with applicable law, seller's liability for default, breach, or failure under this label shall be limited to the amount of the purchase price. To the extent consistent with applicable law, Seller shall have no liability for consequential damages.

In case of emergency or for product information, call 1-800-xxx-xxxx or contact your veterinarian if your pet is experiencing an adverse event.

Wellmark International  
1501 East Woodfield Road 200W  
Schaumburg, Illinois 60173  
**[zodiacpet.com]**

**Side Effects:** Monitor your dog after application. Side effects may include signs of skin irritation such as redness, scratching, or other signs of discomfort. Gastrointestinal signs such as vomiting or diarrhea have also been reported. If these or other side effects occur, consult your veterinarian or [Brand name] at [phone number].

