



UNITED STATES ENVIRONMENTAL PROTECTION AGENCY  
WASHINGTON, DC 20460

OFFICE OF CHEMICAL SAFETY  
AND POLLUTION PREVENTION

July 17, 2023

Amanda Burwell  
Biocide Registration Manager  
Stepan Company  
Electronic Transmittal: Amanda.burwell@stepan.com

Subject: PRIA Label Amendment – Adjusting organism contact times and other label edits  
Product Name: STEPAN DISINFECTANT WIPE  
EPA Registration Number: 1839-190  
Received Date: 12/13/2022  
Action Case Number: 00410422

Dear Amanda Burwell:

The amended label referred to above, submitted in connection with registration under the Federal Insecticide, Fungicide and Rodenticide Act, as amended, is acceptable. This approval does not affect any conditions that were previously imposed on this registration. You continue to be subject to existing conditions on your registration and any deadlines connected with them.

A stamped copy of your labeling is enclosed for your records. This labeling supersedes all previously accepted labeling. Pursuant to 40 CFR 156.10(a)(6), you must submit one copy of the final printed labeling before you release the product for shipment with the new labeling. In accordance with 40 CFR 152.130(c), you may distribute or sell this product under the previously approved labeling for 18 months from the date of this letter. After 18 months, you may only distribute or sell this product if it bears this new revised labeling or subsequently approved labeling. “To distribute or sell” is defined under FIFRA section 2(gg) and its implementing regulation at 40 CFR 152.3.

Should you wish to add/retain a reference to the company’s website on your label, then please be aware that the website becomes labeling under FIFRA and is subject to review by the Agency. See FIFRA section 2(p)(2). If the website is false or misleading, the product would be misbranded and unlawful to sell or distribute under FIFRA section 12(a)(1)(E). 40 CFR 156.10(a)(5) lists examples of statements EPA may consider false or misleading. In addition, regardless of whether a website is referenced on your product’s label, claims made on the website may not substantially differ from those claims approved through the registration process, FIFRA section 12(a)(1)(B). Therefore, should the Agency find or if it is brought to our attention that a website contains false or misleading statements or claims substantially differing from the EPA approved registration, the website will be referred to the EPA’s Office of Enforcement and Assurance.

Your release for shipment of the product constitutes acceptance of these conditions. If these conditions are not complied with, the registration will be subject to cancellation in accordance

Page 2 of 2  
EPA Reg. No. 1839-190  
Action Case No. 00410422

with FIFRA section 6. If you have any questions, please contact Carlos Corona via email at [Corona.Carlos@epa.gov](mailto:Corona.Carlos@epa.gov).

Sincerely,

A handwritten signature in black ink that reads "Tara M. Flint Silva". The signature is written in a cursive, flowing style.

Tara Flint Silva, Acting Product Manager 31  
Regulatory Management Branch I  
Antimicrobials Division  
Office of Pesticide Programs

# STEPAN<sup>®</sup> DISINFECTANT WIPE

## FRONT PANEL

### ACTIVE INGREDIENTS

Alkyl (60% C <sub>14</sub> , 30% C <sub>16</sub> , 5% C <sub>12</sub> , 5% C <sub>18</sub> ) dimethyl benzyl ammonium chlorides .....	0.14%
Alkyl (68% C <sub>12</sub> , 32% C <sub>14</sub> ) dimethyl ethylbenzyl ammonium chlorides .....	0.14%
<b>INERT INGREDIENTS</b> .....	<u>99.72%</u>
Total	100.00%

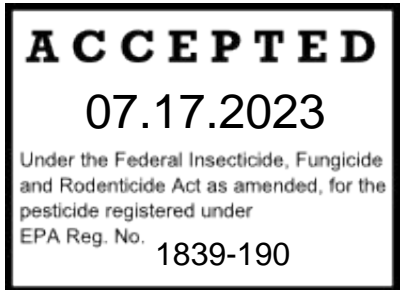

**KEEP OUT OF REACH OF CHILDREN**

## CAUTION

See (side)(back)(panel)(additional)(inside)(booklet)(insert)(outer container) for (additional) (precautionary statements) (and)(or) (first aid statements) (and)(or) (directions for use).

EPA REG. NO. 1839-190

EPA EST. NO. (as indicated on container)

(Beginning of) (batch) (lot) code indicates EPA (Est.) (Establishment) (#) (No.) (Number)

### STEPAN COMPANY

1101 Skokie Blvd

Northbrook, IL 60062

NET CONTENTS: X lbs. X ozs. (minimum wt. X lbs. X ozs.)

*(mandatory: must be expressed in avoirdupois pounds and ounces)*

*Optional: can also express as total count and size*

X (Pre-measured) (Pre-moistened) (Wipes) (Towelettes) (Cloths) (X)" x (X)"  
(e.g. 40 Pre-measured Wipes (7" x 8") (18cm x 20cm)

X (Pre-measured) Single Use (Pre-Moistened) (Wipes) (Towelettes) (Cloths) (X)" x (X)"  
(e.g. 40 Pre-measured Single Use Towelettes (7" x 8") (18cm x 20cm)

### PRECAUTIONARY STATEMENTS

Hazards to Humans and Domestic Animals

**CAUTION:** Causes moderate eye irritation. Avoid contact with eyes or clothing. Wash thoroughly with soap and water after handling.

#### FIRST AID

Have the product container or label with you when calling a poison control center or doctor, or going for treatment.

**IF IN EYES:** Hold eyes open and rinse slowly and gently with water for 15–20 minutes. Remove contact lenses if present, after the first 5 minutes, then continue rinsing. Call a poison control center or doctor for treatment advice.

**(Optional)** You may contact XXX/XXX-XXXX for emergency medical treatment information.

(page 1 of 22)

Bracketed information is denoted as: {insert as noted }, ( optional text ), [ required qualifier ].  
The term "this product" used throughout this document may be replaced with the marketed product brand name.  
The term "x" is a place holder for numerical digits.  
Punctuation and plural/singular word forms may be adjusted to allow for grammatical correctness.  
Appropriate metric or imperial unit may be added as optional, supplemental information.

Amended 07/13/2023

# **(Non-Public Health) MARKETING CLAIMS**

*{Note to reviewer: Marketing claims may appear anywhere on the label}*

## **General**

- (ORANGE)(LEMON)(FRESH)(SOAP)(CITRUS)(SCENTED)(SCENT)
- (Is not abrasive to) (Will not scratch) (and) (or) (bleach) (strip color from) (Will not bleach) (Will not strip color from) treated surfaces
- LitePak™ (can)(canister), uses (X)% less (material) (plastic) than (previously used can) (other)(most) cans of this size!
- LitePak™ (can) (cans) (canister) (container) = (equals) less packaging (than most containers of this size) (than most cans of this size)!
- Non-Bleaching to surfaces
- Convenient flip top lid
- Convenient wipes
- Disposable cloth wipes
- Easy convenient dispensing
- Easy to use
- Easy to use package (canister) to keep your wipes moist
- Effective daily use
- Eliminates odors
- Just pull, wipe and toss for cleaning (performance)
- Lint-free
- Use a (low-linting) (*{Note to reviewer: Insert other substrate material type as appropriate}*) (wipe)(cloth) for each area (or)(task)
- Made with scrubbing fibers
- Non-scratching wipe
- Non-woven disposable (wipes) (cloths) (towelettes)
- Pre-moistened (wipe) (towel) (towelette) (cloth)
- Ready to use (R-T-U) wipes
- Saves time
- Strong wipe for tough cleaning jobs
- Use every day in every room (throughout the house)
- (This product or product name) is intended (is designed) for use in: *{insert use sites from use site table}* (and more)
- Designed (formulated) for (homes) (vehicles) (autos) (and) (offices).
- *{Note to reviewer: The following may only be used to identify a specific retailer (who is not the producer or supplemental distributor):}* (Sold at)(Sold exclusively at)(Available at)(Available exclusively at) *[insert retailer name and information]*. *{Brand graphics for the retailer may be added for only identified parties.}*
- easy reach-in dispensing
- easy to (carry) (use) around the house
- easy to store (can) (canister)
- convenient (can) (canister) storage
- one side to scrub, the other side to wipe(!)
- uses [x]% less plastic than other (cans) (canisters) (in the market)
- uses [x]% less packaging than (multipacks with trays) (traditional multipacks of) similar products
- uses [x]% recycled materials in the packaging
- packaging made from [x]% renewable resources
- LitePak™ is a trademark of Alltrista Plastics, LLC, dba Jarden Plastic Solutions
- (Uses) (X%) less (material) (plastic) (packaging) than (other) (similar size) (cans) (containers) (packages) (in the market)
- Bonus pack (!)
- Bonus size (!)
- (x) wipes (trial) (travel) pack (included)
- (Larger) (bigger) (thicker) (textured) (size) (sheet) (wipe) (cloth)
- (Improved) (better) dispensing
- Package is 100% recyclable
- This product takes a step by using up to 30% less packaging in the canister than previous product's package

*(page 2 of 22)*

*Amended 07/13/2023*

Bracketed information is denoted as: *{insert as noted}*, *( optional text )*, *[ required qualifier ]*.

The term "this product" used throughout this document may be replaced with the marketed product brand name.

The term "x" is a place holder for numerical digits.

Punctuation and plural/singular word forms may be adjusted to allow for grammatical correctness.

Appropriate metric or imperial unit may be added as optional, supplemental information.

- This product takes a step by using up to 30% less packaging than previous product's package. This means the packaging weight reduction is up to 30% compared to the previous [customer product name] packaging as measured by weight.
- Changing our environmental footprint® is registered in the United States Patent and Trademark Office to Rockline Industries, Inc.
- [X]% (more)(than)(wipes)(vs)(standard)(35, 40, 45, 60, 65, 70, 75, 80, 90, 100) count (pack)(canisters)
- Performance in a Pouch {Note to reviewer: this is a trademarked phrase and may only be used to support MDI branded product}
- Assembled in USA
- Assembled in America
- Convenience in a can
- Less (packaging)(plastic) to throw away!
- Remember to (buy)(pack) (take along)for (camping)(reunions)(social events)(back to school)(vacation)
- Easy Dispensing Package (!)
- Additional Optional Marketing Claims containing "new" to be used only for a period of six months after a product change, beginning when the change is first sold or distributed:
- New package!
- New (larger)(bigger)(thicker)(textured)(size)(sheet)(wipe)(cloth)!
- New (improved)(easy)(better) dispensing!
- New (!) {Note to reviewer: To be used only during the first 6 months of product launch}
- Use a new, (low-linting) ({Note to reviewer: Insert other substrate material type as appropriate}) (wipe)(cloth) for each area (or)(task)
- (Fragrance) (Perfume) (and) (dye) free {Note to reviewer: These claims should only be used with applicable formula}
- {NOTE TO REVIEWER: The following fruit icons/graphics can only be used with product that is lemon, orange or citrus scented.}



## **SUBSTRATE CONTENT CLAIMS**

{Note to reviewer: The following claims may only be used if the supplemental registrant or Stepan has documentation to support claims}

- (Substrate) (Wipe fabric) (Towelette fabric) (Cloth) made (of) (from) (minimum) (up to) (XX%) (regenerated) (recycled) (cellulose) (wood pulp) (plant based) (sources) (materials) (resources)
- (Wipe) [(Substrate) (Towelette fiber(s)) (Cloth)] Fiber(s) (are) (is) (made from) (contains) (regenerated) (recycled) (cellulose) (wood pulp) (plant based) (sources)
- Wipe [(fabric)(material)(substrate)] made from (minimum) (up to) (XX%) (wood pulp) (plant based) (ingredients) (fibers)
- Made with Lyocell® (the) (ultra-soft) (soft) (strong) (durable) (resource) (fiber)(s)
- (Material)(wipe fabric)(cloth)(towelette fabric) made from (X%) (compostable)(recycled) (wood pulp)(cotton)(cellulose) (polyester) fibers
- (Substrate)(Fabric){(Note to reviewer: Insert substrate material type as appropriate)} is made of strong fibers

## **Cleaning Claims**

- (CLEANER)(NEW)(QUICK)(EASY)(EFFECTIVE)(FAST EFFECTIVE)(CONVENIENT)
- ALL PURPOSE CLEANER
- Cleaning made easy for all your hard, non-porous surfaces
- Cleans and cuts grease
- Cleans tough stains
- Cleans with (just) one wipe

(page 3 of 22)

Amended 07/13/2023

Bracketed information is denoted as: {insert as noted }, ( optional text ), [ required qualifier ].

The term "this product" used throughout this document may be replaced with the marketed product brand name.

The term "x" is a place holder for numerical digits.

Punctuation and plural/singular word forms may be adjusted to allow for grammatical correctness.

Appropriate metric or imperial unit may be added as optional, supplemental information.

- Cleans with no need for sprays or buckets
- Cleans without scratching your surfaces
- Cuts through tough grime
- Cuts grease (and)(&) tough grime
- Easy Cleaning (Around the house)
- Fast and effective cleaning
- For all non-porous ††household surfaces
- For all your (heavy) (light) duty jobs
- Great for on-the-go cleaning
- Leaves a clean, fresh scent
- Leaves your (bathroom) (kitchen††) fresh and clean
- One-step cleaning^
- Quick and easy clean-ups
- Quick cleaning
- Textured (cleaning) (wipe) (towelette) (cloth) for better cleaning
- Textured (wipe) (towelette) (cloth) surface for better cleaning
- ({Note to reviewer: Insert substrate material type as appropriate}) substrate easily distributes chemical onto surface to help clean (tough) (messes)(dirt)(grime)
- The smart way to clean and (sanitize) and/or (disinfect)
- Touch-up cleaning any time
- Use on hard, non-porous surfaces: (stainless steel) (Formica®) (glass) (glass tables) (glazed porcelain) (plastic)
- Use on (equipment) hard, non-porous surfaces
- maximum cleaning, minimum effort
- for all ††household surfaces, indoor and outdoor
- great for clean-up at school, daycare or community center
- (Back-to-school) (spring cleaning) (variety)(special) (bundle) (bonus) (multi) (pack)
- Textured (wipe) for better cleaning!
- Textured (wipe)(cloth)(material) (traps)(picks up)(particles)(crumbs)(dirt)(hair)
- (This product) (Product name) ({Note to reviewer: Insert substrate material type as appropriate}) wipes capture (dirt)(soil)(debris)(grime) up into the cloth rather than spreading them around on the surface
- Cleaning made easy!
- Improved (scrubby)(scrubbing) (texture)(fibers)(material)
- Effective against odor-causing bacteria
- Fast and easy way to clean
- (Kitchen††) and (Bathroom) wipes
- Nursery room (wipes) (cloths) (towelettes)
- Tough wipe for tough cleaning jobs
- Helps enhance cleaning performance

## **(Public Health) MARKETING CLAIMS**

{Note to reviewer: Marketing claims may appear anywhere on the label}

### **Disinfection and Sanitization Claims (Hard Non-Porous Surfaces)**

- Kills HIV-1
- Kills Antibiotic Resistant Bacteria: CA-MRSA, MRSA, VISA, VRE and NDM-1
- Kills 99.9% of Bacteria in (just) 15 Seconds (!)\*\*
- Kills *Campylobacter jejuni* in (just) (1 minute) (60 seconds)(!)
- Disinfects (††household), (††kitchen) and/or (bathroom) bacteria†
- Kills Flu Virus††
- Kills H1N1 Influenza A virus (formerly called swine flu)
- Kills (the) Cold† & Flu Virus(es) (on hard non-porous surfaces)†††
- Kills Carbapenem Resistant Enterobacteriaceae (CRE)††††
- 99.9% effective in 15 seconds against *Staphylococcus aureus* (Staph) (ATCC 6538), *Klebsiella pneumoniae* (ATCC 4352), *Listeria monocytogenes* (ATCC 35152), *Escherichia coli* (E. coli) O157:H7 (ATCC 43895).
- Effective in (1 minute) (60 seconds) against *Campylobacter jejuni* (ATCC 29428)
- 99.9% effective in killing common (††household) (††kitchen) (bathroom) bacteria<sup>8</sup>

(page 4 of 22)

Amended 07/13/2023

Bracketed information is denoted as: {insert as noted }, ( optional text ), [ required qualifier ].

The term "this product" used throughout this document may be replaced with the marketed product brand name.

The term "x" is a place holder for numerical digits.

Punctuation and plural/singular word forms may be adjusted to allow for grammatical correctness.

Appropriate metric or imperial unit may be added as optional, supplemental information.

- Kills 99.9% of Staphylococcus aureus (Staph) (ATCC 6538), Klebsiella pneumoniae (ATCC 4352), Listeria monocytogenes (ATCC 35152), Escherichia coli (E. coli) O157:H7 (ATCC 43895) in (just) 15 seconds(!)
- Kills 99.9% of Escherichia coli (E. coli) O157:H7 (ATCC 43895) in (just) 15 seconds(!)
- Kills Campylobacter jejuni (ATCC 29428) in (just) (1 minute) (60 seconds)!
- Kills common (‡‡household) (‡‡kitchen) (bathroom) bacteria<sup>8</sup>
- Kills 99.9% of Viruses\* (Bacteria) (and) (Fungi) (on hard, non-porous ‡‡household surfaces)
- Kills 99.9% of Germs
- 3-minute germicidal disinfectant wipe(s) *{Note to reviewer, this statement may only be used when directions for use lists contact times of 3 minutes or less.}*
- Kills bacteria in [(2) (5)] minutes *{Note to reviewer, may use 2 or 5 minutes to correspond to disinfection directions for use}*
- Disinfects (and deodorizes<sup>3</sup>) in (just) [(2) (two) (5) (five)] minutes. *{Note to reviewer, may use 2 or 5 minutes to correspond to disinfection directions for use}*
- [(2 minute) (5 minute)] (disinfect) (contact) (kill) (dwell) time *{Note to reviewer, may use 2 or 5 minutes to correspond to disinfection directions for use}*
- (This product) (Product) is effective against {XX} microorganisms<sup>3</sup> (including SARS-CoV-2) (,) (in a [(2) (5)] minute contact time) on hard, non-porous surfaces *{Note to reviewer: XX will reflect the actual number of listed pathogens from Micro-Organism table utilized on the final market label within the Disinfection and \*Virucidal Directions for Use. May use 2 or 5 minutes to correspond to disinfection directions for use}*
- Kills 99.9% of foodborne (illness causing) bacteria<sup>9</sup> on hard, non-porous surfaces in (just) (1 minute) (60 seconds).
- Kills 99.9% of Campylobacter jejuni (ATCC 29428) in (just) (1 minute) (60 seconds)
- Kills Influenza A2 virus the virus that causes the flu.
- (Sanitize) (Disinfect) your hard, non-porous ‡‡household surfaces: highchairs<sup>11</sup>, booster seats<sup>11</sup>, strollers<sup>11</sup>, car seats<sup>11</sup>, cribs<sup>11</sup>, tabletops, countertops, appliance exteriors<sup>7</sup>, sinks, and glazed tiles
- (Sanitizing) and/or (Disinfecting) wipe
- (This product or product name) (will clean and disinfect<sup>3</sup>) (is formulated to disinfect) hard, non-porous, (inanimate environmental) surfaces (of) (such as): (bed railings) (cabinets) (carts) (chairs) (counters) (countertops) (tables) (tabletops) (telephones) (toilet seats) (toilet exteriors) (bathtubs) (shower stalls) (shower doors) (sinks) (tiles) (vanity tops) (grocery cart handles) (grocery carts) (shopping carts) (grocery cart child seats) (changing tables<sup>11</sup>) (cribs<sup>11</sup>) (diaper pails) (trashcans) (garbage cans) (computers) (laptops) (cell phones) (tablets) (desks) (desktops) (doorknobs) (fax machines) (printers) (garbage cans) (headsets) (keyboards) (light switches) (railings) (seats) (appliance exteriors<sup>7</sup>) (bathroom)( ‡‡kitchen)( faucets) (fixtures) (stove tops<sup>7</sup>) (ultrasound transducers and probes) (gym equipment) (exercise machines) (wrestling mats) (gymnastic equipment) (floors) (walls) (metal surfaces) (stainless steel surfaces) (glazed porcelain) (glazed ceramic tile) (and) (plastic surfaces).
- Use (this product or product name) to clean and disinfect<sup>3</sup> non-porous personal protective safety equipment, protective headgear, hard hats, half mask respirators, full face breathing apparatus, gas masks, goggles, spectacles, face shields, silicone rubber or PVC hearing protectors and vinyl covered ear muffs. Rinse all equipment that comes in prolonged contact with skin before reuse with clean warm water (about 120°F), and allow to air dry. (Caution: Cleaning at the 120°F temperature will avoid overheating and distortion of the personal safety equipment that would necessitate replacement.)
- (This product or product name) cleans and/or disinfects<sup>3</sup> and/or deodorizes.
- Antibacterial (wipes) (formula)
- Use this product to clean, disinfect and deodorize flower buckets, walls and floors of coolers, shippers, greenhouse packing areas, garbage pails and other areas where obnoxious odors may develop<sup>3</sup>.
- (This product or product name) may be used as a general purpose antimicrobial detergent<sup>3</sup> on hard, non-porous surfaces in florist shops, wholesale florist, shippers, greenhouse packing areas and other commercial floriculture places for efficient cleaning and antimicrobial action against certain bacteria which cause:
  - Plugging of stems with slime, which reduces uptake of water for various flowers including roses, chrysanthemums, gladioli and tulips.
  - Production of ethylene gas, which may injure blooms of the various sensitive flowers including carnations, snapdragons, some orchids, babies breath, sweet peas, freesia and alstroemeria.
- Leaves hard, non-porous surfaces disinfected.
- One step^ (cleaning) and /or (disinfecting<sup>3</sup>) and/or (deodorizing).
- Disinfects (odor causing) (common) (‡‡household) (‡‡kitchen –and/or-bathroom) bacteria†
- Sanitizes (TV) (DVD) (Video Game) remote controls
- Kills (common)( ‡‡household)( ‡‡kitchen)(bathroom) germs<sup>10</sup> (everywhere you go)

(page 5 of 22)

Amended 07/13/2023

Bracketed information is denoted as: {insert as noted }, ( optional text ), [ required qualifier ].

The term "this product" used throughout this document may be replaced with the marketed product brand name.

The term "x" is a place holder for numerical digits.

Punctuation and plural/singular word forms may be adjusted to allow for grammatical correctness.

Appropriate metric or imperial unit may be added as optional, supplemental information.

- Cleaning and/or disinfecting<sup>3</sup> (on the go)
- Suitable for (disinfecting<sup>3</sup> and) heavy-duty cleaning
- One Step<sup>^</sup> Cleaning and Disinfecting<sup>3</sup>
- CLEANS, DISINFECTS<sup>3</sup> & DEODORIZES
- ANTIBACTERIAL FORMULA CLEANS and DISINFECTS<sup>3</sup>
- \*VIRUCIDAL//BACTERICIDAL//PSEUDOMONICIDAL<sup>6</sup>
- Antibacterial formula cleans and (disinfects<sup>3</sup>) (sanitizes<sup>4</sup>) in one step<sup>^</sup>
- (Antimicrobial) (Antibacterial) wipes
- (Clean) and (Sanitize<sup>4</sup>) and (Disinfect<sup>3</sup>) non-porous surfaces (in any room in the house) (throughout the house)
- (Clean) and (Sanitize<sup>4</sup>) and (Disinfect<sup>3</sup>) any room in the house
- (Antibacterial) (Disinfecting<sup>3</sup>) and scrubbing all in one
- Cleans, (sanitizes<sup>4</sup>) (disinfects<sup>3</sup>) and deodorizes
- Effective in (sanitizing) (disinfecting) your hard, non-porous (††kitchen) (bathroom) surfaces
- (Hospital) (General) disinfectant wipes
- Hard surface (disinfecting) (sanitizing) wipe
- Ideal for cleaning and (sanitizing<sup>4</sup>) (disinfecting<sup>3</sup>) any non-porous surface
- Multi-purpose (sanitizing) (disinfecting) wipe
- (Non-bleaching for surfaces) (surface safe) (sanitizing) (disinfecting) (wipes) (towelettes) (cloths)
- Use in (public toilets) (Laundromats) (camp sites) (pet areas) (hotels) (motels) (lodging establishments) (manufacturing facilities) (factories) (offices) (office buildings) wherever (sanitizing) (disinfecting) is important
- (This product or product name) are (is a) non-woven, disposable (towelette(s)) (wipe(s)), pre-saturated with a quaternary disinfectant cleaner.
- (This product) is designed as a cleaner and disinfectant<sup>3</sup> for use in (medical institutions) (hospitals) (nursing homes) (homes) (schools) (hotels) (restaurants) (offices) (RVs) (trailers) (boats) (and) (automobiles) (vehicles).
- (This product) is formulated to clean and disinfect<sup>3</sup> automobile interior surfaces such as (steering wheels) (seat belt buckles and housings) (child restraint seats<sup>11</sup>) (door handles) (non-porous surfaces of visors) (mirrors) (dashboards) (gear shift levers) (accessory control knobs) (wheelchair lifts).
- The antibacterial formula cleans and disinfects<sup>3</sup> in one step<sup>^</sup>. May be used in the ††kitchen on counters, sinks, appliances<sup>7</sup>, and stovetops<sup>7</sup>. A rinse with potable water is required for surfaces in direct contact with food. In addition, this product deodorizes those areas which generally are hard to keep fresh smelling, such as garbage storage areas, empty garbage bins and cans, basements, restrooms and other areas which are prone to odors caused by microorganisms.
- (This Product) (Product Name) (Kills) (is) (Effective against) (Eliminates 99.9%) (of) (has demonstrated effectiveness against) the virus that causes COVID-19<sup>5</sup> on hard non-porous surfaces (in) (just) (30 seconds) (!)<sup>3</sup>
- (This Product) (Product Name) (Kills) (is) (Effective against) (Eliminates 99.9%) (of) (has demonstrated effectiveness against) SARS-CoV-2 (the Coronavirus that causes COVID-19) on hard non-porous surfaces (in) (just) (30 seconds) (!)<sup>3</sup>
- (This Product) (Product Name) (Kills) (is) (Effective against) (Eliminates 99.9%) (of) (has demonstrated effectiveness against) SARS-CoV-2, which causes COVID-19 on hard non-porous surfaces (in) (just) (30 seconds) (!)<sup>3</sup>
- (This Product) (Product Name) (Kills) (is) (Effective against) (Eliminates 99.9%) (of) (has demonstrated effectiveness against) SARS-Related Coronavirus 2 (SARS-CoV-2) (USA-WA1/2020) (causative agent of COVID-19) (the virus that causes COVID-19) on hard non-porous surfaces (in) (just) (30 seconds) (!)<sup>3</sup>
- (This Product) (Product Name) (Kills) (is) (Effective against) (Eliminates 99.9%) (of) (has demonstrated effectiveness against) SARS-CoV-2 virus (the virus that causes COVID-19) responsible for COVID-19 on hard non-porous surfaces (in) (just) (30 seconds) (!)<sup>3</sup>
- (This Product) (Product Name) Disinfects hard non-porous surfaces by killing (99.9%) (of) the virus that causes COVID-19<sup>5</sup> (in) (just) (One Step<sup>^</sup>)<sup>3</sup>
- (This Product) (Product Name) Disinfects hard non-porous surfaces by killing (99.9%) (of) SARS-CoV-2 (the Coronavirus that causes COVID-19) (in) (just) (One Step<sup>^</sup>)<sup>3</sup>
- (This Product) (Product Name) Disinfects hard non-porous surfaces by killing (99.9%) (of) SARS-CoV-2, which causes COVID-19 (in) (just) (One Step<sup>^</sup>)<sup>3</sup>
- (This Product) (Product Name) Disinfects hard non-porous surfaces by killing (99.9%) (of) SARS-Related Coronavirus 2 (SARS-CoV-2) (USA-WA1/2020) (causative agent of COVID-19) (the virus that causes COVID-19) (in) (just) (One Step<sup>^</sup>)<sup>3</sup>



- (This Product) (Product Name) Disinfects hard non-porous surfaces by killing (99.9%) (of) SARS-CoV-2 virus (the virus that causes COVID-19) (in) (just) (One Step<sup>3</sup>)
- (This Product) (Product Name) (Kills) (is) (Effective against) (Eliminates 99.9%) (of) (has demonstrated effectiveness against) the virus that causes COVID-19<sup>5</sup> on hard non-porous surfaces<sup>3</sup>
- (This Product) (Product Name) (Kills) (is) (Effective against) (Eliminates 99.9%) (of) (has demonstrated effectiveness against) SARS-CoV-2 (the Coronavirus that causes COVID-19) on hard non-porous surfaces<sup>3</sup>
- (This Product) (Product Name) (Kills) (is) (Effective against) (Eliminates 99.9%) (of) (has demonstrated effectiveness against) SARS-CoV-2, which causes COVID-19 on hard non-porous surfaces<sup>3</sup>
- (This Product) (Product Name) (Kills) (is) (Effective against) (Eliminates 99.9%) (of) (has demonstrated effectiveness against) SARS-Related Coronavirus 2 (SARS-CoV-2) (USA-WA1/2020) (causative agent of COVID-19) (the virus that causes COVID-19) on hard non-porous surfaces<sup>3</sup>
- This Product) (Product Name) (Kills) (is) (Effective against) (Eliminates 99.9%) (of) (has demonstrated effectiveness against) SARS-CoV-2 virus (the virus that causes COVID-19) on hard non-porous surfaces<sup>3</sup>
- (This Product) (Product Name) Kills (99.9% of) SARS-CoV-2, which causes COVID-19 on hard non-porous surfaces<sup>3</sup>
- (This Product) (Product Name) Kills (99.9% of) SARS-CoV-2, which causes COVID-19 on hard non-porous surfaces (in) (just) (30 seconds) (!)<sup>3</sup>
- This Product) (Product Name) Kills (99.9%<sup>3</sup> of) SARS-CoV-2, which causes COVID-19 on hard non-porous surfaces (in) (just) (One Step<sup>3</sup>)
- (This Product) (Product Name) Kills (is) (Effective against) the virus that causes COVID-19<sup>5</sup> on hard non-porous surfaces (in) (just) (30 seconds) (!)<sup>3</sup>
- (This Product) (Product Name) Kills (is) (Effective against) the virus that causes COVID-19<sup>5</sup> on hard non-porous surfaces (in) (just) (One Step<sup>3</sup>)
- (This Product) (Product Name) Kills (is) (Effective against) the virus that causes COVID-19<sup>5</sup> on hard non-porous surfaces<sup>3</sup>
- (This Product) (Product Name) Kills SARS-CoV-2 (COVID 19 virus) (virus) on hard non-porous surfaces<sup>3</sup>
- (This Product) (Product Name) Kills SARS-CoV-2 (COVID 19 virus) (virus) on hard non-porous surfaces (in) (just) (30 seconds) (!)<sup>3</sup>
- (This Product) (Product Name) Kills SARS-CoV-2 (COVID 19 virus) (virus) on hard non-porous surfaces (in) (just) (One Step<sup>3</sup>)
- (This Product) (Product Name) Kills SARS-CoV-2 (COVID 19 virus) (virus) on hard non-porous surfaces<sup>3</sup>
- (This Product) (Product Name) (is) Effective against SARS-CoV-2 (COVID 19 virus) on hard non-porous surfaces<sup>3</sup>
- (This Product) (Product Name) (is) Effective against SARS-CoV-2 (COVID 19 virus) on hard non-porous surfaces (in) (just) (30 seconds) (!)<sup>3</sup>
- (This Product) (Product Name) (is) Effective against SARS-CoV-2 (COVID 19 virus) on hard non-porous surfaces (in) (just) (One Step<sup>3</sup>)
- (This product) (Product Name) is a broad-spectrum, hard non-porous surface disinfectant that has been shown to be effective against SARS-CoV-2 (COVID-19 virus tested and listed on the label)<sup>3</sup>

## MICRO-ORGANISMS

DISINFECTION		
Bacteria		Contact Time
<i>Pseudomonas aeruginosa</i>	(ATCC 15442)	(2) (5) minutes
<i>Staphylococcus aureus</i>	(ATCC 6538)	(2) (5) minutes
<i>Salmonella enterica</i> (Salmonella)	(ATCC 10708)	(2) (5) minutes
Methicillin resistant <i>Staphylococcus aureus</i> (MRSA)	(ATCC 33592)	(2) (5) minutes
Community Associated Methicillin resistant <i>Staphylococcus aureus</i> (CA-MRSA) Genotype USA300	(NRS 384)	(2) (5) minutes
Community Associated Methicillin resistant <i>Staphylococcus aureus</i> (CA-MRSA) Genotype USA400	(NRS 123)	(2) (5) minutes
Vancomycin Resistant <i>Enterococcus faecium</i> (VRE)	(ATCC 51559)	(2) (5) minutes
Multi-Drug Resistant (MDR) <i>Acinetobacter baumannii</i> Cefazidime and Gentamicin Resistant	(ATCC BAA-1605)	(2) (5) minutes

(page 7 of 22)

Amended 07/13/2023

Bracketed information is denoted as: {insert as noted }, ( optional text ), [ required qualifier ].

The term "this product" used throughout this document may be replaced with the marketed product brand name.

The term "x" is a place holder for numerical digits.

Punctuation and plural/singular word forms may be adjusted to allow for grammatical correctness.

Appropriate metric or imperial unit may be added as optional, supplemental information.

Extended Spectrum Beta-Lactamase (ESBL) <i>Escherichia coli</i>	(ATCC BAA-196)	(2) (5) minutes
<i>Klebsiella pneumoniae</i> New Delhi Metallo-Beta Lactamase (NDM-1) Carbapenem Resistant		(2) (5) minutes
<i>Escherichia coli</i> O157:H7	(ATCC 35150)	(2) (5) minutes
Vancomycin intermediate resistant <i>Staphylococcus aureus</i> (VISA)	(CDC HIP 5836)	(2) (5) minutes
<i>Streptococcus pyogenes</i>	(ATCC 19615)	(2) (5) minutes
<b>Viruses</b>		<b>Contact Time</b>
<b>Viruses Enveloped</b>		
Human Immunodeficiency Virus Type 1 (HIV-1)	Zeptomatrix	30 seconds
Influenza A Virus (H1N1)	A/PR/8/34	1 minute (60 seconds)
Influenza A2/305/57 Virus (H2N2)	Charles River Laboratories (A/2/305/57)	2 minutes
Avian Influenza Virus (H5N1)	NIBRG-14	30 seconds
Hepatitis B Virus (HBV)	HepadnaVirus Testing Inc. (LeGath)	1 minutes (60 seconds)
Hepatitis C Virus (HCV)	American BioResearch Laboratories	1 minutes (60 seconds)
Duck Hepatitis B Virus (DHBV)	HepadnaVirus Testing Inc. (LeGath)	1 minutes (60 seconds)
Bovine Viral Diarrhea Virus (BVDV)	American BioResearch Laboratories	1 minutes (60 seconds)
SARS-Related Coronavirus 2 (SARS-CoV-2)	USA-WA1/2020 BEI NR-52281	30 seconds
Human Coronavirus	(ATCC VR-740, strain 229E)	2 minutes
Herpes Simplex Virus 1 (HSV-1)	(ATCC VR-260)	2 minutes
Herpes Simplex Virus 2 (HSV-2)	(ATCC VR-734)	2 minutes
<b>Virus Large Non-Enveloped</b>		
Human Rotavirus	(ATCC VR-2018)	1 minutes (60 seconds)
<b>Viruses Small Non-Enveloped</b>		
Feline Calicivirus	(ATCC VR-782)	2 minutes
Norovirus (Norwalk Virus)		2 minutes
Rhinovirus Type 14	(ATCC VR-284)	2 minutes
Rhinovirus Type 39	(ATCC VR-340)	2 minutes
<b>FUNGICIDAL</b>		
Trichophyton interdigitale, formerly known as trichophyton mentagrophytes	(ATCC 9533)	3 minutes
<b>NON-FOOD CONTACT HARD SURFACE SANITIZATION</b>		
<i>Escherichia coli</i> O157:H7	(ATCC 43895)	15 seconds
<i>Klebsiella pneumoniae</i>	(ATCC 4352)	15 seconds
<i>Listeria monocytogenes</i>	(ATCC 35152)	15 seconds
<i>Staphylococcus aureus</i>	(ATCC 6538)	15 seconds
<i>Campylobacter jejuni</i>	(ATCC 29428)	60 seconds

(page 8 of 22)

Amended 07/13/2023

Bracketed information is denoted as: {insert as noted }, ( optional text ), [ required qualifier ].

The term "this product" used throughout this document may be replaced with the marketed product brand name.

The term "x" is a place holder for numerical digits.

Punctuation and plural/singular word forms may be adjusted to allow for grammatical correctness.

Appropriate metric or imperial unit may be added as optional, supplemental information.

## **USE SITES**

Product label may list use site and/or graphic depiction of site

### **Use Sites:**

<b>Hard, nonporous Surface(s)</b>			
Airports	Ambulances	Anesthesia Facilities	Animal holding areas
Animal hospitals	Animal life science laboratories	Athletic facilities	‡‡Banquet halls
Barber shops	(Bathroom)(Restroom)(Washrooms)(s)	Beauty salons	Boats
Breeding establishments	CAT labs	‡‡Catering facilities	(Cardiac Care Unit) (Critical Care Unit) (Cardiac Catheterization Unit) (CCU)
Central Supply Areas	Clinics	Commercial Florist(s) (Shops)	Correctional facilities
Critical Care Areas (Units)			
Daycare centers	‡‡Delicatessens	Dental Offices	Dialysis Clinics
Doctor's office(s)	(Emergency Room) (E.R.)	Emergency Rooms	Emergency Rooms
(Fitness Centers) (gymnasiums)(gyms)	Funeral homes	Grocery stores	Grooming establishments
Gyms	Health clubs	Home health care	‡‡Homes
Hospices	Hospitals and Health Care Settings	‡‡Households	‡‡Household kitchens and/or bathrooms
(Intensive Care Unit(s)) (I.C.U.)		‡‡Institutional kitchens and/or bathrooms	Kennels
‡‡Kitchen(s)	Laboratory	Laundry rooms	Mortuaries
Neonatal Intensive Care Units (NICU)		Newborn nursery	Nursery
Nursing homes	Operating rooms	Operating Rooms	Ophthalmic offices
Ophthalmic offices	Pediatric Intensive Care Units (PICU)		Pediatrics Facilities
Pet animal kennels	Pet animal quarters	Pet shops	Physical therapy
Physician's office(s)	Radiology Facilities	Recovery Room	(Recreational Vehicles) (RV's)
Rehabilitation Facilities	(Rental) (Cars) (Trucks)	‡‡Residences	Respiratory therapy
‡‡Restaurants(s)	Schools	Shopping Centers	Surgery Facilities
Tack shops	Trailers	(Transport) (Animal transportation) vehicles	Transport vehicles
Transportation terminals	Veterinary Clinics	Veterinary examination rooms	Veterinary waiting rooms
Veterinary X-ray rooms	X-Ray Facilities	Zoos	

## **Disclaimers**

‡‡ When using on food contact surfaces: thoroughly rinse all treated surfaces with potable (tap) water.

(page 9 of 22)

Amended 07/13/2023

Bracketed information is denoted as: {insert as noted }, ( optional text ), [ required qualifier ].

The term "this product" used throughout this document may be replaced with the marketed product brand name.

The term "x" is a place holder for numerical digits.

Punctuation and plural/singular word forms may be adjusted to allow for grammatical correctness.

Appropriate metric or imperial unit may be added as optional, supplemental information.

<sup>^</sup> “One Step” claim is limited to association with non-food contact surface use.

<sup>1</sup> Human Coronavirus (ATCC VR-740)

<sup>3</sup> When used according to disinfection directions

<sup>4</sup> When used according to hard surface sanitization directions

<sup>5</sup> Severe Acute Respiratory Syndrome Related Coronavirus 2

<sup>6</sup> *Pseudomonas aeruginosa*

<sup>7</sup> Allow surfaces to come to room temperature prior to treatment

<sup>8</sup> {insert bacteria from Micro-Organism table}

<sup>9</sup> *Staphylococcus aureus* (Staph), *Listeria monocytogenes*, *Campylobacter jejuni*, *Escherichia coli* (E. coli) O157:H7

<sup>10</sup> {insert organisms from Micro-Organism table- must include at a minimum *Staphylococcus aureus*, *Salmonella enterica*, and at least one virus or fungi from the table}

<sup>11</sup> use only on hard, non-porous surfaces and thoroughly rinse all surfaces with potable water after application

\* (This symbol will connect to the specific viruses claimed for the product.)

\*\* *Staphylococcus aureus* (Staph), *Klebsiella pneumoniae*, *Listeria monocytogenes*, *Escherichia coli* (E. coli) O157:H7

† *Pseudomonas aeruginosa*, *Staphylococcus aureus* (Staph), *Salmonella enterica* (Salmonella), *Streptococcus pyogenes* (Strep), *Escherichia coli* (E. coli) O157:H7

†† Influenza A<sub>2</sub> Virus

††† Influenza A Virus, H1N1 Influenza A Virus, Human Coronavirus<sup>1</sup>

†††† *Klebsiella pneumoniae* New Delhi Metallo-Beta Lactamase (NDM-1) Carbapenem Resistant

## DIRECTIONS FOR USE

It is a violation of Federal Law to use this product in a manner inconsistent with its labeling.

*(For labels that list medical premises and metal and/or stainless steel surfaces, one of the following statements must be used:)*

This product is not to be used as a terminal sterilant/high-level disinfectant on any surface or instrument that (1) is introduced directly into the human body, either into or in contact with the bloodstream or normally sterile areas of the body, or (2) contacts intact mucous membranes but which does not ordinarily penetrate the blood barrier or otherwise enter normally sterile areas of the body.

or

This product is not for use on critical and semi-critical medical device surfaces.

A potable water rinse is required for surfaces in direct contact with food.

**CLEANING:** Use one (product name) (wipe) (towelette) to completely remove all (visible) (dirt) (and) (debris) from surfaces to be treated.

**DISINFECTING:** {Note to Reviewer: Select one of the following paragraphs:}

- To disinfect hard, non-porous surfaces, thoroughly wet the surface to be treated. Treated surface must remain visibly wet for disinfecting. Use enough (wipes) (cloths) (towelettes) for treated surface to remain visibly wet for [(2) (5)] minutes. For visibly soiled surfaces, clean before following disinfecting instructions. Allow surfaces to air dry.

{Or}

- To disinfect hard, non-porous surfaces, use enough (wipes) (cloths) (towelettes) to ensure surface remains visibly wet for [(2) (5)] minutes. For visibly soiled surfaces, clean before following disinfecting instructions. Allow surfaces to air dry.

(page 10 of 22)

Amended 07/13/2023

Bracketed information is denoted as: {insert as noted }, ( optional text ), [ required qualifier ].

The term “this product” used throughout this document may be replaced with the marketed product brand name.

The term “x” is a place holder for numerical digits.

Punctuation and plural/singular word forms may be adjusted to allow for grammatical correctness.

Appropriate metric or imperial unit may be added as optional, supplemental information.

(This product or product name) is an effective disinfectant against:

- *<Reference bacteria and ATCC number, if applicable, from micro-organisms table>*, when the treated surface is allowed to remain visibly wet for 2 minutes.
- *<Reference bacteria and ATCC number, if applicable, from micro-organisms table>*, when the treated surface is allowed to remain visibly wet for 5 minutes.

**\*VIRUCIDAL ACTIVITY** {Note to reviewer: market label may list all viruses at 2 or 5 minute contact time in lieu of separate shorter contact times):

- *<Reference viral organism and ATCC number, if applicable, from micro-organisms table>*, when the treated surface is allowed to remain visibly wet for 30 seconds.
- *<Reference viral organism and ATCC number, if applicable, from micro-organisms table>*, when the treated surface is allowed to remain visibly wet for (1 minute) (60 seconds).
- *<Reference viral organism and ATCC number, if applicable, from micro-organisms table>*, when the treated surface is allowed to remain visibly wet for 2 minutes.

**KILLS HIV-1, HBV, and HCV ON PRE-CLEANED ENVIRONMENTAL SURFACES/OBJECTS PREVIOUSLY SOILED WITH BLOOD/BODY FLUIDS** in health care settings (Hospitals, Nursing Homes) or other settings in which there is an expected likelihood of soiling of inanimate surfaces/objects with blood or body fluids, and in which the surfaces/objects likely to be soiled with blood or body fluids can be associated with the potential for transmission of Human Immunodeficiency Virus Type 1, Human Hepatitis B Virus (HBV) and Human Hepatitis C Virus (HCV).

**SPECIAL INSTRUCTIONS FOR CLEANING AND DECONTAMINATION AGAINST HIV-1, HBV and HCV OF SURFACES/OBJECTS SOILED WITH BLOOD/BODY FLUIDS.**

**PERSONAL PROTECTION:** When handling items soiled with blood or body fluids, use disposable latex gloves, gowns, masks and eye coverings.

**CLEANING PROCEDURES:** Blood and other body fluids must be thoroughly cleaned from surfaces and objects before application of (this product or product name).

**CONTACT TIME:** Allow surface to remain visibly wet for (1 minute) (60 seconds).

**DISPOSAL OF INFECTIOUS MATERIALS:** Blood and other body fluids should be autoclaved and disposed of according to local regulations for infectious waste disposal.

**FUNGICIDAL ACTIVITY:** (This product or product name) is an effective fungicide against *Trichophyton interdigitale*, formerly *Trichophyton mentagrophytes* (ATCC 9533) (causative agent of Athlete's Foot Fungus) (a cause of ringworm) (a cause of ringworm of the foot), when used as directed on hard surfaces found in bathrooms, shower stalls, locker rooms, exercise facilities or other clean, hard, non-porous, surfaces commonly contacted by bare feet. The surface must remain visibly wet for 3 minutes. Allow surfaces to air dry.

**EFFICACY TESTS HAVE DEMONSTRATED THAT (THIS PRODUCT OR PRODUCT NAME) IS AN EFFECTIVE BACTERICIDE, \*VIRUCIDE AND FUNGICIDE IN THE PRESENCE OF ORGANIC SOIL (5% BLOOD SERUM).**

**For Ultrasound Transducers and Probes:**

Use only on external surfaces of ultrasound transducers and probes.

With a clean washcloth, clean gel from external surface of the ultrasound transducer or probe to be disinfected. Then thoroughly wet probe with (wipe(s) (towelette(s))). Treated surface must remain visibly wet for 5 minutes. Use additional (wipe(s)) (towelette(s)) if needed to assure continuous 5 minute wet contact time. Let air dry.

**SANITIZING/DEODORIZING:** To sanitize/deodorize hard, non-porous surfaces; wipe surface, using enough (wipes) (towelettes) (cloths) to allow treated surface to remain visibly wet for (15 seconds) for *<Reference Non-food contact hard surface sanitization bacterial organism and ATCC number, if applicable, from micro-organisms table along with relevant contact time>* (and) (60 seconds for *Campylobacter jejuni*)

(page 11 of 22)

Amended 07/13/2023

Bracketed information is denoted as: {insert as noted }, ( optional text ), [ required qualifier ].

The term "this product" used throughout this document may be replaced with the marketed product brand name.

The term "x" is a place holder for numerical digits.

Punctuation and plural/singular word forms may be adjusted to allow for grammatical correctness.

Appropriate metric or imperial unit may be added as optional, supplemental information.

Let surface dry. For visibly soiled surfaces, clean excess dirt first.

For surfaces that may come in contact with food, a potable water rinse is required.

For plastic and painted surfaces, spot test on an inconspicuous area before use.

(This product or product name) will not harm most surfaces including acrylic, fiberglass and vinyl.

**Do not use on unpainted wood.**

Not for personal cleansing.

This is **not** a baby wipe!

Do not flush in toilet.

*Canister Directions (Use any of the following instructions – can also use with canister icon)*

**TO OPEN:**

- Remove lid from canister.
- Lift flap in center of lid.
- Pull up corner of center (wipe) (towelette) (cloth), twist to a point and thread through dispenser hole in lid. **DO NOT PUSH FINGER THROUGH OPENING.**
- Replace lid. Pull out exposed (wipe) (towelette) (cloth) and snap off. The next (wipe) (towelette) (cloth) pops up automatically. Dispose of used (wipes) (towelettes) (cloths) in trash receptacle. Snap center flap down when finished to retain moisture.
- Do not flush.

**TO OPEN PACKAGE:** Flip open dispensing cap and remove lid by pulling upward. Thread center (wipe) (towelette) (cloth) corner through slits in lid center. **DO NOT PUSH FINGER THROUGH OPENING.** Replace lid. Dispense (wipes) (towelettes) (cloths) by pulling out at an angle. Snap flip lid down when finished, to retain moisture. Dispose of used (wipes) (towelettes) (cloths) in trash. Do not flush.

**TO OPEN PACKAGE:** Pop open dispensing tab and remove top by lifting upward. Pull up corner of center (wipe) (towelette) (cloth), twist to a point and thread through slits in top. **DO NOT PUSH FINGER THROUGH SLITS.** Replace top and pull (wipe) (towelette) (cloth) at slight angle. The next (wipe) (towelette) (cloth) pops up automatically. Snap tab closed to retain moisture. Do not flush.

**DISPENSER:** To start feed, remove (large) cover and discard seal from container. From center of (wipe) (towelette) (cloth) roll, pull up (wipe) (towelette) (cloth) corner, twist into a point and thread it through the hole in the container cover. **DO NOT PUSH FINGER THROUGH HOLE.** Pull through about one inch. Replace cover. Pull out first (wipe) (towelette) (cloth) and snap off at a 90 degree angle. Remaining (wipes) (towelettes) (cloths) feed automatically ready for next use. When through using, keep small center cap closed to prevent moisture loss. Do not flush.

*Flip-top Canister Directions (can also use with Flip-top Canister icon)*

**TO OPEN PACKAGE:** 1. Lift tab at front of lid to open. 2. Pull up corner of center sheet and thread through dispenser slit in lid. 3. Pull out exposed (wipe) (towelette) (cloth) at a 45 degree angle and snap off. The next (wipe) (towelette) (cloth) is ready for dispensing. 4. Close lid to retain moisture. 5. Dispose of used (wipes) (towelettes) (cloths) in trash (receptacle). Do not flush.

*Flip-top Canister Directions (can also use with Flip-top Canister icon)*

**TO OPEN PACKAGE:** Lift tab at front of lid to open. 1. Pull up corner of center sheet and thread through dispenser slit in lid. 2. Pull out exposed (wipe) (towelette) (cloth) at a 45 degree angle and snap off. The next (wipe) (towelette) (cloth) is ready for dispensing. 3. Close lid to retain moisture. 4. Dispose of used (wipes) (towelettes) (cloths) in trash (receptacle). Do not flush.

*Refillable Package Instructions: (Use with product supplied in refillable packages)*

**TO OPEN PACKAGE:** Flip open dispensing flap and remove lid by lifting upward. Place (pouch) (package) in (container) (tub). Open pouch by peeling back seal. Insert (wipe) (towelette) (cloth) through opening in lid. Replace lid. The next (wipe) (towelette) (cloth) pops up automatically. When finished, close lid flap to retain moisture.

*Refill Package Instructions: (Use for refill package)*

**TO OPEN PACKAGE:** Flip open dispensing flap and remove lid by lifting upward. Place refill in (container) (tub). Open (container) (tub) by peeling back seal. Insert (wipe) (towelette) (cloth) through opening in lid. Replace lid. The next (wipe) (towelette) (cloth) pops up automatically. When finished, close lid to retain moisture.

*Resealable Package Instructions: (Use for product supplied in resealable pouches/packages)*

**TO OPEN PACKAGE:** Slowly peel back label. (Pull out) (Remove) (wipes) (towelettes) (cloths) as needed. To retain moisture, reseal (pouch) (package) by firmly pressing label back on the (pouch) (package).

*Single Use Pouch Instructions: (Use for product supplied in single use pouches/packets)*

**TO OPEN PACKAGE:** Tear pouch open (along dotted line) (at tear notch) (along the top edge of pouch). (Pull out) (Remove) (wipes) (towelettes) (cloth).

*For product supplied in a single use pouch with a folded towelette, include the following)*

Unfold (wipe) (towelette) (cloth) before use.

*Center Pull Dispenser Instructions: (Use for product supplied in plastic bags)*

**TO OPEN PACKAGE:** (Open lid of the dispenser.) (Cut "V" out of the top of the (plastic) bag.) (Tear open (tab on) top of (plastic) bag.) (Cut open top of (plastic) bag.) (Remove the Styrofoam core from the center of the roll.) Pull out the first (wipe) (towelette) (cloth) approximately 6 to 8 inches from the center of the roll. (Place entire bag inside of center pull dispenser. Thread the (wipe) (towelette) (cloth) through the opening on the dispenser.) Place entire bag inside of center pull dispenser. Close the lid of the dispenser.) ((Wipe) (Towelette) (Cloth) dispensing tension may be adjusted on the bottom of the dispenser). (Additional loading directions are listed on the dispenser.) Dispenser may be mounted with (wipes) (towelettes) (cloths) (dispensing up) (dispensing down) (dispensing up or down).

## STORAGE AND DISPOSAL

**Do not contaminate water, food or feed by storage or disposal.**

*(The following Storage/Disposal statement can be used for household and Institutional/Industrial products)*

*(Optional for product supplied in nonrefillable canisters)*

**CONTAINER STORAGE/DISPOSAL:** Store in an area inaccessible to children. Wipes: Dispose of (wipe) (towelette) in trash after use. Do not flush. Canister: Tightly close lid between uses to retain moisture. Nonrefillable container. Do not reuse or refill this (container) (canister). Offer empty (container) (canister) for recycling if available or discard in trash.

*(Optional for Product Supplied in Refillable Containers & Refill Package)*

**CONTAINER STORAGE/DISPOSAL:** Store in an area inaccessible to children. Wipes: Dispose of (wipe) (towelette) in trash after use. Do not flush. Container: Refill only with (this product) (product name). Do not reuse or refill except as described in the directions for use. Tightly close lid between uses to retain moisture. Offer empty (container) (tub) for recycling if available or discard in trash. Refill (Package) (Container) (Pouch): Nonrefillable (package) (container) (pouch). Do not reuse or

*(page 13 of 22)*

*Amended 07/13/2023*

Bracketed information is denoted as: {insert as noted }, ( optional text ), [ required qualifier ].

The term "this product" used throughout this document may be replaced with the marketed product brand name.

The term "x" is a place holder for numerical digits.

Punctuation and plural/singular word forms may be adjusted to allow for grammatical correctness.

Appropriate metric or imperial unit may be added as optional, supplemental information.

**refill this (package) (container) (pouch). Offer empty (container) (package) (pouch) for recycling if available or discard in trash.**

*(Optional for Product Supplied in Resealable Packages)*

**CONTAINER STORAGE/DISPOSAL:** Store in an area inaccessible to children. Wipes: Dispose of (wipe) (towelette) in trash after use. Do not flush. Resealable (Package) (Pouch): Reseal label between uses to retain moisture. Do not reuse or refill empty (pouch) (package). Offer empty (package) (pouch) for recycling if available or discard in trash.

*(Optional for Product Supplied in Single Use Pouches/Packets)*

**CONTAINER STORAGE/DISPOSAL:** Store in an area inaccessible to children. Wipes: Dispose of (wipe) (towelette) in trash after use. Do not flush. (Pouch) or (Packet): Offer empty (pouch) (packet) for recycling if available or discard in trash.

*(Optional for Product Supplied in plastic bags for use in Center Pull Dispensers)*

**CONTAINER STORAGE/DISPOSAL:** Store in an area inaccessible to children. Wipes: Dispose of (wipe) (towelette) (cloth) in trash after use. Do not flush. Dispenser: Refill only with (this product) (product name). Do not reuse or refill except as described in the directions for use. Keep dispenser closed to retain moisture. Plastic Bag: Do not reuse or refill empty plastic bag. Offer empty plastic bag for recycling if available or discard in trash.



## **GRAPHICS**

*{Note to Reviewer: These are representative icons / descriptions for use sites/application methods that may appear on the label listed with the appropriate directions for use, PPE or package type. Toilets and urinal graphics should be qualified with “\*exterior surfaces only” under or near the graphic.}*

### **Use Site or Surface Graphics:**

(sink with faucet)  
(work station tub or sink)  
(rubber gloves) (masks) (PPEs)  
(table)  
(chair)  
(bed frame)  
(wall)  
(cabinet)  
(doorknob)  
(garbage can)  
(non-wooden picnic table)  
(outdoor furniture except cushions and wood frames).  
(Telephone, receivers, and keypads)  
(non-food contact counter tops, equipment, shelves, racks and carts)  
(kitchen countertops and kitchen areas {Note to reviewer: Place qualifier “††” with graphic on package label})  
(shower stalls)  
(shower doors and curtains)  
(tubs)  
(glazed tiles)  
(toilets- exterior surfaces only)  
(urinals- exterior surfaces only)  
(glazed porcelain tile) and (restroom fixtures).  
(wheelchair)  
(walkers/canes)  
(computer)  
(shopping cart)  
(desks)  
(stovetops and refrigerators {Note to reviewer: Place qualifier “7” with graphic on package label})  
(microwave – Note to reviewer the phrase “exterior surfaces only” must be placed under or near the graphic on the package label})  
(non-porous hard surfaces of workout/gym equipment)  
(non-porous hard surfaces of child car seats, highchairs, baby swings, strollers, baby walkers, changing tables, cribs, baby rooms {Note to reviewer: Place qualifier “11” with graphic on package label})  
(vehicle) (boat) (RV) (trailer)

*{Note to reviewer: The following images are only meant to be representative examples of final package label graphics. All label graphics must be qualified as noted above}*

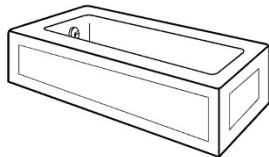

**Bathtub**



**Canister Directions**



**Changing Table**



**Computer**



**Baby crib**

(page 15 of 22)

Bracketed information is denoted as: {insert as noted }, ( optional text ), [ required qualifier ].  
The term “this product” used throughout this document may be replaced with the marketed product brand name.  
The term “x” is a place holder for numerical digits.  
Punctuation and plural/singular word forms may be adjusted to allow for grammatical correctness.  
Appropriate metric or imperial unit may be added as optional, supplemental information.

Amended 07/13/2023



**Door Knob**



**Faucet**

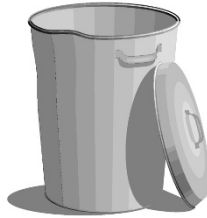

**Garbage Can**

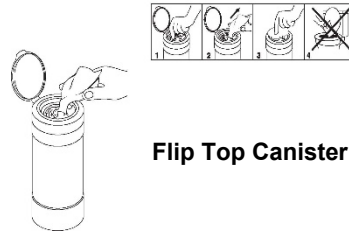

**Flip Top Canister**

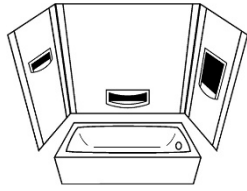

**Tub and Shower walls**



**Baby's Room**



**Shopping Cart**





Bracketed information is denoted as: {insert as noted }, ( optional text ), [ required qualifier ].  
 The term "this product" used throughout this document may be replaced with the marketed product brand name.  
 The term "x" is a place holder for numerical digits.  
 Punctuation and plural/singular word forms may be adjusted to allow for grammatical correctness.  
 Appropriate metric or imperial unit may be added as optional, supplemental information.

**Other Graphic Images:**

(graphics that show how to open package and refill containers)

(recycling logo) {Note to reviewer: Only for containers which may be recycled per storage and disposal directions}

(American flag logo) {Note to reviewer: May only be used on labels which carry “Assembled in USA” or “Assembled in America” marketing statements.}

(Brand or Company name specific graphics, logos, and stylized fonts including background patterns and fill colors)

(Women owned business logos or other business industry membership logos)

(Do not flush icons)

{Note to reviewer the exact virus image below may be used in association with SARS-CoV-2 marketing claims and applicable directions for use as a stylized graphic including any of the following statements: “Kills (the) COVID-19 Virus<sup>3,5,\*</sup>”; “Effective against SARS-CoV-2<sup>3</sup>”; “Kills SARS-CoV-2<sup>3</sup> (in) (just) (30 seconds)” .}



Pouch/Packet Label to be used with Master Container Label

# STEPAN® DISINFECTANT WIPE

EPA REG. NO. 1839-190  
EPA EST. NO. 1839-IL-01

Net Contents: X lbs. X ozs. (*mandatory: must be expressed in avoirdupois pounds and ounces*)

*Optional: can also express as total count and size*

1 (Wipe) (Towelette) (Cloth)

## ACTIVE INGREDIENTS

Alkyl (60% C <sub>14</sub> , 30% C <sub>16</sub> , 5% C <sub>12</sub> , 5% C <sub>18</sub> ) dimethyl benzyl ammonium chlorides .....	0.14%
Alkyl (68% C <sub>12</sub> , 32% C <sub>14</sub> ) dimethyl ethylbenzyl ammonium chlorides .....	0.14%
<b>INERT INGREDIENTS</b> .....	<u>99.72%</u>
Total	100.00%

## KEEP OUT OF REACH OF CHILDREN CAUTION

**SEE (OUTER CONTAINER) (BOX) FOR PRECAUTIONARY STATEMENTS AND USE DIRECTIONS.**

**DISPOSAL:** DISPOSE (WIPE) (TOWELETTE) (CLOTH) IN TRASH AFTER USE. DO NOT FLUSH. OFFER EMPTY (POUCH) (PACKET) FOR RECYCLING IF AVAILABLE OR DISCARD EMPTY IN TRASH.

*(NOTE TO REVIEWER: The following statements are optional and may appear anywhere on the label)*

### **Warranty Statements**

- Satisfaction guaranteed
- Money back if not 100% satisfied.
- Unconditional Guarantee  
If for any reason you are not completely satisfied with your purchase, simply return the product with proof of purchase for a replacement or refund, whichever you prefer. We welcome any comments or questions you may have. When writing, please include the 12-digit UPC number.  
Questions? (phone number)
- (Product or brand name) Satisfaction Plus! (product or brand icon)  
If you are not satisfied with any (customer brand) product, simply return it to the store where purchased. We will refund your money PLUS replace the item with a like item of the brand of your choice—FREE.
- (customer brand) Guarantee  
Complete Satisfaction Or Your Money Back
- Satisfaction Guaranteed  
For information call (phone number)
- Quality Assured (product or brand icon)  
Satisfaction guaranteed or your money back
- Quality Assured  
I am proud to put my name on this product. Think of it as your guarantee that we've done our best to bring you the best. (name/ signature) (to be used with Meijer brand only)
- (customer brand) Quality (icon)  
Money back guarantee
- (customer brand) Quality Guaranteed (icon)
- (customer brand) Your Satisfaction is Guaranteed (icon)
- Our promise. Offering premium quality products at an exceptional value is our ongoing commitment to you. Our goal is to ensure that this and every (customer name) product meets or exceeds your expectations for quality and performance. Your satisfaction is guaranteed every time you use this product. For questions or comments regarding this product, call toll free in the continental U.S. (phone number), (time), (time zone), (days of the week). (to be used for Members Mark® only)
- (customer symbol) Quality Guaranteed: 100% Satisfaction Guaranteed with (all) (this) (customer brand) Product(s) (or Your Money Back), (return it for a refund or replacement)
- Satisfaction Guaranteed. Money Back If Not 100% Satisfied
- Satisfaction Guarantee (circling customer icon)
- Satisfaction Guaranteed by Refund or Exchange

*(page 20 of 22)*

*Amended 07/13/2023*

Bracketed information is denoted as: {insert as noted }, ( optional text ), [ required qualifier ].

The term "this product" used throughout this document may be replaced with the marketed product brand name.

The term "x" is a place holder for numerical digits.

Punctuation and plural/singular word forms may be adjusted to allow for grammatical correctness.

Appropriate metric or imperial unit may be added as optional, supplemental information.

- Cleans, Disinfects<sup>3</sup>. Guaranteed. Return the unused portion with receipt for a replacement or your money back.
- Comments or questions? (phone number)

(Company name) quality guaranteed (symbol). We're committed to your satisfaction and guarantee the quality of this product. Contact us at (phone number). Please have package available.

U-Line, 1-800-XXX-XXXX, S-XXXXX

**{NOTE TO REVIEWER: NOT FOR USE ON FINAL IN-COMMERCE PRODUCT LABEL}**

**Emerging Viral Pathogen Claims**

This product qualifies for emerging viral pathogen claims per the EPA's 'Guidance to Registrants: Process for Making Claims Against Emerging Viral Pathogens not on EPA-Registered Disinfectant Labels' when used in accordance with the appropriate use directions indicated below:

This product meets the criteria to make claims against certain emerging viral pathogens from the following viral categories:

- Enveloped viruses
- Large non-enveloped viruses
- Small non-enveloped viruses

<i>For an emerging viral pathogen that is a/an...</i>	<i>...follow the directions for use for the following organisms on the label:</i>
<b>Enveloped virus</b>	Human Rotavirus (ATCC VR-2018)
<b>Large, non-enveloped virus</b>	Feline Calicivirus (ATCC VR-782)
<b>Small, non-enveloped virus</b>	Feline Calicivirus (ATCC VR-782) Rhinovirus Type 39 (ATCC VR-340)

**Acceptable Claim Language:**

**[Product Name]** has demonstrated effectiveness against viruses similar to **[name of emerging virus]** on **hard, non-porous surfaces**. Therefore, **[product name]** can be used against **[name of emerging virus]** when used in accordance with the directions for use against **[insert relevant supporting virus(es) from table above]** on **hard, non-porous surfaces**. Refer to the **[CDC or OIE]** website at **[pathogen-specific website address]** for additional information.

**[Name of illness/outbreak]** is caused by **[name of emerging virus]**. **[Product name]** kills similar viruses and therefore can be used against **[name of emerging virus]** when used in accordance with the directions for use against **[insert relevant supporting virus(es) from table above]** on **hard, non-porous surfaces**. Refer to the **[CDC or OIE]** website at **[website address]** for additional information."