

Page # 152
11/12
1/2

Fuller SYSTEM, INC.

WOBURN, MASS. 01801
PHONE AREA CODE 617-933-0945

RESTRICTED USE PESTICIDE
For retail sale to and use only by Certified Applicators or persons under their direct supervision, and only for those uses covered by the Certified Applicator's certification.

STOP - READ LABEL BEFORE USING!
THIS CAN NOT BE DISTRIBUTED AND RESALE SEPARATELY

POISON
See Side Panels for Antidote & Precautions



DANGER
Keep Out of Reach of Children

FULEX DITHIO INSECTICIDAL SMOKE
CONTAINS SULFOTEPP

Net Weight 1.00 lb (454 g)
EPA Reg. No. 1327-38

NOT FOR HOME USE

04477 POISON PRECAUTIONS
Do not operate car near combustion motor at back of F-40

POISON PRECAUTIONS
See Side Panels for Antidote & Precautions

POISON PRECAUTIONS
See Side Panels for Antidote & Precautions

POISON PRECAUTIONS
See Side Panels for Antidote & Precautions

POISON PRECAUTIONS
See Side Panels for Antidote & Precautions

POISON PRECAUTIONS
See Side Panels for Antidote & Precautions

ACCEPTED

Under the Federal Insecticide, Fungicide, and Rodenticide Act, as amended for the pesticide registered under EPA Reg. No. **1327-38**

USE ONLY WHEN WEARING THE FOLLOWING PROTECTIVE EQUIPMENT AND CLOTHING

Protective clothing and equipment must be worn at all times during application.

WORK SAFETY RULES

1. Do not use in enclosed spaces unless properly ventilated.
2. Do not use in occupied buildings.
3. Do not use in areas where food is stored or prepared.
4. Do not use in areas where children or pets are present.
5. Do not use in areas where livestock are present.
6. Do not use in areas where crops are present.
7. Do not use in areas where water is present.
8. Do not use in areas where electrical equipment is present.
9. Do not use in areas where flammable materials are present.
10. Do not use in areas where fire hazards are present.

POISON SIGNS (Symptoms)

1. Irritation of the skin, eyes, nose, and throat.
2. Headache, dizziness, and nausea.
3. Difficulty breathing and chest pain.
4. Weakness and fatigue.
5. Loss of consciousness.

FIRST AID TREATMENT

1. Remove person from exposure area.
2. Wash exposed areas with soap and water.
3. Flush eyes with water for 15 minutes.
4. Seek medical attention immediately.

POST TREATED AREA

1. Do not enter treated area until notified.
2. Do not use treated area for food preparation or storage.
3. Do not use treated area for living quarters.

CONTAINER DISPOSAL

1. Do not reuse container.
2. Do not dump container.
3. Do not burn container.
4. Do not bury container.
5. Do not use container for other purposes.

WARRANTY

RESTRICTED USE PESTICIDE
For retail sale to and use only by Certified Applicators or persons under their direct supervision, and only for those uses covered by the Certified Applicator's certification.

FULEX DITHIO INSECTICIDAL SMOKE
E.P.A. Reg. No. 1327-38

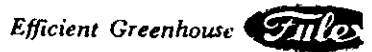

Supplementary Directions for Fulex DITHIO SMOKE

For use on greenhouse ornamentals only, not for use on edible plants.

(Read these instructions before using)

These directions are intended to supplement the label on each Fulex Dithio smoke can. These directions will outline the general procedure for using these units.

- Do not breathe the smoke or vapors.
- Do not get the contents on skin or eyes.
- Keep the contents and smoke from feed and food products.
- Never enter smoke or active vapors unless wearing a gas mask passed by the U.S. Bureau of Mines for Sulfitepp protection and protective clothing such as plastic pants and natural rubber gloves.

FOR THESE PESTS

This smoke is designed for use against RED SPIDERS, THIRIPS, APHIDS, WHITE FLIES, and some species of Mealybugs and soft brown scale.

PREPARATION OF GREENHOUSE

1. Turn off ventilators and openings in the greenhouse prior to treatment.
2. Lock or barricade all entrances or post warning signs at entrances.
3. Turn off misting systems prior to application.
4. Keep generators at least 2 ft. away from plants.

OPERATING CONDITIONS

Temperatures within the greenhouse should be maintained between 70°F and 90°F. All plant foliage and blooms should be free from moisture and the relative humidity should be kept low. Soil should be moist but it is advisable not to water a greenhouse the same day that it is treated. Do not use on a rainy day. Do not use on a windy day which might cause fumes to drift. Pick wide open blooms before treating.

VENTILATION

It is advisable to ventilate the greenhouse within twelve hours from the start of treatment. Ventilation at the end of eight hours is more desirable if it is possible. Do not drop temperatures suddenly when ventilating as this may cause moisture condensation which must be avoided.

Day or night treatments are possible provided proper temperature and humidity conditions can be maintained. Allow eight hours to elapse after treatment before greenhouse workers are allowed in the greenhouse. If treatment is started in the early evening, the greenhouse should be safe for workers the following morning but greenhouse should be aired thoroughly before entry for at least 2 hours before starting regular work.

HOW TO APPLY

Shake contents before using

Figure the proper number of cans necessary. Distribute the cans in the center aisle of ordinary greenhouses in the following manner: one can within 10 feet of the ends of the greenhouse and the remaining cans spaced equidistant throughout the length of the greenhouse. *As you space the cans in their proper positions, you should unscrew and remove the top covers.*

After cans have been properly distributed prior to ignition, use a match or cigarette lighter and light the sparkler at the bottom near the handle wire so that it will burn toward the top end of the sparkler. Then, after the sparkler is lighted, insert it into the top of the contents of the can. The first can to be ignited should be the farthest one from the exit of the greenhouse. Proceed to the next can, etc., until all cans are ignited; then get out of the greenhouse IMMEDIATELY.

HOW TO OPERATE

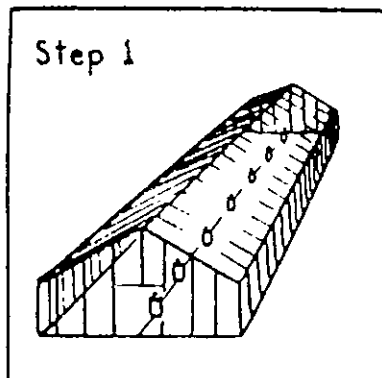

Space cans in greenhouse center walk (or in a walk nearest the center) as shown. Remove tops of cans when placing them.

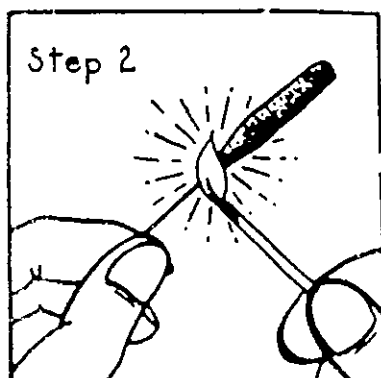

Starting with can farthest from exit, light a sparkler as shown (at handle end).

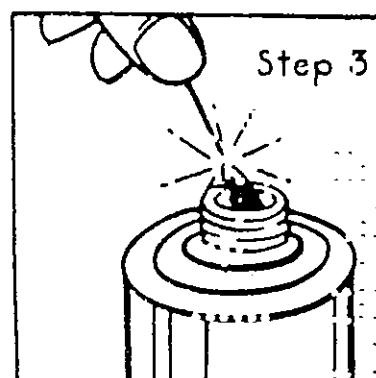

Insert lighted sparkler deeply into contents of can. Then proceed to next can, light another sparkler until all cans are

HOW TO APPLY

Shake contents before using

Figure the proper number of cans necessary. Distribute the cans in the center aisle of ordinary greenhouses in the following manner: one can within 10 feet of the ends of the greenhouse and the remaining cans spaced equidistant throughout the length of the greenhouse. *If you space the cans in their proper positions, you should unscrew and remove the top covers.*

After cans have been properly distributed prior to lighting, use a match or cigarette lighter and light the sparkler at the bottom near the handle wire so that it will burn toward the top end of the sparkler. Then, after the sparkler is lighted, insert it into the top hole of the contents of the can. The first can to be ignited should be the farthest one from the exit of the greenhouse. Proceed to the next can, etc., until all cans are ignited, then get out of the greenhouse IMMEDIATELY.

HOW TO OPERATE

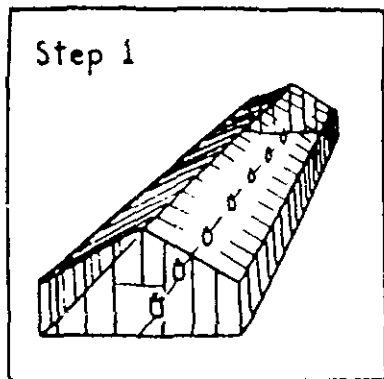

Space cans in greenhouse center walk (or in a walk nearest the center) as shown. Remove tops of cans when placing them in position for lighting.

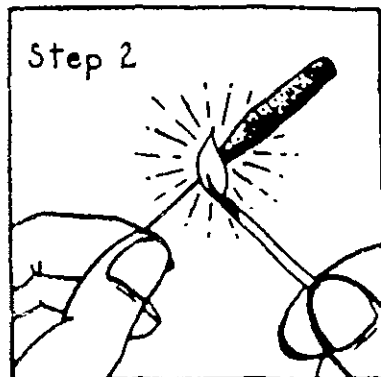

Starting with can farthest from exit, light a sparkler as shown (at handle end).

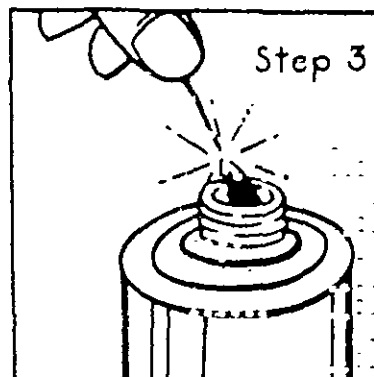

Insert lighted sparkler deeply into contents of can. Then proceed to next can, light another sparkler until all cans are ignited.

CARBON OR FLY ASH

88-1281

V.1

The larger size cans may throw fine particles of carbon into the air nearby under certain conditions. If this becomes objectionable, we suggest placing the cans on their sides before lighting. Place them all in one direction (away from the greenhouse exit) lengthwise in the walk. Insert sparkler in the usual manner by centering the cans while on their sides. Do not operate near flammable material.

REPEAT APPLICATIONS

Repeat applications at intervals of 3 days should be used to keep up your infestations.

REMEMBER

- Wear eye mask and protective clothing if you should have to enter the smoke for any reason.
- Keep workmen and other persons out of area next to greenhouse being treated if leakage of smoke from the greenhouse is evident in such areas. This applies to connecting passageways, boiler rooms, stove rooms, etc., adjacent to greenhouses.

FULLER SYSTEM, INC.

WOBURN, MASS.

LOOK!

Other FULLER products are available for insect control and for diseases. Write for free information. What is YOUR problem?