

Fuller SYSTEM, INC.

WOBURN, MASS. 01801
PHONE AREA CODE 617-933-0945

RESTRICTED USE PESTICIDE
For retail sale to and use only by Certified Applicators or persons under their direct supervision, and only for those uses covered by the Certified Applicator's certification.

BEST DOCUMENT AVAILABLE

CANCER-POISON-PRECAUTIONS
Do not operate an open combustion material because of fly ash.

POISONOUS IF SWALLOWED

POISONOUS BY SKIN CONTACT

POISONOUS IF INHALED

POISONOUS TO FISH AND WILDLIFE

FULLER SYSTEM, INC. - WOBURN, MASS.

STOP-READ LABEL BEFORE USING
THIS CAN NOT FOR DISTRIBUTION AND RESALE SEPARATELY

POISON
See Side Panels for Antidote & Precautions



DANGER
Keep Out of Reach of Children

FULEX PARATHION INSECTICIDAL SMOKE

Active Ingredient: Parathion, D-Diethyl D-thio-phosphoryl phosphorochloridate 87%
Inert Ingredients 13%

NET WEIGHT 32 oz
Treats 2,000 cu. ft.
NOT FOR HOME USE
FOR USE ON GREENHOUSE VEGETABLES ONLY

USE ONLY WHEN WEARING THE FOLLOWING PROTECTIVE EQUIPMENT AND CLOTHING:

Respirator, long-sleeved shirt and trousers, gloves, shoes, socks, and closed-toe shoes. Do not eat, drink, or smoke while using this product.

WORK SAFETY RULES

Read and follow all directions on the label. Do not use in residential areas. Do not use in areas where children or pets are present. Do not use in areas where food is stored. Do not use in areas where food is prepared. Do not use in areas where food is served. Do not use in areas where food is consumed. Do not use in areas where food is stored, prepared, served, or consumed. Do not use in areas where food is stored, prepared, served, or consumed. Do not use in areas where food is stored, prepared, served, or consumed.

POISON SIGNS (Symptoms)

Headache, dizziness, nausea, vomiting, diarrhea, muscle twitching, weakness, and loss of consciousness. If these symptoms occur, stop using the product immediately and seek medical attention.

FIRST AID TREATMENT

Get fresh air. If inhaled, move to fresh air. If on skin, wash with soap and water. If in eyes, flush with water. If swallowed, do not induce vomiting. Seek medical attention immediately.

NOTE TO PHYSICIAN

Do not use in areas where food is stored, prepared, served, or consumed. Do not use in areas where food is stored, prepared, served, or consumed. Do not use in areas where food is stored, prepared, served, or consumed. Do not use in areas where food is stored, prepared, served, or consumed.

POISON TREATED AREA

Do not enter treated area until the odor has completely disappeared. Do not use treated area for food storage, preparation, service, or consumption.

NON WARRANTY

Fuller System, Inc. does not warrant the effectiveness of this product against any pest or disease.

E.P.A. Est. No. 01327-MA-01

ACCEPTED
SEP. 20, 1978
SEP 20 1978

1327-13

BEST DOCUMENT AVAILABLE

RESTRICTED USE PESTICIDE
For retail sale to and use only by Certified Applicators or persons under their direct supervision, and only for those uses covered by the Certified Applicator's certification.

FULEX PARATHION INSECTICIDAL SMOKE 2M
E.P.A. Reg. No. 1327-13

BEST DOCUMENT AVAILABLE

Supplementary Directions for Fulex Parathion SMOKE

(Read these instructions before using)

These directions are intended to supplement the label on each Fulex Parathion smoke can. These directions will outline the general procedure for using these units.

- Do not breathe the smoke or vapors.
- Do not get the contents on skin or eyes.
- Keep the contents away from food and feed products.
- Never enter smoke or active vapors unless wearing a mask passed by the U.S. Bureau of Mines for Parathion protection and protection clothing, such as plastic coveralls and rubber gloves.

FOR THESE PESTS

This smoke is designed for use against RED SPIDERS, THrips, and APHIDS in greenhouses.

PREPARATION OF GREENHOUSE

1. Close all ventilators and openings in the greenhouse prior to treatment.
2. Lock or barricade all entrances or post warning signs at entrances.

OPERATING CONDITIONS

Temperatures within the greenhouse should be maintained between 70° and 90°. All plant foliage and blooms should be free from moisture and the relative humidity should be kept low. Soil should be moist but it is advisable not to water a greenhouse the same day that it is treated. Do not use on a rainy day. Do not use on a windy day which might cause fumes to drift. Pick wide open blooms before treating.

VENTILATION

It is advisable to ventilate the greenhouse within twelve hours from the start of treatment. Ventilation at the end of eight hours is more desirable if it is possible. Do not drop temperatures suddenly when ventilating as this may cause moisture condensation which must be avoided.

Day or night treatments are possible provided proper temperature and humidity conditions can be maintained. Allow eight hours to elapse after treatment before greenhouse workers are allowed in the greenhouse. If treatment is started in the early evening, the greenhouse should be safe for workers the following morning. If a greenhouse should be aired thoroughly before entry.

HOW TO APPLY

Shake contents before using

BEST DOCUMENT AVAILABLE

Figure the proper number of cans necessary. Distribute the cans in the center aisle of ordinary greenhouses in the following manner: *one can every 10 feet of the ends of the greenhouse and the remaining cans spaced equidistant throughout the length of the greenhouse.* As you space the cans in their proper positions, you should unscrew and remove the top covers.

After cans have been properly distributed prior to ignition, use a match or cigarette lighter and light the sparkler at the bottom near the handle wire so that it will burn toward the top end of the sparkler. Then, after the sparkler is lighted, insert it into the top inch of the contents of the can. The first can to be ignited should be the farthest one from the exit of the greenhouse. Proceed to the next can, etc., until all cans are ignited, then get out of the greenhouse IMMEDIATELY.

Under the Federal Insecticide Act,
EPA Reg. No. 1327-13
10-1-60

HOW TO OPERATE

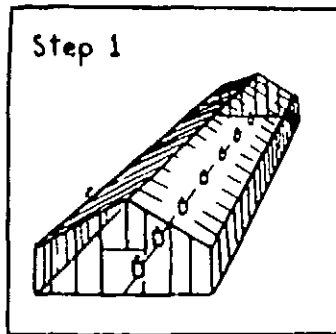

Space cans in greenhouse center walk (or in a walk nearest the center) as shown. Remove tops of cans when placing them in position for lighting.

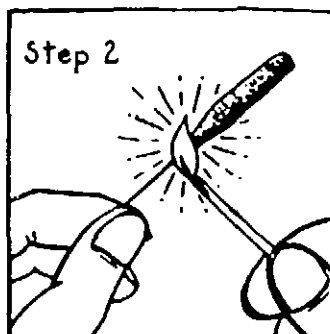

Starting with can farthest from exit, light a sparkler as shown (at handle end).

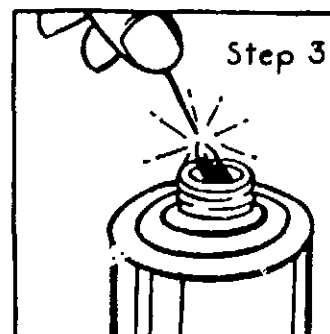

Insert lighted sparkler deeply into contents of can. Then proceed to next can, light another sparkler until all cans are ignited.

CARBON OR FLY ASH

The larger size cans may throw fine particles of carbon into the air nearby under certain conditions. If this becomes objectionable, we suggest placing the cans on their sides before lighting. Place them all in one direction (away from the greenhouse exit) lengthwise in the walk. Insert sparkler in the usual manner by lighting the cans while on their sides. **DO NOT USE THESE CANS NEAR COMBUSTIBLE MATERIAL**

REPEAT APPLICATIONS

One or two repeat applications at an interval of about one week should be used to clean up severe infestations.

REMEMBER

- Wear a gas mask and protective clothing if you should have to enter the smoke for any reason.
- Keep workmen and other persons out of area next to greenhouse being treated if leakage of smoke from the greenhouse is evident in such areas. This applies to connecting passage ways, border rooms, show rooms, etc., adjacent to greenhouses.

FULLER SYSTEM, INC.

WOBURN, MASS.

LOOK!

8 Other FULEX products are available for insect control and for diseases. Write for free information. What is YOUR problem?