

# Fuller SYSTEM, INC.

WOBURN, MASS. 01801  
PHONE AREA CODE 617-933-0945

**RESTRICTED USE PESTICIDE**  
For retail sale to and use only by Certified Applicators or persons under their direct supervision, and only for those uses covered by the Certified Applicator's certification.

**STOP - READ LABEL BEFORE USING**  
THIS CAN NOT FOR DISTRIBUTION AND RESALE SEPARATELY

**POISON**  
See Side Panels for Antidote & Precautions

**DANGER**  
Keep Out of Reach of Children

**USE ONLY WHEN WEARING THE FOLLOWING PROTECTIVE EQUIPMENT AND CLOTHING**

**WORN SAFETY RULES**

**POISON SIGNS (Symptoms)**

**FIRST AID TREATMENT**

**FULEX PARATHION INSECTICIDAL SMOKE**

Federal Insecticide, Fungicide, and Rodenticide Act, registered under EPA Reg. No. 1327-11

Active Ingredient: Parathion, O, O diethyl O-p-nitrophenyl phosphorothioate

NET WEIGHT 13.2 oz  
Treats 20,000 cu. ft.  
**NOT FOR HOME USE**  
FOR USE ON GREENHOUSE ORNAMENTALS

**POST TREATED AREA**

**CLEANUP DISPOSAL**

**STOP USE DIRECTIONS**

**NON WARRANTY**

**DANGER - POISON - PRECAUTIONS**  
Do not operate can near combustible material because of fly ash

**POISON - IF SWALLOWED**

**POISON - IF SKIN CONTACT**

**POISON - IF BREATHED**

**POISONOUS TO FISH AND WILDLIFE**

FULLER SYSTEM, INC WOBURN MASS

BEST DOCUMENT AVAILABLE

BEST DOCUMENT AVAILABLE

E.P.A. - Region VI  
First International Bldg.  
1201 Elm Street  
Dallas, TX 75270  
Attn: Mr. Norman D. Dyer  
Pesticides Branch

**RESTRICTED USE PESTICIDE**  
For retail sale to and use only by Certified Applicators or persons under their direct supervision, and only for those uses covered by the Certified Applicator's certification.

**FULEX PARATHION INSECTICIDAL SMOKE**  
E.P.A. Reg. No. 1327-11

Efficient Greenhouse

## Supplementary Directions for Fulex Parathion SMOKE

(Read these instructions before using)

These directions are intended to supplement the directions on the Fulex Parathion smoke can. They do not outline the general procedure for using these units.

- Do not breathe the smoke or vapors.
- Do not get the contents on your face.
- Keep the contents and smoke from drifting into your eyes.
- Never enter a greenhouse treated with Fulex Parathion smoke until the smoke has dissipated.

### FOR THE PESTS

This smoke is designed for use against FLYING INSECTS, THIRPS, AND SPIDER MITES.

### PREPARATION OF GREENHOUSE

1. Close all ventilators and openings in the greenhouse prior to treatment.
2. Lock or barricade all entrances and post warning signs at entrances.

### OPERATING CONDITIONS

Temperatures within the greenhouse should be maintained between 70°F and 90°F. All plants to be treated should be free from moisture and the relative humidity should be kept low. Soil should be moist but it is advisable not to water a greenhouse the same day that it is treated. Do not use on a rainy day. Do not use on a windy day which might cause fumes to drift. Pick water open blooms before treating.

### VENTILATION

It is advisable to ventilate the greenhouse within twelve hours from the start of treatment. Ventilation at the end of eight hours is more desirable if it is possible. Do not drop temperatures suddenly when ventilating as this may cause moisture condensation which must be avoided.

Day or night treatments are possible provided proper temperature and humidity conditions can be maintained. Allow eight hours to elapse after treatment before greenhouse workers are allowed in the greenhouse. If treatment is started in the early evening, the greenhouse should be safe for workers the following morning, but greenhouse should be aired thoroughly before entry.

### HOW TO APPLY

*Shake contents before using*

Determine the proper number of cans necessary. Distribute the cans in the center aisle of ordinary greenhouses in the following manner: one can within 10 feet of the ends of the greenhouse and the remaining cans spaced equidistant throughout the length of the greenhouse. *As you space the cans in their proper positions, you should unscrew and remove the top covers.*

After cans have been properly distributed prior to ignition, use a match or cigarette lighter and light the sparkler at the bottom near the handle wire so that it will burn toward the top end of the sparkler. Then, after the sparkler is lighted, insert it into the top inch of the contents of the can. The first can to be ignited should be the farthest one from the exit of the greenhouse. Proceed to the next can, etc., until all cans are ignited, then get out of the greenhouse IMMEDIATELY.

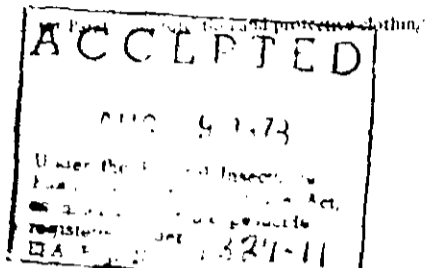

## HOW TO OPERATE

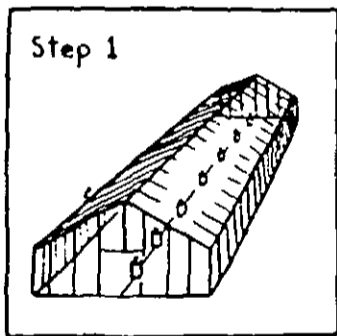

Space cans in greenhouse center walk (or in a walk nearest the center) as shown. Remove tops of cans when placing them in position for lighting.

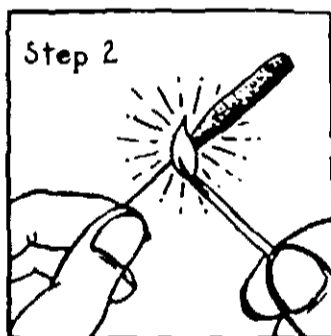

Starting with can farthest from exit, light a sparkler as shown (at handle end).

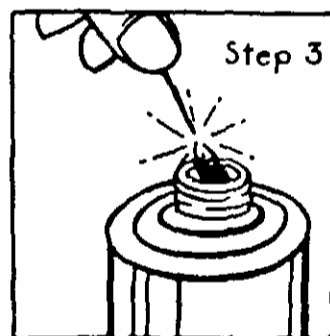

Insert lighted sparkler deeply into contents of can. Then proceed to next can, light another sparkler until all cans are ignited.

### CARBON OR FLY ASH

The larger size cans may throw fine particles of carbon into the air nearby under certain conditions. If this becomes objectionable, we suggest placing the cans on their sides before lighting. Place them all in one direction (away from the greenhouse exit) lengthwise in the walk. Insert sparkler in the usual manner by lighting the cans while on their sides. **DO NOT USE THESE CANS NEAR COMBUSTIBLE MATERIAL**

### REPEAT APPLICATIONS

One or two repeat applications at an interval of about one week should be used to clean up severe infestations.

### REMEMBER

- Wear a gas mask and protective clothing if you should have to enter the smoke for any reason.
- Keep workers and other persons out of area next to greenhouse being treated if leakage of smoke from the greenhouse is evident in such areas. This applies to connecting passageways, utility rooms, show rooms, etc., adjacent to greenhouses.

FULLER SYSTEM, INC.

WOBURN, MASS.

LOOK!

8 Other FULEX products are available for insect control and for diseases. Write for free information. What is YOUR problem?