



U.S. ENVIRONMENTAL PROTECTION AGENCY
 Office of Pesticide Programs
 Registration Division (7505P)
 1200 Pennsylvania Ave., N.W.
 Washington, D.C. 20460

EPA Reg. Number:

1021-2822

Date of Issuance:

9/13/18

NOTICE OF PESTICIDE:

Registration
 Reregistration
 (under FIFRA, as amended)

Term of Issuance:

Conditional

Name of Pesticide Product:

MGK Formula 2993

Name and Address of Registrant (include ZIP Code):

McLaughlin Gormley King Company
 D/B/A MGK
 8810 Tenth Avenue North
 Minneapolis, MN 55427-4319

Note: Changes in labeling differing in substance from that accepted in connection with this registration must be submitted to and accepted by the Registration Division prior to use of the label in commerce. In any correspondence on this product always refer to the above EPA registration number.

On the basis of information furnished by the registrant, the above named pesticide is hereby registered under the Federal Insecticide, Fungicide and Rodenticide Act.

Registration is in no way to be construed as an endorsement or recommendation of this product by the Agency. In order to protect health and the environment, the Administrator, on his motion, may at any time suspend or cancel the registration of a pesticide in accordance with the Act. The acceptance of any name in connection with the registration of a product under this Act is not to be construed as giving the registrant a right to exclusive use of the name or to its use if it has been covered by others.

This product is conditionally registered in accordance with FIFRA section 3(c)(7)(A). You must comply with the following conditions:

1. Submit and/or cite all data required for registration/reregistration/registration review of your product under FIFRA when the Agency requires all registrants of similar products to submit such data.
2. You are required to comply with the data requirements described in the DCI or EDSP Order identified below:

Signature of Approving Official:

Elizabeth Fertich, Product Manager 04
 Invertebrate Vertebrate Branch I, Registration Division (7505P)

Date:

9/13/18

EPA Form 8570-6

- a. Fipronil GDCI-129121-1305
- b. Fipronil GDCI-129121-1512

You must comply with all of the data requirements within the established deadlines. If you have questions about the Generic DCI or EDSP Order listed above, you may contact the Chemical Review Manager in the Pesticide Reevaluation Division:

<http://iaspub.epa.gov/apex/pesticides/f?p=chemicalsearch:1>

3. Make the following label changes before you release the product for shipment:
 - Revise the EPA Registration Number to read, “EPA Reg. No. 1021-2822.”
4. Submit one copy of the final printed label for the record before you release the product for shipment.

Should you wish to add/retain a reference to the company’s website on your label, then please be aware that the website becomes labeling under the Federal Insecticide Fungicide and Rodenticide Act and is subject to review by the Agency. If the website is false or misleading, the product would be misbranded and unlawful to sell or distribute under FIFRA section 12(a)(1)(E). 40 CFR 156.10(a)(5) list examples of statements EPA may consider false or misleading. In addition, regardless of whether a website is referenced on your product’s label, claims made on the website may not substantially differ from those claims approved through the registration process. Therefore, should the Agency find or if it is brought to our attention that a website contains false or misleading statements or claims substantially differing from the EPA approved registration, the website will be referred to the EPA’s Office of Enforcement and Compliance.

If you fail to satisfy these data requirements, EPA will consider appropriate regulatory action including, among other things, cancellation under FIFRA section 6(e). Your release for shipment of the product constitutes acceptance of these conditions. A stamped copy of the label is enclosed for your records. Please also note that the record for this product currently contains the following CSFs:

- Basic CSF dated 12/01/2017

If you have any questions, please contact Jennifer Gaines by phone at 703-305-5967, or via email at gaines.jennifer@epa.gov.

Enclosure

NOTE: Bold, Italicized text is information for the reader and is not part of the label. [Bracketed information is optional text]. (Text in parenthesis is alternative). Text separated by "/" denotes and/or options.

MGK[®] Formula 2993

[To control yellowjackets.]

[For use outdoors around buildings, establishments and areas such as: commercial, industrial, agricultural, residential, public settings and transportation equipment where yellowjackets are a nuisance.]

ACTIVE INGREDIENT:

Fipronil.....	0.1%
OTHER INGREDIENTS.....	99.9%
	100.0%

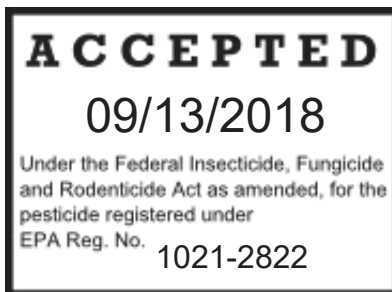

KEEP OUT OF REACH OF CHILDREN

Have the product container or label with you when calling a poison control center or doctor or going for treatment. For information regarding medical emergencies or pesticide incidents, call 1-888-740-8712.

Manufactured for



8810 Tenth Avenue North
Minneapolis, MN 55427

EPA Reg. No. 1021-UNASSIGNED

EPA Est. No. 1021-MN-2

Net Contents: _____[Grams, Fluid oz.]

PRECAUTIONARY STATEMENTS
HAZARDS TO HUMANS AND DOMESTIC ANIMALS

Wash hands thoroughly with soap and water after handling and before eating, drinking, chewing gum, using tobacco or using the toilet.

ENVIRONMENTAL HAZARDS

This pesticide is toxic to fish and wildlife. Cover or collect spilled bait during loading. Do not apply directly to water. Do not contaminate water by cleaning of equipment or disposal of equipment wash waters.

PHYSICAL OR CHEMICAL HAZARDS

Do not apply this product around electrical equipment due to the possibility of shock hazard.

See [[inside] [booklet] [package [insert] [or box] [original container label]] [[side] [back [panel]]] for [additional] [Precautionary [Statements,]] [Directions for Use] [and] [Storage and Disposal].

(MGK[®] (Brand Name) YELLOWJACKET BAIT effectively kills yellowjacket colonies. [MGK (Brand name) Yellowjacket Bait (Station) contains (an ingredient) (Fipronil) that kills yellowjackets continuously (nonstop). MGK (Brand name) Yellowjacket Bait (station) is attractive to [pestiferous (scavenger)] species of yellowjackets and kills the nest (colony) [including queens]. [MGK (Brand

NOTE: *Bold, italicized text is information for the reader and is not part of the label.* [Bracketed information is optional text]. (Text in parenthesis is alternative). Text separated by "/" denotes and/or options.

name) Yellowjacket Bait] may be placed outdoors where you have seen yellowjackets [foraging or flying]. MGK (Brand name) Yellowjacket Bait is effective even under high yellowjacket pressure.

DIRECTIONS FOR USE

It is a violation of Federal Law to use this product
In a manner inconsistent with its labeling.

READ ENTIRE LABEL. USE STRICTLY IN ACCORDANCE WITH PRECAUTIONARY STATEMENTS AND DIRECTIONS AND WITH APPLICABLE STATE AND FEDERAL REGULATIONS.

For use outdoors around buildings, establishments and areas such as: commercial, industrial, agricultural, residential, public settings and transportation equipment where yellowjackets are a nuisance.

To control yellowjackets.

USE RESTRICTIONS:

- Do not use without a bait station.
- Do not place the bait station within reach of small children or pets.
- Do not place stations within 20 feet of known yellowjacket nest (colony).
- Do not apply bait outside of station
- Do not spray or add any other insecticides to the bait or station.
- Apply no more than 45 grams of bait per half acre [90 grams per acre] at any one time.

USE DIRECTIONS:

This product is for use outdoors in a bait station for the control of yellowjackets. For best results bait should be applied when yellowjackets are actively foraging, such as in the morning or during sunny warm conditions when the expected daytime temperature is greater than 50° F [10° C] and less than 90° F [32°C]. It is not necessary to find or locate the yellowjacket nest (colony) for bait to be effective.

The number of stations used may vary, as long as no more than 90 grams of bait per acre are applied at any one time. For best results, place at least 8-10 stations per acre. For areas less than an acre, fewer stations can be used. [See Application Rate Table]

Hang or attach the station at least 4 feet off the ground, to available trees or structures within area of protection. If no tree or structure is available in a given area, stakes or poles can be used for placement of bait stations at least 4 feet off the ground.

NOTE: Bold, Italicized text is information for the reader and is not part of the label. [Bracketed information is optional text]. (Text in parenthesis is alternative). Text separated by “/” denotes and/or options.

Bait Station Directions

Do not use bait stations with an opening outside of these dimensions 16.5mm to 16.5 mm by 24mm x 24mm.

This allows adequate room for yellowjacket entry and exit while not allowing non-target access.

Option 1:

Bottle Stations

Pre-drilled bottles may be available for purchase separately.



- 1) Push down on cover and twist counter clockwise to open. [Other graphic/illustration]
- 2) Apply 3-9 grams of bait (each gram = 1/5 teaspoon) onto inside wall of station.

[Graphic/illustration approx. 3 grams of bait ]

- 3) Replace cover and turn clockwise to close. [Graphic/illustration]
- 4) Position the station at least 4 feet above the ground by hanging to or attaching to an object, using the string/wire or double-sided adhesive pad. [Graphic/illustration]
- 5) When yellowjackets are no longer present in treatment area, remove stations.
- 6) If the bait in the stations is not entirely consumed, please refer to the Storage and Disposal statements for proper disposal.

NOTE: Bold, Italicized text is information for the reader and is not part of the label. [Bracketed information is optional text]. (Text in parenthesis is alternative). Text separated by "/" denotes and/or options.

**Option 2:
Easy Grip Station**

Prepare the station for placement as follows:

- 1) Remove station from package
- 2) Open station by squeezing rear handles together.
- 3) While maintaining pressure to keep station open, apply 3-9 grams (each gram = 1/5 teaspoon) of bait to inside wall of station.
- 4) Position the station at least 4 feet above the ground by hanging to or attaching to an object using a hanger/S-hook/zip tie/string/wire/double-sided adhesive pad. [Graphic/illustration]
- 5) When yellowjackets are no longer present in treatment area, remove stations.
- 6) If the bait in the stations is not entirely consumed, please refer to the Storage and Disposal statements for proper disposal.

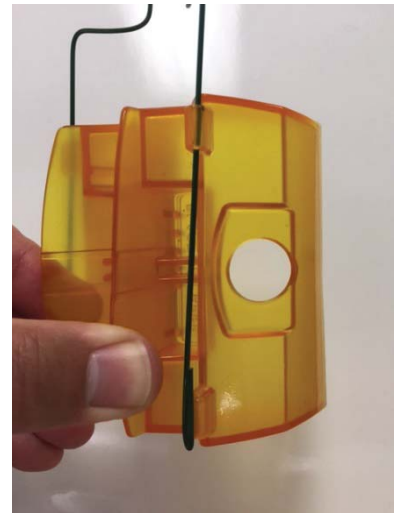

NOTE: Bold, Italicized text is information for the reader and is not part of the label. [Bracketed information is optional text]. (Text in parenthesis is alternative). Text separated by “/” denotes and/or options.

**Option 3:
Orange Clamshell Station**

Prepare the station for placement as follows:

[Other Illustration]

- 1) Remove station from packaging and unfold/open it up.

[Other Illustration]



- 2) Apply 3-9 grams (each gram = 1/5 teaspoon) of bait onto inside wall or bottom of station. [graphic or illustration  = approx. 3 grams of bait]

[Other Illustration]



- 3) Snap station closed on top.
- 4) Position the station at least 4 feet above the ground by hanging to or attaching to an object, using a S-hook hanger/string/wire/zip tie or double-sided adhesive pad.
- 5) When yellowjackets are no longer present in treatment area, remove stations.
- 6) If the bait in the stations is not entirely consumed, please refer to the Storage and Disposal statements for proper disposal.

NOTE: Bold, Italicized text is information for the reader and is not part of the label. [Bracketed information is optional text]. (Text in parenthesis is alternative). Text separated by "/" denotes and/or options.

Option 4: This option is to be used for packages that contain bait only, without station. Professional pest management professionals will reuse existing stations.

Refill

Use bait only in a station specifically designed for yellowjackets, and with openings from 16.5mm x 16.5mm to 24mm x 24mm:

- 1) Apply 3-9 grams (each gram = 1/5 teaspoon) of bait onto inside wall or bottom of station. [graphic or illustration [ = approximately 3 gm bait]
- 2) Position the station at least 4 feet above the ground by hanging to or attaching to an object using a S-hook hanger/string/wire/zip tie or double-sided adhesive pad.
- 3) When yellowjackets are no longer present in treatment area, remove stations.
- 4) If the bait in the stations is not entirely consumed, please refer to the Storage and Disposal statements for proper disposal.

NOTE: Bold, Italicized text is information for the reader and is not part of the label. [Bracketed information is optional text]. (Text in parenthesis is alternative). Text separated by "/" denotes and/or options.

APPLICATIONS TO LARGE OUTDOOR AREAS:

Place at least 8-10 bait stations per acre (see application rate instructions below). Place stations approximately 70 feet apart. If a yellowjacket nest (colony) location is identified, do not place a station within 20 feet of the nest (colony) because yellowjackets tend to forage farther away from their nest (colony). In large areas, it is recommended to draw a diagram marking all bait station placements to prevent bait stations from being lost. Use the diagram to check bait stations and for collection of stations after control is achieved.

APPLICATION RATES:

Apply 3-9 grams (each gram = 1/5 teaspoon) of bait per station depending on the severity of the yellowjacket problem. Use at least 8-10 stations per acre. Apply no more than 90 grams of bait per acre (43,560 sq. ft.). [45 grams of bait per half acre (21,780 sq. ft.)]

For best results, initially apply 3 grams of bait in each station. Before leaving the treatment area, it is recommended to check the early station placements. If more than 75% of the bait has been removed from the station and there is still yellowjacket activity, reapply the full 9 grams of bait to each depleted station as long as no more than 90 grams of bait per acre are present. [45 grams of bait per half acre (21,780 sq. ft.)]

Rebaiting Process

For best results, check bait stations 3-4 days after bait placement but no longer than 7 days after placement. Add up to 9 grams of fresh bait to each depleted station as long as no more than 90 grams of bait per acre are present. [45 grams of bait per half acre (21,780 sq. ft.)]

For the stations where no bait was taken, dump unused bait into a container for later disposal, per the Storage and Disposal instructions, and apply fresh bait to station. Move the stations to a new location within the treatment area where yellowjacket activity or bait removal has been observed.

[Grams of Bait

- 1 grams = 1/5 teaspoon
- 2 grams = 2/5 teaspoon
- 3 grams = 3/5 teaspoon
- 6 grams = 1 1/5 teaspoons
- 9 grams = 1 4/5 teaspoons]

[4 Station Placement Example for Half Acre

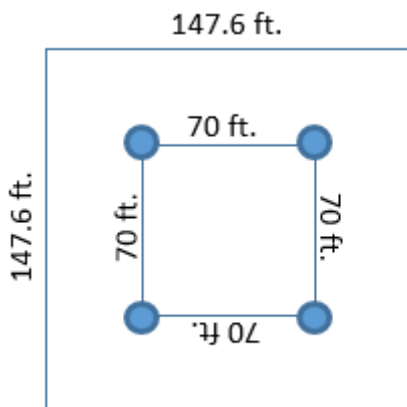

Dots represent bait stations.

Total coverage area is 21,780 sq. ft. for half-acre applications.

Place four stations roughly 70 feet from one another (a maximum of 9 grams per station for 4-station placement).]

NOTE: Bold, Italicized text is information for the reader and is not part of the label. [Bracketed information is optional text]. (Text in parenthesis is alternative). Text separated by "/" denotes and/or options.

Optional table for recommended application rate per station

[Application Rate Table

Maximum Grams of Bait per Station
Area in Square Feet (Acres)

Stations	4,356 ft ² (0.1 A)	10,890 ft ² (0.25 A)	14,519 ft ² (0.33 A)	21,780 ft ² (0.5 A)	29,040 ft ² (0.67A)	32,670 ft ² (0.75A)	43,560 ft ² (1A)
1	9.0 gm	9.0 gm	9.0 gm	9.0 gm	9.0 gm	9.0 gm	9.0 gm
2	4.5 gm	9.0 gm	9.0 gm	9.0 gm	9.0 gm	9.0 gm	9.0 gm
3	3.0 gm	7.1 gm	9.0 gm	9.0 gm	9.0 gm	9.0 gm	9.0 gm
4	██████	5.6 gm	7.5 gm	9.0 gm	9.0 gm	9.0 gm	9.0 gm
5	██████	4.4 gm	6.0 gm	9.0 gm	9.0 gm	9.0 gm	9.0 gm
6	██████	3.7 gm	5.0 gm	7.5 gm	9.0 gm	9.0 gm	9.0 gm
7	██████	3.2 gm	4.2 gm	6.4 gm	8.5 gm	9.0 gm	9.0 gm
8	██████	██████	3.7 gm	5.6 gm	7.5 gm	8.4 gm	9.0 gm
9	██████	██████	3.3 gm	5.0 gm	6.6 gm	7.5 gm	9.0 gm
10	██████	██████	3.0 gm	4.5 gm	6.0 gm	6.7 gm	9.0 gm

[Each gram of bait is roughly 1/5 of a teaspoon.]

[Application Rate Table

Acres	Maximum Area Bait in Grams	Maximum Number of Stations
0.1 (1/10)	9.0	3
0.25 (1/4)	22.5	7
0.33 (1/3)	30.0	10
0.5 (1/2)	45.0	15
0.66 (2/3)	60.0	20
0.75 (3/4)	67.5	22
1	90.0	30

[Each gram of bait is roughly 1/5 of a teaspoon.]

[5 Station Placement Example for Half Acre

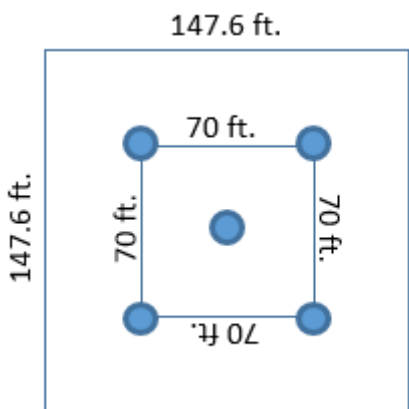

1

NOTE: Bold, italicized text is information for the reader and is not part of the label. [Bracketed information is optional text]. (Text in parenthesis is alternative). Text separated by "/" denotes and/or options.

STORAGE AND DISPOSAL

PESTICIDE STORAGE:

Store at room temperature and avoid extended exposure to heat. Store in a dry place. Always store pesticides in the original container. Store away from food and pet food.

PESTICIDE DISPOSAL AND CONTAINER HANDLING:

Syringe is not a refillable container. Do not reuse or refill this syringe.

If empty:

Place in trash or offer for recycling if available.

If partly filled:

Call your local solid waste agency for disposal instructions. Never place unused product down any indoor or outdoor drain.

[Storage and Disposal for non-refillable bulk containers for repacking into end use containers]

STORAGE AND DISPOSAL

Do not contaminate water, food, or feed by storage or disposal.

PESTICIDE STORAGE: Keep this product in its tightly closed original container when not in use.

Store at room temperature and avoid extended exposure to heat. Store in an area that is inaccessible to children and animals.

PESTICIDE DISPOSAL: Wastes resulting from the use of this product may be disposed of on site or at an approved waste disposal facility.

CONTAINER HANDLING: Non-refillable container. Do not reuse or refill this container. Triple rinse (or equivalent) and offer for recycling if available or reconditioning if appropriate, or puncture and dispose of in a sanitary landfill, or by other approved State and local procedures.

OPTIONAL WARRANTY STATEMENTS:

NOTICE: To the extent consistent with applicable law, buyer assumes all responsibility for safety and use not in accordance with directions.

[IMPORTANT: Read the entire Directions for Use, Conditions of Sale and Disclaimer of Warranties and Limitations of Liability before using this product.

CONDITIONS OF SALE: The directions for use of this product have been determined to be appropriate for the correct use of this product. This product has been tested under different environmental conditions similar to those that are ordinary and customary where the product is to be used. Insufficient control of pests or plant injury may result from the occurrence of extraordinary or unusual conditions, or from failure to follow label directions. In addition, failure to follow label directions may cause injury to animals, man and damage to the environment. Manufacturer and Seller offer, and the buyer accepts and uses, this product subject to the conditions that extraordinary or unusual environmental conditions, or failure to follow label directions are beyond the control of Manufacturer and Seller and are, therefore, the responsibility of the buyer.

LIMITED WARRANTY AND LIMITATION OF DAMAGES

Manufacturer and Seller warrant that this material conforms to the chemical description on the label. TO THE EXTENT CONSISTENT WITH APPLICABLE LAW, MANUFACTURER AND SELLER MAKE NO OTHER EXPRESS OR IMPLIED WARRANTY, INCLUDING ANY OTHER EXPRESS OR IMPLIED WARRANTY OF FITNESS OR MERCHANTABILITY, and no agent of Manufacturer or Seller is authorized to do so except in writing with a specific reference to this warranty. Any damages arising from a breach of this warranty shall be limited to direct damages and shall not include consequential commercial damages such as loss of profits or values, etc.]

NOTE: Bold, Italicized text is information for the reader and is not part of the label. [Bracketed information is optional text]. (Text in parenthesis is alternative). Text separated by “/” denotes and/or options.

Marketing Claims

General

New (for 6 months)
Clean, Odorless Bait
Clean, Effective and Easy to Use
Easy to use
For outdoor use in commercial, industrial and residential areas
Only attracts Yellowjackets / *Vespula* Spp.

Efficacy

Kills (Controls) Yellowjackets / *Vespula* Spp.
Effective bait against Yellowjackets / *Vespula* Spp.
Effective bait for Yellowjackets / *Vespula* Spp.
Kills (Controls) Yellowjacket / *Vespula* Spp.
Nests (Colonies) in structures
Kills (Controls) Yellowjacket / *Vespula* Spp.
Nests (Colonies)
Kills (Controls) Yellowjacket / *Vespula* Spp.
Nests (Colonies) in the ground
Effective [localized] control of Yellowjackets
Kills [Controls] Yellowjacket / *Vespula* Spp.
Nests (Colonies) within a quarter acre of the station
Controls Yellowjacket / *Vespula* Spp. Nests (Colonies) [even those] that cannot be located
For use all season long in controlling Yellowjacket / *Vespula* Spp. Nests (Colonies)
Kills hidden (unseen) Yellowjacket / *Vespula* Spp. Nests (Colonies)
Kills Yellowjacket/*Vespula* Spp. Nests (Colonies) you can't find (locate) (see)
Kills the [Yellowjacket / *Vespula* Spp.] queen
Collapses the entire Yellowjacket nest

Bait Transfer Claims

Horizontal transfer [of the bait] kills the colony (nest)
Foraging Yellowjackets transfer (take) the bait to the (nest) (colony) effectively killing the nest (colony) [including queens]
The yellowjackets feed on the bait and then take the bait back to kill the others in the

nest [colony]. There is no need to find or disturb the nest (colony) to destroy it.

Palatability

Yellowjacket bait provides long range olfactory cues, up to 350 ft.
Attracts Yellowjackets which then return to their nest (colony) and share the bait that kills the colony
Do not use this product for Paper Wasps, Baldfaced Hornets or Mud Daubers
Dual action – attracts and kills yellowjackets

Location Claims

For use in yards

Convenience Claims

Ideal for situations when the nest (colony) location is unknown or inaccessible
For nests (colonies) you can't find (locate) (see)

Optional Claims When Package Includes a Station

Easy to Use Station
[Convenient] Station can be placed or hung almost anywhere at least 4 feet off the ground.
[Refillable] Station can be used year after year
Refills available

Optional Claims When Package Does Not Include a Station

Must use a station with openings 16.5-24mm in diameter

Only attracts Yellowjackets.

How it Works

Bait is taken back and shared within the colony
Active ingredient is transferred throughout the colony