



U.S. ENVIRONMENTAL PROTECTION AGENCY
 Office of Pesticide Programs
 Registration Division (7505P)
 1200 Pennsylvania Ave., N.W.
 Washington, D.C. 20460

EPA Reg. Number:

1021-2793

Date of Issuance:

10/27/15

NOTICE OF PESTICIDE:

Registration
 Reregistration
 (under FIFRA, as amended)

Term of Issuance:

Conditional

Name of Pesticide Product:

MGK FORMULA 30643

Steven K. Ditto
 US Regulatory Affairs Manager
 McLaughlin Gormley King Company
 8810 Tenth Avenue North
 Minneapolis, MN 55427

Note: Changes in labeling differing in substance from that accepted in connection with this registration must be submitted to and accepted by the Registration Division prior to use of the label in commerce. In any correspondence on this product always refer to the above EPA registration number.

On the basis of information furnished by the registrant, the above named pesticide is hereby registered under the Federal Insecticide, Fungicide and Rodenticide Act.

Registration is in no way to be construed as an endorsement or recommendation of this product by the Agency. In order to protect health and the environment, the Administrator, on his motion, may at any time suspend or cancel the registration of a pesticide in accordance with the Act. The acceptance of any name in connection with the registration of a product under this Act is not to be construed as giving the registrant a right to exclusive use of the name or to its use if it has been covered by others.

This product is conditionally registered in accordance with FIFRA section 3(c)(7)(A). You must comply with the following conditions:

1. Submit and/or cite all data required for registration/reregistration/registration review of your product under FIFRA when the Agency requires all registrants of similar products to submit such data.

Signature of Approving Official:

Jennifer Urbanski, Ph.D., Product Manager 04
 Invertebrate & Vertebrate Branch 1
 Registration Division (7505P)
 Office of Pesticide Programs

Date:

10/27/15

2. You are required to comply with the data requirements described in the DCI identified below:

- a. Piperonyl Butoxide GDCI-067501-1063
- b. Clothianidin GDCI-044309-1185

You must comply with all of the data requirements within the established deadlines. If you have questions about the Generic DCI listed above, you may contact the Chemical Review Manager in the Pesticide Reevaluation Division: http://www.epa.gov/oppsrrd1/contacts_prd.htm

3. The data requirements for storage stability and corrosion characteristics (Guidelines 830.6317 and 830.6320) are not satisfied. A one year study is required to satisfy these data requirements. You have 18 months from the date of registration to provide these data.
4. Make the following label changes before you release the product for shipment:
 - Revise the EPA Registration Number to read, “EPA Reg. No. 1021-2793.”
5. Submit one copy of the final printed label for the record before you release the product for shipment.

Should you wish to add/retain a reference to the company’s website on your label, then please be aware that the website becomes labeling under the Federal Insecticide Fungicide and Rodenticide Act and is subject to review by the Agency. If the website is false or misleading, the product would be misbranded and unlawful to sell or distribute under FIFRA section 12(a)(1)(E). 40 CFR 156.10(a)(5) list examples of statements EPA may consider false or misleading. In addition, regardless of whether a website is referenced on your product’s label, claims made on the website may not substantially differ from those claims approved through the registration process. Therefore, should the Agency find or if it is brought to our attention that a website contains false or misleading statements or claims substantially differing from the EPA approved registration, the website will be referred to the EPA’s Office of Enforcement and Compliance.

If you fail to satisfy these data requirements, EPA will consider appropriate regulatory action including, among other things, cancellation under FIFRA section 6(e). Your release for shipment of the product constitutes acceptance of these conditions. A stamped copy of the label is enclosed for your records. Please also note that the record for this product currently contains the following CSFs:

- Basic CSF dated 01/22/2015

If you have any questions, you may contact Elizabeth Fertich at 703-347-8560 or via email at fertich.elizabeth@epa.gov.

MGK® Formula 30643

ACTIVE INGREDIENTS:

Clothianidin	0.40%
Metofluthrin	0.01%
Piperonyl Butoxide*	1.00%

OTHER INGREDIENTS:	98.59%
	100.00%

*(butylcarbityl) (6-propylpiperonyl) ether and related compounds

[Contains 0.3409 lb. of Clothianidin, 0.0085 lb. of metofluthrin and 0.8523 lb. of piperonyl butoxide per gallon]

[Crossfire is a trademark of Sumitomo Chemical Co., Ltd.]

ACCEPTED

Oct 27, 2015

Under the Federal Insecticide, Fungicide
and Rodenticide Act as amended, for the
pesticide registered under

EPA Reg. No. 1021-2793

KEEP OUT OF REACH OF CHILDREN

See attached booklet [inside label] [back panel] for additional precautionary statements
[and directions for use].

PRECAUCION AL CONSUMIDOR: Si usted no lee inglés, no use este producto hasta que la etiqueta le haya sido explicada ampliamente.
(**TO THE USER:** If you cannot read English, do not use this product until the label has been fully explained to you.)

HOT LINE NUMBER

Have the product container or label with you when calling a poison control center or doctor, or going for treatment. For information on this product (including health concerns, medical emergencies or pesticide incidents), you may call 1-888-740-8712.

Manufactured by:



8810 Tenth Avenue North
Minneapolis, MN 55427

EPA Reg. No. 1021-ETOG

EPA Est. No. 1021-MN-2

Net Contents:

PRECAUTIONARY STATEMENTS HAZARDS TO HUMANS AND DOMESTIC ANIMALS

Wash thoroughly with soap and water after handling and before eating, drinking, chewing gum, using tobacco or using the toilet.

PERSONAL PROTECTIVE EQUIPMENT (PPE)

Applicators and other handlers must wear:

- Long-sleeved shirt
- Long pants, and
- Shoes and socks

User Safety Requirements

- Follow manufacturer's instructions for cleaning/maintaining PPE. If no such instructions for washables exist, use detergent and hot water. Keep and wash PPE separately from other laundry.
- Discard clothing and other absorbent materials that have been drenched or heavily contaminated with the product. Don't reuse them.

User Safety Recommendations

- **Users should wash hands before eating, drinking, chewing gum, using tobacco, or using the toilet.**
- **Users should remove clothing PPE immediately if pesticide gets inside. Then wash thoroughly and put on clean clothing.**

PHYSICAL AND CHEMICAL HAZARDS

Do not apply this product in, on or around electrical equipment due to the possibility of shock hazard.

DIRECTIONS FOR USE

It is a violation of Federal Law to use this product
in a manner inconsistent with its labeling.

READ ENTIRE LABEL. USE STRICTLY IN ACCORDANCE WITH PRECAUTIONARY STATEMENTS AND DIRECTIONS AND WITH APPLICABLE STATE AND FEDERAL REGULATIONS.

SHAKE WELL BEFORE EACH USE

A READY TO USE INSECTICIDE SPRAY FOR INDOOR USE ONLY

MGK® FORMULA 30643[PRODUCT NAME] is the next generation insecticide which effectively kills Bed Bugs in both residential and commercial buildings and structures. **MGK® FORMULA 30643**'s [Product name] patent pending technology provides residual control for up to four weeks after application and is scientifically formulated to target [pyrethroid, wild and or field] **resistant** as well as susceptible **Bed Bug strains**. **MGK® FORMULA 30643** [PRODUCT NAME] also kills **Bed Bug Nymphs and Eggs** by contact. Apply **MGK® FORMULA 30643** [PRODUCT NAME] as an indoor crack and crevice, or direct spray application [according to application instructions] in non-food areas including: hotels, shelters, modes of transportation, restaurants, schools, nursing homes, warehouses, offices, apartments, motels, kennels, and hospitals. **MGK® FORMULA 30643** [PRODUCT NAME] is an easy to use product for application with hand-held, or backpack sprayers. This product will not stain water-safe fabrics or surfaces, however care should be taken to test an inconspicuous area for staining prior to use.

TO KILL BED BUGS (Adults, Nymphs and Eggs): For best results, vacuuming surfaces is recommended prior to treatment. Spray bed bugs and eggs directly wherever possible. Apply as a pinstream, coarse spray or low pressure spray for crack and crevice, carpet perimeter, and direct spray applications in and around non-food areas where bed bugs and their eggs may hide or harbor. For example, on and around baseboards, floorboards, millwork, bed frames, headboards, wall hangings, furniture, door and window frames, walls, closets, window treatments, beneath floor coverings, as well as other non-washable items that may come in contact with bed bugs such as luggage, shoes and backpacks. If treating a pet's living environment, spray on and around pet beds, bedding, floors, sleeping areas and furnishings. This product can also be applied with a paintbrush to walls, baseboards, floorboards, behind wall hangings and other similar areas.

MATTRESS APPLICATION: **MGK® FORMULA 30643** [PRODUCT NAME] can be directly applied to mattress and box springs surfaces. For porous surfaces such as mattresses and carpet perimeter areas, apply until thoroughly damp but not wet. Infested bed linens should not be treated. These should be removed, tightly sealed in a plastic bag, laundered and dried at high temperatures prior to re-use. Vacuuming surfaces prior to treatment is highly recommended. Using pinstream, coarse or low pressure equipment, spray directly to mattress surface paying special attention to seams, folds, tufts and edges as well as bed frames and box springs where bed bugs harbor. Re-make bed with clean linens prior to reuse.

USE RESTRICTIONS

- THIS PRODUCT IS NOT FOR USE ON HUMANS OR ANIMALS
- Do not spray product directly on pets.
- Not for broadcast use.
- Do not use in commercial food/feed processing, preparation, food/feed storage or serving areas.
- In the home, all food/feed processing surfaces and utensils should be covered during treatment, or thoroughly washed before use. Cover or remove exposed food/feed.
- Remove pets, birds and cover fish aquariums before spraying.
- This product will not stain water-safe fabrics and surfaces, however care should be taken to test an inconspicuous area for staining prior to use.
- DO NOT allow adults, children or pets to enter treated area until sprays are dry
- DO NOT apply to plants or crops
- DO NOT treat areas when occupants are present
- DO NOT apply as a space spray
- DO NOT wet articles to the point of runoff or drip
- DO NOT use treated articles until spray has dried

Directions For Use Options Based On Applicator

Option 1 – for Manual spray container

[HOW TO APPLY/USE: *[Placeholder for pictograms depicting bulleted items below]*

- Hold with applicator aimed away from you.
- Spray surfaces from a distance of 8 to 10 inches until slightly damp.]

STORAGE AND DISPOSAL

Do not contaminate water, food, or feed by storage and disposal.

PESTICIDE STORAGE: Protect from freezing. Always store this pesticide product in the original container. Store in a cool, dry (preferably locked) place that is inaccessible to children and animals, and in a safe area away from food and pet food.

PESTICIDE DISPOSAL AND CONTAINER HANDLING: Non-refillable container. Do not reuse or refill this container.

If empty: Place in trash or offer for recycling if available.

If partly filled: Call your local solid waste agency for disposal instructions. Never place unused product down any indoor or outdoor drain.

End of Option 1

Option 2 – for Trigger Sprayer [Applicator Name]

[[Applicator Name] [Applicator/Sprayer] Directions]

[HOW TO APPLY/USE: *[Placeholder for pictograms depicting bulleted items below.]*

- Turn sprayer nozzle to open.
- Adjust sprayer nozzle as desired. [Set sprayer to a coarse spray.]
- Hold 8 to 10 inches from the surface to be sprayed.
- Spray surface until slightly damp.]

STORAGE AND DISPOSAL

Do not contaminate water, food, or feed by storage and disposal.

PESTICIDE STORAGE: [Small 32 fl. oz. Container or smaller] [Applicator Name] Rotate nozzle to closed position, -OR- Turn sprayer nozzle to "OFF [X]. Protect from freezing. Always store this pesticide product in the original container. Store in a cool, dry (preferably locked) place that is inaccessible to children and animals, and in a safe area away from food and pet food.

PESTICIDE DISPOSAL AND/CONTAINER HANDLING: Non-refillable container. Do not reuse or refill this container.

If empty: Place in trash or offer for recycling if available.

If partly filled: Call your local solid waste agency for disposal instructions. Never place unused product down any indoor or outdoor drain.

PESTICIDE STORAGE: Greater than 32 fl. oz.] [Applicator Name] Place trigger sprayer under handle on container to keep sprayer above the level of contents. Protect from freezing. Always store this pesticide product in the original container. Store in a cool, dry (preferably locked) place that is inaccessible to children and animals, and in a safe area away from food and pet food.

PESTICIDE DISPOSAL AND CONTAINER HANDLING: Non-refillable container. Do not reuse or refill this container.

If empty: Place in trash or offer for recycling if available.

If partly filled: Call your local solid waste agency for disposal instructions. Never place unused product down any indoor or outdoor drain.

End of Option 2

[Option 3] Quick Connect Trigger [Applicator Name]

[[Applicator Name] [Applicator/Sprayer] Directions]

Quick Connect Sprayer [1. Pull sprayer from bottle. 2. Pull [color] hose connector and coil from sprayer handle. 3. Insert hose connector into [color] spout on cap [until it clicks] into place. 4. Flip up spout. Turn sprayer nozzle to open, and [pull trigger to] spray.]

or

Quick Connect Sprayer [1. Remove sprayer. Pull cord ALL THE WAY OUT. 2. Insert [color] plug into spout [on cap] [until it clicks].]3. [Flip up spout.] Open nozzle at end of sprayer and pull trigger to spray.]

Note to PM: Illustrations may be associated with each step.

[HOW TO APPLY/USE: [Placeholder for pictograms depicting the bulleted items below]

- Turn sprayer nozzle to open.
- Adjust sprayer nozzle as desired. [Set sprayer to a coarse spray.]
- Hold 8 to 10 inches from the surface to be sprayed.
- Spray surface until slightly damp.]

STORAGE AND DISPOSAL

Do not contaminate water, food, or feed by storage and disposal.

PESTICIDE STORAGE: [Applicator Name] Flip down spout to close. No need to disconnect trigger sprayer. Close nozzle on trigger sprayer [Turn sprayer nozzle to "OFF"[X]. Snap sprayer back in place. Protect from freezing. Always store this pesticide product in the original container. Store in a cool, dry (preferably locked) place that is inaccessible to children and animals, and in a safe area away from food and pet food.

PESTICIDE DISPOSAL AND CONTAINER HANDLING: Non-refillable container. Do not reuse or refill this container.

If empty: Place in trash or offer for recycling if available.

If partly filled: Call your local solid waste agency for disposal instructions. Never place unused product down any indoor or outdoor drain.

End of Option 3

Option 4 – Pull ‘N Spray II

[[Applicator Name] [Applicator/Sprayer] Directions]

[Illustration #1: Pictograms depicting bulleted actions below]

- Remove sprayer from side carrier and unwrap hose completely.
- Insert [color of plug] plug at end of hose into [color of spout] spout on cap [until it clicks.]
- [Flip up spout]. Spout must remain up while spraying.

[Illustration #2 Pictograms depicting bulleted actions below]

- Twist nozzle at end of sprayer to desired spray pattern.

[Illustration #3, Pictograms depicting the bulleted actions below]

- Point sprayer away from body.
- Grasp sprayer by the handle.
- Slowly pull ring at bottom of sprayer handle until it stops and hold for two (2) seconds to ready the sprayer.

[Illustration #4, Pictograms depicting the bulleted actions below]

- Press and hold button on sprayer to begin spraying.
- Pull ring at sprayer bottom again as needed to continue spraying.

[HOW TO APPLY/USE: [Placeholder for pictograms depicting the bulleted actions below]

- Follow illustrations and instructions above.
- Twist nozzle at end of sprayer to desired spray pattern.
- Point sprayer away from body and press sprayer button to begin spraying.
- Pull ring at sprayer bottom again as needed to continue spraying.
- Hold 8 to 10 inches from the surface to be sprayed.
- Spray surface until slightly damp.]

Optional Refill [and Reuse] Directions

[The Pull 'N Spray II/Applicator Name [applicator/wand] may be reused with the available MGK® FORMULA 30643/Product Name refill bottle/container. Read and follow instructions in Reuse Directions to reuse the applicator.] --OR--

[REFILL: This container may be refilled with MGK® FORMULA 30643 / product name. To refill pour MGK® FORMULA 30643 / product name into container.]

Refill [and Reuse] Directions

How to attach the [Pull 'N Spray II/Applicator Name] [applicator/wand] to MGK® FORMULA 30643 / product name [refill bottle]:

Removing [Pull 'N Spray II/Applicator Name] [applicator] from original bottle:

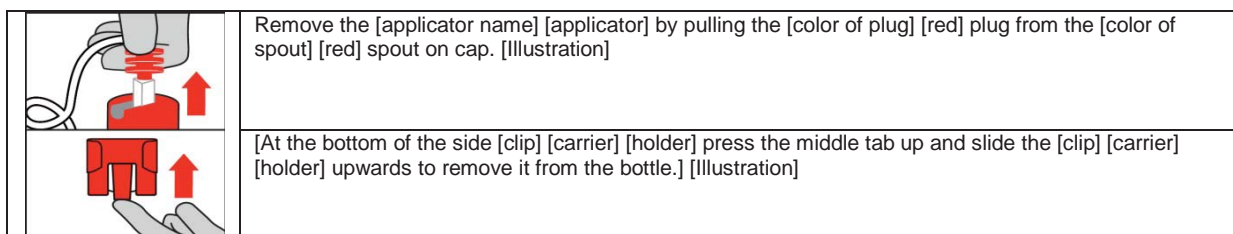

Adding [Pull 'N Spray II/Applicator Name] [applicator] to MGK® FORMULA 30643 /Product Name:

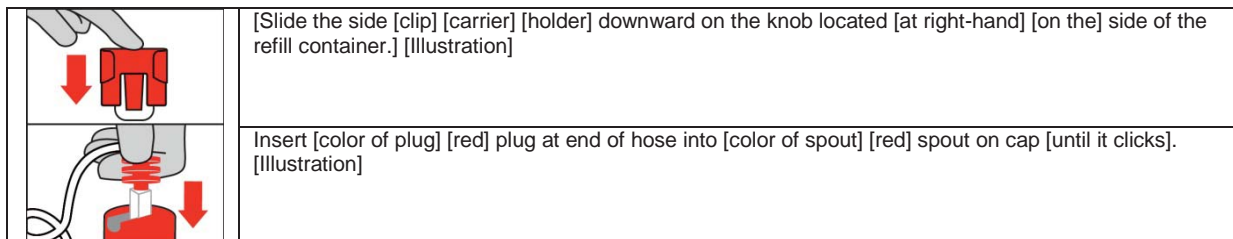

STORAGE AND DISPOSAL

Do not contaminate water, food, or feed by storage and disposal.

PESTICIDE STORAGE: [Pull 'N Spray II/Applicator Name] [Applicator]: Completely discharge/dispense product in sprayer prior to storage. Flip down [color of spout] spout on cap. **DO NOT DISCONNECT SPRAYER HOSE FROM CAP.** Place sprayer back inside carrier on bottle with the nozzle facing down. Protect from freezing. Always store this pesticide product in the original container. Store in a cool, dry (preferably locked) place that is inaccessible to children and animals, and in a safe area away from food and pet food.

PESTICIDE DISPOSAL AND CONTAINER HANDLING[Refillable Containers]: Refillable container. Refill this with MGK Formula 30643 [Product Name] only. Do not reuse this container for any other purpose. Pull 'N Spray II/Applicator Name can be reused with MGK® FORMULA 30643/Product Name refill bottle/container. Follow instructions in the Reuse Directions when reusing [applicator name].

If empty: Place in trash or offer for recycling if available.

If partly filled: Call your local solid waste agency for disposal instructions. Never place unused product down any indoor or outdoor drain.

PESTICIDE DISPOSAL AND CONTAINER HANDLING[Non-Refillable Containers]:

Non refillable Container: Do not reuse or refill this container:

If empty: Place in trash or offer for recycling if available.

If partly filled: Call your local solid waste agency for disposal instructions. Never place unused product down any indoor or outdoor drain.

End of Option 4

Option 5 – Comfort Wand [Applicator Name]

[[Applicator Name] [Applicator/Wand] Directions]

[1. Remove] Remove [applicator name] Wand from side [holder/clip] [Illustration #1&2]

- [Unwrap hose completely]
- [Remove protective strip from battery compartment to activate batteries]

[2. Connect] Insert [color of plug] plug at end of hose into [color of spout] spout on cap [until it clicks. Flip up spout.] [Spout must remain up while spraying] [Illustration #3]]

[3. Extend] Flip open [applicator name] wand until it locks into position [Illustration #4]

[4. Spray] Twist nozzle at end of [applicator name] wand to desired spray pattern. [Ensure trigger lock is disengaged before spraying.] Hold [color of trigger] trigger for continuous spray. [Illustration #5]

[HOW TO APPLY/USE: [icon]

- Follow illustrations and instructions above.
- Twist nozzle at end of [applicator name] wand to desired spray pattern.
- Point [applicator name] wand away from body and Hold [color of trigger] trigger for continuous spray.
- Release trigger to stop spray.
- Hold 8 to 10 inches from the surface to be sprayed.
- Spray surface until slightly damp.]

[After Use: twist nozzle to OFF position. [Engage trigger lock.] Flip the [applicator name] wand closed and store on the side [holder/clip].]

Important Use Information: Do not submerge in water. When storing sprayer for long periods, remove batteries.

To replace batteries: Open battery compartment at bottom of [applicator name] wand. Remove used batteries and replace with four new AA batteries in correct position as marked per diagram inside battery compartment. Securely close battery compartment door. Always use a complete set of the same type when replacing batteries. Never mix alkaline, carbon-zinc or rechargeable batteries.

Optional Refill [and Reuse] Directions

[The Comfort Wand/Applicator Name [applicator/wand] may be reused with MGK® FORMULA 30643/Product Name refill bottle/container. Read and follow instructions in Reuse Directions to reuse the applicator.] --OR--

[REFILL: This container may be refilled with MGK® FORMULA 30643 / product name. To refill pour MGK® FORMULA 30643 / product name into container.]



Refill [and Reuse] Directions

How to attach the [Comfort Wand/Applicator Name] [applicator/wand] to MGK® FORMULA 30643 /Product name [refill bottle]:

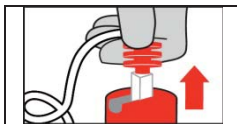
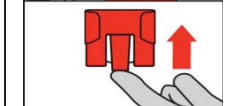
Removing [Comfort Wand/Applicator Name] [applicator] from original bottle:

	<p>Remove the [applicator name] [applicator] by pulling the [color of plug] [red] plug from the [color of spout] [red] spout on cap. [Illustration]</p>
	<p>[At the bottom of the side [clip] [carrier] [holder] press the middle tab up and slide the [clip] [carrier] [holder] upwards to remove it from the bottle.] [Illustration]</p>

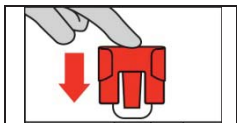
Adding [Comfort Wand/Applicator Name] [applicator] to MGK® FORMULA 30643 /Product Name:

	<p>[Slide the side [clip] [carrier] [holder] downward on the knob located [at right-hand] [on the] side of the refill container.] [Illustration]</p>
	<p>Insert [color of plug] [red] plug at end of hose into [color of spout] [red] spout on cap [until it clicks]. [Illustration]</p>

STORAGE AND DISPOSAL

Do not contaminate water, food, or feed by storage and disposal.

PESTICIDE STORAGE: [Applicator Name] [Applicator]: Flip down (color of spout) spout on cap. NO NEED TO DISCONNECT SPRAYER HOSE FROM CAP. Completely discharge/dispense product in sprayer prior to storage. Twist sprayer nozzle to the OFF position. [Engage trigger lock.]. Flip the [applicator name] wand closed and place [sprayer] back inside carrier [clip] [holder]. Protect from freezing. Always store this pesticide product in the original container. Store in a cool, dry (preferably locked) place that is inaccessible to children and animals, and in a safe area away from food and pet food.

PESTICIDE DISPOSAL AND CONTAINER HANDLING[Refillable Containers]: Reusable container. Refill this container with MGK Formula 30643 [product name] only. Do not reuse this container for any other purpose. Comfort Wand /Applicator Name can be reused with MGK® FORMULA 30643 /Product Name refill bottle/container. Follow instructions in Reuse Directions when reusing [applicator name].

If empty: Place in trash or offer for recycling if available.

If partly filled: Call your local solid waste agency for disposal instruction. Never place unused product down any indoor or outdoor drain.

PESTICIDE DISPOSAL AND CONTAINER HANDLING[Non-refillable Containers]:

Non refillable Container: Do not reuse or refill this container:

If empty: Place in trash or offer for recycling if available.

If partly filled: Call your local solid waste agency for disposal instructions. Never place unused product down any indoor or outdoor drain

End of Option 5

Option 6 – EZ Sprayer [Pump 'n Go] [Applicator Name]

[[Applicator Name] [Applicator] Directions]

CUT [Illustration # 1, Pictograms depicting action #1 below]

1. Carefully cut the two [enter color] [white] zip ties securing the hose and pump handle with scissors. Use caution not to cut the [enter color] [white] hose.

CONNECT [Illustration #2, Pictograms depicting actions below]

2. Unwind hose. Firmly push the connector at the end of the hose onto the spout on the pump, until it locks into place.

EXTEND WAND [Illustration #3, Pictograms depicting actions below]

3. Lift sprayer wand off bottle. Push [enter color] [yellow] button while pulling out on the wand nozzle tip. Fully extend wand until [enter color] [yellow] button snaps into SPRAY position. NOTE: [White] [color of] trigger will not function until wand is fully extended and [enter color] yellow button is visible in the spray position.

PUMP [Illustration # 4, Pictograms depicting actions below]

4. [Make sure handle is screwed on TIGHTLY or the bottle will not pressurize.] Pump container 10-20 [X-X] times to pressurize bottle. A full bottle requires fewer pumps than an empty bottle. Pumping to the higher range will provide longer spray duration. After pumping, push pump down and turn handle clockwise to lock into carrying position. NOTE: This bottle is designed to expand under pressure and cannot be over-pressurized.

SPRAY [Illustration # 5, Pictograms depicting actions below]

5. Aim wand. Spray by pushing down [enter color] [white] trigger with thumb. Adjust spray pattern by rotating [enter color] [white] nozzle tip up to one-half rotation.

STORE [Illustration # 6, Pictograms depicting actions below]

6. When finished spraying, push the [enter color] [yellow] button and push the wand until the [enter color] [yellow] button snaps back into the original storage position. Place wand back onto the bottle with nozzle facing down.

DEPRESSURIZE [Illustration # 7, Pictograms depicting actions below]

7. Push pump handle all the way down and turn pump handle and cap counter-clockwise to relieve pressure, then retighten prior to storing.

Option 7 – Other Pump Style [Quick Pump] [Applicator Name]

[[Applicator Name] [Applicator] Directions]

[1.] TO USE

Remove wand from holster and pull the hose from the storage compartment. Turn the pump handle clockwise to make sure the pump is tight [and push the pop-up pressure indicator completely down] before pumping. [illustration #1. Pictograms depicting actions in item 1]

[2.] TO PUMP

Turn the pump handle clockwise [one-quarter turn] to release the handle. Pump the sprayer [until the pressure indicator pops up about an inch]. [That's your signal you are ready to spray.] Turn the pump handle counterclockwise [one-quarter turn] to secure the handle for carrying. [illustration #2, Pictograms depicting actions in item 2 above]

[3.] TO SPRAY

Begin spraying by pushing the lever on the spray handle down. Rotate the nozzle at the tip of the wand to adjust spray from a stream to gentle mist. For continuous spraying, push the lever down and slide forward to lock. Pull back to release. Hold 8 to 10 inches from the surface to be sprayed. Spray surface until slightly damp. [illustration #3, Pictograms depicting actions in item 3 above]

[4.] TO STORE

Slowly turn the pump handle counterclockwise to untighten and release pressure, then turn back clockwise to retighten the handle. Push the hose back into the storage compartment and put the wand back in holster. [illustration #4, pictograms depicting actions in item 4. Above.]

[HOW TO APPLY/USE: [icon, pictograms depicting bulleted items below]

- Follow illustrations and instructions above.
- Point [applicator name] away from body Release trigger to stop spray.
- Hold 8 to 10 inches from the surface to be sprayed.
- Spray surface until slightly damp.]





Optional Refill [and Reuse] Directions

[This product is also available for sale in a refill bottle/container. Read and follow instructions in the Refill Directions to refill the original container with the Quick Pump/Applicator Name [applicator]. Do not refill this bottle/container with any other product. Wear protective clothing as directed in Precautionary Statements when refilling this bottle/container.] --OR--

[REFILL: This container may be refilled with MGK® FORMULA 30643 / product name. To refill pour MGK® FORMULA 30643 / product name into container.]

Refill [and Reuse] Directions

How to refill MGK® FORMULA 30643 /Product Name with [Quick Pump/Applicator Name] [applicator]:

	Remove the pump handle on the Quick Pump/Applicator Name by twisting it counterclockwise. [Illustration]
	Remove the cap from the MGK® FORMULA 30643 / Product Name bottle/container. [Illustration]
	Pour the product carefully and directly into the Quick Pump/Applicator Name container. Do Not fill above 2 2/3 3/4" from the top of the container. DO NOT add water. [Illustration]
	Secure the pump handle back on the container by twisting it clockwise until tight. [Illustration]

STORAGE AND DISPOSAL

Do not contaminate water, food, or feed by storage and disposal.

PESTICIDE STORAGE: Protect from freezing. Always store this pesticide product in the original container. Store in a cool, dry (preferably locked) place that is inaccessible to children and animals, and in a safe area away from food and pet food.

PESTICIDE DISPOSAL AND CONTAINER HANDLING [Non-Refillable Containers]: Non-Refillable Container. Do not reuse or refill this container.

If empty: Place in trash or offer for recycling if available.

If partly filled: Call your local solid waste agency for disposal instructions. Never place unused product down any indoor or outdoor drain.

PESTICIDE DISPOSAL AND CONTAINER HANDLING [Refillable Containers]:

Refillable container. Refill this container with MGK Formula 30643 [product name] only. Do not reuse this container for any other purpose.

If empty: Place in trash or offer for recycling if available.

If partly filled: Call your local solid waste agency for disposal instructions. Never place unused product down any indoor or outdoor drain.

End of Options 6 and 7

Optional Trouble Shooting Section for [Battery Powered Wand] [Comfort Wand] [Comfort Shot Wand] [Pump 'N Go] [EZ Sprayer] [Applicator name]

Troubleshooting Tips:

Problem: Sprayer does not spray [function].

Possible Cause: Batteries not installed properly.

Solution: See instructions for correct battery placement.

Problem: Sprayer makes a straining noise [Sprayer runs but nothing [no product] comes out].

Possible Cause: Nozzle is turned Off.

Solution: Turn nozzle to (desired) spray setting [position].

Possible Cause: [Red] [color] plug at end of hose is not flipped up.

Solution: Insert [color of plug] plug at end of hose into [color of spout] spout on cap [until it clicks and flip up spout.]

Possible Cause: Sprayer is not primed.

Solution: Press and hold button on sprayer for about [X] (10/ 15/ 20/ 30) seconds to prime the sprayer.

DISCLAIMER, RISKS OF USING THIS PRODUCT, LIMITED WARRANTY AND LIMITATION OF LIABILITY

IMPORTANT: Read the entire Label including this Disclaimer, Risks of Using this Product, Limited Warranty, and Limitation of Liability before using this product. If the terms are not acceptable THEN DO NOT USE THE PRODUCT.

RISKS OF USING THIS PRODUCT The Buyer and User (referred to collectively herein as "Buyer") of this product should be aware that there are inherent unintended risks associated with the use of this product which are impossible to eliminate. These risks include, but are not limited to lack of control of the target pests, resistance of the target pest to this product, injury caused by drift. Such risks of non-performance, resistance or other unintended consequences are unavoidable and may result because of such factors as presence of other materials either applied in the tank mix with this product or prior to application of this product, cultural practices or the manner of use or application, (or a combination of such factors) all of which are factors beyond the control of MGK. The Buyer should be aware that these inherent unintended risks may impact the effectiveness of this product. If the Buyer chooses not to accept these risks, THEN THIS PRODUCT SHOULD NOT BE APPLIED. By applying this product Buyer acknowledges and accepts these inherent unintended risks AND TO THE FULLEST EXTENT ALLOWED BY LAW, AGREES THAT ALL SUCH RISKS ASSOCIATED WITH THE APPLICATION AND USE ARE ASSUMED BY THE BUYER. MGK shall not be responsible for losses or damages (including, but not limited to incidental, consequential or special damages that may be claimed) resulting from use of this product in any manner not set forth on the label. Buyer assumes all risks associated with the use of this product in any manner or under conditions not specifically directed or approved on the label.

LIMITED WARRANTY warrants only that this product conforms to the chemical description on the label and is reasonably fit for the purposes stated in the label, under average use conditions, when used strictly in accordance with the label and subject to the Risks of Using This Product as described above. To the extent consistent with applicable law AND AS SET FORTH ABOVE, MGK MAKES NO OTHER WARRANTIES, EITHER EXPRESSED OR IMPLIED. No agent or representative of MGK or Seller is authorized to make or create any other express or implied warranty.

LIMITATION OF LIABILITY To the fullest extent allowed by law, MGK or Seller is not liable for any incidental, consequential, indirect or special damages resulting from the use or handling of this product. The limitation includes, but is not limited to increased finance charges or altered finance ratings, emotional or mental distress and/or exemplary damages. TO THE FULLEST EXTENT ALLOWED BY LAW, THE EXCLUSIVE REMEDY OF THE BUYER, AND THE EXCLUSIVE MAXIMUM LIABILITY OF MGK OR SELLER FOR ANY AND ALL CLAIMS, LOSSES, INJURIES OR DAMAGES (INCLUDING CLAIMS BASED ON BREACH OF WARRANTY, CONTRACT, NEGLIGENCE, TORT, STRICT LIABILITY OR OTHERWISE) RESULTING FROM THE USE OR HANDLING OF THIS PRODUCT SHALL BE THE RETURN OF THE PURCHASE PRICE OF THIS PRODUCT OR, AT THE ELECTION OF MGK OR SELLER, THE REPLACEMENT OF THE PRODUCT.

PROMPT NOTICE OF CLAIM To the extent consistent with applicable law allowing such requirements MGK must be provided Product Name/Label Number/Page # notice as soon as Buyer has reason to believe it may have a claim, but in no event later than twenty-one days from date of application, so that an immediate inspection of the affected property can be made. To the extent consistent with applicable law if Buyer does not notify MGK of any claims, in such period, it shall be barred from obtaining any remedy.

NO AMENDMENTS MGK and Seller offer this product, and Buyer accepts it, subject to the foregoing Disclaimer, Risks of Using This Product, Limited Warranty and Limitation of Liability, which may not be modified by any oral or written agreement.

[Or alternate text]

[IMPORTANT: READ BEFORE USE

Read the entire Directions for Use, Conditions, Disclaimer of Warranties and Limitations of Liability before using this product. If terms are not acceptable, return the unopened product container at once.

By using this product, user or buyer accepts the following conditions, disclaimer of warranties and limitations of liability.

CONDITIONS: The directions for use of this product are believed to be adequate and must be followed carefully. However, it is impossible to eliminate all risks associated with the use of this product. Ineffectiveness or other unintended consequences may result because of such factors as weather conditions, presence of other materials, or the manner of use or application, all of which are beyond the control of MGK. All such risks shall be assumed by the user or buyer.

DISCLAIMER OF WARRANTIES: TO THE EXTENT CONSISTENT WITH APPLICABLE LAW, MGK MAKES NO OTHER WARRANTIES, EXPRESS OR IMPLIED, OF MERCHANTABILITY OR OF FITNESS FOR A PARTICULAR PURPOSE OR OTHERWISE, THAT EXTEND BEYOND THE STATEMENTS MADE ON THIS LABEL. No agent of MGK is authorized to make any warranties beyond those contained herein or to modify the warranties contained herein. To the extent consistent with applicable law, MGK disclaims any liability whatsoever for special, incidental or consequential damages resulting from the use or handling of this product.

LIMITATIONS OF LIABILITY: TO THE EXTENT CONSISTENT WITH APPLICABLE LAW, THE EXCLUSIVE REMEDY OF THE USER OR BUYER FOR ANY AND ALL LOSSES, INJURIES OR DAMAGES RESULTING FROM THE USE OR HANDLING OF THIS PRODUCT, WHETHER IN CONTRACT, WARRANTY, TORT, NEGLIGENCE, STRICT LIABILITY OR OTHERWISE, SHALL NOT EXCEED THE PURCHASE PRICE PAID, OR AT MGK'S ELECTION, THE REPLACEMENT OF PRODUCT.]

[Or alternate text]

[Note [Notice]: Seller warrants that this product complies with the specifications expressed in this label. To the extent consistent with applicable law, seller makes no other warranties, and disclaims all other warranties, express or implied, including but not limited to warranties of merchantability and fitness for the intended purpose. To the extent consistent with applicable law, seller's liability or default, breach or failure under this label shall be limited to the amount of the purchase price. To the extent consistent with applicable law, seller shall have no liability for consequential damages.]

[Or alternate text]

[Notice: To the extent consistent with applicable law, buyer assumes all responsibility for safety and use not in accordance with directions.]

[Or alternate text]

[NOTICE TO USER

To the fullest extent permitted by law, seller makes no warranty, express or implied, of merchantability, fitness or otherwise concerning the use of this product other than as indicated on the label. User assumes all risks of use, storage or handling not in strict accordance with accompanying directions.]

[] Denotes alternate text in addition to any sub-set of the directions for use.

OPTIONAL MARKETING CLAIMS:

NOTE: Bold, Italicized text is information for the reader and is not part of the label. Information in [brackets] or (parentheses) is optional text. Text separated by “/” denotes and/or options.

Note to PM: When qualified claims are used on the market label, the qualifying statement will appear in close proximity to the claim when it does not impact any mandatory language.

- *[Kills Bed Bugs and Bed Bug Eggs*
- *Scientifically formulated to kill Pyrethroid-resistant and or Field and or Wild Bed Bug Strains*
- *Kills all bed bug life stages by Contact*
- *Kills and or Controls and or Targets Adult and Nymphs Bed Bug Life Stages*
- *Kills and or Targets all Bed Bug Life Stages: Adults, Nymphs and Eggs*
- *Kills Bed Bugs on unpainted wood surfaces for up to 4 weeks*
- *Reduces and or Prevents pyrethroid-resistant and susceptible Bed Bug egg hatch*
- *Residual Control and or Kill for up to 4 weeks or 30 days or 1 month.*
- *Effectively controls Bed Bugs for up to 30 days Post or After Application on unpainted wood surfaces.*
- *Direct contact provides kill in only 5 minutes*
- *Patent Pending Technology*
- *Recommended for use by Pest Control Operators or Pest Management Professionals or Commercial Applicators*
- *For use in Residential, Institutional and Commercial Facilities*
- *Approved for direct application on or onto mattresses*
- *Use as part of your existing bed bug control program*
- *Non-staining*
- *No visible residue*
- *Low odor*
- *Non-Repellent*
- *water-based formula*
- *Blend of active ingredients to control and or kill pyrethroid resistant bed bugs]*