



OFFICE OF CHEMICAL SAFETY AND POLLUTION PREVENTION

WASHINGTON, D.C. 20460

July 11, 2024

Stephanie Stephens
Principal Scientist
Agent for Douglas Products
Exponent, Inc.
1150 Connecticut Ave NW
Suite 1100
Washington, D.C., 20036

Subject: Label Amendment –EPA’s Sulfuryl Fluoride Revised Mitigation and Response to
Comments on the Draft Interim Re-Entry Mitigation Measures
Product Name: Vikane
EPA Registration Number: 1015-78
Application Date: November 20, 2023
Decision Number: 594714

Dear Stephanie Stephens:

The amended label referred to above, submitted in connection with registration under the Federal Insecticide, Fungicide, and Rodenticide Act, as amended, is acceptable. This approval does not affect any conditions that were imposed on this registration. You continue to be subject to existing conditions on your registration and any deadlines connected with them.

A stamped copy of your labeling is enclosed for your records. This labeling supersedes all previously accepted labeling and must be used at your next label printing. You must submit one copy of the final printed labeling before you release the product for shipment with the new labeling. In accordance with 40 CFR 152.130(c), you may distribute or sell this product under the previously approved labeling for 12 months from the date of this letter. After 12 months, you may only distribute or sell this product if it bears this new revised labeling or subsequently approved labeling. “To distribute or sell” is defined under FIFRA section 2(gg) and its implementing regulation at 40 CFR 152.3.

Should you wish to add/retain a reference to the company’s website on your label, then please be aware that the website becomes labeling under the Federal Insecticide, Fungicide, and Rodenticide Act and is subject to review by the Agency. If the website is false or misleading, the

product would be misbranded and unlawful to sell or distribute under FIFRA section 12(a)(1)(E). 40 CFR 156.10(a)(5) list examples of statements EPA may consider false or misleading. In addition, regardless of whether a website is referenced on your product's label, claims made on the website may not substantially differ from those claims approved through the registration process. Therefore, should the Agency find or if it is brought to our attention that a website contains false or misleading statements or claims substantially differing from the EPA approved registration, the website will be referred to the EPA's Office of Enforcement and Compliance Assurance.

Your release for shipment of the product constitutes acceptance of these conditions. If these conditions are not complied with, the registration will be subject to cancellation in accordance with FIFRA section 6.

If you have any questions about this letter, please contact Moana Appleyard by phone at (202) 566-2220, or via email at appleyard.moana@epa.gov.

Sincerely,

A handwritten signature in dark ink, appearing to read "Kevin Costello", is positioned above the typed name and title.

Kevin Costello, Branch Chief
Risk Management and Implementation Branch 2
Pesticide Re-Evaluation Division
Office of Pesticide Programs

ENCLOSURE: Stamped label

Specimen Label

RESTRICTED USE PESTICIDE DUE TO INHALATION TOXICITY

For sale to and use only by Certified Applicators or persons under their direct supervision and only for those uses covered by the Certified Applicator's certification.

SULFURYL FLUORIDE

GROUP

8C

INSECTICIDE



ACCEPTED

Jul 11, 2024

Under the Federal Insecticide, Fungicide
and Rodenticide Act as amended, for the
pesticide registered under
EPA Reg. No. 1015-78

SPECIALTY GAS FUMIGANT

®Trademark of Douglas Products and Packaging Company ("Douglas Products")

For control of: Existing infestations of listed insects and related pests such as drywood termites, Formosan termites, powder post beetles, death watch beetles, old house borers, bedbugs, clothes moths, rodents (rats, mice), the larvae and adults of carpet beetles (except egg stage), German, oriental, American, and brown-banded cockroaches, and pests in sulfuryl fluoride quarantine treatment schedules, such as brown marmorated stink bugs.

For use in: Dwellings (including mobile homes), buildings, construction materials, furnishings (household effects), shipping containers and vehicles including automobiles, buses, surface ships, passenger railcars, and recreational vehicles (but not including aircraft), and all contents, parts, or materials that could comprise or be located within any of the foregoing.

When fumigating, observe local, state, and federal rules and regulations including such things as use of chloropicrin, clearing devices, positive-pressure self-contained breathing apparatus, security requirements, and placement of warning signs.

Application personnel must participate in Douglas Products' Product Stewardship Plan.

Active Ingredient	
sulfuryl fluoride.....	99.8%
Other Ingredients.....	0.2%
Total.....	100.0%

EPA Reg. No. 1015-78

Keep Out of Reach of Children

DANGER  **POISON**

[Editors note: the word POISON must appear in red]

PELIGRO

Precaucion al usuario: Si usted no lee inglés, no use este producto hasta que la etiqueta le haya sido explicada ampliamente.

(If you do not understand the label, find someone to explain it to you in detail.)

Precautionary Statements

Hazards to Humans and Domestic Animals

Extremely Hazardous Liquid And Vapor Under Pressure • Fatal If Inhaled • May Be Fatal If Swallowed • Liquid May Cause Freeze Burns of Exposed Skin

Do not get in eyes, on skin, or on clothing. Vikane® specialty gas fumigant is odorless. Exposure to toxic levels may occur without warning or detection by the user.

Refer to the Directions for Use section on this label and the Vikane Gas Fumigant Structural Fumigation Manual for additional precautionary information and Directions for Use.

Notice: Labeling for Vikane consists of the label and the structural fumigation manual. Both the label and the manual must be read and understood before using this product. Use only according to label directions. **Before using this product, read Warranty Disclaimer, Inherent Risks of Use, and Limitation of Remedies elsewhere on this label. If terms are unacceptable, return at once unopened.**

In case of emergency endangering health or the environment involving this product, call 1-844-845-3129 or 1-352-323-3500.

Pest Control Chemical: Do not ship or store with food, feed, drugs, or clothing.

Directions for Use

It is a violation of Federal law to use this product in a manner inconsistent with its labeling.

Read all Directions for Use carefully before applying.

FIRST AID	
IF INHALED:	<ul style="list-style-type: none">• Get exposed person to fresh air.• Keep warm and at rest.• Make sure person can breathe freely.• If breathing has stopped, call 911 or an ambulance, then give artificial respiration.• Do not put anything in the mouth of an unconscious person.• Call a poison control center or doctor for treatment advice.
IF ON SKIN OR CLOTHING:	<ul style="list-style-type: none">• Immediately apply water to contaminated area of clothing before removing.• Once area has thawed, remove contaminated clothing, shoes, and other items covering skin.• Rinse contaminated skin area with plenty of water for 15-20 minutes.• Call a poison control center or doctor for treatment advice.
IF IN EYES:	<ul style="list-style-type: none">• Hold eye open and rinse slowly and gently with water for 15 to 20 minutes.• Remove contact lenses, if present, after the first 5 minutes, then continue rinsing eye.• Call a poison control center or doctor for treatment advice.
HOT LINE NUMBER	
In all cases of overexposure, such as nausea, difficulty in breathing, abdominal pain, slowing of movements and speech, numbness in extremities, get medical attention immediately. Take person to a doctor or emergency treatment facility. Have the product container or label with you when calling a poison control center or doctor, or going for treatment. In case of emergency endangering health or the environment involving this product, call 1-844-845-3129 or 1-352-323-3500.	
NOTE TO PHYSICIAN	
Vikane is a gas which has no warning properties such as odor or eye irritation. (However, chloropicrin is used as a warning agent and is a known lachrymator). Early symptoms of exposure to Vikane are respiratory irritation and central nervous system depression. Excitation may follow. Slowed movement, reduced awareness, and slow or garbled speech may be noted. Prolonged exposure can produce lung irritation, pulmonary edema, nausea, and abdominal pain. Repeated exposure to high concentrations can result in significant lung and kidney damage. Single exposures at high concentrations have resulted in death. Treat symptomatically. Liquid Vikane in the eye may cause damage due to frostbite or freezing.	

Refer to Chapter 7 in the Vikane Gas Fumigant Structural Fumigation Manual for first aid for overexposure to chloropicrin.

Storage and Handling

Store in dry, cool, well-ventilated area under lock and key. Post as a pesticide storage area. If the storage area is in an occupied building, the storage area must have either 1) a forced air ventilation system that meets required local ordinances for the storage of hazardous materials and operates continuously; or 2) be equipped with a permanently mounted and properly maintained and functioning sulfuryl fluoride monitoring device designed to alert occupants of the building if sulfuryl fluoride in the air of the storage area is greater than 1 ppm. Store cylinders upright, secured to a rack or wall to prevent tipping. Do not contaminate water, food, or feed by storage.

Cylinders must not be subjected to rough handling or mechanical shock such as dropping, bumping, dragging, or sliding beyond that which would normally occur when moving cylinders. Do not transport any cylinders in closed vehicles where they occupy the same common airspace as personnel. Transport securely only in an upright position.

Do not remove valve protection bonnet and safety cap until immediately before use. Replace safety cap and valve protection bonnet when cylinder is not in use.

When cylinder is empty, close valve, screw safety cap onto valve outlet, and replace protection bonnet before returning to supplier. Only the registrant is authorized to refill cylinders. Do not use cylinder for any other purpose. Follow registrant's instructions for return of empty or partially empty cylinders.

Leak Procedures: Evacuate immediate area of leak. Use a NIOSH or MSHA approved positive pressure self-contained breathing apparatus (SCBA, not SCUBA) or combination air-supplied/SCBA respirator, such as manufactured by Ranger, Survivair, Scott, or MSA, for entry into affected areas to correct problem. Move leaking or damaged cylinder outdoors or to an isolated location, observing strict safety precautions. Work upwind if possible. Do not permit entry into leakage area by unprotected persons until concentration of fumigant in the breathing zone (areas within the structure where individuals typically stand, sit, or lie down) is determined to be 1 part per million (ppm) or less. Confirm concentration of sulfuryl fluoride of 1 ppm or less with a clearance device. Refer to EPA's website at Sulfuryl Fluoride | US EPA (<https://www.epa.gov/ingredients-used-pesticide-products/sulfuryl-fluoride>) for more information and a list of effective clearance devices. For more detailed information on the source and use of air monitoring devices or respirators, consult distributors for Vikane and for these devices and respirators.

Cylinder and Product Disposal: Promptly return all empty cylinders to your distributor of Vikane. Follow proper cylinder handling directions above. Pesticide wastes are acutely hazardous. Improper disposal of excess pesticide is a violation of Federal law. If these wastes cannot be disposed of by use according to label instructions, consult your State Pesticide or Environmental Control Agency, or the Hazardous Waste Representative at the nearest EPA Regional Office for guidance.

Information

The Structural Fumigation Manual is part of the labeling for Vikane. Before using, read and follow all label precautions and directions. After the parties enter into a fumigation contract, the Fact Sheet for Vikane must be provided to an adult occupant of the structure to be fumigated or of each currently occupied unit in multi-unit structures.

Vikane is a highly hazardous material and must be used only by individuals knowledgeable of the hazards of this chemical and trained in the use of required respiratory equipment, fumigant detection devices, emergency procedures, and in the proper use of this fumigant.

When used for fumigation of enclosed spaces, such as houses and other structures, warehouses, vaults, chambers, trucks, vans, boxcars, ships, and other transport vehicles, 2 persons trained in the use of this product, at least one being an applicator who is licensed/certified by the state, must be present during introduction of fumigant, reentry prior to aeration, and during the initiation of the initial aeration procedure when exposure exceeds 1 ppm. **Two persons need not be present if monitoring is conducted remotely (outside the area being fumigated) and no one enters the fumigated structure.**

If fumigating for insect pests, do not apply when temperature at site of pest activity is below 40°F. This temperature may be measured at the slab foundation, sub-floor soil, or wherever the coolest part of the structure may be. This restriction does not apply when fumigating for rodents.

When fumigating a single unit/room within or connected to a larger structure (such as town houses, apartments, condominiums), all units of the entire structure must be vacated during the fumigation and aeration periods.

Chloropicrin must be used as described on this label to warn of an ongoing fumigation.

Douglas Products' Product Stewardship Plan

Douglas Products' Product Stewardship Plan, that includes EPA's stewardship plan criteria, is available at Sulfuryl Fluoride I US EPA (<https://www.epa.gov/ingredients-used-pesticide-products/sulfuryl-fluoride>). Applicators and distributors of Vikane Gas Fumigant must participate in Douglas Products' Product Stewardship Plan for residential structural fumigations. This plan is also available at Sulfuryl Fluoride I US EPA (<https://www.epa.gov/ingredients-used-pesticide-products/sulfuryl-fluoride>) for Vikane Gas Fumigant. Vikane must only be used by application personnel who satisfactorily comply with the Vikane Stewardship Plan, including the initial and annual training requirements.

Preparation for Fumigation

Site-Specific Structural Fumigation Log

Structural Fumigation Log requirements. The following elements for structural fumigation for each site must be documented.

The Site-specific Structural Fumigation Log is intended to ensure a safe and effective fumigation. The certified applicator in charge of fumigation is responsible for verifying that a Fumigation Log must contain, as a minimum, the information listed below. The information followed by a "(B)" below must be documented before the initiation of the fumigation; other information listed below without a "B" must be documented during the fumigation process, if not before. Contracts, site graphs, dose calculation reports, state or federally required forms and/or other documents prepared for or used during the fumigation can be used as documentation for these Fumigation Log requirements. Fumigation employees who introduce chloropicrin and sulfuryl fluoride, initiate aeration, and/or conduct final clearance testing must have participated in the registrant's sulfuryl fluoride training, as required by the registrant's stewardship plan.

1. General Information:
 - a. Fumigation company (B)
 - b. Fumigation site address (B)
 - c. Structure type (B)
 - d. Target pest(s) (B)
2. Fumigant Introduction:
 - a. Dosing calculations:
 - i. Dosage factor
 - ii. Tarp condition
 - iii. Under seal type
 - iv. Seal condition
 - v. Wind (mph)
 - vi. Volume of fumigated space (1000 cubic feet) (B)
 - vii. Underseal
 - viii. Temperature
 - ix. Hours of Exposure
 - b. Introduction of chloropicrin and sulfuryl fluoride:
 - i. Name, license number, and signature of certified applicator responsible for introduction of chloropicrin and sulfuryl fluoride.
 - ii. Name(s) of second trained person(s) and certified applicator(s) assisting with introduction of chloropicrin and sulfuryl fluoride.
 - iii. Total ounces of warning agent chloropicrin introduced and number of introduction sites.
 - iv. Cylinder serial number(s) of sulfuryl fluoride applied.
 - v. Pounds of fumigant applied.
 - vi. Date and time of fumigant release.
3. Aeration:
 - a. Name, license number, and signature of certified applicator responsible for initiating aeration.
 - b. Name(s) of certified applicator(s) and second trained person(s) assisting with initiating aeration.
 - c. Date and time of aeration initiated.
4. Final clearance testing:
 - a. Name, license number, and signature of certified applicator responsible for conducting final clearance testing.
 - b. Name(s) of certified applicators assisting final clearance testing.
 - c. Date and time final clearance testing completed.
 - d. Clearance device model type
5. Emergency response information:
 - a. Get exposed person to fresh air. Call 911 or an ambulance. Keep exposed person warm and at rest. Make sure person can breathe freely. If breathing has stopped, give artificial respiration. Do not put anything in the mouth of an unconscious person.
6. Open Comment field:
 - a. Provide an open field for additional comments or issues that is not captured in other sections of this Structural Fumigation Log.

Structural Fumigation

Remove from the structure to be fumigated all persons, domestic animals, pets, and desirable growing plants. See the Structural Fumigation Manual for instructions regarding the handling of fish tanks. For mattresses (excluding waterbeds) and pillows completely enveloped in waterproof coverings, do one of the following: 1) open the seal of the waterproof covering or 2) remove the mattress or pillow from the space to be fumigated if the waterproof covering cannot be opened. Mattresses and pillows with waterproof coverings containing built-in vents designed to permit air passage are considered to have an open seal to the waterproof covering and can remain as-is in the fumigated space. Food, feed, drugs (including tobacco products), and medicinals (including those items in refrigerators and freezers) can remain in the structure if they are in plastic, glass, or metal bottles, cans, or jars with the original manufacturer's air-tight seal intact. Food, feed, drugs (including tobacco products), and medicinals (including those items in refrigerators and freezers) not in plastic, glass, or metal bottles, cans, or jars with the original manufacturer's air-tight seal intact, need to be removed from the fumigation site, or double bagged in Nylofume® bags, which are available from distributors of Vikane.

Note: Extinguish all flames, including pilot lights of water heaters, gas refrigerators, ranges, ovens, broilers, dryers, gas fireplaces, etc. Turn off or unplug all electrical heating elements such as those in heaters, pianos, organs, etc. Shut off automatic switch controls for appliances and lighting systems which will be included in the space to be fumigated.

Prepare for Aeration Procedures 1 and 2 by doing the following:

- Open all operable attic doors and accesses and direct a fan into the attic.
- Position introduction and circulation fans to provide for air circulation throughout the fumigated space. For example, a circulation fan in the hall could be used to aid air circulating in bedrooms and bathrooms.
- For residential structures, use a minimum of one fan of at least 18 inches in diameter for every 22,500 cubic feet of space to be fumigated.¹

Open operable internal doors, internal openings to attics and sub areas, furniture with large voids (such as wardrobes, etc.), cabinets, drawers, closets, and appliances (such as washers, dishwashers, dryers, microwave or conventional ovens, etc.). Using electric fan(s) will help provide for forced distribution and aeration of basements and other dead air spaces to facilitate rapid dispersion of gas. Refrigerator and freezer doors may be left open if the units are turned off or disconnected and all food items have been removed. If the applicator chooses to leave any appliance, including refrigerators and freezers closed during the fumigation, the appliances must be opened when clearing the structure until the concentration of Vikane in it is 1 ppm or less.

Multi-Unit Structures: When fumigating a single unit/room within a larger structure (such as townhouses, apartments, condominiums), all units of the entire structure must be prepared as a fumigated structure, and all applicable rules, regulations and label instructions apply, such as occupant notification, structure preparation, posting, securing, and aeration. An adult occupant of each currently-occupied unit must be provided with the Fact Sheet for Vikane. Ensure that all exterior entranceways and exterior doors providing access to individual units are secured with secondary locks (see Securing Structure Entrances) so that only the state licensed applicator in charge can gain access. Chloropicrin need only be used in the fumigated space where Vikane is introduced.

During Step (3) of Aeration Procedure 1 or 2, check all units within the fumigated structure for concentrations of Vikane with a clearance device. Confirm concentration of sulfuryl fluoride of 1 ppm or less with a clearance device. Refer to EPA's website at Sulfuryl Fluoride | US EPA (<https://www.epa.gov/ingredients-used-pesticide-products/sulfuryl-fluoride>) for more information and a list of effective clearance devices. If the concentration of Vikane is greater than 1 ppm in the breathing zone (i.e., areas within the structure where individuals typically stand, sit or lie down) in a unit, ventilate the unit with operable doors and windows open and continue to measure the concentration of Vikane until it is 1 ppm or less. Structure may be reoccupied when concentrations in the breathing zones in all units is 1 ppm or less.

Connected Structures: A connected structure is defined as any structure connected with the structure to be fumigated by construction elements (e.g., pipes, conduits, ducts, etc.) which may allow passage of fumigant between the structures. If state rules and regulations do not describe or permit a process to isolate and seal a connected structure to prevent passage of fumigant from the fumigated structure, then the connected structure must be vacated during the fumigation. When it is necessary to vacate any connected structure, that structure shall be considered as a fumigated structure and all applicable rules, regulations and label instructions apply, such as occupant notification, structure preparation, posting, securing, and aeration. Chloropicrin need only be used in structures where Vikane is introduced. Concentration levels of Vikane must be measured in the breathing zones (areas within the structure where individuals typically stand, sit or lie down) (see Aeration and Reentry) in any connected space or structure to confirm concentrations are 1 ppm or less before structure can be reoccupied.

Tarpaulin Fumigation

Open operable windows as permitted by local and state regulations and as described in the Vikane Gas Fumigant Structural Fumigation Manual. When tarping, use a highly resistant material such as a vinyl coated nylon, or polyethylene sheeting of at least 4 mil thickness. Seal all seams. Seal the bottom edges of the cover to the ground using materials such as soil, sand, or weighted "snakes." To minimize escape of gas through the soil and to avoid injury to nearby plants, wet soil outward from foundation to the cover if not sufficiently moist to act as a barrier for the gas.

Taped Fumigation

For fumigation sites that can be sealed with plastic, paper, or tape, seal adequately around doors, windows, vents, and other openings.

Chamber Fumigation

For chamber fumigation use a tightly-sealed chamber with adequate circulation.

Construction Materials, Furnishings (Household Effects), Vehicles, and Shipping Containers

Follow preparations as appropriate in above paragraphs for chamber, taped fumigation, or tarpaulin fumigation to assure good confinement of the gas for the recommended period of exposure.

Fumigation of Surface Ships in Port

Surface ships in size up to and including large ocean-going ships may be fumigated with Vikane to control the various pests listed. The professional fumigator and the ship's captain (or owner) shall follow all applicable regulations including those listed in the Coast Guard, DOT, Title 46, Shipping section, Parts 147A.1-147A.43. Except for those persons involved in fumigation, no people, plants, or pets may be on board during fumigation.

The person responsible for the fumigation must notify the master of the vessel, or his representative, of the requirements relating to personal protection equipment and detection equipment. Emergency procedures, cargo ventilation, periodic monitoring and inspections, and first aid measures must be discussed with and understood by the master of the vessel or his representative.

If leakage of the fumigant is detected, the person in charge of the fumigation shall take action to correct the leakage, or shall inform the master of the vessel, or his representative, of the leakage so that corrective action can be taken.

The vessel must not be moved during the fumigation and aeration periods. If reentry is necessary before aeration is completed, positive pressure self-contained respiratory protection must be worn.

Warning Agent

Chloropicrin is a warning agent introduced into the structure during fumigation. Chloropicrin is an effective warning agent but is not intended to be used

¹A residential structure is where people typically live (temporarily or permanently) and sleep, such as single-family residences, mobile homes, apartments, townhouses, condominiums, hotels, motels, assisted care facilities, nursing homes, hospitals, barracks, and dormitories.

to vacate people, pets, domestic animals, or feral animals from the structure prior to introduction of Vikane. Therefore, the structure to be fumigated must be inspected to confirm required preparations have been completed prior to introduction of chloropicrin. In order to avoid direct exposure to the fumigant being released, chloropicrin must be released within the structure at least 5 to 10 minutes prior to introduction of the fumigant. Place a handful of wicking agent (e.g., cotton) in a chloropicrin evaporation container(s). Do not use chloropicrin evaporation containers or application equipment made of magnesium, aluminum, or their alloys as chloropicrin may be severely corrosive to such metals. To enhance the distribution of chloropicrin throughout the structure, place the chloropicrin evaporation container in the air stream of a fan. Pour chloropicrin over the wicking agent. When adding chloropicrin to evaporation containers, dispense no more than 3 fl oz per container. Use 1 fl oz/10,000 to 15,000 cubic feet (30 ml/283 to 425 cubic meters) of space to be fumigated or follow dosage rate calculated by the Vikane Fumiguide® Calculator. Establish at least one chloropicrin introduction site for each 45,000 cubic feet of space to be fumigated. When applying chloropicrin at multiple chloropicrin introduction points within a structure, start at the point farthest from the exit and work toward the exit. Removal of all chloropicrin evaporation containers from the fumigated space during the initial phase of aeration after tarp removal will aid in the dissipation of the warning agent from the structure.

Chloropicrin need not be used when fumigating passenger railcars; however, a thorough walk-through inspection must be performed of each railcar with doors being immediately locked upon leaving each car, and a guard must be posted during fumigant introduction, exposure period, and aeration.

Chloropicrin is a warning agent which causes smarting of the eyes, tears, and discomfort, and has a very disagreeable pungent odor at very low concentrations. Chloropicrin must be used by persons certified to apply Vikane or under their supervision. Applicators must observe the chloropicrin precautionary statements and personal protective equipment appearing in the "Release of Warning Agent" Chapter of the Vikane Gas Fumigant Structural Fumigation Manual.

Personal Protection Equipment

Eye Protection

Wear splash-resistant goggles (goggles designed and made of material that allows no measurable movement of the liquid pesticide being used to pass through them during use) or full-face shield for eye protection during introduction of the fumigant.

Protective Clothing

Do not wear gloves or rubber boots. Do not reuse clothing or shoes that have become contaminated with liquid Vikane until thoroughly aerated and cleaned.

Respiratory Protection

If the concentration of Vikane in the breathing zone (areas within the structure where individuals typically stand, sit or lie down) of the fumigated area (as measured with a clearance device that does not exceed 1 ppm (4 mg/cubic meter), no respiratory protection is required. Confirm concentration of sulfuryl fluoride of 1 ppm or less with a clearance device. Refer to EPA's website at Sulfuryl Fluoride | US EPA (<https://www.epa.gov/ingredients-used-pesticide-products/sulfuryl-fluoride>) for more information and a list of effective clearance devices. When this concentration is exceeded, all persons in the exposed area must wear a NIOSH or MSHA approved positive pressure self-contained breathing apparatus (SCBA, not SCUBA) or combination air-supplied/SCBA respirator such as manufactured by Ranger, Survivair, Scott, or MSA. Before using any make or brand of SCBA, learn how to use it correctly. Determine that it has an adequate air supply for the job at hand, that it fits properly, providing an adequate seal around the face, and that it is in good working order. For more detailed information on the source and use of air monitoring devices and respirators, consult distributors for Vikane and for these devices and respirators.

Prefumigation Check: Check for potential leaks.

Securing Structure Entrances

To secure the structure against unauthorized entry during the fumigation exposure period and Step 2 of Aeration Procedure 1 or 2, use a locking device or barricade on all exterior doors or doorways. A locking device, such as a secondary lock, or barricade must be demonstratively effective in preventing an exterior door or doorway from being opened from the exterior using normal opening or entering processes by anyone other than the certified applicator in charge of the fumigation or persons in his/her on-site direct supervision. Consult state and local regulations for any supplementary instructions and restrictions on securing against entry. See the Vikane Gas Fumigant Structural Fumigation Manual for directions for securing Passenger Railcars.

Dosage and Exposure Time

For fumigation to control drywood termites and non-egg stages of other insect and related structural and household pests, the Vikane Fumiguide Calculator is to be used for the coordination of fumigant rates with soil or slab temperature, exposure period, and fumigant loss rate measured as half-loss-time (HLT). When control of the egg stage is desired or when fumigating for Formosan termites, use the indicated multiple factor of the drywood termite dosage (as determined by Vikane Fumiguide Calculator) for pests listed in the following table:

Pest	Dosage Factor (as a multiple of drywood termite dosage)
rodents ¹	1/2X
carpet beetles ² , German cockroaches, and other cockroach species ²	1X
Bedbugs	1.9X
furniture carpet beetles ²	3X
old house borers and Formosan termites	4X
clothes moths	6X
powder post beetles and death watch beetles	10X

These dosages apply to dwellings, buildings, construction materials, furnishings, and vehicles.

Do not use less than the specified dosage factors when treating for rodents, cockroaches, bed bugs, and termites.

¹To determine the proper dose for rodent control, use 80°F as the calculating temperature. Unlike insects, rodents are warm blooded and do not require increased dosages at lower temperatures.

²More than one fumigation may be needed to control the infestation after egg hatch.

For fumigation to control rodents, use sufficient gas to accumulate at least 36 ounce-hours following equilibrium, regardless of ambient air temperature. Refer to the Vikane Gas Fumigant Structural Fumigation Manual.

Software versions of the Fumiguide Calculator are available for use on various devices and platforms. Contact Douglas Products or your distributor of

Vikane for information on how to obtain the Fumiguides.

Posting of Fumigated Areas

The following is a baseline of requirements for warning signs to be posted for fumigations using Vikane. States that currently have requirements that are comparable to the elements listed here, can maintain those requirements for warning signs. Additional elements imposed by states may also be added to these warning signs.

1. The applicator must post the fumigated areas with warning signs with a white background stating the following:
 - a. The signal word DANGER/PELIGRO at a minimum height of 2 inches, the SKULL and CROSSBONES symbol at a minimum height of 1 inch, and the statement "Area under fumigation, DO NOT ENTER/NO ENTRE" all printed in one or more colors contrasting with the white background.
 - b. The date of fumigation.
 - c. Brand name of fumigant used (minimum height ½ inch).
 - d. Name, address, and telephone number of the applicator, or company performing the fumigation.
2. Information on warning signs must remain legible and visible for the duration of the fumigation and aeration periods.
3. Warning signs must be placed on the structure at or near all doors and entrances.
4. On tented structures, additional warning signs must be placed on the outside of the tarp so that they are clearly visible from all accessible sides, and from any direction from which the site may be approached.

Only a certified applicator may authorize removal of placards, and only when the concentration of Vikane within the structure where individuals typically stand, sit or lie down, is 1 ppm or less.

Introducing the Fumigant

Release the fumigant from outside the structure, tarp, or vehicle. The release point(s) should be into a large open space(s) in the fumigation site(s). Release the fumigant through a suitable leak-proof tube with a minimum burst pressure of 500 pounds per square inch (psi). Direct the fumigant into the blast of air from a fan(s) having a capacity of at least 1,000 cubic feet per minute (cfm) for each pound of Vikane released per minute. Damage to household materials can occur if insufficient fan capacity is used for the rate of Vikane released. It is recommended that protective sheeting, such as polyethylene plastic under the shooting stand, shooting hose, and shooting fan be used to further protect floors during application. **To prevent damage, do not apply fumigant directly to any surface.**

Aeration and Reentry

Structures

No one is allowed in treated areas if the level of Vikane is above 1 ppm unless provided with a NIOSH or MSHA approved positive pressure self-contained breathing apparatus (SCBA, not SCUBA) or combination air supplied/SCBA respirator such as manufactured by Ranger, Survivair, Scott, or MSA. **Note: During the initial aeration procedure, approved respiratory protection must be worn until the concentration of Vikane is confirmed not to exceed 1 ppm.** Confirm concentration of sulfuryl fluoride of 1 ppm or less with a clearance device. Refer to EPA's website at Sulfuryl Fluoride | US EPA (<https://www.epa.gov/ingredients-used-pesticide-products/sulfuryl-fluoride>) for more information and a list of effective clearance devices. Since clearance devices give immediate readings, respiratory protection is not required when clearing with these instruments after having completed the initial aeration procedure. If a reading indicates levels in excess of 1 ppm, leave the affected area immediately.

Aeration of Residential Structures

A residential structure is where people typically live (temporarily or permanently) and sleep, such as single-family residences, mobile homes, apartments, townhouses, condominiums, hotels, motels, assisted care facilities, nursing homes, hospitals, barracks, and dormitories.

Preparation

Prepare for Aeration Procedures 1 and 2 by doing the following:

- Open all operable attic doors and accesses and direct a fan into the attic.
- Position introduction and circulation fans to provide for air circulation throughout the fumigated space. For example, a circulation fan in the hall could be used to aid air circulating in bedrooms and bathrooms.
- Use a minimum of one fan of at least 18 inches in diameter for every 22,500 cubic feet of space to be fumigated.

Select the appropriate procedure based on the fumigation rate:

All residential structures² fumigated at 16 oz/MCF (1000 cubic feet of gas) or less may be aerated using Aeration Procedure 1 or 2.

All residential structures fumigated at concentrations greater than 16 oz/MCF must be aerated using Aeration Procedure 2.

Aeration Procedure 1

These steps must be completed in sequence.

Step (1): Aerate structure with all operable windows and doors open, aided by the use of at least one fan (of at least 18 inches in diameter) for every 22,500 cubic feet of fumigated space for a minimum of 2 hours following the directions in the Preparation section. If the structure has an attached garage, the door between the garage and structure should be open. If the structure has a central air system, turn on only the fan (or blower) for each operational unit. As an alternative, a circulation fan may be placed in front of a furnace inlet to blow air into central heating and cooling ducts. Removal of all chloropicrin evaporation containers from the fumigated space during Step (1) will aid in the dissipation of the warning agent from the structure.

Step (2): Secure structure and do not allow reentry for a minimum of 12 hours from the start of aeration (first opening of the seal) for residential structures.² During this time structures must remain posted with warning signs.

Step (3): After the minimum 12-hour waiting period in Step (2), measure the concentration of Vikane in breathing zones of each room with a clearance device. Refer to EPA's website at Sulfuryl Fluoride | US EPA (<https://www.epa.gov/ingredients-used-pesticide-products/sulfuryl-fluoride>) for more information and a list of effective clearance devices. If the concentration of Vikane is greater than 1 ppm, ventilate structure with operable doors and

² A residential structure is where people typically live (temporarily or permanently) and sleep, such as single-family residences, mobile homes, apartments, townhouses, condominiums, hotels, motels, assisted care facilities, nursing homes, hospitals, barracks, and dormitories.

windows open and confirm concentrations are 1 ppm or less before the structure is reoccupied. Refer to EPA's website at Sulfuryl Fluoride | US EPA (<https://www.epa.gov/ingredients-used-pesticide-products/sulfuryl-fluoride>) for more information and a list of effective clearance devices.

Aeration Procedure 2

These steps must be completed in sequence.

Step (1): Aerate structure with all operable windows and doors open, aided by the use of at least one fan (of at least 18 inches in diameter) for every 22,500 cubic feet of fumigated space, for a minimum of 2 hours following the directions in the Preparation Section. If the structure has an attached garage, the door between the garage and structure should be open. If the structure has a central air system, turn on only the fan (or blower) for each operational unit. As an alternative, a circulation fan may be placed in front of a furnace inlet to blow air into central heating and cooling ducts. Removal of all chloropicrin evaporation containers from the fumigated space during Step (1) will aid in the dissipation of the warning agent from the structure.

Step (2): Secure the structure and do not allow reentry for the minimum number of hours as listed in the **Table 1. Determining Minimum Hours of Aeration Time Based on Initial Concentration of Sulfuryl Fluoride Introduced**, from the start of aeration (first opening of the seal) for residential structures.² During this time the structure must remain posted.

Table 1. Determining Minimum Hours of Aeration Time Based on Initial Concentration of Sulfuryl Fluoride Introduced

Initial Concentration of Sulfuryl Fluoride Introduced (ounces per thousand cubic feet)	Minimum Hours of Aeration Time**
Greater than 16 to 32	14
Greater than 32 to 48	16
Greater than 48 to 64	18
Greater than 64 to 96	20
Greater than 96 to 112	22
Greater than 112	24

**When the high ambient temperature for the aeration period is below 40°F at the fumigation site, a minimum of 24 hours of aeration is required.

Step (3): After the minimum waiting period in Step (2), measure the concentration of Vikane in breathing zones of each room with a clearance device. Refer to EPA's website at Sulfuryl Fluoride | US EPA (<https://www.epa.gov/ingredients-used-pesticide-products/sulfuryl-fluoride>) for more information and a list of effective clearance devices. If the concentration of Vikane is greater than 1 ppm, ventilate structure with operable doors and windows open and confirm concentrations are 1 ppm or less before the structure is reoccupied.

Refer to Chapters 10 and 11 of the Vikane Gas Fumigant Structural Fumigation Manual for aeration procedures for non-residential structures, including passenger railcars, fumigation chambers, vehicles, vessels (surface ships), containers, and tarped stacks. Do not reoccupy the fumigation site, i.e., building, ship, vehicle, or chamber, or move the vehicle until aeration is complete. Warning signs must remain posted until aeration is determined to be complete.

Terms and Conditions of Use

If terms of the following Warranty Disclaimer, Inherent Risks of Use, and Limitation of Remedies are not acceptable, return unopened package at once to the seller for a full refund of purchase price paid. Otherwise, use by the buyer or any other user constitutes acceptance of the terms under Warranty Disclaimer, Inherent Risks of Use and Limitation of Remedies.

Warranty Disclaimer

Douglas Products and Packaging Company warrants that this product conforms to the chemical description on the label and is reasonably fit for the purposes stated on the label when used in strict accordance with the directions, subject to the inherent risks set forth below. TO THE EXTENT PERMITTED BY LAW, DOUGLAS PRODUCTS MAKES NO OTHER EXPRESS OR IMPLIED WARRANTY OF MERCHANTABILITY OR FITNESS FOR A PARTICULAR PURPOSE OR ANY OTHER EXPRESS OR IMPLIED WARRANTY.

Inherent Risks of Use

It is impossible to eliminate all risks associated with use of this product. Plant injury, lack of performance, or other unintended consequences may result because of such factors as use of the product contrary to label instructions (including conditions noted on the label, such as low temperature, soil conditions, etc.), abnormal conditions (such as excessive wind, tornadoes, hurricanes), presence of other materials, the manner of application, or other factors, all of which are beyond the control of Douglas Products or the seller. All such risks shall be assumed by buyer.

Limitation of Remedies

To the extent permitted by law, the exclusive remedy for losses or damages resulting from this product (including claims based on contract, negligence, strict liability, or other legal theories), shall be limited to, at Douglas Products' election, one of the following:

1. Refund of purchase price paid by buyer or user for product bought, or
2. Replacement of amount of product used.

Douglas Products shall not be liable for losses or damages resulting from handling or use of this product unless Douglas Products is promptly notified of such loss or damage in writing. In no case shall Douglas Products be liable for consequential or incidental damages or losses.

The terms of the Warranty Disclaimer, Inherent Risks of Use, and Limitation of Remedies cannot be varied by any written or verbal statements or agreements. No employee or sales agent of Douglas Products or the seller is authorized to vary or exceed the terms of the Warranty Disclaimer or Limitation of Remedies in any manner.

®Trademark of Douglas Products and Packaging Company ("Douglas Products")

Produced for
Douglas Products and Packaging Company
1550 East Old 210 Highway
Liberty, MO 64068-9459

A-3-LBL-VKUSA-001

EPA accepted xx/xx/xxxx



STRUCTURAL FUMIGATION MANUAL

FOR USE EXCLUSIVELY WITH VIKANE[®] GAS FUMIGANT

These materials have been created specifically for Vikane[®] gas fumigant and no other structural fumigant. The information contained in these materials is product labeling and use instructions for Vikane and is not intended for use with other structural fumigants, which will have different product label requirements. These materials may not be copied, in whole or in part, or reproduced without the permission of Douglas Products.



© Trademark of Douglas Products.

Vikane is a federally Restricted Use Pesticide.

Always read and follow label directions.

These materials have been created specifically for Vikane gas fumigant and no other structural fumigant. These materials may not be copied, in whole or in part, or reproduced without the permission of Douglas Products.



RESTRICTED USE PESTICIDE DUE TO INHALATION TOXICITY

For sale to and use only by Certified Applicators or persons under their direct supervision and only for those uses covered by the Certified Applicator's certification.

SULFURYL FLUORIDE

GROUP

8C

INSECTICIDE

Structural Fumigation Manual for Vikane®

SPECIALTY GAS FUMIGANT

For control of: Existing infestations of listed insects and related pests such as drywood termites, Formosan termites, powder post beetles, death watch beetles, old house borers, bedbugs, clothes moths, rodents (rats, mice), the larvae and adults of carpet beetles (except egg stage), German, oriental, American, and brown-banded cockroaches, and pests (such as brown marmorated stink bugs) in sulfuryl fluoride quarantine treatment schedules.

For use in: Dwellings (including mobile homes), buildings, construction materials, furnishings (household effects), shipping containers and vehicles including automobiles, buses, surface ships, passenger railcars, and recreational vehicles (but not including aircraft), and all contents, parts, or materials that could comprise or be located within any of the foregoing.

When fumigating, observe local, state, and federal rules and regulations including such things as use of chloropicrin, clearing devices, positive-pressure self-contained breathing apparatus, security requirements, and placement of warning signs.

Application personnel must participate in Douglas Products' Product Stewardship Plan.

Active Ingredient
sulfuryl fluoride..... 99.8%
Other Ingredients 0.2%
Total 100.0%

Keep Out of Reach of Children

DANGER  **POISON**

[Editors note: the word POISON must appear in red]

PELIGRO

Si usted no lee inglés, no use este producto hasta que la etiqueta le haya sido explicada ampliamente.
(If you do not understand the label, find someone to explain it to you in detail.)

FIRST AID	
IF INHALED:	<ul style="list-style-type: none"> • Get exposed person to fresh air. • Keep warm and at rest. • Make sure person can breathe freely. • If breathing has stopped, call 911 or an ambulance, then give artificial respiration. • Do not put anything in the mouth of an unconscious person. • Call a poison control center or doctor for treatment advice.
IF ON SKIN OR CLOTHING:	<ul style="list-style-type: none"> • Immediately apply water to contaminated area of clothing before removing. • Once area has thawed, remove contaminated clothing, shoes, and other items covering skin. • Rinse contaminated skin area with plenty of water for 15-20 minutes. • Call a poison control center or doctor for treatment advice.
IF IN EYES:	<ul style="list-style-type: none"> • Hold eye open and rinse slowly and gently with water for 15 to 20 minutes. • Remove contact lenses, if present, after the first 5 minutes, then continue rinsing eye. • Call a poison control center or doctor for treatment advice.
HOT LINE NUMBER	
<p>In all cases of overexposure, such as nausea, difficulty in breathing, abdominal pain, slowing of movements and speech, numbness in extremities, get medical attention immediately. Take person to a doctor or emergency treatment facility. Have the product container or label with you when calling a poison control center or doctor, or going for treatment. In case of emergency endangering health or the environment involving this product, call 1-844-845-3129 or 1-352-323-3500.</p>	
NOTE TO PHYSICIAN	
<p>Vikane is a gas which has no warning properties such as odor or eye irritation. (However, chloropicrin is used as a warning agent and is a known lachrymator). Early symptoms of exposure to Vikane are respiratory irritation and central nervous system depression. Excitation may follow. Slowed movement, reduced awareness, and slow or garbled speech may be noted. Prolonged exposure can produce lung irritation, pulmonary edema, nausea, and abdominal pain. Repeated exposure to high concentrations can result in significant lung and kidney damage. Single exposures at high concentrations have resulted in death. Treat symptomatically. Liquid Vikane in the eye may cause damage due to frostbite or freezing.</p>	

Refer to Chapter 7 in the Vikane Gas Fumigant Structural Fumigation Manual for first aid for overexposure to chloropicrin.

Liquid Vikane in the eye may cause damage due to frostbite or freezing.

In case of emergency endangering health or the environment involving this product, call 1-844-845-3129 or 1-352-323-3500.

Pest Control Chemical: Do not ship or store with food, feed, drugs, or clothing.

EPA Reg. No. 1015-78

®Trademark of Douglas Products and Packaging Company ("Douglas Products")

**Produced for
Douglas Products and Packaging Company
1550 East Old 210 Highway
Liberty, MO 64068-9459**

TABLE OF CONTENTS

Page

FUMIGATING WITH VIKANE	6
INTRODUCTION	6
DOUGLAS PRODUCTS' PRODUCT STEWARDSHIP PLAN	6
CHAPTER 1: PRODUCT INFORMATION	7
THE LABEL.....	7
COMPOSITION	7
PHYSICAL PROPERTIES	7
CHAPTER 2: ADDITIONAL SAFETY INFORMATION	9
POISONING SYMPTOMS	9
PHYSICIAN INFORMATION	9
WORKER SAFETY.....	10
Personal Protection Equipment.....	10
CHAPTER 3: CYLINDER HANDLING AND STORAGE	11
CYLINDER SAFETY.....	11
Cylinder Information	11
Cylinder Handling	11
Cylinder Storage.....	11
Cylinder Transport.....	12
Empty Cylinders	12
Cylinder Leak Procedures.....	12
CHAPTER 4: SITE-SPECIFIC STRUCTURAL FUMIGATION LOG	14
CHAPTER 5: FUMIGATION PREPARATION	16
OCCUPANTS/CUSTOMER COMMUNICATIONS.....	16
Fact Sheet	16
Property Owner/Customer Checklist.....	16
MULTI-UNIT STRUCTURES	16
CONNECTED STRUCTURES	16
WHAT TO REMOVE PRIOR TO FUMIGATION.....	17
FLAMES OR HEATING ELEMENTS	18
GAS DISTRIBUTION.....	18
FAN PLACEMENT AND SPECIFICATIONS.....	18
Purpose of Fans	18
Positioning Fans	18
Fan Specifications.....	19
Reaching Equilibrium.....	19
Continuous Circulation with Fans	20
ELECTRICITY	20
MONITORING HOSES.....	20
SEALING THE STRUCTURE	20
Tape and Seal	20
Tarping	21
Conduits.....	22
PLACARDING AND SECURING FUMIGATED AREAS.....	22
Posting of Fumigated Areas	22
Warning Agent.....	23
Securing Structures	23
Guards.....	24
CHAPTER 6: FUMIGUIDE® CALCULATIONS.....	25
FUMIGANT DOSAGE.....	25
FACTORS AFFECTING OZ-HR DOSAGE	25

Pest Factor	25
Temperature.....	27
THE VIKANE FUMIGUIDE® CALCULATOR.....	27
Calculating HLT	27
Calculating the Oz-Hr Dosage.....	28
Calculating the Amount of Vikane to Introduce.....	29
Using the Vikane Fumiguide® Calculator When Monitoring	29
CHAPTER 7: RELEASE OF WARNING AGENT	31
PHYSICAL PROPERTIES OF CHLOROPICRIN COMPARED TO VIKANE.....	31
SAFETY PRECAUTIONS WHEN USING CHLOROPICRIN	31
Personal Protective Equipment	32
First Aid.....	32
Storage and Handling.....	32
INTRODUCTION OF CHLOROPICRIN.....	33
ADDITIONAL PRECAUTIONS FOR USE AND HANDLING OF CHLOROPICRIN.....	33
CHAPTER 8: VIKANE INTRODUCTION.....	34
PREVENTING PROPERTY DAMAGE.....	34
CHOOSING FUMIGANT INTRODUCTION LOCATIONS.....	34
SELECTION AND USE OF EQUIPMENT FOR FUMIGANT INTRODUCTION	34
Weighing the Fumigant	34
Hoses.....	35
Fan Placement and Specifications	35
Protective Sheeting.....	35
Chloropicrin Introduction	36
Safety Equipment	36
RELEASING VIKANE FROM THE CYLINDER	36
Frozen Valves and Hoses	36
Frozen Cylinders.....	36
Releasing the Last 3 to 5 lbs. of Vikane	37
CHAPTER 9: MONITORING VIKANE	38
GUIDELINES FOR MONITORING A FUMIGATION	38
EQUIPMENT	38
Fumiguide® Calculator.....	38
Monitoring Hoses.....	38
Monitoring Equipment.....	38
CHAPTER 10: AERATING AND CLEARANCE TESTING.....	39
PREPARING FOR AERATION.....	39
AERATION PROCEDURES.....	39
Aeration Procedure 1	41
Aeration Procedure 2	41
CLEARANCE TESTING EQUIPMENT	42
REOCCUPANCY.....	42
AERATING CHLOROPICRIN	43
LATENT MORTALITY	43
NON-TARGET ORGANISMS	43
CHAPTER 11: SITE SPECIFIC CONSIDERATIONS (SUCH AS CHAMBERS, VEHICLES, SHIPS, PASSENGER RAILCARS	44
CHAMBERS	44
Atmospheric Pressure Chambers	44
Vacuum Chambers.....	44
TARPED STACKS.....	45
VEHICLES, VESSELS, AND CONTAINERS.....	45
Selection of Fumigation Location	46
Securing the Vehicle, Vessel, or Container	46
Surface Ships	46
Fumigation of Vessels on Water	46

Aerating the Vehicle, Vessel, Container, or Tarped Stack.....46

PASSENGER RAILCARS.....46

 Securing Passenger Railcars.....46

 Aerating Passenger Railcars.....47

FUMIGATING WITH VIKANE

INTRODUCTION

Vikane® specialty gas fumigant was specifically developed by The Dow Chemical Company in the 1950s for remedial control of wood-destroying insects and other structure-infesting pests. Vikane is registered for use exclusively by professional applicators to control existing infestations of insects, related pests, and rodents infesting dwellings (including mobile homes), buildings, construction materials, furnishings (household items), shipping containers and vehicles including automobiles, buses, surface ships, passenger railcars, and recreational vehicles (excluding aircraft).

While every structural fumigation is unique, there are basic principles and requirements to follow that are common to all structural fumigations. The purpose and objective of this Structural Fumigation Manual ("Manual") are to supplement and support the cylinder label for Vikane and to reinforce the responsible and effective use of Vikane.

Read and understand the label and the Manual before using Vikane. The Manual is part of the labeling for Vikane. The Manual contains important information for applicator safety and for the effective use of this product. If the Manual is lost, contact your distributor of Vikane or Douglas Products to obtain a replacement copy.

This Manual is not intended to supersede label requirements or state and local regulations. Each applicator using Vikane is responsible for complying with all federal, state, and local regulations or codes regulating the use of this product. The development of this Manual included the study and interpretation of many codes and regulations considered relevant to the use of Vikane. However, because regulations and the enforcement of regulations can change, the applicator should stay informed about state and local regulations in areas where they operate. This Manual may be periodically revised as necessary to reflect modification of requirements.

State and local government offices, distributors of Vikane, or Douglas Products' sales representatives responsible for your area can help identify the relevant agencies responsible for regulating fumigation practices in your area.

In emergency situations, help may be obtained by calling Douglas Products at **1-844 845-3129 or 1-352-323-3500**.

DOUGLAS PRODUCTS' PRODUCT STEWARDSHIP PLAN

Product Stewardship means the responsible and ethical management of the health, safety, and environmental risks of a pesticide product. Douglas Products has a Product Stewardship Plan for applicators and distributors of Vikane. The objective of this plan is to promote product stewardship and educate distributors and applicators on the responsible use of Vikane in accordance with all directions, as well as Douglas Products' requirements and those of EPA.

Douglas Products' Product Stewardship Plan, that includes EPA's stewardship plan criteria, is available at Sulfuryl Fluoride I US EPA (<https://www.epa.gov/ingredients-used-pesticide-products/sulfuryl-fluoride-clearance-devices>). Applicators and distributors of Vikane® gas fumigant must participate in Douglas Products' Product Stewardship Plan for residential structural fumigations. This plan is also available at Sulfuryl Fluoride I US. EPA EPA (<https://www.epa.gov/ingredients-used-pesticide-products/sulfuryl-fluoride-clearance-devices>) for Vikane® gas fumigant. Vikane must only be used by application personnel who satisfactorily comply with the Vikane Stewardship Plan, including the initial and annual training requirements.

CHAPTER 1: PRODUCT INFORMATION

Vikane is a restricted use pesticide due to acute inhalation toxicity of sulfuryl fluoride.

THE LABEL

This product is registered by the Environmental Protection Agency, Registration Number 1015-78. The label for Vikane consists of the container label for Vikane and this document. It is illegal to use the product in any manner inconsistent with the label. Labels are periodically revised and available through Douglas Products or your authorized distributor of Vikane.

COMPOSITION

Vikane is an inorganic chemical and is composed of:

Active Ingredient	
sulfuryl fluoride (by weight).....	99.8%
Other Ingredients	0.2%
Total	100.0%

PHYSICAL PROPERTIES

Sulfuryl fluoride is a colorless, odorless toxic gas. Cylinders containing Vikane are under pressure and must not be stored near excessive heat or open flame. Exposures to temperatures above 158°F will cause a fusible plug to melt and the contents will be released.

Structural formula: SO_2F_2

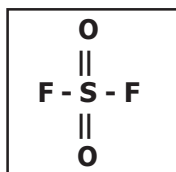

Color: None

Odor: None

Molecular Weight: 102.07 AMU

Specific Gravity: 1.35 at 20°C (68°F)

Vapor Density: 4.3 g/L at 20°C (68°F); air = 1

Vapor Pressure: 15.2 atm at 20°C (68°F)

Boiling Point: -55.2°C (-67°F) at 760 mmHg

Gas Solubility at Pressure = 1 atm: 25°C (77°F) and in water 0.075% (750 ppm) by weight, only slightly soluble in organic solvents and vegetable oils.

Stability: Stable to heat normally encountered in structural and other fumigations. Non-flammable under normal conditions in all atmospheric concentrations. However, heaters and open flames must be extinguished as temperatures over 400°C (752°F) will cause decomposition products to be formed which can be corrosive and etch metal and glass.

Heat of Vaporization: 81.1 BTU/pound at -55°C (-67°F) or 4600 cal/mol. 1 lb. of sulfuryl fluoride = 4.45 moles. 1 lb. of Vikane will lower 1000 cu ft of dry air by 2.5°C (4.5°F).

Volume per Pound: 1 lb. of gas occupies 3.8 cu ft at 25°C (77°F) and 760 mm Hg. 1 lb. of gas per 1000 cu ft of unoccupied space equals approximately 3850 ppm at room temperature and pressure (25°C at 760 mm Hg).

Hydrolysis: Hydrolysis slow in water, but rapid in basic solutions.

Reactivity: Sulfuryl fluoride is relatively non-reactive as a gas. No malodor or corrosive effects have been detected when the chemical has been used as directed. Sulfuryl fluoride can react with strong bases such as some photo developing solutions.

Effect on Ozone: Sulfuryl fluoride is not a stratospheric ozone-depleting substance. Vikane contains no chlorine or bromine and, thus, does not deplete stratospheric ozone by known mechanisms. When a structure is aerated, Vikane rapidly dissipates to non-detectable levels.

CHAPTER 2: ADDITIONAL SAFETY INFORMATION

Vikane is toxic to most living organisms including humans. It is colorless, odorless, packaged as a liquid gas under pressure, and has no warning properties. **Vikane must only be used by certified professional applicators.**

Symptoms in humans from inhalation exposure to Vikane will depend upon the concentration and the length of exposure experienced. Vikane is toxic and must be handled carefully because of the potential hazards it presents. Disregarding the lethal potential of Vikane can result in serious illness, even death.

POISONING SYMPTOMS

Vikane is colorless, odorless and, at low concentrations, non-irritating to mucous membranes. Vikane has no warning properties at working concentrations.

The earliest sign of overexposure to Vikane is central nervous system (CNS) depression. Although dose-response data are not available for effects in humans exposed to Vikane, acute inhalation studies have been conducted on laboratory animals. No signs of CNS depression were observed in rats exposed to 450 ppm for 4 hours, while rats exposed to 750 ppm were lethargic following this exposure time.

Exposure to progressively higher concentrations is expected to result in convulsions, tremors and/or strychnine-like muscular rigidity. Rats exposed to 1000 ppm began to show CNS depression 15 minutes after initiation of exposure, and slight eye irritation was evident after 2 hours. By 3 1/2 hours, the animals were moribund and/or convulsive, and some died shortly after termination of the 4-hour exposure. Rats exposed to 1425 ppm were sedated in 20 minutes, prostrate in 40 minutes, convulsive after 1 to 2 hours and dead in 4 hours.

Humans exposed to high concentrations of Vikane may experience respiratory irritation, nausea, abdominal pain, CNS depression, slowing of movements and speech, and numbness in the extremities. Survival after exposure to high concentrations can occur even following convulsions if exposure has been brief.

PHYSICIAN INFORMATION

The prediction of possible effects in human beings is based in part on observations made on laboratory animals. On this basis, depending upon length of overexposure, it is predicted that persons exposed to Vikane will probably show little evidence of intoxication at first unless the concentration was moderate to high (>400 ppm).

Initial effects will probably be depression on the CNS with slow speech and body movement the first signs noted. Convulsions may ensue with respiratory arrest being a terminal event. Assisted respiration may be necessary. Early symptoms of exposure to sulfuryl fluoride are respiratory irritation and CNS depression. Excitation may follow. Slowed movement, reduced awareness, and slow or garbled speech may be noted.

Remove exposed patient to fresh air and put at rest. It is essential to keep the exposed individual at bed rest and under observation for at least 24 hours. Clinical observation should be directed at the pulmonary, hepatic and renal systems. A postmortem finding in a fatality attributed to sulfuryl fluoride was pulmonary edema. Death was attributed to cardio-respiratory failure.

There is no known antidote. Clinical observation is essential. Treatment is based upon the clinical judgment of the physician and the individual reaction of the patient. Refer to the SDS for Vikane for more detailed information on treatment of observed symptoms.

IN CASE OF EMERGENCY CALL 1-844-845-3129 or 1-352-323-3500

WORKER SAFETY

If the concentration of Vikane in the breathing zone of the fumigated area does not exceed 1 ppm (4 mg/cubic meter), no respiratory protection is required. Confirm concentration of sulfuryl fluoride of 1 ppm or less with a clearance device. Refer to EPA's website at Sulfuryl Fluoride | US EPA (<https://www.epa.gov/ingredients-used-pesticide-products/sulfuryl-fluoride>) for more information and a list of effective clearance devices. Breathing zones are defined as areas within the structure where individuals typically stand, sit, or lie down. If the concentration of Vikane is greater than 1 ppm, further aeration and re-testing is required. When this concentration is exceeded, or when the concentration is unknown, all persons in the exposed area must wear a National Institute of Occupational Safety and Health (NIOSH) or Mine Safety and Health Administration (MSHA) approved positive pressure self-contained breathing apparatus (SCBA, not SCUBA) or combination air-supplied/SCBA respirator such as manufactured by Draeger, Ranger, Survivair, Scott, or MSA.

Two persons trained in the use of Vikane, at least one being an applicator licensed/certified by the state, must be present during introduction of fumigant, reentry prior to aeration, and during the initiation of the initial aeration procedure when exposure exceeds 1 ppm. Two persons need not be present if monitoring is conducted remotely (outside the area being fumigated) and no one enters the fumigated structure.

Personal Protection Equipment

The label for Vikane requires the following personal protective equipment.

Respiratory Protection

Respiratory protection must be worn when the concentration of Vikane in the breathing zone (areas within the structure where individuals typically stand, sit, or lie down) exceeds 1 ppm or when the concentration is not known. Prior to introducing fumigant, the applicator should confirm that SCBAs are available and operational. The respiratory protection must be a NIOSH or MSHA approved, positive-pressure SCBA (not SCUBA) or combination air-supplied/SCBA respirator, such as manufactured by Draeger, Survivair, Ranger, Scott, or MSA.

Consult current OSHA standards and manufacturer recommendations for directions concerning SCBA use and maintenance.

Eye Protection

Wear splash-resistant goggles (goggles designed and made of material that allows no measurable movement of the liquid pesticide being used to pass through them during use) or a full-face shield for eye protection during introduction of the fumigant.

Protective Clothing

Do not wear gloves or rubber boots. Do not reuse clothing or shoes that have become contaminated with liquid Vikane until thoroughly aerated.

IN CASE OF EMERGENCY CALL 1-844-845-3129 or 1-352-323-3500

In all cases of overexposure, such as nausea, difficulty in breathing, abdominal pain, slowing of movements and speech, numbness in extremities, get medical attention immediately. Take person to a doctor or emergency treatment facility.

CHAPTER 3: CYLINDER HANDLING AND STORAGE

CYLINDER SAFETY

Cylinder Information

Vikane is sold as a compressed liquid gas in a high-pressure cylinder and must be handled, stored, and transported with caution. Rough handling or mechanical shock to cylinders such as dropping, bumping, dragging, or sliding should be avoided when possible. Every cylinder should be inspected upon delivery for damage. If the cylinder is damaged, return the cylinder to the distributor for Vikane.

No additional gas is used to pressurize the cylinder. Each full cylinder contains 57 kg (125 lb.) of product normally under about 1380 to 2070 kPa (200 to 300 psi) at typical temperatures (60 to 90°F). Inside the cylinder, a dip tube is connected to the cylinder valve and extends to the bottom of the cylinder.

Cylinder Handling

Cylinders of Vikane are fitted with a special valve system (see Figure 1). The cylinder is equipped with both a safety cap and a covering called a "bonnet" which protects the valve system from being damaged and prevents accidental release of the fumigant. Do not remove valve protection bonnet and safety cap until immediately before use. Replace safety cap and valve protection bonnet when cylinder is not in use. Close valves when fumigant introduction is finished, or the cylinder is empty.

Do not hang or lift cylinders by the valves or the protection bonnet. Use a "hanging" bonnet or other device specifically designed for this purpose when lifting and/or weighing a cylinder on a hanging scale. Hanging bonnets are available through distributors of Vikane.

Figure 1. Vikane Cylinder Valve

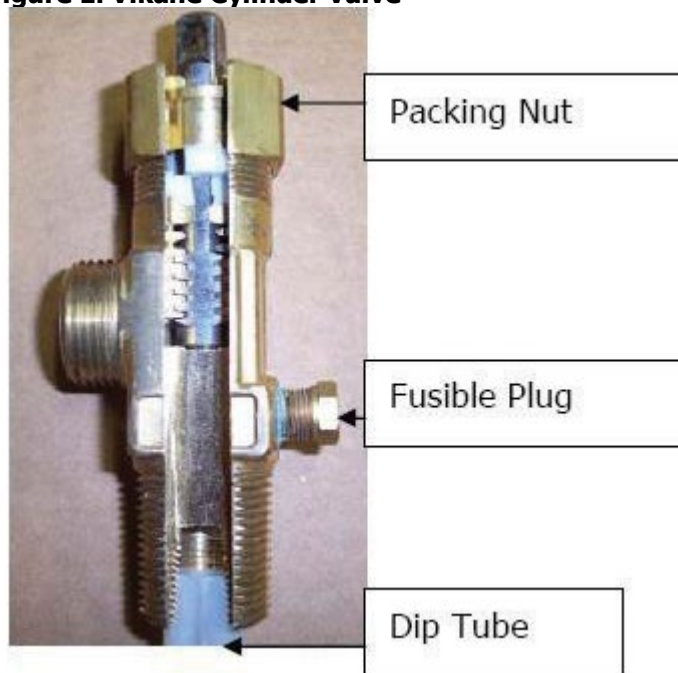

Cylinder Storage

Store cylinders of Vikane in a dry, cool, well-ventilated area under lock and key. Post as a pesticide storage area. If the storage area is in an occupied building, the storage area must have either 1) a forced air ventilation system that meets required local ordinances for the storage of hazardous materials and operates continuously; or 2) be equipped with a permanently mounted and properly maintained and functioning sulfuryl fluoride monitoring device designed to alert occupants of the building if sulfuryl

fluoride in the air of the storage area is greater than 1 ppm. Store cylinders upright, secured to a rack, wall, or similar stable fixture to prevent tipping.

Keep the safety cap and protective bonnet on cylinders except when introducing the fumigant.

Various state and local authorities may regulate the storage of Vikane. Be certain to check with the appropriate authorities in your area.

Do not contaminate water, food, or feed by storage.

Cylinder Transport

Transport cylinders capped, secured, and locked in an upright position. Do not transport cylinders that are unsecured or laying on their side. These are requirements of the Department of Transportation (DOT) when transporting compressed air cylinders. Loose cylinders can become airborne and cause significant damage in an accident.

Because of the toxicity of Vikane, do not transport cylinders in the same airspace as the driver or other occupants of vehicles, such as in vans or unpartitioned trucks.

Always store and transport cylinders in a secured upright position.

Do not transport cylinders of Vikane in the same airspace or breathing zone of any area occupied by the driver and other occupants of vehicles.

Consult your local distributor or Douglas Products for training resources for DOT regulations.

Air Transportation

Never transport cylinders of Vikane by aircraft.

Empty Cylinders

Return all empty cylinders to your distributor of Vikane. Follow proper cylinder handling directions above. When the cylinder is empty, close the valve, screw the safety cap onto valve outlet, and replace protection bonnet before returning to supplier. Only Douglas Products is authorized to refill cylinders. Do not use cylinders for any other purpose.

Remember to close valve completely on empty cylinders.

Avoid marking the cylinder bonnet in any manner.

Avoid marking functional cylinders with paint, tape, or wax pencils, as these materials are difficult to remove when cylinders are processed by Douglas Products and cause confusion with cylinders marked for special service upon return to Douglas Products.

Cylinder Leak Procedures

If a cylinder is suspected of leaking fumigant, evacuate immediate area. Use a NIOSH or MSHA approved positive pressure SCBA (not SCUBA) or combination air-supplied/SCBA respirator, such as manufactured by Draeger, Ranger, Survivair, Scott, or MSA, for entry into affected areas to correct problem. The SCBA must be worn when exposure is greater than 1 part per million (ppm) or when the concentration is

unknown.

Move leaking or damaged cylinder outdoors or to an isolated location, observing strict safety precautions. Work upwind if possible. Do not permit entry into areas in which fumigant concentration exceeds 1 ppm by unprotected persons until concentration of fumigant in the breathing zone (areas within the structure where individuals typically stand, sit or lie down) is determined to be 1 ppm or less. Confirm concentration of sulfuryl fluoride of 1 ppm or less with a clearance device. Refer to EPA's website at Sulfuryl Fluoride | US EPA (<https://www.epa.gov/ingredients-used-pesticide-products/sulfuryl-fluoride>) for more information and a list of effective clearance devices.

Often tightening the packing nut on the top of the valve with an adjustable wrench will stop the leak. Do not use excessive force to open a stuck or improperly seated valve. Call Douglas Products at 1-844-845-3129 or 1-352-323-3500 if immediate guidance is needed on how to handle a leaking cylinder. For cylinders that are deemed to be defective, contact your distributor of Vikane or Douglas Products for return procedures. Avoid using a cylinder in which you believe the valve may be defective.

Once the cylinder is empty, contact your distributor of Vikane for proper return instructions.

IN CASE OF EMERGENCY CALL 1-844-845-3129 or 1-352-323-3500

CHAPTER 4: SITE-SPECIFIC STRUCTURAL FUMIGATION LOG

Structural Fumigation Log requirements. The following elements for structural fumigation for each site must be documented.

The Site-specific Structural Fumigation Log is intended to ensure a safe and effective fumigation. The certified applicator in charge of fumigation is responsible for verifying that a Fumigation Log must contain, as a minimum, the information listed below. The information followed by a "(B)" below must be documented before the initiation of the fumigation; other information listed below without a "B" must be documented during the fumigation process, if not before. Contracts, site graphs, dose calculation reports, state or federally required forms and/or other documents prepared for or used during the fumigation can be used as documentation for these Fumigation Log requirements. Fumigation employees who introduce chloropicrin and sulfuryl fluoride, initiate aeration, and/or conduct final clearance testing must have participated in the registrant's sulfuryl fluoride training, as required by the registrant's stewardship plan.

1. **General Information:**

- Fumigation company (B)
- Fumigation site address (B)
- Structure type (B)
- Target pest(s) (B)

2. **Fumigant introduction:**

Dosing calculations:

- Dosage factor
- Tarp condition
- Seal condition
- Wind (mph)
- Volume of fumigated space (1000 cubic feet) (B)
- Underseal
- Temperature
- Hours of Exposure

Introduction of chloropicrin and sulfuryl fluoride:

- Name, license number, and signature of certified applicator responsible for introduction of chloropicrin and sulfuryl fluoride.
- Name(s) of second trained person(s) and certified applicator(s) assisting with introduction of chloropicrin and sulfuryl fluoride.
- Total ounces of warning agent chloropicrin introduced and number of introduction sites.
- Cylinder serial number(s) of sulfuryl fluoride applied.
- Pounds of fumigant applied.
- Date and time of fumigant release.

3. **Aeration:**

- Name, license number, and signature of certified applicator responsible for initiating aeration.
- Name(s) of certified applicator(s) and second trained person(s) assisting with initiating aeration.

- Date and time of aeration initiated.

4. **Final clearance testing:**

- Name, license number, and signature of certified applicator responsible for conducting final clearance testing.
- Name(s) of certified applicators assisting final clearance testing.
- Date and time final clearance testing completed.
- Clearance device model type.

5. **Emergency preparedness/response information:** Get exposed person to fresh air. Call 911 or an ambulance. Keep exposed person warm and at rest. Make sure person can breathe freely. If breathing has stopped, give artificial respiration. Do not put anything in the mouth of an unconscious person.

6. **Open Comment field:** Provide an open field for additional comments or issues that is not captured in other sections of this Structural Fumigation Log.

CHAPTER 5: FUMIGATION PREPARATION

Fumigator should read and be familiar with the Manual prior to using the fumigant.

Some local ordinances may require notification of local police or fire department and emergency responders of impending start and finish times for a structural fumigation, and relevant safety and health information on the fumigant to be used, in case of emergency.

Always follow federal, state, and local regulations.

OCCUPANTS/CUSTOMER COMMUNICATIONS

Fact Sheet

After the parties enter into a fumigation contract, the Fact Sheet for Vikane must be provided to an adult occupant of the structure to be fumigated or of each currently occupied unit in multi-unit structures. This Fact Sheet is required by the label for Vikane and should not be confused with the customer checklist required by some state regulations. Copies of the Fact Sheet may be ordered from Douglas Products or your distributor representative for Vikane.

Property Owner/Customer Checklist

Follow state requirements for informing occupants and owners of buildings to be fumigated of the fumigation process and of their involvement in preparation, vacancy, and re-occupancy. Some states require the applicator to provide the customer with a list of preparations required for the fumigation. The customer may also be required to acknowledge in writing certain liabilities, such as potential damage to plants included within the fumigation or tarping space, and fragile structural features such as tile roofs, antennas, gutters, awnings, attached fences, etc.

Listed below are items that the applicator should consider informing owners and occupants of a building to be fumigated prior to the fumigation. Some of these items of notification may be required by state regulations.

- Their specific role of occupant/owners in preparation for fumigation - what to prepare, turn off, remove, etc.
- There can be no entry by unauthorized personnel into the structure until it is certified clear for reentry by the fumigation company.
- The applicator or state regulations may require property owners to provide keys to the applicator for the structure to be fumigated. Follow state regulations regarding fumigator access to the fumigated space.
- Occupants/owners should inform the applicator of known or potential connections to adjacent buildings.

MULTI-UNIT STRUCTURES

When fumigating a single unit/room within a larger structure (such as townhouses, apartments, condominiums), all units of the entire structure must be prepared as a fumigated structure, and all applicable rules, regulations and label instructions apply, such as occupant notification, structure preparation, posting, securing and aeration. An adult occupant of each currently occupied unit must be provided with the Fact Sheet for Vikane.

CONNECTED STRUCTURES

A connected structure is defined as any structure connected with the structure to be fumigated by construction elements (e.g., pipes, conduits, ducts, etc.) which may allow passage of fumigant between the structures. If state rules and regulations do not describe or permit a process to isolate and seal a connected structure to prevent passage of fumigant from the fumigated structure, then the connected structure must be vacated during the fumigation. When it is necessary to vacate any connected structure, that structure shall be considered as a fumigated structure and all applicable rules, regulations and label instructions apply, such as occupant notification, structure preparation, posting, securing, and aeration. The connected structure does not need to be sealed. Chloropicrin does not need to be introduced into the connected structure. Chloropicrin need only be used in the space where Vikane is introduced. Concentration levels of Vikane must be measured (see Aeration and Clearance Testing) in any connected space or structure to confirm concentrations are 1 ppm or less before structure can be reoccupied.

WHAT TO REMOVE PRIOR TO FUMIGATION

Remove from the structure to be fumigated all persons, domestic animals, pets, and desirable growing plants.

Domestic animals and pets do not include feral animals, which include domesticated animals that have reverted to a wild condition and are not legally owned by any person(s). If pets, domestic or feral animals are observed or known to occupy areas of the structure to be fumigated, it is recommended that the fumigator and property owner determine whose responsibility it will be to remove, trap, or otherwise exclude these animals from the structure prior to the fumigation. It is recommended that the applicator inform occupants and owners of the following: 1) to notify nearby neighbors of the date of fumigation; 2) to keep pets away during the fumigation; and 3) to close off any open access to the subarea to prevent pets from entering. This should assist in vacating the structure of pets, domestic and feral animals prior to the fumigation.

Remove fish tanks containing live fish, remove the fish from the tank, or develop a plan for preparing the tank for fumigation. If necessary, exclude water in the tank and biological filters, if present, from the fumigated space by sealing with gas resistant tarps or sheeting. If water aeration is required during fumigation, provide fresh air from outside the fumigated space for the tank aerator.

For mattresses (excluding waterbeds) and pillows completely enveloped in waterproof coverings, do one of the following: 1) open the seal of the waterproof covering or 2) remove the mattress or pillow from the space to be fumigated if the waterproof covering cannot be opened. Mattresses and pillows with waterproof coverings containing built-in vents designed to permit air passage are considered to have an open seal to the waterproof covering and can remain as-is in the fumigated space.

Food, feed, drugs (including tobacco products), and medicinals (including those items in refrigerators and freezers) can remain in the structure if they are in plastic, glass, or metal bottles, cans, or jars with the original manufacturer's air-tight seal intact. Food, feed, drugs (including tobacco products), and medicinals (including those items in refrigerators and freezers) not in plastic, glass, or metal bottles, cans, or jars with the original manufacturer's air-tight seal intact, need to be removed from the fumigation site, or double bagged in Nylofume® bags, which are available from distributors of Vikane.

Opened items that do not need to be removed or sealed in Nylofume bags include dental hygiene products (including toothpaste, mouthwash, dental adhesives, and dental whitening products), cosmetics including lipstick, all externally applied lotions and ointments, ice, and water.

Sulfuryl fluoride can react with strong bases such as some photo developing solutions. It is advised that the fumigator recommend to occupants that photo developing solutions that are not in a manufacturer's airtight container be removed or bagged in Nylofume bags prior to the fumigation or replaced after the fumigation.

FLAMES OR HEATING ELEMENTS

Vikane is a very stable compound that is relatively non-reactive and non-flammable. However, under high heat conditions present in gas flames or glowing electric elements, Vikane can decompose into sulfur dioxide (SO₂), hydrogen fluoride (HF), and other decomposition products. HF readily solubilizes in water to form hydrofluoric acid. This acid is highly reactive and can corrode or damage many materials including metals, glass, ceramic finishes, and fabrics. Therefore, extinguish all flames including pilot lights of furnaces, hot water heaters, dryers, gas refrigerators, ranges, ovens, broilers, gas fireplaces, etc. Turn off or unplug all electrical heating elements such as those in heaters, dryers, etc. Turn off or unplug all heaters, electric pianos, or organs, etc. Shut off automatic switch controls for appliances and lighting systems that will be included in the space to be fumigated.

Follow procedures required by the local gas company when shutting off natural gas or propane service. The local gas company or other appropriate authority will need to turn on gas service after it has been turned off to determine that the gas flow and pressure are normal.

Before fumigating, extinguish ALL flames, including pilot lights and turn off ALL glowing heating elements. The heat of gas flames, pilot light flames, or the glowing wires or hot surfaces of electric heaters can cause Vikane to break down to form a corrosive material.

Chlorine Gas: Confinement of chlorine gas in an airspace can damage metals. This can occur from the inclusion in the tent of the swimming pool chlorinators that generate chlorine gas for chlorination. Therefore, these pieces of equipment should either be turned off or excluded from the fumigation.

GAS DISTRIBUTION

Open operable internal doors, internal openings to attics and sub areas, furniture with large voids (such as wardrobes, etc.), cabinets, drawers, closets, and appliances (such as washers, dishwashers, dryers, microwaves, conventional ovens, etc.). This will aid in fumigant distribution and aeration. Refrigerator and freezer doors may be left open if the units are turned off or disconnected and all food items have been removed. If the applicator chooses to leave any appliance, including refrigerators and freezers, closed during the fumigation, the appliance must be opened when clearing the structure until the concentration of Vikane in it is 1 ppm or less.

If the structure has an attached garage, the door between the garage and structure should be open during aeration. This door can remain open during the fumigation.

FAN PLACEMENT AND SPECIFICATIONS

Purpose of Fans

There are three purposes for fans in a structural fumigation:

1. Fumigant introduction
2. Equilibrium and circulation
3. Aeration

Positioning Fans

The following is a requirement for positioning of fans:

- During aeration, open all operable attic doors and accesses and direct a fan into the attic. This fan can be positioned prior to fumigant introduction and operated throughout the fumigant exposure period if desired. There is no set pattern established for the positioning or the number of fans to use.

The following guidelines for fan placement may be followed when practical:

- Introduction: Each fan used at a release point for fumigant introduction should be into a large open space in the fumigation site. Multiple release points may be necessary depending upon the size of the fumigated space and the amount of fumigant to be introduced (see Chapter 8 on Introduction of Vikane).
- Equilibrium: Fans should be strategically placed to facilitate rapid dispersion and equilibrium of the fumigant:
 - Consider using at least one fan for each level of the structure, including basements.
 - If a building is compartmentalized, such as containing steeples or towers, consider placing fans in each compartment or section.
 - Consider using at least one fan per 45,000 cubic feet of space for circulation. The number of fans required will depend upon the structure volume and configuration.
- Aeration: If the structure has a central air handling system, the fan (or blower) should be activated for each unit if operational. As an alternative, a fan may be placed in front of a furnace inlet to blow air into central heating and cooling ducts. This fan can be positioned prior to fumigant introduction and operated throughout the fumigant exposure period if desired.

Fan Specifications

There are specifications for fan capacity used at a release point for fumigant introduction and during aeration as follows:

- Introduction: These fans must have a *minimum* capacity of at least 1000 cubic feet per minute (cfm) for each pound of Vikane released per minute. More than one fan can be used at the fumigant release point to obtain this capacity.
- Aeration: Fan capacity and dimension requirements vary based on type of structure being aerated. Check on fan requirements based on type of structure aerated (See Chapters 10 and 11).

Check the manufacturer rating for fan capacity (cfm) to determine if sufficient capacity is used to meet label requirements.

Other specifications for fans used during fumigation are at the discretion of the applicator, unless otherwise specified by state and local laws. It is recommended that the applicator consider the following when selecting and installing fans at a fumigation site:

- The fans should be UL listed and grounded. Fans are available with a thermal shut-off switch that automatically turns off the fan motor if it overheats.
- Use fans that have a durable housing to protect the blades, such as metal cage fans, commercial or industrial grade fans, etc.
- Use fans with housing and electric cords intact.

Reaching Equilibrium

When liquid Vikane is released from the introduction hose, it extracts heat from the surrounding air as it expands to form a gas. A pound of liquid Vikane changing to the gas phase will drop the temperature of 1000 cubic feet of dry air 4.5°F (28.3 m³ of air 2.5°C).

The chilling can cause the formation of a cloud of condensed water (fog) that should be dissipated before it collects on a surface. The rate of dissipation depends upon the fumigant release rate, relative humidity, and fan capacity, quantity, and placement.

Vikane gas is heavier than air and can initially settle to the bottom of the fumigation space unless mechanically mixed. Vikane will eventually move from an area of high concentration to low concentration and can reach equilibrium in a confined space without the use of fans. Nonetheless, the rate of passive diffusion of Vikane may be too slow to achieve equilibrium within a desirable period so mechanical mixing of Vikane with air using fans is important.

Continuous Circulation with Fans

After fumigant introduction is completed and equilibrium is obtained, fans may be left operating during the fumigation exposure period if desired. Continuous circulation using fans during the fumigant exposure period will not detectably affect the loss rate (half-loss time, HLT) of Vikane for an adequately sealed structure.

Prepare for Aeration Procedures 1 and 2 by doing the following:

- Open all operable attic doors and accesses and direct a fan into the attic.
- Position introduction and circulation fans to provide for air circulation throughout the fumigated space. For example, a circulation fan in the hall could be used to aid air circulating in bedrooms and bathrooms.
- For residential structures, use a minimum of one fan of at least 18 inches in diameter for every 22,500 cubic feet of space to be fumigated.¹

ELECTRICITY

Electricity is needed to operate fans during fumigant introduction and aeration. If electricity is not available on the property to be fumigated, the applicator should make alternate arrangements, such as having a generator or securing power from a neighbor.

MONITORING HOSES

If fumigant concentrations will be monitored during the fumigant exposure period, monitoring hoses are placed in the structure prior to fumigant introduction. Consult the chapter on Monitoring Vikane for guidance on placement of monitoring hoses.

SEALING THE STRUCTURE

Increasing the seal (HLT) of the fumigation site is one of the most effective ways to ensure a quality fumigation and reduce the total amount of fumigant needed. There are various methods available to seal structures.

Tape and Seal

Some types of construction, such as stucco, brick masonry block, concrete, and metal, may be adequately sealed by using sealing materials, such as polyethylene sheeting, laminated paper, non-porous panels, fumigation tape, spray adhesives, foams, and/or insulation materials. These materials are used to seal gaps in doors, windows, roof eaves, loading docks, pipes, vents, and other openings. When properly used, these

¹ A residential structure is where people typically live (temporarily or permanently) and sleep, such as single-family residences, mobile homes, apartments, townhouses, condominiums, hotels, motels, assisted care facilities, nursing homes, hospitals, barracks, and dormitories.

materials can adequately confine the fumigant within the structure.

However, even with thorough taping and sealing, fumigant can leak through the building walls and roof at an unknown rate. The Vikane Fumiguide® Calculator for estimating HLT was developed for tarped structures and may not accurately estimate the HLT of tape and seal structures (see Chapter 6 on Fumiguide® Calculations). For this reason, it is recommended to monitor a tape and seal structure with a Fumiscope or similar device to confirm the HLT and adequate dosage accumulation (see Chapter 9 on Monitoring Vikane).

Tarping

Tarpaulins (tarps) can be used to cover the entire structure/area being fumigated, or in combination with tape and seal methods, to cover part of a structure. This method is effective on a wide variety of structure sizes and types. The ability of a tarp to contain a gas depends upon its construction material, the condition of the tarp, and the quality of the tarp installation.

Tarp Material

Use tarps made of materials that will adequately confine Vikane for the required time, such as 4 to 6 mil polyethylene, laminated polyethylene, vinyl coated nylon, neoprene coated nylon, and PVC (polyvinyl chloride) coated nylon.

Materials of at least 4 mil (160 microns) in thickness should be used. Polyethylene tarps less than 4 mil (160 microns) are not recommended because they do not possess the strength and weight needed for the handling, wind resistance and abrasion encountered in most fumigations.

Tarp Condition

Tarps should be kept in good repair to minimize fumigant loss through tears and extensive abrasions. It is recommended to seal tarp tears using appropriate methods, which can include sewing, patching with tarp material using glue or a heat gun, taping, or rolling and clamping the tarp to cover these openings. Consult manufacturers for recommended repair methods for their tarps.

The applicator can protect tarps from tearing by covering sharp structural edges with materials such as tape, carpeting, corner pads, etc.

Tarp Installation

To minimize escape of gas through the soil and to avoid injury to nearby plants, wet soil outward from foundation to the cover if not sufficiently moist to act as a barrier for the gas. Watering the soil in the subarea of crawlspace structures immediately prior to fumigation is not recommended in geographies with high humidity and high soil moisture content, such as the southeastern U.S., because moisture may condense on interior surfaces during the fumigation causing water damage and/or odor problems. For fumigated structures located over or adjacent to water, placing tarps in water can provide an adequate underseal.

To minimize gas loss, a smooth ground surface should be created when practical for tarps to contact by following steps such as:

- Rake back sufficient loose material, such as mulch, gravel, bark chips, pine needles, and debris from the foundation.
- Use sand or soil to ramp, or use tape and adhesives, to seal gaps around rigid, immovable objects, such as curbs, pavers, and garden edging.

Seal the bottom edges of the tarp to the ground using materials such as soil, sand, or

weighted "snakes," (tubular bags filled with sand, gravel, or water). Sufficient tarp "apron" should be available at ground level for the sealing and to accommodate shifting of tarps from wind movement. These guidelines may be followed to minimize gas loss:

- Use sufficiently filled snakes for sealing tarps for expected conditions.
- Overlap snakes to minimize fumigant passage between them.
- For water snakes, roll and securely clamp the ends to minimize water leakage during the fumigation exposure period. Block/secure the water snakes to prevent them from rolling off the tarp apron.

Where tarps join, the edges should be tightly rolled and clamped. Tall or highly stressed tarp seams, such as in windy conditions, will require closer spacing of clamps.

Conduits

The fumigated structure should be inspected for pipes, conduits, ducts, or others features which would result in fumigant loss outside of the fumigated space. If possible, these features should be sealed to stop excessive gas loss.

PLACARDING AND SECURING FUMIGATED AREAS

Posting of Fumigated Areas

The following is a baseline of requirements for warning signs to be posted for fumigations using Vikane. States that currently have requirements that are comparable to the elements listed here, can maintain those requirements for warning signs. Additional elements imposed by states may also be added to these warning signs.

1. The applicator must post the fumigated areas with warning signs with a white background stating the following:
 - a. The signal word DANGER/PELIGRO at a minimum height of 2 inches, the SKULL and CROSSBONES symbol at a minimum height of 1 inch, and the statement "Area under fumigation, DO NOT ENTER/NO ENTRE" all printed in one or more colors contrasting with the white background.
 - b. The date of fumigation.
 - c. Brand name of fumigant used (minimum height ½ inch).
 - d. Name, address, and telephone number of the applicator, or company performing the fumigation.
2. Information on warning signs must remain legible and visible for the duration of the fumigation and aeration periods.
3. Warning signs must be placed on the structure at or near all doors and entrances.
4. On tented structures, additional warning signs must be placed on the outside of the tarp so that they are clearly visible from all accessible sides, and from any direction from which the site may be approached.

The following are additional considerations for posting warning signs:

- Securely affix warning signs to the structure.
- Use telephone number(s) written on the warning signs that allow for prompt 24-hour communication, including weekends, with the certified applicator in case of emergency.
- Follow all state and federal regulations regarding use of and information reported on warning signs. Some states have additional regulations regarding warning sign formatting, size, color, information content, placement, and weather durability.

Only a certified applicator may authorize removal of warning signs. The warning signs may be removed only when the concentration of Vikane within the breathing zones (areas within the structure where individuals typically stand, sit, or lie down) of the fumigated area is 1 ppm or less after Step 3 of the aeration procedure.

Warning Agent

Vikane has no intrinsic warning properties. Chloropicrin is used as a warning agent and is introduced into the fumigated structure at least 5 to 10 minutes before Vikane is introduced (see Chapter 7 on Release of Warning Agent).

Securing Structures

To secure the structure against unauthorized entry during the fumigation exposure period and Step 2 of Aeration Procedure 1 or 2 (see Chapter 10 on Aerating and Clearance Testing), use a locking device or barricade on all exterior doors or doorways. A locking device, such as a secondary lock, or barricade must be demonstratively effective in preventing an exterior door or doorway from being opened from the exterior using normal opening or entering processes by anyone other than the certified applicator in charge of the fumigation or persons in his/her on-site direct supervision. Consult state and local regulations for any supplementary instructions and restrictions on securing against entry.

Examples of common locking devices to secure the fumigated structure against unauthorized entry include:

Clam Shell Locks

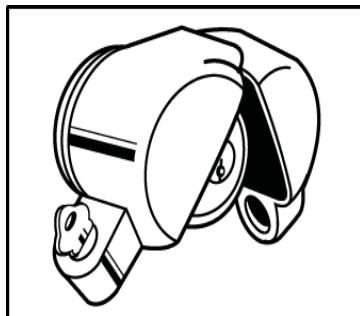

Clam shell locks are designed to prevent use of the door or occupant's keys to unlock entrance doors.

Key-Way Locks

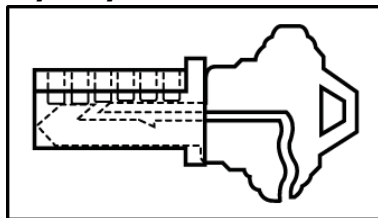

Key-way locks are designed to prevent use of the occupant's keys to unlock entrance doors. These function by inserting a two-part locking key into the door keyhole and removing only half of the key. The other half of the locking key remaining in the door prevents insertion of the occupant's key.

J-SAFE Locks

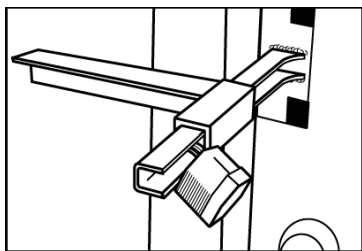

A variety of other devices, such as chains, padlocks, plywood, and c-clamps, can be used depending upon the entrance configuration.

Existing locking devices, such as pins or bars for sliding glass doors, or interior bolts, can be used to secure entrances without the use of secondary locking devices if the devices cannot be opened or removed from the exterior of the structure. Electronic keycard and "keyless" locks, including push button locks, can be used if the access code can be changed so that only the certified applicator in charge of the fumigation or persons in his/her on-site direct supervision have the access code, and the codes used by the owner/occupants are not functional during the fumigation. Otherwise, locking devices, barricades, or other methods must be used to secure exterior entrances using electronic, keyless locks.

The purpose of opening windows in tarped buildings during the fumigant exposure period is to reduce the time for the fumigant to reach equilibrium inside the building and between the building and the tarps. For wood-destroying insects, this can be necessary for sufficient fumigant exposure of target pests infesting external structural features such as wood eaves and soffits. Windows are not considered normal entries and should be opened, if operable and as permitted by local and state regulations, during fumigation of tarped buildings. Consult state and local regulations for any supplementary instructions and restrictions on opening windows.

Although windows are not considered normal entries, in areas where security may be an issue, fumigators may do the following to reduce the number of windows that need to be opened during the fumigant exposure period:

- For single story structures, open at least one operable window in each room, including garages, that contain one or more windows that can be accessed and opened by normal means (e.g., does not require moving furniture, removing nails, or cutting seals such as paint).
- For multi-story structures with shared interior airspace between floors, all windows on the ground level may remain closed. Open at least one operable window in each room of upper stories that contain one or more windows that can be accessed and opened by normal means (e.g., does not require moving furniture, removing nails, or cutting seals such as paint).

Guards

For fumigation of passenger rail cars using Vikane, guards may be used in lieu of use of chloropicrin as a warning agent. Guards may be required in state or local regulations or by the customer. If chloropicrin is not used as a warning agent when fumigating passenger rail cars with Vikane, then a guard is required.

CHAPTER 6: FUMIGUIDE® CALCULATIONS

FUMIGANT DOSAGE

The dosage of a fumigant is calculated as the product of its concentration (C in ounces) and exposure time (T in hours). The oz-hr dosage can be achieved by varying C (ounces/1000 cubic feet) and T (hours) to produce a toxic effect on the target pest(s). Therefore, the oz-hr dosage required to kill the target pest(s) is accumulated over a period of time and is measured in ounce-hours.

$$\text{Dosage} = \text{Concentration (C)} \times \text{Time (T)} = \text{oz-hr/1000 cu ft} = \text{oz-hr Dosage}$$

The concentration in oz/1000 cu ft of fumigant multiplied by the exposure time in hours.

Concentration of Vikane
1 oz/1000 cu ft = 240 ppm

FACTORS AFFECTING OZ-HR DOSAGE

The oz-hr dosage required is determined by the target pest species and life stage, and the temperature at the site of the target pest.

Pest Factor

The toxicity of fumigants, including Vikane, is determined largely by the uptake of fumigant by the target pest during the time of exposure. The post-embryonic stages of all arthropods tested are more susceptible to Vikane than the eggs and are controlled with relatively low dosages of Vikane. Table 1 shows oz-hr dosage in laboratory trials required to control different life stages of various pest species.

Higher dosages of Vikane are required for complete control of the egg stage of non-social insects. For social insects, such as termites and ants, control of the egg stage is not necessary when workers are eradicated. The larvae of social insects hatching from eggs will not survive without the care of workers. For termites and ants, fumigant dosages lethal for workers will also kill winged reproductives, called swarmers.

Table 1. Lethal Accumulated Dosages (LAD₉₉) (oz-h/1000 cu ft) of Sulfuryl Fluoride for Various Arthropod Species

Species		Hrs of exposure	Temp (°F)	Life Stage of Arthropod			
Scientific Name	Common Name			Adult	Egg	Larva/ Nymph	Pupa
Ticks and spiders							
<i>Rhipicephalus sanguineus</i>	brown dog tick	16	72	186 ^d (2) ^h	--	--	--
		8	81	108	--	--	--
<i>Latrodectus hesperus</i>	black widow spider	20	81	82 (4)	300 ^a	--	--
<i>Loxosceles reclusa</i>	brown recluse spider	20	81	77 (7)	--	--	--
Cockroaches							
<i>Periplaneta americana</i>	American cockroach	16	80	9 ^c (7)	413 ^c (14)	--	--
		8	81	--	>402 ^d (14)	--	--
<i>Blattella germanica</i>	German cockroach	16	80	19 ^c (3)	--	--	--
		4	70	16 (2)	64 ^c (13)	--	--
		8	81	--	--	17 ^f (9)	--
<i>Supella longipalpa</i>	brown-banded cockroach	16	80	64 ^a (14)	>256 ^d (14)	64 ^a (14)	--
Termites							
<i>Neotermes jouteli</i>	--	22	81	36 (5)	--	--	--
<i>Zootermopsis angusticollis</i>	western dampwood termite	22	81	35 (5)	--	--	--
<i>Kaloterms approximatus</i>	--	22	81	44 (5)	--	--	--
<i>Cryptotermes cavifrons</i>	--	22	81	37 (5)	--	--	--
		4-20	81	48 ^a (3)	--	--	--
<i>Incisitermes snyderi</i>	--	22	81	46 (5)	--	--	--
<i>Incisitermes schwarzi</i>	--	4-20	81	48 ^a (3)	--	--	--
<i>Incisitermes minor</i>	western drywood termite	22	81	51 (5)	--	--	--
		24	80	47 (5-14)	--	--	--
<i>Reticulitermes flavipes</i>	eastern subterranean termite	22	81	20 (5)	--	--	--
<i>Reticulitermes tibialis</i>	--	22	81	30 (5)	--	--	--
<i>Coptotermes formosanus</i>	formosan subterranean termite	22	81	39 (5)	--	--	--
		4-20	81	48 ^a (3)	--	--	--
		24	86	132 ^a (0)	--	--	--
<i>Prorhinotermes simplex</i>	--	22	81	42 (5)	--	--	--
Bed bugs							
<i>Cimex lectularius</i>	bed bug	16	80	64 ^a (14)	64 ^a (14)	64 ^a (14)	--
		24	77	95.9 ⁱ (7)	69.1 (7)	95.9 ⁱ (7)	--
		24	59	238.1 ⁱ (3)	149.8 (8)	238.1 ⁱ (3)	--
Dermestid beetles							
<i>Attagenus unicolor</i>	black carpet beetle	16	80	--	1213 ^e	38 ^c (14)	--
		22	80	44 (4)	1694 (18)	68 (2)	--
<i>Anthrenus flavipes</i>	furniture carpet beetle	22	80	78 (6)	854 (18)	156 (8)	--
<i>Dermestes maculatus</i>	hide beetle	22	80	29 (3)	769 (5)	28 (6)	--
<i>Trogoderma granarium</i>	khapra beetle	8	70	--	>499 ^d	80 ^c	128 ^c
Wood-boring beetles							
<i>Lasioderma serricorne</i>	cigarette beetle	16	80	15 ^c (14)	--	--	--
		22	80	35 (3)	712 (10)	56 (3)	--
<i>Lyctus planicollis</i>	southern lyctus beetle	16	79	--	512 ^c	--	--
<i>Lyctus brunneus</i>	--	6.5	72	--	289 ^{a,d}	--	--
<i>Euvrilletta peltata</i>	--	18	72	--	470 ^{a,h}	--	--
<i>Hemicoeus gibbicollis</i>	--	20	72	--	>500 ^d	87 ^a	--
Grain beetles							
<i>Tribolium confusum</i>	confused flour beetle	5	77	55 (7)	--	--	--
		16	80	55 ^c (14)	1125 ^c (14)	--	--
		24	80	--	1517 ^c	--	--
<i>Sitophilus granarius</i>	granary weevil	5	77	18 (7)	--	--	--
		16	80	15 ^c (14)	794 ^c (14)	14 ^c (14)	14 ^c (14)
<i>Rhyzopertha dominica</i>	lesser grain borer	16	80	10 ^c (14)	219 ^c (14)	--	21 ^c (14)
<i>Oryzaephilus surinamensis</i>	sawtoothed grain beetle	16	80	14 ^c (7)	--	--	--
<i>Tenebroides mauritanicus</i>	cadelle	5	77	--	--	82 (7)	--
Moths							
<i>Ephestia elutella</i>	tobacco moth	16	80	--	768 ^a (14)	64 ^a (14)	--
<i>Sitotroga cerealella</i>	Angoumois grain moth	16	80	21 ^c (3)	87 ^c (14)	24 ^c (14)	--
<i>Anagasta kuehniella</i>	Mediterranean flour moth	16	80	34 ^c (3)	--	42 ^c (14)	--
<i>Spodoptera eridania</i>	southern armyworm	16	80	--	363 ^c	--	--
<i>Tineola bisselliella</i>	webbing clothes moth	10	80	--	280 ^a (14)	70 ^c (14)	--
Flies and fleas							
<i>Musca domestica</i>	house fly	16	80	15 ^c (0)	--	--	22 ^c
<i>Ctenocephalides felis</i>	cat flea	20	72	--	--	--	24 ^e

Species		Hrs of exposure	Temp (°F)	Life Stage of Arthropod			
Scientific Name	Common Name			Adult	Egg	Larva/Nymph	Pupa
Ants							
<i>Camponotus floridanus</i>	carpenter ant	8	81	18 (5)	--	--	--
<i>Camponotus modus</i>	carpenter ant	8	61	48 (8)	--	--	--
<i>Camponotus vicinus</i>	carpenter ant	8	61	35 (8)	--	--	--

^aLowest LAD (oz-h/1000 ft³ is equivalent to mg-h/h and g-h/m³) tested resulting in 100% mortality of life stage.

^bNumber in parentheses is days after fumigation at which mortality was assessed.

^cLAD₉₅

^dHighest concentration tested; emergence from same eggs/egg cases observed.

^eLAD₉₀

^fNinth-generation selection of survivors from exposure to sulfuryl fluoride.

^g>2-day old eggs.

^h>4-day old eggs.

ⁱLowest dosage tested for confirmatory trials

Source: E.M. Thoms and Scheffrahn, R.H. (1994) "Control of Pests by Fumigation with Vikane Gas Fumigant." DOWN TO EARTH™ 49(2).

Temperature

As temperature decreases, the respiration rate of arthropods decreases, reducing fumigant uptake. Therefore, the fumigant dosage must be increased as the temperature at the site of the target pest decreases. The exception to this is rodents, which are warm-blooded animals and do not require increased dosages at lower temperatures. To determine the proper dose for rodent control, use 80°F as the calculating temperature.

THE VIKANE FUMIGUIDE® CALCULATOR

The Vikane Fumiguide® Calculator is used for fumigations using Vikane. Software versions of the Fumiguide® Calculator are available for use on various devices and platforms. Contact Douglas Products or your distributor of Vikane for information on how to obtain the Fumiguide® Calculator.

The Vikane Fumiguide® Calculator is part of the labeling for this product and must be used to calculate the dose to apply, unless Vikane is used for quarantine/regulatory purposes as specified by a regulatory authority, such as a local, state, federal, tribal, or international authority. For quarantine/regulatory treatments, follow the requirements for dosage rates, treatment temperatures and periods, monitoring, and other procedures specified by the authority responsible for the treatment schedule. Douglas Products assumes no risk or liability for loss or damage from fumigation performed for quarantine/regulatory purposes.

General guidelines for use of the Vikane Fumiguide® Calculator are provided below.

Calculating HLT

Fumigant confinement is described as HLT, the time for the initial fumigant concentration to be reduced by half. The Fumiguide® Calculator uses five factors to estimate HLT:

1. Tarpaulin (tarp) condition
2. Seal condition (where a tarp is sealed to the ground, structural and landscape features, another tarp, etc.)
3. Wind speed
4. Volume of fumigated space
5. Underseal (concrete for slab or soil type for crawlspace)

Considerations when estimating HLT using the Fumiguide® Calculator:

- **Tarpaulin condition and seal condition are qualitative ratings and are based upon the experience of the applicator.** If the applicator does not know how to rate these conditions or the building is a tape and seal with no tarpaulin used, it is recommended that the fumigation be monitored to determine the actual HLT.

- **The average forecasted wind speed for the duration of the fumigation can be used for calculating the HLT** because the wind speed prior to fumigant introduction may change during the fumigant exposure period.
- **The structural volume is the product of the building length (L), width (W), and average height (H).** For a square or rectangular, flat-roofed building, the volume is $L \times W \times H$. For a structure with a typical gabled roof, the average height equals the height to the roofline (eaves) plus one-half the height from the roofline to the roof peak. For basement structures, the distance below grade to the flooring should be included in height measurements to calculate volume. For tarped structures, areas within the tarped space, such as chimneys, steps, decks, and roof overhangs, should be included in the volume for the fumigated space. If desired, contact Douglas Products for training materials on calculating volumes for more complex structures to be fumigated with Vikane.
- **If a structure contains both slab and crawlspace foundations, the underseal should be based upon the soil type in the crawlspace** unless this crawlspace is small in size compared to that of the slab or is partitioned from the slab for fumigation.

Calculating the Oz-Hr Dosage

The Vikane Fumiguide® Calculator calculates the oz-hr dosage based upon the target pest species, its life stage, and temperature at the site of the target pest. In the Fumiguide® Calculator, a dosage factor of "1" is the oz-hr dosage for drywood termites. For other target pests, the Fumiguide® Calculator calculates higher or lower dosages as multiples of the dosage required to kill drywood termites at the same temperature, depending upon the susceptibility of these pests to Vikane. For example, 10-fold the drywood termite dosage is required to control the egg stage of anobiid beetles (see Table 2).

Table 2.

Target Pest	Dosage Factor (as a multiple of drywood termite dosage)
rodents ¹	1/2X
carpet beetles ² , German cockroaches and other cockroach species ²	1X
Bedbugs	1.9X
furniture carpet beetles ²	3X
old house borers and Formosan termites	4X
clothes moths	6X
powder post beetles and death watch beetles	10X

Do not use less than the specified dosage factors when treating for rodents, cockroaches, bed bugs, and termites.

¹To determine the proper dose for rodent control, use 80°F as the calculating temperature. Unlike insects, rodents are warm blooded and do not require increased dosages at lower temperatures. At least 36 ounce-hours must be accumulated, regardless of temperature, for successful rodent fumigation.

²More than one fumigation may be needed to control the infestation after egg hatch.

Calculating the Amount of Vikane to Introduce

The Fumiguide® Calculator calculates the amount of Vikane to introduce into a fumigated space based upon the following factors:

- **Estimated HLT**
- **Monitored or non-monitored fumigation** - To compensate for not confirming the actual HLT, 33% more Vikane is added to a non-monitored fumigation compared to a monitored fumigation when all other conditions are equal. Monitoring a fumigation can reduce the amount of Vikane applied.
- **Oz-hr dosage to be accumulated**
- **Exposure time (for oz-hr dosage accumulation)** – Exposure time for oz-hr dosage accumulation is measured from fumigant equilibrium to the initiation of aeration. It can take one hour on average for sulfuryl fluoride to reach equilibrium throughout the fumigated space, including pest harborages, after fumigant introduction is completed. Therefore, it is recommended to subtract one hour from the end of fumigant introduction to the initiation of aeration to obtain the exposure time used for Fumiguide calculations.
- **Volume of the fumigated space**

Using the Vikane Fumiguide® Calculator When Monitoring

During the exposure period, the concentration of Vikane can be measured by high concentration sulfuryl fluoride measuring instrument, such as a Fumiscope, SF-ReportIR, SF-400, or similar device at two or more time intervals to calculate the actual HLT, per the following recommendations:

1. Measure (with a high concentration sulfuryl fluoride measuring instrument such as a Fumiscope, SF-ReportIR, SF-400, or similar device) the concentration of Vikane/1000 cu ft at or after equilibrium which typically occurs about one hour after fumigant introduction is completed.
2. Take a second measurement of concentration of Vikane after a sufficient time elapsed to calculate the HLT (See Chapter 9 on Monitoring Vikane). Accuracy of calculating the actual HLT increases as time between monitoring intervals is increased.
3. If the HLT is shorter than estimated (more rapid loss of fumigant), then more Vikane may need to be added to finish on time or the exposure time may be extended if sufficient Vikane remains.
4. Use the Vikane Fumiguide® Calculator to determine actual HLT, oz-hr dosage accumulation, and if additional fumigant or time is needed to achieve the required oz-hr dosage.

For assistance with dosage calculations and the Vikane Fumiguide[®] Calculator, contact your local distributor or Douglas Products' representative or call Douglas Products at 1-844-884-5263.

CHAPTER 7: RELEASE OF WARNING AGENT

Vikane has no intrinsic warning properties, such as odor. The warning agent chloropicrin is released before introducing Vikane to allow time for it to begin to volatilize and distribute throughout the space to be fumigated. Chloropicrin is an effective warning agent but is not intended to be used to vacate people, pets, domestic animals, or feral animals from the structure prior to introduction of Vikane. Therefore, the structure to be fumigated must be inspected to confirm required preparations have been completed prior to introduction of chloropicrin.

The warning agent chloropicrin must be released into the fumigated space after the structure is inspected to confirm required preparations have been completed.

The warning agent chloropicrin must be released into the fumigated space at least 5 to 10 minutes before introduction of Vikane.

The only exceptions to use of chloropicrin would be when fumigating passenger railcars and permanent and temporary fumigation chambers including, but not limited to, shipping containers, storage pods, trailers, and trucks, with the following requirements:

- These structures are not completely covered by tarps.
- A thorough walk-through inspection must be performed of each railcar/chamber with doors being locked immediately upon leaving.
- For railcars, a guard must be posted during fumigant introduction, exposure period, and aeration if chloropicrin is not used.
- A guard is not required for permanent and temporary fumigation chambers, unless required by state regulations, if locking device(s) or barricade(s) are installed that are demonstratively effective in preventing the fumigated space from being entered using normal opening or entering processes by anyone other than the certified applicator in charge of the fumigation or persons in his/her on-site direct supervision.

There may be unusual circumstances in which the use of chloropicrin is not possible due to its unknown effects on sensitive items, such as artifacts in museums or in police evidence storage. In these circumstances, waiving the use of chloropicrin must be approved by the state regulatory authority and must include alternative safety precautions, such as guarding the fumigated site.

PHYSICAL PROPERTIES OF CHLOROPICRIN COMPARED TO VIKANE

Chloropicrin	Vikane
CCl_3NO_2	SO_2F_2
trichloronitromethane	sulfuryl fluoride
threshold limit value: 0.1 ppm	threshold limit value: 1 ppm
boiling point: 112°C (233.6°F)	boiling point: -55.2°C (-67°F)
vapor pressure: 20 mm Hg at 20°C	vapor pressure: 13,442 mm Hg at 25°C

SAFETY PRECAUTIONS WHEN USING CHLOROPICRIN

Chloropicrin is a warning agent that causes smarting of the eyes, tears, discomfort, and has a very disagreeable pungent odor at very low concentrations.

Chloropicrin must be used by a person certified to apply Vikane or under their supervision. Applicators must observe the chloropicrin precautionary statements and personal protective equipment appearing on this label. Chloropicrin must be applied by persons certified to apply Vikane or under their supervision on site, with a second person trained in the use of chloropicrin being available on site.

Personal Protective Equipment

Some materials that are chemical-resistant to this product are nitrile and butyl. For more options, follow the instructions for category F on the chemical-resistance category selection chart.

All persons applying chloropicrin must wear:

- Long-sleeved shirt and long pants
- Chemical-resistant gloves
- Protective eyewear or face shield (do **not** wear goggles)
- Persons applying chloropicrin must wear either a positive pressure SCBA or combination air-supplied/SCBA when one person is applying chloropicrin to more than two chloropicrin introduction points within a single fumigated structure.

The employer of any person applying chloropicrin must make sure that they are provided with and correctly wear the required personal protective equipment. Follow manufacturer's instructions for cleaning/maintaining PPE. If no such instructions for washables exist, use detergent and hot water. Keep and wash PPE separately from other laundry.

First Aid

First aid recommendations, such as time to flush eyes or skin if contacted **by chloropicrin**, vary depending upon the product label. General first aid procedures are as follows:

If inhaled: Move person to fresh air. Keep warm. If person is not breathing, call 911 or an ambulance, then give artificial respiration. Do not give anything by mouth to an unconscious person. Call a poison control center or doctor for further treatment advice.

If on skin or clothing: Immediately remove contaminated clothing, shoes, or any other item on skin. Rinse skin immediately with plenty of water for 15-20 minutes. Call a poison control center or doctor for treatment advice.

If in eyes: Hold eye open and rinse slowly and gently with water for 15-20 minutes. Remove contact lenses, if present, after the first 5 minutes, then continue rinsing eye. Call a poison control center or doctor for treatment advice.

If swallowed: Call a poison control center or doctor for treatment advice. Have person sip a glass of water if they are able to swallow. Do not induce vomiting unless told to do so by a poison control center or doctor. Do not give anything by mouth to an unconscious person.

Note to Physician: Chloropicrin is a volatile liquid that is an active ingredient in tear gas. As a gas it is a powerful lachrymator. Symptoms of overexposure are profuse lachrymation, respiratory distress, and vomiting. Pulmonary edema may develop later.

Storage and Handling

Storage

Store upright in a cool, dry, well-ventilated area under lock and key. Store only in original container. Do not contaminate water, food or feed by storage or disposal.

Spill and Leak Procedures

Evacuate immediate area of spill or leak. Use a self-contained breathing apparatus (SCBA) for entry into affected area to correct the problem. Move the leaking or damaged containers outdoors or to an isolated location, observing strict safety precautions. Work upwind if possible. Allow spilled material to evaporate or absorb onto vermiculite, dry sand, earth, or similar absorbent material. Thoroughly aerate absorbent materials outdoors prior to disposing on site or at an approved disposal facility. Do not permit entry into spill area or cleanup area by unprotected persons until chloropicrin is aerated.

Disposal

If the chloropicrin container is disposable and is non-returnable to the supplier, it is recommended to aerate the empty container opened (e.g., cap off) within the fumigated space during fumigation. The

location should be close to a fan and/or chloropicrin introduction site. Replace cap. After it has been aerated inside of the fumigated space, close the container (e.g., replace the cap) and dispose in a sanitary landfill or by other approved state and local procedures.

INTRODUCTION OF CHLOROPICRIN

Research indicates that when chloropicrin is applied according to label directions at each introduction site for Vikane, it will rapidly reach and maintain warning concentrations throughout the fumigated space for the fumigation exposure period. In order for chloropicrin to perform effectively as a warning agent, it must be applied:

- In a shallow container with fresh wicking material.
- In the air stream of a fan.
- At a rate of 1 oz/10,000 to 15,000 cu ft or follow dosage rate calculated by the Fumiguide® Calculator for a maximum and minimum chloropicrin dose in total ounces to apply. The maximum ounce dose will be based upon 1 oz/10,000 cubic feet. The minimum ounce dose will be based on structure size, underseal (slab or soil) and fumigant exposure time.
- At no more than 3 fl oz of chloropicrin per evaporation container.
- At one or more chloropicrin introduction sites for each 45,000-cu ft of space to be fumigated.

In addition, it is suggested that chloropicrin be introduced:

- On each floor of a multi-story structure.
- At each introduction site of Vikane.
- In areas without excessive furnishings and contents to adsorb chloropicrin.

When applying chloropicrin at multiple chloropicrin introduction points within a structure, start at the point farthest from the exit and work toward the exit.

ADDITIONAL PRECAUTIONS FOR USE AND HANDLING OF CHLOROPICRIN

- **Do not rely upon chloropicrin as the only deterrent to unauthorized entry during the fumigation.** Follow all label, state, and local regulations for: conducting the final inspection to ensure the fumigation site is vacated of people, pets, and domestic animals prior to fumigant introduction; securing structure entrances; and posting of warning signs. State and local regulations may require additional security measures, such as posting of guards.
- **Use a measuring device to measure the calculated volume of chloropicrin to apply.** Measuring devices with a graduated scale for fluid ounces and sealable lids are available. An additional advantage of using these devices is that chloropicrin can be measured outside the structure so only the amount of chloropicrin needed during the fumigation is carried into the structure.
- **Do not apply liquid chloropicrin directly to soil, concrete, or wood in the fumigated space.** Odor from chloropicrin desorbing from these surfaces after direct application can be persistent and difficult to remove.
- **Do not apply chloropicrin in containers made of magnesium, aluminum, or their alloys since chloropicrin is corrosive to these metals.**
- **Removal of all chloropicrin evaporation containers from the fumigated space during initial phase of aeration after tarp removal** may aid in the dissipation of the warning agent from the structure.
- **The US Department of Transportation (DOT) regulates the transportation of chloropicrin.** Regulations include transporting chloropicrin in a DOT-approved shipping container, secured in a separate airspace from the driver and vehicle occupants, in a placarded vehicle operated by a driver with a commercial driver's license with Haz-Mat endorsement.

Contact your local distributor or Douglas Products for information on purchasing evaporation containers, measuring devices for chloropicrin (liquid or airborne concentrations), and training resources for DOT regulations.

CHAPTER 8: VIKANE INTRODUCTION

PREVENTING PROPERTY DAMAGE

Improper introduction of Vikane may cause property damage from the following processes:

- Liquid Vikane directly contacting surfaces and causing freeze damage or corrosion. Gaseous Vikane is non-corrosive.
- Excessive condensation, called a “fog-out,” causing staining, tarnishing, or corrosion. As described in Chapter 5 on Fumigation Preparation, when liquid Vikane is released from the introduction hose, it extracts heat from the surrounding air as it expands to form a gas. The chilling can cause the formation of a cloud of condensed water (fog) that should be dissipated before it collects on surfaces. Minute quantities of certain byproducts in Vikane may damage susceptible surfaces, such as metals, tile, glass, and carpeting, during a fog-out when they are dissolved in water at sufficient concentrations at the introduction location. These byproducts are of no consequence in the gaseous phase.

Release of Vikane as a liquid, not a gas, and fog-outs can be prevented by the applicator selecting the appropriate fumigant introduction release location(s), introduction hoses, and fans as described below.

CHOOSING FUMIGANT INTRODUCTION LOCATIONS

Apply Vikane in a manner to achieve equilibrium, minimize fog-out potential or damage to fumigated materials, and ensure safety to personnel, pets, and domestic animals. Considerations for introduction location selection include:

1. The largest, open space(s) where **fumigant will not be applied directly to any surface.**
2. Areas without excessive contents (e.g., clutter, many boxes, overstuffed furniture, and pillows) to adsorb chloropicrin since it is suggested that chloropicrin be applied at each introduction site for Vikane.
3. Multiple introduction sites may be necessary if the structure is large, multi-story, has multiple firewalls or is compartmentalized, or if high dose rates of Vikane are applied.
 - a. One fumigant introduction site for each 20,000 to 45,000 cu ft in residential dwellings or similar compartmentalized structures is recommended.
 - b. At least one introduction site on each floor of a multi-story structure is recommended. Unfinished attics and crawlspaces generally are not used as introduction sites to introduce Vikane due to the potential for fog-outs.

SELECTION AND USE OF EQUIPMENT FOR FUMIGANT INTRODUCTION

Select equipment for the introduction of Vikane to meet the following criteria:

- Reliably measure the amount of Vikane being introduced.
- Not damage the cylinder of Vikane or valve.
- Not break down or contaminate Vikane.
- Confine Vikane until it is released into the fumigation area.
- Prevent a fog-out and liquid sulfuryl fluoride from contacting surfaces that could be damaged.
- Enhance fumigant distribution to reach equilibrium.

Weighing the Fumigant

Measure the pounds of Vikane introduced using equipment such as weighing scales. Platform or hanging scales can be used to weigh the cylinder containing Vikane during fumigant introduction to determine the pounds of fumigant introduced. If hanging scales are used, hanging bonnets or similar devices designed for this purpose must be used to hang the cylinder from the scale. Consult Douglas Products or your distributor of Vikane for sources of hanging bonnets or cylinder slings.

Never suspend the cylinder containing Vikane by the valve!

Hoses

Release Vikane through an introduction hose that meets the following criteria:

- Leak proof hose with a minimum burst pressure of 500 pounds per square inch (psi).
- Should be flexible, kink resistant, durable, and compatible with liquid Vikane.
- Has appropriate diameter and length to control the introduction rate of Vikane so fan capacity is not exceeded. Vikane is introduced into the blast of air from one or more fans having a total capacity of at least 1000 cu ft per minute (cfm) for each pound of Vikane released per minute. Tables 3 and 4 below can be used to select the appropriate diameter and length of introduction hose to obtain the desired introduction rate for Vikane based on fan capacity. (The maximum introduction rate for Vikane is also calculated by the Fumiguide® Calculator based on fan amps and relative humidity.)

Table 3. Effect of Inside Diameter Size on Introduction Rate of Vikane Through a 25 ft Polyethylene Hose at 65°F

Tube Inside Diameter (ID)	Pounds Vikane per Minute
1/8	4
1/4	20
1/2	45

Table 4. Effect of Hose Length (1/8" ID) on Introduction Rate of Vikane at 65°F

Hose Length (ft)	Pounds Vikane per Minute
25	4.0
50	2.8
100	2.0 ¹

¹Where fumigant introduction rates lower than 2 lb./min. are needed, a longer hose can be used, e.g., 200 ft.

Use of 1/8 inch ID introduction hose of about 100 feet in length will provide a fumigant introduction rate for drywood termite fumigations that will not exceed the capacity of most standard industry fans.

Prior to use, confirm with distributor or manufacturer that the introduction hose meets the above requirements.

Securing Introduction Hose

Secure the introduction hose to the introduction fan, an introduction stand or by other means to avoid damaging surfaces, furnishings, or structural features.

A commonly used method is to securely attach the introduction hose to a tarp clamp and then use the tarp clamp to attach the hose to the fan cage. The fan cage is then angled upward at about 45°. Introduction hoses should not be attached to customer furnishings or structural features such as door knobs to avoid damaging surfaces of these items by clamping, taping, or contact with liquid Vikane.

It is recommended to leave the introduction hose in place during the fumigation exposure period in case additional fumigant needs to be introduced later depending upon fumigant confinement conditions.

Fan Placement and Specifications

Refer to the Chapter 5 on Fumigation Preparation for complete directions and recommendations on fan specifications and placement prior to introduction.

Protective Sheeting

It is recommended that protective sheeting, such as polyethylene plastic or tarps, be placed under the introduction stand (if used), hose and fan to further protect floors and floor coverings during application. All of the fumigant introduction options outlined above offer the flexibility to incorporate protective sheeting in critical areas.

Chloropicrin Introduction

Chloropicrin can be introduced at introduction sites for Vikane. Chloropicrin must be used within the structure at least 5 to 10 minutes prior to the introduction of Vikane. Complete directions and recommendations for chloropicrin use and handling are reviewed in Chapter 7 on Release of Warning Agent.

Safety Equipment

Wear splash-resistant goggles (goggles designed and made of material that allows no measurable movement of the liquid pesticide being used to pass through them during use) or full-face shield for eye protection during introduction of the fumigant. Do not wear gloves or rubber boots. Do not reuse clothing or shoes that have become contaminated with liquid Vikane until thoroughly aerated and cleaned. Have proper respiratory protection (SCBA) available in case of an emergency, such as a ruptured introduction hose. Follow label, state, and local regulations regarding inspection of the space to be fumigated prior to release of the fumigant.

RELEASING VIKANE FROM THE CYLINDER

Refer to Chapter 3 on Cylinder Handling and Storage for a complete description of cylinder configuration and handling.

Each cylinder of Vikane is equipped with a dip tube that extends from the bottom of the tank to a valve on the top. To release the fumigant, this valve is opened to permit a free flow of the liquid, which vaporizes as it escapes from the introduction hose. The valve should be turned fully open to fill the fumigant introduction hose with liquid Vikane. Initially, the valve should be opened slightly until flow has begun and then opened about one full turn, which should give full flow through the fumigant introduction hose. When finished, close the valve tightly using an appropriate wrench with a handle of sufficient length to provide the necessary torque. A clearance detector or leak detector may be used to test for a tight seal of the introduction hose at the cylinder valve. Contact Douglas Products for information on the types of wrenches that should be used to open and close valves of cylinders of Vikane.

Frozen Valves and Hoses

As previously discussed in Chapter 5 on Fumigation Preparation, when liquid Vikane is released from the introduction hose, it extracts heat from the surrounding air as it expands to form a gas. A pound of liquid Vikane changing to the gas phase will drop the temperature of 1000 cu ft of dry air 4.5°F (28.3 m³ of air 2.5°C).

If the valve is "just cracked" to reduce the rate of release from the cylinder, Vikane will expand from a liquid to a gas in the introduction hose, chilling and frosting of the exterior of the valve and hose. This is avoided by allowing full flow through the cylinder valve. The rate of flow of Vikane should be controlled by the ID and length of hose (see Tables 3 and 4) and not be restricting flow through the valve.

Frozen Cylinders

If there is a break in the dip tube in the cylinder (a rare occurrence), Vikane will be discharged through the valve and introduction hose as a gas, not a liquid, when the liquid level falls below the break in the broken dip tube. As the liquid expands in the cylinder, heat will be extracted from the surrounding area as described above and the cylinder will frost or freeze at that point. Vikane will be discharged, but at a slower rate because it is in the gaseous phase. Cylinders showing signs of a broken dip tube should be returned to the distributor (see Chapter 3 on Cylinder Handling and Storage) so that the problem can be repaired before refilling. Contact your distributor of Vikane for instructions on documentation and return of a potentially malfunctioning cylinder.

Releasing the Last 3 to 5 lbs. of Vikane

The final pounds of Vikane in a cylinder generally are in a gaseous state and will move through the introduction hose more slowly than will the liquid fumigant. Testing by Douglas Products has determined that it can take up to 20 minutes at 75°F (air temp) to release the last 2 lb. of sulfuryl fluoride from a compressed gas cylinder.

CHAPTER 9: MONITORING VIKANE

The goal in monitoring fumigant concentration during the fumigation exposure time is to calculate the actual HLT and oz-hr dosage accumulation. This allows the applicator to adjust the fumigation if needed, by adding more fumigant or modifying the exposure time, so the necessary oz-hr dosage is accumulated. Monitoring a fumigation is not required by the label for Vikane but may be required in certain circumstances such as when specified in a contract or by quarantine regulations.

GUIDELINES FOR MONITORING A FUMIGATION

1. Consider monitoring Vikane in the space(s) most representative of the atmosphere in the structure, such as the living space of a residential building. In large jobs, multiple sampling locations may be appropriate. Monitoring can also be conducted in the attic and/or crawlspace, if present and accessible, to determine fumigant distribution throughout the structure.
2. In partitioned structures, monitoring samples should be taken from the separate sections, such as each floor of a multistory building.
3. The time required between measurements to determine the actual HLT will depend upon the fumigant confinement. The time between readings should be sufficient to detect a change in the fumigant concentration. Usually, two to four hours will be adequate, but in the case of structures with excellent confinement, more time may be required.
4. To confirm the total oz-hr dosage accumulated, the fumigated space will need to be monitored at two time intervals occurring approximately at equilibrium and prior to aeration.

EQUIPMENT

Fumiguide® Calculator

The Fumiguide® Calculator can be used for both non-monitored and monitored fumigations. At least two fumigant concentration measurements taken at two different time intervals following fumigant introduction and the time between the two measurements are needed to calculate an actual HLT and oz-hr dosage accumulation. Contact your Douglas Products representative or Vikane Distributor for more information on using the Fumiguide® Calculator when monitoring a fumigation.

Monitoring Hoses

Monitoring hoses for sampling fumigant concentrations should be placed in the structure prior to fumigant introduction. Semi-rigid hoses typically 1/8" to 1/2" ID are used. Monitoring hoses larger than 1/2" ID may take a longer time to pull the sample from the fumigated space to the monitoring device because of the larger volume of air needed to be moved.

Monitoring Equipment

Several devices are currently available for monitoring Vikane concentrations during a fumigation to calculate achieved dosage and actual the half-loss time associated with a fumigation using the Vikane Fumiguide® Calculator. Examples of these devices are the Fumiscope, SF-ReportIR, and SF-400, but others may also be available. Follow all manufacturer recommendations for use and calibration of any monitoring device used. Contact distributors and Douglas Products for information on where to purchase or repair equipment for monitoring fumigations of Vikane.

Do not use monitoring devices as clearance devices. Monitoring devices are not sensitive enough to use as a clearing device after aeration of Vikane.

CHAPTER 10: AERATING AND CLEARANCE TESTING

When used for fumigation of enclosed spaces, two persons trained in the use of this product, at least one being an applicator who is licensed/certified by the state, must be present during the initiation of the initial aeration procedure.

PREPARING FOR AERATION

When preparing the fumigation, it is recommended to plan ahead for the aeration period and take steps to aid aeration by strategic placement of fans and other aeration tools. The fans used for fumigant introduction and distribution (Fig. 2) may need to be repositioned to enhance aeration (Fig. 3). The most efficient use of the aeration fans is to position so airflow is moving in one direction. This is done by positioning fans for fresh air intake in openings on one side of the structure and fans for exhausting fumigant in openings on the opposite side of the structure (Fig. 3). Consult local regulations for any additional requirements or restrictions for aeration procedures.

Figure 2. Example of Fan Placement for Introduction and Distribution of Vikane

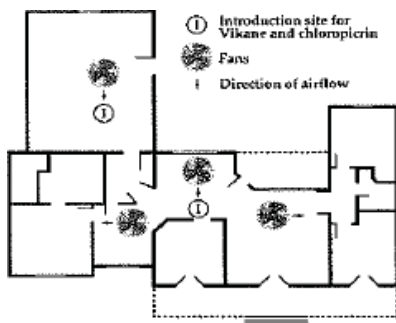
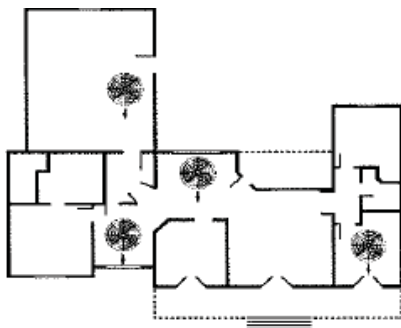

Figure 3. Example of Fans Repositioned for Unidirectional Flow for Aeration of Vikane



AERATION PROCEDURES

Aeration procedures available to the fumigator may vary depending upon the state. Refer to the label registered in the state, your distributor, or your Douglas Products representative for further information.

No one should be in treated areas if the level of Vikane is above 1 ppm, or if the level of Vikane is unknown, unless provided with a NIOSH or MSHA approved positive self-contained breathing apparatus (SCBA, not SCUBA) or combination air supplied/SCBA respirator such as manufactured by Ranger, Survivair, Scott or MSA.

RESIDENTIAL STRUCTURES

A residential structure is where people typically live (temporarily or permanently) and sleep, such as single-family residences, mobile homes, apartments, townhouses, condominiums, hotels, motels, assisted care facilities, nursing homes, hospitals, barracks, and dormitories.

Preparation

Prepare for Aeration Procedures 1 and 2 by doing the following:

- Open all operable attic doors and accesses and direct a fan into the attic.
- Position introduction and circulation fans to provide for air circulation throughout the fumigated space. For example, a circulation fan in the hall could be used to aid air circulating in bedrooms and bathrooms.
- For residential structures, use a minimum of one fan of at least 18 inches in diameter for every 22,500 cubic feet of space to be fumigated.¹

Select the appropriate procedure for based on the fumigation rate:

All residential structures fumigated at 16 oz/MCF (1,000 cubic feet) or less may be aerated using Aeration Procedure 1 or 2.

All residential structures fumigated at concentrations greater than 16 oz/MCF must be aerated using Aeration Procedure 2.

Aeration Procedure 1

These steps must be completed in sequence.

Step (1): Aerate structure with all operable windows and doors open, aided by at least one fan (of at least 18 inches in diameter) for every 22,500 cubic feet of fumigated space, for a minimum of 2 hours following the directions in the Preparation section. If the structure has an attached garage, the door between the garage and structure should be open. If the structure has a central air system, turn on only the fan (or blower) for each operational unit. As an alternative, a circulation fan may be placed in front of a furnace inlet to blow air into central heating and cooling ducts. Removal of all chloropicrin evaporation containers from the fumigated space during Step (1) will aid in the dissipation of the warning agent from the structure.

Step (2): Secure structure and do not allow reentry for a minimum of 12 hours from the start of aeration (first opening of the seal) for residential structures.² During this time structures must remain posted with warning signs.

Step (3): After the minimum 12-hour waiting period in Step (2), measure the concentration of Vikane in breathing zones of each room with a clearance device. Refer to EPA's website at Sulfuryl Fluoride | US EPA (<https://www.epa.gov/ingredients-used-pesticide-products/sulfuryl-fluoride>) for more information and a list of effective clearance devices. If the concentration of Vikane is greater than 1 ppm, ventilate structure with operable doors and windows open and confirm concentrations are 1 ppm or less before the structure is reoccupied.

Aeration Procedure 2

These steps must be completed in sequence.

Step (1): Aerate structure with all operable windows and doors open, aided by at least one fan (of at least 18 inches in diameter) for every 22,500 cubic feet of fumigated space, for a minimum of 2 hours following the directions in the Preparation Section. If the structure has an attached garage, the door between the garage and structure should be open. If the structure has a central air system, turn on only the fan (or blower) for each operational unit. As an alternative, a circulation fan may be placed in front of a furnace inlet to blow air into central heating and cooling ducts. Removal of all chloropicrin evaporation containers from the fumigated space during Step (1) will aid in the dissipation of the warning agent from the structure.

Step (2): Secure the structure and do not allow reentry the minimum number of hours as listed in the Table 5. Determining Minimum Hours of Aeration Time Based on Initial Concentration of Sulfuryl Fluoride Introduced, from the start of aeration (first opening of the seal) for residential structures.² During this time the structure

² A residential structure is where people typically live (temporarily or permanently) and sleep, such as single-family residences, mobile homes, apartments, townhouses, condominiums, hotels, motels, assisted care facilities, nursing homes, hospitals, barracks, and dormitories.

must remain posted with warning signs.

Step (3): After the minimum waiting period, measure the concentration of Vikane in breathing zones of each room with a clearance device. Refer to EPA's website at Sulfuryl Fluoride | US EPA (<https://www.epa.gov/ingredients-used-pesticide-products/sulfuryl-fluoride>) for more information and a list of effective clearance devices. If the concentration of Vikane is greater than 1 ppm, ventilate structure with operable doors and windows open and confirm concentrations are 1 ppm or less before the structure is reoccupied.

Table 5. Determining Minimum Hours of Aeration Time Based on Initial Concentration of Sulfuryl Fluoride Introduced

Initial Concentration of Sulfuryl Fluoride Introduced (ounces per thousand cubic feet)	Minimum Hours of Aeration Time**
Greater than 16 to 32	14
Greater than 32 to 48	16
Greater than 48 to 64	18
Greater than 64 to 96	20
Greater than 96 to 112	22
Greater than 112	24

**When the high ambient temperature for the aeration period is below 40°F at the fumigation site, a minimum of 24 hours of aeration is required.

NON-RESIDENTIAL STRUCTURES

Select the appropriate procedure based on the fumigation rate:

All structures fumigated at 16 oz/MCF or less may be aerated using procedures 1 or 2.

All structures fumigated at concentrations greater than 16 oz/MCF must be aerated using procedure 2.

Aeration Procedure 1

These steps must be completed in sequence.

Step (1): Aerate structure with all operable windows and doors open, aided by the use of one or more fans, for a minimum of 1 hour. Total fan capacity, using one or more fans, shall be capable of displacing a total of 5000 cfm.

Step (2): Secure structure and do not allow reentry for a minimum of 6 hours from the start of aeration (first opening of the seal). During this time structures must remain posted.

Step (3): After the minimum 6-hour waiting period, measure the concentration of Vikane in breathing zones of each room with a clearance device. Refer to EPA's website at Sulfuryl Fluoride | US EPA (<https://www.epa.gov/ingredients-used-pesticide-products/sulfuryl-fluoride>) for more information and a list of effective clearance devices. Breathing zones are defined as areas within the structure where individuals typically stand, sit, or lie down. If the concentration of Vikane is greater than 1 ppm, further aeration and re-testing are required. If the concentration of Vikane is greater than 1 ppm, ventilate structure with operable doors and windows open and confirm concentrations are 1 ppm or less before the structure is reoccupied.

Aeration Procedure 2

These steps must be completed in sequence.

Step (1): Aerate structure with all operable windows and doors open, aided by the use of one or more fans, for a minimum of 1 hour. Total fan capacity, using one or more fans, shall be capable of displacing a total of 5000 cfm.

Step (2): Secure the structure and do not allow reentry for a minimum of 8 hours from the start of

aeration (first opening of the seal). During this time the structure must remain posted.

Step (3): After the minimum 8-hour waiting period, measure the concentration of Vikane in breathing zones of each room with a clearance device. Refer to EPA's website at Sulfuryl Fluoride | US EPA (<https://www.epa.gov/ingredients-used-pesticide-products/sulfuryl-fluoride>) for more information and a list of effective clearance devices. Breathing zones are defined as areas within the structure where individuals typically stand, sit, or lie down. If the concentration of Vikane is greater than 1 ppm, further aeration and re-testing is required. If the concentration of Vikane is greater than 1 ppm, ventilate structure with operable doors and windows open and confirm concentrations are 1 ppm or less before the structure is reoccupied.

Aeration Procedures 1 and 2 require the applicator to aerate the structure with operable doors and windows open and with the aid of one or more fans for a minimum of two hours for residential structures and one hour for non-residential structures. This active ventilation is required to enhance fumigant diffusion and prevent fumigant concentrations from exceeding 1 ppm following clearance. These aeration procedures have been tested under a variety of structural and environmental conditions typically encountered while conducting structural fumigations. The applicator may increase the total required aeration period for ease in scheduling.

During the initial active aeration procedure, approved respiratory protection must be worn until the concentration of sulfuryl fluoride is confirmed to be 1 ppm or less. Confirm concentration of sulfuryl fluoride of 1 ppm or less with a clearance device. Refer to EPA's website at Sulfuryl Fluoride | US EPA (<https://www.epa.gov/ingredients-used-pesticide-products/sulfuryl-fluoride>) for more information and a list of effective clearance devices. Since the devices provide immediate readings, respiratory protection is not required when testing with these devices after having completed the initial one-hour aeration procedure. If a reading indicates levels in excess of 1 ppm, leave the affected area immediately.

At the conclusion of the passive aeration period, confirm concentration of sulfuryl fluoride of 1 ppm or less with a clearance device in the breathing zones of each room in the structure and in any connected structures. Refer to EPA's website at Sulfuryl Fluoride | US EPA (<https://www.epa.gov/ingredients-used-pesticide-products/sulfuryl-fluoride>) for more information and a list of effective clearance devices. Breathing zones are defined as areas within the structure where individuals typically stand, sit, or lie down. If the concentration of Vikane is greater than 1 ppm, further aeration and re-testing is required.

CLEARANCE TESTING EQUIPMENT

Confirm concentration of sulfuryl fluoride of 1 ppm or less with a clearance device. Refer to EPA's website at Sulfuryl Fluoride | US EPA (<https://www.epa.gov/ingredients-used-pesticide-products/sulfuryl-fluoride>) for more information and a list of effective clearance devices. Prior to using any clearance device to clear a structure for reoccupancy, follow the manufacturer's directions for zeroing these devices. Manufacturer's instructions also include information regarding appropriate and necessary calibration and maintenance. Manufacturers' recommendations must be followed to ensure proper operation of these devices. Contact your distributor or Douglas Products for information on where to purchase and service these detectors.

REOCCUPANCY

Until the final clearance is verified, the structure is still considered under fumigation and appropriate precautions must continue to be taken, such as warning signs remaining posted on all entrances. Do not allow reoccupancy of any fumigated area until the aeration and clearing process is complete according to directions and concentrations of Vikane do not exceed 1 ppm. Confirm concentration of sulfuryl fluoride of 1 ppm or less with a clearance device. Refer to EPA's website at Sulfuryl Fluoride | US EPA (<https://www.epa.gov/ingredients-used-pesticide-products/sulfuryl-fluoride>) for more information and a list of effective clearance devices. Only a certified applicator may authorize the removal of the warning signs. Consult local authorities for instructions regarding documentation of clearance such as posting clearance notices.

Follow all federal, state, and local requirements for reoccupancy.

AERATING CHLOROPICRIN

The following procedures are contained on the label for Vikane to aid in aerating chloropicrin:

- Open all operable attic doors and accesses and direct a fan into the attic.
- If the structure has an attached garage, the door between the garage and structure should be open.
- If the structure has a central air handling system, the fan (or blower) should be activated for each unit if operational. As an alternative, a fan may be placed in front of a furnace inlet to blow air into central heating and cooling ducts.

LATENT MORTALITY

Sometimes live insects may be found immediately after a fumigation. Under optimum conditions, the target pest(s) will be dead or dying by the end of the fumigation period. Latent mortality in insects occurs for exposures very near mortality threshold levels. Researchers have observed a delay in mortality of three to five days following exposure to Vikane. Therefore, judgment of the success of the fumigation should not be made on the presence of live organisms immediately following the fumigation.

NON-TARGET ORGANISMS

Live organisms which are not specific targets of the fumigation may be found within the fumigated space following aeration. This does not indicate the fumigation failed to control the target pests because lethal dosage requirements may be higher for non-target organisms than for the target pest(s). It is also possible the non-target organism entered the structure during the aeration period.

CHAPTER 11: SITE SPECIFIC CONSIDERATIONS (SUCH AS CHAMBERS, VEHICLES, SHIPS, PASSENGER RAILCARS)

When fumigating chambers, vehicles, ships, passenger railcars, containers, or any other structures, all appropriate label instructions apply such as structure preparation, posting, securing, fumigant introduction, and aeration.

Site specific considerations are discussed below

CHAMBERS

Load chambers and stacks so that adequate air movement can occur around fumigated items to allow even distribution of the gas.

Atmospheric Pressure Chambers

Design and Construction

A suitable atmospheric fumigation chamber consists of a sufficiently gas-tight room with an appropriate door. An application system, exhaust fan and a small circulation fan for gas distribution are recommended.

Exhaust Fan(s)

The size of the exhaust fan will depend upon the size of the fumigation chamber and the aeration time requirements. Generally, a fan capable of changing the air in the chamber in 5 to 10 minutes is recommended. The chamber should exhaust Vikane away from adjoining buildings or work areas. Consult your state agency for emission control requirements.

Vacuum Chambers

Vacuum chambers require special designs that take into account the vacuum pressure exerted on the materials of construction. For this reason, it is recommended that trained engineers be consulted before constructing a vacuum chamber. Follow all directions given by the manufacturer or design engineer.

Specially built steel chambers for vacuum fumigations provide the fastest and most effective fumigation. After the commodity is placed in the chamber, pumps evacuate air. Vikane is introduced and rapidly penetrates all space previously occupied by air. A lethal dosage of Vikane results when the proper concentration is maintained for the required fumigation period.

Drawing a Vacuum

A vacuum of 25 to 27 inches of mercury is commonly drawn for vacuum fumigations. It is advisable to check to ensure that the vacuum is maintained according to plan. Unplanned vacuum release indicates leakage. Note that some vacuum fumigations are planned to allow release of the vacuum during exposure with the objective of improving penetration of the commodity as air enters the chamber.

Introducing Fumigant

Because of the special design of vacuum chambers, it is recommended that the manufacturer or design engineer's operation procedure be followed. A small fan can be used to distribute the gas uniformly in the chamber if the vacuum is to be maintained throughout the exposure period.

Dosage Monitoring

The Fumiscoper, SF-ReportIR, SF-400, or similar device cannot be used to measure Vikane during a vacuum fumigation unless the vacuum is released. If the vacuum is maintained and thus no gas is leaking from chamber, the achieved oz-hr dosage can be calculated by using the simple Concentration x Time formula.

Aeration Procedures

At the end of the exposure, release the vacuum. It is recommended to purge the chamber of

air/fumigant two times by pulling a partial vacuum prior to checking the gas concentration for reentry purposes.

For both atmospheric and vacuum chamber fumigations:

- Load chambers so that adequate air movement can occur to allow distribution of the fumigant.
- Application of chloropicrin is not required for chamber fumigations if the chamber 1) can be inspected prior to fumigant introduction to confirm that all persons, domestic animals, and pets have been vacated and 2) is secured to prevent the chamber door from being opened using normal opening or entering processes by anyone other than the certified applicator in charge of the fumigation or persons in his/her on-site direct supervision.
- An introduction fan/circulation fan is recommended when introducing Vikane into chambers to distribute fumigant throughout the chamber. However, if a sufficient open space is not available or if use of an introduction fan is not practical, an introduction/circulation fan is not required. Introduce the fumigant in a manner to avoid a fog-out slowly and not apply liquid Vikane to the surfaces of fumigated commodities.
- Aeration of Vikane from the chamber head space is generally very rapid, but desorption from fumigated items can occur for a longer period of time. Always check for the concentration of Vikane with a suitable detector before entering the chamber without proper respiratory protection (SCBA). It is advised to keep the exhaust fans running during the aeration period and also while unloading the chamber. Only the certified applicator can authorize the removal of warning signs when it has been determined that the concentration of Vikane in the chamber head space is 1 ppm or less.

Contact Douglas Products for consultation regarding any specific question regarding construction of fumigation chambers.

TARPED STACKS

Fumigations may be conducted in temporary chambers created using tarpaulins or other gas impermeable sheeting as the "walls" to hold in the fumigant. These are also called "stack fumigations."

It is recommended to place items on a sufficiently airtight underseal, such as another tarp, polyethylene, concrete, or asphalt, when practical and cover items with impermeable sheeting (i.e., tarp). The edge of the tarp can be sealed either by weighting the edges with soil, sand, "snakes" or equivalent, or by rolling and clamping the edges with the underlying tarp (if used) to envelope the fumigated items. See Chapter 5 on Fumigation Preparation for information on tarps and sealing methods. Monitoring these fumigations is recommended since the HLT may be difficult to estimate using the Fumiguide® Calculator.

Tarp/stack fumigations must be conducted outdoors or in a building that must comply with all requirements for a structural fumigation (removal of people, pets and plants, use of warning agent, posting of warning signs, etc.).

Tarp/stack fumigations must be conducted outdoors or in a building that will not be occupied during fumigation and aeration periods.

VEHICLES, VESSELS, AND CONTAINERS

Vikane is not registered for the treatment of aircraft or underwater vessels.

Passenger railcars, empty and loaded shipping containers, trucks, automobiles, busses, recreational vehicles (including campers and trailers), surface ships, and other transport vehicles or vessels may be fumigated in essentially the same manner as small structures. Monitoring these fumigations is recommended since the HLT may be difficult to estimate using the Fumiguide® Calculator. Automobiles may remain in garages that are being fumigated; however, the applicator must be able to inspect all areas of the vehicle (including the trunk) prior to fumigant introduction.

In-transit fumigation (including aeration) of any vehicle is prohibited on public roads or waterways. Do

not move a vehicle while under fumigation.

Follow all local, state, and federal regulations covering the fumigation of vehicles and vessels.

Selection of Fumigation Location

Place vehicles, containers, and vessels in a location that is appropriate for conducting a fumigation away from other work areas. Small pleasure boats may either be removed from the water and fumigated on land or fumigated in the water. Large vessels, such as houseboats, and ocean-going vessels, such as freighters and cruise ships, can be fumigated in the water at dockside.

Securing the Vehicle, Vessel, or Container

Secure the vehicle, vessel, or container to prevent entry by unauthorized person using normal means during the fumigation, using measures such as, but not limited to, placement in a secured area in which access by unauthorized persons is restricted, applying locking devices or barricades to exterior entryways into the vehicle, vessel, or container, or guarding. It is also advised that vehicles be secured by setting the brakes and blocking the wheels so that the vehicle will not move during the fumigation and aeration periods.

Surface Ships

Follow all local, state, and federal requirements for ship fumigation, including those required by the United States Department of Transportation in the Code of Federal Regulations, Title 46 ("Shipping"), Chapter 1, Part 147a and the label for Vikane. Since the noted Federal Regulation is for fumigants in general, do not use procedures that are not permissible for Vikane as directed by label instructions and regulations. The certified applicator and ship's captain or owner shall follow the requirements listed on the label for Vikane and local and state requirements. Except for those persons involved in the fumigation, no unauthorized persons may be on board during fumigation.

Fumigation of Vessels on Water

If vessels are sealed by tarping, it is common practice to extend the tarps below the water surface, unless restricted by local or state regulations. When extending tarps into the water, the change in water level in tidal water and how this may affect tarps sealed around the lines mooring the boat to the dock must be considered. Water acts as an excellent barrier for Vikane because of its low water solubility. When using the Fumiguide® Calculator to estimate HLT for fumigations in water, using the slab rating to describe the water underseal is appropriate.

Aerating the Vehicle, Vessel, Container, or Tarped Stack

After removal of the tarps and/or seals, aerate until the concentration of Vikane in the head space and breathing zone is 1 ppm or less. Confirm concentration of sulfuryl fluoride of 1 ppm or less with a clearance device. Refer to EPA's website at Sulfuryl Fluoride | US EPA (<https://www.epa.gov/ingredients-used-pesticide-products/sulfuryl-fluoride>) for more information and a list of effective clearance devices. For live-aboard vessels and vehicles, such as mobile homes and RVs, follow Aeration Procedure 1 or 2 for non-residential structures as described in Chapter 10 if the vessel or vehicle will be used for its intended purpose immediately after completion of aeration. Otherwise, aerate until the concentration of Vikane in the head space and breathing zone is 1 ppm or less as described above.

PASSENGER RAILCARS

Securing Passenger Railcars

Follow either Procedure #1 or Procedure #2 for securing railcars.

Procedure #1: A thorough walk-through inspection must be performed of each railcar with doors being immediately locked upon leaving each car. Post a guard during fumigation introduction, exposure period, and aeration. Because a guard is posted, application of a warning agent is not required for passenger railcars.

Procedure #2: A thorough walk-through inspection must be performed of each railcar with doors being immediately locked upon leaving each car. If no guard is posted, then apply a warning agent following instructions per label directions. To secure the passenger railcar against unauthorized entry during the fumigation exposure period, use a locking device or barricade on all exterior doors or doorways. A locking device or barricade must be demonstratively effective in preventing an exterior door or doorway from being opened using normal opening or entering processes by anyone other than the state licensed applicator in charge of the fumigation or persons in his/her on-site direct supervision. Consult state and local regulations for any supplementary instructions and local restrictions on securing against entry.

Aerating Passenger Railcars

Passenger railcars may be aerated using either of the following two aeration procedures (railcars must remain posted until cleared for re-occupancy):

Aeration Procedure 1

If on-board railcar ventilation systems are not operable, aerate railcar for a minimum of 6 hours using the following procedure:

Step (1): Remove all tape, seals, and/or tarps.

Step (2): Open all exterior railcar doors.

Step (3): Open all internal doors such as cabinets, closets, appliances, and sleeping berths.

Step (4): In sleeper cars, turn all mattresses askew to expose cavities beneath sleeping berths.

Step (5): Ventilate the railcars for a minimum of 1 hour with enough portable fans to provide a minimum 4000 cfm capacity per floor. A bilevel railcar would require 8000 cfm capacity or greater than 4000 cfm per floor. Direct fans in such a manner to create cross-ventilation of railcar.

Step (6): After the minimum 6-hour aeration time, railcars may be reoccupied when the concentration of Vikane is 1 ppm or less with all doors and windows closed and ventilation systems turned off. Confirm concentration of sulfuryl fluoride of 1 ppm or less with a clearance device. Refer to EPA's website at Sulfuryl Fluoride | US EPA (<https://www.epa.gov/ingredients-used-pesticide-products/sulfuryl-fluoride>) for more information and a list of effective clearance devices.

Aeration Procedure 2

If on-board railcar ventilation systems are operable, actively ventilate the railcar for a minimum of 2 hours using the following procedures:

Step (1): Remove all tape, seals, and/or tarps.

Step (2): Open all exterior car doors.

Step (3): Open all internal doors such as cabinets, closets, appliances and sleeping berths.

Step (4): In sleeper cars, turn all mattresses askew to expose cavities beneath sleeping berths.

Step (5): Turn on all on-board Heating, Ventilation, Air Conditioning (HVAC) systems and exhaust fans.

Step (6): In sleeper cars, turn on all operable wall or ceiling mounted fans.

Step (7): Ventilate the railcar with enough portable fans to provide a minimum 4000 cfm capacity per floor (in addition to on-board systems). A bilevel railcar would require 8000 cfm capacity or greater - 4000 cfm per floor. Direct fans in such a manner to create cross-ventilation of railcar.

Step (8): After the minimum 2 hours active ventilation/aeration, the railcar may be reoccupied when the concentration of Vikane is 1 ppm or less with all doors and windows closed and ventilation systems turned off. Confirm concentration of sulfuryl fluoride of 1 ppm or less with a clearance device. Refer to EPA's website at Sulfuryl Fluoride | US EPA (<https://www.epa.gov/ingredients-used-pesticide-products/sulfuryl-fluoride>) for more information and a list of effective clearance devices.

Do not reoccupy the railcar or move the railcar until aeration is complete. Warning signs must remain posted until aeration is determined to be complete.

A-3-BOK-VKUSA-001;

Date: xx/xx/xxxx

(Cylinder Label):

RESTRICTED USE PESTICIDE DUE TO INHALATION TOXICITY

For sale to and use only by Certified Applicators or persons under their direct supervision and only for those uses covered by the Certified Applicator's certification.

SULFURYL FLUORIDE**GROUP****8C****INSECTICIDE****Vikane®****SPECIALTY GAS FUMIGANT**

For control of: Existing infestations of listed insects and related pests such as drywood termites, Formosan termites, powder post beetles, death watch beetles, old house borers, bedbugs, clothes moths, rodents (rats, mice), the larvae and adults of carpet beetles (except egg stage), German, oriental, American, and brown-banded cockroaches, and pests in sulfuryl fluoride quarantine treatment schedules, such as brown marmorated stink bugs.

For use in: Dwellings (including mobile homes), buildings, construction materials, furnishings (household effects), shipping containers and vehicles including automobiles, buses, surface ships, passenger railcars, and recreational vehicles (but not including aircraft), and all contents parts or materials that could comprise or be located within any of the foregoing.

When fumigating, observe local, state, and federal rules and regulations including such things as use of chloropicrin, clearing devices, positive-pressure self-contained breathing apparatus, security requirements, and placement of warning signs.

Application personnel must participate in Douglas Products' Product Stewardship Plan.

Active Ingredient

sulfuryl fluoride 99.8%

Other Ingredients 0.2%

Total 100.0%

Keep Out of Reach of Children

DANGER  **POISON**

[Editors note: the word POISON must appear in red]

PELIGRO

Precaucion al usuario: Si usted no lee inglés, no use este producto hasta que la etiqueta le haya sido explicada ampliamente. (If you do not understand the label, find someone to explain it to you in detail.)

Precautionary Statements

Hazards to Humans and Domestic Animals

Extremely Hazardous Liquid And Vapor Under Pressure • Fatal If Inhaled • May Be Fatal If Swallowed • Liquid May Cause Freeze Burns of Exposed Skin

Do not get in eyes, on skin, or on clothing. Vikane® specialty gas fumigant is odorless. Exposure to toxic levels may occur without warning or detection by the user.

FIRST AID	
IF INHALED:	<ul style="list-style-type: none"> • Get exposed person to fresh air. • Keep warm and at rest. • Make sure person can breathe freely. • If breathing has stopped, call 911 or an ambulance, then give artificial respiration • Do not put anything in the mouth of an unconscious person. • Call a poison control center or doctor for treatment advice.
IF ON SKIN OR CLOTHING:	<ul style="list-style-type: none"> • Immediately apply water to contaminated area of clothing before removing. • Once area has thawed, remove contaminated clothing, shoes, and other items covering skin. • Rinse contaminated skin area with plenty of water for 15-20 minutes • Call a poison control center or doctor for treatment advice.
IF IN EYES:	<ul style="list-style-type: none"> • Hold eye open and rinse slowly and gently with water for 15 to 20 minutes. • Remove contact lenses, if present, after the first 5 minutes, then continue rinsing eye. • Call a poison control center or doctor for treatment advice.
HOT LINE NUMBER	
In all cases of overexposure, such as nausea, difficulty in breathing, abdominal pain, slowing of movements and speech, numbness in extremities, get medical attention immediately. Take person to a doctor or emergency treatment facility. Have the product container or label with you when calling a poison control center or doctor, or going for treatment. In case of emergency endangering health or the environment involving this product, call 1-844-845-3129 or 1-352-323-3500.	
NOTE TO PHYSICIAN	
Vikane is a gas which has no warning properties such as odor or eye irritation. (However, chloropicrin is used as a warning agent and is a known lachrymator). Early symptoms of exposure to Vikane are respiratory irritation and central nervous system depression. Excitation may follow. Slowed movement, reduced awareness, and slow or garbled speech may be noted. Prolonged exposure can produce lung irritation, pulmonary edema, nausea, and abdominal pain. Repeated exposure to high concentrations can result in significant lung and kidney damage. Single exposures at high concentrations have resulted in death. Treat symptomatically. Liquid Vikane in the eye may cause damage due to frostbite or freezing.	

Refer to Chapter 7 in the Vikane Gas Fumigant Structural Fumigation Manual for first aid for overexposure to chloropicrin.

Refer to the Directions for Use section on this label, the product label and the Vikane Gas Fumigant Structural Fumigation Manual for additional precautionary information.

Notice: Labeling for Vikane consists of the label and the structural fumigation manual. Both the label and the manual must be read and understood before using this product. Use only according to label directions. **Before using this product, read Warranty Disclaimer, Inherent Risks of Use, and Limitation of Remedies elsewhere on this label. If terms are unacceptable, return at once unopened.**

In case of emergency endangering health or the environment involving this product, call 1-844-845-3129 or 1-352-323-3500.

Pest Control Chemical: Do not ship or store with food, feed, drugs or clothing.

EPA Reg. No. 1015-78

EPA Est. _____

®Trademark of Douglas Products and Packaging Company ("Douglas Products")

Produced for
Douglas Products and Packaging Company
1550 East Old 210 Highway
Liberty, MO 64068-9459

NET CONTENTS _____

Directions for Use

It is a violation of Federal law to use this product in a manner inconsistent with its labeling.

Read all Directions for Use carefully before applying.

Storage and Handling

Store in dry, cool, well-ventilated area under lock and key. Post as a pesticide storage area. If the storage area is in an occupied building, the storage area must have either 1) a forced air ventilation system that meets required local ordinances for the storage of hazardous materials and operates continuously; or 2) be equipped with a permanently mounted and properly maintained and functioning sulfuryl fluoride monitoring device designed to alert occupants of the building if sulfuryl fluoride in the air of the storage area is greater than 1 ppm. Store cylinders upright, secured to a rack or wall to prevent tipping. Do not contaminate water, food, or feed by storage.

Cylinders must not be subjected to rough handling or mechanical shock such as dropping, bumping, dragging, or sliding beyond that which would normally occur when moving cylinders. Do not transport any cylinders in closed vehicles where they occupy the same common airspace as personnel. Transport securely only in an upright position.

Do not remove valve protection bonnet and safety cap until immediately before use. Replace safety cap and valve protection bonnet when cylinder is not in use.

When cylinder is empty, close valve, screw safety cap onto valve outlet, and replace protection bonnet before returning to supplier. Only the registrant is authorized to refill cylinders. Do not use cylinder for any other purpose. Follow registrant's instructions for return of empty or partially empty cylinders.

Leak Procedures: Evacuate immediate area of leak. Use a NIOSH or MSHA approved positive pressure self-contained breathing apparatus (SCBA, not SCUBA) or combination air-supplied/SCBA respirator, such as manufactured by Ranger, Survivair, Scott, or MSA, for entry into affected areas to correct problem. Move leaking or damaged cylinder outdoors or to an isolated location, observing strict safety precautions. Work upwind if possible. Do not permit entry into leakage area by unprotected persons until concentration of fumigant in the breathing zone (areas within the structure where individuals typically stand, sit or lie down) is determined to be 1 part per million (ppm) or less. Confirm concentration of sulfuryl fluoride of 1ppm or less with a clearance device. Refer to EPA's website at Sulfuryl Fluoride | US EPA (<https://www.epa.gov/ingredients-used-pesticide-products/sulfuryl-fluoride>) for more information and a list of effective clearance devices. For more detailed information on the source and use of air monitoring devices or respirators, consult distributors for Vikane and for these devices and respirators.

Cylinder and Product Disposal: Promptly return all empty cylinders to your distributor of Vikane. Follow proper cylinder handling directions above.

Pesticide wastes are acutely hazardous. Improper disposal of excess pesticide is a violation of Federal law. If these wastes cannot be disposed of by use according to label instructions, consult your State Pesticide or Environmental Control Agency, or the Hazardous Waste Representative at the nearest EPA Regional Office for guidance.

Information

The Structural Fumigation Manual is part of the labeling for Vikane. Before using, read and follow all label precautions and directions. After the parties enter into a fumigation contract, the Fact Sheet for Vikane must be provided to an adult occupant of the structure to be fumigated or of each currently occupied unit in multi-unit structures.

Vikane is a highly hazardous material and must be used only by individuals knowledgeable of the hazards of this chemical and trained in the use of required respiratory equipment, fumigant detection devices, emergency procedures, and in the proper use of this fumigant.

When used for fumigation of enclosed spaces, such as houses and other structures, warehouses, vaults, chambers, trucks, vans, boxcars, ships, and other transport vehicles, 2 persons trained in the use of this product, at least one being an applicator who is licensed/certified by the state, must be present during introduction of fumigant, reentry prior to aeration, and during the initiation of the initial aeration procedure

when exposure exceeds 1 ppm. **Two persons need not be present if monitoring is conducted remotely (outside the area being fumigated) and no one enters the fumigated structure.**

If fumigating for insect pests, do not apply when temperature at site of pest activity is below 40°F. This temperature may be measured at the slab foundation, sub-floor soil, or wherever the coolest part of the structure may be. This restriction does not apply when fumigating for rodents.

When fumigating a single unit/room within or connected to a larger structure (such as town houses, apartments, condominiums), all units of the entire structure must be vacated during the fumigation and aeration periods.

Chloropicrin must be used as described on this label to warn of an ongoing fumigation.

Douglas Products' Product Stewardship Plan

Douglas Products' Product Stewardship Plan, that includes EPA's stewardship plan criteria, is available at Sulfuryl Fluoride I US EPA (<https://www.epa.gov/ingredients-used-pesticide-products/sulfuryl-fluoride>). Applicators and distributors of Vikane Gas Fumigant must participate in Douglas Products' Product Stewardship Plan for residential structural fumigations. This plan is also available at Sulfuryl Fluoride I US EPA (<https://www.epa.gov/ingredients-used-pesticide-products/sulfuryl-fluoride>) for Vikane Gas Fumigant. Vikane must only be used by application personnel who satisfactorily comply with the Vikane Stewardship Plan, including the initial and annual training requirements.

Preparation for Fumigation

Site-Specific Structural Fumigation Log

Structural Fumigation Log requirements. The following elements for structural fumigation for each site must be documented.

The Site-specific Structural Fumigation Log is intended to ensure a safe and effective fumigation. The certified applicator in charge of fumigation is responsible for verifying that a Fumigation Log must contain, as a minimum, the information listed below. The information followed by a "(B)" below must be documented before the initiation of the fumigation; other information listed below without a "(B)" must be documented during the fumigation process, if not before. Contracts, site graphs, dose calculation reports, state or federally required forms and/or other documents prepared for or used during the fumigation can be used as documentation for these Fumigation Log requirements. Fumigation employees who introduce chloropicrin and sulfuryl fluoride, initiate aeration, and/or conduct final clearance testing must have participated in the registrant's sulfuryl fluoride training, as required by the registrant's stewardship plan.

1. General Information:
 - a. Fumigation company (B)
 - b. Fumigation site address (B)
 - c. Structure type (B)
 - d. Target pest(s) (B)
2. Fumigant Introduction:
 - a. Dosing calculations:
 - i. Dosage factor
 - ii. Tarp condition
 - iii. Under seal type
 - iv. Seal condition
 - v. Wind (mph)
 - vi. Volume of fumigated space (1000 cubic feet) (B)
 - vii. Underseal
 - viii. Temperature
 - ix. Hours of Exposure
 - b. Introduction of chloropicrin and sulfuryl fluoride:
 - i. Name, license number, and signature of certified applicator responsible for introduction of chloropicrin and sulfuryl fluoride.
 - ii. Name(s) of second trained person(s) and certified applicator(s) assisting with introduction of chloropicrin and sulfuryl fluoride.

- iii. Total ounces of warning agent chloropicrin introduced and number of introduction sites.
 - iv. Cylinder serial number(s) of sulfuryl fluoride applied.
 - v. Pounds of fumigant applied.
 - vi. Date and time of fumigant release.
3. Aeration:
- a. Name, license number, and signature of certified applicator responsible for initiating aeration.
 - b. Name(s) of certified applicator(s) and second trained person(s) assisting with initiating aeration.
 - c. Date and time of aeration initiated.
4. Final clearance testing:
- a. Name, license number, and signature of certified applicator responsible for conducting final clearance testing.
 - b. Name(s) of certified applicators assisting final clearance testing.
 - c. Date and time final clearance testing completed.
 - d. Clearance device model type
5. Emergency response information:
- a. Get exposed person to fresh air. Call 911 or an ambulance. Keep exposed person warm and at rest. Make sure person can breathe freely. If breathing has stopped, give artificial respiration. Do not put anything in the mouth of an unconscious person.
6. Open Comment field:
- a. Provide an open field for additional comments or issues that is not captured in other sections of this Structural Fumigation Log.

Structural Fumigation

Remove from the structure to be fumigated all persons, domestic animals, pets, and desirable growing plants. See the Structural Fumigation Manual for instructions regarding the handling of fish tanks. For mattresses (excluding waterbeds) and pillows completely enveloped in waterproof coverings, do one of the following: 1) open the seal of the waterproof covering or 2) remove the mattress or pillow from the space to be fumigated if the waterproof covering cannot be opened. Mattresses and pillows with waterproof coverings containing built-in vents designed to permit air passage are considered to have an open seal to the waterproof covering and can remain as-is in the fumigated space. Food, feed, drugs (including tobacco products), and medicinals (including those items in refrigerators and freezers) can remain in the structure if they are in plastic, glass, or metal bottles, cans, or jars with the original manufacturer's air-tight seal intact. Food, feed, drugs (including tobacco products), and medicinals (including those items in refrigerators and freezers) not in plastic, glass, or metal bottles, cans, or jars with the original manufacturer's air-tight seal intact, need to be removed from the fumigation site, or double bagged in Nylofume® bags, which are available from distributors of Vikane.

Note: Extinguish all flames, including pilot lights of water heaters, gas refrigerators, ranges, ovens, broilers, dryers, gas fireplaces, etc. Turn off or unplug all electrical heating elements such as those in heaters, pianos, organs, etc. Shut off automatic switch controls for appliances and lighting systems which will be included in the space to be fumigated.

Prepare for Aeration Procedures 1 and 2 by doing the following:

- a) Open all operable attic doors and accesses and direct a fan into the attic.
- b) Position introduction and circulation fans to provide for air circulation throughout the fumigated space. For example, a circulation fan in the hall could be used to aid air circulating in bedrooms and bathrooms.
- c) For residential structures, use a minimum of one fan of at least 18 inches in diameter for every 22,500 cubic feet of space to be fumigated.¹

¹A residential structure is where people typically live (temporarily or permanently) and sleep, such as single-family residences, mobile homes, apartments, townhouses, condominiums, hotels, motels, assisted care facilities, nursing homes, hospitals, barracks, and dormitories.

Open operable internal doors, internal openings to attics and sub areas, furniture with large voids (such as wardrobes, etc.), cabinets, drawers, closets, and appliances (such as washers, dishwashers, dryers, microwave or conventional ovens, etc.). Using electric fan(s) will help provide for forced distribution and aeration of basements and other dead air spaces to facilitate rapid dispersion of gas. Refrigerator and freezer doors may be left open if the units are turned off or disconnected and all food items have been removed. If the applicator chooses to leave any appliance, including refrigerators and freezers closed during the fumigation, the appliances must be opened when clearing the structure until the concentration of Vikane in it is 1 ppm or less.

Multi-Unit Structures: When fumigating a single unit/room within a larger structure (such as townhouses, apartments, condominiums), all units of the entire structure must be prepared as a fumigated structure, and all applicable rules, regulations and label instructions apply, such as occupant notification, structure preparation, posting, securing, and aeration. An adult occupant of each currently-occupied unit must be provided with the Fact Sheet for Vikane. Ensure that all exterior entranceways and exterior doors providing access to individual units are secured with secondary locks (see Securing Structure Entrances) so that only the state licensed applicator in charge can gain access. Chloropicrin need only be used in the fumigated space where Vikane is introduced. During Step (3) of Aeration Procedure 1 or 2, check all units within the fumigated structure for concentrations of Vikane with a clearance device. Confirm concentration of sulfuryl fluoride of 1ppm or less with a clearance device. Refer to EPA's website at Sulfuryl Fluoride | US EPA (<https://www.epa.gov/ingredients-used-pesticide-products/sulfuryl-fluoride>) for more information and a list of effective clearance devices. If the concentration of Vikane is greater than 1 ppm in the breathing zone (i.e., areas within the structure where individuals typically stand, sit or lie down) in a unit, ventilate the unit with operable doors and windows open and continue to measure the concentration of Vikane until it is 1 ppm or less. Structure may be reoccupied when concentrations in the breathing zones in all units is 1 ppm or less.

Connected Structures: A connected structure is defined as any structure connected with the structure to be fumigated by construction elements (e.g., pipes, conduits, ducts, etc.) which may allow passage of fumigant between the structures. If state rules and regulations do not describe or permit a process to isolate and seal a connected structure to prevent passage of fumigant from the fumigated structure, then the connected structure must be vacated during the fumigation. When it is necessary to vacate any connected structure, that structure shall be considered as a fumigated structure and all applicable rules, regulations and label instructions apply, such as occupant notification, structure preparation, posting, securing, and aeration. Chloropicrin need only be used in structures where Vikane is introduced. Concentration levels of Vikane must be measured in the breathing zones (areas within the structure where individuals typically stand, sit or lie down) (see Aeration and Reentry) in any connected space or structure to confirm concentrations are 1 ppm or less before structure can be reoccupied.

Tarpaulin Fumigation

Open operable windows as permitted by local and state regulations and as described in the Vikane Gas Fumigant Structural Fumigation Manual. When tarping, use a highly resistant material such as a vinyl coated nylon, or polyethylene sheeting of at least 4 mil thickness. Seal all seams. Seal the bottom edges of the cover to the ground using materials such as soil, sand, or weighted "snakes." To minimize escape of gas through the soil and to avoid injury to nearby plants, wet soil outward from foundation to the cover if not sufficiently moist to act as a barrier for the gas.

Taped Fumigation

For fumigation sites that can be sealed with plastic, paper, or tape, seal adequately around doors, windows, vents, and other openings.

Chamber Fumigation

For chamber fumigation use a tightly-sealed chamber with adequate circulation.

Construction Materials, Furnishings (Household Effects), Vehicles, and Shipping Containers

Follow preparations as appropriate in above paragraphs for chamber, taped fumigation, or tarpaulin fumigation to assure good confinement of the gas for the recommended period of exposure.

Fumigation of Surface Ships in Port

Surface ships in size up to and including large ocean-going ships may be fumigated with Vikane to control the various pests listed. The professional fumigator and the ship's captain (or owner) shall follow all applicable regulations including those listed in the Coast Guard, DOT, Title 46, Shipping section, Parts 147A.1-147A.43. Except for those persons involved in fumigation, no people, plants, or pets may be on board during fumigation.

The person responsible for the fumigation must notify the master of the vessel, or his representative, of the requirements relating to personal protection equipment and detection equipment. Emergency procedures, cargo ventilation, periodic monitoring and inspections, and first aid measures must be discussed with and understood by the master of the vessel or his representative.

If leakage of the fumigant is detected, the person in charge of the fumigation shall take action to correct the leakage, or shall inform the master of the vessel, or his representative, of the leakage so that corrective action can be taken.

The vessel must not be moved during the fumigation and aeration periods. If reentry is necessary before aeration is completed, positive pressure self-contained respiratory protection must be worn.

Warning Agent

Chloropicrin is a warning agent introduced into the structure during fumigation. Chloropicrin is an effective warning agent but is not intended to be used to vacate people, pets, domestic animals, or feral animals from the structure prior to introduction of Vikane. Therefore, the structure to be fumigated must be inspected to confirm required preparations have been completed prior to introduction of chloropicrin. In order to avoid direct exposure to the fumigant being released, chloropicrin must be released within the structure at least 5 to 10 minutes prior to introduction of the fumigant. Place a handful of wicking agent (e.g., cotton) in a chloropicrin evaporation container(s). Do not use chloropicrin evaporation containers or application equipment made of magnesium, aluminum, or their alloys as chloropicrin may be severely corrosive to such metals. To enhance the distribution of chloropicrin throughout the structure, place the chloropicrin evaporation container in the air stream of a fan. Pour chloropicrin over the wicking agent. When adding chloropicrin to evaporation containers, dispense no more than 3 fl oz per container. Use 1 fl oz/10,000 to 15,000 cubic feet (30 ml/283 to 425 cubic meters) of space to be fumigated or follow dosage rate calculated by the Vikane Fumiguide® Calculator. Establish at least one chloropicrin introduction site for each 45,000 cubic feet of space to be fumigated. When applying chloropicrin at multiple chloropicrin introduction points within a structure, start at the point farthest from the exit and work toward the exit.

Removal of all chloropicrin evaporation containers from the fumigated space during the initial phase of aeration after tarp removal will aid in the dissipation of the warning agent from the structure.

Chloropicrin need not be used when fumigating passenger railcars; however, a thorough walk-through inspection must be performed of each railcar with doors being immediately locked upon leaving each car, and a guard must be posted during fumigant introduction, exposure period, and aeration.

Chloropicrin is a warning agent which causes smarting of the eyes, tears, and discomfort, and has a very disagreeable pungent odor at very low concentrations. Chloropicrin must be used by persons certified to apply Vikane or under their supervision. Applicators must observe the chloropicrin precautionary statements and personal protective equipment appearing in the "Release of Warning Agent" Chapter of the Vikane Gas Fumigant Structural Fumigation Manual.

Personal Protection Equipment**Eye Protection**

Wear splash-resistant goggles (goggles designed and made of material that allows no measurable movement of the liquid pesticide being used to pass through them during use) or full-face shield for eye protection during introduction of the fumigant.

Protective Clothing

Do not wear gloves or rubber boots. Do not reuse clothing or shoes that have become contaminated with liquid Vikane until thoroughly aerated and cleaned.

Respiratory Protection

If the concentration of Vikane in the breathing zone (areas within the structure where individuals typically stand, sit or lie down) of the fumigated area (as measured does not exceed 1 ppm (4 mg/cubic meter), no respiratory protection is required. Confirm concentration of sulfuryl fluoride of 1ppm or less with a clearance device. Refer to EPA's website at Sulfuryl Fluoride | US EPA (<https://www.epa.gov/ingredients-used-pesticide-products/sulfuryl-fluoride>) for more information and a list of effective clearance devices. When this concentration is exceeded, all persons in the exposed area must wear a NIOSH or MSHA approved positive pressure self-contained breathing apparatus (SCBA, not SCUBA) or combination air-supplied/SCBA respirator such as manufactured by Ranger, Survivair, Scott, or MSA. Before using any make or brand of SCBA, learn how to use it correctly. Determine that it has an adequate air supply for the job at hand, that it fits properly, providing an adequate seal around the face, and that it is in good working order. For more detailed information on the source and use of air monitoring devices and respirators, consult distributors for Vikane and for these devices and respirators.

Prefumigation Check: Check for potential leaks.

Securing Structure Entrances

To secure the structure against unauthorized entry during the fumigation exposure period and Step 2 of Aeration Procedure 1 or 2, use a locking device or barricade on all exterior doors or doorways. A locking device, such as a secondary lock, or barricade must be demonstratively effective in preventing an exterior door or doorway from being opened from the exterior using normal opening or entering processes by anyone other than the certified applicator in charge of the fumigation or persons in his/her on-site direct supervision. Consult state and local regulations for any supplementary instructions and restrictions on securing against entry. See the Vikane Gas Fumigant Structural Fumigation Manual for directions for securing Passenger Railcars.

Dosage and Exposure Time

For fumigation to control drywood termites and non-egg stages of other insect and related structural and household pests, the Vikane Fumiguide Calculator is to be used for the coordination of fumigant rates with soil or slab temperature, exposure period, and fumigant loss rate measured as half-loss-time (HLT). When control of the egg stage is desired or when fumigating for Formosan termites, use the indicated multiple factor of the drywood termite dosage (as determined by Vikane Fumiguide Calculator) for pests listed in the following table:

Pest	Dosage Factor (as a multiple of drywood termite dosage)
rodents ¹	1/2X
carpet beetles ² , German cockroaches, and other cockroach species ²	1X
Bedbugs	1.9X
furniture carpet beetles ²	3X
old house borers and Formosan termites	4X
clothes moths	6X
powder post beetles and death watch beetles	10X

These dosages apply to dwellings, buildings, construction materials, furnishings, and vehicles.

Do not use less than the specified dosage factors when treating for rodents, cockroaches, bed bugs, and termites.

¹To determine the proper dose for rodent control, use 80°F as the calculating temperature. Unlike insects, rodents are warm blooded and do not require increased dosages at lower temperatures.

²More than one fumigation may be needed to control the infestation after egg hatch.

For fumigation to control rodents, use sufficient gas to accumulate at least 36 ounce-hours following equilibrium, regardless of ambient air temperature. Refer to the Vikane Gas Fumigant Structural Fumigation Manual.

Software versions of the Fumiguide Calculator are available for use on various devices and platforms. Contact Douglas Products or your distributor of Vikane for information on how to obtain the Fumiguides.

Posting of Fumigated Areas

The following is a baseline of requirements for warning signs to be posted for fumigations using Vikane. States that currently have requirements that are comparable to the elements listed here, can maintain those requirements for warning signs. Additional elements imposed by states may also be added to these warning signs.

1. The applicator must post the fumigated areas with warning signs with a white background stating the following:
 - a. The signal word DANGER/PELIGRO at a minimum height of 2 inches, the SKULL and CROSSBONES symbol at a minimum height of 1 inch, and the statement "Area under fumigation, DO NOT ENTER/NO ENTRE" all printed in one or more colors contrasting with the white background.
 - b. The date of fumigation.
 - c. Brand name of fumigant used (minimum height ½ inch).
 - d. Name, address, and telephone number of the applicator, or company performing the fumigation.
2. Information on warning signs must remain legible and visible for the duration of the fumigation and aeration periods.
3. Warning signs must be placed on the structure at or near all doors and entrances.
4. On tented structures, additional warning signs must be placed on the outside of the tarp so that they are clearly visible from all accessible sides, and from any direction from which the site may be approached.

Introducing the Fumigant

Release the fumigant from outside the structure, tarp, or vehicle. The release point(s) should be into a large open space(s) in the fumigation site(s). Release the fumigant through a suitable leak-proof tube with a minimum burst pressure of 500 pounds per square inch (psi). Direct the fumigant into the blast of air from a fan(s) having a capacity of at least 1,000 cubic feet per minute (cfm) for each pound of Vikane released per minute. Damage to household materials can occur if insufficient fan capacity is used for the rate of Vikane released. It is recommended that protective sheeting, such as polyethylene plastic under the shooting stand, shooting hose, and shooting fan be used to further protect floors during application.

To prevent damage, do not apply fumigant directly to any surface.

Aeration and Reentry

Structures

No one is allowed in treated areas if the level of Vikane is above 1 ppm unless provided with a NIOSH or MSHA approved positive pressure self-contained breathing apparatus (SCBA, not SCUBA) or combination air supplied/SCBA respirator such as manufactured by Ranger, Survivair, Scott, or MSA.

Note: During the initial aeration procedure, approved respiratory protection must be worn until the concentration of Vikane is confirmed not to exceed 1 ppm. Confirm concentration of sulfurlyl fluoride of 1ppm or less with a clearance device. Refer to EPA's website at Sulfuryl Fluoride | US EPA (<https://www.epa.gov/ingredients-used-pesticide-products/sulfuryl-fluoride>) for more information and a list of effective clearance devices. Since clearance devices give immediate readings, respiratory protection is not required when clearing with these instruments after having completed the initial aeration procedure. If a reading indicates levels in excess of 1 ppm, leave the affected area immediately.

Aeration of Residential Structures

A residential structure is where people typically live (temporarily or permanently) and sleep, such as single-family residences, mobile homes, apartments, townhouses, condominiums, hotels, motels, assisted care facilities, nursing homes, hospitals, barracks, and dormitories.

Preparation

Prepare for Aeration Procedures 1 and 2 by doing the following:

- Open all operable attic doors and accesses and direct a fan into the attic.
- Position introduction and circulation fans to provide for air circulation throughout the fumigated space. For example, a circulation fan in the hall could be used to aid air circulating in bedrooms and bathrooms.
- Use a minimum of one fan of at least 18 inches in diameter for every 22,500 cubic feet of space to be fumigated.

Select the appropriate procedure based on the fumigation rate:

All residential structures² fumigated at 16 oz/MCF (1000 cubic feet of gas) or less may be aerated using Aeration Procedures 1 or 2.

All residential structures fumigated at concentrations greater than 16 oz/MCF must be aerated using Aeration Procedure 2.

Aeration Procedure 1

These steps must be completed in sequence.

Step (1): Aerate structure with all operable windows and doors open, aided by the use of at least one fan (of at least 18 inches in diameter) for every 22,500 cubic feet of fumigated space for a minimum of 2 hours following the directions in the Preparation section. If the structure has an attached garage, the door between the garage and structure should be open. If the structure has a central air system, turn on only the fan (or blower) for each operational unit. As an alternative, a circulation fan may be placed in front of a furnace inlet to blow air into central heating and cooling ducts. Removal of all chloropicrin evaporation containers from the fumigated space during Step (1) will aid in the dissipation of the warning agent from the structure.

Step (2): Secure structure and do not allow reentry for a minimum of 12 hours from the start of aeration (first opening of the seal) for residential structures.² During this time structures must remain posted with warning signs.

Step (3): After the minimum 12-hour waiting period in Step (2), measure the concentration of Vikane in breathing zones of each room with a clearance device. Refer to EPA's website at Sulfuryl Fluoride | US EPA (<https://www.epa.gov/ingredients-used-pesticide-products/sulfuryl-fluoride>) for more information and a list of effective clearance devices. If the concentration of Vikane is greater than 1 ppm, ventilate structure with operable doors and windows open and confirm concentrations are 1 ppm or less before the structure is reoccupied.

Aeration Procedure 2

These steps must be completed in sequence.

Step (1): Aerate structure with all operable windows and doors open, aided by the use of at least one fan (of at least 18 inches in diameter) for every 22,500 cubic feet of fumigated space, for a minimum of 2 hours following the directions in the Preparation Section. If the structure has an attached garage, the door between the garage and structure should be open. If the structure has a central air system, turn on only the fan (or blower) for each operational unit. As an alternative, a circulation fan may be placed in front of a furnace inlet to blow air into central heating and cooling ducts. Removal of all chloropicrin evaporation containers from the fumigated space during Step (1) will aid in the dissipation of the warning agent from the structure.

Step (2): Secure the structure and do not allow reentry for the minimum number of hours as listed in the **Table 1. Determining Minimum Hours of Aeration Time Based on Initial Concentration of Sulfuryl Fluoride Introduced**, from the start of aeration (first opening of the seal) for residential structures.² During this time the structure must remain posted with warning signs.

Table 1. Determining Minimum Hours of Aeration Time Based on Initial Concentration of Sulfuryl Fluoride Introduced

Initial Concentration of Sulfuryl Fluoride Introduced (ounces per thousand cubic feet)	Minimum Hours of Aeration Time**
Greater than 16 to 32	14
Greater than 32 to 48	16
Greater than 48 to 64	18
Greater than 64 to 96	20
Greater than 96 to 112	22
Greater than 112	24

**When the high ambient temperature for the aeration period is below 40°F at the fumigation site, a minimum of 24 hours of aeration is required.

² A residential structure is where people typically live (temporarily or permanently) and sleep, such as single-family residences, mobile homes, apartments, townhouses, condominiums, hotels, motels, assisted care facilities, nursing homes, hospitals, barracks, and dormitories.

Step (3): After the minimum waiting period, measure the concentration of Vikane in breathing zones of each room with a clearance device. Refer to EPA's website at Sulfuryl Fluoride | US EPA (<https://www.epa.gov/ingredients-used-pesticide-products/sulfuryl-fluoride>) for more information and a list of effective clearance devices. If the concentration of Vikane is greater than 1 ppm, ventilate structure with operable doors and windows open and confirm concentrations are 1 ppm or less before the structure is reoccupied.

Refer to Chapters 10 and 11 of the Vikane Gas Fumigant Structural Fumigation Manual for aeration procedures for non-residential structures, including passenger railcars, fumigation chambers, vehicles, vessels (surface ships), containers, and tarped stacks. Do not reoccupy the fumigation site, i.e., building, ship, vehicle, or chamber, or move the vehicle until aeration is complete. Warning signs must remain posted until aeration is determined to be complete.

Terms and Conditions of Use

If terms of the following Warranty Disclaimer, Inherent Risks of Use, and Limitation of Remedies are not acceptable, return unopened package at once to the seller for a full refund of purchase price paid. Otherwise, use by the buyer or any other user constitutes acceptance of the terms under Warranty Disclaimer, Inherent Risks of Use and Limitation of Remedies.

Warranty Disclaimer

Douglas Products and Packaging Company warrants that this product conforms to the chemical description on the label and is reasonably fit for the purposes stated on the label when used in strict accordance with the directions, subject to the inherent risks set forth below. TO THE EXTENT PERMITTED BY LAW, DOUGLAS PRODUCTS MAKES NO OTHER EXPRESS OR IMPLIED WARRANTY OF MERCHANTABILITY OR FITNESS FOR A PARTICULAR PURPOSE OR ANY OTHER EXPRESS OR IMPLIED WARRANTY.

Inherent Risks of Use

It is impossible to eliminate all risks associated with use of this product. Plant injury, lack of performance, or other unintended consequences may result because of such factors as use of the product contrary to label instructions (including conditions noted on the label, such as low temperature, soil conditions, etc.), abnormal conditions (such as excessive wind, tornadoes, hurricanes), presence of other materials, the manner of application, or other factors, all of which are beyond the control of Douglas Products or the seller. All such risks shall be assumed by buyer.

Limitation of Remedies

To the extent permitted by law, the exclusive remedy for losses or damages resulting from this product (including claims based on contract, negligence, strict liability, or other legal theories), shall be limited to, at Douglas Products' election, one of the following:

1. Refund of purchase price paid by buyer or user for product bought, or
2. Replacement of amount of product used.

Douglas Products shall not be liable for losses or damages resulting from handling or use of this product unless Douglas Products is promptly notified of such loss or damage in writing. In no case shall Douglas Products be liable for consequential or incidental damages or losses.

The terms of the Warranty Disclaimer, Inherent Risks of Use, and Limitation of Remedies cannot be varied by any written or verbal statements or agreements. No employee or sales agent of Douglas Products or the seller is authorized to vary or exceed the terms of the Warranty Disclaimer or Limitation of Remedies in any manner.

®Trademark of Douglas Products and Packaging Company ("Douglas Products")
EPA accepted xx/xx/xxxx