



UNITED STATES ENVIRONMENTAL PROTECTION AGENCY
WASHINGTON, DC 20460

OFFICE OF CHEMICAL SAFETY
AND POLLUTION PREVENTION

July 28, 2020

John F. Wright
Agent for Lebanon Seaboard Corporation
c/o Product & Regulatory Associates, LLC
8595 Collier Blvd., Suite 107-51
Naples, FL 34114

Subject: Notification per PRN 98-10 – Improve label text and graphic legibility (no new edits)
Product Name: Turf Broadleaf Weed Control
EPA Registration Number: 961-418
Application Date: May 1, 2020
Decision Number: 564366

Dear Mr. Wright:

The Agency is in receipt of your Application for Pesticide Notification under Pesticide Registration Notice (PRN) 98-10 for the above referenced product. The Registration Division (RD) has conducted a review of this request for its applicability under PRN 98-10 and finds that the action requested falls within the scope of PRN 98-10.

The label submitted with the application has been stamped “Notification” and will be placed in our records.

Should you wish to add/retain a reference to the company’s website on your label, then please be aware that the website becomes labeling under the Federal Insecticide, Fungicide, and Rodenticide Act (FIFRA) and is subject to review by the Agency. If the website is false or misleading, the product would be misbranded and unlawful to sell or distribute under FIFRA section 12(a)(1)(E). 40 CFR 156.10(a)(5) list examples of statements EPA may consider false or misleading. In addition, regardless of whether a website is referenced on your product’s label, claims made on the website may not substantially differ from those claims approved through the registration process. Therefore, should the Agency find or if it is brought to our attention that a website contains false or misleading statements or claims substantially differing from the EPA approved registration, the website will be referred to the EPA’s Office of Enforcement and Compliance.

If you have any questions, please contact Endia Blunt at 703-347-0788 or by email at Blunt.Endia@epa.gov.

Sincerely,

A handwritten signature in cursive script that reads "Mindy Ondish".

Mindy Ondish
Product Manager 23
Herbicide Branch
Registration Division (7505P)
Office of Pesticide Programs

NOTIFICATION

961-418

The applicant has certified that no changes, other than those reported to the Agency have been made to the labeling. The Agency acknowledges this notification by letter dated:

07/28/2020

TURF Broadleaf Weed Control

[Alternate Brand Name:
Preen Lawn Weed Killer]

ACTIVE INGREDIENTS:

2,4-dichlorophenoxyacetic acid	1.37%
(+)-(R)-2-(2 methyl-4-chlorophenoxy)propionic acid	0.31%
Dicamba: 3,6-dichloro-o-anisic acid	0.13%

OTHER INGREDIENTS:	<u>98.19%</u>
TOTAL	100.00%

THIS PRODUCT CONTAINS:

- 27.4 lb 2,4-dichlorophenoxyacetic acid equivalent per ton.
- 6.2 lb (+)-(R)-2-(2 methyl-4-chlorophenoxy)propionic acid equivalent per ton.
- 2.6 lb 3,6-dichloro-o-anisic acid equivalent per ton.

Isomer Specific by AOAC Methods

TRIMEC® is a registered trademark of PBI/Gordon Corporation.

KEEP OUT OF REACH OF CHILDREN CAUTION

STOP! READ THE ENTIRE LABEL FIRST. OBSERVE ALL PRECAUTIONS AND FOLLOW DIRECTIONS CAREFULLY.

See [back panel][booklet][container label] for First Aid and additional Precautionary Statements

EPA Reg.No. 961-418 (L) (D)
 EPA Est. No. 961-PA-01, 961-IL-01,
 Superscript used is first letter of lot number

Manufactured By: [Distributed By:] [Produced By:]
 Lebanon Seaboard Corporation
 1600 East Cumberland Street
 Lebanon, PA 17042

[Optional]Made [in the U.S.A.] [of U.S. and imported parts][of U.S. and global components]
www.lebsea.com [www.greenviewfertilizer.com] [www.preen.com]

Covers [X,XXX] Square Feet [SQUARE FEET] [SQ.FT.] [Sq.Ft.] [sq.ft.][sq ft]
 Net Weight: [Net Wt.:] [Net Wt][Net Wt] xx lbs. [LBS.][lb] [LB] [POUNDS] (xx.x kg) [(XX.X KG)] 30lbs (13.61kg)
 Treats: XX,XXX Sq.Ft. [SQ.FT.] [Square Feet] [SQUARE FEET] [sq.ft.][sq ft]

[Optional Heading: Care & Handling]
STOP! READ THE ENTIRE LABEL FIRST. OBSERVE ALL PRECAUTIONS AND FOLLOW DIRECTIONS CAREFULLY.

PRECAUTIONARY STATEMENTS

Hazards to Humans and Domestic Animals

CAUTION: Harmful if absorbed through skin. Harmful if inhaled. Avoid contact with skin, eyes, or clothing. Avoid breathing dust. Causes moderate eye irritation. Wash

thoroughly with soap and water after handling and before eating, drinking, chewing gum, using tobacco, or using the toilet. Wear long-sleeved shirt and long pants, socks, shoes, and gloves. Remove and wash contaminated clothing before reuse.

First Aid	
If on skin or on clothing:	<ul style="list-style-type: none"> • Take off contaminated clothing. • Rinse skin immediately with plenty of water for 15 - 20 minutes. • Call a poison control center or doctor for treatment advice.
If inhaled:	<ul style="list-style-type: none"> • Move person to fresh air. If person is not breathing, call 911 or ambulance, then give artificial respiration, preferably mouth-to-mouth if possible. • Call a poison control center or doctor for further treatment advice.
If in eyes:	<ul style="list-style-type: none"> • Hold eye open and rinse slowly and gently with water for 15 - 20 minutes. • Remove contact lenses, if present, after the first 5 minutes, then continue rinsing eye. • Call a poison control center or doctor for treatment advice.
If swallowed:	<ul style="list-style-type: none"> • Call a poison control center or doctor immediately for treatment advice. • Have person sip a glass of water if able to swallow. • Do not induce vomiting unless told to do so by a poison control center or doctor. • Do not give anything by mouth to an unconscious person.
Have the product container or label with you when calling a poison control center or doctor or going for treatment. For Emergency Medical Treatment Information call (888)208-1368.	

Environmental Hazards

This pesticide is toxic to fish and aquatic invertebrates and may adversely affect non-target plants. To protect the environment, do not allow pesticide to enter or run off into storm drains, drainage ditches, gutters or surface waters. Applying this product in calm weather when rain is not predicted for the next 24 hours will help to ensure that wind or rain does not blow or wash pesticide off the treatment area. Sweeping any product that lands on a driveway, sidewalk, or street, back onto the treated area of the lawn will help to prevent run off to water bodies or drainage systems.

This chemical has properties and characteristics associated with chemicals detected in groundwater. The use of this chemical in areas where soils are permeable, particularly where the water table is shallow, may result in groundwater contamination. Application around a cistern or well may result in contamination of drinking water or groundwater.

DIRECTIONS FOR USE

It is a violation of Federal law to use this product in a manner inconsistent with its labeling.

- Do not apply this product in a way that will contact any person or pet, either directly or through drift. Keep people and pets out of the area during application. Do not allow people or pets to enter the treated area until dusts have settled.
- This product is intended for residential use.

**[Optional Heading:] [INSTRUCTIONS:] [Use Instructions:] [Application Directions]
[Application Instructions]**

[TURF Broadleaf Weed Control or This product] controls a wide range of listed lawn weeds which includes dandelion, chickweed, knotweed, plantain, henbit, spurge and many others commonly found in home lawns. Retreatment may be necessary if (a) lawn is heavily overrun by weeds, or, (b) if adverse low moisture conditions prevail and weeds are in a state of poor growth. If necessary make a second application after 30 days.

For use on established warm season turfgrasses - includes bermudagrass, centipedegrass, and zoysiagrass.

For use on established cool season turfgrasses - includes Kentucky bluegrass, perennial ryegrass, tall fescue, and turf-type tall fescues.

USE RESTRICTIONS:

Do not apply this product on carpetgrass, dichondra, St. Augustinegrass, or established turf containing desirable clovers.

Do not apply this product to newly seeded grasses until well-established or after the second or third mowing.

Reseeding or overseeding areas may occur three (3) weeks after the application of this product.

Do not use this product on or in close proximity to desirable plants and do not spread granules onto exposed root systems or adventitious shoots (rhizomes) within the drip line of the roots of desirable trees and shrubs, since injury may result.

Do not use this product on flowers, vegetables, groundcovers, gardens or landscape plantings which includes shrubs and trees. Do not exceed specified dosage for any area and do not apply this product within the dripline of or over surface roots of trees, shrubs, and other ornamentals.

Do not apply directly to or near water, storm drains, gutters, sewers, or drainage ditches. Do not apply within 25 feet of rivers, fish ponds, lakes, streams, reservoirs, marshes, estuaries, bays, and oceans. Do not apply when windy. Apply this product directly to your lawn, and sweep any product landing on the driveway, sidewalk, gutter, or street back onto the treated area. To prevent product run-off, do not over water the treated area(s) to the point of runoff or apply when raining or when rain is expected that day.

[HOW MUCH TO APPLY:]

The maximum broadcast application rate is 2.0 pounds of product per 1,000 sq.ft. per application [(1.2 lb 2,4-D ae, 0.27 lb MCP-p ae and 0.12 lb dicamba ae per acre per application)]. The maximum number of broadcast applications is limited to 2 per year with a minimum of 30 days between applications. The maximum seasonal rate is 4.0 pounds of product per 1,000 sq.ft. [(2.4 lb 2,4-D ae, 0.54 lb MCP-p ae and 0.24 lb dicamba ae per acre)].

[WHEN TO APPLY:] [Note to reviewer one of the following statements will be on the label.]

Apply when listed broadleaf weeds are [actively] growing in spring or early fall.

[Apply when listed weeds are [actively] growing in spring]

[Apply when listed weeds are [actively] growing in fall]

[Apply when listed weeds are [actively] growing]

[Can be applied anytime listed weeds are growing]

Apply when the air is calm to ensure uniform coverage and do not spread granules onto flowers, vegetables, and ornamental shrubbery.

[WHAT TO EXPECT:] [APPLICATION INSTRUCTIONS:]

(Steps 1-5) – OPTION A:

1. Mow lawn to normal height 1 to 2 days before application.
2. Water lawn thoroughly at least 1 day before application to sustain moisture until the next watering (see step 5).
3. Apply when listed weeds are young and actively growing, preferably in the morning when dew is on the grass. If grass is not moist at time of application, sprinkle lightly with water to allow the granules to adhere and to remain on the leaf surface of the weeds.
4. Do not apply when temperatures are consistently above 90°F.
5. Do not wash [this product] from weed leaves for 1 to 2 days after application. After 1 to 2 days, thoroughly water the lawn.

(Steps 1-5) – OPTION B:

1. Mow lawn to normal height, 1 to 2 days before application.
2. For best results lawn must be MOIST and the air calm, when product is applied. When the lawn is moist, the product granules stick better to the leafy parts of the weeds, ensuring that the weed-killing ingredients are absorbed by the weed plant.
TIP: Apply after a heavy dew or rain, or on a thoroughly watered lawn.
TIP: DO NOT apply to a moist lawn **IF** rain is expected within 24 hours of application.
TIP: DO NOT water in immediately after application as the granules need to stick to the weed plant leaf for 1-2 days to be most effective.
3. Apply when weeds are young and actively growing.
4. Avoid applying when temperatures are consistently above 90°F.

5. After a 1-2 day period after application, if it has not rained – the lawn should be thoroughly watered.

[Optional Heading:] [Spreader Settings]

[Note: Registrant/Subregistrant will insert appropriate spreader setting information based on spreader models and use rate.]

Optional [Application Equipment and Instructions] [Spreader Directions]:

[Determining Your Lawn’s Square Footage

To determine how much of this product to apply, you must determine the square footage of your lawn. An easy way to do this is to walk the length of your lawn, figuring that one pace equals approximately 3 feet. Do the same with the width of the lawn. Then multiply the length by the width to arrive at the total. Make sure you subtract the square footage of your home and driveway when calculating the total square footage of your lawn. If your lawn has an irregular shape, try dividing it up into a number of square areas. Calculate the square footage for each area, then add the figures together to reach your total lawn size.]

[Insert icon representing footprint of house, driveway and lawn]

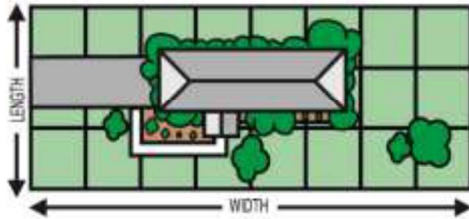

[above pictogram is optional]

Optional

[Determining the SIZE of Your Lawn]

[Simply multiply the length of the yard in feet, by the width in feet, to get the total size of the yard in square feet. Remember to subtract the square footage of the home and driveway and any additional large areas such as pools and flower beds, when calculating total square footage of the lawn so you don’t buy more product than actually needed.]

[Check the package for details on how many square feet it covers]

[Lot Size / Acre to Sq. Ft. Conversion:]

LOT SIZE / ACRE :	SQ. FT:
1/10	4,356
1/8	5,445
1/4	10,890
1/3	14,520
1/2	21,780
3/4	32,670
1 Acre	43,560

[Spreader Tips

The two main types of spreaders are the Drop Spreader, which drops the material straight down the width of the spreader as you push, and the Broadcast Spreader (also known as a rotary), which throws the material from the spreader.]

[Drop Spreader: [(See Fig. A.)]First make two passes along the top of the area you'll be covering. Then make two passes along the bottom area. Then move back and forth along the long part of the lawn. On each pass, as you reach the strips at the top and bottom of the area to be covered, shut off the spreader. It's also important to shut off the spreader when you are stopped.]

[Insert drop spreader icon]

[Insert icon showing spreader path]

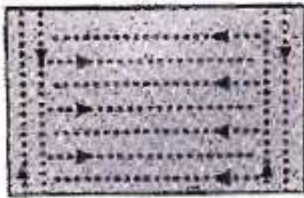

[] [above pictogram is optional] [Fig. A.]

[Broadcast Spreader: [(See Fig. B.)] Apply in a single pass by starting on the outside border and apply in a circular path working toward the center.]

[Insert broadcast spreader icon]

[Insert icon showing spreader path]

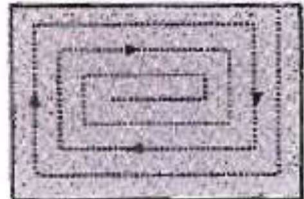

[] [above pictogram is optional][Fig. B.]

[Optional Spreader Language:]

[The above spreader settings are approximate. To check your spreader - 1.0 lb. of material covers approximately 500 sq.ft. (2.0 lbs. of material per 1,000 sq. ft.).

Note: if spreader model does not appear above please call [toll free] XXX-XXX-XXXX, X am – X pm [ET] [CT] [MT] [PT], [Monday – Friday] [Monday – Sunday] [Anytime] [24/7] for additional model settings.]

[SPREADER SETTINGS:]

[This container, with the Ready2Go Spreader attachment, is pre-calibrated for the contents enclosed. No additional settings are required.]

[Consult basic rate of application information, in the HOW MUCH TO APPLY section of instructions.]

[Altering speed of operation from target rate of application is NOT allowed and may provide varying results.]

For use on:

[bermudagrass], [centipedegrass], [Kentucky bluegrass], [tall fescue], [turf-type tall fescue], [zoysiagrass]

Drop Spreader	Setting [Delivers 2.0 lbs./1,000 sq.ft.]
Agri-Fab® Drop	xx
Greenview® Drop-Spred® XP1	xx
Red Devil® Drop (1-5)	xx
Republic®	xx
Scotts® Drop AccuGreen® (2-18)	xx
Scotts® Drop PF1 (2-18)	xx
Sta-Green® Drop (1-5)	xx
[Spreader model]	[xx]
Broadcast Spreader	Setting [Delivers 2.0 lbs./1,000 sq.ft.]
Agri-Fab® Rotary	xx
Cyclone® Rotary	xx
Earthway® Rotary	xx
Greenview® Jet-Spred® SS1	xx
Lesco® Rotary (dial A-S)/(number dial)	xx
Red Devil® Rotary (1-20)	xx
Republic® Rotary	xx
Scotts® EasyGreen®	xx
Scotts® EdgeGuard®	xx
Scotts® SpeedyGreen® 2000, 3000	xx
Sears® Craftsman Rotary	xx
Sta-Green® Rotary (1-10)	xx
True Temper® Rotary	xx
Vigoro® Rotary (1-10)	xx
[Spreader model]	[xx]

[These settings were calibrated and field tested. However, age and condition of spreader, speed of operation, and evenness of terrain may require slightly different settings for desired coverage.]

REFILL INSTRUCTIONS: [Optional for reusable rigid plastic container with application device]

- [This container with [spreader applicator] [Ready2Go Spreader™] is reusable with [TURF Broadleaf Weed Control or this product].
- Refill the container with desired amount of this product and use as directed.
- When done, store or dispose of this container as listed on the label.]

REFILL INSTRUCTIONS: [Optional for reusable rigid plastic container with application device] [This container with [spreader applicator] [Ready2Go Spreader™] is reusable with [TURF Broadleaf Weed Control or this product]. Refill the container with desired amount of this product and use as directed. When done, store or dispose this container as listed on the label.]

[Optional Storage and Disposal statement for use with reusable containers.]

STORAGE AND DISPOSAL

Do not contaminate water, food or feed by storage and disposal.

Pesticide Storage: Store product in its original container in a cool dry, locked place out of the reach of children and animals.

Pesticide Disposal and Container Handling: Nonrefillable container. Do not reuse or refill this container except as described in the DIRECTIONS FOR USE (see Refill Instructions). **If Empty:** Place in trash or offer for recycling if available. **If partly filled:** Call your local solid waste agency for disposal instructions. Never place unused product down any indoor or outdoor drain.

STORAGE AND DISPOSAL

Do not contaminate water, food, or feed by storage and disposal.

PESTICIDE STORAGE: Store this product only in its original container in a cool, dry, locked place out of the reach of children and animals.

PESTICIDE DISPOSAL AND CONTAINER HANDLING: Nonrefillable container. Do not reuse or refill this container. **If empty:** Place in trash or offer for recycling if available. **If partly filled:** Call your local solid waste agency for disposal instructions. Never place unused product down any indoor or outdoor drain.

WARRANTY

[NOTE] [To the extent consistent with applicable law, Buyer assumes all responsibility for safety and performance if this product is not used according to the directions.]

[Optional Warranty]

WARRANTY IMPORTANT: READ BEFORE USE

Read the entire Directions for Use, Conditions, Disclaimer of Warranties and Limitations of Liability before using this product. If terms are not acceptable, return the unopened product container at once.

By using this product, user or buyer accepts the following Conditions, Disclaimer of Warranties and Limitations of Liability.

CONDITIONS: The directions for use of this product are believed to be adequate and must be followed carefully. However, it is impossible to eliminate all risks associated with the use of this product. Crop injury, ineffectiveness or other unintended consequences may result because of such factors as weather conditions, presence of other materials, or the manner of use or application, all of which are beyond the control of Lebanon Seaboard Corporation [Company Name]. All such risks shall be assumed by the user or buyer.







DISCLAIMER OF WARRANTIES: To the extent consistent with applicable law, LEBANON SEABOARD CORPORATION [COMPANY NAME] MAKES NO OTHER WARRANTIES, EXPRESS OR IMPLIED, OF MERCHANTABILITY OR OF FITNESS FOR A PARTICULAR PURPOSE OR OTHERWISE, THAT EXTEND BEYOND THE STATEMENTS MADE ON THIS LABEL. No agent of Lebanon Seaboard Corporation [Company Name] is authorized to make any warranties beyond those contained herein or to modify the warranties contained herein. To the extent consistent with applicable law, Lebanon Seaboard Corporation [Company Name] DISCLAIMS ANY LIABILITY WHATSOEVER FOR SPECIAL, INCIDENTAL OR CONSEQUENTIAL DAMAGES RESULTING FROM THE USE OR HANDLING OF THIS PRODUCT.

LIMITATIONS OF LIABILITY: To the extent consistent with applicable law, THE EXCLUSIVE REMEDY OF THE USER OR BUYER FOR ANY AND ALL LOSSES, INJURIES OR DAMAGES RESULTING FROM THE USE OR HANDLING OF THIS PRODUCT, WHETHER IN CONTRACT, WARRANTY, TORT, NEGLIGENCE, STRICT LIABILITY OR OTHERWISE, SHALL NOT EXCEED THE PURCHASE PRICE PAID, OR AT LEBANON SEABOARD CORPORATION'S ELECTION, THE REPLACEMENT OF PRODUCT.]

Appendix I

[Optional Label Claims]

Claims – Miscellaneous

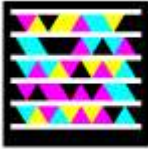
1.  (Symbol for Spring)
2.  (Symbol for Summer)
3.  (Symbol for Fall)
4.  (Symbol for Spring)
5.  (Symbol for Summer)
6.  (Symbol for Fall)
7.  [With variations for seasons which are ghosted out]
8. Apply in [Spring], [Fall]
9.  (MST – Mobile Scan Tag / color) Note, actual symbology varies from product to product, as with UPC codes.



10. (MST – Mobile Scan Tag / black & white)

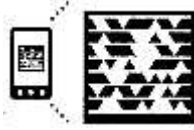

11. (MST – Mobile Scan Tag / black and white with phone icon)

12. Easy to Use.

13. Another great lawn and garden product, from the makers of Preen®.

14. Pet access to lawn once dust from application settles.

15. Pet access to lawn allowed once dust settles.



16. Must use the paw print pictogram with marketing claims No. 14 and 15 above].

17. [2] [3] [4] Season Lawn Care Program

18. [Bar code] [product number]

19. [Item number]

20. [Not] Proof of Purchase

21. Apply in spring and fall

22. Apply when weeds* are growing

23. For use on cool and warm season turfgrass

24. For use on [bermudagrass], [centipedegrass], [Kentucky bluegrass], [tall fescue], [turf-type tall fescue], [zoysiagrass]

25. For use on lawns

26. Keep your lawn looking great all year [Early Spring] [Late Spring] [Fall] [Insert other lawn product package images with product name]

27. Questions or Comments? Call 1-xxx-xxx-xxxx. [insert phone graphic]

28. This Bag Treats Up to ____ Square Feet

Claims regarding Weed Control Properties

1. 3 month [12 weeks] weed* grass control

2. Apply when [broadleaf] weeds* are [actively] growing [in spring or early fall] [Note: from the When to Apply section of the label]

3. Contains Trimec® Herbicide

4. Consistently fast on: tough weeds* like clover, plantain, ground ivy and spurge [various other weeds listed]

5. Controls [Kills] clover, dandelion, plantain, chickweed and [other broadleaf weeds*] [others as listed]

6. Controls [Kills] Dandelion, Clover, Chickweed, [Knotweed], [Henbit], Plantain, [and] Spurge [and Many Other Broadleaf Weeds as Listed on the Back Panel.]

7. Controls a Wide Spectrum of Broadleaf Weeds*

8. Controls Dandelion, White Clover, Plantain, Chickweed, Spurge and Many Other Listed Weeds*

9. Controls new weeds* for 3 months [12 weeks]

10. Destroys weeds* fast

11. For a beautiful weed-free* lawn [turf]

12. For use on: Kentucky bluegrass, perennial ryegrass, fescue spp., bermudagrass, centipedegrass and zoysiagrass.
13. Helps keep lawns [turf] weed-free*
14. Kills [down to] the root[!], [not the lawn]
15. Kills [major] broadleaf weeds* [like clover, dandelion, oxalis]
16. Kills [Over] [More Than] [XXX] [200] [Listed Weeds] [Weeds as listed] [*][!] [as Listed](note: 202 listed weeds)
17. Kills [xxx] [200] [listed] weeds* - dandelion, clover and other common lawn weeds*
18. Kills clover, dandelion, plantain, chickweed and other broadleaf weeds* (see list on back of bag)
19. Kills 200 weeds*
20. Kills 200 Lawn Weeds* To The Root!
21. Kills broadleaf weeds* in lawns [turf]
22. Kills clover, chickweed, spurge and many other broadleaf weeds*
23. Kills dandelions [and most lawn weeds*]
24. Kills dandelion and many other broadleaf weeds*
25. Kills even the tough[est] broadleaf weeds* [like clover, dandelion, oxalis]
26. Kills even the toughest weeds*
27. Kills fall lawn weeds*
28. Kills major broadleaf weeds* and roots. And [TURF Broadleaf Weed Control] is formulated to kill only the weeds*, not the lawn [turf]. Use as directed to kill major broadleaf weeds* in your lawn [turf].
29. Kills [more than] [over] 200 [tough] [lawn] weeds*
30. Kills over [xxx] [200] of the toughest weeds*
31. Kills over [xxx] [200] weed* types
32. Kills Over [XXX] [Listed] Weeds* [as Listed], Henbit, Dollar Weed, White Clover, Plantain and Chickweed
33. Kills [to] the root[!]
34. Kills the weeds*, not the lawn [turf]
35. Kills the toughest [lawn] weeds* [to the root]
36. Kills tough lawn [turf] weeds*
37. Kills weeds* growing in spring or fall
38. Kills weeds* [quickly and] completely
39. Kills weed* roots!
40. Kills weeds* now for few weeds in spring
41. Kills weeds* on contact
42. Kills weeds* to the root
43. [Preen] Kills weeds*, not lawn [turf] grasses
44. [Preen] Kills 200 Weeds* [to the root]
45. [Preen] Kills xx+ [200] Weeds*
46. Kills xx+ [200+] Weeds*; [Types,] Even the Roots.
47. Kills xx+ [200+] [Listed] Weeds* [Types] and Roots
48. Northern and Southern Grasses Bluegrass, Fescue, Zoysia, Bermuda, Centipede, Perennial Ryegrass
49. Provides broadleaf control
50. Starts working on contact
51. Targets weeds*, leaves [grasses] [the lawn] [the turf] unharmed

- 52. Tough on [lawn] weeds*
- 53. Tough weed killer
- 54. Treats Northern and Southern Grasses



- 55. Trimec® logo
- 56. Weed-fighting* formula
- 57. Use on Lawns [Turf] to Kill Tough Weeds* like Clover and Dandelion
- 58. Weed images [any listed weed]
- 59. Works on contact

*See Use Directions for complete list of treated weeds.

GreenView® Brand of Products Optional Marketing Claims

- 1. To the extent with applicable law, [GreenView®] [Company Name] guarantees you will be satisfied with the performance of this product when used as directed. If you are not satisfied, return to a[n] [Company name] store with proof of purchase for a replacement product or full refund of the purchase price. Or you can mail proof of purchase to the address listed below for a full refund. [Company name and address]
- 2. [GreenView®] [Company name] guarantees you will be satisfied with the performance of this product when used as directed, or your money back. If not satisfied, describe the nature of your problem and simply send proof of purchase to [Lebanon Seaboard Corporation, 1600 East Cumberland Street, Lebanon, PA 17042] [Company name and address].
- 3. For more information on our complete line of [GreenView®] [Company name] [Brand name] Lawn and Garden Products, visit our website at [www.lebsea.com] [www.greenviewfertilizer.com] [Insert product images]



- 4. GreenView® logo
- 5. GreenView® is a registered trademark of Lebanon Seaboard Corporation.
- 6. GreenView® yard wide guarantee [green leaf graphic] [GreenView® logo]



[* See back panel for more details] , as part of design only shown when used on label surfaces, other than the back panel)

Preen® Brand of Products Optional Marketing Claims

- 1. To the extent consistent with applicable law, [Company name] guarantees you will be satisfied with the performance of this product when used as directed, or your money back. If not satisfied, describe the nature of your problem, and send with proof of purchase to: [Company name and address]



2. Preen® logo
3. Preen® Guarantee
4. Preen® is a registered trademark of Lebanon Seaboard Corporation.
5. www.preen.com
6. Preen kills 200 listed weeds [as listed][*]
7. Preen works so you don't have to
8. Keep your lawn looking great all year [Early Spring] [Late Spring] [Fall] (show other Preen lawn package images with product name)
9. Try [these] other Preen products:
 - a. [Preen Lawn Stepsaver Weed Control Plus Fertilizer]
 - b.[Preen Lawn Weed & Feed]
 - c.[Preen [Garden] Weed Preventer Plus Plant Food]
 - d.[Preen [Garden] Weed Preventer]
 - e.[Preen Organic Vegetable Garden Weed Preventer]
 - f. [Preen Mulch Plus]
 - g. [Preen Lawn Crabgrass Control]
 - h. [Preen Southern Weed Preventer]
 - i. [Preen Southern Weed Preventer Plus Plant Food]
 - j. [Preen Lawn Weed Control Plus Crabgrass Preventer]
 - k.[Preen Weed & Grass Killer]
 - l. [Preen Landscape Weed Control Fabric]
 - m. [Preen [Garden] Weed Preventer with Battery-Powered Spreader Cap]
 - n.[Preen Southern Weed Preventer with Battery-Powered Spreader Cap]
 - o.[Landscape Mulch]

10. Scan the code to watch how Preen's Ready2Go Spreader™ [works][makes preventing lawn weeds easier than ever.][or visit <http://www.preen.com/ready2go-spreader>]



11. Scan the code to watch how Preen's Ready2Go Spreader™ [saves time][makes preventing lawn weeds easier than ever.][or visit <http://www.preen.com/ready2go-spreader>]



12. Scan the code to watch how Preen's Ready2Go Spreader™ [saves time and eliminates guesswork.] [or visit <http://www.preen.com/ready2go-spreader>]



ACE® Brand of Products Optional Marketing Claims

1. ACE® is a registered trademark of ACE Hardware Corp.
2. Green Turf® is a registered trademark of [Company Name]
3. Made in the USA for ACE Hardware Corp., Oak Brook, Illinois, 60523, USA
4. Questions or Comments Call 1-XXX-XXX-XXXX



5. Satisfaction Guaranteed ACE® Promise [circle graphic]
6. Telephone graphic
7. [Brand Name or This product] contains the latest technology in weed control. It kills over 200 of the toughest weeds.
8. The ACE® Promise. If this ACE product when used for its intended purpose, fails to give you complete satisfaction, return the item to the ACE Hardware store where purchased for free replacement of the same or similar item.
9. www.acehardware.com
- 10.



11.



12. When applied as directed, this product meets the guidelines for metals adopted by the Association of American Plant Food Control Officials.

Sta-Green® Brand of Products Optional Marketing Claims

1. Computer and phone graphics
2. If you use [TURF Broadleaf Weed Control] as directed and are not completely satisfied, send proof of purchase from this package and the original cash register receipt to the address below. We will refund the purchase price you paid.
3. LOOK! For other quality Sta-Green® lawn & garden products. For more information, visit us on our website at www.sta-green.com or call our Consumer Service [Customer Service] Hotline [Number] at 1-xxx-xxx-xxxx.
4. Money Back Guarantee [optional graphic]
5. Sta-Green® is a registered trademark of [Company name]



6. Sta-Green® logo
7. The Sta-Green® Promise
8. Your satisfaction guaranteed or your money back!

Private Label Customer brand of Products Optional Marketing Claims

1. To the extent consistent with applicable law, [Company name] guarantees you will be satisfied with the performance of this product when used as directed, or your money back. If not satisfied, describe the nature of your problem, and send with proof of purchase to: [Company name and address]
2. [Private label] is a registered trademark of [Company name]
3. [Private label] logo
4. Computer and phone graphics
5. If you use [TURF Broadleaf Weed Control] as directed and are not completely satisfied, send proof of purchase from this package and the original cash register receipt to the address below. We will refund the purchase price you paid.
6. LOOK! For other quality [Private Label] lawn & garden products. For more information, visit us on our website at or call our Consumer Service [Customer Service] Hotline [Number] at 1-xxx-xxx-xxxx.
7. Money Back Guarantee [optional graphic]
8. Your satisfaction guaranteed or your money back!

Agway® Brand of Products Optional Marketing Claims

1. Agway Lawn Weed Control
2. Agway Guarantees Satisfaction
3. If for any reason you are not fully satisfied with the performance of this product, we want to know. Just bring the item back to the store and we will exchange it or issue a refund.



4. Agway® logo
5. Guaranteed Satisfaction logo/pictogram
6. Manufactured for and distributed by Southern States Cooperative, Inc., 6606 West Broad Street, Richmond, VA 23230
7. To find an Agway store near you visit www.agway.com



- 8.



- 9.
10. [Brand] is a registered trademark of [Company]
11. [Brand] is a trademark of [Company]
12. 4 Stage Lawn Care Program
13. Agway Guarantees Satisfaction
14. Guarantees Satisfaction
15. Agway® and Greenlawn® are registered trademarks of Southern States Cooperative, Inc.
16. Agway® and Stage® are registered trademarks of Southern States Cooperative, Inc.
17. Calendar Application Icon
18. (Subregistrant) Guarantees Satisfaction
19. 4 Stage Lawn Care Program.[Pictogram numbers 1-4] [pictogram for 4 Step Program]
 - March 1 – April 30
 - April 15 – June 15
 - August 1- September 30
20. Agway [(Subregistrant)] Recommended 4 Stage Lawn Program makes it easier to have a lush, green lawn. Our 4 simple applications eliminate the guesswork and give you professional lawn care results. Each stage combines just the right amount of fertilizer with the right amount of control and prevention. Just match each stage to the correct season and you'll prevent crabgrass, control weeds [and insects] and prepare your lawn for the winter. It's what your lawn needs for strong growth.
21. AGWAY'S Greenlawn products are the quality choice in complete lawn care. You determine your lawn needs, and you'll find a Greenlawn product to help you. Fertilizers, lawn starters, crabgrass prevention, weed [and insect] control, winterizers - everything your lawn needs for a lush, green lawn and year-round protection. Each one is easy to apply and guaranteed to produce quick, long-lasting results.
22. Notice: Read the entire label. Use only according to label directions. Before buying this product, read the Warranty Section elsewhere on this label. If terms are not acceptable, return the unopened container at once.
23. AGWAY Guarantees Satisfaction If for any reason you are not fully satisfied with the performance of this product, we want to know. Just bring the item back to the store and we will exchange it or issue a refund.
24. For best results, use an Agway spreader.
25. For more information on spreader settings go to www.agway.com
26. For more information, visit www.agway.com

Vigoro Brand of Products Optional Marketing Claims



- 1.
2. Vigoro is a registered trademark of HOMER TLC, INC. CORPORATION

3. Vigoro, is a ® sub-brand of The Home Depot.
4. THD corporate address is: **The Home Depot** , 2455 Paces Ferry Road Atlanta, Georgia 30339
5. [Apply when listed weeds are actively growing] [APPLY WHEN LISTED WEEDS ARE ACTIVELY GROWING]
6. [Apply to a wet lawn] [APPLY TO A WET LAWN]
7. The Home Depot (logo)



8. Garden Club (logo)



9. MEMBERSHIP IS FREE!
10. www.homedepotgardenclub.com
11. Beautiful Lawns Since 1924™
12. Vigoro logo



13. Kills over 200 weed types! as listed
14. Kills down to the root!
15. Logo WORKS THE FIRST TIME OR YOUR MONEY BACK!



16. VIGORO GUARANTEE:
If for any reason you, the consumer, are not satisfied after using this product, you are entitled to get your money back. Simply send us proof of purchase and we will mail you a refund check promptly.
17. MONEY BACK GUARANTEE [If you are not satisfied with the performance of this product when used as directed, return to a Home Depot store with proof of purchase for a replacement product or full refund of the purchase price. Or you can mail proof of purchase to the address listed below for a full refund: Lebanon Seaboard Corporation, 1600 E. Cumberland Street, Lebanon, PA 17042.] [The Home Depot guarantees you will be satisfied with the performance of this product when used as directed. If you are not satisfied, return to

a Home Depot store with proof of purchase for a replacement product or full refund of the purchase price. Or you can mail proof of purchase to the address listed below for a full refund: Lebanon Seaboard Corporation, 1600 E. Cumberland Street, Lebanon, PA 17042.]

18. Visit Us On The Internet or Call Our Customer Satisfaction Hotline (image)



19. Vigoro.com or

18 . Spreader offering [Note: may insert appropriate spreader setting information based on desired spreaders and specified use rates as listed.]

19. DETERMINE SIZE OF AREA TO BE TREATED

[Insert Image for Spreader application.]



[above pictogram is optional]

20. [Insert icon showing spreader path]



[above pictogram is optional]

21. [Insert icon showing spreader path]



[above pictogram is optional]

Menards® Brand of Products Optional Marketing Claims:

- 1.



- 2.



- 3.
- 4.
- 5.



- 6. 100% Satisfaction Guaranteed or Your Money Back
- 7. Distributed by Eau Claire Coop Oil Co., P.O. Box 837, Eau Claire, WI 54702
- 8. ForeverGreen® is a registered trademark of E C Grow Incorporated Corporation.
- 9. Lawn Builder
- 10. Menards is a registered trademark of Menard, Inc. Corporation.

Pike Nurseries® Brand of Products Optional Marketing Claims



- 1.



- 2.
- 3. PIKE NURSERIES is a registered trademark of Pike Nurseries Acquisition, LLC.
- 4. Pike Nurseries Corporate Office, 2675 Breckinridge Blvd., Suite 300, Duluth, GA 30096
- 5. Satisfaction Guaranteed
- 6. SUPER PREMIUM

Armstrong Garden Centers Brand of Products Optional Marketing Claims



- 1. Armstrong Garden Centers, Inc. , 2200 E. Route 66, Suite 200, Glendora, CA 91740

Orchard Supply Brand of Products Optional Marketing Claims



- 1.



2.



3.

4. Orchard Supply Hardware is a registered trademark of Orchard Supply Hardware, LLC.

Orchard Supply Hardware, 6450 Via Del Oro, San Jose, CA 95119

OPTIONAL MARKETING CLAIMS FOR Ready2Go Spreader:

1. Ready2Go Spreader™ logo



2. Ready2Go SPREADER™

3. Ready2Go SPREADER and design is a trademark of Lebanon Seaboard Corporation.

4. Ready2Go SPREADER is a trademark of Lebanon Seaboard Corporation.

5. Ready2Go SPREADER is a registered trademark of Lebanon Seaboard Corporation.

6. www.Ready2GoSpreader.com

7. For more information on [Ready2Go Spreader™ products][this product][additional Ready2Go Spreader™ products], visit
[www.preen.com][www.greenviewfertilizer.com][www.Ready2GoSpreader.com]



8.

9. Ready2Go SPREADER™ REFILL

10. Optional pictograms of Ready 2 Go Spreader™ that may or may not appear on the product label.

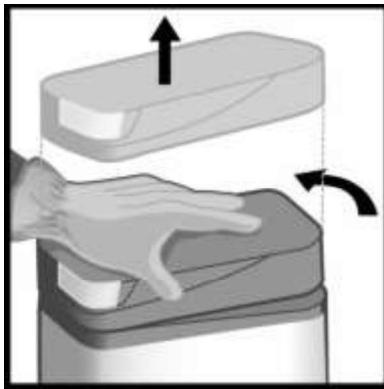

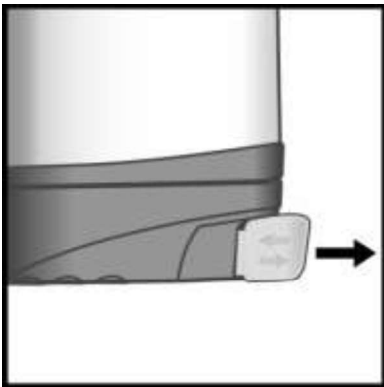
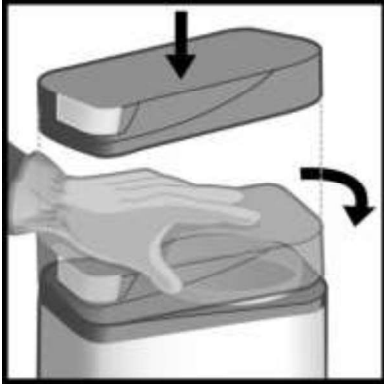

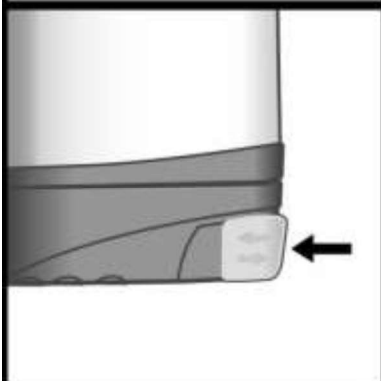
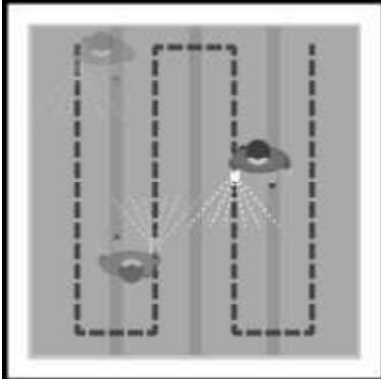
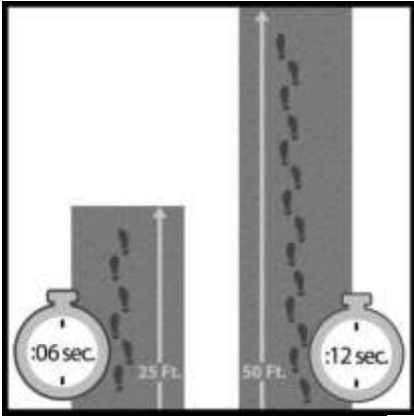



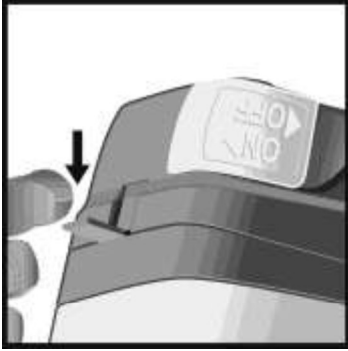

11. Ideal for [smaller] [Urban] [any sized] [any size] lawn[s]
12. Great for spot treatment of [larger] [any sized] [any size] lawn[s]
13. Ideal for treatment on uneven terrain
14. Ideal for application on more difficult terrain such as hilly or uneven areas where a traditional spreader is hard to push
15. Ideal for application on difficult terrain
16. Provides exceptional maneuverability.
17. Easy to maneuver for application around landscape items
18. Battery-powered spreader container is refillable.
19. Battery Powered with Refillable Container
20. Container is refillable.
21. Refillable container
22. Weed control product and spreader, all in one!
23. Weed *[control] [killer] and spreader, all in one.
24. Container with integrated [battery-powered] spreader [unit] [device] [applicator]
25. The Ready2Go Spreader™ way
26. It's ready to go.
27. Easy set up.
28. Easy to Use [.] [!]
29. Easy to store.
30. Pre-calibrated.
31. No settings required.

- 32. Calibrated, No Settings [!]
- 33. Easy to carry.
- 34. Easy to store.
- 35. Easy to carry and store.
- 36. Easy to hold.
- 37. Hold easily at side.
- 38. No pushing, no fatigue.
- 39. Easy to change directions when applying.
- 40. Apply walking forward, or backward.
- 41. You can easily avoid walking through areas where product is applied.
- 42. More flexibility and maneuverability when applying.
- 43. Hand held spreader.
- 44. For treating:
 - difficult terrain
 - spot treatment areas
- 45. Battery-powered
- 46. Weighs only [xx] lbs. when container is full.
- 47. R2G
- 48. Exceptional value – weed [killer] [control] and spreader in one
- 49. Ready2Go Spreader™ Directions: [Getting started] [(First time use)]

- [1]PLACE the Ready2Go Spreader™ UPSIDE DOWN on a flat surface (the [GREEN] [any color] BASE facing up).



- [Optional Pictogram or image]
- [2]HOLD the container steady and TURN the base COUNTER-CLOCKWISE [(to left)] [approximately quarter turn] until it STOPS and LIFT to remove.

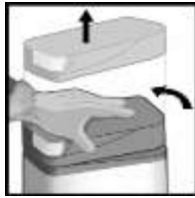

- [Optional Pictogram or image]
- [3]REMOVE the protective seal from the round opening, and [in one smooth movement] PULL the tab from the battery compartment.



[Optional Pictogram or image]

- [4]REALIGN the protruding tabs on the base with the slots on the container and TURN CLOCKWISE [(to right)] until the base LOCKS back in its original position.

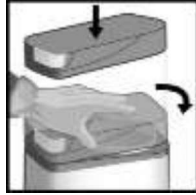

[Optional Pictogram or image]

- [5]FLIP the Ready2Go Spreader™ back to the UPRIGHT position. The Ready2Go Spreader™ is now ready to use.



[Optional Pictogram or image]

50. Ready2Go Spreader™ Directions: [Getting started] [(First time use)]

- [1] REMOVE the sticker from the [latch area][side] of the Ready2Go Spreader™.



[Optional Pictogram or image]

- [2] PLACE the Ready2Go Spreader™ UPSIDE DOWN on a flat surface (the [GREEN] [any color] BASE facing up).



[Optional Pictogram or image]

- [3] HOLD the container steady and flip the latch to open.



[Optional Pictogram or image]

- [4] TURN the base [COUNTER-CLOCKWISE] [(to left)] [approximately quarter turn] until it STOPS and LIFT to remove.

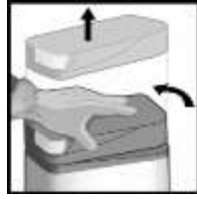

[Optional Pictogram or image]

- [5] REMOVE the protective seal from the round opening, and [in one smooth movement] PULL the tab from the battery compartment.



[Optional Pictogram or image]

- [6] REALIGN the protruding tabs on the base with the slots on the container and TURN [CLOCKWISE] [(to right)] until the base LOCKS back in its original position.

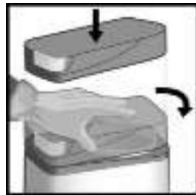

[Optional Pictogram or image]

- [7] SECURELY close the latch.



[Optional Pictogram or image]

- [8] FLIP the Ready2Go Spreader™ back to the UPRIGHT position. The Ready2Go Spreader™ is now ready to use.



[Optional Pictogram or image]

51. First time use

- [1] Place unit upside down on a flat surface [as shown].
- [2] Turn the [green] [any color] [R2G] spreader base counterclockwise a quarter turn and lift to remove.
- [3] Remove the protective seal on the container.
- [4] Remove the battery compartment pull tab to [activate] [power the unit].
- [5] [While still in an inverted position], realign the spreader base, with the container. Twist clockwise to lock into position.
- [6] Flip it to the upright position and you are ready to begin applying product.

52. First time use

- [1] Remove the sticker from the [latch area][side] of the Ready2Go Spreader™
- [2] Place unit upside down on a flat surface [as shown].
- [3] Holding the container steady, flip the latch to open.
- [4] Turn the [green] [any color] [R2G] spreader base [counterclockwise] a quarter turn and lift to remove.
- [5] Remove the protective seal on the container.
- [6] Remove the battery compartment pull tab to [activate] [power the unit].
- [7] While still in an inverted position], realign the spreader base, with the container. Twist [clockwise] to lock into position.
- [8] Securely close the latch.
- [9] Flip it to the upright position and you are ready to begin applying product.

53. Directions for applying the product [or product name] to your lawn:

- [1] Move to the lawn area to be treated.



[Optional Pictograms or images]

- POSITION the Ready2Go Spreader™ comfortably [at] [by] your side (arm fully extended), over the target area, and TURN ON by pulling back the on/off slide switch.

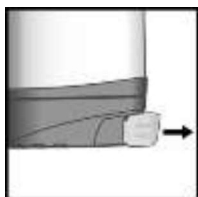

[Optional Pictograms or images]

- [2] When product begins spreading, WALK over the application area at a NORMAL WALKING PACE



[Optional Pictogram or image]

- (6 seconds for a 25' strip, or 12 seconds for a 50' strip).

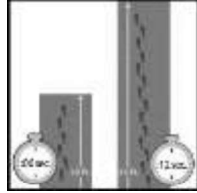

[Optional Pictogram or image]

- CONTINUE to within [2'] [two feet] of the end of the application area, and begin a new row by taking [2] [TWO] STEPS TO THE RIGHT OR LEFT, and walk back parallel to your first row. There should be a SLIGHT OVERLAP to the spread radius.

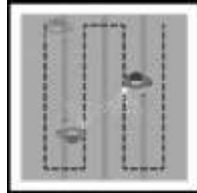

[Optional Pictogram or image]

- CONTINUE in this manner until you have finished applying the product.

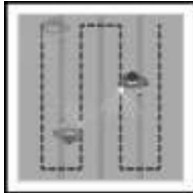

[Optional Pictogram or image]

- [3] TURN OFF the Ready2Go Spreader™ by PUSHING IN the slide switch.

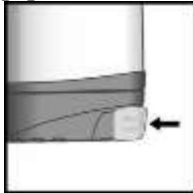

[Optional Pictogram or image]

- If product remains, store in a cool, dry place. If empty and lawn application is finished, simply refill the container.

54. Applying product with the Ready2Go Spreader™ applicator:

55. To Apply:

- Be sure you are on the lawn area to be treated.

- Hold the spreader comfortably at your side with arm fully extended downward.
- Pull the [yellow] [any color] slide switch at the side-back of the spreader/container ON and begin walking to apply.
- Apply according to the application instructions (pace) and pattern diagram (pattern) for best results.
- When product is depleted, push the [yellow] [any color] slide switch IN to turn the spreader OFF.
- If product remains, store in a cool, dry place. If empty and lawn application is finished, simply refill the container.

56. Target pace

57. Desired pattern

58. Refilling your Ready2Go Spreader™: [To refill your [R2G][Ready2Go] spreader™ container:]

- [1]PLACE the Ready2Go Spreader™ UPSIDE DOWN on a flat surface [the [GREEN] [any color] BASE facing up].
- [2]HOLD the container steady while TURNING the base COUNTER-CLOCKWISE until it STOPS and LIFT to remove.
- [3]CUT a corner opening on the [TURF Fertilizer Plus Trimec Ester Weed Control or product name] refill bag, and pour into the Ready2Go Spreader™ until the container is FULL.



[Optional Pictogram or image]

- [4]Replace the spreader unit base. [Align tabs and slots and twist clockwise into place]
- [5]FLIP the Ready2Go Spreader™ to the UPRIGHT position. The Ready2Go Spreader™ is now ready to operate. Follow application instructions.

59. Refilling your Ready2Go Spreader™: [To refill your Ready2Go Spreader Container:]

- [1]PLACE the Ready2Go Spreader™ UPSIDE DOWN on a flat surface [the [GREEN] [any color] BASE facing up].
- [2] HOLD the container steady and flip the latch to open.
- [3] TURN the base [COUNTER-CLOCKWISE] until it STOPS and LIFT to remove.
- [4]CUT a corner opening on the [TURF Fertilizer Plus Trimec Ester Weed Control or product name] [refill] [bag], and pour into the Ready2Go Spreader™ until the container is FULL.



[Optional Pictogram or image]

- [5]Replace the spreader unit base. [Align tabs and slots and twist [clockwise] into place]
 - [6]Securely close the latch.
 - [7]FLIP the Ready2Go Spreader™ to the UPRIGHT position. The Ready2Go Spreader™ is now ready to operate. Follow application instructions.
 -
60. To refill your Ready2Go Spreader™ container, while in the off position, flip the unit and place it on a flat surface.
- [1]Holding the container steady, grip the [green] [any color] base and twist it a quarter turn counterclockwise until it stops. Simply lift to remove.
 - [2]Open the refill bag, and pour contents into the container base until full.
 - [3]Replace the spreader unit base. [Align tabs and slots and twist clockwise into place]
 - [4]Return the container to an upright position and you are ready to go! Follow application instructions.
61. To refill your Ready2Go Spreader™ container, while in the off position, flip the unit and place it on a flat surface.
- [1]Holding the container steady, flip the latch and grip the [green] [any color] base and twist it a quarter turn [counterclockwise] until it stops. Simply lift to remove.
 - [2]Open the [refill] bag, and pour contents into the container base until full.
 - [3]Replace the spreader unit base. [Align tabs and slots and twist [clockwise] into place]. Secure the latch.
 - [4]Return the container to an upright position and you are ready to go! Follow application instructions.
62. To replace batteries:
- Access the battery compartment on the inside of the spreader base.
 - Battery compartment door opens by pinching tab and lifting to open.
63. Requires [1] [2] [3] [4] [AA] [AAA] [C] [D] batteries (included).
64. Batteries are [disengaged] [inactivated] for shipment. [Simply pull [protection] [protective] tab from battery compartment to engage battery power.]
65. Use [Battery type] batteries.
66. Rechargeable batteries may be used.
67. Batteries included, but disabled for shipment. Pull tab from battery compartment to activate.

- 68. Pull tab to activate batteries.
- 69. Do not mix old and new batteries.
- 70. Do not mix alkaline, standard (carbon-zinc), or rechargeable [(ni-cad, ni-mh, etc)] batteries.
Save time, easy to apply
- 71. Save time.



*As compared to traditional fertilizer spreader setup and application

72.



*As compared to traditional fertilizer spreader setup and application

- 73.
- 74. Product goes on evenly.
- 75. No spreader maintenance [just change batteries]
- 76. Battery life typically [insert number] applications.
- 77. No settings.
- 78. No guesswork.
- 79. Minimum set up – Just flip the switch and go!
- 80. Easy to maneuver to avoid trees, shrubs and gardens during application.
- 81. Take pride in your lawn, pride in your neighborhood.
- 82. Make caring for your lawn, easy and fun!
- 83. Lawn not level, low spots and puddles?
- 84. More even distribution of weed [killer] [control] on uneven terrain.
- 85. Ideal for spot treatments on difficult terrains
- 86. Goes on evenly.
- 87. Spreads evenly.
- 88. Don't be afraid to do it yourself and save. Ready2Go Spreader™ makes it easy.
- 89. Storage convenience.
- 90. Easy to store on shelf.
- 91. A weed*-free lawn is a heartier lawn.

92. Integrated battery powered spreader
93. Keep your lawn looking the best it can
94. Treat ugly spots and lawn patches easily
95. The easy way to a beautiful [yard][lawn]
96. [Beat] [Knock] back weeds* in your lawn in one simple step
97. Is your lawn sparse in certain areas?
98. Treat sparse lawn spots
99. A beautiful lawn can be an asset
100. Spreader setting is fixed [No settings required]
101. Pre-calibrated, no settings – get it right every time!
102. Change direction easily
103. YOU are in control
104. A real time saver
105. Easy to refill and store
106. Remove guesswork. Settings are pre-calibrated.
107. Don't worry if you're doing it right. [Ready2Go Spreader™ is just that – Ready to go!]
108. No more worries about getting it right. No more guesswork. Just flip the switch and go! Follow all label directions.
109. Treat the whole lawn.
110. Spot treatment and added maneuverability have revolutionized the way we spread weed [control] [killer] products.
111. Treat the whole lawn, or just your trouble spots.
112. No spreader to push and pull.
113. No maintenance, no clogging.
114. Makes applying weed [control] [killer] products on uneven or hilly lawn terrain a breeze.
115. Flip container
116. Twist [Right] [Left] Base
117. Lift Base
118. Set Container Upright
119. Pull [On] [Off] [Slider] [Lever] [Button] [Slide Switch] [On] [Off]
120. Push [On][Off] [Slider] [Lever] [Button][Slide Switch] [On] [Off]
121. Set on Flat, Stable Surface
122. Fill Container
123. Refill Container
124. Refillable container – use again and again
125. Pour Refill Contents Into Container
126. Push [Slider] [Lever] [Button] [Slide Switch] In to Stop
127. Return to upright position

- 128. Relax and Extend Arm
- 129. Hold [Grip] [Handle]
- 130. Reusable applicator base
- 131. Includes [1] [2] [3] [4] [AA] [AAA] [C] [D] batteries
- 132. Dispenses evenly for better results
- 133. Lift here to open.
- 134. Press to reseal
- 135. Remove prior to first use



- 136.
- 137. Use protective eyewear when using battery powered spreader
- 138. See inside booklet for complete directions for use.
- 139. Overlap [Rows] [Slightly] [6][any number] ["] [inches]
- 140. [:xx] [sec] [seconds]
- 141. R2G
- 142. Visit [www.preen.com] [www.greenviewfertilizer.com] [for gardening] [for lawn] [and weed prevention] tips, [and] [valuable offers] [and more information on] [Preen products] [GreenView products] [insert brand].
- 143. [\$1.50] [\$2.00] [\$2.50] [\$3.00] [\$4.00] [\$5.00] off [regular price] [visit www.Preen.com] [www.greenviewfertilizer.com][for details] [see store associate for details].
- 144. [\$1.50] [\$2.00] [\$2.50] [\$3.00] [\$4.00] [\$5.00] off a future [Preen] [GreenView] [insert brand] purchase [of select [brand] products.] [Visit www.preen.com] [Visit www.greenviewfertilizer.com] [for details] [see store associate for details].
- 145. [\$1.50] [\$2.00] [\$2.50] [\$3.00] [\$4.00] [\$5.00] rebate [visit www.preen.com] [visit www.greenviewfertilizer.com] [for details] [see store associate for details].
- 146. [\$1 - \$10] Rebate (-) [Visit www.preen.com] [Visit Preen.com] [Visit www.greenviewfertilizer.com] for offer details [, & complete terms & conditions.] [Expires [place holder for DATE].] [Limit 1 request per household.] [Void where prohibited.]
- 147. Combo Pack
- 148. Combo Pack – [product name] Ready2Go Spreader™ and [product name] Refill Bag
- 149. Value Pack
- 150. Value Pack – [product name] Ready2Go Spreader™ and [product name] Refill Bag
- 151. Great Value – [Combo] [Combination] [Pak] [Pack]
- 152. COMBO PACK: Contains [1] Spreader Container and [1] Refill Bag
- 153. Total Combined Lawn Coverage: 5,000 Sq. Ft.

154. Combo Pack: Contains (1) Ready2Go Spreader™ [Container] with product, and (1) Ready2Go Spreader™ Refill Bag
155. Combo Pack: Contains: (1) Ready2Go Spreader™ [Container] with [product name] (2,500 Sq. Ft. Coverage) and (1) Ready2Go Spreader™ Refill Bag with [product name] (2,500 Sq. Ft. Coverage)
156. Combo Pack: (2) Ready2Go Spreaders containing [product name] [a] [-] total coverage of 5,000 Sq. Ft

*See Use Directions for complete list of treated weeds.

Appendix II

[TURF Broadleaf Weed Control] Controls [Kills] [200] [more than ###] listed weeds! (List of weeds may include the following):

WEEDS

Annual yellow sweetclover	Clover, white	Musk thistle	Spiny cocklebur
Aster	Cockle	Mustard	Spiny sowthistle
Austrian fieldcress	Cocklebur	Narrowleaf plantain	Spotted catsear
Bedstraw	Common mullein	Narrowleaf vetch	Spotted spurge
Beggarticks	Creeping jenny	Nettle	Spurweed
Betony, Florida	Cudweed	Orange hawkweed	Stinging nettle
Bindweed, field	Curly dock	Oriental cocklebur	Strawberry, India mock
Bird vetch	Daisy, English	Oxalis	Tall nettle
Bitter wintercress	Daisy fleabane	Parsley-piert	Tall vervain
Bittercress, hairy	Daisy, oxeye	Parsnip	Tansy ragwort
Bitterweed	Dandelion	Pearlwort	Tansy mustard
Black-eyed Susan	Dichondra	Pennycress	Tanweed
Black medic	Dogbane	Pepperweed	Thistle
Black mustard	Dogfennel	Pigweed	Trailing crownvetch
Blackseed plantain	Dollarweed	Pineywoods bedstraw	Tumble mustard
Blessed thistle	False dandelion	Plains coreopsis	Tumble pigweed
Bloodflower milkweed	Falseflax	Plantain	Velvetleaf
Blue lettuce	False sunflower	Poison ivy	Venice mallow
Blue vervain	Fiddleneck	Poison oak	Virginia buttonweed
Bracted plantain	Florida pusley	Pokeweed	Virginia creeper
Brassbuttons	Frenchweed	Poorjoe	Virginia pepperweed
Bristly oxtongue	Galinsoga	Prairie sunflower	Wavyleaf bullthistle
Broadleaf dock	Goldenrod	Prickly lettuce	Western clematis
Broadleaf plantain	Ground ivy	Prickly sida	Western salsify
Broomweed	Gumweed	Prostrate knotweed	White mustard
Buckhorn	Hairy fleabane	Prostrate pigweed	Wild aster
	Hawkweed	Prostrate spurge	Wild buckwheat

[TURF Broadleaf Weed Control] Controls [Kills] [200] [more than ###] listed weeds! (List of weeds may include the following):

WEEDS

Buckhorn plantain	Healall	Prostrate vervain	Wild carrot
Bulbous buttercup	Heartleaf drymary	Puncturevine	Wild four-o'clock
Bull thistle	Heath aster	Purslane, common	Wild garlic
Bullnettle	Hedge bindweed	Ragweed	Wild geranium
Burclover	Hedge mustard	Red sorrel	Wild lettuce
Burdock	Hemp	Redroot pigweed	Wild marigold
Burning nettle	Henbit	Redstem filaree	Wild mustard
Burweed	Hoary cress	Rough cinquefoil	Wild onion
Buttercup	Hoary plantain	Rough fleabane	Wild parsnip
Buttonweed	Hoary vervain	Russian pigweed	Wild radish
Canada thistle	Horsenettle	Russian thistle	Wild rape
Carolina geranium	Jimsonweed	Scarlet pimpernel	Wild strawberry
Carpetweed	Knawel	Scotch thistle	Wild sweet potato
Catchweed bedstraw	Knotweed	Sheep sorrel	Wild vetch
Catnip	Kochia	Shepherdspurse	Woodsorrel
Catsear	Lambsquarters	Slender plantain	Woolly croton
Chickweed, common	Lespedeza	Smallflower galinsoga	Woolly morningglory
Chickweed, mouseear	Mallow	Smooth dock	Woolly plantain
Chicory	Matchweed	Smooth pigweed	Wormseed
Cinquefoil	Mexicanweed	Sorrel	Yarrow
Clover, crimson	Milk vetch	Sowthistle	Yellow rocket
Clover, hop	Morningglory	Spanishneedles	Yellowflower
Clover, red	Mouseear hawkweed	Speedwell	pepperweed
Clover, strawberry	Mugwort	Spiny amaranth	and other broadleaf
Clover, sweet			weeds